

Kingsmen (Thames) Inc. / Havelock Corners (Kingsmen)

Lot/Unit: 83 Phase/Building: 4A Model/Floor Plan: Arthur (4205) Elev C 4 Bed - 4+1 Bath

CABINETRY

Inv.4711	1 - To supply & install a different colour island in the kitchen.... see colour chart for details	
Line 60224	Note:	
10Aug20 / 10Aug20		

CABINETRY APPLIANCE - FRIDGE

CABINETRY MICROWAVE OVEN STOVE COOKTOP

CARPET

Inv.4711	1 - To supply & install the CORONET Escape to Maui carpet to the master bedroom, bedroom #2, #3 & #4 in lieu of the standard carpet.... see colour chart for details.	
Line 60222	Note: Still to install the standard under pad.	
10Aug20 / 10Aug20		

ELECTRICAL

HARDWOOD

Inv.4711	1 - To supply & install the STAINED KENTWOOD PROGRESSIVES OAK 3 1/2" - - UPPER HALL & Computer loft area in lieu of the standard carpet... see colour chart for details.	
Line 60215	Note:	
10Aug20 / 10Aug20		

HEATING AND AIR CONDITIONING

MISCELLANEOUS

Inv.4711	1 - Purchaser has selected their interior finishes on August 10, 2020.	
Line 60214	Note:	
10Aug20 / 10Aug20		

PLUMBING

RAILING

Inv.4711	1 - To supply & install the RAILING - UPGRADE 1 - METAL HANDRAIL 3 INCH OVAL IN OAK - PICKETS STEEL ½ INCH SQUARE, PLAIN, WITH SHOES IN FLAT BLACK - POSTS 3½ INCH SQUARE, WITH CAP OAK IN OAK in lieu of the standard pickets and rails.	
Line 60216	Note:	
10Aug20 / 10Aug20		

TILE - FLOOR

Inv.4711	1 - To supply & install the UPGRADE 3 - FLOOR TILE - - FOYER TILE in lieu of the standard floor tiles... see colour chart for details... see sketch #3 for direction of stacked tile.	
Line 60217	Note:	
10Aug20 / 10Aug20		
Inv.4711	1 - To supply & install the UPGRADE 3 - FLOOR TILE - MUDROOM TILE in lieu of the standard floor tiles... see colour chart for details... see sketch #3 for direction of stacked tile.	
Line 60218	Note:	
10Aug20 / 10Aug20		



CONSTRUCTION SUMMARY

Kingsmen (Thames) Inc. / Havelock Corners (Kingsmen)

Lot/Unit: 83 Phase/Building: 4A Model/Floor Plan: Arthur (4205) Elev C 4 Bed - 4+1 Bath

Inv.4711	1 - To supply & install the UPGRADE 3 - FLOOR TILE - POWDER ROOM TILE in lieu of the standard floor tiles... see colour chart for details... see sketch #3 for direction of stacked tile.	
Line 60219	Note:	
10Aug20 / 10Aug20		
Inv.4711	1 - To supply & install the UPGRADE 3 - FLOOR TILE - KITCHEN/BREAKFAST TILE in lieu of the standard floor tiles... see colour chart for details... see sketch #3 for direction of stacked tile.	
Line 60220	Note:	
10Aug20 / 10Aug20		
Inv.4711	1 - To supply & install the UPGRADE 2- FLOOR TILE - ENSUITE FLOOR TILE in lieu of the standard floor tiles... see colour chart for details... see sketch #4 for direction of stacked tile.	
Line 60221	Note:	
10Aug20 / 10Aug20		

TILE - WALL

Inv.4711	1 - Install all wall tiles where applicable in the master ensuite, bed #2's, #3's & #4's bathroom on the 10" side staked horizontally.	
Line 60223	Note:	
10Aug20 / 10Aug20		

EXTRAS AS PER OFFER

Purchasers: RAJA SAAD D KABIR & HINA HAQ NAWAZ GOI Property: 83 of Plan - Draft Approval SB17-03-08
 Telephone Res. / Bus: / Project: Kingsmen (Thames) Inc.
 Decor Advisor: Barbara Coccia Model and Elevation: Arthur (4205) Elev C 4 Bed - 4+1 Bath

Layout Changes: ☐ Yes ☒ No Sketch Attached: ☒ Yes ☐ No Exterior Colour Scheme:

1. Cabinetry

	Style and Colour	Counter Top	Hardware
Kitchen / Breakfast	#3 Charleston 3DL Orchid	#1 C/S #3040 Cement 3cm	Handle #12843
Kitchen Island	#3 Charleston 3DL Moonlight	#1 C/S #3040 Cement 3cm	Handle #12843
Laundry Room	/	/	/
Powder Room	#3 Charleston 3DL Orchid	Inukshuk Grey P-344-LM	Handle #12881
Main Bathroom	/	/	/
Master Ensuite Bathroom	#3 Charleston 3DL Navy Blue	Calcutta Marble 4925K-07	Handle #12881
Second Ensuite Bathroom (If Applicable)	#3 Charleston 3DL Moonlight	Calcutta Marble 4925K-07	Handle #12881
Bed #3 Bathroom	#3 Charleston 3DL Raincloud	Calcutta Marble 4925K-07	Handle #12881
Bed #4 Bathroom	#3 Charleston 3DL Moonlight	Calcutta Marble 4925K-07	Handle #12881

Appliances Custom Size Fridge ☐ Yes ☒ No Valance Lighting ☐ Yes ☒ No Microwave / Range Hood ☐ Yes ☒ No

Cooktop / Rangetop ☐ Yes ☒ No Built in Wall Oven ☐ Yes ☒ No Slide-in Range ☐ Yes ☒ No

Comment /

2. Flooring

	Selection
Foyer	***UPG #3 12x24" Mayfair Statuario Venato HD Polished Rect. Porcelain STACKED
Main Hall	/
Back Hall	/
Breakfast	***UPG #3 12x24" Mayfair Statuario Venato HD Polished Rect. Porcelain STACKED
Laundry Room	13x13" Malena Ice ✓
Kitchen	***UPG #3 12x24" Mayfair Statuario Venato HD Polished Rect. Porcelain STACKED
Powder Room	***UPG #3 12x24" Mayfair Statuario Venato HD Polished Rect. Porcelain STACKED
Main Bathroom	(Bedroom #3) 13x13" Malena Carbon SH/FL- 2x2" Soho White Matte "Bathroom" BC
Master Ensuite Bathroom (If Applicable)	**UPG #2 12x24" Classic Cararra HD Porcelain Title STACKED SH/FL- 2x2" Soho White Matte
Mud Room	***UPG #3 12x24" Mayfair Statuario Venato HD Polished Rect. Porcelain STACKED
Bed. #2 & #4 Bathroom	13x13" Malena Ice
Living Room	/
Dining Room	3 1/2" Elements Oak Sturgeon
Family / Great Room	3 1/2" Elements Oak Sturgeon
Den / Library / Study	3 1/2" Elements Oak Sturgeon
Basement Landing (If Applies)	/
Lower Landing (If Applicable)	/
Upper Landing	/
Upper Hall	*3 1/2" Elements Oak Sturgeon (Including computer niche)
Master Bedroom	*Escape to Maui #14722 Macrame
Bedroom #2	*Escape to Maui #14722 Macrame
Bedroom #3	*Escape to Maui #14722 Macrame
Bedroom #4	*Escape to Maui #14722 Macrame
Bedroom #5	/
Shower Jamb	Master Ensuite & Bed. #3 Bathroom- Anatolia Marmiline Snow

Flooring Continued on Page 2

Initial: 

Page 1 of 3

Purchasers: RAJA SAAD D KABIR & HINA HAQ NAWAZ GOI Property: 83 of Plan - Draft Approval SB17-03-08
Telephone Res. / Bus: / Project: Kingsmen (Thames) Inc.
Decor Advisor: Barbara Coccia Model and Elevation: Arthur (4205) Elev C 4 Bed - 4+1 Bath

4. Flooring - Continued -

Upgrade Underpad	Type	Area
	STD	Master, Bedroom #2, #3, & #4
Carpet on Stairs	Capped	Runner - *Upgrade
Comment	/	/

3. Plumbing Fixtures / Faucets

Kitchen	STD	Second Ensuite	STD	Powder Room	STD
Master Ensuite	STD			Other Room	/
Main Bathroom	/	Bed. #3 & #4 Bathroom	STD		

Comment

Still to supply and install the standard undermount sink in the kitchen.

4. Wall Tile

	Tile Selection	Listello	Insert	Insert Selection
Main Bathroom	/	<input type="checkbox"/>	<input type="checkbox"/>	/
Master Ensuite				
Tub Deck	/	<input type="checkbox"/>	<input type="checkbox"/>	/
Tub Apron	/	<input type="checkbox"/>	<input type="checkbox"/>	/
Tub Surround	/	<input type="checkbox"/>	<input type="checkbox"/>	/
Shower Stall	8x10" Carbon Ice	<input type="checkbox"/>	<input type="checkbox"/>	/
Second Ensuite	8x10" Malena Carbon	<input type="checkbox"/>	<input type="checkbox"/>	/
Bed. #3 Bathroom	8x10" Carbon Ice	<input type="checkbox"/>	<input type="checkbox"/>	/
Bed. #4 Bathroom	8x10" Malena Carbon	<input type="checkbox"/>	<input type="checkbox"/>	/
Kitchen Backsplash	/	<input type="checkbox"/>	<input type="checkbox"/>	/
Complete Backsplash	/	<input type="checkbox"/>	<input type="checkbox"/>	/

Comment

Install wall tiles in all bathrooms on the 10" side stacked horizontally.



horizontal stacked

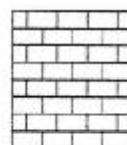

brick pattern



vertical stacked

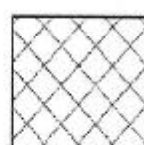

diagonal/diamond

5. Fireplace

Living Room

Purchased As Per Plan N/A

☐ ☐ ☐

Family Room

Purchased As Per Plan N/A

☐ ☐ ☐

Other Room - Specify Great/Study

Purchased As Per Plan N/A

☐ ☒ ☐

Fireplace Type	/	/	Two Sided
Mantle Type	/	/	NF-08
Over Mantle	/	/	/
Colour / Stain	/	/	White
Surround	/	/	/
Hearth	/	/	/
Comment	/		

Initial:

4-6 SK

Page 2 of 3

Purchasers: RAJA SAAD D KABIR & HINA HAQ NAWAZ GOI Property: 83 of Plan - Draft Approval SB17-03-08
 Telephone Res. / Bus: / Project: Kingsmen (Thames) Inc.
 Decor Advisor: Barbara Coccia Model and Elevation: Arthur (4205) Elev C 4 Bed - 4+1 Bath

6. Trim Carpentry

Door Hardware

Interior Trim

Comment

/

Interior Doors

☐ 2 Panel Arch Top

☒ 2 Panel Square Top

☐ 6 Panel



H.G. SK

Initial for Door Style

7. Railings and Pickets

Railing Package

Railing Colour

Wood Stairs ☐ No ☒ Oak

Picket Colour

Tread Colour

Comment

* See Invoice for details on UPG #1 Metal Package * SK

8. Plaster Mouldings and Medallions

Foyer	/	/	Kitchen/Breakfast	/	/
Main Hall	/	/	Den/Library	/	/
Living Room	/	/	Lower Landing	/	/
Dining Room	/	/		/	/
Family Room	/	/		/	/

Comment

/

9. Wall Paint

Kingsmen White

Smooth Ceilings

☐ First Floor

☐ First Floor incl. Second Floor Hall

☐ First and Second Floor

☒ Throughout

☐ Not Applicable

Trim Paint

10. Additional Comments

/

11. Disclaimers and Notes

- Colours of all materials are as close as possible to builder's selection, but not necessarily identical due to variances in manufacturing.
- Any extras listed above are null and void unless accompanied by a separate invoice/amendment. Said invoice must be paid in full.
- The Purchaser acknowledges that after Interior Colour Selection form is signed and dated, no further changes will be permitted other than re-selection due to unavailability. H.G. SK Purchaser's Initials
- The Purchaser acknowledges reading and accepting the "Kingsmen Group Décor Centre Disclaimers" form. This document contains other miscellaneous disclaimers.

This Interior Colour Selection is final and approved by:

Purchaser:

Signature: [Signature] Date: 10/08/2020

Signature: [Signature] Date: 10/08/2020

Vendor: _____

Kingsmen (Thames) Inc.

SCHEDULE "B-1"
Floor Plan

Lot 83
Phase 4A
Model: Arthur (4205) Elev C 4 Bed - 4+1 Bath
Standard

sketch #3
** Floor tile Reference Only **

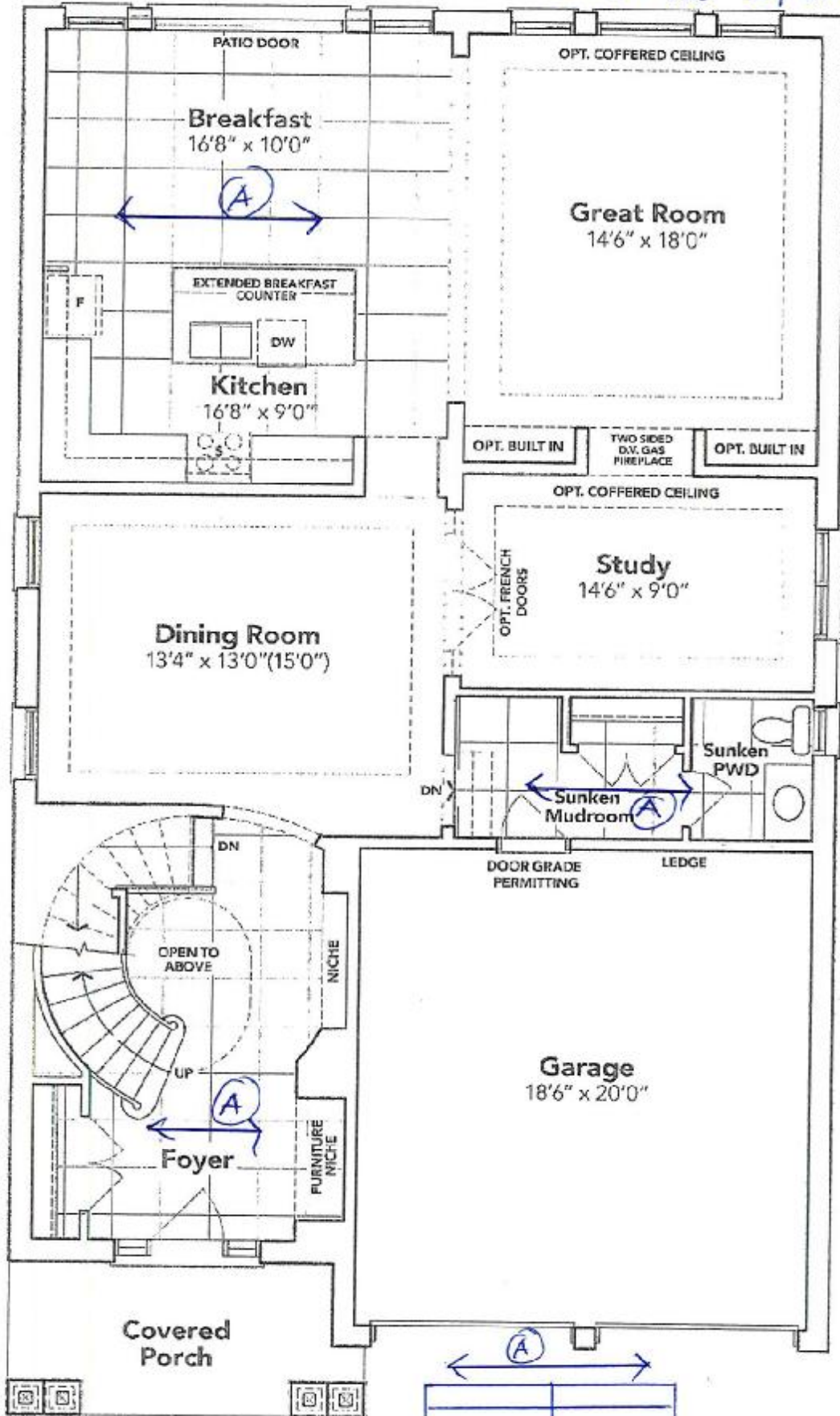

Handwritten notes:
1. 12x24" Floor Tile
2. 12x24" Floor Tile

GROUND FLOOR EL. C

The floor plans and elevations shown are pre-construction plans and may be revised or improved as necessitated by architectural controls and the construction process. The measurements adhere to the rules and regulations of the TARIION Warranty Corporation's official method for the calculation of floor area. Materials, specifications and floor plans are subject to change without notice. All house renderings are artist's concept only. Actual usable floor space may vary from the stated floor area. All options shown are upgrades. E. & O. E.

SCHEDULE "B-1"
Floor Plan

Lot 83
Phase 4A
Model: Arthur (4205) Elev C 4 Bed - 4+1 Bath
Standard

Sketch #3
** Floor tile Reference Only **

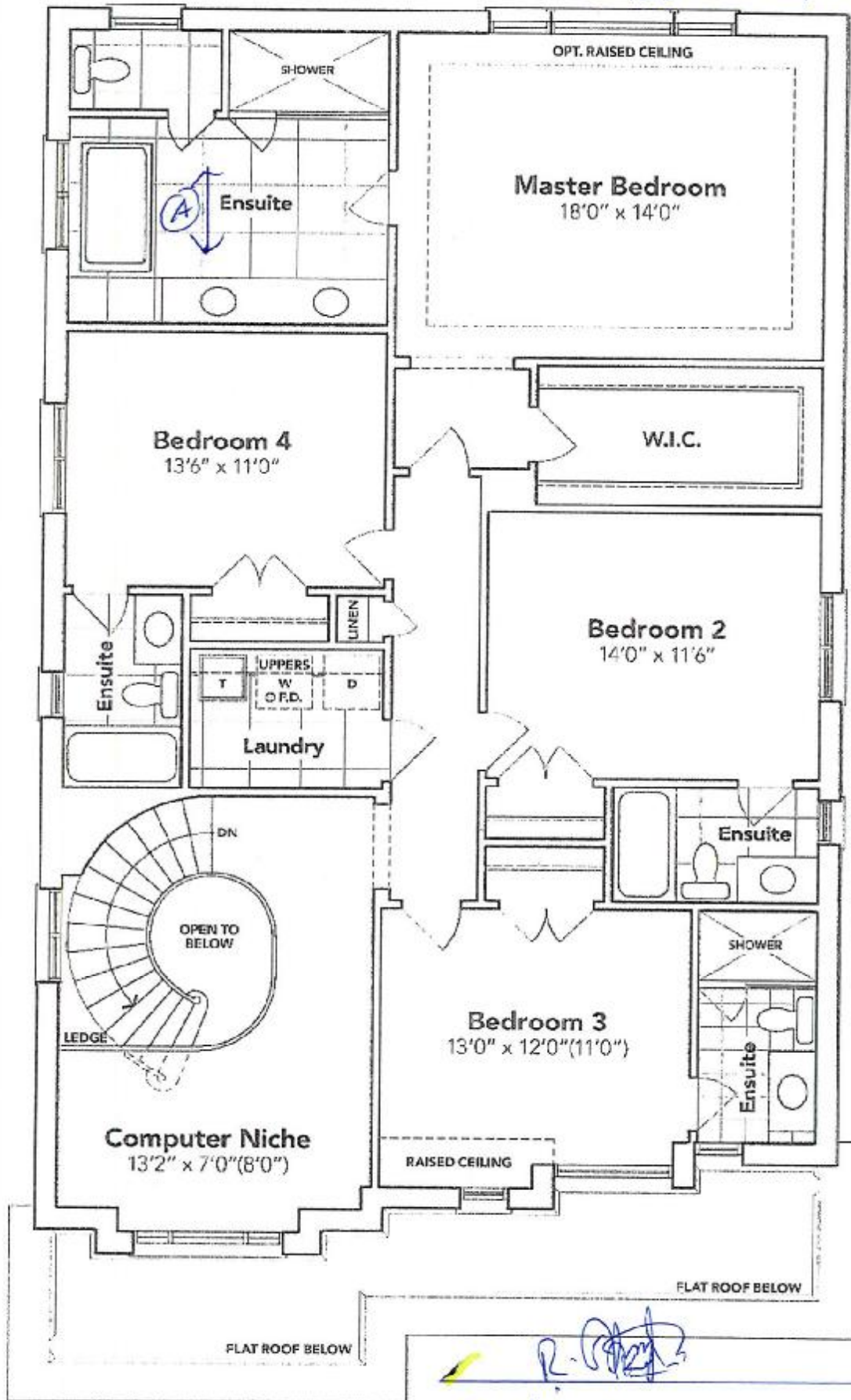

SECOND FLOOR EL. C

The floor plans and elevations shown are pre-construction plans and may be revised or improved as necessitated by architectural controls and the construction process. The measurements adhere to the rules and regulations of the TARIION Warranty Corporation's official method for the calculation of floor area. Materials, specifications and floor plans are subject to change without notice. All house renderings are artist's concept only. Actual usable floor space may vary from the stated floor area. All options shown are upgrades. E. & O. E.