

Kingsmen (Thames) Inc. / Havelock Corners (Kingsmen)

Lot/Unit: 71    Phase/Building: 4A    Model/Floor Plan: John (4201) Elev B 4 Bed - 2+1 Bath

.Miscellaneous

.Pantry Cabinets

Cabinetry

Inv.4567	1 - To supply & install the CABINETRY - KITCHEN - UPGRADE - CLASSIC II ( #6 door style ) in the kitchen in lieu of the standard cabinetry.	
Line 59839	Note:	
19Mar20 / 24Jun20		

CABINETRY ACCESSORIES

CABINETRY BASE CABINETS

CABINETRY MICROWAVE OVEN STOVE COOKTOP

CABINETRY VANITY

CARPET

Inv.4567	1 - To supply & install the Escape To Maui carpet in the master bedroom, bedroom #2, bedroom #3 and bedroom #4 in lieu of the standard carpet	
Line 59829	Note:	
19Mar20 / 24Jun20		

COUNTER TOP

Inv.4567	1 - To supply & install a 4" + - Quartz Backsplash to the counter in the powder room ( see colour chart for details )	
Line 59840	Note: Back wall only.	
19Mar20 / 24Jun20		

Inv.4567	1 - To supply & install a 4" + - Quartz Backsplash to the counter in the main bathroom ( see colour chart for details )	
Line 59841	Note: Back wall only.	
19Mar20 / 24Jun20		

Inv.4567	1 - To supply & install a 4" + - Quartz Backsplash to the counter in the Master bathroom ( see colour chart for details )	
Line 59842	Note: Back wall only.	
19Mar20 / 24Jun20		

COUNTER TOP - EXTRAS

COUNTER TOP - KITCHEN

Inv.4567	1 - To supply & install the COUNTER TOP - KITCHEN - KITCHEN - 3CM COUNTER TOP - UPGRADE LEVEL 3 C/S # 6313 Turbine Grey in lieu of the standard quartz countertop	
Line 59822	Note:	
19Mar20 / 24Jun20		

COUNTER TOP - VANITY

Kingsmen (Thames) Inc. / Havelock Corners (Kingsmen)

Lot/Unit: 71    Phase/Building: 4A    Model/Floor Plan: John (4201) Elev B 4 Bed - 2+1 Bath

Inv.4567	1 - To supply & install the COUNTER TOP - VANITY - MASTER ENSUITE - 2CM COUNTER TOP - UPGRADE LEVEL 1 C/S # 9141 Ice snow in lieu of the standard laminate countertop.	
Line 59823	Note:	
19Mar20 / 24Jun20		
Inv.4567	1 - To supply & install the COUNTER TOP - VANITY - MAIN BATHROOM - 2CM COUNTER TOP - UPGRADE LEVEL 1 C/S # 6041 Nordic Loft in lieu of the standard laminate countertop.	
Line 59824	Note:	
19Mar20 / 24Jun20		
Inv.4567	1 - To supply & install the COUNTER TOP - VANITY - POWDER ROOM - 2CM COUNTER TOP - UPGRADE LEVEL 1, C/S # 9141 Ice Snow in lieu of the standard laminated counter tops	
Line 59837	Note: Purchaser has upgraded to an undermount sink, sold sep.	
19Mar20 / 24Jun20		Still to install the standard faucet.

ELECTRICAL

FIREPLACE

Inv.4567	1 - To supply & install FIREPLACE SUROUND - ONE SIDED FIREPLACE - 3 PIECE 5 INCH GRANITE SURROUND	
Line 59830	Note:	
19Mar20 / 24Jun20		

HARDWOOD

Inv.4567	1 - To supply & install the KENTWOOD PROGRESSIVES OAK 3 1/2" - - UPPER HALL in lieu of the standard carpet	
Line 59820	Note:	
19Mar20 / 24Jun20		

Heating And Air Conditioning

MISCELLANEOUS

PLUMBING

Inv.4567	1 - To supply & install the BLANCO QUATRUS MODEL: 401244 in the kitchen in lieu of the standard kitchen sink...see spec's	
Line 59832	Note: Still to install the standard kitchen faucet.	
19Mar20 / 24Jun20		Purchaser has upgraded to a soap dispenser, sold sep.
Inv.4567	1 - To supply & install the MOEN soap dispenser mdoel # 3942 in chrome in the kitchen...see spec's See sketch # 3	
Line 59833	Note:	
19Mar20 / 24Jun20		
Inv.4567	1 - To supply & install an under mount vanity sink CONTRAC Catena in white model: 4210CIY in the powder room in lieu of the standard sink. see spec's	
Line 59834	Note: Still to install the standard facuet.	
19Mar20 / 24Jun20		

Kingsmen (Thames) Inc. / Havelock Corners (Kingsmen)

Lot/Unit: 71    Phase/Building: 4A    Model/Floor Plan: John (4201) Elev B 4 Bed - 2+1 Bath

Inv.4567	2 - To supply & install two under mount vanity sinks CONTRAC Catena in white model: 4210CIY in the master bathroom in lieu of the standard sink. see spec's	
Line 59835	Note: Still to install the standard facuet.	
19Mar20 / 24Jun20		
Inv.4567	2 - To supply & install two under mount vanity sinks CONTRAC Catena in white model: 4210CIY in the main bathroom in lieu of the standard sink. see spec's	
Line 59836	Note:	
19Mar20 / 24Jun20		

RAILING

Inv.4567	1 - To supply & install the RAILING - UPGRADE 1 - METAL HANDRAIL 3 INCH OVAL IN OAK - PICKETS STEEL ½ INCH SQUARE, PLAIN, WITH SHOES IN FLAT BLACK - POSTS 3½ INCH SQUARE, WITH CAP OAK IN OAK	
Line 59821	Note:	
19Mar20 / 24Jun20		

TILE - FLOOR

Inv.4567	1 - To supply & install the UPGRADE 4 - FLOOR TILE - - FOYER TILE 24 x 24" Mayfair Statuario Venato HD. Polished Rect. Porc in lieu of the standard floor tile.	
Line 59816	Note:	
19Mar20 / 24Jun20		
Inv.4567	1 - To supply & install the UPGRADE 4 - FLOOR TILE - MUDROOM TILE 24 x 24" Mayfair Statuario Venato HD. Polished Rect. Porc in lieu of the standard floor tile.	
Line 59817	Note:	
19Mar20 / 24Jun20		
Inv.4567	1 - To supply & install the UPGRADE 4 - FLOOR TILE - POWDER ROOM TILE 24 x 24" Mayfair Statuario Venato HD. Polished Rect. Porc in lieu of the standard floor tile.	
Line 59818	Note:	
19Mar20 / 24Jun20		
Inv.4567	1 - To supply & install the UPGRADE 4 - FLOOR TILE - KITCHEN/BREAKFAST TILE 24 x 24" Mayfair Statuario Venato HD. Polished Rect. Porc in lieu of the standard floor tile.	
Line 59819	Note:	
19Mar20 / 24Jun20		

TILE - WALL

Inv.4567	1 - To supply & install the standard wall tile on the 10" side horizontal stacked where applicable.	
Line 59831	Note:	
19Mar20 / 24Jun20		

EXTRAS AS PER OFFER

Purchasers: HARWINDER SINGH MARAHAR & KAMALINDE Property: 71 of Plan - Draft Approval SB17-03-08  
 Telephone Res. / Bus: / Project: Kingsmen (Thames) Inc.  
 Decor Advisor: Barbara Coccia Model and Elevation: John (4201) Elev B 4 Bed - 2+1 Bath

Layout Changes: ☒ Yes ☐ No Sketch Attached: ☐ Yes ☒ No Exterior Colour Scheme:

### 1. Cabinetry

	Style and Colour	Counter Top	Hardware
Kitchen / Breakfast	*# 6Manchester Paint,Macadaima Blk.Brush	**#3 C/S#6313 Turbine Grey 3cm	# 12881 Handle
Kitchen Island	*# 6Manchester Paint,Macadaima Blk.Brush	**#3 C/S#6313 Turbine Grey 3cm	# 12881 Handle
Laundry Room			
Powder Room	#4 Soho Viva Sunset Cruise	*#1, C/S #9141 Ice Snow 2cm	# 12881 Handle
Main Bathroom	#5 Humber Coffee Bean	*#1 C/S #6041 Nordic Loft 2cm.	# 12881 Handle
Master Ensuite Bathroom	#3 Trinity Viva Sunset Crusie	*#1 C/S #9141 Ice Snow 2cm.	# 12881 Handle
Second Ensuite Bathroom (If Applicable)	/		
	/		
	/		

### Appliances

Custom Size Fridge

☒ Yes ☐ No

Valance Lighting

☒ Yes ☐ No

Microwave / Range Hood

☐ Yes ☒ No

Cooktop / Rangetop

☒ Yes ☐ No

Built in Wall Oven

☒ Yes ☐ No

Slide-in Range

☐ Yes ☒ No

### Comment

Kitchen cabinet door con't: Brushst. NOTE: Lower valance trim was sold at the structural appointment, no lights no rough in wires have been purchased.

### 2. Flooring

	Selection
Foyer	**** Upg. 4, 24 x 24" Mayfair Statuario Venato HD. Polished Rect. Porcelain
Main Hall	/
Back Hall	/
Breakfast	**** Upg. 4, 24 x 24" Mayfair Statuario Venato HD. Polished Rect. Porcelain
Laundry Room	13 x 13" Malena Ice
Kitchen	**** Upg. 4, 24 x 24" Mayfair Statuario Venato HD. Polished Rect. Porcelain
Powder Room	**** Upg. 4, 24 x 24" Mayfair Statuario Venato HD. Polished Rect. Porcelain
Main Bathroom	13 x 13" Cinq White
Master Ensuite	13 x 13" Keaton Ice
Bathroom (If Applicable)	/
Mud Room	**** Upg. 4, 24 x 24" Mayfair Statuario Venato HD. Polished Rect. Porcelain
Master ens. shower floor	2 x 2" Soho Warm Grey matte
Living Room	3 1/2" Elements Talon Oak ( FORMAL ROOM )
Dining Room	/
Family / Great Room	3 1/2" Elements Talon Oak
Den / Library / Study	/
Basement Landing (If Applies)	/
Lower Landing (If Applicable)	3 1/2" Elements Talon Oak
Upper Landing	3 1/2" Elements Talon Oak
Upper Hall	*3 1/2" Elements Talon Oak
Master Bedroom	* Escape To Maui #16847 Honesty
Bedroom #2	* Escape To Maui #16847 Honesty
Bedroom #3	* Escape To Maui #16847 Honesty
Bedroom #4	* Escape To Maui #16847 Honesty
Bedroom #5	/
Master Ens. Shower Jamb	Anatolia Marmiline Snow

RECEIVED

JUN 25 2020

Flooring Continued on Page 2

Initial:

H-S K

Page 1 of 3



**Purchasers:** HARWINDER SINGH MARAHAR & KAMALINDE **Property:** 71 of Plan - Draft Approval SB17-03-08  
**Telephone Res. / Bus:** / **Project:** Kingsmen (Thames) Inc.  
**Decor Advisor:** Barbara Coccia **Model and Elevation:** John (4201) Elev B 4 Bed - 2+1 Bath

### 2. Flooring - Continued -

Upgrade Underpad	Type	Area
	Standard	master bedroom, bedroom #2, #3 & #4
Carpet on Stairs	Capped	Runner - *Upgrade
Comment	/	/

### 3. Plumbing Fixtures / Faucets

Kitchen	Standard	Second Ensuite	/	Powder Room	Standard
Master Ensuite	Standard			Other Room	/
Main Bathroom	Standard		/		

#### Comment

Purchaser has upgraded the kitchen and all bathroom sinks, see upgrade list for details... Still to install all standard faucets.

### 4. Wall Tile

	Tile Selection	Listello	Insert	Insert Selection
Main Bathroom	8 x 10" Cinq White	<input type="checkbox"/>	<input type="checkbox"/>	
Master Ensuite				
Tub Deck	/	<input type="checkbox"/>	<input type="checkbox"/>	
Tub Apron	/	<input type="checkbox"/>	<input type="checkbox"/>	
Tub Surround	/	<input type="checkbox"/>	<input type="checkbox"/>	
Shower Stall	8 x 10" Keaton Ice	<input type="checkbox"/>	<input type="checkbox"/>	
Second Ensuite	/	<input type="checkbox"/>	<input type="checkbox"/>	
	/	<input type="checkbox"/>	<input type="checkbox"/>	
	/	<input type="checkbox"/>	<input type="checkbox"/>	
Kitchen Backsplash	/	<input type="checkbox"/>	<input type="checkbox"/>	
Complete Backsplash	/	<input type="checkbox"/>	<input type="checkbox"/>	

#### Comment

Install the standard wall tiles on the 10" side horizontal, stacked.

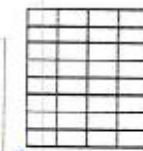

horizontal stacked



brick pattern



vertical stacked



diagonal/diamond

### 5. Fireplace

#### Living Room

Purchased ☐ As Per Plan ☐ N/A ☒

#### Family Room

Purchased ☐ As Per Plan ☐ N/A ☒

#### Other Room - Specify Great room

Purchased ☐ As Per Plan ☒ N/A ☐

Fireplace Type			Front Facing
Mantle Type			NF-8
Over Mantle			/
Colour / Stain			White
Surround			** Nero Marquina Marble
Hearth			/
Comment			

Initial:

HS LR

**Purchasers:** HARWINDER SINGH MARAHAR & KAMALINDE **Property:** 71 of Plan - Draft Approval SB17-03-08  
**Telephone Res. / Bus:** / **Project:** Kingsmen (Thames) Inc.  
**Decor Advisor:** Barbara Coccia **Model and Elevation:** John (4201) Elev B 4 Bed - 2+1 Bath

### 6. Trim Carpentry

Door Hardware

Interior Trim

Comment

#### Interior Doors

☐ 2 Panel Arch Top

☒ 2 Panel Square Top

☐ 6 Panel

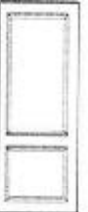

Initial for Door Style

HS KR

### 7. Railings and Pickets

Railing Package

Railing Colour  Picket Colour

Wood Stairs ☐ No ☒ Oak Tread Colour

Comment

### 8. Plaster Mouldings and Medallions

Foyer   Kitchen/Breakfast

Main Hall   Den/Library

Living Room   Lower Landing

Dining Room

Family Room

Comment

### 9. Wall Paint

Kingsmen White

Smooth Ceilings ☐ First Floor  
☐ First Floor incl. Second Floor Hall  
☒ First and Second Floor  
☐ Throughout  
☐ Not Applicable

Trim Paint

### 10. Additional Comments

### 11. Disclaimers and Notes

- Colours of all materials are as close as possible to builder's selection, but not necessarily identical due to variances in manufacturing.
- Any extras listed above are null and void unless accompanied by a separate invoice/amendment. Said invoice must be paid in full.
- The Purchaser acknowledges that after Interior Colour Selection form is signed and dated, no further changes will be permitted other than re-selection due to unavailability. HS KR Purchaser's Initials
- The Purchaser acknowledges reading and accepting the "Kingsmen Group Décor Centre Disclaimers" form. This document contains other miscellaneous disclaimers.

This Interior Colour Selection is final and approved by:

Purchaser:

Signature: Harwinder Marahan Date: 06/24/2020

Signature: Barbara Coccia Date: 06/24/2020

Vendor: Kingsmen (Thames) Inc.

Kingsmen (Thames) Inc.



SCHEDULE "B-1"  
Floor Plan

Lot 71  
Phase 4A  
Model: John (4201) Elev B 4 Bed - 2+1 Bath  
Standard

*Harwiner Marcher.*  
*Refined*

*Sketch #3*  
*\* Soap dispenser location only \**

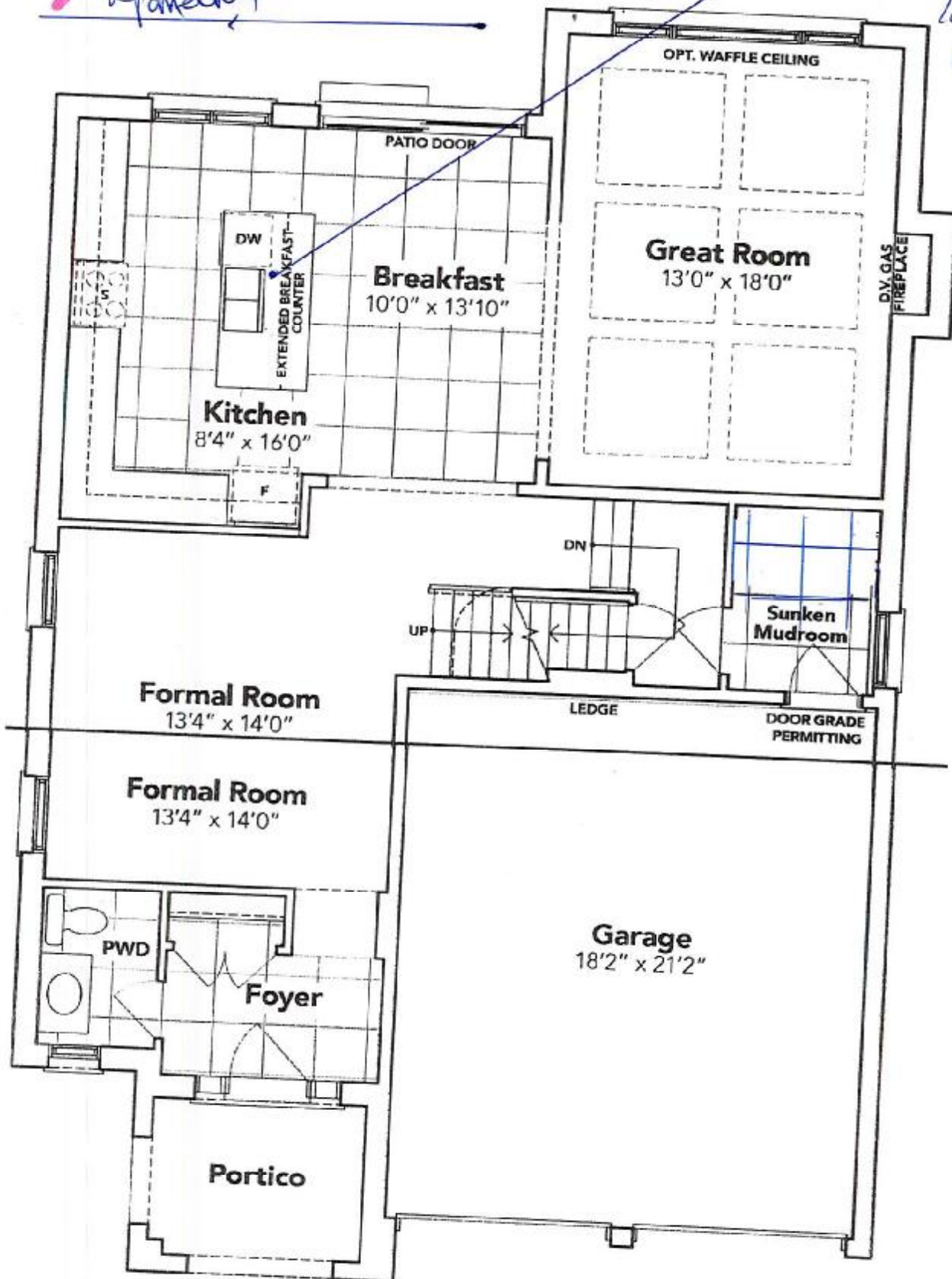

PART. GROUND FLOOR EL. B

Floor plans and elevations shown are pre-construction plans and may be revised or improved as necessitated by architectural tools and the construction process. The measurements adhere to the rules and regulations of the TARION Warranty Corporation's method for the calculation of floor area. Materials, specifications and floor plans are subject to change without notice. All house drawings are artist's concept only. Actual usable floor space may vary from the stated floor area. All options shown are upgrades. O. E.

QUATRUS®  
Undermount

LOT: 71 Thames PH: 4A  
Re: Undermount Kitchen Sink &  
Soap Dispenser (Still to install S.D.  
faucet)

QUATRUS®

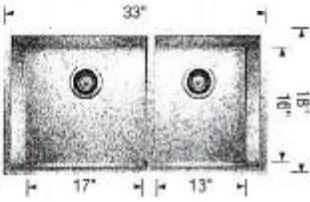

Technical specifications

Undermount  
Minimum Cabinet Size\*  
36" (915 mm)  
Bowl Depth  
6" (229 mm)  
Cubed Weight  
56 lb. (25.4 kg)

Model  
401244

Finish

Accessories

List  
Price

402123	Grid (LB**)	\$ 237
402124	Grid (SB**)	\$ 212
406345	Ash cutting board	\$ 301
406344	Workstation	\$ 152
517666	CapFlow™	\$ 37

## Soap or Lotion Dispensers

Traditional Transitional Modern

However you define your faucet's style,  
you can assure a coordinated look with Moen soap dispensers.

Harwiner morgan  
DeWitt



Soap or Lotion  
Dispenser

Model 3942  
Not available in ORB

Chrome



Lot: 71 Thames Pk. 4A.

Re: Undermount Vanity  
Sink (Powder Rm, Master  
Ens. & Main Bathroom)

**KINGSIIEN**

GROUP INC.

## Main Floor Vanity Display

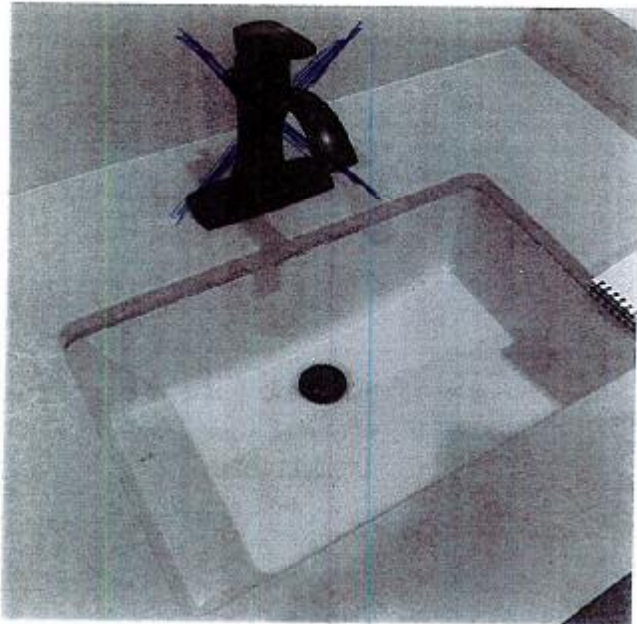

### DISPLAY ITEMS

#### Sink (Item 9)

Contract Catena Undermount  
Model 4210CIY

Harold's Mania

Glanville