

Kingsmen (Thames) Inc. / Havelock Corners (Kingsmen)

Lot/Unit: 89 Phase/Building: 4A Model/Floor Plan: John (4201) Elev B 4 Bed - 2+1 Bath

CABINETRY

| | | |
|------------------|----------------------------------------------------------------------|--|
| Inv.4635 | 1 - To accomdate for the upgraded 30" chimney hood fan... see spec's | |
| Line 59254 | Note: | |
| 7May20 / 12Jun20 | | |
| Inv.4635 | 1 - See attached for fridge specifications. | |
| Line 59731 | Note: | |
| 7May20 / 12Jun20 | | |

CABINETRY HOOD FANS

| | | |
|------------------|-----------------------------------------------------------------------------------------------------------------------------------------------------------------------------|--|
| Inv.4635 | 1 - To supply & install teh HOOD FAN - PRO COLLECTION (SCB72230) WALL MOUNT RANGE HOOD WITH 650 CFM FAN - 30 INCH in the kitchen in lieu of the std. hood fan... see spec's | |
| Line 59253 | Note: | |
| 7May20 / 12Jun20 | | |

CABINETRY MICROWAVE OVEN STOVE COOKTOP

| | | |
|------------------|------------------------------------------------------------------------------------------------------------------------------------------------------------------------------------------|--|
| Inv.4635 | 1 - To supply & install the WALL CABINET WITH SHELF FOR MICROWAVE - FINISHED INTERIOR - OPENING 24INCHESW X 13 3 - 4INCHESH X 17INCHESD - CLASSIC SERIES in the kitchen.. see sketch # 1 | |
| Line 59260 | Note: The elec. outlet is sold sep. and is mandatory to be purchased with this upgrade. | |
| 7May20 / 12Jun20 | | |

CABINETRY PANTRY

| | | |
|------------------|--------------------------------------------------------------------------------------------------------------------------------------------------------------------------------------------|--|
| Inv.4635 | 2 - To supply & install approx. a 2 foot wide, 2 door wide PANTRY 66 CM DEEP IN LIEU OF UPPER - BASE - COUNTER DEPTH - PRICE IS PER FOOT - CLASSIC SERIES in the kitchen... see sketch # 1 | |
| Line 59258 | Note: | |
| 7May20 / 12Jun20 | | |

CABINETRY VANITY

| | | |
|------------------|-------------------------------------------------------------------------------------------------------------------------------|--|
| Inv.4635 | 1 - To supply & install the VANITY BANK OF DRAWERS - MAX. WIDTH 55CM - CLASSIC SERIES in the master ensuite... see sketch # 2 | |
| Line 59255 | Note: | |
| 7May20 / 12Jun20 | | |

ELECTRICAL

| | | |
|------------------|---------------------------------------------------------------------------------------------------------------------------|--|
| Inv.4635 | 1 - To supply & install the standard T.V. rough in in the great room and master bedroom... see sketch # 1 & # 2 | |
| Line 59227 | Note: | |
| 7May20 / 12Jun20 | | |
| Inv.4635 | 1 - To supply & install the standard Phone rough in in the kitchen, master bedroom and bedroom # 4...see sketch & 1 & # 2 | |
| Line 59228 | Note: | |
| 7May20 / 12Jun20 | | |
| Inv.4635 | 1 - To supply & install an additional RG6 CABLE PER JACK in bedroom # 2... see sketch # 2 | |
| Line 59229 | Note: | |
| 7May20 / 12Jun20 | | |



CONSTRUCTION SUMMARY

Kingsmen (Thames) Inc. / Havelock Corners (Kingsmen)

Lot/Unit: 89 Phase/Building: 4A Model/Floor Plan: John (4201) Elev B 4 Bed - 2+1 Bath

| | | |
|----------------------------------------------------|--------------------------------------------------------------------------------------------------------------------------------------------------------------------------------------------------------------------------------------------------------------------------------------------------|--|
| Inv.4635 Line 59230 7May20 / 12Jun20 | 1 - To SUPPLY AND INSTALL AN ADDITIONAL BASIC RECEPTACLE (NOT DEDICATED) at approx. 66" + - up from the floor centered + - to the F/P in the great room... Note: See sketch # 1 This is for a future wall mount T.V. | |
| Inv.4635 Line 59231 7May20 / 12Jun20 | 1 - To SUPPLY AND INSTALL CONDUIT FOR TV OVER THE FIREPLACE – TERMINATED IN SAME ROOM at arppox. 66 " + - up from the floor centered + - to the F/P mantle and terminated next to + - the std. T.V. rough in in the great room..see sketch # 1 Note: This is for a future wall mount T.V. | |
| Inv.4635 Line 59245 7May20 / 12Jun20 | 1 - To SUPPLY AND INSTALL REINFORCING FOR A CEILING light in the FORMAL ROOM area.... see sketch #1 Note: | |
| Inv.4635 Line 59261 7May20 / 12Jun20 | 1 - To SUPPLY AND INSTALL MICROWAVE PLUG (DEDICATED CIRCUIT AND INCLUDES ARC FAULT BREAKER) for the upgraded microwave shelf in the kitchen... see sketch # 1 Note: | |
| Inv.4635 Line 59729 7May20 / 12Jun20 | 1 - To SUPPLY AND INSTALL EXTRA CEILING BOX ROUGH IN CAPPED (DOES NOT INCLUDE SWITCH) over the breakfast bar in the kitchen..see sketch # 1 Note: This capped elec. will be connected to a sep. switch, switch is sold sep. | |
| Inv.4635 Line 59730 7May20 / 12Jun20 | 1 - To supply & install AN ADDITIONAL SINGLE POLE SWITCH connected to the upgraded ceiling capped elec. over the breakfast bar in the kitchen. Note: | |

FIREPLACE

| | | |
|----------------------------------------------------|----------------------------------------------------------------------------------------------------------------------------------------------------|--|
| Inv.4635 Line 59247 7May20 / 12Jun20 | 1 - To supply & install the upgraded mantle NF-17 in WHITE in lieu of the standard F/P mantle in the great room... see spec attached. Note: | |
|----------------------------------------------------|----------------------------------------------------------------------------------------------------------------------------------------------------|--|

HEATING AND AIR CONDITIONING

| | | |
|----------------------------------------------------|---------------------------------------------------------------------|--|
| Inv.4635 Line 59221 7May20 / 12Jun20 | 1 - TO supply & install a Humidifier to the furnace... Note: | |
|----------------------------------------------------|---------------------------------------------------------------------|--|

MISCELLANEOUS

| | | |
|----------------------------------------------------|----------------------------------------------------------------------------------------------------------------------------------------------------------------------------------------------------------------------------------------------------------------------|--|
| Inv.4635 Line 59225 7May20 / 12Jun20 | 1 - To supply & install a capped gas rough in with the 110 V elec. (code requirement) for a future gas stove in the kitchen..see spec's attached. Note: PURCHASER HAS NOT PURCHASED THE UPGRADE TO ACCOMODATE FOR THE FURTURE SLIDE IN STOVE ACCOMMODATIONS. | |
| Inv.4635 Line 59784 7May20 / 12Jun20 | 1 - Amendment fee Note: | |

PLUMBING

Kingsmen (Thames) Inc. / Havelock Corners (Kingsmen)

Lot/Unit: 89 Phase/Building: 4A Model/Floor Plan: John (4201) Elev B 4 Bed - 2+1 Bath

| | | |
|------------------|------------------------------------------------------------------------------------------------------------------------------------------------------------------------------------------------------------------------------------|--|
| Inv.4635 | 1 - To supply & install the MIROLIN " BROKE" free standing tub in the master ensuite in lieu of the std. free standing tub...see spec's. | |
| Line 59226 | Note: | |
| 7May20 / 12Jun20 | | |
| Inv.4635 | 1 - To supply & install a WATERLINE ROUGH-IN TO THE FRIDGE LOCATION (NO HOOK UP) in the kitchen... | |
| Line 59223 | Note: | |
| 7May20 / 12Jun20 | | |
| Inv.4635 | 1 - To supply & install a WATERLINE ROUGH-IN TO THE DRYER LOCATION (NO HOOK UP) in the laundry room See spec's attached. | |
| Line 59224 | Note: | |
| 7May20 / 12Jun20 | | |
| Inv.4635 | 1 - To supply & instal the MOEN CHATEAU tow handle roman tub faucet with hand shower model T991/9796 in chrome in the master ensuite soaker tub faucet in lieu of the std. faucet in the master ensuite's soaker tub... see spec's | |
| Line 59252 | Note: | |
| 7May20 / 12Jun20 | | |

EXTRAS AS PER OFFER

| | |
|--------------------------------------------------------------------------------------------------------------------------------------------------------------------|--|
| VENDOR TO INSTALL CAPPED GAS LINE (ROUGH-IN ONLY) AT REAR OF HOME FOR FUTURE BBQ LOCATION. LOCATION TO BE FINALIZED AT VENDORS SOLE DISCRETION. Worksheet Note: | |
| VENDOR TO SUPPLY & INSTALL AIR CONDITIONING UNIT, SIZED ACCORDINGLY, FROM VENDORS STANDARD SAMPLES. Worksheet Note: | |

SCHEDULE "B-1"

Floor Plan

Lot 89
Phase 4A
Model: John (4201) Elev B 4 Bed - 2+1 Bath
Standard



SEE ATTACHED FOR SIGNATURES

sketch #1

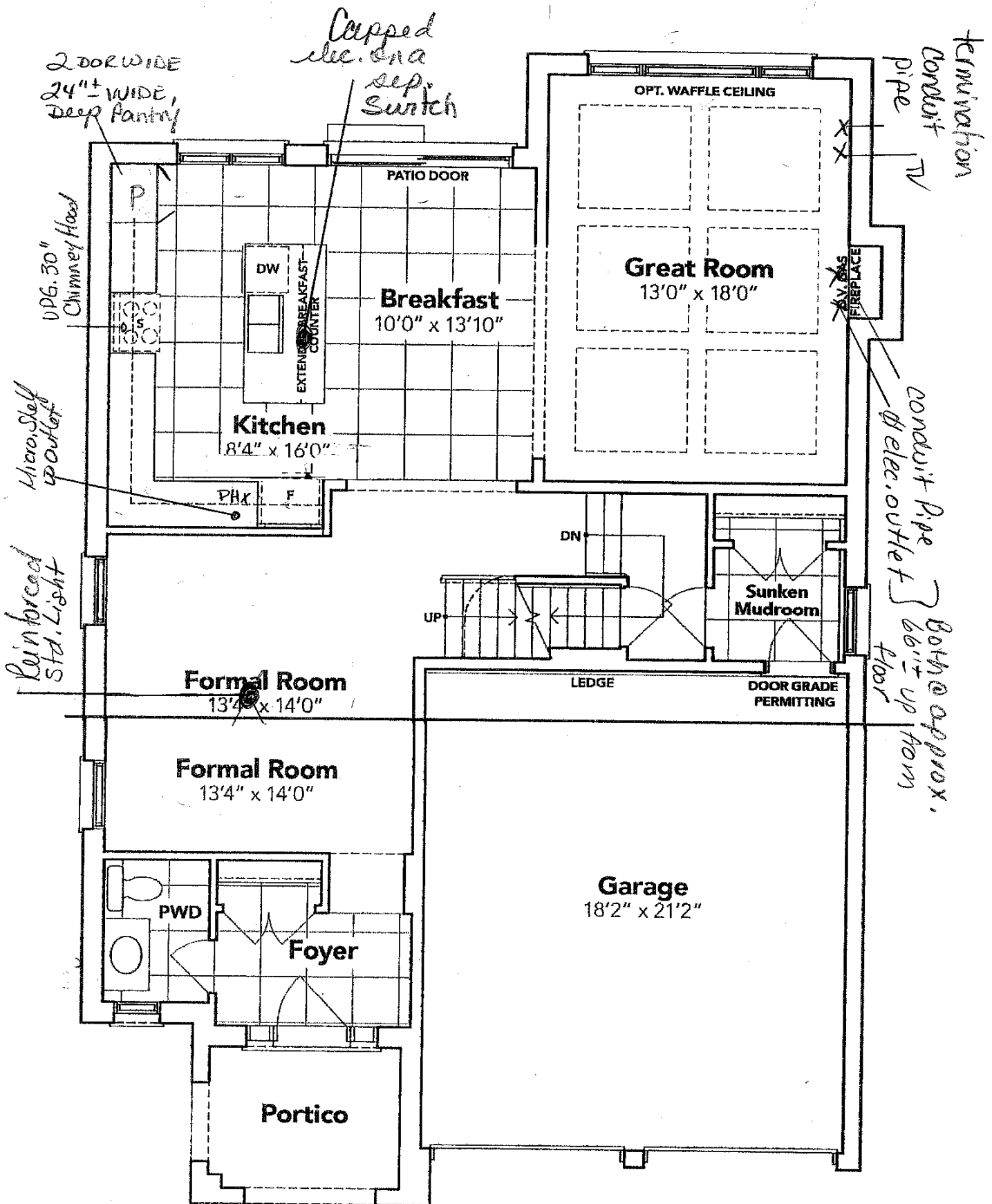

PART. GROUND FLOOR EL. B

The floor plans and elevations shown are pre-construction plans and may be revised or improved as necessitated by architectural controls and the construction process. The measurements adhere to the rules and regulations of the TARION Warranty Corporation's official method for the calculation of floor area. Materials, specifications and floor plans are subject to change without notice. All house renderings are artist's concept only. Actual usable floor space may vary from the stated floor area. All options shown are upgrades. E. & O. E.

SCHEDULE "B-1"
Floor Plan

Lot 89
Phase 4A
Model: John (4201) Elev B 4 Bed - 2+1 Bath
Standard

Sketch #2



SEE ATTACHED FOR SIGNATURES

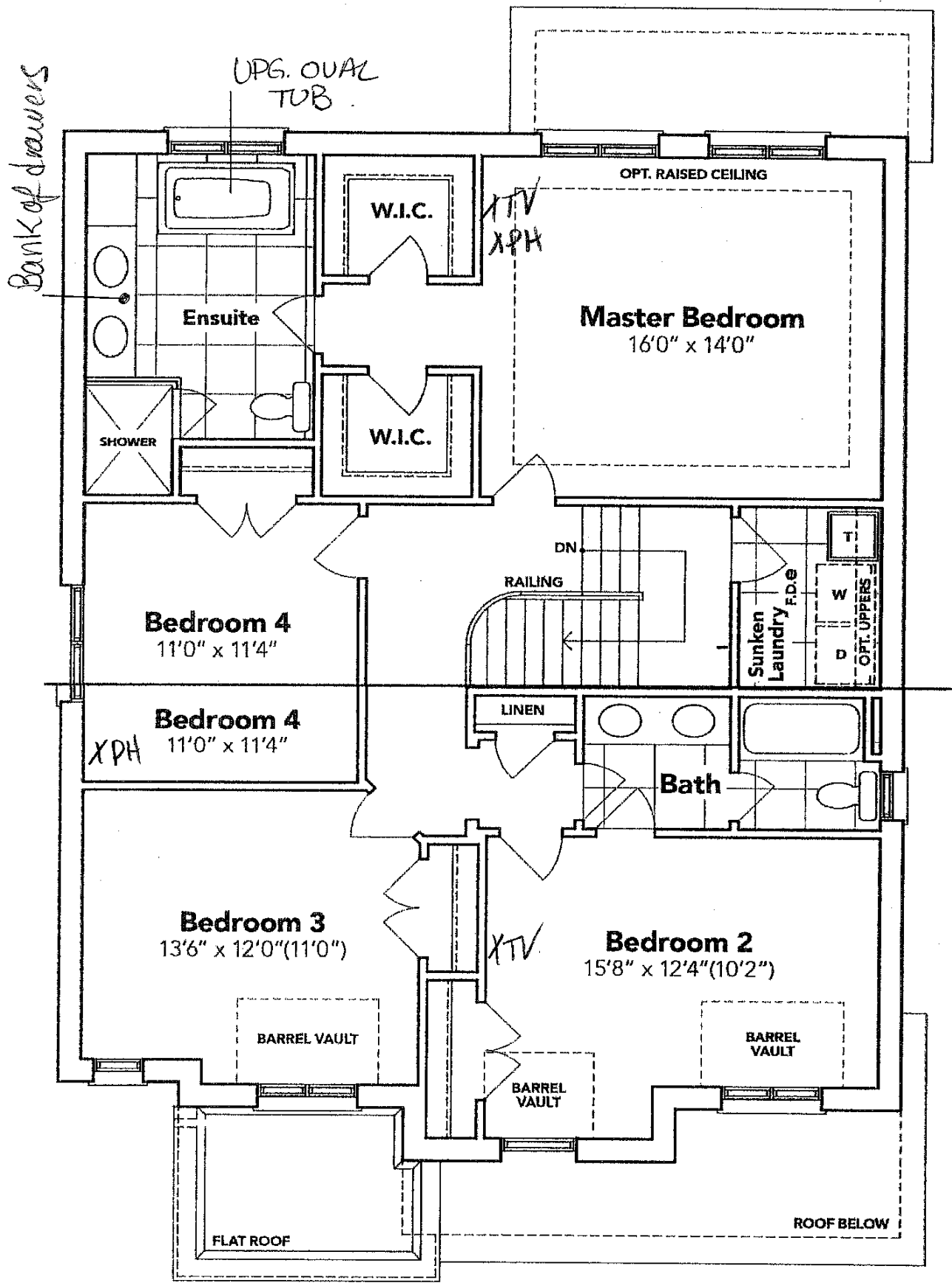

PART. SECOND FLOOR EL. B

The floor plans and elevations shown are pre-construction plans and may be revised or improved as necessitated by architectural controls and the construction process. The measurements adhere to the rules and regulations of the TARION Warranty Corporation's official method for the calculation of floor area. Materials, specifications and floor plans are subject to change without notice. All house renderings are artist's concept only. Actual usable floor space may vary from the stated floor area. All options shown are upgrades. E. & O. E.

LOT: 89 Thames PH: 4A

RE: UPG. 30" Chimney Hood Fan in Kitchen

Specifications



SEE ATTACHED FOR SIGNATURES

Air Flow Volume: 650 CFM
Electrical Connection: 120V/60Hz
Power Consumption: 240 Watts
Current: 2.0 Amps
Fan Speed: 1599 RPM
Finishes: Stainless Steel
Duct: 6" Round
Knock-out: 6" Round - Top Only
Dimensions: Width: 30"/36"
Height: 44 1/2"
Depth: 19 3/4"
Noise Level: Min. 2 Sones
Max. 7 Sones

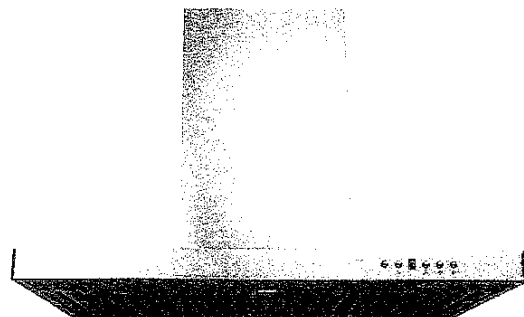

SCB722 - Baffle Filter



Ordering Model Chart

| Model | Colour | Knock-out | Duct | Size | Filter | CFM |
|---------------------|----------------------------|---------------|---------------------|----------------|-------------------|----------------|
| SCB72230 | Stainless Steel | 6" | 6" Round | 30" | Baffle | 650 |
| SCB72236 | Stainless Steel | 6" | 6" Round | 36" | Baffle | 650 |

Notes

Cyclone®

LOT: 89 Thames PM: 4A

RE: UPG. FREE STANDING SOAKER TUB.
FOR MASTER ENS.



SEE ATTACHED FOR SIGNATURES



Brooke™ | 1

Brooke™

Categories: Acrylic Freestanding

DESCRIPTION

68" Freestanding Bath
SKU #: CF2002

FEATURES

- Installation friendly two piece design
- Accepts deck mounted faucet
- Includes a chrome integral pop up drain and rectangular overflow.
- ~~Includes a chrome integral pop up drain and rectangular overflow.~~
- Centre drain
- Includes levelling feet
- Available in White Only

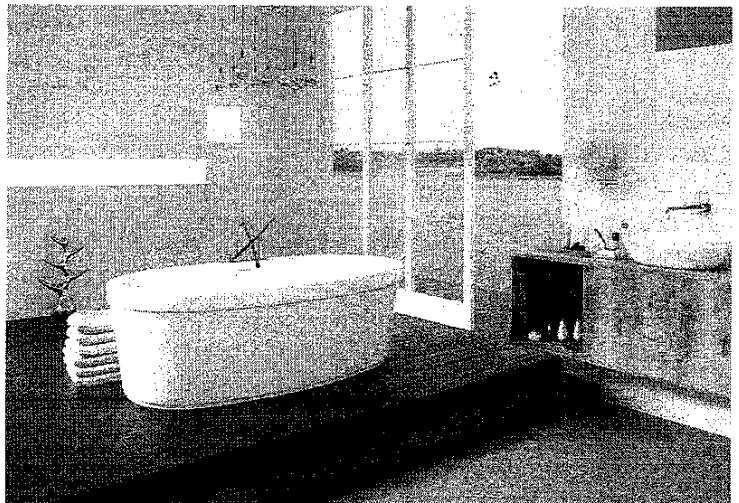

DIMENSIONS

68" x 36" x 23"

OPTIONS & ACCESSORIES

SOAKER

CF2002

LOT: 89 Thames PH: 44

RE: UPG. FAUCET FOR SOAKER TUB
IN MASTER B.S.



SEE ATTACHED FOR SIGNATURES

Chateau®

Traditional | Transitional | Modern

*The Chateau collection delivers Moen performance and reliability
with a simple understated appeal.*



**Two Handle Roman Tub
Faucet with Hand Shower**
Model T991 / 9796

"Chrome Finish"

LOT: 89 Thames PH: 4A
RE: UPG, F/P Mantle.



SEE ATTACHED FOR SIGNATURES

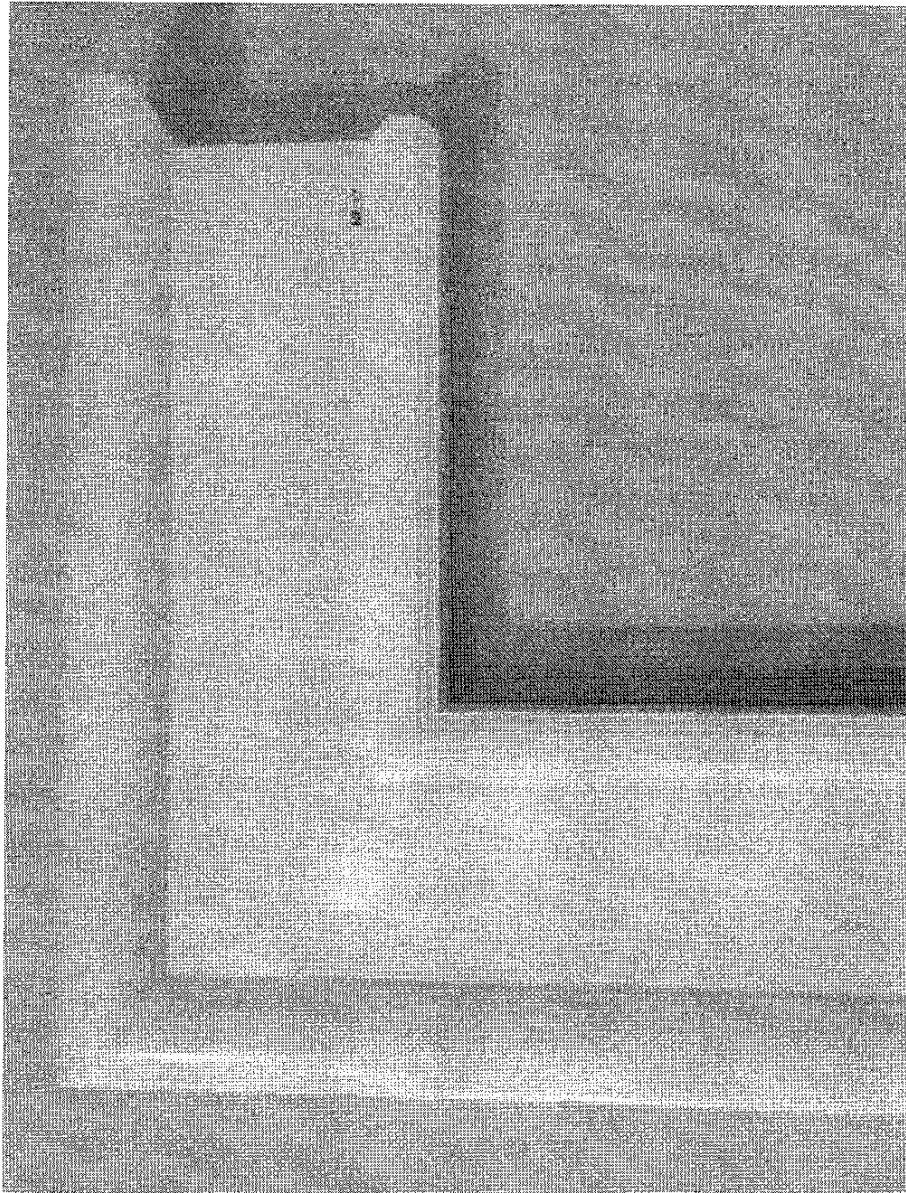

NX60T8511SG

6.0 cu. ft. Slide-In Gas Range

SAMSUNG



SEE ATTACHED FOR SIGNATURES

Lot: 89 Thames PM: 4A

Re: Gas Stove Spec's

*No Slide'n Stove Acc. have
been purchased *

Signature Features

Air Fry

- The ideal way to cook healthier fried food as it eliminates excess fat, but everything is still crispy and brown outside and juicy inside.

Wi-Fi Connectivity

- Monitor and control the oven using the SmartThings App¹. And control the oven with your voice using a voice assistant², such as Samsung Bixby³, Amazon Alexa or Google Assistant.

True Convection

- A heated fan distributes heat all around the oven and keeps the temperature constant so dishes are cooked quickly and thoroughly.

Powerful, Flexible Cooktop

- Cook fast with 5 specialized burners, a 16K BTU Power Burner and one 5K Simmer Burner.

Fingerprint Resistant Finish

- Prevent surfaces from being covered in unsightly fingerprints, or marks and smudges.

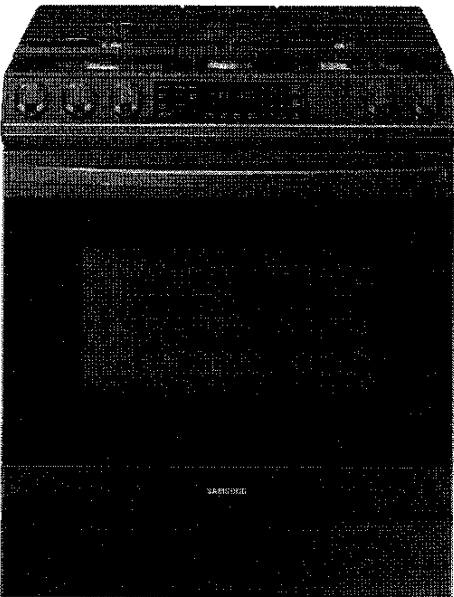

Available Colours



Fingerprint Resistant Black
Stainless Steel (shown)



Fingerprint Resistant
Stainless Steel

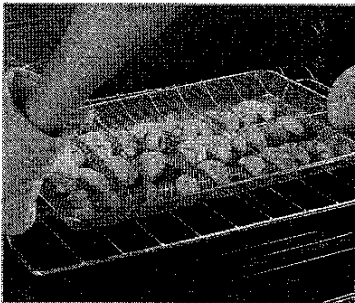

Air Fry

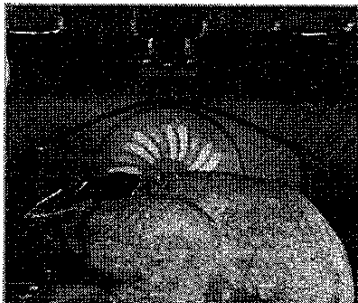

True Convection

Features

- Air Fry with included Air Fry Rack
- True Convection
- Wi-Fi Connectivity
- Voice Control
- Flexible Cooktop
- Fingerprint Resistant Finish

- Large Capacity – 6.0 cu. ft.
- 5 Gas Burners
- 5K Simmer Burner
- Wide View Window
- Reversible Cast Iron Grate
- Storage Drawer

Convenience

- Self Clean
- 2 Chrome Racks
- Auto Oven Light
- Sabbath Mode
- Kitchen Timer
- Delay Start
- Auto Shut-Off Option
- Child Safety Lock

¹Available on Android and iOS devices. A Wi-Fi connection and a Samsung account are required.

²A Wi-Fi connection is required.

³Bixby is Samsung's brand of artificial intelligence (AI) / Internet of Things (IoT) voice assistant. A Samsung account is required.

NX60T8511SG

SAMSUNG

6.0 cu. ft. Slide-In Gas Range

**No Slide-In Stove Acc. have*

*Installation Specifications Been Purchased **

BEFORE YOU BEGIN to install this appliance, refer to the following information, dimensions, and clearances. Do not locate the range where it may be subject to strong drafts. Provide adequate clearances between the range and adjacent combustible surfaces. These dimensions must be met for safe use of the range.

The location of the electrical outlet and gas piping may be adjusted to meet the following dimensions and clearances.

For installation in Canada, a free-standing range is not to be installed closer than 4.7 in (12 cm) from any adjacent surface.

*LOT: 89 Thames PH: 4A
RE: GAS STOVE SPEC'S CON'T*

Total Power 58.5K BTU  SEE ATTACHED FOR SIGNATURES

Power Source
120V/60Hz/40A

5-Burner Cooktop

- Right Front: 18K BTU
- Left Front: 16K BTU
- Right Rear: 5K BTU
- Left Rear: 9.5K BTU
- Centre (Oval): 10K BTU

Oven: 6.0 cu. ft. Capacity

- Bake: 175°F–550°F
- Bake Burner: 18K BTU
- Broil Burner: 16.5K BTU
- Variable Broil: Low/High (375°F–480°F)
- Sabbath Mode

Storage Drawer

- Capacity: 1.0 cu. ft.

Warranty

One (1) Year Parts and Labour

Product Dimensions & Weight (WxHxD)

Outside Net Dimensions: 29 15/16" x 36 1/4"-37" x 28 11/16"
Weight: 208.1 lbs (94.4 Kg)

Shipping Dimensions & Weight (WxHxD)

Dimensions: 33 1/16" x 41 3/4" x 30 5/16"
Weight: 233.7 lbs (106 Kg)

| Colour | Model # | UPC Code |
|-----------------------|-------------|--------------|
| Black Stainless Steel | NX60T8511SG | 887276409238 |
| Stainless Steel | NX60T8511SS | 887276409245 |

Dimensions

CAUTION: This range has been designed to comply with the maximum allowable wood cabinet temperature of 194 °F (90 °C). Make sure the wall covering, countertops, and cabinets around the range can withstand the heat (up to 194 °F [90 °C]) generated by the range. If not, discoloration, delamination, or melting may occur.

SLIDE-IN CUTOUT

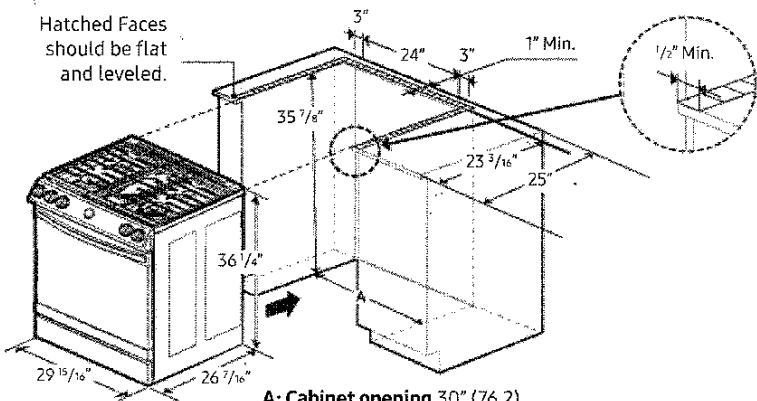

A: Cabinet opening 30" (76.2)

IMPORTANT: If your cabinet have height over 36 1/4", this range cannot be installed without supporting unit like hard block.

Recommended Locations for Gas Piping and Electrical Outlets

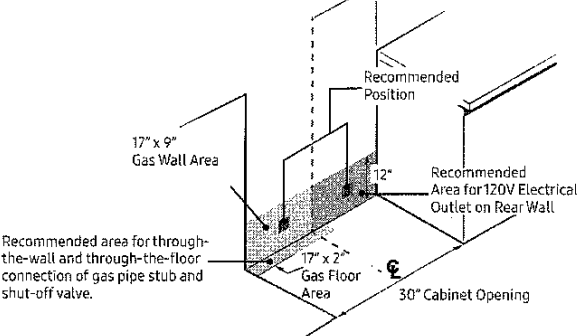

Actual colour may vary. Design, specifications and colour availability are subject to change without notice. Non-metric weights and measurements are approximate.
© 2020 Samsung Electronics Canada Inc. All rights reserved. Samsung is a registered trademark of Samsung Electronics Co., Ltd., used with permission.

RF28R7201SR

SAMSUNG

28 cu. ft. 4-Door French Door Refrigerator

* WIDTH & Height Only *

Lot: 89 Thomas PH: 4A
Re: Fridge SPEC'S



SEE ATTACHED FOR SIGNATURES

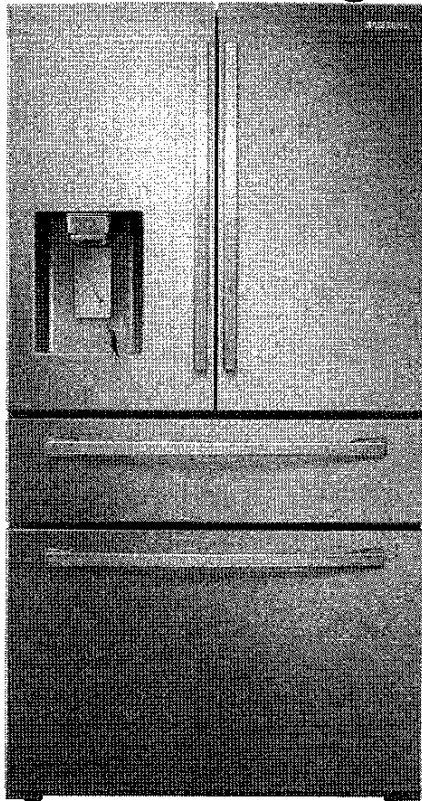

Signature Features

FlexZone™ Drawer

A flexible storage drawer with four different temperature settings and an adjustable Smart Divider to stay organized.

Fingerprint Resistant

A special finish to reduce smudges and minimize cleaning.

Wi-Fi and Bixby Enabled

Use your smartphone to control the temperature and monitor your refrigerator remotely.

Available Colors



Fingerprint Resistant
Stainless Steel (shown)



Fingerprint Resistant
Black Stainless Steel



Fingerprint Resistant
Tuscan Stainless Steel

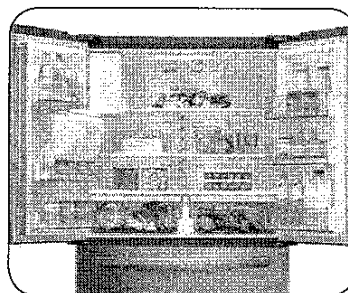

French Door Design

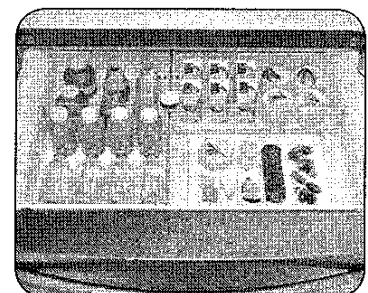

FlexZone™ Drawer

Convenience

- FlexZone™ Drawer with 4 Temperature Settings and Smart Divider
- Adjustable Shelves for Tall Oversized Items
- Auto Pull-Out Upper Freezer Drawer
- Water Filter Indicator

Design

- Modern External Filtered Water and Ice Dispenser
- High Efficiency LED Lighting
- Accessibility (ADA Compliant)
- EZ-Open Handle™ on Freezer Door and FlexZone™ Drawer
- Tempered Glass Spill-Proof Shelves
- Gallon Door Bins
- Dispenser Light

Performance

- Twin Cooling Plus®
- Ice Max - Stores up to 10 lbs of ice
- Energy Star® Compliant
- Power Freeze and Power Cool Options
- Two Humidity-Controlled Crispers
- CoolTight Door
- Door Alarm

Rating



ENERGY STAR® rated:
755 kWh/yr

RF28R7201SR

width & height only

SAMSUNG

28 cu. ft. 4-Door French Door Refrigerator

Lot: 89 Thamus PH: 4A

→ SEE ATTACHED FOR SIGNATURES

Re: FRIDGE SPEC'S CONT

Installation Specifications

1. Measure the height, width and depth of the opening, making sure to include baseboards, molding tile, countertop overhang, etc. Check to be sure there is enough room to open the door (consider walls, islands or other obstacles when measuring).
2. Refer to illustration below to determine dimensions.
3. Allow 2.5" of clearance on hinge side of refrigerator when installing next to a wall where handle may make contact.
4. Allow 1" minimum clearance at rear for proper air circulation and water/electrical connections. Allow a 3/8" minimum clearance at sides and top for ease of installation.
5. Ensure each door and entryway in the home is wide enough for the refrigerator to be moved through easily.

For optimal usage and to be able to open refrigerator doors completely, do not install next to a wall.

Please note: The following dimension and cutout information is for planning purposes only. For complete installation details, consult manual packed with product, or download manual online at [samsung.com](#).

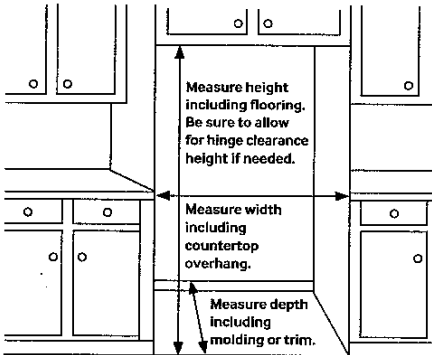

Dimensions

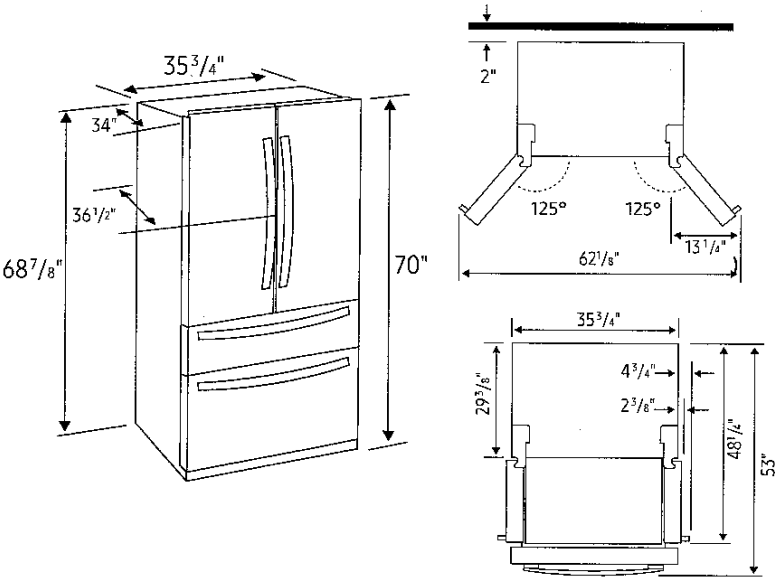

- Total Capacity: 28 cu. ft.**
- Refrigerator: 15.9 cu. ft.**
- Modern External Filtered Water and Ice Dispenser
 - Crushed or Cubed Ice
 - Ice Max
 - 2 Humidity-Controlled Crispers
 - 5 Tempered Glass Spill-Proof Shelves
 - Adjustable Shelf for Tall Oversized Items
 - 6 Door Bins
 - Right Door: 3 Gallon Bins
 - Left Door: 3 Regular Bins
 - High Efficiency LED Lighting
- FlexZone™ Drawer: 3.8 cu. ft.**
- EZ-Open Handle™
 - 4 Temperature Zones with Smart Divider:
 - Meat/Fish (29°F)
 - Cold Drinks (33°F)
 - Deli/Snacks (37°F)
 - Wine/Party Dishes (42°F)
 - High Efficiency LED Lighting
- Freezer: 8.3 cu. ft.**
- EZ-Open Handle™
 - 1 Drawer Divider
 - High Efficiency LED Lighting

Warranty

One (1) Year Parts and Labor on Refrigerator

Five (5) Years Parts and Labor on Sealed Refrigeration System Only*

Ten (10) Years Parts and Five (5) Years Labor on Digital Inverter Compressor

*Compressor, evaporator, condenser, drier and connecting tubing.

Product Dimensions & Weight

Dimensions (WxHxD with hinges, handles and doors): 35 3/4" x 70" x 36 1/2"

Dimensions (WxHxD without hinges and door): 35 3/4" x 68 7/8" x 29 3/8"

Dimensions (WxHxD with hinge and door, no handle): 35 3/4" x 70" x 34"

Weight: 322 lbs.

Shipping Dimensions & Weight (WxHxD)

Dimensions: 38 1/4" x 75 3/4" x 36 1/4"

Weight: 344 lbs.

| Color | Model # | UPC Code |
|----------------------------------------------|-------------|--------------|
| Fingerprint Resistant Stainless Steel | RF28R7201SR | 887276304922 |
| Fingerprint Resistant Black Stainless Steel | RF28R7201SG | 887276304915 |
| Fingerprint Resistant Tuscan Stainless Steel | RF28R7201DT | 887276304908 |

Actual color may vary. Design, specifications, and color availability are subject to change without notice. Non-metric weights and measurements are approximate.
©2019 Samsung Electronics America, Inc., 85 Challenger Road, Ridgefield Park, NJ 07660. Tel: 800-SAMSUNG. [samsung.com](#). Samsung is a registered trademark of Samsung Electronics Co., Ltd.

DVE45R6300V

SAMSUNG

Samsung Smart Front Load Electric Dryer with Steam Sanitize+
7.5 cu. ft. Capacity DOE

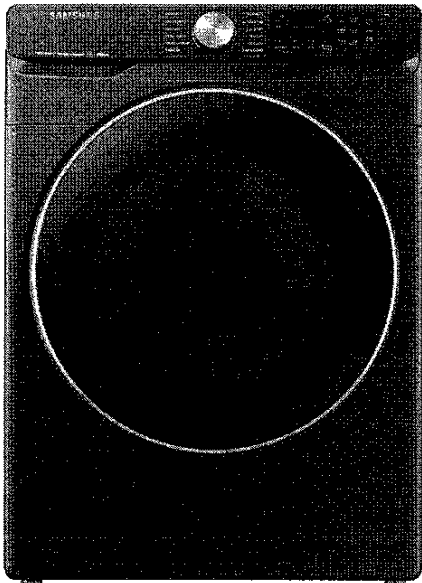

LOT: 89 Thames PH: 4A
Re: DRYER SPEC'S → SEE ATTACHED FOR SIGNATURES





Signature Features

- Bixby Enabled** 
- Wi-Fi connected so you can remotely start or stop your cycle, schedule laundry on your time, receive end of cycle alerts, and more right from your smartphone.¹
- Steam Sanitize+**
- The Steam Sanitize+ cycle removes 99.9% of germs and bacteria, over 95% of pollen, and kills 100% of dust mites². Multi-Steam Technology steams away wrinkles, odors, and static.
- Sensor Dry**
- Automatically optimizes the time and temperature of your drying cycle to protect your clothes from heat damage, while avoiding excess energy use.

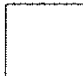
Available Colors

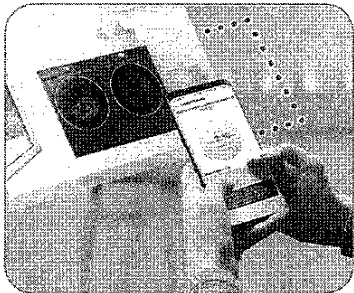
-  Fingerprint Resistant Black Stainless Steel (shown)
-  Champagne
-  White



Bixby Enabled 



Steam Sanitize+

Features

- Bixby Enabled 
- Steam Sanitize+
- Sensor Dry
- Vent Sensor
- Interior Drum Light
- 12 Preset Drying Cycles
- 10 Additional Drying Options
- 5 Temperature Levels
- 4-Way Venting
- Dual Heaters
- Reversible Crystal Blue Door
- LED Display: Ice Blue

Convenience

- Child Lock
- Lint Filter Indicator



Rating

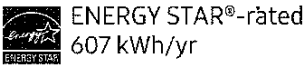

¹The Samsung SmartThings application is required and is available on Android and iOS devices. A Wi-Fi connection is required. User will be solely responsible for any consequence(s) that may result, including but not limited to any damage or harm caused by incorrect information provided by the user. Only monitoring is allowed for Gas dryer for safety reasons.

²Based on internal testing and independently verified by Intertek. Individual results may vary.

³ADA Compliant when using a Samsung 27" wide riser (WE272NV or WE272NW).

DVE45R6300V

SAMSUNG

Samsung Smart Front Load Electric Dryer with Steam Sanitize+

7.5 cu. ft. Capacity DOE

LOT: 89 THAMES PH: QA

RE: DRYER SPEC'S CONT

SEE ATTACHED FOR SIGNATURES

Installation Specifications

If the washer and dryer are installed together or the dryer alone, the closet front must have two unobstructed air openings for a combined minimum total area of 72-inch² (see stacked build below). Your washer alone does not require a specific air opening.

*Required spacing (External exhaust elbow may require additional space.)

1. Alcove or closet installation

Minimum Clearance for Closet and Alcove Installations:

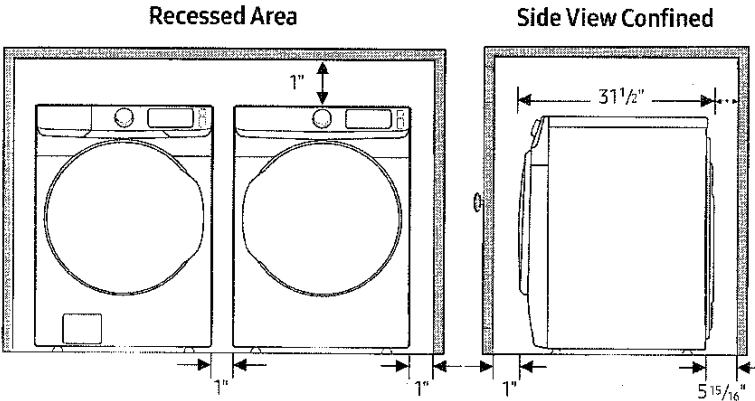

2. With stacked washer and dryer

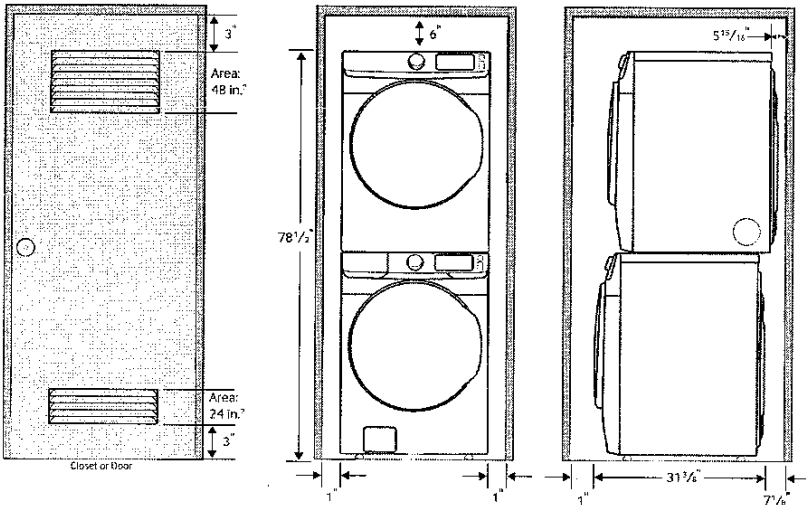

Dimensions

Required Dimensions for Installation with Pedestal:

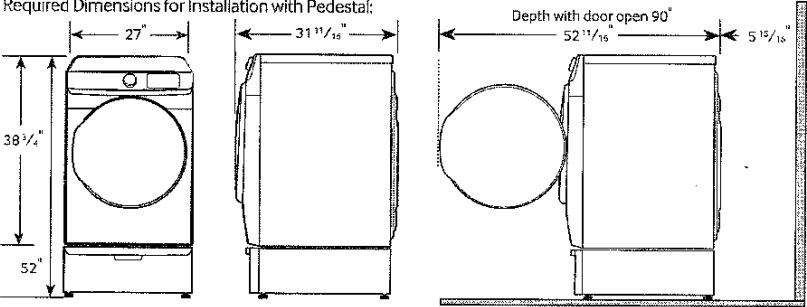

12 Preset Drying Cycles:

Refresh, Steam Sanitize+, Normal, Heavy Duty, Permanent Press, Active Wear, Bedding, Delicates, Time Dry, Air Fluff, Quick Dry, Downloaded

10 Additional Drying Options:

Damp Alert, Wrinkle Prevent, Smart Control, Adjust Time (Up), Adjust Time (Down), Eco Dry, Drum Light, Child Lock, Smart Care, Alarm Off

5 Temperature Levels:

High, Medium High, Medium, Medium Low, Low

5 Dry Levels:

More Dry, Normal-More Dry, Normal Dry, Normal-Less Dry, Less Dry

Warranty

One (1) Year Parts and Labor

Product Dimensions & Weight (WxHxD)

Dimensions: 27" x 38 3/4" x 31 1/2"

Weight: 123 lbs

Shipping Dimensions & Weight (WxHxD)

Dimensions: 29 3/8" x 42 9/16" x 33 1/2"

Weight: 130 lbs

| Electric | Model # | UPC Code |
|---------------------------------------------|-------------|--------------|
| Fingerprint Resistant Black Stainless Steel | DVE45R6300V | 88727630046 |
| Champagne | DVE45R6300C | 887276331631 |
| White | DVE45R6300W | 88727630047 |
| Gas | | |
| Fingerprint Resistant Black Stainless Steel | DVG45R6300V | 88727630050 |
| Champagne | DVG45R6300C | 88727633164 |
| White | DVG45R6300W | 88727630051 |
| Matching Washer | | |
| Fingerprint Resistant Black Stainless Steel | WF45R6300AV | 88727629948 |
| Champagne | WF45R6300AC | 88727633146 |
| White | WF45R6300AW | 88727629949 |

| Pedestal | | |
|---------------------------------------------|---------|--------------|
| Fingerprint Resistant Black Stainless Steel | WE402NV | 887276310141 |
| Champagne | WE402NC | 887276310121 |
| White | WE402NW | 887276310152 |

| Accessories | | |
|--------------|--------|-------------|
| Stacking Kit | SKK-8K | 88727634403 |
| Vent Kit | DV-2A | 88727614641 |