

**Kingsmen (Thames) Inc. / Havelock Corners (Kingsmen)**

**Lot/Unit: 9    Phase/Building: 4A    Model/Floor Plan: John (4201) Elev A 4 Bed - 2+1 Bath**

**CABINETRY**

Inv.4639	1 - This is to accomodate the cabinetry for the upgraded 30" chimney hood fan in the kitchen... see spec's	
Line 59386	Note:	
12May20 / 20May20		

**CABINETRY ACCESSORIES**

Inv.4639	3 - To supply & install the LIGHT VALANCE - FOR CLARIFICATION OF STYLES SEE MOULDING MATRIX - LIGHT VALANCE IS NOW APPROXIMATELY 2INCHES 50MM HIGH - CLASSIC SERIES in the kitchen.	
Line 59399	Note: NO ROUGH IN WIRES OR LIGHTS HAVE BEEN PURCHASED.	
12May20 / 20May20		

**CABINETRY BASE CABINETS**

Inv.4639	1 - To supply & install the BASE PIE CUT CORNER - CLASSIC SERIES in the kitchen.. see sketch # 1	
Line 59398	Note:	
12May20 / 20May20		

**CABINETRY HOOD FANS**

Inv.4639	1 - To supply & install the HOOD FAN - PRO COLLECTION (SCB72230) WALL MOUNT RANGE HOOD WITH 650 CFM FAN - 30 INCH in lieu of the standard hood fan in the kitchen... see spec's	
Line 59385	Note:	
12May20 / 20May20		

**CABINETRY MICROWAVE OVEN STOVE COOKTOP**

Inv.4639	1 - To supply & install the WALL CABINET WITH SHELF FOR MICROWAVE - FINISHED INTERIOR - OPENING 24INCHESW X 13 3 - 4INCHESH X 17INCHESD - CLASSIC SERIES in the kitchen..see sketch # 1	
Line 59396	Note: Elec. outlet is mandatory for this upgrade, and is sold sep.	
12May20 / 20May20		

**CABINETRY VANITY**

Inv.4639	1 - To supply & install a VANITY BANK OF DRAWERS - MAX. WIDTH 55CM - CLASSIC SERIES in the master ensuite... see sketch # 2	
Line 59395	Note:	
12May20 / 20May20		

**COUNTER TOP**

Inv.4639	1 - As per schedule "PE": Vendor to include level 1, 2cm granite or quartz in all bathrooms, as per plan, in lieu of the included standard laminate counter tops. Selections to be made from builders standard samples.	
Line 59383	Note:	
12May20 / 20May20		

**ELECTRICAL**

**Kingsmen (Thames) Inc. / Havelock Corners (Kingsmen)**

**Lot/Unit: 9    Phase/Building: 4A    Model/Floor Plan: John (4201) Elev A 4 Bed - 2+1 Bath**

Inv.4639	1 - To supply & install the standard T.V. rough in in the Great room and master bedroom...see sketch # 1 & # 2	
Line 59388	Note:	
12May20 / 20May20		
Inv.4639	1 - To supply & install the standard Phone rough in in the kitchen, master bedroom and bedroom # 2...see sektch #1 & # 2	
Line 59389	Note:	
12May20 / 20May20		
Inv.4639	1 - To SUPPLY AND INSTALL AN ADDITIONAL BASIC RECEPTACLE (NOT DEDICATED) at approx. 66 " + - up from the floor centered + - to the F/P mantle	
Line 59390	Note: in the great room... see sketch # 1	
12May20 / 20May20                      This is for a future wall mount t.v.		
Inv.4639	1 - To SUPPLY AND INSTALL CONDUIT FOR TV OVER THE FIREPLACE – TERMINATED IN SAME ROOM have it installed at approx. 66 " + - up from the floor next to + - the upgraded conduit pipe centered + - to the F/P mantle in the great room..see sketch # 1	
Line 59391	Note: This is for a future wall mount t.v.	
12May20 / 20May20		
Inv.4639	2 - To SUPPLY AND INSTALL " TWO" EXTRA CEILING BOX ROUGH IN CAPPED (DOES NOT INCLUDE SWITCH) over the breakfast bar in the kitchen... see sketch # 1	
Line 59392	Note: These two capped ceiling elec. will be connected to a sep. switch, switch is sold sep.	
12May20 / 20May20		
Inv.4639	1 - To supply & install AN ADDITIONAL SINGLE POLE SWITCH connected to the TWO upgraded ceiling capped elec. over the breakfast bar in the kitchen.	
Line 59393	Note:	
12May20 / 20May20		
Inv.4639	1 - To SUPPLY AND INSTALL MICROWAVE PLUG (DEDICATED CIRCUIT AND INCLUDES ARC FAULT BREAKER) to be installed where upg. microwave shelf is in the kitchen...see sketch # 1	
Line 59397	Note:	
12May20 / 20May20		

**FIREPLACE**

Inv.4639	1 - To supply & install the upgraded EFSI in WHITE upgraded F/P mantle in the great room in lieu of the standard mantle... see spec's	
Line 59394	Note:	
12May20 / 20May20		

**HEATING AND AIR CONDITIONING**

Inv.4639	1 - To supply & install a Humidifier to the furnace...	
Line 59384	Note:	
12May20 / 20May20		

**MISCELLANEOUS**

**PLUMBING**

Kingsmen (Thames) Inc. / Havelock Corners (Kingsmen)

Lot/Unit: 9    Phase/Building: 4A    Model/Floor Plan: John (4201) Elev A 4 Bed - 2+1 Bath

Inv.4639	1 - T0 supply & install the upgraded MIROLIN "BROOKE" free standing tub in lieu of the standard free standing tub in the master ensuite... see spec's	
Line 59387	Note:	
12May20 / 20May20		

EXTRAS AS PER OFFER

VENDOR TO INSTALL CAPPED GAS LINE (ROUGH-IN ONLY) AT REAR OF HOME FOR FUTURE BBQ LOCATION. LOCATION TO BE FINALIZED AT VENDORS SOLE DISCRETION. <i>Worksheet</i> Note:	
VENDOR TO INSTALL GAS LINE (ROUGH-IN ONLY) TO KITCHEN IN AT STOVE LOCATION (AS PER PLAN) TO INCLUDE 110V CODE REQUIREMENT. <i>Worksheet</i> Note:	
VENDOR TO SUPPLY & INSTALL AIR CONDITIONING UNIT, SIZED ACCORDINGLY, FROM VENDORS STANDARD SAMPLES. <i>Worksheet</i> Note:	

**SCHEDULE "B-1"**  
**Floor Plan**

Lot 9  
Phase 4A  
Model: John (4201) Elev A 4 Bed - 2+1 Bath  
Standard

*Sketch #1*

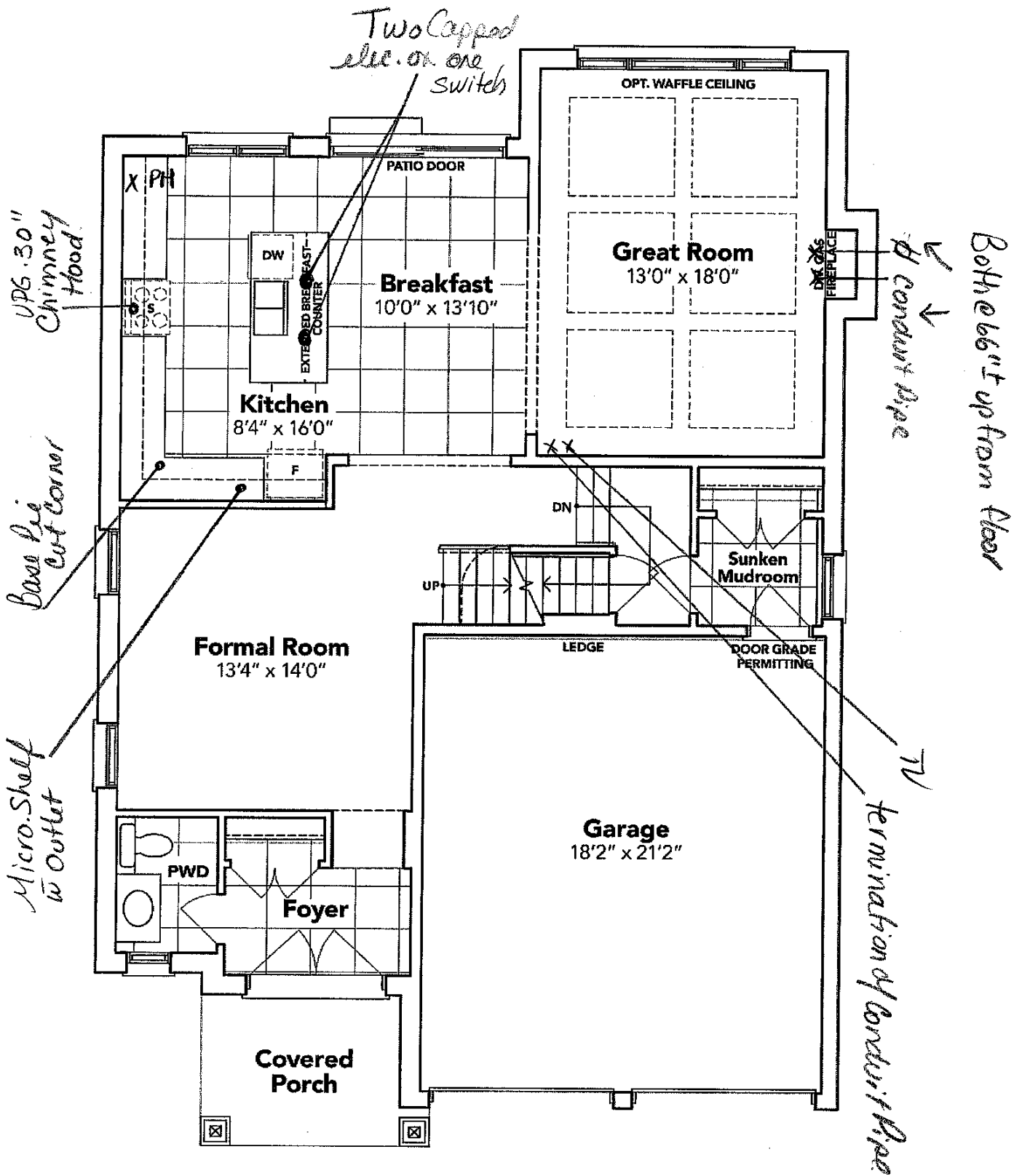

→ SEE ATTACHED FOR SIGNATURES

**GROUND FLOOR EL. A**

The floor plans and elevations shown are pre-construction plans and may be revised or improved as necessitated by architectural controls and the construction process. The measurements adhere to the rules and regulations of the TARION Warranty Corporation's official method for the calculation of floor area. Materials, specifications and floor plans are subject to change without notice. All house renderings are artist's concept only. Actual usable floor space may vary from the stated floor area. All options shown are upgrades. E. & O. E.

**SCHEDULE "B-1"**  
**Floor Plan**

Lot 9  
 Phase 4A  
 Model: John (4201) Elev A 4 Bed - 2+1 Bath  
 Standard

*sketch #2*

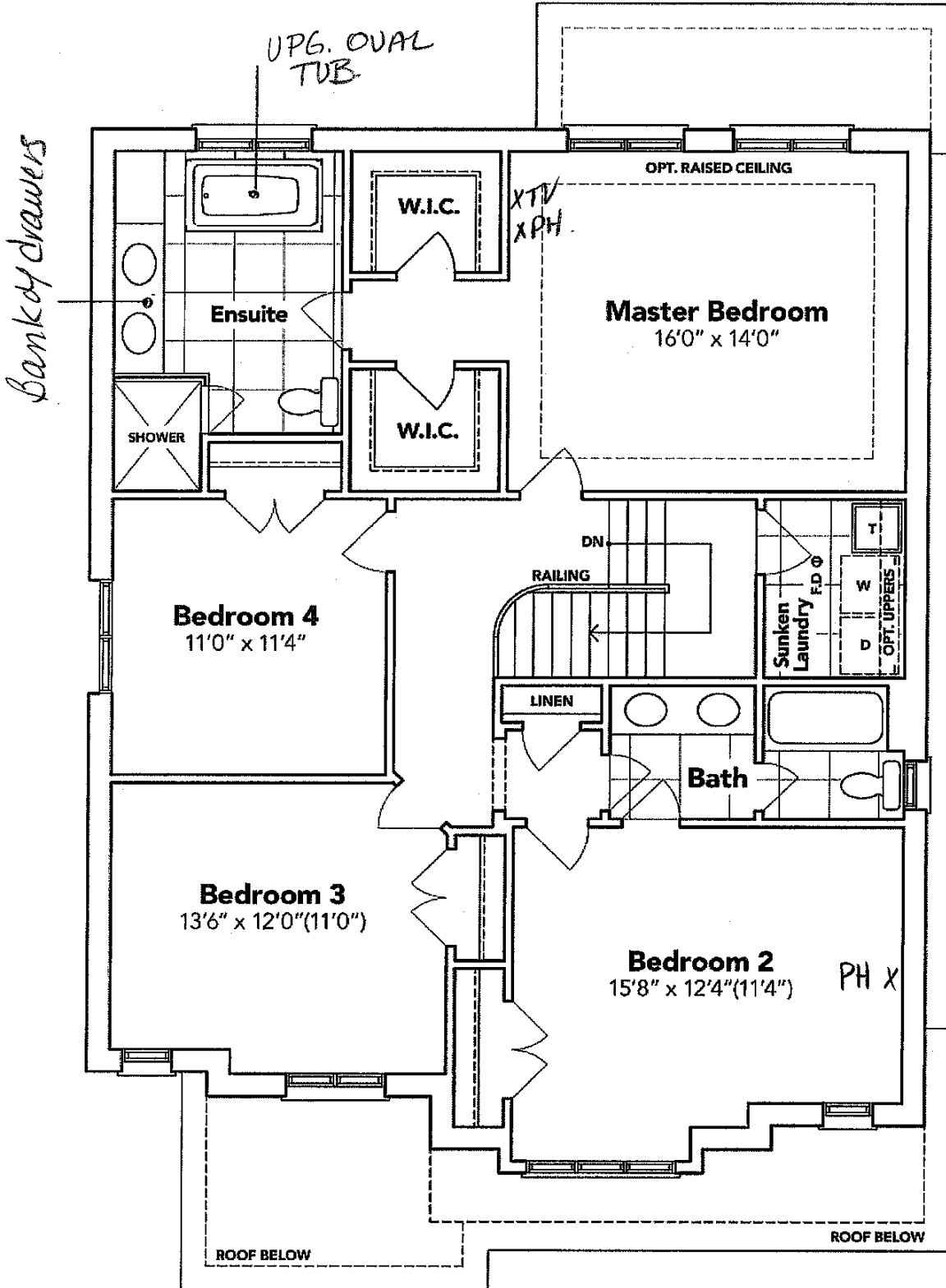

SEE ATTACHED FOR SIGNATURES

**SECOND FLOOR EL. A**

The floor plans and elevations shown are pre-construction plans and may be revised or improved as necessitated by architectural controls and the construction process. The measurements adhere to the rules and regulations of the TARION Warranty Corporation's official method for the calculation of floor area. Materials, specifications and floor plans are subject to change without notice. All house renderings are artist's concept only. Actual usable floor space may vary from the stated floor area. All options shown are upgrades. E. & O. E.



LOT: 9 Thames PH: 4A

RE: UPG. 30" Chimney Hood Fan

Specifications

- Air Flow Volume: 650 CFM
- Electrical Connection: 120V/60Hz
- Power Consumption: 240 Watts
- Current: 2.0 Amps
- Fan Speed: 1599 RPM
- Finishes: Stainless Steel
- Duct: 6" Round
- Knock-out: 6" Round - Top Only
- Dimensions: Width: 30"/36"  
Height: 44 1/2"  
Depth: 19 3/4"
- Noise Level: Min. 2 Sones  
Max. 7 Sones

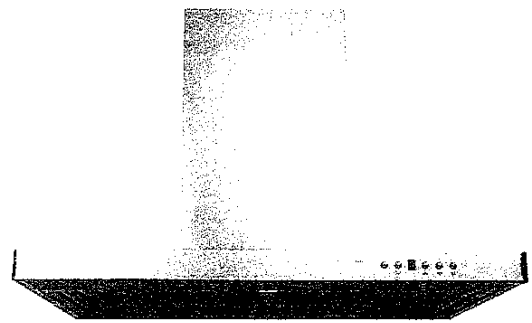

SCB722 - Baffle Filter



Ordering Model Chart

Model	Colour	Knock-out	Duct	Size	Filter	CFM
SCB72230	Stainless Steel	6"	6" Round	30"	Baffle	650
<del>SCB72236</del>	<del>Stainless Steel</del>	<del>6"</del>	<del>6" Round</del>	<del>36"</del>	<del>Baffle</del>	<del>650</del>

Notes

SEE ATTACHED FOR SIGNATURES



LOT: 9 Thames PH:4A

RE: UPG. OVAL FREE STANDING TUB FOR  
MASTER ENS:



SEE ATTACHED FOR SIGNATURES



Brooke™ | 1

## Brooke™

Categories: Acrylic Freestanding

### DESCRIPTION

68" Freestanding Bath  
SKU #: CF2002

### FEATURES

- Installation friendly two piece design
- Accepts deck mounted faucet
- Includes a chrome integral pop up drain and rectangular overflow
- ~~Deck mounted faucet~~
- Centre drain
- Includes levelling feet
- Available in White Only

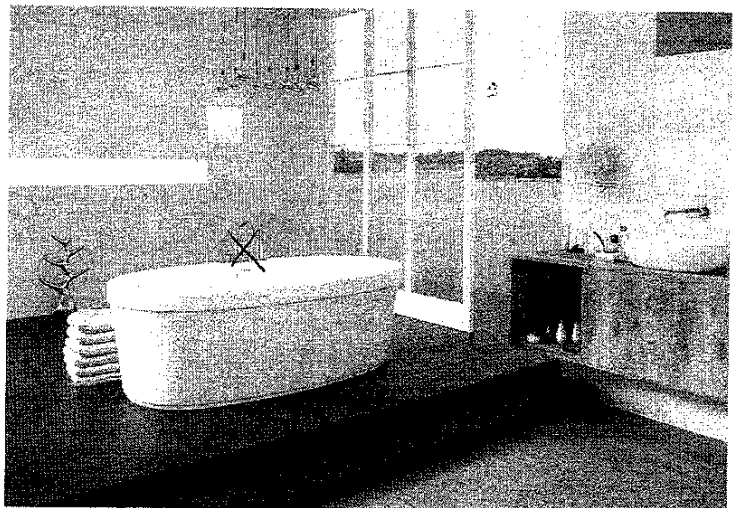

### DIMENSIONS

68" x 36" x 23"

## OPTIONS & ACCESSORIES

### SOAKER

CF2002

LOT: 9 Thomas PH: 4A  
RE: UPG. FIP Mantle.



SEE ATTACHED FOR SIGNATURES

