

Kingsmen (Thames) Inc. / Havelock Corners (Kingsmen)

Lot/Unit: 25 Phase/Building: 4A Model/Floor Plan: James (3601) Elev B 4 Bed - 2+1 Bath

CABINETRY VANITY

Inv.4605	1 - To INCREASE VANITY TO KITCHEN HEIGHT 90CM HIGH - MAINTAINS VANITY DEPTH - VIKING SERIES for the powder room...	
Line 58790	Note:	
17Apr20 / 4May20		
Inv.4605	1 - To INCREASE VANITY TO KITCHEN HEIGHT 90CM HIGH - MAINTAINS VANITY DEPTH - VIKING SERIES for the master bathroom...	
Line 58791	Note:	
17Apr20 / 4May20		
Inv.4605	1 - To INCREASE VANITY TO KITCHEN HEIGHT 90CM HIGH - MAINTAINS VANITY DEPTH - VIKING SERIES for the main bathroom...	
Line 58792	Note:	
17Apr20 / 4May20		

COUNTER TOP

Inv.4605	1 - As per schedule "PE": Vendor to incluyde level 1, 3cm granite or quartz in ktichen, as per plan, in lieu of the included laminate counter tops. Selections to be made from builders standard samples.	
Line 58783	Note:	
17Apr20 / 4May20		

ELECTRICAL

Inv.4605	1 - To supply & install the standard T.V. rough in in the great room and master bedroom... see sketch # 1 & # 2	
Line 58785	Note: The T.V. rough in in the great room needs to be installed at approx. 66" + - up from the floor centered +- to the F/P mantle	
17Apr20 / 4May20		
This is for a future wall mount T.V.		
Inv.4605	1 - To supply & install the standard Phone rough in in the kitchen, master bedroom and Bedroom # 2.... see sketch # 1 & # 2	
Line 58786	Note:	
17Apr20 / 4May20		
Inv.4605	1 - To SUPPLY AND INSTALL AN ADDITIONAL BASIC RECEPTACLE (NOT DEDICATED) at approx. 66 " +- up from the floor centered to the F/P mantle..see sketch #1	
Line 58787	Note: This is for a future wall mount T.V.	
17Apr20 / 4May20		
Inv.4605	1 - Relocate the std. ceiling light from the upper stair landing to the O.T.B. area on the second floor... see sketch # 2	
Line 58788	Note:	
17Apr20 / 4May20		

HEATING AND AIR CONDITIONING



CONSTRUCTION SUMMARY

Kingsmen (Thames) Inc. / Havelock Corners (Kingsmen)

Lot/Unit: 25 Phase/Building: 4A Model/Floor Plan: James (3601) Elev B 4 Bed - 2+1 Bath

EXTRAS AS PER OFFER

VENDOR TO INSTALL CAPPED GAS LINE (ROUGH-IN ONLY) AT REAR OF HOME FOR FUTURE BBQ LOCATION. LOCATION TO BE FINALIZED AT VENDORS SOLE DISCRETION. <i>Worksheet</i> Note:	
VENDOR TO INSTALL GAS LINE (ROUGH-IN ONLY) TO KITCHEN IN AT STOVE LOCATION (AS PER PLAN) TO INCLUDE 110V CODE REQUIREMENT. <i>Worksheet</i> Note:	
VENDOR TO SUPPLY & INSTALL AIR CONDITIONING UNIT, SIZED ACCORDINGLY, FROM VENDORS STANDARD SAMPLES. <i>Worksheet</i> Note:	

SCHEDULE "B-1"
Floor Plan

Model: James (3601) Elev B 4 Bed - 2+1 Bath
Standard

LOT: 25 sketch #1

Both @ 66" ± up from floor
✓
T.V. & electrical

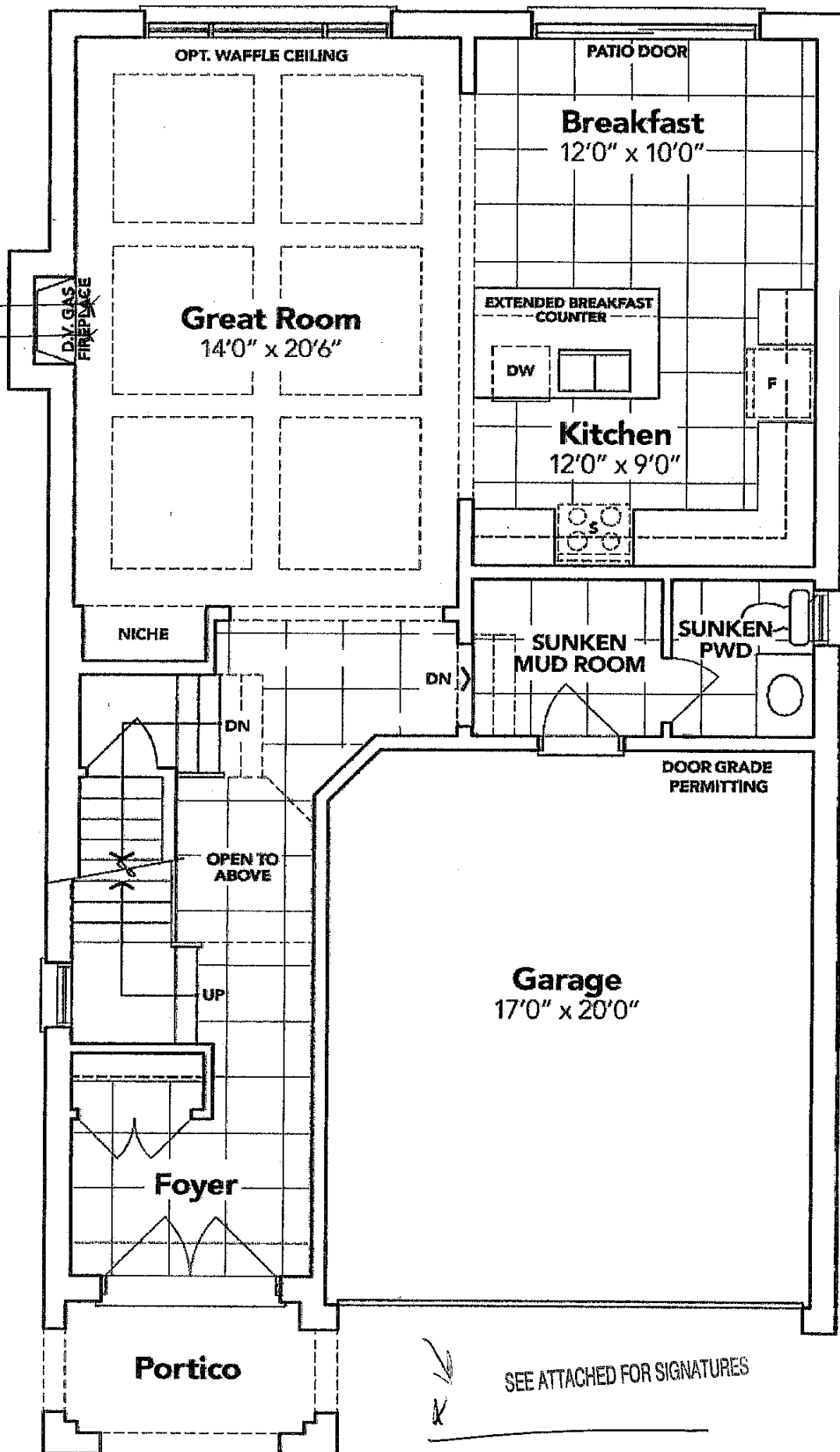

GROUND FLOOR EL. B

The floor plans and elevations shown are pre-construction plans and may be revised or improved as necessitated by architectural controls and the construction process. The measurements adhere to the rules and regulations of the TARION Warranty Corporation's official method for the calculation of floor area. Materials, specifications and floor plans are subject to change without notice. All house renderings are artist's concept only. Actual usable floor space may vary from the stated floor area. All options shown are upgrades. E. & O. E.

LOT 25 Sketch #2.

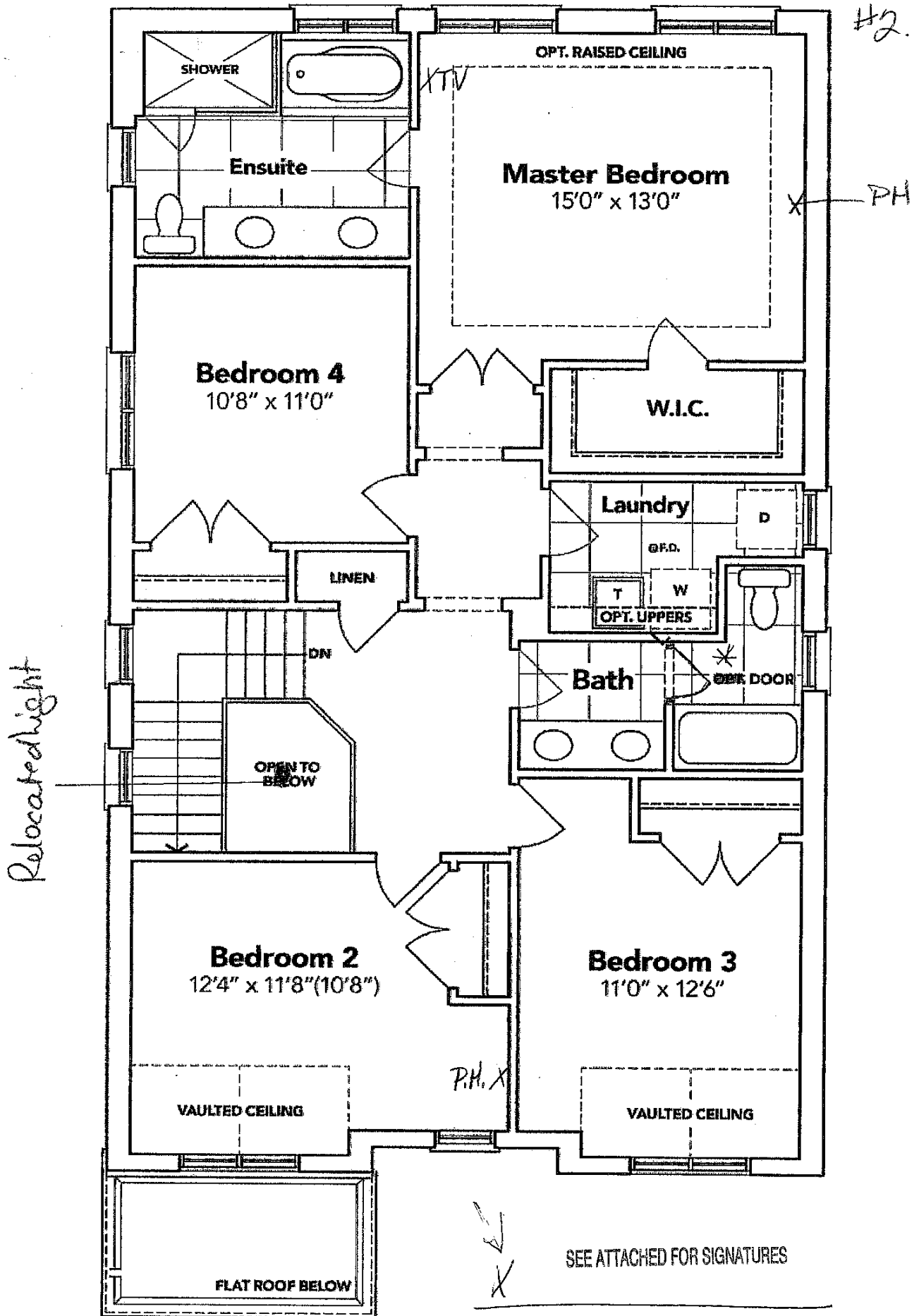

SECOND FLOOR EL. B

The floor plans and elevations shown are pre-construction plans and may be revised or improved as necessitated by architectural controls and the construction process. The measurements adhere to the rules and regulations of the TARION Warranty Corporation's official method for the calculation of floor area. Materials, specifications and floor plans are subject to change without notice. All house renderings are artist's concept only. Actual usable floor space may vary from the stated floor area. All options shown are upgrades. E. & O. E.