

Kingsmen (Thames) Inc. / Havelock Corners (Kingsmen)

Lot/Unit: 49    Phase/Building: 4A    Model/Floor Plan: Arthur (4205) Elev C 4 Bed - 4+1 Bath

CABINETRY

Inv.4617	1 - To accomodate for the upgraded 30" chimney hood fan in the kitchen .... see spec's	
Line 58947	Note:	
24Apr20 / 27Apr20		

CABINETRY HOOD FANS

Inv.4617	1 - HOOD FAN - PRO COLLECTION (SCB72230) WALL MOUNT RANGE HOOD WITH 650 CFM FAN - 30 INCH	
Line 58946	Note:	
24Apr20 / 27Apr20		

CABINETRY VANITY

Inv.4617	1 - To supply & install a VANITY BANK OF DRAWERS - MAX. WIDTH 55CM - CLASSIC SERIES in the master ensuite... see sketch # 2	
Line 58960	Note:	
24Apr20 / 27Apr20		

ELECTRICAL

Inv.4617	1 - To supply & install the standard T.V. rough in in the great room and master bedroom... see sketch # 1 & # 2	
Line 58948	Note:	
24Apr20 / 27Apr20		
Inv.4617	1 - To supply & install the standard Phone rough in in the study, master bedroom and computer niche area ... see sektch # 1 & # 2	
Line 58949	Note:	
24Apr20 / 27Apr20		
Inv.4617	1 - To SUPPLY AND INSTALL AN ADDITIONAL BASIC RECEPTACLE (NOT DEDICATED) at approx. 66 " + - up from the floor centered +- to the F/P in the great room.	
Line 58950	Note: See sketch # 1	
24Apr20 / 27Apr20                      This is for a future wall mount T.V		
Inv.4617	1 - To supply & install a conduit pipe at approx. 66 " + - up from the floor centered to the F/P and terminated next to +- the std. T.V. rough in in the great room... see sketch # 1	
Line 58951	Note: This is for a future wall mount T.V	
24Apr20 / 27Apr20		
Inv.4617	1 - To SUPPLY AND INSTALL EXTRA CEILING BOX ROUGH IN CAPPED (DOES NOT INCLUDE SWITCH) over the breakfast bar in the kitchen... see sketch # 1	
Line 58953	Note: This capped ceiling elec. will be connected to a sep. switch, switch is sold sep.	
24Apr20 / 27Apr20		
Inv.4617	1 - To supply & install AN ADDITIONAL SINGLE POLE SWITCH connected to the upg. capped ceiling electrical over the Breakfast bar in the kitchen.	
Line 58954	Note:	
24Apr20 / 27Apr20		

HEATING AND AIR CONDITIONING



CONSTRUCTION SUMMARY

Kingsmen (Thames) Inc. / Havelock Corners (Kingsmen)

Lot/Unit: 49    Phase/Building: 4A    Model/Floor Plan: Arthur (4205) Elev C 4 Bed - 4+1 Bath

EXTRAS AS PER OFFER

VENDOR TO INSTALL CAPPED GAS LINE (ROUGH-IN ONLY) AT REAR OF HOME FOR FUTURE BBQ LOCATION. LOCATION TO BE FINALIZED AT VENDORS SOLE DISCRETION. <i>Worksheet</i> Note:	
VENDOR TO SUPPLY & INSTALL AIR CONDITIONING UNIT, SIZED ACCORDINGLY, FROM VENDORS STANDARD SAMPLES. <i>Worksheet</i> Note:	

# SCHEDULE "B-1"

## Floor Plan

Lot 49  
Phase 4A  
Model: Arthur (4205) Elev C 4 Bed - 4+1 Bath  
Standard

Sketch #1

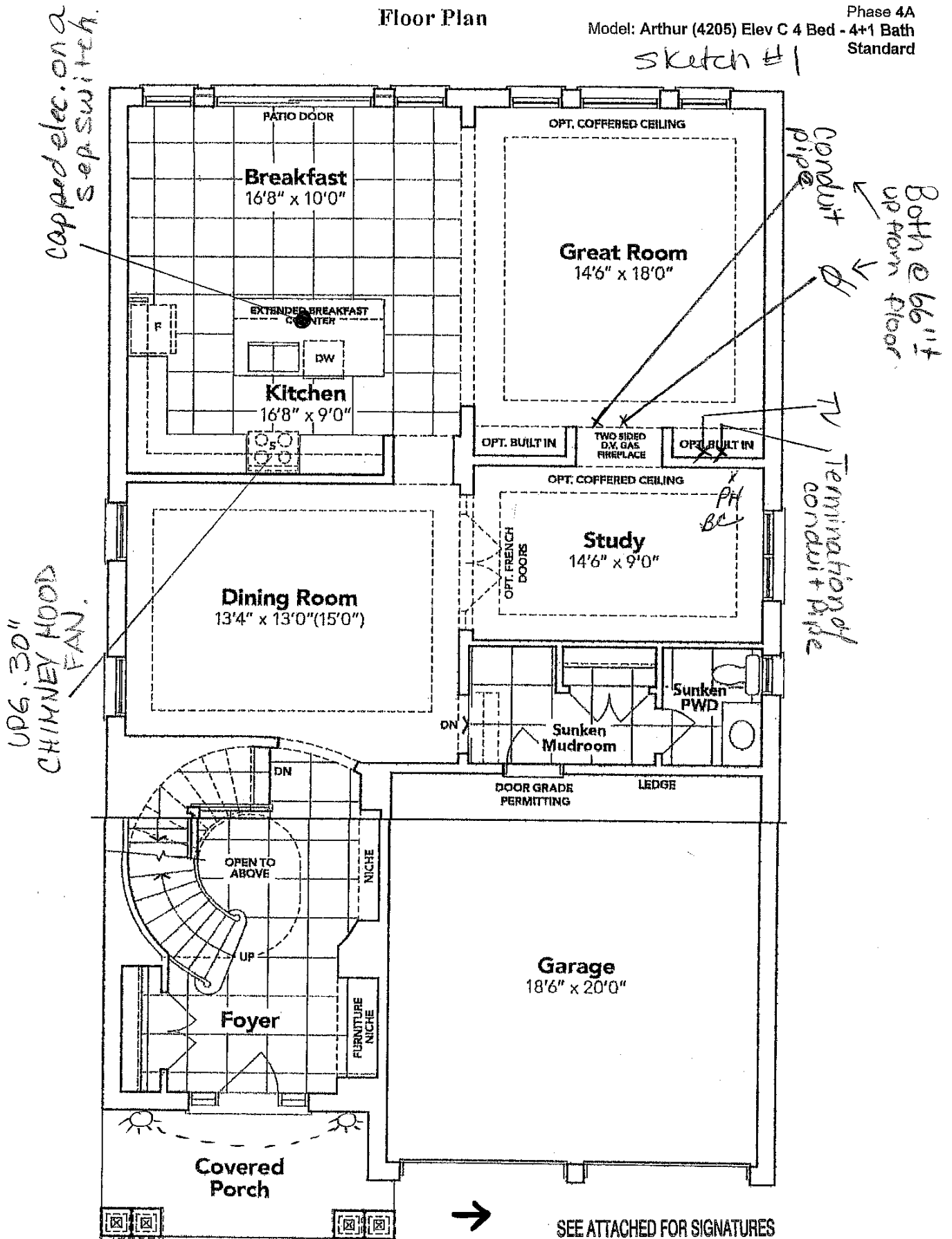

# structural

## PART. GROUND FLOOR EL. C

The floor plans and elevations shown are pre-construction plans and may be revised or improved as necessitated by architectural controls and the construction process. The measurements adhere to the rules and regulations of the TARIION Warranty Corporation's official method for the calculation of floor area. Materials, specifications and floor plans are subject to change without notice. All house renderings are artist's concept only. Actual usable floor space may vary from the stated floor area. All options shown are upgrades. E. & O. E.

SCHEDULE "B-1" - Page 2 of 3

# SCHEDULE "B-1"

## Floor Plan

Lot 49  
Phase 4A  
Model: Arthur (4205) Elev C 4 Bed - 4+1 Bath  
Standard

Sketch #2

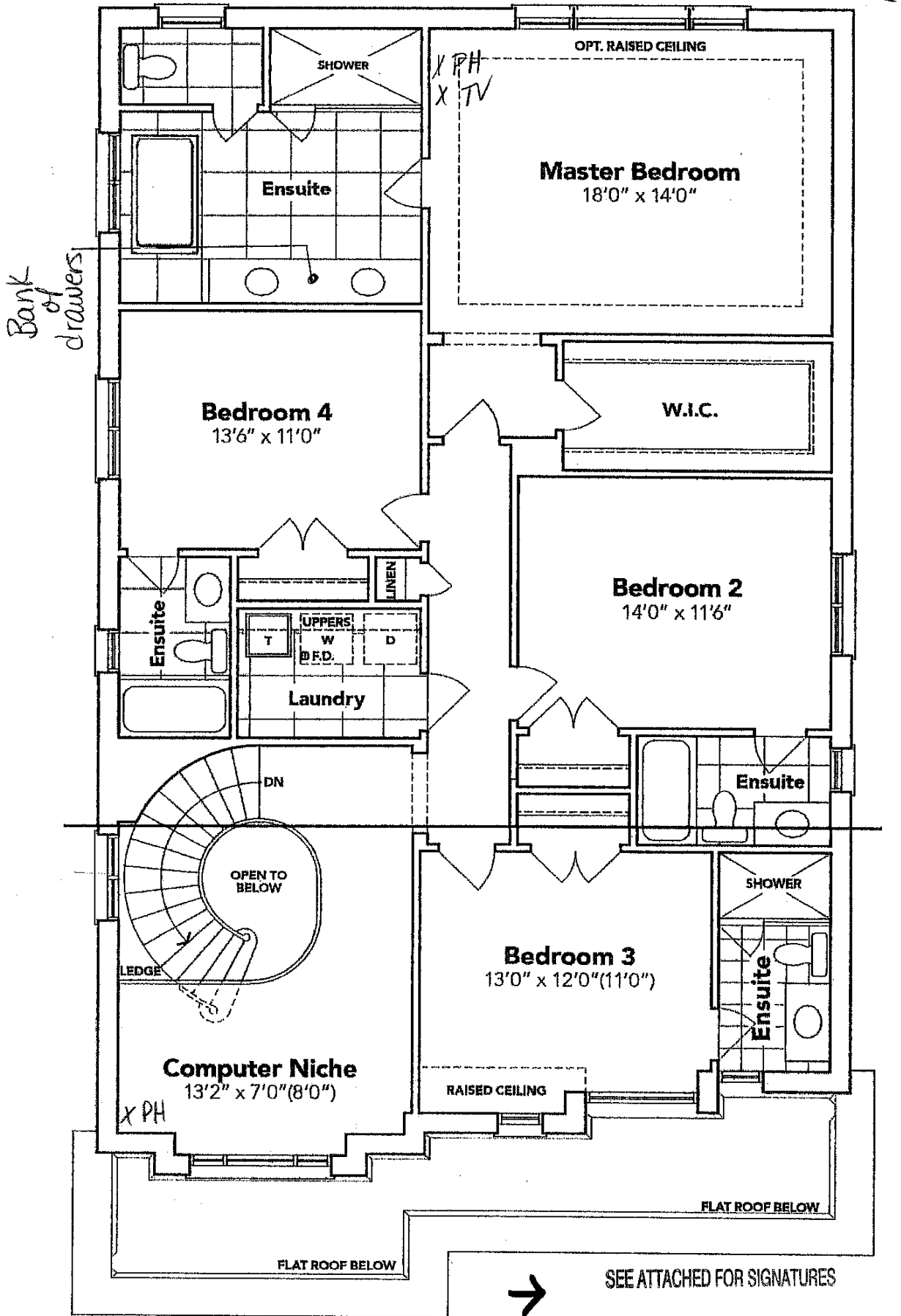

## PART. SECOND FLOOR EL. C

The floor plans and elevations shown are pre-construction plans and may be revised or improved as necessitated by architectural controls and the construction process. The measurements adhere to the rules and regulations of the TARION Warranty Corporation's official method for the calculation of floor area. Materials, specifications and floor plans are subject to change without notice. All house renderings are artist's concept only. Actual usable floor space may vary from the stated floor area. All options shown are upgrades. E. & O. E.

structural

SCHEDULE "B-1" - Page 3 of 3

LOT: 49 Hawelock Corners PH: 4A

RE: UPG. 30" Chimney Hood Fan

Specifications

Air Flow Volume: 650 CFM  
Electrical Connection: 120V/60Hz  
Power Consumption: 240 Watts  
Current: 2.0 Amps  
Fan Speed: 1599 RPM  
Finishes: Stainless Steel  
Duct: 6" Round  
Knock-out: 6" Round - Top Only  
Dimensions: Width: 30"/36"  
Height: 44 1/2"  
Depth: 19 3/4"  
Noise Level: Min. 2 Sones  
Max. 7 Sones

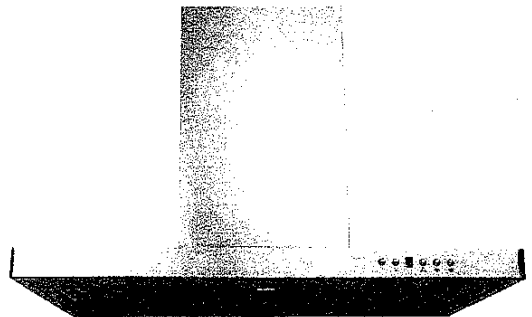

SCB722 - Baffle Filter



Ordering Model Chart

Model	Colour	Knock-out	Duct	Size	Filter	CFM
SCB72230	Stainless Steel	6"	6" Round	30"	Baffle	650
<del>SCB72236</del>	<del>Stainless Steel</del>	<del>6"</del>	<del>6" Round</del>	<del>36"</del>	<del>Baffle</del>	<del>850</del>

Notes

→ SEE ATTACHED FOR SIGNATURES

Cyclone®

LOT: 49 HOOBLOK CORNERS PH: 44

RE: UPG 30" Chimney Hood Fan

### Specifications

Air Flow Volume: 650 CFM  
Electrical Connection: 120V/60Hz  
Power Consumption: 240 Watts  
Current: 2.0 Amps  
Fan Speed: 1599 RPM  
Finishes: Stainless Steel  
Duct: 6" Round  
Knock-out: 6" Round - Top Only  
Dimensions: Width: 30 7/8"  
Height: 44 1/2"  
Depth: 19 3/4"  
Noise Level: Min. 2 Sones  
Max. 7 Sones

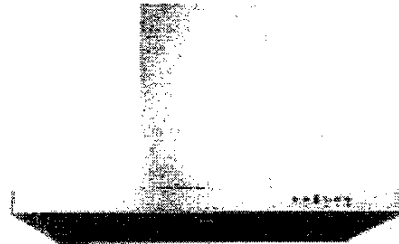

SCB722 - Baffle Filter



### Ordering Model Chart

Model	Colour	Knock-out	Duct	Size	Filter	CFM
SCB72230	Stainless Steel	6"	6" Round	30"	Baffle	650
<del>SCB72230</del>	<del>Stainless Steel</del>	<del>6"</del>	<del>6" Round</del>	<del>30"</del>	<del>Baffle</del>	<del>650</del>

### Notes

→ *[Handwritten signature]*

*Cyclone*®