

Kingsmen (Thames) Inc. / Havelock Corners (Kingsmen)

Lot/Unit: 13 Phase/Building: 4A Model/Floor Plan: Edward (3602) Elev C 4 Bed - 2+1 Bath

CABINETRY

Inv.4592	1 - Purchaser has upgraded the 30" hood fan in the kitchen....see spec's attached.	
Line 58635	Note:	
7Apr20 / 29Apr20		
Inv.4592	1 - See attached for Fridge spec's	
Line 58937	Note:	
7Apr20 / 29Apr20		

CABINETRY ACCESSORIES

Inv.4592	3 - To supply & install LIGHT VALANCE - FOR CLARIFICATION OF STYLES SEE MOULDING MATRIX - LIGHT VALANCE IS NOW APPROXIMATELY 2INCHES 50MM HIGH - PRICE PER 8 FOOT LENGTH - VIKING SERIES	
Line 58653	Note: NOTE NO ROUGH IN WIRES OR LIGHTS HAVE BEEN PURCHASED	
7Apr20 / 29Apr20		

CABINETRY BASE CABINETS

Inv.4592	1 - To SUPPLY & Install the POTS & PANS DRAWER - MINIMUM 60 CM - MAXIMUM 90 CM - SIZE SUBJECT TO FLOOR PLAN - VIKING SERIES in the kitchen... see sketch # 1	
Line 58655	Note:	
7Apr20 / 29Apr20		
Inv.4592	1 - To supply & install the PULL-OUT SPICE RACK CABINET - FULL-HEIGHT CABINET RECEIVES 3 TRAY- AVAILABLE ONLY IN 30CM + - WIDE CABINETS - VIKING SERIES next to the standard bank of drawers in the kitchen... see sketch # 1	
Line 59063	Note:	
7Apr20 / 29Apr20		
Inv.4592	1 - To supply & install the BASE PIE CUT CORNER - VIKING SERIES in the kitchen... see sketch # 1	
Line 58652	Note:	
7Apr20 / 29Apr20		

CABINETRY MICROWAVE OVEN STOVE COOKTOP

Inv.4592	1 - To accomodate for a future SLIDE-IN STOVE PREP AND CUT-OUT FOR LAMINATE COUNTERTOP - SUPPLY SPECS - LAMINATE COUNTER SHOULD BE CLEAN CUT - SEE 01F - VIKING SERIES	
Line 58658	Note:	
7Apr20 / 29Apr20		
Inv.4592	1 - To supply & install the WALL CABINET WITH SHELF FOR MICROWAVE - FINISHED INTERIOR - OPENING 24INCHESW X 13 3 - 4INCHESH X 17INCHESD - VIKING SERIES	
Line 58659	Note: Electrical outlet is sold sep.	
7Apr20 / 29Apr20		

CABINETRY PANTRY

Kingsmen (Thames) Inc. / Havelock Corners (Kingsmen)

Lot/Unit: 13 Phase/Building: 4A Model/Floor Plan: Edward (3602) Elev C 4 Bed - 2+1 Bath

Inv.4592	2 - To supply & install PANTRY 66 CM DEEP IN LIEU OF UPPER - BASE - COUNTER DEPTH - PRICE IS PER FOOT - VIKING SERIES next to the fridge in the kitchen.... see sketch # 1	
Line 58661	Note:	
7Apr20 / 29Apr20		
Inv.4592	2 - To supply & install an additional two feet + - of PANTRY 66 CM DEEP - COUNTER DEPTH - PRICE IS PER FOOT - VIKING SERIES ... see sketch # 1	
Line 58662	Note:	
7Apr20 / 29Apr20		

CABINETRY VANITY

Inv.4592	1 - To supply & install a VANITY BANK OF DRAWERS - MAX. WIDTH 55CM - VIKING SERIES in the master ensuite bathroom... see sketch # 2	
Line 58663	Note:	
7Apr20 / 29Apr20		
Inv.4592	1 - To supply & install a VANITY BANK OF DRAWERS - MAX. WIDTH 55CM - VIKING SERIES in the main bathroom... see sketch # 2	
Line 58936	Note:	
7Apr20 / 29Apr20		

CABINETRY WALL AND HUTCH

Inv.4592	1 - To supply & install an UPPER ANGLE CORNER PER UNIT - VIKING SERIES in the kitchen.... see sketch # 1	
Line 58935	Note:	
7Apr20 / 29Apr20		

COUNTER TOP - EXTRAS

Inv.4592	1 - CLEAN CUT - NO BACKSPLASH ON LAMINATE COUNTERTOPS - FOR ALL COOKTOPS AND SLIDE-IN STOVES AND HUTCH CABINETS - VIKING SERIES	
Line 58656	Note:	
7Apr20 / 29Apr20		

ELECTRICAL

Inv.4592	1 - To supply & install a CYCLONE 30" PTB86 stainless steel hood fan in the kitchen in lieu of the std. hood fan.... see spec's attached	
Line 58634	Note:	
7Apr20 / 29Apr20		
Inv.4592	1 - To supply & install the standard T.V. rough in in the great room and master bedroom... see sketch # 1 & # 2	
Line 58639	Note:	
7Apr20 / 29Apr20		
Inv.4592	1 - To supply & install the standard Phone rough in in the great room, master bedroom and bedroom # 2...See sketch # 1 & # 2	
Line 58640	Note:	
7Apr20 / 29Apr20		

Kingsmen (Thames) Inc. / Havelock Corners (Kingsmen)

Lot/Unit: 13 Phase/Building: 4A Model/Floor Plan: Edward (3602) Elev C 4 Bed - 2+1 Bath

Inv.4592 Line 58641 7Apr20 / 29Apr20	1 - To supply & install a conduit pipe at approx. 66 " + - up from the floor centered + - to the F/P mantle and terminated next to + - the std. T.V. rough in in the great room....see sketch # 1 Note:	
Inv.4592 Line 58642 7Apr20 / 29Apr20	1 - To SUPPLY AND INSTALL AN ADDITIONAL BASIC RECEPTACLE (NOT DEDICATED) at approx. 66 " +- up form the floor centered to the F/P mantle..see sketch # 1 Note:	
Inv.4592 Line 58644 7Apr20 / 29Apr20	2 - To supply & install an additional T.V. rough in, one in bedroom # 2 & one in bedroom # 4... see sketch # 2 Note:	
Inv.4592 Line 58645 7Apr20 / 29Apr20	1 - To supply & install an additional Phone rough in in bedroom # 4... see sketch # 2 Note:	
Inv.4592 Line 58646 7Apr20 / 29Apr20	1 - To SUPPLY AND INSTALL EXTRA CEILING BOX ROUGH IN CAPPED (DOES NOT INCLUDE SWITCH) over the breakfast bar in the kitchen... see sketch # 1 Note: This ceiling electrical rough in will be connected to a switch, switch is sold sep.	
Inv.4592 Line 58647 7Apr20 / 29Apr20	1 - To supply & install an ADDITIONAL SINGLE POLE SWITCH connected to the upgraded ceiling capped electrical over the breakfast bar in the kitchen.. see sketch # 1 Note:	
Inv.4592 Line 58648 7Apr20 / 29Apr20	1 - Relocate the standard ceiling light from the upper stair landing to the O.T.B. area on the second floor...see sketch # 2 Note:	
Inv.4592 Line 58649 7Apr20 / 29Apr20	1 - Reinforce the relocated ceiling light at O.T.B. on the second floor....see sketch # 2 Note:	
Inv.4592 Line 58660 7Apr20 / 29Apr20	1 - To SUPPLY AND INSTALL AN ADDITIONAL BASIC RECEPTACLE (DEDICATED CIRCUIT AND INCLUDES ARC FAULT BREAKER) for the future microwave Note: Microwave shelf is sold seperately.	

HEATING AND AIR CONDITIONING

MISCELLANEOUS

Inv.4592 Line 58633 7Apr20 / 29Apr20	1 - To supply & install a gas rough in " capped" and a 110V electrical for a future gas stove in the kitchen Note:	
--	---	--

PLUMBING

Kingsmen (Thames) Inc. / Havelock Corners (Kingsmen)

Lot/Unit: 13 Phase/Building: 4A Model/Floor Plan: Edward (3602) Elev C 4 Bed - 2+1 Bath

Inv.4592	1 - To supply & install the WATERLINE ROUGH-IN TO THE FRIDGE LOCATION (NO HOOK UP)	
Line 58632	Note:	
7Apr20 / 29Apr20		
Inv.4592	1 - To supply & install PLUMBING EXTRAS - SHOWER STALL (IN LIEU OF STANDARD 5 FOOT TUB) in the main bathroom.... see sketch # 2	
Line 58637	Note: NOTE THIS INCLUDES A SHOWER LIGHT.	
7Apr20 / 29Apr20	NO GLASS SHOWER PANEL OR DOOR HAS BEEN PURCHASED.	

EXTRAS AS PER OFFER

VENDOR TO INSTALL CAPPED GAS LINE (ROUGH-IN ONLY) AT REAR OF HOME FOR FUTURE BBQ LOCATION. LOCATION TO BE FINALIZED AT VENDORS SOLE DISCRETION. <i>Worksheet</i> Note:	
VENDOR TO SUPPLY & INSTALL AIR CONDITIONING UNIT, SIZED ACCORDINGLY, FROM VENDORS STANDARD SAMPLES. <i>Worksheet</i> Note:	

LOT: 13
Sketch #1 BL

Both at approx. 66" \uparrow up from floor
conduit pipe
termination conduit pipe

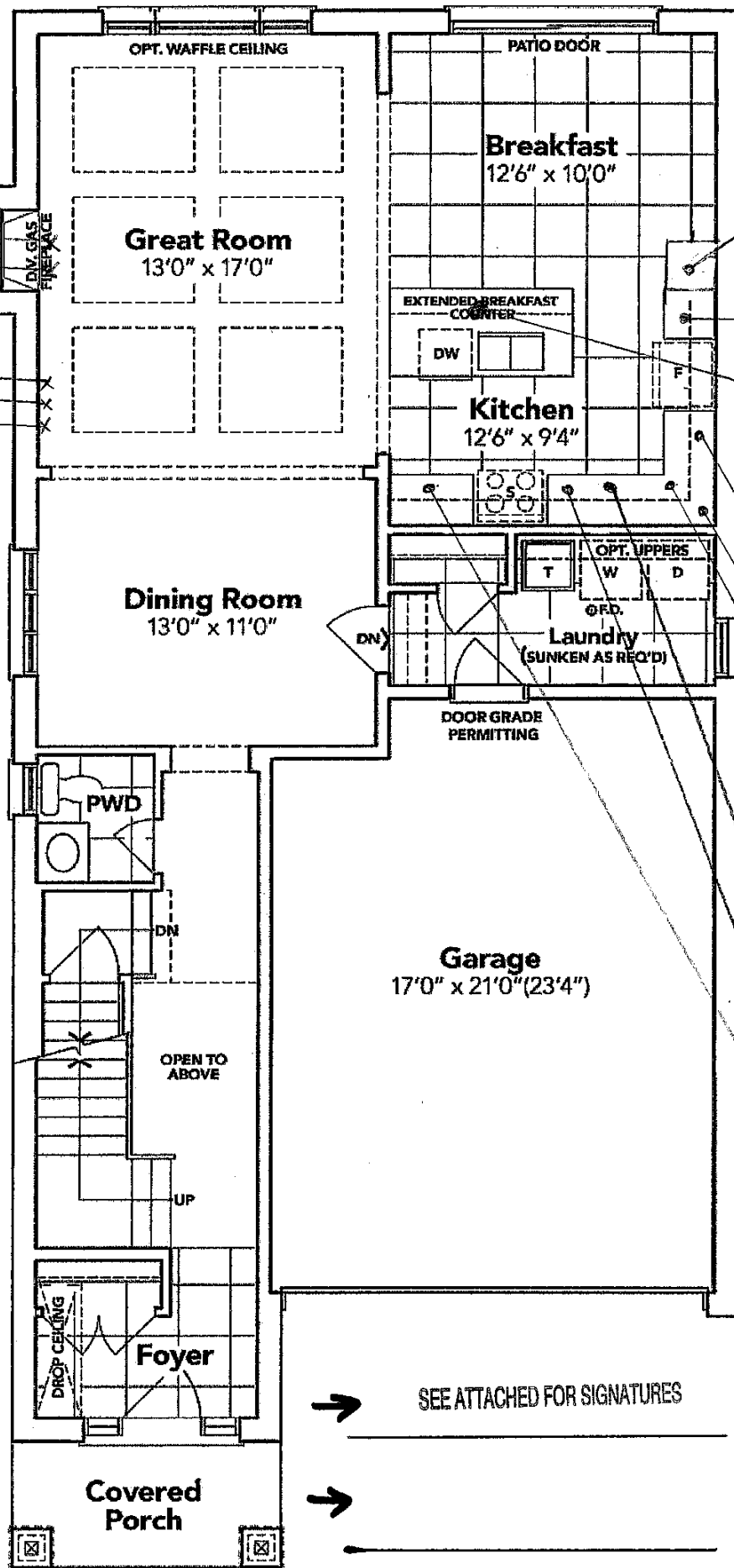

GROUND FLOOR EL. C

The floor plans and elevations shown are pre-construction plans and may be revised or improved as necessitated by architectural controls and the construction process. The measurements adhere to the rules and regulations of the TARION Warranty Corporation's official method for the calculation of floor area. Materials, specifications and floor plans are subject to change without notice. All house renderings are artist's concept only. Actual usable floor space may vary from the stated floor area. All options shown are upgrades. E. & O. E.

AS

SCHEDULE "B-1"
Floor Plan

Lot 13
Phase 4A
Model: Edward (3602) Elev C 4 Bed - 2+1 Bath
Standard

Sketch #2 BC

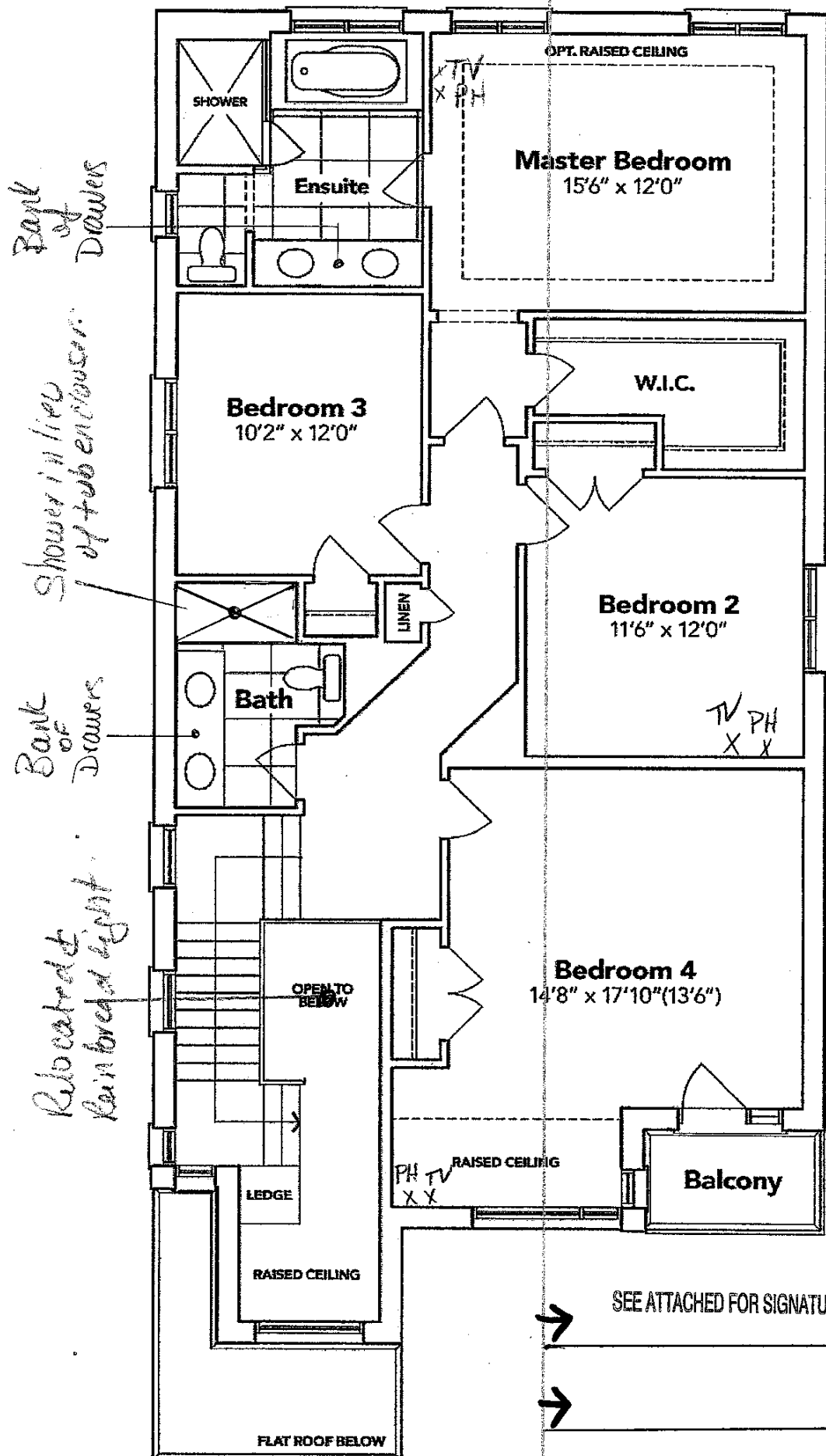

SEE ATTACHED FOR SIGNATURES

SECOND FLOOR EL. C

The floor plans and elevations shown are pre-construction plans and may be revised or improved as necessitated by architectural controls and the construction process. The measurements adhere to the rules and regulations of the TARION Warranty Corporation's official method for the calculation of floor area. Materials, specifications and floor plans are subject to change without notice. All house renderings are artist's concept only. Actual usable floor space may vary from the stated floor area. All options shown are upgrades. E. & O. E.

(Signature)

LOT: 13 THAMES PH: 4A

RE: UPG. 30" HOOD FAN

Specifications

SPEC'S FOR
KITCHEN.

Air Flow Volume: 600 CFM

Electrical Connection: 120V/60Hz

Power Consumption: 210 Watts

Current: 2.5 Amps

Fan Speed: 1550 RPM

Finishes: Stainless Steel

Duct: 6" Round

Knock-out: 6" Round (Top Only)

Dimensions: Width: 30"/36"

Height: 17 3/4"

Depth: 21 1/4"

Noise Level: Min. 2 Sones

Max. 6 Sones

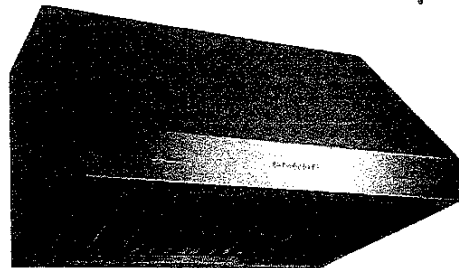

Ordering Model Chart

Model	Colour	Knock-out	Duct	Size	Filter	CFM
PTB8630	Stainless Steel	6"	6" Round	30"	Baffle	600
PTB8630	Stainless Steel	6"	6" Round	30"	Baffle	600

Notes



SEE ATTACHED FOR SIGNATURES

Cyclone[®]
Breathe Better

LOT: 13 THAMES PH-4A RE: GAS 30" SLIDE-IN STOVE
SPEC'S

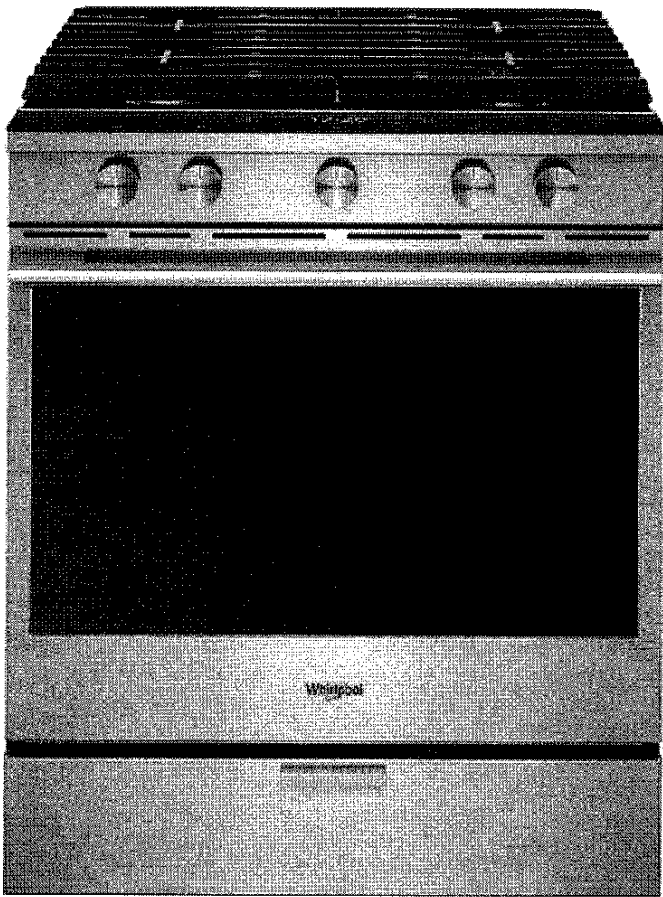

WHIRLPOOL 5.8 CU. FT. SMART SLIDE-IN
GAS RANGE - WEGA25H0HZ

\$ 1,899.00



SEE ATTACHED FOR SIGNATURES

SKU: WEGA25HZ
VSN: WEGA25H0HZ

Dimensions

Width: 29.88" (75.9 cm) Height: 36" (91.4 cm) Depth: 28.63" (72.7 cm)

Beautifully modern and packed with power – this Whirlpool 5.8-cubic-foot slide-in range was built to give you full control in the kitchen. On top, you have a powerful stove with durable EZ-2-Lift™ cast-iron grates that are hinged and dishwasher safe, plus an extra central oval burner to make cooking with large cookware simple. Inside the oven, take full advantage of settings like Party Mode and Frozen Bake™ designed save you time and get food to the table faster. Plus, fingerprint resistant stainless steel keeps this range looking clean and sparkling by repelling smudges.



Unique Features

LOT: 13 THAMES PH. 4A RE: GAS 30" SLIDE 'N
STOVE SPECS CONT

Convection Conversion:
Your oven automatically converts traditional recipes for convection cooking by adjusting cooking times and temperatures for you.

Control Lock Mode:
From your smart device you can remotely disable the control panel to avoid unintended use.

Rapid Preheat:
Save time with 20% faster preheating. A rear fan combined with the use of all of the elements helps to heat the oven quickly.

Griddle:
Make pancakes, grill vegetables or sear steaks with the included griddle that lets you cook breakfast, lunch and dinner right on the cooktop.

Temperature Sensor:
Get evenly baked food with a sensor that monitors oven temperature and adjusts the cooking elements automatically.

Sabbath Mode:
Use your smartphone or tablet to remotely set the oven to remain on the "Bake" setting at a constant. When this mode is enabled, displays, tones and all other cooking and cleaning cycles are disabled.

→ SEE ATTACHED FOR SIGNATURES

General Details

VSN	WEGA25H0HZ
UPC/GTIN	883049457260
Appliance Features	Child Lock, Fingerprint-Resistant, Smart Capable
Cooking Features	Built-In Thermometer, Convection, Sabbath Mode, Self-Clean, Storage Drawer
Range Type	Slide-In
Fuel Type	Gas
Control Panel	Electronic Touch
Handle Type	Towel Bar

Cooktop Details

Cooktop Surface	Porcelain Coated Steel
Cooktop Grates	Dishwasher Safe, Matte Finish, Porcelain Coated Cast Grates, Hinged
Cooktop Modes	Simmer, High Output, Dual Flame
Other Burner(s)	Central Oval Burner

General Details

LOT: 13 THAMES PH: 4A RE: GAS 30" SLIDE IN STOVE SPEC'S CONT	
Ignition Type	Direct Spark Ignition

Oven Details

Oven Modes	Broil, Cancel/Off, Clock, Control Lock, Convection Modes, Cook Time Indicator, Delay Start, Easy Bake, Easy Convection Baked Goods, Easy Convection Meats, Easy Convection Pizza, Energy Save Mode, Favorite, Frozen Bake, Full Meal Cook, Keep Warm Setting, Language Conversion, Proofing, Rapid Preheat, Sabbath Mode, Timer
Baking Elements	18,000 BTU → SEE ATTACHED FOR SIGNATURES
Broiler Element	Top of Oven
Lighting	Incandescent
Door	Metal and Glass

Installation Details

Installation Requirements	https://api.whirlpoolcentral.ca/_resources/documents/WEGA25H0HZ_installation_instructions.pdf
Instruction Manual URL	Instruction Manual (https://api.whirlpoolcentral.ca/_resources/documents/WEGA25H0HZ_use_and_care_en.pdf)

Additional Details

Technology Features	Smart Capable, Wi-Fi
Safety Details	See Owner's Guide
Certification(s)	ADA Height and Operation Compliant, Kosher Consumer Friendly

Additional Dimensions

Oven Capacity (cu. ft.)	5.8
Depth with Door Open 90 degrees (in.)	48.875
Other Dimensions	<ul style="list-style-type: none">Width: 29.875Height: 36Depth: 28.625



My Store: **WOODBIDGE** ▾

Open • Closes 6 p.m.

Curbside Pick-up Only



Search over 200,000 products

Due to significant increases in demand, some stores may take longer to prepare your curbside order. Please wait for the Ready for Pick-Up email before proceeding. [Learn more](#)

LOT: 13
THAMES
PH: 4A
Re: FRIDGE
SPEC'S

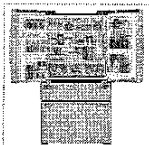
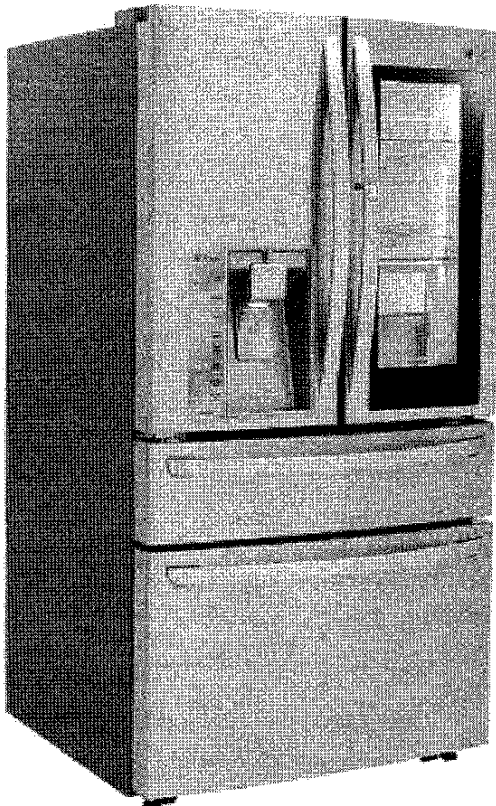

LG Electronics 36-inch W 30 cu. ft. 4-Door French Door Refrigerator with InstaView Door-in-Door in Stainless Steel - ENERGY STAR®

Model # LMXS30796S | Store SKU # 1001075755

★★★★★ (383)

SEE ATTACHED FOR SIGNATURES



\$3,695.00 / each



Delivery Charges Apply

BUY MORE, SAVE MORE [Learn More](#)

SCHEDULED DELIVERY

Enter your postal code for availability and earliest delivery date:

A1A 1A1

Add To Cart

LOT: 13 THAMES
PH: 4A
RE: FRIDGE SPEC'S
CON'T.

Overview
Specifications
Reviews
Overview
Specifications
Reviews

Overview

Model # LMXS30796S Store SKU # 1001075755

Smart style with easy access to your favourites. Knock twice on the tinted glass InstaView Door-in-Door panel to see inside the easy-access door without letting the cold air out. The Door-in-Door feature allows you to get in and get out providing easy access to beverages and snacks. Equipped with ColdSaver Technology, cold air loss can be reduced by up to 47% which means your food stays fresher longer.

- InstaView Door-in-Door gives you easy access to your favourites
- Slim SpacePlus Ice System provides more self space and usable capacity
- The Smart Cooling Plus System keeps food fresher, longer
- Luxurious, fingerprint-resistant finish

Read more about Delivery & Installation | Download the Appliance Delivery Checklist

Specifications

Dimensions

Assembled Depth (in inches)

35.2

Assembled Height (in inches)

70.2

Assembled Weight (in lbs)

419

Assembled Width (in inches)

35.7

Packaged Depth (in inches)

40.3

Packaged Height (in inches)

73

Packaged Weight (In lbs)

452

Packaged Width (in inches)

38

Details

Adjustable Door Bins

3

Built-In

No

Cantilever Shelves

No

Capacity (cu. ft.)

30

Certified

Yes

Colour Family

Stainless Steel

Counter or Standard Depth

Standard Depth

Country of Origin

O-Other

SEE ATTACHED FOR SIGNATURES

