



CONSTRUCTION SUMMARY

Kingsmen (Thames) Inc. / Havelock Corners (Kingsmen)

Lot/Unit: 67 Phase/Building: 4A Model/Floor Plan: James (3601) Elev A 4 Bed - 2+1 Bath

CABINETRY BASE CABINETS

Inv.4590	1 - To supply & intall BASE PIE CUT CORNER - VIKING SERIES in the kitchen... see sketch # 1	
Line 58610	Note:	
3Apr20 / 6Apr20		

CABINETRY VANITY

Inv.4590	1 - To supply & install the VANITY BANK OF DRAWERS - MAX. WIDTH 55CM - VIKING SERIES in the master ensuite bathroom.... see sketch # 2	
Line 58611	Note:	
3Apr20 / 6Apr20		

COUNTER TOP

ELECTRICAL

Inv.4590	1 - To SUPPLY AND INSTALL AN ADDITIONAL BASIC RECEPTACLE (NOT DEDICATED)	
Line 58603	Note: Install at approx. 66 " +- up from the floor centered + - to the F/P mantle in the great room... see sketch # 1	
3Apr20 / 6Apr20		
Inv.4590	1 - To supply & install the std. T.V. rough in in the great room and master bedroom.... see sketch # 1 & # 2	
Line 58604	Note: Install the std. T.V. rough in in the great room at approx. 66 " +- up from the floor centered + - to the F/P mantle	
3Apr20 / 6Apr20		
Inv.4590	1 - To supply & install the standard Phone rough in in the kitchen, master bedroom and bedroom # 2... see sketch # 1 & #2	
Line 58605	Note:	
3Apr20 / 6Apr20		
Inv.4590	1 - To SUPPLY AND INSTALL EXTRA CEILING BOX ROUGH IN CAPPED (DOES NOT INCLUDE SWITCH) above the breakfast bar in the kitchen.... see sketch # 1	
Line 58606	Note: These wires will be connected to a sep. switch, switch is sold sep.	
3Apr20 / 6Apr20		
Inv.4590	1 - To supply & intall AN ADDITIONAL SINGLE POLE SWITCH connected to the upgraded capped ceiling electrical above the breakfast bar in the kitchen.	
Line 58607	Note:	
3Apr20 / 6Apr20		
Inv.4590	1 - Relocate the std. ceiling light from the upper stair landing to the O.T.B. area on the second floor.... see sketch # 2	
Line 58608	Note:	
3Apr20 / 6Apr20		
Inv.4590	1 - Reinforce the relocated light at the O.T.B. area on the second floor..see sketch # 2	
Line 58609	Note:	
3Apr20 / 6Apr20		

HARDWOOD

HEATING AND AIR CONDITIONING

Kingsmen (Thames) Inc. / Havelock Corners (Kingsmen)

Lot/Unit: 67 Phase/Building: 4A Model/Floor Plan: James (3601) Elev A 4 Bed - 2+1 Bath

PLUMBING

Inv.4590	1 - To supply & install the WATERLINE ROUGH-IN TO THE FRIDGE LOCATION (NO HOOK UP)	
Line 58602	Note:	
3Apr20 / 6Apr20		

EXTRAS AS PER OFFER

VENDOR TO INSTALL CAPPED GAS LINE (ROUGH-IN ONLY) AT REAR OF HOME FOR FUTURE BBQ LOCATION. LOCATION TO BE FINALIZED AT VENDORS SOLE DISCRETION. <i>Worksheet</i> Note:	
VENDOR TO INSTALL GAS LINE (ROUGH-IN ONLY) TO KITCHEN IN AT STOVE LOCATION (AS PER PLAN) TO INCLUDE 110V CODE REQUIREMENT. <i>Worksheet</i> Note:	
VENDOR TO SUPPLY & INSTALL AIR CONDITIONING UNIT, SIZED ACCORDINGLY, FROM VENDORS STANDARD SAMPLES. <i>Worksheet</i> Note:	
VENDOR TO INCLUDE LEVEL 1, 20CM GRANITE OR QUARTZ IN ALL BATHROOMS, AND KITCHEN, AS PER PLAN, IN LIEU OF THE INCLUDED LAMINATE COUNTER TOPS. SELECTIONS TO BE MADE FROM BUILDERS STANDARD SAMPLES. <i>Worksheet</i> Note:	
VENDOR TO INCLUDE ENGINEERED HARDWOOD FLOORING THROUGHOUT THE SECOND FLOOR IN LIEU OF INCLUDED CARPET, AS PER PLAN, AND SELECTIONS AS OUTLINED IN SCHEDULE A FOR INCLUDED ENGINEERED HARDWOOD ON THE MAIN FLOOR. THIS HAS NO CASH VALUE. <i>Worksheet</i> Note:	

SCHEDULE "B-1"
Floor Plan

Lot 67
Phase 4A
Model: James (3601) Elev A 4 Bed - 2+1 Bath
Standard

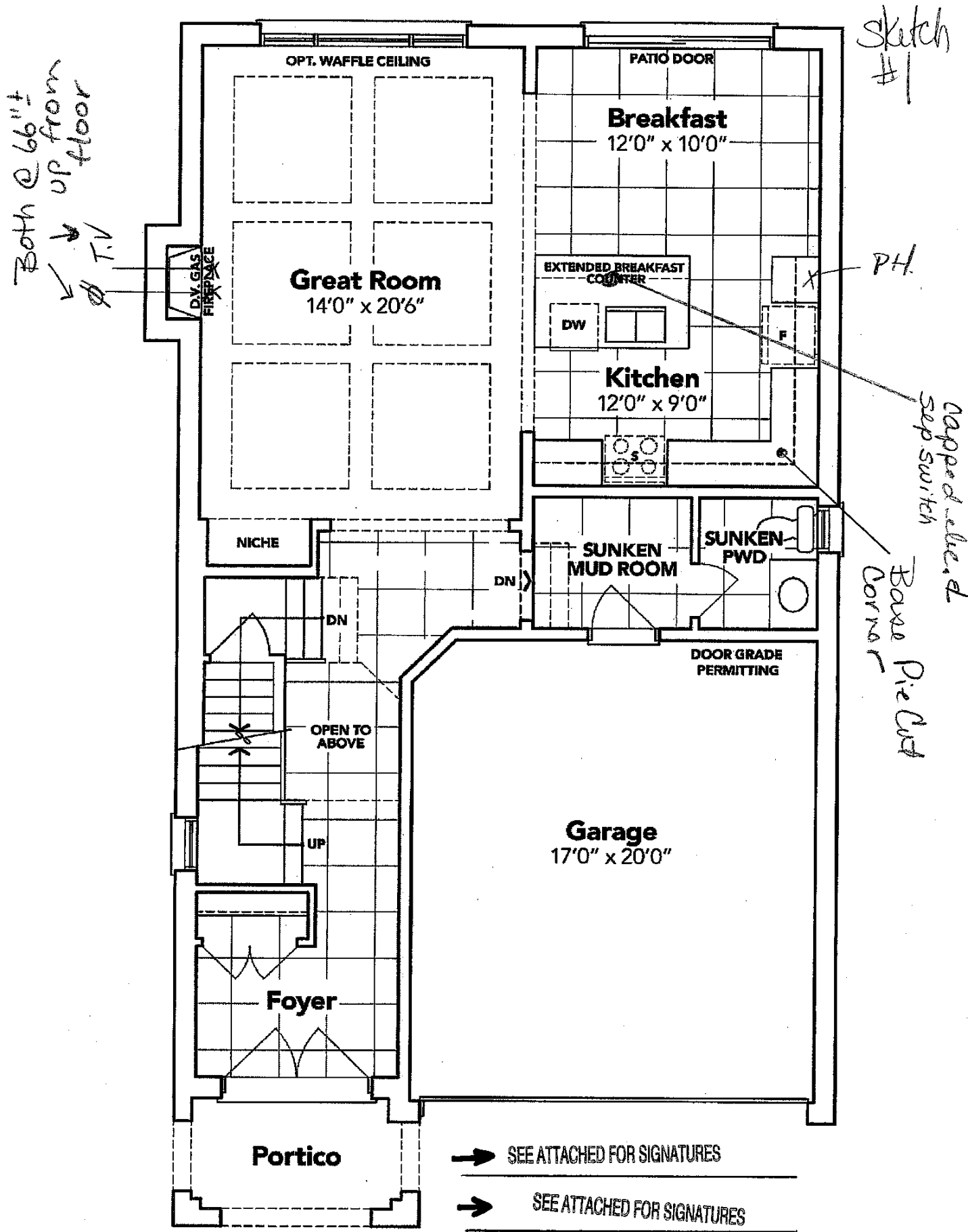

GROUND FLOOR EL. A

The floor plans and elevations shown are pre-construction plans and may be revised or improved as necessitated by architectural controls and the construction process. The measurements adhere to the rules and regulations of the TARION Warranty Corporation's official method for the calculation of floor area. Materials, specifications and floor plans are subject to change without notice. All house renderings are artist's concept only. Actual usable floor space may vary from the stated floor area. All options shown are upgrades. E. & O. E.

SCHEDULE "B-1"
Floor Plan

Lot 67
Phase 4A
Model: James (3601) Elev A 4 Bed - 2+1 Bath
Standard

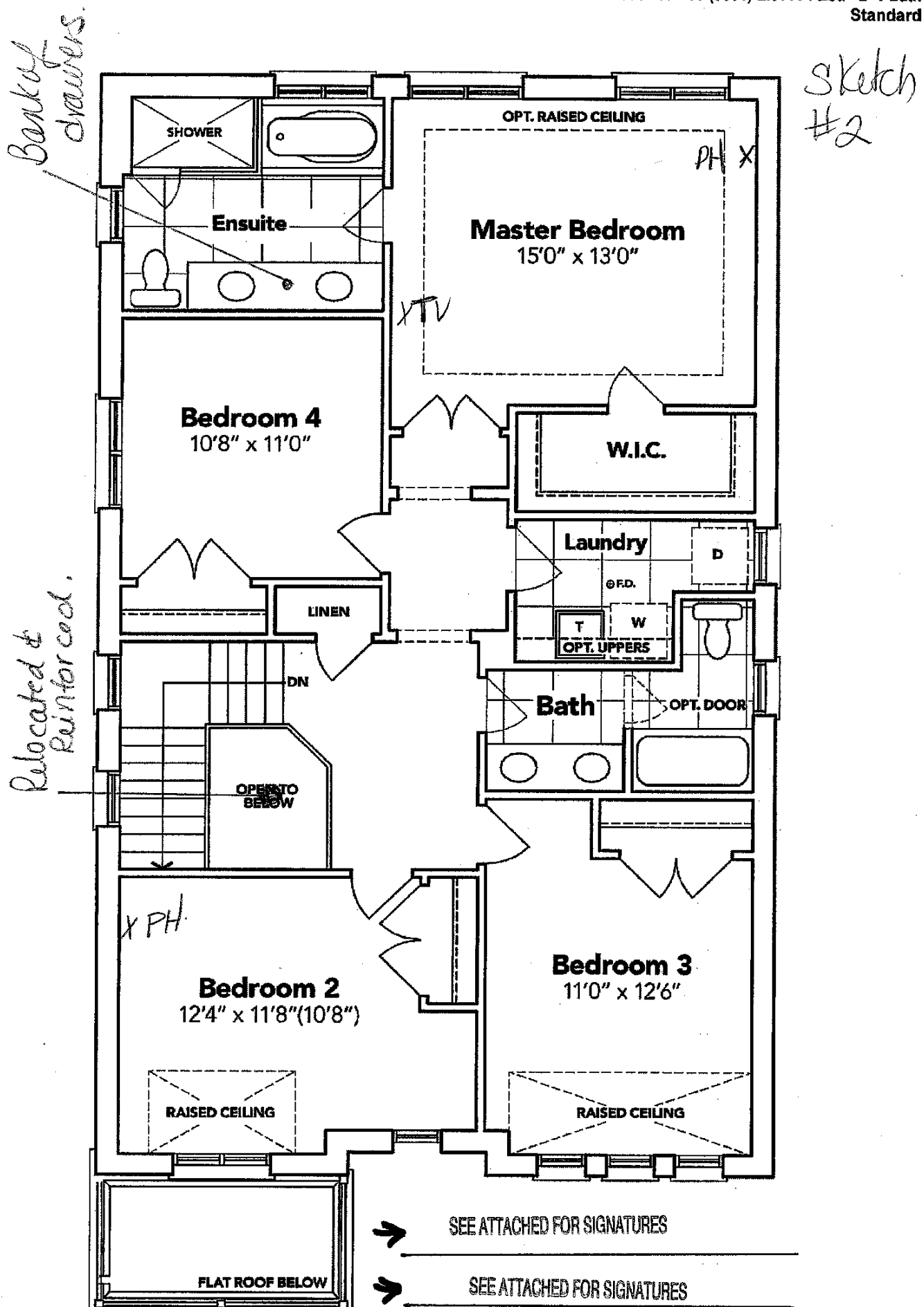

SECOND FLOOR EL. A

The floor plans and elevations shown are pre-construction plans and may be revised or improved as necessitated by architectural controls and the construction process. The measurements adhere to the rules and regulations of the TARION Warranty Corporation's official method for the calculation of floor area. Materials, specifications and floor plans are subject to change without notice. All house renderings are artist's concept only. Actual usable floor space may vary from the stated floor area. All options shown are upgrades, E. & O. E.

SCHEDULE "B-1" - Page 2 of 3

Initials: NS PS