



CONSTRUCTION SUMMARY

KINGSMEN (THAMES) INC. / Havelock Corners (Kingsmen)

Lot/Unit: 71 Phase/Building: 4A Model/Floor Plan: John (4201) Elev B 4 Bed - 2+1 Bath

.Miscellaneous

Inv.4565	1 - Do not supply or install the closet in the MUD room see sketch # 1	
Line 58125	Note:	
17Mar20 / 17Mar20		

.Pantry Cabinets

Inv.4565	1 - To supply & install a TWO door wide approx. 30" +- in total width by 24" + - deep pantry in lieu of the standard upper and lower base cabinets in the kitchen using the standard line of cabinetry.... see sketch # 1	
Line 58142	Note:	
17Mar20 / 17Mar20		

Cabinetry

Inv.4565	1 - Accomodate for a future 36" stove opening in the kitchen.	
Line 58145	Note:	
17Mar20 / 17Mar20		
Inv.4565	1 - To supply & install a Garbage pull (45 cm) out using the standard line of cabinetry... see sketch # 1	
Line 58141	Note:	
17Mar20 / 17Mar20		
Inv.4565	1 - To supply & install deep fridge uppers (NO GABLES) in the standard line of cabinetry.... see sketch # 1	
Line 58136	Note: See attached for fridge spec's.	
17Mar20 / 17Mar20		
Inv.4565	1 - To supply & install an upper angled corner cabinet using the standard line of cabinetry.... see sketch # 1	
Line 58137	Note:	
17Mar20 / 17Mar20		

CABINETRY ACCESSORIES

Inv.4565	3 - To supply & install the LIGHT VALANCE - NOT APPLICABLE FOR THERMOVISION - in the kitchen.	
Line 58139	Note: NO Rough in wires on a sep. switch has been purchased	
17Mar20 / 17Mar20		

CABINETRY BASE CABINETS

Inv.4565	1 - To supply & install the BASE PIE CUT CORNER - STANDARD LINE in the kitchen.... see sketch # 1	
Line 58138	Note:	
17Mar20 / 17Mar20		

CABINETRY MICROWAVE OVEN STOVE COOKTOP

Inv.4565	1 - To supply & install a 36" wide COOKTOP CABINET (FULL HEIGHT) WITH FALSE TOP DRAWER AND POT & PANS DRAWERS BELOW - PURCHASER MUST SUPPLY SPECS - STANDARD LINE... see sketch # 1	
Line 58143	Note: Electrical is sold seperately.	
17Mar20 / 17Mar20		



CONSTRUCTION SUMMARY

KINGSMEN (THAMES) INC. / Havelock Corners (Kingsmen)

Lot/Unit: 71 Phase/Building: 4A Model/Floor Plan: John (4201) Elev B 4 Bed - 2+1 Bath

Inv.4565	1 - To supply & install a BUILT IN DOUBLE APPLIANCE CABINET WITH DRAWER BELOW - TRIM KIT REQUIRED - PURCHASER MUST SUPPLY SPECS - STANDARD LINE ... see sketch # 1	
Line 58144	Note: Electrical is sold seperately.	
17Mar20 / 17Mar20		

CABINETRY VANITY

Inv.4565	1 - To supply & install - INCREASE VANITY HEIGHT TO KITCHEN HEIGHT (90 CM) - in the main bathroom.	
Line 58152	Note:	
17Mar20 / 17Mar20		
Inv.4565	1 - To supply & install - INCREASE VANITY HEIGHT TO KITCHEN HEIGHT (90 CM) - in the master bathroom.	
Line 58153	Note:	
17Mar20 / 17Mar20		
Inv.4565	1 - To supply & install a VANITY BANK OF DRAWERS - 55 CM MAXIMUM - STANDARD LINE in the Master Ensuite... see sketch # 2	
Line 58154	Note:	
17Mar20 / 17Mar20		
Inv.4565	1 - To supply & install VANITY BANK OF DRAWERS - 55 CM MAXIMUM - STANDARD LINE in the MAIN bathroom.... see sketch # 1	
Line 58155	Note:	
17Mar20 / 17Mar20		

COUNTER TOP - EXTRAS

Inv.4565	1 - To accomodate for a COUNTER TOP PROVISION ONLY - GRANITE/Quartz CUTOUT PROVISION FOR 36" COOKTOP CONDITION... see spec's	
Line 58167	Note:	
17Mar20 / 17Mar20		

ELECTRICAL

Inv.4565	1 - To supply & install WIRING - OVEN - ELECTRICAL WIRING FOR BUILT-IN OVEN... see spec's attached.	
Line 58148	Note:	
17Mar20 / 17Mar20		
Inv.4565	1 - To supply & install a Receptacle to the upper hallway.... see sketch # 2	
Line 58150	Note:	
17Mar20 / 17Mar20		
Inv.4565	1 - To supply & install a 36" Basic stainless hood fan in the kitchen in lieu of the standard 30" stainless steel hood fan.	
Line 58146	Note:	
17Mar20 / 17Mar20		
Inv.4565	1 - To supply & install the standard T.V. rough in in the Great room and Master bedroom.... see sketch # 1 & # 2	
Line 58158	Note:	
17Mar20 / 17Mar20		



CONSTRUCTION SUMMARY

KINGSMEN (THAMES) INC. / Havelock Corners (Kingsmen)

Lot/Unit: 71 Phase/Building: 4A Model/Floor Plan: John (4201) Elev B 4 Bed - 2+1 Bath

Inv.4565	1 - To supply & install the standard Phone rough in in the Great room, Master bedroom and Bedroom 2...See sketch # 1 & # 2	
Line 58159	Note:	
17Mar20 / 17Mar20		
Inv.4565	1 - To supply & install a receptacle at approx. 66 + - up from the floor centered + - to the F/P mantle see sketch # 1	
Line 58160	Note: This is for a future wall mount T.V.	
17Mar20 / 17Mar20		
Inv.4565	1 - To supply & install a conduit pipe at approx. 66 " +- up from the floor centered + - to the F/P mantle and terminated next to the std. T.V. rough in in the Great room	
Line 58161	Note: This is for a future wall mount T.V.	
17Mar20 / 17Mar20		
Inv.4565	1 - To supply & install a CAPPED CEILING LIGHT ROUGH-IN ONLY ON SEPARATE SINGLE SWITCH over the breakfast bar area...see sketch # 1	
Line 58130	Note:	
17Mar20 / 17Mar20		

Heating And Air Conditioning

Inv.4565	1 - To supply & install the HUMIDIFIER on the furnace...	
Line 58126	Note:	
17Mar20 / 17Mar20		
Inv.4565	1 - As per schedule "PE": Vendor to install capped gas line (rough in only) at rear of home for future BBQ location. Location to be finalized at vendors sole discretion.	
Line 58123	Note:	
17Mar20 / 17Mar20		
Inv.4565	1 - As per schedule "PE": Vendor to supply & install air conditioning unit, sized accordingly, from vendors standard samples.	
Line 58124	Note:	
17Mar20 / 17Mar20		
Inv.4565	1 - To supply & install a gas rough in and an electrical outlet on a sep. circuit for the future 36" cook top... see spec's attached	
Line 58147	Note:	
17Mar20 / 17Mar20		

PLUMBING

Inv.4565	1 - To supply & install a WATERLINE ROUGH-IN TO THE FRIDGE LOCATION (NO HOOK UP)...	
Line 58127	Note:	
17Mar20 / 17Mar20		



CONSTRUCTION SUMMARY

KINGSMEN (THAMES) INC. / Havelock Corners (Kingsmen)

Lot/Unit: 71 Phase/Building: 4A Model/Floor Plan: John (4201) Elev B 4 Bed - 2+1 Bath

EXTRAS AS PER OFFER

VENDOR TO INSTALL CAPPED GAS LINE (ROUGH-IN ONLY) AT REAR OF HOME FOR FUTURE BBQ LOCATION. LOCATION TO BE FINALIZED AT VENDORS SOLE DISCRETION. <i>Worksheet</i> Note:	
VENDOR TO SUPPLY & INSTALL AIR CONDITIONING UNIT, SIZED ACCORDINGLY, FROM VENDORS STANDARD SAMPLES. <i>Worksheet</i> Note:	

SCHEDULE "B-1"

Floor Plan

Model: John (4201) Elev B 4 Bed - 2+1 Bath
Standard

Lot 71

Phase 4A

Sketch #1

termination
of
conduit pipe

electrical outlet &
conduit pipe @ approx.
66" ± up from floor

Deluxe
closet

Capped
Electrical

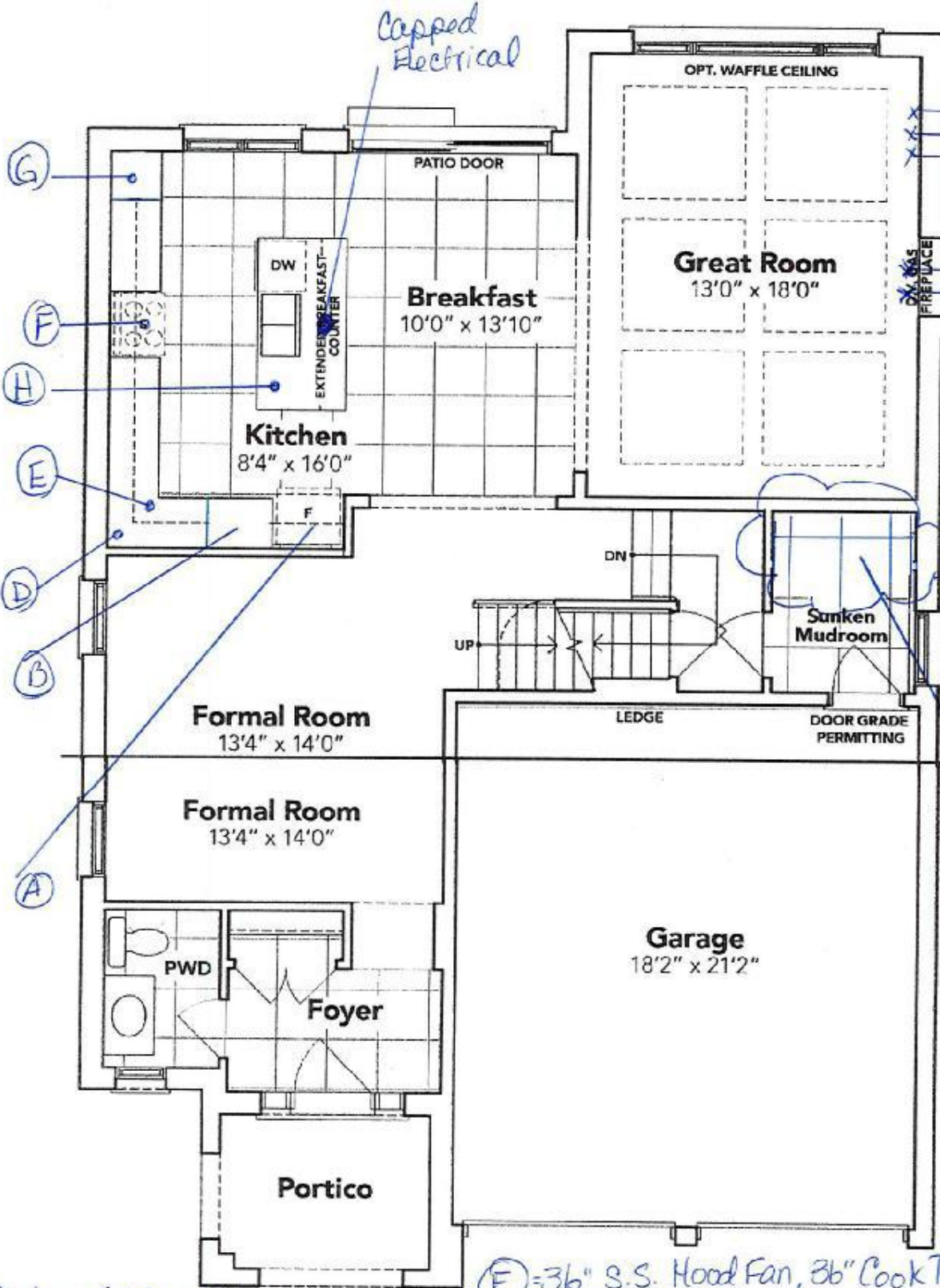

- (A) - deep fridge uppers
- (B) - Built in Micro/Wall Oven
- (D) - Upper Angled Corner
- (E) - Base Pie Cut Corner

(F) - 36" S.S. Hood Fan, 36" Cook Top w/
Pots & Pans

(G) - Pantry

(H) - Garbage Pull Out

PART. GROUND FLOOR EL. B

Harwin & Margherita
Blanchard

The floor plans and elevations shown are pre-construction plans and may be revised or improved as necessitated by architectural controls and the construction process. The measurements adhere to the rules and regulations of the TARION Warranty Corporation's official method for the calculation of floor area. Materials, specifications and floor plans are subject to change without notice. All house renderings are artist's concept only. Actual usable floor space may vary from the stated floor area. All options shown are upgrades. E. & O. E.

(H.S.)

(M.P.)

SCHEDULE "B-1"

Floor Plan

LOT #1
Phase 4A
Model: John (4201) Elev B 4 Bed - 2+1 Bath
Standard

Sketch #2

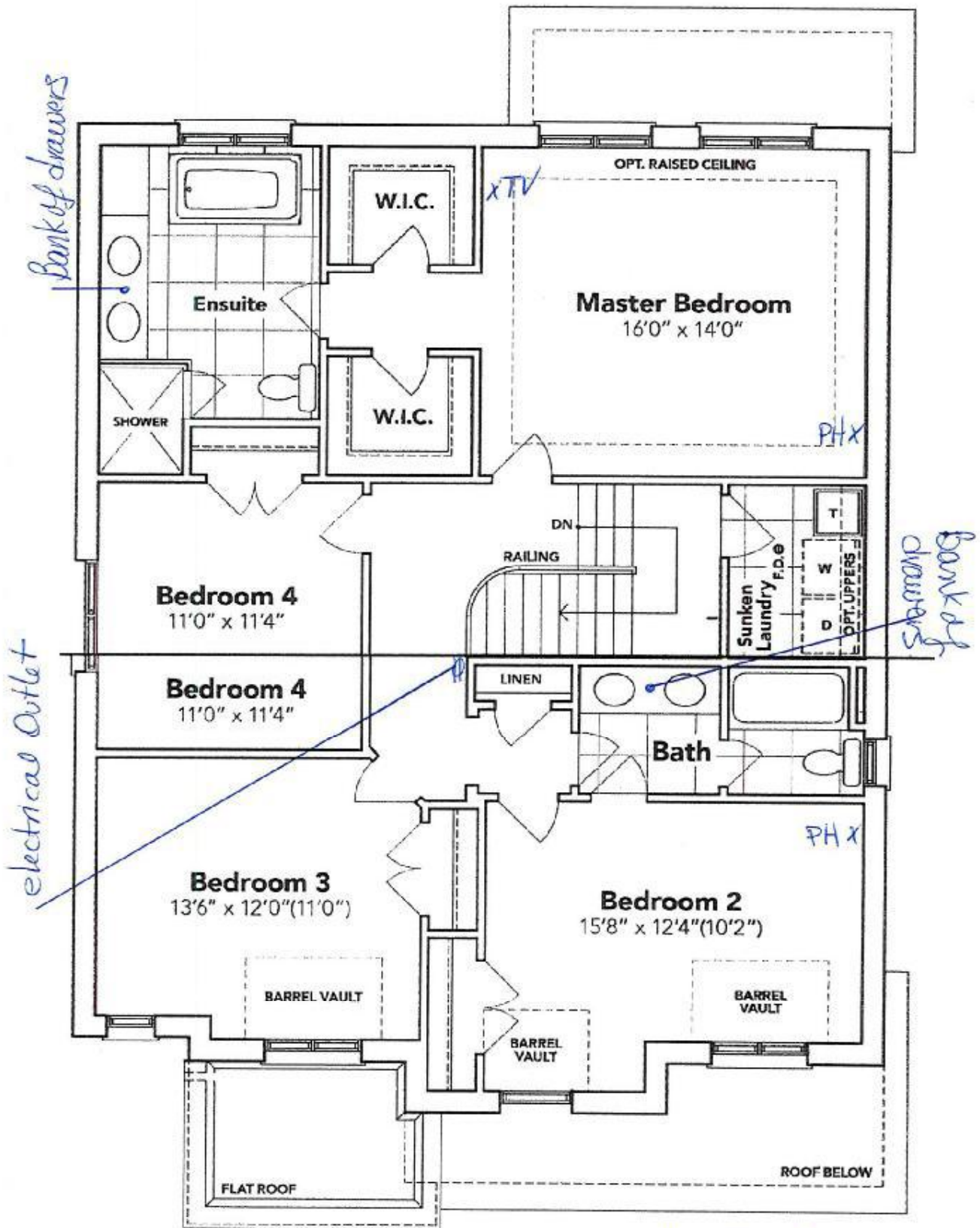

PART. SECOND FLOOR EL. B

The floor plans and elevations shown are pre-construction plans and may be revised or improved as necessitated by architectural controls and the construction process. The measurements adhere to the rules and regulations of the TARIION Warranty Corporation's official method for the calculation of floor area. Materials, specifications and floor plans are subject to change without notice. All house renderings are artist's concept only. Actual usable floor space may vary from the stated floor area. All options shown are upgrades. E. & O. E.

SCHEDULE "B-1" - Page 3 of 3

Lot: 71 Hawelock Corners PH. 4A
Re: 36" Gas Cooktop SPEC'S

4A-
for 71

x Harwinder Marahar.

x Danielhu

NA36N7755TS

36" Gas Cooktop

SAMSUNG



Signature Features

22K True Dual-Power Burner

- Two independent heating burners offer intense heat and precise control to quickly boil water or temper chocolate.

Analog Controls with Digital Wi-Fi and Bluetooth® Technology

- The ultimate combination of analog comfort and digital technology delivers exceptional cooking performance.

Cast Iron Griddle

- Cook breakfast, grill sandwiches, or sauté vegetables on the removable griddle.

Available Colors



Stainless Steel (shown)



Fingerprint Resistant
Black Stainless Steel



22K True Dual-Power Burner

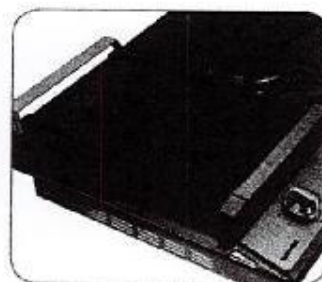

Cast Iron Griddle

Features

- Bluetooth® Connected to Hood
- Blue LED Lights
- Wi-Fi Connectivity
- Powerful Cooktop
 - Right Front: 13K BTU
 - Left Front: 9.5K BTU
 - Right Rear: 5K BTU
 - Left Rear: 9.5K BTU
 - Center: True Dual, 22K BTU (Brass)

- Cast Iron 3-Piece Grates
- Sealed Burners
- Burner On/Off Monitoring
- ADA Compliant

Convenience

- Wok Grate
- LP Conversion Kit



ADA Compliant

Lot: 71 Havelock Corners PH: 4A
 Re: 36" Gas Cooktop SPEC'S CON.T

4A -
 4/7/1

o Harinder Moukhar

x Amaneh

NA36N7755TS

SAMSUNG

36" Gas Cooktop

Installation Requirements

Countertop cut-out and minimum clearance dimensions:

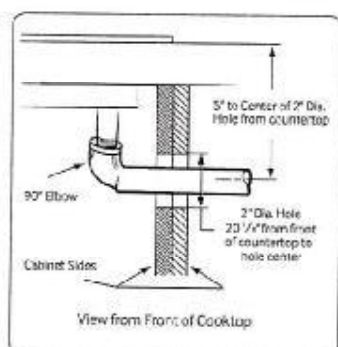
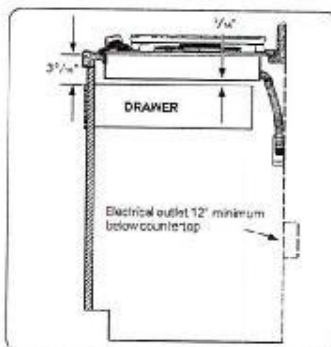
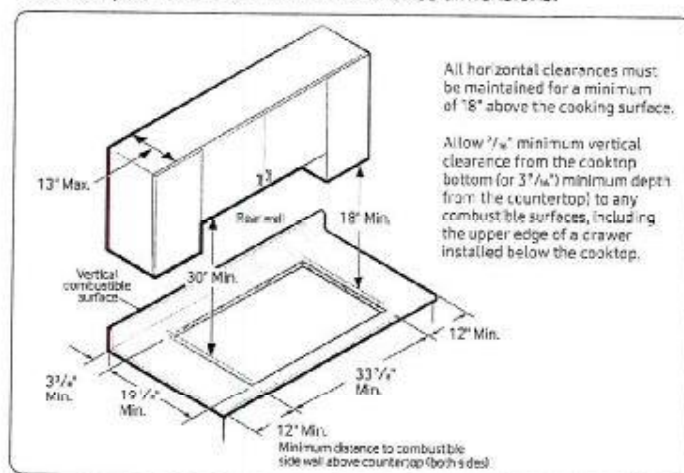

Total Power (BTU)

59K

Power Source

120V / 60 Hz / 1A

Gas Cooktop (BTU)

- Right Front: 13K
- Left Front: 9.5K
- Right Rear: 5K Simmer
- Left Rear: 9.5K
- Center: 22K (True Dual)

Warranty

One (1) Year All Parts and Labor

Product Dimensions & Weight (WxHxD)

Outside (Max) Cooktop Dimensions:

36" x 54 1/2" x 22 1/3"

Cooktop Cut-Out Dimensions:

33 7/8" x 31 1/8" x 19 1/8"

Weight: 87.7 lbs. (88.4 lbs. Fingerprint Resistant Black Stainless Steel)

Shipping Dimensions & Weight (WxHxD)

Dimensions: 40 9/16" x 10 5/8" x 25 5/8"

Weight: 95.9 lbs. (97.2 lbs. Fingerprint Resistant Black Stainless Steel)

Color

Stainless Steel

Model

NA36N7755TS

UPC Code

887276281766

Fingerprint Resistant

Black Stainless Steel

NA36N7755TG

887276281759

Installing Over a Single Oven

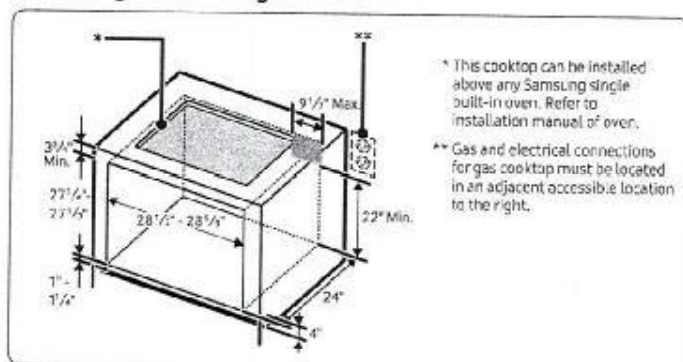

Cooktop Dimensions

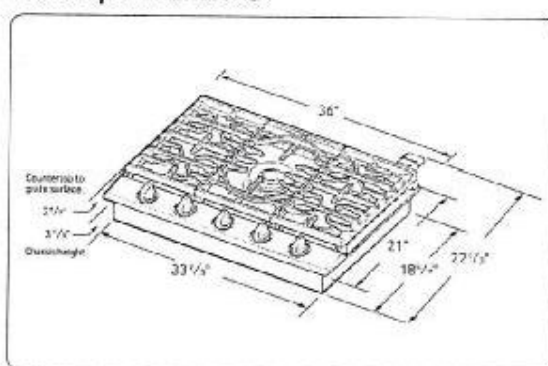

LOT: 71 Havelock Corners PH. 4A
Re: Builtin Micro/Oven Specs

x Hawinder Maister

x Afzal Huss

4A -
for 71

NQ70M7770DS

30" Microwave Combination Wall Oven

SAMSUNG



Signature Features

Steam Cook (Oven)

- Delivers moisture at precise times for a crisp, browned outside and tender inside.

Speed Cook (Microwave)

- Cook food faster and more evenly by using power convection.

Flex Duo™ (Oven)

- Cook two dishes at different temperatures simultaneously with the Smart Divider.

Available Colors



Stainless Steel (shown)



Black Stainless Steel

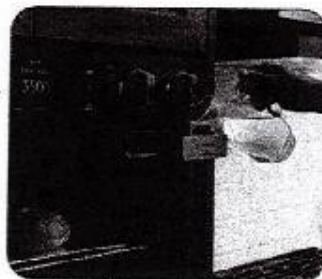

Steam Cook



Flex Duo™

Features

- Digital-Analog Controls
- 1.9/5.1 cu. ft. Capacity
- Hybrid Clean and Self-Clean (Oven)
- Gourmet Cook (Oven)
- Dual Convection (Oven)
- Wi-Fi Connectivity
- Wi-Fi Enabled Temperature Probe (Oven)
- LED Spotlights (Oven)
- Easy View Window
- 3 Heavy-Duty Racks including a Gliding Rack (Oven)
- Soft-Close Door (Oven)

- Ceramic Plate (Microwave)
- Rapid Preheat (Oven)
- Auto Latch Microwave Door
- 6 Oven Modes including Steam Bake and Steam Roast
- Blue LED Illuminated Knobs
- Broil Element
- Smart Control Key (Oven)
- 6 Rack Positions (Oven)
- Drop-Down Door Design
- LCD Display

Convenience

- Hidden Heating Element (Oven)
- Sabbath Mode (Oven)
- Delay Start (Oven)
- Proofing (Oven)
- Warming Mode (Oven)
- Kitchen Timer
- Child Safety Lock
- Convection Conversion

Lot: 71 Hawelock Corners Ph: 4A
Re: Built in Micro / Oven Specs Cont

4A -
Lot 71

x Hawelock Corners
x Offsite

NQ70M7770DS

30" Microwave Combination Wall Oven

SAMSUNG

Cabinet Dimensions

Combination Oven Installed in Cabinet

* Junction Box

** Allow a minimum of 22" for clearance to adjacent corners, drawers, walls, etc. when door is open.

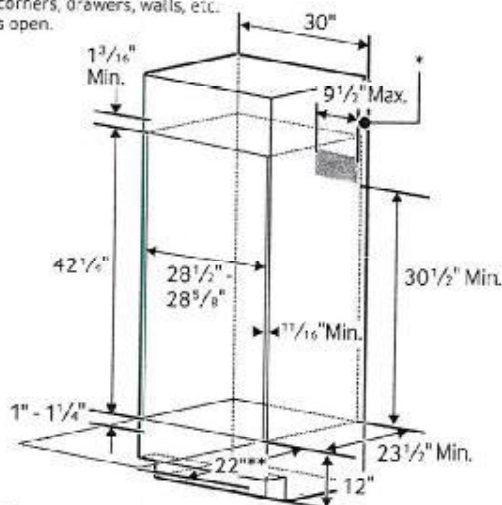

Product Dimensions

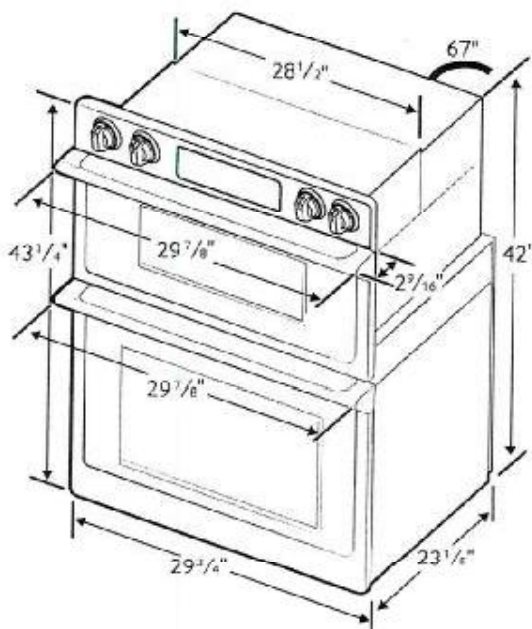

Total Capacity: 1.9/5.1 cu. ft.

- Microwave: 1.9 cu. ft.
- Wall Oven: 5.1 cu. ft. total, 2.8/2.2 cu. ft.
- Hidden Bake Element
- Bake: 175°F–550°F
- Convection Bake: 175°F–550°F
- Convection Roast: 175°F–550°F
- Broil: Low-High
- Steam Bake: 230°F–550°F
- Steam Roast: 230°F–550°F
- Proofing
- Sabbath Mode

Warranty

One (1) Year All Parts and Labor
Ten (10) Years Parts Warranty for Magnetron

Product Dimensions & Weight (WxHxD)

Outside (Max) Combination Oven Dimensions:
29 7/8" x 43 1/4" x 25 11/16"

Combination Oven Cut-Out Dimensions:
28 1/2" x 42 1/4" x 23 1/2"

Weight: 262.4 lbs.

Shipping Dimensions & Weight (WxHxD)

Dimensions:
33 5/8" x 48 3/16" x 29 51/64"

Weight: 291.1 lbs.

Color

Stainless Steel
Black Stainless Steel

Model

NQ70M7770DS
NQ70M7770DG

UPC Code

887276195186
887276195162

RATING	
240V	9.5 kW
208V	7.2 kW
BREAKER SIZE	
240V	40 Amps
208V	40 Amps

Lot: 71 Havelock Corners PH 4A
Re: Fridge Spec's

4A -
Lot 71

✓ Harwinckle MacKenzie

✗ [Signature]

RF22M9581SR

SAMSUNG

Samsung Counter-Depth, 4-Door Flex™ with Family Hub™

22 cu. ft. Capacity



Signature Features

Food

- Use your voice to add items to your shopping lists.
- See inside from anywhere with 3 built-in cameras.

Family

- Sync calendars for all family activities and events.
- Remotely share photos, notes and memos.

Fun

- Stream music, mirror your Samsung TV or Samsung phone directly on your Family Hub™ screen.

Connect

- Simplify your life through the SmartThings app by controlling smart devices and appliances: set lights, adjust the thermostat or monitor your baby's room.

Available Colors



Stainless Steel (shown)



Black Stainless Steel

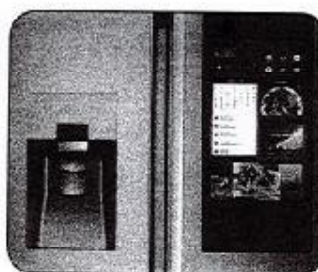

Family Hub™

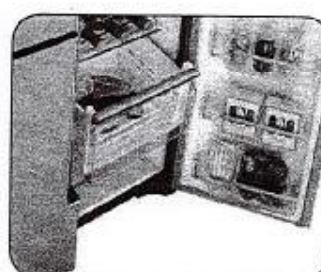

FlexZone™

Features

- Profile Base Communication Apps
- S-Voice – Integrated Voice-Activated Features
- One Family Hub™ Experience Integrated Mobile App
- FlexZone™
- Triple and Metal Cooling
- Large Capacity – 22 cu. ft.
- External Filtered Water and Ice Dispenser
- Ice Master Ice Maker in the Refrigerator
- High-Efficiency LED Lighting
- Wine Rack
- Fingerprint-Proof Coating
- ENERGY STAR® Compliant
- EZ Slide-Out Shelves in Freezer and FlexZone™
- Counter-Depth

Convenience

- Tempered Glass Spill-Proof Shelves
- Gallon Door Bins
- Flip-Up Shelf
- Door Alarm
- Water Filter Indicator

Rating



ENERGY STAR®-rated:
709 kWh/yr

Lot: 71 Havelock Corners PH. 4A
Re: FRIDGE SPEC'S CONT

4A -
Sat 7/1

X Harwindey Mawher.
X D. Mawher

RF22M9581SR

SAMSUNG

Samsung Counter-Depth, 4-Door Flex™ with Family Hub™

22 cu. ft. Capacity

Installation Specifications

1. Measure the height, width and depth of the opening, making sure to include baseboards, molding, tile, countertop overhang, etc. Check to be sure there is enough room to open the door (consider walls, islands or other obstacles when measuring).
2. Refer to illustration below to determine dimensions.
3. Allow 2.5" of clearance on hinge side of refrigerator when installing next to a wall where handle may make contact.
4. Allow 1" minimum clearance at rear for proper air circulation and water/electrical connections. Allow a 3/8" minimum clearance at sides and top for ease of installation.
5. Ensure each door and entryway in the home is wide enough for the refrigerator to be moved through easily.

For optimal usage and to be able to open refrigerator doors completely, do not install next to a wall.

Please note: The following dimension and cutout information is for planning purposes only. For complete installation details, consult manual packed with product, or download manual online at samsung.com.

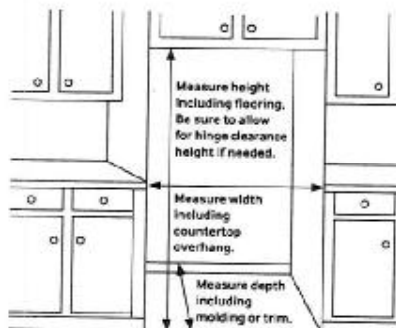

Dimensions

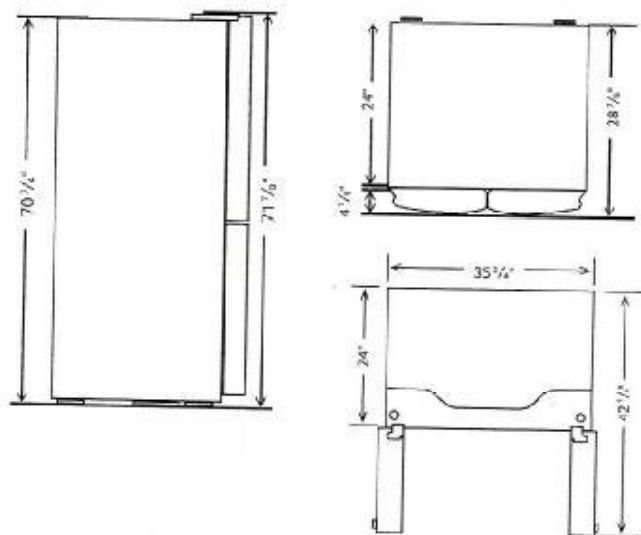

Total Capacity: 22 cu. ft.

Refrigerator: 13.2 cu. ft.

- Premium External Filtered Water and Ice Dispenser (Crushed or Cubed Ice)
- Ice Master Ice Maker
- 2 Humidity-Controlled Crispers
- Gallon Door Bins
- 5 Tempered Glass Spill-Proof Shelves
 - 1 Slide-In
 - 1 Flip-Up
 - 3 Fixed
- Wine Rack
- High-Efficiency LED Lighting

FlexZone™: 4.4 cu. ft.

- 1 EZ Slide-Out Shelf
- 2 Drawers
- 5 Temperature Zones:
 - 41°F
 - 35°F
 - 30°F
 - 23°F
 - -8°F – 5°F
- High-Efficiency LED Lighting

Freezer: 4.4 cu. ft.

- 1 EZ Slide-Out Shelf
- 2 Freezer Drawers
- High-Efficiency LED Lighting

Warranty

One (1) Year Parts and Labor on Refrigerator
Five (5) Years Parts and Labor on Sealed Refrigeration System Only*
Ten (10) Years Parts and Five (5) Years Labor on Digital Inverter Compressor

*Compressor, evaporator, condenser, drier and connecting tubing.

Product Dimensions & Weight

Dimensions (WxHxD with hinges, handles and doors):
35³/₄" x 71⁷/₈" x 28⁷/₈"

Dimensions (WxHxD without hinges and door):
35³/₄" x 70³/₄" x 24"

Dimensions (WxHxD with hinge and door, no handle):
35³/₄" x 71⁷/₈" x 28⁷/₈"

Weight: 350.5 lbs.

Shipping Dimensions & Weight (WxHxD)

Dimensions: 38⁵/₁₆" x 78" x 31⁵/₁₆"

Weight: 374.7 lbs.

Color	Model #	UPC Code
Stainless Steel	RF22M9581SR	887276197999
Black Stainless Steel	RF22M9581SG	887276197982

Actual color may vary. Design specifications, and color availability are subject to change without notice. Non-metric weights and measurements are approximate.

©2016 Samsung Electronics America, Inc. 85 Challenger Road, Ridgefield Park, NJ 07660. Tel: 800-SAMSUNG, samsung.com. Samsung is a registered trademark of Samsung Electronics Co., Ltd.