

KINGSMEN (THAMES) INC. / Havelock Corners (Kingsmen)

Lot/Unit: 91 Phase/Building: 4A Model/Floor Plan: James (3601) Elev A 4 Bed - 2+1 Bath

.Base Cabinets

Inv. 4545 Line 57834 14Feb20 / 28Feb20	1 - To supply & install a base pie cut corner in the kitchen using the standard product line.... see sketch # 3 Note:	
Inv. 4545 Line 57835 14Feb20 / 28Feb20	2 - To supply & install an additional TWO pull out drawers in the kitchen ...see sketch # 3 Note:	

.Miscellaneous

Inv. 4545 Line 57833 14Feb20 / 28Feb20	1 - To supply & install an angled corner cabinet with matching interior and a clear plain glass door using the standard product line in the kitchen.....see sketch # 3 Note:	
Inv. 4545 Line 57923 14Feb20 / 28Feb20	1 - As per SCHEDULE PE: Vendor to install capped gas line (rough in only) at rear of home for future BBQ location. Location to be finalized at vendors sole discretion. Note:	
Inv. 4545 Line 57924 14Feb20 / 28Feb20	1 - As per SCHEDULE PE: Vendor to install a gas line (rough in only) to kitchen in at stove location (as per plan) To include 110V code requirement. Note:	
Inv. 4545 Line 57925 14Feb20 / 28Feb20	1 - As per SCHEDULE PE: Vendor to supply & install air conditioning unit, sized accordingly, from vendors standard samples. Note:	
Inv. 4545 Line 57926 14Feb20 / 28Feb20	1 - As per SCHEDULE PE: Vendor to inclue level 1, 20 cm granite or quarz ina ll bathrooms, and kitchens as per plan, in lieu of the included laminate counter tops. Selections to be made from builders samples. Note:	
Inv. 4545 Line 57927 14Feb20 / 28Feb20	1 - As per SCHEDULE PE: Vendor to include engineered hardwood flooring throughout the second floor in lieu of included carpet, as per plan, and selections as outlined in schedule A for included engineered hardwood on the main floor. This has no cash value. Note:	
Inv. 4545 Line 57788 14Feb20 / 28Feb20	1 - Relocate the std. Ceiling light in the kitchen over to the kitchen island area....see sketch #1 Note:	
Inv. 4545 Line 57778 14Feb20 / 28Feb20	1 - To supply & install the Optional RAISED ceiling in the Master Bedroom.....see sketch #2 Note:	
Inv. 4545 Line 57811 14Feb20 / 28Feb20	1 - To supply & install a conduit pipe at approx. 66" + - up from the floor , centered to the F/P mantle in the great room and dropped down to the unfinished basement area... see sketch #1 Note:	

KINGSMEN (THAMES) INC. / Havelock Corners (Kingsmen)

Lot/Unit: 91 Phase/Building: 4A Model/Floor Plan: James (3601) Elev A 4 Bed - 2+1 Bath

Inv.4545	1 - Do not supply or install any towel bars, toilet paper holders or soap dishes throughout all bathrooms.	
Line 57823	Note:	
14Feb20 / 28Feb20		
Inv.4545	1 - To supply & install a HUMMIDIFIER to the furance	
Line 57824	Note:	
14Feb20 / 28Feb20		

.Vanity Cabinets

Inv.4545	2 - To supply & install TWO bottom drawers to existing Main Bathroom VANITY using the standard cabinetry line.... see sketch # 4	
Line 57819	Note:	
14Feb20 / 28Feb20		
Inv.4545	2 - To supply & install TWO bottom drawers to existing Master ensuite Bathroom VANITY using the standard cabinetry line see sketch # 4	
Line 57820	Note:	
14Feb20 / 28Feb20		

Cabinetry

Inv.4545	1 - To supply & install one deep gable with deep fridge uppers in the kitchen using the std. cabinetry line.... see sketch # 3	
Line 57829	Note: See fridge spec's attached.	
14Feb20 / 28Feb20		
Inv.4545	1 - To supply & install full height 24" + - deep two door wide pantry in the kitchen in lieu of the std. upper and lower base cabinets in the standard product line....see sketch # 3	
Line 57830	Note:	
14Feb20 / 28Feb20		
Inv.4545	1 - To supply & install an angled full height open corner shelf approx. 24 " + - deep in the standard product line in the kitchen....see sketch # 3	
Line 57831	Note:	
14Feb20 / 28Feb20		
Inv.4545	4 - To supply & install FOUR pull out double drawers to the inside of the upgraded pantry (starting from the bottom up) in the kitchen....see sketch #3	
Line 57832	Note:	
14Feb20 / 28Feb20		

CABINETRY VANITY

Inv.4545	1 - To supply & install a VANITY BANK OF DRAWERS - 55 CM MAXIMUM -in the std line if cabinetry in the main bathroom... see sketch # 4	
Line 57821	Note:	
14Feb20 / 28Feb20		
Inv.4545	1 - To supply & install a VANITY BANK OF DRAWERS - 55 CM MAXIMUM in the standard line of cabinetry in the master ensuite bathroom... see sketch #4	
Line 57822	Note:	
14Feb20 / 28Feb20		

KINGSMEN (THAMES) INC. / Havelock Corners (Kingsmen)

Lot/Unit: 91 Phase/Building: 4A Model/Floor Plan: James (3601) Elev A 4 Bed - 2+1 Bath

Inv. 4545 Line 57817 14Feb20 / 28Feb20	1 - To supply & install - INCREASE VANITY HEIGHT TO KITCHEN HEIGHT (90 CM) - DEPTH TO REMAIN THE SAME for the MASTER ENSUITE BATHROOM Note: 	
Inv. 4545 Line 57818 14Feb20 / 28Feb20	1 - To supply & install- INCREASE VANITY HEIGHT TO KITCHEN HEIGHT (90 CM) - DEPTH TO REMAIN THE SAME - for the POWDER ROOM bathroom. Note: 	

ELECTRICAL

Inv. 4545 Line 57789 14Feb20 / 28Feb20	5 - To supply & install FIVE POT LIGHTS FIRST FLOOR - LED in the kitchen area see sketch # 1 Note: These FIVE pot lights will be connected to a sep. switch, switch is sold sep. NOTE:: STANDARD KITCHEN CEILING LIGHT HAS BEEN RELOCATED, SEE SEP. EXTRA	
Inv. 4545 Line 57790 14Feb20 / 28Feb20	1 - To supply & install a s sep. SWITCH - ADDITIONAL INTERIOR SINGLE POLE SWITCH connected to the upgraded FIVE pot lights in the kitchen. Note: 	
Inv. 4545 Line 57793 14Feb20 / 28Feb20	4 - To supply & install FOUR POT LIGHTS FIRST FLOOR - LED in the BREAKFAST AREA... see sketch # 1 Note: These four pot lights will be connected to sep. switch, switch is sold sep. 	
Inv. 4545 Line 57794 14Feb20 / 28Feb20	1 - To supply & install a SWITCH - DIMMER SWITCH DECORA LOW VOLTAGE (500W) for the FOUR pot lights in the breakfast area. Note: 	
Inv. 4545 Line 57796 14Feb20 / 28Feb20	6 - To supply & install SIX POT LIGHTS FIRST FLOOR - LED in the GREAT ROOM area.... see sketch # 1 Note: These SIX pot lights will be connected to a sep. switch, switch is sold sep. 	
Inv. 4545 Line 57797 14Feb20 / 28Feb20	1 - To supply & install a SWITCH - DIMMER SWITCH DECORA LOW VOLTAGE (500W) connected to the SIX pot lights in the Great room. Note: 	
Inv. 4545 Line 57798 14Feb20 / 28Feb20	1 - Do not supply or install the std. ceiling light in the FOYER area, leave std. switch Note: 	
Inv. 4545 Line 57799 14Feb20 / 28Feb20	2 - To supply & install TWO POT LIGHTS FIRST FLOOR - LED in the foyer area... see sketch # 1 Note: These Two pot lights will be connected to the std. switch in the foyer area. 	
Inv. 4545 Line 57800 14Feb20 / 28Feb20	1 - Do not supply or install any ceiling lights to the Main floor hallway... leave std. switch(s) Note: 	

KINGSMEN (THAMES) INC. / Havelock Corners (Kingsmen)

Lot/Unit: 91 Phase/Building: 4A Model/Floor Plan: James (3601) Elev A 4 Bed - 2+1 Bath

Inv.4545	4 - To supply & install FOUR POT LIGHTS FIRST FLOOR - LED to the main floor hallway.... see sketch # 1	
Line 57801	Note: These four pot lights will be connected to the std. switch(s)	
14Feb20 / 28Feb20		
Inv.4545	1 - Relcoate the std. ceiling light from the UPPER STAIRCASE LANDING to the O.T.B. area and have this relocated light Reinforced... see sketch # 2	
Line 57804	Note: Fee charged is for the Reinforcement and relocation	
14Feb20 / 28Feb20		
Inv.4545	1 - To supply & install a RECEPTACLE - ADDITIONAL INTERIOR RECEPTACLE (NOT SEPARATE CIRCUIT) to the main floor hallway.... see sketch # 1	
Line 57806	Note:	
14Feb20 / 28Feb20		
Inv.4545	1 - To supply & install a RECEPTACLE - ADDITIONAL INTERIOR RECEPTACLE (NOT SEPARATE CIRCUIT) to the upper hallway ... see sketch # 2	
Line 57807	Note:	
14Feb20 / 28Feb20		
Inv.4545	1 - To supply & install the Standard T.V. rough in's, one in the Great room and one in the Master bedroom....see sketch # 1 & # 2	
Line 57808	Note:	
14Feb20 / 28Feb20		
Inv.4545	1 - To supply & install the std. Phone rough in's, one in the Kitchen, one in the Master bedroom and one in Bedroom #4... see sketch #1 & #2	
Line 57809	Note:	
14Feb20 / 28Feb20		
Inv.4545	1 - To supply & install a RECEPTACLE - ADDITIONAL INTERIOR RECEPTACLE (NOT SEPARATE CIRCUIT) at approx. 66" + - up from the floor centered + - to the F/P mantle in the Great room... see sketch # 1	
Line 57810	Note:	
14Feb20 / 28Feb20		
Inv.4545	1 - To supply & install an additional conduit pipe next to the std. T.V rough in in the NICHE area and have it dropped down to the unfinished basement ... see sketch # 1	
Line 57989	Note:	
14Feb20 / 28Feb20		

Fireplace

Inv.4545	1 - To supply & install the F/P package: to include the Fan for the F/P in the great room along with the on/off remote	
Line 57969	Note:	
14Feb20 / 28Feb20		
Inv.4545	1 - SURROUND - STANDARD FIREPLACE - MARBLE (5 INCH WIDE)	
Line 57812	Note: Colour selection will be done at the time of interior finishing appointment.	
14Feb20 / 28Feb20		
Inv.4545	1 - HEARTH - 1 SIDED - MARBLE	
Line 57813	Note: Colour selection will be done at the time of interior finishing appointment.	
14Feb20 / 28Feb20		

Heating And Air Conditioning



CONSTRUCTION SUMMARY

KINGSMEN (THAMES) INC. / Havelock Corners (Kingsmen)

Lot/Unit: 91 Phase/Building: 4A Model/Floor Plan: James (3601) Elev A 4 Bed - 2+1 Bath

Inv.4545	1 - See attached for gas stove spec's; Gas line was part of Schedule PE	
Line 57785	Note:	
14Feb20 / 28Feb20		

PLUMBING

Inv.4545	1 - To supply & install rough in for future WATERLINE ROUGH-IN TO THE FRIDGE LOCATION (NO HOOK UP)	
Line 57782	Note:	
14Feb20 / 28Feb20		

Inv.4545	1 - To supply & install the WHIRLPOOL OPTION FROM OVAL TUB - 6 JETS - 60 X 42 ONLY in lieu of the std. soaker tub in the master ensuite.	
Line 57911	Note:	
14Feb20 / 28Feb20		

Inv.4545	1 - To supply & install a WATERLINE ROUGH-IN to the laudry room (NO HOOK UP) for a future dryer... see spec's	
Line 57966	Note:	
14Feb20 / 28Feb20		

Trim

Inv.4545	1 - To suppy & install the OPT. door in the MAIN bathroom... see sketch # 2	
Line 57780	Note:	
14Feb20 / 28Feb20		

EXTRAS AS PER OFFER

Note:	
-------	--

SCHEDULE "B-1"
Floor Plan

SKETCH #1

Lot 91
Phase 4A
Model: James (3601) Elev A 4 Bed - 2+1 Bath
Standard

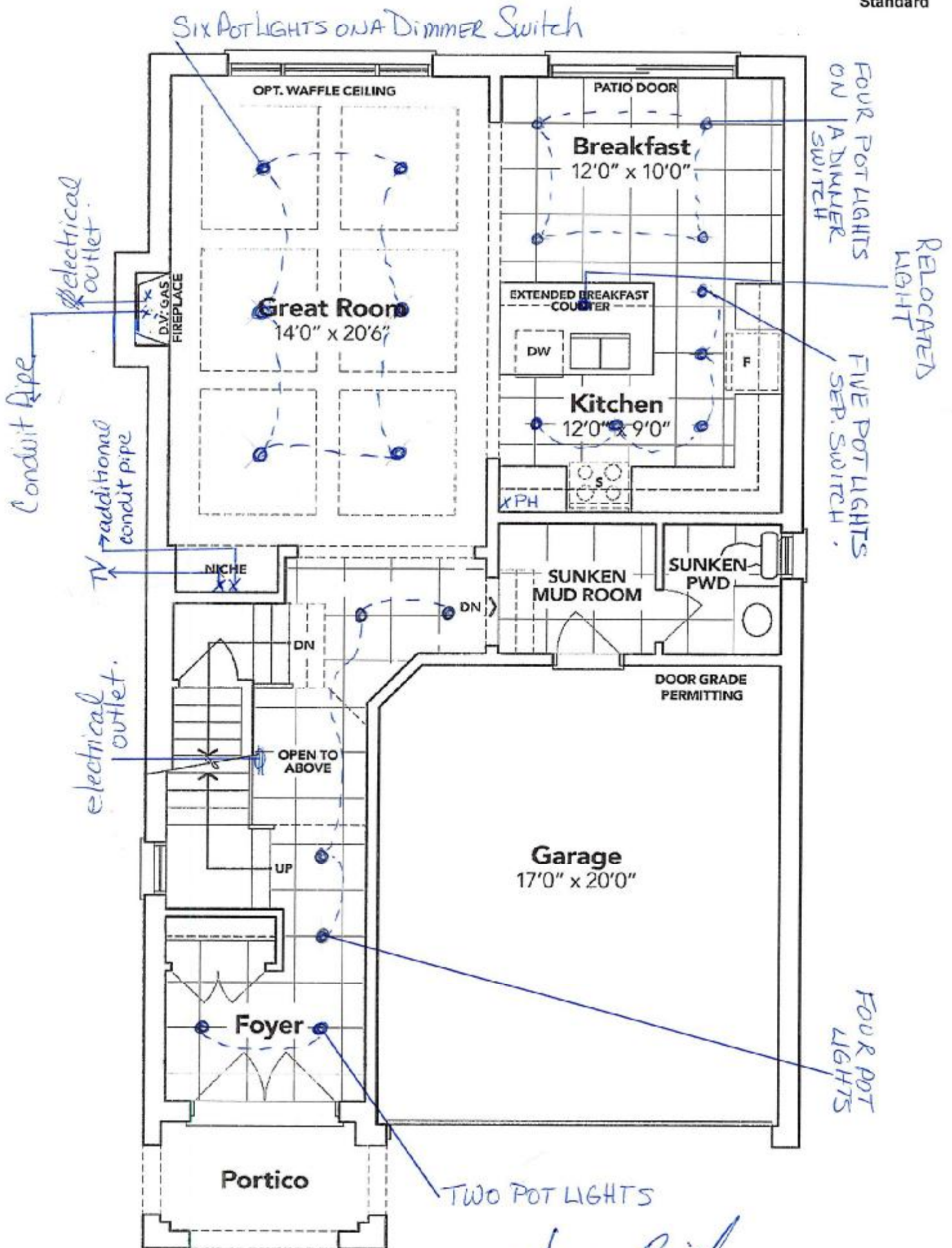

GROUND FLOOR EL. A

Reid
Architectural Reid

The floor plans and elevations shown are pre-construction plans and may be revised or improved as necessitated by architectural controls and the construction process. The measurements adhere to the rules and regulations of the TARIION Warranty Corporation's official method for the calculation of floor area. Materials, specifications and floor plans are subject to change without notice. All house renderings are artist's concept only. Actual usable floor space may vary from the stated floor area. All options shown are upgrades. E. & O. E.

SCHEDULE "B-1"
Floor Plan

SKETCH #2

Lot 91
Phase 4A

el: James (3601) Elev A 4 Bed - 2+1 Bath
Standard

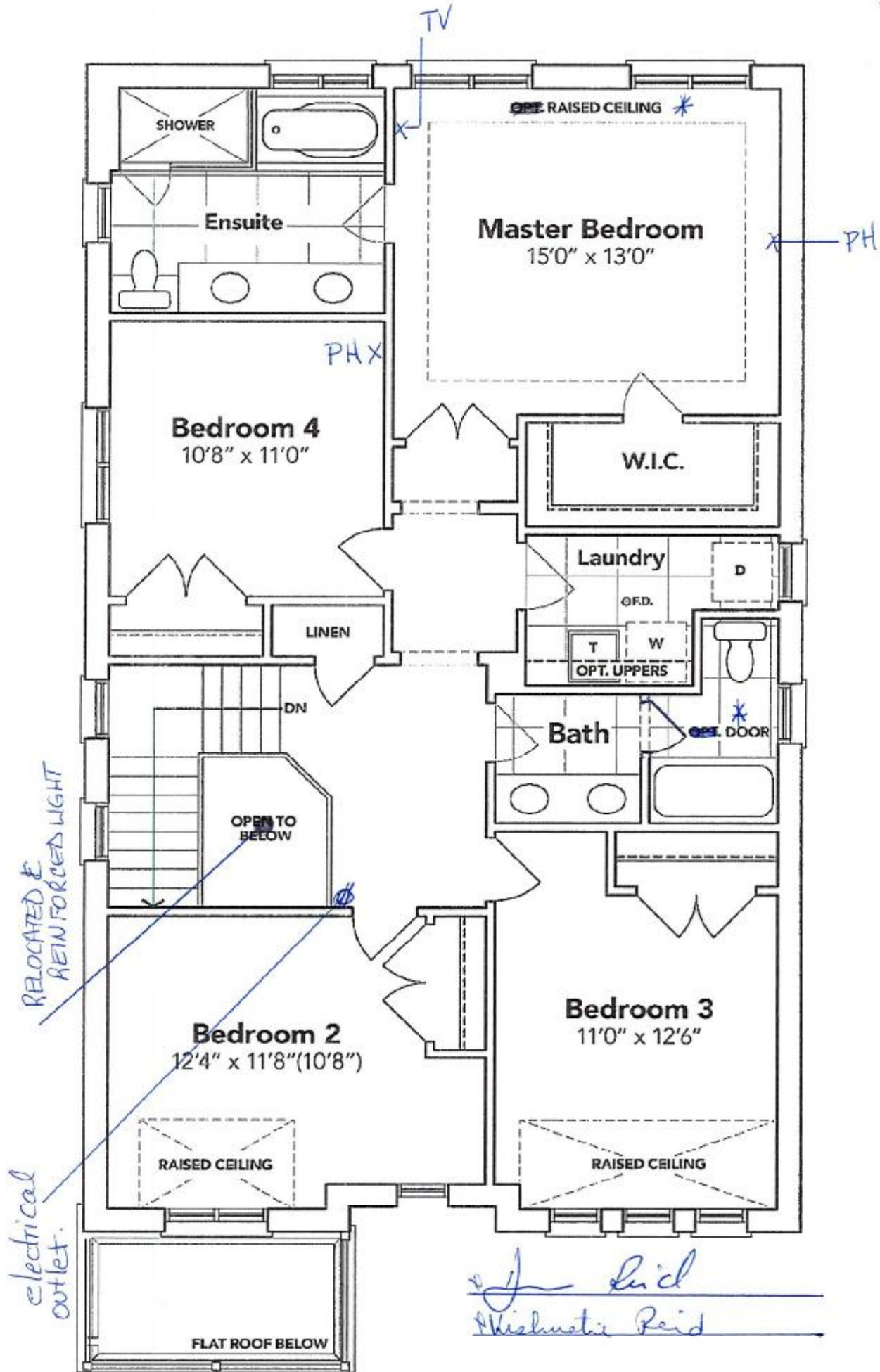

SECOND FLOOR EL. A

The floor plans and elevations shown are pre-construction plans and may be revised or improved as necessitated by architectural controls and the construction process. The measurements adhere to the rules and regulations of the TARIION Warranty Corporation's official method for the calculation of floor area. Materials, specifications and floor plans are subject to change without notice. All house renderings are artist's concept only. Actual usable floor space may vary from the stated floor area. All options shown are upgrades. E. & O. E.

Lot 91
Phase 4A
Bed: James (3601) Elev A 4 Bed - 2+1 Bath
Standard

The floor plan shows a house with the following rooms and features:

- Great Room:** 14'0" x 20'6", featuring an "OPT. WAFFLE CEILING" and a "D.V. GAS FIREPLACE".
- Breakfast:** 12'0" x 10'0", with a "PATIO DOOR".
- Kitchen:** 12'0" x 9'0", including an "EXTENDED BREAKFAST COUNTER", a "DW" (dishwasher), and a "S" (sink).
- Sunken Mud Room:** Adjacent to the kitchen.
- Sunken PWD:** (Pantry/Walk-in Cooler/Freezer).
- Garage:** 17'0" x 20'0", with a "DOOR GRADE PERMITTING".
- Foyer:** Located near the "Portico" entrance.
- Portico:** The front entrance area.
- Stairs:** Labeled "UP" and "DN" (down).
- Niche:** A small recessed area near the stairs.

Handwritten annotations in blue ink provide additional details:

- "open shelf / angled 24" ± deep." pointing to a shelf in the breakfast area.
- "Pantry w P/O/S" pointing to the sunken pantry area.
- "Deep Fridge upper w gable." pointing to the sunken PWD area.
- "Base Pic Cot Corner" pointing to a corner in the sunken PWD area.
- "upper angled corner, w glass & matching interior" pointing to a corner in the sunken PWD area.
- "2 pullout drawers" pointing to a corner in the sunken PWD area.

Signature: *Michael Reid*

SCHEDULE "B-1" - Page 3 of 3

Floor Plan

Lot 91
Phase 4A
el: James (3601) Elev A 4 Bed - 2+1 Bath
Standard

Sketch #4.

bank of drawers

Bottom drawer

Bottom
drawer

Bottom
- drawer

Bottom
drawer

Bank of drawers

*
= Master & Main
Bathroom Vanity
upgrade
(Not to Scale)

for Real
Plaswatie Real

SECOND FLOOR EL. A

The floor plans and elevations shown are pre-construction plans and may be revised or improved as necessitated by architectural controls and the construction process. The measurements adhere to the rules and regulations of the TARIION Warranty Corporation's official method for the calculation of floor area. Materials, specifications and floor plans are subject to change without notice. All house renderings are artist's concept only. Actual usable floor space may vary from the stated floor area. All options shown are upgrades. E. & O. E.

SCHEDULE "B-1" - Page 2 of 3

inMS_014.rpt 22Sep18

Initials: NA

Lot: 91 Havelock Corners
 PH. 4A
 RE: Fridge Specs (width & height only)

4A -
 Lot 91



Bottom Mount Refrigerator



PRODUCT MODEL NUMBERS

WRX735SDB

WRX735SDH

Electrical: A 115-volt, 60-Hz, AC-only, 15- or 20-amp fused, grounded electrical supply is required. It is recommended that a separate circuit serving only your refrigerator be provided. Use an outlet that cannot be turned off by a switch. Do not use an extension cord.

NOTE: Before performing any type of installation, cleaning, or removing a light bulb, turn the control (Thermostat, Refrigerator or Freezer Control depending on the model) to OFF and then disconnect the refrigerator from the electrical source. When you are finished, reconnect the refrigerator to the electrical source and reset the control (Thermostat, Refrigerator or Freezer Control depending on the model) to the desired setting. See "Using the Controls."

Water: A cold water supply with water pressure between 30 and 120 psi (207 and 827 kPa) is required to operate ice maker and water dispenser. If you have questions about your water pressure, call a licensed, qualified plumber.

IMPORTANT: The pressure of the water coming out of a reverse osmosis system going to the water inlet valve of the refrigerator needs to be between 30 and 120 psi (207 and 827 kPa).

Reverse Osmosis Water Supply: If a reverse osmosis water filtration system is connected to your cold water supply, the water pressure to the reverse osmosis system needs to be a minimum of 40 to 60 psi (276 to 414 kPa).

PRODUCT DIMENSIONS

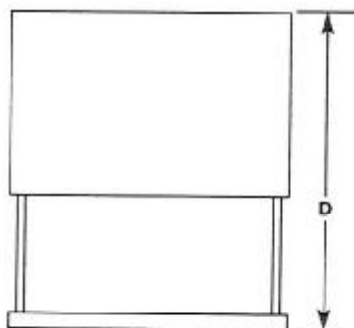
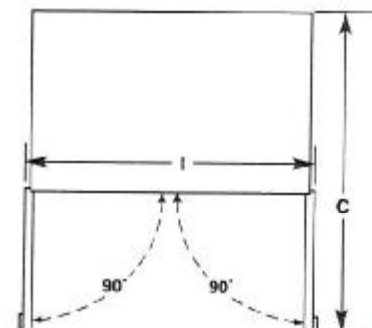
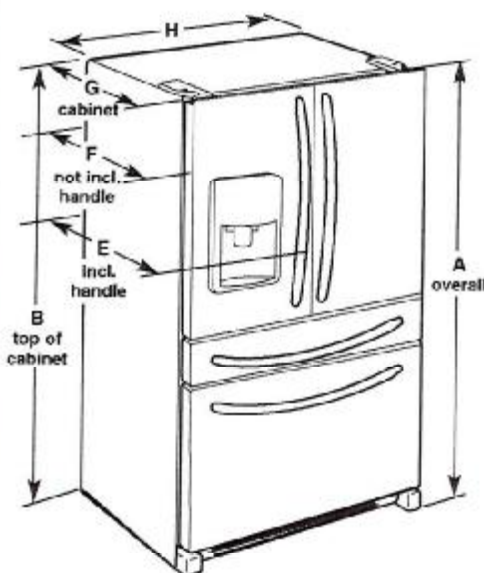

Model Number	Model Size	Height - Overall "A"	Height - Top of Cabinet "B"	Depth - Door Open 90° "C"	Depth - Drawer Open "D"	Depth - With Handles "E"	Depth - Without Handles "F"	Depth - Cabinet Only "G"	Width - Cabinet "H"	Width - Door Open 90° "I"
WRX 736SDB	24.7 cu. ft.	70 1/4" (178.1 cm)	68 1/4" (174.3 cm)	48" (121.9 cm)	52 3/4" (133.0 cm)	34 1/4" (88.3 cm)	32 1/4" (81.6 cm)	29" (73.6 cm)	35 1/4" (90.5 cm)	41" (104.1 cm)
WRX 735SDH	24.5 cu. ft.	70 1/4" (178.1 cm)	68 1/4" (174.3 cm)	48" (121.9 cm)	52 1/4" (133.0 cm)	34 1/8" (87.9 cm)	32 1/8" (81.6 cm)	29" (73.6 cm)	35 1/4" (90.5 cm)	41" (104.1 cm)

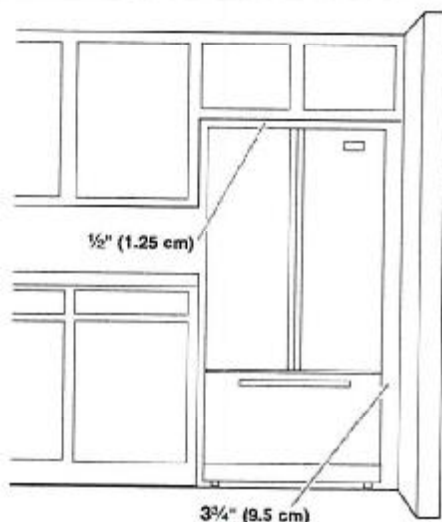

To ensure proper ventilation for your refrigerator, allow for a 1/2" (1.25 cm) space on each side and at the top. Allow for 1" (2.54 cm) of space behind the refrigerator. If your refrigerator has an ice maker, make sure you leave some extra space at the back for the water line connections.

If you are installing your refrigerator next to a fixed wall, leave 3 3/4" (9.5 cm) minimum on the hinge side (depending on your model) to allow for the door to swing open.

NOTE: It is recommended that you do not install the refrigerator near an oven, radiator, or other heat source, nor in a location where the temperature will fall below 55°F (13°C).

Because Whirlpool Corporation policy includes a continuous commitment to improve our products, we reserve the right to change materials and specifications without notice.

Dimensions are for planning purposes only. For complete details, see Installation Instructions packed with product. Specifications subject to change without notice.

Ref. W10422734A
 04/17

Lot: 91 Hawelock Corners
Ph: 4A
Re: Gas Stove Specs

4A-
Lot 91



WFG775H0H FREESTANDING RANGE

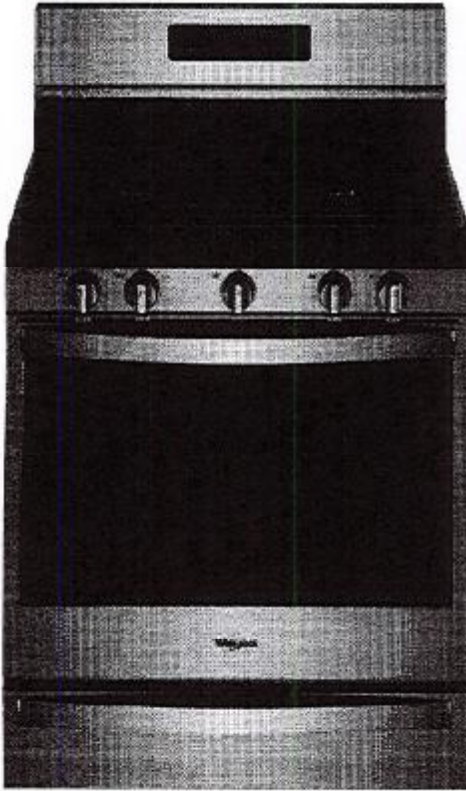

EZ-2-LIFT™ HINGED CAST-IRON GRATES



Get quick access to spills on the cooktop with our industry-first EZ-2-Lift™ hinged cast-iron grates. The hinged design lets you wipe up under them without removing them. For a more thorough clean, the grates are also dishwasher-safe.

FROZEN BAKE™ TECHNOLOGY



Skip preheating and cook frozen favorites like pizza in fewer steps with preprogrammed settings that automatically adjust cooking times for you.

CENTER OVAL BURNER



Easily fit large griddles and other longer cookware on this fifth burner so they heat evenly on the range top.

OTHER FEATURES

- Fan convection cooking
- SpeedHeat™ burner
- AquaLift® self-cleaning technology
- Temperature Sensor
- Rapid Preheat
- Griddle
- 5.8 cu. ft. capacity
- Large oven window
- Dishwasher-safe knobs



White
(W)



Black
(B)



Fingerprint Resistant
Stainless Steel (Z)



Fingerprint Resistant Black
Stainless Steel (V)

MODEL	WFG775H0HW	WFG775H0HB	WFG775H0HZ	WFG775H0HV
Max height (in)	46-1/2	46-1/2"	46-1/2"	46-1/2"
Width (in)	29-7/8"	29-7/8"	29-7/8"	29-7/8"
Depth (in)	27-3/8"	27-3/8"	27-3/8"	27-3/8"

Whirlpool®

Lot: 91 Havelock Corners Ph: 4A
Re: Gas Stove Spec's con't

4A -
Lot 91

jm

12

Location Requirements

IMPORTANT: Observe all governing codes and ordinances. Do not obstruct flow of combustion and ventilation air.

- It is the installer's responsibility to comply with installation clearances specified on the model/serial rating plate. The model/serial rating plate is located on the oven frame behind the top right side of the oven door.
- Recessed installations must provide complete enclosure of the sides and rear of the range.
- All openings in the wall or floor where range is to be installed must be sealed.
- Do not seal the range to the side cabinets.
- Cabinet opening dimensions that are shown must be used. Given dimensions are minimum clearances.
- The floor anti-tip bracket must be installed. To install the antitip bracket shipped with the range, see the "Install Anti-Tip Bracket" section.
- Grounded electrical supply is required. See the "Electrical Requirements" section.
- Proper gas supply connection must be available. See the "Gas Supply Requirements" section.
- Contact a qualified floor covering installer to check that the floor covering can withstand at least 200°F (93°C).
- Use an insulated pad or 1/4" (6.4 mm) plywood under range if installing range over carpeting.

IMPORTANT: To avoid damage to your cabinets, check with your builder or cabinet supplier to make sure that the materials used will not discolor, delaminate, or sustain other damage. This oven has been designed in accordance with the requirements of UL and CSA International and complies with the maximum allowable wood cabinet temperatures of 194°F (90°C).

Mobile Home Additional Installation Requirements

The installation of this range must conform to the Manufactured Home Construction and Safety Standard, Title 24 CFR, Part 3280 (formerly the Federal Standard for Mobile Home Construction and Safety, Title 24, HUD Part 280). When such standard is not applicable, use the Standard for Manufactured Home Installations, ANSI A225.1/NFPA 501A or with local codes.

In Canada, the installation of this range must conform with the current standards CAN/CSA-Z240, latest edition, or with local codes.

Mobile home installations require:

- When this range is installed in a mobile home, it must be secured according to the instructions in this document.

Product Dimensions

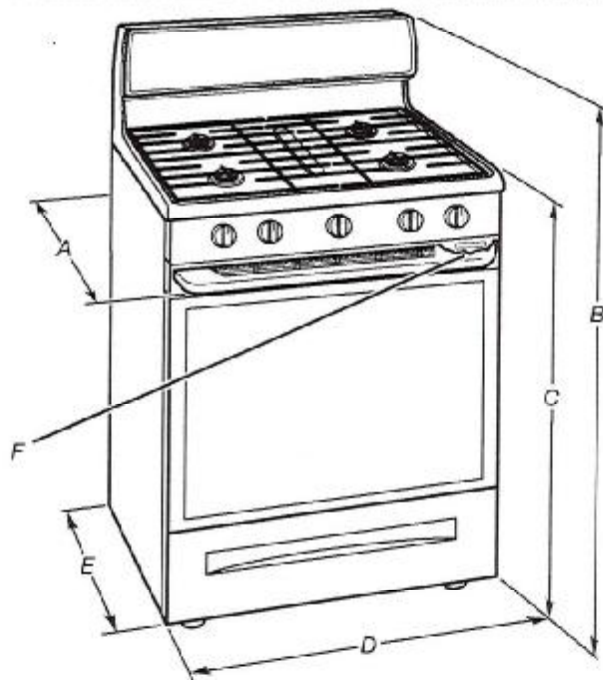

- A. 27¹/₈" (69.5 cm) max. depth with handle
- B. 46¹/₂" (118.1 cm) overall height (max.) with leveling legs screwed all the way in*
- C. 36" (91.4 cm) cooktop height (max.) with leveling legs screwed all the way in*
- D. 29¹/₂" (75.9 cm) width
- E. 25¹/₁₆" (64.3 cm) depth. Back of range to front of cooktop**
- F. Model/serial rating plate (located on the oven frame behind the top right side of the oven door)

IMPORTANT: Range must be level after installation. Follow the instructions in the "Level Range" section. Using the cooktop as a reference for leveling the range is not recommended.

* Range can be raised approximately 1" (2.5 cm) by adjusting the leveling legs.

** Front of door and drawer may extend farther forward, depending on styling.

Lot: 91 Howelock Corners
 Pn: 4A
 Re: Gas Stove Spec's Cont

4A:
 Lot 91

DR RE

Cabinet Dimensions

Cabinet opening dimensions shown are for 25" (64.0 cm) countertop depth, 24" (61.0 cm) base cabinet depth and 36" (91.4 cm) countertop height.

IMPORTANT: If installing a range hood or microwave hood combination above the range, follow the range hood or microwave hood combination installation instructions for dimensional clearances above the cooktop surface.

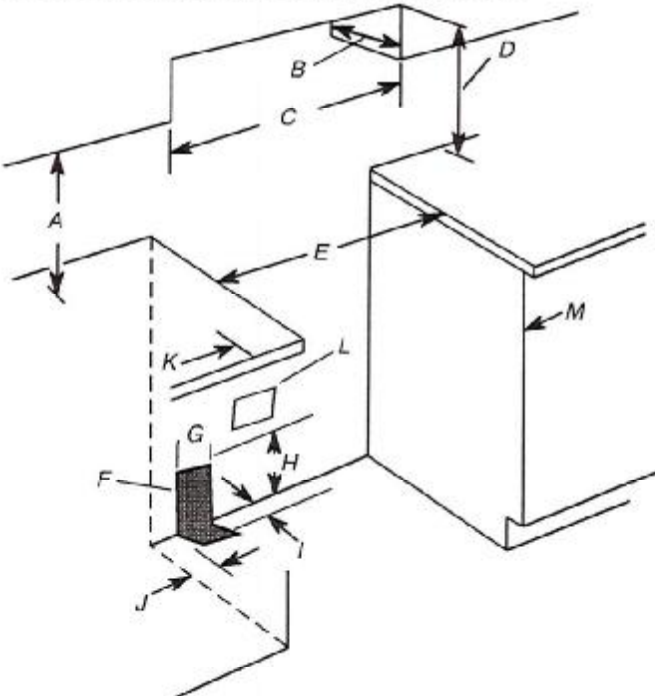

- A. 18" (45.7 cm) upper side cabinet to countertop
- B. 13" (33 cm) max. upper cabinet depth
- C. 30" (76.2 cm) min. opening width
- D. For minimum clearance to top of cooktop, see NOTE*.
- E. 30 1/8" (76.5 cm) min. opening width
- F. The shaded areas are recommended for installation of rigid gas pipe.
- G. 11" (27.9 cm)
- H. 17" (43.2 cm)
- I. 2" (5.1 cm)
- J. 4 1/8" (11.4 cm)
- K. 3" (7.6 cm) min. clearance from both sides of range to side wall or other combustible material.
- L. Grounded outlet
- M. Cabinet door or hinges should not extend into the cutout.

* NOTE: 24" (61.0 cm) minimum when bottom of wood or metal cabinet is covered by not less than 1/4" (6.4 mm) flame retardant millboard covered with not less than No. 28 MSG sheet steel, 0.015" (0.4 mm) stainless steel, 0.024" (0.6 mm) aluminum or 0.020" (0.5 mm) copper.
 30" (76.2 cm) minimum clearance between the top of the cooking platform and the bottom of an uncovered wood or metal cabinet.

Electrical Requirements

⚠ WARNING



Electrical Shock Hazard

Plug into a grounded 3 prong outlet.

Do not remove ground prong.

Do not use an adapter.

Do not use an extension cord.

Failure to follow these instructions can result in death, fire, or electrical shock.

IMPORTANT: The range must be electrically grounded in accordance with local codes and ordinances, or in the absence of local codes, with the National Electrical Code, ANSI/NFPA 70 or Canadian Electrical Code, CSA C22.1.

This range is equipped with an electronic ignition system that will not operate if plugged into an outlet that is not properly polarized.

If codes permit and a separate ground wire is used, it is recommended that a qualified electrical installer determine that the ground path is adequate.

A copy of the above code standards can be obtained from:

National Fire Protection Association
 1 Batterymarch Park
 Quincy, MA 02169-7471

CSA International
 8501 East Pleasant Valley Road
 Cleveland, OH 44131-5575

- A 120 volt, 60 Hz., AC only, 15-amp fused, electrical circuit is required. A time-delay fuse or circuit breaker is also recommended. It is recommended that a separate circuit serving only this range be provided.
- Electronic ignition systems operate within wide voltage limits, but proper grounding and polarity are necessary. Check that the outlet provides 120-volt power and is correctly grounded.
- This gas range is not required to be plugged into a GFCI (Ground-Fault Circuit Interrupter) outlet. It is recommended that you not plug an electric spark ignition gas range or any other major appliance into a GFCI wall outlet as it may cause the GFCI to trip during normal cycling.
- Performance of this range will not be affected if operated on a GFCI-protected circuit. However, occasional nuisance tripping of the GFCI breaker is possible due to the normal operating nature of electronic gas ranges.
- The wiring diagram is located on the back of the range in a clear plastic bag.

NOTE: The metal chassis of the range must be grounded in order for the control panel to work. If the metal chassis of the range is not grounded, no keypads will operate. Check with a qualified electrician if you are in doubt as to whether the metal chassis of the range is grounded.

Lot: 91 Havelock Corners
Ph: 4A
Re: W/D Spec's Con't

4A-
Lot 91

Prepared by
Josh Robins
josh@noobbody.com

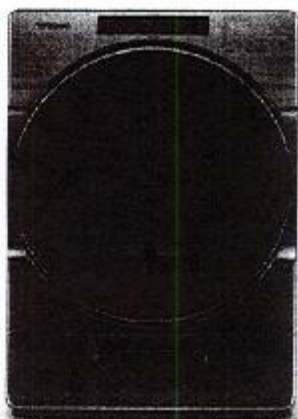

5.2 cu. ft. I.E.C. Closet-Depth Front Load Washer with Load & Go™ XL Dispenser

WFW6620HC

Available Finishes/Colours

☒ WFW6620HC
Chrome Shadow

☐ WFW6620HW
White

Dimensions

Depth	31 9/16
Width	27

Controls

LCD Touch Screen	No
LED Color	Blue

Exterior

Lid/Door Lock	Yes
Lid/Door Swing	Left
Window	Yes

Compatibility

Connectivity	No
Works With	No

Controls

Automatic Temperature Controls	Yes
--------------------------------	-----

Control Type	Tap Touch
--------------	-----------

Control Location	Front
------------------	-------

Electronic Display Type	Cycle Indicator Lights with Digital Time Remaining
-------------------------	----------------------------------------------------

End of Cycle Signal	Yes
---------------------	-----

Appearance

Window	Yes
LCD Touch Screen	No

Details

Advanced Vibration Control™	No
Automated Dispenser	Load&Go™
Automatic Load Size Sensing Technology	Yes

Skip adding detergent to every load with a Whirlpool® closet-depth front load washing machine. The Load & Go™ XL dispenser holds enough laundry soap for 40 loads and automatically adds the right amount. Intuitive Controls let you create customized washing machine cycles, and the ENERGY STAR® certified front load washer will even help you save on your utility bills.

Top Features

Load & Go™ XL Dispenser

ENERGY STAR® Certified

5.2 cu. ft. I.E.C. Capacity

Manuals & Literature:

Energy Guide

Installation Guide

Use and Care Guide

Warranty Information

Whirlpool

Because Whirlpool Corporation policy includes a continuous commitment to improve our products, we reserve the right to change materials and specifications without notice. Dimensions are for planning purposes only. For complete details, see Installation Instructions packed with product. Specifications subject to change without notice.

Lot: 91 Havelock Corners
Ph: 4A
Re: W/D Specs

4A-
Lot 91



Prepared by
Josh Robins
josh@nooobody.com

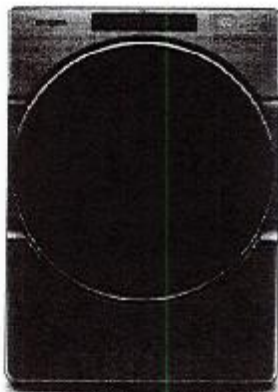

7.4 cu. ft. Front Load Electric Dryer with Steam Cycles

YWED6620HC

Available Finishes/Colours

☒ YWED6620HC
Chrome Shadow

☐ YWED6620HW
White

Dimensions

Depth	31
Height	38 3/4
Width	27

Configuration and Overview

Fuel Type	Electric
-----------	----------

Appearance

Door Style	Side Swing
Window	Yes
Reversible Door	Yes

Exterior

Door Style	Side Swing
Window	Yes
Door Opening	Right
Reversible Door	Yes

Controls

Control Location	Front
------------------	-------

Controls

Electronic Display Type	Cycle Indicator Lights
Feedback-Status Indicators	Check Vent, Cool Down, Damp, Sensing, V
End of Cycle Signal	Yes
Control Type	Electronic Touch

Misc.

Accessory Relationships	Yes
Home Delivery	Yes
Will Call	Yes

Details

Maytag Commercial Components	No
Automatic Dry Control	Yes

Give your family's clothes the care they deserve with a front load electric dryer with the Wrinkle Shield™ Plus option with Steam. Advanced Moisture Sensing helps prevent overdrying by using three moisture sensors to end the cycle at just the right time. The ENERGY STAR® certified electric dryer even includes a Static Reduce option to help decrease static after drying.

Top Features

Wrinkle Shield™ Plus Option with Steam

7.4 cu. ft. Capacity

Intuitive Controls

Manuals & Literature:

Installation Guide Use and Care Guide

Warranty Information



Because Whirlpool Corporation policy includes a continuous commitment to improve our products, we reserve the right to change materials and specifications without notice. Dimensions are for planning purposes only. For complete details, see Installation Instructions packed with product. Specifications subject to change without notice.