

KINGSMEN (THAMES) INC. / Havelock Corners (Kingsmen)

Lot/Unit: 94 Phase/Building: 4A Model/Floor Plan: James (3601) Elev C 4 Bed - 2+1 Bath

Miscellaneous

Inv.4552	1 - To supply & install the standard phone rough in in the kitchen, master bedroom and bedroom # 2... see sketch # 1 & #2	
Line 57943	Note:	
26Feb20 / 26Feb20		
Inv.4552	1 - To supply & install a gas rough in with an electrical outlet for a future gas cook top.... see spec's	
Line 57945	Note:	
26Feb20 / 26Feb20		
Inv.4552	1 - To supply & install accomodations for a future 30" gas cook top with pots and pans drawers; To supply & install accomodations for a future built in wall oven/micro tower w/drawer to include electrical required built in's ...see specs/sketch# 1	
Line 57947	Note: This quote is for using the standard line cabinetry and laminate counterop.	
26Feb20 / 26Feb20		
NOTE: Gas line and electrical for the future gas cook top is sold sep.		
Purchaser is aware that the top drawer to the pots and pans is a dummy drawer.		
Inv.4552	1 - To supply & install deep fridge uppers with doors and one gable in the standard line of cabintery.... see sketch # 1	
Line 57949	Note: The fridge has been relocated.	
26Feb20 / 26Feb20		

Cabinetry

Inv.4552	1 - To supply & install an upper angled corner cabinet using the standard line of cabientry.... see sketch # 1	
Line 57953	Note:	
26Feb20 / 26Feb20		
Inv.4552	1 - Clean cut (no backsplash) on laminate countertop in the kitchen.	
Line 57954	Note:	
26Feb20 / 26Feb20		
Inv.4552	1 - Relocate the opening for the future fridge in the kitchen... see sketch # 1	
Line 57946	Note:	
26Feb20 / 26Feb20		

CABINETRY VANITY

Inv.4552	1 - To supply & install a VANITY BANK OF DRAWERS - 55 CM MAXIMUM - STANDARD LINE in the master ensuite... see sketch # 2	
Line 57955	Note:	
26Feb20 / 26Feb20		

Electrical

Inv.4552	1 - To supply & install the CYCLONE chimney hood fan model SCB50030 in lieu of the standard hood fan... see spec's	
Line 57948	Note: Due to this upgrade the upper cabinets need to be deleted.	
26Feb20 / 26Feb20		



CONSTRUCTION SUMMARY

KINGSMEN (THAMES) INC. / Havelock Corners (Kingsmen)

Lot/Unit: 94 Phase/Building: 4A Model/Floor Plan: James (3601) Elev C 4 Bed - 2+1 Bath

Inv.4552	1 - To supply & install OUTLET - DUPLEX - 110V at approx. 66 " +- up from the floor centered + - to the F/P mantle see sketch # 1	
Line 57944	Note: This is for a future wall mount T.V.	
26Feb20 / 26Feb20		
Inv.4552	1 - Relcoate the std.ceiling light that is one the upper landing to the main staircase over to the O.T.B. area see sketch # 2	
Line 57941	Note:	
26Feb20 / 26Feb20		
Inv.4552	1 - To supply & install the standard T.V. rough in in the great room at apprxo. 66 " + - up from the floor centered to the F/P mantle and the other standard T.V. rough in the master bedroom see sketch # 1 & # 2	
Line 57942	Note:	
26Feb20 / 26Feb20		

EXTRAS AS PER OFFER

5 FREE APPLIANCES ? STAINLESS STEEL FRONT - FRIDGE: STOVE AND DISHWASHER. WHITE WASHER AND DRYER (SUPPLIED ONLY, NOT INSTALLED, FROM BUILDERS STANDARD LINE) TO ARRANGE DELIVERY ? CALL THE BRICK COMMERCIAL SALES DIVISION AT 1-877-353-2850. <i>Worksheet</i> Note:	
VENDOR TO INSTALL CAPPED GAS LINE (ROUGH-IN ONLY) AT REAR OF HOME FOR FUTURE BBQ LOCATION. LOCATION TO BE FINALIZED AT VENDORS SOLE DISCRETION. <i>Worksheet</i> Note:	
VENDOR TO SUPPLY & INSTALL AIR CONDITIONING UNIT, SIZED ACCORDINGLY, FROM VENDORS STANDARD SAMPLES. <i>Worksheet</i> Note:	

SCHEDULE "B-1"
Floor Plan

Lot 94
Phase 4A
Model: James (3601) Elev C 4 Bed - 2+1 Bath
Standard

Sketch #1

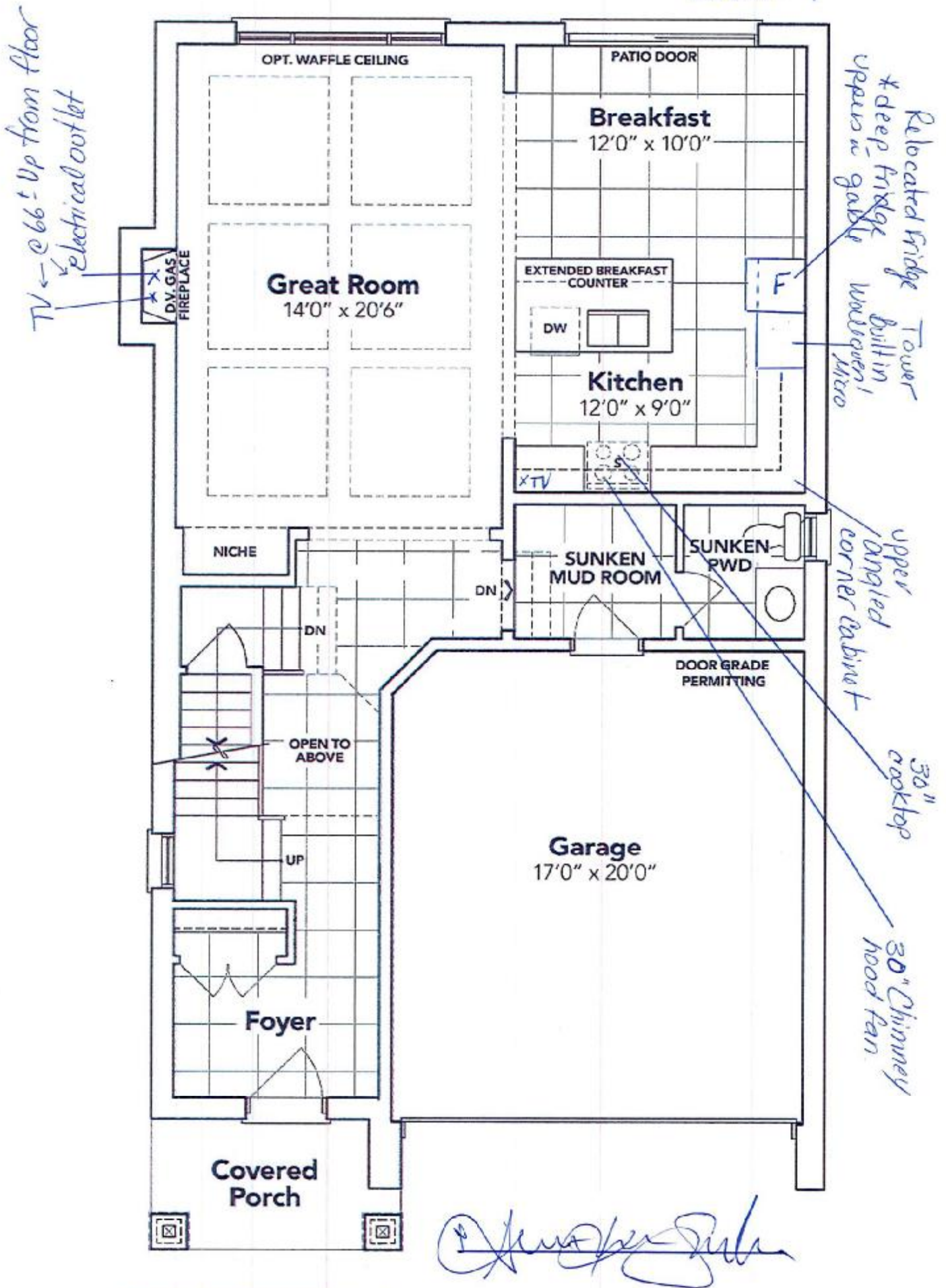

GROUND FLOOR EL. C

The floor plans and elevations shown are pre-construction plans and may be revised or improved as necessitated by architectural controls and the construction process. The measurements adhere to the rules and regulations of the TARION Warranty Corporation's official method for the calculation of floor area. Materials, specifications and floor plans are subject to change without notice. All house renderings are artist's concept only. Actual usable floor space may vary from the stated floor area. All options shown are upgrades. E. & O. E.

SCHEDULE "B-1"
Floor Plan

Lot 94
Phase 4A
Model: James (3601) Elev C 4 Bed - 2+1 Bath
Standard

Sketch #2

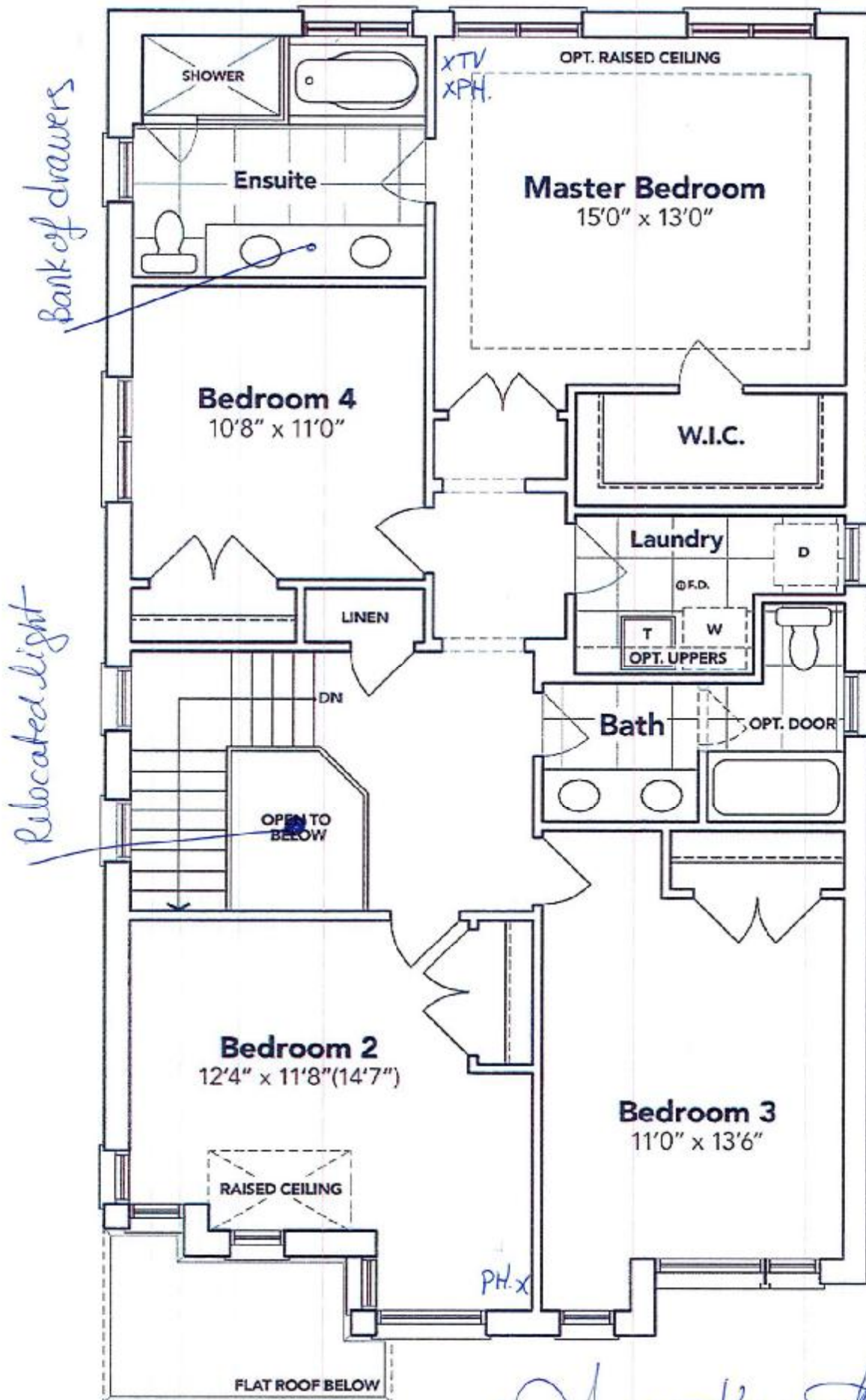

SECOND FLOOR EL. C

The floor plans and elevations shown are pre-construction plans and may be revised or improved as necessitated by architectural controls and the construction process. The measurements adhere to the rules and regulations of the TARION Warranty Corporation's official method for the calculation of floor area. Materials, specifications and floor plans are subject to change without notice. All house renderings are artist's concept only. Actual usable floor space may vary from the stated floor area. All options shown are upgrades. E. & O. E.

[Handwritten signature/initials]

LOT: 94 Havelock Corners
Pn: 4A Re: 30" Chimney Hood Fan Spec's

4A - lot 94

Specifications

Air Flow Volume: 550 CFM
Electrical Connection: 120V/60Hz
Power Consumption: 200 Watts
Current: 2.0 Amps
Fan Speed: 1599 RPM
Finishes: Stainless Steel
Duct: 6" Round
Knock-out: 6" Round - Top Only
Dimensions: Width: 30"/36"
Height: 46"
Depth: 18"
Noise Level: Min. 2 Sones
Max. 6 Sones



SCB500 - Baffle Filter



Ordering Model Chart

Model	Colour	Knock-out	Duct	Size	Filter
SCB50030	Stainless Steel	6"	6" Round	30"	Baffle
SCB50036	Stainless Steel	6"	6" Round	36"	Baffle

Notes

Cyclone®

4A-504
94

NOW, WE DELIVER TO OTTAWA! | OTTAWA JOB FAIR INFO [CLICK HERE](#)



Lot: 94 Havelock Corners Ph-4A.
Re: 30" Built'n Wall Oven Micro. Spec's

[Home](#) >

KitchenAid 30-inch 6.4 cu.ft Combination Wall Oven True Convection with Even Heat in stainless steel KOCE500ESS

KitchenAid 30-inch 6.4 cu.ft Combination Wall Oven True Convection with Even Heat in stainless steel KOCE500ESS

SKU 094324 In stock

★★★★★ 4.6 (1175) [Write a review](#)

This 30 in. KitchenAid Double Wall Oven with Even-Heat True Convection provides consistent heating and even cooking.

\$4,899.99 ~~\$6,199.99~~

(Free Shipping Included)

Old Appliance Removal

-- Please Select --

[Add to Cart](#)

[♥ Add to Wish List](#) | [Add to Compare](#)

[Free Shipping On Order Over \\$448](#)

[100% Price Match Guarantee](#)

Share: [✉ Email to a friend](#)

Sale

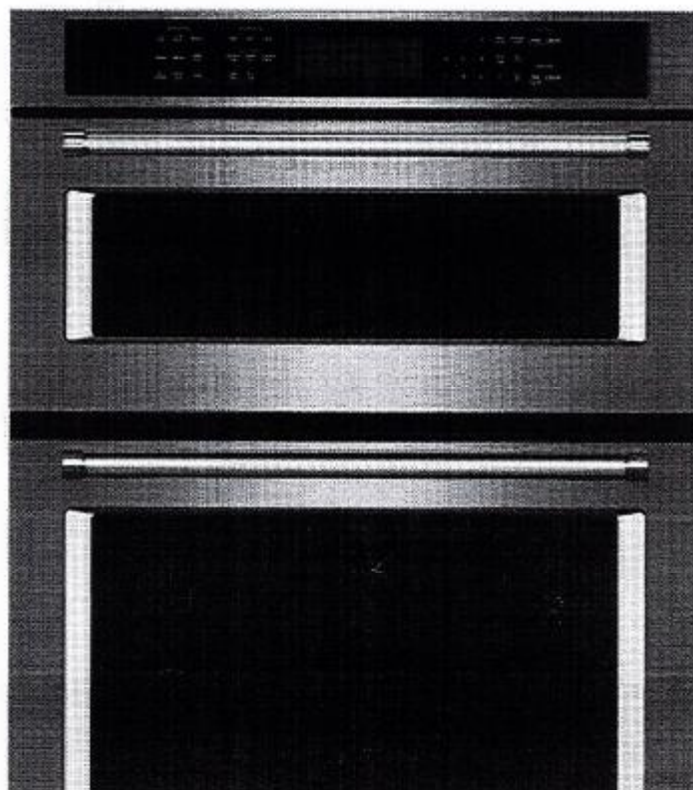

Lot: 94 Havelock Corners Ph. 4A R: 30" Built-in Wall Oven Micro Spec's

Product Dimensions

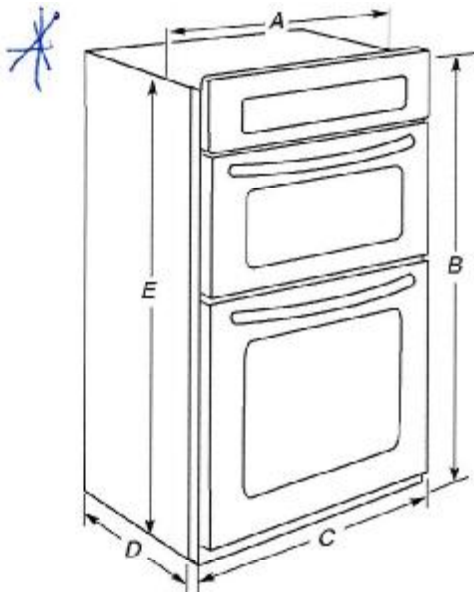

- A. 28 5/8" (71.9 cm) recessed width
- B. 42 1/8" (107.5 cm) overall height
- C. 29 1/4" (75.6 cm) overall width
- D. 23" (58.4 cm) max. recessed depth
- E. 40 1/2" (103.5 cm) recessed height

Cabinet Dimensions

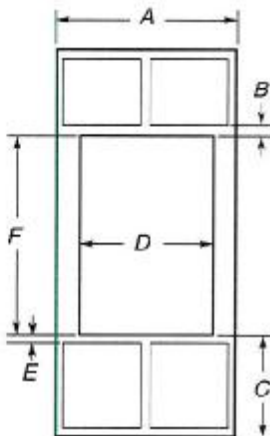

- A. 30" (76.2 cm) min. cabinet width
- B. 1" (2.5 cm) top of cutout to bottom of upper cabinet door
- C. 19 1/4" (48.9 cm) bottom of cutout to floor
- D. 26 1/2" (72.4 cm) cutout width
- E. 1 1/2" (3.8 cm) min. bottom of cutout to top of cabinet door
- F. 41 1/4" (104.8 cm) cutout height

Cabinet Side View

CON'T

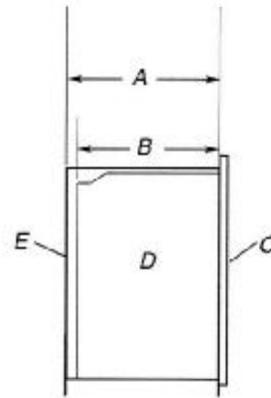

- A. 24" (61.0 cm) min. cutout depth
- B. 23" (58.4 cm) recessed oven depth
- C. Oven front
- D. Recessed oven
- E. Cabinet

Water Filtration System Location Requirements

For best results, do not install the water filtration system outside, or in extreme hot or cold temperatures. Temperature of water supply to the water filtration system must be between 40°F/4°C and 100°F/38°C. Do not install on hot water supply line.

Locate the water filtration system near the cold water supply pipe under the kitchen sink to filter cold water.

It will be necessary to drill a 1/2" (1.3 cm) minimum diameter hole in the upper right or left rear corner of the side wall of the cabinet under the sink to route the water supply tubing through to the oven cabinet cutout.

Another 1/2" (1.3 cm) minimum diameter hole will need to be drilled at the rear wall in the oven cabinet cutout.

Depending on your installation configuration, more routing holes may be required.

Coil enough copper tubing inside the oven cabinet to allow for the connection to the oven to be made outside the oven cabinet prior to setting the oven in place.

Typical Installation Configuration

NOTE: For unique installations contact a licensed plumber.

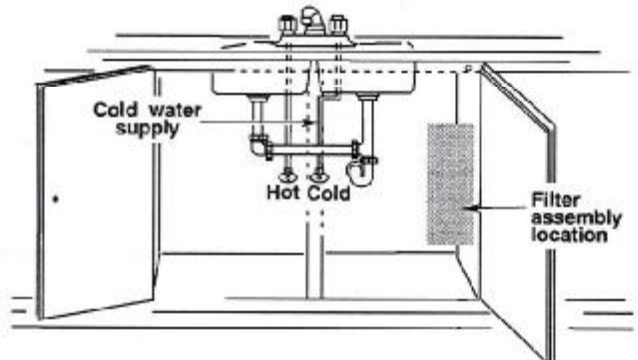

[Handwritten signature]

NOW, WE DELIVER TO OTTAWA! | OTTAWA JOB FAIR INFO [CLICK HERE](#)

4A-
50+9d



Lot: 94 Havelock Corners Ph: 4A
Re: 30" Gas Cooktop Spec's

[Home](#) > Whirlpool 30 Inch Gas Cooktop with Griddle WCG97US0HS

Whirlpool 30 Inch Gas Cooktop with Griddle WCG97US0HS

SKU WCG97US0HS In stock

★★★★★ (0) [Write a review](#)

\$1,199.99 ~~\$1,449.99~~

(Free Shipping Included)

Old Appliance Removal

[Handwritten signature]

— Please Select —

Add to Cart

♥ [Add to Wish List](#) | [Add to Compare](#)

[Free Shipping On Order Over \\$448](#)
[100% Price Match Guarantee](#)

Share: [Email to a friend](#)

Sale

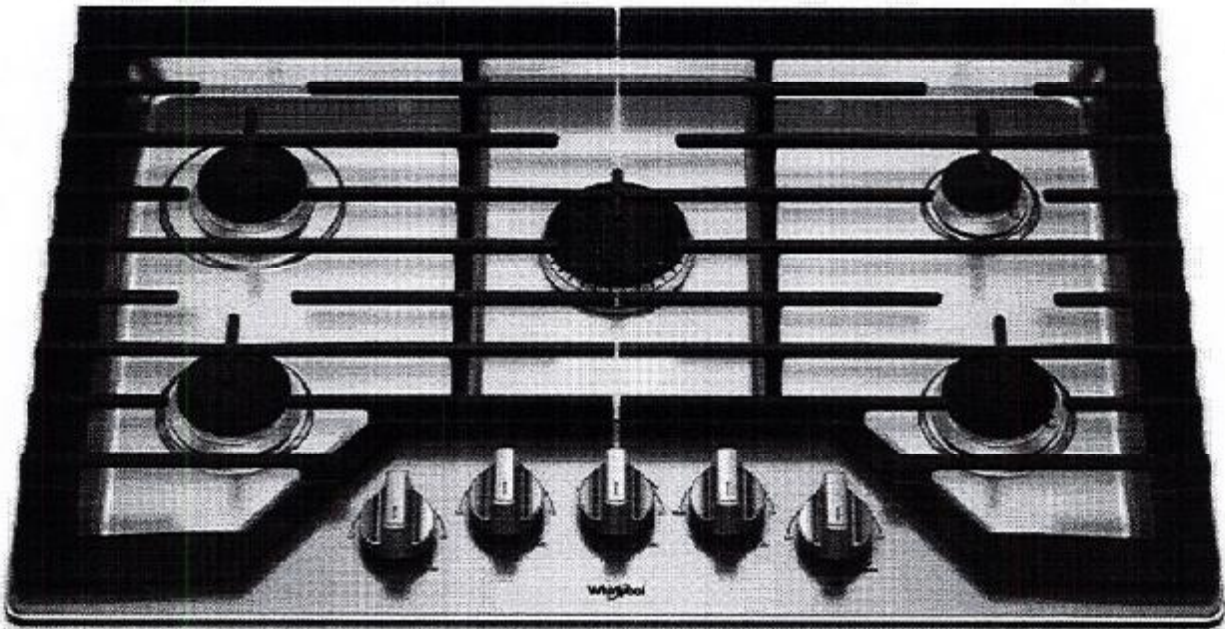

INSTALLATION REQUIREMENTS

Tools and Parts

Gather the required tools and parts before starting installation. Read and follow the instructions provided with any tools listed here.

Tools needed

- Tape measure
- Marker or pencil
- 1/4" (6.35 mm) nut driver
- Pliers
- Flat-blade screwdriver

Parts supplied

- Foam strip roll
- 2 1/2" (6.4 cm) clamping screws (2)
- Clamping brackets (2)

Parts needed

- A UL listed or CSA approved connector for 1/2" (1.3 cm) diameter conduit
- UL listed wire connectors

Check local codes. Check existing electrical supply. See the "Electrical Requirements" section.

It is recommended that all electrical connections be made by a licensed, qualified electrical installer.

Lot: 94 Mavelock Corners

Ph: 4A.

Re: 30" Gas Stove Spec's Cont

[Signature]

Location Requirements

IMPORTANT: Observe all governing codes and ordinances. When installing cooktop, use minimum dimensions given.

- To eliminate the risk of burns or fire by reaching over the heated surface units, cabinet storage space located above the surface units should be avoided. If cabinet storage is to be provided, the risk can be reduced by installing a range hood that projects horizontally a minimum of 5" (12.7 cm) beyond the bottom of the cabinets.
- The cooktop must be a specified cooktop that is approved to be installed either alone or over an undercounter built-in oven. Check the cooktop base for an approved installation label. If you do not find this label, contact your dealer to confirm that your cooktop is approved.
- The cooktop must be installed in a level countertop.
- Ovens approved for this type of installation will have an approval label located on the top of the oven. If you do not find this label, contact your dealer to confirm that your oven is approved. Refer to oven manufacturer's Installation Instructions for approval for built-in undercounter use and proper cutout dimensions.
- The cooktop should be installed away from strong draft areas, such as windows, doors, fans or strong heating vents. The cooktop should be located for convenient use in the kitchen.
- Use the countertop opening dimensions that are given with these Installation Instructions. Given dimensions are minimum clearances and provide 0" (0 cm) clearance.
- Grounded electrical supply is required. See "Electrical Requirements" section.

IMPORTANT: To avoid damage, check with your builder or cabinet supplier to make sure that the materials used will not discolor, delaminate or sustain other damage.

Product Dimensions

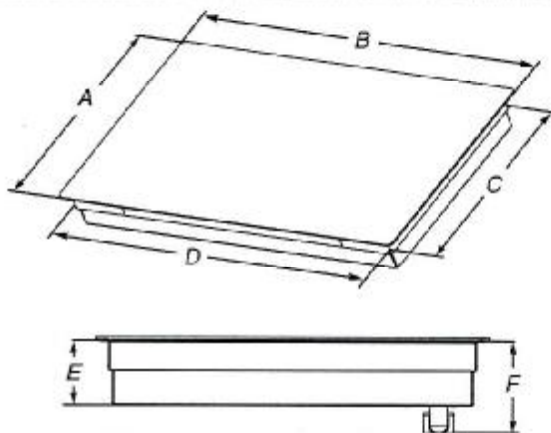

- A. Glass depth - black and white models - 21 3/4" (55.2 cm)
Glass depth - stainless steel models - 22 1/4" (56.4 cm)
- B. Glass width - 30" (76.2 cm) models - 30 1/8" (78.4 cm)
Glass width - 36" (91.4 cm) models - 36 3/8" (92.3 cm)
- C. Frame depth - 20 1/4" (51.5 cm)
- D. Frame width - 30" (76.2 cm) models - 28 5/8" (73.5 cm)
Frame width - 36" (91.4 cm) models - 34 7/8" (87.5 cm)
- E. Cooktop height - 3 3/4" (9.6 cm)
- F. Cooktop height including conduit (located at rear of cooktop, right side) - 5 1/4" (13.5 cm)

LOT: 94 Havelock Corners

Ph: 4A

Re: 30" Gas Stove Spec's Con't

4A -

Set 9d

Cabinet Dimensions

IMPORTANT: If installing a range hood or microwave hood combination above the cooktop, follow the range hood or microwave hood combination installation instructions for dimensional clearances above the cooktop surface.

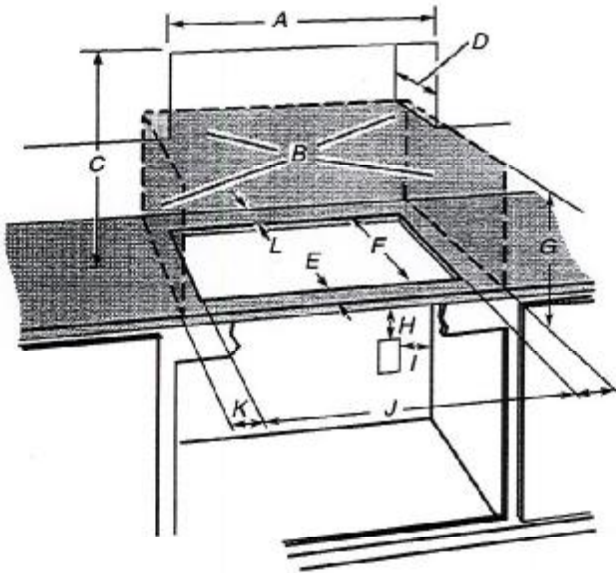

- A. 30" (76.2 cm) on 30" models; 36" (91.4 cm) on 36" models
- B. Combustible area above countertop (shown by dashed box above)
- C. 30" (76.2 cm) minimum clearance between top of cooktop platform and bottom of uncovered wood or metal cabinet (24" [61 cm] minimum clearance if bottom of wood or metal cabinet is covered by not less than 1/2" [0.6 cm] flame retardant millboard covered with not less than No. 28 MSG sheet steel, 0.015" [0.04 cm] stainless steel, or 0.024" [0.06 cm] aluminum or 0.020" [0.05 cm] copper)
- D. 13" (33 cm) recommended upper cabinet depth
- E. 2" (5.1 cm) on most models; 2 3/4" (6.7 cm) on model JEC4430B
- F. 20 1/2" (52.0 cm) recommended cutout.
Will fit in cutout from 20 3/8" - 20 7/8" (51.8-52.2 cm).
- G. 18" (45.7 cm) minimum clearance from upper cabinet to countertop within minimum horizontal clearances to cooktop
- H. Junction box or outlet: 7" (17.8 cm) minimum from top of countertop
- I. Junction box or outlet: 9" (23.0 cm) maximum from right side of cabinet
- J. 29 1/2" (74.9 cm) recommended cutout on 30" (76.2 cm) models.
Will fit in cutout from 29 1/8" - 29 3/4" (73.8-75.1 cm) on 30" (76.2 cm) models.
35 1/2" (90.2 cm) recommended cutout on 36" (91.4 cm) models.
Will fit in cutout from 34 3/8" - 35 3/8" (87.8-90.3 cm) on 36" (91.4 cm) models.
- K. 1" (2.5 cm) minimum distance to nearest left and right side combustible surface above cooktop
- L. 1" (2.5 cm) minimum clearance between back wall and countertop

NOTES: After making the countertop cutout, some installations may require notching down the base cabinet side walls to clear the cooktop base. To avoid this modification, use a base cabinet with sidewalls wider than the cutout.

If cabinet has a drawer, a 5 1/2" (14.0 cm) depth clearance from the top of the countertop to the top of the drawer (or other obstruction) in base cabinet is required.

Electrical Requirements

⚠ WARNING



Electrical Shock Hazard

Disconnect power before servicing.

Use 8 gauge copper wire.

Electrically ground cooktop.

Failure to follow these instructions can result in death, fire, or electrical shock.

If codes permit and a separate ground wire is used, it is recommended that a qualified electrical installer determine that the ground path and wire gauge are in accordance with local codes.

Check with a qualified electrical installer if you are not sure the cooktop is properly grounded.

Make sure that the electrical connection and wire size are adequate and in conformance with the National Electrical Code, ANSI/NFPA 70-latest edition or CSA Standards C22.1-94, Canadian Electrical Code, Part 1 and C22.2 No. 0-M91-latest edition, and all local codes and ordinances.

A copy of the above code standards can be obtained from:

National Fire Protection Association
1 Batterymarch Park
Quincy, MA 02169-7471

CSA International
8501 East Pleasant Valley Road
Cleveland, OH 44131-5575

Before You Make the Electrical Connection:

To properly install your cooktop, you must determine the type of electrical connection you will be using and follow the instructions provided for it here.

- A 3-wire or 4-wire, single phase, 120/240 volt, 60-Hz., AC only electrical supply is required on a separate, 40-amp circuit fused on both sides of the line. The model/serial number rating plate is located on the metal cabinet underneath the cooktop. See the following illustration.

NOTE: A separate 30-amp circuit fused on both sides of the line can be used for models W5CE3024 and G9CE3065.

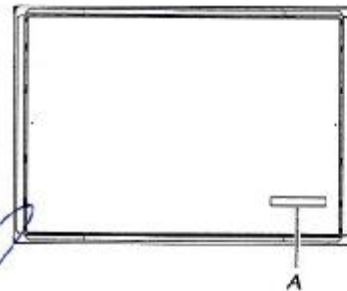

[Handwritten signature]