

KINGSMEN (THAMES) INC. / Havelock Corners (Kingsmen)

Lot/Unit: 132 BLOCK 124    Phase/Building: 4A    Model/Floor Plan: William (2603) Elev B1 4  
Bed - 2+1 Bath

.Appliance - Fridge

Inv.4437	1 - LOCATION: KITCHEN	
	SUPPLY AND INSTALL CABINETRY TO ACCOMMODATE A 48" FRIDGE - BUILT IN WITH INTEGRATED OR FLUSH INSTALL (07H)	
Line 57617	Note: SEE SPECS ATTACHED	
11Apr19 / 22Jul19		

.Miscellaneous

Inv.4437	1 - LOCATION: ALL BATHROOMS	
	DO NOT SUPPLY OR INSTALL THE STANDARD TOWEL BARS, TOILET PAPER HOLDERS AND SOAP HOLDERS IF APPLICABLE	
Line 57632	Note:	
11Apr19 / 22Jul19		

Audio And Security

Inv.4437	1 - LOCATION: DINING ROOM	
	CABLE TO BE CENTRED TO WALL IN DINING ROOM AND LOCATED AT APPROXIMATLEY 76" HIGH ABOVE FINISHED FLOOR.	
Line 57625	Note: SEE SKETCH FOR LOCATION	
11Apr19 / 22Jul19		
Inv.4437	1 - LOCATION: MASTER BEDROOM	
	CABLE TO BE CENTRED TO WALL IN DINING ROOM AND LOCATED AT APPROXIMATLEY 72" HIGH ABOVE FINISHED FLOOR.	
Line 57627	Note: SEE SKETCH FOR LOCATION	
11Apr19 / 22Jul19		
Inv.4437	1 - LOCATE THE STANDARD TELEPHONE OUTLETS AS PER SKETCH ATTACHED LOCATE AT STANDARD HEIGHT	
Line 57631	Note:	
11Apr19 / 22Jul19		

Cabinetry

Inv.4437	9 - LOCATION: KITCHEN	
	SUPPLY AND INSTALL NINE FEET (9') OF UPPER CABINETS TO RE-DESIGN KITCHEN TO ACCOMMODATE A 48" FRIDGE, 36" COOK-TOP STOVE AND 30" BUILT IN WALL OVEN/MICRO WAVE UNIT. (02A)	
Line 56762	Note: STANDARD LINE CABINETS - SEE FRENDEL KITCHEN SKETCH ATTACHED	
11Apr19 / 22Jul19		
Inv.4437	4 - LOCATION: KITCHEN ISLAND	
	SUPPLY AND INSTALL FOUR FEET (4') OF BASE ISLAND WITH PANEL TO LENGTHEN ISLAND (23B)	
Line 56763	Note: STANDARD LINE CABINETS - SEE FRENDEL KITCHEN SKETCH ATTACHED	
11Apr19 / 22Jul19		

KINGSMEN (THAMES) INC. / Havelock Corners (Kingsmen)

Lot/Unit: 132 BLOCK 124    Phase/Building: 4A    Model/Floor Plan: William (2603) Elev B1 4  
Bed - 2+1 Bath

Inv.4437	9 - LOCATION: KITCHEN  SUPPLY AND INSTALL NINE FEET (9') OF BASE CABINETS TO RE-DESIGN KITCHEN TO ACCOMMODATE A 48" FRIDGE, 36" COOK TOP STOVE AND 30" BUILT IN WALL OVEN/MICRO WAVE UNIT. (01B)  Line 56764      Note: STANDARD LINE CABINETS - SEE FRENDEL KITCHEN SKETCH ATTACHED  11Apr19 / 22Jul19	
Inv.4437	1 - LOCATION: KITCHEN  SUPPLY AND INSTALL CABINETRY TO ACCOMMODATE BUILT IN WALL OVEN/MICRO UNIT (18H) WITH DRAWER BELOW - STANDARD LINE CABINETS  Line 56765      Note: LOCATION AS PER SKETCH ATTACHED  11Apr19 / 22Jul19	
Inv.4437	1 - LOCATION: KITCHEN  SUPPLY AND INSTALL CABINETRY TO ACCOMMODATE 36" GAS RANGE COOK-TOP (25H) WITH POT DRAWERS BELOW. STANDARD LINE CABINETS  Line 56767      Note: NOTE: N/A WITH LAMINATE COUNTER-TOP  11Apr19 / 22Jul19	
Inv.4437	1 - LOCATION: KITCHEN  SUPPLY AND INSTALL 2 BIN WASTE CENTER (19B)  Line 56888      Note: SEE FRENDEL KITCHEN SKETCH ATTACHED  11Apr19 / 22Jul19	
Inv.4437	1 - LOCATION: KITCHEN  BASE PIE CUT CORNER CABINET (26B)  Line 56889      Note: SEE FRENDEL KITCHEN SKETCH ATTACHED  11Apr19 / 22Jul19	
Inv.4437	1 - LOCATION: KITCHEN  UPPER ANGLE CORNER CABINET WITH CLEAR GLASS AND MATCHING INTERIOR (25A) COMBO  Line 56890      Note: SEE FRENDEL KITCHEN SKETCH ATTACHED  11Apr19 / 22Jul19	
Inv.4437	1 - LOCATION: KITCHEN  ADDITIONAL BANK OF DRAWERS (11B)  Line 56892      Note: STANDARD LINE CABINETS - SEE FRENDEL KITCHEN SKETCH ATTACHED  11Apr19 / 22Jul19	
Inv.4437	1 - LOCATION: KITCHEN  DELETE THE UPPER CABINETS ABOVE THE STOVE AND FINISH SIDES TO ACCOMMODATE A FUTURE CHIMNEY HOOD FAN  Line 56988      Note:  11Apr19 / 22Jul19	

KINGSMEN (THAMES) INC. / Havelock Corners (Kingsmen)

Lot/Unit: 132 BLOCK 124    Phase/Building: 4A    Model/Floor Plan: William (2603) Elev B1 4  
Bed - 2+1 Bath

Inv.4437	1 - LOCATION: KITCHEN  CABINETRY - KITCHEN - UPGRADE - CLASSIC III INCLUDES BUFFET NICHE AS PER PLAN  Line 57671      Note: LANCASTER PAINT CHIA SEED  11Apr19 / 22Jul19	
Inv.4437	1 - LOCATION: MASTERE ENSUITE  CABINETRY - VANITY - MASTER ENSUITE - UPGRADE - CLASSIC III  Line 57702      Note: LANCASTER MAPLE CAVIAR  11Apr19 / 22Jul19	

CABINETRY VANITY

Inv.4437	1 - LOCATION: MASTER ENSUITE  VANITY BANK OF DRAWERS - 55 CM MAXIMUM - STANDARD LINE TO BE LOCATED BETWEEN VANITY SINKS  Line 57641      Note:  11Apr19 / 22Jul19	
Inv.4437	1 - LOCATION: MAIN BATHROOM  VANITY BANK OF DRAWERS - 55 CM MAXIMUM - STANDARD LINE TO BE LOCATED BETWEEN VANITY SINKS  Line 57642      Note:  11Apr19 / 22Jul19	

Carpet

Inv.4437	1 - LOCATION: ALL BEDROOMS  SUPPLY AND INSTALL UPGRADE CARPET - MOHAWK LANDSLIDE WITH STANDARD UNDERPAD IN LIEU OF STANDARD CARPET  Line 57694      Note: MOHAWK LANDSLIDE # 917 JANUARY FROST  11Apr19 / 22Jul19	
----------	--	--

COUNTER TOP - EXTRAS

Inv.4437	2 - LOCATION: MASTER ENSUITE  COUNTER TOP PROVISION ONLY - GRANITE CUTOUT PROVISION FOR UNDER MOUNT SINKS IN MASTER ENSUITE  Line 57701      Note:  11Apr19 / 22Jul19	
----------	--	--

COUNTER TOP - VANITY

Inv.4437	1 - LOCATION: MASTER ENSUITE  COUNTER TOP - VANITY - MASTER ENSUITE - 2CM COUNTER TOP - UPGRADE LEVEL 5 STANDARD EDGE PROFILE  Line 57698      Note: CAESARSTONE PURE WHITE 1141  11Apr19 / 22Jul19	
----------	---	--

Countertop

KINGSMEN (THAMES) INC. / Havelock Corners (Kingsmen)

Lot/Unit: 132 BLOCK 124    Phase/Building: 4A    Model/Floor Plan: William (2603) Elev B1 4  
Bed - 2+1 Bath

Inv.4437	1 - LOCATION: KITCHEN ISLAND  SUPPLY AND INSTALL WATERFALL SIDES TO TWO (2) SIDES OF ISLAND IN KITCHEN  Line 57684      Note: CAESARSTONE PURE WHITE 1141  11Apr19 / 22Jul19	
Inv.4437	1 - LOCATION: BUFFET NICHE IN DINING ROOM  SUPPLY AND INSTALL QUARTZ COUNTER-TOP WITH STANDARD PROFILE EDGE IN LIEU OF STANDARD LAMINATE TO BUFFER NICHE.  Line 57689      Note: CAESARSTONE PURE WHITE 4141  11Apr19 / 22Jul19	
Inv.4437	1 - LOCATION: KITCHEN  SUPPLY AND INSTALL CAESARSTONE QUARTZ COUNTER-TOP WITH STANDARD EDGE PROFILE (IN LIEU OF STANDARD LAMINATE) INCLUDING KITCHEN ISLAND. INCLUDES CUT OUT/POLISHING FOR UNDERMOUNT SINK.  Line 57683      Note: CAESARSTONE PURE WHITE 1141  11Apr19 / 22Jul19	
Inv.4437	1 - LOCATION: KITCHEN  SUPPLY AND INSTALL FULL HEIGHT QUARTZ BACKSPLASH (INCLUDING BEHIND CHIMNEY HOOD FAN) TO ALIGN WITH UPPER CABINET HEIGHT  Line 57685      Note: CAESARSTONE PURE WHITE 1141  11Apr19 / 22Jul19	

Electrical

Inv.4437	1 - LOCATION: DINING ROOM  SUPPLY AND INSTALL AN ELECTRICAL OUTLET/PLUG CENTRED TO WALL IN DINING ROOM AND LOCATED AT APPROXIMATELY 76" HIGH ABOVE FINISHED FLOOR AND NEXT TO CABLE OUTLET  Line 57626      Note: SEE SKETCH FOR LOCATION  11Apr19 / 22Jul19	
Inv.4437	1 - LOCATION: KITCHEN  SUPPLY AND INSTALL ELECTRICAL REQUIRED FOR BUILT IN WALL OVEN/MICROWAVE (240 V) AND CONNECTION  Line 56766      Note:  11Apr19 / 22Jul19	
Inv.4437	1 - LOCATION: KITCHEN  SUPPLY AND INSTALL ELECTRICAL OUTLET/PLUG TO ACCOMMODATE A BUILT IN 48" FRIDGE  Line 57618      Note: SPECS ATTACHED  11Apr19 / 22Jul19	

**KINGSMEN (THAMES) INC. / Havelock Corners (Kingsmen)**

**Lot/Unit: 132 BLOCK 124    Phase/Building: 4A    Model/Floor Plan: William (2603) Elev B1 4  
Bed - 2+1 Bath**

Inv.4437	1 - LOCATION: KITCHEN  SUPPLY AND INSTALL ELECTRICAL PLUG REQUIRED TO ACCOMODATE A CHIMNEY HOOD FAN BEING SUPPLIED AND INSTALLED BY PURCHASER AFTER CLOSING	
Line 56989	Note:	
11Apr19 / 22Jul19		
Inv.4437	1 - LOCATION: MASTER ENSUITE  SUPPLY AND INSTALL CAPPED CEILING OUTLET ON A SEPARATE SWITCH TO BE CENTRED IN CEILING ABOVE SOAKER TUB	
Line 57633	Note: SEE SKETCH FOR LOCATION	
11Apr19 / 22Jul19		
Inv.4437	1 - LOCATION: MASTER BEDROOM  SUPPLY AND INSTALL AN ELECTRICAL OUTLET/PLUG CENTRED TO WALL IN DINING ROOM AND LOCATED AT APPROXIMATELY 72" HIGH ABOVE FINISHED FLOOR AND NEXT TO CABLE OUTLET	
Line 57628	Note: SEE SKETCH FOR LOCATION	
11Apr19 / 22Jul19		
Inv.4437	3 - LOCATION: KITCHEN ISLAND  SUPPLY AND INSTALL THREE (3) CAPPED CEILING OUTLETS ALL TO BE ON A SEPARATE SWITCH TO BE CENTRED IN CEILING ABOVE KITCHEN ISLAND. PLEASE SPACE EVENLY ABOVE ISLAND WHICH HAS BEEN EXTENDED. SEE REVISED KITCHEN PLAN	
Line 57659	Note:	
11Apr19 / 22Jul19		

**Hardwood**

Inv.4437	1 - LOCATION: MAIN FLOOR NON TILE AREAS  SUPPLY AND INSTALL UPGRADE HARDWOOD - VINTAGE SELECT V-HERRINGBONE ORACLE PEARL FINISH 3-1/4" WHITE OAK TO DINING ROOM/DINING HALL, GREAT ROOM, LANDINGS AND UPPER HALLWAY	
Line 57696	Note: VINTAGE ORACLE	
11Apr19 / 22Jul19		

**Heating And Air Conditioning**

Inv.4437	1 - LOCATION: EXTERIOR  AS PER SCHEDULE PE ITEM # 5 - VENDOR TO INSTALL CAPPED GAS LINE (ROUGH IN ONLY) AT REAR OF HOME FOR FUTURE BBQ. APPLIANCE TO BE SUPPLIED AND INSTALL BY PURCHASER AFTER CLOSING	
Line 56714	Note: LOCATION TO BE DETERMINED BY VENDOR	
11Apr19 / 22Jul19		
Inv.4437	1 - LOCATION: EXTERIOR  AS PER SCHEDULE PE ITEM #6 - VENDOR TO SUPPLY AND INSTALL AIR CONDITIONING UNIT, SIZED ACCORDINGLY, FROM VENDOR'S STANDARD SELECTION	
Line 56715	Note: LOCATION AS PER SKETCH ATTACHED	
11Apr19 / 22Jul19		

KINGSMEN (THAMES) INC. / Havelock Corners (Kingsmen)

Lot/Unit: 132 BLOCK 124    Phase/Building: 4A    Model/Floor Plan: William (2603) Elev B1 4  
Bed - 2+1 Bath

Inv.4437	1 - LOCATION: KITCHEN	
	LOCATE 6" DUCT OPENING IN CENTRE OF WALL TO ACCOMMODATE A CHIMNEY HOOD RANGE BEING INSTALLED BY CLIENT AFTER CLOSING.	
Line 57687	Note: SEE SPECS ATTACHED	
11Apr19 / 22Jul19		

PAINT AND DRYWALL

Inv.4437	1 - LOCATION : MAIN STAIRS	
	PAINT EXTRAS - STAIN RAILINGS, PICKETS AND POSTS (PER FLIGHT) OAK	
Line 57663	Note: VINTAGE ORACLE COLOUR	
11Apr19 / 22Jul19		
Inv.4437	1 - LOCATION: MAIN STAIRS	
	PAINT EXTRAS - STAIN STAIRS (EXCLUDING RAILINGS) (PER FLIGHT - OAK)	
Line 57664	Note: VINTAGE ORACLE COLOUR	
11Apr19 / 22Jul19		

Plumbing

Inv.4437	1 - LOCATION: MASTER ENSUITE SHOWER STALL	
	SUPPLY AND INSTALL FRAMELESS GLASS SHOWER WITH FRAMELESS GLASS DOOR TO FRONT PORTION OF SHOWER STALL. NOTE: HALF GLASS ONLY ABOVE VANITY (AS PER PLAN)	
Line 57638	Note:	
11Apr19 / 22Jul19		
Inv.4437	2 - LOCATION: MASTER ENSUITE	
	UPGRADE FAUCET COLLECTION TO MOEN DOUX MATTE BLACK - MODEL S6910 SINGLE LEVER FAUCET FOR MASTER ENSUITE	
Line 57699	Note:	
11Apr19 / 22Jul19		
Inv.4437	1 - LOCATION: FRIDGE	
	WATERLINE ROUGH-IN TO THE FRIDGE LOCATION (NO HOOK UP)	
Line 57658	Note:	
11Apr19 / 22Jul19		
Inv.4437	2 - LOCATION: MASTER ENSUITE	
	SUPPLY AND INSTALL UNDERMOUNT SINKS IN LIEU OF STANDARD OVER MOUNT SINKS TO MASTER ENSUITE. MODEL 4210 CIY WHITE - CONTRAC CATENA	
Line 57700	Note:	
11Apr19 / 22Jul19		
Inv.4437	1 - LOCATION: MASTER ENSUITE SOAKER TUB	
	UPGRADE FAUCET COLLECTION TO MOEN DOUX MATTE BLACK - 4PC WITH HANDSHOWER TS984BL/9796	
Line 57680	Note:	
11Apr19 / 22Jul19		

KINGSMEN (THAMES) INC. / Havelock Corners (Kingsmen)

Lot/Unit: 132 BLOCK 124    Phase/Building: 4A    Model/Floor Plan: William (2603) Elev B1 4  
Bed - 2+1 Bath

Inv.4437	1 - LOCATION: MASTER ENSUITE SHOWER STALL  UPGRADE FAUCET COLLECTION TO MOEN DOUX MATTE BLACK / HAND HELD SHOWER UNIT WITH SLIDE BAR. MODEL TS2202BL/62380 - WITH TS9204BL/3372/388EPBL/A725BL DIVERTER AND HAND SHOWER	
Line 57681	Note:	
11Apr19 / 22Jul19		
Inv.4437	1 - LOCATION: KITCHEN  SUPPLY AND INSTALL UPGRADE FAUCET TO KITCHEN IN LIEU OF STANDARD MOEN # ALIGN 5923BL	
Line 57682	Note:	
11Apr19 / 22Jul19		
Inv.4437	1 - LOCATION: KITCHEN  SUPPLY AND INSTALL UPGRADE UNDERMOUNT SINK - BLANCO SUPER SINGLE 401409 CINDER COLOUR	
Line 57688	Note:	
11Apr19 / 22Jul19		

Stairs And Railing

Inv.4437	1 - LOCATION: MAIN STAIRS  RAILING - UPGRADE 4 METAL - HANDRAIL MOD RECTANGLE OAK - PICKETS STEEL 1/2 INCH ROUND PLAIN / 496/1 WITH SHOES FLAT BLACK - POSTS 3-1/2" SQUARE CHAMFERED WITH CAP OAK	
Line 57697	Note:	
11Apr19 / 22Jul19		

Tile

Inv.4437	1 - LOCATION: MAIN BATH SHOWER STALL  SUPPLY AND INSTALL UPGRADE SHOWER FLOOR TILE IN LIEU OF STANDARD 2" X 2" MOSAIC SHOWER FLOOR	
Line 57669	Note: SOHO PENNY ROUND MOSAIC WHITE GLOSSY 51-030	
11Apr19 / 22Jul19		
Inv.4437	1 - LOCATION: MASTER ENSUITE SHOWER STALL  SUPPLY AND INSTALL UPGRADE WALL TILE - 12" X 24" LINEA IN LIEU OF STANDARD WALL TILE TO 3 WALLS AND CEILING AREA IN GLASS SHOWER STALL STANDARD VERTICAL INSTALL	
Line 57666	Note: 12" X 24" LINEA PRIZMATIC WHITE	
11Apr19 / 22Jul19		
Inv.4437	1 - LOCATION: TILED (FLOOR) AREAS  SUPPLY AND INSTALL UPGRADE TILE - 12" X 24" POLISHED PORCELAIN TILE IN LIEU OF STANDARD TO FOYER, POWDER ROOM, MUD ROOM, KITCHEN/BREAKFAST AREA, LAUNDRY ROOM, MAIN BATH AND MASTER ENSUITE FLOOR/TUB DECK AND WALL	
Line 57665	Note: 12" X 24" PRIMA WHITE POLISHED (STANDARD STACKED INSTALL)	
11Apr19 / 22Jul19		



KINGSMEN (THAMES) INC. / Havelock Corners (Kingsmen)

Lot/Unit: 132 BLOCK 124    Phase/Building: 4A    Model/Floor Plan: William (2603) Elev B1 4  
Bed - 2+1 Bath

Inv.4437	1 - LOCATION: MASTER ENSUITE SHOWER STALL	
	SUPPLY AND INSTALL UPGRADE SHOWER FLOOR TILE IN LIEU OF STANDARD 2" X 2" MOSAIC SHOWER FLOOR	
Line 57667	Note: SOHO PENNY ROUND MOSAIC WHITE GLOSSY 51-030	
11Apr19 / 22Jul19		
Inv.4437	1 - LOCATION: MAIN BATH TUB ENCLOSURE	
	SUPPLY AND INSTALL UPGRADE 1 WALL TILE - 4' X 16" IN LIEU OF STANDARD WALL TILE TO MAIN BATH TUB ENCLOSURE	
	BRICK JOINT INSTALL	
Line 57668	Note: SOHO WHITE GLOSSY 50-600	
11Apr19 / 22Jul19		

Trim

Inv.4437	1 - LOCATION: FRONT DOOR	
	SUPPLY AND INSTALL UPGRADE GRIP SET (HAWTHORN) MATTE BLACK TO EXTERIOR OF FRONT DOOR	
	INTERIOR SIDE OF DOOR TO BE HALIFAX MATTE BLACK	
Line 57661	Note:	
11Apr19 / 22Jul19		
Inv.4437	1 - LOCATION: MASTER WALK IN CLOSET	
	DELETE THE DOOR INTO THE WALK IN CLOSET - DO NOT SUPPLY OR INSTALL.	
	SUPPLY AND INSTALL A TRIMMED DOOR OPENING ONLY	
Line 57648	Note:	
11Apr19 / 22Jul19		
Inv.4437	1 - LOCATION: INTERIOR	
	TRIM - UPGRADE TRIM - 3 1/2 INCH STP BEV CASING - 5 1/2 INCH STP BEV BASEBOARD	
Line 57654	Note:	
11Apr19 / 22Jul19		
Inv.4437	1 - LOCATION: INTERIOR DOORS	
	SUPPLY AND INSTALL 2 PANEL INTERIOR DOORS (80" HIGH) STANDARD HEIGHT IN LIEU OF STANDARD DOORS	
Line 57656	Note:	
11Apr19 / 22Jul19		
Inv.4437	1 - LOCATION: INTERIOR DOORS	
	SUPPLY AND INSTALL UPGRADE INTERIOR PASSAGE SET TO ALL INTERIOR DOORS	
	IN LIEU OF STANDARD STRAIGHT CHROME LEVER	
Line 57660	Note: HALIFAX MATTE BLACK	
11Apr19 / 22Jul19		





CONSTRUCTION SUMMARY

KINGSMEN (THAMES) INC. / Havelock Corners (Kingsmen)

Lot/Unit: 132 BLOCK 124    Phase/Building: 4A    Model/Floor Plan: William (2603) Elev B1 4  
Bed - 2+1 Bath

EXTRAS AS PER OFFER

5 FREE APPLIANCES ? STAINLESS STEEL FRONT ? FRIDGE: STOVE AND DISHWASHER. WHITE WASHER AND DRYER (SUPPLIED ONLY, NOT INSTALLED, FROM BUILDERS STANDARD LINE) TO ARRANGE DELIVERY ? CALL THE BRICK COMMERCIAL SALES DIVISION AT (416) 249-4373. <i>Worksheet</i> Note:	
VENDOR TO INSTALL CAPPED GAS LINE (ROUGH-IN ONLY) AT REAR OF HOME FOR FUTURE BBQ LOCATION.   LOCATION TO BE FINALIZED AT VENDORS SOLE DISCRETION AT DECOR APPOINTMENT. <i>Worksheet</i> Note:	
VENDOR TO SUPPLY & INSTALL AIR CONDITIONING UNIT, SIZED ACCORDINGLY, FROM VENDORS STANDARD SAMPLES. <i>Worksheet</i> Note:	

Purchasers: OMAR ARLEY CARMONA MADRIGAL & IRIS IDProperty: 132 BLOCK 124 of Plan - Draft Approval &  
 Telephone Res. / Bus: / Project: KINGSMEN (THAMES) INC.  
 Decor Advisor: Steffanee Appio Model and Elevation: William (2603) Elev B1 4 Bed - 2+1 Bath

Layout Changes: ☒ Yes ☐ No Sketch Attached: ☒ Yes ☐ No Exterior Colour Scheme:

### 1. Cabinetry

	Style and Colour	Counter Top	Hardware
Kitchen / Breakfast	LANCASTER PAINT CHIA SEED	PURE WHITE 1141	9677 HANDLE
Kitchen Island	LANCASTER PAINT CHIA SEED	PURE WHITE 1141	9677 HANDLE
Laundry Room			
Powder Room	MANCHESTER MAPLE CAVIAR	4854K-22 WHITE DI PESCO	151 KNOB
Main Bathroom	MANCHESTER MAPLE CAVIAR	4854K-22 WHITE DI PESCO	151 KNOB
Master Ensuite Bathroom	LANCASTER MAPLE CAVIAR	PURE WHITE 1141	151 KNOB
Second Ensuite Bathroom (If Applicable)			
BUFFET NICHE	LANCASTER PAINT CHIA SEED	PURE WHITE 1141	9677 HANDLE

Appliances Custom Size Fridge ☒ Yes ☐ No Valance Lighting ☐ Yes ☒ No Microwave / Range Hood ☐ Yes ☒ No  
 Cooktop / Rangetop ☒ Yes ☐ No Built in Wall Oven ☒ Yes ☐ No Slide-in Range ☐ Yes ☒ No

Comment

CAESARSTONE COUNTER-TOP IN KITCHEN AND MASTER ENSUITE - STANDARD EDGE PROFILE

### 2. Flooring

	Selection
FOYER	12" X 24" PRIMA WHITE POLISHED - 69-871 STANDARD STACKED INSTALL
Main Hall	3-1/4" VINTAGE SELECT V-HERRINGBONE PEARL ORACLE COLOUR (IN FRONT OF STAIRS)
Back Hall	
Breakfast	12" X 24" PRIMA WHITE POLISHED - 69-871 STANDARD STACKED INSTALL
Laundry Room	12" X 24" PRIMA WHITE POLISHED - 69-871 STANDARD STACKED INSTALL
Kitchen	12" X 24" PRIMA WHITE POLISHED - 69-871 STANDARD STACKED INSTALL
Powder Room	12" X 24" PRIMA WHITE POLISHED - 69-871 STANDARD STACKED INSTALL
Main Bathroom	12" X 24" PRIMA WHITE POLISHED - 69-871 STANDARD STACKED INSTALL
Master Ensuite	12" X 24" PRIMA WHITE POLISHED - 69-871 STANDARD STACKED INSTALL
Bathroom (If Applicable)	
Mud Room	12" X 24" PRIMA WHITE POLISHED - 69-871 STANDARD STACKED INSTALL
Living Room	
Dining Room	3-1/4" VINTAGE SELECT V-HERRINGBONE PEARL ORACLE COLOUR
Family / Great Room	3-1/4" VINTAGE SELECT V-HERRINGBONE PEARL ORACLE COLOUR
Den / Library / Study	
Basement Landing (If Applies)	
Lower Landing (If Applicable)	3-1/4" VINTAGE SELECT V-HERRINGBONE PEARL ORACLE COLOUR
Upper Landing	3-1/4" VINTAGE SELECT V-HERRINGBONE PEARL ORACLE COLOUR
Upper Hall	3-1/4" VINTAGE SELECT V-HERRINGBONE PEARL ORACLE COLOUR
Master Bedroom	MOHAWK LANDSLIDE # 917 JANUARY FROST WITH STANDARD UNDERPAD
Bedroom #2	MOHAWK LANDSLIDE # 917 JANUARY FROST WITH STANDARD UNDERPAD
Bedroom #3	MOHAWK LANDSLIDE # 917 JANUARY FROST WITH STANDARD UNDERPAD
Bedroom #4	MOHAWK LANDSLIDE # 917 JANUARY FROST WITH STANDARD UNDERPAD
Bedroom #5	

Flooring Continued on Page 2

Initial:



Purchasers: OMAR ARLEY CARMONA MADRIGAL & IRIS ID  
Telephone Res. / Bus: /  
Decor Advisor: Steffanee Appio  
Property: 132 BLOCK 124 of Plan - Draft Approval S  
Project: KINGSMEN (THAMES) INC.  
Model and Elevation: William (2603) Elev B1 4 Bed - 2+1 Bath

## 4. Flooring - Continued

Upgrade Underpad	Type	Area
	STANDARD	BEDROOMS ONLY
Carpet on Stairs	Capped	Runner - *Upgrade
Comment		

MOHAWK LANDSLIDE # 917 JANUARY FROST

## 3. Plumbing Fixtures / Faucets

	UPG	Second Ensuite		Powder Room	STD
Kitchen					
Master Ensuite					
Main Bathroom					

## Comment

UPGRADE UNDERMOUNT SINK IN KITCHEN AND UPGRADE SINGLE HOLE FAUCET IN KITCHEN  
UPGRADE UNDERMOUNT SINKS IN MASTER ENSUITE AND UPGRADE SINGLE HOLE FAUCETS

## 4. Wall Tile

	Tile Selection	Listello	Insert	Insert Selection
Main Bathroom	4" X 16" SOHO WHITE GLOSS 60-600	<input type="checkbox"/>	<input type="checkbox"/>	BRICK JOINT INSTALL
Master Ensuite				
Tub Deck	12" X 24" PRIMA WHITE POLISHED 69-871	<input type="checkbox"/>	<input type="checkbox"/>	
Tub Apron	12" X 24" PRIMA WHITE POLISHED 69-871	<input type="checkbox"/>	<input type="checkbox"/>	
Tub Surround	12" X 24" PRIMA WHITE POLISHED 69-871	<input type="checkbox"/>	<input type="checkbox"/>	
Shower Stall	12" X 24" LINEA PRIZMATIC WHITE 69-985 - VERTICAL	<input type="checkbox"/>	<input type="checkbox"/>	
Second Ensuite		<input type="checkbox"/>	<input type="checkbox"/>	
		<input type="checkbox"/>	<input type="checkbox"/>	
		<input type="checkbox"/>	<input type="checkbox"/>	
Kitchen Backsplash		<input type="checkbox"/>	<input type="checkbox"/>	
Complete Backsplash	PURE WHITE 1141 FULL HEIGHT	<input type="checkbox"/>	<input type="checkbox"/>	

## Comment

51-030 SOHO WHITE GLOSSY PENNY ROUND MOSAICS TO  
SHOWER FLOOR IN MASTER ENSUITE

horizontal stacked

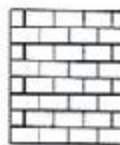

brick pattern



vertical stacked



diagonal/diamond

## 5. Fireplace

	Living Room			Family Room			Other Room - Specify		
	Purchased	As Per Plan	N/A	Purchased	As Per Plan	N/A	Purchased	As Per Plan	N/A
Fireplace Type	<input type="radio"/>	<input type="radio"/>	<input type="radio"/>	<input type="radio"/>	<input checked="" type="radio"/>	<input type="radio"/>	<input type="radio"/>	<input type="radio"/>	<input type="radio"/>
Mantle Type				STANDARD					
Over Mantle				STANDARD					
Colour / Stain									
Surround									
Hearth									
Comment									

Initial:

D C J

Purchasers: OMAR ARLEY CARMONA MADRIGAL & IRIS ID Property: 132 BLOCK 124 of Plan - Draft Approval S  
 Telephone Res. / Bus: / Project: KINGSMEN (THAMES) INC.  
 Decor Advisor: Steffanee Appio Model and Elevation: William (2603) Elev B1 4 Bed - 2+1 Bath

### 6. Trim Carpentry

Door Hardware HALIFAX MATTE BLACK UPGRADE

Interior Trim 3-1/2" STEP BEVEL CASING - 5-1/2" STEP BEVEL BASEBOARD

Comment

Interior Doors

☐ 2 Panel Arch Top

☒ 2 Panel Square Top

☐ 6 Panel



Initial for Door Style

### 7. Railings and Pickets

Railing Package UPGRADE 4 METAL

Railing Colour ORACLE

Picket Colour FLAT BLACK

Wood Stairs ☐ No ☒ Oak

Tread Colour ORACLE

Comment

STAIN OAK STAIRS TO COMPLIMENT HARDWOOD - VINTAGE ORACLE COLOUR  
 HANDRAIL MOD RECTANGLE / PICKETS STEEL 1/2" ROUND PLAIN 496/1 WITH SHOES/POSTS 3-1/2" SQUARE  
 CHAMFERED WITH CAP OAK

### 8. Plaster Mouldings and Medallions

Foyer

Main Hall

Living Room

Dining Room

Family Room

Kitchen/Breakfast

Den/Library

Lower Landing

Comment

### 9. Wall Paint

STANDARD KINGSMEN WHITE

Smooth Ceilings

☐ First Floor

☐ First Floor incl. Second Floor Hall

☒ First and Second Floor

☐ Throughout

☐ Not Applicable

Trim Paint

### 10. Additional Comments

### 11. Disclaimers and Notes

- Colours of all materials are as close as possible to builder's selection, but not necessarily identical due to variances in manufacturing.
- Any extras listed above are null and void unless accompanied by a separate invoice/amendment. Said invoice must be paid in full.
- The Purchaser acknowledges that after Interior Colour Selection form is signed and dated, no further changes will be permitted other than re-selection due to unavailability. 3.3.3 Purchaser's Initials
- The Purchaser acknowledges reading and accepting the "Kingsmen Group Décor Centre Disclaimers" form. This document contains other miscellaneous disclaimers.

This Interior Colour Selection form is approved by:

Purchaser

Signature

Date:

Signature

Date:

Vendor:

KINGSMEN (THAMES) INC.



END MODEL

# William

B1/B2A

2120 SQ. FT.



## MAIN FLOOR

4A-10†132



**B1**

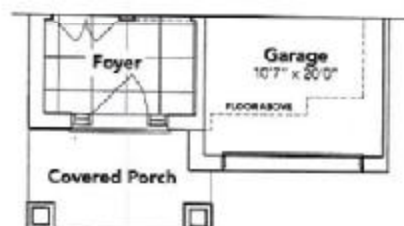

This sketch is provided solely for reference to those items noted on the accompanying "Upgrades/Excludes" sheet. All other details, dimensions & layouts are for illustrative purposes only and may not be applicable to the Purchaser's Model.

Site W1112 Lot 17a

Date: 02/01/19

Purchaser Initials lca Production Initials \_\_\_\_\_



# SECOND FLOOR

KINGSIIEN GROUP INC.

4A-10132

(X) dropped outlet

## OPT. SECOND FLOOR



B1



## BASEMENT

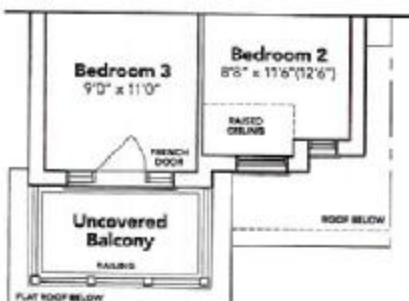
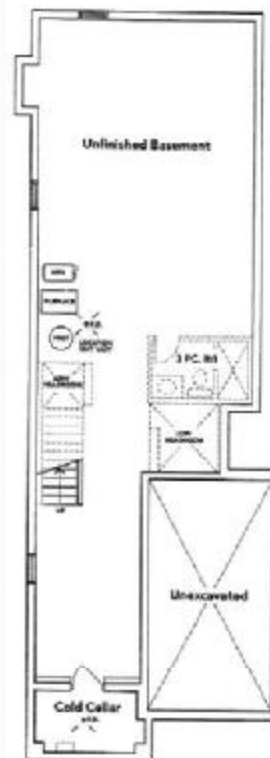

B2A



B2A

HAVELOCK CORNERS WOODSTOCK

All prices, figures, sizes, specifications and information are subject to change without notice. Dimensions are approximate. Actual floor area, including lines and square footage may vary from stated floor area. F. & O. Model 2803.

This sketch is provided solely for illustrative purposes only and may not be applicable to the Purchaser's Model.

Site Woodstock Lot 132  
Date 6/20/19  
Purchaser Initials lc Production Initials oc

Circle  
Telephone  
Play

# Kitchen



**FRENDEL'S**  
KITCHENS LIMITED  
1330 Preston Blvd. Mississauga, Ont. L4W 1C3

## Kingsmen

Havelock Corners PH 4  
(Woodstock)

William/2603 LOT 132

### STANDARD FEATURES:

- Blum standard hinges
- Blum Metabox drawers
- Backing on kitchen cabinets
- 100cm Uppers
- Opening for ~~36"~~ 48" fridge
- Bank of drawers as specified on plan
- Laminate countertops

• waterfall sides

4A-104132

Drawn By: Bethany  
Date: June 20, 2014  
Scale: Not To Scale

Approved By: *client*  
*cc*

Date: 6/20/14

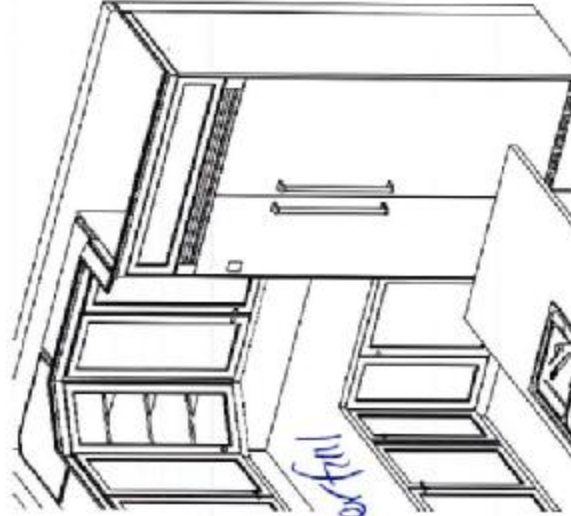
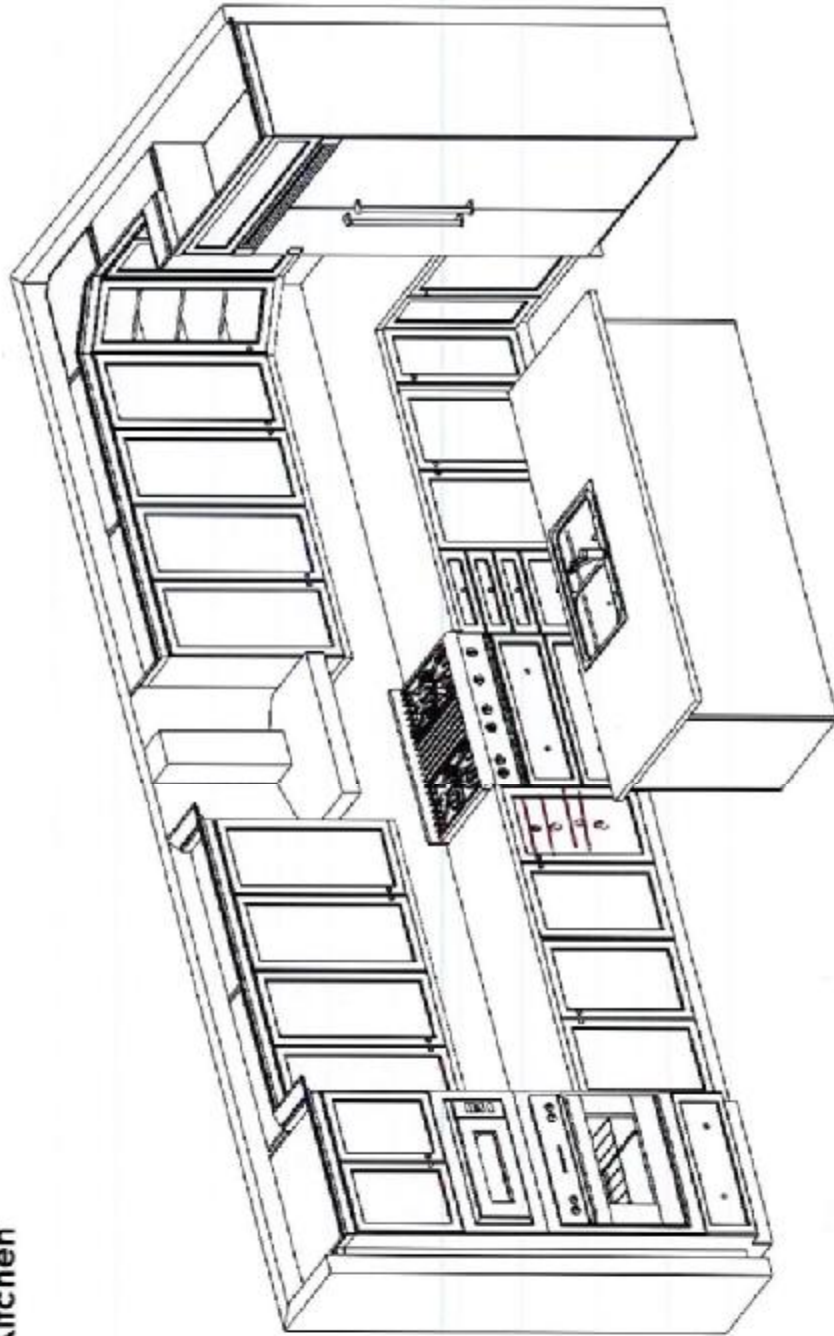

- Extend uppers and base to nib wall at breakfast area
- Extended island (8')
- Angled corner upper w/glass (confirm fin. Interior and glass type)
- Base pie cut cabinet
- 45cm waste centre
- 36" range top w/pot drawers below
- 48" Built in fridge
- 30" built in oven w/drawer below
- ~~Crown moulding~~
- Light valance



waterfall

waterfall sides

This sketch is for DESIGN PURPOSES ONLY – It is not meant to be an exact rendition.



## Kitchen

Havelock Corners PH 4  
(Woodstock)

William/2603 LOT 132

#### STANDARD FEATURES:

- Blum standard hinges
- Blum Metabox drawers
- Backing on kitchen cabinets
- 100cm Uppers
- Opening for ~~240mm~~ 418
- Bank of drawers as specified on plan
- Laminate countertops

• water-fall sides

Drawn By: Bethany O  
Date: June 20, 2019  
Scale: Not To Scale

Approved By Bulkier:

Date:

4A-10t132

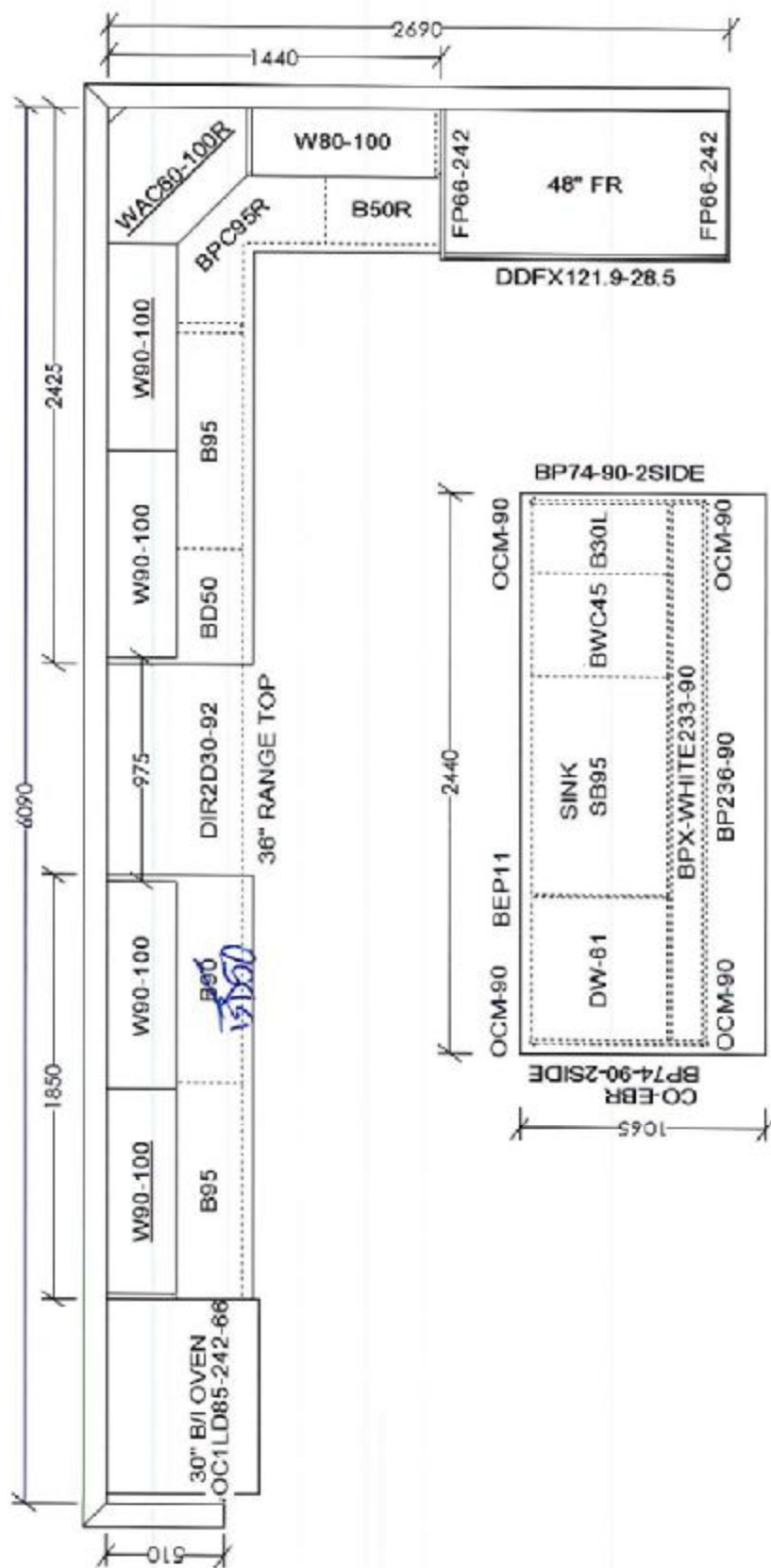

**This sketch is for DESIGN PURPOSES ONLY – It is not meant to be an exact rendition.**

4A-107132



## KitchenAid Model: KVWB606HBS

36" Wall-Mount, 3-Speed Canopy Hood

Color  Black Stainless Steel with PrintShield™ Finish

### Product Description

The power of this 36-inch vent hood effectively vents most cooking surfaces. One of the premium features of this vent hood is auto speed sensing that adjusts fan speed to help protect cabinets from potentially harmful steam, grease, and odors. The sharp, glass-touch display showcases easy-to-use touch controls.

### Specifications

#### Certifications

Prop 65	 CALIFORNIA RESIDENTS ONLY - WARNING: Cancer and Reproductive Harm - www.P65Warnings.ca.gov
---------	--

#### Details

Task Light Type	LED
Number of Night Light	1
Night Light Type	Halogen
Task Lighting	Yes
Night Light	Yes
Number of Task Light	1

#### Dimensions

Width	91.44 36.0
Height	62.55 24-5/8
Depth	50.01 19-11/16

#### Dimensions

Gross Weight	153.42 60-2/5
--------------	------------------

#### Refinements

Features	Perimeter Ventilation
----------	-----------------------

#### Certifications

Prop 65	 CALIFORNIA RESIDENTS ONLY - WARNING: Cancer and Reproductive Harm - www.P65Warnings.ca.gov
UL	UL
Size	91.44 36
Hood Type	Wall Mount

### Ventilation System

Filters	Dishwasher-Safe Grease
Auto Function	Auto On and Speed Adjust
Duct Outlet Size	6
Blower Type	Centrifugal
Duct Direction	Vertical
Duct Type	Round
Sound Min Speed dBA	49-1/2
Sound Max Speed Sones	5-2/5
Number of Speeds	3
Sound Max Speed	65.0
Sound Min Speed Sones	1-1/2

### Key Features

Seuil de 65 000 BTU, 585 pi cu/min.  
Perimeter Ventilation  
Auto Speed Setting  
LED Task Lights  
Halogen Night Lights  
3-Speed Electronic Glass Touch Control with Boost  
Whisper Quiet® System @ 49 dBA (1.5 sones) at Low  
Dishwasher Safe Grease Filters  
Easy In-line Conversion

### UPC Listing

Model : KVWB606DBS	UPC : 883049364964
Model : KVWB606DSS	UPC : 883049328201
Model : KVWB606HBS	UPC : 883049484099

This sketch is provided solely for reference to those items noted on the accompanying "Upgrades/Extras". All other details, dimensions & layouts are for illustrative purposes only and may not be applicable to the Purchaser's Model

Site Woodstock Lot 132  
Date 10/20/19  
Purchaser Initials acw Production Initials \_\_\_\_\_

4A-10132

# KitchenAid®

FOR THE WAY IT'S MADE™

## 30" (72.6 cm) and 36" (91.4 cm) Wall-Mount Canopy Range Hood

### PRODUCT MODEL NUMBERS

KAWB600D

KVWB600D

**Electrical:** A 120 volt, 60 Hz., AC only, 15-amp, fused electrical circuit is required.

### VENTING METHODS

This canopy range hood is factory set for venting through the roof or through the wall.

A 6" (15.2 cm) round vent system is needed for installation (not included). The hood exhaust opening is 6" (15.2 cm) round.

**NOTE:** Flexible vent is not recommended. Flexible vent creates back pressure and air turbulence that greatly reduce performance.

Vent system can terminate either through the roof or wall. To vent through a wall, a 90° elbow is needed.

### Rear Discharge

A 90° elbow may be installed immediately above the hood.

### For Non-Vented (Recirculating) Installations

If it is not possible to vent cooking fumes and vapors to the outside, the hood can be used in the non-vented (recirculating) version, using a Recirculation Kit (which includes charcoal filters and a deflector). To order, see the "Assistance or Service" section.

#### Roof Venting

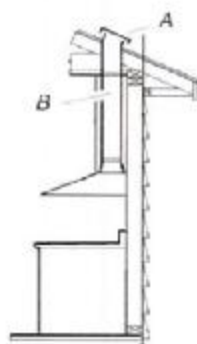

A. Roof cap  
B. 6" (15.2 cm) round vent

#### Wall Venting

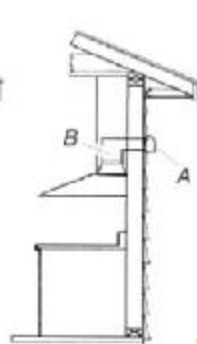

A. Wall cap  
B. 6" (15.2 cm) round vent

#### Non-Vented (Recirculating)

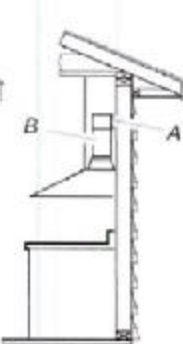

A. Deflector  
B. 6" (15.2 cm) round vent

### Calculating Vent System Length

To calculate the length of the system you need, add the equivalent feet (meters) for each vent piece used in the system.

#### Vent System

Vent Piece	6" (15.2 cm) Round	
45° elbow	2.5 ft (0.8 m)	
90° elbow	5.0 ft (1.5 m)	

Maximum equivalent vent length is 35 ft (10.7 m).

### Example Vent System

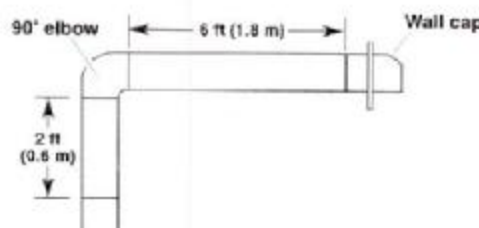

The following example falls within the maximum recommended vent length of 35 ft (10.7 m).

1 - 90° elbow	= 5.0 ft (1.5 m)
1 - wall cap	= 0.0 ft (0.0 m)
8 ft (2.4 m) straight	= 8.0 ft (2.4 m)
Length of system	= 13.0 ft (3.9 m)

### PRODUCT DIMENSIONS

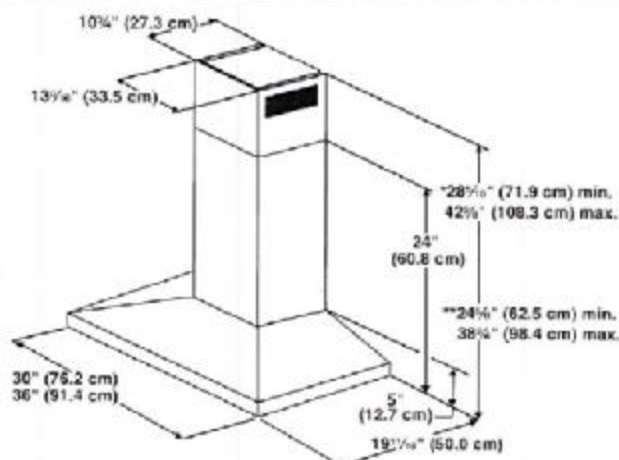

\* For non-vented (recirculating) installations

\*\* For vented installations

This sketch is provided solely for reference to those items noted on the accompanying "Upgrades/Extras". All other details, dimensions & layouts are for illustrative purposes only and may not be applicable to the Purchaser's Model.

Site Woodstock Lot 132

Date 6/20/19

Purchaser Initials WJ Production Initials \_\_\_\_\_



4A10132

# CABINET DIMENSIONS

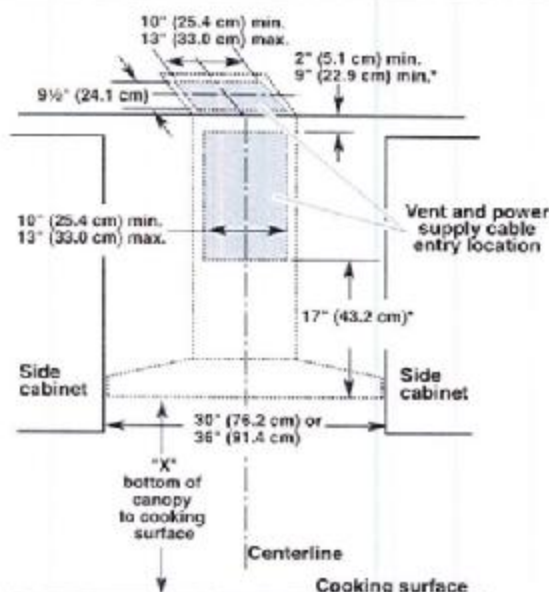

\*For non-vented (recirculating) installations

## IMPORTANT:

- Minimum distance "X": 24" (61.0 cm) from electric cooking surface.
- Minimum distance "X": 27" (68.6 cm) from gas cooking surfaces.
- Suggested maximum distance "X": 36" (91.4 cm)

The chimneys can be adjusted for different ceiling heights. See the following chart.

Vented Installations		
	Min. ceiling height	Max. ceiling height
Electric cooking surface	7' 1" (2.16 m)	9' 2" (2.79 m)
Gas cooking surface	7' 4" (2.23 m)	9' 2" (2.79 m)
Non-vented (recirculating) Installations		
	Min. ceiling height	Max. ceiling height
Electric cooking surface	7' 1" (2.16 m)	9' 6" (2.9 m)
Gas cooking surface	7' 4" (2.23 m)	9' 6" (2.9 m)

**\*NOTE:** The range hood chimneys are adjustable and designed to meet varying ceiling or soffit heights depending on the distance "X" between the bottom of the range hood and the cooking surface. For higher ceilings, a Chimney Extension Kit is available from your dealer or an authorized parts distributor. The chimney extension replaces the chimney shipped with the range hood. To order, see the "Assistance or Service" section.

This sketch is provided solely for reference to those items noted on the accompanying "Upgrades/Extras". All other details, dimensions & layouts are for illustrative purposes only and may not be applicable to the Purchaser's Model.

Site Winstock Lot 132

Date 6/20/19

Purchaser Initials ou Production Initials \_\_\_\_\_

4A-10132



## KitchenAid Model: KGCU467VSS

36-Inch 6-Burner Gas Rangetop, Commercial-Style

Color   Stainless Steel

### Product Description

With six burners, this 36-inch gas rangetop has a commercial appeal that will satisfy even the most discriminating cooks. You'll enjoy both power and versatility with two 20K BTU Ultra Power™ Dual-Flame Burners. A 5K BTU simmer/melt burner will help you maintain the low temperatures needed for melting or gentle simmering.

### Specifications

#### Certifications

ADA Compliant	Yes
Prop 65	 CALIFORNIA RESIDENTS ONLY - WARNING: Cancer and Reproductive Harm - www.P65Warnings.ca.gov

#### Appearance

Digital Display	No
-----------------	----

#### Controls

Knob Color	Color Coordinated/Black on
Infinite Heat Controls	Yes

#### Dimensions

Cutout Depth	56.52 22-1/4
Cutout Width	89.54 35-1/4
Width	91.28 35-15/16
Height	19.05 7-1/2
Depth	70.64 27-13/16

#### Refinements

Features	20K BTU Dual-Ring Burner Even-Heat Melt Burner
----------	---

#### Dimensions

Gross Weight	322.58 127.000
--------------	-------------------

### Cooktop Details

Left Rear Element-Burner	Professional
Center Rear Element-Burner	5000 BTU
Left Front Element-Burner	Ultra Power™ Dual-Flame
Center Rear Element-Burner	Simmer
Cooktop Element Style	Sealed Burner
Right Rear Element-Burner	Professional
Left Rear Element-Burner	15,000 BTU
Center Front Element-	Professional
Cooktop Surface Material	Porcelain Coated Steel
Number of Open Bays	NA
Number of Grates	6
Left Front Element-Burner	20,000 BTU
Heating Element On	No
Automatic Pan Detection	No
Number of Cooking Element-	6
Power Outage Compatible	Yes
Right Rear Element-Burner	15,000 BTU
Downdraft Vent	No
Center Front Element-	15,000 BTU
Hot Surface Indicator Light	No
Right Front Element-Burner	Ultra Power™ Dual-Flame
Ignition Type	Direct Spark Ignition
Grate Details	Matte Finish Continuous Cast Iron Grates
Right Front Element-Burner	20,000 BTU

This sketch is provided solely for reference to those items noted on the accompanying "Upgrades/Extras". All other details, dimensions & layouts are for illustrative purposes only and may not be applicable to the Purchaser's Model

Site Woodstock Lot 132  
 Date 6/26/19  
 Purchaser Initials ac Production Initials \_\_\_\_\_

4A-10132

**Certifications**

LP Convertible	Yes - Kit Included
Cooktop Type	Standard
Prop 65	 CALIFORNIA RESIDENTS ONLY - WARNING: Cancer and Reproductive Harm - www.P65Warnings.ca.gov
UL	UL
Size	91.44 36
Installs Over Built-In Oven	No
ADA Compliant	Yes
Power Boost	No
Fuel Type	Gas

**Key Features**

LP Conversion Kit Included  
 5K BTU Simmer/Melt Burner  
 Continuous Surface with Heavy-Duty Grates  
 Commercial-Style Design with Bold, Heavy-Duty Look  
 Three 15K BTU Professional Burners  
 Two 20K BTU Ultra Power™ Dual-Flame Burners

**Electrical Requirements**

Power Cord Included Yes  
 Hz 60

**UPC Listing**

Model : KGCU467VSS      UPC : 883049155944

This sketch is provided solely for reference to those items  
 noted on the accompanying "Upgrades/Extras". All other  
 details, dimensions & layouts are for illustrative purposes  
 only and may not be applicable to the Purchaser's Model

Site Woodstock Lot 132  
 Date 6/6/19  
 Purchaser Initials OCW Production Initials \_\_\_\_\_



4A-10132

# KitchenAid® Commercial Style Gas Cooktop

FOR THE WAY IT'S MADE.®

## PRODUCT MODEL NUMBERS

KGCCU407V      KGCU482V  
 KGCU402V      KGCU483V  
 KGCU463V      KGCU484V  
 KGCU467V

### Type of Gas

Natural Gas:

This cooktop is factory-set for use with Natural gas. To convert to LP gas, see the Gas Conversion instructions provided in the package containing literature. The model/serial rating plate located on the left underside of the cooktop burner base has information on the types of gas that can be used. If the types of gas listed do not include the type of gas available, check with the local gas supplier.

### LP Gas conversion:

Conversion must be done by a qualified service technician. No attempt shall be made to convert the cooktop from the gas specified on the model/serial rating plate for use with a different gas without consulting the serving gas supplier. To convert to LP gas, use the LP gas conversion kit provided with the cooktop and see the "Gas Conversions" section.

### Gas Supply Line

- Provide a gas supply line of 3/4" (1.9 cm) rigid pipe to the cooktop location. A smaller size pipe on longer runs may result in insufficient gas supply. With LP gas, piping or tubing size can be 1/2" (1.3 cm) minimum. Usually, LP gas suppliers determine the size and materials used in the system.

**NOTE:** Pipe-joint compounds that resist the action of LP gas must be used. Do not use TEFLON® tape.

### Flexible metal appliance connector:

- If local codes permit, a new CSA design-certified, 4 - 5 ft (122 - 152.4 cm) long, 3/8" (1.6 cm) or 1/2" (1.9 cm) I.D., flexible metal appliance connector may be used for connecting the cooktop to the gas supply line.



- Must include a shutoff valve:

The supply line must be equipped with a manual shutoff valve. This valve should be located in the same room but external to the cooktop enclosure or cabinet. It should be in a location that allows ease of opening and closing. Do not block access to shutoff valve. The valve is for turning on or shutting off gas to the cooktop.

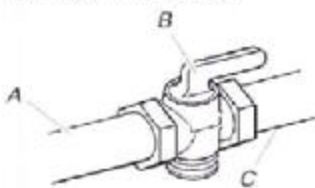

A. Gas supply line  
 B. Shutoff valve "open" position  
 C. To cooktop

### Electrical:

A 120-volt, 60-Hz, AC-only, 15-amp, fused electrical circuit is required. A time-delay fuse or circuit breaker is also recommended. It is recommended that a separate circuit serving only this cooktop be provided.

®TEFLON is a registered trademark of E. I. Du Pont De Nemours and Company.

## LOCATION REQUIREMENTS

**IMPORTANT:** Observe all governing codes and ordinances. Do not obstruct flow of combustion and ventilation air.

It is the installer's responsibility to comply with installation clearances specified on the model/serial rating plate. The model/serial rating plate is located on the underside of the cooktop burner base.

It is recommended that a 600 CFM or larger vent hood be installed above the cooktop.

It is not recommended that a microwave hood combination be mounted above the cooktop.

The cooktop should be installed in a location away from strong draft areas, such as windows, doors and strong heating vents or fans.

All openings in the wall or floor where cooktop is to be installed must be sealed.

Cabinet opening dimensions that are shown must be used. Given dimensions are minimum clearances.

**IMPORTANT:** To avoid damage to your cabinets, check with your builder or cabinet supplier to make sure that the materials used will not discolor, delaminate or sustain other damage.

## PRODUCT DIMENSIONS

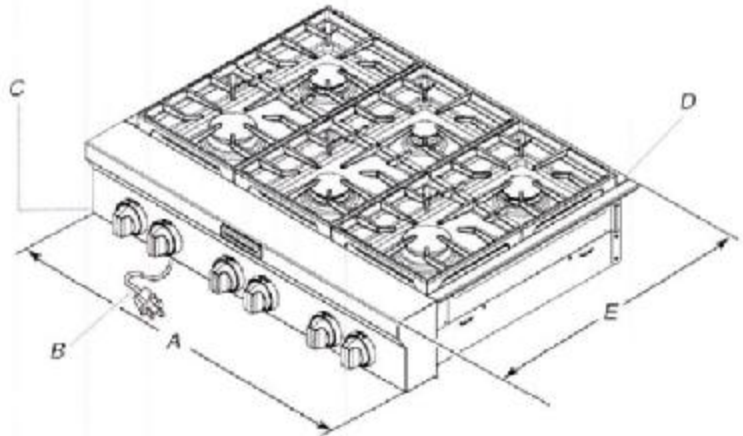

- A. 30" (76.2 cm) cooktop: 29 1/2" (75.9 cm)  
 36" (91.4 cm) cooktop: 35 1/2" (91.1 cm)  
 48" (121.9 cm) cooktop: 47 1/2" (121.6 cm)  
 B. 36" (91.4 cm) long 3 prong grounding-type power supply cord

- C. Model/serial rating plate (located on the underside of the cooktop burner base)  
 D. Island trim or optional backguard  
 E. 27 1/4" (70.5 cm)

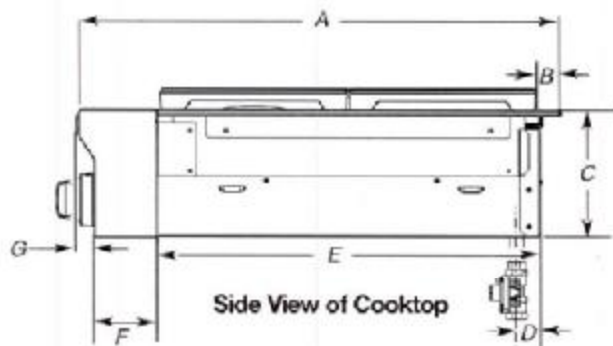

- A. 27 1/4" (70.5 cm)  
 B. 1 1/4" (3.2 cm)  
 C. 7 1/8" (18.8 cm)  
 D. Gas inlet is located 1 1/8" (4.8 cm) from the back of the cooktop burner base and 4 3/8" (12.4 cm) in from left-hand side of the cooktop burner base.

- E. 22" (55.9 cm)  
 F. 3 3/8" (9.2 cm)  
 G. 1" (2.6 cm)

This sketch is provided solely for reference to those items noted on the accompanying "Upgrades/Extras". All other details, dimensions & layouts are for illustrative purposes only and may not be applicable to the Purchaser's Model

Site Westport Lot 130

Date 6/20/19

Purchaser Initials W Production Initials W



4A10132

# CABINET REQUIREMENTS

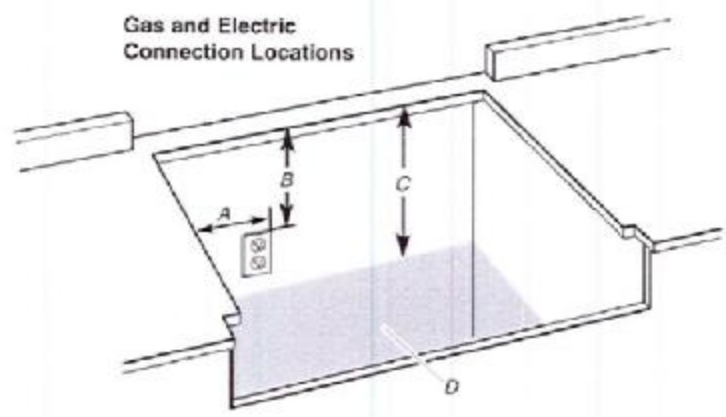

- A. Grounded 3-prong outlet should be located on left-hand side of the cutout 18" (45.7 cm) max. from enclosure sidewall
  - B. 10" (25.4 cm) min. clearance from countertop to top of the outlet
  - C. 14" (35.6 cm) countertop to the gas supply line
  - D. Gas supply line should be located in this area on rear or side walls, or the supply line can come up through the floor.
- NOTE:** Solid side and bottom of cutout enclosure not shown.

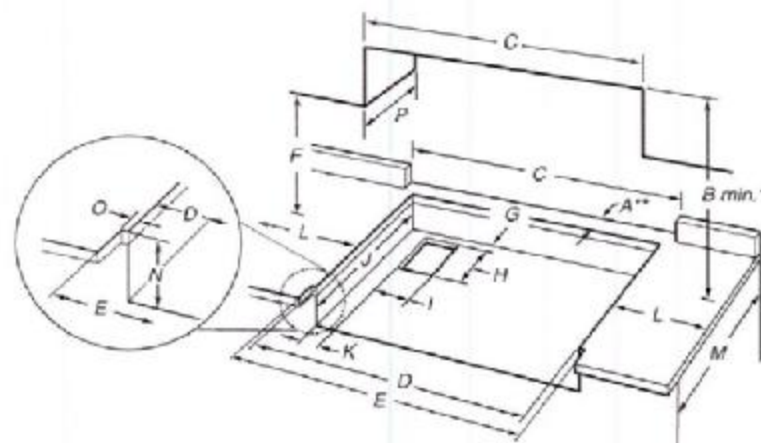

- A. See chart
- B. See chart
- C. See chart
- D. See chart
- E. See chart
- F. 18" (45.7 cm) min. clearance upper cabinet to countertop
- G. 3/4" (1.9 cm) back of cabinet cutout to gas opening cutout
- H. 6 3/8" (16.1 cm) gas opening cutout depth
- I. 12 1/2" (31.7 cm) gas opening cutout width
- J. 22 1/2" (56.5 cm) cabinet cutout depth
- K. 2" (5.1 cm) cabinet side to gas cutout
- L. 6" (15.2 cm) min. distance on both sides of the cooktop to the side wall or other combustible material above cooking surface
- M. 24" (61.0 cm) cabinet depth
- N. 7 1/4" (18.4 cm) cabinet depth to countertop
- O. Notch to be equal on both sides
- P. 13" (33.0 cm) upper cabinet depth

Size	Model	A** Cooktop Cutout to Back Wall	B* Cooktop to Cabinet	C Optional Backguard Opening	D Cabinet and Countertop	E Countertop Only
30" (76.2 cm)	<del>KGCU467</del>	1 3/4" (4.4 cm)**	30" (76.2 cm)	30" (76.2 cm)	29 1/4" (74.3 cm)	30" (76.2 cm) or 29 3/4" (75.9 cm) for zero clearance
36" (91.4 cm)	<del>KGCU462</del> <del>KGCU465</del> KGCU467	1 1/2" (3.8 cm)** 1 3/4" (4.4 cm) 1 3/4" (4.4 cm)	42" (106.7 cm)	36" (91.4 cm)	35 1/4" (89.5 cm)	36" (91.4 cm) or 35 3/4" (91.1 cm) for zero clearance
48" (121.9 cm)	<del>KGCU482</del> <del>KGCU465</del> <del>KGCU467</del>	1 1/2" (3.8 cm)** 1 3/4" (4.4 cm)** 1 1/2" (3.8 cm)**	42" (106.7 cm)	48" (121.9 cm)	47 1/4" (120.0 cm)	48" (121.9 cm) or 47 1/2" (121.6 cm) for zero clearance

**\*NOTES:** Dimension "B" can be reduced by 6" (15.2 cm) when bottom of wood or metal cabinet is covered by not less than 0.25" (6.4 mm) flame retardant millboard covered with not less than No. 28 MSG sheet metal, 0.015" (0.4 mm) stainless steel, 0.024" (0.6 mm) aluminum or 0.020" (0.5 mm) copper.

If installing a range hood above the cooktop, follow the range hood instructions for dimensional clearances above the cooktop surface.

**\*\*NOTE:** If backwall is constructed of a combustible material and a backguard is not installed, a minimum clearance of dimension A + 6" (15.2 cm) is required for 48" (121.9 cm) cooktops and cooktops with a grill.

This sketch is provided solely for reference to those items noted on the accompanying "Upgrades/Extras". All other details, dimensions & layouts are for illustrative purposes only and may not be applicable to the Purchaser's Model.

Site Wentstock Lot 132

Date 6/26/19

Purchaser Initials cc. W Production Initials \_\_\_\_\_

4A-10132



## KitchenAid Model: KOCE500EBS

30" Combination Wall Oven with Even-Heat™ True Convection (Lower Oven)

Color  Black Stainless Steel with PrintShield™ Finish

### Product Description

This 30" Combination Wall Oven with Even-Heat™ True Convection provides consistent heating and even cooking. A unique bow-tie shaped design and convection fan helps ensure there are no burnt edges or undercooked centers. Its upper Microwave Convection Cooking Oven combines a 900 watt microwave with a 1600 watt convection element for high speed cooking. Bold design details are the perfect balance of elegance and functionality.

### Specifications

#### Certifications

ADA Compliant	No
Prop 65	 CALIFORNIA RESIDENTS ONLY - WARNING: Cancer and Reproductive Harm - www.P65Warnings.ca.gov

#### Details

Self-Cleaning Oven Racks	No
Broiler Location	Top of Oven
Door Broil Position	Closed
Language Conversion	English/French
Oven Cooking System	Convection
Number of Oven Racks	3
Convection Functions	Bake Broil Roast
Oven Light Type	Halogen
Oven Self-Cleaning	Adjustable Self Cleaning
Oven Interior Width	63.50 25.0
Door Lock	Yes
Oven Rack 2 Type	Standard
Bake Element Power	2800W
Number of Rack Guides	6
Interior Color	Black
Oven Interior Height	45.72 18.0
Door Removable	Yes
Hidden Bake Element	Yes
Automatic Shut-Off	Yes
Oven Rack 1 Type	Standard
Oven Interior Depth	48.26 19.0
Number of Oven Lights	2
Oven Rack 3 Type	Gliding Roll-Out

#### Microwave Details

Grill Power	1600.0
Door Swing	Drop Down
Turntable	Yes
Grill	Yes
Cooking Power	900
Microwave Selections	Baking Rack Add A Minute Cook Power Cook Time Crisp Pan Defrost Easy Convection Popcorn Reheat Soften/Melt Steam Steam Accessory
Convection Power	1600
Turntable Diameter Size	35.88 14-1/8
Interior Light	Halogen
Convection	Yes
Sensor Cooking	Yes - Microwave

#### Configuration

Oven Configuration	Microwave Combination
--------------------	-----------------------

#### Details

Oven Cleaning Type	Adjustable Self Cleaning
--------------------	--------------------------

#### Appearance

Flush Installation Approved	Yes
Handle Material	Metal
Door Type	Metal & Glass
Handle Color	Stainless Steel

This sketch is provided solely for reference to those items noted on the accompanying "Upgrades/Extras". All other details, dimensions & layouts are for illustrative purposes only and may not be applicable to the Purchaser's Model.

Site Woodsstock Lot 132  
Date 6/26/19  
Purchaser Initials o.w Production Initials \_\_\_\_\_



4A40132

# Dimensions

Cutout Depth	60.96 24.0
Depth Closed Excluding	62.23 24-1/2
Cutout Width	72.39 28-1/2
Capacity	6-2/5
Cutout Height	104.93 41-5/16
Depth With Door Open 90	118.74 46-3/4
Width	76.20 30.0
Height	107.95 42-1/2
Oven Capacity	141.50 5.0
Microwave Capacity	39.62 1.4
Depth	68.90 27-1/8

# Refinements

Features	Even-Heat™ True EasyConvect™ Conversion FIT System Self Clean SatinGlide™ Roll Out
----------	--

# Dimensions

Gross Weight	670.56 264.000
--------------	-------------------

# Certifications

Prop 65	 CALIFORNIA RESIDENTS ONLY - WARNING: Cancer and Reproductive Harm - <a href="http://www.P65Warnings.ca.gov">www.P65Warnings.ca.gov</a>
UL	UL
Size	76.20 30
Oven Type	Combination
ADA Compliant	No
CUL	Yes
Fuel Type	Electric

# Key Features

Even-Heat™ True Convection Oven (Lower Oven)  
Microwave Convection Cooking (upper oven)  
Professionally-Inspired Design (VBL Light)  
Temperature Probe  
EasyConvect™ Conversion System  
5.0 Cu. Ft. Capacity (lower oven)  
1.4 Cu. Ft. Capacity (upper oven)  
Crispwave™ Microwave Technology and Crisper Pan  
SatinGlide™ Roll-Out Extension Rack (lower oven)

# Electrical Requirements

Power Cord Included No  
Hz 60

# UPC Listing

Model : KOCE500EBL UPC : 883049327372  
Model : KOCE500EBS UPC : 883049363004  
Model : KOCE500ESS UPC : 883049327389  
Model : KOCE500EWH UPC : 883049327396

This sketch is provided solely for reference to those items  
noted on the accompanying "Upgrades/Extras". All other  
details, dimensions & layouts are for illustrative purposes  
only and may not be applicable to the Purchaser's Model  
Site Woodstock Lot 132  
Date 6/20/19  
Purchaser Initials ocw Production Initials \_\_\_\_\_

4A-10132

# KitchenAid® 27" (68.6 cm) and 30" (76.2 cm) Electric Built-In Microwave/Oven Combination

## PRODUCT MODEL NUMBERS

KEMS309E

KOCE500E

KOCE507E

## ELECTRICAL CONNECTION

If codes permit and a separate ground wire is used, it is recommended that a qualified electrical installer determine that the ground path and the wire gauge are in accordance with local codes. Check with a qualified electrical installer if you are not sure the oven is properly grounded.

This oven must be connected to a grounded metal, permanent wiring system.

Be sure that the electrical connection and wire size are adequate and in conformance with the National Electrical Code, ANSI/NFPA 70-latest edition or CSA Standards C22.1-94, Canadian Electrical Code, Part 1 and C22.2 No. 0-M91-latest edition, and all local codes and ordinances.

To properly install your oven, you must determine the type of electrical connection you will be using and follow the instructions provided for it here.

- Oven must be connected to the proper electrical voltage and frequency as specified on the model/serial/rating plate. See the following illustration.



A. Model/serial/rating plate

- Models rated from 7.3 to 9.6 kW at 240 volts (5.4 to 7.4 kW at 208 volts) require a separate 40-amp circuit. Models rated at 4.8 kW and below at 240 volts (3.8 kW and below at 208 volts) require a separate 30-amp circuit.
- A circuit breaker is recommended.
- Connect directly to the fused disconnect (or circuit breaker box) through flexible, armored or nonmetallic sheathed, copper cable (with grounding wire). See "Make Electrical Connection" section.
- Flexible conduit from the oven should be connected directly to the junction box.
- Do not cut the conduit. The length of conduit provided is for serviceability of the oven.
- A UL listed or CSA approved conduit connector must be provided.
- If the house has aluminum wiring, follow the procedure below:
  - Connect a section of solid copper wire to the pigtail leads.
  - Connect the aluminum wiring to the added section of copper wire using special connectors and/or tools designed and UL listed for joining copper to aluminum.

Follow the electrical connector manufacturer's recommended procedure. Aluminum/copper connection must conform with local codes and industry accepted wiring practices.

For power requirements, refer to the following table.

Model	Voltage	Amperage (L1)*	Amperage (L2)*	Rating (W)
KOCE507E/KOCE500E	120/240	32	30	8000
KOCE507E/KOCE500E	120/208	30	28	6600

\*Amperage values noted above are for information purposes only; the units are rated in watts.

## PRODUCT DIMENSIONS

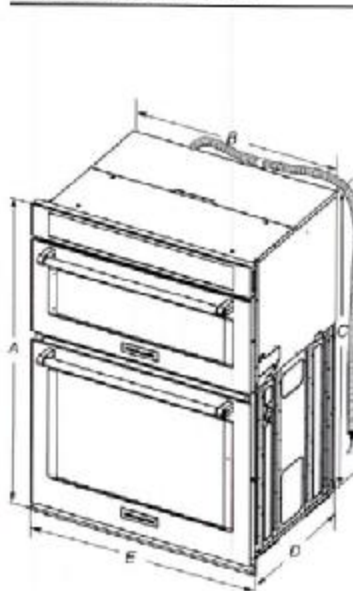

- 27" (68.6 cm) models**
- A. 42 1/4" (108.0 cm) overall height
  - B. 25 1/4" (64.6 cm) recessed width
  - C. 41" (104.1 cm) recessed height
  - D. 23 1/4" (59.1 cm) max. recessed depth
  - E. 27" (68.6 cm) overall width
  - F. 48" (121.9 cm) flexible conduit length measured from the conduit clamp located at the rear of the oven. Do not remove the conduit clamp.
- 30" (76.2 cm) models**
- A. 42 1/4" (108.0 cm) overall height
  - B. 28 1/4" (72.3 cm) recessed width
  - C. 41" (104.1 cm) recessed height
  - D. 23 1/4" (59.1 cm) max. recessed depth
  - E. 30" (76.2 cm) overall width
  - F. 48" (121.9 cm) flexible conduit length measured from the conduit clamp located at the rear of the oven. Do not remove the conduit clamp.

## Cabinet Dimensions

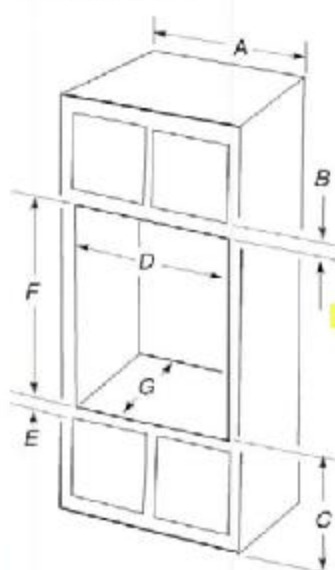

- 27" (68.6 cm) models**
- A. 27" (68.6 cm) min. cabinet width
  - B. 1" (2.5 cm) top of cutout to bottom of upper cabinet door
  - C. 19 1/4" (48.9 cm) bottom of cutout to floor is recommended. 4"-19 1/4" (10.2-48.9 cm) bottom of cutout to floor is acceptable.
  - D. 25 1/4" (64.6 cm) cutout width
  - E. 1 1/2" (3.8 cm) min. bottom of cutout to top of cabinet door
  - F. 41 1/4" (105 cm) recommended cutout height
  - G. 24" (60.7 cm) cutout depth
- 30" (76.2 cm) models**
- A. 30" (76.2 cm) min. cabinet width
  - B. 1" (2.5 cm) top of cutout to bottom
  - C. 19 1/4" (48.9 cm) bottom of cutout to floor is recommended. 4"-19 1/4" (10.2-48.9 cm) bottom of cutout to floor is acceptable.
  - D. 28 1/4" (72.4 cm) cutout width
  - E. 1 1/2" (3.8 cm) min. bottom of cutout
  - F. 41 1/4" (105 cm) recommended cutout
  - G. 24" (60.7 cm) cutout depth

\* NOTE: The cabinet height can be between 41" (104.1 cm) and 41 1/4" (105.6 cm) for microwave/oven combination.

Because Whirlpool Corporation includes a continuous commitment to improve our products, we reserve the right to change materials and specifications without notice.

Dimensions are for planning purposes only. For complete details, see Installation Instructions packed with product. Specifications subject to change without notice.

Ref. W1072583B  
2/10/18

This sketch is provided solely for reference to those items noted on the accompanying "Upgrades/Extras". All other details, dimensions & layouts are for illustrative purposes only and may not be applicable to the Purchaser's Model

Site Wentworth Lot 132

Date 6/20/19

Purchaser Initials W Production Initials \_\_\_\_\_



4A10T132



## KitchenAid Model: KBSD608EBS

29.5 cu. ft 48-Inch Width Built-In Side by Side Refrigerator with PrintShield™ Finish

**Color**  Black Stainless Steel with PrintShield™ Finish

### Product Description

This versatile 29.5 Cu. ft built-in refrigerator features the ExtendFresh™ Plus Temperature Management System, which maintains the perfect temperature for fresh ingredients. The Produce Preserver extends freshness by neutralizing the over-ripening effects of ethylene emitted by certain fruits and vegetables. It also features PrintShield™ Finish, a fingerprint resistant finish, which protects against smudges and enhances the look of the refrigerator.

### Specifications

#### Filter Details

Water Filter Indicator/Reset	Yes
Produce Preserver	Yes
Water Filter Location	Exterior

#### Description

Type of Refrigerator	Side-by-Side
----------------------	--------------

#### Appearance

Door Finish	Smooth
Door Style	Flat
Handle Material	Stainless Steel
Hidden Hinge	Yes
LCD Touch Screen	No
Handle Color	Stainless Steel
Cabinet Finish	Smooth

#### Refinement KAD

Finl PrintShield™	PrintShield Finish
-------------------	--------------------

#### Certifications

Energy Rating	805
CEE Tier	Tier I
Prop 65	 CALIFORNIA RESIDENTS ONLY - WARNING: Cancer and Reproductive Harm - www.P65Warnings.ca.gov
Energy Star® Qualified	ENERGY STAR® Qualified

#### Controls

Door Ajar/Open Alarm	Yes
Air Filter Indicator/Reset	No
Automatic Defrost	Yes
Sabbath Mode	Yes

### Refinements

<b>Features</b>	<b>ExtendFresh Temperature</b> <b>Produce Preserver</b> <b>Adjustable Spill Resistant</b> <b>Intuitive Controls</b> <b>LED Lighting</b> <b>PrintShield Finish</b> <b>Exterior Ice and Water</b>
-----------------	---

### Dimensions

<b>Gross Weight</b>	<b>1407.16</b>
	<b>554.000</b>

### Freezer Details

<b>Freezer Number of Shelves</b>	<b>5</b>
----------------------------------	----------

### Certifications

<b>UL</b>	<b>UL</b>
<b>Counter Depth</b>	<b>Yes</b>
<b>CEE Tier</b>	<b>Tier I</b>
<b>Prop 65</b>	 CALIFORNIA RESIDENTS ONLY - WARNING: Cancer and Reproductive Harm - www.P65Warnings.ca.gov
<b>Advance Foam Insulation</b>	<b>99.9% lower Global</b>

This sketch is provided solely for reference to those items noted on the accompanying "Upgrades/Extras". All other details, dimensions & layouts are for illustrative purposes only and may not be applicable to the Purchaser's Model

Site Woodstock Lot 132

Date 6/20/19

Purchaser Initials cyw Production Initials \_\_\_\_\_

4A10132

**Dimensions**

Cutout Height	212.09 83-1/2
Refrigerator Volume	543.93 19.22
Cutout Width	120.65 47-1/2
Capacity	29-13/25
Depth	70.48 27-3/4
Cabinet Width	119.38 47.0
Height	211.77 83-3/8
Depth Closed Including	70.48 27-3/4
Height To Top Of Cabinet	211.77 83-3/8
Freezer Volume	291.49 10.30
Width	122.56 48-1/4
Cutout Depth	60.96 24.0
Depth Closed Excluding	61.91 24-3/8
Depth With Door Open 90	130.49 51-3/8
Depth Excluding Doors	61.28 24-1/8

**Configuration**

Installation Configuration	Built-In
Door Style Configuration	Side-by-Side
Refrigeration Configuration	Refrigerator

**Icemaker Details**

Icemaker Location	Freezer
Icemaker	Factory Installed

**Dispenser Details**

Dispenser Type	Exterior Ice and Water
Dispenser Options	Filtered Water Control/Child Lock

**Refrigerator Details**

Humidity-Controlled	No
Number of Interior Shelves	5
Non Climate Control	2 Full-Width
Lighting	LED

**Key Features**

PrintShield™ Finish  
 ExtendFresh™ Temperature Management System  
 Produce Preserver  
 SatinGlide® Crispers  
 Exterior Ice and Water Dispenser  
 Professionally-Inspired Design  
 ENERGY STAR® Qualified  
 LED Lighting  
 Adjustable Spill-Resistant Glass Shelves  
 Intuitive Controls  
 Fit System Limited Guarantee

**UPC Listing**

Model : KBSD608EBS      UPC : 883049367125  
 Model : KBSD608ESS      UPC : 883049357263

This sketch is provided solely for reference to those items noted on the accompanying "Upgrades/Extras". All other details, dimensions & layouts are for illustrative purposes only and may not be applicable to the Purchaser's Model

Site Woodstock Lot 132  
 Date 10/20/19  
 Purchaser Initials sc/h Production Initials \_\_\_\_\_



4A-167132

**KitchenAid®**

FOR THE WAY IT'S MADE®

**Side By Side Built-In Refrigerator**

**PRODUCT MODEL NUMBERS**

~~KBSD602E~~ ~~KBSD606E~~ **KBSD608E** ~~KBSN602E~~ ~~KBSN606E~~  
~~KBSD612E~~ ~~KBSD618E~~

**Electrical:** A 115 volt, 60 Hz., AC only, 15- or 20-amp fused, grounded electrical supply is required. It is recommended that a separate circuit serving only your refrigerator be provided. Use an outlet that cannot be turned off by a switch. Do not use an extension cord.

**Water Pressure:** A cold water supply with water pressure between 30 and 120 psi (207 and 827 kPa) is required to operate the water dispenser and ice maker. If you have questions about your water pressure, call a licensed, qualified plumber.

**Reverse Osmosis Water Supply:**

**IMPORTANT:** The pressure of the water supply coming out of a reverse osmosis system going to the water inlet valve of the refrigerator needs to be between 30 and 120 psi (207 and 827 kPa).

**IMPORTANT:**

- It is recommended that you do not install the refrigerator near an oven, radiator, or other heat source.
- Do not install in a location where the temperature will fall below 55°F (13°C).
- Floor must support the refrigerator weight, more than 600 lbs (272 kg), door panels and contents of the refrigerator.

**PRODUCT DIMENSIONS**

- The depth from the front of the top grille to the back of the refrigerator cabinet is 5 5/8" (64.5 cm).
- The power cord is 84" (213 cm) long.
- Height dimensions are shown with leveling legs extended 1/4" (3 mm) below the rollers.

**SIDE VIEW**

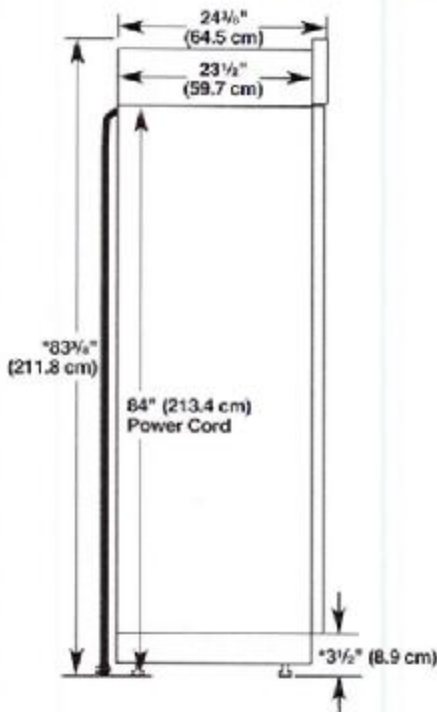

\*When leveling legs are fully extended to 1 1/4" (3.2 cm) below rollers, add 1 1/4" (2.9 cm) to the height dimensions.

**OPENING DIMENSIONS**

To avoid tipping during use, the solid soffit must be within 1" (2.5 cm) maximum above the refrigerator. If the solid soffit is higher than 1" (2.5 cm) or one is not available, then the refrigerator must be braced. If the anti-tip boards are needed, they must be attached to the rear wall studs 80" to 90" (203 cm to 229 cm) above the floor. See "Install Anti-Tip Boards" for more information.

**NOTE:** A clearance of 1/2" (1.3 cm) above the top grille must be maintained in order for the top grille to be removed.

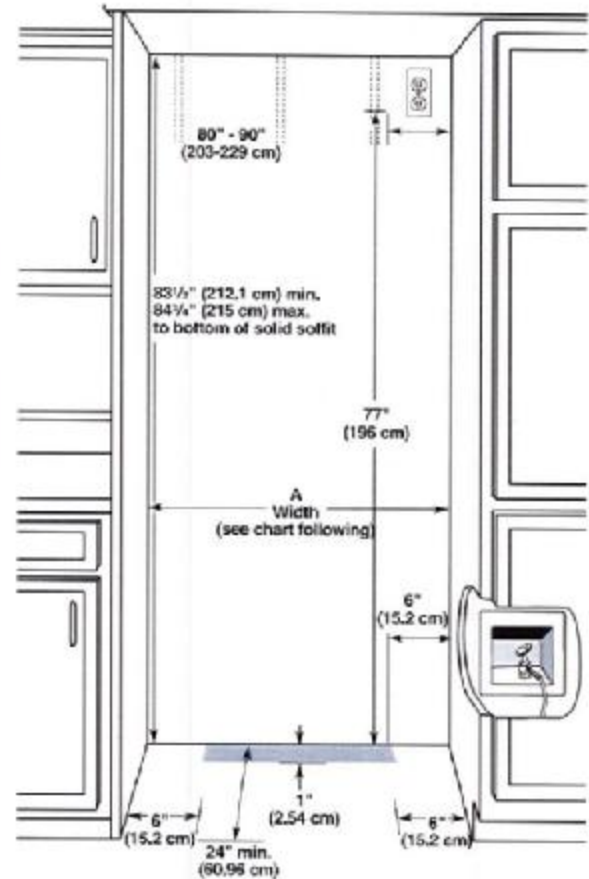

Model	Width A (as shown above)	Dimension B (as shown above)
36	35 1/2" to 35 3/4" (90.2 cm to 90.8 cm)	4" (10.2 cm)
42	41 1/2" to 41 3/4" (105.4 cm to 106.1 cm)	7 1/2" (19.1 cm)
48	47 1/2" to 47 3/4" (120.2 cm to 121.3 cm)	13 1/2" (34.3 cm)

**NOTE:** Flooring under refrigerator must be at same level as the room. Face of cabinet must be plumb.

Because Whirlpool Corporation policy includes a continuous commitment to improve our products, we reserve the right to change materials and specifications without notice.

Dimensions are for planning purposes only. For complete details, see Installation Instructions packed with product. Specifications are subject to change without notice to those items

Page 1 of 2

Ref. W10769109  
3/16

noted on the accompanying "Upgrades/Extras". All other details, dimensions & layouts are for illustrative purposes only and may not be applicable to the Purchaser's Model.

Site Woodstock Lot 132  
 Date 6/20/19  
 Purchaser Initials AK Production Initials \_\_\_\_\_



4A10132

# TOP VIEW

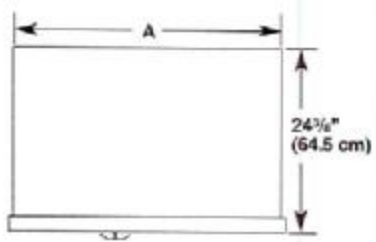

Model	Width A
36	35" (88.9 cm)
42	41" (104.1 cm)
48	47" (119.4 cm)

# FRONT VIEW

- Width dimensions were measured from trim edge to trim edge.
- Height dimensions are shown with leveling legs extended 1/8" (3 mm) below the rollers.

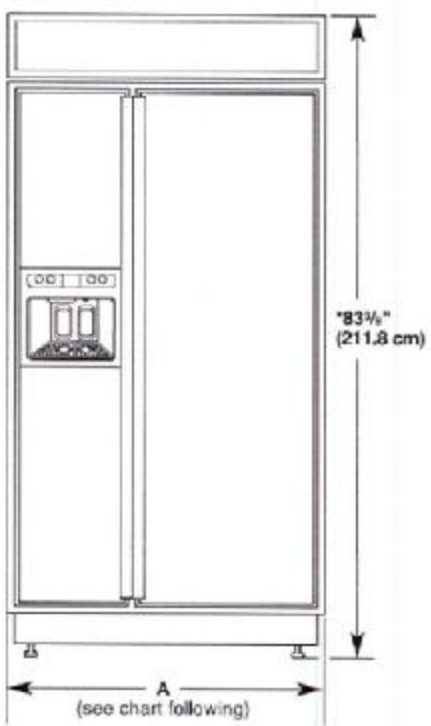

Model	Width A (Trim edge to trim edge)
36	36 1/2" (92.3 cm)
42	42 1/2" (107.5 cm)
48	48 1/2" (122.8 cm)

\*When leveling legs are fully extended to 1 1/4" (3.2 cm) below rollers, add 1 1/8" (2.9 cm) to the height dimensions.

# DOOR SWING DIMENSIONS

The location must permit both doors to open to a minimum of 90°. Allow 5" (12.7 cm) minimum space between the side of the refrigerator and a corner wall.  
**NOTE:** More clearance may be required if you are using overlay panels, custom handles, or extended handles on a Classic model.  
 To adjust the door swings, see "Adjust Doors."

## 36" (91.4 cm) Models

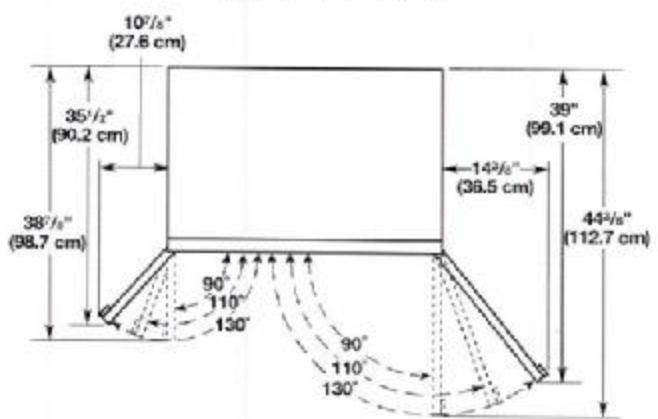

## 42" (106.7 cm) Models

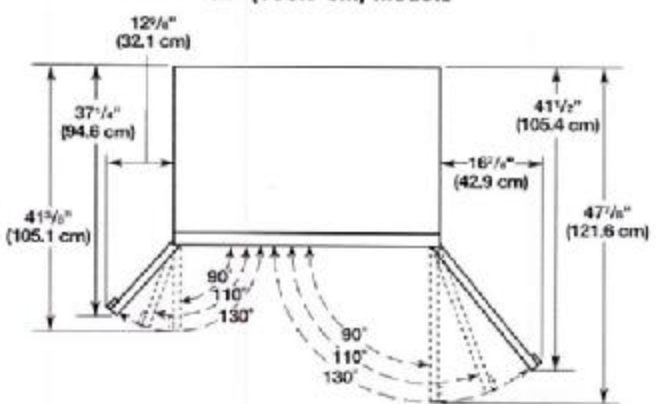

## 48" (121.9 cm) Models

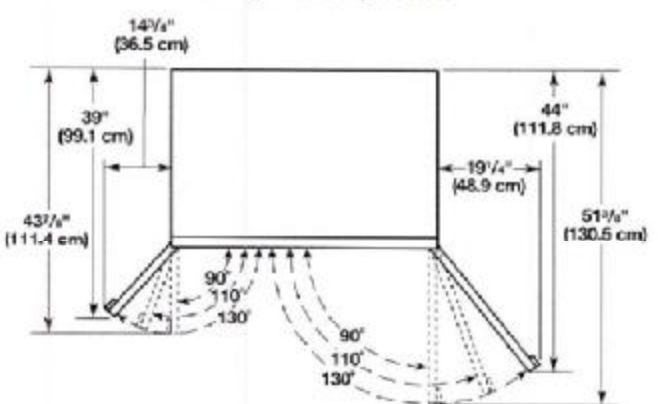

Site Winstock Lot 132  
 Date 6/26/19  
 Purchaser Initials ECW Production Initials \_\_\_\_\_