

KINGSMEN (THAMES) INC. / Havelock Corners (Kingsmen)

Lot/Unit: 179 BLOCK 134    Phase/Building: 4A    Model/Floor Plan: Richard (2602) Elev B1  
Opt 4 Bed - 2+1 Bath

Audio And Security

Inv.4525	1 - LOCATION OF STANDARD CABLE AND PHONE OUTLETS AS PER PER SKETCH ATTACHED LOCATE AT STANDARD HEIGHT	
Line 57387	Note:	
6Jun19 / 6Jun19		

CABINETRY APPLIANCE - FRIDGE

Inv.4525	1 - LOCATION: KITCHEN	
	59 CM FRIDGE CABINET - 2 GABLES & CABINET 59 CM DEEP - DEEP - STANDARD	
Line 57393	Note:	
6Jun19 / 6Jun19		

Hardwood

Inv.4525	2 - LOCATION: MAIN AND UPPER LANDINGS	
	HARDWOOD - UPGRADE 2 - ELEMENTS 3-1/2" X 3/4" ENGINEERED HARDWOOD STAINED IN LIEU OF NATURAL FINISH	
Line 57390	Note: ELEMENTS STURGEON COLOUR	
6Jun19 / 6Jun19		
Inv.4525	1 - LOCATION: GREAT ROOM	
	HARDWOOD - UPGRADE 2 - ELEMENTS 3-1/2" X 3/4" ENGINEERED HARDWOOD STAINED IN LIEU OF NATURAL FINISH	
Line 57391	Note: ELEMENTS STURGEON COLOUR	
6Jun19 / 6Jun19		
Inv.4525	1 - LOCATION: UPPER HALLWAY	
	HARDWOOD - UPGRADE 2 - ELEMENTS 3-1/2" X 3/4" ENGINEERED HARDWOOD STAINED IN LIEU OF STANDARD CARPET	
Line 57392	Note: ELEMENTS STURGEON COLOUR	
6Jun19 / 6Jun19		

Heating And Air Conditioning

Inv.4525	1 - LOCATION: EXTERIOR	
	AS PER SCHEDULE PE ITEM # 4 - VENDOR TO INSTALL CAPPED GAS LINE (ROUGH IN ONLY) AT REAR OF HOME FOR FUTURE BBQ LOCATION. PURCHASER TO SUPPLY AND INSTALL APPLIANCE AFTER CLOSING	
Line 57385	Note: LOCATION TO BE DETERMINED BY VENDOR	
6Jun19 / 6Jun19		
Inv.4525	1 - LOCATION: EXTERIOR	
	AS PER SCHEDULE PE ITEM # 5 - VENDOR TO SUPPLY AND INSTALL AIR CONDITIONING UNIT, SIZED ACCORDINGLY, FROM VENDOR'S STANDARD SELECTION	
Line 57386	Note: LOCATION TO BE DETERMINED BY VENDOR	
6Jun19 / 6Jun19		

PAINT AND DRYWALL

KINGSMEN (THAMES) INC. / Havelock Corners (Kingsmen)

Lot/Unit: 179 BLOCK 134    Phase/Building: 4A    Model/Floor Plan: Richard (2602) Elev B1  
Opt 4 Bed - 2+1 Bath

Inv.4525	1 - LOCATION: MAIN STAIRS	
Line 57388	PAINT EXTRAS - STAIN RAILINGS AND PICKETS (PER FLIGHT) OAK Note: ELEMENTS STURGEON COLOUR	
6Jun19 / 6Jun19		

Inv.4525	1 - LOCATION: MAIN STAIRS	
Line 57389	PAINT EXTRAS - STAIN STAIRS (EXCLUDING RAILINGS) (PER FLIGHT - OAK) Note: ELEMENTS STURGEON COLOUR	
6Jun19 / 6Jun19		

EXTRAS AS PER OFFER

5 FREE APPLIANCES ? STAINLESS STEEL FRONT - FRIDGE: STOVE AND DISHWASHER. WHITE WASHER AND DRYER (SUPPLIED ONLY, NOT INSTALLED, FROM BUILDERS STANDARD LINE) TO ARRANGE DELIVERY ? CALL THE BRICK COMMERCIAL SALES DIVISION AT 1-877-353-2850. Worksheet    Note:	
VENDOR TO INSTALL CAPPED GAS LINE (ROUGH-IN ONLY) AT REAR OF HOME FOR FUTURE BBQ LOCATION. LOCATION TO BE FINALIZED AT VENDORS SOLE DISCRETION. Worksheet    Note:	
VENDOR TO SUPPLY & INSTALL AIR CONDITIONING UNIT, SIZED ACCORDINGLY, FROM VENDORS STANDARD SAMPLES. Worksheet    Note:	

Purchaser: CHRISTOPHER ALBERT WADHAM Property: 179 BLOCK 134 of Plan - Draft Approval S  
 Telephone Res. / Bus: / Project: KINGSMEN (THAMES) INC.  
 Decor Advisor: Steffanee Appio Model and Elevation: Richard (2602) Elev B1 Opt 4 Bed - 2+1 Ba

Layout Changes: ☐ Yes ☒ No Sketch Attached: ☒ Yes ☐ No Exterior Colour Scheme:

### 1. Cabinetry

	Style and Colour	Counter Top	Hardware
Kitchen / Breakfast	PVC SLAB LATITUDE EAST	1881K-52 CIPOLLINO BIANCO	9677 HANDLE
Kitchen Island	PVC SLAB LATITUDE EAST	1881K-52 CIPOLLINO BIANCO	9677 HANDLE
Laundry Room			
Powder Room	PVC SLAB CARAWAY	4954K-22 WHITE DI PESCO	9677 HANDLE
Main Bathroom	PVC SLAB CARAWAY	4954K-22 WHITE DI PESCO	9677 HANDLE
Master Ensuite Bathroom	PVC SLAB CARAWAY	4954K-22 WHITE DI PESCO	9677 HANDLE
Second Ensuite Bathroom (If Applicable)			

### Appliances

#### Custom Size Fridge

☐ Yes ☒ No

#### Valance Lighting

☐ Yes ☒ No

#### Microwave / Range Hood

☐ Yes ☒ No

#### Cooktop / Rangetop

☐ Yes ☒ No

#### Built in Wall Oven

☐ Yes ☒ No

#### Slide-in Range

☐ Yes ☒ No

### Comment

### 2. Flooring

#### Selection

FOYER	13" X 13" CINQ WHITE
Main Hall	13" X 13" CINQ WHITE (IN FRONT OF STAIRS)
Back Hall	
Breakfast	13" X 13" CINQ WHITE
Laundry Room	13" X 13" CINQ WHITE
Kitchen	13" X 13" CINQ WHITE
Powder Room	13" X 13" CINQ WHITE
Main Bathroom	13" X 13" CINQ WHITE
Master Ensuite	13" X 13" CINQ WHITE
Bathroom (If Applicable)	
Mud Room	
GARAGE LANDING	13" X 13" CINQ WHITE
Living Room	
Dining Room	
Family / Great Room	3-1/2" X 3/4" ELEMENTS ENGINEERD HARDWOOD - STURGEON COLOUR
Den / Library / Study	
Basement Landing (If Applies)	
Lower Landing (If Applicable)	3-1/2" X 3/4" ELEMENTS ENGINEERD HARDWOOD - STURGEON COLOUR
Upper Landing	3-1/2" X 3/4" ELEMENTS ENGINEERD HARDWOOD - STURGEON COLOUR
Upper Hall	3-1/2" X 3/4" ELEMENTS ENGINEERD HARDWOOD - STURGEON COLOUR
Master Bedroom	MOHAWK SO SWEET # 01 WITH STANDARD UNDERPAD
Bedroom #2	MOHAWK SO SWEET # 01 WITH STANDARD UNDERPAD
Bedroom #3	MOHAWK SO SWEET # 01 WITH STANDARD UNDERPAD
Bedroom #4	MOHAWK SO SWEET # 01 WITH STANDARD UNDERPAD
Bedroom #5	

Flooring Continued on Page 2

Initial: CW

Page 1 of 3



Purchaser: CHRISTOPHER ALBERT WADHAM

Property: 179 BLOCK 134 of Plan - Draft Approval S

Telephone Res. / Bus: /

Project: KINGSMEN (THAMES) INC.

Decor Advisor: Steffanee Appio

Model and Elevation: Richard (2602) Elev B1 Opt 4 Bed - 2+1 Ba

### 2. Flooring - Continued -

Upgrade Underpad	Type	Area
	STANDARD	BEDROOMS ONLY
Carpet on Stairs	Capped	Runner - *Upgrade
Comment		

MOHAWK SO SWEET # 01 WITH STANDARD UNDERPAD

### 3. Plumbing Fixtures / Faucets

Kitchen	STD	Second Ensuite		Powder Room	STD
Master Ensuite	STD			Other Room	
Main Bathroom	STD				

Comment

### 4. Wall Tile

	Tile Selection	Listello	Insert	Insert Selection
Main Bathroom	8" X 10" CINQ WHITE	<input type="checkbox"/>	<input type="checkbox"/>	SHOWER STALL
Master Ensuite				
Tub Deck	13" X 13" CINQ WHITE	<input type="checkbox"/>	<input type="checkbox"/>	
Tub Apron	13" X 13" CINQ WHITE	<input type="checkbox"/>	<input type="checkbox"/>	
Tub Surround	13" X 13" CINQ WHITE	<input type="checkbox"/>	<input type="checkbox"/>	
Shower Stall	8" X 10" CINQ WHITE	<input type="checkbox"/>	<input type="checkbox"/>	
Second Ensuite		<input type="checkbox"/>	<input type="checkbox"/>	
		<input type="checkbox"/>	<input type="checkbox"/>	
Kitchen Backsplash		<input type="checkbox"/>	<input type="checkbox"/>	
Complete Backsplash		<input type="checkbox"/>	<input type="checkbox"/>	

Comment

2" X 2" STANDARD WHITE MOSAIC SHOWER FLOOR TILES IN BOTH SHOWER STALLS

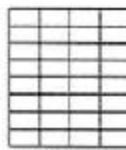

horizontal stacked

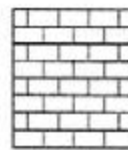

brick pattern



vertical stacked



diagonal/diamond

### 5. Fireplace

	Living Room			Family Room			Other Room - Specify		
	Purchased	As Per Plan	N/A	Purchased	As Per Plan	N/A	Purchased	As Per Plan	N/A
Fireplace Type	<input type="radio"/>	<input type="radio"/>	<input type="radio"/>	<input type="radio"/>	<input checked="" type="radio"/>	<input type="radio"/>	<input type="radio"/>	<input type="radio"/>	<input type="radio"/>
Mantle Type				STANDARD					
Over Mantle				STANDARD					
Colour / Stain									
Surround									
Hearth									
Comment									

Initial:

CW

Page 2 of 3

Purchaser: CHRISTOPHER ALBERT WADHAM

Property: 179 BLOCK 134 of Plan - Draft Approval S

Telephone Res. / Bus: /

Project: KINGSMEN (THAMES) INC.

Decor Advisor: Steffanee Appio

Model and Elevation: Richard (2602) Elev B1 Opt 4 Bed - 2+1 Ba

### 6. Trim Carpentry

Door Hardware STANDARD

Interior Trim STANDARD

Comment

Interior Doors

☐ 2 Panel Arch Top

☐ 2 Panel Square Top

☒ 6 Panel



Initial for Door Style CW

### 7. Railings and Pickets

Railing Package STANDARD

Railing Colour STURGEON COLOUR

Picket Colour STURGEON COLOUR

Wood Stairs ☐ No ☒ Oak

Tread Colour STURGEON COLOUR

Comment

STAIN OAK STAIRS TO COMPLIMENT HARDWOOD - ELEMENTS STURGEON COLOUR

### 8. Plaster Mouldings and Medallions

Foyer

Main Hall

Living Room

Dining Room

Family Room

Kitchen/Breakfast

Den/Library

Lower Landing

Comment

### 9. Wall Paint

STANDARD KINGSMEN WHITE

Smooth Ceilings ☐ First Floor

☐ First Floor incl. Second Floor Hall

☒ First and Second Floor

☐ Throughout

☐ Not Applicable

Trim Paint

### 10. Additional Comments

### 11. Disclaimers and Notes

- Colours of all materials are as close as possible to builder's selection, but not necessarily identical due to variances in manufacturing.
- Any extras listed above are null and void unless accompanied by a separate invoice/amendment. Said invoice must be paid in full.
- The Purchaser acknowledges that after Interior Colour Selection form is signed and dated, no further changes will be permitted other than re-selection due to unavailability. CW Purchaser's Initials
- The Purchaser acknowledges reading and accepting the "Kingsmen Group Décor Centre Disclaimers" form. This document contains other miscellaneous disclaimers.

This Interior Colour Selection is final and approved by:

Purchaser:

Signature: Christopher Wadham Date: June 6/19

Vendor:

KINGSMEN (THAMES) INC.

Aldo Morigello

June 12/19

Page 3 of 3



TOWNHOME 2602

# Richard

B1/B2A

1810/1805 SQ. FT.

3-4 2-3+1



## MAIN FLOOR

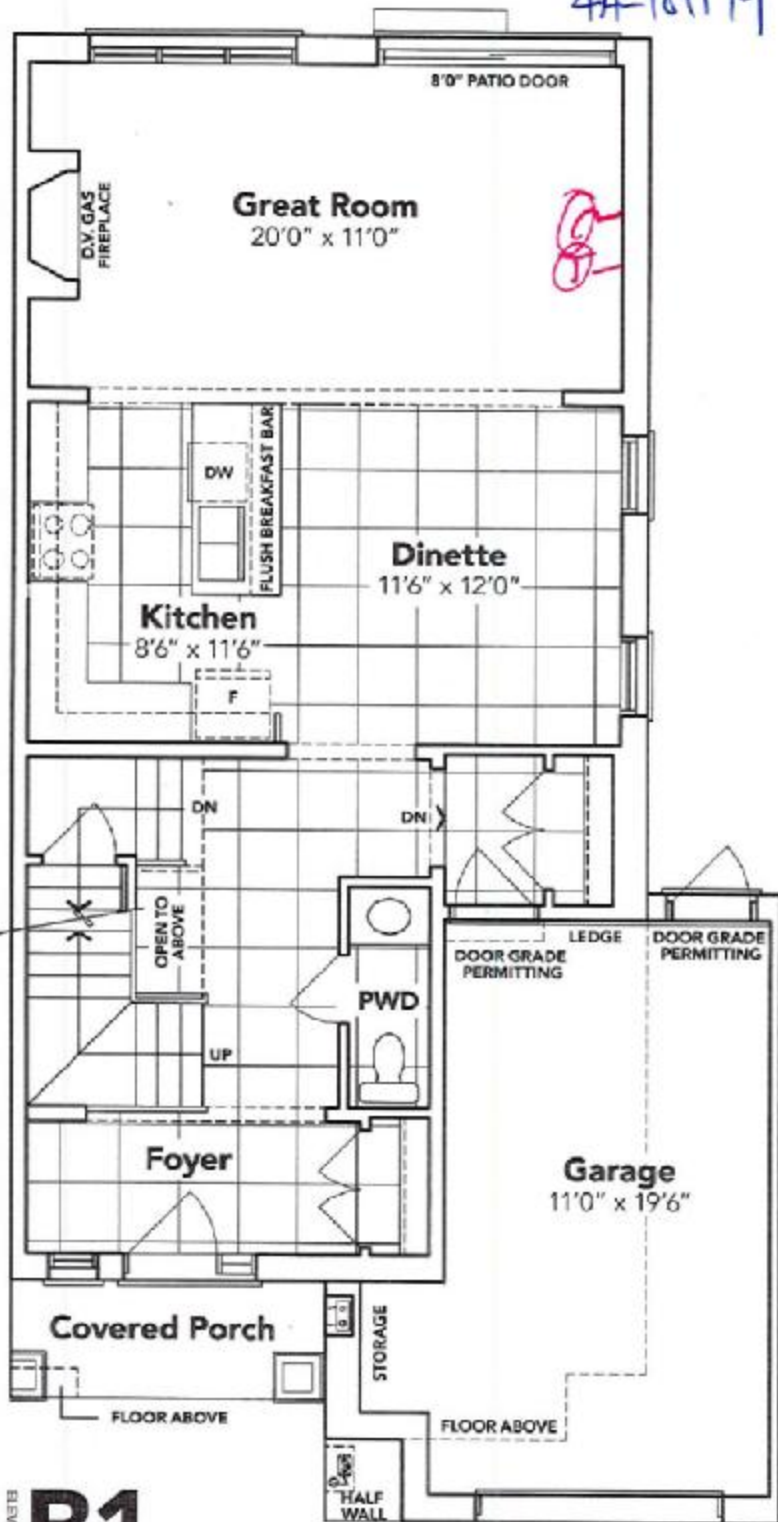

B1



This sketch is provided solely for reference to those items noted on the accompanying "List of Extras". All other details, dimensions & layouts are for illustrative purposes only and may not be applicable to the Purchaser's Model.

Site Woodstock Lot 179  
 Date 6/6/19  
 Purchaser Initials CW Production Initials \_\_\_\_\_

Circle  
 Telephone

# SECOND FLOOR

**KINGSIIEN**  
GROUP INC.

4A-10179

## OPT. SECOND FLOOR



## BASEMENT

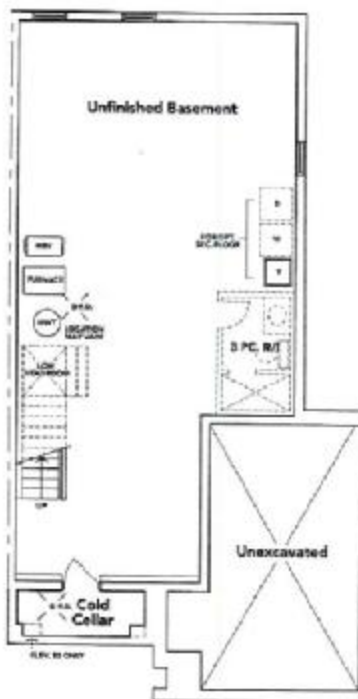

**HAVELOCK**  
**CORNERS**  
WOODSTOCK

All prices, figures, sizes, specifications and information are subject to change without notice. All areas and stated dimensions are approximate. Available floor space, living area and square footage may vary from stated floor area. E & O. E Model 2602.

This sketch is provided for illustrative purposes only and may not be applicable to the Purchaser's Model Site. Woodstock Lot 179  
Date 6/6/19  
Purchaser Initials ew Production Initials \_\_\_\_\_



ELEVATION **B1**

ROOF BELOW



**B2A**



**B2A OPT.**

able  
Telephone