

CONSTRUCTION SUMMARY

Thames Developments (2011) Ltd. / Havelock Corners

Lot/Unit: 66 Phase/Building: 3 Model/Floor Plan: Harrington (42-2) Elev C

CABINETRY ACCESSORIES

Inv.4230	1 - LOCATION: KITCHEN	
	SUPPLY AND INSTALL UPGRADE CABINETS TO KITCHEN IN LIEU OF STANDARD. CLASSIC LINE IN LIEU OF VIKING 3	
Line 53697	Note: ST.LAWRENCE WHITE SUGAR	
11Nov17 / 11Nov17		

CABINETRY APPLIANCE - FRIDGE

Inv.4230	1 - LOCATION: KITCHEN	
	59 CM FRIDGE CABINET - 2 GABLES & CABINET 59 CM DEEP - DEEP - UPGRADE 3	
Line 53698	Note:	
11Nov17 / 11Nov17		

CABINETRY BASE CABINETS

Inv.4230	2 - LOCATION: KITCHEN	
	BASE PIE CUT CORNER - UPGRADE 1	
Line 53701	Note:	
11Nov17 / 11Nov17		

CABINETRY WALL AND HUTCH

Inv.4230	2 - LOCATION: KITCHEN	
	UPPER ANGLE CORNER - PRICE IS PER UNIT - UPGRADE 1 NO GLASS OR MATCHING INTERIOR	
Line 53700	Note:	
11Nov17 / 11Nov17		
Inv.4230	2 - LOCATION: KITCHEN	
	GLASS DOOR CLEAR - WHITE CABINET INTERIOR - UPGRADE 1	
Line 53702	Note: TO BE INSTALLED IN UPPER ANGLE CORNER CABINET	
11Nov17 / 11Nov17		
Inv.4230	2 - LOCATION: KITCHEN	
	MATCHING INTERIOR FOR GLASS DOOR CABINETS - PRICE IS PER CABINET - UPGRADE 1	
Line 53703	Note: TO BE LOCATED IN UPPER ANGLE CORNER CABINET	
11Nov17 / 11Nov17		

HARDWOOD

Inv.4230	1 - LOCATION: UPPER HALLWAY	
	SUPPLY AND INSTALL 3-1/2" ELEMENTS NATURAL FINISH HARDWOOD IN LIEU OF STANDARD CARPET TO UPPER HALLWAY	
Line 53695	Note:	
11Nov17 / 11Nov17		

CONSTRUCTION SUMMARY

Thames Developments (2011) Ltd. / Havelock Corners

Lot/Unit: 66 Phase/Building: 3 Model/Floor Plan: Harrington (42-2) Elev C

Inv.4230	1 - LOCATION: MASTER BEDROOM	
	SUPPLY AND INSTALL 3-1/2" ELEMENTS NATURAL FINISH HARDWOOD IN LIEU OF STANDARD CARPET TO MASTER BEDROOM	
Line 53696	Note:	
11Nov17 / 11Nov17		

MISCELLANEOUS

PAINT AND DRYWALL

Inv.4230	1 - SUPPLY AND INSTALL SMOOTH CEILINGS IN LIEU OF STANDARD FEATURE - MAIN FLOOR	
Line 53686	Note:	
11Nov17 / 11Nov17		
Inv.4230	1 - SUPPLY AND INSTALL SMOOTH CEILINGS IN LIEU OF STANDARD FEATURE - SECOND FLOOR	
Line 53687	Note:	
11Nov17 / 11Nov17		

EXTRAS AS PER OFFER

ALTERNATE (42-02) MASTER BEDROOM/ENSUITE PLAN . SEE SKETCH Worksheet Note:	
INSTALL ROUGH-IN FOR 3 PIECE BATHROOM IN BASEMENT AS PER PLAN Worksheet Note:	
VENDOR AGREES TO ENLARGE THE BASEMENT WINDOWS TO 24 INCHES X 30 INCHES (where applicable) AS PER PLAN. PURCHASER FURTHER ACKNOWLEDGES THAT THERE MAY BE WINDOW WELLS INSTALLED TO ACCOMMODATE ENLARGED BASEMENT WINDOWS. Worksheet Note:	
VENDOR TO INSTALL GAS LINE (ROUGH-IN ONLY) TO KITCHEN IN AT STOVE LOCATION (AS PER PLAN) TO INCLUDE 110V CODE REQUIREMENT. Worksheet Note:	
VENDOR TO SUPPLY & INSTALL AIR CONDITIONING UNIT, SIZED ACCORDINGLY, FROM VENDORS STANDARD SAMPLES. Worksheet Note:	
VENDOR TO INSTALL CAPPED GAS LINE (ROUGH-IN ONLY) AT REAR OF HOME FOR FUTURE BBQ LOCATION AS MARKED ON SKETCH. Worksheet Note:	
5 FREE APPLIANCES ? STAINLESS STEEL FRONT ? FRIDGE: STOVE AND DISHWASHER. WHITE WASHER AND DRYER (SUPPLIED ONLY, NOT INSTALLED, FROM BUILDERS STANDARD LINE) TO ARRANGE DELIVERY ? CALL THE BRICK COMMERCIAL SALES DIVISION AT (416) 249-4373. Worksheet Note:	
PURCHASER ACKNOWLEDGES THAT GRADING PLANS HAVE NOT BEEN FINALIZED AND AS SUCH INFORMATION ON DECK AND WALK OUT CONDITIONS ARE NOT YET AVAILABLE. GRADING IS SUBJECT TO THE TERMS AND CONDITIONS CAPTIONED IN THE AGREEMENT OF PURCHASE AND SALE HEREIN. Worksheet Note:	

INTERIOR COLOUR SCHEME

Purchaser: Sivashankar Sivasubramaniam

Property: 66 of Plan - TBA

Telephone Res. / Bus: (416) 567-2604 /

Project: Thames Developments (2011) Ltd.

Decor Advisor: Steffannee Appio

Model and Elevation: Harrington (42-2) Elev C

Layout Changes: ☐ Yes ☒ No

Sketch Attached: ☒ Yes ☐ No

Exterior Colour Scheme:

1. Cabinetry

	Style and Colour	Counter Top	Hardware
Kitchen / Breakfast	ST. LAWRENCE WHITE SUGAR	4925K-07 CALCUTTA MARBLE	9677 HANDLE
Kitchen Island	 	 	
Laundry Room	 	 	
Powder Room	PVC SLAB WHITE SUGAR	1882K-52 CIPOLLINO GRIGIO	9677 HANDLE
Main Bathroom	PVC SLAB LATITUDE EAST	1881K-52 CIPOLLINO BIANCO	9677 HANDLE
Master Ensuite Bathroom	PVC SLAB MERINGUE	1882K-52 CIPOLLINO GRIGIO	9677 HANDLE
Second Ensuite Bathroom (If Applicable)	 	 	
	 	 	
	 	 	

Appliances

Custom Size Fridge

☐ Yes ☒ No

Valance Lighting

☐ Yes ☒ No

Microwave / Range Hood

☐ Yes ☒ No

Cooktop / Rangetop

☐ Yes ☒ No

Built in Wall Oven

☐ Yes ☒ No

Slide-in Range

☐ Yes ☒ No

Comment

2. Flooring

	Selection
FOYER	13" X 13" SERPENTINE BEYAZ WHITE (TR.ST.BYZ.1313)
Main Hall	13" X 13" SERPENTINE BEYAZ WHITE (TR.ST.BYZ.1313)
Back Hall	
Breakfast	13" X 13" SERPENTINE BEYAZ WHITE (TR.ST.BYZ.1313)
Laundry Room	13" X 13" SERPENTINE BEYAZ WHITE (TR.ST.BYZ.1313)
Kitchen	13" X 13" SERPENTINE BEYAZ WHITE (TR.ST.BYZ.1313)
Powder Room	13" X 13" SERPENTINE BEYAZ WHITE (TR.ST.BYZ.1313)
Main Bathroom	13" X 13" SERPENTINE BEYAZ WHITE (TR.ST.BYZ.1313)
Master Ensuite Bathroom (If Applicable)	13" X 13" SERPENTINE SYRAK CHARCOAL (TR.ST.SRYK.1313)
Mud Room	13" X 13" SERPENTINE BEYAZ WHITE (TR.ST.BYZ.1313)
	
Living Room	3-1/2" ELEMENTS NATURAL FINISH HARDWOOD
Dining Room	3-1/2" ELEMENTS NATURAL FINISH HARDWOOD
Family / Great Room	3-1/2" ELEMENTS NATURAL FINISH HARDWOOD
Den / Library / Study	
Basement Landing (If Applies)	
Lower Landing (If Applicable)	3-1/2" ELEMENTS NATURAL FINISH HARDWOOD
Upper Landing	3-1/2" ELEMENTS NATURAL FINISH HARDWOOD
Upper Hall	3-1/2" ELEMENTS NATURAL FINISH HARDWOOD
Master Bedroom	3-1/2" ELEMENTS NATURAL FINISH HARDWOOD
Bedroom #2	MOHAWK SO SWEET #12 WITH STANDARD UNDERPAD
Bedroom #3	MOHAWK SO SWEET #12 WITH STANDARD UNDERPAD
Bedroom #4	MOHAWK SO SWEET #12 WITH STANDARD UNDERPAD
Bedroom #5	
	

Flooring Continued on Page 2

Initial: LS

Page 1 of 3

INTERIOR COLOUR SCHEME

Purchaser: Sivashankar Sivasubramaniam

Property: 66 of Plan - TBA

Telephone Res. / Bus: (416) 567-2604 /

Project: Thames Developments (2011) Ltd.

Decor Advisor: Steffanee Appio

Model and Elevation: Harrington (42-2) Elev C

2. Flooring - Continued -

Upgrade Underpad

Type

Area

STANDARD

BEDROOMS 2,3,4

Carpet on Stairs

Capped

Runner - *Upgrade

Comment

STANDARD CARPET - MOHAWK SO SWEET #12 WITH STANDARD UNDERPAD

3. Plumbing Fixtures / Faucets

Kitchen

STD

Second Ensuite

Powder Room

STD

Master Ensuite

STD

Other Room

Main Bathroom

STD

Comment

4. Wall Tile

	Tile Selection	Listello	Insert	Insert Selection
Main Bathroom	8" X 10" SERPENTINE BEYAZ WHITE	<input type="checkbox"/>	<input type="checkbox"/>	TR.ST.BYZ.0810
Master Ensuite				
Tub Deck	8" X 10" SERPENTINE SYRAK CHARCOAL	<input type="checkbox"/>	<input type="checkbox"/>	TR.ST.SRYK.0810
Tub Apron	8" X 10" SERPENTINE SYRAK CHARCOAL	<input type="checkbox"/>	<input type="checkbox"/>	TR.ST.SRYK.0810
Tub Surround	8" X 10" SERPENTINE SYRAK CHARCOAL	<input type="checkbox"/>	<input type="checkbox"/>	TR.ST.SRYK.0810
Shower Stall	8" X 10" SERPENTINE SYRAK CHARCOAL	<input type="checkbox"/>	<input type="checkbox"/>	TR.ST.SRYK.0810
Second Ensuite		<input type="checkbox"/>	<input type="checkbox"/>	
		<input type="checkbox"/>	<input type="checkbox"/>	
		<input type="checkbox"/>	<input type="checkbox"/>	
Kitchen Backsplash		<input type="checkbox"/>	<input type="checkbox"/>	
Complete Backsplash		<input type="checkbox"/>	<input type="checkbox"/>	

Comment

STANDARD 2" X 2" MOSAIC WHITE SHOWER FLOOR TILE

5. Fireplace

Living Room

Family Room

Other Room - Specify

Purchased As Per Plan N/A

Purchased As Per Plan N/A

Purchased As Per Plan N/A

☐

☐

☐

☐

☒

☐

☐

☐

☐

Fireplace Type

STANDARD

Mantle Type

WHITE PAINT GRADE

Over Mantle

Colour / Stain

Surround

NERO

Hearth

Comment

Initial:

SLS

Page 2 of 3

INTERIOR COLOUR SCHEME

Purchaser: Sivashankar Sivasubramaniam
Telephone Res. / Bus: (416) 567-2604 /
Decor Advisor: Steffannee Appio

Property: 66 of Plan - TBA
Project: Thames Developments (2011) Ltd.
Model and Elevation: Harrington (42-2) Elev C

Property: 66 of Plan - TBA

Project: Thames Developments (2011) Ltd.

Model and Elevation: Harrington (42-2) Elev C

Door Hardware <input type="text" value="STANDARD"/>	Interior Doors
Interior Trim <input type="text" value="STANDARD"/>	<input type="radio"/> 2 Panel Arch Top
Comment <div style="border: 1px solid black; height: 100px; width: 100%;"></div>	<input type="radio"/> 2 Panel Square Top
	<input checked="" type="radio"/> 6 Panel

Initial for Door Style S.S.

Interior Doors

☐ 2 Panel Arch Top

☐ 2 Panel Square Top

● 6 Panel

Initial for Door Style



Railing Package	STANDARD		
Railing Colour	NATURAL	Picket Colour	STANDARD
Wood Stairs	<input type="radio"/> No <input checked="" type="radio"/> Oak	Tread Colour	NATURAL
Comment	NATURAL FINISH OAK WITH STANDARD OAK PICKETS		

Tread Colour NATURAL

NATURAL FINISH OAK WITH STANDARD OAK PICKETS

Foyer			Kitchen/Breakfast		
Main Hall			Den/Library		
Living Room			Lower Landing		
Dining Room					
Family Room					
Comment					

Comment

STANDARD SENATOR WHITE	Smooth Ceilings	<input type="radio"/> First Floor <input type="radio"/> First Floor incl. Second Floor Hall <input checked="" type="radio"/> First and Second Floor <input type="radio"/> Throughout <input type="radio"/> Not Applicable
	Trim Paint	STANDARD

Smooth Ceilings ☐ **First Floor**

☐ First Floor incl. Second Floor Hall

● First and Second Floor

○ Throughout

☐ Not Applicable

Trim Paint STANDARD

--

1) Colours of all materials are as close as possible to builder's selection, but not necessarily identical due to variances in manufacturing.

2) Any extras listed above are null and void unless accompanied by a separate invoice/amendment. Said invoice must be paid in full.

3) The Purchaser acknowledges that after Interior Colour Selection form is signed and dated, no further changes will be permitted other than re-selection due to unavailability. _____ Purchaser's Initials

4) The Purchaser acknowledges reading and accepting the "Senator Homes Décor Centre Disclaimers" form. This document contains other miscellaneous disclaimers.

This Interior Colour Selection is final and approved by:

Purchaser: _____

Signature: Shirley Date: NOV 11 / 2017

Vendor: _____

Thames Developments (2011) Ltd.

1) Colours of all materials are as close as possible to builder's selection, but not necessarily identical due to variances in manufacturing.

2) Any extras listed above are null and void unless accompanied by a separate Invoice/amendment. Said invoice must be paid in full.

3) The Purchaser acknowledges that after Interior Colour Selection form is signed and dated, no further changes will be permitted other than re-selection due to unavailability. _____ Purchaser's Initials

4) The Purchaser acknowledges reading and accepting the "Senator Homes Décor Centre Disclaimers" form. This document contains other miscellaneous disclaimers.

This Interior Colour Selection is final and approved by:

Purchaser:

Signature: She Date: Nov 11/2017

Vendor:

Thames Developments (2011) Ltd.

GROUND FLOOR
ELEV. 10'

The ground floor plan shows a large **GARAGE** (10'0" x 20'0") on the left. To its right is the **FAMILY ROOM** (11'4" x 18'11") with a fireplace on the left wall. A **CL** (closet) is located between the family room and the **BREAKFAST** room (10'0" x 12'7"). The **BREAKFAST** room has a **6" SLIDING DOOR** leading to a **COVERED PORCH**. A **STOVE** is located in the **KITCHEN** area (12'2" x 10'6"). A **SEMI. CLO. W/ HALF BATH** is situated between the breakfast room and the kitchen. The **DINING ROOM** (12'0" x 10'0") features a **CUPBEES CEILING**. The **LIVING ROOM** (9'10" x 11'0") also has a **CUPBEES CEILING**. A **CL** is located between the living room and the **FOYER**. The **FOYER** leads to a **POWDER** room. A **SEMI. CLO. W/ HALF BATH** is also located near the foyer. A **CL** is located between the foyer and the **POWDER** room. A **COVERED PORCH** is located at the bottom of the plan.

Floor plan of a building with the following rooms and features:

- HALL**: 10' X 20'
- LIVING ROOM**: 11' X 12' (includes a fireplace)
- KITCHEN**: Includes a sink and a toilet.
- BATH**: Includes a toilet.
- BEDROOM**: Includes a sink.

The plan also shows a large, irregular boundary line surrounding the building, and a small square area labeled "C" in the bottom right corner.

[illegible]

Harrington
2,460 SQ. FT. ELEV. D & C

Materials, specifications, and floor plans are subject to change without notice. All house products are subject to alterations. All floor plans are approximate dimensions. Actual usable floor space may vary from the stated floor area. Square footage includes open to below. Double doors window shown as elevation are not specific and may not apply to all lots and models, and only apply to window type or condition. E. & O. E. - 42-02

SCHEDULE B1

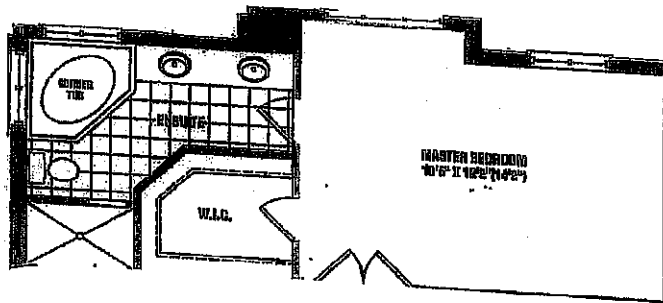

Harrington's ALT. MASTER
BEDROOM/ENSUITE

LOT 66 Phase 3

SKETCH ^(S.S.)
