

CONSTRUCTION SUMMARY

Thames Developments (2011) Ltd. / Havelock Corners

Lot/Unit: 8 Phase/Building: 3 Model/Floor Plan: Bruce (50-5) Elev B

AUDIO AND SECURITY

Inv.4276	1 - LOCATION: GREAT ROOM DATA OUTLET - INCLUDES ROUGH-IN PLUS RJ45 PLATE AND TERMINATION TO BASEMENT. TO BE CENTRED TO WALL ABOVE FIREPLACE AND LOCATED AT APPROXIMATELY 66" HIGH +/- ABOVE FINISHED FLOOR	
Line 54262	Note:	
4Dec17 / 4Dec17		
Inv.4276	1 - LOCATION: GREAT ROOM STANDARD CABLE OUTLET TO BE CENTRED TO WALL ABOVE FIREPLACE AND LOCATED AT APPROXIMATELY 66" HIGH +/- ABOVE FINISHED FLOOR AND NEXT TO DATA CABLE AND ELECTRICAL OUTLETS THAT HAVE BEEN PURCHASED SEPARATELY.	
Line 54264	Note:	
4Dec17 / 4Dec17		
Inv.4276	1 - LOCATION: BEDROOM 2 SUPPLY AND INSTALL A CABLE OUTLET TO BEDROOM 2 AS PER SKETCH ATTACHED	
Line 54265	Note:	
4Dec17 / 4Dec17		
Inv.4276	1 - LOCATION: BEDROOM 3 SUPPLY AND INSTALL A CABLE OUTLET IN BEDROOM 3 AS PER SKETCH ATTACHED	
Line 54266	Note:	
4Dec17 / 4Dec17		

CABINETRY

Inv.4276	1 - LOCATION: KITCHEN SUPPLY AND INSTALL A 36" STOVE AND HOOD FAN OPENING IN LIEU OF STANDARD 30". (COOK-TOP STOVE)	
Line 54269	Note:	
4Dec17 / 4Dec17		
Inv.4276	1 - LOCATION: KITCHEN RELOCATE THE FRIDGE OPENING TO END OF WALL AS PER SKETCH ATTACHED	
Line 54276	Note:	
4Dec17 / 4Dec17		
Inv.4276	1 - LOCATION: ISLAND SUPPLY AND INSTALL 1' FOOT ADDITIONAL FLUSH BREAKFAST BAR TO ISLAND THAT HAS BEEN EXTENDED	
Line 54286	Note:	
4Dec17 / 4Dec17		
Inv.4280	1 - LOCATION: KITCHEN KITCHEN - UPGRADE 1 - CLASSIC 1 LINE IN LIEU OF STANDARD VIKING 3	
Line 54366	Note: ST. LAWRENCE WHITE SUGAR	
4Dec17 / 4Dec17		

CONSTRUCTION SUMMARY

Thames Developments (2011) Ltd. / Havelock Corners

Lot/Unit: 8 Phase/Building: 3 Model/Floor Plan: Bruce (50-5) Elev B

Inv.4281	1 - LOCATION: KITCHEN	
	SUPPLY FINISHED SIDES TO CABINETRY ABOVE STOVE. PURCHASER TO SUPPLY AND INSTALL THEIR OWN CHIMNEY HOOD FAN AFTER CLOSING	
Line 54392	Note:	
4Dec17 / 4Dec17		

CABINETRY APPLIANCE - FRIDGE

Inv.4276	1 - LOCATION: KITCHEN	
	66CM FRIDGE CABINET - 2 GABLES & CABINET 66CM CM DEEP - DEEP UPGRADE 2	
Line 54277	Note:	
4Dec17 / 4Dec17		

CABINETRY BASE CABINETS

Inv.4276	1 - LOCATION: KITCHEN	
	BASE PIE CUT CORNER - UPGRADE 2	
Line 54278	Note: TO BE LOCATED AS PER SKETCH ATTACHED	
4Dec17 / 4Dec17		
Inv.4276	2 - LOCATION: KITCHEN	
	SUPPLY AND INSTALL UPPER CABINET CABINET 30 CM (12 INCH) DEEP - PRICE IS PER FOOT - UPGRADE 3	
Line 54280	Note: TO BE LOCATED NEXT TO DISHWASHER TO EXTEND CABINETRY TOWARD PATIO DOOR	
4Dec17 / 4Dec17		
Inv.4276	2 - LOCATION: KITCHEN	
	BASE CABINET - PRICE IS PER FOOT - INCLUDES COUNTER TOP FROM STANDARD LINE - UPGRADE 3	
Line 54281	Note: TO BE LOCATED NEXT TO DISHWASHER TO EXTEND CABINETRY TOWARD PATIO DOOR	
4Dec17 / 4Dec17		
Inv.4276	1 - LOCATION: ISLAND	
	BASE ISLAND WITH PANEL - PRICE IS PER FOOT - INCLUDES 27 INCH DEEP COUNTER FROM VENDORS STANDARD LINE - UPGRADE 3	
Line 54285	Note: EXTEND ISLAND BY 1' FOOT	
4Dec17 / 4Dec17		

CABINETRY HARDWARE

Inv.4276	1 - LOCATION: KITCHEN ISLAND	
	BASE WASTE / RECYCLE CENTER PULL OUT DOOR - ONLY AVAILABLE IN 45 CM CABINET (2) 35L BINS - PRICE IS PER UNIT	
Line 54283	Note: TO BE LOCATED IN ISLAND	
4Dec17 / 4Dec17		

CABINETRY MICROWAVE OVEN STOVE COOKTOP

CONSTRUCTION SUMMARY

Thames Developments (2011) Ltd. / Havelock Corners

Lot/Unit: 8 Phase/Building: 3 Model/Floor Plan: Bruce (50-5) Elev B

Inv.4276	1 - LOCATION: KITCHEN	
	COOKTOP CABINET (FULL HEIGHT) WITH FALSE TOP DRAWER AND POT & PANS DRAWERS BELOW - PURCHASER MUST SUPPLY SPECS - UPGRADE 2	
Line 54271	Note:	
4Dec17 / 4Dec17		
Inv.4276	1 - LOCATION: KITCHEN	
	BUILT IN DOUBLE APPLIANCE CABINET WITH DRAWER BELOW - TRIM KIT REQUIRED - PURCHASER MUST SUPPLY SPECS - UPGRADE 2	
	66CM DEEP CABINetry	
Line 54272	Note: LOCATION AS PER SKETCH ATTACHED	
4Dec17 / 4Dec17		

CABINETRY PANTRY

Inv.4281	2 - LOCATION: SERVERY/BUTLER PANTRY	
	PANTRY 59 CM DEEP PER IN LIEU OF UPPER/BASE - PRICE IS PER FOOT - UPGRADE 1	
Line 54391	Note:	
4Dec17 / 4Dec17		

CABINETRY WALL AND HUTCH

Inv.4276	1 - LOCATION: KITCHEN	
	UPPER ANGLE CORNER - PRICE IS PER UNIT - UPGRADE 2	
	NO GLASS OR MATCHING INTERIOR	
Line 54279	Note: TO BE LOCATED AS PER SKETCH ATTACHED	
4Dec17 / 4Dec17		

COUNTER TOP - EXTRAS

Inv.4276	1 - LOCATION: KITCHEN	
	SUPPLY AND INSTALL STONE CUTOUT PROVISION FOR COOKTOP CONDITION	
Line 54284	Note:	
4Dec17 / 4Dec17		

COUNTER TOP - KITCHEN

Inv.4276	1 - LOCATION: KITCHEN	
	KITCHEN - LEVEL 1 CAESARSTONE WITH STANDARD EDGE PROFILE FOR ADDITIONAL 2' FEET OF BASE CABINETS ADDED AND 1' FOOT OF ADDITIONAL ISLAND ADDED	
Line 54290	Note: 4230 SHITAKE CAESARSTONE	
4Dec17 / 4Dec17		
Inv.4276	1 - LOCATION: KITCHEN	
	KITCHEN - LEVEL 1 - CAESARSTONE WITH STANDARD EDGE PROFILE IN LIEU OF STANDARD COUNTER-TOP.	
Line 54289	Note: 4230 SHITAKE CAESARSTONE	
4Dec17 / 4Dec17		

CONSTRUCTION SUMMARY

Thames Developments (2011) Ltd. / Havelock Corners

Lot/Unit: 8 Phase/Building: 3 Model/Floor Plan: Bruce (50-5) Elev B

Inv.4281	1 - LOCATION: KITCHEN	
	SUPPLY AND INSTALL GRANITE CUTOUT AND POLISHED EDGE FOR UNDERMOUNT SINK	
Line 54395	Note: SINGLE HOLE FAUCET AND UNDERMOUNT SINK PURCHASED SEPARATELY.	
4Dec17 / 4Dec17		

ELECTRICAL

Inv.4276	1 - LOCATION: GREAT ROOM	
	SUPPLY AND INSTALL ADDITIONAL INTERIOR RECEPTACLE (NOT SEPARATE CIRCUIT).TO BE CENTRED TO WALL ABOVE FIREPLACE AND LOCATED AT APPROXIMATELY 66" HIGH +/- ABOVE FINISHED FLOOR.	
Line 54263	Note: LOCATION AS PER SKETCH ATTACHED.	
4Dec17 / 4Dec17		

Inv.4276	1 - LOCATION: LIVING ROOM	
	SUPPLY AND INSTALL CAPPED CEILING LIGHT ROUGH-IN ONLY ON SEPARATE SINGLE SWITCH TO BE CENTRED IN CEILING OF LIVING ROOM.	
Line 54268	Note: LOCATION AS PER SKETCH ATTACHED.	
4Dec17 / 4Dec17		

Inv.4276	1 - LOCATION: KITCHEN	
	ELECTRICAL - CONNECTION FOR BUILT-IN OVEN	
Line 54273	Note:	
4Dec17 / 4Dec17		

Inv.4276	1 - LOCATION: KITCHEN	
	SUPPLY AND INSTALL ELECTRICAL WIRING FOR BUILT-IN MICROWAVE	
Line 54274	Note: LOCATION AS PER SKETCH ATTACHED.	
4Dec17 / 4Dec17		

Inv.4276	1 - LOCATION: EXTERIOR PORTICO	
	SUPPLY AND INSTALL EXTERIOR CAPPED CEILING LIGHT ROUGH-IN ONLY ON SEPARATE SWITCH TO BE CENTRED IN CEILING OF EXTERIOR PORTICO.	
Line 54307	Note: LOCATION AS PER SKETCH ATTACHED.	
4Dec17 / 4Dec17		

Inv.4281	1 - LOCATION: KITCHEN	
	SUPPLY AND INSTALL ADDITIONAL INTERIOR RECEPTACLE (15AMP) REQUIRED FOR FUTURE CHIMNEY HOOD FAN BEING SUPPLIED AND INSTALLED AFTER CLOSING	
Line 54394	Note: LOCATION AS PER SKETCH ATTACHED.	
4Dec17 / 4Dec17		

HARDWOOD

Inv.4276	1 - LOCATION: UPPER HALLWAY	
	AS PER SCHEDULE PE ITEM # 13 - SUPPLY AND INSTALL NATURAL FINISH OAK HARDWOOD IN LIEU OF STANDARD CARPET. SELECTION IS FROM VENDOR'S STANDARD SAMPLE.	
Line 54261	Note:	
4Dec17 / 4Dec17		

CONSTRUCTION SUMMARY

Thames Developments (2011) Ltd. / Havelock Corners

Lot/Unit: 8 Phase/Building: 3 Model/Floor Plan: Bruce (50-5) Elev B

Inv.4276	1 - LOCATION: DINING ROOM	
	SUPPLY AND INSTALL HARDWOOD - 3-1/2" X 3/4" ELEMENTS OAK STAINED STURGEON COLOUR	
Line 54343	Note:	
4Dec17 / 4Dec17		
Inv.4276	1 - LOCATION: - LIVING ROOM	
	SUPPLY AND INSTALL HARDWOOD - 3-1/2" X 3/4" ELEMENTS OAK STAINED STURGEON COLOUR	
Line 54345	Note:	
4Dec17 / 4Dec17		
Inv.4276	1 - LOCATION: LIBRARY	
	SUPPLY AND INSTALL HARDWOOD - 3-1/2" X 3/4" ELEMENTS OAK STAINED STURGEON COLOUR	
Line 54342	Note:	
4Dec17 / 4Dec17		
Inv.4276	1 - LOCATION: GREAT ROOM / FAMILY ROOM	
	SUPPLY AND INSTALL HARDWOOD - 3-1/2" X 3/4" ELEMENTS OAK STAINED STURGEON COLOUR	
Line 54344	Note:	
4Dec17 / 4Dec17		
Inv.4276	1 - LOCATION: - - UPPER HALL	
	SUPPLY AND INSTALL HARDWOOD - 3-1/2" X 3/4" ELEMENTS OAK STAINED STURGEON COLOUR	
Line 54346	Note:	
4Dec17 / 4Dec17		

MISCELLANEOUS

Inv.4276	1 - LOCATION: FOYER	
	DELETE THE HALF WALL WITH DECORATIVE COLUMN IN THE FOYER RELOCATE THIS HALF WALL BETWEEN THE MAIN HALLWAY AND LIBRARY	
Line 54365	Note: LOCATION AS PER SKETCH ATTACHED	
4Dec17 / 4Dec17		

PAINT AND DRYWALL

Inv.4276	1 - LOCATION: MAIN STAIRS	
	PAINT EXTRAS - STAIN RAILINGS AND PICKETS (PER FLIGHT)	
Line 54347	Note: ELEMENTS STURGEON COLOUR	
4Dec17 / 4Dec17		
Inv.4276	1 - LOCATION: MAIN STAIRS	
	PAINT EXTRAS - STAIN STAIRS (EXCLUDING RAILINGS) (PER FLIGHT - OAK)	
Line 54348	Note: ELEMENTS STURGEON COLOUR	
4Dec17 / 4Dec17		

PLUMBING

CONSTRUCTION SUMMARY

Thames Developments (2011) Ltd. / Havelock Corners

Lot/Unit: 8 Phase/Building: 3 Model/Floor Plan: Bruce (50-5) Elev B

Inv.4276	1 - LOCATION: KITCHEN	
	SUPPLY AND INSTALL UPGRADE SINK IN KITCHEN IN LIEU OF STANDARD UNDERMOUNT - BOSCO RADIUS CORNER MODEL #203319 (30" X 18" X 10")	
Line 54287	Note: DOES NOT INCLUDE SINGLE HOLE FAUCET	
4Dec17 / 4Dec17		
Inv.4276	1 - LOCATION: MASTER ENSUITE SHOWER STALL	
	FRAMELESS GLASS SHOWER ENCLOSURE WITH FRAMELESS DOOR. NOTE: HALF GLASS TO SIDE WHERE TUB ADJOINS - NO FULL GLASS ON THIS SIDE	
Line 54356	Note:	
4Dec17 / 4Dec17		
Inv.4280	1 - LOCATION: TWIN BATH	
	SHOWER DOOR - CHROME FRAME - GLASS SHOWER DOOR - CLEAR GLASS	
Line 54367	Note:	
4Dec17 / 4Dec17		

PLUMBING - KITCHEN FAUCETS:

Inv.4276	1 - LOCATION: KITCHEN	
	SUPPLY AND INSTALL SINGLE HOLE FAUCET IN LIEU OF STANDARD TO KITCHEN. MOEN INTEGRA MODEL #67315C CHROME FINISH	
Line 54364	Note:	
4Dec17 / 4Dec17		

TILE

Inv.4276	1 - LOCATION: FOYER	
	SUPPLY AND INSTALL FLOOR TILE - UPGRADE 5 - - VESTIBULE FLOOR STANDARD STACKED INSTALL - SEE SKETCH FOR TILE DIRECTION	
Line 54349	Note: 12" X 24" TIMELESS POLISHED TAUPE (OV.TL.TPE.1223.PL)	
4Dec17 / 4Dec17		
Inv.4276	1 - LOCATION: LAUNDRY ROOM	
	SUPPLY AND INSTALL FLOOR TILE - UPGRADE 5 - - LAUNDRY ROOM FLOOR. STANDARD STACKED INSTALL - SEE SKETCH FOR TILE DIRECTION	
Line 54351	Note: 12" X 24" TIMELESS POLISHED TAUPE (OV.TL.TPE.1224.PL)	
4Dec17 / 4Dec17		
Inv.4276	1 - LOCATION: MAIN HALLWAY	
	SUPPLY AND INSTALL UPGRADE LEVEL 5 TILE TO MAIN HALLWAY IN LIEU OF STANDARD NATURAL FINISH OAK HARDWOOD. STANDARD STACKED INSTALL - SEE SKETCH FOR TILE DIRECTION	
Line 54353	Note: 12" X 24" TIMELESS POLISHED TAUPE (OV.TL.TPE.1223.PL)	
4Dec17 / 4Dec17		
Inv.4276	1 - LOCATION: MASTER ENSUITE TUB SURROUND	
	SUPPLY AND INSTALL FLOOR TILE - UPGRADE 5 - TO MASTER ENSUITE TUB WALL SURROUND	
Line 54358	Note: 12" X 24" TIMELESS POLISHED LIGHT GREY (OV.TL.LGR.1224.PL)	
4Dec17 / 4Dec17		

CONSTRUCTION SUMMARY

Thames Developments (2011) Ltd. / Havelock Corners

Lot/Unit: 8 Phase/Building: 3 Model/Floor Plan: Bruce (50-5) Elev B

Inv.4276	1 - LOCATION: POWDER ROOM	
	SUPPLY AND INSTALL FLOOR TILE - UPGRADE 5 - - POWDER ROOM FLOOR. STANDARD STACKED INSTALL - SEE SKETCH FOR TILE DIRECTION	
Line 54350	Note: 12" X 24" TIMELESS POLISHED TAUPE (OV.TL.TPE.1223.PL)	
4Dec17 / 4Dec17		
Inv.4276	1 - LOCATION: KITCHEN/BREAKFAST AREA	
	SUPPLY AND INSTALL FLOOR TILE - UPGRADE 5 - - KITCHEN AND BREAKFAST FLOOR WITH SERVERY. STANDARD STACKED INSTALL - SEE SKETCH FOR TILE DIRECTION	
Line 54352	Note: 12" X 24" TIMELESS POLISHED TAUPE (OV.TL.TPE.1223.PL)	
4Dec17 / 4Dec17		
Inv.4276	1 - LOCATION: GARAGE ENTRANCE	
	SUPPLY AND INSTALL UPGRADE LEVEL 5 FLOOR TILE IN LIEU OF STANDARD NATURAL OAK FINISH HARDWOOD TO GARAGE ENTRANCE/LANDING AT POWDER ROOM. STANDARD STACKED INSTALL - SEE SKETCH FOR TILE DIRECTION.	
Line 54354	Note: 12" X 24" TIMELESS POLISHED TAUPE (OV.TL.TPE.1223.PL)	
4Dec17 / 4Dec17		
Inv.4276	1 - LOCATION: MASTER ENSUITE FLOOR	
	SUPPLY AND INSTALL FLOOR TILE - UPGRADE 5 - - ENSUITE BATHROOM FLOOR. STANDARD STACKED INSTALL - SEE SKETCH FOR TILE DIRECTION	
Line 54357	Note: 12" X 24" TIMELESS POLISHED LIGHT GREY (OV.TL.LGR.1224.PL)	
4Dec17 / 4Dec17		
Inv.4276	1 - LOCATION: MASTER ENSUITE SHOWER STALL	
	SUPPLY AND INSTALL FLOOR TILE - UPGRADE 5 - IN LIEU OF WALL TILE TO SHOWER STALL IN MASTER ENSUITE (INCLUDING CEILING OF SHOWER)	
Line 54359	Note: 12" X 24" TIMELESS POLISHED LIGHT GREY (OV.TL.LGR.1224.PL)	
4Dec17 / 4Dec17		
Inv.4276	1 - LOCATION: TWIN BATHROOM	
	SUPPLY AND INSTALL FLOOR TILE - UPGRADE 4 - - TWIN BATH FLOOR	
Line 54361	Note: 12" X 12" REGAL JET BLACK POLISHED (NY.RG.JBK.1212.PL)	
4Dec17 / 4Dec17		

CONSTRUCTION SUMMARY

Thames Developments (2011) Ltd. / Havelock Corners

Lot/Unit: 8 Phase/Building: 3 Model/Floor Plan: Bruce (50-5) Elev B

EXTRAS AS PER OFFER

INSTALL ROUGH-IN FOR 3 PIECE BATHROOM IN BASEMENT AS PER PLAN <i>Worksheet Note:</i>	
VENDOR AGREES TO ENLARGE THE BASEMENT WINDOWS TO 24 INCHES X 30 INCHES (where applicable) AS PER PLAN. PURCHASER FURTHER ACKNOWLEDGES THAT THERE MAY BE WINDOW WELLS INSTALLED TO ACCOMMODATE ENLARGED BASEMENT WINDOWS. <i>Worksheet Note:</i>	
VENDOR TO INSTALL GAS LINE (ROUGH-IN ONLY) TO KITCHEN IN AT STOVE LOCATION (AS PER PLAN) TO INCLUDE 110V CODE REQUIREMENT. <i>Worksheet Note:</i>	
VENDOR TO SUPPLY & INSTALL AIR CONDITIONING UNIT, SIZED ACCORDINGLY, FROM VENDORS STANDARD SAMPLES. <i>Worksheet Note:</i>	
VENDOR TO INSTALL CAPPED GAS LINE (ROUGH-IN ONLY) AT REAR OF HOME FOR FUTURE BBQ LOCATION AS MARKED ON SKETCH. <i>Worksheet Note:</i>	
PURCHASER ACKNOWLEDGES THAT GRADING PLANS HAVE NOT BEEN FINALIZED AND AS SUCH INFORMATION ON DECK AND WALK OUT CONDITIONS ARE NOT YET AVAILABLE. GRADING IS SUBJECT TO THE TERMS AND CONDITIONS CAPTIONED IN THE AGREEMENT OF PURCHASE AND SALE HEREIN. <i>Worksheet Note:</i>	
VENDOR TO INSTALL ENGINEERED HARDWOOD IN THE HALLWAY ON THE 2ND FLOOR IN LIEU OF INCLUDED CARPET AS PER PLAN. ENGINEERED HARDWOOD TO BE SELECTED FROM BUILDERS STANDARD SAMPLES. <i>Worksheet Note:</i>	

INTERIOR COLOUR SCHEME

Purchasers: Davinder Singh Mandair & Harmeet Kaur Mandai **Property:** 8 of Plan - TBA
Telephone Res. / Bus: (416) 799-0978 / **Project:** Thames Developments (2011) Ltd.
Decor Advisor: Steffannee Appio **Model and Elevation:** Bruce (50-5) Elev B

Layout Changes: ☐ Yes ☒ No **Sketch Attached:** ☐ Yes ☒ No **Exterior Colour Scheme:**

1. Cabinetry

	Style and Colour	Counter Top	Hardware
Kitchen / Breakfast	ST. LAWRENCE WHITE SUGAR	4230 SHITAKE CAESARSTONE	9677 HANDLE
Kitchen Island	ST. LAWRENCE WHITE SUGAR	4230 SHITAKE CAESARSTONE	9677 HANDLE
Laundry Room	CAMDEN OAK OREGANO	P277-LM ST. LAWRENCE BEDR	9671 HANDLE
Powder Room	CAMDEN OAK OREGANO	P277-LM ST. LAWRENCE BEDR	9671 HANDLE
Main Bathroom			
Master Ensuite Bathroom	HUDSON ONTARIO WHITE	P346-LM INUKSHUK CARBON	9660 HANDLE
Second Ensuite Bathroom (If Applicable)	CAMDEN OAK OREGANO	4726K-52 MILANO QUARTZ	9671 HANDLE
TWIN BATH	CAMDEN OAK CAVIAR CL	4925K-07 CALCUTTA MARBLE	9661 HANDLE

Appliances
Custom Size Fridge ☒ Yes ☐ No **Valance Lighting** ☐ Yes ☒ No **Microwave / Range Hood** ☐ Yes ☒ No
Cooktop / Rangetop ☒ Yes ☐ No **Built in Wall Oven** ☒ Yes ☐ No **Slide-in Range** ☐ Yes ☒ No

Comment

STANDARD EDGE PROFILE TO STONE COUNTER-TOP IN KITCHEN

2. Flooring

	Selection
FOYER	12" X 24" TIMELESS POLISHED TAUPE (OV.TL.TPE.1224.PL) STANDARD STACKED INSTALL
Main Hall	12" X 24" TIMELESS POLISHED TAUPE (OV.TL.TPE.1224.PL) STANDARD STACKED INSTALL
Back Hall	
Breakfast	12" X 24" TIMELESS POLISHED TAUPE (OV.TL.TPE.1224.PL) STANDARD STACKED INSTALL
Laundry Room	12" X 24" TIMELESS POLISHED TAUPE (OV.TL.TPE.1224.PL) STANDARD STACKED INSTALL
Kitchen	12" X 24" TIMELESS POLISHED TAUPE (OV.TL.TPE.1224.PL) STANDARD STACKED INSTALL
Powder Room	12" X 24" TIMELESS POLISHED TAUPE (OV.TL.TPE.1224.PL) STANDARD STACKED INSTALL
Main Bathroom	
Master Ensuite	12" X 24" TIMELESS POLISHED LIGHT GREY (OV.TL.LGR.1224.PL) STANDARD STACKED
Bathroom (If Applicable)	13" X 13" REFLEX TAUPE (GE.RF.TPE.1313) ENSUITE 2
Mud Room	
TWIN BATH	12" X 12" REGAL JET BLACK POLISHED (NY.RG.JBK.1212.PL)
Living Room	3-1/2" X 3/4" OAK -ELEMENTS STURGEON COLOUR
Dining Room	3-1/2" X 3/4" OAK -ELEMENTS STURGEON COLOUR
Family / Great Room	3-1/2" X 3/4" OAK -ELEMENTS STURGEON COLOUR
Den / Library / Study	3-1/2" X 3/4" OAK -ELEMENTS STURGEON COLOUR
Basement Landing (If Applies)	
Lower Landing (If Applicable)	12" X 24" TIMELESS POLISHED TAUPE (OV.TL.TPE.1224.PL) GARAGE ENTRANCE/POWDER LANDI
Upper Landing	
Upper Hall	3-1/2" X 3/4" OAK -ELEMENTS STURGEON COLOUR
Master Bedroom	MOHAWK SO SWEET #01 WITH STANDARD UNDERPAD
Bedroom #2	MOHAWK SO SWEET #01 WITH STANDARD UNDERPAD
Bedroom #3	MOHAWK SO SWEET #01 WITH STANDARD UNDERPAD
Bedroom #4	MOHAWK SO SWEET #01 WITH STANDARD UNDERPAD
Bedroom #5	

Flooring Continued on Page 2

Initial:

Akm DM

Page 1 of 3

INTERIOR COLOUR SCHEME

Purchasers: Davinder Singh Mandair & Harmeet Kaur Mandai **Property:** 8 of Plan - TBA
Telephone Res. / Bus: (416) 799-0978 / **Project:** Thames Developments (2011) Ltd.
Decor Advisor: Steffannee Appio **Model and Elevation:** Bruce (50-5) Elev B

2. Flooring - Continued -

Upgrade Underpad	Type STANDARD	Area ALL BEDROOMS
Carpet on Stairs	Capped	Runner - *Upgrade
Comment		

MOHAWK SO SWEET #01 WITH STANDARD UNDERPAD

3. Plumbing Fixtures / Faucets

Kitchen	UPG	Second Ensuite	STD	Powder Room	STD
Master Ensuite	STD			Other Room	
Main Bathroom		TWIN BATH	STD		

Comment

UPGRADE - UNDERMOUNT SINK AND SINGLE HOLE FAUCET IN KITCHEN

4. Wall Tile

	Tile Selection	Listello	Insert	Insert Selection
Main Bathroom		<input type="checkbox"/>	<input type="checkbox"/>	
Master Ensuite				
Tub Deck	12" X 24" TIMELESS POLISHED LIGHT GREY	<input type="checkbox"/>	<input type="checkbox"/>	OV.TL.LGR.1224.PL
Tub Apron	12" X 24" TIMELESS POLISHED LIGHT GREY	<input type="checkbox"/>	<input type="checkbox"/>	
Tub Surround	12" X 24" TIMELESS POLISHED LIGHT GREY	<input type="checkbox"/>	<input type="checkbox"/>	
Shower Stall	12" X 24" TIMELESS POLISHED LIGHT GREY	<input type="checkbox"/>	<input type="checkbox"/>	
Second Ensuite	8" X 10" REFLECTION TAUPE	<input type="checkbox"/>	<input type="checkbox"/>	QT.RF.TPE.0810
TWIN BATH	8" X 10" SERPENTINE SYRAK CHARCOAL	<input type="checkbox"/>	<input type="checkbox"/>	TR.ST.SRK.0810
		<input type="checkbox"/>	<input type="checkbox"/>	
Kitchen Backsplash		<input type="checkbox"/>	<input type="checkbox"/>	
Complete Backsplash		<input type="checkbox"/>	<input type="checkbox"/>	

Comment

STANDARD 2" X 2" MOSAIC WHITE SHOWER FLOOR TILE IN MASTER ENSUITE AND TWIN BATH SHOWER STALLS

5. Fireplace

	Living Room			Family Room			Other Room - Specify		
	Purchased	As Per Plan	N/A	Purchased	As Per Plan	N/A	Purchased	As Per Plan	N/A
Fireplace Type	<input type="radio"/>	<input type="radio"/>	<input type="radio"/>	<input type="radio"/>	<input checked="" type="radio"/>	<input type="radio"/>	<input type="radio"/>	<input type="radio"/>	<input type="radio"/>
Mantle Type				STANDARD					
Over Mantle				STANDARD ER22 WHITE PAINT					
Colour / Stain									
Surround				NERO					
Hearth									

Comment

Initial: HKM D.M

Page 2 of 3

INTERIOR COLOUR SCHEME

Purchasers: Davinder Singh Mandair & Harmeet Kaur Mandair **Property:** 8 of Plan - TBA
Telephone Res. / Bus: (416) 799-0978 / **Project:** Thames Developments (2011) Ltd.
Decor Advisor: Steffannee Appio **Model and Elevation:** Bruce (50-5) Elev B

6. Trim Carpentry

Door Hardware

Interior Trim

Comment

Interior Doors

☐ 2 Panel Arch Top

☐ 2 Panel Square Top

☒ 6 Panel



Initial for Door Style HKM D.M

7. Railings and Pickets

Railing Package

Railing Colour

Wood Stairs ☐ No ☒ Oak

Picket Colour

Tread Colour

Comment

STAIN OAK STAIRS TO COMPLIMENT HARDWOOD - ELEMENTS STURGEON COLOUR

8. Plaster Mouldings and Medallions

Foyer

Kitchen/Breakfast

Main Hall

Den/Library

Living Room

Lower Landing

Dining Room

Family Room

Comment

9. Wall Paint

STANDARD SENATOR WHITE

Smooth Ceilings

☐ First Floor

☐ First Floor incl. Second Floor Hall

☐ First and Second Floor

☐ Throughout

☒ Not Applicable

Trim Paint

10. Additional Comments

11. Disclaimers and Notes

- Colours of all materials are as close as possible to builder's selection, but not necessarily identical due to variances in manufacturing.
- Any extras listed above are null and void unless accompanied by a separate invoice/amendment. Said invoice must be paid in full.
- The Purchaser acknowledges that after Interior Colour Selection form is signed and dated, no further changes will be permitted other than re-selection due to unavailability. _____ Purchaser's Initials
- The Purchaser acknowledges reading and accepting the "Senator Homes Décor Centre Disclaimers" form. This document contains other miscellaneous disclaimers.

This Interior Colour Selection is final and approved by:

Purchaser:

Signature: Harmeet K. Mandair Date: DEC 4/17

Signature: Davinder Mandair Date: Dec 4-2017 Vendor: _____

Thames Developments (2011) Ltd.

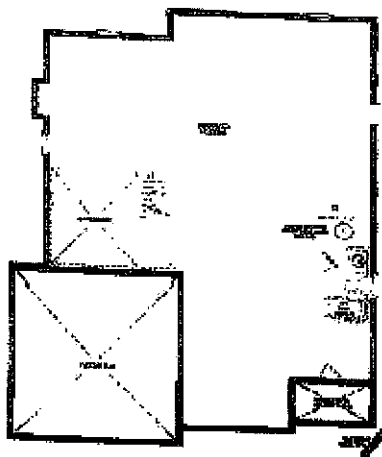
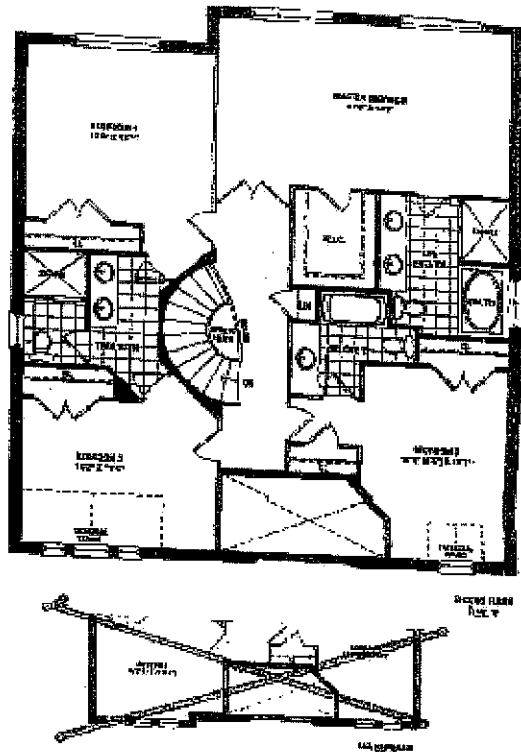
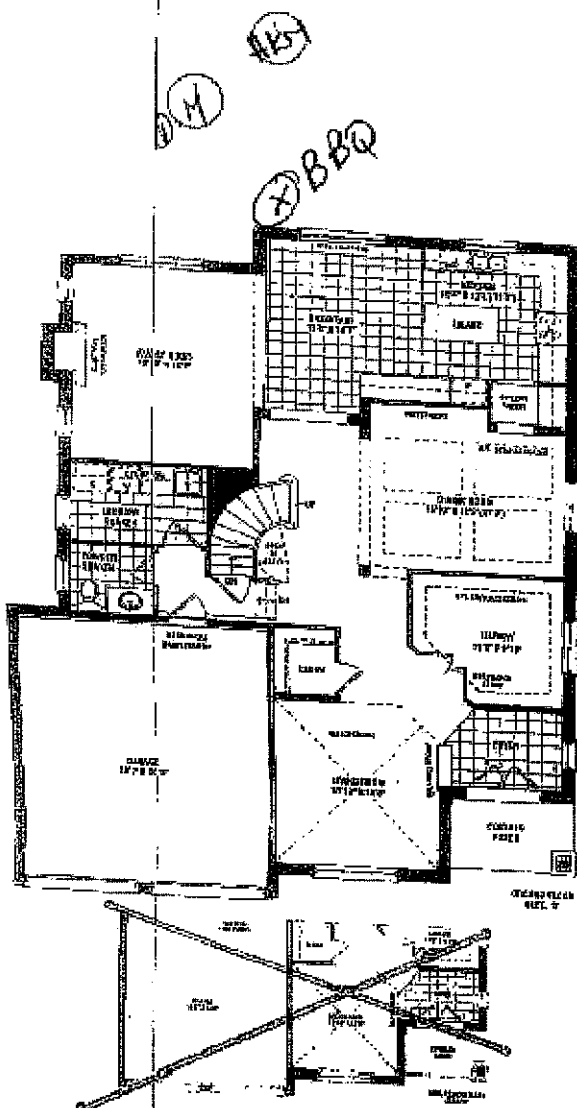

Lot 8
Phase 3

Bruce
3,145 SQ. FT. ELEV. B
~~2,155 SQ. FT. ELEV. C~~

Sonumandair@hotmail.com



This sketch is provided solely for reference to those items noted on the accompanying "Upgrades/Extras". All other details, dimensions & features are for illustrative purposes only and may not be applicable to the Purchased Model.

Site 10010 10010

Date 10/9/17

Purchaser Initials <u>HK</u>	Production Initials _____
------------------------------	---------------------------

W.D.

10/10/2019

~~SECRET~~

16/11/2015

Micro
Wave
oven

Tracy

a) extend island with flush bar
by 1' foot

6pm
6:15

This sketch is for DESIGN PURPOSES ONLY – It is not meant to be an exact rendition.

F R E N D E L
K I T C H E N S L I M I T E D
1380 Thompson Drive, Alhambra, CA 91801

HaveLock Corner PH3A
(Woodstock)
Bruce/50-5

STANDARD FEATURES:

- 100cm Uppers
- Crown moulding
- Light valance
- Bank of drawers as specified on plan
- Pot/pan drawers as specified on plan
- Blum Tandembox Antaro soft-closing drawers
- Opening for 36" FR (95cm x 180cm)
- Laminate countertops
- Laundry base as specified on plan
- Opt. Laundry uppers as specified on plan

Drawn By: Bethany O
Date: Oct 06, 2017
Scale: Not To Scale

Approved By Builder

Date:

- SCHEDULE B1**

This sheet is provided to be filled out by the purchaser in accordance with the instructions on the back of the sheet. The purchaser is responsible for providing the necessary information to the manufacturer.

Site Thames Plot

Date 12/4/17

Purchaser initials DM Production initials _____

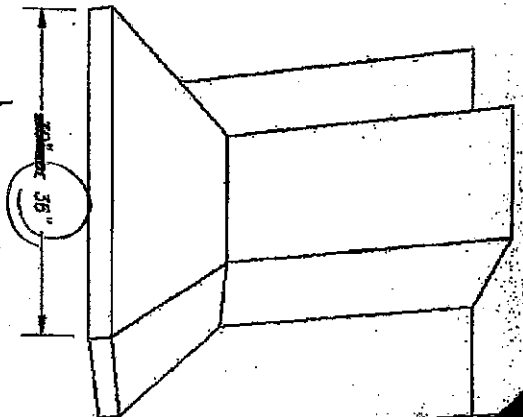

The standard 77cm. wide stove upper will be installed so the standard fan can be installed for occupancy purposes. Cabinet and fan will be removed by purchaser after closing. Builder will not be held responsible for any damage to wall or adjacent cabinetry after removal.

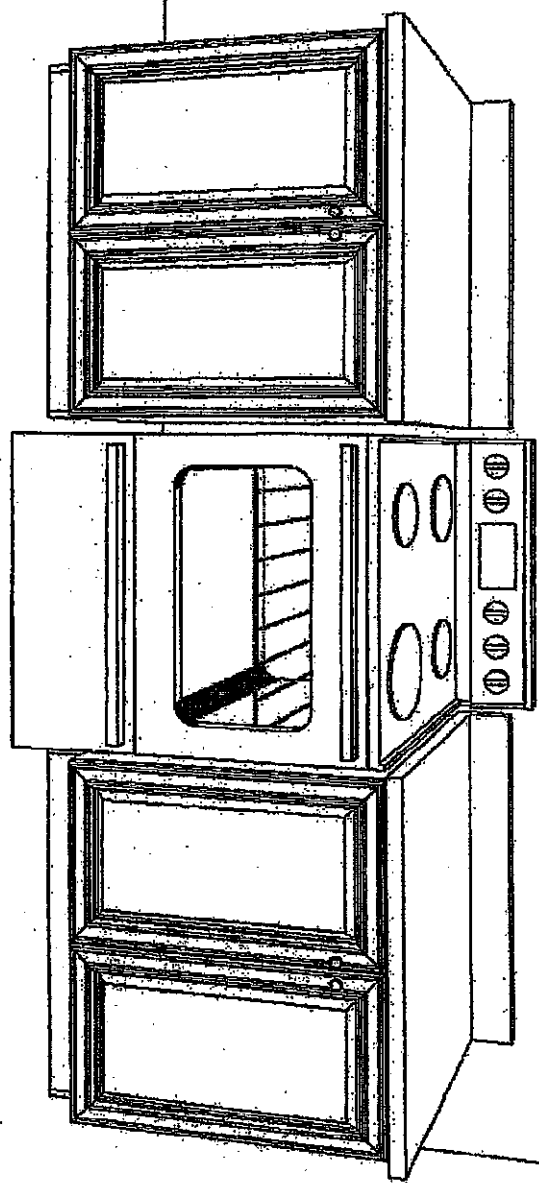
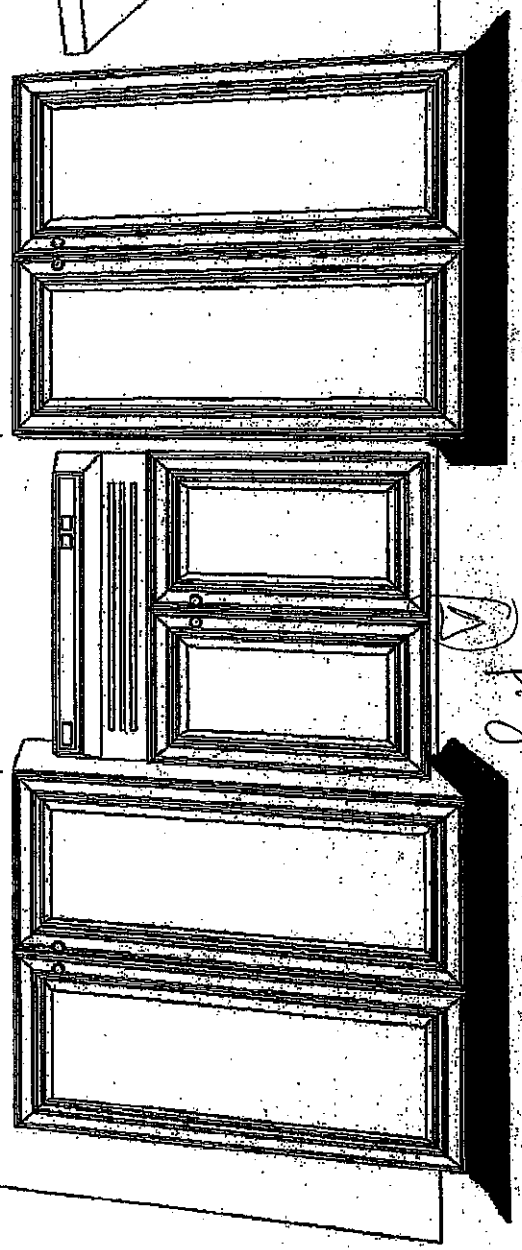

Steffanee Appio

From: Narinder Singh <narinder@elitehomestore.ca>
Sent: Tuesday, December 05, 2017 4:01 PM
To: Steffanee Appio; SONUMANDAIR@hotmail.com
Subject: Appliances Specs For LOT# 08 phase 3(DAVINDER SINGH MANDAIR)
Attachments: 10077_NQ70M7770DS_V6.pdf; DW80M9960_V4.pdf; Family_Hub_2017_Refrigerator_French-Door_RF22M9581SG_SPEC_SHEET.pdf; NA36K7750TS.PDF; NK36K7000WS.PDF

Hi

Please Check the attached for appliances dimension
if you have any questions feel free to contact

Refrigerator-----RF22M9581SG

Cooktop-----NA36K7750TG

Waloven Combo-----NQ70M7770DG

Rangehood-----NK36K7000WG

Dishwasher-----DW80M9960UG

Thanks
Narinder Singh
647-462-1499

hot 8-Thomas
3B
12/6/17

NQ70M7770DS

SAMSUNG

30" Microwave Combination Wall Oven

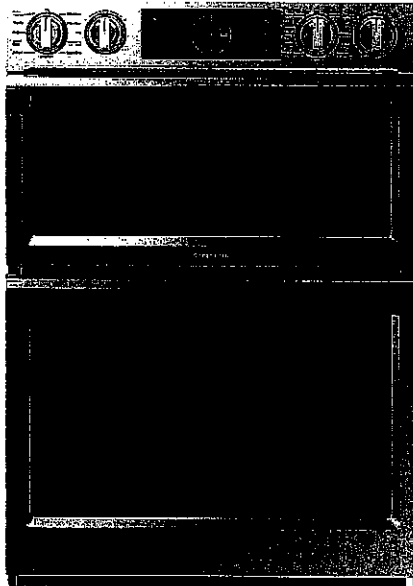

Signature Features

Steam Cook (Oven)

- Delivers moisture at precise times for a crisp, browned outside and tender inside.

Speed Cook (Microwave)

- Cook food faster and more evenly by using power convection.

Flex Duo™ (Oven)

- Cook two dishes at different temperatures simultaneously with the Smart Divider.

Available Colors



Stainless Steel (shown)



Black Stainless Steel



Steam Cook

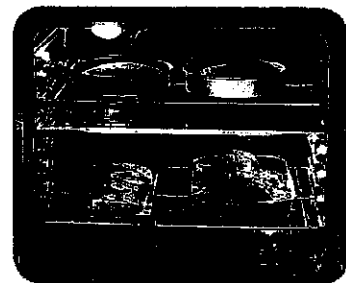

Flex Duo™

Features

- Digital-Analog Controls
- 1.9/5.1 cu. ft. Capacity
- Hybrid Clean and Self-Clean (Oven)
- Gourmet Cook (Oven)
- Dual Convection (Oven)
- Wi-Fi Connectivity
- Wi-Fi Enabled Temperature Probe (Oven)
- LED Spotlights (Oven)
- Easy View Window
- 3 Heavy-Duty Racks including a Gliding Rack (Oven)
- Soft-Close Door (Oven)
- Ceramic Plate (Microwave)
- Rapid Preheat (Oven)
- Auto Latch Microwave Door
- 6 Oven Modes including Steam Bake and Steam Roast
- Blue LED Illuminated Knobs
- Broil Element
- Smart Control Key (Oven)
- 6 Rack Positions (Oven)
- Drop-Down Door Design
- LCD Display

Convenience

- Hidden Heating Element (Oven)
- Sabbath Mode (Oven)
- Delay Start (Oven)
- Proofing (Oven)
- Warming Mode (Oven)
- Kitchen Timer
- Child Safety Lock
- Convection Conversion

Hot & Thermo
37-
12/10/17

NQ70M7770DS

30" Microwave Combination Wall Oven

SAMSUNG

Cabinet Dimensions

Combination Oven Installed in Cabinet

*Junction Box

**Allow a minimum of 22" for clearance to adjacent corners, drawers, walls, etc. when door is open.

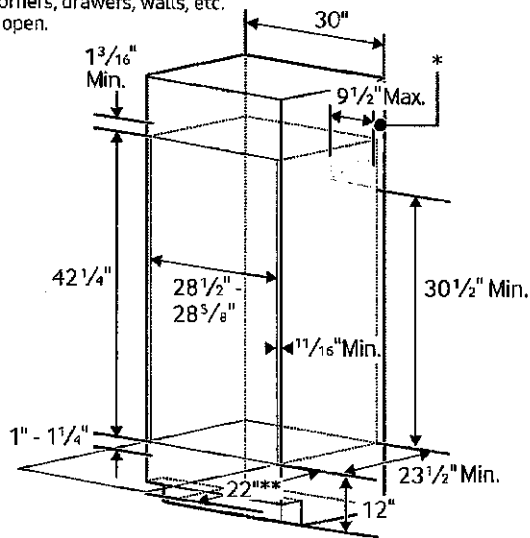

Product Dimensions

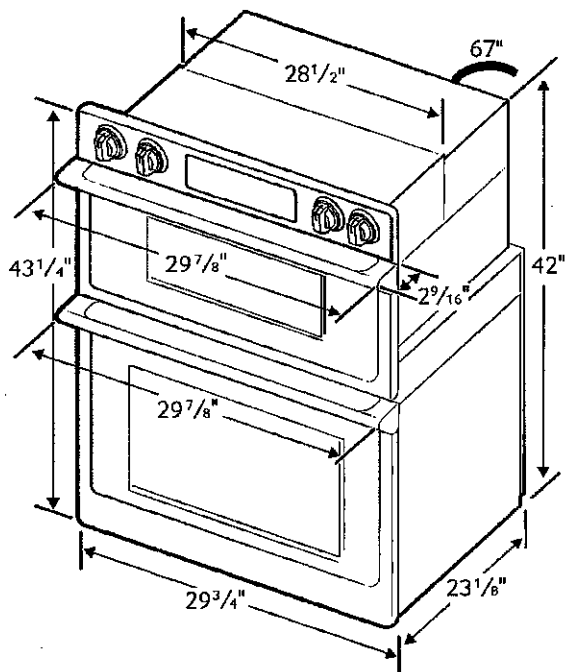

Total Capacity: 1.9/5.1 cu. ft.

- Microwave: 1.9 cu. ft.
- Wall Oven: 5.1 cu. ft. total, 2.8/2.2 cu. ft.
- Hidden Bake Element
- Bake: 175°F–550°F
- Convection Bake: 175°F–550°F
- Convection Roast: 175°F–550°F
- Broil: Low-High
- Steam Bake: 230°F–550°F
- Steam Roast: 230°F–550°F
- Proofing
- Sabbath Mode

Warranty

One (1) Year All Parts and Labor
Ten (10) Years Parts Warranty for Magnetron

Product Dimensions & Weight (WxHxD)

Outside (Max) Combination Oven Dimensions:
29 7/8" x 43 1/4" x 25 11/16"

Combination Oven Cut-Out Dimensions:
28 1/2" x 42 1/4" x 23 1/2"

Weight: 119 lbs.

Shipping Dimensions & Weight (WxHxD)

Dimensions:
33 5/8" x 48 3/16" x 29 51/64"

Weight: 132.5 lbs.

Color

Stainless Steel
Black Stainless Steel

Model

NQ70M7770DS
NQ70M7770DG

UPC Code

887276195186
887276195162

RATING	
240V	9.5 kW
208V	7.2 kW
BREAKER SIZE	
240V	40 Amps
208V	40 Amps

Actual color may vary. Design, specifications, and color availability are subject to change without notice. Non-metric weights and measurements are approximate.
©2017 Samsung Electronics America, Inc. 85 Challenger Road, Ridgefield Park, NJ 07660. Tel: 800-SAMSUNG. samsung.com. Samsung is a registered trademark of Samsung Electronics Co. Ltd.

hot 8 homes
317
12/6/17

NA36K7750TS

36" Gas Cooktop



Stainless Steel
(Shown)



Black Stainless Steel

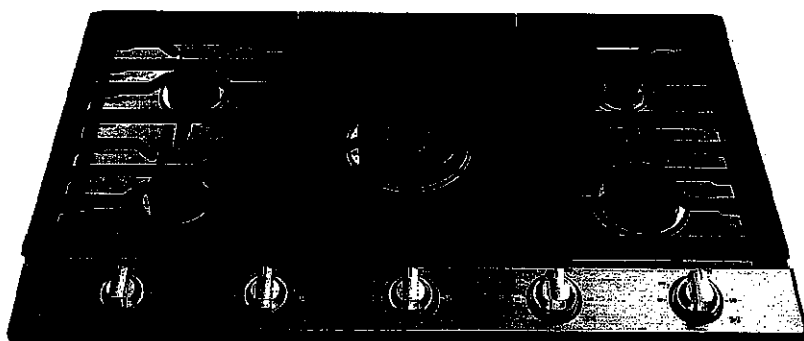

Features

- Bluetooth Connected to Hood
- WiFi Connectivity
- Powerful Cooktop
 - Right Front: 13K BTU
 - Left Front: 9.5K BTU
 - Right Rear: 5K BTU
 - Left Rear: 9.5K BTU
 - Center: Dual, 22K BTU (Oval)
- Cast Iron 3-Piece Grates
- Sealed Burners
- Burner On/Off Monitoring

Convenience

- Wok Grate
- Dishwasher Safe Grates
- LP Conversion Kit



22K True Dual Power Burner

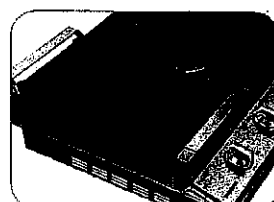

Cast Iron Griddle

Signature Features

22K BTU True Dual Power Burner

- Two independent burners offer intense heat and precise control to quickly boil water or temper chocolate.

LED Illuminated Backlit Knobs

- Visually lets you know your cooktop is on, even at a distance.

Cast Iron Griddle

- Cook breakfast foods, grill sandwiches, or sauté vegetables on the griddle.

SAMSUNG

Lot 8 Themed
37-
12/6/17

NA36K7750TS

36" Gas Cooktop

Installing Your Cooktop

Can be installed over a single oven.

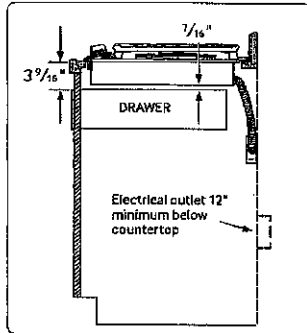

All horizontal clearances must be maintained for a minimum of 18" above the cooking surface.

Allow 7/16" minimum vertical clearance from the cooktop bottom (or 39/16") minimum depth from the countertop) to any combustible surfaces, including the upper edge of a drawer installed below the cooktop.

See built-in oven installation for complete installation instructions.

Maintain the following minimum clearance dimensions.

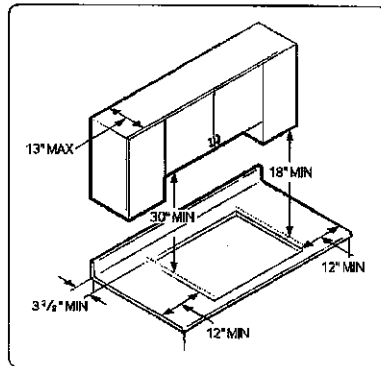
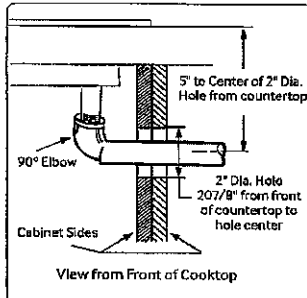

Total Power (BTU)

■ 59K

Power Source

■ 120V/60Hz

Gas Cooktop (BTU)

- Right Front: 13K
- Left Front: 9.5K
- Right Rear: 5K Simmer
- Left Rear: 9.5K
- Center: 22K (Dual)

Warranty

One (1) Year All Parts and Labour

Dimensions

Cooktop Dimensions

Refer to installation manual for more details.

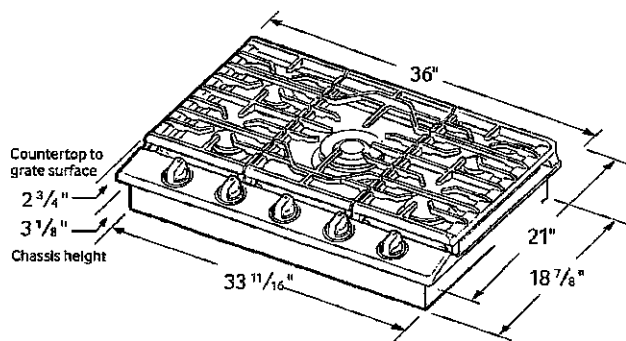

Cut-out Dimensions of Countertop

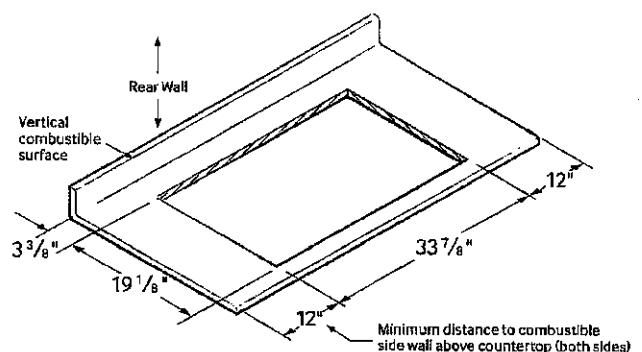

COLOUR	MODEL #	UPC CODE
Stainless Steel	NA36K7550TS	887276183572
Black Stainless Steel	NA36K7550TG	887276183503

PLEASE VISIT SAMSUNG.COM FOR OUR LATEST UPDATES.

Actual colour may vary. Design, specifications, and colour availability are subject to change without notice. Non-metric weights and measurements are approximate.

© 2016 Samsung Electronics Canada Inc. All rights reserved. Samsung is a registered trademark of Samsung Electronics Co., Ltd., used with permission.

SAMSUNG

hot 3177hames
hot 8
6/6/17

NK36K7000WS

36" Range Hood



Stainless Steel
(Shown)



Black Stainless Steel

Features

- 600 CFM Ventilation System
- 3 Fan Speeds including Booster
- Wall-Mounted Chimney Style
- Digital Touch Control
- Exterior Venting

Convenience

- LED Lighting

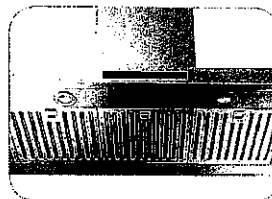
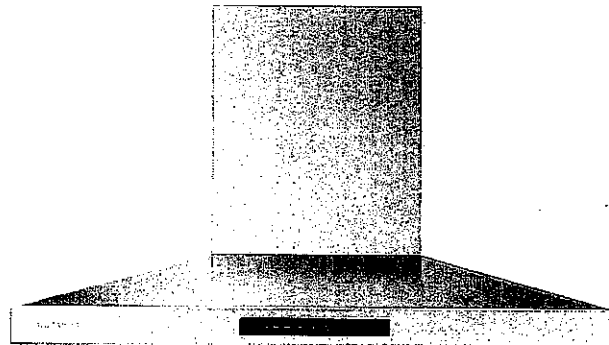

Baffle Filter



WiFi Monitoring

Signature Features

Bluetooth Connected Hood

- Automatically sync the fans and the lights with the burners through Bluetooth.¹

¹Only on select Samsung cooktops.

Baffle Filter

- Dishwasher-safe metal filters help keep the air clean by drawing grease and odor through the hood.

WiFi Monitoring

- Control the connected hood vent and LED lights remotely from your smartphone.²

²Only when synced with select Samsung cooktops. Available on android and iOS.
WiFi connection required.

SAMSUNG

hot8-Thames
317
12/6/17

NK36K7000WS

36" Range Hood

Venting Methods

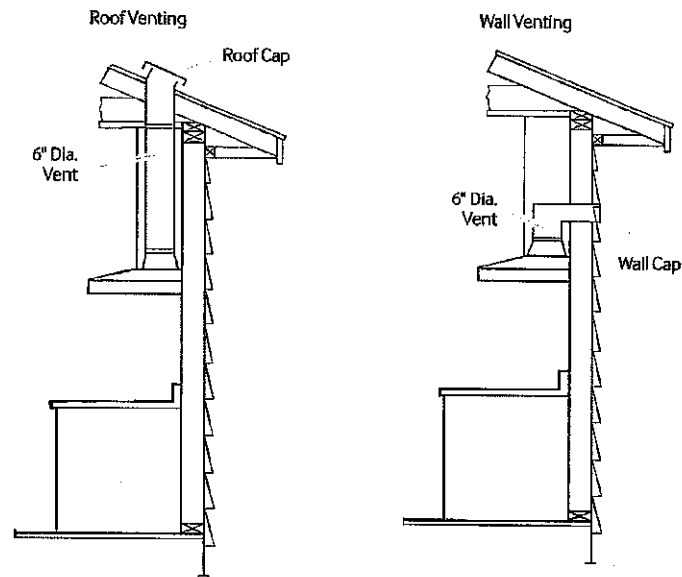

Total Power

≈ 220 W

Power Source

≈ 120 V/60 Hz

Range Hood

- ≈ 36," Stainless Steel Chimney Hood
- ≈ Vent Fan: 600 CFM
- ≈ Front-Centered, Touch Control
- ≈ 4 Fan Speeds: 3 Step, 1 Booster
- ≈ Hood Connectivity Control
- ≈ Bluetooth On/Off Control
- ≈ Mobile Monitoring: Fan Speed, Lighting On/Off, Power Control
- ≈ Removable Baffle Filter
- ≈ LED Lighting

Warranty

One (1) Year All Parts and Labour

Dimensions and Clearance

Refer to installation manual for more details.

** For Vented Installation

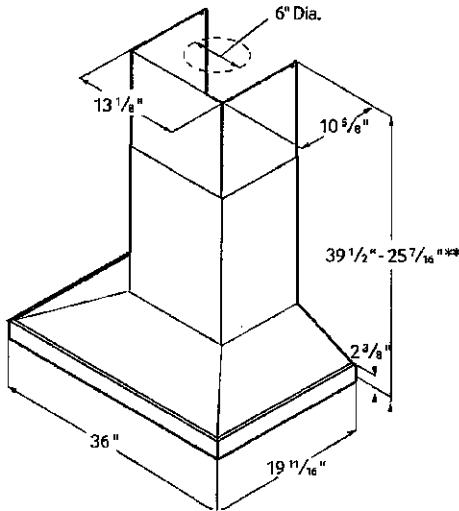

COLOUR	MODEL #	UPC CODE
Stainless Steel	NK36K7000WS	887276182988
Black Stainless	NK36K7000WG	887276182971

PLEASE VISIT SAMSUNG.COM FOR OUR LATEST UPDATES.

Actual colour may vary. Design, specifications, and colour availability are subject to change without notice.

Non-metric weights and measurements are approximate.

© 2016 Samsung Electronics Canada Inc. All rights reserved. Samsung is a registered trademark of Samsung Electronics Co., Ltd., used with permission.

SAMSUNG

hot #8 names
317
12/6/17

RF22M9581SR

SAMSUNG

Samsung Counter-Depth, 4-Door Flex™ with Family Hub™

22 cu. ft. Capacity

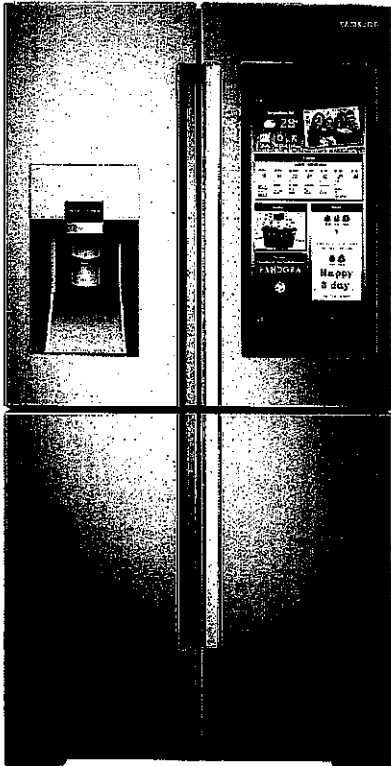

Signature Features

Family Connection

- Share multiple calendars, photos and notes.

Food Management

- 3 built-in cameras take a picture of the inside of your fridge; order groceries online from the touchscreen.

Entertainment

- Stream music, videos, mirror your TV.

Available Colors



Stainless Steel (shown)



Black Stainless Steel

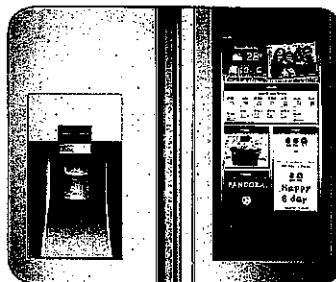

Family Hub™

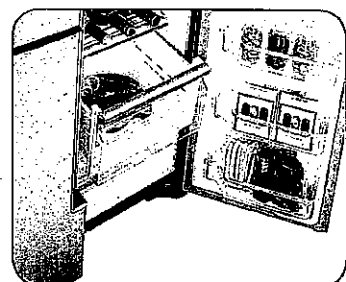

FlexZone™

Features

- Profile Base Communication Apps
- S-Voice – Integrated Voice-Activated Features
- One Family Hub™ Experience Integrated Mobile App
- FlexZone™
- Triple and Metal Cooling
- Large Capacity – 22 cu. ft.
- External Filtered Water and Ice Dispenser
- Ice Master Ice Maker in the Refrigerator
- High-Efficiency LED Lighting
- Wine Rack
- Fingerprint-Proof Coating
- ENERGY STAR® Compliant
- EZ Slide-Out Shelves in Freezer and FlexZone™
- Counter-Depth

Convenience

- Tempered Glass Spill-Proof Shelves
- Gallon Door Bins
- Flip-Up Shelf
- Door Alarm
- Water Filter Indicator

Rating



ENERGY STAR®-rated:
709 kWh/yr

hot #8-Thames
317
12/16/17

RF22M9581SR

SAMSUNG

Samsung Counter-Depth, 4-Door Flex™ with Family Hub™

22 cu. ft. Capacity

Installation Specifications

1. Measure the height, width and depth of the opening, making sure to include baseboards, molding tile, countertop overhang, etc. Check to be sure there is enough room to open the door (consider walls, islands or other obstacles when measuring).
2. Refer to illustration below to determine dimensions.
3. Allow 2.5" of clearance on hinge side of refrigerator when installing next to a wall where handle may make contact.
4. Allow 1" minimum clearance at rear for proper air circulation and water/electrical connections. Allow a 3/8" minimum clearance at sides and top for ease of installation.
5. Ensure each door and entryway in the home is wide enough for the refrigerator to be moved through easily.

For optimal usage and to be able to open refrigerator doors completely, do not install next to a wall.

Please note: The following dimension and cutout information is for planning purposes only. For complete installation details, consult manual packed with product, or download manual online at samsung.com.

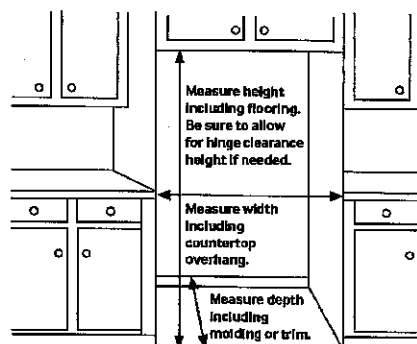

Dimensions

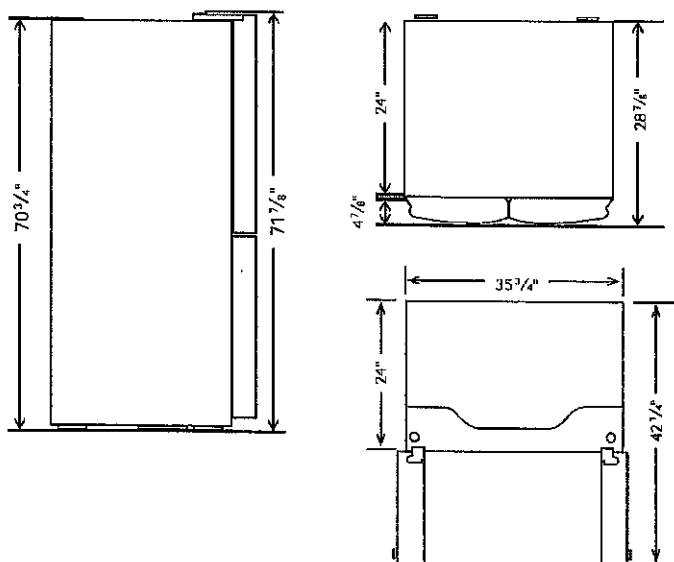

Total Capacity: 22 cu. ft.

Refrigerator: 13.2 cu. ft.

- Premium External Filtered Water and Ice Dispenser (Crushed or Cubed Ice)
- Ice Master Ice Maker
- 2 Humidity-Controlled Crispers
- Gallon Door Bins
- 5 Tempered Glass Spill-Proof Shelves
 - 1 Slide-In
 - 1 Flip-Up
 - 3 Fixed
- Wine Rack
- High-Efficiency LED Lighting

FlexZone™: 4.4 cu. ft.

- 1 EZ Slide-Out Shelf
- 2 Drawers
- 5 Temperature Zones:
 - 41°F
 - 35°F
 - 30°F
 - 23°F
 - -8°F – 5°F
- High-Efficiency LED Lighting

Freezer: 4.4 cu. ft.

- 1 EZ Slide-Out Shelf
- 2 Freezer Drawers
- High-Efficiency LED Lighting

Warranty

One (1) Year Parts and Labor on Refrigerator

Five (5) Years Parts and Labor on

Sealed Refrigeration System Only*

Ten (10) Years Parts and Five (5) Years

Labor on Digital Inverter Compressor

*Compressor, evaporator, condenser, drier and connecting tubing.

Product Dimensions & Weight

Dimensions (WxHxD with hinges, handles and doors):

35 3/4" x 71 7/8" x 28 7/8"

Dimensions (WxHxD without hinges and door):

35 3/4" x 70 3/4" x 24"

Dimensions (WxHxD with hinge and door, no handle):

35 3/4" x 71 7/8" x 28 7/8"

Weight: 350.5 lbs.

Shipping Dimensions & Weight (WxHxD)

Dimensions: 38 5/16" x 78" x 31 5/16"

Weight: 374.7 lbs.

Color	Model #	UPC Code
Stainless Steel	RF22M9581SR	887276197999
Black Stainless Steel	RF22M9581SG	887276197982

Actual color may vary. Design, specifications, and color availability are subject to change without notice. Non-metric weights and measurements are approximate.

©2017 Samsung Electronics America, Inc. 85 Challenger Road, Ridgefield Park, NJ 07660. Tel: 800-SAMSUNG. samsung.com. Samsung is a registered trademark of Samsung Electronics Co., Ltd.

hof #8
Thames
3A
12/6/17

DW80M9960

Samsung WaterWall™ Dishwasher

SAMSUNG

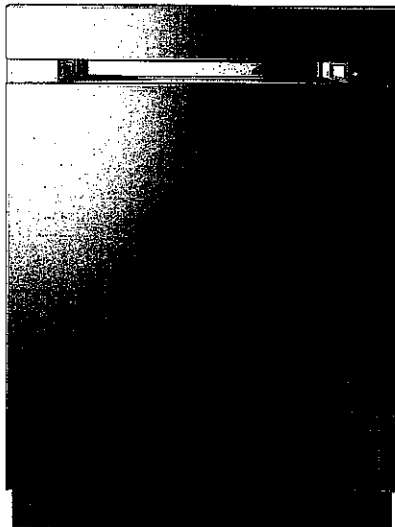

Signature Features

WaterWall™ Linear Wash System

- A powerful, streaming wall of water delivers remarkable cleaning results. Maintains maximum pressure from corner to corner.

AutoRelease™ Door

- At the end of a cycle, the door automatically pops open to circulate air and accelerate drying time.

Zone Booster™

- Target different zones of your dishwasher with custom settings.

Available Colors



Stainless Steel (shown)



Black Stainless Steel

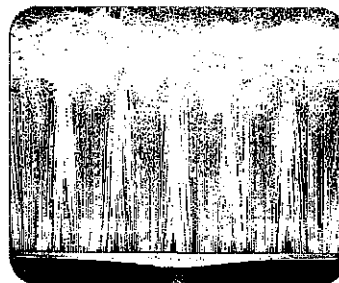

WaterWall™ Linear Wash System

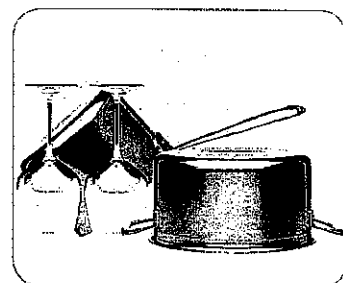

Zone Booster

Features

- Third Rack with FlexTray™
- Quiet Operation: 38 dBA
- Wi-Fi Connectivity
- 7 Wash Cycles
- 8 Options
- ENERGY STAR® rated: 239 kWh/Year
- Express Cycle: 60 Minutes
- One-Touch Adjustable Racking System
- 15 Place Settings
- Digital Leak Sensor
- Indicator Light

Convenience

- Child Lock
- Delay Start

Lot 8-Thomas
317
12/6/17

DW80M9960

Samsung WaterWall™ Dishwasher

SAMSUNG

Installation Specifications

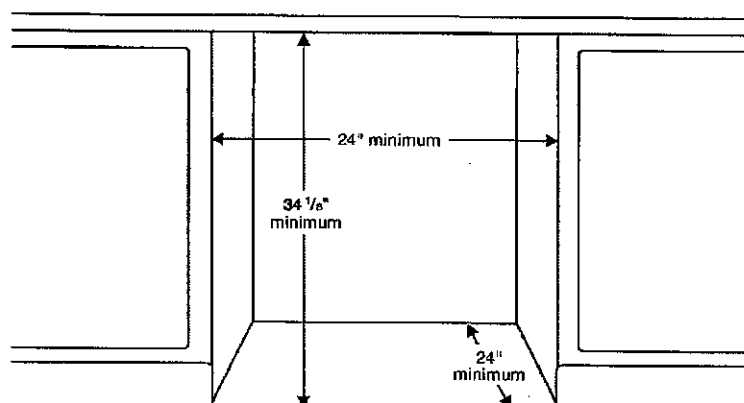

Features

- 7 Wash Cycles: Auto, Normal, Heavy, Delicate, Express 60, Rinse Only, Self Clean
- 8 Options: Half-Load Wash (Lower Rack), Zone Booster (Left), Speed Booster, Hi-Temp Wash, Sanitize (Anti-bacterial – NSF), Delay Start, Control Lock, Smart Control (Wi-Fi App)
- AutoRelease™ Door
- Hidden Heat Element
- Stainless Steel Interior Tub

Convenience

- Child Lock
- Digital Water Leakage Sensor
- Third Rack with FlexTray™
- One-Touch Adjustable Racking System
- Silverware Basket
- Upper Rack: 2 Cup Shelves, 2 Adjustable Tines
- Lower Rack: Fold-Down Tines

Warranty

One (1) Year All Parts and Labor

Five (5) Year Limited on Printed Circuit Board and Interior Nylon Racks

Lifetime Limited Warranty on Stainless Steel Door Liner and Tub for Leakage

Dimensions

Side View

Rear View

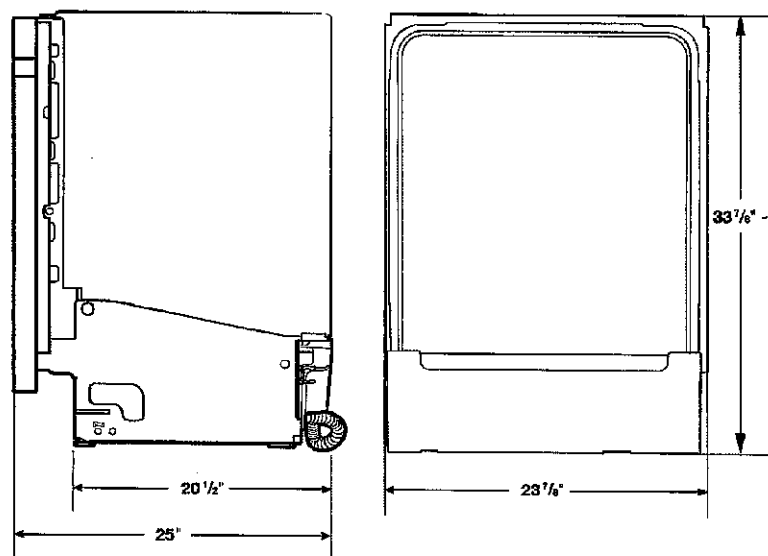

Product Dimensions & Weight (WxHxD)

Dimensions:
23 7/8" x 33 7/8" x 25"

Weight: 95 lbs.

Shipping Dimensions & Weight (WxHxD)

Dimensions:
26" x 34 3/4" x 29 3/4"

Weight: 101 lbs.

Color	Model #	UPC Code
Stainless Steel	DW80M9960US	887276194172
Black Stainless Steel	DW80M9960UG	887276197838

Actual color may vary. Design, specifications, and color availability are subject to change without notice. Non-metric weights and measurements are approximate.
©2017 Samsung Electronics America, Inc. 85 Challenger Road, Ridgefield Park, NJ 07660. Tel: 800-SAMSUNG. samsung.com. Samsung is a registered trademark of Samsung Electronics Co., Ltd.