



CONSTRUCTION SUMMARY

Teefy Developments (Bathurst Glen) Limited / NIDO

Lot/Unit: 45    Phase/Building: 1    Model/Floor Plan: Eagle (25-5) Elev B 3 Bed

CABINETRY

Inv.4213	1 - LOCATION: KITCHEN  BUILT IN DOUBLE APPLIANCE CABINET WITH DRAWER BELOW - PURCHASER MUST SUPPLY SPECS -  Line 53599      Note: LOCATION AS PER SKETCH ATTACHED  4Oct17 / 4Oct17	
Inv.4213	3 - LOCATION: KITCHEN  SUPPLY AND INSTALL ADDITIONAL THREE (3) FEET OF BASE CABINETS TO ACCOMODATE BUILT IN APPLIANCES BASE CABINET 30 CM (24 INCH) DEEP  Line 53604      Note: LOCATION AS PER SKETCH ATTACHED  4Oct17 / 4Oct17	
Inv.4213	3 - LOCATION: KITCHEN  SUPPLY AND INSTALL ADDITIONAL THREE (3) FEET OF UPPER CABINETS TO ACCOMODATE BUILT IN APPLIANCES  Line 53605      Note: LOCATION AS PER SKETCH ATTACHED  4Oct17 / 4Oct17	
Inv.4213	1 - LOCATION: KITCHEN  SUPPLY AND INSTALL DEEP UPPER CABINETS WITH TWO (2) 66CM SIDE GABLES  Line 53606      Note:  4Oct17 / 4Oct17	
Inv.4213	1 - LOCATION: KITCHEN  SUPPLY AND INSTALL 36" STOVE AND HOOD FAN OPENING IN LIEU OF STANDARD 30"  Line 53607      Note:  4Oct17 / 4Oct17	
Inv.4213	1 - LOCATION: KITCHEN  SUPPLY AND INSTALL FINSIHED SIDES TO UPPER CABINETS ABOVE STOVE. PURCHASER TO SUPPLY AND INSTALL THEIR OWN HOOD FAN AFTER CLOSING  Line 53608      Note:  4Oct17 / 4Oct17	

CABINETRY ACCESSORIES

Inv.4213	1 - LOCATION: KITCHEN  COOKTOP CABINET (FULL HEIGHT) WITH FALSE TOP DRAWER AND POT & PANS DRAWERS BELOW - PURCHASER MUST SUPPLY SPECS  Line 53597      Note: NOTE: 36" COOK-TOP (GAS)  4Oct17 / 4Oct17	
----------	---	--

COUNTER TOP - GRANITE



CONSTRUCTION SUMMARY

Teefy Developments (Bathurst Glen) Limited / NIDO

Lot/Unit: 45    Phase/Building: 1    Model/Floor Plan: Eagle (25-5) Elev B 3 Bed

Inv.4213	1 - LOCATION: ENSUITE 2	
	SUPPLY AND INSTALL UPGRADE COUNTER-TOP TO ENSUITE 2 CAESARSTONE LEVEL 4 - WITH STANDARD EDGE PROFILE	
Line 53614	Note: 5141 FROSTY CARINA	
4Oct17 / 4Oct17		
Inv.4213	1 - LOCATION: MASTER ENSUITE	
	SUPPLY AND INSTALL UPGRADE COUNTER-TOP TO MASTER ENSUITE CAESARSTONE LEVEL 4 - WITH STANDARD EDGE PROFILE	
Line 53613	Note: 5141 FROSTY CARINA	
4Oct17 / 4Oct17		
Inv.4213	1 - LOCATION: ENSUITE 3	
	SUPPLY AND INSTALL UPGRADE COUNTER-TOP TO ENSUITE 3 CAESARSTONE LEVEL 4 - WITH STANDARD EDGE PROFILE	
Line 53615	Note: 5141 FROSTY CARINA	
4Oct17 / 4Oct17		

ELECTRICAL

Inv.4213	1 - LOCATION: KITCHEN	
	SUPPLY AND INSTALL ELECTRICAL WIRING FOR BUILT IN WALL OVEN AND MICRO UNIT	
Line 53598	Note:	
4Oct17 / 4Oct17		
Inv.4213	1 - LOCATION: KITCHEN	
	SUPPLY AND INSTALL ELECTRICAL REQUIRED TO ACCOMODATE CHIMNEY HOOD FAN AS PER SPECS ATTACHED. PURCHASER TO SUPPLY AND INSTALL THEIR OWN HOOD FAN AFTER CLOSING	
Line 53609	Note:	
4Oct17 / 4Oct17		

HEATING AND AIR CONDITIONING

Inv.4213	1 - LOCATION: KITCHEN	
	SUPPLY AND INSTALL ROUGH IN GAS LINE TO STANDARD STOVE LOCATION. 110 ELECTRICAL OUTLET WILL BE PROVIDED AND THE STANDARD 240 VOLT WILL REMAIN. PURCHASER TO SUPPLY AND INSTALL THEIR OWN APPLIANCE AFTER CLOSING.	
Line 53602	Note:	
4Oct17 / 4Oct17		
Inv.4213	1 - LOCATION: KITCHEN	
	RELOCATE THE DUCT OPENING TO ACCOMODATE A FUTURE CHIMNEY HOOD FAN AS PER SPECS ATTACHED. PURCHASER TO SUPPLY AND INSTALL THEIR OWN HOOD FAN AFTER CLOSING	
Line 53610	Note:	
4Oct17 / 4Oct17		

TILE



CONSTRUCTION SUMMARY

Teefy Developments (Bathurst Glen) Limited / NIDO

Lot/Unit: 45    Phase/Building: 1    Model/Floor Plan: Eagle (25-5) Elev B 3 Bed

Inv.4213	1 - LOCATION: FOYER	
	SUPPLY AND INSTALL UPGRADE FLOOR TILE TO FOYER IN LIEU OF STANDARD. STANDARD STACKED INSTALL	
Line 53612	Note: 12" X 24" CARRARA X SERIES WHITE POLISHED (OV.CX.WHT.1224.PL)	
4Oct17 / 4Oct17		

EXTRAS AS PER OFFER

Note:	
-------	--

Purchaser:
OU WANG

Property:
45 of Plan -

Telephone Res. / Bus:
(416) 402-5751 /

Project:
Teefy Developments (Bathurst Glen) Limite

Decor Advisor:
Steffannee Appio

Model and Elevation:
Eagle (25-5) Elev B 3 Bed

Layout Changes:
☐ Yes
☐ No

Sketch Attached:
☒ Yes
☐ No

Exterior Colour Scheme:

1. Cabinetry

	Style and Colour	Counter Top	Hardware
Kitchen / Breakfast	LANCASTER PAINT WINTER WHITE	NEW CALEDONIA GRANITE	9677 HANDLE
Kitchen Island	LANCASTER PAINT WINTER WHITE	NEW CALEDONIA GRANITE	9677 HANDLE
Laundry Room	PVC SLAB LATITUDE EAST	4924-38 WHITE CARRARA	9661 HANDLE
Powder Room	BOSTON MAPLE POPPY SEED	BIANCO SARDO GRANITE	171 KNOB
Main Bathroom			
Master Ensuite Bathroom	BOSTON PAINT CANNOLI	5141 FROSTY CARINA	181 KNOB
Second Ensuite Bathroom (If Applicable)	BOSTON PAINT CANNOLI	5141 FROSTY CARINA	181 KNOB
ENSUITE 3	BOSTON PAINT CANNOLI	5141 FROSTY CARINA	181 KNOB
LOWER LEVEL BATHROOM	BOSTON MAPLE POPPY SEED	BIANCO SARDO GRANITE	171 KNOB

Appliances

Custom Size Fridge

☐ Yes
☒ No

Cooktop / Rangetop

☒ Yes
☐ No

Valance Lighting

☐ Yes
☒ No

Built in Wall Oven

☒ Yes
☐ No

Microwave / Range Hood

☐ Yes
☒ No

Slide-in Range

☐ Yes
☒ No

Comment

STANDARD EDGE PROFILE TO STONE COUNTER-TOP IN KITCHEN AND BATHROOMS  
NOTE: 36" GAS COOK-TOP  
NOTE: EXTENSION OF CABINETRY TOWARD BREAKFAST AREA - CABINET SURROUND EXCEEDS ISLAND LENGTH

2. Flooring

	Selection
FOYER	12" x 24" CARRARA "X" SERIES WHITE POLISHED (OV.CX.WHT.1224.PL) STACKED INSTALL
Main Hall	
Back Hall	
Breakfast	5" VINTAGE HANDSCRAPED WHITE OAK - OTHELLO COLOUR
Laundry Room	13" X 13" SERPENTINE BEYAZ WHITE (TR.ST.BYZ.1313) LOWER LEVEL
Kitchen	5" VINTAGE HANDSCRAPED WHITE OAK - OTHELLO COLOUR
Powder Room	13" X 13" SERPENTINE BEYAZ WHITE (TR.ST.BYZ.1313)
Main Bathroom	13" X 13" KELLY GREY (GE.KL.GRY.1313) ENSUITE 2
Master Ensuite	13" X 13" KELLY GREY (GE.KL.GRY.1313)
Bathroom (If Applicable)	13" X 13" SERPENTINE BEYAZ WHITE (TR.ST.BYZ.1313) LOWER LEVEL BATHROOM
Mud Room	13" X 13" SERPENTINE BEYAZ WHITE (TR.ST.BYZ.1313) LOWER LEVEL
ENSUITE 3	13" X 13" KELLY GREY (GE.KL.GRY.1313)
Living Room	
Dining Room	5" VINTAGE HANDSCRAPED WHITE OAK - OTHELLO COLOUR
Family / Great Room	5" VINTAGE HANDSCRAPED WHITE OAK - OTHELLO COLOUR
Den / Library / Study	
Basement Landing (If Applies)	
Lower Landing (If Applicable)	
Upper Landing	5" VINTAGE HANDSCRAPED WHITE OAK - OTHELLO COLOUR (INCLUDING STUDY NOOK)
Upper Hall	5" VINTAGE HANDSCRAPED WHITE OAK - OTHELLO COLOUR
Master Bedroom	5" VINTAGE HANDSCRAPED WHITE OAK - OTHELLO COLOUR
Bedroom #2	5" VINTAGE HANDSCRAPED WHITE OAK - OTHELLO COLOUR
Bedroom #3	5" VINTAGE HANDSCRAPED WHITE OAK - OTHELLO COLOUR
Bedroom #4	
Bedroom #5	
RECREATION ROOM	MOHAWAK CITYVIEW - 721 CREAMER WITH STANDARD UNDERPAD - LOWER LEVEL



INTERIOR COLOUR SCHEME

Lot #45.

Purchaser: OU WANG  
Telephone Res. / Bus: (416) 402-5751 /  
Decor Advisor: Steffanee Appio

Property: 45 of Plan -  
Project: Teefy Developments (Bathurst Glen) Limite  
Model and Elevation: Eagle (25-5) Elev B 3 Bed

2. Flooring - Continued -

Upgrade Underpad	Type STANDARD	Area RECREATION ROOM ONLY
Carpet on Stairs	Capped	Runner - *Upgrade
Comment MOHAWK CITYVIEW - 721 CREAMER WITH STANDARD UNDERPAD (RECREATION ROOM ONLY)		

3. Plumbing Fixtures / Faucets

Kitchen	STD	Second Ensuite	STD	Powder Room	STD
Master Ensuite	STD			Other Room	
Main Bathroom		ENSUITE 3	STD		
Comment					

4. Wall Tile

	Tile Selection	Listello	Insert	Insert Selection
Main Bathroom		<input type="checkbox"/>	<input type="checkbox"/>	
Master Ensuite				
Tub Deck	8" X 10" REFLECTION BONE (QT.RF.BON.0810)	<input type="checkbox"/>	<input type="checkbox"/>	
Tub Apron	8" X 10" REFLECTION BONE (QT.RF.BON.0810)	<input type="checkbox"/>	<input type="checkbox"/>	
Tub Surround	8" X 10" REFLECTION BONE (QT.RF.BON.0810)	<input type="checkbox"/>	<input type="checkbox"/>	
Shower Stall	8" X 10" REFLECTION BONE (QT.RF.BON.0810)	<input type="checkbox"/>	<input type="checkbox"/>	
Second Ensuite	8" X 10" REFLECTION BONE (QT.RF.BON.0810)	<input type="checkbox"/>	<input type="checkbox"/>	
ENSUITE 3	8" X 10" REFLECTION BONE (QT.RF.BON.0810)	<input type="checkbox"/>	<input type="checkbox"/>	
LOWER BATHROOM	8" X 10" REFLECTION BONE (QT.RF.BON.0810)	<input type="checkbox"/>	<input type="checkbox"/>	
Kitchen Backsplash		<input type="checkbox"/>	<input type="checkbox"/>	
Complete Backsplash		<input type="checkbox"/>	<input type="checkbox"/>	
Comment STANDARD 2" X 2" MOSAIC WHITE FLOOR TILE IN MASTER ENSUITE SHOWER STALL AND LOWER LEVEL BATHROOM SHOWER STALL				

5. Fireplace

	Living Room			Family Room			Other Room - Specify		
	Purchased	As Per Plan	N/A	Purchased	As Per Plan	N/A	Purchased	As Per Plan	N/A
	<input type="radio"/>	<input type="radio"/>	<input type="radio"/>	<input type="radio"/>	<input checked="" type="radio"/>	<input type="radio"/>	<input type="radio"/>	<input type="radio"/>	<input type="radio"/>
Fireplace Type				STANDARD					
Mantle Type				STANDARD					
Over Mantle									
Colour / Stain									
Surround									
Hearth									
Comment									

Initial:

WY CL



## INTERIOR COLOUR SCHEME

Lot #45.

Purchaser: OU WANG  
Telephone Res. / Bus: (416) 402-5751 /  
Decor Advisor: Steffanee Appio

Property: 45 of Plan -  
Project: Teefy Developments (Bathurst Glen) Limite  
Model and Elevation: Eagle (25-5) Elev B 3 Bed

## 6. Trim Carpentry

Door Hardware STANDARD

Interior Trim STANDARD

Comment

## Interior Doors

☐ 2 Panel Arch Top☒ 2 Panel Square Top☐ 6 PanelInitial for Door Style *WJ* *cl*

## 7. Railings and Pickets

Railing Package STANDARD

Railing Colour OTHELLO

Picket Colour FLAT BLACK METAL

Wood Stairs ☐ No ☒ Oak

Tread Colour OTHELLO

Comment

STAIN OAK STAIRS TO COMPLIMENT HARDWOOD - OTHELLO COLOUR

## 8. Plaster Mouldings and Medallions

Foyer			Kitchen/Breakfast		
Main Hall			Den/Library		
Living Room			Lower Landing		
Dining Room					
Family Room					

Comment

## 9. Wall Paint

STANDARD SENATOR WHITE

Smooth Ceilings ☐ First Floor  
☐ First Floor incl. Second Floor Hall  
☐ First and Second Floor  
☒ Throughout  
☐ Not Applicable

Trim Paint

## 10. Additional Comments

## 11. Disclaimers and Notes

- Colours of all materials are as close as possible to builder's selection, but not necessarily identical due to variances in manufacturing.
- Any extras listed above are null and void unless accompanied by a separate invoice/amendment. Said invoice must be paid in full.
- The Purchaser acknowledges that after Interior Colour Selection form is signed and dated, no further changes will be permitted other than re-selection due to unavailability. \_\_\_\_\_ Purchaser's Initials
- The Purchaser acknowledges reading and accepting the "Senator Homes Décor Centre Disclaimers" form. This document contains other miscellaneous disclaimers.

This Interior Colour Selection is final and approved by:

Purchaser:

Signature: *Wang. Chen* Date: *10/04/2017*Vendor: *[Signature]*  
Teefy Developments (Bathurst Glen) Limited

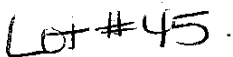

~~ELEVATION 'A' 3018 SF~~

EAGLE

ELEVATION 'B' 3018 SF

ELEVATION: C-3018 ST

675

2

[illegible]

104297

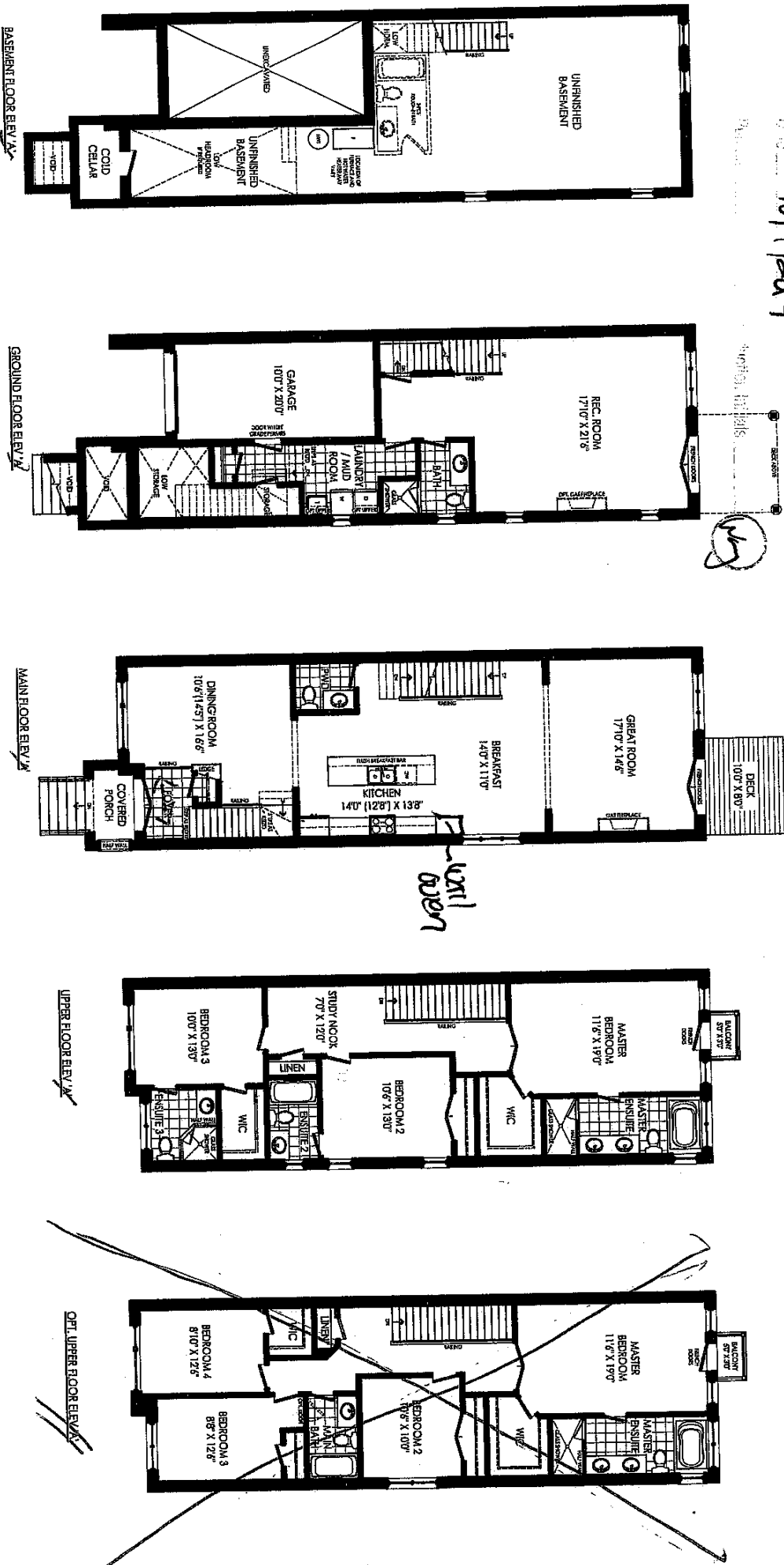

Elevation "B" - See Parbais

Renderings can easily conceipt. Some elevations may vary from that shown. All dimensions are approximate. All square footages may include open to above/below space. Actual usable square footages may vary from that stated herein. E.S.O.E. 125-6

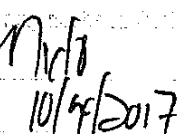

\*\*\*confirm items in red\*\*\*

8/11/2017



**KitchenAid®** 27" (68.6 cm) and 30" (76.2 cm) Electric Built-In Microwave/Oven Combination

**PRODUCT MODEL NUMBERS**

KEMS809E KOCE500E KOCE507E

**ELECTRICAL CONNECTION**

If codes permit and a separate ground wire is used, it is recommended that a qualified electrical installer determine that the ground path and the wire gauge are in accordance with local codes. Check with a qualified electrical installer if you are not sure the oven is properly grounded.

This oven must be connected to a grounded metal, permanent wiring system.

Be sure that the electrical connection and wire size are adequate and in conformance with the National Electrical Code, ANSI/NFPA 70-latest edition or CSA Standards C22.1-94, Canadian Electrical Code, Part 1 and C22.2 No. O-M91-latest edition, and all local codes and ordinances.

To properly install your oven, you must determine the type of electrical connection you will be using and follow the instructions provided for it here.

- Oven must be connected to the proper electrical voltage and frequency as specified on the model/serial/rating plate. See the following illustration.

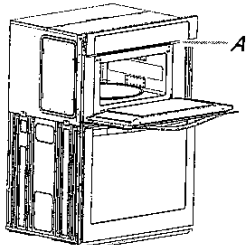

A. Model/serial/rating plate

- Models rated from 7.3 to 9.6 kW at 240 volts (5.4 to 7.4 kW at 208 volts) require a separate 40-amp circuit. Models rated at 4.8 kW and below at 240 volts (3.6 kW and below at 208 volts) require a separate 30-amp circuit.
- A circuit breaker is recommended.
- Connect directly to the fused disconnect (or circuit breaker box) through flexible, armored or nonmetallic sheathed, copper cable (with grounding wire). See "Make Electrical Connection" section.
- Flexible conduit from the oven should be connected directly to the junction box.
- Do not cut the conduit. The length of conduit provided is for serviceability of the oven.
- A UL listed or CSA approved conduit connector must be provided.
- If the house has aluminum wiring, follow the procedure below:
  - Connect a section of solid copper wire to the pigtail leads.
  - Connect the aluminum wiring to the added section of copper wire using special connectors and/or tools designed and UL listed for joining copper to aluminum.

Follow the electrical connector manufacturer's recommended procedure. Aluminum/copper connection must conform with local codes and industry accepted wiring practices.

For power requirements, refer to the following table.

Model	Voltage	Amperage (L1)*	Amperage (L2)*	Rating (W)
KOCE507E/KOCE500E	120/240	32	30	8000
KOCE507E/KOCE500E	120/208	30	28	6600

\*Amperage values noted above are for information purposes only: the units are rated in watts.

**PRODUCT DIMENSIONS**

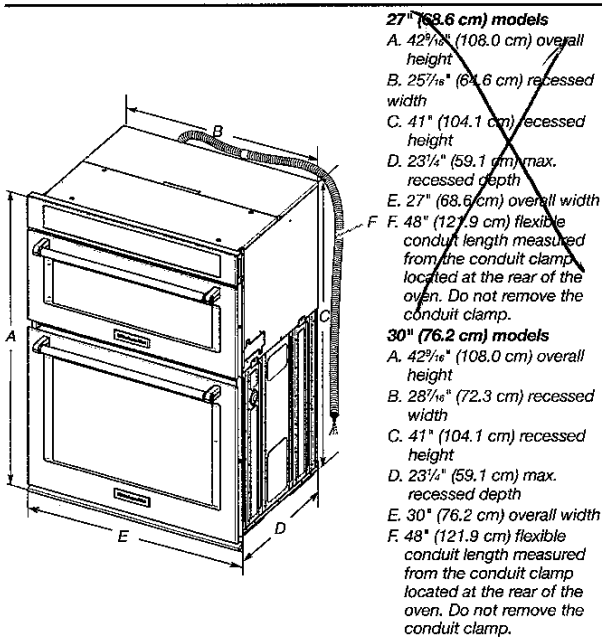

- 27" (68.6 cm) models**
- A. 42 1/2" (108.0 cm) overall height
  - B. 25 7/8" (64.6 cm) recessed width
  - C. 41" (104.1 cm) recessed height
  - D. 23 1/4" (59.1 cm) max. recessed depth
  - E. 27" (68.6 cm) overall width
  - F. 48" (121.9 cm) flexible conduit length measured from the conduit clamp located at the rear of the oven. Do not remove the conduit clamp.
- 30" (76.2 cm) models**
- A. 42 1/2" (108.0 cm) overall height
  - B. 28 7/8" (72.3 cm) recessed width
  - C. 41" (104.1 cm) recessed height
  - D. 23 1/4" (59.1 cm) max. recessed depth
  - E. 30" (76.2 cm) overall width
  - F. 48" (121.9 cm) flexible conduit length measured from the conduit clamp located at the rear of the oven. Do not remove the conduit clamp.

**Cabinet Dimensions**

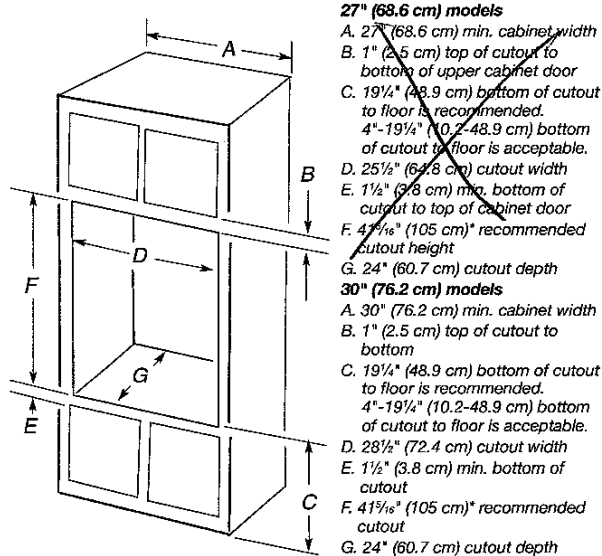

- 27" (68.6 cm) models**
- A. 27" (68.6 cm) min. cabinet width
  - B. 1" (2.5 cm) top of cutout to bottom of upper cabinet door
  - C. 19 1/4" (48.9 cm) bottom of cutout to floor is recommended. 4"-19 1/4" (10.2-48.9 cm) bottom of cutout to floor is acceptable.
  - D. 25 1/2" (64.8 cm) cutout width
  - E. 1 1/2" (3.8 cm) min. bottom of cutout to top of cabinet door
  - F. 41 1/8" (105 cm)\* recommended cutout height
  - G. 24" (60.7 cm) cutout depth
- 30" (76.2 cm) models**
- A. 30" (76.2 cm) min. cabinet width
  - B. 1" (2.5 cm) top of cutout to bottom
  - C. 19 1/4" (48.9 cm) bottom of cutout to floor is recommended. 4"-19 1/4" (10.2-48.9 cm) bottom of cutout to floor is acceptable.
  - D. 28 1/2" (72.4 cm) cutout width
  - E. 1 1/2" (3.8 cm) min. bottom of cutout
  - F. 41 1/8" (105 cm)\* recommended cutout
  - G. 24" (60.7 cm) cutout depth

\* NOTE: The cabinet height can be between 41" (104.1 cm) and 41 1/2" (105.6 cm) for microwave/oven combination.

This sketch is provided solely for reference to those items noted on the accompanying "Upgrades/Extras". All other details, dimensions & layouts are for illustrative purposes only and may not be applicable to the Purchaser's Model

Site Nido Lot 45  
Date 10/4/17

Purchaser Initials W Production Initials \_\_\_\_\_

# Installation Instructions

## 36" Sealed Gas Cooktop

PGP976, PGP986 CGP650



Questions? Call 800.GE.CARES (800.432.2737) or Visit our Website at: [GEAppliances.com](http://GEAppliances.com)  
In Canada, call 1.800.561.3344 or Visit our Website at: [www.geappliances.ca](http://www.geappliances.ca)

### IN THE COMMONWEALTH OF MASSACHUSETTS:

- This product must be installed by a licensed plumber or gas fitter.
- When using ball-type gas shut-off valves, they shall be the T-handle type.
- A flexible gas connector, when used, must not exceed 3 feet.

### BEFORE YOU BEGIN

Read these instructions completely and carefully.

- **IMPORTANT** — Save these instructions for local inspector's use.
- **IMPORTANT** — Observe all governing codes and ordinances.
- Note to Installer – Be sure to leave these instructions with the Consumer.
- Note to Consumer – Keep these instructions for future reference.
- Product failure due to improper installation is not covered under the Warranty.

**⚠ WARNING** — This appliance must be properly grounded.

- **IMPORTANT** — Leak testing of the appliance shall be conducted according to the manufacturer's instructions.
- Proper installation is the responsibility of the installer and product failure due to improper installation is NOT covered under warranty.

**⚠ WARNING** — Disconnect all electrical power to this sketch is provided solely for reference to those items or functions before installing. All other details, dimensions & layouts are for illustrative purposes only and may not be applicable to the Purchaser's Model.

31-1065 11-13 GE

Date

Purchaser Initials

Production Initials

### FOR YOUR SAFETY:

**⚠ WARNING** — If the information in this manual is not followed exactly, a fire, explosion or gas leak may result causing property damage, personal injury or death.

Do not store or use gasoline or other flammable vapors and liquids in the vicinity of this or any other appliance!

Do not install this product with an air curtain hood or other range hood that operates by blowing air down on the cooktop. This airflow may interfere with operation of the gas burners resulting in fire or explosion hazard.



### WHAT TO DO IF YOU SMELL GAS:

- Do not try to light any appliance. Do not touch any electrical switch; do not use any phone in your building.
- Immediately call your gas supplier from a neighbor's phone. Follow the gas supplier's instructions.
- If you cannot reach your gas supplier, call the fire department.

Installation and service must be performed by a qualified installer, service agency or the gas supplier.

This cooktop has been certified by UL. You'll find safety precautions in your Owner's Manual. Read them carefully.

- Installation of this cooktop must conform with local codes or in the absence of local codes with the National Fuel Gas Code, ANSI Z223.1/NFPA 54—Latest edition.
- Be sure your cooktop is installed properly by a qualified installer or service technician.
- To eliminate reaching over surface burners, cabinet storage above burner should be avoided.
- Do not install the unit near an outside door or where a draft may affect its use.

Nido hot 45  
10/4/17  
Wg

# Installation Instructions

## IMPORTANT SAFETY INSTRUCTIONS

### ELECTRICAL REQUIREMENTS

This appliance must be supplied with the proper voltage and frequency and connected to an individual, properly grounded branch circuit, protected by a circuit breaker or fuse having amperage as noted on the rating plate.

We recommend you have the electrical wiring and hookup of your cooktop connected by a qualified electrician. After installation, have the electrician show you where your main cooktop disconnect is located.

Check with your local utilities for electrical codes which apply in your area. Failure to wire your cooktop according to governing codes could result in a hazardous condition. If there are no codes, your cooktop must be wired and fused to meet the requirements of the National Electrical Code, ANSI/NFPA No. 70—Latest edition. You can get a copy by writing:

National Fire Protection Association  
Batterymarch Park  
Quincy, MA 02269

In Canada your cooktop must be wired and fused to meet the requirements of the Canadian Electrical Code.

Be sure the installation of this product in a mobile home conforms with the Manufactured Home Construction and Safety Standard, Title 24 CFR, Part 3280. If this standard does not apply, you must follow the standard for Manufactured Home Installations, ANSI/NCSBS A225.1 or with local codes where applicable.

You can get a copy of the Federal Standard by Writing:

Office of Mobile Home Standards  
HUD Building  
451 7th Street, S.W.  
Washington, D.C. 24010

### PARTS INCLUDED



2 Screws

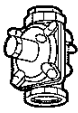

Regulator

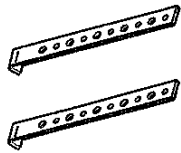

2 Hold  
Down Brackets

### MATERIALS YOU MAY NEED



Joint Sealant

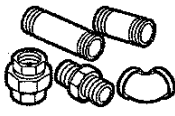

Pipe Fittings



Shut-Off Valve



CSA-Approved Flexible Gas Line  
3/8" Min. ID, 1/2" NPT Connection,  
3-foot Maximum Length (Massachusetts Only)

### TOOLS YOU WILL NEED FOR INSTALLATION



Pencil



Saber Saw



Phillips-Head  
Screwdriver

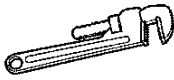

Pipe Wrench



Ruler or Straightedge



Safety Glasses

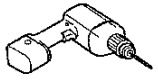

1/8" Drill Bit & Electric or  
Hand Drill

# Installation Instructions

Nido Lot 45  
10/4/17  
Wg

## PRE-INSTALLATION CHECKLIST

- A** When preparing cooktop opening, make sure the inside of the cabinet and the cooktop do not interfere with each other. (See section on preparing the opening.)
- B** Remove packaging materials, grate boxes, regulator with literature, and literature package from the cooktop before beginning installation.

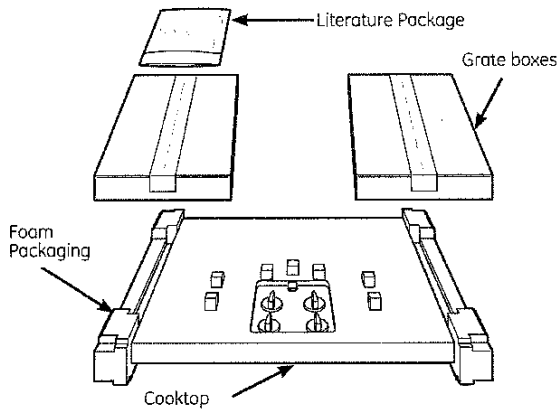

- C** Remove Installation Instructions from literature pack and read them carefully before you begin.  
Be sure to place all literature (Owners Manual, Installation Instructions, etc.) in a safe place for future reference.



- D** Make sure you have all the tools and materials you need before starting the installation of the cooktop.
- E** Your home must provide the adequate electrical service needed to safely and properly use your cooktop. (Refer to section on electrical requirements.)
- F** When installing your cooktop in your home, make sure all local codes and ordinances are followed exactly as stated.
- G** Make sure the wall coverings, countertop and cabinets around the cooktop can withstand heat (up to 200°F) generated by the cooktop.

Installation Instructions

Nido Lot 45  
10/4/2017

Wey

PREPARING THE OPENING

1

MAINTAIN THE FOLLOWING MINIMUM CLEARANCE DIMENSIONS

13" MAX. Depth of unprotected overhead cabinets

30" MIN. clearance from countertop to unprotected overhead surface

C - MIN. clearance from cutout to rear wall

L - MIN. clearance from cooktop to left side wall

2-1/2" MIN from cutout to front of countertop

R - MIN. clearance from cutout to right side wall

18" MIN. height from countertop to nearest cabinet on either side of unit

30" or wider cabinet base

ALL HORIZONTAL CLEARANCES MUST BE MAINTAINED FOR A MINIMUM OF 18" ABOVE THE COOKING SURFACE.

	L	R	C
PGP976	3-3/4"	6"	3-3/8"
PGP986	12"	12"	3-3/8"
CGP650	12"	12"	3-3/8"

NOTE: Allow 7/16" minimum vertical clearance from the cooktop bottom (or 3-11/16" minimum depth from the countertop) to any combustible surfaces, such as a cabinet drawer.

For island installation, maintain 2-1/2 in. minimum from cutout to front and back edge of countertop. Maintain 3 in. minimum from cutout to side edges of countertop.

2

OVERALL COOKTOP DIMENSIONS

36"

21"

3-1/4"

33-11/16"

18-7/8"

Cooktop

3

CUTOUT DIMENSIONS OF COUNTERTOP

To ensure accuracy, it is best to make a template when cutting the opening in the counter.

33-7/8" length of cut

16-15/16"

19-1/8" width cut

4

RECOMMENDED GAS SUPPLY LOCATION FROM BACKWALL

1" Min. From Backwall

7"

From Cutout Center Line

Recommended gas supply location

5

MAKE SURE WALL COVERINGS, COUNTERTOP AND CABINETS AROUND COOKTOP CAN WITHSTAND HEAT (UP TO 200°F) GENERATED BY COOKTOP

Wall covering, cabinets and countertop must withstand heat up to 200°F

6

FOR AMERICANS WITH DISABILITIES ACT (ADA) FORWARD APPROACH INSTALLATION ONLY:

Allow 5" minimum depth between the countertop and an enclosure.

5"

NOTE: The enclosure must be made of wood material. Also, an access panel is required for the electrical outlet, pressure regulator, shut-off valve, hold-down brackets, and service.

4

Installation Instructions

nido hot45  
10/4/2017

INSTALLING THE COOKTOP UNIT

Wg

1 LOCATE ELECTRICAL OUTLET AND GAS SHUT-OFF VALVE BENEATH CABINET

NEVER REUSE OLD CONNECTORS WHEN INSTALLING THIS UNIT.

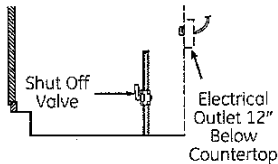

Install a manual shut-off valve in the gas line in an easily accessible location outside the cooktop. Be sure you know how and where to shut off the gas supply to the cooktop. Install the electrical outlet 12" below the countertop.

2 PROTECT SURFACE OF COOKTOP

Place a towel or tablecloth onto the countertop. Lay the cooktop upside down onto the protected surface.

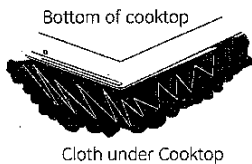

3 LOCATE MOUNTING PARTS

Remove the hold down brackets from the literature package.

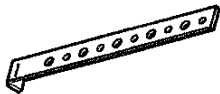

4 ATTACH BRACKETS TO COOKTOP

Remove the screw from the side of the cooktop and screw the hold-down bracket to the side of the cooktop unit. Repeat for opposite side of cooktop.

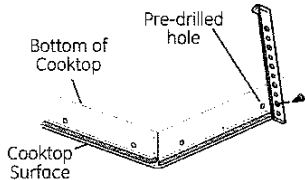

5 INSERT COOKTOP INTO CUTOUT

Insert the cooktop centered into the cutout opening. Make sure the front edge of the countertop is parallel to the cooktop. Make final check that all required clearances are met.

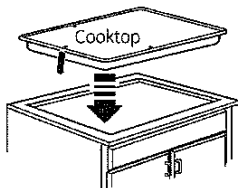

Once the unit is in place, screw the hold-down bracket into the cabinet sides to secure the unit into place.

Installation Instructions

Nido Lot 45  
10/18/2017  
Way

INSTALLATION—GAS CONNECTIONS

1 PROVIDE ADEQUATE GAS SUPPLY

This cooktop is designed to operate on natural gas at 5" of water column manifold pressure and 7" of water column (W.C.) supply pressure. It is shipped from the factory set for natural gas. The convertible pressure regulator supplied with the unit must be connected in series with the manifold of the cooktop and must remain in series with the supply line regardless of whether natural or L.P. gas is being used. FOR PROPER OPERATION, THE MAXIMUM INLET PRESSURE TO THE REGULATOR MUST BE NO MORE THAN 14" OF WATER COLUMN PRESSURE. For checking the regulator, the inlet pressure must be at least 1" W.C.. (or 3.4 KPA) greater than the regulator output setting. If the regulator is set for 5" W.C. of water column pressure, the inlet pressure must be at least 6" W.C.. If the regulator is set for 10" W.C., the inlet pressure must be at least 11" W.C.. The gas supply line to the cooktop should be 1/2" or 3/4" pipe.

2 INSTALL REGULATOR

NEVER REUSE OLD CONNECTORS WHEN INSTALLING THIS COOKTOP.

**WARNING:** Never reuse old flexible connectors. The use of old flexible connectors can cause gas leaks and personal injury. Always use new flexible connectors when installing a gas appliance.

Screw a section of pipe onto the inlet end of the pressure regulator and install the coupling.

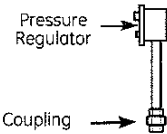

To reduce the likelihood of gas leaks, apply teflon tape or a thread compound approved for use with LP or Natural gases to all threaded connections.

3 INSTALL REGULATOR ONTO BURNER BOX BOTTOM

Screw the regulator onto the burner box bottom pipe connection. Make sure the top of the regulator is facing towards the cabinet front, easily accessible through the cabinet doors. The regulator may also be installed prior to inserting the cooktop into the cutout if extreme caution is used to ensure the regulator connection is not compromised.

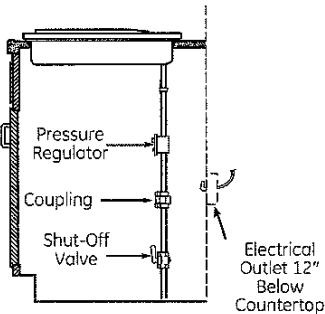

4 COMPLETE CONNECTION WITH A COUPLING

Complete the connection between the regulator, pipe coupling, and the shut-off valve.

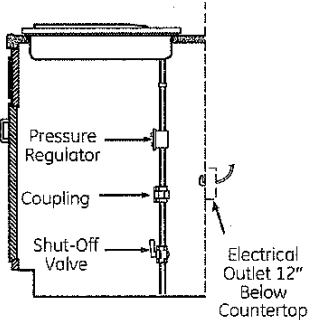

## Installation Instructions

Nido Lot 45  
10/4/2017  
Wg

### 5 CHECK FOR LEAKS

LEAK TESTING OF THE APPLIANCE SHALL BE CONDUCTED ACCORDING TO THE MANUFACTURER'S INSTRUCTIONS.

Before testing for leaks, make sure all burner knobs are in the OFF position.

After connecting the cooktop to gas, check system for leaks with a manometer. If a manometer is not available, turn the gas supply on to the cooktop and use a liquid leak detector at all joints and connections to check for leaks.

Tighten all connections if necessary to prevent gas leakage in the cooktop or supply line.

**DO NOT USE OPEN FLAME TO CHECK FOR LEAKS!**

Disconnect the cooktop and its individual shut-off valve from the gas supply piping system during any pressure testing of that system at test pressures greater than 1/2 psig (3.5 kPa).

Isolate the cooktop from the gas supply piping system by closing its individual shut-off valve during any pressure testing of the gas supply system at test pressures equal to or less than 1/2 psig (3.5 kPa).

### 6 INSTALLATION OVER BUILT-IN OVEN

See built-in oven installation for complete installation instructions.

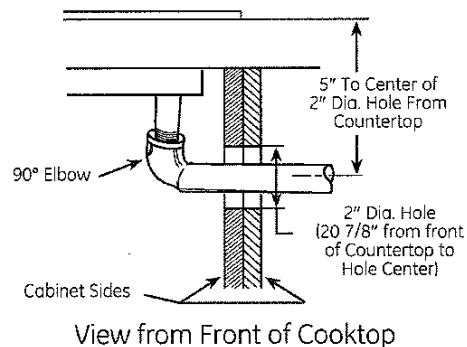



Nido Lot 45  
10/4/17  
Wg

# Installation Instructions

## INSTALLATION—ELECTRICAL CONNECTIONS

**⚠ WARNING** — Disconnect all electrical power at the main circuit breaker or fuse box before installing.

**ELECTRICAL SUPPLY AND OUTLET**

An adequate electrical supply and outlet must be used to operate the electrical parts of your cooktop.

**A**

The power cord of this appliance is equipped with a 3-prong (grounding) plug which must be used with a properly grounded 3-hole outlet with a standard 120 Volt, 60 cycle AC household current.

**B**

If you do not have a 3-hole grounded outlet, have a qualified electrician change your old one. DO NOT, UNDER ANY CIRCUMSTANCES, CUT OR REMOVE THE THIRD (GROUND) PRONG FROM THE POWER CORD. DO NOT USE AN ADAPTER. DO NOT USE AN EXTENSION CORD.

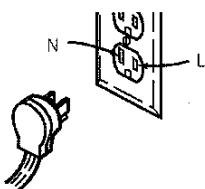

Insure proper ground and firm connection before use

## Installation Instructions

### COOKTOP BURNERS

Nido lot 45  
10/4/2017  
Wg

#### 1 ASSEMBLING THE COOKTOP BURNERS

The electrode of the igniter is exposed. Be careful not to turn on any cooktop controls while the top of the burner is removed. Do not remove the top or touch the electrode of any burner while another burner is turned on. Electrical shock might result.

- A** Place the burner head onto the burner base. Make sure to place the correct burner head on the correct burner base and that the burner head sits level on the burner base. The burner heads are not interchangeable. Ensure the slot in the burner head is positioned over the electrode and that the burner head is fully inserted inside the burner base. A small gap between the base and head is normal.



Burner cap properly seated



Burner cap not properly seated

- B** Place the burner caps on the burner heads, making sure to place the correct burner cap on the correct burner head. The burner caps are not interchangeable. Each cap has three to four pins. Make sure that the burner caps are properly seated on the burner heads and that none of the pins sit in the stability chamber.

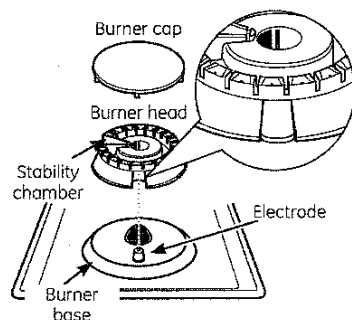

OR

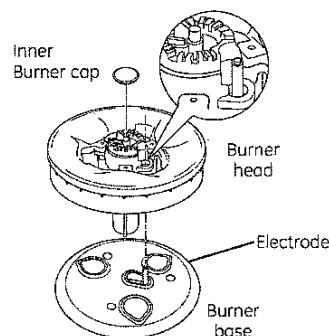

#### 2 CHECK IGNITERS

Operation of the electric igniters should be checked after the cooktop and supply line have been carefully checked for leaks and the cooktop has been connected to the electrical power.

On models so equipped, check to be sure the cooktop is in the **UNLOCKED** position.

- A** Push and turn a burner valve to the **LITE** position. All spark igniters will make a series of sparks (ticking sounds), but only the burner turned to **LITE** will light.

- The burner should light when gas is available to the burner.
- Once the burner lights, it should be turned out of the **LITE** position.

- B** Try each valve separately until all burners have been checked.

Installation Instructions

Model W445  
W/4/17  
W

COOKTOP BURNERS (CONT.)

3 BURNER IGNITION

Cooktop Spark Ignition—When you turn the cooktop knob to LITE, the spark igniter makes a series of electric sparks (ticking sounds) which light the burner. During a power failure, the burners will not light automatically. In an emergency, a cooktop burner may be lit with a match by following the steps below.

On models so equipped, check to be sure the cooktop is in the **UNLOCKED** position.

- A Light a match and hold the flame near the burner you want to light. Wooden matches work best.
- B Push in and turn the control knob slowly. Be sure you are turning the correct knob for the burner you are lighting.

**NOTE:** If the burner does not light within five seconds, turn the knob off and wait one minute before trying again.

4 THE BURNER FLAMES

Turn each burner on. Flames should be blue in color with no trace of yellow. The burner flames should not flutter or blow away from the burner. The flame should be no less than 1/4" on the lowest setting and no greater than 1-1/2" on highest setting.

**CAUTION:** If you attempt to measure the flame, please use caution. Burns could result.

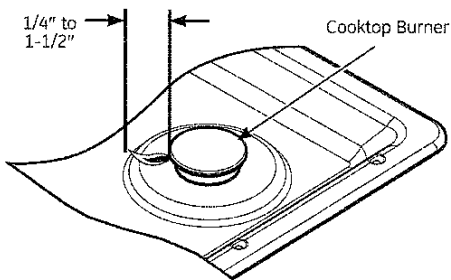

Burners should be checked frequently

5 BURNER GRATES

The three cooktop grates are designed for specific positions. For maximum stability, these grates should only be used in their proper position with the edges positioned on top of the black bumpers as shown

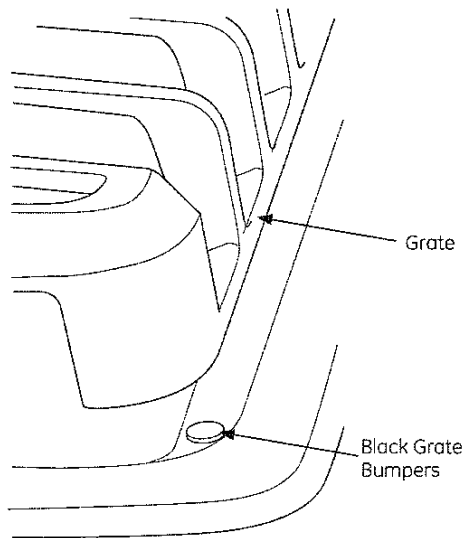

## Installation Instructions

### OPERATION CHECKLIST

Wing.

- |   |  |
|---|--|
| <p><b>A</b> Make sure all controls are left in the <b>OFF</b> position. Check to be sure the cooktop is in the <b>UNLOCKED</b> position (on models so equipped).</p>  | <p><b>D</b> When ordering parts, always include the serial number, model number and a code letter to ensure proper replacement parts.</p>                              |
| <p><b>B</b> Make sure the flow of air to and from the cooktop is unobstructed.</p>  | <p><b>E</b> <b>Recheck Steps:</b><br/>Double check to make sure everything in this guide has been completed. Rechecking steps will ensure safe use of the cooktop.</p> |
| <p><b>C</b> The serial plate for your cooktop is located on the bottom of the burner box. In addition to the model and serial numbers, it tells you the ratings of the burners and the type of fuel and pressure the cooktop was adjusted for when it left the factory.</p> |  |