



CONSTRUCTION SUMMARY

Carrville Investments Ltd. / Loggias of Richvale

Lot/Unit: 16 Phase/Building: 2 Model/Floor Plan: The Venezia (50-1) Elev B

CABINETRY

Inv.4173	1 - LOCATION: KITCHEN	
	SUPPLY A 48" FRIDGE OPENING IN LIEU OF STANDARD ACCOMMODATE FOR BUILT IN FRIDGE WITH INTEGRATED OR FLUSH INSET INSTALLATION (07H)	
Line 53367	Note:	
18Aug17 / 18Aug17		
Inv.4173	1 - LOCATION: KITCHEN	
	SUPPLY AND INSTALL STACKED UPPER CABINETS WITH FASCIA PAN AND CROWN MOULDING TO CLOSE OFF SPACE BETWEEN CEILING AND TOP OF UPPER CABINETS	
Line 53375	Note: NO GLASS OR MATCHING INTERIOR	
18Aug17 / 18Aug17		

CABINETRY HARDWARE

Inv.4173	1 - LOCATION: KITCHEN ISLAND	
	BASE WASTE / RECYCLE CENTER PULL OUT DOOR - ONLY AVAILABLE IN 45 CM CABINET (2) 35L BINS - PRICE IS PER UNIT	
Line 53374	Note:	
18Aug17 / 18Aug17		

CABINETRY MICROWAVE OVEN STOVE COOKTOP

Inv.4173	1 - LOCATION: KITCHEN	
	BUILT IN DOUBLE APPLIANCE CABINET WITH DRAWER BELOW - TRIM KIT REQUIRED - PURCHASER MUST SUPPLY SPECS - UPGRADE 2 BUILT IN MICROWAVE AND STEAM OVEN	
Line 53369	Note: TO BE LOCATED NEXT TO FRIDGE	
18Aug17 / 18Aug17		
Inv.4173	1 - LOCATION: KITCHEN	
	BUILT IN SINGLE APPLIANCE CABINET WITH POTS & PANS DRAWERS BELOW - TRIM KIT REQUIRED - PURCHASER MUST SUPPLY SPECS - BUILT IN COFFEE MAKER STATION	
Line 53372	Note: TO BE LOCATED AT END OF CABINET RUN TOWARD BREAKFAST AREA	
18Aug17 / 18Aug17		

COUNTER TOP - GRANITE

Inv.4173	1 - LOCATION: KITCHEN	
	COUNTER TOP - GROUP 2 - KITCHEN - 3CM COUNTER TOP - WITH STANDARD EDGE PROFILE	
Line 53380	Note: 4600 ORGANIC WHITE CAESASTONE	
18Aug17 / 18Aug17		
Inv.4173	1 - LOCATION: MASTER ENSUITE - HER SIDE	
	COUNTER TOP - GROUP 2 - HER ENSUITE - 2CM COUNTER TOP - WITH STANDARD EDGE PROFILE	
Line 53388	Note: 4600 ORGANIC WHITE CAESARSTONE	
18Aug17 / 18Aug17		



CONSTRUCTION SUMMARY

Carrville Investments Ltd. / Loggias of Richvale

Lot/Unit: 16 Phase/Building: 2 Model/Floor Plan: The Venezia (50-1) Elev B

Inv.4173	1 - LOCATION: MASTER ENSUITE - HIS SIDE	
	COUNTER TOP - GROUP 2 - HIS ENSUITE - 2CM COUNTER TOP - WITH STANDARD EDGE PROFILE	
Line 53389	Note: 4600 ORGANIC WHITE CAESARSTONE	
18Aug17 / 18Aug17		

ELECTRICAL

Inv.4173	6 - LOCATION: GREAT ROOM	
	TO LOCATE SIX (6) STANDARD POTLIGHTS INCLUDED IN OFFER DELETE THE STANDARD CEILING FIXTURE AND USE THE SWITCH TO OPERATE THE POTLIGHTS	
Line 53361	Note: A SEPARATE SWITCH FOR THESE POTLIGHTS HAS NOT BEEN PURCHASED	
18Aug17 / 18Aug17		
Inv.4173	8 - LOCATION: LIVING/DINING ROOM	
	TO LOCATE EIGHT (8) STANDARD POTLIGHTS INCLUDED IN OFFER DO NOT DELETE THE STANDARD CEILING FIXTURE IN DINING ROOM USE THE SWITCHED OUTLET FROM THE LIVING ROOM TO OPERATE THE POTLIGHTS	
Line 53362	Note: A SEPARATE SWITCH TO OPERATE THESE POTLIGHTS HAS NOT BEEN PURCHASED	
18Aug17 / 18Aug17		
Inv.4173	3 - LOCATION: MAIN HALL COFFERED CEILING BOX	
	TO LOCATE THREE (3) STANDARD POTLIGHTS INCLUDED IN OFFER DELETE THE STANDARD CEILING FIXTURE(S) IF AND WHERE APPLICABLE	
Line 53363	Note: A SEPARATE SWITCH FOR THESE POTLIGHTS HAS BEEN PURCHASED	
18Aug17 / 18Aug17		
Inv.4173	1 - LOCATION: MAIN HALL COFFERED CEILING BOX	
	SUPPLY AND INSTALL A SEPARATE SWITCH TO OPERATE THE POTLIGHTS IN THE COFFFERED BOX	
Line 53364	Note:	
18Aug17 / 18Aug17		
Inv.4173	3 - LOCATION: KITCHEN ISLAND	
	TO LOCATE THREE (3) STANDARD POTLIGHTS INCLUDED IN OFFER TO BE EQUALLY SPACED AND CENTRED IN CEILING ABOVE ISLAND	
Line 53365	Note: A SEPARATE SWITCH FOR THESE POTLIGHTS HAS BEEN PURCHASED	
18Aug17 / 18Aug17		
Inv.4173	1 - LOCATION: KITCHEN ISLAND	
	SUPPLY AND INSTALL A SEPARATE SWITCH TO OPERATE THE POTLIGHTS ABOVE THE KITCHEN ISLAND	
Line 53366	Note:	
18Aug17 / 18Aug17		



CONSTRUCTION SUMMARY

Carrville Investments Ltd. / Loggias of Richvale

Lot/Unit: 16 Phase/Building: 2 Model/Floor Plan: The Venezia (50-1) Elev B

Inv.4173	1 - LOCATION: KITCHEN	
	SUPPLY AND INSTALL A 20AMP ELECTRICAL OUTLET REQUIRED FOR THE 48" FRIDGE	
Line 53368	Note:	
18Aug17 / 18Aug17		
Inv.4173	1 - LOCATION: KITCHEN	
	ELECTRICAL - CONNECTION FOR BUILT-IN MICROWAVE TO BE LOCATED NEXT TO FRIDGE - SEE SKETCH	
Line 53370	Note:	
18Aug17 / 18Aug17		
Inv.4173	1 - LOCATION: KITCHEN	
	SUPPLY A 20 AMP ELECTRICAL OUTLET REQUIRED FOR STEAM OVEN TO BE LOCATED BENEATH THE MICROWAVE	
Line 53371	Note:	
18Aug17 / 18Aug17		
Inv.4173	1 - LOCATION: KITCHEN	
	SUPPLY AND INSTALL A 20AMP ELECTRICAL OUTLET REQUIRED FOR THE COFFEE MAKER STATION - SEE SKETCH FOR LOCATION	
Line 53373	Note:	
18Aug17 / 18Aug17		
Inv.4173	1 - LOCATION: EXTERIOR LOGGIA CEILING	
	SUPPLY AND INSTALL CAPPED EXTERIOR CEILING LIGHT ROUGH-IN ONLY ON SEPARATE SINGLE SWITCH	
Line 53378	Note: LOCATION AS PER SKETCH ATTACHED.	
18Aug17 / 18Aug17		

FIREPLACE

Inv.4173	1 - LOCATION: MASTER BEDROOM	
	RELOCATE THE STANDARD LIGHT TO BE OFFSET AS PER SKETCH ATTACHED	
Line 53379	Note:	
18Aug17 / 18Aug17		

TILE

Inv.4173	1 - LOCATION: FOYER/POWDER ROOM HALL	
	FLOOR TILE - UPGRADE 4 - VESTIBULE - SIDE HALL - FLOOR	
Line 53381	Note: 24" X 24" MUSE MATTE WHITE (IM.MU.WHT.2424.MT)	
18Aug17 / 18Aug17		
Inv.4173	1 - LOCATION: POWDER ROOM	
	FLOOR TILE - UPGRADE 4 - POWDER ROOM - FLOOR	
Line 53382	Note: 24" X 24" MUSE MATTE WHITE (IM.MU.WHT.2424.MT)	
18Aug17 / 18Aug17		



CONSTRUCTION SUMMARY

Carrville Investments Ltd. / Loggias of Richvale

Lot/Unit: 16 Phase/Building: 2 Model/Floor Plan: The Venezia (50-1) Elev B

Inv.4173	1 - LOCATION: MASTER ENSUITE - HER SIDE FLOOR TILE - UPGRADE 6 - MASTER ENSUITE - HIS - HERS - FLOOR STANDARD STACKED INSTALL - SEE SKETCH FOR TILE DIRECTION Line 53383 Note: 12" X 24" CARRARA X SERIES POLISHED WHITE (OV.CX.WHT.1224.PL) 18Aug17 / 18Aug17	
Inv.4173	1 - LOCATION: MASTER ENSUITE - HIS SIDE FLOOR TILE - UPGRADE 6 - MASTER ENSUITE - HIS - HERS - FLOOR STANDARD STACKED INSTALL - SEE SKETCH FOR TILE DIRECTION Line 53384 Note: 12" X 24" CARRARA X SERIES POLISHED WHITE (OV.CX.WHT.1224.PL) 18Aug17 / 18Aug17	
Inv.4173	1 - LOCATION: MASTER ENSUITE SHOWER STALL FLOOR TILE - UPGRADE 6 - MASTER ENSUITE - HIS - HERS - SHOWER WITH CEILING STANDARD STACKED INSTALL - TO FOLLOW ALIGNMENT WITH FLOOR TILE Line 53385 Note: 12" X 24" CARRARA X SERIES POLISHED WHITE (OV.CX.WHT.1224.PL) 18Aug17 / 18Aug17	

EXTRAS AS PER OFFER

The Purchaser has been referred by a Realtor and/or is a Realtor. The Realtor listed on Schedule R attached hereto shall be entitled to a referral commission in accordance with the terms and conditions detailed on Schedule R. Worksheet Note:	
The Vendor agrees to allow the purchaser the one time right to assign this transaction, and Purchaser agrees to use the Vendors approved form of assignment. The cost of such assignment will be \$10,000 payable to the Vendor should the purchaser decide to Worksheet Note:	
Subzero/Wolf Kitchen Appliances including 36 inch stainless steel fridge and 36 inch gas range, 36 inch stainless steel chimney style hood fan and ASKO stainless steel dishwasher, from Vendors standard package. No cash value, non-transferrable and no Worksheet Note:	
The Purchaser has selected Exterior Package No:_1___as their FIRST choice. As a SECOND choice, should the FIRST package become unavailable or should there be any architectural control conflicts, the Purchasers SECOND choice is Exterior Package No:___3___ Worksheet Note:	



INTERIOR COLOUR SCHEME

Pha #16.

Purchasers: Jianzhong Gao & Xiaowen Lin
Telephone Res. / Bus: (647) 985-2822 /
Decor Advisor: Steffanee Appio

Property: 16 of Plan -
Project: Carrville Investments Ltd.
Model and Elevation: The Venezia (50-1) Elev B

Layout Changes: ☐ Yes ☒ No Sketch Attached: ☒ Yes ☐ No Exterior Colour Scheme:

1. Cabinetry

	Style and Colour	Counter Top	Hardware
Kitchen / Breakfast	BRUSSELS MAPLE ESPRESSO CL	4600 ORGANIC WHITE CAESAR	9677 HANDLE
Kitchen Island	BRUSSELS MAPLE ESPRESSO CL	4600 ORGANIC WHITE CAESAR	9677 HANDLE
Laundry Room	PVC SLAB LATITUDE EAST	4924-38 CARRARA WHITE	9677 HANDLE
Powder Room	TORONTO MAPLE ESPRESSO CL	NEW CALEDONIA	171 KNOB
Main Bathroom			
Master Ensuite Bathroom	LANCASTER MAPLE CAVIAR CL	4600 ORGANIC WHITE CAESAR	196 KNOB
Second Ensuite Bathroom (If Applicable)	PVC SLAB MERINGUE	NEW CALEDONIA	9677 HANDLE
TWIN BATH	PVC SLAB MERINGUE	NEW CALEDONIA	9677 HANDLE

Appliances Custom Size Fridge ☒ Yes ☐ No Valance Lighting ☐ Yes ☒ No Microwave / Range Hood ☒ Yes ☐ No
Cooktop / Rangetop ☐ Yes ☒ No Built in Wall Oven ☒ Yes ☐ No Slide-in Range ☒ Yes ☐ No
Comment ☐ Yes ☒ No ☒ Yes ☐ No ☒ Yes ☐ No

STANDARD EDGE PROFILE TO STONE COUNTER-TOPS IN KITCHEN AND BATHROOMS

2. Flooring

	Selection
FOYER	24" X 24" MUSE WHITE MATTE (IM.MU.WHT.2424.MT)
Main Hall	5" VINTAGE HANDSCRAPED OAK - GOTHAM
Back Hall	24" X 24" MUSE WHITE MATTE (IM.MU.WHT.2424.MT) SIDE HALL TO POWDER ROOM
Breakfast	24" X 24" MUSE WHITE MATTE (IM.MU.WHT.2424.MT)
Laundry Room	13" X 13" SERPENTINE BEYAZ WHITE (TR.ST.BYZ.WHT.1313)
Kitchen	24" X 24" MUSE WHITE MATTE (IM.MU.WHT.2424.MT)
Powder Room	24" X 24" MUSE WHITE MATTE (IM.MU.WHT.2424.MT)
Main Bathroom	N/A
Master Ensuite	12" X 24" CARRARA X SERIES POLISHED WHITE (OV.CX.WHT.1224.PL) STACKED INSTALL
Bathroom (If Applicable)	13" X 13" SERPENTINE SRYAK CHARCOAL (TR.ST.SRK.1313) ENSUITE 2
Mud Room	13" X 13" SERPENTINE BEYAZ WHITE (TR.ST.BYZ.WHT.1313)
TWIN BATH	13" X 13" SERPENTINE SYRAK CHARCOAL (TR.ST.SRK.1313)
Living Room	5" VINTAGE HANDSCRAPED OAK - GOTHAM
Dining Room	5" VINTAGE HANDSCRAPED OAK - GOTHAM
Family / Great Room	5" VINTAGE HANDSCRAPED OAK - GOTHAM
Den / Library / Study	5" VINTAGE HANDSCRAPED OAK - GOTHAM
Basement Landing (If Applies)	N/A
Lower Landing (If Applicable)	5" VINTAGE HANDSCRAPED OAK - GOTHAM
Upper Landing	5" VINTAGE HANDSCRAPED OAK - GOTHAM
Upper Hall	5" VINTAGE HANDSCRAPED OAK - GOTHAM
Master Bedroom	5" VINTAGE HANDSCRAPED OAK - GOTHAM
Bedroom #2	5" VINTAGE HANDSCRAPED OAK - GOTHAM
Bedroom #3	5" VINTAGE HANDSCRAPED OAK - GOTHAM
Bedroom #4	5" VINTAGE HANDSCRAPED OAK - GOTHAM
Bedroom #5	
YOGA ROOM	5" VINTAGE HANDSCRAPED OAK - GOTHAM

Flooring Continued on Page 2

Initial:

Jh Gao

Page 1 of 3



INTERIOR COLOUR SCHEME

Ph 2#16.

Purchasers: Jianzhong Gao & Xiaowen Lin
Telephone Res. / Bus: (647) 985-2822 /
Decor Advisor: Steffanee Appio

Property: 16 of Plan -
Project: Carrville Investments Ltd.
Model and Elevation: The Venezia (50-1) Elev B

2. Flooring - Continued -

Upgrade Underpad	Type	Area
Carpet on Stairs	Capped	Runner - *Upgrade
Comment		

3. Plumbing Fixtures / Faucets

Kitchen		Second Ensuite		Powder Room	
Master Ensuite				Other Room	
Main Bathroom					
Comment					

4. Wall Tile

	Tile Selection	Listello	Insert	Insert Selection
Main Bathroom		<input type="checkbox"/>	<input type="checkbox"/>	
Master Ensuite				
Tub Deck		<input type="checkbox"/>	<input type="checkbox"/>	
Tub Apron		<input type="checkbox"/>	<input type="checkbox"/>	
Tub Surround		<input type="checkbox"/>	<input type="checkbox"/>	
Shower Stall	12" X 24" CARRARA X SERIES POLISHED WHITE	<input type="checkbox"/>	<input type="checkbox"/>	OV.CX.WHT.1224.PL
Second Ensuite	8" X 12" BRICK GLOSSY WHITE (TH.BR.WHT.0812.GL)	<input type="checkbox"/>	<input type="checkbox"/>	2 X 2 MOSAIC WHITE FLOOR
TWIN BATH	8" X 12" BRICK GLOSSY WHITE (TH.BR.WHT.0812.GL)	<input type="checkbox"/>	<input type="checkbox"/>	IN SHOWER STALL ENS 2
		<input type="checkbox"/>	<input type="checkbox"/>	
Kitchen Backsplash		<input type="checkbox"/>	<input type="checkbox"/>	
Complete Backsplash		<input type="checkbox"/>	<input type="checkbox"/>	
Comment				
STANDARD UNDERMOUNT SINK TO ALL BATHROOMS				
12" X 24" FLOOR TILE IN MASTER ENSUITE SHOWER STALL TO INSTALLED IN LINE WITH FLOOR TILE				
2 X 2 STANDARD MOSAIC WHITE FLOOR TILE IN SHOWER STALL				

5. Fireplace

	Living Room			Family Room			Other Room - Specify		
	Purchased	As Per Plan	N/A	Purchased	As Per Plan	N/A	Purchased	As Per Plan	N/A
	<input type="radio"/>	<input type="radio"/>	<input type="radio"/>	<input type="radio"/>	<input checked="" type="radio"/>	<input type="radio"/>	<input type="radio"/>	<input type="radio"/>	<input type="radio"/>
Fireplace Type				STANDARD BLACK INSERT					
Mantle Type				VILLA NOVA					
Over Mantle									
Colour / Stain									
Surround									
Hearth									
Comment									



INTERIOR COLOUR SCHEME

Ph 2 #16.

Purchasers: Jianzhong Gao & Xiaowen Lin

Property: 16 of Plan -

Telephone Res. / Bus: (647) 985-2822 /

Project: Carrville Investments Ltd.

Decor Advisor: Steffanee Appio

Model and Elevation: The Venezia (50-1) Elev B

6. Trim Carpentry

Door Hardware STANDARD

Interior Trim STANDARD

Comment

Interior Doors

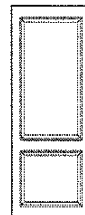
☐ 2 Panel Arch Top☒ 2 Panel Square Top☐ 6 Panel

Initial for Door Style

Lin

7. Railings and Pickets

Railing Package STANDARD

Railing Colour GOTHAM

Picket Colour FLAT BLACK METAL

Wood Stairs ☐ No ☒ Oak

Tread Colour GOTHAM

Comment

STAIN OAK STAIRS TO COMPLIMENT HARDWOOD COLOUR - GOTHAM

8. Plaster Mouldings and Medallions

Foyer

Main Hall

Living Room

Dining Room

Family Room

Kitchen/Breakfast

Den/Library

Lower Landing

Comment

9. Wall Paint

STANDARD SENATOR WHITE

Smooth Ceilings

☐ First Floor☐ First Floor incl. Second Floor Hall☐ First and Second Floor☒ Throughout☐ Not Applicable

Trim Paint

10. Additional Comments

11. Disclaimers and Notes

- Colours of all materials are as close as possible to builder's selection, but not necessarily identical due to variances in manufacturing.
- Any extras listed above are null and void unless accompanied by a separate invoice/amendment. Said invoice must be paid in full.
- The Purchaser acknowledges that after Interior Colour Selection form is signed and dated, no further changes will be permitted other than re-selection due to unavailability. Purchaser's Initials
- The Purchaser acknowledges reading and accepting the "Senator Homes Décor Centre Disclaimers" form. This document contains other miscellaneous disclaimers.

This Interior Colour Selection is final and approved by:

Purchaser:

Signature: Lin Xiaome

Date: Aug 18, 2017

Signature: Jianzhong Gao

Date:

Vendor:

Carrville Investments Ltd.

Sep 5/17.

Pha #16.

The Loggias in

richdale

SOUTH RICHMOND HILL

VENEZIA

ELEV. A 3,785 SQ.FT. | ELEV. B 3,785 SQ.

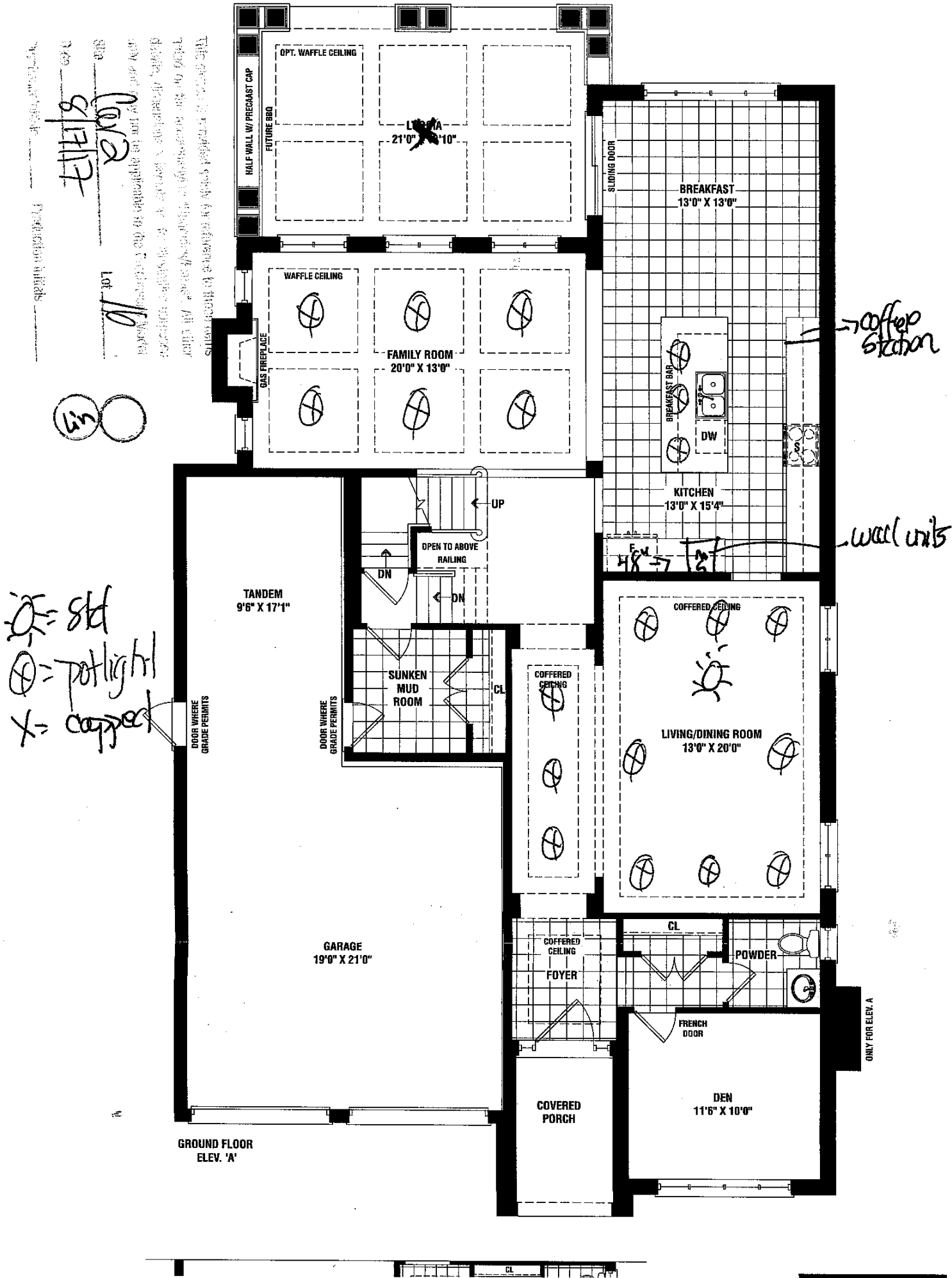

Pho #16

This sketch is provided solely for reference to those items noted on the accompanying "Upgrades/Extras". All other details, dimensions & layouts are for illustrative purposes only and may not be applicable to the Purchaser's Model

FT. | ELEV. C 3,785 SQ.FT.

Site 1002 Lot 16
Date 8/17/17
Purchaser Initials _____ Production Initials _____

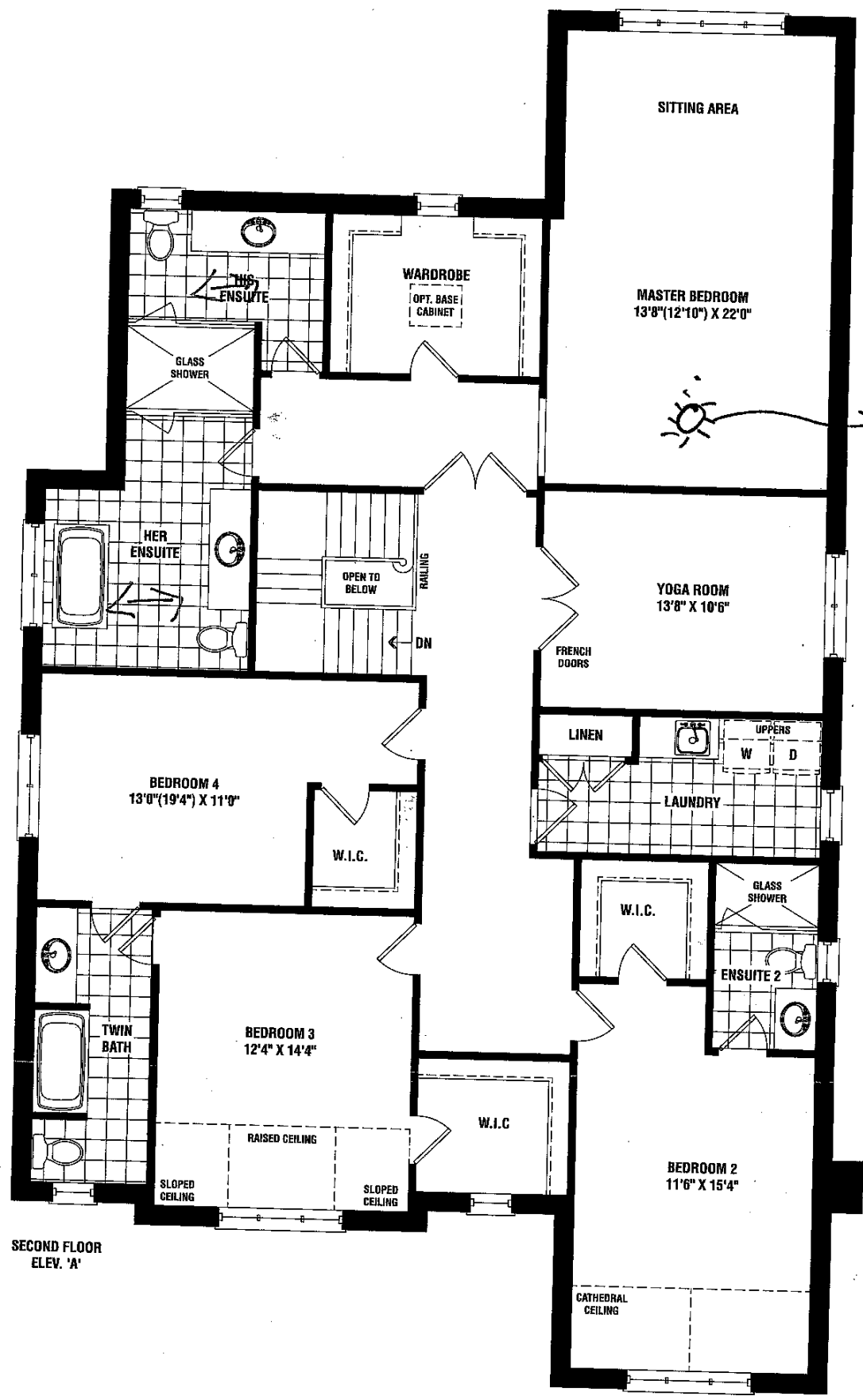

SECOND FLOOR
ELEV. 'A'

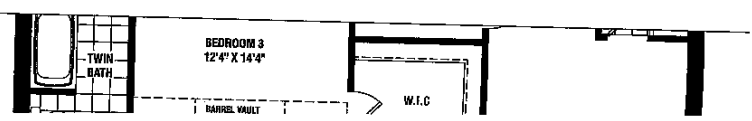
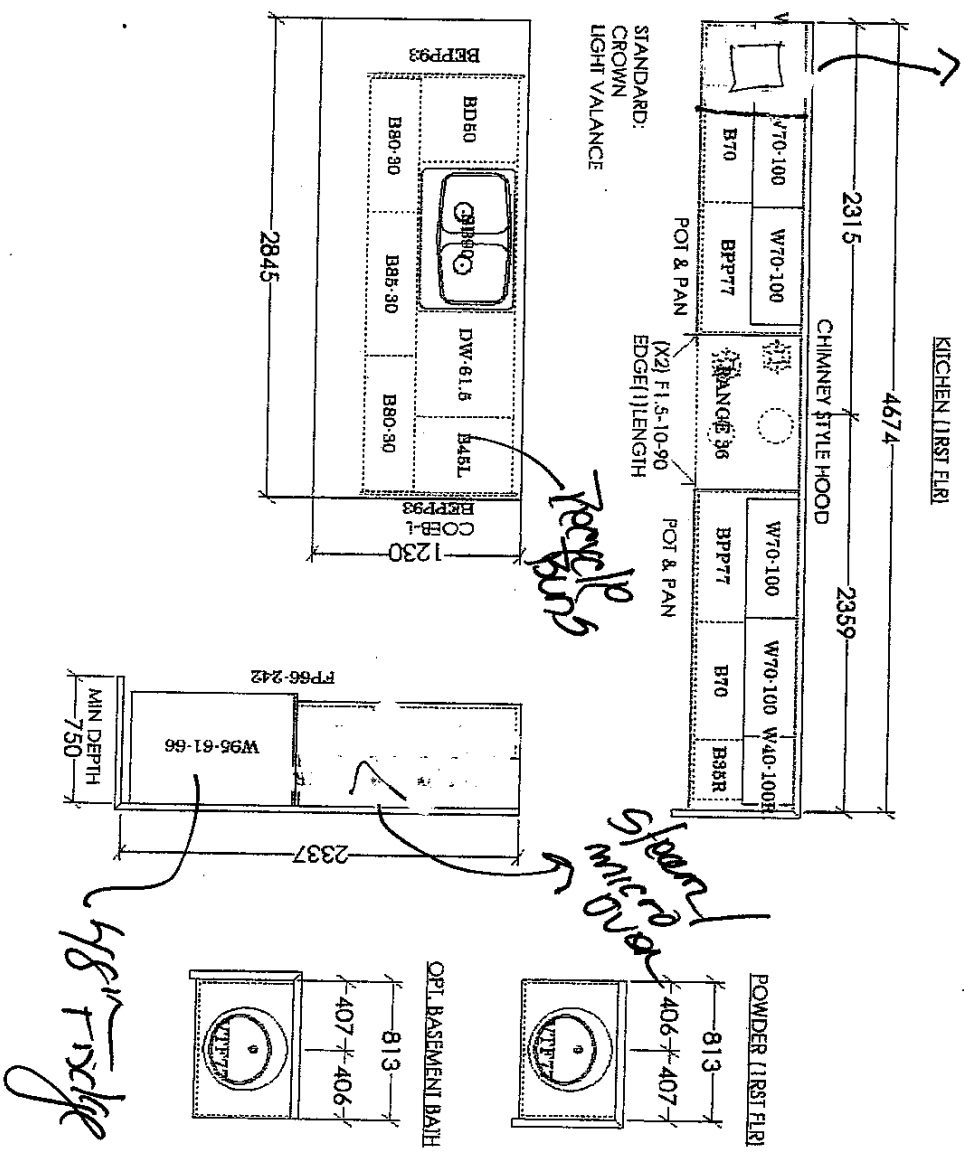



Photo #16

built in
after
station

(1) Stacked upper (no glass)
(2) Fridge/pan + cabinet





F R E N D E L
KITCHENS LIMITED
1330 Sheppard Ave. E., Suite 100, Willowdale, ON M2H 1S5

SENATOR HOMES
RICHVALE PHASE 2
MODEL: VENEZIA
50-1 (1st Flr)

STANDARD CONTRACT INCLUDES:

- Kitchen**
 - Canopy Hood 104 +/- cm Wide opening
 - Deep fridge 95cm Wide - gables at exposed ends
 - Slide in range 92 Wide opening
 - Soft close hinges
 - Elite collections receive soft close tandem drawers
 - Pots and pan drawers (x2 sets)
 - 1 bank of 4 drawers
 - Crown moulding
 - Light valance
 - Backing on all cabinets (excluding sink base)
 - Countertop by others
- Vanity**
 - Vanities - 80cm H
 - Vanities are 53.4cm Deep
 - Vanities include top drawers
 - Soft close hinges
 - Elite collections receive soft close tandem drawers
 - Countertop by others

THIS DRAWING IS FOR DESIGN PURPOSES ONLY.
IT IS NOT AN EXACT REPRESENTATION.
5/9/2017

This sketch is provided solely for reference to those items noted on the accompanying "Upgrades/Extras". All other details, dimensions & fixtures are for illustrative purposes only and may not be applicable to the "contract" model.

Site 1002 Lot 10
Date 8/11/17
Purchaser Initials lar Production Initials

Pho#16.

STANDARD 2ND FLR - ELEV. A, B, C

HIS ENSUITE (2ND FLR)

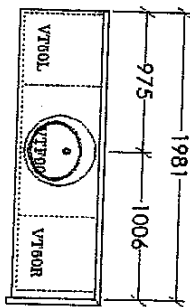

HER ENSUITE (2ND FLR)

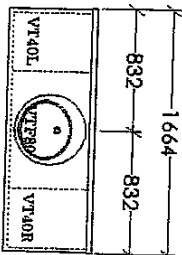

IWIN BATH (2ND FLR)

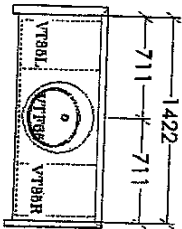

ENSUITE 2 (2ND FLR)

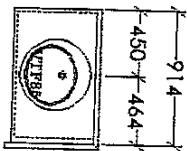

LAUNDRY (2ND FLR)

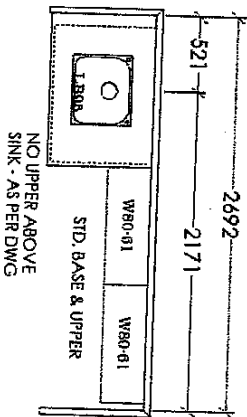

**OPT. 2ND FLR - ELEV. A, B, C
FOR OPT. HER MASTER W.I.C.**

HIS ENSUITE (2ND FLR)

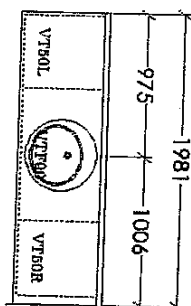

HER ENSUITE (2ND FLR)

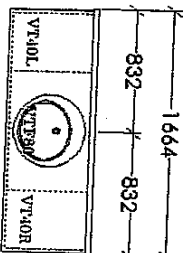

IWIN BATH (2ND FLR)

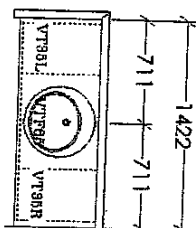

ENSUITE 2 (2ND FLR)

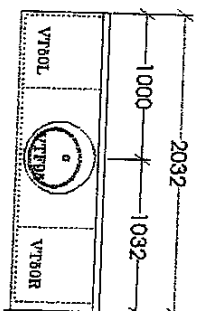

LAUNDRY (2ND FLR)

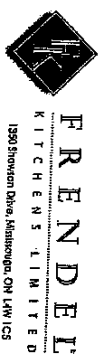
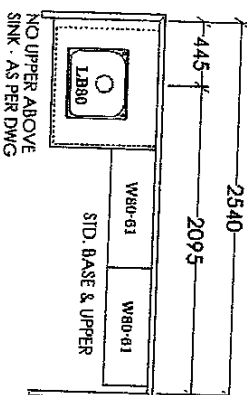

SENATOR HOMES
RICHALE PHASE 2
MODEL: VENEZIA
50-1 (2ND FLR)

STANDARD CONTRACT INCLUDES:

Vanity

- Vanities - 80cm H
- Vanities are 53.4cm Deep
- Vanities include top drawers
- Soft close hinges
- Elite collections receive soft close tandem drawers
- Countertop by others

THIS DRAWING IS FOR DESIGN PURPOSES ONLY.
IT IS NOT AN EXACT RENDERING.

5/9/2017

This sheet is made for reference for the client. It is not a contract. The client is responsible for the final design and construction. The client is responsible for the final design and construction. The client is responsible for the final design and construction.

8/17/17

Production finished

48" BUILT-IN SIDE-BY-SIDE REFRIGERATOR/FREEZER



BI-48S/S



FEATURES

- LED Lighting for brighter interior
- Dual refrigeration keeps food fresher longer
- Air purification system fights spoilage, odors
- Crispers and deli drawers in low-temp, high-humidity zones for optimum freshness
- Microprocessor control assures peak performance
- Water-filtration system reduces contaminants, chlorine taste and odor
- Freshness cards for maximum food preservation
- Rigorously tested in our U.S. manufacturing facilities to ensure decades of use
- Exceptional 24/7 support from Madison, WI-based Customer Care team
- Magnetic door seal system locks in cold air
- Automatic ice maker with "max ice" feature
- Adjustable shelves for maximum convenience

ACCESSORIES

- Air Purification Cartridge
 - Built-In Custom Side Panel Mounting Kit
 - Egg Container
 - Stainless Steel Side Panel
 - Water Filter 4204490
 - White Side Panel
 - Stainless steel kickplate
 - Grilles for 83" or 88" finished height (84" is standard)
 - Side panel mounting kit
- Accessories are available through an authorized Sub-Zero dealer.
For local dealer information, visit subzero-wolf.com/locator.

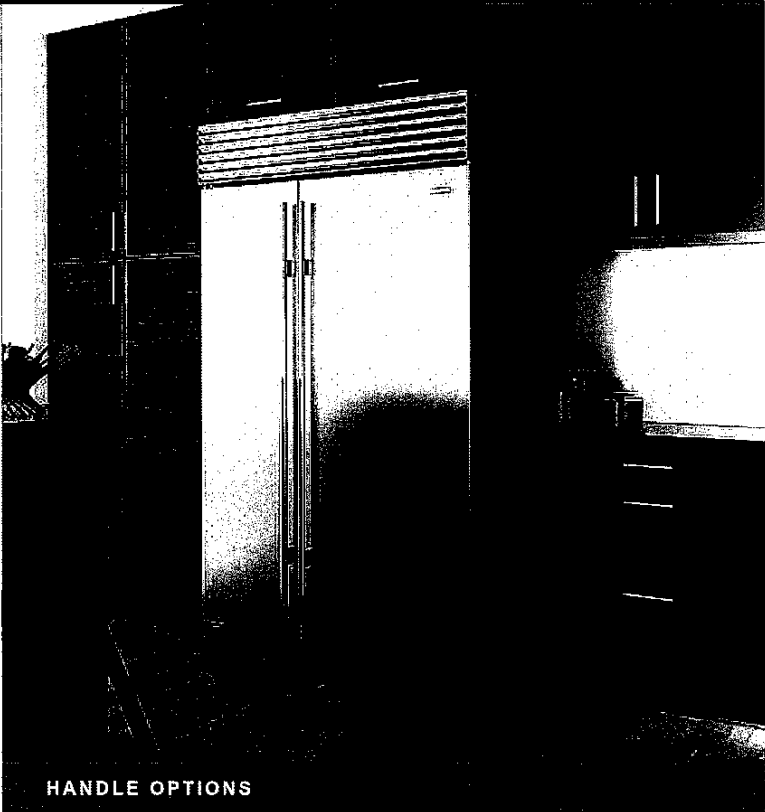

HANDLE OPTIONS

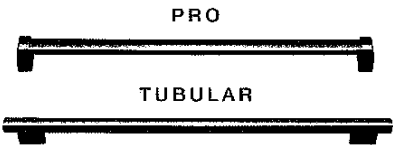

PRODUCT DETAILS

REFRIGERATOR

- 4 Adjustable glass shelves
- 1 Stationary glass shelf
- 1 High-humidity drawer with divider
- 2 Storage drawers with divider
- 3 Adjustable door shelves
- 2 Stationary door shelves
- Adjustable dairy compartment

FREEZER

- 3 Adjustable wire shelves
- 1 Stationary solid shelf
- 3 Storage drawers
- 5 Adjustable door shelves
- Automatic ice maker

48" BUILT-IN SIDE-BY-SIDE REFRIGERATOR/FREEZER

SUB-ZERO

PRODUCT SPECIFICATIONS

Model	BI-48S/S
Dimensions	48"W x 84"H x 24"D
Door Clearance	30"
Weight	630 lbs
Refrigerator Capacity	19.1 cu. ft.
Freezer Capacity	9.8 cu. ft.
Electrical Supply	115 VAC, 60 Hz
Electrical Service	15 amp dedicated circuit
Receptacle	3-prong grounding-type

ELECTRICAL

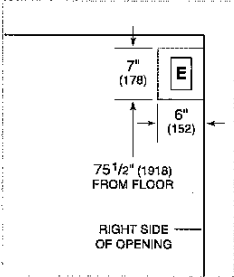

PLUMBING

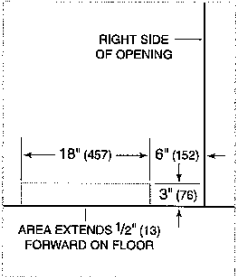

NOTE:

Dimensions in parenthesis are in millimeters unless otherwise specified

INTERIOR VIEW

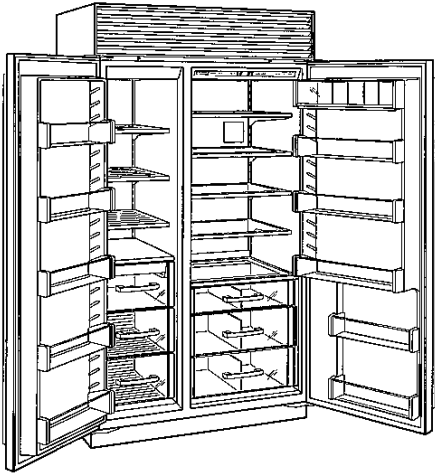

This illustration is intended for interior reference only and may not represent the exterior of the model being specified.

DIMENSIONS

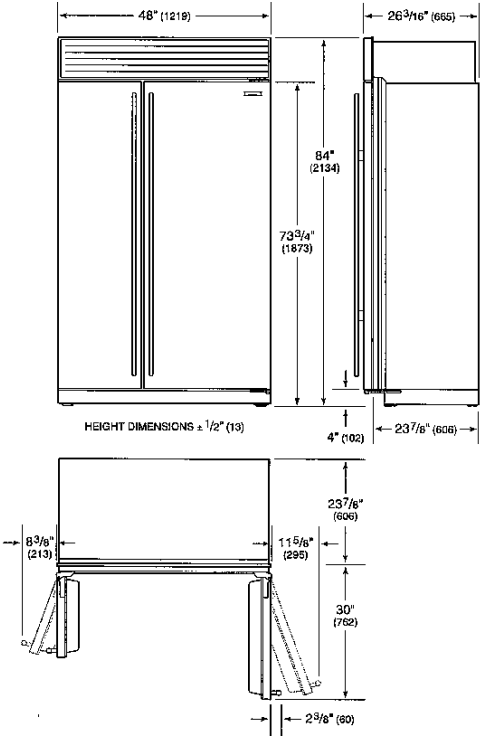

STANDARD INSTALLATION

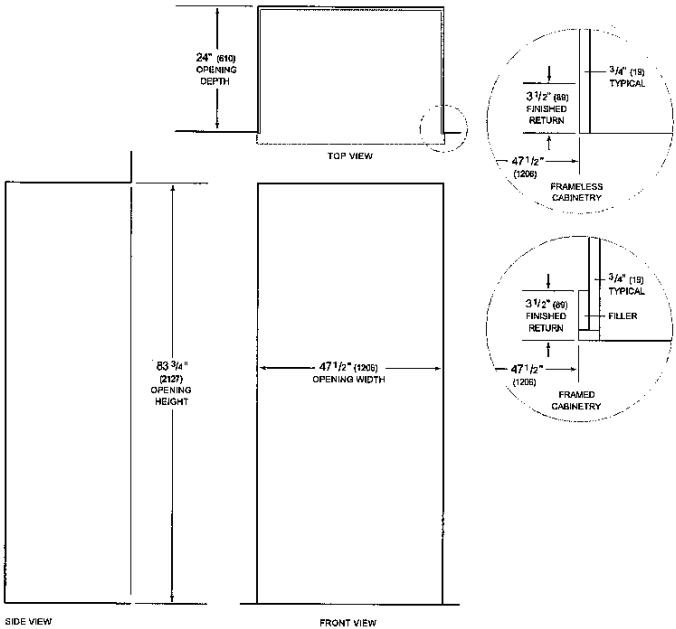

NOTE: 3 1/2" (89 mm) finished returns will be visible and should be finished to match cabinetry. Shaded line represents profile of unit.

Ph2-16.

Miele

PureLine
24" Combi-Steam Oven

DGC 6800-1

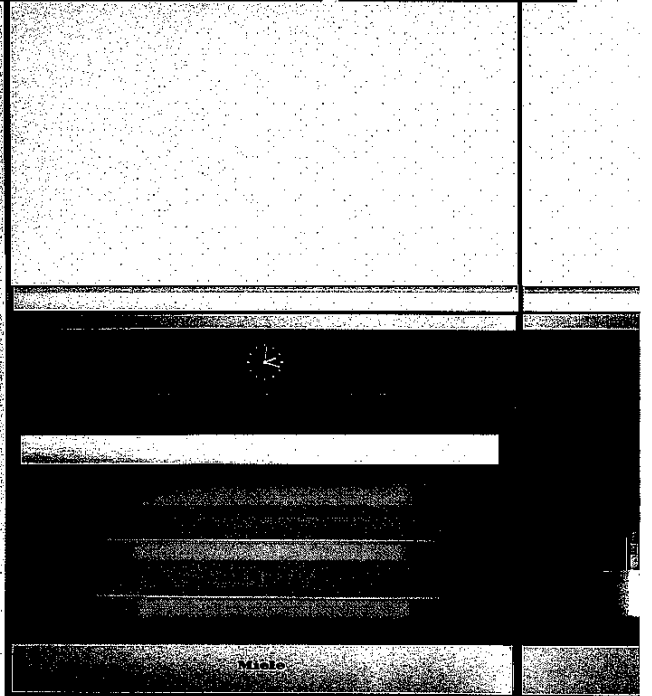

© Miele.ca
Specification Sheet DGS09062016

PureLine Combi-Steam Oven
DGC 6800-1

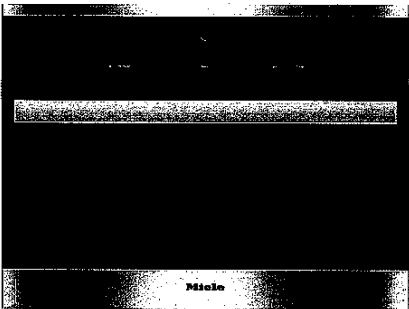

DGC 6800-1

Features:

- M Touch innovative and revolutionary controls are both easy-to-operate and navigate. An intuitive swipe of the screen will quickly lead you to your desired selection
- MultiSteam technology delivers powerful external steam generation and optimum steam distribution via 6 inlet ports
- Wired roast probe for perfect roasting
- 3-in-1 appliance
 1. True European convection oven
 2. Steam oven
 3. Combination of steam and convection oven
- MasterChef and MasterChef Gourmet menus offer over 150 food types to cook to perfection
- XL stainless steel cavity
- Lift up control panel conceals water and condensate container (both containers are dishwasher-safe)
- The simple yet sleek Silhouette handle seems to float, enhancing its modern design lines

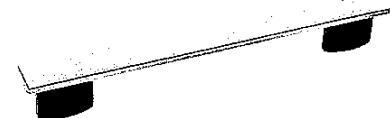

SPECIFICATIONS	
DGC 6800-1	
Overall Fascia Dimensions	23 7/16" (595 mm) W x 18" (455.5 mm) H x 7/8" (23 mm) D
Overall Unit Width - Excluding Fascia Dimension	21 5/16" (548 mm)
Overall Unit Height - Excluding Fascia Dimension	17 11/16" (449 mm)
Overall Unit Depth - Excluding Fascia Dimension	21 5/8" (550 mm)
Oven Door Clearance	12 3/16" (319 mm)
Built-in	
Minimum Opening Width	22 1/16" (560 mm)
Minimum Opening Height	17 11/16" (450 mm)
Minimum Opening Depth	21 7/8" (555 mm)
Minimum Base Support	60 lbs
Additional Cut-Outs Required	Venting cut-out required 19 11/16" x 1 9/16" (500 x 40 mm)
Electrical	
Electrical Requirements	120V/240V, 60Hz, 20A 120V/208V, 60Hz, 20A
Power Rating	120V/240V - 3.7 kw 120V/208V - 3.2 kw
Power Cord	Molded plug - NEMA 6-20, 240V power cord 5 ft (1.5 m)
Shipping	
Shipping Weight	65 lbs
Shipping Dimensions	26 7/32" (666 mm) W x 21 5/8" (549 mm) H x 23 1/16" (535 mm) L
Support	
Call Miele	800.565.6435
Miele Website	www.miele.ca

PureLine Combi-Steam Oven
DGC 6800-1 XL



PRODUCT VIEWS

Isometric View

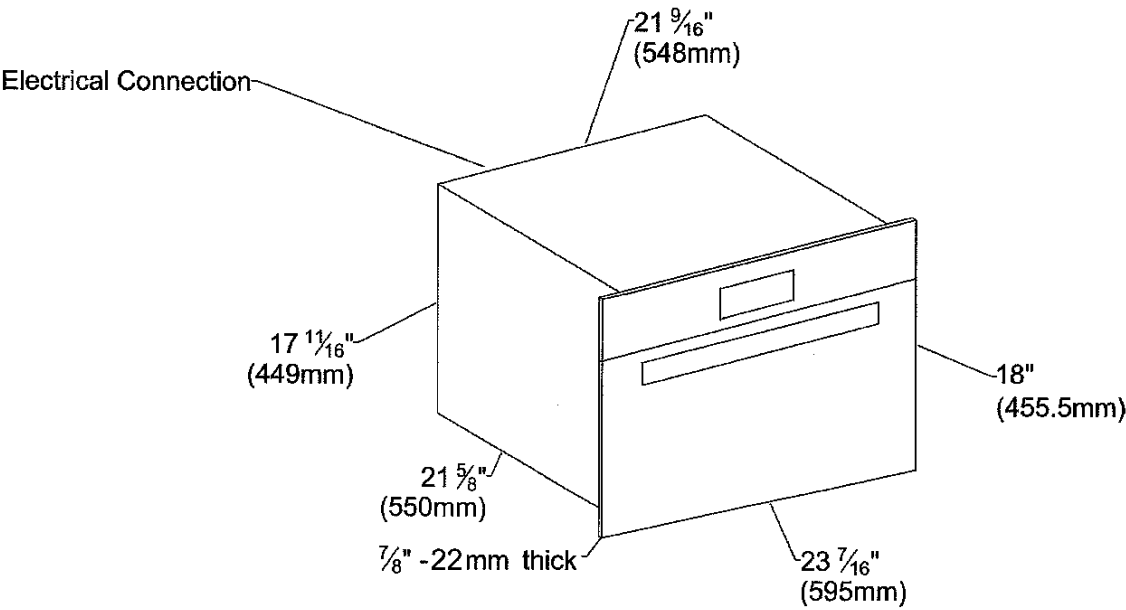

Front View

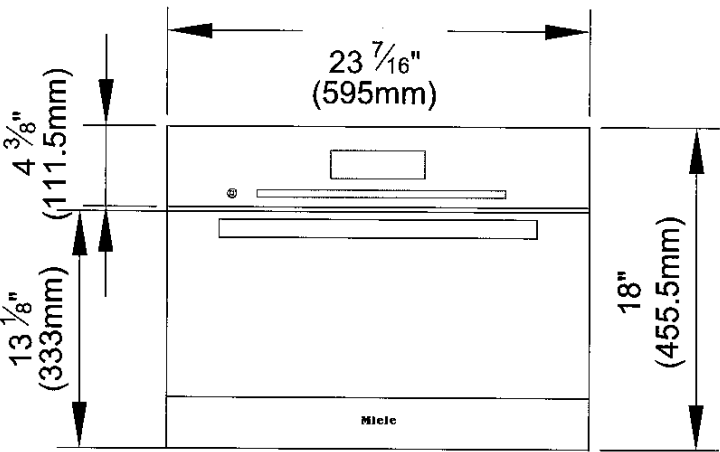

Ph 2-16.

PureLine Combi-Steam Oven
DGC 6800-1 XL



INSTALLATION SPECIFICATIONS

Top View, Door Open

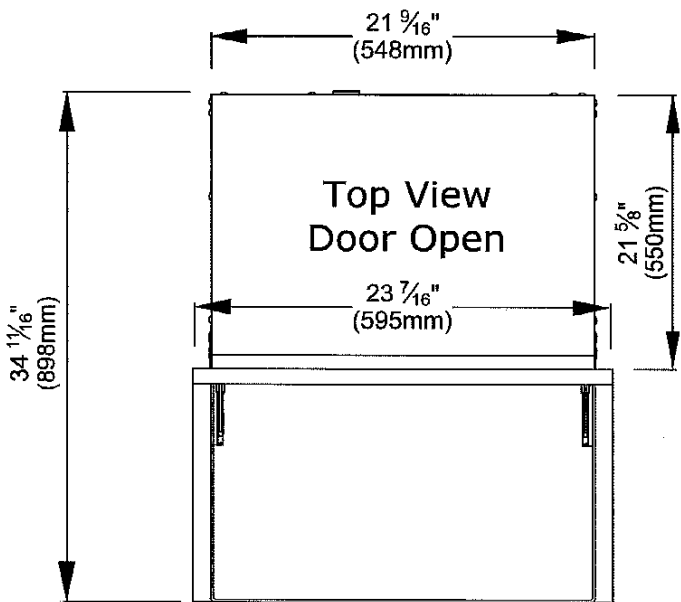

Side View, Door Open

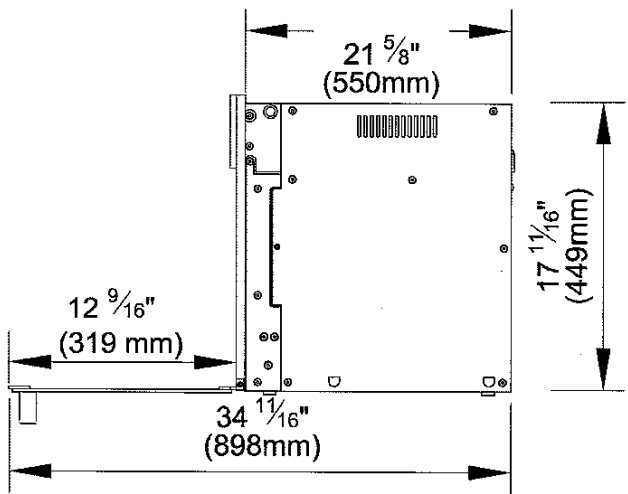

PureLine Combi-Steam Oven
DGC 6800-1 XL



INSTALLATION SPECIFICATIONS

Door Swing and Face Detail

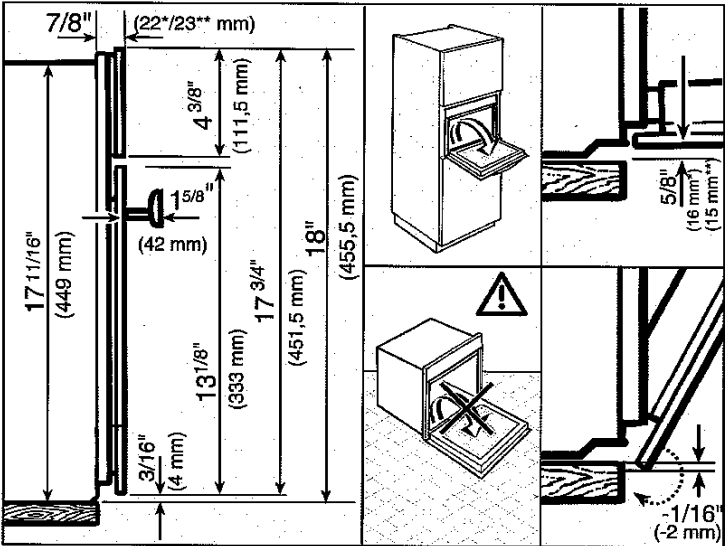

- * Appliances with glass front
- ** Appliances with metal front

Control Panel Swivel View

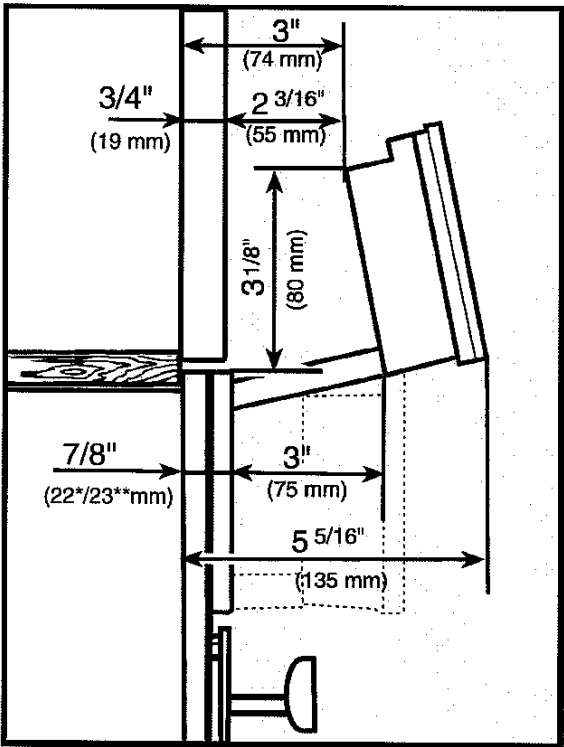

Pha-16.

PureLine Combi-Steam Oven
DGC 6800-1 XL



INSTALLATION SPECIFICATIONS

Tall Cabinet Installation

- ① Combi Steam Oven
- ② Installation niche
- ③ Power supply to the appliance
- ④ Recommended location for electrical connection
- ⑤ Power cord

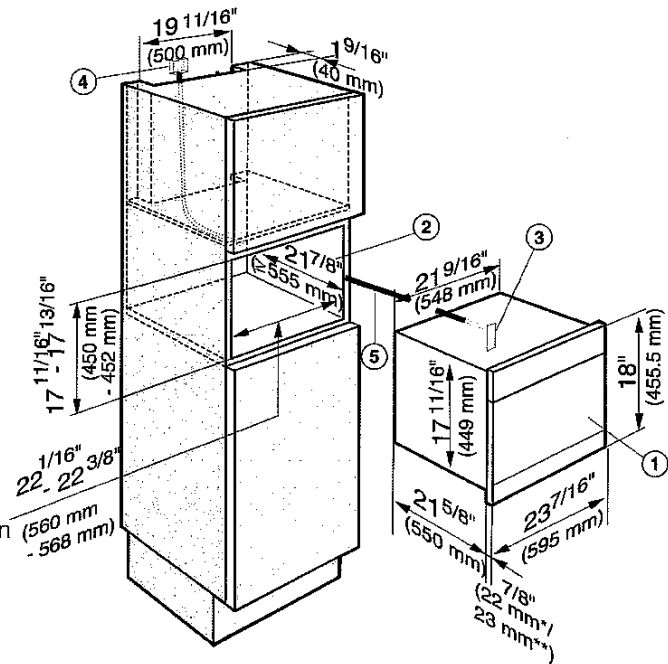

* Appliances with glass front
** Appliances with metal front

Tall Cabinet Installation —
Venting Requirements

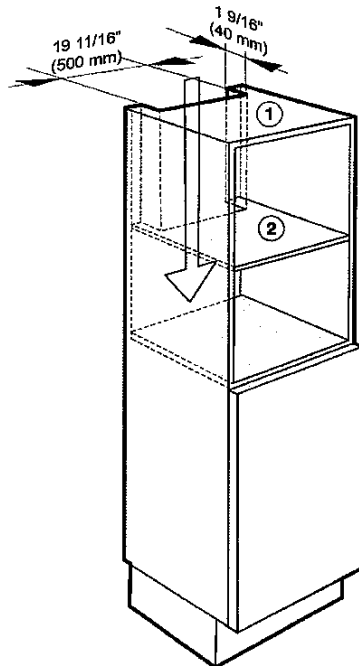

To ensure that the Combi Steam Oven has adequate ventilation, the following cut-outs measuring 19 11/16" x 1 9/16" (500 x 40 mm) must be made:

- ① in the top of the cabinet
- ② in the center shelf above the installation niche

The cabinet housing must not have a back panel fitted behind the installation niche.

PureLine Combi-Steam Oven

DGC 6800-1 XL



INSTALLATION SPECIFICATIONS

Installation Above 24" Oven

- ① Combi Steam Oven
- ② Installation niche
- ③ Power supply to the appliance
- ④ Recommended location for electrical connection
- ⑤ Power cord
- ⑥ Oven

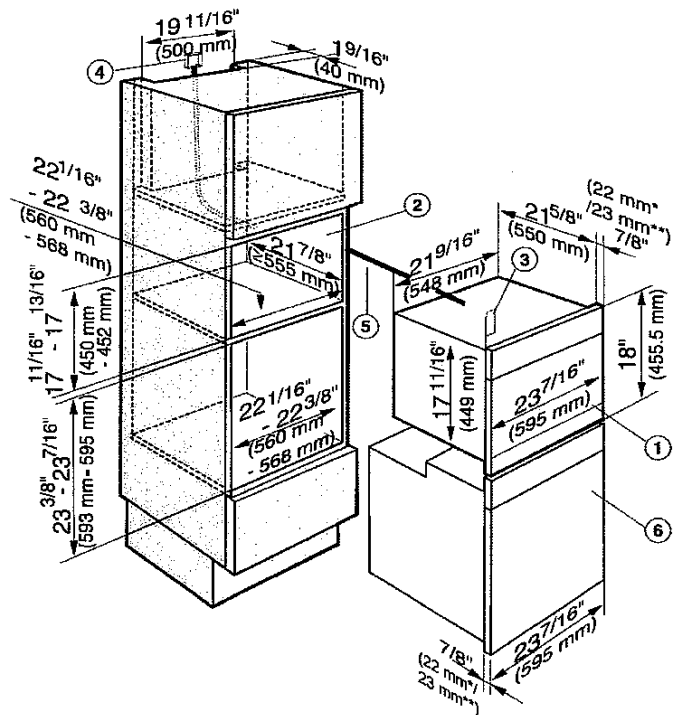

Installation Above 24" Oven —
Venting Requirements

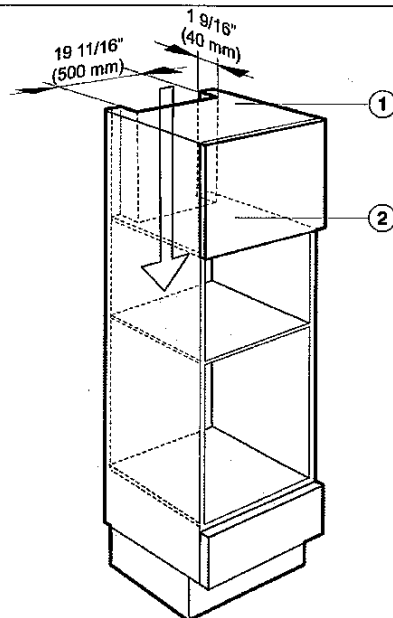

To ensure that the Combi Steam Oven has adequate ventilation, the following cut-outs measuring 19 11/16" x 1 9/16" (500 x 40 mm) must be made:

- ① in the top of the cabinet
- ② in the center shelf above the installation niche

The cabinet housing must not have a back panel fitted behind the installation niche.

Cut-out for venting the oven:
Please refer to the installation instructions for the oven.

PureLine Combi-Steam Oven
DGC 6800-1 XL



INSTALLATION SPECIFICATIONS
Installation Above Warming Drawer

- ① Combi Steam Oven
- ② Installation niche
- ③ Power supply to the appliance
- ④ Recommended location for electrical connection
- ⑤ Power cord
- ⑥ Warming drawer

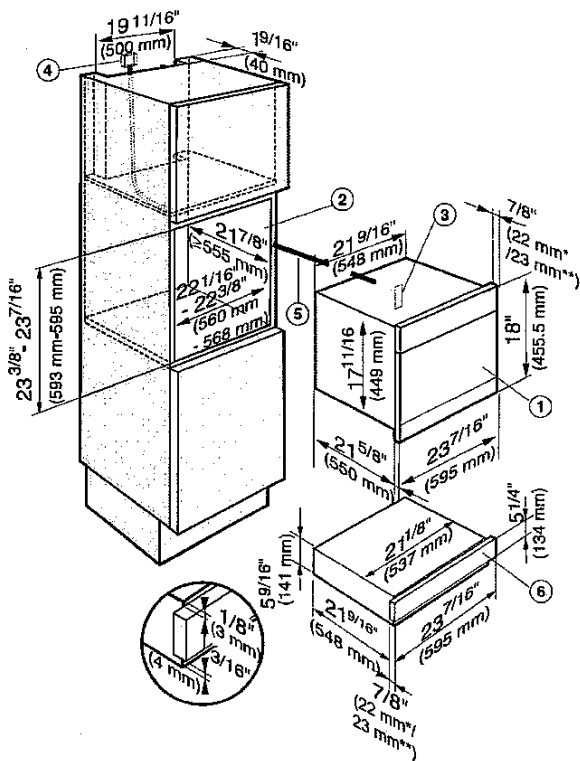

Installation Above Warming Drawer —
Venting Requirements

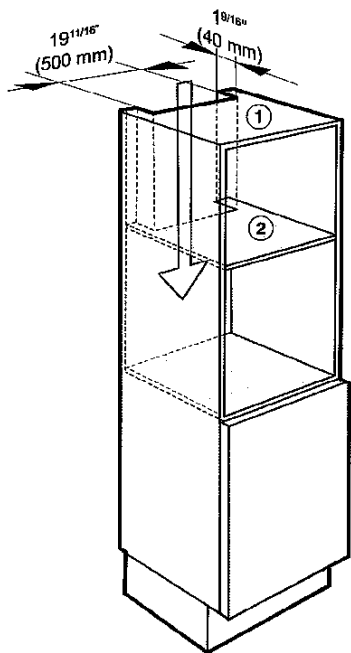

To ensure that the Combi Steam Oven has adequate ventilation, the following cut-outs measuring 19 11/16" x 1 9/16" (500 x 40 mm) must be made:

- ① in the top of the cabinet
- ② in the center shelf above the installation niche

The cabinet housing must not have a back panel fitted behind the installation niche.

PureLine Combi-Steam Oven
DGC 6800-1 XL



INSTALLATION SPECIFICATIONS

Installation Undercounter

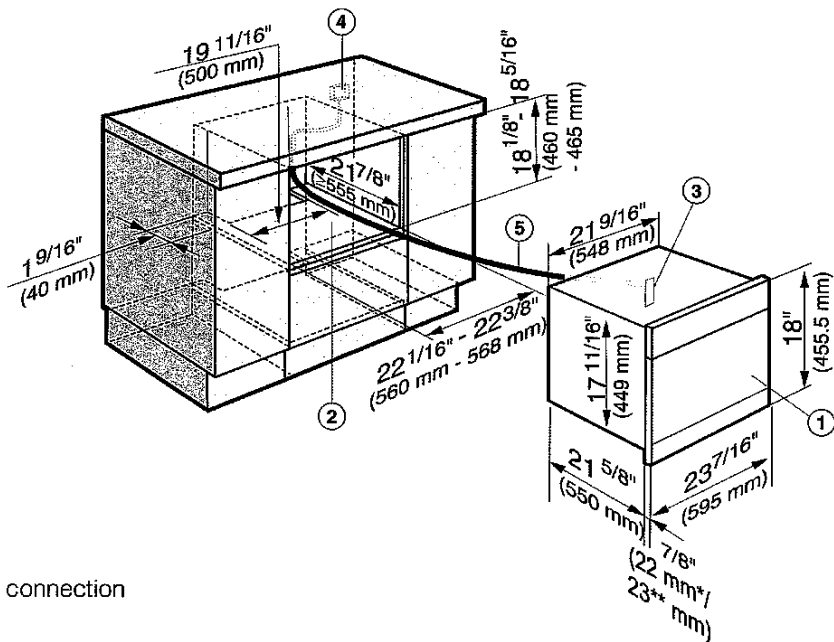

- ① Combi Steam Oven
- ② Installation niche
- ③ Power supply to the appliance
- ④ Recommended location for electrical connection
- ⑤ Power cord

* Appliances with glass front
** Appliances with metal front

If the appliance is to be installed under a cooktop, observe the instructions for installation of the cooktop and its installation height.

Installation Undercounter —
Venting Requirements

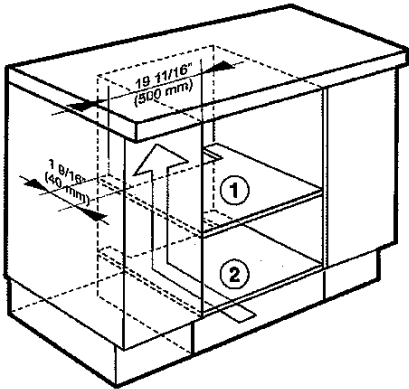

To ensure that the Combi Steam Oven has adequate ventilation, the following cut-outs measuring 19 11/16" x 1 9/16" (500 x 40 mm) must be made:

- ① in the appliance support base
- ② in the bottom of the cabinet space below

The cabinet housing must not have a back panel fitted behind the installation niche.

PureLine Combi-Steam Oven
DGC 6800-1 XL



HANDLE DETAILS
All Miele Signature And PureLine
Handle Dimensions

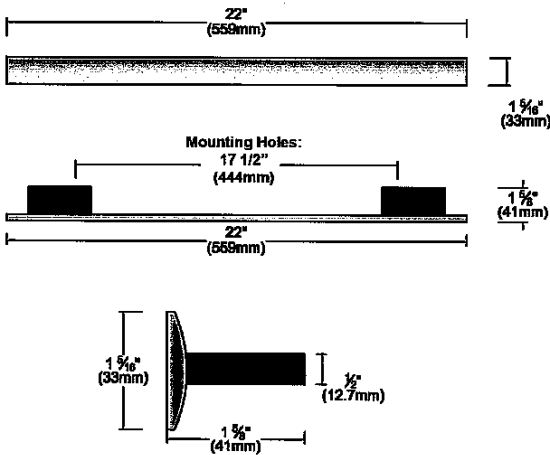

Please note hinges may require adjusting or replacing when changing from a ContourLine Handle to a PureLine or Miele Signature Handle.

All ContourLine Handle
Dimensions

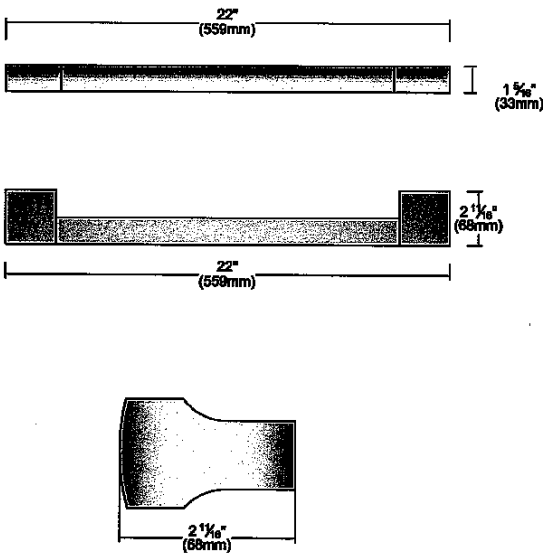

Please note hinges may require adjusting or replacing when changing from a PureLine or Miele Signature Handle to a ContourLine Handle.

Pha-16.

Miele

PureLine
24" Microwave Oven
M 6260 TC

Miele

© 2013 Miele AG
Specification Sheet 11-31162013

PureLine 24" Microwave Oven
M 6260 TC

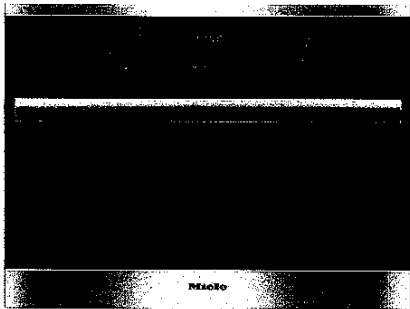

M 6260 TC
Features:

- DirectSelect controls offer turn dial operation with a 7-segment liquid crystal display
- Popcorn button
- 900 watt microwave
- XL cavity — 1.62 cu ft (46 l) with a 15.8" turntable diameter to reheat several plates at one time
- 16 automatic programs
 - 9 for defrosting
 - 3 for cooking frozen food
 - 4 for fresh ingredients
- Minute plus button
- Timer
- LED lighting for the perfect illumination and low maintenance
- Horizontal alignment with other 60cm appliances
- The simple yet sleek Silhouette handle seems to float enhancing its modern design lines.



SPECIFICATIONS

M 6260 TC

Overall Unit Width - Excluding Fascia Dimension	21 5/8" (550 mm)
Overall Height - Excluding Fascia Dimension	16 1/4" (413 mm)
Overall Depth - Excluding Fascia Dimension	19 3/16" (487 mm)
Oven Door Clearance	15 1/2" (394 mm)
Overall Oven Interior Capacity	Suitable for plates with a diameter up to 15.8"
Overall Fascia Dimensions	23 7/16" (595 mm) W x 17 15/16" (455.5 mm) H x 7/8" (23 mm) D
Built-In	
Minimum Cabinet Width	22 1/16" (562 mm)
Minimum Cabinet Depth	21 5/8" (550 mm)
Minimum Cabinet Height	17 11/16" (450 mm)
Minimum Base Support	40 lbs (18 kg)
Electrical	
Electrical Requirements	120V 15A 60Hz
Power Cord	Molded NEMA 5-15 plug, 5 ft. (1.5 m)
Total Amps	11.4A (120V)
Shipping	
Shipping Weight	49 lbs (22 kg)
Shipping Dimensions	25 7/8" W x 19 13/16" H x 21 1/8" L
Support	
Call Miele	800.565.6435
Miele Website	www.miele.ca

PureLine 24" Microwave Oven
M 6260 TC



HANDLE DETIALS
All Miele Signature And PureLine
Handle Dimensions

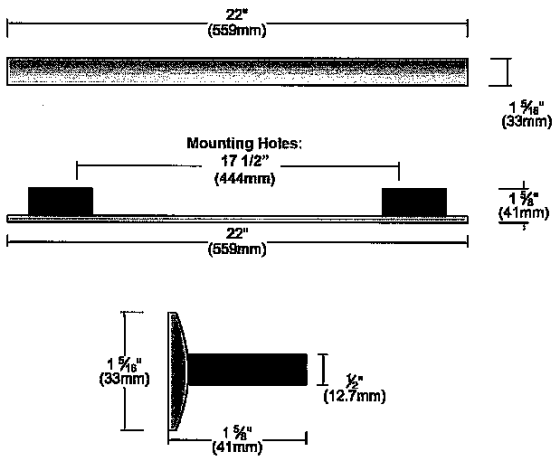

Please note hinges may require adjusting or replacing when changing from a ContourLine Handle to a Pureline or Signature handle.

All ContourLine Handle
Dimensions

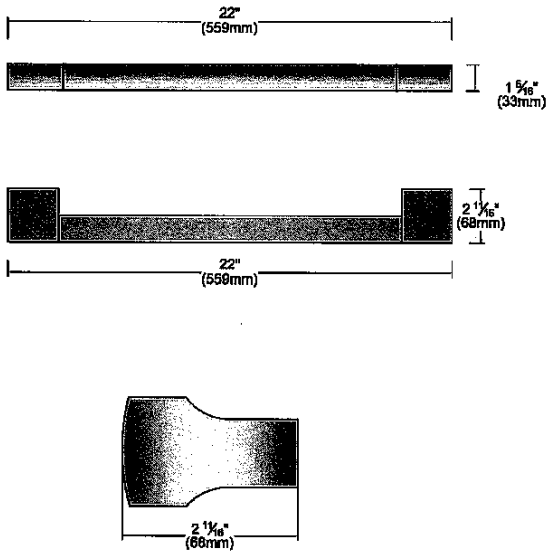

Please note hinges may require adjusting or replacing when changing from a Pureline or Signature handle to a ContourLine Handle.

PureLine 24" Microwave Oven
M 6260 TC



INSTALLATION SPECIFICATIONS

Side flush

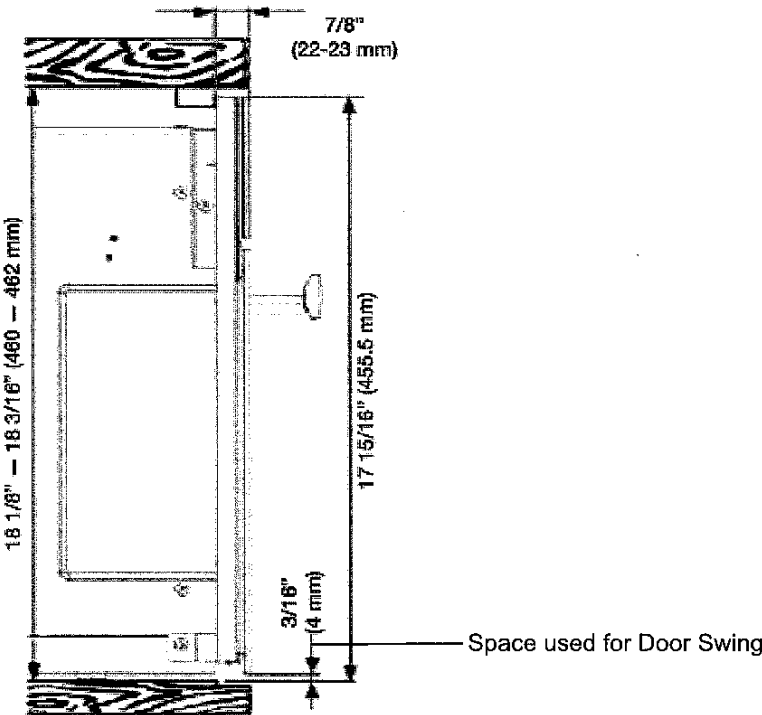

Side proud

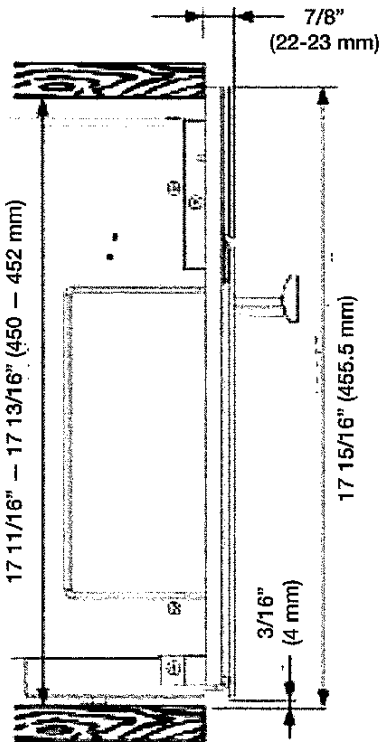

PureLine 24" Microwave Oven
M 6260 TC



INSTALLATION SPECIFICATIONS

Install in Tall Cabinet

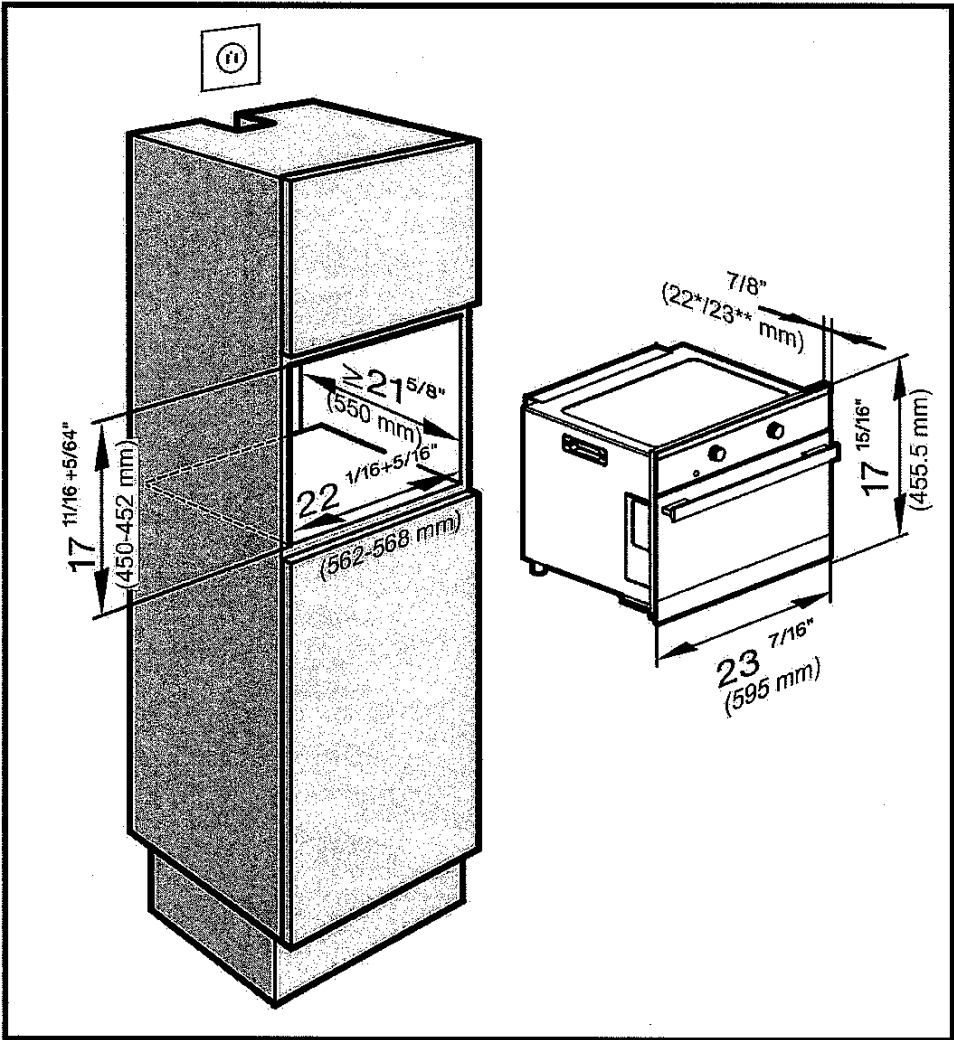

* Oven with glass front
** Oven with metal front

Miele

Clean Touch Steel
24" Whole Bean Coffee System

CVA 6800

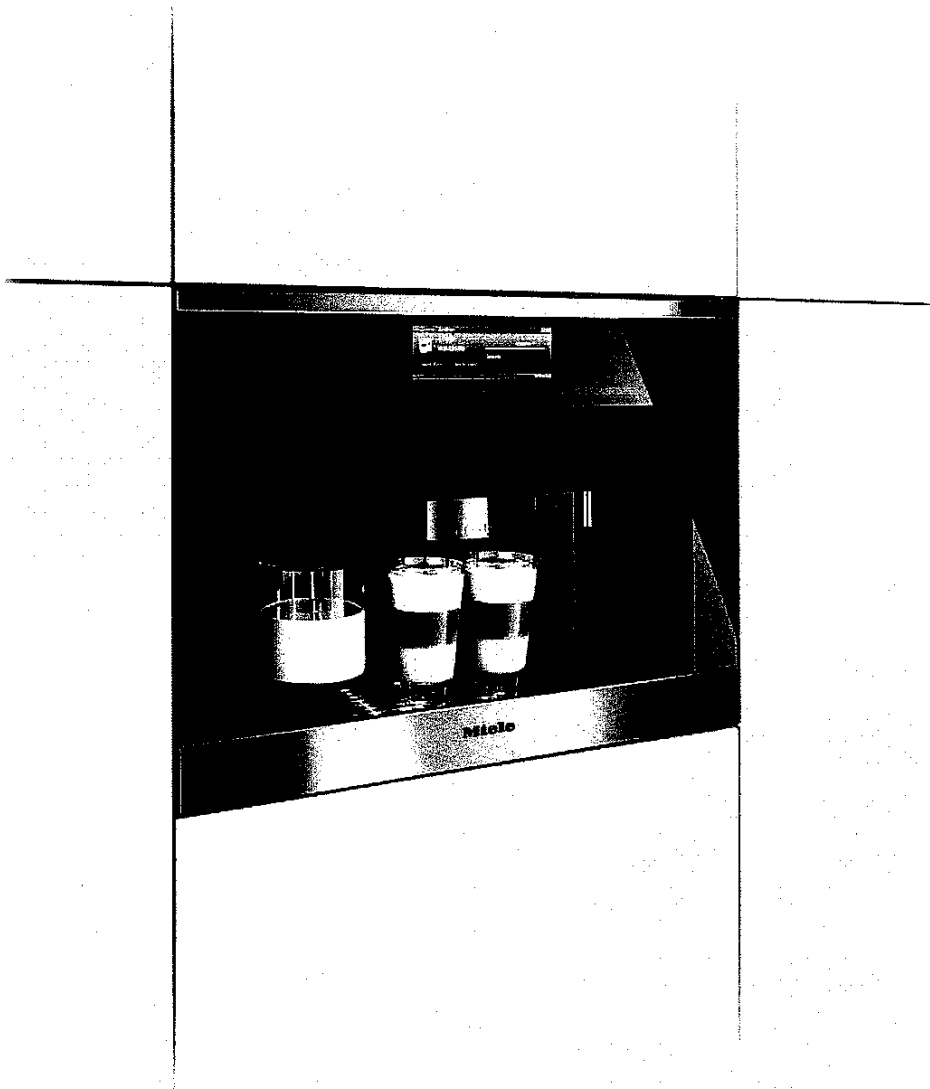

Whole Bean Coffee System
CVA 6800



CVA 6800

Features:

- M Touch innovative and revolutionary controls are both easy to operate and navigate. An intuitive swipe of the screen will quickly lead you to your desired selection
- OneTouch function prepares two hot beverages in succession when pressing the button twice
- OneTouch for Two operation dispenses two cappuccino or latte macchiato drinks, coffee or espresso simultaneously
- CupSensor recognizes the rim of the cup and alters the spout accordingly
- EasyClick Milk System simply clicks the milk reservoir into and out of place at the front of the machine
- Dishwasher-safe milk flask
- Automatic rinsing and cleaning programs
- Up to 10 user profiles
- The coffee pot function allows up to eight cups of coffee to be brewed at one time
- BrilliantLight
- Timer function
- Ground coffee chute for whole bean bypass
- Removable brew unit for easy cleaning
- Removable water tank

SPECIFICATIONS

CVA 6800

Overall Unit Width - Excluding Fascia Dimension	21 ⁷ / ₁₆ " (545 mm)
Overall Unit Height - Excluding Fascia Dimension	17 ¹ / ₂ " (445 mm)
Overall Unit Depth - Excluding Fascia Dimension	18 ¹ / ₈ " (460 mm)
Door Depth When Open	23 ⁷ / ₁₆ " (594 mm)
Overall Fascia Dimensions	23 ⁷ / ₁₆ " (595 mm) W x 17 ¹⁵ / ₁₆ " (455.5 mm) H x 1 ¹³ / ₁₆ " (22 mm) D
Built-In	
Minimum Cabinet Width	22 ¹ / ₁₆ " (560 mm)
Minimum Cabinet Depth	21 ⁵ / ₈ " (550 mm)
Minimum Cabinet Height	17 ¹¹ / ₁₆ " (450 mm)
Minimum Base Support	62 lbs (28,2 kg)
Additional Cut-outs Required	Venting: 19 ¹¹ / ₁₆ " (500 mm) x 1 ⁹ / ₁₆ " (40 mm) or 31" in ² (200 cm ²)
Electrical	
Electrical Requirements	120V, 60Hz, 15A
Power Cord	Molded NEMA 5-15A plug, 6 ft (1.8 m)
Shipping	
Shipping Weight	70 lbs (32 kg)
Shipping Dimensions	23 ⁵ / ₈ " W x 22 ¹ / ₁₆ " H x 26" L
Support	
Call Miele	800.565.6435
Miele Website	www.miele.ca

Pha-1b.

Whole Bean Coffee System
CVA 6800



PRODUCT VIEWS

Isometric View

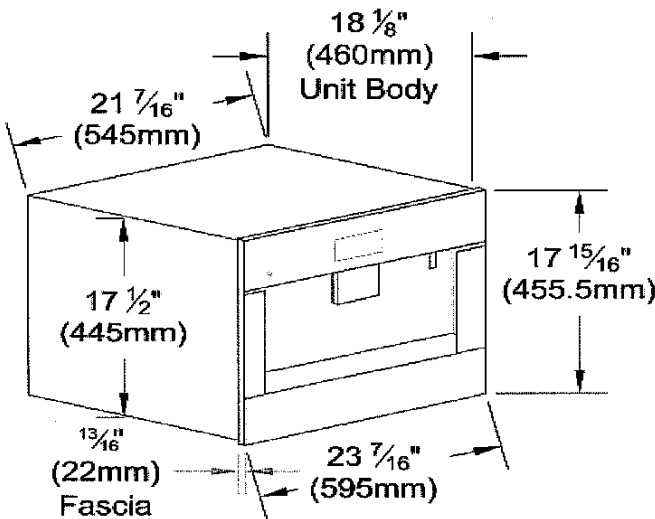

Top View, Door Open

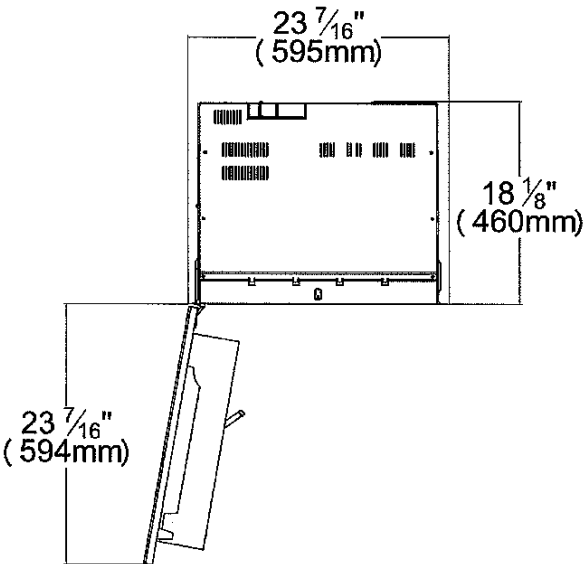

Whole Bean Coffee System
CVA 6800



PRODUCT VIEWS

Front View

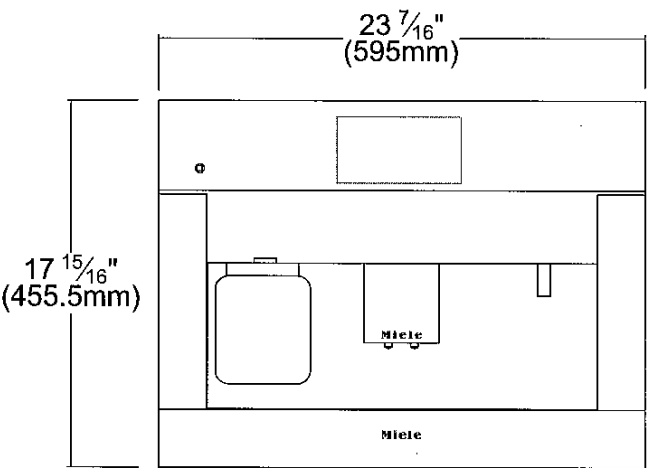

Side View

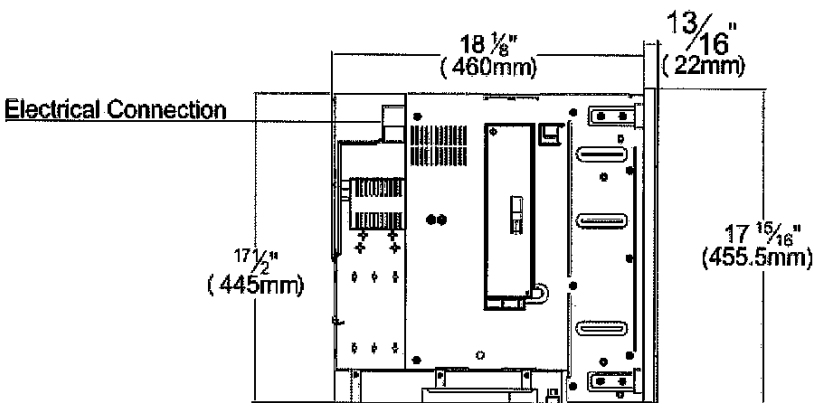

Pha-1b.

Whole Bean Coffee System
CVA 6800



PRODUCT VIEWS

Rear View

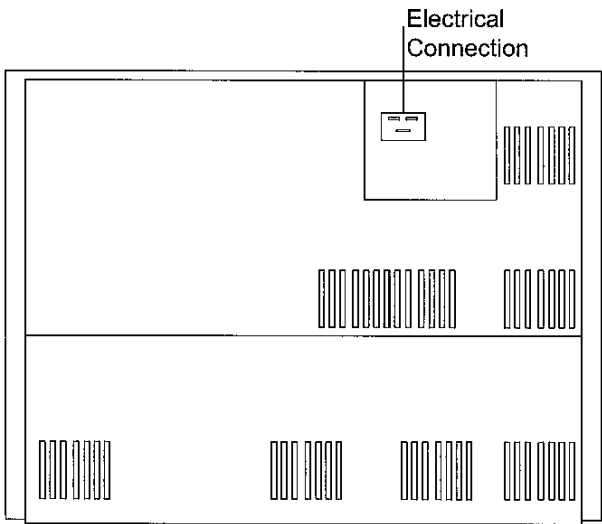

Whole Bean Coffee System
CVA 6800



INSTALLATION SPECIFICATIONS
Cutout Dimensions

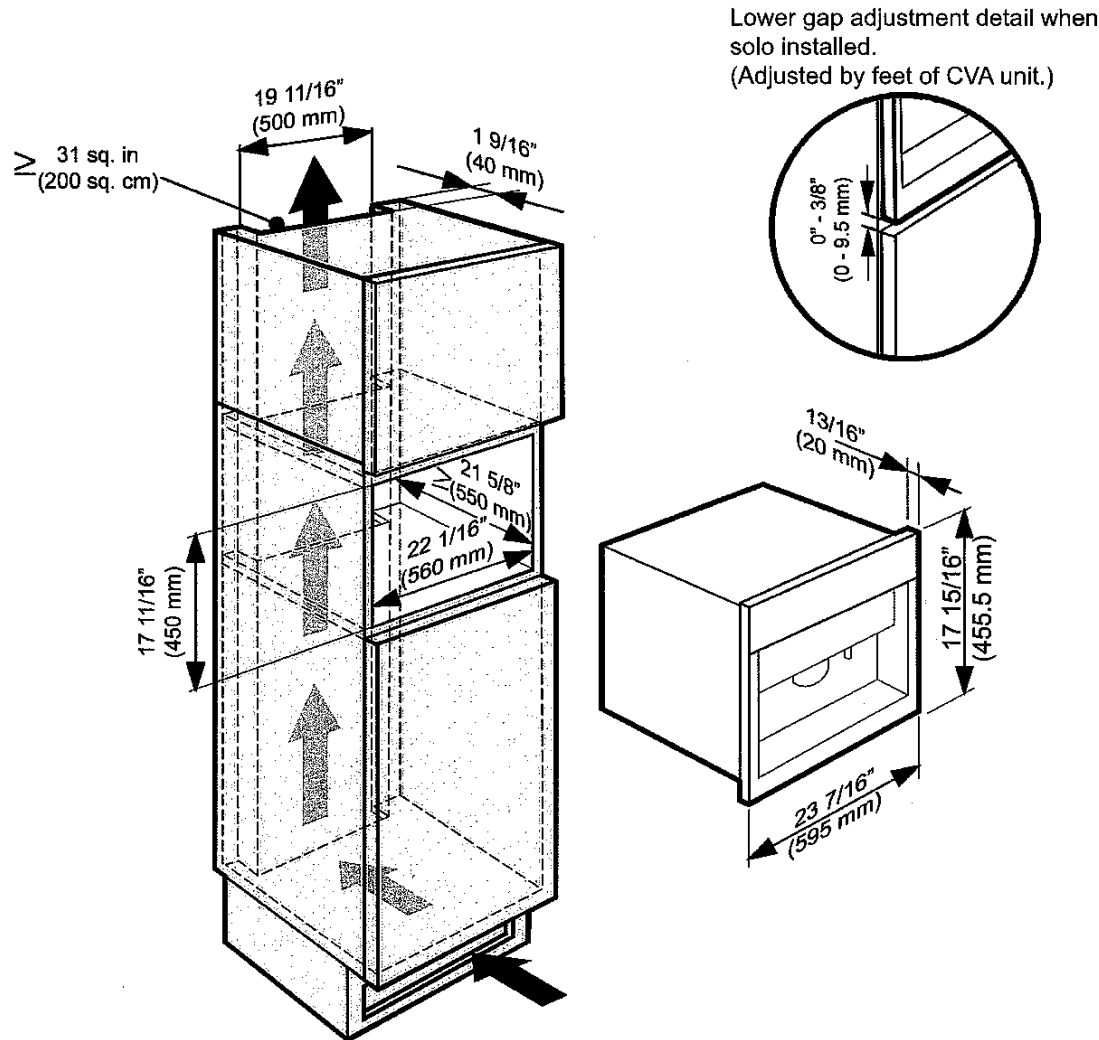

PLEASE NOTE: Condensation water can damage the coffee system or surrounding cabinets. The specified ventilation cross-sections absolutely must be observed.

Whole Bean Coffee System CVA 6800

Miele

INSTALLATION SPECIFICATIONS Ventilation Requirements

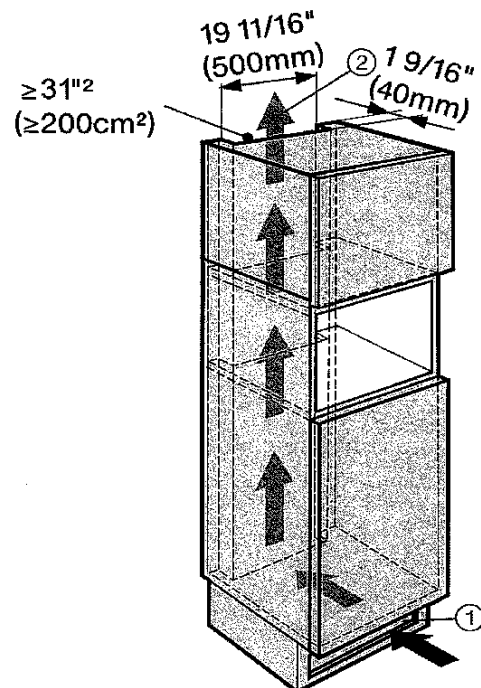

Air intake ① occurs via the plinth at the bottom of the appliance and the air escapes at the top ② at the rear of the surrounding cabinets.

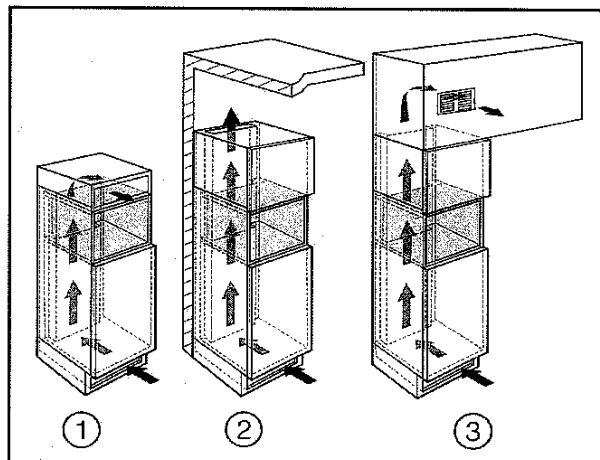

- ① directly above the coffee system with a ventilation grille (free airflow of at least 31 square inches / 200 cm²)
- ② between the surrounding cabinets and the ceiling
- ③ through a suspended ceiling

PLEASE NOTE: Condensation water can damage the coffee system or surrounding cabinets. The specified ventilation cross-sections absolutely must be observed.

Whole Bean Coffee System CVA 6800

Miele

INSTALLATION SPECIFICATIONS With Warming Drawer

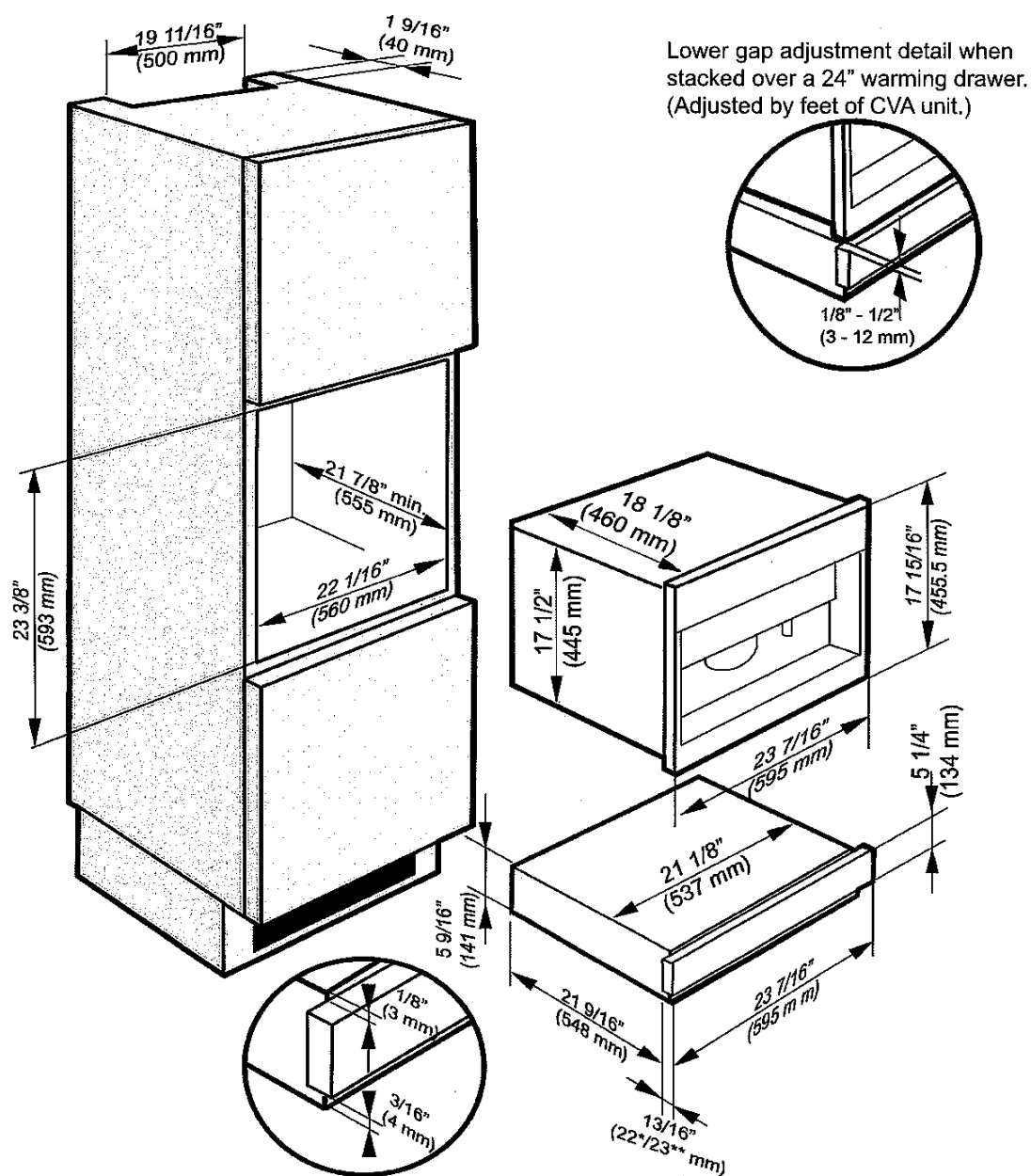

PLEASE NOTE: Condensation water can damage the coffee system or surrounding cabinets. The specified ventilation cross-sections absolutely must be observed.