



CONSTRUCTION SUMMARY

Carrville Investments Ltd. / Loggias of Richvale

Lot/Unit: 1 Phase/Building: 2 Model/Floor Plan: The Avanti (40-2) Elev A

CABINETRY

Inv.4170	1 - LOCATION: KITCHEN	
	SUPPLY A 42" FRIDGE OPENING IN LIEU OF STANDARD 36"	
Line 53311	Note: SEE SPECS ATTACHED FOR APPLIANCE DETAILS	
16Aug17 / 16Aug17		
Inv.4170	1 - LOCATION: KITCHEN	
	SUPPLY (07H) ACCOMMODATE FOR BUILT IN FRIDGE WITH INTERGRATED INSET INSTALLATION	
Line 53313	Note:	
16Aug17 / 16Aug17		

CABINETRY VANITY

ELECTRICAL

Inv.4170	1 - LOCATION: KITCHEN	
	SUPPLY A 20AMP ELECTRICAL OUTLET REQUIRED FOR 42" FRIDGE	
Line 53312	Note:	
16Aug17 / 16Aug17		

FIREPLACE

PLUMBING

lot 1 - cara

42" BUILT-IN FRENCH DOOR REFRIGERATOR/FREEZER

SUB-ZERO

BI-42UFD/S

Senator Loft
Anna /
Art our
Petronko

FEATURES

- LED Lighting for brighter interior
- Maximum capacity in a 42" French door model
- Dual refrigeration keeps food fresher longer
- Air purification system fights spoilage, odors
- Crispers and deli drawers in low-temp, high-humidity zones for optimum freshness
- Microprocessor control assures peak performance
- Two-column shelving for customized storage
- Soft-close deli drawer for meats, cheeses and more
- Water-filtration system reduces contaminants, chlorine taste and odor
- Freshness cards for maximum food preservation
- Rigorously tested in our U.S. manufacturing facilities to ensure decades of use
- Exceptional 24/7 support from Madison, WI-based Customer Care team
- Over-and-under refrigerator/freezer storage
- Magnetic door seal system locks in cold air
- Automatic ice maker with "max ice" feature
- Adjustable shelves for maximum convenience

ACCESSORIES

- Stainless Steel Side Panel
 - White Side Panel
 - Air Purification Cartridge
 - Egg Container
 - Stainless steel kickplate
 - Grilles for 83" or 88" finished height (84" is standard)
 - Side panel mounting kit
- Accessories are available through an authorized Sub-Zero dealer.
For local dealer information, visit subzero-wolf.com/locator.

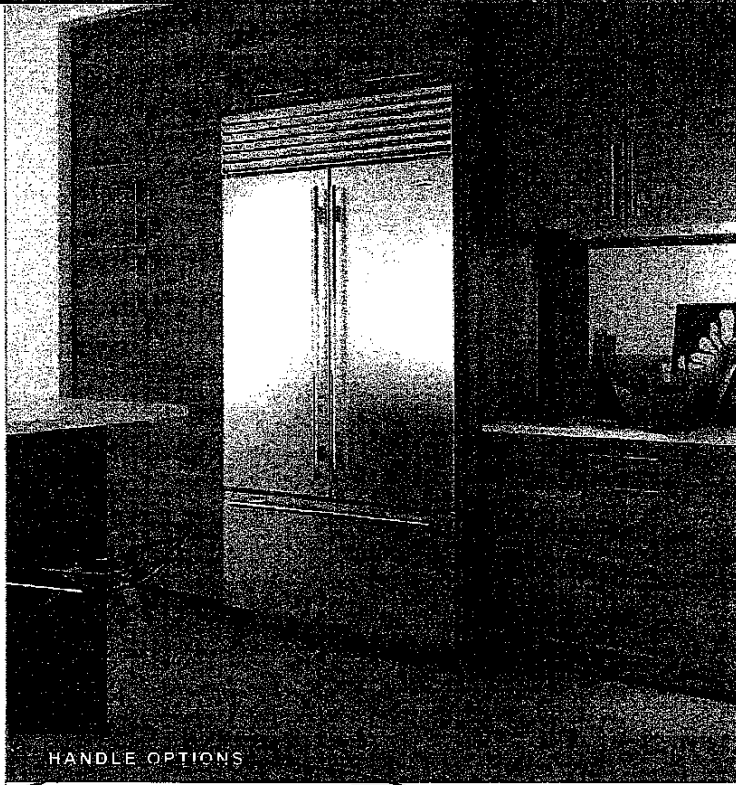

HANDLE OPTIONS

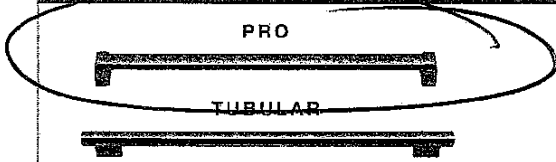

PRODUCT DETAILS

REFRIGERATOR

- 6 Adjustable glass shelves
- 1 Stationary glass shelf
- 1 Deli drawer with dividers
- 2 Crisper drawers
- 4 Adjustable door shelves
- 2 Stationary door shelves
- 2 Adjustable dairy compartments

FREEZER

- Full-extension roll-out freezer drawer
- Two-tier wire storage baskets
- Automatic ice maker

Ice
maker
only

hot/cera

42" BUILT-IN FRENCH DOOR REFRIGERATOR/FREEZER

SUB-ZERO

PRODUCT SPECIFICATIONS

Model	BI-42UFD/S
Dimensions	42"W x 84"H x 24"D
Door Clearance	22 1/4"
Drawer Clearance	23 5/8"
Weight	582 lbs
Refrigerator Capacity	17.9 cu. ft.
Freezer Capacity	6.3 cu. ft.
Electrical Supply	115 VAC, 60 Hz
Electrical Service	15 amp dedicated circuit
Receptacle	3-prong grounding-type

ELECTRICAL

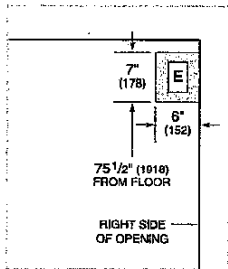

INTERIOR VIEW

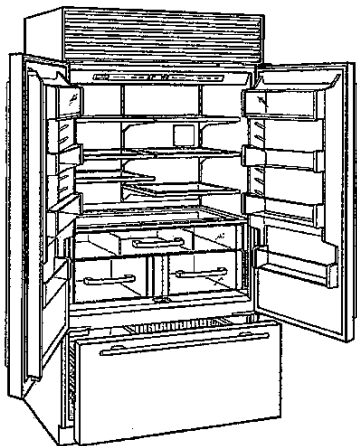

This illustration is intended for interior reference only and may not represent the exterior of the model being specified.

DIMENSIONS

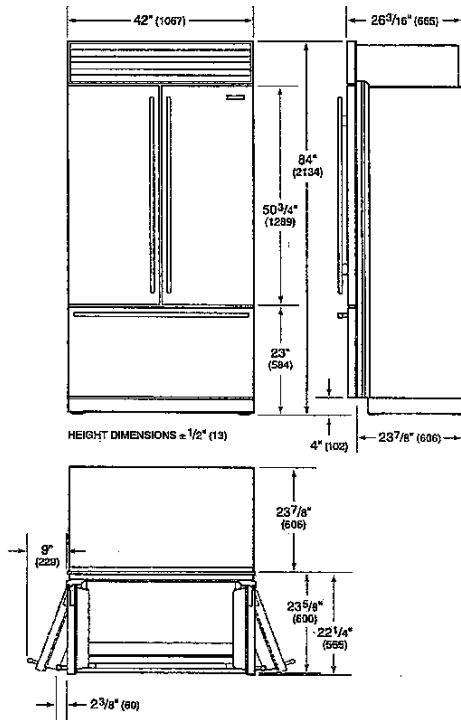

STANDARD INSTALLATION

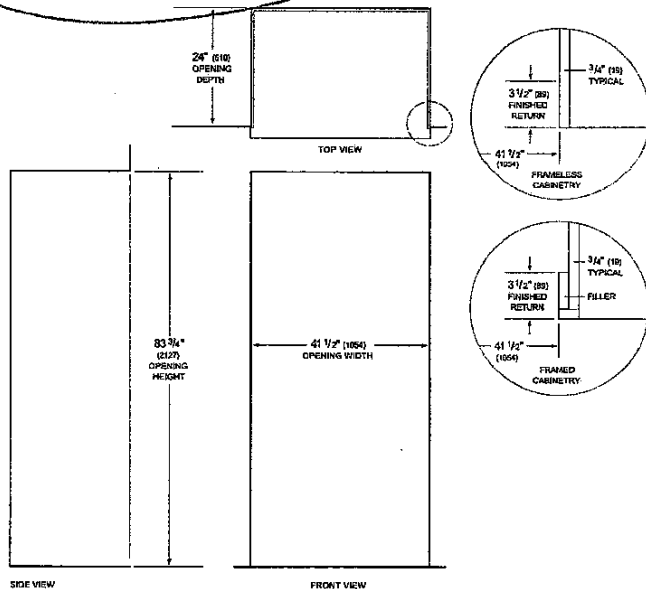

NOTE: 3 1/2" (89mm) finished returns will be visible and should be finished to match cabinetry. Shaded line represents profile of unit.