



CONSTRUCTION SUMMARY

Carrville Investments Ltd. / Loggias of Richvale

Lot/Unit: 20    Phase/Building: 2    Model/Floor Plan: The Ferrara (50-3) Elev B

CABINETRY

Inv.4146	1 - LOCATION: KITCHEN  SUPPLY A 48" STOVE AND HOOD OPENING IN LIEU OF STANDARD 36" SEE SPECS ATTACHED FOR APPLIANCE	
Line 52945	Note:	
20Jun17 / 2Aug17		
Inv.4146	1 - LOCATION: KITCHEN  RELOCATE THE FRIDGE OPENING TO OPPOSITE WALL AS PER SKETCH ATTACHED. RELOCATE A PORTION OF THE BASE/UPPER CABINETS AND STONE COUNTER-TOP TO FORMER FRIDGE LOCATION	
Line 52947	Note: SEE SKETCH ATTACHED FOR LOCATION	
20Jun17 / 2Aug17		
Inv.4146	1 - LOCATION: KITCHEN  CABINETRY - KITCHEN - UPGRADE CABINETRY FINISH TO GLAZE	
Line 52949	Note: MADRID PAINT CANOLI CHOCOLATE GLAZE	
20Jun17 / 2Aug17		
Inv.4146	1 - LOCATION: POWDER ROOM  CABINETRY - POWDER ROOM - UPGRADE CABINETRY FINISH TO GLAZE	
Line 52950	Note: MADRID PAINT CANOLI CHOCOLATE GLAZE	
20Jun17 / 2Aug17		
Inv.4146	1 - LOCATION: KITCHEN  SUPPLY AND INSTALL STACKED UPPER CABINETS WITH MULLION GLASS DOORS AND MATCHING INTERIOR. NOTE: CHOCOLATE GLAZE FINISH	
Line 52951	Note: SEE FRENDEL KITCHEN SKETCH ATTACHED	
20Jun17 / 2Aug17		
Inv.4146	1 - LOCATION: KITCHEN  SUPPLY AND INSTALL FASCIA PAN AND LARGE CROWN MOULDING THROUGHOUT KITCHEN. NOTE: CHOCOLATE GLAZE FINISH	
Line 52952	Note: SEE FRENDEL SKETCH ATTACHED	
20Jun17 / 2Aug17		
Inv.4146	1 - LOCATION: KITCHEN  SUPPLY AND INSTALL 48" PREMIER HOOD COVER FOR INSERT / WITH TWO (2) CORBELS. NO ARCH - STRAIGHT	
Line 52953	Note: HOOD INSERT BEING SUPPLIED AND INSTALLED BY PURCHASER AFTER CLOSING.	
20Jun17 / 2Aug17		
Inv.4146	1 - LOCATION: KITCHEN ISLAND  SUPPLY AND INSTALL BASEBOARD MOULDING/FLUSH KICK AT TWO (2) SIDES OF ISLAND	
Line 52955	Note: SEE FRENDEL SKETCH ATTACHED	
20Jun17 / 2Aug17		



CONSTRUCTION SUMMARY

Carrville Investments Ltd. / Loggias of Richvale

Lot/Unit: 20    Phase/Building: 2    Model/Floor Plan: The Ferrara (50-3) Elev B

Inv.4146	1 - LOCATION: KITCHEN  SUPPLY ONLY FACE PANEL FOR FRIDGE - FLUSH BUILT IN WITH DECORATIVE PANEL HANDLES TO BE SUPPLIED AND INSTALLED BY PURCHASER  Line 52956      Note:  20Jun17 / 2Aug17	
Inv.4146	1 - LOCATION: KITCHEN  SUPPLY ONLY FACE PANEL FOR DISHWASHER - BUILT IN AND DECORATIVE PANEL HANDLES TO BE SUPPLIED AND INSTALLED BY PURCHASER  Line 52957      Note:  20Jun17 / 2Aug17	
Inv.4146	1 - LOCATION: MASTER ENSUITE  CABINETRY - MASTER ENSUITE - HIS - HERS - UPGRADE CABINETRY Line 52974      Note: SIENNA MAPLE SOAPSTONE CL  20Jun17 / 2Aug17	
Inv.4146	1 - NOTES FOR REVISED KITCHEN SELECTION / LAYOUT CHANGES  CHOCOLATE GLAZE SELECTION REQUIRES MINIMUM 12 WEEK PRODUCTION. CLIENT ACKNOWLEDGES AND ACCEPTS THAT KITCHEN MAY BE DELAYED IF UPGRADES ARE NOT PROCESSED ACCORDING TO CONSTRUCTION TIME LINE  Line 53002      Note:  20Jun17 / 2Aug17	
Inv.4146	1 - NOTES TO KITCHEN SELECTION / LAYOUT CHANGES  SUPPLY OPTIONAL FLIP UP DOOR ABOVE FRIDGE AS PER FRENDEL SKETCH ATTACHED  Line 53003      Note:  20Jun17 / 2Aug17	
Inv.4146	1 - NOTES TO KITCHEN SELECTION / LAYOUT CHANGES  RANGE IS BEING CENTRED AS PER REVISED SKETCH EXTENDING KITCHEN INTO SERVERY TO ACCOMMODATE THIS CHANGE  PANTRY TO REMAIN AS PER PLAN Line 53004      Note:  20Jun17 / 2Aug17	
Inv.4146	1 - NOTES TO KITCHEN SELECTIONS / CHANGES TO LAYOUT  18" FREEZER (LEFT HINGE), 30" FRIDGE (RIGHT HINGE), 18" WINE COOLER (RIGHT HINGE) AND 18" PANTRY AT END OF APPLIANCE RUN Line 53005      Note: SEE REVISED KITCHEN SKETCH FOR APPLIANCE INSTALL  20Jun17 / 2Aug17	
Inv.4146	1 - LOCATION: ISLAND BACK SIDE  SUPPLY AND INSTALL OPEN SHELVES TO ENTIRE BACK OF ISLAND IN LIEU OF STANDARD DOORS Line 53006      Note:  20Jun17 / 2Aug17	



CONSTRUCTION SUMMARY

Carrville Investments Ltd. / Loggias of Richvale

Lot/Unit: 20    Phase/Building: 2    Model/Floor Plan: The Ferrara (50-3) Elev B

CABINETRY HARDWARE

Inv.4146	1 - LOCATION: KITCHEN ISLAND	
	BASE WASTE / RECYCLE CENTER PULL OUT DOOR - ONLY AVAILABLE IN 45 CM CABINET (2) 35L BINS - PRICE IS PER UNIT	
Line 52954	Note:	
20Jun17 / 2Aug17		
Inv.4146	1 - LOCATION: KITCHEN	
	KITCHEN - CABINET HARDWARE - UPGRADE 2 - DISPLAY BOARD	
Line 52972	Note: 131 KNOB	
20Jun17 / 2Aug17		
Inv.4146	1 - LOCATION: MASTER ENSUITE (HIS AND HER SIDE)	
	VANITY - CABINET HARDWARE - UPGRADE 2 - DISPLAY BOARD	
Line 52973	Note: 12843 HANDLE	
20Jun17 / 2Aug17		

CABINETRY MICROWAVE OVEN STOVE COOKTOP

Inv.4146	1 - LOCATION: KITCHEN	
	FLUSH MOUNT BUILT IN DOUBLE APPLIANCE CABINET WITH DRAWER BELOW TO ACCOMODATE A BUILT IN STEAM OVEN AND MICROWAVE OVEN. LOCATE AT END OF CABINET RUN TOWARD SERVERY	
Line 52948	Note: SEE SKETCH FOR LOCATION	
20Jun17 / 2Aug17		

CABINETRY VANITY

Inv.4146	2 - LOCATION: MASTER ENSUITE (HER SIDE)	
	VANITY BANK OF DRAWERS (60 CM TO 90 CM) - SEE NOTE L - UPGRADE 2	
Line 52960	Note: ONE BANK ON EITHER SIDE OF SINK	
20Jun17 / 2Aug17		
Inv.4146	2 - LOCATION: TWIN BATH	
	VANITY BANK OF DRAWERS (60 CM TO 90 CM) - SEE NOTE L - UPGRADE 1	
Line 52961	Note: ONE BANK ON EITHER SIDE OF SINK	
20Jun17 / 2Aug17		

COUNTER TOP - GRANITE

Inv.4146	1 - LOCATION: KITCHEN	
	COUNTER TOP - GROUP 5 - KITCHEN - 3CM COUNTER TOP - WITH STANDARD EDGE PROFILE	
Line 52962	Note: CAESARSTONE 5141 FROSTY CARINA	
20Jun17 / 2Aug17		
Inv.4146	1 - LOCATION: KITCHEN ISLAND	
	SUPPLY AND INSTALL - COUNTER TOP WATER FALL GABLE - MITRE SEAM - GROUP 5 2CM UP TO 36 INCHES	
Line 52963	Note:	
20Jun17 / 2Aug17		



CONSTRUCTION SUMMARY

Carrville Investments Ltd. / Loggias of Richvale

Lot/Unit: 20    Phase/Building: 2    Model/Floor Plan: The Ferrara (50-3) Elev B

Inv.4146	1 - LOCATION: LAUNDRY ROOM  COUNTER TOP - GROUP 2 - LAUNDRY ROOM - 2CM COUNTER TOP - WITH STANDARD EDGE PROFILE  Line 52965      Note: CAESARSTONE 6141 OCEAN FOAM  20Jun17 / 2Aug17	
Inv.4146	1 - LOCATION: POWDER ROOM  COUNTER TOP - GROUP 5 - POWDER ROOM - 2CM COUNTER TOP - WITH STANDARD EDGE PROFILE  Line 52966      Note: CAESARSTONE 5141 FROSTY CARINA  20Jun17 / 2Aug17	
Inv.4146	1 - LOCATION: MASTER ENSUITE (HER SIDE)  COUNTER TOP - GROUP 5 - HER ENSUITE - 2CM COUNTER TOP - WITH STANDARD EDGE PROFILE  Line 52967      Note: CAESARSTONE 5031 STATUARIO MAXIMUS  20Jun17 / 2Aug17	
Inv.4146	1 - LOCATION: MASTER ENSUITE (HIS SIDE)  COUNTER TOP - GROUP 5 - HIS ENSUITE - 2CM COUNTER TOP - WITH STANDARD EDGE PROFILE  Line 52968      Note: CAESARSTONE 5031 STATUARIO MAXIMUS  20Jun17 / 2Aug17	
Inv.4146	1 - LOCATION: ENSUITE 4  COUNTER TOP - GROUP 5 - ENSUITE 4 - 2CM COUNTER TOP - WITH STANDARD EDGE PROFILE  Line 52969      Note: CAESARSTONE 5131 CALACUTTA NUVO  20Jun17 / 2Aug17	
Inv.4146	1 - LOCATION: ENSUITE 5  COUNTER TOP - GROUP 5 - ENSUITE 5 - 2CM COUNTER TOP - WITH STANDARD EDGE PROFILE  Line 52970      Note: CAESARSTONE 5131 CALACUTTA NUVO  20Jun17 / 2Aug17	
Inv.4146	1 - LOCATION: TWIN BATH  COUNTER TOP - GROUP 5 - TWIN BATHROOM - 2CM COUNTER TOP - WITH STANDARD EDGE PROFILE  Line 52971      Note: CAESARSTONE 5131 CALACUTTA NUVO  20Jun17 / 2Aug17	
Inv.4146	1 - LOCATION: MASTER ENSUITE  SUPPLY AND INSTALL GROUP 5 CAESARSTONE TO MAKE-UP COUNTER ADDED TO REVISED MASTER ENSUITE. STANDARD EDGE PROFILE  Line 53201      Note: 5031 STATUARIO MAXIMUS  20Jun17 / 2Aug17	

COUNTER TOP - KITCHEN



CONSTRUCTION SUMMARY

Carrville Investments Ltd. / Loggias of Richvale

Lot/Unit: 20    Phase/Building: 2    Model/Floor Plan: The Ferrara (50-3) Elev B

Inv.4146	1 - LOCATION: KITCHEN ISLAND	
	SUPPLY AND INSTALL GRANITE CUTOUT AND POLISHED EDGE FOR UNDERMOUNT SINK	
Line 52828	Note: SINGLE HOLE FAUCET AND UNDERMOUNT SINK PURCHASED SEPARATELY.	
20Jun17 / 2Aug17		

ELECTRICAL

Inv.4146	8 - LOCATION: GREAT ROOM	
	TO LOCATE EIGHT STANDARD POTLIGHTS AS PER SKETCH ATTACHED	
	DO NOT DELETE THE STANDARD CEILING FIXTURE IN THE MIDDLE OF THE ROOM.	
Line 52815	Note: A SEPARATE SWITCH TO OPERATE THE POTLIGHTS HAS BEEN PURCHASED	
20Jun17 / 2Aug17		

Inv.4146	1 - LOCATION: GREAT ROOM	
	SUPPLY AND INSTALL A SEPARATE SWITCH TO OPERATE THE POTLIGHTS IN THE GREAT ROOM	
Line 52816	Note: TO BE LOCATED ON SAME GANG BOX WITH STANDARD GREAT ROOM LIGHT	
20Jun17 / 2Aug17		

Inv.4146	4 - LOCATION: DINING ROOM	
	TO LOCATE FOUR STANDARD POTLIGHTS AS PER SKETCH ATTACHED	
	DO NOT DELETE THE STANDARD CEILING FIXTURE IN THE MIDDLE OF THE ROOM.	
Line 52817	Note: A SEPARATE SWITCH TO OPERATE THESE POTLIGHTS HAS BEEN PURCHASED	
20Jun17 / 2Aug17		

Inv.4146	1 - LOCATION: DINING ROOM	
	SUPPLY AND INSTALL A SEPARATE SWITCH TO OPERATE THE POTLIGHTS IN THE DINING ROOM	
Line 52818	Note: TO BE LOCATED ON SAME GANG BOX WITH THE STANDARD DINING ROOM LIGHT	
20Jun17 / 2Aug17		

Inv.4146	4 - LOCATION: DEN	
	TO LOCATE FOUR STANDARD POTLIGHTS AS PER SKETCH ATTACHED	
	DO NOT DELETE THE STANDARD CEILING FIXTURE IN THE MIDDLE OF THE ROOM.	
Line 52819	Note: A SEPARATE SWITCH TO OPERATE THESE POTLIGHTS HAS BEEN PURCHASED	
20Jun17 / 2Aug17		

Inv.4146	1 - LOCATION: DEN	
	SUPPLY AND INSTALL A SEPARATE SWITCH TO OPERATE THE POTLIGHTS IN THE DEN	
Line 52820	Note: TO BE LOCATED ON SAME GANG BOX WITH STANDARD DEN LIGHT	
20Jun17 / 2Aug17		



CONSTRUCTION SUMMARY

Carrville Investments Ltd. / Loggias of Richvale

Lot/Unit: 20    Phase/Building: 2    Model/Floor Plan: The Ferrara (50-3) Elev B

Inv.4146	4 - LOCATION: LIVING ROOM  TO LOCATE FOUR STANDARD POTLIGHTS AS PER SKETCH ATTACHED  DO NOT DELETE THE STANDARD CEILING FIXTURE IN THE MIDDLE OF THE ROOM.  Line 52821    Note:	
20Jun17 / 2Aug17		
Inv.4146	4 - LOCATION: LIVING ROOM  TO LOCATE FOUR STANDARD POTLIGHTS AS PER SKETCH ATTACHED  USE THE STANDARD SWITCHED OUTLET TO OPERATE THE POTLGHTS  Line 52822    Note: A SEPARATE SWITCH FOR THE POTLIGHTS HAS NOT BEEN PURCHASED	
20Jun17 / 2Aug17		
Inv.4146	1 - LOCATION: KITCHEN  SUPPLY A TOTAL OF THREE (3) DEDICATED 15AMP ELECTRICAL OUTLETS TO ACCOMODATE SUBZERO UNITS AS FOLLOWS TO BE PLACED SIDE BY SIDE. 30" FRIDGE, 18" FREEZER AND 18" COOLER ONE OUTLET FOR EACH UNIT  Line 52942    Note: SEE SKETCH FOR LOCATION	
20Jun17 / 2Aug17		
Inv.4146	1 - LOCATION: KITCHEN  SUPPLY A 20AMP ELECTRICAL OUTLET TO ACCOMODATE A BUILT IN WALL STEAM OVEN. SPECS ATTACHED  Line 52943    Note: SEE SKETCH FOR LOCATION	
20Jun17 / 2Aug17		
Inv.4146	1 - LOCATION: KITCHEN  SUPPLY A 15AMP ELECTRICAL OUTLET TO ACCOMODATE A BUILT IN WALL MICROWAVE OVEN. SEE SPECS ATTACHED  Line 52944    Note: LOCATION AS PER SKETCH ATTACHED	
20Jun17 / 2Aug17		

MISCELLANEOUS

Inv.4146	1 - LOCATION: MASTER ENSUITE  RECONFIGURE ENTIRE MASTER ENSUITE AS PER REVISED SKETCH ATTACHED. ITEMIZED DETAILS ON SEPARATE PE  Line 53182    Note:	
20Jun17 / 2Aug17		
Inv.4146	1 - LOCATION: DINING/LIVING ROOM  DELETE THE FULL WALLS ON EITHER SIDE OF THE 2 SIDED FIREPLACE AND CREATED TRIMMED OPENINGS. HEADER/ARCHWAY TO REMAIN TO ACOMMODATE VENTILATION FOR FIREPLACE  Line 53183    Note: SEE ITEMIZED DETAILS ON SEPARATE PE	
20Jun17 / 2Aug17		



CONSTRUCTION SUMMARY

Carrville Investments Ltd. / Loggias of Richvale

Lot/Unit: 20    Phase/Building: 2    Model/Floor Plan: The Ferrara (50-3) Elev B

Inv.4167	1 - LOCATION: YOGA ROOM  CONVERT YOGA ROOM TO WALK IN CLOSET FOR MASTER BEDROOM. DELETE FRENCH DOORS AND RELOCATE A SINGLE DOOR OPENING FROM MASTER BEDROOM. SUPPLY AND INSTALL STANDARD HEIGHT INTERIOR DOOR.  Line 53187 Note: PAYMENT HAS BEEN APPLIED ON PE # 4146-7 - ITEM #71  2Aug17 / 2Aug17	
Inv.4167	1 - LOCATION: MASTER ENSUITE  RECONFIGURE THE MASTER ENSUITE TO ACCOMMODATE THE FOLLOWING CHANGES: A) DELETE THE HIS AND HERS WALK IN CLOSETS B) DELETE HIS TOILET AND HIS VANITY C) DELETE THE COFFERED CEILING AND HALLWAY  Line 53188 Note: PAYMENT HAS BEEN APPLIED ON PE # 4146-7 - ITEM #71  2Aug17 / 2Aug17	
Inv.4167	1 - LOCATION: MASTER ENSUITE  CONTINUED RECONFIGURATION D) DELETE HER VANITY E) DELETE THE WALLS AROUND HER TOILET F) LEAVE THE FREE STANDING TUB  Line 53189 Note: PAYMENT HAS BEEN APPLIED ON PE # 4146-7 - ITEM #71  2Aug17 / 2Aug17	
Inv.4167	1 - LOCATION: MASTER ENSUITE  CONTINUED RECONFIGURATION G) SUPPLY A CONTINOUS DOUBLE VANITY WITH MAKE-UP COUNTER AS PER SKETCH ATTACHED. FRENDEL TO PROVIDE FINAL SKETCH AND MEASUREMENTS  Line 53190 Note: PAYMENT HAS BEEN APPLIED ON PE # 4146-7 - ITEM #71  2Aug17 / 2Aug17	
Inv.4167	1 - LOCATION: MASTER ENSUITE  CONTINUED RECONFIGURATION H) SUPPLY AND INSTALL INCREASED SHOWER STALL TO BE LOCATED BETWEEN THE WINDOWS AS PER SKETCH ATTACHED. I) SUPPLY A FULL WALL BETWEEN THE TOILET AND SHOWER TO ACCOMODATE PLUMBING FIXTURES.  Line 53191 Note: PAYMENT HAS BEEN APPLIED ON PE # 4146-7 - ITEM #71  2Aug17 / 2Aug17	
Inv.4167	1 - LOCATION: MASTER ENSUITE  CONTINUED RECONFIGURATION J) FRAMELESS GLASS TO SIDE FACING VANITIES AND TO FRONT K) SHOWER DOOR TO BE AT FRONT L) CREATE NEW ENTRY WITH DOOR INTO MASTER TO FACE FRONT OF SHOWER  Line 53192 Note: PAYMENT HAS BEEN APPLIED ON PE # 4146-7 - ITEM #71  2Aug17 / 2Aug17	



CONSTRUCTION SUMMARY

Carrville Investments Ltd. / Loggias of Richvale

Lot/Unit: 20    Phase/Building: 2    Model/Floor Plan: The Ferrara (50-3) Elev B

Inv.4167	1 - LOCATION: MASTER ENSUITE  NEW SHOWER DIMENSIONS TO BE DETERMINED ONCE ARCHITECTURAL DRAWINGS HAVE BEEN FINALIZED  Line 53193      Note: PAYMENT HAS BEEN APPLIED ON PE # 4146-7 - ITEM #71  2Aug17 / 2Aug17	
Inv.4167	1 - LOCATION: MASTER ENSUITE  SEE COLOUR CHART FOR FINISHING SELECTIONS  Line 53194      Note:  2Aug17 / 2Aug17	
Inv.4167	1 - LOCATION: LIVING/DINING ROOM  DELETE THE FULL WALLS ON EITHER SIDE OF 2 SIDED FIREPLACE AND SUPPLY MAXIMUM WIDTH TRIMMED OPENINGS. OPENINGS TO BE SAME SIZE. NIB WALLS MAY REMAIN DUE HVAC REQUIREMENTS.  Line 53195      Note: PAYMENT HAS BEEN APPLIED ON PE # 4146-7 - ITEM #72  2Aug17 / 2Aug17	
Inv.4167	1 - LOCATION: LIVING/DINING ROOM  VENTILATION FOR 2 SIDED FIREPLACE TO BE RE-ROUTED IN HEADER/ARCHWAY ABOVE. BULKHEAD MAY BE PRESENT  Line 53196      Note:  2Aug17 / 2Aug17	
Inv.4167	1 - LOCATION: POWER ROOM  ACCOMODATIONS REQUIRED FOR WALL HUNG TOILET IN POWDER ROOM  Line 53197      Note: PAYMENT HAS BEEN APPLIED ON PE # 4146-1 - ITEM #9  2Aug17 / 2Aug17	
Inv.4167	1 - LOCATION: TWIN BATH AND ENSUITE 5  FRAMELESS GLASS FRONT PORTION SHOWER STALLS IN LIEU OF TUBS IN TWIN BATH AND ENSUITE 5. FRAMELESS GLASS DOOR AND STANDARD POTLIGHT IN EACH SHOWER STALL. SIDE WALLS TO REMAIN AS PER PLAN  Line 53198      Note: PAYMENT HAS BEEN APPLIED ON PE # 4146-2 - ITEMS #19 AND 20  2Aug17 / 2Aug17	
Inv.4167	1 - *****STRUCTURAL *****  SEND TO SITE ASAP TO ACCOMODATE THESE STRUCTURAL CHANGES.  Line 53199      Note:  2Aug17 / 2Aug17	

PLUMBING

Inv.4146	1 - LOCATION: POWDER ROOM  SUPPLY AND INSTALL TOTO WALL HUNG TOILET MODEL #CWT418MFG-1 IN LIEU OF STANDARD FOR POWDER ROOM ONLY  Line 52823      Note: SEE SPEC ATTACHED  20Jun17 / 2Aug17	
----------	--	--





CONSTRUCTION SUMMARY

Carrville Investments Ltd. / Loggias of Richvale

Lot/Unit: 20    Phase/Building: 2    Model/Floor Plan: The Ferrara (50-3) Elev B

Inv.4146	6 - LOCATION: ALL BATHROOMS  SUPPLY AND INSTALL CONTRAC CATENA RECTANGULAR UNDERMOUNT VANITY SINK MODEL #4210CIY (17X14)  Line 52824      Note:  20Jun17 / 2Aug17	
Inv.4146	1 - LOCATION: KITCHEN  SUPPLY AND INSTALL UPGRADE GROHE FAUCET TO MAIN KITCHEN SINK MODEL # K7 - SEMI PRO CHROME FINISH (32951000)  Line 52825      Note:  20Jun17 / 2Aug17	
Inv.4146	1 - LOCATION: KITCHEN ISLAND  SUPPLY AND INSTALL UPGRADE FAUCET TO PREP SINK IN ISLAND GROHE MODEL K7 CHROME FINISH (32380000)  Line 52826      Note:  20Jun17 / 2Aug17	
Inv.4146	1 - LOCATION: KITCHEN ISLAND  SUPPLY AND INSTALL OPTIONAL PREP SINK (SINGLE BOWL) TO ISLAND AS FRANKE MODEL # TECHNA TCX110-18 UNDERMOUNT  Line 52827      Note:  20Jun17 / 2Aug17	
Inv.4146	1 - LOCATION: KITCHEN  SUPPLY AND INSTALL POT FILLER BEHIND STOVE - WALL MOUNT GROHE REAL STEEL MODEL # CONTEMPORARY 31075SDO  Line 52829      Note: SEE SPEC ATTACHED  20Jun17 / 2Aug17	
Inv.4146	4 - LOCATION: ALL SHOWER STALLS  SUPPLY AND INSTALL SHOWER DRAIN TROUGH STYLE DRAINS ACO 36 - LINEAR DRAINS COMPLETE WITH GRID  Line 52830      Note:  20Jun17 / 2Aug17	
Inv.4146	1 - LOCATION: MASTER ENSUITE  UPGRADE ENSUITE SHOWER LEAVING STANDARD HEAD AND ADD 8" RAIN HEAD - UPGRADE COMPONENTS CHROME. GROHE AGIRA SHOWER OPTION 2  Line 52831      Note: AS PER SPECS ATTACHED  20Jun17 / 2Aug17	
Inv.4146	1 - LOCATION: TWIN BATH  SUPPLY AND INSTALL FRAMELESS SHOWER ENCLOSURE IN LIEU OF TUB. INCLUDES STANDARD DOOR. STANDARD POT LIGHT, STANDARD FLOOR AND WALL TILES.  Line 52832      Note:  20Jun17 / 2Aug17	



CONSTRUCTION SUMMARY

Carrville Investments Ltd. / Loggias of Richvale

Lot/Unit: 20    Phase/Building: 2    Model/Floor Plan: The Ferrara (50-3) Elev B

Inv.4146	1 - LOCATION: ENSUITE 5  SUPPLY AND INSTALL FRAMELESS SHOWER ENCLOSURE IN LIEU OF TUB. INCLUDES STANDARD DOOR. STANDARD POT LIGHT, STANDARD FLOOR AND WALL TILES.	
Line 52833	Note:	
20Jun17 / 2Aug17		
Inv.4146	1 - LOCATION: KITCHEN  SUPPLY AND INSTALL WATERLINE ROUGH-IN TO THE FREEZER LOCATION (NO HOOK UP)	
Line 52946	Note: LOCATION AS PER SKETCH ATTACHED.	
20Jun17 / 2Aug17		
Inv.4167	1 - LOCATION: MASTER ENSUITE  PLEASE NOTE THAT A RAIN HEAD SHOWER 8" IS BEING ADDED IN ADDITION TO THE STANDARD SHOWER HEAD. PLEASE MAKE PLUMBING PROVISIONS FOR THIS CHANGE.	
Line 53200	Note: PAYMENT HAS BEEN APPLIED ON PE # 4146-2 - ITEM #17	
2Aug17 / 2Aug17		

TILE

Inv.4146	1 - LOCATION: KITCHEN  BACKSPLASH - KITCHEN - CAESARSTONE KITCHEN BACKSPLASH - ABOVE COUNTER AND BEHIND STOVE ONLY	
Line 52964	Note: CAESARSTONE 5141 FROSTY CARINA	
20Jun17 / 2Aug17		
Inv.4146	1 - LOCATION: KITCHEN/BREAKFAST/SERVERY  FLOOR TILE - UPGRADE 6 - KITCHEN - BREAKFAST - SERVERY - FLOOR	
Line 52975	Note: 24" X 24" MARMI EVOLUZIONE TAFU LIGHT GREY (MZ.ME.TFU.2424.PL)	
20Jun17 / 2Aug17		
Inv.4146	1 - LOCATION: SIDE HALL AT POWDER ROOM/GARAGE ENTRANCE  FLOOR TILE - UPGRADE 6 - SIDE ENTRANCE - GARAGE - FLOOR	
Line 52976	Note: 24" X 24" MARMI EVOLUZIONE TAFU LIGHT GREY (MZ.ME.TFU.2424.PL)	
20Jun17 / 2Aug17		
Inv.4146	1 - LOCATION: POWDER ROOM  FLOOR TILE - UPGRADE 6 - POWDER ROOM - FLOOR	
Line 52977	Note: 24" X 24" MARMI EVOLUZIONE TAFU LIGHT GREY (MZ.ME.TFU.2424.PL)	
20Jun17 / 2Aug17		
Inv.4146	1 - LOCATION: FOYER  FLOOR TILE - UPGRADE 6 - VESTIBULE - WALK IN CLOSET- FLOOR	
Line 52978	Note: 24" X 24" MARMI EVOLUZIONE TAFU LIGHT GREY (MZ.ME.TFU.2424.PL)	
20Jun17 / 2Aug17		



CONSTRUCTION SUMMARY

Carrville Investments Ltd. / Loggias of Richvale

Lot/Unit: 20    Phase/Building: 2    Model/Floor Plan: The Ferrara (50-3) Elev B

Inv.4146	1 - LOCATION: ENSUITE 4  FLOOR TILE - UPGRADE 4 - ENSUITE 4- FLOOR STANDARD STACKED INSTALL - SEE SKETCH FOR TILE DIRECTION  Line 52979    Note: 12" X 24" UNICOLOUR POLISHED LIGHT GREY (BY.UN.LGR.1224.PL)  20Jun17 / 2Aug17	
Inv.4146	1 - LOCATION: ENSUITE 5  FLOOR TILE - UPGRADE 4 - ENSUITE 5 - FLOOR STANDARD STACKED INSTALL - SEE SKETCH FOR TILE DIRECTION  Line 52980    Note: 12" X 24" UNICOLOUR POLISHED LIGHT GREY (BY.UN.LGR.1224.PL)  20Jun17 / 2Aug17	
Inv.4146	1 - LOCATION: TWIN BATH  FLOOR TILE - UPGRADE 4 - TWIN BATH - FLOOR STANDARD STACKED INSTALL - SEE SKETCH FOR TILE DIRECTION  Line 52981    Note: 12" X 24" UNICOLOUR POLISHED LIGHT GREY (BY.UN.LGR.1224.PL)  20Jun17 / 2Aug17	
Inv.4146	1 - LOCATION: ENSUITE 4 SHOWER STALL  WALL TILE - UPGRADE 4 - BATHROOM 4 - SHOWER WITH CEILING  HORIZONTAL INSTALL *****  Line 52982    Note: 8" X 24" LAGUNA WHITE WAVE (IV.LG.WHT.0824.WV)  20Jun17 / 2Aug17	
Inv.4146	1 - LOCATION: ENSUITE 5 SHOWER STALL  WALL TILE - UPGRADE 4 - BATHROOM 5 - TUB WITH CEILING  HORIZONTAL INSTALL *****  Line 52983    Note: 8" X 24" LAGUNA WHITE WAVE (IV.LG.WHT.0824.WV)  20Jun17 / 2Aug17	
Inv.4146	1 - LOCATION: TWIN BATH SHOWER STALL  WALL TILE - UPGRADE 4 - BATHROOM 5 - SHOWER WITH CEILING  HORIZONTAL INSTALL *****  Line 52984    Note: 8" X 24" LAGUNA WHITE WAVE (IV.LG.WHT.0824.WV)  20Jun17 / 2Aug17	
Inv.4146	1 - LOCATION: MASTER ENSUITE (HER SIDE)  FLOOR TILE - UPGRADE 6 - MASTER ENSUITE - HIS - HERS - FLOOR  STANDARD STACKED INSTALL - SEE SKETCH FOR TILE DIRECTION  Line 52985    Note: 24" X 48" TIMELESS WHITE POLISED (OV.TL.WHT.2448.PL)  20Jun17 / 2Aug17	
Inv.4146	1 - LOCATION: MASTER ENSUITE (HIS SIDE)  FLOOR TILE - UPGRADE 6 - MASTER ENSUITE - HIS - HERS - SHOWER FLOOR  STANDARD STACKED INSTALL - SEE SKETCH FOR TILE DIRECTION  Line 52986    Note: 24" X 48" TIMELESS WHITE POLISED (OV.TL.WHT.2448.PL)  20Jun17 / 2Aug17	



CONSTRUCTION SUMMARY

Carrville Investments Ltd. / Loggias of Richvale

Lot/Unit: 20    Phase/Building: 2    Model/Floor Plan: The Ferrara (50-3) Elev B

Inv.4146	1 - LOCATION: MASTER ENSUITE SHOWER STALL  SUPPLY AND INSTALL FLOOR TILE IN LIEU OF WALL TILE TO SHOWER STALL INCLUDING CEILING.  INSTALL TO ALIGN WITH FLOOR (PARALLEL) Note: 24" X 48" TIMELESS WHITE POLISED (OV.TL.WHT.2448.PL)	
Line 52987		
20Jun17 / 2Aug17		
Inv.4146	1 - LOCATION: MASTER ENSUITE SHOWER STALL  SUPPLY AND INSTALL UPGRADE FLOOR TILE SHOWER STALL IN MASTER ENSUITE. Note: MARBLE HEXAGON POLISHED ORIENTAL WHITE (GM.ORT.WHT.HEX)	
Line 52988		
20Jun17 / 2Aug17		
Inv.4146	3 - LOCATION: ENSUITE 4, ENSUITE 5 AND TWIN SHOWER  FLOOR TILE - UPGRADE FLOOR- BATHROOM 4 - SHOWER FLOOR Note: PENNY ROUND TAUPE GLOSSY 12" X 12" (WB.PR.TPE.1212.GL.)	
Line 52989		
20Jun17 / 2Aug17		

EXTRAS AS PER OFFER

The Vendor agrees to allow the purchaser the one time right to assign this transaction, and Purchaser agrees to use the Vendors approved form of assignment. The cost of such assignment will be \$10,000 payable to the Vendor should the purchaser decide to Worksheet Note:	
Subzero/Wolf Kitchen Appliances including 36 inch stainless steel fridge and 36 inch gas range, 36 inch stainless steel chimney style hood fan and ASKO stainless steel dishwasher, from Vendors standard package. No cash value, non-transferrable and no Worksheet Note:	
Optional 5 Bedroom Second Floor Worksheet Note:	
The Purchaser has selected Exterior Package No:____as their FIRST choice. As a SECOND choice, should the FIRST package become unavailable or should there be any architectural control conflicts, the Purchasers SECOND choice is Exterior Package No:_____. Worksheet Note:	



## INTERIOR COLOUR SCHEME

**\*\* NOTE: This is not an approved document. Document must be locked \*\*\***

Purchaser: HONG DA SHEN

Property: 20 of Plan -

Telephone Res. / Bus: (647) 808-5266 /

Project: Carrville Investments Ltd.

Decor Advisor: Steffannee Appio

Model and Elevation: The Ferrara (50-3) Elev B

Layout Changes: ☐ Yes ☐ No

Sketch Attached: ☒ Yes ☐ No

Exterior Colour Scheme:

### 1. Cabinetry

	Style and Colour	Counter Top	Hardware
Kitchen / Breakfast	MADRID PAINT CANOLI CHOCOLATE GLAZ	5141 FROSTY CARINA	131 KNOB
Kitchen Island	MADRID PAINT CANOLI CHOCOLATE GLAZ	5141 FROSTY CARINA	131 KNOB
Laundry Room	PVC SLAB LATITUDE EAST	6141 OCEAN FOAM	9677 HANDLE
Powder Room	MADRID PAINT CANOLI CHOCOLATE GLAZ	5141 FROSTY CARINA	131 KNOB
Main Bathroom	N/A	N/A	N/A
Master Ensuite Bathroom	SIENNA MAPLE SOAPSTONE CL	5031 STATUARIO MAXIMUS	12843 HANDLE
Second Ensuite Bathroom (If Applicable)	PVC SLAB MERINGUE - ENSUITE 4	5131 CALACUTTA NUVO	9677 HANDLE
TWIN BATH	PVC SLAB MERINGUE	5131 CALACUTTA NUVO	9677 HANDLE
ENSUITE 5	PVC SLAB MERINGUE	5131 CALACUTTA NUVO	9677 HANDLE

### Appliances

#### Custom Size Fridge

☒ Yes ☐ No

#### Valance Lighting

☒ Yes ☐ No

#### Microwave / Range Hood

☐ Yes ☐ No

#### Cooktop / Rangetop

☐ Yes ☒ No

#### Built in Wall Oven

☒ Yes ☐ No

#### Slide-in Range

☐ Yes ☒ No

### Comment

STANDARD EDGE PROFILE TO ALL STONE COUNTER-TOPS IN KITCHEN, LAUNDRY ROOM AND BATHROOMS

### 2. Flooring

	Selection
FOYER	24" x 24" MARMI EVOLUZIONE TAFU LIGHT GREY (MZ.ME.TFU.2424.PL)
Main Hall	VINTAGE 5" HANDSCRAPED OAK - GOTHAM
Back Hall	24" x 24" MARMI EVOLUZIONE TAFU LIGHT GREY (MZ.ME.TFU.2424.PL) POWER ROOM SIDE HALL
Breakfast	24" x 24" MARMI EVOLUZIONE TAFU LIGHT GREY (MZ.ME.TFU.2424.PL)
Laundry Room	13" X 13" SERPENTINE BEYAZ WHITE (TR.ST.BYZ.1313)
Kitchen	24" x 24" MARMI EVOLUZIONE TAFU LIGHT GREY (MZ.ME.TFU.2424.PL)
Powder Room	24" x 24" MARMI EVOLUZIONE TAFU LIGHT GREY (MZ.ME.TFU.2424.PL)
Main Bathroom	12" X 24" UNICOLOUR POLISHED LIGHT GREY (BY.UN.LGR.1224.PL) ENSUITE 4 - STACKED INSTA
Master Ensuite	24" X 48" TIMELESS POLISHED WHITE (OV.TL.WHT.2448.PL) STACKED INSTALL
Bathroom (If Applicable)	12" X 24" UNICOLOUR POLISHED LIGHT GREY (BY.UN.LGR.1224.PL) ENSUITE 5 - STACKED INSTA
Mud Room	N/A
TWIN BATH	12" X 24" UNICOLOUR POLISHED LIGHT GREY (BY.UN.LGR.1224.PL) STACKED INSTALL
Living Room	VINTAGE 5" HANDSCRAPED OAK - GOTHAM
Dining Room	VINTAGE 5" HANDSCRAPED OAK - GOTHAM
Family / Great Room	VINTAGE 5" HANDSCRAPED OAK - GOTHAM
Den / Library / Study	VINTAGE 5" HANDSCRAPED OAK - GOTHAM
Basement Landing (If Applies)	VINTAGE 5" HANDSCRAPED OAK - GOTHAM
Lower Landing (If Applicable)	VINTAGE 5" HANDSCRAPED OAK - GOTHAM
Upper Landing	VINTAGE 5" HANDSCRAPED OAK - GOTHAM
Upper Hall	VINTAGE 5" HANDSCRAPED OAK - GOTHAM
Master Bedroom	VINTAGE 5" HANDSCRAPED OAK - GOTHAM
Bedroom #2	VINTAGE 5" HANDSCRAPED OAK - GOTHAM
Bedroom #3	VINTAGE 5" HANDSCRAPED OAK - GOTHAM
Bedroom #4	VINTAGE 5" HANDSCRAPED OAK - GOTHAM
Bedroom #5	VINTAGE 5" HANDSCRAPED OAK - GOTHAM
YOGA ROOM	VINTAGE 5" HANDSCRAPED OAK - GOTHAM

Flooring Continued on Page 2

Initial:

Page 1 of 3



INTERIOR COLOUR SCHEME

**\*\* NOTE: This is not an approved document. Document must be locked \*\*\***

Purchaser: HONG DA SHEN  
Telephone Res. / Bus: (647) 808-5266 /  
Decor Advisor: Steffanee Appio

Property: 20 of Plan -  
Project: Carrville Investments Ltd.  
Model and Elevation: The Ferrara (50-3) Elev B

2. Flooring - Continued -

Upgrade Underpad	Type	Area
	N/A	N/A
Carpet on Stairs	Capped	Runner - *Upgrade
Comment		

3. Plumbing Fixtures / Faucets

Kitchen	UPG	Second Ensuite	STD	Powder Room	STD
Master Ensuite	STD			Other Room	STD
Main Bathroom		TWIN BATH	STD		

Comment  
CATENA UNDERMOUNT SINKS TO ALL BATHROOMS

4. Wall Tile

	Tile Selection	Listello	Insert	Insert Selection
Main Bathroom	N/A	<input type="checkbox"/>	<input type="checkbox"/>	
Master Ensuite				
Tub Deck	N/A	<input type="checkbox"/>	<input type="checkbox"/>	
Tub Apron	N/A	<input type="checkbox"/>	<input type="checkbox"/>	
Tub Surround	N/A	<input type="checkbox"/>	<input type="checkbox"/>	
Shower Stall	24" X 48" TIMELESS WHITE POLISHED (OV.TL.WHT.244	<input type="checkbox"/>	<input type="checkbox"/>	UPGRADE SHOWER FLOOR
Second Ensuite	8" X 24" LAGUNA WHITE WAVE (IV.LG.WHT.0824.WV)	<input type="checkbox"/>	<input type="checkbox"/>	UPGRADE SHOWER FLOOR
TWIN	8" X 24" LAGUNA WHITE WAVE (IV.LG.WHT.0824.WV)	<input type="checkbox"/>	<input type="checkbox"/>	UPGRADE SHOWER FLOOR
ENSUITE 5	8" X 24" LAGUNA WHITE WAVE (IV.LG.WHT.0824.WV)	<input type="checkbox"/>	<input type="checkbox"/>	UPGRADE SHOWER FLOOR
Kitchen Backsplash	FROSTY CARINA CAESARSTONE	<input type="checkbox"/>	<input type="checkbox"/>	
Complete Backsplash		<input type="checkbox"/>	<input type="checkbox"/>	

Comment  
MASTER SHOWER FLOOR - MARBLE HEXAGON POLISHED ORIENTAL WHITE (GM.ORT.WHT.HEX)  
ENSUITE 4, 5 & TWIN SHOWER FLOOR: PENNY ROUND TAUPE GLOSSY (WB.PR.TPE.1212.GL)  
HORIZONTAL INSTALL TO ALL WALL TILES IN SHOWER STALLS (4,5 TWIN)

5. Fireplace

	Living Room			Family Room			Other Room - Specify		
	Purchased	As Per Plan	N/A	Purchased	As Per Plan	N/A	Purchased	As Per Plan	N/A
	<input type="radio"/>	<input type="radio"/>	<input type="radio"/>	<input type="radio"/>	<input checked="" type="radio"/>	<input type="radio"/>	<input type="radio"/>	<input type="radio"/>	<input type="radio"/>
Fireplace Type				STANDARD BLACK					
Mantle Type				VILLA NOVA					
Over Mantle									
Colour / Stain									
Surround									
Hearth									
Comment									

Initial:



## INTERIOR COLOUR SCHEME

**\*\* NOTE: This is not an approved document. Document must be locked \*\*\***

Purchaser: HONG DA SHEN  
Telephone Res. / Bus: (647) 808-5266 /  
Decor Advisor: Steffanee Appio

Property: 20 of Plan -  
Project: Carrville Investments Ltd.  
Model and Elevation: The Ferrara (50-3) Elev B

### 6. Trim Carpentry

Door Hardware STANDARD

Interior Trim STANDARD

Comment

#### Interior Doors

☐ 2 Panel Arch Top

☒ 2 Panel Square Top

☐ 6 Panel

Initial for Door Style

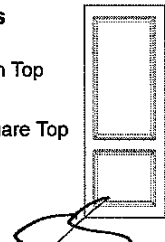

### 7. Railings and Pickets

Railing Package STANDARD

Railing Colour GOTHAM

Picket Colour FLAT BLACK METAL

Wood Stairs ☐ No ☒ Oak

Tread Colour GOTHAM

Comment

STAIN OAK STAIRS TO COMPLIMENT HARDWOOD - GOTHAM STAIN

### 8. Plaster Mouldings and Medallions

Foyer

Main Hall

Living Room

Dining Room

Family Room

Kitchen/Breakfast

Den/Library

Lower Landing

Comment

### 9. Wall Paint

STANDARD SENATOR WHITE

#### Smooth Ceilings

☐ First Floor

☐ First Floor incl. Second Floor Hall

☐ First and Second Floor

☒ Throughout

☐ Not Applicable

Trim Paint

### 10. Additional Comments

### 11. Disclaimers and Notes

- 1) Colours of all materials are as close as possible to builder's selection, but not necessarily identical due to variances in manufacturing.
- 2) Any extras listed above are null and void unless accompanied by a separate invoice/amendment. Said invoice must be paid in full.
- 3) The Purchaser acknowledges that after Interior Colour Selection form is signed and dated, no further changes will be permitted other than re-selection due to unavailability. \_\_\_\_\_ Purchaser's Initials
- 4) The Purchaser acknowledges reading and accepting the "Senator Homes Décor Centre Disclaimers" form. This document contains other miscellaneous disclaimers.

This Interior Colour Selection is final and approved by:

Purchaser:

Signature:

Date:

Vendor:

Carrville Investments Ltd.

AUG 9/17



...reference to those items noted on the accompanying "Upgrades/Extras". All other details, dimensions & favours are for illustrative purposes only and may not be applicable to the Purchaser's Model.

ELEV. A 4,603 SQ. FT. | ELEV. B 4,574 SQ. FT.

Site W 2 Lot 20

Date 6/20/20

Purchaser Initials \_\_\_\_\_ Production Initials \_\_\_\_\_

⊗ = pot light  
⊗X = standard light

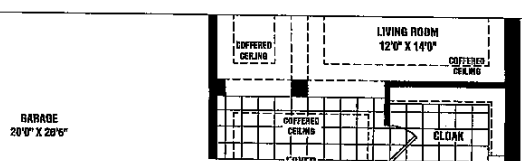
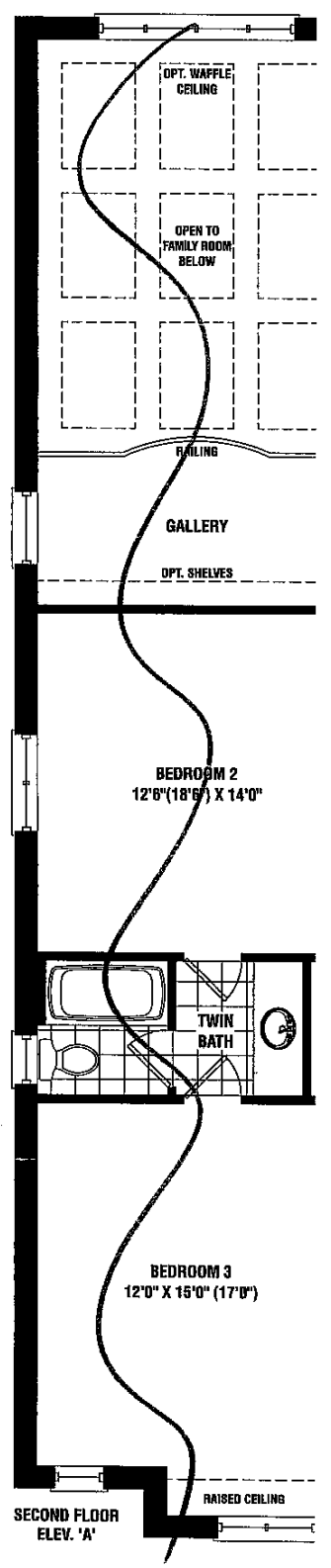
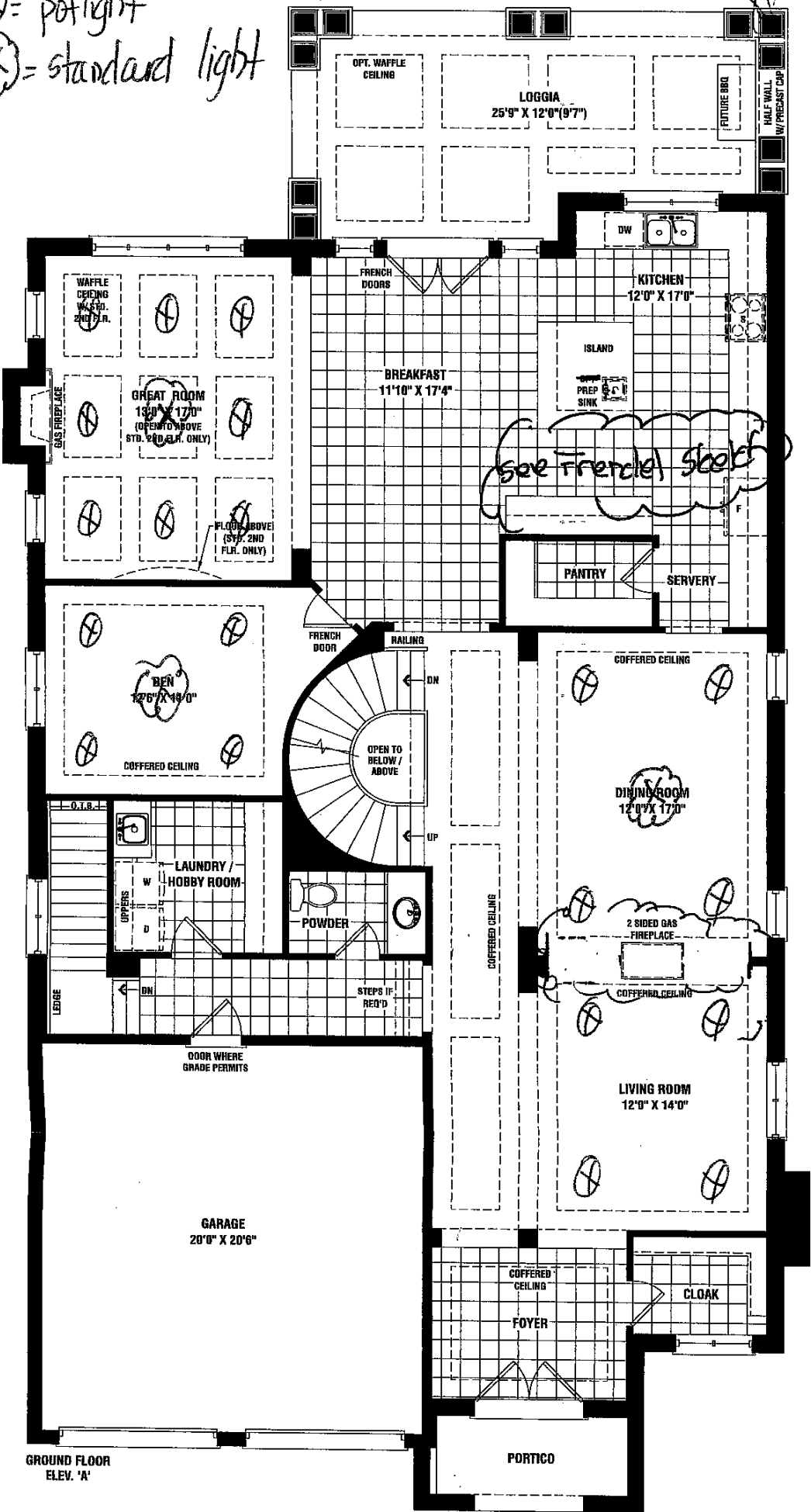



ASTER BEDROOM  
24'6" X 17'0"

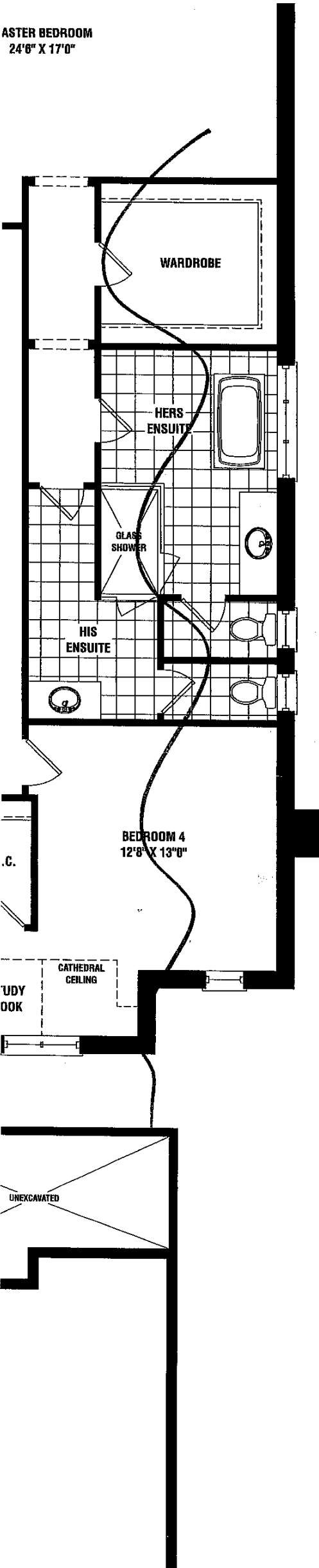

Site \_\_\_\_\_  
Date \_\_\_\_\_  
Project \_\_\_\_\_

Cor 2  
6/20/17  
20

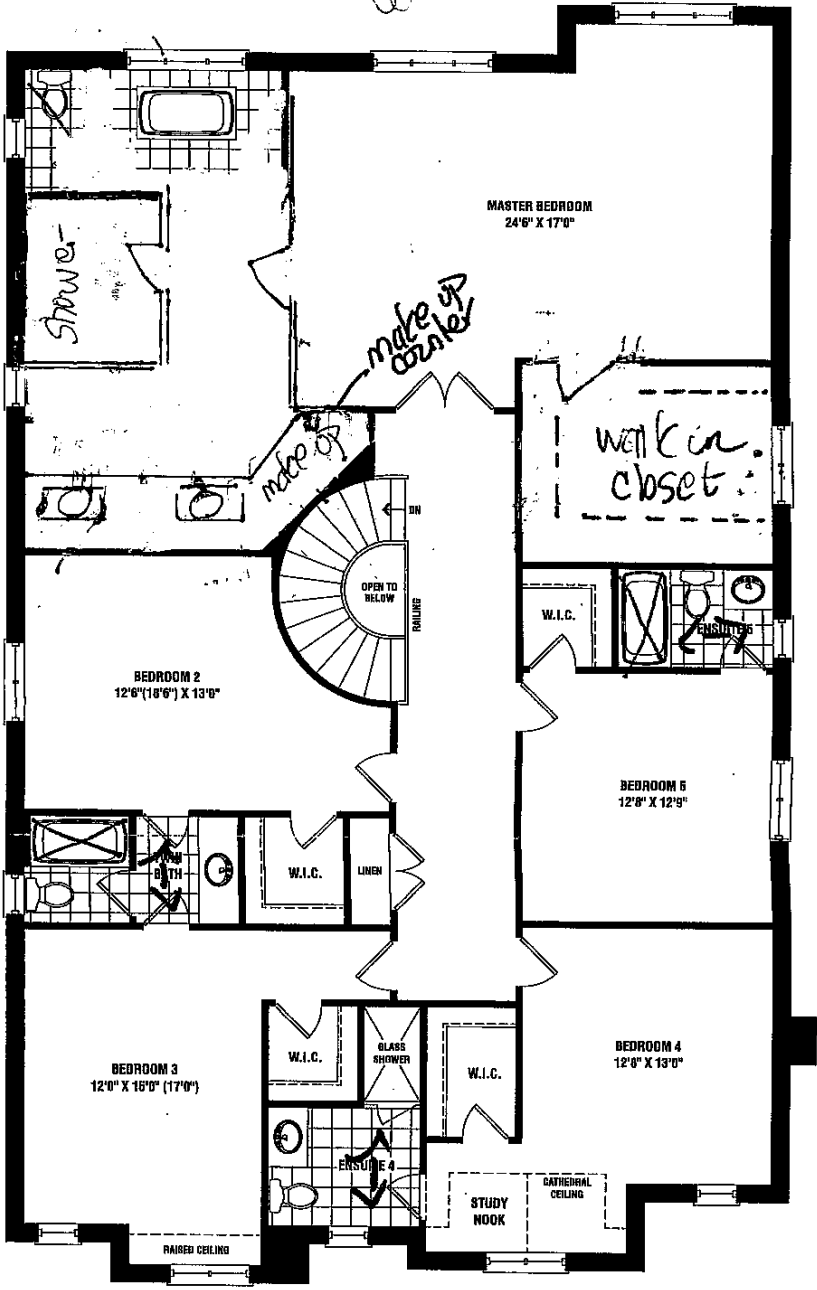

OPT. SECOND FLOOR  
ELEV. 'A'  
5 BEDROOM / YOGA ROOM

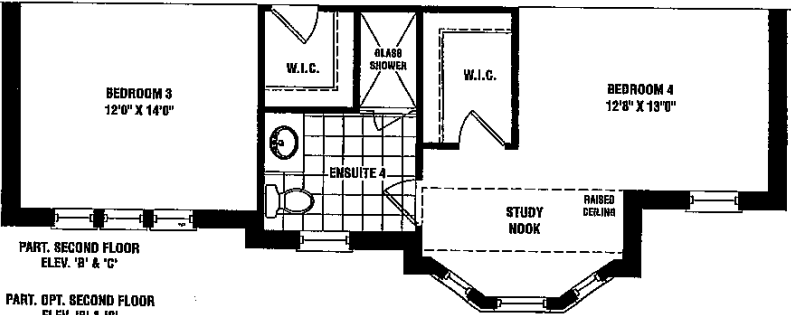

PART. SECOND FLOOR  
ELEV. 'B' & 'C'  
PART. OPT. SECOND FLOOR  
ELEV. 'B' & 'C'  
5 BEDROOM / YOGA ROOM

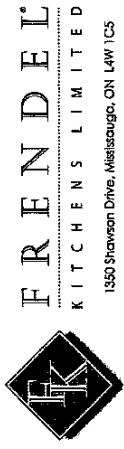

**SENATOR HOMES**  
**RICHVALE PHASE 2**  
**MODEL: FERRARA**  
**50-3 (1<sup>ST</sup> FLR) – LOT 20 UPG**

FLIP UP (X4)

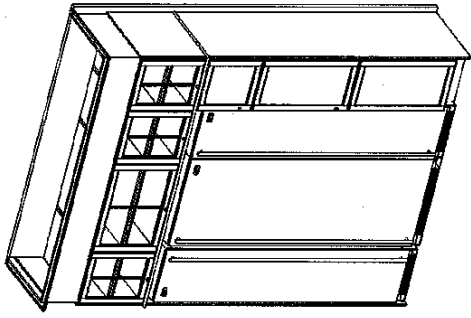

FLIP UP (X2)

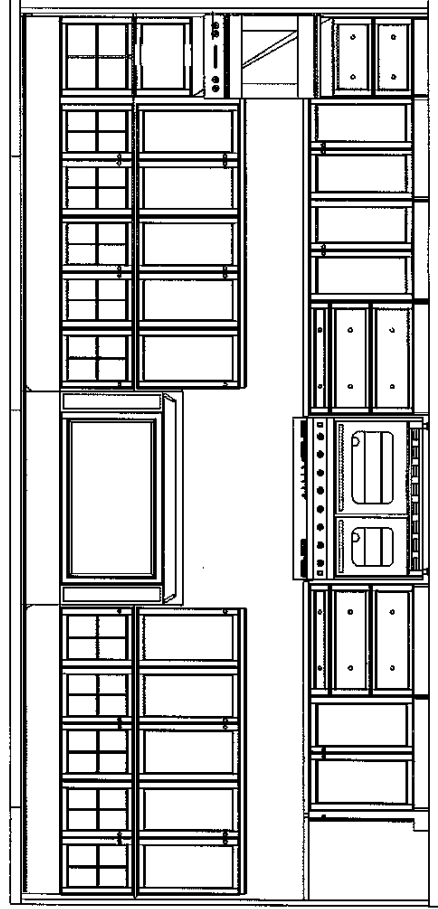
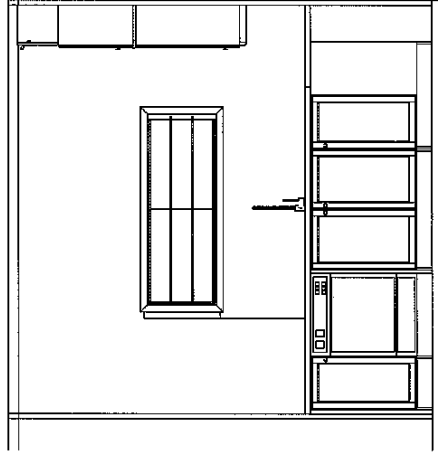
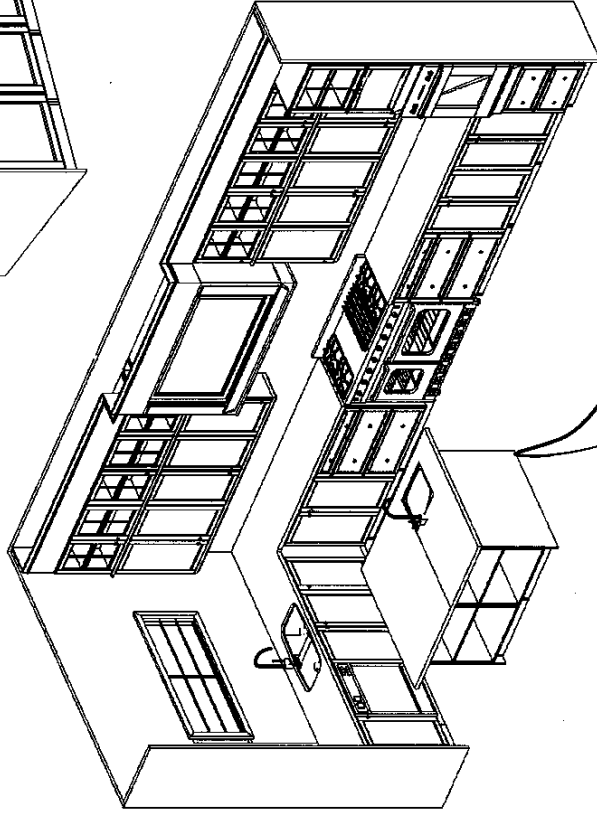
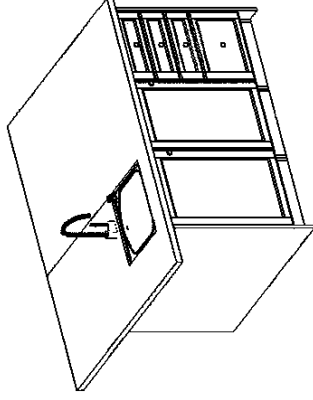
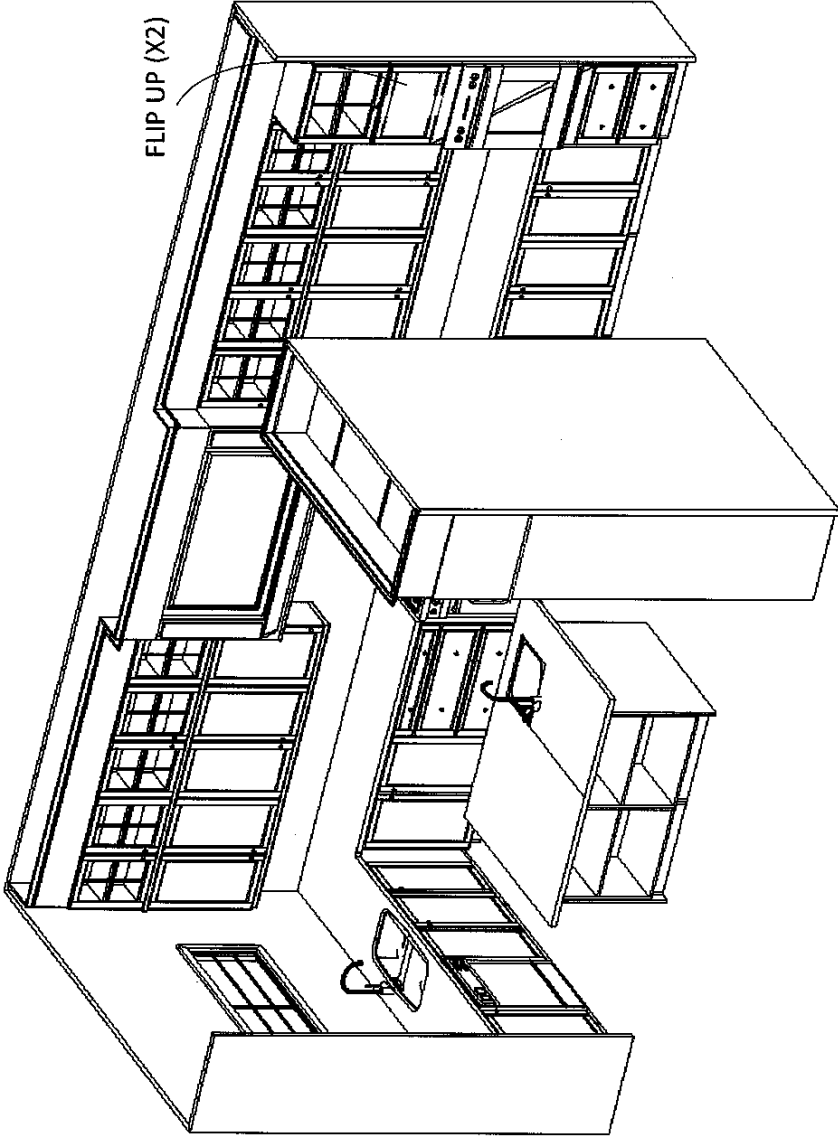

THIS DRAWING IS FOR DESIGN PURPOSES ONLY.  
IT IS NOT AN EXACT REPRESENTATION.

7/10/2017

--STACK HEIGHT REFLECTED ON LAYOUT AND DRAWINGS: 77CM LOWERS -- 55CM HIGH UPPERS?  
to eliminate space above fridge - senator projects typically use 90cm h

--KITCHEN INCLUDES 6 FLIP UP CABINETS  
- KITCHEN INCLUDES 16 GLASS DOORS (11 FIN. INT.)

KITCHEN (1ST FLR)

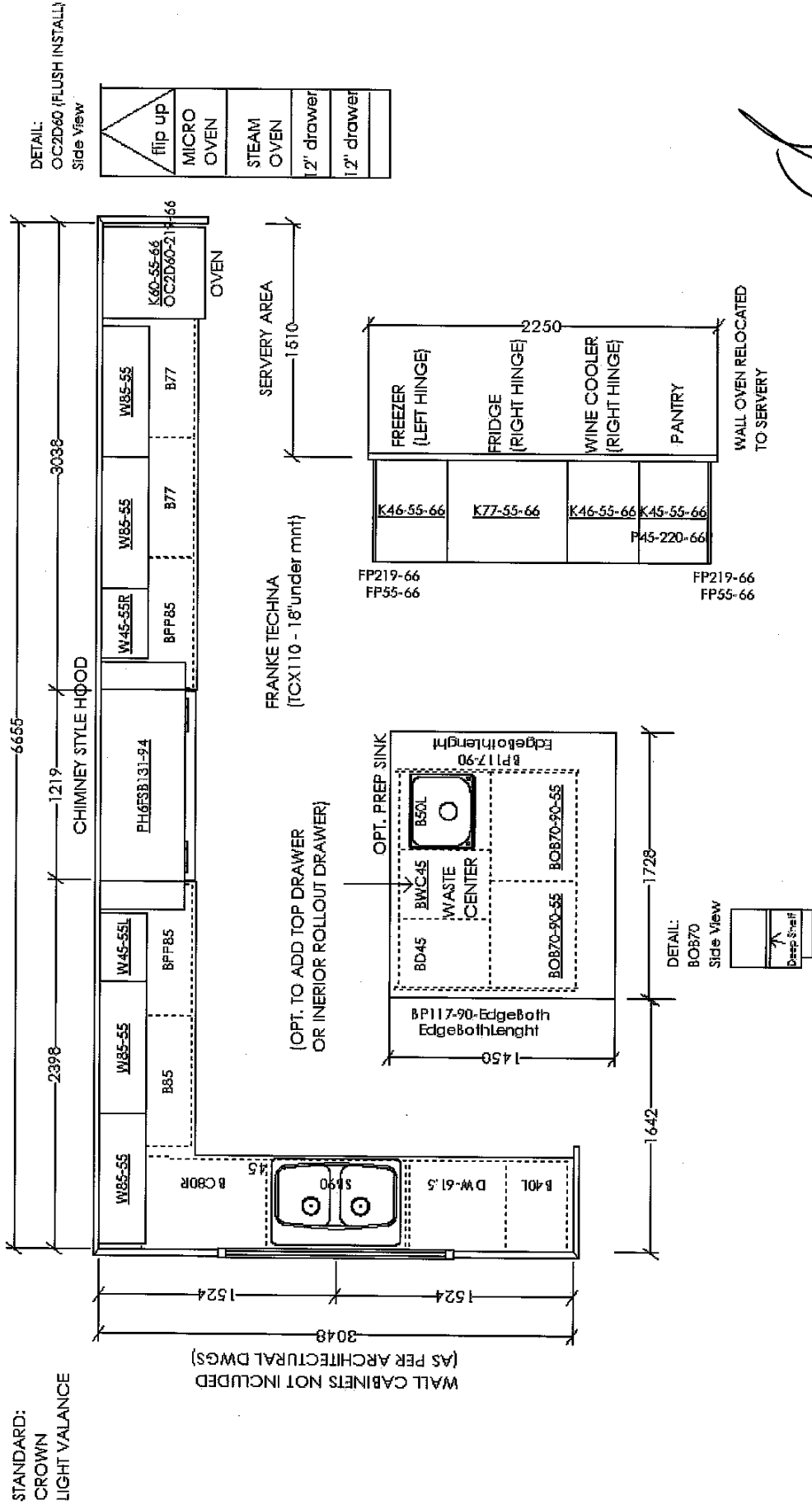

28

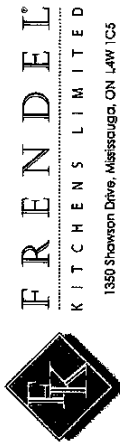

**SENATOR HOMES**  
**RICHVALE PHASE 2**  
**MODEL: FERRARA**  
**50-3 (1<sup>ST</sup> FLR) – LOT 20 UPG**

**STANDARD CONTRACT INCLUDES:**

**Kitchen**

- Canopy Hood 104 +/- cm Wide opening
- Deep fridge 95cm Wide - gables at exposed ends
- Slide in range 92 Wide opening
- Soft close hinges
- Elite collections receive soft close Tandem drawers
- Pots and pan drawers (x2 sets)
- 1 bank of 4 drawers
- Crown moulding
- Light valance
- Backing on all cabinets (excluding sink base)
- Countertop by others

**Vanity**

- Vanities - 80cm H
- Vanities are 53.4cm Deep
- Vanities include top drawers
- Soft close hinges
- Elite collections receive soft close Tandem drawers
- Countertop by others

THIS DRAWING IS FOR DESIGN PURPOSES ONLY.  
IT IS NOT AN EXACT RENDITION.

7/10/2017

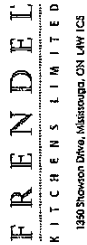

**SENATOR HOMES**  
**RICHVALE PHASE 2**  
**MODEL: FERRARA**  
**50-3 (2<sup>nd</sup> FLR)**

**STANDARD CONTRACT INCLUDES:**

**Vanity**

- Vanities - 80cm H
- Vanities are 53.4cm Deep
- Vanities include top drawers
- Soft close hinges
- Elite collections receive soft close Tandem drawers
- Countertop by others

THIS DRAWING IS FOR DESIGN PURPOSES ONLY.  
IT IS NOT AN EXACT RENDITION.  
5/9/2017

hans  
and  
Zander

OPT. 2ND FLR - ELEV. A, B, C - 5 BEDROOM - YOGA RM

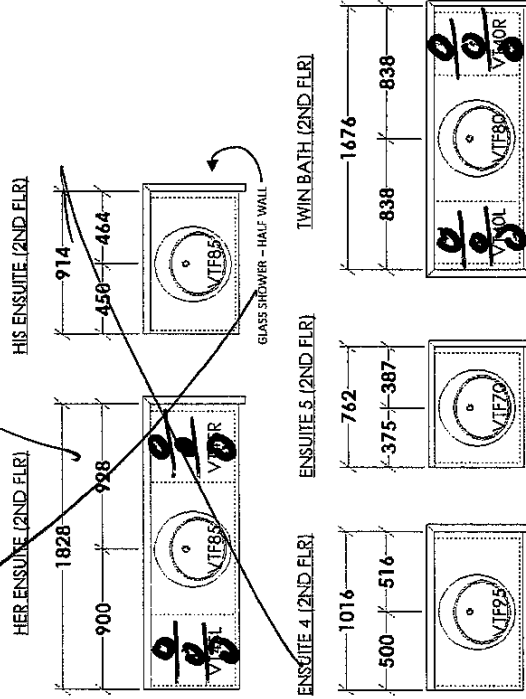

## STANDARD 2ND FLR - ELEV. A, B, C

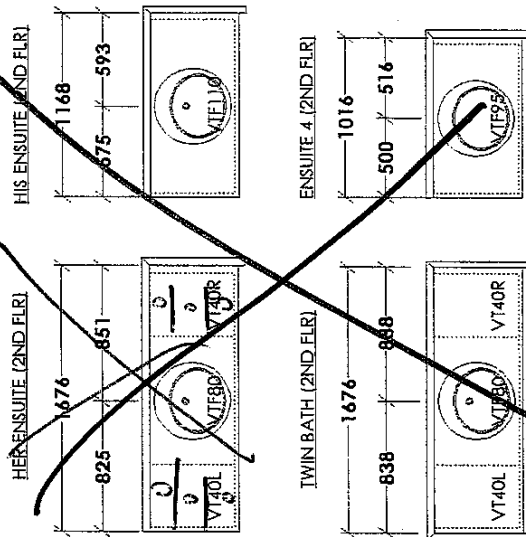

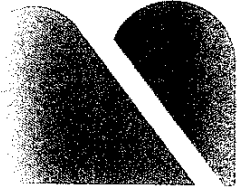

Schedule 'C'

**Breda  
BayPoint**  
Plumbing & Mechanical Inc

**richdale** PH 2 UP-GRADE  
SOUTH RICHMOND HILL

**Shower**

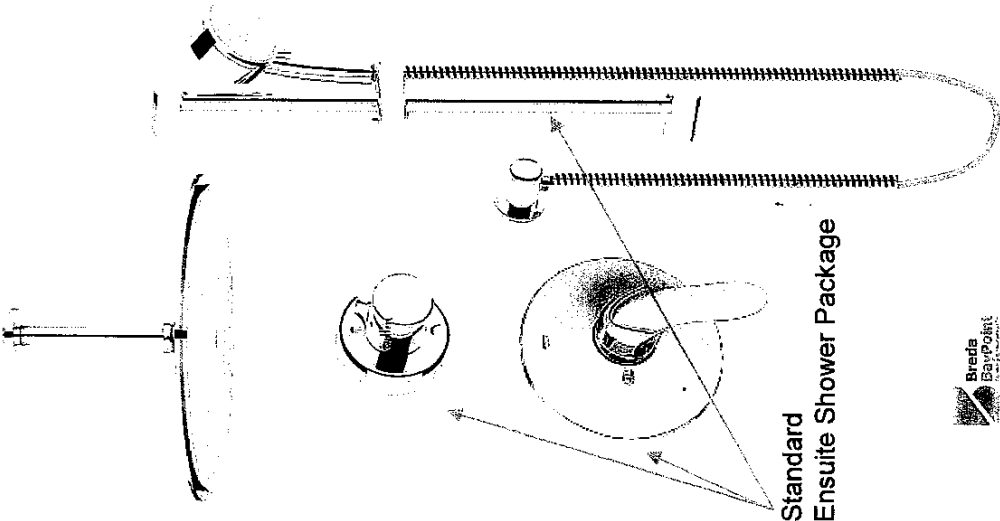

Standard  
Ensuite Shower Package

hot #20  
Carville P2

**Option 1**

Up-grade Ensuite Shower remove Standard Head  
And Add 8" Rain Head

Up-Grade Components CHROME  
1x Grohe 27217000 6" Ceiling Arm & Flange  
1x Grohe 28373000 8" Round Rain Head

**Total Price = \$4350.00 + hst**  
In addition to standard contract



6/22/2017



**TOTO**

## Wall Mounted Toilet Carrier

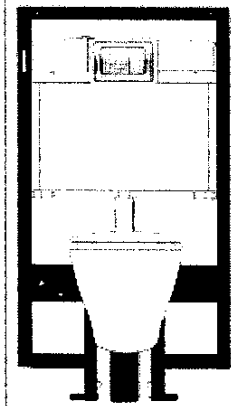

The Carrier's requires  
a 2'x4" Wall space.



TOTO Wall Mounted Toilet &  
Duravit Wall Carrier Carrier  
Model: TOTO T140 MFG#4  
TOTO T140 MFG#4  
TOTO T140 MFG#4  
TOTO T140 MFG#4

PRICE = \$1150.00 +hst  
in lieu of standard

Feb 4/2016

Car 2  
hot 20



## Wall Mounted Toilet Carrier



**GEBERIT**



The Carrier's requires  
a 2'x6" Wall space.  
Standard interior Wall  
Dimension do not  
work.

Faucet Not Included

### TOILET

Gerberit Wall Carrier with Chrome  
Dual Flush Actuator and Duravit  
ME Stark Toilet and Seat

Gerberit Wall Carrier 111 115261 5 1/2" x 6" Wall  
Gerberit Wall Flush Plate 112 110 21 1/2"  
Duravit ME Stark Toilet 252301  
Duravit Seat Soft Close 252301

**DURAVIT**

PRICE = \$1520.00 +hst  
in lieu of standard

**KOHLER**

## Wall Mounted Toilet Carrier



The Carrier's requires  
a 2'x6" Wall space.  
Standard interior Wall  
Dimension do not  
work.

KOHLER Wall Mounted Toilet &  
Duravit Wall Carrier Carrier  
Kohler Toilet & Seat  
Kohler Toilet & Seat  
Kohler Toilet & Seat  
Kohler Toilet & Seat

PRICE = \$1290.00 +hst  
in lieu of standard

Sincerely,  
Victor Breda

**Steffanee Appio**

**From:** Victor Breda <vbreda@sbreda.com>  
**Sent:** Tuesday, June 20, 2017 12:34 PM  
**To:** Steffanee Appio  
**Subject:** RE: NEED FINISH

Hi Stephanie, here are the prices, please note that there are no Prep faucets  
these are the only ones available.  
All prices are in lieu of standard + hst

lot 20  
Car 2

**GROHE**

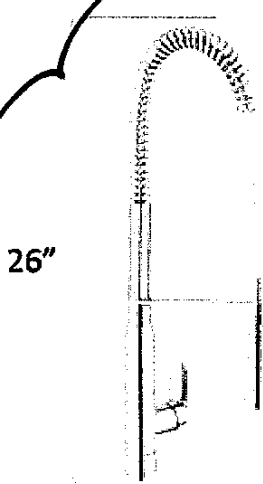

26"

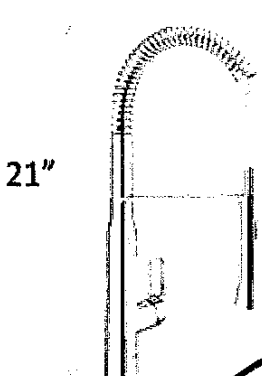

21"

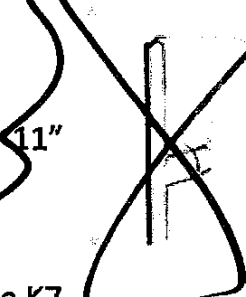

11"

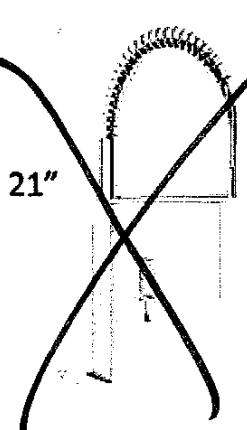

21"

**Grohe K7 – Semi Pro**  
32951000 Chrome = \$885.00 +hst  
~~32951DC0 Super Steel~~ \$1155.00 + hst

**Grohe K7**  
32178000 Chrome = \$865.00 +hst  
32178DC0 Super Steel \$1135.00 + hst

**Grohe K7 – Semi Pro Medium**  
32380000 Chrome = \$735.00 +hst  
~~32380DC0 Super Steel~~ \$960.00 + hst

**Grohe Eurocube –**  
31401000 Chrome = \$735.00 +hst  
31401DC0 Super Steel \$960.00 + hst

Sincerely,  
Victor Breda



**From:** Steffanee Appio [mailto:sappio@senatorhomes.com]  
**Sent:** June 20, 2017 10:43 AM  
**To:** Victor Breda <vbreda@sbreda.com>  
**Subject:** NEED FINISH

Hi Victor – Good morning☺

Would you kindly provide me with the price for the Grohe K7 and Eurocube chrome finish faucets?

I would need the price for the main and prep sink faucets

thanks

**Steffanee Appio**

**From:** Victor Breda <vbreda@sbreda.com>  
**Sent:** Wednesday, June 07, 2017 2:49 PM  
**To:** Steffanee Appio  
**Subject:** RE: LOT 4 - CARRVILLE PRICE REQUEST  
**Attachments:** ~~CCO 1 - LOT 4 - Extras.pdf~~

Lot 20  
Car 2

Hi Stephanie, please see attached Change order for Pricing and Below is picture reference.

~~LOT 4 - Carville Extras~~

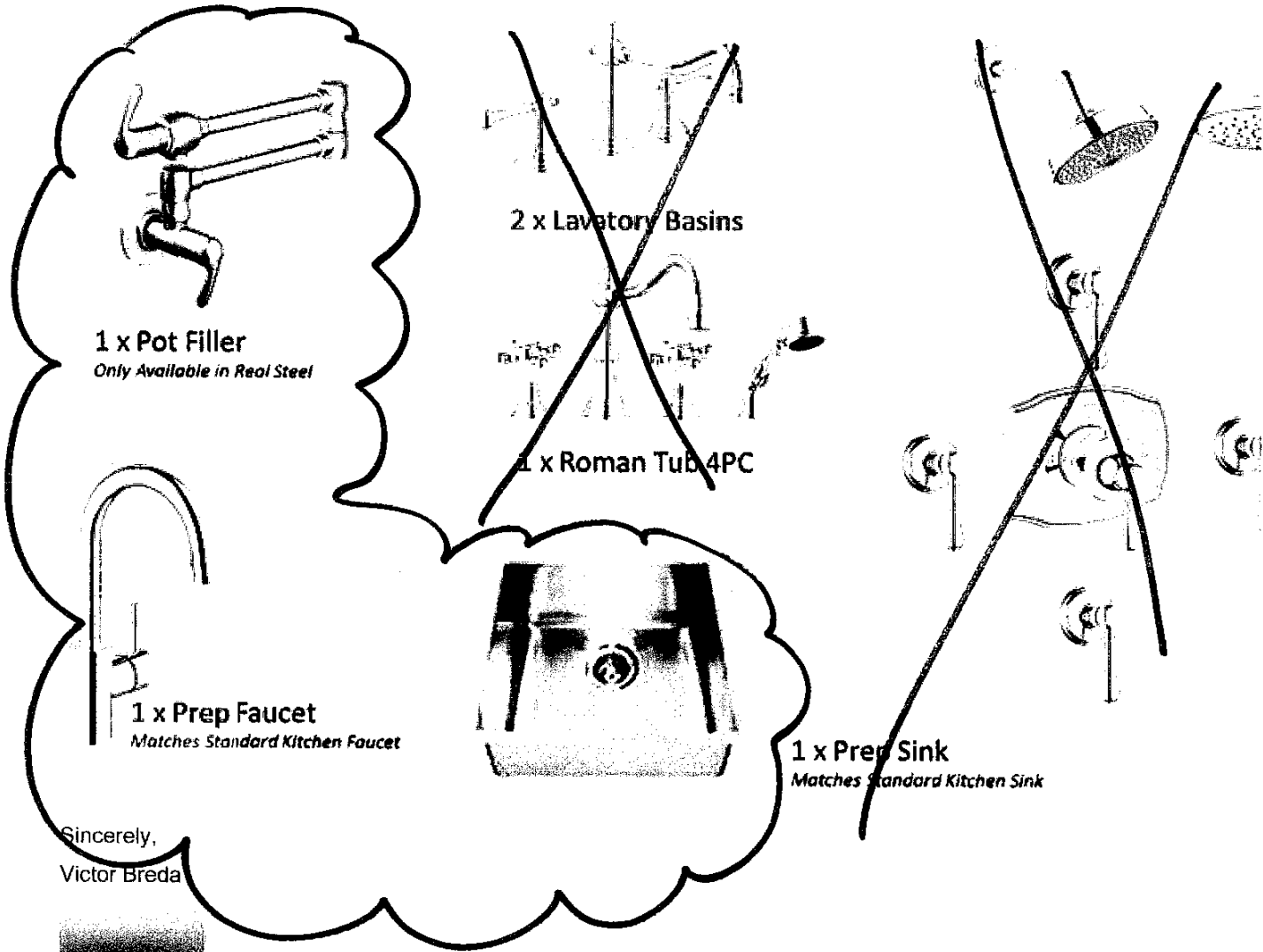

**From:** Steffanee Appio [mailto:sappio@senatorhomes.com]  
**Sent:** June 7, 2017 2:02 PM  
**To:** Victor Breda <vbreda@sbreda.com>  
**Cc:** Aldo Mirigello <amirigello@senatorhomes.com>  
**Subject:** LOT 4 - CARRVILLE PRICE REQUEST

Hi Victor,

Would you kindly be able to provide me with pricing for the following items:

Master Ensuite – Bridgeford Collection Chrome Finish (Grohe)

1. Lavatory – widespread faucets with lever handles (x2)
2. Freestanding tub – widespread faucet with cross handles with hand held spray



Lot 20  
Car 2

**Miele**

PureLine  
24" Combi-Steam Oven

DGC 6800-1



Miele USA  
Specification Sheet DGC 6800-1

lot 20  
Para 2

PureLine Combi-Steam Oven  
DGC 6800-1

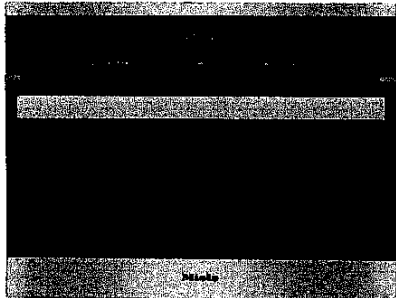

DGC 6800-1

Features:

- M Touch innovative and revolutionary controls are both easy-to-operate and navigate. An intuitive swipe of the screen will quickly lead you to your desired selection
- MultiSteam technology delivers powerful external steam generation and optimum steam distribution via 6 inlet ports
- Wired roast probe for perfect roasting
- 3-in-1 appliance
  1. True European convection oven
  2. Steam oven
  3. Combination of steam and convection oven
- MasterChef and MasterChef Gourmet menus offer over 150 food types to cook to perfection
- XL stainless steel cavity
- Lift up control panel conceals water and condensate container (both containers are dishwasher-safe)
- The simple yet sleek Silhouette handle seems to float, enhancing its modern design lines



SPECIFICATIONS	
DGC 6800-1	
Overall Fascia Dimensions	23 <sup>7</sup> / <sub>16</sub> " (595 mm) W x 18" (455.5 mm) H x <sup>7</sup> / <sub>8</sub> " (23 mm) D
Overall Unit Width - Excluding Fascia Dimension	21 <sup>9</sup> / <sub>16</sub> " (548 mm)
Overall Unit Height - Excluding Fascia Dimension	17 <sup>11</sup> / <sub>16</sub> " (449 mm)
Overall Unit Depth - Excluding Fascia Dimension	21 <sup>5</sup> / <sub>8</sub> " (550 mm)
Oven Door Clearance	12 <sup>9</sup> / <sub>16</sub> " (319 mm)
Built-In	
Minimum Opening Width	22 <sup>1</sup> / <sub>16</sub> " (560 mm)
Minimum Opening Height	17 <sup>11</sup> / <sub>16</sub> " (450 mm)
Minimum Opening Depth	21 <sup>1</sup> / <sub>8</sub> " (555 mm)
Minimum Base Support	60 lbs
Additional Cut-Outs Required	Venting cut-out required 19 <sup>11</sup> / <sub>16</sub> " x 1 <sup>9</sup> / <sub>16</sub> " (500 x 40 mm)
Electrical	
Electrical Requirements	120V/240V, 60Hz, 20A 120V/208V, 60Hz, 20A
Power Rating	120V/240V - 3.7 kw 120V/208V - 3.2 kw
Power Cord	Molded plug - NEMA 6-20, 240V power cord 5 ft (1.5 m)
Shipping	
Shipping Weight	65 lbs
Shipping Dimensions	26 <sup>7</sup> / <sub>32</sub> " (666 mm) W x 21 <sup>5</sup> / <sub>8</sub> " (549 mm) H x 23 <sup>1</sup> / <sub>16</sub> " (535 mm) L
Support	
Call Miele	800.565.6435
Miele Website	www.miele.ca

hot 20  
mar 2

PureLine Combi-Steam Oven  
DGC 6800-1 XL



PRODUCT VIEWS

Isometric View

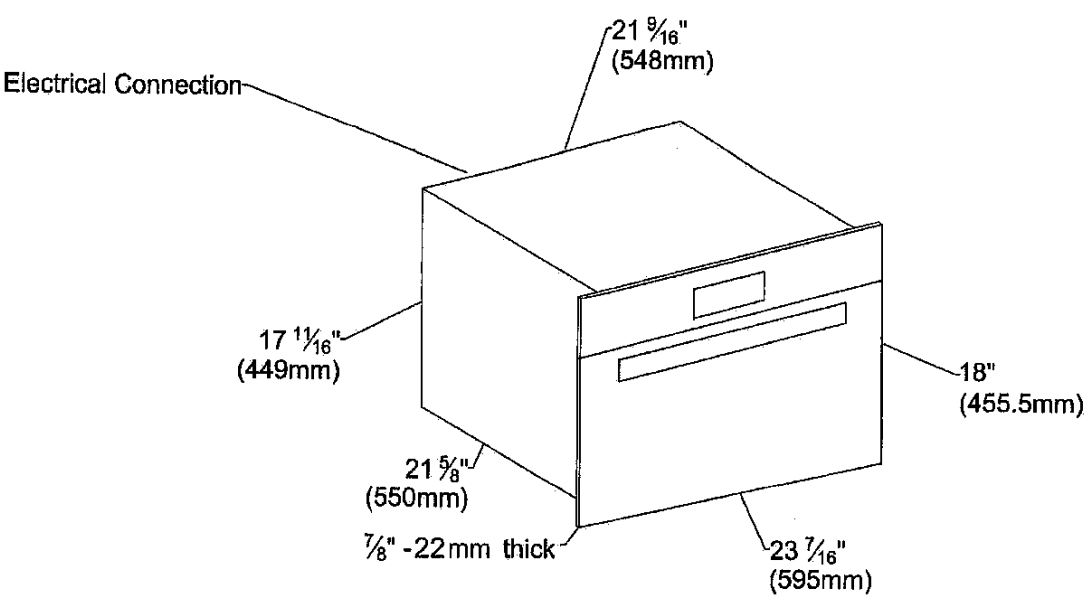

Front View

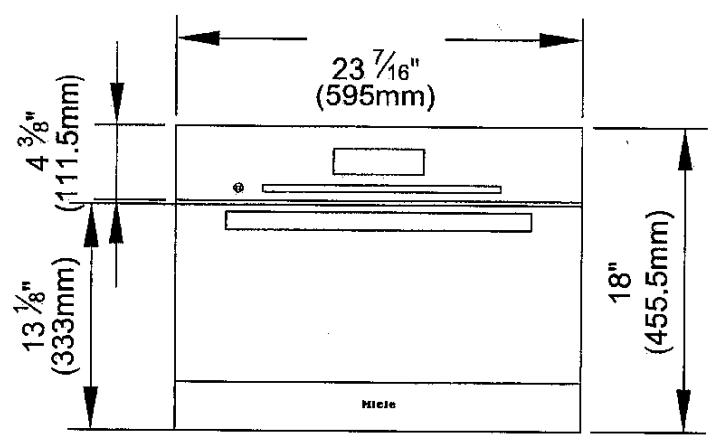

hot 20  
para 2

PureLine Combi-Steam Oven  
DGC 6800-1 XL



INSTALLATION SPECIFICATIONS

Top View, Door Open

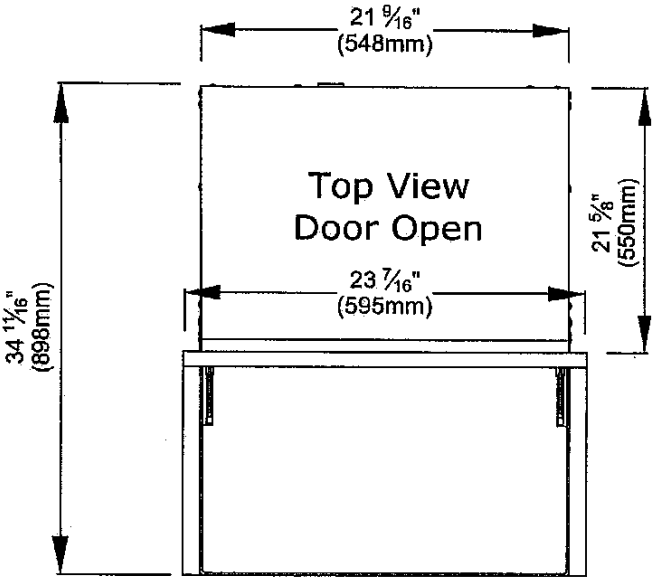

Side View, Door Open

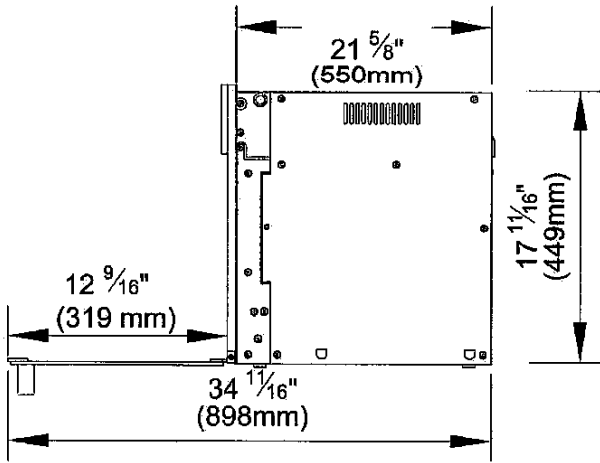

hot 20  
car 2

PureLine Combi-Steam Oven  
DGC 6800-1 XL



INSTALLATION SPECIFICATIONS

Door Swing and Face Detail

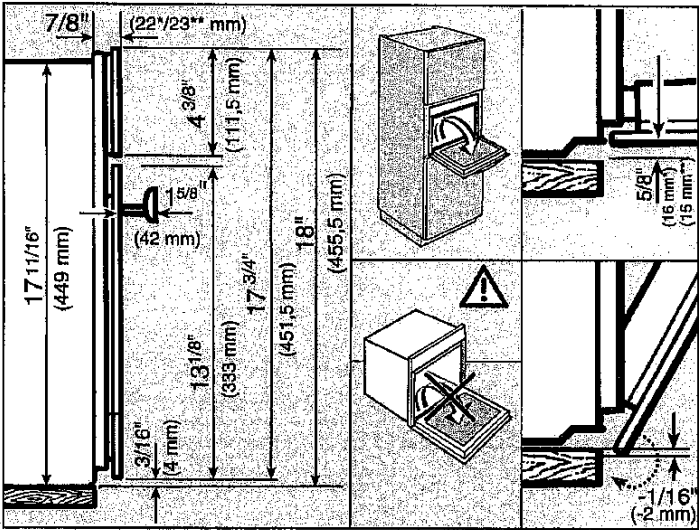

\* Appliances with glass front  
\*\* Appliances with metal front

Control Panel Swivel View

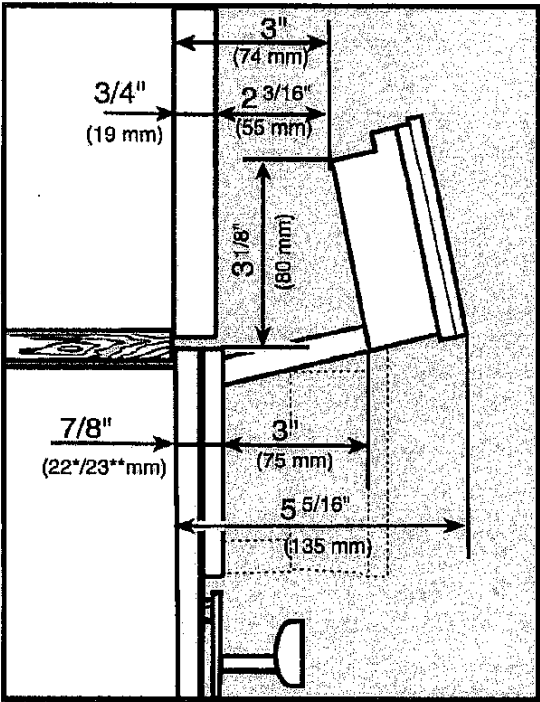

hot 20  
car 2

## PureLine Combi-Steam Oven DGC 6800-1 XL

**Miele**

### INSTALLATION SPECIFICATIONS

#### Tall Cabinet Installation

- ① Combi Steam Oven
- ② Installation niche
- ③ Power supply to the appliance
- ④ Recommended location for electrical connection
- ⑤ Power cord

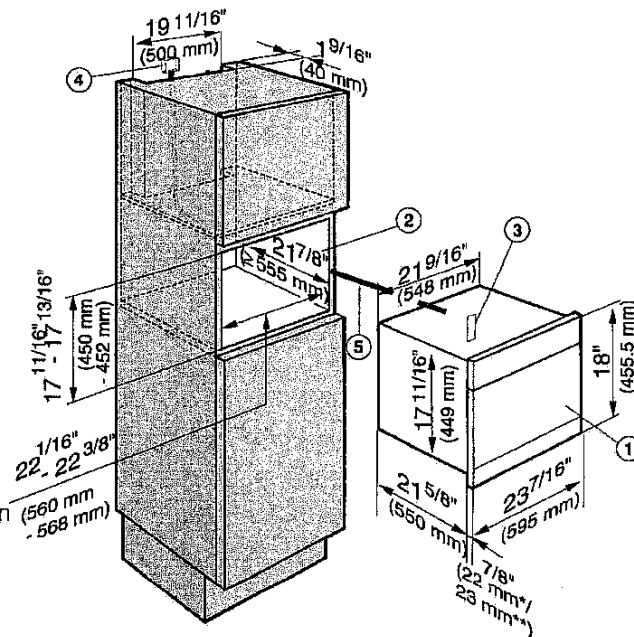

- \* Appliances with glass front
- \*\* Appliances with metal front

#### Tall Cabinet Installation — Venting Requirements

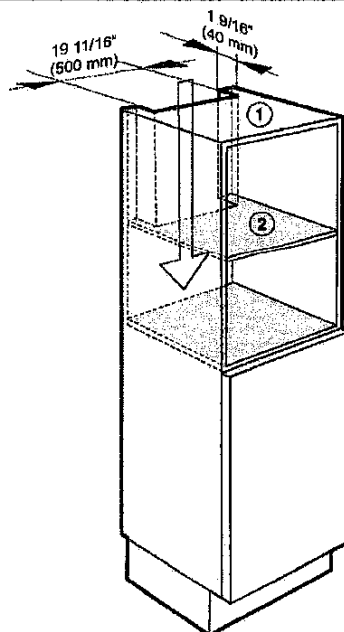

To ensure that the Combi Steam Oven has adequate ventilation, the following cut-outs measuring 19 11/16" x 1 9/16" (500 x 40 mm) must be made:

- ① in the top of the cabinet
- ② in the center shelf above the installation niche

The cabinet housing must not have a back panel fitted behind the installation niche.

hot20  
car2

PureLine Combi-Steam Oven  
DGC 6800-1 XL



HANDLE DETAILS  
All Miele Signature And PureLine  
Handle Dimensions

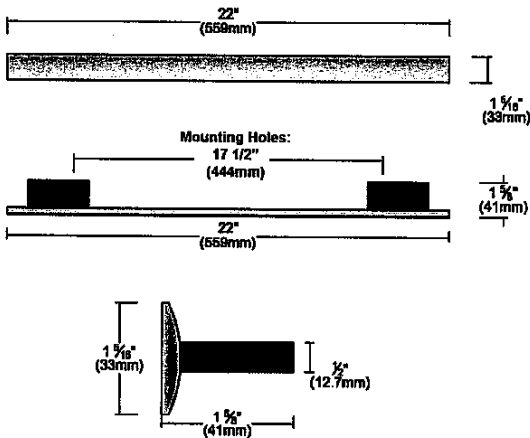

Please note hinges may require adjusting or replacing when changing from a ContourLine Handle to a PureLine or Miele Signature Handle.

All ContourLine Handle  
Dimensions

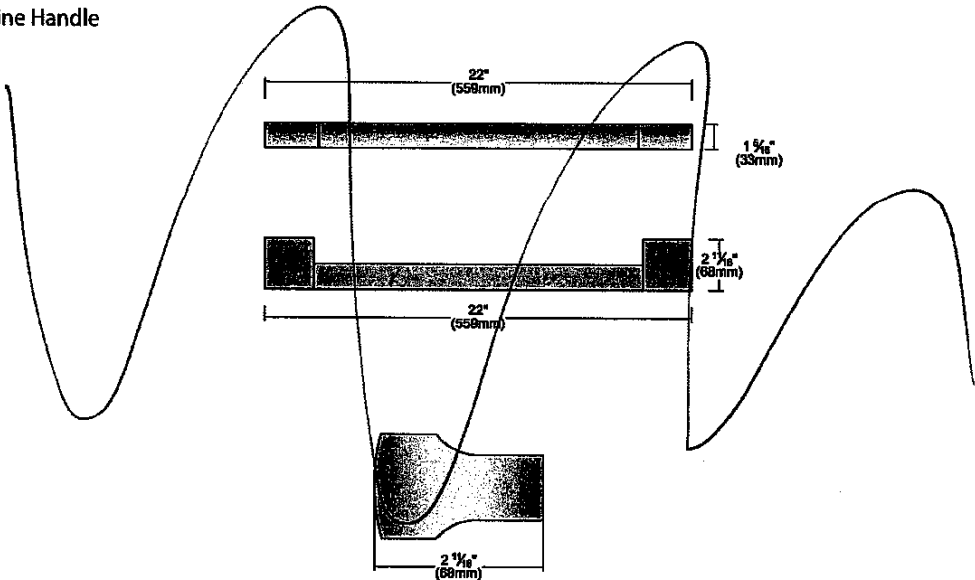

Please note hinges may require adjusting or replacing when changing from a PureLine or Miele Signature Handle to a ContourLine Handle.

lot 20  
car 2



Miele.ca  
Specialist in Sales and Service



hot 20  
car 2

PureLine 24" Microwave Oven  
M 6260 TC

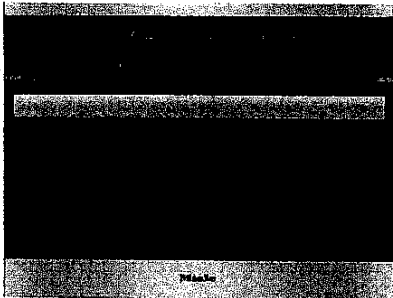

M 6260 TC  
Features:

- DirectSelect controls offer turn dial operation with a 7-segment liquid crystal display
- Popcorn button
- 900 watt microwave
- XL cavity — 1.62 cu ft (46 l) with a 15.8" turntable diameter to reheat several plates at one time
- 16 automatic programs
  - 9 for defrosting
  - 3 for cooking frozen food
  - 4 for fresh ingredients
- Minute plus button
- Timer
- LED lighting for the perfect illumination and low maintenance
- Horizontal alignment with other 60cm appliances
- The simple yet sleek Silhouette handle seems to float enhancing its modern design lines.

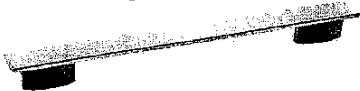

SPECIFICATIONS	
M 6260 TC	
Overall Unit Width - Excluding Fascia Dimension	21 5/8" (550 mm)
Overall Height - Excluding Fascia Dimension	16 1/4" (413 mm)
Overall Depth - Excluding Fascia Dimension	19 3/16" (487 mm)
Oven Door Clearance	15 1/2" (394 mm)
Overall Oven Interior Capacity	Suitable for plates with a diameter up to 15.8"
Overall Fascia Dimensions	23 7/16" (595 mm) W x 17 1/16" (455.5 mm) H x 7/8" (23 mm) D
Built-In	
Minimum Cabinet Width	22 1/16" (562 mm)
Minimum Cabinet Depth	21 5/8" (550 mm)
Minimum Cabinet Height	17 11/16" (450 mm)
Minimum Base Support	40 lbs (18 kg)
Electrical	
Electrical Requirements	120V 15A 60Hz
Power Cord	Molded NEMA 5-15 plug, 5 ft. (1.5 m)
Total Amps	11.4A (120V)
Shipping	
Shipping Weight	49 lbs (22 kg)
Shipping Dimensions	25 7/8" W x 19 13/16" H x 21 1/8" L
Support	
Call Miele	800.565.6435
Miele Website	www.miele.ca

hot 20  
Para

PureLine 24" Microwave Oven  
M 6260 TC



HANDLE DETAILS

All Miele Signature And PureLine  
Handle Dimensions

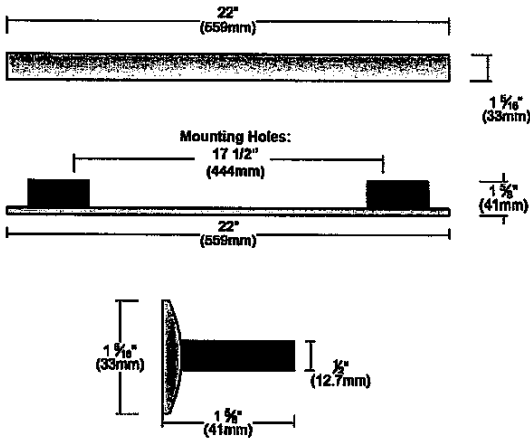

Please note hinges may require adjusting or replacing when changing from a ContourLine Handle to a Pureline or Signature handle.

All ContourLine Handle  
Dimensions

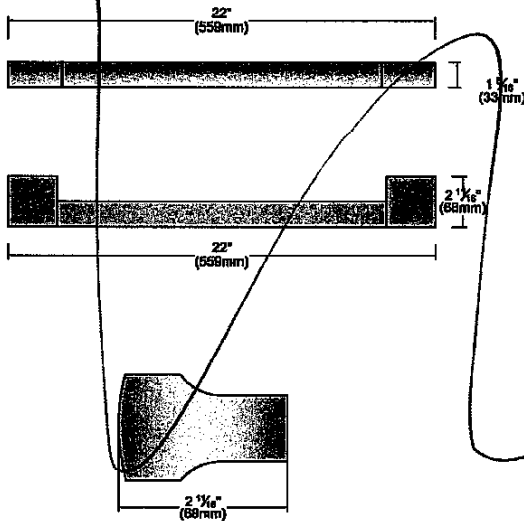

Please note hinges may require adjusting or replacing when changing from a Pureline or Signature handle to a ContourLine Handle.

hot 20  
Per 2

PureLine 24" Microwave Oven  
M 6260 TC



INSTALLATION SPECIFICATIONS

Side flush

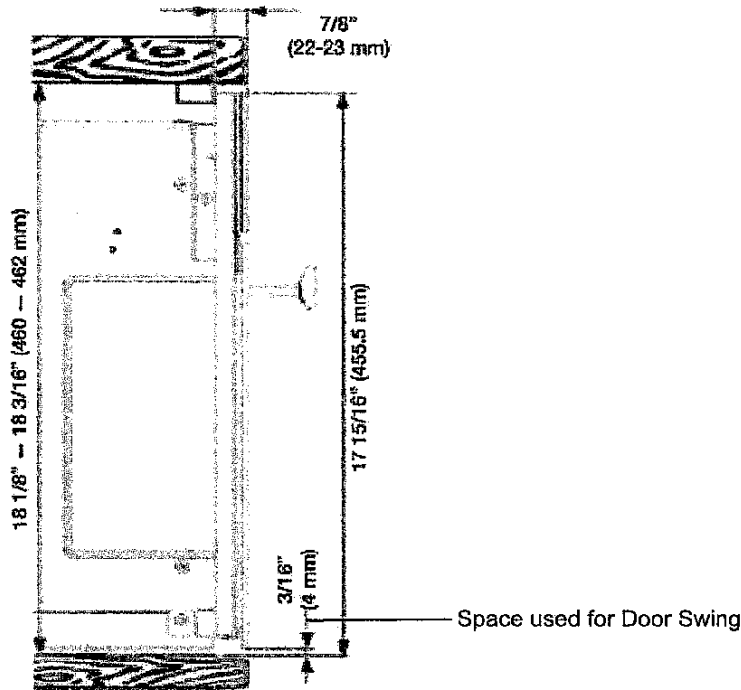

Side proud

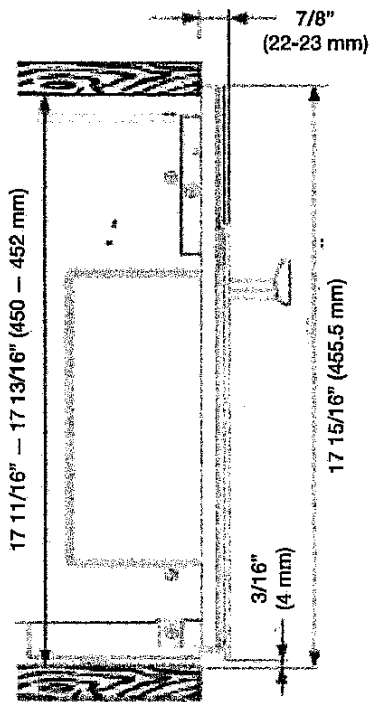

Lot 20  
Car 2

# PureLine 24" Microwave Oven M 6260 TC



## INSTALLATION SPECIFICATIONS

Install in Tall Cabinet

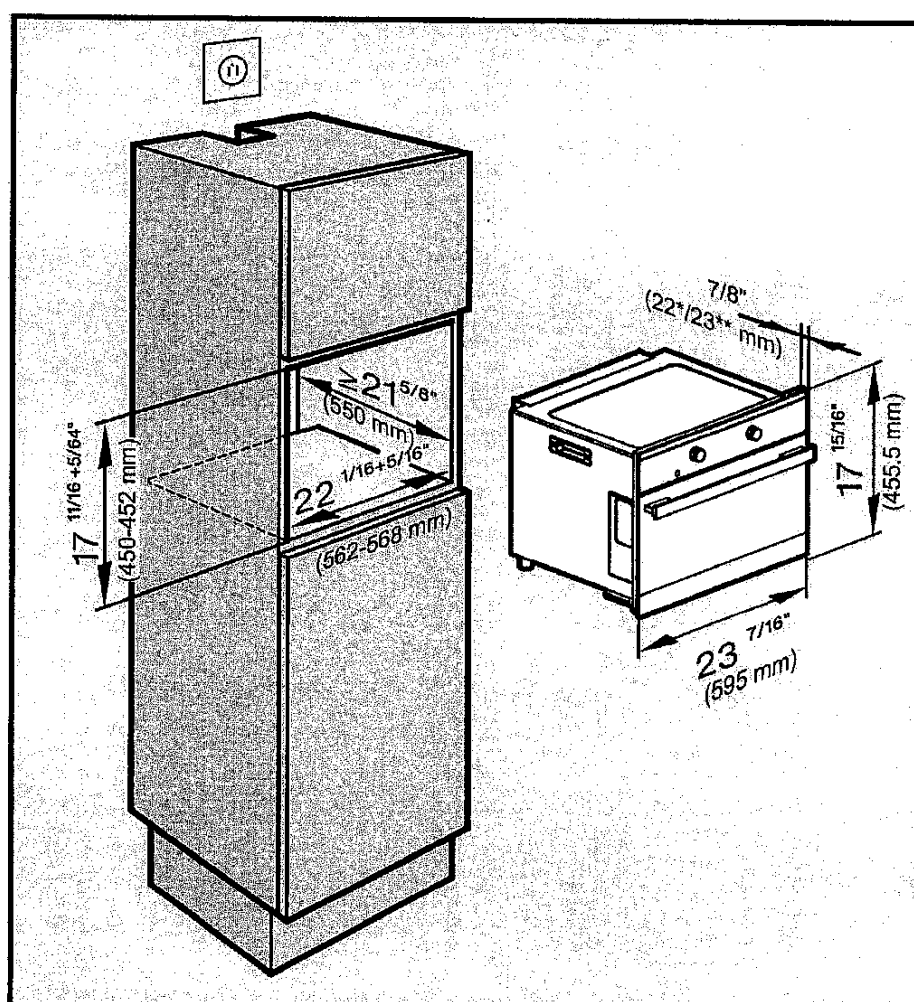

- \* Oven with glass front
- \*\* Oven with metal front

Lot 20  
Mer 2

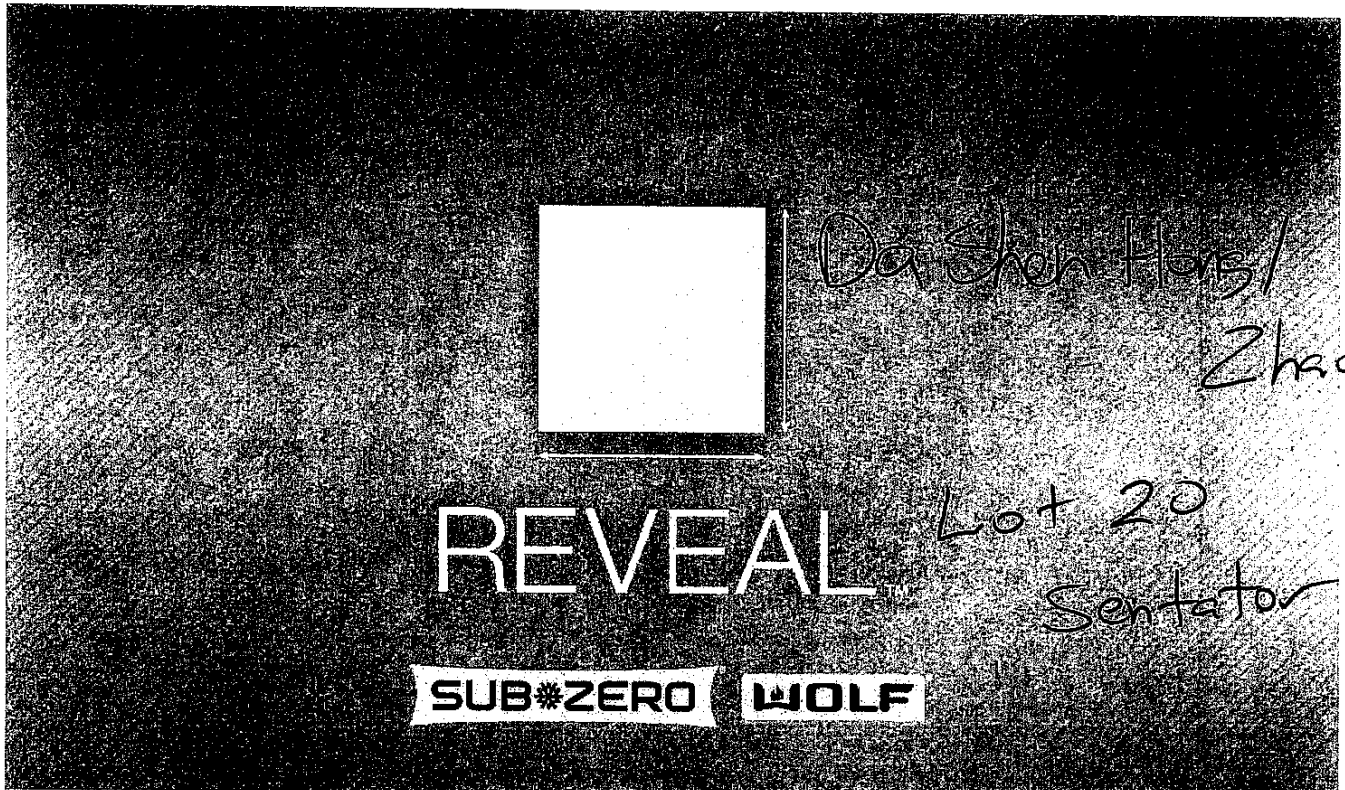

## My Reveal Project

For help with questions about the specifications provided for your configuration, call us toll-free between 8am-5pm CST at [\(866\) 689-9653](tel:8666899653).

Disclaimer: We strongly recommend saving all Reveal configurations to "My Sub-Zero Account" to ensure the most up-to-date specification information is reflected on your shared documents as product specifications are subject to change without notice. Otherwise, we suggest that this configuration be recreated prior to finalizing your cabinetry enclosures.

specs for:

30" fridge

18" wine

18" freezer

combo install  
stainless panels  
purchase

hot 20  
Per 2

REVEAL

SUB-ZERO WOLF

Group 1: Opening and Panel Specs, Stainless Panels, 4" Toe Kick, Pro Handles

Specifications:

Specifications Summary

Planning Notes

Front View

Side View

Top View

Top View Detail

IC-18FI Additional Requirements

IC-30R Additional Requirements

IW-18 Additional Requirements



IC-18FI

18" Integrated Column Freezer with Ice Maker - Panel Ready, Left Hinge



IW-18

18" Integrated Wine Storage - Panel Ready, Left Hinge, No Lock



IC-30R

30" Integrated Column Refrigerator - Panel Ready, Right Hinge



7023628

Integrated Handle-to-Handle Dual Installation Kit



7025304

30" Integrated Column Door Panel, Stainless Steel with Pro Handle, 4" Toe Kick, Right Hinge



7025325

18" Integrated Column Door Panel, Stainless Steel with Pro Handle, 4" Toe Kick, Left Hinge



7025329

18" Integrated Wine Column Door Panel, Stainless Steel with Pro Handle, 4" Toe Kick, Left Hinge



7029829













Integrated Handle-to-Hinge Dual Installation Kit

hot 20  
par 2



Specifications Summary

Group 1

MODEL	OVERALL DIMENSIONS	WEIGHT	OPENING DIMENSIONS
IC-30R <a href="#">3D Studio Max (3DS)</a> <a href="#">3D AutoCad (DWG)</a> <a href="#">2D AutoCad (DWG)</a> <a href="#">AutoCad (DXF)</a> <a href="#">ArchiCad (GSM)</a> <a href="#">3D Studio Max (MAX)</a> <a href="#">Wavefront 3D (OBJ)</a> <a href="#">Revit Files (RFA)</a> <a href="#">SketchUp (SKP)</a> <a href="#">QR SHEET</a> <a href="#">Subzero Design Guide</a> <a href="#">Model Detail</a>	30"  84"  24" 	400 lbs	66"  84"  25" 
IC-18FI <a href="#">3D Studio Max (3DS)</a> <a href="#">3D AutoCad (DWG)</a> <a href="#">2D AutoCad (DWG)</a> <a href="#">AutoCad (DXF)</a> <a href="#">ArchiCad (GSM)</a> <a href="#">3D Studio Max (MAX)</a> <a href="#">Wavefront 3D (OBJ)</a> <a href="#">Revit Files (RFA)</a> <a href="#">SketchUp (SKP)</a> <a href="#">QR SHEET</a> <a href="#">Subzero Design Guide</a> <a href="#">Model Detail</a>	18"  84"  24" 	260 lbs	
IW-18 <a href="#">3D Studio Max (3DS)</a> <a href="#">3D AutoCad (DWG)</a> <a href="#">2D AutoCad (DWG)</a> <a href="#">AutoCad (DXF)</a> <a href="#">ArchiCad (GSM)</a> <a href="#">3D Studio Max (MAX)</a> <a href="#">Wavefront 3D (OBJ)</a> <a href="#">Revit Files (RFA)</a> <a href="#">SketchUp (SKP)</a> <a href="#">QR SHEET</a> <a href="#">Subzero Design Guide</a> <a href="#">Model Detail</a>	18"  84"  24" 	350 lbs	

18" Integrated Column Door Panel, Stainless Steel with Pro Handle, 4" Toe Kick, Left Hinge (7025325)

Integrated Handle-to-Hinge Dual Installation Kit (7029829)

18" Integrated Wine Column Door Panel, Stainless Steel with Pro Handle, 4" Toe Kick, Left Hinge (7025329)

Integrated Handle-to-Handle Dual Installation Kit (7023628)

30" Integrated Column Door Panel, Stainless Steel with Pro Handle, 4" Toe Kick, Right Hinge (7025304)



Lot 20  
Car 2



Planning Notes

Group 1

Integrated Refrigeration

The depth of each integrated model is 24" (610). Allow for panel thickness when planning the finished opening depth. A minimum 3 1/2" (89) finished return is required on all sides of the opening. Framed cabinets will require additional finished filler material behind the face frame for a proper installation.

Front View

Group 1

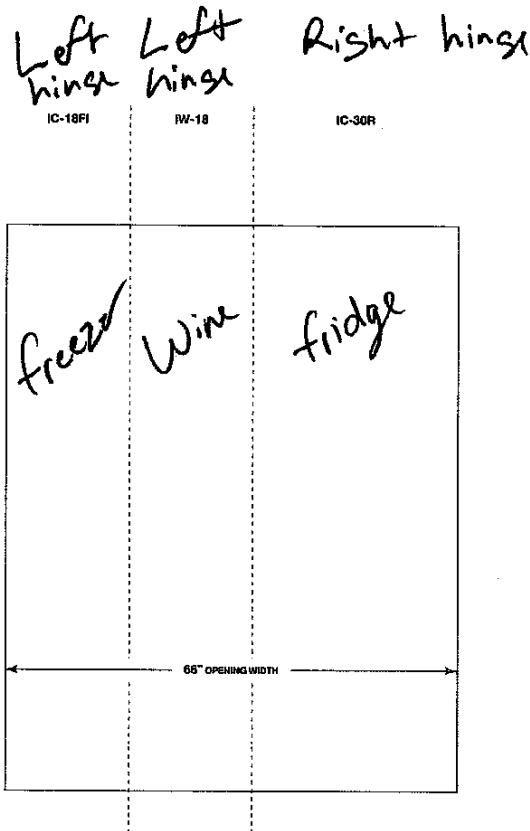



hot 20  
Per 2

REVEL

SUB•ZERO WOLF

## Top View

Group 1

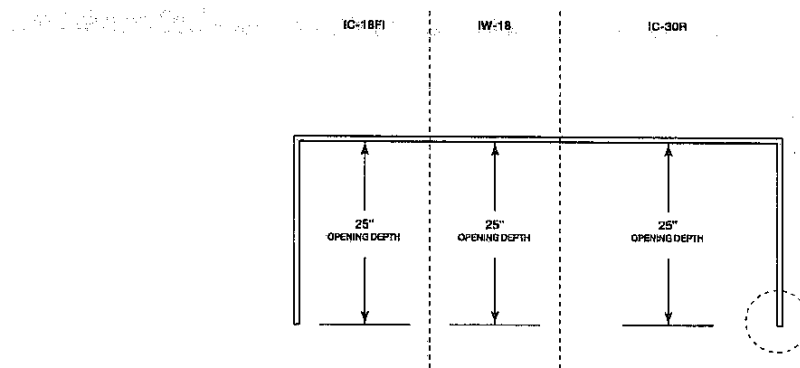

## Top View Detail

Group 1

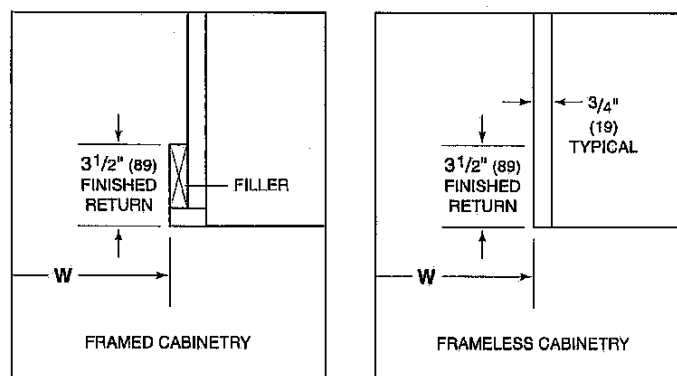

The depth of each integrated model is 24" (610). Allow for panel thickness when planning the finished opening depth. A minimum 3 1/2" (89) finished return is required on all sides of the opening. Framed cabinets will require additional finished filler material behind the face frame for a proper installation.

hot 20  
Car 2



Side View

Group 1

All Models

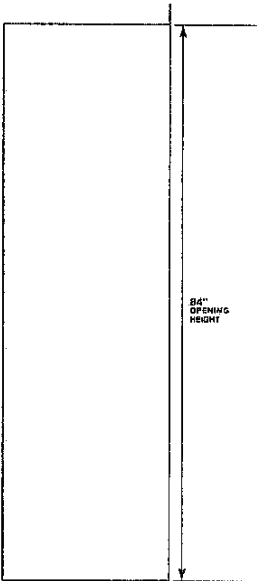

hot 20  
Per 2



IC-18FI Overall Dimensions

Group 1

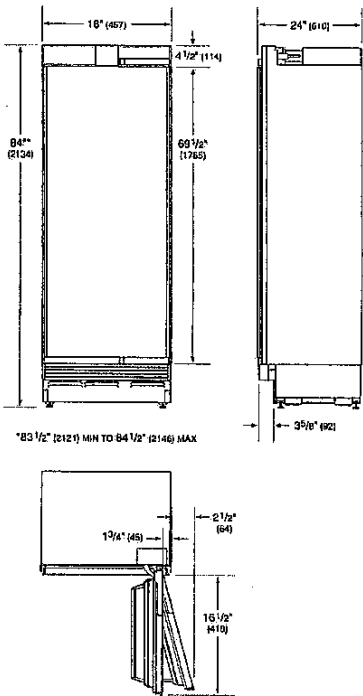

IC-18FI Electrical

Group 1

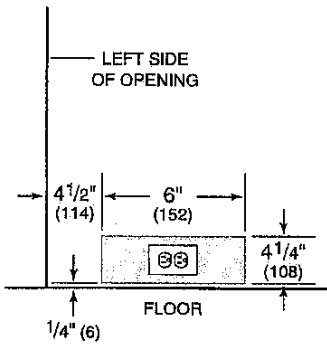

Electrical Supply	grounded, 115 VAC, 60 Hz
Electrical Service	15 amp dedicated circuit
Receptacle	3-prong grounding-type

**WARNING**

Installation must comply with all applicable electrical codes.

A separate circuit, servicing only this appliance is required. A ground fault circuit interrupter (GFCI) is not recommended and may cause interruption of operation. Installation must comply with all applicable electrical codes.

hot 20  
bar 2

REYBA

SUB-ZERO WOLF

## IC-18FI Plumbing

Group 1

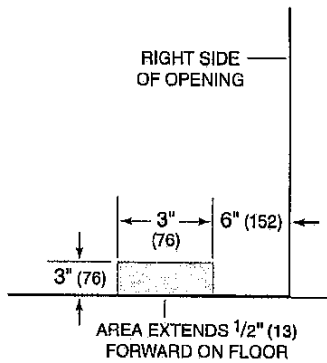

Excess Line For Connection 36"

The water supply line should be connected to the house supply with an easily accessible shut-off valve. Do not use self-piercing valves. The water supply line must not interfere with installation of the anti-tip brackets. A reverse osmosis system can be used provided there is constant water pressure of 35–120 psi (2.4–8.3 bar) supplied to the unit at all times. A copper line is not recommended for this application. Installation must comply with all applicable plumbing codes.

**SUBZERO WOLF**

**Group 1**

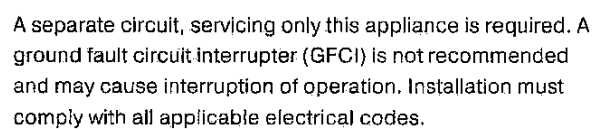
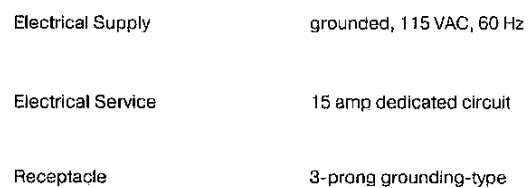

hot 20  
Per 2

REVEAL

SUB-ZERO WOLF

IW-18 Overall Dimensions

Group 1

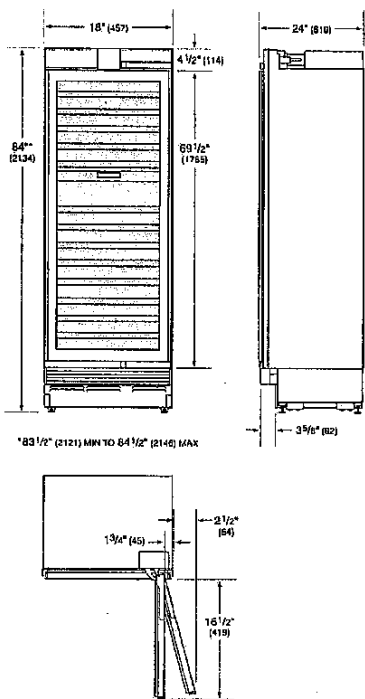

IW-18 Electrical

Group 1

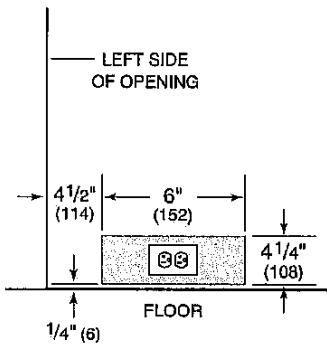

Electrical Supply	grounded, 115 VAC, 60 Hz
Electrical Service	15 amp dedicated circuit
Receptacle	3-prong grounding-type

WARNING

Installation must comply with all applicable electrical codes.

best

Hot 20  
Cera  
SPECIFICATION SHEET

PIK SERIES  
INSERT

Revised hood  
insert  
Lot 20  
Da Shun Hong

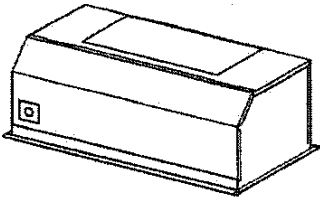

Especially designed to be installed in custom hood  
for use over residential commercial-style cooking  
surfaces.

FEATURES

- Cabinet mount – custom application
- Widths: 33", 45"
- Halogen lighting (33" – 2 x 50 watt; 45" – 3 x 50 watt GU10) Lamps included
- Slide controls: Lighting, on-off, infinite speed
- Easily accessible, dishwasher-safe stainless steel baffle filters
- Heat Sentry™ turns blower ON to HIGH speed when excess heat is detected
- For indoor use only

OPTIONS

- Custom hood liners (L33 or L45 Series):  
Widths - 36", 42", 48", 54" and 60"  
Adjustable depth - see liner spec. sheet for details  
Stainless Steel construction - protects custom hood base and wipes clean easily
- Ambient light panel (ALP Series) for L Series custom hood liners (Halogen lighting: 36" and 42" – 2 x 50 watt; 48", 54" and 60" – 3 x 50 watt GU10) Lamps included
- Backsplash (RMP Series):  
Widths - 36", 42", 48", 60"  
Stainless Steel construction - protects back wall and wipes clean easily
- WCPI Remote control: With Stainless Steel faceplate, to fit any décor.

INSERT SPECIFICATIONS

120 VAC, 60 Hz  
Amps (without blower) 0.8 (PIK33), 1.3 (PIK45)

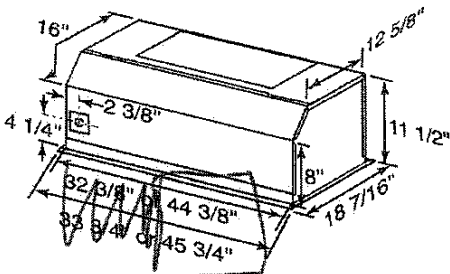

Mount insert so bottom of custom hood is 24" to 30" above cooking surface.

Custom Hood Liner  
L33 or L45 Series

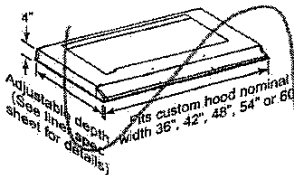

Ambient Light Panel  
ALP Series

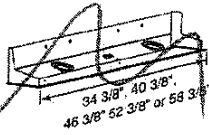

WCPI Remote Control

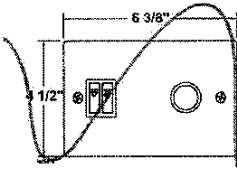

Backsplash  
RMP Series

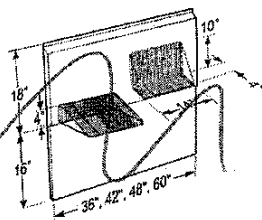

BEST Hartford, Wisconsin www.BestRangeHoods.com 800-558-1711  
BEST Drummondville, QC Canada www.BestRangeHoods.com 866-737-7770

REFERENCE	QTY.	REMARKS	Project	
			Location	
			Architect	
			Engineer	
			Contractor	
			Submitted by	Date

# PIK MOUNTING

## SIZE OF THE CUT-OUT

NOTE: If optional L series liner is used, refer to installation instructions for size and location of the cut-out.

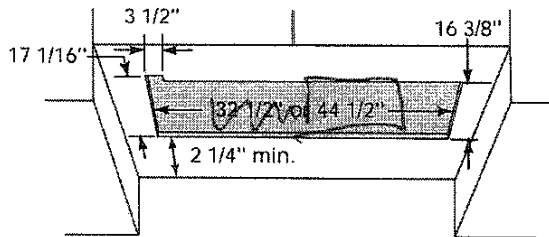

NOTE: The 3 1/2" notch must be cut only if the WCPI optional wall control will be installed.

no notch

## Suggested Custom Hood Internal Framework

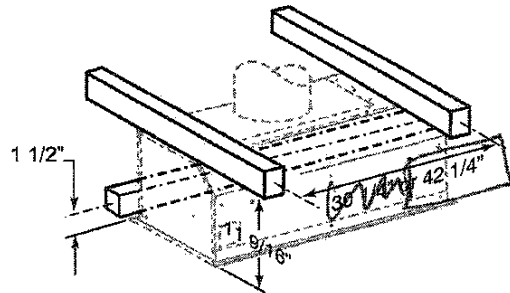

## - PIK33 AND PIK45 INSERT SYSTEM - INTERIOR BLOWERS

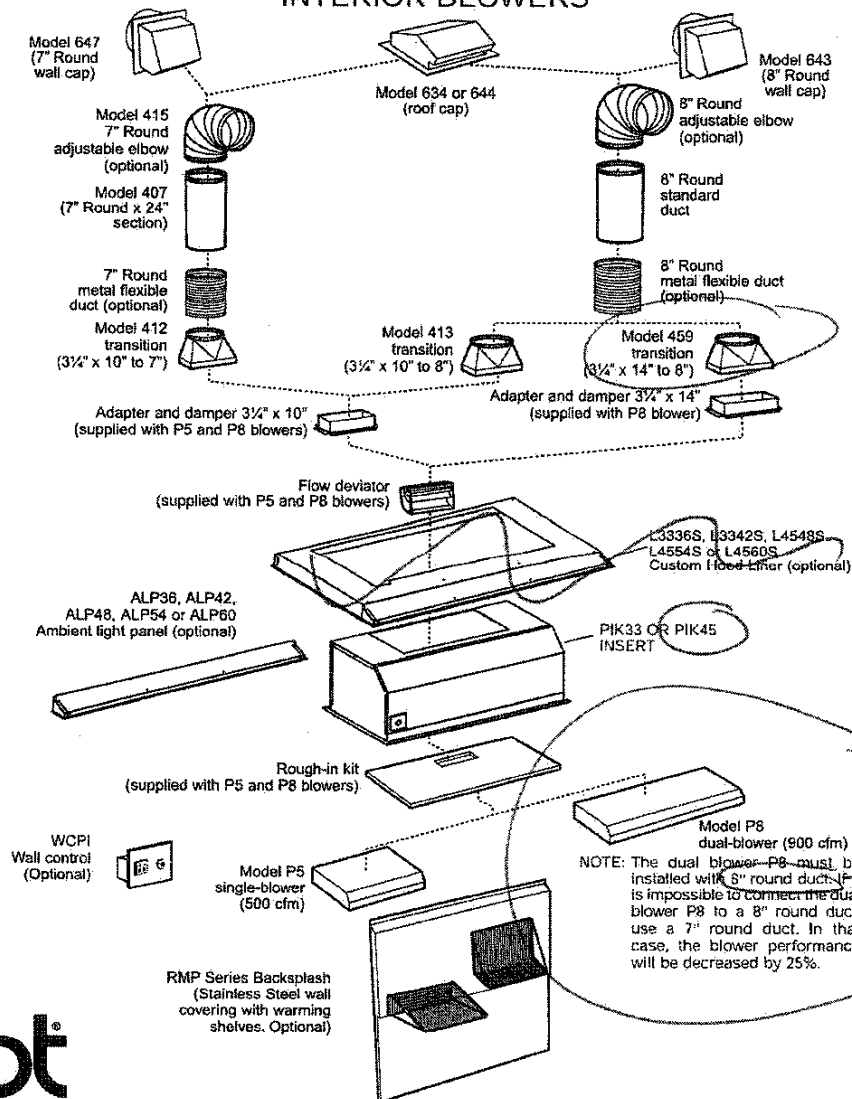

included

duct size

best



hot 20  
Car 2

## 48" GAS RANGE - 6 BURNERS AND INFRARED GRIDDLE

GR486G



### FEATURES

- 6 dual-stacked burners plus 15,000 Btu infrared griddle
- Continuous cast-iron grates for easy movement of pots and pans
- Convection oven for faster, more consistent cooking
- Infrared broiler inside 30" oven sears quickly and evenly
- Dual-stacked, sealed burners for higher highs, lower lows
- Second, 18" non-convection oven
- Rigorously tested in our U.S. manufacturing facilities for decades of use
- Exceptional 24/7 support from our Customer Care team in Madison
- Heavy-gauge stainless steel
- Signature red infinite control knobs
- Spark ignition system re-ignites if flame goes out
- Adjustable legs for stability, plus rear casters

### ACCESSORIES

- 11" Cutting Board
- Bake stone kit (stone, rack and peel)
- Stainless steel, brass or chrome bezels
- High altitude conversion kit
- Full-extension easy glide oven rack
- Cast iron S-grates and wok grate
- Stainless steel kickplate
- Signature red, black or stainless steel control knobs
- Front leg covers
- 5" and 10" stainless steel risers, and 20" riser with shelf

Accessories available through an authorized Sub-Zero dealer.  
For local dealer information, visit [subzero-wolf.com/locator](http://subzero-wolf.com/locator).

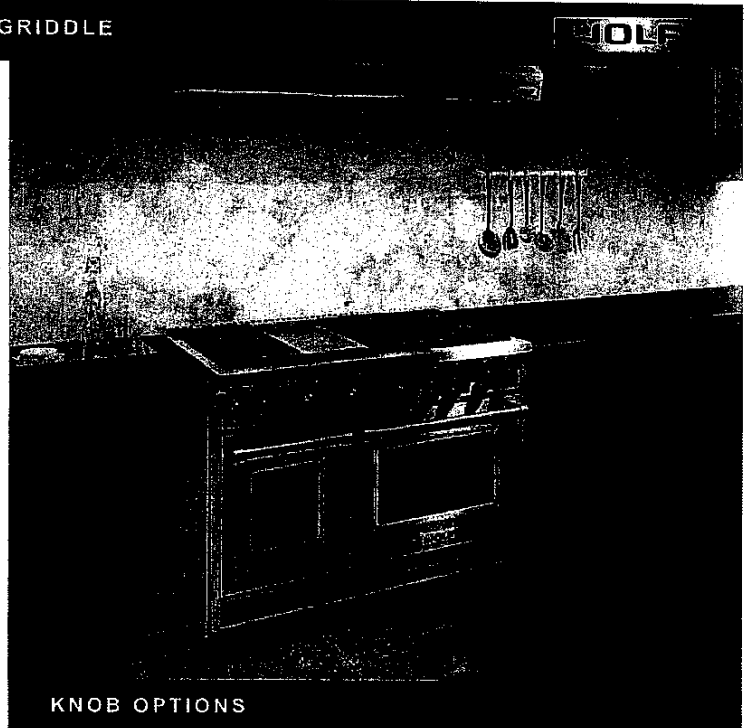

KNOB OPTIONS



### TOP CONFIGURATION

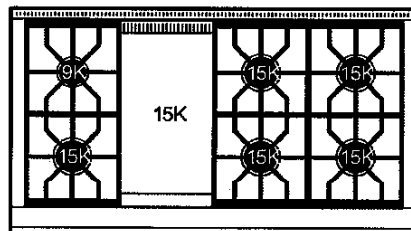

### RANGETOP SPECIFICATIONS

- 1 - 9,200 Btu Burner
- 5 - 15,000 Btu Burners
- 1 - 15,000 Btu (13,000 Btu LP) Griddle

48" GAS RANGE - 6 BURNERS AND INFRARED GRIDDLE

## DIMENSIONS

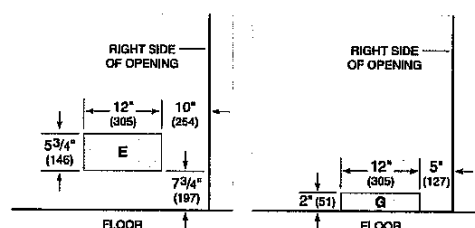
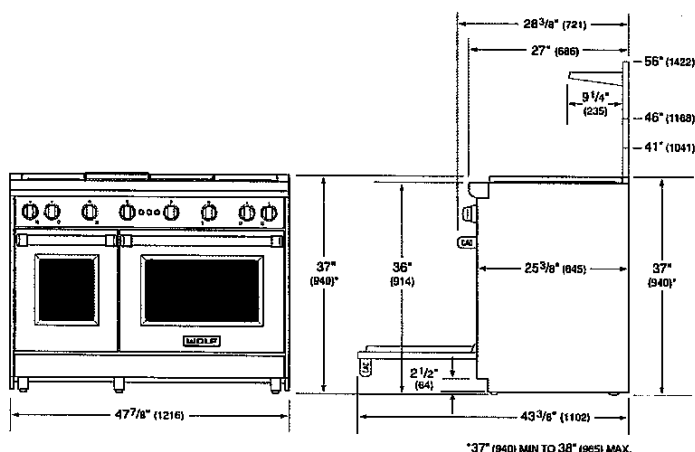

## STANDARD INSTALLATION

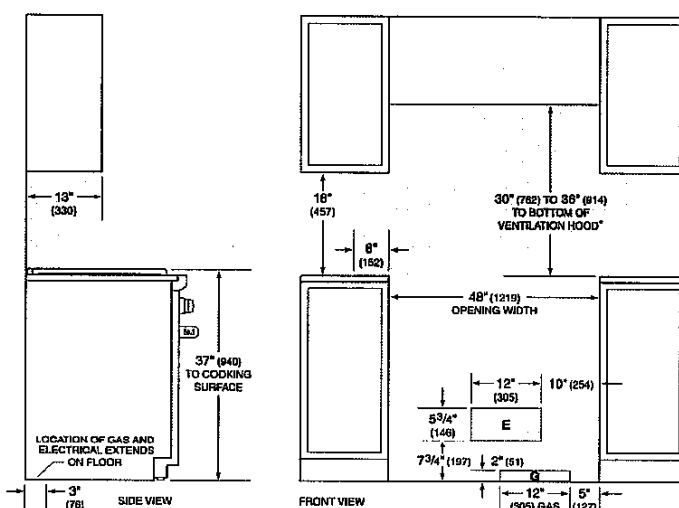

\*Without ventilation hood, 42" (1067) minimum clearance countertop to combustible materials, charcoal grill and GF408 require non-combustible materials.  
NOTE: Shaded area above countertop indicates minimum clearance to combustible surfaces, combustible materials cannot be located within this area.  
For island installation, 12" (305) minimum clearance back of range to combustible rear wall above countertop.

hot 20  
Mar 2

24" BUILT-IN DISHWASHER—INTEGRATED HANDLE

**ASKO**  
Designed by Scandinavia

**MODEL D5426XLS**



**FEATURES**

Integrated handle and front controls

TouchProof™ stainless steel

Condensation drying system

15 place-setting capacity

Quiet operation—46 dB(A)

7Spray™ wash system; separate spray nozzles clean pot & pans and continuously spray cutlery basket

6 wash programs

Heavy-duty stainless steel construction with nylon-coated steel racks

Touch screen display

Remaining time and program end indicator

ADA height compliant

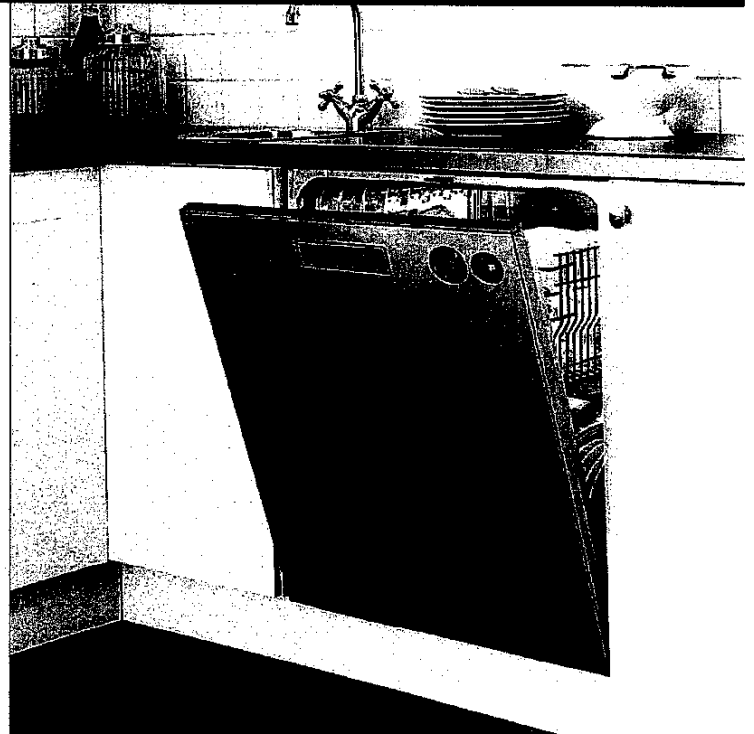

**INTERIOR FEATURES**

- Standard upper rack
- Standard lower rack

**PROGRAMS**

- Sanitation Wash
- Normal Wash
- Heavy Wash
- Quick Wash
- Eco Wash
- Rinse and Hold

hot20  
Mar 2

24" BUILT-IN DISHWASHER—INTEGRATED HANDLE



PRODUCT SPECIFICATIONS

Model	D5426XLS
Width	23 <sup>7</sup> / <sub>8</sub> "
Height	32 <sup>3</sup> / <sub>4</sub> "**– 34 <sup>3</sup> / <sub>4</sub> "
Depth	22 <sup>7</sup> / <sub>8</sub> "
Door Clearance	24 <sup>5</sup> / <sub>8</sub> "
Weight	115 lb
Max Loading Height Upper Rack	9"
Max Loading Height Lower Rack	12 <sup>1</sup> / <sub>4</sub> "
Electrical Supply	115 VAC, 60 Hz
Electrical Service	15 amp circuit
Plumbing Supply	1/4" OD copper, braided stainless steel or PEX tubing
Pressure	4.2–140 psi

Electrical supply, plumbing supply and drain should be located in an adjacent cabinet. If not, they must be located within the shaded area shown in the illustrations below.

ELECTRICAL | PLUMBING

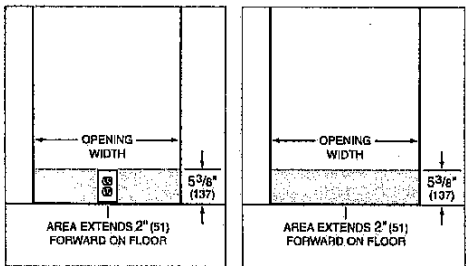

DIMENSIONS

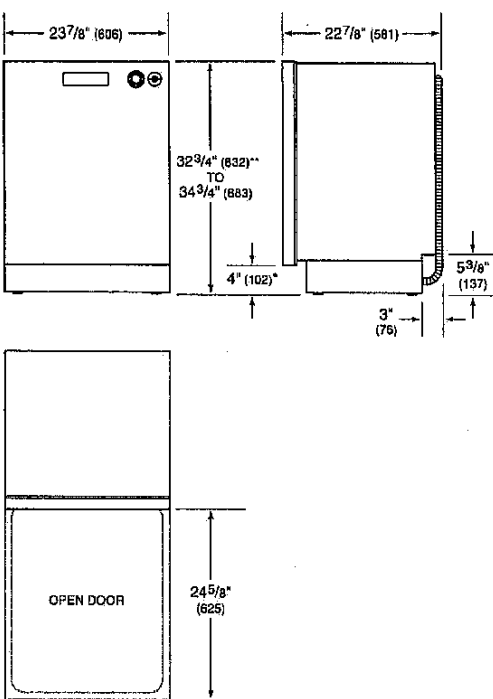

\*Dimension will vary with product height.  
\*\*Can be reduced to 32<sup>1</sup>/<sub>4</sub>" (819) by removing top trim and lowering side trim.

INSTALLATION

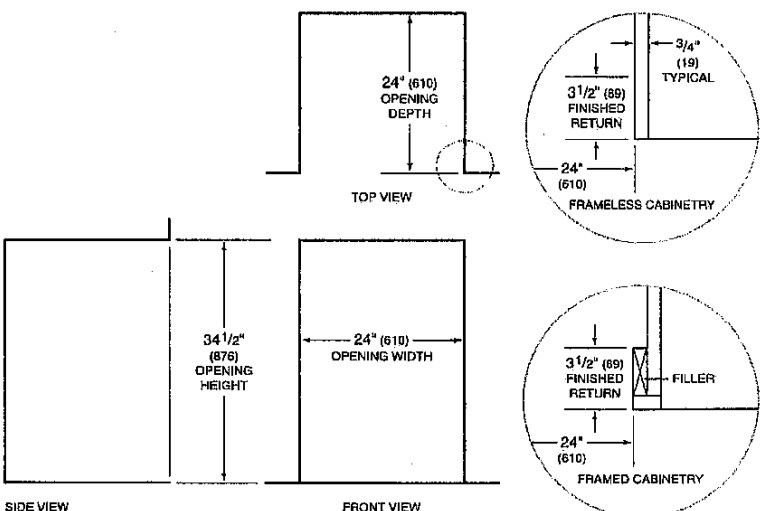

NOTE: 3 1/2" (89) finished returns will be visible and should be finished to match cabinetry.

hot20  
hera2

# WA50M7450AP

Samsung Top-Load Washer

5.0 cu. ft. Capacity DOE

SAMSUNG

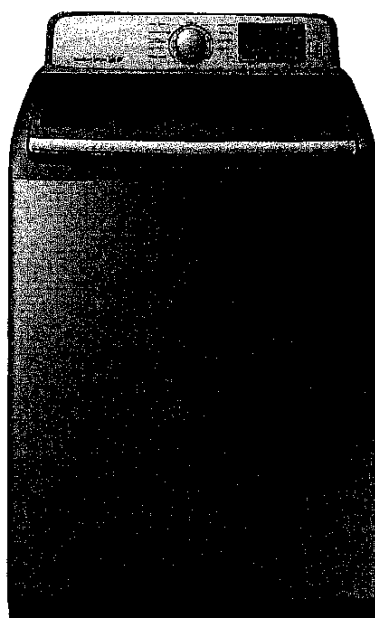

## Signature Features

### 5.0 cu. ft. Capacity

- Fewer washes, less time in the laundry room.

### VRT Plus™ Technology

- Reduces vibration 40% more than standard VRT™ for quiet washing.\*

\*Based on Owens Corning sounds power testing.

### Self Clean

- Keeps your laundry drum fresh and odor-free.
- Sends reminders to clean the tub every forty wash cycles.

## Available Color



Platinum



5.0 cu. ft. Capacity

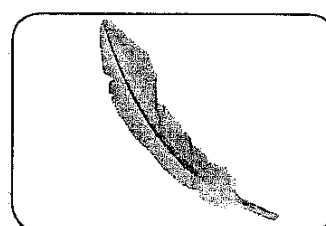

VRT Plus™ Technology

## Features

- 5.0 cu. ft. Capacity
- VRT Plus™ Technology
- Self Clean
- Smart Care
- Diamond Drum Design
- EZ Drawer Dispenser
- 800 RPM Maximum Spin Speed
- Stainless Steel Pulsator
- Direct Drive Motor
- 11 Preset Wash Cycles
- 7 Options
- LED Display: Ice Blue
- Door Lid: Chrome Deco Tinted Glass
- Soft-Close Lid

## Convenience

- Child Lock
- Delay End
- 5 Temperature Settings
- 4 Spin Settings
- 3 Soil Settings
- Dispenser Trays: Main Wash, Softener, Bleach (Auto)

## Rating



ENERGY STAR®-rated

IMEF = 2.06

IWF = 4.3

140 kWh/yr

hot 20  
Per 2

# WA50M7450AP

SAMSUNG

Samsung Top-Load Washer  
5.0 cu. ft. Capacity DOE

## Installation Specifications

Alcove or closet installation

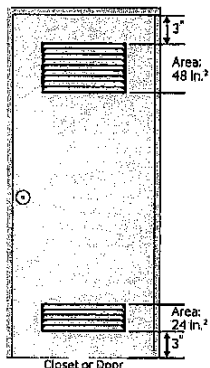
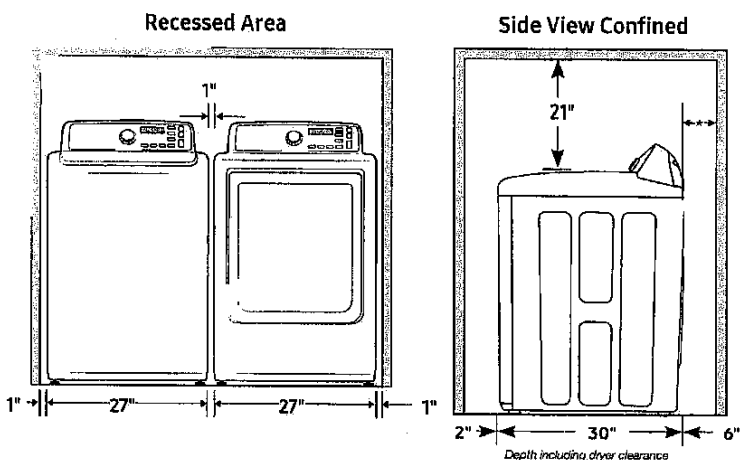

Minimum clearances for closets and alcoves:

Sides – 1"  
Top – 21"  
Rear – 6"  
Closet Front – 2"

If the washer and dryer are installed together, the closet front must have at least a 72-inch² unobstructed air opening. Your washer alone does not require a specific air opening.

\*Required spacing (External exhaust elbow may require additional space.)

### 11 Preset Wash Cycles:

Normal, Bedding/WaterProof, Heavy Duty, Permanent Press, Brilliant Whites, Active Wear, Delicates/Hand Wash, Quick Wash, Rinse and Spin, Spin Only, Deep Wash

### 7 Options:

Self Clean, Delay End, Pre Soak, Extra Rinse, Sound On/Off, Child Lock, Smart Care

### 5 Temperature Settings:

Hot, Warm, Eco Warm, Cold, Cool

### 4 Spin Settings:

High, Medium, Low, No Spin

### 3 Soil Settings:

Heavy, Normal, Light

### 2 Sound Level Settings:

On/Off

### Dispenser Trays:

Main Wash, Softener, Bleach (Auto)

### Warranty

One (1) Year Parts and Labor  
Three (3) Years Stainless Steel Drum (Part Only)  
Ten (10) Years Direct Drive Motor (Part Only)

### Product Dimensions & Weight (WxHxD)

Dimensions: 27" x 45" x 29<sup>5</sup>/<sub>16</sub>"  
Weight: 141.1 lbs

### Shipping Dimensions & Weight (WxHxD)

Dimensions: 29<sup>1</sup>/<sub>2</sub>" x 47<sup>3</sup>/<sub>4</sub>" x 31"  
Weight: 152.1 lbs

## Dimensions

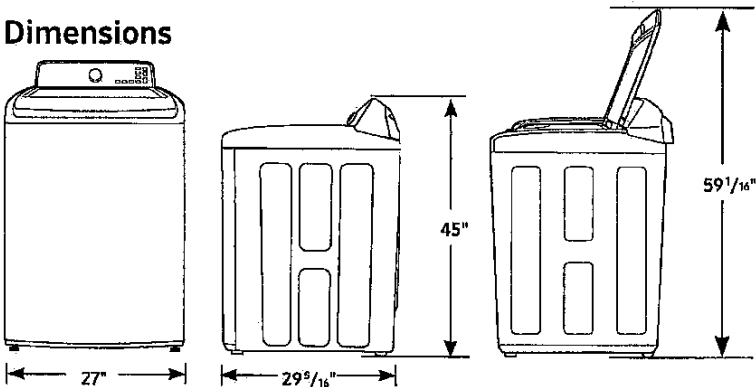

Color	Model #	UPC Code
Platinum	WA50M7450AP	887276196404

### Matching Dryer (Electric/Gas)

Platinum	DVE50M7450P	887276223674
Platinum	DVG50M7450P	887276223681

hot 20  
Per 2

# DVE50M7450P

Samsung Electric Dryer

7.4 cu. ft. Capacity DOE

SAMSUNG

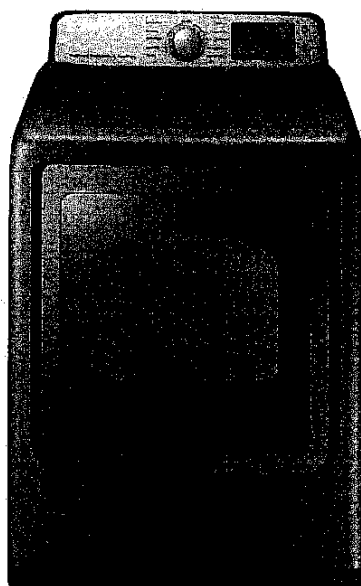

## Signature Features

### Multi-Steam Technology

- Steam away wrinkles, odors, bacteria, and static.

### Eco Dry

- Uses up to 25% less energy for every load.

### Sensor Dry

- Optimizes the time and temperature to dry clothes thoroughly, avoiding heat damage.

## Available Color



Platinum

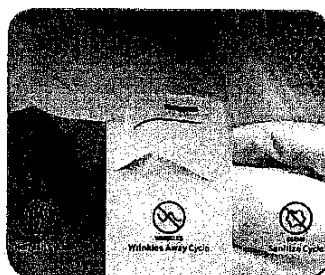

Multi-Steam Technology

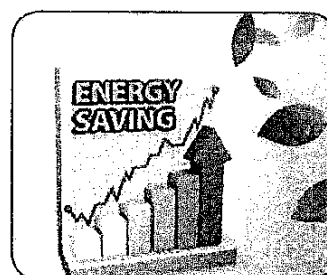

Eco Dry

## Features

- Multi-Steam Technology
- Eco Dry
- Sensor Dry
- Smart Care
- 11 Preset Dry Cycles
- 7 Options
- 4 Temperature Settings
- Interior Drum Light
- 7.4 cu. ft. Capacity
- LED Display: Ice Blue
- Reversible See-Through Door
- Wrinkle Prevent Option
- 4-Way Venting
- Powder Coat Interior

## Convenience

- Child Lock
- Filter Check Indicator

hot 20  
Carz

# DVE50M7450P

Samsung Electric Dryer  
7.4 cu. ft. Capacity DOE

SAMSUNG

## Installation Specifications

Alcove or closet installation

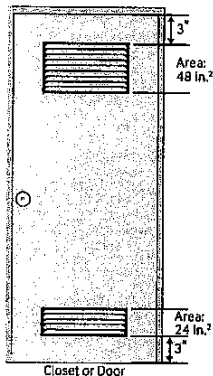
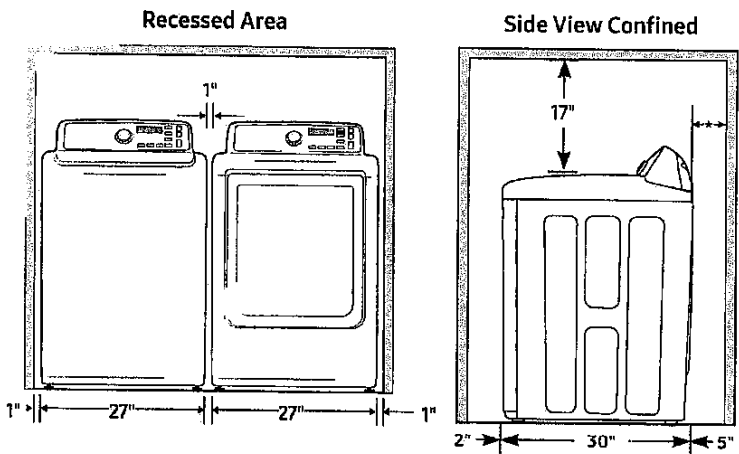

Minimum clearances for closets and alcoves:

Sides – 1"  
Top – 17"  
Rear – 5"  
Closet Front – 2"

If the washer and dryer are installed together, the closet front must have at least a 72-inch<sup>2</sup> unobstructed air opening. Your washer alone does not require a specific air opening.

\*Required spacing (External exhaust elbow may require additional space.)

### 4-Way Venting

#### 11 Preset Dry Cycles:

Steam Refresh, Steam Sanitize, Steam Wrinkle Away, Normal, Heavy Duty, Towels, Permanent Press, Bedding, Delicates, Time Dry, Quick Dry

#### 7 Options:

Wrinkle Prevent, Adjust Time (up), Adjust Time (down), Child Lock, Eco Dry, Smart Care, Drum Light

#### 4 Temperature Settings:

High, Medium, Low, Extra Low

#### 4 Dry Levels:

Very Dry, More Dry, Normal Dry, Damp Dry

#### 2 Sound Level Settings:

On/Off

#### Warranty

One (1) Year Parts and Labor

#### Product Dimensions & Weight (WxHxD)

Dimensions: 27" x 45" x 30"

Weight: 121.3 lbs

#### Shipping Dimensions & Weight (WxHxD)

Dimensions: 29<sup>1</sup>/<sub>2</sub>" x 47<sup>3</sup>/<sub>4</sub>" x 31<sup>3</sup>/<sub>16</sub>"

Weight: 130.1 lbs

Electric	Model #	UPC Code
Platinum	DVE50M7450P	887276223674
Gas		
Platinum	DVG50M7450P	887276223681
Matching Washer		
Platinum	WA50M7450AP	887276196404

## Dimensions

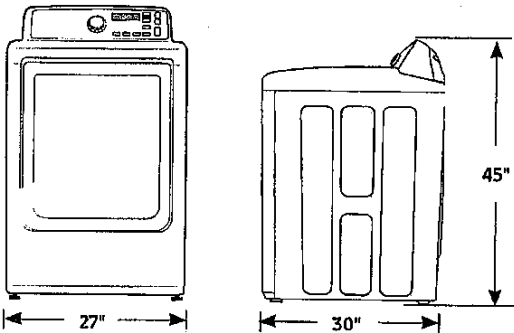

Actual color may vary. Design, specifications, and color availability are subject to change without notice. Non-metric weights and measurements are approximate.  
©2016 Samsung Electronics America, Inc. 85 Challenger Road, Ridgefield Park, NJ 07660. Tel: 800-SAMSUNG. samsung.com. Samsung is a registered trademark of Samsung Electronics Co., Ltd.