



CONSTRUCTION SUMMARY

Carrville Investments Ltd. / Richvale

Lot/Unit: 40    Phase/Building: 1    Model/Floor Plan: The Spruce (20-2) Elev B

AUDIO AND SECURITY

Inv.3720	1 - AUDIO & SECURITY	
	LOCATION: GRAND ALARMS	
	GRAND ALARMS TO CONTACT PURCHASER DIRECTLY TO LOCATE STANDARD CABLE AND TELEPHONE ROUGH IN.	
	CONTACT AT GRAND ALARMS: JACQUELINE (416) 410-3020	
Line 48350	Note:	
5Jul16 / 5Jul16		

CABINETRY

Inv.3720	1 - LOCATION: KITCHEN	
	SUPPLY FINISHED SIDES TO UPPER CABINETS ON EITHER SIDE OF STOVE. THE STANDARD 77CM WIDE STOVE UPPER AND STANDARD FAN WILL BE INSTALLED FOR OCCUPANCY PURPOSES. CABINET AND FAN WILL BE REMOVED BY PURCHASER AFTER CLOSING.	
Line 48352	Note: BUILDER WILL NOT BE HELD RESPONSIBLE FOR ANY DAMAGE TO WALL OF ADJACENT CABINETRY REMOVAL.	
5Jul16 / 5Jul16		

CABINETRY ACCESSORIES

Inv.3720	1 - LOCATION: KITCHEN	
	SUPPLY AND INSTALL LARGE FASCIA PANEL AND CROWN MOULDING TO UPPER CABINETS IN KITCHEN TO CLOSE OFF SPACE BETWEEN CEILING AND/OR BULKHEAD AND CABINETS.	
Line 48363	Note: AS PER FRENDEL KITCHEN LAYOUT	
5Jul16 / 5Jul16		

CABINETRY APPLIANCE - FRIDGE

Inv.3720	1 - 66 CM FRIDGE CABINET - 1 GABLE 66 CM & CABINET 59 CM DEEP - SEE 66CM DEEP PANTRY IF ADJACENT TO PANTRY - COUNTER DEPTH - UPGRADE 1	
Line 48351	Note: SEE FRENDEL KITCHEN LAYOUT FOR LOCATION	
5Jul16 / 5Jul16		

CABINETRY BASE CABINETS

Inv.3720	1 - LOCATION: KITCHEN	
	BASE PIE CUT CORNER - UPGRADE 1	
Line 48364	Note: SEE FRENDEL KITCHEN LAYOUT FOR LOCATION	
5Jul16 / 5Jul16		

CABINETRY WALL AND HUTCH

Inv.3720	1 - LOCATION: KITCHEN	
	UPPER ANGLE CORNER - PRICE IS PER UNIT - UPGRADE 1	
Line 48365	Note: SEE FRENDEL KITCHEN LAYOUT FOR LOCATION	
5Jul16 / 5Jul16		

COUNTER TOP - GRANITE



CONSTRUCTION SUMMARY

Carrville Investments Ltd. / Richvale

Lot/Unit: 40    Phase/Building: 1    Model/Floor Plan: The Spruce (20-2) Elev B

Inv.3720	1 - COUNTER TOP - GROUP 3 - KITCHEN - 3CM WITH FE30 EDGE PROFILE	
	GHIBLI GRANITE	
Line 48354	Note:	
5Jul16 / 5Jul16		

ELECTRICAL

Inv.3720	1 - LOCATION: KITCHEN	
	SUPPLY AND INSTALL ADDITIONAL INTERIOR RECEPTACLE ON SEPARATE CIRCUIT TO ACCOMMODATE INSTALL OF FUTURE CHIMNEY HOOD FAN.	
Line 48353	Note: PURCHASE TO SUPPLY AND INSTALL OWN HOOD FAN AFTER CLOSING	
5Jul16 / 5Jul16		

STAIRS AND RAILINGS

Inv.3720	1 - RAILING UPGRADE 4 - HANDRAIL 3 INCH OVAL OAK - PICKETS STEEL 1/2 INCH SQUARE, SINGLE COLLAR/PLAIN, WITH SHOES FLAT BLACK - POSTS 3 1/2 INCH SQUARE, CHAMFERED, WITH CAP OAK	
Line 48368	Note:	
5Jul16 / 5Jul16		

TILE

Inv.3720	1 - FLOOR TILE - UPGRADE 4 - POWDER ROOM FLOOR	
	12X24 NIAGARA FALLS - WHITE (QT.NF.WHT.1224)	
Line 48360	Note: STANDARD STACKED INSTALLATION - SEE SKETCH FOR TILE DIRECTION	
5Jul16 / 5Jul16		
Inv.3720	1 - FLOOR TILE - UPGRADE 4 - VESTIBULE FLOOR	
	12X24 NIAGARA FALLS - WHITE (QT.NF.WHT.1224)	
Line 48361	Note: STANDARD STACKED INSTALLATION - SEE SKETCH FOR TILE DIRECTION	
5Jul16 / 5Jul16		

EXTRAS AS PER OFFER

Stainless Steel Fridge, Stove and Dishwasher and front loading washer and dryer in white from Vendors standard samples, no cash value, not transferable. (Supplied only not installed) ** to arrange delivery call: The Brick commercial sales division at (416) 291-2222 Worksheet Note:	
Rogers Free Services Package includes 6 months of: home phone, TV and Internet Service. Worksheet Note:	



# INTERIOR COLOUR SCHEME

Purchaser: Silvana Basciano

Property: 40 of Plan -

Telephone Res. / Bus: (416) 550-2206 /

Project: Carrville Investments Ltd.

Decor Advisor: Veronica Ashton

Model and Elevation: The Spruce (20-2) Elev B

Layout Changes: ☐ Yes ☒ No Sketch Attached: ☐ Yes ☒ No Exterior Colour Scheme:

1. Cabinetry	Style and Colour	Counter Top	Hardware
Kitchen / Breakfast	LANCASTER PAINT - CANNOLI	*UPG 3 GHIBLI GRANITE	HANDLE 9671
Kitchen Island	LANCASTER PAINT - CANNOLI	*UPG 3 GHIBLI GRANITE	HANDLE 9671
Laundry Room	N/A	N/A	N/A
Powder Room	NEWPORT MAPLE - SHALE GREY	WHITE CARRARA 4924-38	HANDLE 9651
Main Bathroom	HUMBER - WHITE SUGAR	CIPOLLINO BIANCO 1881K-52	HANDLE 9651
Master Ensuite Bathroom	BRUSSELS MAPLE - ESPRESSO	SPRING CARNIVAL 1876K-52	HANDLE 9651
Second Ensuite Bathroom (If Applicable)	KINGSTON MAPLE - SOAPSTONE	WHITE CARRARA 4924-38	HANDLE 9677
	(LOWER LEVEL BATHROOM)	(LOWER LEVEL BATHROOM)	(LL BATHROOM)

Appliances Custom Size Fridge ☐ Yes ☒ No Valance Lighting ☐ Yes ☒ No Microwave / Range Hood ☒ Yes ☐ No

Cooktop / Rangetop ☐ Yes ☒ No Built in Wall Oven ☐ Yes ☒ No Slide-in Range ☒ Yes ☐ No

Comment STANDARD EDGE TO GRANITE IN KITCHEN

2. Flooring	Selection
Foyer	UPG 4 - 12X24 NIAGARA FALLS - WHITE (QT.NF.WHT.1224)
Main Hall	3/4" X 3-5/8" GENERATIONS OAK ENG. HARDWOOD - COBALT
Back Hall	
Breakfast	3/4" X 3-5/8" GENERATIONS OAK ENG. HARDWOOD - COBALT
Laundry Room	13X13 REFLEX - OLIVE (GE.RF.OLV.1313.)
Kitchen	3/4" X 3-5/8" GENERATIONS OAK ENG. HARDWOOD - COBALT
Powder Room	UPG 4 - 12X24 NIAGARA FALLS - WHITE (QT.NF.WHT.1224)
Main Bathroom	13X13 REFLEX - OLIVE (GE.RF.OLV.1313.)
Master Ensuite	13X13 REFLEX - WHITE (GE.RF.WH.1313)
Bathroom (If Applicable)	(LOWER LEVEL) 13X13 NEW REEDS - SILVER (GE.NR.SIL.1313)
Mud Room	
Living Room	
Dining Room	3/4" X 3-5/8" GENERATIONS OAK ENG. HARDWOOD - COBALT
Family / Great Room	3/4" X 3-5/8" GENERATIONS OAK ENG. HARDWOOD - COBALT
Den / Library / Study	
Basement Landing (If Applies)	
Lower Landing (If Applicable)	
Upper Landing	3/4" X 3-5/8" GENERATIONS OAK ENG. HARDWOOD - COBALT
Upper Hall	3/4" X 3-5/8" GENERATIONS OAK ENG. HARDWOOD - COBALT
Master Bedroom	STANDARD BERBER PAPILIO CARPET - 17185 SOFT CAMEO
Bedroom #2	STANDARD BERBER PAPILIO CARPET - 17185 SOFT CAMEO
Bedroom #3	STANDARD BERBER PAPILIO CARPET - 17185 SOFT CAMEO
Bedroom #4	
Bedroom #5	
Recreation Room	STANDARD BERBER PAPILIO CARPET - 17185 SOFT CAMEO

Flooring Continued on Page 2

Initial: SB

Page 1 of 3





## INTERIOR COLOUR SCHEME

CARV. 40 PH1

Purchaser: Silvana Basciano

Property: 40 of Plan -

Telephone Res. / Bus: (416) 550-2206 /

Project: Carrville Investments Ltd.

Decor Advisor: Veronica Ashton

Model and Elevation: The Spruce (20-2) Elev B

## 2. Flooring - Continued -

Upgrade Underpad	Type	Area
	STANDARD	RECREATION ROOM & ALL BEDROOMS
Carpet on Stairs	Capped	Runner - *Upgrade
Comment		

## 3. Plumbing Fixtures / Faucets

Kitchen	STD	Second Ensuite	STD	Powder Room	STD
Master Ensuite	STD			Other Room	
Main Bathroom					
Comment					

## 4. Wall Tile

	Tile Selection	Listello	Insert	Insert Selection
Main Bathroom	8X10 REFLECTION - WHITE (QT.RF.WHT.0810)	<input type="checkbox"/>	<input type="checkbox"/>	
Master Ensuite				
Tub Deck		<input type="checkbox"/>	<input type="checkbox"/>	
Tub Apron		<input type="checkbox"/>	<input type="checkbox"/>	
Tub Surround		<input type="checkbox"/>	<input type="checkbox"/>	
Shower Stall	8X10 REFLECTION - WHITE (QT.RF.WHT.0810)	<input type="checkbox"/>	<input type="checkbox"/>	
Second Ensuite	8X10 NEW REEDS - SILVER (QT.NR.SIL.0810)	<input type="checkbox"/>	<input type="checkbox"/>	
	(LOWER LEVEL BATHROOM)	<input type="checkbox"/>	<input type="checkbox"/>	
		<input type="checkbox"/>	<input type="checkbox"/>	
Kitchen Backsplash		<input type="checkbox"/>	<input type="checkbox"/>	
Complete Backsplash		<input type="checkbox"/>	<input type="checkbox"/>	

Comment

2X2 MOSAIC - SNOW WHITE TILES IN MASTER ENSUITE SHOWER STALL

## 5. Fireplace

	Living Room			Family Room			Other Room - Specify		
	Purchased	As Per Plan	N/A	Purchased	As Per Plan	N/A	Purchased	As Per Plan	N/A
Fireplace Type	<input type="radio"/>	<input type="radio"/>	<input checked="" type="radio"/>	<input type="radio"/>	<input checked="" type="radio"/>	<input type="radio"/>	<input type="radio"/>	<input type="radio"/>	<input checked="" type="radio"/>
Mantle Type				STANDARD BLF-50					
Over Mantle									
Colour / Stain									
Surround									
Hearth									
Comment									

Initial:

SB

Page 2 of 3



## INTERIOR COLOUR SCHEME

CARV. LOT 40 PH1

Purchaser: Silvana Basciano  
Telephone Res. / Bus: (416) 550-2206 /  
Decor Advisor: Veronica Ashton

Property: 40 of Plan -  
Project: Carrville Investments Ltd.  
Model and Elevation: The Spruce (20-2) Elev B

## 6. Trim Carpentry

Door Hardware STANDARD

Interior Trim STANDARD

Comment

## Interior Doors

☐ 2 Panel Arch Top☒ 2 Panel Square Top☐ 6 Panel

Initial for Door Style

SB

## 7. Railings and Pickets

Railing Package UPGRADE 4 - SEE PE ATTACHED

Railing Colour COBALT

Picket Colour MATTE BLACK METAL

Wood Stairs ☐ No ☒ Oak

Tread Colour COBALT

Comment

STAIN STAIRS TO COMPLIMENT HARDWOOD FLOORING "COBALT"

## 8. Plaster Mouldings and Medallions

Foyer

Main Hall

Living Room

Dining Room

Family Room

Kitchen/Breakfast

Den/Library

Lower Landing

Comment

## 9. Wall Paint

STANDARD SENATOR WHITE

Smooth Ceilings

☐ First Floor☐ First Floor incl. Second Floor Hall☐ First and Second Floor☒ Throughout☐ Not Applicable

Trim Paint STANDARD

## 10. Additional Comments

## 11. Disclaimers and Notes

- 1) Colours of all materials are as close as possible to builder's selection, but not necessarily identical due to variances in manufacturing.
- 2) Any extras listed above are null and void unless accompanied by a separate invoice/amendment. Said invoice must be paid in full.
- 3) The Purchaser acknowledges that after Interior Colour Selection form is signed and dated, no further changes will be permitted other than re-selection due to unavailability. SB Purchaser's Initials
- 4) The Purchaser acknowledges reading and accepting the "Senator Homes Décor Centre Disclaimers" form. This document contains other miscellaneous disclaimers.

This Interior Colour Selection is final and approved by:

Purchaser:

Signature: S. Basciano Date: July 5/16

Vendor:

Carrville Investments Ltd.



CARV - LOT 40 PH1

This sketch is provided solely for reference to those items noted on the accompanying "Upgrades/Extras". All other details, dimensions & layouts are for illustrative purposes only and may not be applicable to the Purchaser's Model

<—> = Tile direction (Foyer)  
 ↑↓ = Tile direction (Powder room)

Site Carville Lot 40  
 Date July 5/16  
 Purchaser Initials JB Production Initials \_\_\_\_\_

**richdale**  
 SOUTH RICHMOND HILL  
**SCHEDULE B**

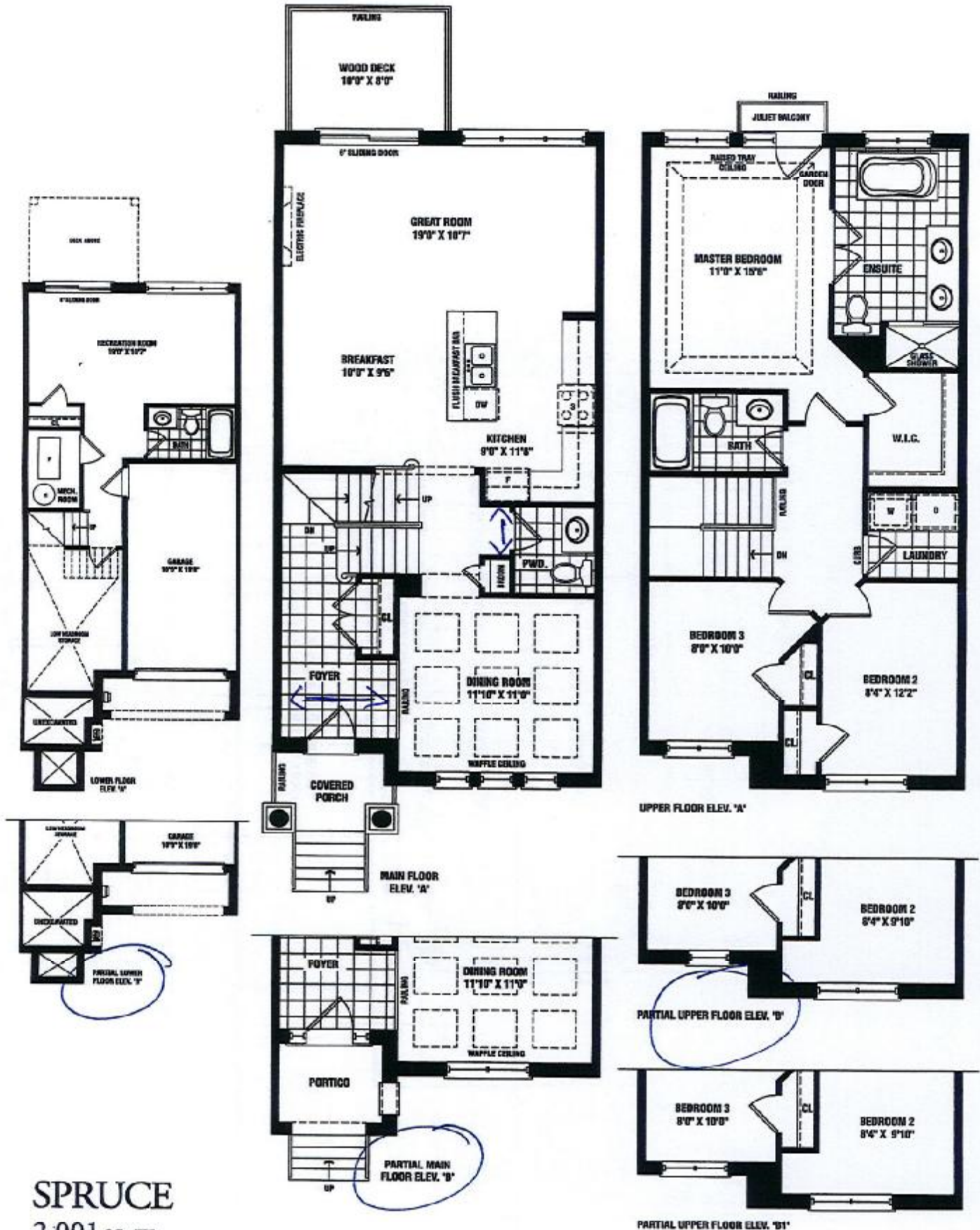

**SPRUCE**  
 2,001 SQ. FT.  
 ELEV. A, B & B-1

Actual usable square footage may vary from that stated herein. The floor plan may be mirror image/reverse from that shown. E&C.E. 20-2

**SENATOR**  
 HOMES

AR



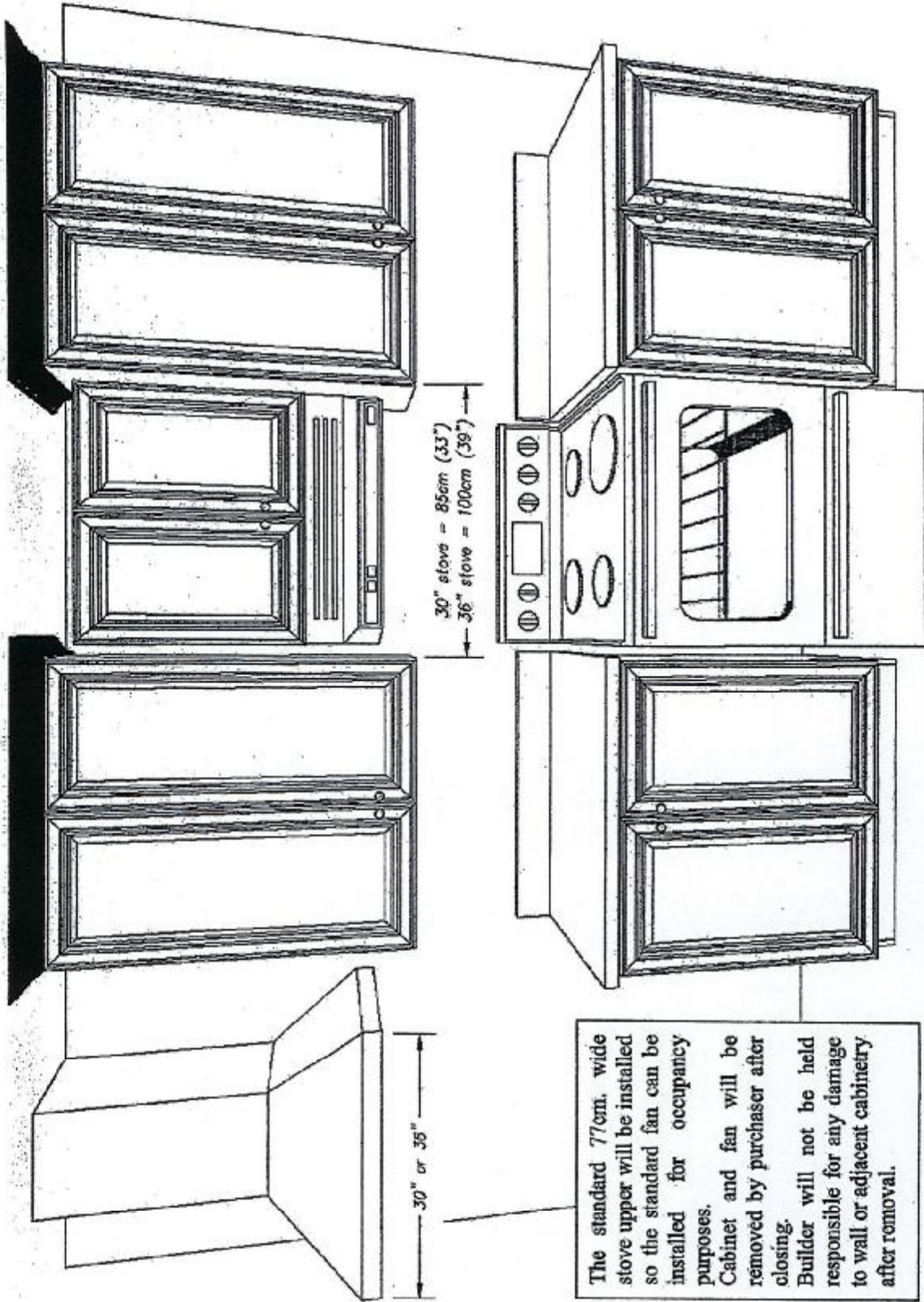

The standard 77cm. wide stove upper will be installed so the standard fan can be installed for occupancy purposes. Cabinet and fan will be removed by purchaser after closing. Builder will not be held responsible for any damage to wall or adjacent cabinetry after removal.

This sketch is provided solely for reference to those items noted on the accompanying "Upgrades/Extras". All other details, dimensions & layouts are for illustrative purposes only and may not be applicable to the Purchaser's Model

Site Oranville Lot 40

Date May 5/16

Purchaser Initials SB Production Initials \_\_\_\_\_



FRENDEL  
KITCHENS LIMITED  
3330 Steeles Avenue East, Unit 104, Scarborough, Ontario M1V 5T2

(1) Upper angled  
cabinets

(1) 50cm deep bridge  
units with 60cm gable

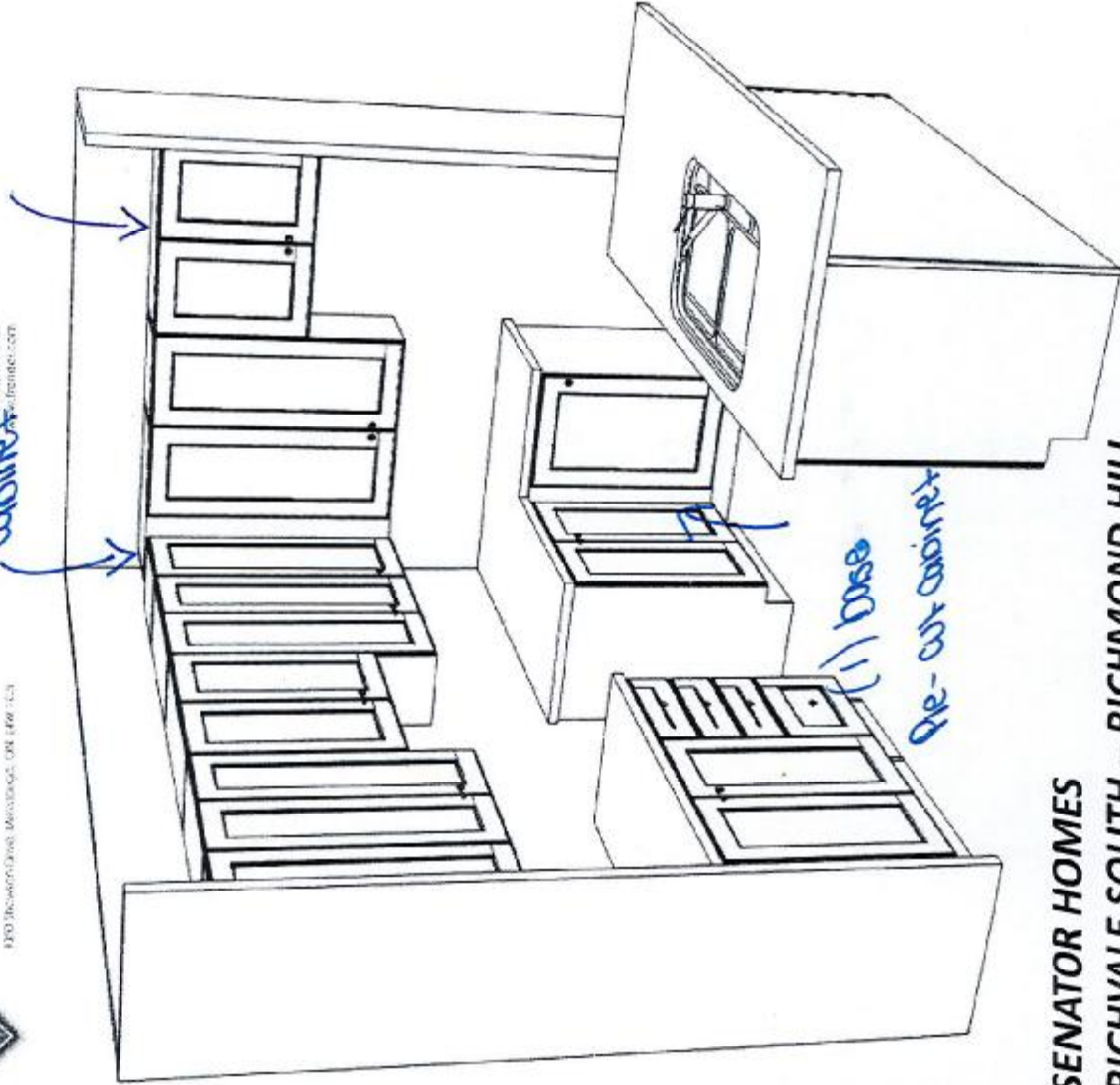
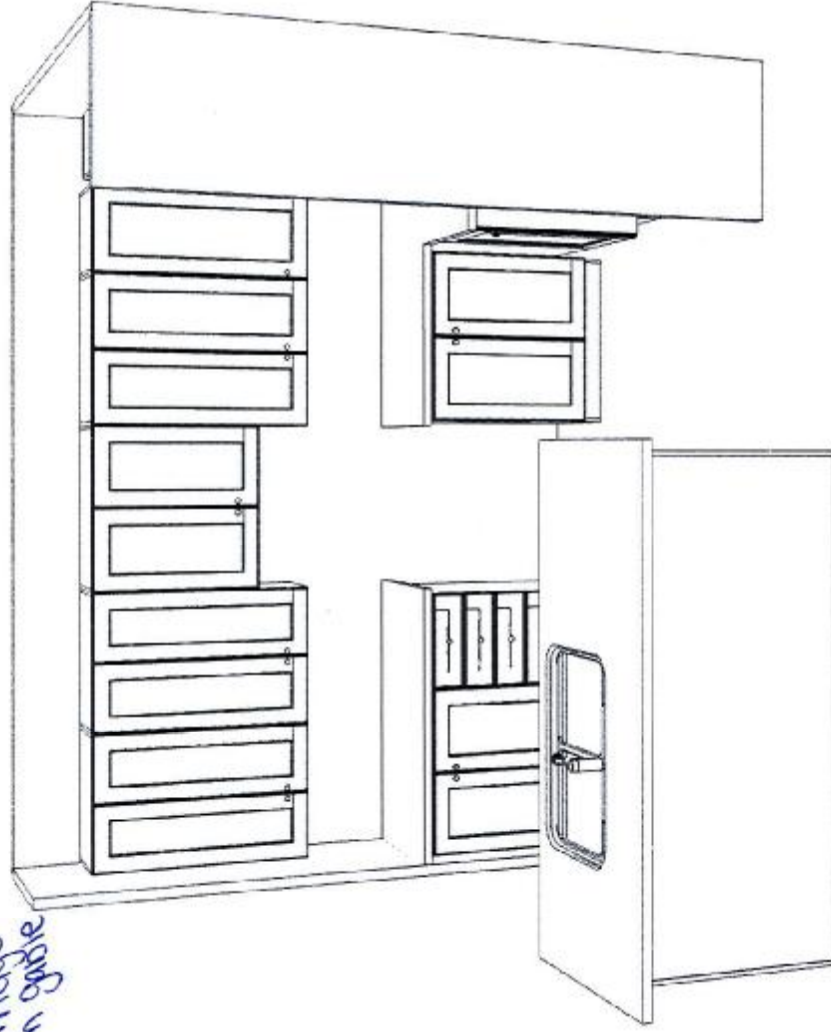

(1) Base  
QE - cut cabinets

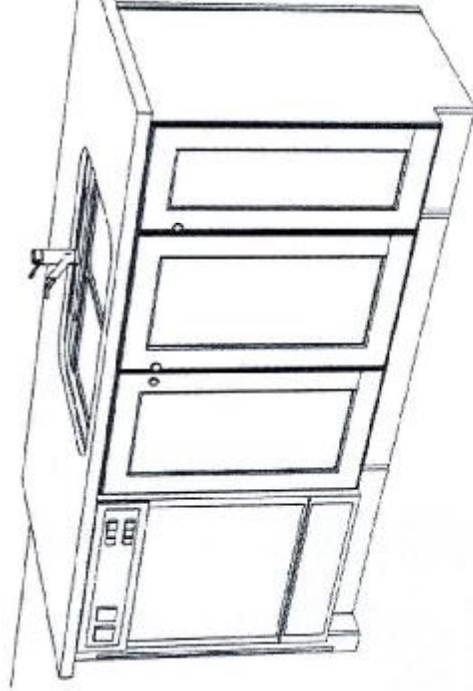

This sketch is provided solely for reference to those item  
noted on the accompanying "Upgrades/Extras". All other  
details, dimensions & layouts are for illustrative purposes  
only and may not be applicable to the Purchaser's Model

Site Scarville Lot 40  
Date May 5/16  
Purchaser Initials SB Production Initials \_\_\_\_\_

CARV. LOT 40 PH1

SENATOR HOMES  
RICHVALE SOUTH - RICHMOND HILL  
MODEL: TH-20-2 (SPRUCE) ELEV. A, B, B1  
TOTAL UNITS: 15

June 2, 2016





FRENDEL  
HOMES, LIMITED  
1200 The Woodlands, Maryland, 21066

For PDS 400/280  
From 1901 470-1966  
www.frendel.com

### KITCHEN (1ST FLR)

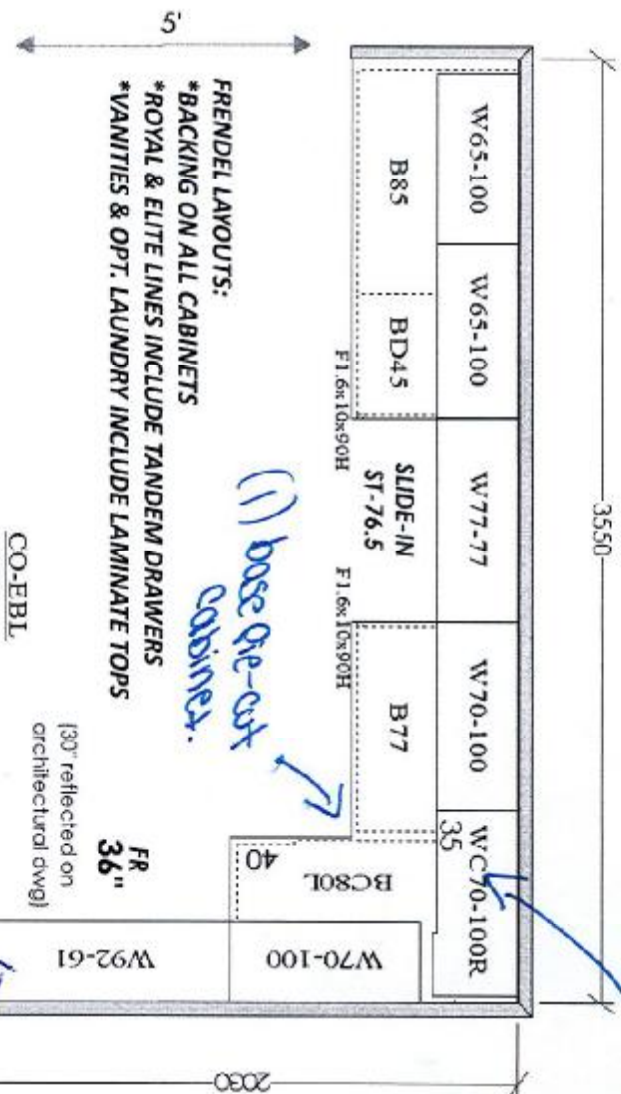

### BATH (LOWER LEVEL)

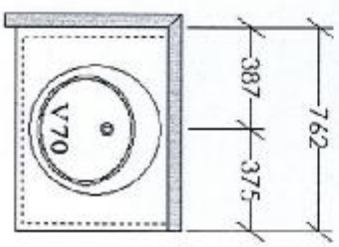

### POWDER (1ST FLR)

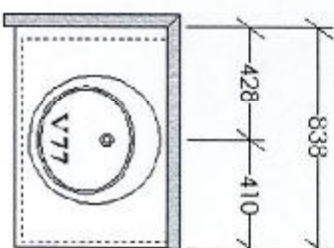

### MAIN BATH (2ND FLR)

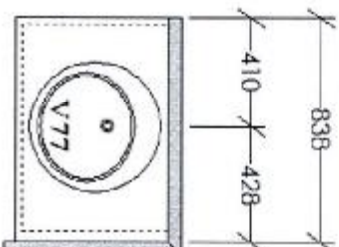

### MASTER ENSUITE (2ND FLR)

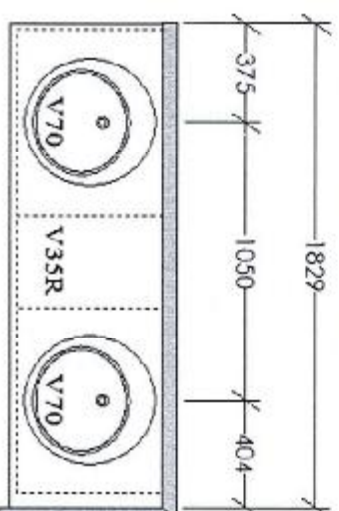

CARV. LOT 40 Pst 1

(1) base one-cut cabinets.

(1) upper range cabinet

(1) 59 can deep fridge  
upgrades with 66cm granite.

\*\*NO OPT. LAUNDRY

This sketch is provided solely for reference to those items noted on the accompanying "Upgrades/Extras". All other details, dimensions & layouts are for illustrative purposes only and may not be applicable to the Purchaser's Model.

### SENATOR HOMES

### RICHVALE SOUTH - RICHMOND HILL

### MODEL: TH-20-2 (SPRUCE) ELEV. A, B, B1

TOTAL UNITS: 15

Site Cascade Lot 40  
Date July 5/16  
Purchaser Initials SP Production Initials \_\_\_\_\_

June 2, 2016





# French Door Refrigerator

E23BC68JPS Professional 34 1/2" Ice

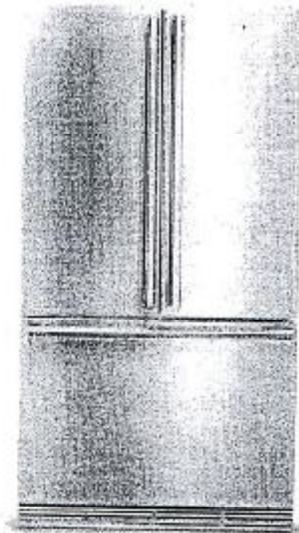

## Custom Temp Drawer™

Enjoy the ultimate in versatility with 9 preset selections including White/Sparkling Wine, Fish/Shellfish, Cheese plus three customizable settings that ensure foods stay at the ideal temperature for serving and maintaining freshness.



## Custom-Design™ Organization System

With our flexible Tri-Level freezer organization system you can keep your freezer well organized. The three Smooth-Glide® baskets with removable dividers and top removable baskets allow you to configure the space to neatly fit large and small items.



## Theatre Lighting

Transition LED lighting gradually illuminates the interior with soft but ample light as you open the door.



## PureAdvantage® Filtration Systems

Our filtration system keeps clean, filtered air circulated throughout to prevent odor transfer and keeps fresh, clean water and ice at your fingertips.

## 23 CU. FT. COUNTER-DEPTH FRENCH DOOR REFRIGERATOR

### CAPACITIES

Total Capacity	23.6 Cu. Ft.
Fresh Food Volume	16.7 Cu. Ft.
Freezer Volume	6.9 Cu. Ft.
Total Shelf Area	26.45 Sq. Ft.
Fresh Food Shelf Area	18.72 Sq. Ft.
Freezer Shelf Area	7.7 Sq. Ft.

### EXTERIOR

Professional Doors and Handle Design	Yes
Custom-Set™ Electronic Controls	Yes
Door Hinge Covers	Yes

### FRESH FOOD CONVENIENCES

PureAdvantage® Water & Ice / Air Filtration	Yes
Water Filter Location	Bottom Left
Tamper Alarm System / Door Ajar Alarm / Power Failure Alarm	Yes
Custom-Design™ Glass Shelves	4 Half Width
Smooth-Glide® Humidity Controlled Left Crisper	Yes
Smooth-Glide® Humidity Controlled Right Crisper	Yes
Custom Temp Drawer™	Yes
Wine Rack	Yes
Clear Gallon Adjustable Door Bin	2
Clear 1/2 Gallon Adjustable Door Bins	3
Locking Clear Utility Bin	Yes
Tilt-Out Can Racks	2
Theatre Ramp-Up Multilevel Lighting - LED	Yes

### FREEZER CONVENIENCES

Automatic Ice Maker	Yes
Ice Maker On/Off	Yes
Fast Ice™	Yes
Self-Closing Drawer	Yes
Sliding Freezer Baskets	2 Full-Width Smooth-Glide® (with Dividers) 1 Half-Width
Plastic Ratchet Tray	1
Tilt-Out Wire Door Racks	1
Theatre Ramp-Up Multilevel Lighting - LED	Yes

### ADDITIONAL FEATURES

ENERGY STAR®	Yes
Sabbath Mode (Star-K® Certified)	Yes

### ACCESSORIES

Collar Kit - PN# EC023005*	Optional
Louvered Trim Kit - PN# 241723001*	Optional
Water Filter Replacement Cartridge - PN# EWFD1	Optional
Air Filter Replacement Cartridge - PN# EAPCBF	Optional

### SPECIFICATIONS

Product Dimensions -	
Height (with Hinges and 3/8" Rollers)	69-1/2"
Cabinet Width/Door Width	35-5/8"/36"
Depth (including Handle)	29-1/2"
Depth (with 30" Doors Open)	42-3/16"
Depth (with Drawers Fully Extended)	44-1/2"
Power Supply Connection Location	Right Bottom Rear
Water Inlet Location	Left Bottom Rear
Voltage Rating	120V/60Hz/15 or 20A
Connected Load (kW Rating) @ 120 Volts*	1.02
Minimum Circuit Required (Amps)	5
Shipping Weight (Approx.)	348 Lbs.

\* For detailed Louvered Trim Kit and Collar Kit installation instructions, refer to Product Installation Guide on the web at [electroluxicon.ca](http://electroluxicon.ca).

An electrical supply with grounded three-prong receptacle is required. The power supply circuit must be installed in accordance with current edition of National Electrical Code (NFPA 70) and local codes & ordinances.

NOTE: Always consult local and national electric and plumbing codes. Refer to Product Installation Guide for detailed installation instructions on the web at [electroluxicon.ca](http://electroluxicon.ca). Specifications subject to change.



# French Door Refrigerator

Electrolux Major Appliances, N.A.

Electrolux ICON

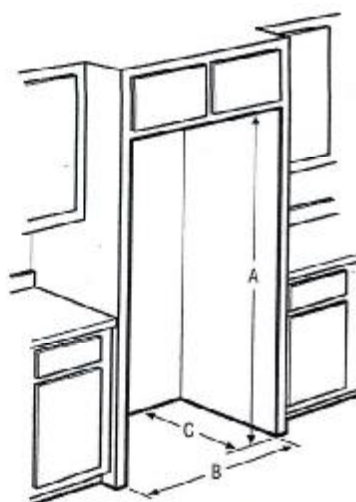

"Built-In Look" Cutout Dimensions

(A) 70 1/4" (B) 36" (C) 25"

Standard Refrigerator Depth vs. Counter Depth

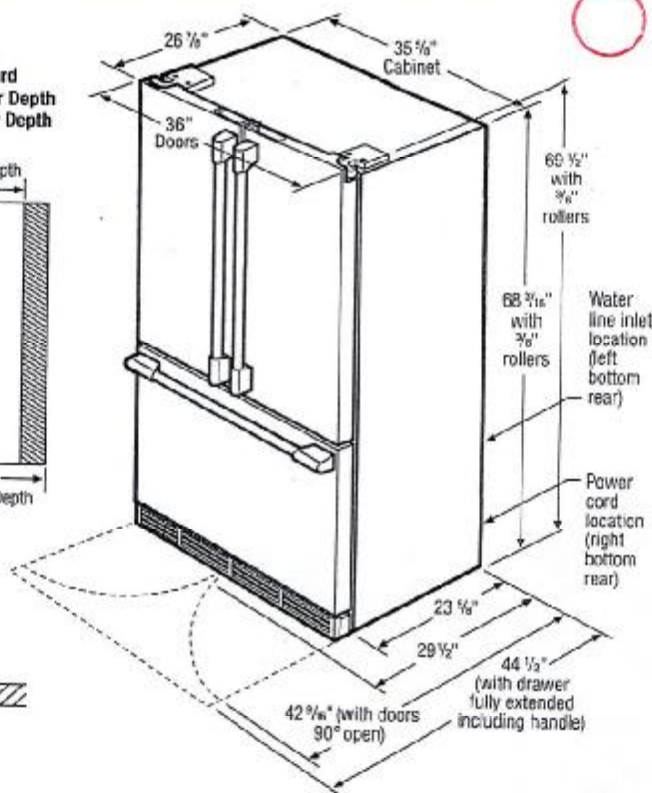
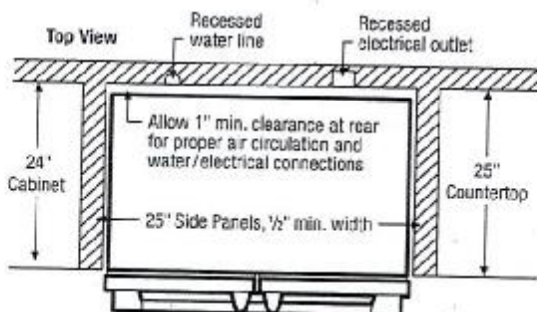

**Note:** Optional Louvered Trim Kit and Collar Kit available for French Door Counter-Depth Refrigerator. For specifications, refer to Louvered Trim Kit (241723001) Installation page or Collar Kit (ECK23CDS) Installation page on web.

## Counter-Depth French Door Refrigerator Specifications

- Product Weight - 338 Lbs.
- An electrical supply with grounded three-prong receptacle is required. The power supply circuit must be installed in accordance with current edition of National Electrical Code (NECA 70) and local codes & ordinances.
- Voltage Rating - 120V/60Hz/15 or 20 Amps
- Connected Load (kW Rating) @ 120 Volts = 1.02 kW
- Amps @ 120 Volts = 8.5 Amps
- Always consult local and national electric & plumbing codes.
- Floor should be level surface of hard material, capable of supporting fully loaded refrigerator.
- When installing refrigerator adjacent to wall, cabinet or other appliance that extends beyond front edge of unit, 20" minimum clearance recommended to allow for optimum 120° to 180° door swing, providing complete drawer/crisper access and removal. (Absolute 4-1/2" minimum clearance will ONLY allow for 60° door swing which will provide drawer/crisper access with restricted removal.)
- To ensure optimum performance, avoid installing in direct sunlight or close proximity to range, dishwasher or other heat source.
- For proper ventilation, front grille MUST remain unobstructed.
- Recess electrical outlet when possible.
- Water recess on rear wall recommended to prevent water line damage.
- Water Pressure - Cold water line must provide between 30 and 100 pounds per square inch (psi).

- Copper tubing with 1/4" O.D. recommended for water supply line with length equal to distance from rear of unit to household water supply line plus 7 additional feet. Optional Water Supply Installation Kits available.
- Adjustable front rollers to assist with door alignment.
- If optional Collar Kit (PN# ECK23CDS) is to be used, different cutout dimensions are required. (Refer to Collar Kit ECK23CDS Installation Specifications page on web.)
- If optional Louvered Trim Kit (PN# 241723001) is to be used, different cutout dimensions are required. (Refer to Louvered Trim Kit 241723001 Installation Specifications page on web.)

## "Built-In Look" Specifications

- Minimum opening of 70-1/4"H x 36"W x 25"D required to allow for base of installation, proper air circulation, and plumbing/electrical connections.
- Remove all wall/floor molding prior to installation.

**Note:** For planning purposes only. Refer to Product Installation Guide on the web at [electroluxicon.ca](http://electroluxicon.ca) for detailed instructions.

## Optional Accessories

- Collar Kit - (PN# ECK23CDS).
- Louvered Trim Kit - (PN# 241723001).
- PureAdvantage® Water Filter Replacement Cartridge - (PN# EWFO1).
- PureAdvantage® Air Filter Replacement Cartridge - (PN# EAFGBF).



Electrolux Major Appliances, N.A.

CANADA • 5955 Terry Fox Way • Mississauga, ON L5V 3E4 • 1-800-265-8352 • [electroluxicon.ca](http://electroluxicon.ca)



High standards of quality at Electrolux Major Appliances, N.A. mean we are constantly working to improve our products. We reserve the right to change specifications or discontinue models without notice.





Corvillie - Lot 40



# ELECTRIC FREESTANDING RANGE

EI30EF4CQS

Featuring IQ-Touch™ Electronic Controls



## SIGNATURE FEATURES



### FRONT CONTROL DESIGN

Effortlessly upgrade your back-control range to built-in style. This range will easily replace traditional 30" freestanding ranges.



### PERFECT TASTE™ DUAL CONVECTION

For consistently delicious taste and texture, our dual-fan convection circulates air more evenly throughout the oven for an even cook. Two variable speeds work in tandem with three heating elements (bake, broil, and convection) to give you delicious results every time.

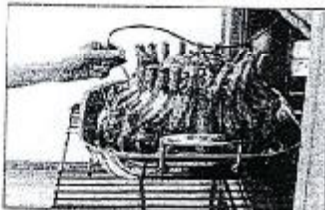

### PERFECT TASTE™ TEMP PROBE

The Perfect Taste™ Temp Probe lets you cook each dish to perfection. It does more than measure temperature — it alerts you when food has reached the desired temperature and automatically adjusts to the Keep Warm setting, so you never overcook your food and deliver perfect results every time.



### FLEX-2-FIT® HEATING ELEMENTS

Automatically expands up to three sizes, giving you precision and control with a variety of cookware.

## PRODUCT DIMENSIONS

Height	36-1/8" - 36-5/8"
Width	29-7/8"
Depth (including handle)	29-31/32"

## MORE EASY-TO-USE FEATURES

### WARMER DRAWER

Maintain the perfect temperature of your food until serving time.

### EASY-TO-CLEAN COOKTOP SURFACE

Smooth glass cooktop makes cleanup a breeze.

### A LUXURY-GLIDE® OVEN RACK

With a ball bearing system, the oven rack is so smooth it extends effortlessly so you can more easily manage the transfer of all dishes, even heavy ones.

### PLATINUM STAR® LIMITED WARRANTY

Our exclusive limited warranty that includes 3-year coverage on parts and one year on labor\*.

### CONVECTION CONVERSION

Automatically adjusts standard baking temperatures to convection temperatures, for perfect, consistent results.

### 6 COOKING MODES

Bake, Broil, Convection Bake, Convection Roast, Keep Warm and Slow Cook.

### KEEP WARM SETTING

Maintain food at the perfect serving temperature with this setting — it's a great feature when you're entertaining. Additional warming zone on cooktop allows for ultimate flexibility.

### IQ-TOUCH™ CONTROLS

The IQ-Touch™ control panel displays all of your options, at all times.

Available in:



Stainless Steel

ELEMENT	WATTS
8 1/2" x 9 1/2" Bake/Expendable Element	4,200/2,000/1,000
9" Electric Element	1,200
6" Electric Element	1,200
5" Electric Element	1,200
Warming Zone	100

\*The 3-year limited warranty applies to all Electrolux Appliances with the exception of the 100 Series of products. Products must have been purchased after July 1, 2004. Coverage includes replacement for 3 years and labor for 1 year.

ELECTROLUXAPPLIANCES.CA



Corvulle - Lot 40

# ELECTRIC FREESTANDING RANGE

E130EF4CQS



## 30" ELECTRIC FREESTANDING RANGE

<b>CONTROL PANEL FEATURES</b>	
IC-Touch™ Electronic Oven Control	Yes
Professional-Grade Element Controls	Yes
Keypad Entry of Time & Temperature	Yes
Electronic Clock & Timer	Yes
Temperature Display	Yes
Automatic Oven Delay Cook & Off	Yes
<b>COOKTOP FEATURES</b>	
Flex-Top™ Ceramic Glass Smoothtop	1
5 to 9 to 12" Triple Expandable Element 1,200W/2,000W/3,000W	1
8" Electric Element 3,000W	1
8" Electric Element 1,800W	2
Warming Zone - 100W	Yes
<b>OVEN FEATURES</b>	
Capacity	5.0 Cu. Ft.
Hidden Bake Element	Yes
Eight-Pass Bake Element - 2500 Watts	Yes
Eight-Pass Broil Element - 4000 Watts	Yes
Convection Element - 2500 Watts	Yes
CosmoBlue Interior	Yes
Self-Clean Coatings with Door Lock	Yes
Perfect Taste™ Convection	Yes
Cooking Modes - Bake, Broil, Convection Bake, Convection Roast, Roast Warm, Slow Cook	6
Cooking Options - Temperature Probe, Delay Bake, Convection Convert	3
Luxury-Designer™ Lighting with Dual 40W Halogen Bulbs	Yes
Luxury-Glaze™ Racks	1
Conventional Racks	1
Convection Roasting Rack	1
<b>ADDITIONAL FEATURES</b>	
Luxury-Heat™ Oven Door	
Extra-Large Glass Window	Yes
Warmer Drawer	Yes
Adjustable Leveling Legs	Yes
Sabbath Mode (Eater-K® Certified)	Yes
<b>ACCESSORIES</b>	
Meat Probe	Included
Stainless Steel Backguard - Part A05H50501	Optional
<b>SPECIFICATIONS</b>	
Colour -	Stainless Steel
Power Supply Connection Location	Right Bottom Rear
Connected Load (kW Rating) @ 240/208 Vols	3.8/10.4
Amps @ 240/208 Vols	57.5/50
Minimum Circuit Required (Amps)	60
Shipping Weight (Approx.)	245 Lbs.

NOTE: Always consult local and national electrical codes. Refer to Product Literature Guide for details, installation instructions or the need of additional equipment or modification required to install.

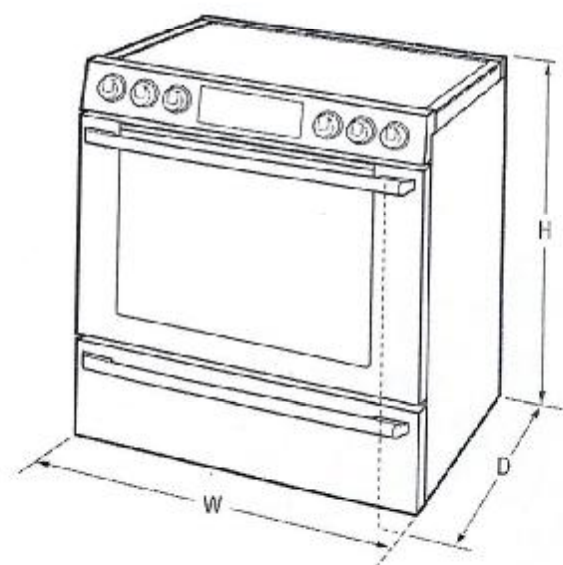

<b>PRODUCT DIMENSIONS</b>	
Height (Adjustable)	36-1/8" - 39-3/8"
Width	29-7/8"
Depth (including handle with 50° Door Open)	28-31/32" 46"
<b>OVEN CAVITY DIMENSIONS</b>	
Height	22-1/2"
Width	24-1/8"
Depth	18-3/4"

## Electrolux Major Appliances, N.A.



CANADA • 5855 Terry Fox Way • Mississauga, ON L5V 3E4 • 1-800-265-8352 • [electroluxappliances.ca](http://electroluxappliances.ca)

E130EF4CQS 10/15

© 2015 Electrolux Major Appliances, NA



High standards of quality at Electrolux Home Products, Inc. mean we are constantly working to improve our products. We reserve the right to change specifications or discontinue models without notice.

Printed in Canada



# Built-In Dishwasher

professional series

**E24ID740PS**



## PRODUCT DIMENSIONS

Height	33-3/4" - 35-3/4"
Width	23-3/4"
Depth	24-1/4"

## MORE EASY-TO-USE FEATURES

### IQ-Touch™ Controls

For those who like to have their options always visible on their dishwasher, the IQ-Touch™ control panel displays all of your options, at all times.

### Easy-Lift Adjustable Racks

Versatile racking system easily adjusts to provide the perfect place for all your dishware — no pinching, pulling, or toggling required.

### Auto Wash Feature

A Smart Soil Sensor technology that determines how long the wash cycle should run, for a more effective operation.

### AquaLux™ Wash System

A unique washing system that uses alternating wash arms, for a quieter and more efficient operation.

### Luxury Soft Grip Racks

Luxury Soft Grip Racks hold plastics and dishware in place, and prevent flipping, for a more thorough clean.

### Perfect Stemware™ Grips

Six flexible grips gently hold stemware and other delicate items for a secure wash, every time.

### Luxury-Glide® Racks

With our Luxury-Glide® technology, upper and lower racks are so smooth they extend effortlessly.

### Sure-2-Fit® Racking System

The most versatile and adjustable racking system — there's a perfect place for over 180 items, from chopsticks to stockpots to stemware. In its lowest position, you can fit 10" dinner plates in the top rack and 12" dinner plates in the bottom.

### More Cycles

With up to ten cycles — including Heavy, Normal, Fast Wash, Auto, Upper Rack Only, Eco Wash, Stemware, Rinse Only, Delicate, and "My Favourite" — you can choose the perfect wash for any occasion.

### "My Favourite" Settings

A programmable setting that lets you customize the wash for your unique cleanup needs.

## Signature Features

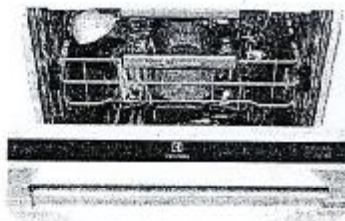

### 30-Minute Fast Wash Cycle

Quick Wash Cycle allows you to thoroughly wash dishes in half the time.

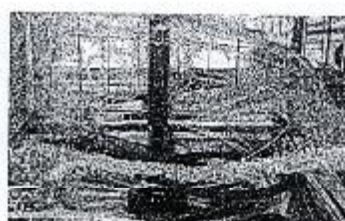

### SatelliteSpray™ Arm

An innovative rotating wash zone gives you 400% more water coverage, targeting virtually every spot in your dishwasher for a truly professional-level clean.

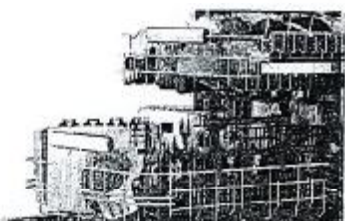

### Largest Usable Capacity

Largest usable capacity in its class, so even your dinner party dishware fits.



### Perfect Stemware™ Cycle

Ensures your stemware comes out spotless and clean.





# Built-In Dishwasher

E24D74QPS • 15 Place Settings



Electrolux

ICON

## BUILT-IN DISHWASHER

### FEATURES

Stainless Steel Interior	Yes
Luxury-Insta™ Door	Yes
Custom-Set™ Options	Yes
Theatre LED Lighting	Yes
Integrated IQ-Touch™ Controls	Yes
LED Indicator Lights	Yes
Tall-Tub Design	Yes
ProClean™ Wash System	Yes
SwirlJet Spray™ Arm	Yes
Luxury-Clean™ Technology	Yes
Luxury-Cut™ Sound Package (Approx. dBA)	Yes/43.0
Wash Levels	5
Aqua-Lux™ Wash System	Yes
Leak-Detection System	Yes
Adjustable Finse Aid Dispenser with Indicator	Yes
ENERGY STAR®	Yes

### CYCLES

Auto Wash	Yes
Deluxe	Yes
Eco Wash	Yes
FarCure™	Yes
Heavy	Yes
Normal	Yes
Perfect Steam™	Yes
30-Min. Fast Wash	Yes
Rinse Only	Yes
Upper Rack	Yes

### OPTIONS

Air Dry	Yes
NSF® Certified Sanitize Option	Yes
Delay Start	30 Min. – 24 Hrs.

### RACK SYSTEM

Sure-Grip™ Rack System	Yes
Upper Rack –	
Adjustable Height	Yes
Cup Clips	4
Cup, Shell/Silverware Holder	2/Yes
Fold-Down Tines	4 Rows
Rack Handle	Yes
Versa-Tray™	Yes
Lower Rack –	
Fold-Down Tines	6 Rows
Knife Holder	Yes
Utility Tray/Shelf	Yes
Silverware/Champagne Glass Holders	4
Silverware Basket	3-Piece Split
Special Items Cover/Wash Small Items Bag	Full Set

### SPECIFICATIONS

Power Supply Connection Location	Right Bottom Front
Water Inlet Location	Left Bottom Front
Loading Legs	Yes
Water Usage (Gallons) – Normal Cycle	4.0 – 6.0
Water Pressure (PSI)	15 – 120
Integral Air Gap on Supply	Yes
Voltage Rating	120V/60 Hz
Connected Load (kW Rating) @ 120 Volts†	1.44
Amps @ 120 Volts	9.2
Shipping Weight (Approx.)	116 Lbs.

†For units on 200-240V rated 120V, dedicated circuit having 2-wire service with a separate ground wire. Appliances must be grounded for safe operation.

NOTE: Always consult local and national electric and plumbing codes. Refer to Product Literature Guide for detailed installation instructions on the web at [electroluxicon.ca](http://electroluxicon.ca). Specifications subject to change.

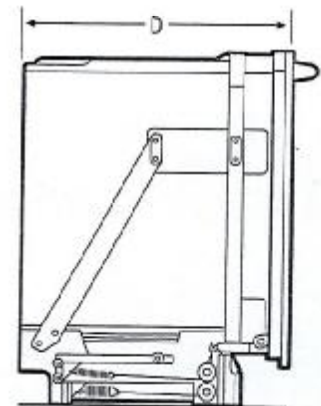
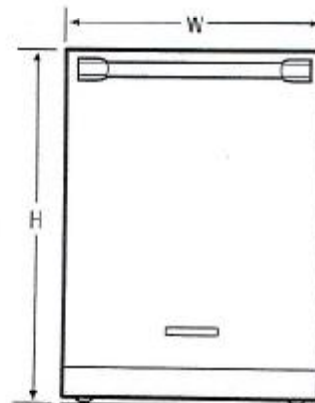

### PRODUCT DIMENSIONS

Height (Adjustable)	33-3/4" – 35-3/4"
Width	23-3/4"
Depth (Including Door)	24-1/4"
Depth (Including Door)	50-1/4"

## Electrolux Major Appliances, N.A.

CANADA • 5855 Terry Fox Way • Mississauga, ON L5V 3E4 • 1-800-265-8352 • [electroluxicon.ca](http://electroluxicon.ca)

E24D74QPS 03/15

© 2015 Electrolux Major Appliances, N.A.

Printed in Canada



High standards of quality in Electrolux home products. We maintain this commitment by improving our products. We reserve the right to change specifications or accessories without notice.





Camille - Lot 40



# FRONT LOAD WASHER

5.0 Cu. Ft.

EFLW417SIW

With LuxCare™ Wash and IQ-Touch™ Controls

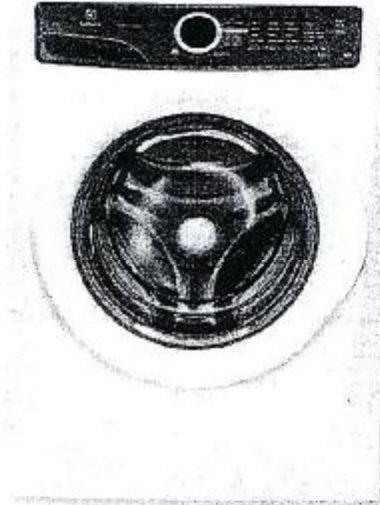

## SIGNATURE FEATURES



### THOROUGH CLEANING WITH LUXCARE™ WASH SYSTEM

Our LuxCare™ Wash System offers a thorough clean with improved wash actions, temperature control, and smart load sensing.

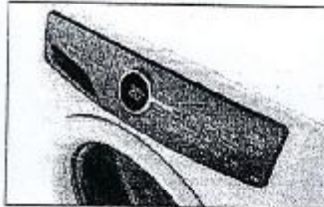

### 20-MINUTE FAST WASH¹

Quickly deep cleans the items you need most.



### STAIN TREAT™ OPTION GENTLY AND EFFECTIVELY REMOVES STAINS

Optimizes the temperature, tumbling actions, and cycle time for optimal stain-removing conditions.



### ENERGY STAR®-CERTIFIED MOST EFFICIENT

Electrolux washers meet strict criteria to guarantee high-quality energy efficient performance — without sacrificing clean.

## PRODUCT DIMENSIONS

Height	38"
Width	27"
Depth	32"

## MORE EASY-TO-USE FEATURES

### 10-YEAR MOTOR WARRANTY PLUS LIFETIME TUB WARRANTY

Rest easy knowing your washer is backed by a 10-year motor and lifetime tub warranty.

### PERFECT BALANCE® SYSTEM & SECOND FLOOR GUARANTEE

Balances loads for smooth, quiet operation. So quiet you can even run your washer on the second floor or near bedrooms without noticing it.²

### FRESH WATER RINSE REMOVES RESIDUAL DETERGENT

We use fresh water in our final rinse to ensure more detergent is removed, which is gentler on sensitive skin and provides better fabric care.

### FITS MORE ROOMS

With four-way venting and a standard 27" platform, our products are designed to fit just about anywhere you want to put them.

### SPACIOUS CAPACITY

Easily cleans a king-sized comforter with spacious 5.0 cu. ft. drum.

### 7 CYCLES TO CARE FOR EVERY FABRIC

Clean all your special items with tailored cycles for delicates, heavy duty, whitest whites, and more.

### BRILLIANT LED DISPLAY SHINES IN EVEN THE DARKEST LAUNDRY ROOMS

Our beautifully bright display illuminates information on cycles and lets you know how much time is left.

### PLATINUM STAR® LIMITED WARRANTY

Our exclusive Platinum Star® Limited Warranty includes a three-year coverage on parts and one year on labour.³

### DELAY START

Adjust washer start time to meet your lifestyle needs.

Available in:



Island White  
(IW)

¹See owner's manual for details.

²We tested in commercial units that are considered noise-free for testing.

³Warranty varies by product. Register your Electrolux Appliance within 60 days of purchase.

Products that have been purchased on or after July 1, 2013. See retailer for warranty details.

ELECTROLUXAPPLIANCES.CA

SB



# FRONT LOAD WASHER

EFLW417SIW

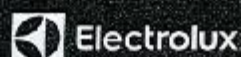

Combine - Lot 40.

## 27" FRONT LOAD WASHER

Capacity	5.0 Cu. Ft.
<b>FEATURES</b>	
Pull-to-Open Door	Yes
iQ-Touch™ Controls	Yes
Perfect Steam™ Wash System	
Balance System	Perfect Balance™
Sound System	Luxury Quiet™
Lighting	
Pull-to-Open Dispenser Drawer	Yes
Wash System	LuxCare™
Integral Water Heater	
Wash Drum	Stainless Steel
Automatic Temperature Control	Yes
Automatic Water Level Adjustment	Yes
Auto Prewash Concent Dispenser (Liquid/Powder)	Yes
Auto Bleach Dispenser (Liquid Only)	Yes
Auto Detergent Dispenser (Liquid/Powder)	Yes
Auto Fabric Softener Dispenser (Liquid Only)	Yes
Variable Speed (RPM)	Variable
Spin Speed (RPM)	1,300
Removable Door	
Adjustable Leveling Legs	Yes
ENERGY STAR™	Most Efficient
NEP™ Certified	

## CYCLES

Heavy Duty, Whitest Whites, Normal, 20-Min. Fast Wash, Delicates, Rinse & Spin, Quick Wash	7
--	---

## OPTIONS

Wash/Fine Temperature Combinations	5
Temperature Selections	4
Auto Clean	
Spin Speed Selections	4
Soil Level Selections	4
Delay Start	Yes
One-of-Cycle Drain	On/Off

## INSTALLATION OPTIONS

Freestanding, Under Counter™, Stacked (Under Dryer), Pedestal, Hidden (in Cabinet, Second Floor)	Yes
--	-----

## ACCESSORIES

LuxuryGlide™ Pedestal with Storage Drawer—Island White — P/N # EFWC157SIW	Optional
Drum Stacking Kit — P/N # SWS2077X	Optional
Drain Hose Extension Kit — P/N # 137008000	Optional

## SPECIFICATIONS

Colour —	Island White
Power Supply Location	Top Right Rear
Water Inlet Location	Top Left Rear
Voltage Rating	120V / 60 Hz
Connected Load (all Rating @ 120 Volts)	1.3
Width @ 120 Volts	26.00
Height @ 120 Volts	2
Shipping Weight (approx.)	229 lbs.

\*SINCE EACH UNIT IS MANUFACTURED IN A FACILITY WHERE CUSTOM-BUILT OVERSIZED AND/OR CAPACITY, THE electrical system with grounded metal wiring, electrical or mechanical. The power supply must be installed in accordance with current national and local codes and standards. Always consult with your local utility and/or electrician for details. Refer to Product Installation Guide for detailed installation instructions. All dimensions are approximate. Specifications subject to change.

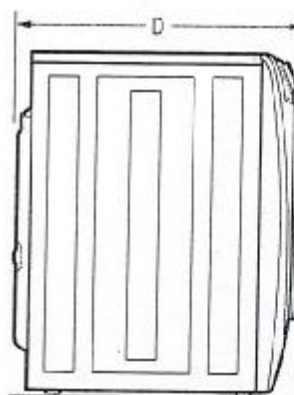
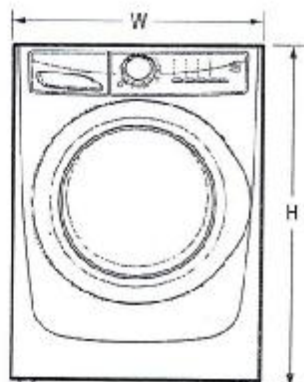

## PRODUCT DIMENSIONS

Height (without 15" Pedestal)	33"
Height (with 15" Pedestal)	53-1/4"
Width	27"
Depth to Centre of Drum (Including Hose)	32"
Depth to Centre of Drum (Including Hose)	53-1/2"

## 15" Pedestal Drawer Installation

Elevates washer height to 53 1/4". For detailed pedestal installation, refer to instructions included with pedestal or on web. Pedestal installation may require modified utility hookup locations. For details, refer to Product Installation Guide on web.

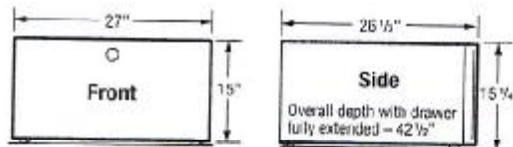

## Electrolux Major Appliances, N.A.

CANADA • 5855 Terry Fox Way • Mississauga, ON L5V 3E4 • 1-800-265-8352 • [electroluxappliances.ca](http://electroluxappliances.ca)

EFLW417S 04/15

© 2016 Electrolux Major Appliances, N.A.



High standards of quality at Electrolux Home Products, Inc. mean we are constantly working to improve our products. We reserve the right to change specifications or discontinue models without notice.

Printed in Canada





Cornille - Lot 40

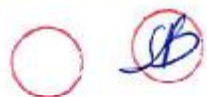

# ELECTRIC FRONT LOAD DRYER

8.0 Cu. Ft.

EFMC417SIW

Perfect Steam™ Dryer with IQ-Touch™ Controls



## SIGNATURE FEATURES



### KEEPS CLOTHES LOOKING THEIR BEST

Clothes are gently tumbled while moisture sensors detect when clothes are dry to prevent over-drying. Customizable options and cycles allow you to care for every fabric.

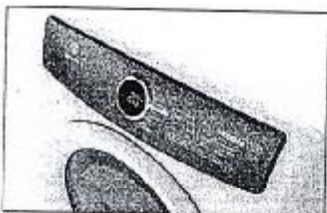

### 20-MINUTE FAST DRY<sup>1</sup>

Quickly dry the items you need most.



### ENERGY STAR®-CERTIFIED

Rigorously tested to do more with less. Electrolux dryers meet strict criteria to guarantee high-quality energy efficient performance.



### PERFECT STEAM™ WRINKLE RELEASE OPTION

Gently releases wrinkles and reduces static to keep clothes looking their best.

## PRODUCT DIMENSIONS

Height	38"
Width	27"
Depth	31-5/8"

## MORE EASY-TO-USE FEATURES

### LARGEST CAPACITY DRYER

Dry more in each load. Our 8.0 cu.ft. dryers have the largest capacity for a standard 27" platform.<sup>2</sup>

### PLATINUM STAR® LIMITED WARRANTY

Our exclusive limited warranty that includes three-year coverage on parts and one year on labour.<sup>3</sup>

### 7 CYCLES TO CARE FOR EVERY FABRIC

Perfectly dry every item with tailored cycles for towels, delicates, and more.

### REVERSIBLE DOOR FITS MORE ROOMS

Enjoy easy loading no matter how your washer and dryer are configured.

### OPTIONAL PEDESTALS AND STACKING KIT FOR MORE INSTALLATION OPTIONS

Place your units with optional pedestal drawers that provide extra storage. Or use the optional stacking kit for convenient placement in small spaces.

### LUXURY-DESIGN® LIGHTING

Conveniently find any article of clothing with premium LED lighting that provides visibility inside your dryer.

### BRILLIANT LED DISPLAY SHINES IN EVEN THE DARKEST LAUNDRY ROOMS

Our beautifully bright display illuminates information on cycles and lets you know how much time is left.

### LUXURY-QUIET™ SOUND SYSTEM

So quiet you can run it whenever you want without disrupting your household.

### CONTROL LOCK

To help avoid unwanted use.

Available in:



Island White  
(19)

View line number in U.S. only and

Always use manufacturer's specifications for correct 27" platform.

Availability based on product registration with Energy Star. North America only. All items of equipment. Products must have been purchased on or after July 1, 2011. See limited warranty for details.

ELECTROLUXAPPLIANCES.CA

SB



# ELECTRIC FRONT LOAD DRYER

EFMC417SIW



## 27" ELECTRIC FRONT LOAD DRYER

Capacity	8.0 Cu. Ft.
<b>FEATURES</b>	
Full-to-Open Door	Yes
10-Touch™ Controls	Yes
Perfect Steam™ Dry System	Yes
Dry System	Luxury-Dry™
Sound System	Lineary-Direct™
Lighting	Luxury-Design™
Tumble System	Gentle Tumble™
Moisture Sensor	Yes
Drum	Painted Steel
Tumble Speed (RPM)	20
Flappable Door	Yes
Adjustable Leveling Legs	Yes
ENERGY STAR®	Yes
NSF® Certified	

<b>CYCLES</b>	
Timed Dry (30, 45, 60, Heavy Duty, Mixed Load, Towels, Normal, 20-Min. Fast Dry, Delicates)	7
<b>OPTIONS</b>	
Temperature Selections	4
Auto Steam	Yes
Electronic Auto Dry System	Yes
Manual Timed Dry Selections	4
Delay Start (Hours)	12
End-of-Cycle Chime	On/Off
Extended Tumble	
Anti-Static	
Line Dry	
Shrink Guard	
Dryness Levels	4

<b>INSTALLATION OPTIONS</b>	
Freestanding, Under Counter*, Stacked (Always Washers, Pedestal, Hidden In-Chest, Second Floor)	Yes
4-Way Door Swing	Yes

<b>ACCESSORIES</b>	
Luxury-Style™ Pedestal with Spacious Storage Drawer (Island White – PNA-EPWD1575W)	Optional
Error Stacking Kit – PN# STACK177X	Optional
Cycling Rack – PN# AQ4840701	Optional

<b>SPECIFICATIONS</b>	
Colour –	
Island White	1W*
Maximum Exhaust Duct Length** (ft.)	120
Power Supply Connection Location	Rear
Voltage Rating	240V/50 Hz/30A
Connected Load (Watt Rating) @ 240 Volts	6.0
Amps @ 240 Volts	25
Heating Element @ 240 Volts (Watts)	5,400
Shipping Weight (Approx.)	141 Lbs.

\*Shipping, delivery and installation fees are extra. See dealer for details. See dealer for details.

\*\*See installation guide for details on ducting and clearances for exhaust and vent.

NOTE: Always consult local and national electrical and plumbing codes. Refer to Product Installation Guide for detailed instructions and warnings on the back of the installation manual.

Dimensions subject to change.

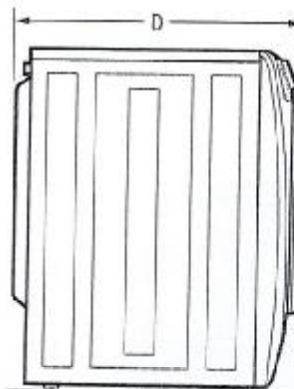

### PRODUCT DIMENSIONS

Height (without 15" Pedestal) (with 15" Pedestal)	30" 53-1/4"
Width	27"
Depth (to Centre of Arc, Not including Hoses) (with Door 90° Open)	31-5/8" 53-1/2"

## 15" Pedestal Drawer Installation

Elevates dryer height to 53 1/4". For detailed pedestal installation, refer to instructions included with pedestal or on web. Pedestal installation may require modified utility hookup locations. For details, refer to Product Installation Guide on web.

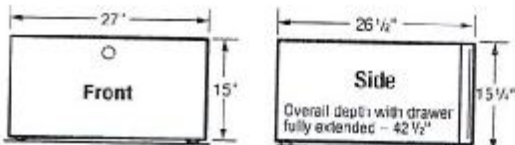

## Electrolux Major Appliances, N.A.

CANADA • 5855 Terry Fox Way • Mississauga, ON L5V 3E4 • 1-800-265-8352 • [electroluxappliances.ca](http://electroluxappliances.ca)

EFMC417S 04/16

© 2016 Electrolux Major Appliances, N.A.



High standards of quality of Electrolux Major Appliances are maintained by continuously working to improve our products. We reserve the right to change specifications or discontinue models without notice.

Printed in Canada



# SPECIFICATION SHEET VJ51030SS/VJ51036SS

## SPECIFICATIONS

MODEL	VJ51030SS / VJ51036SS
VOLTS	120 VAC
Hz	60
AMPS	3.3
CFM (LOW SPEED)	190
CFM (HIGH SPEED)	450
SONES (LOW SPEED)	2.5
SONES (HIGH SPEED)	8.5
TOTAL HOOD POWER CONSUMPTION	400 W
DUCTING SIZE	6" Round
2 HALOGEN BULBS	JC TYPE, 12 V, 20 W MAX., G-4 BASE
WARRANTY	1 YEAR

## DIMENSIONS

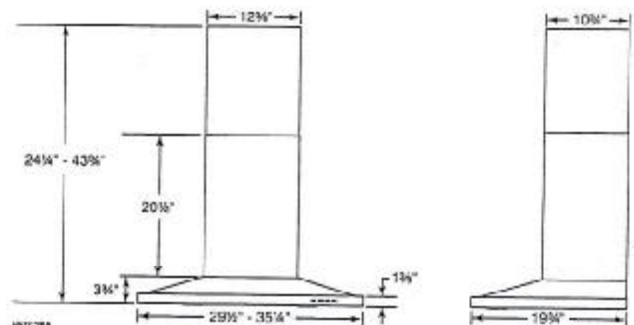

## AIR FLOW PERFORMANCE

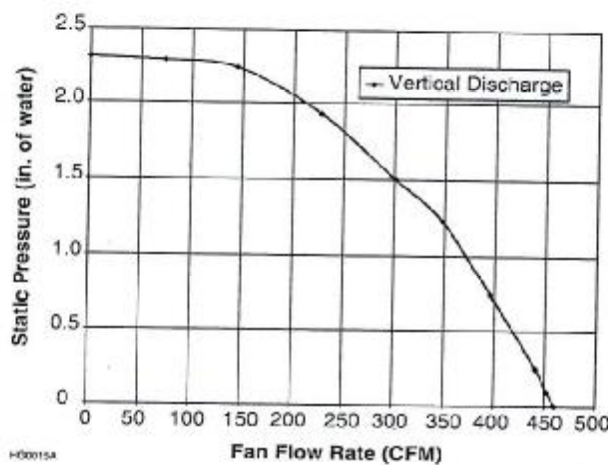

## REQUIREMENTS & STANDARDS

- Complies with UL 507 requirements



HVI-2100 CERTIFIED RATINGS comply with new testing technologies and procedures prescribed by the Home Ventilating Institute, for off-the-shelf products, as they are available to consumers. Product performance is rated at 0.1 in. (2.54 mm) static pressure, based on tests conducted in a state-of-the-art test laboratory. Sones are a measure of humanly-perceived loudness, based on laboratory measurements.

www.venmar.ca

Venmar Ventilation Inc., 550 Lemire Blvd., Drummondville, Québec, Canada J2C 7W9 - Tel.: 1-800-567-3855 Fax: 1-800-567-1715

PROJECT	REMARKS
LOCATION	
MODEL No.	
QTY.	
SUBMITTED BY	
DATE	

PRODUCT SPECIFICATIONS SUBJECT TO CHANGE WITHOUT NOTICE.

VJ5106130903