



CONSTRUCTION SUMMARY

Carrville Investments Ltd. / Richvale

Lot/Unit: 39 Phase/Building: 1 Model/Floor Plan: The Elm (20-3) Elev B

AUDIO AND SECURITY

Inv.3739	1 - GRAND ALARMS TO CONTACT PURCHASER DIRECTLY TO ARRANGE THE LOCATION OF THE STANDARD CABLE AND TELEPHONE ROUGH IN OUTLETS	
Line 48686	Note:	
12Jul16 / 12Jul16		

CABINETRY APPLIANCE - FRIDGE

Inv.3739	1 - LOCATION: KITCHEN	
	66 CM FRIDGE CABINET - 1 GABLE 66 CM & CABINET 59 CM DEEP - SEE 66CM DEEP PANTRY IF ADJACENT TO PANTRY - COUNTER DEPTH - UPGRADE 1	
Line 48687	Note: AS PER FRENDEL KITCHEN PLAN	
12Jul16 / 12Jul16		

MISCELLANEOUS

Inv.3739	1 - LOCATION: MAIN FLOOR BROOM CLOSET	
	DELETE IN ITS ENTIRETY THE BROOM CLOSET ON THE MAIN FLOOR AND LEAVE FLUSH WALL. DELETE THE FURNITURE NICHE AREA AS PER PLAN	
Line 48688	Note:	
12Jul16 / 12Jul16		

EXTRAS AS PER OFFER

Stainless Steel Fridge, Stove and Dishwasher and front loading washer and dryer in white from Vendors standard samples, no cash value, not transferable. (Supplied only not installed) ** to arrange delivery call: The Brick commercial sales division at (416) 291-1111 Worksheet Note:		
Rogers Free Services Package includes 6 months of: home phone, TV and Internet Service. Worksheet Note:		



INTERIOR COLOUR SCHEME

Purchaser: NATALIA PERETT

Property: 39 of Plan -

Telephone Res. / Bus: (905) 553-5358 /

Project: Carrville Investments Ltd.

Decor Advisor: Steffanee Appio

Model and Elevation: The Elm (20-3) Elev B

Layout Changes: ☐ Yes ☐ No Sketch Attached: ☒ Yes ☐ No Exterior Colour Scheme:

1. Cabinetry	Style and Colour	Counter Top	Hardware
Kitchen / Breakfast	HUMBER WHITE SUGAR	NEW CALEDONIA GRANITE	9677 HANDLE
Kitchen Island	HUMBER WHITE SUGAR	NEW CALEDONIA GRANITE	9677 HANDLE
Laundry Room	N/A	N/A	N/A
Powder Room	HUMBER MERINGUE	1882K-52 CIPOLLINO GRIGIO	9677 HANDLE
Main Bathroom	HUMBER MERINGUE	1882K-52 CIPOLLINO GRIGIO	9677 HANDLE
Master Ensuite Bathroom	HUMBER LATITUDE EAST	1881K-52 CIPOLLINO BIANCO	9677 HANDLE
Second Ensuite Bathroom (If Applicable)	HUMBER LATITUDE EAST	1881K-52 CIPOLLINO BIANCO	9677 HANDLE
	LOWER LEVEL BATHROOM	LOWER LEVEL BATHROOM	LL BATHROOM

Appliances

Custom Size Fridge

☐ Yes ☒ No

Valance Lighting

☐ Yes ☒ No

Microwave / Range Hood

☐ Yes ☒ No

Cooktop / Rangetop

☐ Yes ☒ No

Built in Wall Oven

☐ Yes ☒ No

Slide-in Range

☒ Yes ☐ No

Comment

STANDARD EDGE PROFILE TO GRANITE IN KITCHEN

2. Flooring

Selection

FOYER	13" X 13" COSTA MATTE WHITE (GE.CA.WHT.1313.MT)
Main Hall	GENERATIONS SATIN FINISH ENGINEERED HARDWOOD - 3-5/8 X 3/4" GRAPHITE
Back Hall	N/A
Breakfast	GENERATIONS SATIN FINISH ENGINEERED HARDWOOD - 3-5/8 X 3/4" GRAPHITE
Laundry Room	13" X 13" COSTA MATTE WHITE (GE.CA.WHT.1313.MT)
Kitchen	GENERATIONS SATIN FINISH ENGINEERED HARDWOOD - 3-5/8 X 3/4" GRAPHITE
Powder Room	13" X 13" COSTA MATTE WHITE (GE.CA.WHT.1313.MT)
Main Bathroom	13" X 13" COSTA MATTE WHITE (GE.CA.WHT.1313.MT)
Master Ensuite	13" X 13" COSTA MATTE WHITE (GE.CA.WHT.1313.MT)
Bathroom (If Applicable)	13" X 13" COSTA MATTE WHITE (GE.CA.WHT.1313.MT) LOWER LEVEL BATHROOM
Mud Room	N/A
Living Room	N/A
Dining Room	GENERATIONS SATIN FINISH ENGINEERED HARDWOOD - 3-5/8 X 3/4" GRAPHITE
Family / Great Room	GENERATIONS SATIN FINISH ENGINEERED HARDWOOD - 3-5/8 X 3/4" GRAPHITE
Den / Library / Study	N/A
Basement Landing (If Applies)	N/A
Lower Landing (If Applicable)	GENERATIONS SATIN FINISH ENGINEERED HARDWOOD - 3-5/8 X 3/4" GRAPHITE
Upper Landing	GENERATIONS SATIN FINISH ENGINEERED HARDWOOD - 3-5/8 X 3/4" GRAPHITE
Upper Hall	GENERATIONS SATIN FINISH ENGINEERED HARDWOOD - 3-5/8 X 3/4" GRAPHITE
Master Bedroom	STANDARD PAPILO BERBER 17185 SOFT CAMEO
Bedroom #2	STANDARD PAPILO BERBER 17185 SOFT CAMEO
Bedroom #3	STANDARD PAPILO BERBER 17185 SOFT CAMEO
Bedroom #4	N/A
Bedroom #5	N/A
RECREATION ROOM LL	STANDARD PAPILO BERBER 17185 SOFT CAMEO

Flooring Continued on Page 2

Initial:

N.P.

Page 1 of 3



INTERIOR COLOUR SCHEME

Purchaser: NATALIA PERETT

Property: 39 of Plan -

Telephone Res. / Bus: (905) 553-5358 /

Project: Carrville Investments Ltd.

Decor Advisor: Steffanee Appio

Model and Elevation: The Elm (20-3) Elev B

2. Flooring - Continued -

Upgrade Underpad	Type	Area
	STANDARD	RECREATION ROOM & ALL BEDROOMS
Carpet on Stairs	Capped	Runner - *Upgrade
Comment	N/A	N/A

STANDARD PAPILO BERBER 17185 SOFT CAMEO WITH STANDARD UNDERPAD

3. Plumbing Fixtures / Faucets

Kitchen	STD	Second Ensuite	STD	Powder Room	STD
Master Ensuite	STD			Other Room	
Main Bathroom	STD				

Comment

4. Wall Tile

	Tile Selection	Listello	Insert	Insert Selection
Main Bathroom	8" X 10" SERPENTINE BEYAZ WHITE (TR.ST.BYZ.0810)	<input type="checkbox"/>	<input type="checkbox"/>	TUB WALL ENCLOSURE
Master Ensuite				
Tub Deck	N/A	<input type="checkbox"/>	<input type="checkbox"/>	
Tub Apron	N/A	<input type="checkbox"/>	<input type="checkbox"/>	
Tub Surround	N/A	<input type="checkbox"/>	<input type="checkbox"/>	2 X 2 MOSAIC WHITE
Shower Stall	8" X 10" SERPENTINE BEYAZ WHITE (TR.ST.BYZ.0810)	<input type="checkbox"/>	<input type="checkbox"/>	MASTER SHOWER STALL
Second Ensuite	8" X 10" SERPENTINE BEYAZ WHITE (TR.ST.BYZ.0810)	<input type="checkbox"/>	<input type="checkbox"/>	
	LOWER LEVEL BATHROOM TUB WALL ENCLOSURE	<input type="checkbox"/>	<input type="checkbox"/>	
		<input type="checkbox"/>	<input type="checkbox"/>	
Kitchen Backsplash	N/A	<input type="checkbox"/>	<input type="checkbox"/>	
Complete Backsplash	N/A	<input type="checkbox"/>	<input type="checkbox"/>	

Comment

5. Fireplace

	Living Room			Family Room			Other Room - Specify		
	Purchased	As Per Plan	N/A	Purchased	As Per Plan	N/A	Purchased	As Per Plan	N/A
Fireplace Type	<input type="radio"/>	<input type="radio"/>	<input checked="" type="radio"/>	<input type="radio"/>	<input checked="" type="radio"/>	<input type="radio"/>	<input type="radio"/>	<input type="radio"/>	<input checked="" type="radio"/>
Mantle Type				BLF-50 STANDARD					
Over Mantle									
Colour / Stain									
Surround									
Hearth									

Comment

Initial:

NP

Page 2 of 3



INTERIOR COLOUR SCHEME

Purchaser: NATALIA PERETT
 Telephone Res. / Bus: (905) 553-5358 /
 Decor Advisor: Steffanee Appio

Property: 39 of Plan -
 Project: Carrville Investments Ltd.
 Model and Elevation: The Elm (20-3) Elev B

6. Trim Carpentry

Door Hardware STANDARD

Interior Trim STANDARD

Comment

Interior Doors

☐ 2 Panel Arch Top☒ 2 Panel Square Top☐ 6 Panel

Initial for Door Style

N.P.

7. Railings and Pickets

Railing Package STANDARD

Railing Colour GRAPHITE

Picket Colour MATTE BLACK METAL

Wood Stairs ☐ No ☒ Oak

Tread Colour GRAPHITE

Comment

STAIN OAK STAIRS TO COMPLIMENT HARDWOOD - GRAPHITE COLOUR

8. Plaster Mouldings and Medallions

Foyer

Main Hall

Living Room

Dining Room

Family Room

Kitchen/Breakfast

Den/Library

Lower Landing

Comment

9. Wall Paint

STANDARD SENATOR WHITE

Smooth Ceilings

☐ First Floor☐ First Floor incl. Second Floor Hall☐ First and Second Floor☒ Throughout☐ Not Applicable

Trim Paint

10. Additional Comments

11. Disclaimers and Notes

- Colours of all materials are as close as possible to builder's selection, but not necessarily identical due to variances in manufacturing.
- Any extras listed above are null and void unless accompanied by a separate invoice/amendment. Said invoice must be paid in full.
- The Purchaser acknowledges that after Interior Colour Selection form is signed and dated, no further changes will be permitted other than re-selection due to unavailability. Purchaser's Initials
- The Purchaser acknowledges reading and accepting the "Senator Homes Décor Centre Disclaimers" form. This document contains other miscellaneous disclaimers.

This Interior Colour Selection is final and approved by:

Purchaser:

Signature: Natalia Perett Date: 12 July 2016

Vendor:

Carrville Investments Ltd.



richdale
SOUTH RICHMOND HILL
SCHEDULE B

Site Carrollville Lot 37
Date 7/12/16
Purchaser Initials NP Production Initials _____

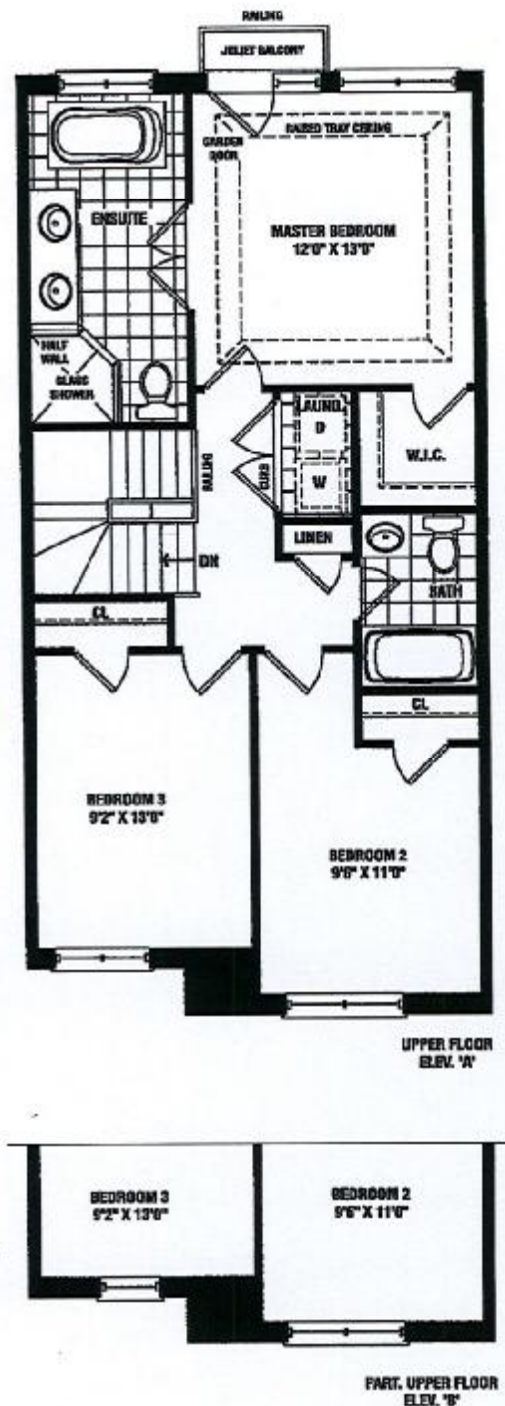

Actual usable square footage may vary from that stated herein. The floor plan may be mirror image/reverse from that shown. E & O.E. 20-0

N.P.
SENATOR
HOMES