



CONSTRUCTION SUMMARY

Carrville Investments Ltd. / Richvale

Lot/Unit: 35    Phase/Building: 1    Model/Floor Plan: The Luna (22-1) Elev B

AUDIO AND SECURITY

Inv.3706	1 - LOCATION: GRAND ALARMS	
	GRAND ALARMS TO CONTACT PURCHASER DIRECTLY TO LOCATE STANDARD CABLE AND TELEPHONE ROUGH IN.	
	CONTACT AT GRAND ALARMS: JACQUELINE (416) 410-3020	
Line 48232	Note:	
27Jun16 / 27Jun16		

CABINETRY

Inv.3773	1 - LOCATION: KITCHEN	
	SUPPLY AND INSTALL LARGE CROWN MOULDING WITH FASCIA PANEL TO UPPER CABINETS TO CLOSE OFF SPACE BETWEEN TOP OF CABINETS AND CEILING AND/OR BULKHEAD.	
Line 49141	Note:	
2Aug16 / 2Aug16		

CABINETRY APPLIANCE - FRIDGE

Inv.3773	1 - 66 CM FRIDGE CABINET - 1 GABLE 66 CM & CABINET 59 CM DEEP - SEE 66CM DEEP PANTRY IF ADJACENT TO PANTRY - COUNTER DEPTH - UPGRADE 1	
Line 49135	Note: SEE FRENDEL KITCHEN LAYOUT ATTACHED FOR LOCATION.	
2Aug16 / 2Aug16		

CABINETRY VANITY

Inv.3773	1 - LOCATION: MASTER ENSUITE VANITY	
	VANITY BANK OF DRAWERS - 55 CM MAXIMUM - UPGRADE 1	
Line 49142	Note:	
2Aug16 / 2Aug16		

ELECTRICAL

Inv.3773	1 - LOCATION: FAMILY ROOM	
	SUPPLY AND INSTALL CAPPED CEILING LIGHT ROUGH-IN ONLY ON SEPARATE SINGLE SWITCH. DO NOT DELETE STANDARD SWITCHED OUTLET.	
Line 49133	Note: LOCATION AS PER SKETCH ATTACHED.	
2Aug16 / 2Aug16		

Inv.3773	1 - LOCATION: DINING ROOM	
	SUPPLY AND INSTALL CAPPED CEILING LIGHT ROUGH-IN ONLY ON SEPARATE SINGLE SWITCH. DO NOT DELETE STANDARD SWITCHED OUTLET.	
Line 49134	Note: LOCATION AS PER SKETCH ATTACHED.	
2Aug16 / 2Aug16		

HEATING AND AIR CONDITIONING

Inv.3706	1 - SUPPLY AND INSTALL ROUGH IN GAS LINE TO STANDARD STOVE LOCATION. 110 ELECTRICAL OUTLET WILL BE PROVIDED AND THE STANDARD 240 VOLT WILL REMAIN. PURCHASER TO SUPPLY AND INSTALL THEIR OWN APPLIANCE AFTER CLOSING.	
Line 48234	Note:	
27Jun16 / 27Jun16		



CONSTRUCTION SUMMARY

Carrville Investments Ltd. / Richvale

Lot/Unit: 35    Phase/Building: 1    Model/Floor Plan: The Luna (22-1) Elev B

MISCELLANEOUS

TILE

Inv.3773	1 - FLOOR TILE - UPGRADE 4 - ENSUITE BATHROOM FLOOR	
	12X24 NIAGARA FALLS - WHITE (QT.NF.WHT.1224)	
Line 49137	Note: STANDARD STACKED LOCATION - SEE FLOORPLAN FOR TILE DIRECTION	
2Aug16 / 2Aug16		
Inv.3773	1 - FLOOR TILE - UPGRADE 4 - MAIN BATHROOM FLOOR	
	12X24 NIAGARA FALLS - WHITE (QT.NF.WHT.1224)	
Line 49138	Note: STANDARD STACKED LOCATION - SEE FLOOR PLAN FOR TILE DIRECTION	
2Aug16 / 2Aug16		
Inv.3773	1 - FLOOR TILE - UPGRADE 4 - POWDER ROOM FLOOR	
	12X24 NIAGARA FALLS - WHITE (QT.NF.WHT.1224)	
Line 49139	Note: STANDARD STACKED INSTALLATION - SEE FLOOR PLAN FOR TILE DIRECTION	
2Aug16 / 2Aug16		
Inv.3773	1 - FLOOR TILE - UPGRADE 4 - VESTIBULE FLOOR	
	12X24 NIAGARA FALLS - WHITE (QT.NF.WHT.1224)	
Line 49140	Note: STANDARD STACKED INSTALLATION - SEE FLOOR PLAN FOR TILE DIRECTION	
2Aug16 / 2Aug16		

EXTRAS AS PER OFFER

Worksheet    Note:	
Stainless Steel Fridge, Stove and Dishwasher and front loading washer and dryer in white from Vendors standard samples, no cash value, not transferable. (Supplied only not installed) ** to arrange delivery call: The Brick commercial sales division at (416) 291-1111 Worksheet    Note:	
Rogers Free Services Package includes 6 months of: home phone, TV and Internet Service. Worksheet    Note:	

## PURCHASER'S EXTRAS

Richvale - Carrville Investments Ltd.

PURCHASERS: Fawad Mushfeq and Mehin Malik Aslanov

TEL: RES.: 416-357-7164

LOT NUMBER		PHASE	HOUSE TYPE		
35		1	The Luna (22-1) Elev B		
ITEM	QTY	EXTRA / CHANGE		PRICE	COMMENTS
1		1 - PURCHASER IS ENTITLED TO RECEIVE \$7,500 DECOR BONUS AS PER VENDOR'S AMENDEMENT TO APS DATED JULY 22ND, 2016. Note:		-\$7,500.00	Each
2		1 - LOCATION: FAMILY ROOM  SUPPLY AND INSTALL CAPPED CEILING LIGHT ROUGH-IN ONLY ON SEPARATE SINGLE SWITCH. DO NOT DELETE STANDARD SWITCHED OUTLET. Note: LOCATION AS PER SKETCH ATTACHED.		\$ 295.63	Each
3		1 - LOCATION: DINING ROOM  SUPPLY AND INSTALL CAPPED CEILING LIGHT ROUGH-IN ONLY ON SEPARATE SINGLE SWITCH. DO NOT DELETE STANDARD SWITCHED OUTLET. Note: LOCATION AS PER SKETCH ATTACHED.		\$ 295.63	Each
4		1 - 66 CM FRIDGE CABINET - 1 GABLE 66 CM & CABINET 59 CM DEEP - SEE 66CM DEEP PANTRY IF ADJACENT TO PANTRY - COUNTER DEPTH - UPGRADE 1 Note: SEE FRENDEL KITCHEN LAYOUT ATTACHED FOR LOCATION.		\$ 921.25	Each
5		1 - FLOOR TILE - UPGRADE 4 - ENSUITE BATHROOM FLOOR  12X24 NIAGARA FALLS - WHITE (QT.NF.WHT.1224) Note: STANDARD STACKED LOCATION - SEE FLOORPLAN FOR TILE DIRECTION		\$ 970.00	Each
6		1 - FLOOR TILE - UPGRADE 4 - MAIN BATHROOM FLOOR  12X24 NIAGARA FALLS - WHITE (QT.NF.WHT.1224) Note: STANDARD STACKED LOCATION - SEE FLOOR PLAN FOR TILE DIRECTION		\$ 315.00	Each
7		1 - FLOOR TILE - UPGRADE 4 - POWDER ROOM FLOOR  12X24 NIAGARA FALLS - WHITE (QT.NF.WHT.1224) Note: STANDARD STACKED INSTALLATION - SEE FLOOR PLAN FOR TILE DIRECTION		\$ 245.00	Each
8		1 - FLOOR TILE - UPGRADE 4 - VESTIBULE FLOOR  12X24 NIAGARA FALLS - WHITE (QT.NF.WHT.1224) Note: STANDARD STACKED INSTALLATION - SEE FLOOR PLAN FOR TILE DIRECTION		\$ 525.00	Each
9		1 - LOCATION: KITCHEN  SUPPLY AND INSTALL LARGE CROWN MOULDING WITH FASCIA PANEL TO UPPER CABINETS TO CLOSE OFF SPACE BETWEEN TOP OF CABINETS AND CEILING AND/OR BULKHEAD. Note:		\$ 3,200.00	Each
10		1 - LOCATION: MASTER ENSUITE VANITY  VANITY BANK OF DRAWERS - 55 CM MAXIMUM - UPGRADE 1 Note:		\$ 687.50	Each

\*\*\*\*\*Enter TAX number\*\*\*\*\*

PREPARED BY: Veronica Ashton

PE 3,773-1

SenInvoiceSQL.rpt 22jun15

Initials: FM M.M

CONSTRUCTION SCHEDULING APPROVAL	
PER:	
DATE:	Aug - 20, 2016

## PURCHASER'S EXTRAS

Richvale - Carrville Investments Ltd.

PURCHASERS: Fawad Mushfeq and Mehin Malik Aslanov

TEL: RES.: 416-357-7164

LOT NUMBER	PHASE	HOUSE TYPE
35	I	The Luna (22-1) Elev B

ITEM	QTY	EXTRA / CHANGE	PRICE	COMMENTS
------	-----	----------------	-------	----------

-\$45.00 Sub Total

-\$50.85 Total

This is your direction to install the above extras in accordance with the following terms and conditions:

1. In the event the work on the house has progressed beyond the point where the items covered by this extra cannot be installed without entailing any unusual expense, then this order is to be cancelled and any deposit paid in connection with the same is to be refunded to the purchaser.
2. The Vendor will undertake to incorporate the work covered by the sales extra in the construction of the house but will not be liable to the purchaser in any way, if for any reason the work covered by the extra is not carried out. In that event, any monies paid in connection with the same shall be returned to the purchaser.
3. It is understood and agreed that if for any reason whatsoever the transaction of Purchase and Sale is not completed, the total cost of extras ordered are not refundable to the Purchaser(s).
4. Extras or changes will not be processed unless signed by the Vendor.
5. These extras may not be amended without the written consent of Carrville Investments Ltd.
6. The purchaser(s) and the builder acknowledge and agree that this "Purchaser's Extra" form shall not be deemed to be part of the agreement of purchase and sale entered into between them, nor an addendum thereto.

### Payment Summary

Paid By Amount

Total Payment:

PURCHASER:

  
Fawad Mushfeq

02-Aug-16  
DATE

VENDOR:



PER: Carrville Investments Ltd.

PURCHASER:

  
Mehin Malik Aslanov

02-Aug-16  
DATE

\*\*\*\*\*Enter TAX number\*\*\*\*\*

PREPARED BY: Veronica Ashton

PE 3.773-2

SenInvoiceSQL.rpt 22Jun15

Initials: FM M.M

CONSTRUCTION SCHEDULING APPROVAL

PER:

DATE:

Aug. 10, 2016



**PURCHASER'S EXTRAS**  
**Richvale - Carrville Investments Ltd.**

**PURCHASERS:** Fawad Mushfeq and Mehin Malik Aslanov

**TEL: RES.: 416-357-7164**

<b>LOT NUMBER</b> 35	<b>PHASE</b> 1	<b>HOUSE TYPE</b> The Luna (22-1) Elev B
-------------------------	-------------------	---

**PURCHASER ACKNOWLEDGEMENT**

**SENATOR HOMES DÉCOR CENTRE**

**Purchaser's order for upgrades MUST ACCOMPANY ALL UPGRADED SELECTIONS OR THESE UPGRADES WILL NOT BE DONE.**

Every effort will be made to ensure that colours and materials selected are as close as possible to sample. However, due to variances in manufacturing and scheduling, we do not guarantee identical colour matching.

**MARBLE:** Due to the many variables that can affect the pattern and/or design, frequently the marble installed on the fireplace and thresholds will not be identical to the samples. We will make every attempt to come as close to the samples as possible but cannot be responsible for results, which differ from the samples.

**STAINS:** Due to the many variables that can affect the outcome of a stain colour on wood, staircases and pickets and rails will not be identical to samples. Factors such as density, age, humidity, air temperature, and the uniqueness of each piece of wood can result in wide variations in darkness or lightness. We will make every attempt to come as close to the samples as possible, but cannot be responsible for results, which differ from the samples. Note: The stain on pre-finished hardwood floors will not be an exact match to the stain colours available on stairs, pickets and rails. The Purchaser is responsible for choosing the stain on these areas to their satisfaction.

**HARDWOOD FLOORING:** The purchaser is advised that cupping and shrinkage are characteristics of hardwood flooring normally appearing some time after installation, and no warranty is provided by the flooring supplier with respect to such cupping and shrinkage. The vendor agrees to install any hardwood flooring ordered by the purchaser in a good and workmanlike manner, but shall not be responsible for, and is hereby released by the purchaser from responsibility and liability for cupping and shrinkage of hardwood flooring. Note: No two pieces of wood are identical. Variations in colour tone and grain patterns make a perfect colour match virtually impossible. It is generally agreed that these variations add to the natural beauty of wood floors.



**APPLIANCES:** All Fridge Openings to be 36" total width.  
Please advise décor Centre at time of colour appointment if custom sizing of cabinets is required for built-in appliances.  
The purchaser is responsible for all costs & fees associated with changes to pre-manufactured kitchens made subsequent to colour appointments.

**KITCHEN CABINETS:** The kitchen you purchase will undoubtedly contain slight colour variations. The degree of these variations is virtually impossible to determine before the kitchen is installed in its intended location. The amount of and type of lighting will also affect various highlights in the finish. Note: No two pieces of wood are identical. Variations in colour tone and grain patterns make a perfect colour match virtually impossible. It is generally agreed that these variations add to the natural beauty of a wood kitchen.

**CERAMIC TILES:** The purchaser is advised that shade variables may exist in some tiles. The sample tiles in the Design Centre may not be an exact match to the tiles installed in your home.  
Note: there may be variations of height on any flooring transition changes.

**\*\*NO FURTHER CHANGES WILL BE ACCEPTED TO ANY ITEM UPON COMPLETION OF THE STRUCTURAL APPOINTMENT\*\***

**\*\*NO FURTHER CHANGES WILL BE ACCEPTED TO ANY ITEM UPON COMPLETION OF THE COLOUR CHART\*\***

<b>PURCHASER:</b>	 Fawad Mushfeq	02-Aug-16 DATE	<b>VENDOR:</b>	 PER: Carrville Investments Ltd.
<b>PURCHASER:</b>	 Mehin Malik Aslanov	02-Aug-16 DATE		

\*\*\*\*\*Enter TAX number\*\*\*\*\*

**PREPARED BY:** Veronica Ashton

**PE 3,773-3**  
SenInvoiceSQL.rpt 22jun15

<b>CONSTRUCTION SCHEDULING APPROVAL</b>	
<b>PER:</b>	
<b>DATE:</b>	Aug-10, 2016





## INTERIOR COLOUR SCHEME

Purchasers: Fawad Mushfeq &amp; Mehin Malik Aslanov

Property: 35 of Plan -

Telephone Res. / Bus: (416) 357-7164 /

Project: Carrville Investments Ltd.

Decor Advisor: Veronica Ashton

Model and Elevation: The Luna (22-1) Elev B

Layout Changes: ☐ Yes ☒ No Sketch Attached: ☐ Yes ☒ No Exterior Colour Scheme: 

## 1. Cabinetry

	Style and Colour	Counter Top	Hardware
Kitchen / Breakfast	HUMBER - WHITE SUGAR	NEW CALEDONIA GRANITE	HANDLE 9677
Kitchen Island	HUMBER - WHITE SUGAR	NEW CALEDONIA GRANITE	HANDLE 9677
Laundry Room			
Powder Room	KINGSTON MAPLE - SOAPSTONE	CALCUTTA MARBLE 4925K-07	KNOB 196
Main Bathroom	KINGSTON MAPLE - SOAPSTONE	CALCUTTA MARBLE 4925K-07	KNOB 196
Master Ensuite Bathroom	KINGSTON MAPLE - CAVIAR	CALCUTTA MARBLE 4925K-07	KNOB 171
Second Ensuite Bathroom (If Applicable)	KINGSTON MAPLE - SOAPSTONE	CALCUTTA MARBLE 4925K-07	KNOB 196
	(LOWER LEVEL BATHROOM)	(LOWER LEVEL BATHROOM)	(LL BATHROOM)

## Appliances

## Custom Size Fridge

☐ Yes ☒ No

## Valance Lighting

☐ Yes ☒ No

## Microwave / Range Hood

☐ Yes ☒ No

## Cooktop / Rangetop

☐ Yes ☒ No

## Built in Wall Oven

☐ Yes ☒ No

## Slide-in Range

☒ Yes ☐ No

## Comment

STANDARD EDGE TO GRANITE IN KITCHEN

## 2. Flooring

	Selection
Foyer	UPG 4 - 12X24 NIAGARA FALLS - WHITE (QT.NF.WHT.1224)
Main Hall	3/4" X 3-5/8" GENERATIONS OAK ENG. HARDWOOD - COBALT
Back Hall	N/A
Breakfast	3/4" X 3-5/8" GENERATIONS OAK ENG. HARDWOOD - COBALT
Laundry Room	13X13 COSTA MATTE - GREY (GE.CA.GRY.1313)
Kitchen	3/4" X 3-5/8" GENERATIONS OAK ENG. HARDWOOD - COBALT
Powder Room	UPG 4 - 12X24 NIAGARA FALLS - WHITE (QT.NF.WHT.1224)
Main Bathroom	UPG 4 - 12X24 NIAGARA FALLS - WHITE (QT.NF.WHT.1224)
Master Ensuite	UPG 4 - 12X24 NIAGARA FALLS - WHITE (QT.NF.WHT.1224)
Bathroom (If Applicable)	(LOWER LEVEL) 13X13 COSTA MATTE - GREY (GE.CA.GRY.1313)
Mud Room	N/A
Living Room	3/4" X 3-5/8" GENERATIONS OAK ENG. HARDWOOD - COBALT
Dining Room	3/4" X 3-5/8" GENERATIONS OAK ENG. HARDWOOD - COBALT
Family / Great Room	3/4" X 3-5/8" GENERATIONS OAK ENG. HARDWOOD - COBALT
Den / Library / Study	N/A
Basement Landing (If Applies)	
Lower Landing (If Applicable)	3/4" X 3-5/8" GENERATIONS OAK ENG. HARDWOOD - COBALT
Upper Landing	3/4" X 3-5/8" GENERATIONS OAK ENG. HARDWOOD - COBALT
Upper Hall	3/4" X 3-5/8" GENERATIONS OAK ENG. HARDWOOD - COBALT
Master Bedroom	STANDARD BERBER PAPILIO CARPET - 17185 SOFT CAMEO
Bedroom #2	STANDARD BERBER PAPILIO CARPET - 17185 SOFT CAMEO
Bedroom #3	STANDARD BERBER PAPILIO CARPET - 17185 SOFT CAMEO
Bedroom #4	N/A
Bedroom #5	N/A
Recreation Room	STANDARD BERBER PAPILIO CARPET - 17185 SOFT CAMEO

Flooring Continued on Page 2

Initial:

FM/MM

Page 1 of 3



## INTERIOR COLOUR SCHEME

CARV - LOT 35 PH 1

Purchasers: Fawad Mushfeq &amp; Mehin Malik Aslanov

Property: 35 of Plan -

Telephone Res. / Bus: (416) 357-7164 /

Project: Carrville Investments Ltd.

Decor Advisor: Veronica Ashton

Model and Elevation: The Luna (22-1) Elev B

## 2. Flooring - Continued -

Upgrade Underpad	Type	Area
	STANDARD	RECREATION ROOM & ALL BEDROOMS
Carpet on Stairs	Capped	Runner - *Upgrade
Comment		

## 3. Plumbing Fixtures / Faucets

Kitchen	STD	Second Ensuite	STD	Powder Room	STD
Master Ensuite	STD			Other Room	
Main Bathroom	STD				
Comment					

## 4. Wall Tile

	Tile Selection	Listello	Insert	Insert Selection
Main Bathroom	8X10 WEAVE - WHITE (QT.WV.WHT.0810)	<input type="checkbox"/>	<input type="checkbox"/>	
Master Ensuite				
Tub Deck		<input type="checkbox"/>	<input type="checkbox"/>	
Tub Apron		<input type="checkbox"/>	<input type="checkbox"/>	
Tub Surround		<input type="checkbox"/>	<input type="checkbox"/>	
Shower Stall	8X10 SERPENTINE - BEYAZ (TR.ST.BYZ.0810)	<input type="checkbox"/>	<input type="checkbox"/>	
Second Ensuite	8X10 WEAVE - WHITE (QT.WV.WHT.0810)	<input type="checkbox"/>	<input type="checkbox"/>	
	(LOWER LEVEL BATHROOM)	<input type="checkbox"/>	<input type="checkbox"/>	
		<input type="checkbox"/>	<input type="checkbox"/>	
Kitchen Backsplash		<input type="checkbox"/>	<input type="checkbox"/>	
Complete Backsplash		<input type="checkbox"/>	<input type="checkbox"/>	
Comment	2X2 MOSAIC TENDER GREY FLOOR TILES IN MASTER ENSUITE SHOWER STALL			

## 5. Fireplace

	Living Room			Family Room			Other Room - Specify		
	Purchased	As Per Plan	N/A	Purchased	As Per Plan	N/A	Purchased	As Per Plan	N/A
Fireplace Type	<input type="radio"/>	<input type="radio"/>	<input checked="" type="radio"/>	<input type="radio"/>	<input checked="" type="radio"/>	<input type="radio"/>	<input type="radio"/>	<input type="radio"/>	<input checked="" type="radio"/>
Mantle Type				Standard BLF-50					
Over Mantle									
Colour / Stain									
Surround									
Hearth									
Comment									

Initial:

FM/M.M

Page 2 of 3





## INTERIOR COLOUR SCHEME

Purchasers: Fawad Mushfeq & Mehin Malik Aslanov  
Telephone Res. / Bus: (416) 357-7164 /  
Decor Advisor: Veronica Ashton

Property: 35 of Plan -  
Project: Carrville Investments Ltd.  
Model and Elevation: The Luna (22-1) Elev B

## 6. Trim Carpentry

Door Hardware STANDARD

Interior Trim STANDARD

Comment

## Interior Doors

☐ 2 Panel Arch Top☒ 2 Panel Square Top☐ 6 PanelInitial for Door Style FM/MM

## 7. Railings and Pickets

Railing Package STANDARD

Railing Colour COBALT

Picket Colour MATTE BLACK METAL

Wood Stairs ☐ No ☒ Oak

Tread Colour COBALT

Comment

STAIN STAIRS TO COMPLIMENT HARDWOOD FLOORING "COBALT"

## 8. Plaster Mouldings and Medallions

Foyer

Main Hall

Living Room

Dining Room

Family Room

Kitchen/Breakfast

Den/Library

Lower Landing

Comment

## 9. Wall Paint

STANDARD SENATOR WHITE

## Smooth Ceilings

☐ First Floor☐ First Floor incl. Second Floor Hall☐ First and Second Floor☒ Throughout☐ Not Applicable

Trim Paint STANDARD

## 10. Additional Comments

## 11. Disclaimers and Notes

- Colours of all materials are as close as possible to builder's selection, but not necessarily identical due to variances in manufacturing.
- Any extras listed above are null and void unless accompanied by a separate invoice/amendment. Said invoice must be paid in full.
- The Purchaser acknowledges that after Interior Colour Selection form is signed and dated, no further changes will be permitted other than re-selection due to unavailability. FM/MM Purchaser's Initials
- The Purchaser acknowledges reading and accepting the "Senator Homes Decor Centre Disclaimers" form. This document contains other miscellaneous disclaimers.

This Interior Colour Selection is final and approved by:

Purchaser:

Signature: [Signature] Date: 02-Aug-16Signature: [Signature] Date: 02-Aug-16

Vendor:

[Signature]  
Carrville Investments Ltd.



CARV - LOT 35-PH1

This sketch is provided solely for reference to those items noted on the accompanying "Upgrades/Extras". All other details, dimensions & layouts are for illustrative purposes only and may not be applicable to the Purchaser's Model

Site Carnille Lot 35  
Date Aug 2 / 2016  
Purchaser Initials FM Production Initials \_\_\_\_\_

richdale  
SOUTH RICHMOND HILL  
SCHEDULE B

X = additional  
capped ceiling outlet.  
↔ = Tile direction  
(Foyer, Powder)  
↑ = Tile direction  
(Main Bath, Master ensuite)



LUNA CORNER  
2,298 SQ. FT.  
ELEV. A & B

Fm  
SENATOR  
HOMES

Actual usable square footage may vary from that stated herein. The floor plan may be mirror image/reverse from that shown. E & O.E. 22-1







F R E N D E L  
K I T C H E N S L I M I T E D  
1380 Brimley Drive, Markham, ON L4W 1C5

Tel: (905) 470-7899  
Fax: (905) 470-1862  
www.frendel.com

(1) 55cm deep fridge  
uppers with 60cm  
gable.

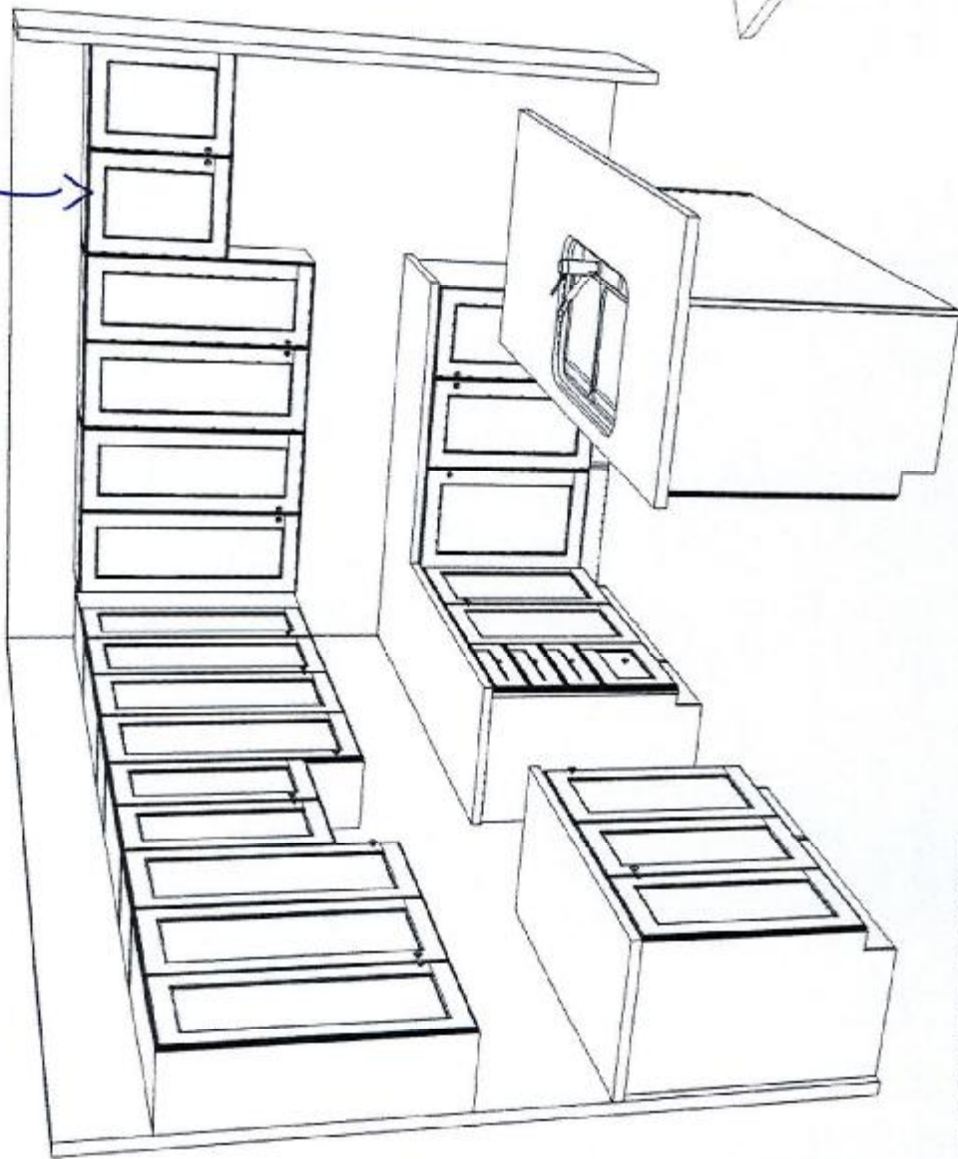
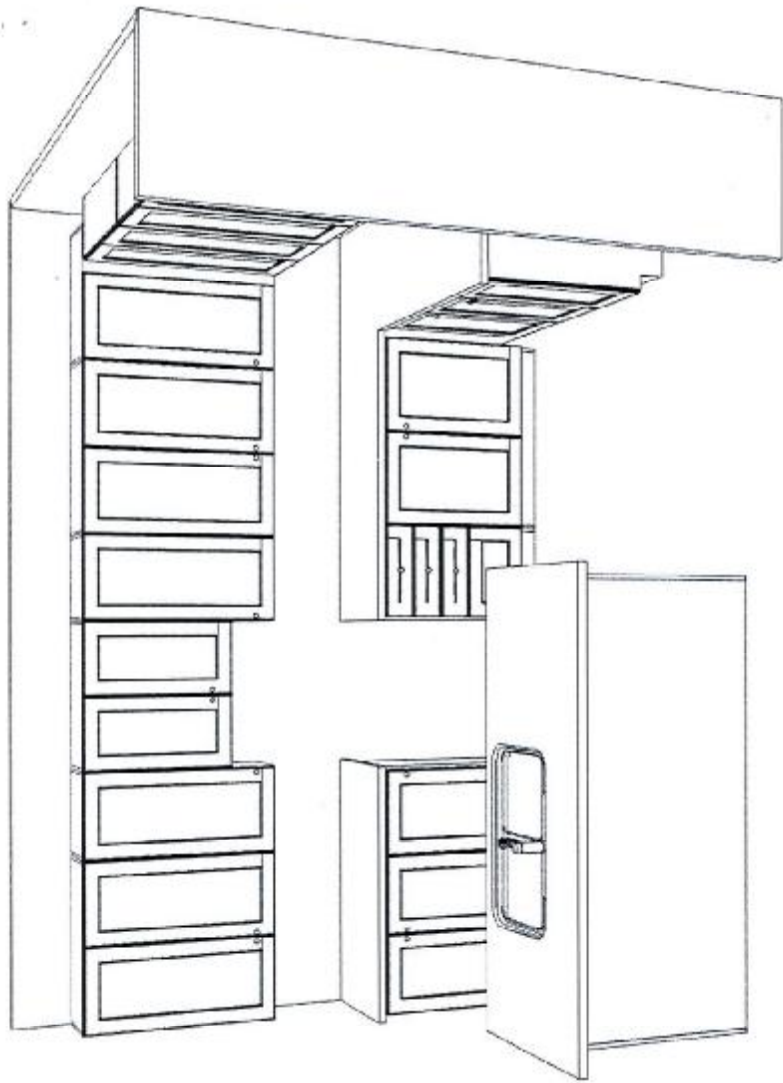

CARV. lot 35 PH 1

This sketch is provided solely for reference to those items  
noted on the accompanying "Upgrade/Extras". All other  
details, dimensions & layouts are for illustrative purposes  
only and may not be applicable to the Purchaser's Model

Site Carvine

Lot 35

Date Aug 2/16

Purchaser Initials FM

Production Initials \_\_\_\_\_

June 2, 2016

SENATOR HOMES  
RICHVALE SOUTH - RICHMOND HILL  
MODEL: TH-22-1-END (LUNA) ELEV. A, B  
TOTAL UNITS: 8