



CONSTRUCTION SUMMARY

Carrville Investments Ltd. / Richvale

Lot/Unit: 46    Phase/Building: 1    Model/Floor Plan: The Elm (20-3) Elev A

AUDIO AND SECURITY

Inv.3760	1 - GRAND ALARMS TO CONTACT PURCHASER DIRECTLY TO ARRANGE THE LOCATION OF THE STANDARD CABLE AND TELEPHONE ROUGH IN OUTLETS	
Line 49013	Note: CONTACT AT GRAND ALARMS: JACQUELINE (416) 410-3020	
25Jul16 / 25Jul16		

CABINETRY APPLIANCE - FRIDGE

Inv.3760	1 - LOCATION: KITCHEN	
	66 CM FRIDGE CABINET - 1 GABLE 66 CM & CABINET 59 CM DEEP - SEE 66CM DEEP PANTRY IF ADJACENT TO PANTRY - COUNTER DEPTH - UPGRADE 1	
Line 49018	Note: AS PER FRENDEL KITCHEN PLAN	
25Jul16 / 25Jul16		

CABINETRY BASE CABINETS

Inv.3760	1 - LOCATION: KITCHEN	
	BASE PIE CUT CORNER - UPGRADE 1	
Line 49020	Note: AS PER FRENDEL KITCHEN PLAN	
25Jul16 / 25Jul16		

CABINETRY WALL AND HUTCH

Inv.3760	1 - LOCATION: KITCHEN	
	UPPER ANGLE CORNER - PRICE IS PER UNIT - UPGRADE 1 NO GLASS OR MATCHING INTERIOR	
Line 49019	Note: AS PER FRENDEL KITCHEN PLAN	
25Jul16 / 25Jul16		

ELECTRICAL

Inv.3760	1 - LOCATION: FAMILY ROOM	
	SUPPLY AND INSTALL CAPPED CEILING LIGHT ROUGH-IN ONLY ON SEPARATE SINGLE SWITCH TO BE CENTRED IN CEILING OF FAMILY ROOM. DO NOT DELETE THE STANDARD SWITCHED OUTLET	
Line 49017	Note: LOCATION AS PER SKETCH ATTACHED.	
25Jul16 / 25Jul16		

HARDWOOD

Inv.3760	1 - LOCATION: DINING ROOM	
	RELOCATE THE STANDARD BLF-50 ELECTRIC FIREPLACE FROM THE GREAT ROOM TO THE DINING ROOM (IN FURNITURE NICHE AREA). CENTRE TO WALL AND LOCATE AT APPROXIMATELY 60" HIGH ABOVE FINISHED FLOOR	
Line 49014	Note: LOCATION AS PER SKETCH ATTACHED	
25Jul16 / 25Jul16		

HARDWOOD FLOORING



CONSTRUCTION SUMMARY

Carrville Investments Ltd. / Richvale

Lot/Unit: 46    Phase/Building: 1    Model/Floor Plan: The Elm (20-3) Elev A

Inv.3760	1 - LOCATION: LOWER LEVEL HALL	
	UPGRADE 1 - SATIN FINISH GENERATION HOME OAK 3 5/8 INCH X 3/4 INCH - STAINS - BASEMENT HALL	
Line 49025	Note: COBALT COLOUR	
25Jul16 / 25Jul16		
Inv.3760	1 - LOCATION: MASTER BEDROOM	
	UPGRADE 1 - SATIN FINISH GENERATION HOME OAK 3 5/8 INCH X 3/4 INCH - STAINS - MASTER BEDROOM	
Line 49022	Note: COBALT COLOUR	
25Jul16 / 25Jul16		
Inv.3760	1 - LOCATION: BEDROOM 2	
	UPGRADE 1 - SATIN FINISH GENERATION HOME OAK 3 5/8 INCH X 3/4 INCH - STAINS - BEDROOM 2	
Line 49023	Note: COBALT COLOUR	
25Jul16 / 25Jul16		
Inv.3760	1 - LOCATION: BEDRROOM 3	
	UPGRADE 1 - SATIN FINISH GENERATION HOME OAK 3 5/8 INCH X 3/4 INCH - STAINS - BEDROOM 3	
Line 49024	Note: COBALT COLOUR	
25Jul16 / 25Jul16		
Inv.3760	1 - LOCATION: LOWER LEVEL RECREATION ROOM	
	UPGRADE 1 - SATIN FINISH GENERATION HOME OAK 3 5/8 INCH X 3/4 INCH - STAINS - BASEMENT RECREATION ROOM	
Line 49026	Note: COBALT COLOUR	
25Jul16 / 25Jul16		

TILE

Inv.3760	1 - LOCATION: FOYER	
	FLOOR TILE - UPGRADE 8 - VESTIBULE FLOOR STANDARD STACKED INSTALL - SEE SKETCH FOR TILE DIRECTION	
Line 49027	Note: 12" X 24" CLASSIC DESIGN ZEBRINO (BIANCO/GREY) OE.CL.ZEB.1224.PL	
25Jul16 / 25Jul16		
Inv.3760	1 - LOCATION: POWDER ROOM	
	FLOOR TILE - UPGRADE 8 - POWDER ROOM FLOOR STANDARD STACKED INSTALL - SEE SKETCH FOR TILE DIRECTION	
Line 49028	Note: 12" X 24" CLASSIC DESIGN ZEBRINO (BIANCO/GREY) OE.CL.ZEB.1224.PL	
25Jul16 / 25Jul16		
Inv.3760	1 - LOCATION: MASTER ENSUITE	
	FLOOR TILE - UPGRADE 5 - ENSUITE BATHROOM FLOOR STANDARD STACKED INSTALL - SEE SKETCH FOR TILE DIRECTION	
Line 49029	Note: 12" x 24" CALACATTA VINTAGE WHITE HONED (VN.CV.WHT.1224.HN)	
25Jul16 / 25Jul16		



CONSTRUCTION SUMMARY

Carrville Investments Ltd. / Richvale

Lot/Unit: 46    Phase/Building: 1    Model/Floor Plan: The Elm (20-3) Elev A

Inv.3760	1 - LOCATION: MAIN BATHROOM	
	FLOOR TILE - UPGRADE 4 - MAIN BATHROOM FLOOR STANDARD STACKED INSTALL - SEE SKETCH FOR TILE DIRECTION	
Line 49031	Note: 12" X 24" NIAGARA FALLS WHITE (QT.NF.WHT.1224)	
25Jul16 / 25Jul16		

EXTRAS AS PER OFFER

Stainless Steel Fridge, Stove and Dishwasher and front loading washer and dryer in white from Vendors standard samples, no cash value, not transferable. (Supplied only not installed) ** to arrange delivery call: The Brick commercial sales division at (4 Worksheet Note:	
Rogers Free Services Package includes 6 months of: home phone, TV and Internet Service. Worksheet Note:	

CARV - lot 46 PH1



## INTERIOR COLOUR SCHEME

Purchasers: Alexey Starizni & Olga Katznelson

Property: 46 of Plan -

Telephone Res. / Bus: (647) 298-8474 /

Project: Carrville Investments Ltd.

Decor Advisor: Steffanee Appio

Model and Elevation: The Elm (20-3) Elev A

Layout Changes: ☐ Yes ☐ No

Sketch Attached: ☒ Yes ☐ No

Exterior Colour Scheme:

### 1. Cabinetry

	Style and Colour	Counter Top	Hardware
Kitchen / Breakfast	BOSTON PAINT WINTER WHITE	GRIGIO SARDO GRANITE	9677 HANDLE
Kitchen Island	BOSTON PAINT WINTER WHITE	GRIGIO SARDO GRANITE	9677 HANDLE
Laundry Room	N/A	N/A	N/A
Powder Room	BOSTON PAINT WINTER WHITE	4988K-07 MERCURY VESTA	9677 HANDLE
Main Bathroom	SLAB PVC CARAWAY	4987K-07 LECHE VESTA	151 KNOB
Master Ensuite Bathroom	HUMBER MERINGUE	P-344-LM INUKSHUK GREY	151 KNOB
Second Ensuite Bathroom (If Applicable)	SLAB PVC LATITUDE EAST	6698-46 PALOMA POLAR	151 KNOB
	LOWER LEVEL BATHROOM	LOWER LEVEL BATHROOM	LL BATHROOM

### Appliances

#### Custom Size Fridge

☐ Yes ☒ No

#### Valance Lighting

☐ Yes ☒ No

#### Microwave / Range Hood

☐ Yes ☒ No

#### Cooktop / Rangetop

☐ Yes ☐ No

#### Built in Wall Oven

☐ Yes ☒ No

#### Slide-in Range

☒ Yes ☐ No

### Comment

STANDARD PROFILE EDGE TO GRANITE IN KITCHEN

### 2. Flooring

#### Selection

FOYER	12" X 24" CLASSIC DESIGN ZEBRINO (BIANCO/GREY) OE.CL.ZEB.1224.PL - STACKED INSTALL
Main Hall	GENERATIONS SATIN FINISH ENGINEERED HARDWOOD - 3-5/8" X 3/4" - COBALT
Back Hall	N/A
Breakfast	GENERATIONS SATIN FINISH ENGINEERED HARDWOOD - 3-5/8" X 3/4" - COBALT
Laundry Room	13" X 13" COSTA MATTE WHITE (GE.CA.WHT.1313) LOWER LEVEL BATHROOM
Kitchen	GENERATIONS SATIN FINISH ENGINEERED HARDWOOD - 3-5/8" X 3/4" - COBALT
Powder Room	12" X 24" CLASSIC DESIGN ZEBRINO (BIANCO/GREY) OE.CL.ZEB.1224.PL - STACKED INSTALL
Main Bathroom	12" X 24" NIAGARA FALLS WHITE (QT.NF.WHT.1224) STACKED INSTALL
Master Ensuite	12" X 24" CALACATTA VINTAGE WHITE HONED (VN.CV.WHT.1224.HN) STACKED INSTALL
Bathroom (If Applicable)	13" X 13" COSTA MATTE WHITE (GE.CA.WHT.1313) LOWER LEVEL BATHROOM
Mud Room	N/A
Living Room	N/A
Dining Room	GENERATIONS SATIN FINISH ENGINEERED HARDWOOD - 3-5/8" X 3/4" - COBALT
Family / Great Room	GENERATIONS SATIN FINISH ENGINEERED HARDWOOD - 3-5/8" X 3/4" - COBALT
Den / Library / Study	N/A
Basement Landing (If Applies)	N/A
Lower Landing (If Applicable)	GENERATIONS SATIN FINISH ENGINEERED HARDWOOD - 3-5/8" X 3/4" - COBALT
Upper Landing	GENERATIONS SATIN FINISH ENGINEERED HARDWOOD - 3-5/8" X 3/4" - COBALT
Upper Hall	GENERATIONS SATIN FINISH ENGINEERED HARDWOOD - 3-5/8" X 3/4" - COBALT
Master Bedroom	GENERATIONS SATIN FINISH ENGINEERED HARDWOOD - 3-5/8" X 3/4" - COBALT
Bedroom #2	GENERATIONS SATIN FINISH ENGINEERED HARDWOOD - 3-5/8" X 3/4" - COBALT
Bedroom #3	GENERATIONS SATIN FINISH ENGINEERED HARDWOOD - 3-5/8" X 3/4" - COBALT
Bedroom #4	N/A
Bedroom #5	N/A
RECREATION ROOM LL	GENERATIONS SATIN FINISH ENGINEERED HARDWOOD - 3-5/8" X 3/4" - COBALT

Flooring Continued on Page 2

Initial:

O.K. R.A

Page 1 of 3



## INTERIOR COLOUR SCHEME

CARV. LOT 46-PH 1

Purchasers: Alexey Starizni &amp; Olga Katznelson

Property: 46 of Plan -

Telephone Res. / Bus: (647) 298-8474 /

Project: Carrville Investments Ltd.

Decor Advisor: Steffanee Appio

Model and Elevation: The Elm (20-3) Elev A

## 2. Flooring - Continued -

Upgrade Underpad	Type	Area
	N/A	N/A
Carpet on Stairs	Capped	Runner - *Upgrade
Comment	N/A	N/A

NO CARPET IN RECREATION ROOM OR BEDROOMS - UPGRADED TO HARDWOOD

## 3. Plumbing Fixtures / Faucets

Kitchen	STD	Second Ensuite	STD	Powder Room	STD
Master Ensuite	STD			Other Room	
Main Bathroom	STD				

Comment

## 4. Wall Tile

	Tile Selection	Listello	Insert	Insert Selection
Main Bathroom	8" X 10" WEAWE TENDER GREY (QT.WV.TGR.0810)	<input type="checkbox"/>	<input type="checkbox"/>	TUB WAL ENCLOSURE
Master Ensuite				
Tub Deck	N/A	<input type="checkbox"/>	<input type="checkbox"/>	
Tub Apron	N/A	<input type="checkbox"/>	<input type="checkbox"/>	
Tub Surround	N/A	<input type="checkbox"/>	<input type="checkbox"/>	2 X 2 MOSAIC WHITE
Shower Stall	8" X 12" BRICK GLOSSY WHITE (TH.BR.WHT.0812.GL)	<input type="checkbox"/>	<input type="checkbox"/>	MASTER SHOWER STALL
Second Ensuite	8" X 10" SERPENTINE BEYAZ WHITE (TR.ST.BYZ.0810)	<input type="checkbox"/>	<input type="checkbox"/>	
	LOWER LEVEL TUB WALL ENCLOSURE	<input type="checkbox"/>	<input type="checkbox"/>	
		<input type="checkbox"/>	<input type="checkbox"/>	
Kitchen Backsplash	N/A	<input type="checkbox"/>	<input type="checkbox"/>	
Complete Backsplash	N/A	<input type="checkbox"/>	<input type="checkbox"/>	

Comment

## 5. Fireplace

	Living Room			Family Room			Other Room - Specify		
	Purchased	As Per Plan	N/A	Purchased	As Per Plan	N/A	Purchased	As Per Plan	N/A
	<input type="radio"/>	<input type="radio"/>	<input type="radio"/>	<input type="radio"/>	<input type="radio"/>	<input type="radio"/>	<input checked="" type="radio"/>	<input type="radio"/>	<input type="radio"/>
Fireplace Type							BLF-50 STANDARD		
Mantle Type									
Over Mantle									
Colour / Stain									
Surround									
Hearth									

Comment

RELOCATE THE FIREPLACE FROM THE FAMILY ROOM TO THE DINING ROOM - CENTRE TO WALL AND LOCATE AT APPROXIMATELY 60" HIGH ABOVE FINISHED FLOOR - SEE SKETCH FOR LOCATION

Initial:

O.K. R.A.

Page 2 of 3

CARRVILLE LOT 46 PH 1



## INTERIOR COLOUR SCHEME

**Purchasers:** Alexey Starizni & Olga Katznelson  
**Telephone Res. / Bus:** (547) 298-8474 /  
**Decor Advisor:** Steffanee Appio

**Property:** 46 of Plan -  
**Project:** Carrville Investments Ltd.  
**Model and Elevation:** The Elm (20-3) Elev A

### 6. Trim Carpentry

**Door Hardware** STANDARD

**Interior Trim** STANDARD

**Comment**

#### Interior Doors

☐ 2 Panel Arch Top

☒ 2 Panel Square Top

☐ 6 Panel



Initial for Door Style O.K. R.A.

### 7. Railings and Pickets

**Railing Package** STANDARD

**Railing Colour** COBALT

**Picket Colour** MATTE BLACK METAL

**Wood Stairs** ☐ No ☒ Oak

**Tread Colour** COBALT

**Comment**

STAIN OAK STAIRS TO COMPLIMENT HARDWOOD - COBALT COLOUR

### 8. Plaster Mouldings and Medallions

<b>Foyer</b>			<b>Kitchen/Breakfast</b>		
<b>Main Hall</b>			<b>Den/Library</b>		
<b>Living Room</b>			<b>Lower Landing</b>		
<b>Dining Room</b>					
<b>Family Room</b>					

**Comment**

### 9. Wall Paint

STANDARD SENATOR WHITE

#### Smooth Ceilings

☐ First Floor

☐ First Floor incl. Second Floor Hall

☐ First and Second Floor

☒ Throughout

☐ Not Applicable

**Trim Paint**

### 10. Additional Comments

### 11. Disclaimers and Notes

- Colours of all materials are as close as possible to builder's selection, but not necessarily identical due to variances in manufacturing.
- Any extras listed above are null and void unless accompanied by a separate invoice/amendment. Said invoice must be paid in full.
- The Purchaser acknowledges that after Interior Colour Selection form is signed and dated, no further changes will be permitted other than re-selection due to unavailability. Purchaser's Initials
- The Purchaser acknowledges reading and accepting the "Senator Homes Décor Centre Disclaimers" form. This document contains other miscellaneous disclaimers.

This Interior Colour Selection is final and approved by:

**Purchaser:**

Signature: A. Katz Date: July 25/2016

Signature: Rashed Ahmadov

Date: 7/25/2016

Vendor: Carrville Investments Ltd.

CARV. LOT 46-PH1

**richdale**  
SOUTH RICHMOND HILL  
**SCHEDULE B**

This sketch is provided solely for reference to those items noted on the accompanying "Upgrades/Extras". All other details, dimensions & layouts are for illustrative purposes only and may not be applicable to the Purchaser's Model.

Site Careville Lot 46  
Date 7/25/16  
Purchaser Initials O.H. Production Initials \_\_\_\_\_

R.A.

X capped outlet



**ELM**  
2,032 sq. ft.  
Elev. A & B

A.K.  
A.S.

**SENATOR**  
HOMES

Actual usable square footage may vary from that stated herein. This floor plan may be mirror image/reverse from that shown. E & C.E. 55-3

This sketch is provided solely for reference to those items noted on the accompanying 'Upgrades/Extras'. All other details, dimensions & layouts are for illustrative purposes only and may not be applicable to the Purchaser's Model.

Site Canville Lot 46  
Date 7/25/16  
Purchaser Initials O.V. Production Initials R.A.

June 2, 2016

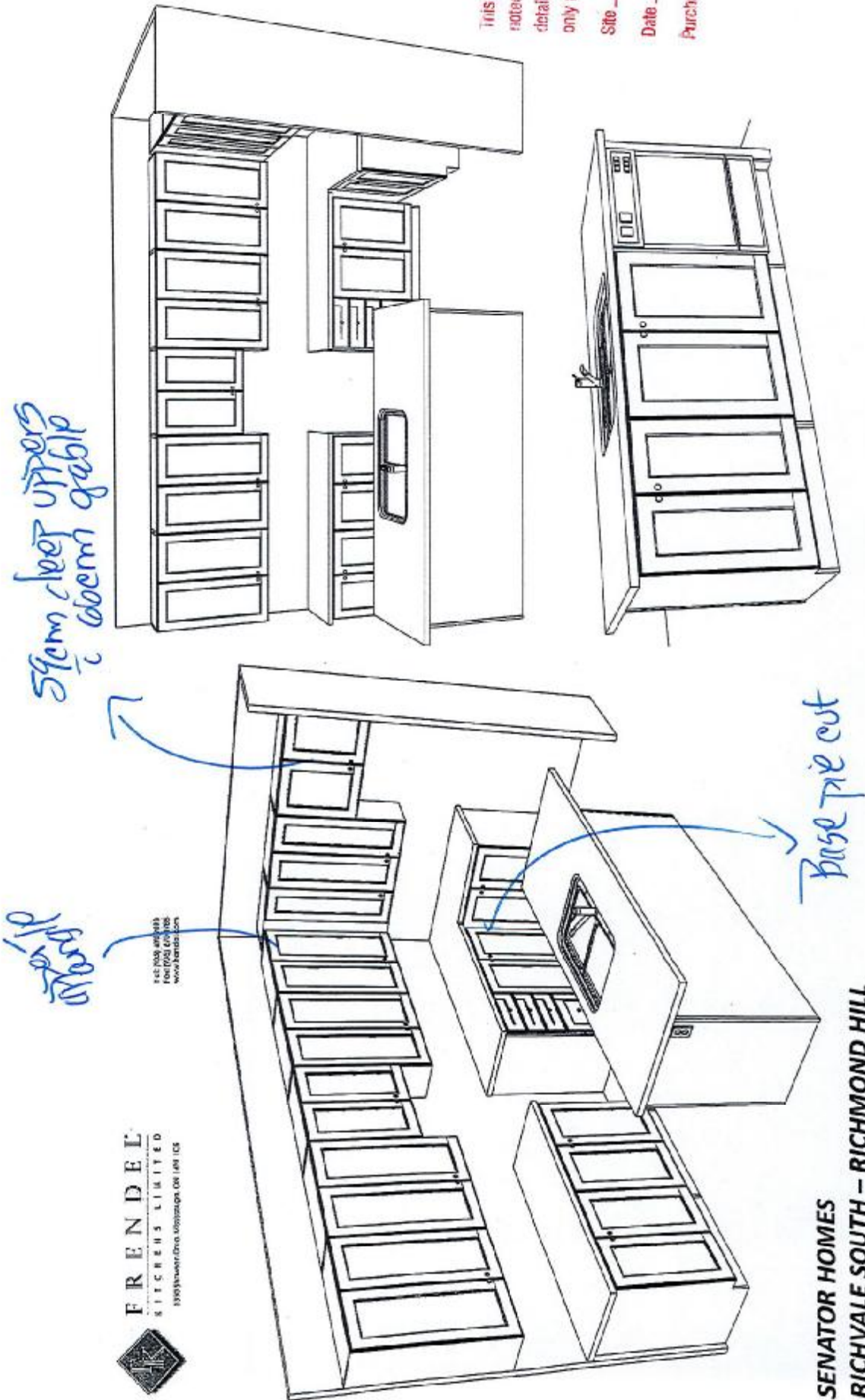

**FRENDEL**  
KITCHENS LIMITED  
1380 Stewart Drive, Upperville, VA 20184  
www.frendel.com

**SENATOR HOMES**  
**RICHVALE SOUTH - RICHMOND HILL**  
**MODEL: TH-20-3 (ELM) ELEV. A, B, B1**  
**TOTAL UNITS: 15**



**\*\*BACKING ON ALL CABINETS**

KITCHEN (1ST FLR)

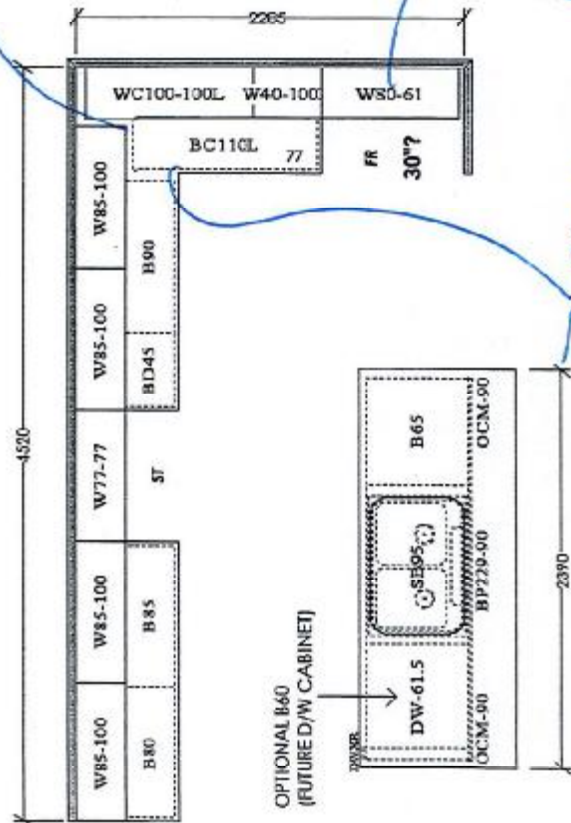

OPTIONAL B60  
(FUTURE D/W CABINET)

7th ASDA

506092  
Sack of paper  
506092

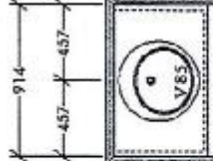

BATH (LOWER LEVEL)

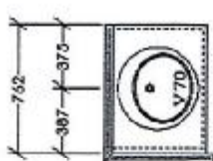

MAIN BATH (2ND FLR)

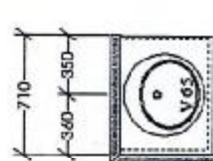

MASTER ENSUITE (2ND FLR)

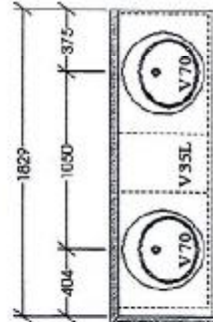

This sketch is provided solely for reference to those items noted on the accompanying "Invoices/Extras". All other details, dimensions & layouts are for illustrative purposes only and may not be applicable to the Purchaser's Model.

Site Wentworth Lot 107 200Date 7/25/16Purchaser Initials O.K. Production Initials \_\_\_\_\_

RA.

**SENATOR HOMES**  
**RICHVALE SOUTH – RICHMOND HILL**  
**MODEL: TH-20-3 (ELM) ELEV. A, B, B1**  
**TOTAL UNITS: 15**

March 15, 2016

CARV. LOT 46-PH 1