



CONSTRUCTION SUMMARY

Carrville Investments Ltd. / Richvale

Lot/Unit: 74 Phase/Building: 1 Model/Floor Plan: The Elm (20-3) Elev B

CABINETRY

Inv.3718	1 - GRAND ALARMS TO CONTACT PURCHASER DIRECTLY TO ARRANGE THE LOCATION OF THE STANDARD CABLE AND TELEPHONE ROUGH IN OUTLETS.	
Line 48335	Note: CONTACT AT GRAND ALARMS: JACQUELINE (416) 410-3020	
4Jul16 / 4Jul16		

CABINETRY APPLIANCE - FRIDGE

Inv.3718	1 - LOCATION: KITCHEN	
	66 CM FRIDGE CABINET - 1 GABLE 66 CM & CABINET 59 CM DEEP - SEE 66CM DEEP PANTRY IF ADJACENT TO PANTRY - COUNTER DEPTH - UPGRADE 1	
Line 48339	Note:	
4Jul16 / 4Jul16		

CABINETRY BASE CABINETS

Inv.3718	1 - LOCATION: KITCHEN	
	BASE PIE CUT CORNER - UPGRADE 1	
Line 48340	Note: TO BE LOCATED AS PER FRENDEL KITCHEN PLAN	
4Jul16 / 4Jul16		

CABINETRY WALL AND HUTCH

Inv.3718	1 - LOCATION: KITCHEN	
	UPPER ANGLE CORNER - PRICE IS PER UNIT - UPGRADE 1 NO GLASS OR MATCHING INTERIOR	
Line 48341	Note: LOCATION AS PER FRENDEL KITCHEN PLAN	
4Jul16 / 4Jul16		

ELECTRICAL

Inv.3718	3 - LOCATION: BREAKFAST ISLAND	
	SUPPLY AND INSTALL CAPPED CEILING LIGHT ROUGH-IN ONLY ON SEPARATE 3 WAY SWITCH TO BE EQUALLY SPACED AND CENTRED IN CEILING ABOVE BREAKFAST ISLAND. DO NOT DELETE STD FIXURES	
Line 48343	Note: LOCATION AS PER SKETCH ATTACHED.	
4Jul16 / 4Jul16		

HARDWOOD FLOORING

Inv.3718	1 - LOCATION: BEDROOM 2	
	UPGRADE 1 - SATIN FINISH GENERATION HOME OAK 3 5/8 INCH X 3/4 INCH - STAINS - BEDROOM 2	
Line 48347	Note: COBALT COLOUR	
4Jul16 / 4Jul16		
Inv.3718	1 - LOCATION: BEDROOM 3	
	UPGRADE 1 - SATIN FINISH GENERATION HOME OAK 3 5/8 INCH X 3/4 INCH - STAINS - BEDROOM 3	
Line 48348	Note: COBALT COLOUR	
4Jul16 / 4Jul16		



CONSTRUCTION SUMMARY

Carrville Investments Ltd. / Richvale

Lot/Unit: 74 Phase/Building: 1 Model/Floor Plan: The Elm (20-3) Elev B

Inv.3718	1 - LOCATION: MASTER BEDROOM	
	UPGRADE 1 - SATIN FINISH GENERATION HOME OAK 3 5/8 INCH X 3/4 INCH - STAINS - MASTER BEDROOM	
Line 48349	Note: COBALT COLOUR	
4Jul16 / 4Jul16		

EXTRAS AS PER OFFER

Stainless Steel Fridge, Stove and Dishwasher and front loading washer and dryer in white from Vendors standard samples, no cash value, not transferable. (Supplied only not installed) ** to arrange delivery call: The Brick commercial sales division at (416) 291-1111 Worksheet Note:	
Rogers Free Services Package includes 6 months of: home phone, TV and Internet Service. Worksheet Note:	



INTERIOR COLOUR SCHEME

Purchaser: Brenda Lee
Telephone Res. / Bus: (647) 993-3829 /
Decor Advisor: Steffanee Appio

Property: 74 of Plan -
Project: Carrville Investments Ltd.

Model and Elevation: The Elm (20-3) Elev B

Layout Changes: ☐ Yes ☐ No

Sketch Attached: ☐ Yes ☒ No

Exterior Colour Scheme:

1. Cabinetry

	Style and Colour	Counter Top	Hardware
Kitchen / Breakfast	HUMBER WHITE SUGAR	NEW CALEDONIA GRANITE	9677 HANDLE
Kitchen Island	HUMBER WHITE SUGAR	NEW CALEDONIA GRANITE	9677 HANDLE
Laundry Room	N/A	N/A	N/A
Powder Room	HUMBER LATITUDE EAST	1881K-52 CIPOLLINO BIANCO	181 KNOB
Main Bathroom	HUMBER MERINGUE	1882K-52 CIPOLLINO GRIGIO	196 KNOB
Master Ensuite Bathroom	HUMBER MERINGUE	1882K-52 CIPOLLINO GRIGIO	196 KNOB
Second Ensuite Bathroom (If Applicable)	HUMBER LATITUDE EAST	1881K-52 CIPOLLINO BIANCO	181 KNOB
	LOWER LEVEL BATHROOM	LOWER LEVEL BATHROOM	LL BATHROOM

Appliances

Custom Size Fridge

☐ Yes ☒ No

Valance Lighting

☐ Yes ☒ No

Microwave / Range Hood

☐ Yes ☒ No

Cooktop / Rangetop

☐ Yes ☒ No

Built in Wall Oven

☐ Yes ☒ No

Slide-in Range

☒ Yes ☐ No

Comment

STANDARD PROFILE EDGE TO GRANITE IN KITCHEN

2. Flooring

Selection

FOYER	13 X 13 COSTA MATTE GREY (GE.CA.GRY.1313.MT)
Main Hall	GENERATIONS SATIN FINISH 3-5/8" X 3/4" ENGINEERED HARDWOOD - COBALT
Back Hall	N/A
Breakfast	GENERATIONS SATIN FINISH 3-5/8" X 3/4" ENGINEERED HARDWOOD - COBALT
Laundry Room	13 X 13 COSTA MATTE WHITE (GE.CA.WHT.1313.MT)
Kitchen	GENERATIONS SATIN FINISH 3-5/8" X 3/4" ENGINEERED HARDWOOD - COBALT
Powder Room	13 X 13 COSTA MATTE GREY (GE.CA.GRY.1313.MT)
Main Bathroom	13 X 13 COSTA MATTE WHITE (GE.CA.WHT.1313.MT)
Master Ensuite	13 X 13 COSTA MATTE WHITE (GE.CA.WHT.1313.MT)
Bathroom (If Applicable)	13 X 13 COSTA MATTE GREY (GE.CA.GRY.1313.MT) LOWER LEVEL BATHROOM
Mud Room	N/A
Living Room	N/A
Dining Room	GENERATIONS SATIN FINISH 3-5/8" X 3/4" ENGINEERED HARDWOOD - COBALT
Family / Great Room	GENERATIONS SATIN FINISH 3-5/8" X 3/4" ENGINEERED HARDWOOD - COBALT
Den / Library / Study	N/A
Basement Landing (If Applies)	N/A
Lower Landing (If Applicable)	GENERATIONS SATIN FINISH 3-5/8" X 3/4" ENGINEERED HARDWOOD - COBALT
Upper Landing	GENERATIONS SATIN FINISH 3-5/8" X 3/4" ENGINEERED HARDWOOD - COBALT
Upper Hall	GENERATIONS SATIN FINISH 3-5/8" X 3/4" ENGINEERED HARDWOOD - COBALT
Master Bedroom	GENERATIONS SATIN FINISH 3-5/8" X 3/4" ENGINEERED HARDWOOD - COBALT
Bedroom #2	GENERATIONS SATIN FINISH 3-5/8" X 3/4" ENGINEERED HARDWOOD - COBALT
Bedroom #3	GENERATIONS SATIN FINISH 3-5/8" X 3/4" ENGINEERED HARDWOOD - COBALT
Bedroom #4	N/A
Bedroom #5	N/A
RECREATION ROOM LL	STANDARD PAPILIO BERBER - 64676 OLIVE CREAM

Flooring Continued on Page 2

Initial:

Page 1 of 3



Purchaser: Brenda Lee
Telephone Res. / Bus: (647) 993-3829 /
Decor Advisor: Steffannee Appio

Property: 74 of Plan -
Project: Carrville Investments Ltd.
Model and Elevation: The Elm (20-3) Elev B

2. Flooring - Continued -

Upgrade Underpad	Type	Area
	STANDARD	RECREATION ROOM ONLY
Carpet on Stairs	Capped	Runner - *Upgrade
Comment	N/A	N/A
STANDARD PAPILO BERBER WITH STANDARD UNDERPAD TO RECREATION ROOM - 64676 OLIVE CREAM		
HARDWOOD TO ALL BEDROOMS ON 2ND FLOOR - SEE PE FOR UPGRADE (ITEMS 7,8,9)		

3. Plumbing Fixtures / Faucets

Kitchen	STD	Second Ensuite	STD	Powder Room	STD
Master Ensuite	STD			Other Room	
Main Bathroom	STD				
Comment					

4. Wall Tile

	Tile Selection	Listello	Insert	Insert Selection
Main Bathroom	8 X 10 SERPENTINE BEYAZ WHITE (TR.ST.BYZ.0810)	<input type="checkbox"/>	<input type="checkbox"/>	TUB WALL ENCLOSURE
Master Ensuite				
Tub Deck	N/A	<input type="checkbox"/>	<input type="checkbox"/>	
Tub Apron	N/A	<input type="checkbox"/>	<input type="checkbox"/>	
Tub Surround	N/A	<input type="checkbox"/>	<input type="checkbox"/>	2 X 2 MOSAIC TENDER GREY
Shower Stall	8 X 10 SERPENTINE BEYAZ WHITE (TR.ST.BYZ.0810)	<input type="checkbox"/>	<input type="checkbox"/>	MASTER SHOWER STALL
Second Ensuite	8 X 10 VENUS GREY (GE.VN.GRY.0810)	<input type="checkbox"/>	<input type="checkbox"/>	
	LOWER LEVEL TUB WALL ENCLOSURE	<input type="checkbox"/>	<input type="checkbox"/>	
		<input type="checkbox"/>	<input type="checkbox"/>	
Kitchen Backsplash	N/A	<input type="checkbox"/>	<input type="checkbox"/>	
Complete Backsplash	N/A	<input type="checkbox"/>	<input type="checkbox"/>	
Comment				

5. Fireplace

	Living Room			Family Room			Other Room - Specify		
	Purchased	As Per Plan	N/A	Purchased	As Per Plan	N/A	Purchased	As Per Plan	N/A
Fireplace Type	<input type="radio"/>	<input type="radio"/>	<input type="radio"/>	<input type="radio"/>	<input checked="" type="radio"/>	<input type="radio"/>	<input type="radio"/>	<input type="radio"/>	<input type="radio"/>
Mantle Type	BLF-50 STANDARD								
Over Mantle									
Colour / Stain									
Surround									
Hearth									
Comment									

Initial:

CAN - LOT 74 - PH 1



INTERIOR COLOUR SCHEME

Purchaser: Brenda Lee
Telephone Res. / Bus: (647) 993-3829 /
Decor Advisor: Steffanee Appio

Property: 74 of Plan -
Project: Carrville Investments Ltd.
Model and Elevation: The Elm (20-3) Elev B

6. Trim Carpentry

Door Hardware STANDARD

Interior Trim STANDARD

Comment

Interior Doors

☐ 2 Panel Arch Top

☒ 2 Panel Square Top

☐ 6 Panel

Initial for Door Style



7. Railings and Pickets

Railing Package STANDARD

Railing Colour COBALT

Picket Colour MATTE BLACK METAL

Wood Stairs ☐ No ☒ Oak

Tread Colour COBALT

Comment

STAIN OAK STAIRS TO COMPLIMENT HARDWOOD - COBALT COLOUR

8. Plaster Mouldings and Medallions

Foyer

Main Hall

Living Room

Dining Room

Family Room

Kitchen/Breakfast

Den/Library

Lower Landing

Comment

9. Wall Paint

STANDARD SENATOR WHITE

Smooth Ceilings

☐ First Floor

☐ First Floor incl. Second Floor Hall

☐ First and Second Floor

☒ Throughout

☐ Not Applicable

Trim Paint

10. Additional Comments

11. Disclaimers and Notes

- 1) Colours of all materials are as close as possible to builder's selection, but not necessarily identical due to variances in manufacturing.
- 2) Any extras listed above are null and void unless accompanied by a separate invoice/amendment. Said invoice must be paid in full.
- 3) The Purchaser acknowledges that after Interior Colour Selection form is signed and dated, no further changes will be permitted other than re-selection due to unavailability. _____ Purchaser's Initials
- 4) The Purchaser acknowledges reading and accepting the "Senator Homes Décor Centre Disclaimers" form. This document contains other miscellaneous disclaimers.

This Interior Colour Selection is final and approved by:

Purchaser:

Signature: Brenda Lee

Date: July 4, 2016

Vendor: [Signature]

Carrville Investments Ltd.



SCHEDULE B

Purchaser Initials W Production Initials _____

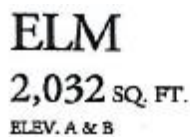

Actual usable square footage may vary from that stated herein. The floor plan may be minor inconsequential from that shown. E & O.E. 20-3



SENATOR
HOMES

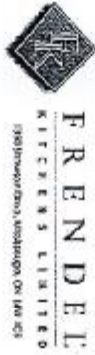

CARV-LOT 74 Pt 1

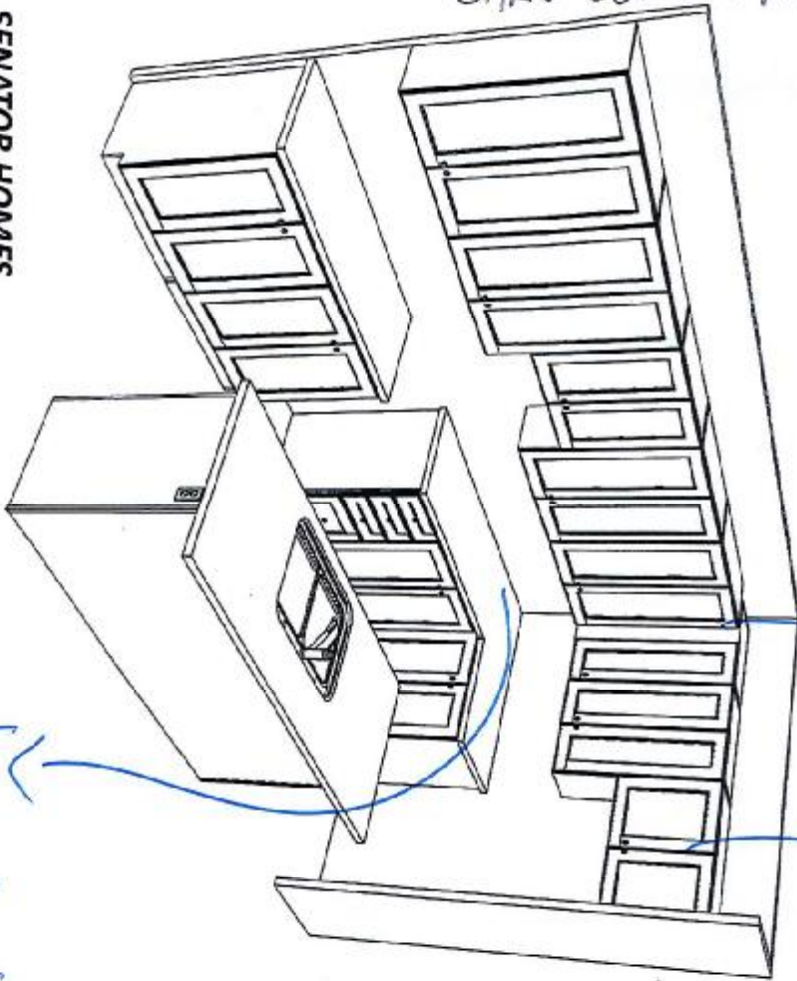

1st Floor, 220, 280, 290, 300, 310, 320, 330, 340, 350, 360, 370, 380, 390, 400, 410, 420, 430, 440, 450, 460, 470, 480, 490, 500, 510, 520, 530, 540, 550, 560, 570, 580, 590, 600, 610, 620, 630, 640, 650, 660, 670, 680, 690, 700, 710, 720, 730, 740, 750, 760, 770, 780, 790, 800, 810, 820, 830, 840, 850, 860, 870, 880, 890, 900, 910, 920, 930, 940, 950, 960, 970, 980, 990, 1000.

upside up

from deep into upper & down side

SENATOR HOMES
RICHVALE SOUTH - RICHMOND HILL
MODEL: TH-20-3 (ELM) ELEV. A, B, B1
TOTAL UNITS: 15

haso pie cut

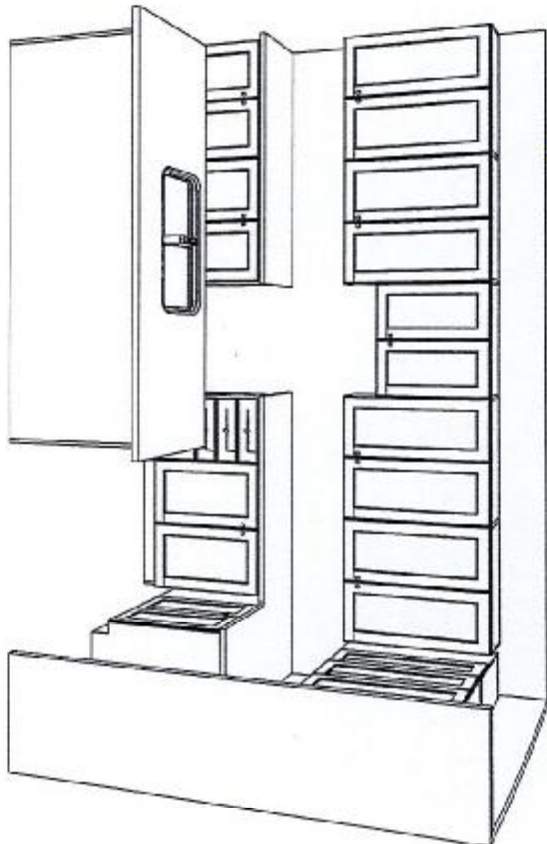
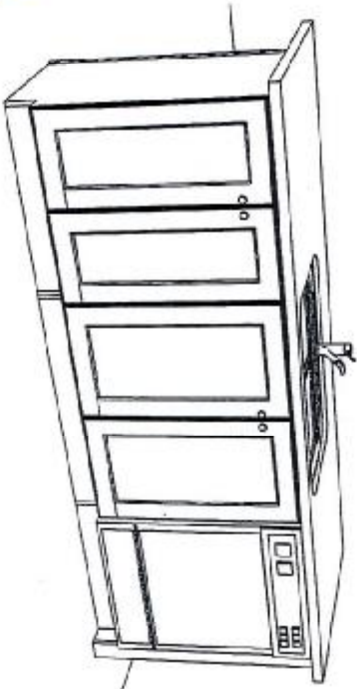

June 2, 2016

This sketch is provided solely for reference to those items noted on the accompanying "Upgrades/Extras". All other details, dimensions & layouts are for illustrative purposes only and may not be applicable to the Purchaser's Model.

Site

Caroip

Lot

74

Date

7/1/2016

Purchaser initials

Production initials