



CONSTRUCTION SUMMARY

Carrville Investments Ltd. / Richvale

Lot/Unit: 61 Phase/Building: 1 Model/Floor Plan: The Spruce (20-2) Elev A

CABINETRY

| | | |
|------------------|---|--|
| Inv.3660 | 1 - LOCATION: KITCHEN | |
| | SUPPLY FINISHED SIDES TO UPPER CABINETS ON EITHER SIDE OF STOVE. THE STANDARD 77CM WIDE STOVE UPPER AND STANDARD FAN WILL BE INSTALLED FOR OCCUPANY PURPOSES. CABINET AND FAN WILL BE REMOVED BY PURCHASER AFTER CLOSING. | |
| Line 47858 | Note: BUILDER WILL NOT BE HELD RESPONSIBLE FOR ANY DAMAGE TO WALL OF ADJACENT CABINETRY AFTER REMOVAL. | |
| 7Jun16 / 13Jun16 | | |

CABINETRY ACCESSORIES

| | | |
|------------------|--|--|
| Inv.3660 | 1 - KITCHEN - SUPPLY AND INSTALL LARGE CROWN MOULDING WITH FASCIA PANEL TO UPPER CABINETS TO CLOSE OFF SPACE BETWEEN CEILING AND/OR BULKHEAD BETWEEN CABINETS - UPGRADE 1 LINE | |
| Line 47842 | Note: | |
| 7Jun16 / 13Jun16 | | |

CABINETRY APPLIANCE - FRIDGE

| | | |
|-------------------|--|--|
| Inv.3670 | 1 - LOCATION; KITCHEN | |
| | 66 CM FRIDGE CABINET - 1 GABLE 66 CM & CABINET 59 CM DEEP - SEE 66CM DEEP PANTRY IF ADJACENT TO PANTRY - COUNTER DEPTH - UPGRADE 1 | |
| Line 47976 | Note: LOCATION AS PER FRENDEL KITCHEN PLAN | |
| 13Jun16 / 13Jun16 | | |

COUNTER TOP - GRANITE

| | | |
|------------------|--|--|
| Inv.3660 | 1 - COUNTER TOP - GROUP 3 - KITCHEN - 3CM WITH FE30 EDGE PROFILE CAESARSTONE: 3100 - JET BLACK | |
| Line 47847 | Note: | |
| 7Jun16 / 13Jun16 | | |

ELECTRICAL

| | | |
|------------------|--|--|
| Inv.3660 | 1 - LOCATION: KITCHEN | |
| | SUPPLY AND INSTALL ADDITIONAL INTERIOR RECEPTACLE ON SEPARATE CIRCUIT TO ACCOMMODATE INSTALL OF FUTURE CHIMNEY HOOD FAN. | |
| Line 47863 | Note: PURCHASER TO SUPPLY AND INSTALL OWN HOOD FAN AFTER CLOSING. | |
| 7Jun16 / 13Jun16 | | |

MISCELLANEOUS

| | | |
|------------------|--|--|
| Inv.3660 | 1 - DELETE AND DO NOT INSTALL CERAMIC ACCESSORIES IN POWDER ROOM, LOWER LEVEL BATHROOM AND ALL BATHROOMS UPSTAIRS. | |
| Line 47872 | Note: | |
| 7Jun16 / 13Jun16 | | |
| Inv.3660 | 1 - DELETE DO NOT INSTALL AND DO NOT SUPPLY BATHROOM MIRRORS THROUGHOUT | |
| Line 47871 | Note: | |
| 7Jun16 / 13Jun16 | | |

PLUMBING



CONSTRUCTION SUMMARY

Carrville Investments Ltd. / Richvale

Lot/Unit: 61 Phase/Building: 1 Model/Floor Plan: The Spruce (20-2) Elev A

| | | |
|------------------|--|--|
| Inv.3660 | 1 - LOCATION: KITCHEN | |
| | SUPPLY AND INSTALL SOAP DISPENSER - MOEN - MODEL: S3947 CHROME. TO BE ON THE RIGHT SIDE OF KITCHEN SINK. | |
| Line 47873 | Note: | |
| 7Jun16 / 13Jun16 | | |

TILE

| | | |
|------------------|--|--|
| Inv.3660 | 1 - - Floor Tile - Upgrade 8 - POWDER ROOM FLOOR | |
| | 12X24 VOLKAS WHITE - POLISHED (HU.VK.WHT.1224.PL) | |
| Line 47849 | Note: TILE DIRECTION AS PER SKETCH ATTACHED | |
| 7Jun16 / 13Jun16 | | |
| Inv.3660 | 1 - Floor Tile - Upgrade 8 - VESTIBULE | |
| | 12X24 VOLKAS WHITE - POLISHED (HU.VK.WHT.1224.PL) | |
| Line 47850 | Note: TILE DIRECTION AS PER SKETCH ATTACHED | |
| 7Jun16 / 13Jun16 | | |
| Inv.3660 | 1 - Floor Tile - Upgrade 4 - ENSUITE BATHROOM FLOOR | |
| | 12X12 UNICOLOUR POLISHED - SUPER BLACK (OV.UN.BLK.1212.PL) | |
| Line 47864 | Note: | |
| 7Jun16 / 13Jun16 | | |

EXTRAS AS PER OFFER

| | | |
|--|-------|--|
| Worksheet | Note: | |
| Stainless Steel Fridge, Stove and Dishwasher and front loading washer and dryer in white from Vendors standard samples, no cash value, not transferable. (Supplied only not installed) ** to arrange delivery call: The Brick commercial sales division at (4 | | |
| Worksheet | Note: | |
| Rogers Free Services Package includes 6 months of: home phone, TV and Internet Service. | | |
| Worksheet | Note: | |

Purchaser: Tatiana Nakhimova
 Telephone Res. / Bus: (416) 388-1080 /
 Decor Advisor: Veronica Ashton

Property: 61 of Plan -
 Project: Carrville Investments Ltd.
 Model and Elevation: The Spruce (20-2) Elev A

Layout Changes: ☐ Yes ☒ No Sketch Attached: ☐ Yes ☒ No Exterior Colour Scheme:

| 1. Cabinetry | Style and Colour | Counter Top | Hardware |
|---|------------------------------|------------------------|-------------|
| Kitchen / Breakfast | BOSTON PAINT - WINTER WHITE | UPG 3100 - JET BLACK | HANDLE 9677 |
| Kitchen Island | BOSTON PAINT - WINTER WHITE | UPG 3100 - JET BLACK | HANDLE 9677 |
| Laundry Room | | | |
| Powder Room | NEWPORT MAPLE - CAVIAR | WHITE CARRARA 4924-38 | HANDLE 9671 |
| Main Bathroom | LANCASTER PAINT - CANNOLI | INUKSHUK GREY P-344-LM | HANDLE 9677 |
| Master Ensuite Bathroom | NEWPORT PAINT - WINTER WHITE | WHITE CARRARA 4924-38 | HANDLE 9677 |
| Second Ensuite Bathroom (If Applicable) | BOSTON PAINT - WINTER WHITE | PALOMA POLAR 6698-46 | HANDLE 9661 |
| | LOWER LEVEL BATHROOM | LOWER LEVEL BATHROOM | LL BATHROOM |

Appliances Custom Size Fridge Valance Lighting Microwave / Range Hood
☐ Yes ☒ No ☐ Yes ☒ No ☒ Yes ☐ No
 Comment Cooktop / Rangetop Built in Wall Oven Slide-in Range
☐ Yes ☒ No ☐ Yes ☒ No ☒ Yes ☐ No

| 2. Flooring | Selection |
|-------------------------------|---|
| Foyer | UPG 8 - 12X24 VOLKAS WHITE - POLISHED (HU.VK.WHT.1224.PL) |
| Main Hall | N/A |
| Back Hall | N/A |
| Breakfast | 3/4" X 3-5/8" GENERATIONS OAK ENG. HARDWOOD - GRAPHITE |
| Laundry Room | 13X13 REFLEX - EXPRESSO (GE.RF.EXP.1313) |
| Kitchen | 3/4" X 3-5/8" GENERATIONS OAK ENG. HARDWOOD - GRAPHITE |
| Powder Room | UPG 8 - 12X24 VOLKAS WHITE - POLISHED (HU.VK.WHT.1224.PL) |
| Main Bathroom | 13X13 NEW REEDS - BROWN (GE.NR.BWN.1313) |
| Master Ensuite | UPG 4 - 12X12 UNICOLOUR - SUPER BLACK (OV.UN.BLK.1212.PL) |
| Bathroom (If Applicable) | (LOWER LEVEL) 13X13 NEW REEDS - GREY (GE.NR.GRY.1313) |
| Mud Room | N/A |
| Living Room | N/A |
| Dining Room | 3/4" X 3-5/8" GENERATIONS OAK ENG. HARDWOOD - GRAPHITE |
| Family / Great Room | 3/4" X 3-5/8" GENERATIONS OAK ENG. HARDWOOD - GRAPHITE |
| Den / Library / Study | N/A |
| Basement Landing (If Applies) | N/A |
| Lower Landing (If Applicable) | N/A |
| Upper Landing | 3/4" X 3-5/8" GENERATIONS OAK ENG. HARDWOOD - GRAPHITE |
| Upper Hall | 3/4" X 3-5/8" GENERATIONS OAK ENG. HARDWOOD - GRAPHITE |
| Master Bedroom | STANDARD BERBER PAPILO CARPET - 17185 SOFT CAMEO |
| Bedroom #2 | STANDARD BERBER PAPILO CARPET - 17185 SOFT CAMEO |
| Bedroom #3 | STANDARD BERBER PAPILO CARPET - 17185 SOFT CAMEO |
| Bedroom #4 | |
| Bedroom #5 | |
| Recreation Room | STANDARD BERBER PAPILO CARPET - 17185 SOFT CAMEO |

Flooring Continued on Page 2

Initial:

TN

Page 1 of 3



INTERIOR COLOUR SCHEME

CARRVILLE PH1
LOT 61

Purchaser: Tatiana Nakhimova
Telephone Res. / Bus: (416) 388-1080 /
Decor Advisor: Veronica Ashton

Property: 61 of Plan -
Project: Carrville Investments Ltd.
Model and Elevation: The Spruce (20-2) Elev A

2. Flooring - Continued -

| | | |
|------------------|----------|--------------------------------|
| Upgrade Underpad | Type | Area |
| | STANDARD | RECREATION ROOM & ALL BEDROOMS |
| Carpet on Stairs | Capped | Runner - *Upgrade |
| Comment | | |

3. Plumbing Fixtures / Faucets

| | | | | | |
|----------------|-----|----------------|-----|-------------|-----|
| Kitchen | STD | Second Ensuite | STD | Powder Room | STD |
| Master Ensuite | STD | | | Other Room | |
| Main Bathroom | STD | | | | |
| Comment | | | | | |

4. Wall Tile

| | Tile Selection | Listello | Insert | Insert Selection |
|--|---|--------------------------|--------------------------|------------------|
| Main Bathroom | 8X10 WEAVE - TENDER GREY (QT.WV.TGR.0810) | <input type="checkbox"/> | <input type="checkbox"/> | |
| Master Ensuite | | | | |
| Tub Deck | | <input type="checkbox"/> | <input type="checkbox"/> | |
| Tub Apron | | <input type="checkbox"/> | <input type="checkbox"/> | |
| Tub Surround | | <input type="checkbox"/> | <input type="checkbox"/> | |
| Shower Stall | 8X10 UNIWALL - WHITE (QT.UW.WHT.0810) | <input type="checkbox"/> | <input type="checkbox"/> | |
| Second Ensuite | 8X10 WEAVE - WHITE (QT.WV.WHT.0810) | <input type="checkbox"/> | <input type="checkbox"/> | |
| | (LOWER LEVEL) | <input type="checkbox"/> | <input type="checkbox"/> | |
| | | <input type="checkbox"/> | <input type="checkbox"/> | |
| Kitchen Backsplash | | <input type="checkbox"/> | <input type="checkbox"/> | |
| Complete Backsplash | | <input type="checkbox"/> | <input type="checkbox"/> | |
| Comment | | | | |
| *2X2 MOSAIC WHITE TILES IN MASTER ENSUITE SHOWER STALL | | | | |

5. Fireplace

| | Living Room | | | Family Room | | | Other Room - Specify | | |
|----------------|-----------------------|-----------------------|-----------------------|-----------------------|----------------------------------|-----------------------|-----------------------|-----------------------|-----------------------|
| | Purchased | As Per Plan | N/A | Purchased | As Per Plan | N/A | Purchased | As Per Plan | N/A |
| Fireplace Type | <input type="radio"/> | <input type="radio"/> | <input type="radio"/> | <input type="radio"/> | <input checked="" type="radio"/> | <input type="radio"/> | <input type="radio"/> | <input type="radio"/> | <input type="radio"/> |
| Mantle Type | | | | BLF-150 | | | | | |
| Over Mantle | | | | | | | | | |
| Colour / Stain | | | | | | | | | |
| Surround | | | | | | | | | |
| Hearth | | | | | | | | | |
| Comment | | | | | | | | | |

Initial:

T.N.

Page 2 of 3



INTERIOR COLOUR SCHEME

CARV-LOT 61 PH1

Purchaser: Tatiana Nakhimova
Telephone Res. / Bus: (416) 388-1080 /
Decor Advisor: Veronica Ashton

Property: 61 of Plan -
Project: Carville Investments Ltd.
Model and Elevation: The Spruce (20-2) Elev A

6. Trim Carpentry

Door Hardware STANDARD

Interior Trim STANDARD

Comment

Interior Doors

☐ 2 Panel Arch Top☒ 2 Panel Square Top☐ 6 Panel

Initial for Door Style

TN

7. Railings and Pickets

Railing Package STANDARD

Railing Colour GRAPHITE

Picket Colour MATTE BLACK METAL

Wood Stairs ☐ No ☒ Oak

Tread Colour GRAPHITE

Comment

STAIN STAIRS TO COMPLIMENT HARDWOOD FLOORING STAIN "GRAPHITE"

8. Plaster Mouldings and Medallions

Foyer

Main Hall

Living Room

Dining Room

Family Room

Kitchen/Breakfast

Den/Library

Lower Landing

Comment

9. Wall Paint

STANDARD SENATOR WHITE

Smooth Ceilings ☐ First Floor
☐ First Floor incl. Second Floor Hall
☐ First and Second Floor
☒ Throughout
☐ Not Applicable

Trim Paint STANDARD

10. Additional Comments

11. Disclaimers and Notes

- Colours of all materials are as close as possible to builder's selection, but not necessarily identical due to variances in manufacturing.
- Any extras listed above are null and void unless accompanied by a separate invoice/amendment. Said invoice must be paid in full.
- The Purchaser acknowledges that after Interior Colour Selection form is signed and dated, no further changes will be permitted other than re-selection due to unavailability. TN Purchaser's Initials
- The Purchaser acknowledges reading and accepting the "Senator Homes Décor Centre Disclaimers" form. This document contains other miscellaneous disclaimers.

This Interior Colour Selection is final and approved by:

Purchaser:

Signature: [Signature] Date: June 13, 16

Vendor:

Carville Investments Ltd.

CARV-LOT 61 PH 1

 tile direction
 tile direction
richdale
 SOUTH RICHMOND HILL
SCHEDULE B

This sketch is provided solely for reference to those items noted on the accompanying "Upgrades/Extras". All other details, dimensions & layouts are for illustrative purposes only and may not be applicable to the Purchaser's Model

Site Cornville Lot 61
 Date line 7/16
 Purchaser Initials PK Production Initials _____

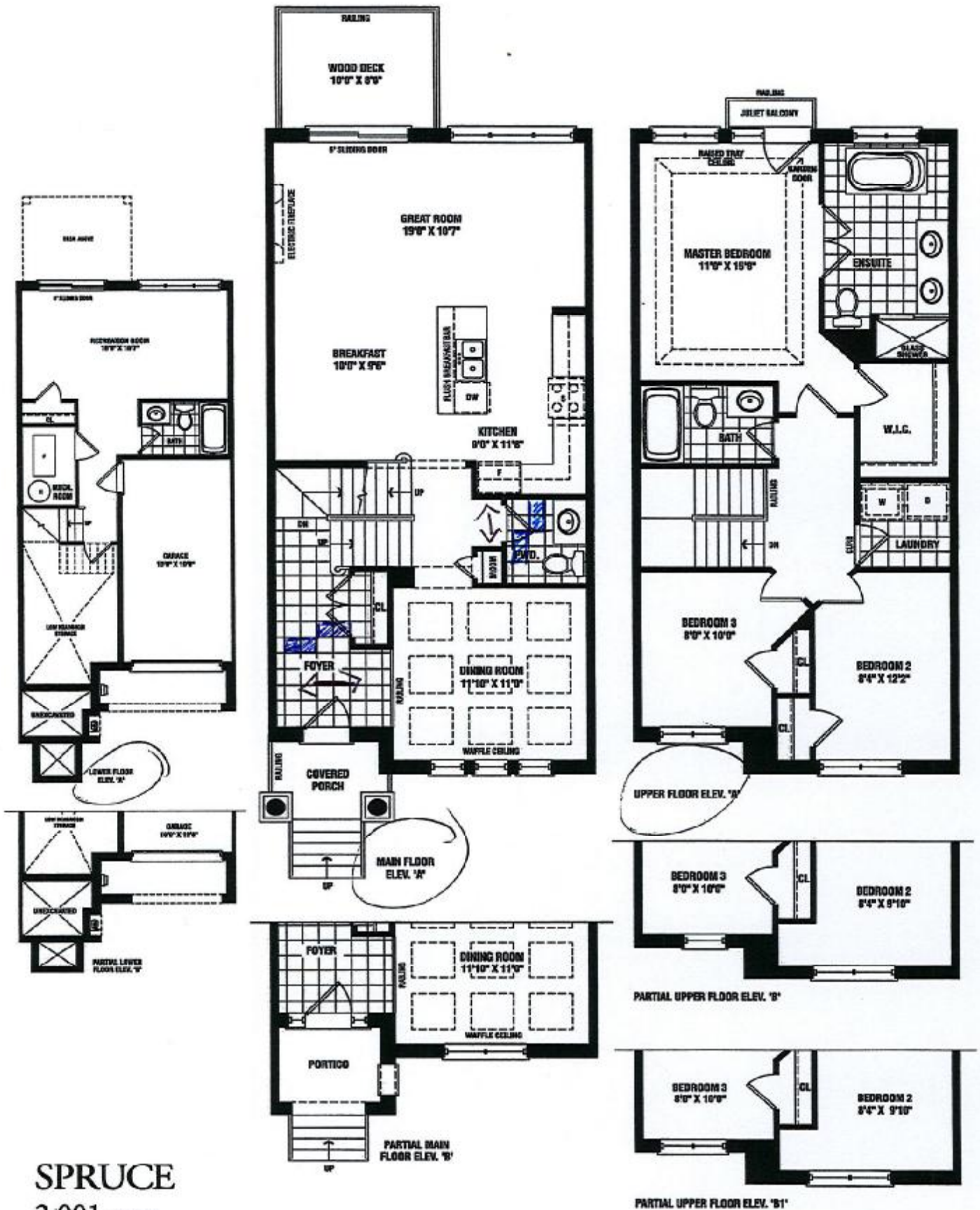

SENATOR
 HOMES
PK

CANU-LOT 61-PH1

This sketch is provided solely for reference to those items noted on the accompanying "Upgrades/Extras". All other details, dimensions & layouts are for illustrative purposes only and may not be applicable to the Purchaser's Model

Site Casville

Lot 61

Date June 7/16

Purchaser Initials TV

Production Initials

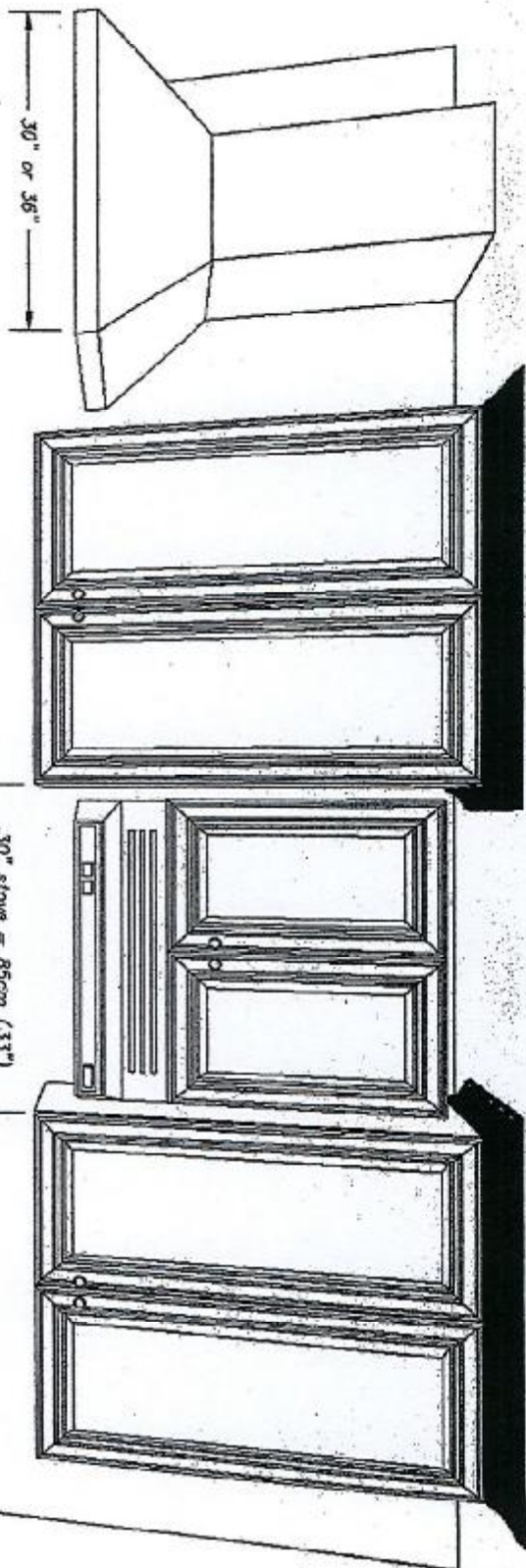

The standard 77cm. wide stove upper will be installed so the standard fan can be installed for occupancy purposes. Cabinet and fan will be removed by purchaser after closing. Builder will not be held responsible for any damage to wall or adjacent cabinetry after removal.

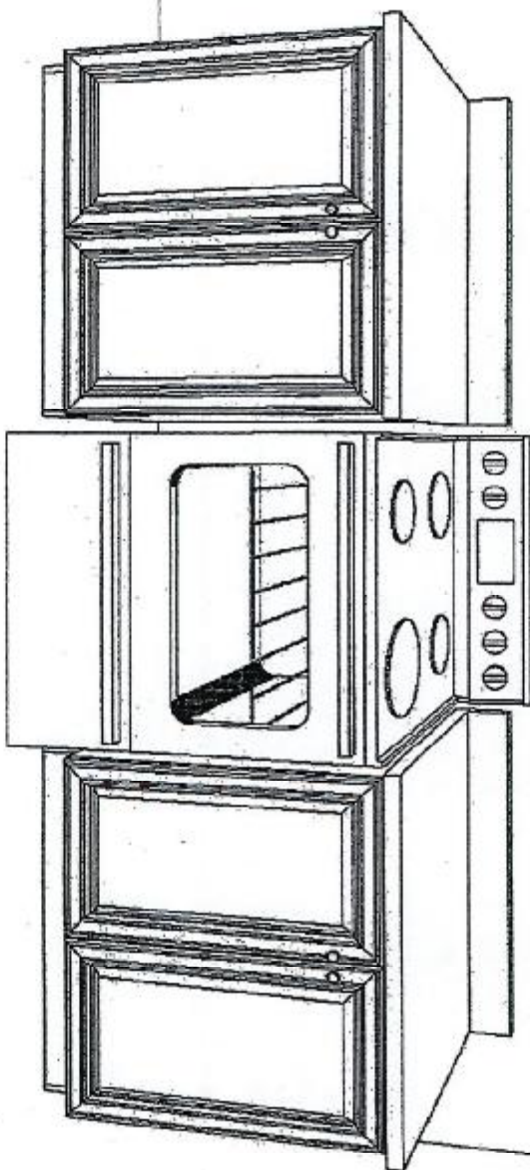



FRENDEL
KITCHENS & BATHS
1801 JENNIFER LANE, SUITE 100, LEXINGTON, KY 40503

1000 1000 1000 1000
1000 1000 1000 1000
1000 1000 1000 1000

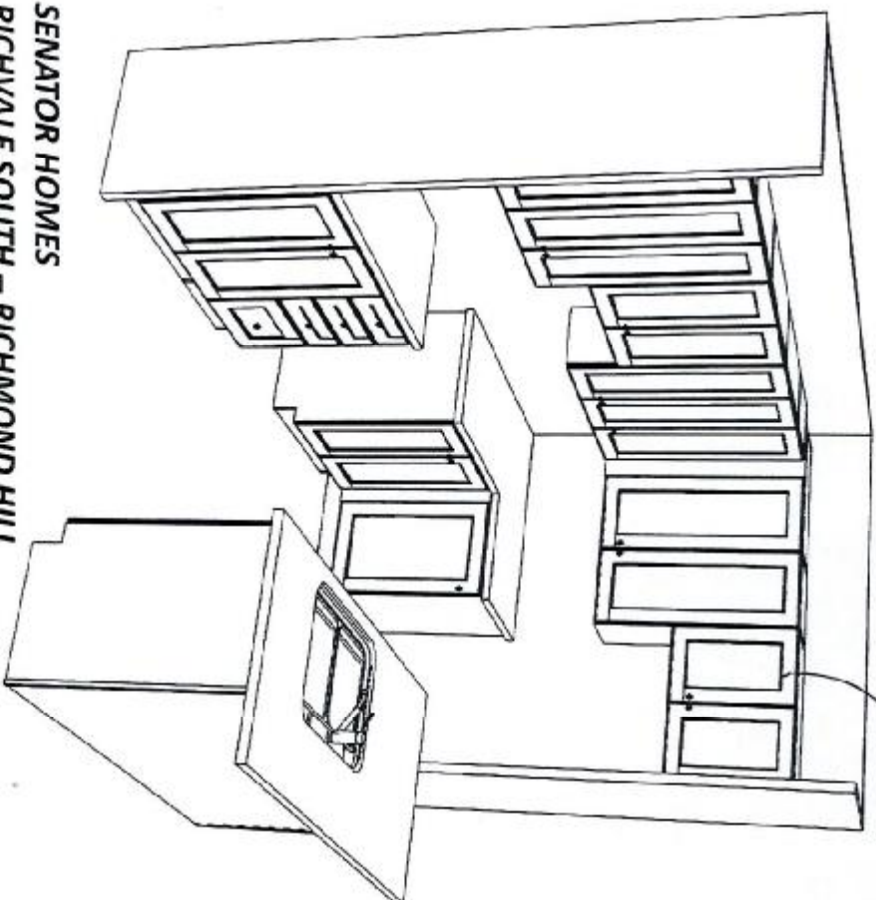

Steam clean uppers
with open gable (1)

Garage - Lot 61

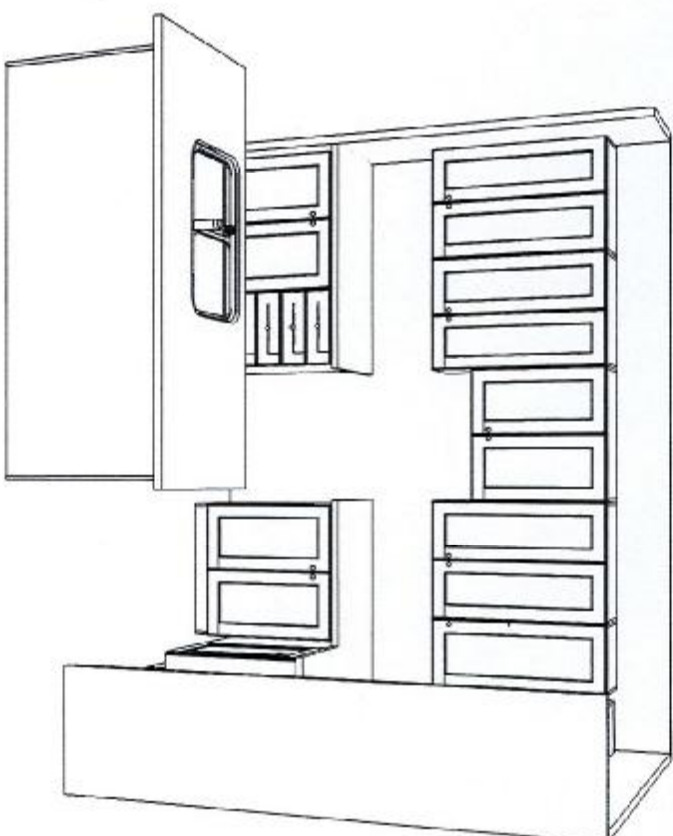

SENATOR HOMES
RICHVALE SOUTH - RICHMOND HILL
MODEL: TH-20-2 (SPRUCE) ELEV. A, B, B1
TOTAL UNITS: 15

June 2, 2016

Home Appliances

Home Appliances Products Cooking & Baking Ventilation Chimney Wall Hoods HCP30651UC

HCP30651UC
30" Pyramid Canopy Chimney Hood
300 Series - Stainless Steel



Price \$ 1,599.00

[Add To Cart](#)

[Find A Dealer](#)

Customer Rating:

★★★★★ 4.4 | 5 Reviews

4 out of 5 (80%) reviewers recommend this product

[Write a review](#)

Lot #61



Specifications

General Properties

General Properties

Certifications

Installation Requirements

Dimensions & Weight

Overall appliance dimensions (HxWxD) (in) 24 9/16" - 38 7/8" / 28 1/4" - 42 9/16" x 30" x 19 11/16"

Product packaging dimensions (HxWxD) (in) 26.49 x 34.25 x 17.99

Height of the chimney (in) 19 9/16" - 33 7/8" / 23 1/4" - 42 9/16"

* Required distance above cooktop/ranges 24" / 27"

Diameter of air duct (in) top 8

Net weight (lbs) 49 lbs

Gross weight (lbs) 55 lbs

6197

TM

Appliance dimensions

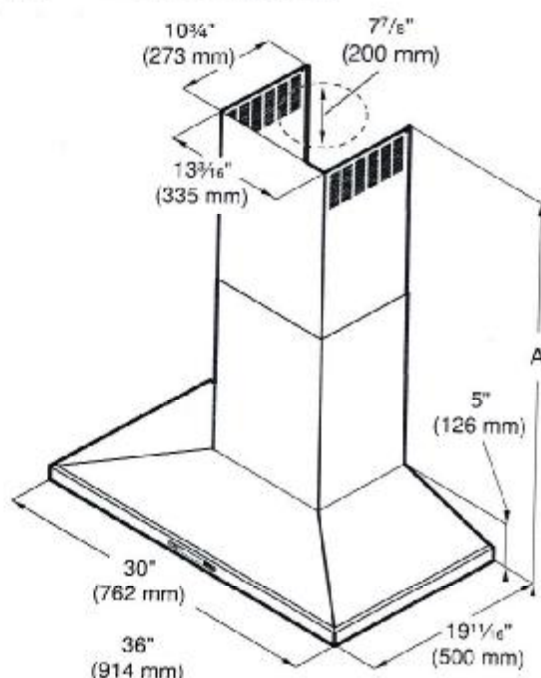

- A Only for circulating-air mode:
 *Max. 42 9/16" (1081 mm)
 *Min. 28 1/4" (718 mm)
 Only for ducted operation:
 *Max. 38 7/8" (988 mm)
 *Min. 24 9/16" (625 mm)

Safety clearances

⚠ WARNING

RISK OF FIRE

Grease deposits in the grease filter can catch fire. The given safety clearance must be observed to avoid heat buildup. Observe the specifications for your cooking appliance. If gas and electric cooktops are used together, the largest given clearance applies.

The appliance may only be installed directly next to a cabinet or wall on one side. The wall or cabinet clearance must be at least 2" (50 mm).

The clearance between the shelf on the cooktop and the bottom of the extractor hood may not be less than 24" (610 mm) in the case of electric cooktops and 30" (760 mm) in case of gas or combined ranges. If the installation instructions for the gas cooking appliance specify a larger distance, this must be taken into account.

Electrical cooktop

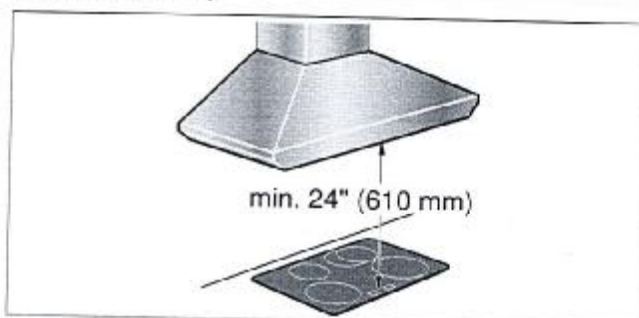

Gas cooktop

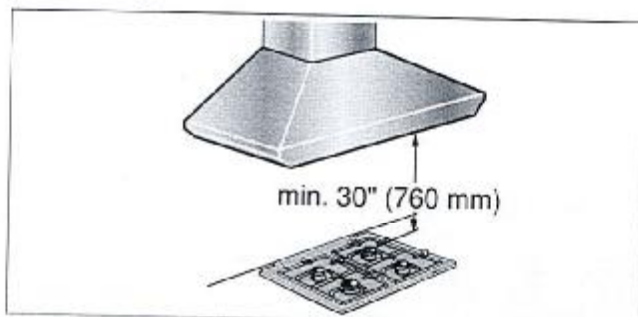

Fan operation

Note: Ventilation may not exit through an already operational smoke or exhaust chimney, nor a duct used for ventilating furnace installation areas.

- If the ventilation is intended to pass through a smoke or exhaust that is not in operation, the responsible area heating inspector must give approval.
- If the ventilation passes through an external wall, use a telescope wall sleeve.

Ventilation line

Note: The device manufacturer does not assume any warranty for complaints attributable to the pipe section.

- The ventilation opening and the exhaust air ducts must be made according to the local circumstances.
- The device achieves its optimum performance by means of a short, straight exhaust air pipe and as large a pipe diameter as possible.
- As a result of long rough exhaust air pipes, many pipe bends or too-small diameters, the optimum extraction performance is not achieved and fan noise is increased.
- The pipes or hoses for laying the exhaust air line must consist of non-combustible material.
- Smooth the connection area of the pipes before installation.
- Seal the connection points of the pipes appropriately.

Lot 61

92

CARVIN

30" Induction Slide-in Range

Benchmark™ Series – Stainless Steel HIIP054C



HIIP054U
Stainless Steel

The full-depth induction slide-in range is one of the few of its kind on the market, and offers a powerful cooktop and oven.

Features & Benefits

The new Bosch slide-in range fits in any freestanding range cutout.

Powerful 3,600 watts speeds cooking time.

Dampened hinges softly and quietly guide the SmoothClose door shut.

A full-extension telescopic rack offers safe access to the oven cavity.

The warming drawer keeps everything you cook warm and ready to serve.

General Properties

| | |
|---------------|---|
| Cooking modes | Meat Probe, Variable Broil (hi & low), Roast, Warm, Proof, Convection Bake, Convection Broil, Convection Roast, Pizza, True Convection/Convection Multi-Rack, Fast Preheat, Sabbath |
|---------------|---|

Cleaning type Self clean

Knob material Full metal

Drawer type Warming drawer

Oven Performance

Bake element watts (W) 2,400 W

Broil element watts (W) 3,800 W

Convection element watts (W) 2,000 W

Element Performance

Total number of cooktop elements 4

Power of front left element watts (W) 2,200 W (3,300 w/ boost)

Power of back left element watts (W) 1,400 W (1,800 w/ boost)

Power of centre element watts (W) N/A

Power of back right element watts (W) 2,400 W (3,600 w/ boost)

Power of front right element watts (W) 1,400 W (1,800 w/ boost)

Element Size

Dimension of front left heating element 9"

Dimension of back left heating element 6"

Dimension of centre heating element N/A

Dimension of back right heating element 11"

Dimension of front right heating element 6"

Technical Details

Watts (W) 12,300 W

Circuit breaker (A) 40 A

Volts (V) 240 V

Frequency (Hz) 60 Hz

Plug type N/A

Cord length N/A

Energy source Electric

Dimensions & Weight

Overall appliance dimensions (HxWxD)(in.) 36 1/2" x 31 1/2" x 28 7/8"

Required cutout size (HxWxD) (in.) 35 1/2" x 30" x 25"

Adjustable range height (in.) 1 1/2"

Net weight (lbs) 248 lbs

Accessories—Included

Use and care manual, installation guide, mounting hardware, island trim, meat probe, standard racks, telescopic rack

Accessories—Optional



HEZTR301
30" Telescopic rack



HEZBS301
Low backguard



Lot #61



For help and assistance with Bosch accessories please call 1-800-944-2904 Mon-Fri 8am to 6pm EST

Notes: All height, width and depth dimensions are shown in inches. Please refer to installation instructions prior to making cutout. BSH reserves the absolute and unrestricted right to change product materials and specifications, at any time, without notice. Consult the product's installation instructions for final dimensional data and other details. Applicable product warranty can be found in accompanying product literature or you may contact your account manager for further details.

Warranties: Bosch warrants that the Product is free from defects in materials and workmanship for a period of three hundred and sixty-five (365) days from the date of purchase. The foregoing timeline begins to run upon the date of purchase, and shall not be stalled, tolled, extended, or suspended, for any reason whatsoever. This Product is also warranted to be free from cosmetic defects in material and workmanship (such as scratches of stainless steel, paint/porcelain blemishes, chip, dents, or other damage to the finish of the Product) for a period of thirty (30) days from the date of purchase or closing date for new construction. This cosmetic warranty excludes slight colour variations due to inherent differences in painted and porcelain parts, as well as differences caused by kitchen lighting, product location, or other similar factors. This cosmetic warranty specifically excludes any display, floor, "As Is", or "E" stock appliances.

For more information on our entire line of products, go to www.bosch-home.ca or call 1-800-944-2904

© 2014 BSH Home Appliances Canada. All rights reserved. Bosch is a registered trademark of Robert Bosch GmbH.

30" Induction Slide-in Range

Benchmark™ Series – Stainless Steel HIIP054C

Lot 61
CARVILLE



BOSCH
Invented for life

Installation Details

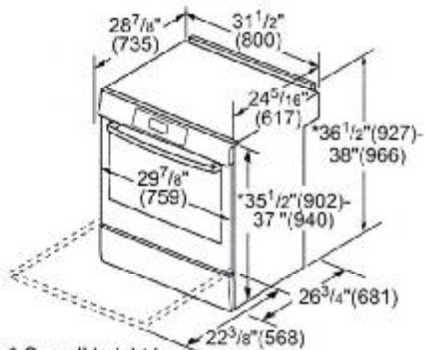

* Overall height is adjustable via leveling legs.

measurements in inches (mm)

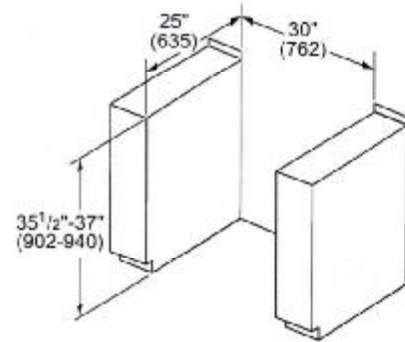

measurements in inches (mm)

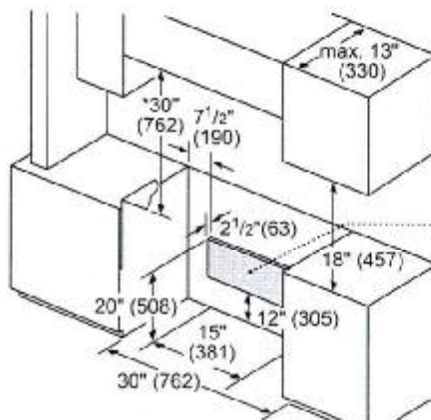

* Minimum clearance of 30" required to overhead combustible surface. If installing overhead vent or over-the-range microwave, refer to clearances provided with these products.

208/240v Electrical Outlet Location

*ELEC

Measurements in inches (mm)

For help and assistance with Bosch accessories please call 1-800-944-2904 Mon-Fri 8am to 6pm EST

Notes: All height, width and depth dimensions are shown in inches. Please refer to installation instructions prior to making cutout. BSH reserves the absolute and unrestricted right to change product materials and specifications, at any time, without notice. Consult the product's installation instructions for final dimensional data and other details. Applicable product warranty can be found in accompanying product literature or you may contact your account manager for further details.

Warranties: Bosch warrants that the Product is free from defects in materials and workmanship for a period of three hundred and sixty-five (365) days from the date of purchase. The foregoing timeline begins to run upon the date of purchase, and shall not be stalled, tolled, extended, or suspended, for any reason whatsoever. This Product is also warranted to be free from cosmetic defects in material and workmanship (such as scratches of stainless steel, paint/porcelain blemishes, chip, dents, or other damage to the finish of the Product) for a period of thirty (30) days from the date of purchase or closing date for new construction. This cosmetic warranty excludes slight colour variations due to inherent differences in painted and porcelain parts, as well as differences caused by kitchen lighting, product location, or other similar factors. This cosmetic warranty specifically excludes any display, floor, "As Is", or "B" stock appliances.

For more information on our entire line of products, go to www.bosch-home.ca or call 1-800-944-2904

© 2014 BSH Home Appliances Canada. All rights reserved. Bosch is a registered trademark of Robert Bosch GmbH.



French Door Refrigerator

E23BC78IPS professional series

Electrolux

ICON

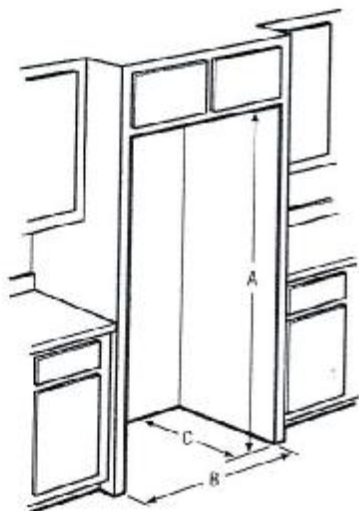

"Built-In Look" Cutout Dimensions

(A) 70 1/4" (B) 36" (C) 25"

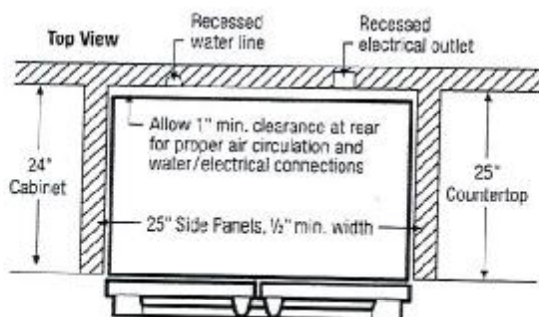

Standard Refrigerator Depth vs. Counter Depth

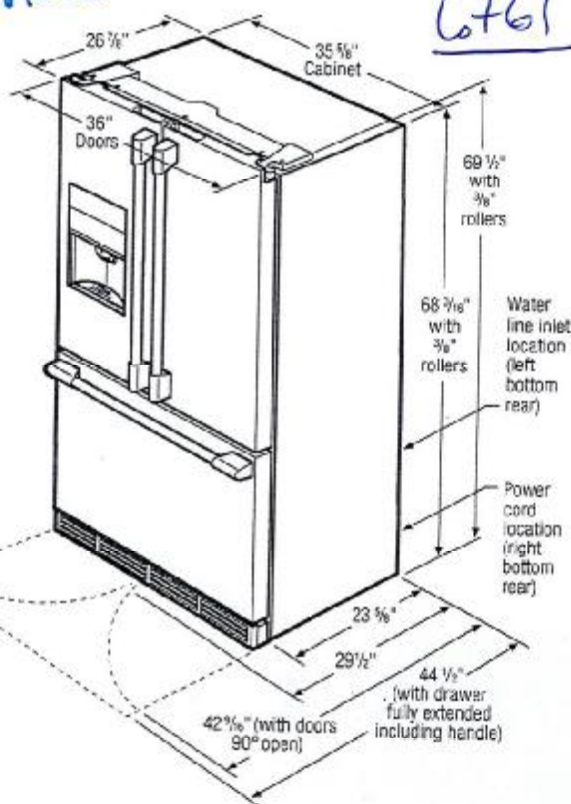

Note: Optional Louvered Trim Kit and Collar Kit available for French Door Counter-Depth Refrigerator. For specifications, refer to Louvered Trim Kit (241723001) installation page or Collar Kit (ECK23CDS) installation page on web.

Counter-Depth French Door Refrigerator Specifications

- Product Weight = 338 Lbs.
- An electrical supply with grounded three-prong receptacle is required. The power supply circuit must be installed in accordance with current edition of National Electrical Code (NFPA 70) and local codes & ordinances.
- Voltage Rating = 120V/60Hz/15 or 20 Amps
- Connected Load (kW Rating) @ 120 Volts = 1.02kW
- Amps @ 120 Volts = 8.5 Amps
- Always consult local and national electric & plumbing codes.
- Floor should be level surface of hard material, capable of supporting fully loaded refrigerator.
- When installing refrigerator adjacent to wall, cabinet or other appliance that extends beyond front edge of unit, 20" minimum clearance recommended to allow for optimum 120° to 180° door swing, providing complete drawer/crisper access and removal. (Absolute 4 1/2" minimum clearance will ONLY allow for 90° door swing which will provide drawer/crisper access with restricted removal.)
- To ensure optimum performance, avoid installing in direct sunlight or close proximity to range, dishwasher or other heat source.
- For proper ventilation, front grille MUST remain unobstructed.
- Recess electrical outlet when possible.
- Water recess on rear wall recommended to prevent water line damage.
- Water Pressure - Cold water line must provide between 30 per square inch (psi).

- Copper tubing with 1/4" O.D. recommended for water supply line with length equal to distance from rear of unit to household water supply line plus 7 additional feet. Optional Water Supply Installation Kits available.
- Adjustable front rollers to assist with door alignment.
- If optional Collar Kit (PN# ECK23CDS) is to be used, different cutout dimensions are required. (Refer to Collar Kit ECK23CDS Installation Specifications page on web.)
- If optional Louvered Trim Kit (PN# 241723001) is to be used, different cutout dimensions are required. (Refer to Louvered Trim Kit 241723001 Installation Specifications page on web.)

"Built-In Look" Specifications

- Minimum opening of 70-1/4" H x 36" W x 25" D required to allow for ease of installation, proper air circulation, and plumbing/electrical connections.
- Remove all wall/floor molding prior to installation.

Note: For planning purposes only. Refer to Product Installation Guide on the web at electroluxicon.ca for detailed instructions.

Optional Accessories

- Collar Kit - (PN# ECK23CDS).
- Louvered Trim Kit - (PN# 241723001).
- PureAdvantage® Water Filter Replacement Cartridge - (PN# EWF01).
- PureAdvantage® Air Filter Replacement Cartridge - (PN# EAF002).

Electrolux Major Appliances, N.A.

CANADA • 5855 Terry Fox Way • Mississauga, ON L5V 3E4 • 1-877-397-3973



by at Electrolux Major Appliances, N.A. mean we are proud of our products. We reserve the right to change specifications or discontinue models without notice.

24" Flush Handle Dishwasher

500 Series- Stainless steel

SHP65T55UC

CANNIUE

6+61.

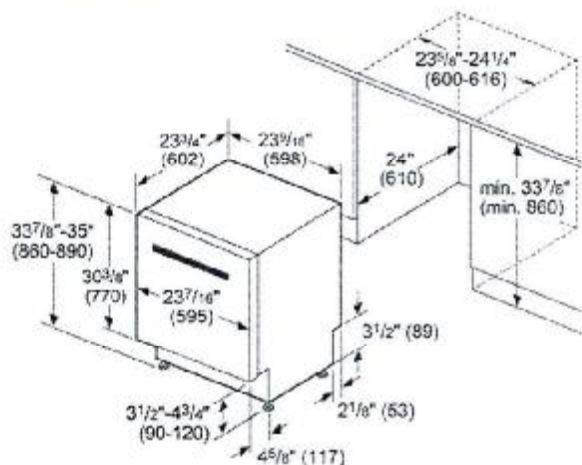

measurements in inches (mm)

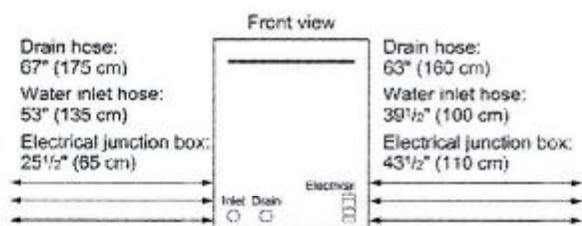

All connections at the rear of the appliance.
Extensions for drain hose available as accessory.
Electrical cable for outlet connection (3 pin plug) available as accessory.

Features

| | |
|------------------------|--|
| Leak Protection System | |
| ChildLock | No |
| Water softener | No |
| Upper Rack | |
| Adjustable upper rack | Rackmatic 3-stage |
| Upper rack cup shelf | 2 |
| Lower Rack | |
| Lower rack cup shelf | |
| 3rd Rack | 3rd Rack 1.0 |
| Silverware basket | Standard |
| Optional accessories | SGZ1010UC, SMZ4000UC, SMZ5002UC, SMZPC002UC |

Technical Specification

| | |
|---|-------------------------|
| UPC code | 825225904519 |
| Panel ready | No |
| Alternative colors available | |
| Silence level (dBA) | 44 |
| Watts (W) | 1300 |
| Current (A) | 12 |
| Volts (V) | 120 |
| Frequency (Hz) | 60 |
| Energy Consumption (kWh/yr) | 259 |
| Energy Star® qualified | Yes |
| NSF certified | Yes |
| Plug type | Fixed connection |
| Power cord length (in) | 43 1/2" |
| Length outlet hose (in) | 67" |
| Length inlet hose (in) | 53" |
| Required cutout size (HxWxD) (in) | 33 7/8" x 23 5/8" x 24" |
| Product packaging dimensions (HxWxD) (in) | 35 3/4" x 26" x 29 3/8" |
| Net weight (lbs) | 91 |
| Gross weight (lbs) | 101 |
| Adjustable feet | Yes |
| Tub material | Stainless steel |
| Tub type | TallTub |
| ADA Compliant | No |
| Number of place settings | 15 |

Notes: All height, width and depth dimensions are shown in inches. *Please refer to installation instructions prior to making cutout. BSH reserves the absolute and unrestricted right to change product materials and specifications, at any time, without notice. Consult the product's installation instructions for final dimensional data and other details. Applicable product warranty can be found in a accompanying product literature or you may contact your account manager for further details.

For more information on our entire line of products, go to boschappliances.com or call 1-800-944-2904.

Copyright ©2013 BSH Home Appliances Corporation. All rights reserved. Bosch is a registered trademark of Robert Bosch GmbH.

Litho Date: 05/2013



24" Compact Washer

800 Series - WAT28402UC

CARL VUC

lot 61.



BOSCH
Invented for life



WAT28402UC
White

The 800 series laundry pair is **ENERGY STAR®** qualified and offers matching quality, water protection, design and fast wash and dry cycles.

Features & Benefits

Wash 5 men's dress shirts in just 15 minutes.

AquaStop® Plus provides extra protection against water damage.

The 800 series washer is ENERGY STAR® qualified.

SpeedPerfect™ provides up to 40% faster washing time.*

EcoSilence™ motor delivers quiet, efficient & long lasting performance.

Wash up to 18 towels in one load.

*As compared to Perm Press Heavy Soil cycle without SpeedPerfect™

General Properties

| | |
|--------------------------------|--|
| Drum material | Stainless Steel |
| Maximum spin speed (rpm) | 1,400 |
| Interior Light | Yes (LED) |
| Leak protection systems | AquaStop® Plus (AquaStop® Base + Aquashield® Hose) |
| Internal water heater | Yes |
| Stackable | Yes |
| Silence level – washing (dBA) | 50 |
| Silence level – spinning (dBA) | 71 |
| Programs (No.), [Special] | (15), [Super Quick 15, Whitest Whites] |
| Options (No.), [Special] | (6), [SpeedPerfect™, PreWash] |
| Energy consumption (kWh/yr) | 84 |
| Water consumption (gal/yr) | 2,320 |
| ENERGY STAR® qualified | Yes |

Capacity

| | |
|--------------------|----------------|
| Capacity (cu. ft.) | 2.2 |
| Relative load | 18 bath towels |

Design Elements

| | |
|--------------------------|-------------------------------|
| Door ring | Chrome |
| Control type | Touch |
| Dial | Chrome design, metal material |
| Bosch logo on door glass | Yes |



Technical Details

| | |
|---|----------------------------|
| Watts (W) | 2,300 |
| Circuit breaker if plugged into an individual circuit (A) | 20 |
| Volts (V) | 208/220-240 |
| Current (A) | 12 |
| Frequency (Hz) | 60 |
| Plug type | 240V; NEMA 6-15 (3 prong) |
| Power cord included | Yes |
| Power cord length (in) | 63 (Full Length) |
| Drain hose length (in) | 57 (Full Length) |
| Inlet hose length (in) | 59 (Full Length) |
| Door hinge | Left Side (Not Reversible) |

Dimensions & Weight

| | |
|--|-------------------------|
| Overall appliance dimensions (HxWxD)(in) | 33 1/4" x 23 1/2" x 25" |
| Net weight (lbs) | 160 |
| Minimum stack height (in) | 67 3/4" |

ADA compliance

- Meets ADA height and access requirements when installed on pedestal.
- Meets ADA operable parts requirements for controls and detergent dispenser.

Accessories—Optional

| | |
|---|------------|
| Short Stainless Steel Hose (if needed for plumbing box clearance with AQS hose) | P/N 645787 |
|---|------------|



WMZ20490
Pedestal



For help and assistance with Bosch accessories please call 1-800-944-2904 Mon-Fri 8am to 6pm EST

Notes: All height, width and depth dimensions are shown in inches. BSH reserves the absolute and unrestricted right to change product materials and specifications, at any time, without notice. Consult the product's installation instructions for final dimensional data and other details prior to making cutout. Applicable product warranty can be found in accompanying product literature or you may contact your account manager for further details.

Warranties: Bosch warrants that the Product is free from defects in materials and workmanship for a period of three hundred and sixty-five (365) days from the date of purchase. The foregoing timeline begins to run upon the date of purchase, and shall not be stalled, tolled, extended, or suspended, for any reason whatsoever. This Product is also warranted to be free from cosmetic defects in material and workmanship (such as scratches of stainless steel, paint/porcelain blemishes, chip, dents, or other damage) to the finish of the Product, for a period of thirty (30) days from the date of purchase or closing date for new construction. This cosmetic warranty excludes slight color variations due to inherent differences in painted and porcelain parts, as well as differences caused by kitchen lighting, product location, or other similar factors. This cosmetic warranty specifically excludes any display, floor, "As Is", or "B" stock appliances.

For more information on our entire line of products, go to www.bosch-home.ca or call 1-800-944-2904

© BSH Home Appliances Limited. All rights reserved. Bosch is a registered trademark of Robert Bosch GmbH.

06/15

24" Compact Condensation Dryer

800 Series - WTG86402UC

CANNIUE

Lot 61.



WTG86402UC
White

The 800 series laundry pair is **ENERGY STAR®** qualified and offers matching quality, water protection, design and fast wash and dry cycles.

Features & Benefits

- Quietest dryer in the 24" category.
- Only ENERGY STAR® dryer in 24" compact laundry market.
- Bosch Washers and Dryers are the only ENERGY STAR® 24" laundry pair.
- Condensation drying doesn't require ducting.
- Perfect design match to Bosch 800 series washer.
- Washer plugs into dryer for easy installation.
- Dry up to 18 towels in one load.

General Properties

| | |
|------------------------------|-------------------------------------|
| Dryer type | Condensing |
| Drum material | Stainless Steel |
| Interior light | Yes (LED) |
| Ventless drying (no ducting) | Yes |
| Stackable | Yes |
| Silence level (dBA) | 63 |
| Programs (No.), [Special] | (15), [Super Quick 15, Anti Shrink] |
| Options (No.), [Special] | (6), [Dry Level, Finished In] |
| Energy consumption (kWh/yr) | 311 |
| ENERGY STAR® qualified | Yes |

Capacity

| | |
|--------------------|----------------|
| Capacity (cu. ft.) | 4.0 |
| Relative load | 18 bath towels |

Design Elements

| | |
|--------------------------|-------------------------------|
| Door ring | Chrome |
| Control type | Touch |
| Dial | Chrome design, metal material |
| Bosch logo on door glass | Yes |

Technical Details

| | |
|---------------------|----------------------------|
| Energy source | Electric |
| Watts (W) | 2,800 |
| Circuit breaker (A) | 30 |
| Volts (V) | 208/220-240 |
| Current (A) | 13 |
| Frequency (Hz) | 60 |
| Plug type | 240V; NEMA 14-30 (4 prong) |



Technical Details (Continued)

| | |
|------------------------|-------------------------|
| Power cord included | Yes |
| Power cord length (in) | 63 (Full Length) |
| Drain hose length (in) | 78 (Full Length) |
| Door hinge | Right Side (Reversible) |

Dimensions & Weight

| | |
|--|-------------------------|
| Overall appliance dimensions (HxWxD)(in) | 33 1/4" x 23 1/2" x 25" |
| Net weight (lbs) | 99 lbs |
| Minimum stack height (in) | 67 3/4" |

ADA compliance

- Meets ADA height and access requirements when installed on pedestal.
- Meets ADA operable parts requirements for controls and lint filter.

Accessories—Optional



WT211400
Stacking kit with shelf



WT220410
Stacking kit without shelf



WMZ20500
Pedestal



WMZ20600
Drying Rack



For help and assistance with Bosch accessories please call 1-800-944-2904 Mon-Fri 8am to 5pm EST

Notes: All height, width and depth dimensions are shown in inches. BSH reserves the absolute and unrestricted right to change product materials and specifications, at any time, without notice. Consult the product's installation instructions for final dimensional data and other details prior to making cutout. Applicable product warranty can be found in accompanying product literature or you may contact your account manager for further details.

Warranties: Bosch warrants that the Product is free from defects in materials and workmanship for a period of three hundred and sixty-five (365) days from the date of purchase. The foregoing timeline begins to run upon the date of purchase, and shall not be stalled, tolled, extended, or suspended, for any reason whatsoever. This Product is also warranted to be free from cosmetic defects in material and workmanship (such as scratches of stainless steel, paint/porcelain blemishes, chip, dents, or other damage) to the finish of the Product, for a period of thirty (30) days from the date of purchase or closing date for new construction. This cosmetic warranty excludes slight color variations due to inherent differences in painted and porcelain parts, as well as differences caused by kitchen lighting, product location, or other similar factors. This cosmetic warranty specifically excludes any display, floor, "As Is", or "B" stock appliances.

For more information on our entire line of products, go to www.bosch-home.ca or call 1-800-944-2904

© BSH Home Appliances Limited. All rights reserved. Bosch is a registered trademark of Robert Bosch GmbH.



09/15

24" Compact Washer

800 Series - WAT28402UC



Installation Details

Closet: Stacked

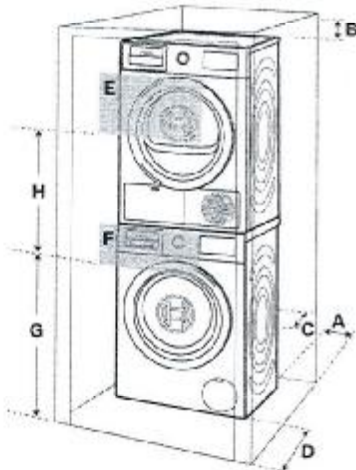

Closet: Stand Alone (shown)
or Side by Side

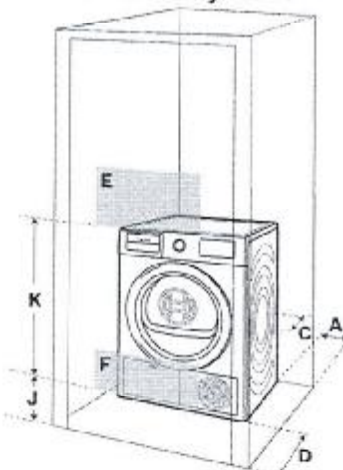

Clearance requirements (Minimum)

| | |
|--------------|-----------|
| A Both Sides | 5/8 in. |
| B Top | 6 1/4 in. |
| C Rear | 2 1/2 in. |
| D Front | 2 1/2 in. |

Ventilation Area (Minimum)

| | |
|----------|------------|
| E Top | 63 sq. in. |
| F Bottom | 63 sq. in. |

Vent Spacing

| | |
|---|--------|
| G | 37 in. |
| H | 26 in. |
| J | 3 in. |
| K | 29 in. |

Enclosure Dimensions

Under Counter: (Preferred)

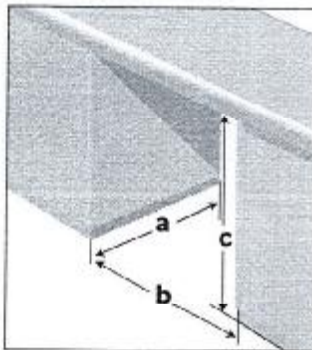

Front of the appliance fully open. No doors or coverings.

Under Counter: (Less Preferred)

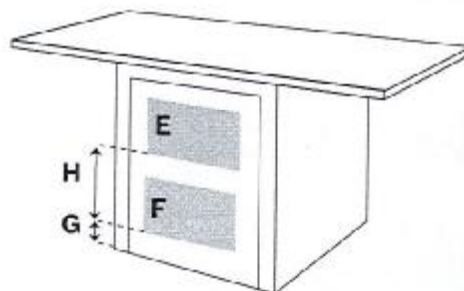

If the front of the appliance is covered, ventilation openings must be installed as shown and front/rear clearances adhered to according to closet installations.

Minimum opening dimensions

| | |
|---|------------|
| a | 28 in. |
| b | 23 7/8 in. |
| c | 34 1/2 in. |

E & F are minimum area sizes

| | |
|---|------------|
| E | 63 sq. in. |
| F | 63 sq. in. |

G & H actual spacing dimensions for min. open area sizes

| | |
|---|--------|
| G | 3 in. |
| H | 14 in. |

For help and assistance with Bosch accessories please call 1-800-944-2904 Mon-Fri 8am to 6pm EST

Notes: All height, width and depth dimensions are shown in inches. BSH reserves the absolute and unrestricted right to change product materials and specifications, at any time, without notice. Consult the product's installation instructions for final dimensional data and other details prior to making cutout. Applicable product warranty can be found in accompanying product literature or you may contact your account manager for further details.

Warranties: Bosch warrants that the Product is free from defects in materials and workmanship for a period of three hundred and sixty-five (365) days from the date of purchase. The foregoing timeline begins to run upon the date of purchase, and shall not be stalled, tolled, extended, or suspended, for any reason whatsoever. This Product is also warranted to be free from cosmetic defects in material and workmanship (such as scratches of stainless steel, paint/porcelain blemishes, chip, dents, or other damage) to the finish of the Product, for a period of thirty (30) days from the date of purchase or closing date for new construction. This cosmetic warranty excludes slight color variations due to inherent differences in painted and porcelain parts, as well as differences caused by kitchen lighting, product location, or other similar factors. This cosmetic warranty specifically excludes any display, floor, "As Is", or "B" stock appliances.

For more information on our entire line of products, go to www.bosch-home.ca or call 1-800-944-2904

© BSH Home Appliances Limited. All rights reserved. Bosch is a registered trademark of Robert Bosch GmbH.



06/15

24" Compact Washer

800 Series – WAT28402UC



Installation Details

Dimensions in inches

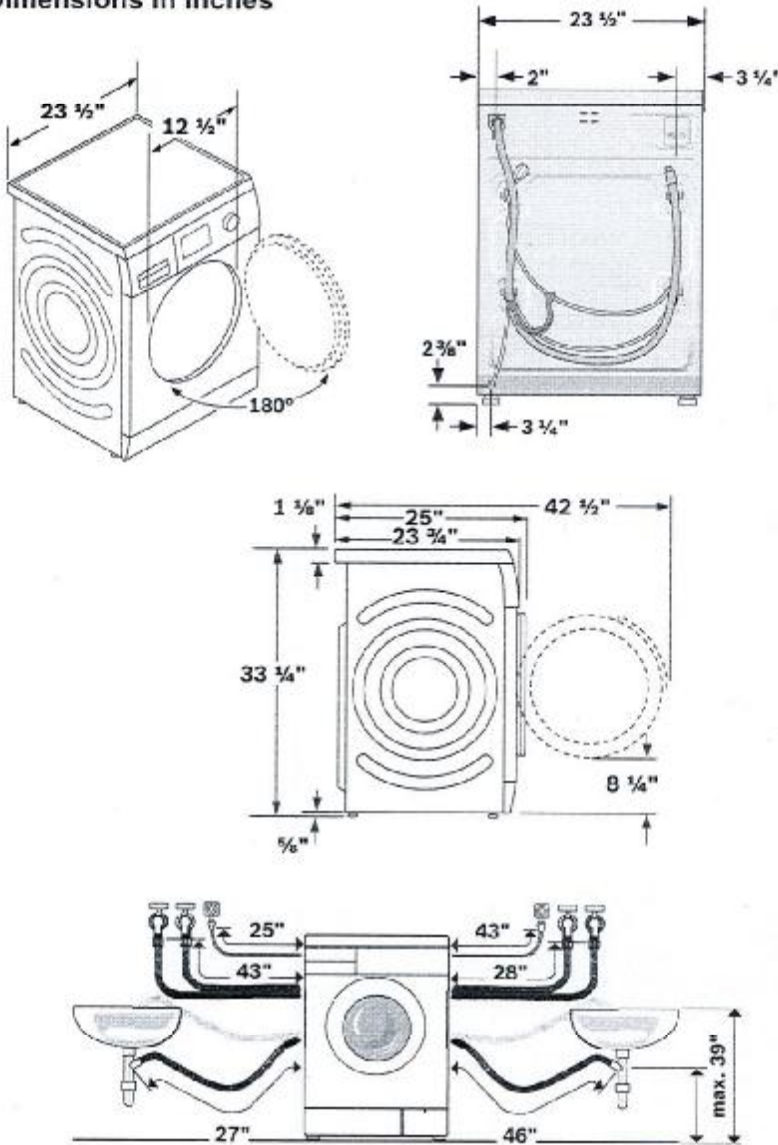

Washer plugged into the dryer

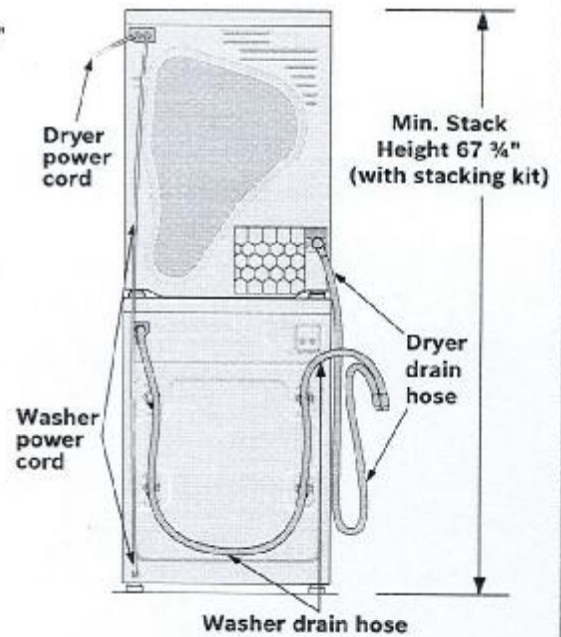

Optional Pedestal

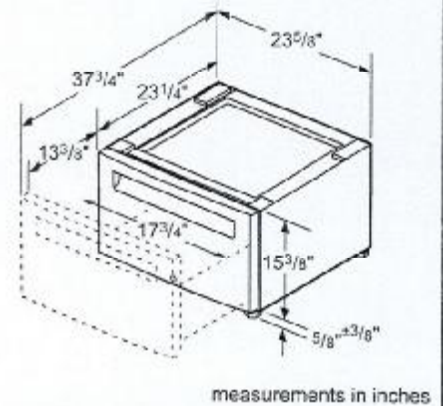

For help and assistance with Bosch accessories please call 1-800-944-2904 Mon-Fri 8am to 6pm EST

Notes: All height, width and depth dimensions are shown in inches. BSH reserves the absolute and unrestricted right to change product materials and specifications, at any time, without notice. Consult the product's installation instructions for final dimensional data and other details prior to making cutout. Applicable product warranty can be found in accompanying product literature or you may contact your account manager for further details.

Warranties: Bosch warrants that the Product is free from defects in materials and workmanship for a period of three hundred and sixty-five (365) days from the date of purchase. The foregoing timeline begins to run upon the date of purchase, and shall not be stalled, tolled, extended, or suspended, for any reason whatsoever. This Product is also warranted to be free from cosmetic defects in material and workmanship (such as scratches of stainless steel, paint/porcelain blemishes, chip, dents, or other damage) to the finish of the Product, for a period of thirty (30) days from the date of purchase or closing date for new construction. This cosmetic warranty excludes slight color variations due to inherent differences in painted and porcelain parts, as well as differences caused by kitchen lighting, product location, or other similar factors. This cosmetic warranty specifically excludes any display, floor, "As Is", or "B" stock appliances.

For more information on our entire line of products, go to www.bosch-home.ca or call 1-800-944-2904

© BSH Home Appliances Limited. All rights reserved. Bosch is a registered trademark of Robert Bosch GmbH.



08/15

Home Appliances

Home Appliances Products Compact Laundry Compact Washers WAT28402UC

800 Series
800 Series - White
WAT28402UC

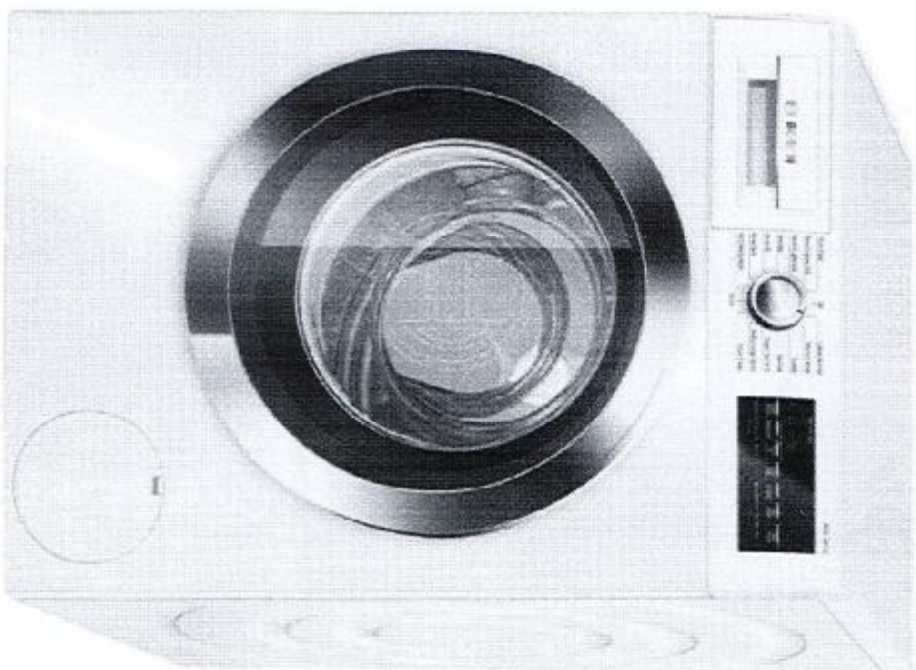

Price \$ 2,049.00

[Add To Cart](#)

[Find A Dealer](#)

Customer Rating:

★★★★★ **4.0** | 4 Reviews

3 out of 4 (75%) reviewers recommend this product.

[Write a review](#)

Lot #61

5.2



The 800 Series Laundry Pair is ENERGY STAR® Qualified and Offers Matching Quality, Water Protection, Design & a Fast Wash Cycle

- Wash 5 men's dress shirts in just 15 minutes.
- AquaStop® Plus provides extra protection against water damage.
- SpeedPerfect™ Provides Up to 40% Faster Washing Time*
- EcoSilence™ Motor Delivers Quiet, Efficient & Long Lasting Performance.
- Exceeds the March 2015 ENERGY STAR Water Consumption Standards

Specifications

Key Features

Design

Interior LED light

Neat White - European Design

Large Door with Chrome Door Ring

Large LED Display with Remaining Time

Electronic Control

Snag Free Stainless Steel Structured Drum

Stackable - Space Saving

Anti-vibration Circular Side Walls Reduce Vibration

Performance

The Wave-shaped Structured Drum Delivers a Powerful yet Gentle Wash.

T.N.

Home Appliances

Home Appliances Products Compact Laundry Compact Dryers 24" Dryers WTG86402UC

24" Compact Condensation Dryer 800 Series - White/Chrome WTG86402UC

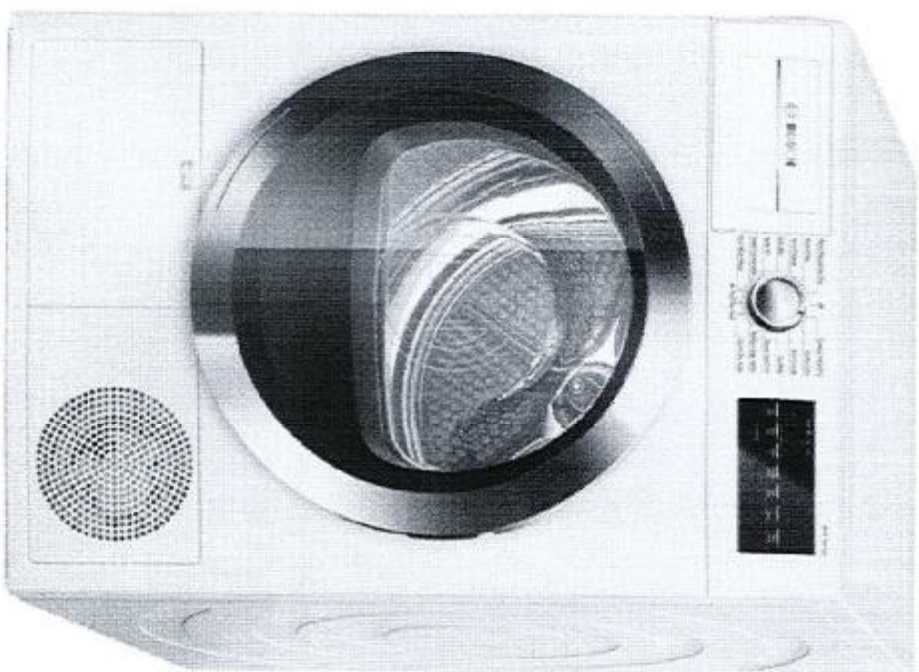

Price \$ 1,799.00

[Add To Cart](#)

[Find A Dealer](#)

Customer Rating:

★★★★★ 5.0 | 1 Review

1 out of 1 (100%) reviewers recommend this product

[Write a review](#)

lot #61

SN



The 800 Series Laundry Pair is ENERGY STAR® Qualified and Offers Matching Quality, Water Protection, Design & a Fast Wash Cycle

- Quietest Dryer in the 24" Category
- One of the Few ENERGY STAR® Qualified Dryer in 24" Compact Laundry Market
- Washer Plugs into Dryer for Easy Installation
- Dry Up to 18 Towels in One Load

Specifications

Key Features

- Condensation Drying Doesn't Require Ducting
- Perfect Design Match to Bosch 800 Series Washer
- Anti-vibration Circular Side Walls Reduce Vibration

Design

- Stainless Steel Structured Drum
- Neat White - European Design
- Large See-thru Door with the Chrome Door Ring
- Large LED Display with Remaining Time
- Electronic Control
- Stackable - Space Saving
- A reversible Door Allows you to Access Laundry from the Right or Left
- An Interior Drum LED Light Allows you to View your Clothes Easily



24" Compact Condensation Dryer

800 Series – WTG86402UC



BOSCH
Invented for life

Installation Details

Dimensions in inches

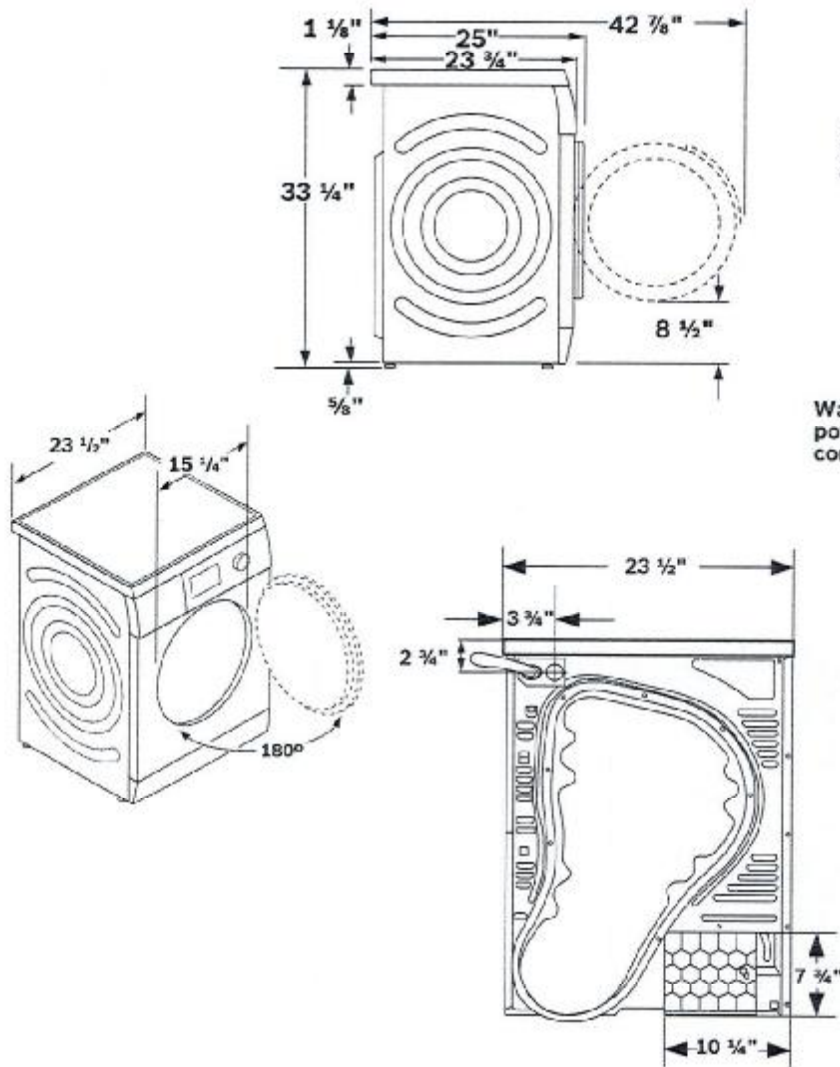

Washer plugged into the dryer

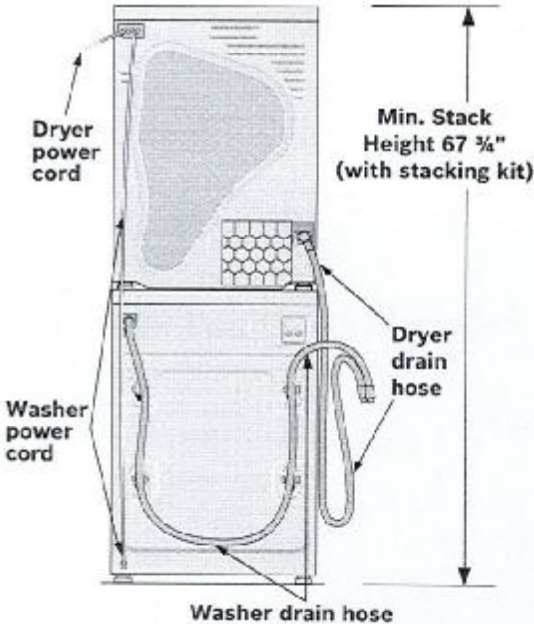

Optional Pedestal

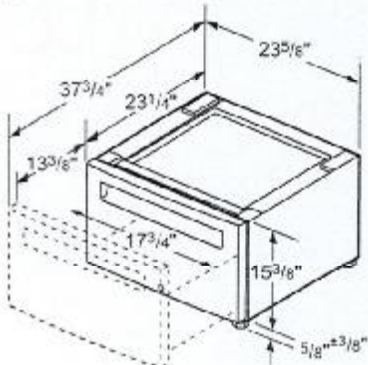

measurements in inches

For help and assistance with Bosch accessories please call 1-800-944-2904 Mon-Fri 8am to 6pm CST

Notes: All height, width and depth dimensions are shown in inches. BSH reserves the absolute and unrestricted right to change product materials and specifications, at any time, without notice. Consult the product's installation instructions for final dimensional data and other details prior to making outcut. Applicable product warranty can be found in accompanying product literature or you may contact your account manager for further details.

Warranties: Bosch warrants that the Product is free from defects in materials and workmanship for a period of three hundred and sixty-five (365) days from the date of purchase. The foregoing timeline begins to run upon the date of purchase, and shall not be stalled, tolled, extended, or suspended, for any reason whatsoever. This Product is also warranted to be free from cosmetic defects in material and workmanship (such as scratches of stainless steel, paint/porcelain blemishes, chip, dents, or other damage) to the finish of the Product, for a period of thirty (30) days from the date of purchase or closing date for new construction. This cosmetic warranty excludes slight color variations due to inherent differences in painted and porcelain parts, as well as differences caused by kitchen lighting, product location, or other similar factors. This cosmetic warranty specifically excludes any display, floor, "As Is", or "B" stock appliances.

For more information on our entire line of products, go to www.bosch-home.ca or call 1-800-944-2904

© BSH Home Appliances Limited. All rights reserved. Bosch is a registered trademark of Robert Bosch GmbH.



09/15

24" Compact Condensation Dryer

800 Series - WTG86402UC



Installation Details

Closet: Stacked

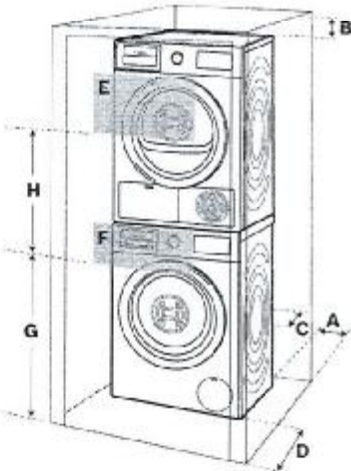

Closet: Stand Alone (shown) or Side by Side

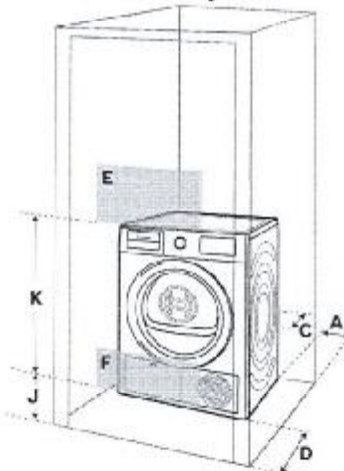

Clearance requirements (Minimum)

| | |
|--------------|-----------|
| A Both Sides | 5/8 in. |
| B Top | 6 1/4 in. |
| C Rear | 2 1/2 in. |
| D Front | 2 1/2 in. |

Ventilation Area (Minimum)

| | |
|----------|------------|
| E Top | 63 sq. in. |
| F Bottom | 63 sq. in. |

Vent Spacing

| | |
|---|--------|
| G | 37 in. |
| H | 26 in. |
| J | 3 in. |
| K | 29 in. |

Enclosure Dimensions

Under Counter: (Preferred)

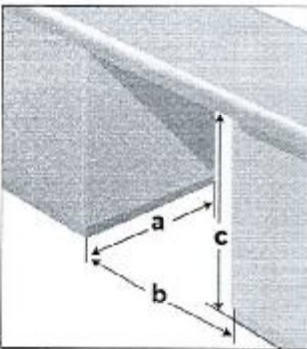

Front of the appliance fully open. No doors or coverings.

Under Counter: (Less Preferred)

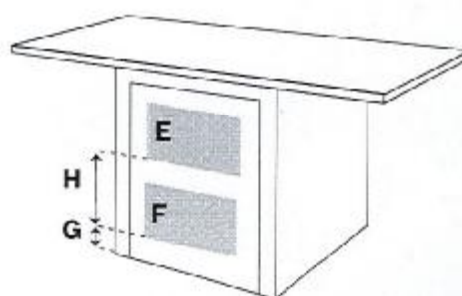

If the front of the appliance is covered, ventilation openings must be installed as shown and front/rear clearances adhered to according to closet installations.

Minimum opening dimensions

| | |
|---|------------|
| a | 28 in. |
| b | 23 7/8 in. |
| c | 34 1/2 in. |

E & F are minimum area sizes

| | |
|---|------------|
| E | 63 sq. in. |
| F | 63 sq. in. |

G & H actual spacing dimensions for min. open area sizes

| | |
|---|--------|
| G | 3 in. |
| H | 14 in. |

For help and assistance with Bosch accessories please call 1-800-944-2904 Mon-Fri 8am to 6pm EST

Notes: All height, width and depth dimensions are shown in inches. BSH reserves the absolute and unrestricted right to change product materials and specifications, at any time, without notice. Consult the product's installation instructions for final dimensional data and other details prior to making cutout. Applicable product warranty can be found in accompanying product literature or you may contact your account manager for further details.

Warranties: Bosch warrants that the Product is free from defects in materials and workmanship for a period of three hundred and sixty-five (365) days from the date of purchase. The foregoing timeline begins to run upon the date of purchase, and shall not be stalled, tolled, extended, or suspended, for any reason whatsoever. This Product is also warranted to be free from cosmetic defects in material and workmanship (such as scratches of stainless steel, paint/porcelain blemishes, chip, dents, or other damage) to the finish of the Product, for a period of thirty (30) days from the date of purchase or closing date for new construction. This cosmetic warranty excludes slight color variations due to inherent differences in painted and porcelain parts, as well as differences caused by kitchen lighting, product location, or other similar factors. This cosmetic warranty specifically excludes any display, floor, "As Is", or "B" stock appliances.

For more information on our entire line of products, go to www.bosch-home.ca or call 1-800-944-2904

© BSH Home Appliances Limited. All rights reserved. Bosch is a registered trademark of Robert Bosch GmbH.



09/15



Wall Mounted Chimney Hoods Add Style and Sophistication to the Kitchen and Gives You Greater Freedom in Your Kitchen Planning

- 600 CFM Centrifugal Integrated Blower Included
- Four Speed Touch Controls with LCD Display

Specifications

Touch Controls with LCD Display

Dishwasher Safe Aluminum Mesh Filters

Converts to Recirculation Mode with Accessory Kit(Separate Purchase Required)

Design

Duct Extension Accessory Kit Available for 9' to 12' Ceilings

Performance

2 Halogen Lights - 12 Volt, 20 Watt max., G-4 Base

8" round duct at discharge.

Efficiency

Blower will automatically turn on at high speed if excessive heat is sensed in the control area.

Absorb odors with charcoal replacement filters.

Convenience

Convenient timer built into control from 1-60 minutes.

Signal on LCD display will illuminate as a reminder to check filters for cleaning.

Audible tone when select controls are pressed.



French Door Refrigerator

E23BC78IPS professional series

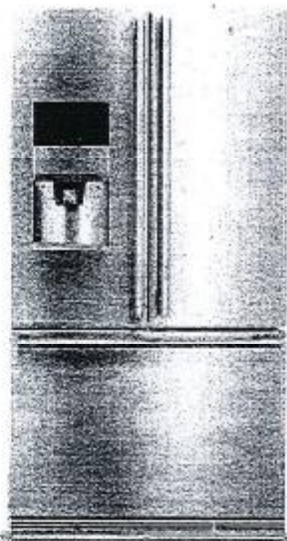

Custom Temp Drawer™

Enjoy the ultimate in versatility with 9 preset sections including White/Sparkling Wine, Fish/Shellfish, Cheese plus three customizable settings that ensure foods stay at the ideal temperature for serving and maintaining freshness.



Custom-Design™ Organization System

With our flexible Tri-Level freezer organization system you can keep your freezer well organized. The three Smooth-Glide® baskets with removable dividers and top removable baskets allow you to configure the space to neatly fit large and small items.



Theatre Lighting

Transition LED lighting gradually illuminates the interior with soft but ample light as you open the door.



PureAdvantage® Filtration Systems

Our filtration system keeps clean, filtered air circulated throughout to prevent odor transfer and keeps fresh, clean water

23 CU. FT. COUNTER-DEPTH FRENCH DOOR REFRIGERATOR

CAPACITIES

| | |
|-----------------------|---------------|
| Total Capacity | 22.6 Cu. Ft. |
| Fresh Food Volume | 15.7 Cu. Ft. |
| Freezer Volume | 6.9 Cu. Ft. |
| Total Shelf Area | 26.45 Sq. Ft. |
| Fresh Food Shelf Area | 18.72 Sq. Ft. |
| Freezer Shelf Area | 7.7 Sq. Ft. |

EXTERIOR

| | |
|--|---------|
| Professional Door and Handle Design | Yes |
| Wave-Touch® Electronic Controls | Yes |
| Door Hinge Covers | Yes |
| Ice/Water Dispenser | Yes |
| Custom-Set™ Temperature Control System and Display | Yes |
| Crushed/Cubes/Water | Yes |
| Air and Water Filter Indicator/Reset | Yes |
| Ice Maker On/Off | Yes |
| Fast Freeze™ | Yes |
| Lock/Dispenser Light Control | Yes/Yes |

FRESH FOOD CONVENIENCES

| | |
|---|-------------------------------------|
| PureAdvantage® Water & Ice / Air Filtration | Yes |
| Water Filter Location | Bottom Left |
| Temp Alarm System / Door Ajar Alarm / Power Failure Alarm | Yes |
| Custom-Design™ Glass Shelves | 3 - Half Width 1 - Quarter Width |
| Smooth-Glide® Humidity-Controlled Left Crisper | Yes |
| Smooth-Glide® Humidity-Controlled Right Crisper | Yes |
| Custom Temp Drawer™ | Yes |
| Wine Rack | Yes |
| Clear Gallon Adjustable Door Bins | 1 |
| Clear 1/2-Gallon Adjustable Door Bins | 1 |
| Clear 2-Liter/1.2-Gallon Removable Door Bins | 2 |
| Locking Clear Utility Bin | Yes |
| Tilt-Out Can Racks | 2 |
| Theatre Ramp-Up Multilevel Lighting - LED | Yes |
| Automatic Ice Maker | Yes |

FREEZER CONVENIENCES

| | |
|---|--------------------------------------|
| Self-Closing Drawer | Yes |
| Sliding Full-Width Freezer Baskets | 3 Smooth-Glide® (2 with Dividers) |
| Plastic Basket Tray | 1 |
| Tilt-Out Wire Door Racks | 1 |
| Theatre Ramp-Up Multilevel Lighting - LED | Yes |

ADDITIONAL FEATURES

| | |
|----------------------------------|-----|
| ENERGY STAR® | Yes |
| Sabbath Mode (Star-K® Certified) | Yes |

ACCESSORIES

| | |
|--|----------|
| Color Kit - PN# ECK23CCS* | Optional |
| Lighting Trim Kit - PN# 24723001* | Optional |
| Water Filter Replacement Cartridge - PN# FWF01 | Optional |
| Air Filter Replacement Cartridge - PN# EAF03F | Optional |

SPECIFICATIONS

| | |
|---|----------------------|
| Overall Exterior Dimensions - | |
| Height (With Hinges and 3/8" Rollers) | 69-1/2" |
| Cabinet Width/Door Width | 36-5/8"/36" |
| Depth (Including Handle) | 29-1/2" |
| With 90° Doors Open | 42-9/16" |
| With Drawer Fully Extended | 44-1/2" |
| Power Supply Connection Location | Right Bottom Rear |
| Water Inlet Location | Left Bottom Rear |
| Voltage Rating | 120V/50 Hz/15 or 20A |
| Connected Load (kW Rating) @ 120 Volts* | 1.03 |
| Minimum Circuit Required (Amps) | 15 |
| Shipping Weight (Approx.) | 348 Lbs. |

*For detailed Linearm Kit and Color Kit installation instructions, refer to Product Installation Guides on the web at electroluxicon.com.

**An electrical supply with grounded three-prong receptacle is required. The power supply circuit must be installed in accordance with current edition of National Electrical Code (NEC), 70 and local codes & ordinances.

NOTE: Always consult local and national electric and plumbing codes. Refer to Product Installation Guide for detailed installation instructions on the web at electroluxicon.com.

Specifications subject to change.

lot #61

TV

SWA

24" Flush Handle Dishwasher
500 Series- Stainless steel
SHP65T55UC

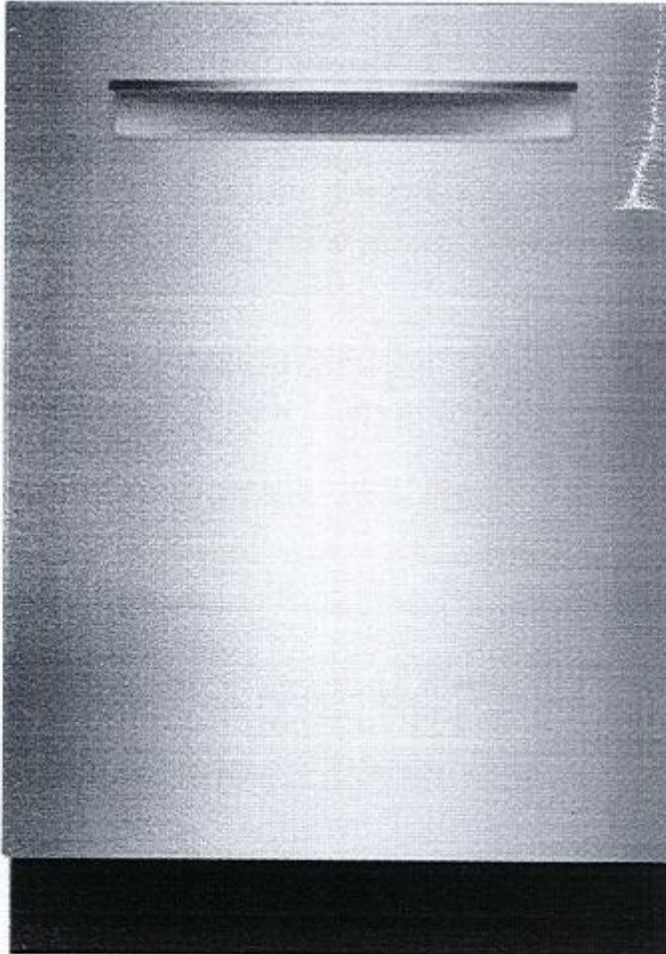

Features and Benefits

Key Features

- 44 dBA- Quietest Brand
- 3rd Rack for Additional Loading Capacity
- InfoLight® Beams on Floor to Indicate Dishwasher is Running
- RackMatic™ on Upper Rack - 3 Height Adjustments and Up to 9 Possible Rack Positions
- AquaStop® Leak Protection Works 24/7

Design

- Full Size Stainless Steel Tall Tub Installs Perfectly Flush
- 3rd Rack for Additional Loading Capacity
- 16 Place Setting Capacity
- LED Remaining Time Display
- RackMatic™ on Upper Rack - 3 Height Adjustments and Up to 9 Possible Rack Positions

Performance

- 44 dBA- Quietest Brand
- 5 Programs and 5 Options
- Detergent Tray Optimizes Detergent Dissolving
- Load Size Sensor Automates Wash Temperature
- Sanitize Option Eliminates Bacteria and Enhances Drying Results
- ExtraShine™ Option Enhances Shine and Drying Results of your Dishes

Efficiency

- 259 kwh/yr - Energy Star®
- Half Load Option for Small Loads

Convenience



Notes: All height, width and depth dimensions are shown in inches. *Please refer to installation instructions prior to making cutout. BSH reserves the absolute and unrestricted right to change product materials and specifications, at any time, without notice. Consult the product's installation instructions for final dimensional data and other details. Applicable product warranty can be found in a accompanying product literature or you may contact your account manager for further details.

For more information on our entire line of products, go to boschappliances.com or call 1-800-944-2904.
Copyright ©2013 BSH Home Appliances Corporation. All rights reserved. Bosch is a registered trademark of Robert Bosch GmbH.
Litho Date: 05/2013

Lot #61

