



CONSTRUCTION SUMMARY

Teefy Developments Limited / 9130 Bathurst

Lot/Unit: 148    Phase/Building: 1    Model/Floor Plan: Riverdale(22-3)

CABINETRY ACCESSORIES

Inv.3513	1 - DIFFERENT COLOUR ISLAND & BASE THAN KITCHEN UPPERS	
Line 46317	Note:	
18Feb16 / 3Mar16		
Inv.3513	3 - CROWN MOULDING - NOT APPLICABLE FOR THERMOVISION - PRICE IS PER 8 FOOT LENGTH	
Line 46321	Note:	
18Feb16 / 3Mar16		
Inv.3513	2 - LIGHT VALANCE - NOT APPLICABLE FOR THERMOVISION - PRICE PER 8 FOOT LENGTH	
	- PRICE TO INCLUDE SERVERY	
Line 46324	Note:	
18Feb16 / 3Mar16		

CABINETRY APPLIANCE - FRIDGE

Inv.3513	1 - 66 CM FRIDGE CABINET - 1 GABLE 66 CM & CABINET 59 CM DEEP - COUNTER DEPTH	
Line 46499	Note:	
18Feb16 / 3Mar16		

CABINETRY HOOD FANS

Inv.3513	1 - ACCOMMODATE FOR CHIMNEY HOOD FAN - PURCHASER MUST SUPPLY SPECS	
Line 46316	Note:	
18Feb16 / 3Mar16		

CABINETRY VANITY

Inv.3513	1 - VANITY BANK OF DRAWERS - 55 CM MAXIMUM - UPGRADE 1	
Line 46328	Note:	
18Feb16 / 3Mar16		

COUNTER TOP - VANITY

Inv.3513	1 - SUPPLY AND INSTALL 2CM STONE COUNTEROP WITH STANDARD SQUARE EDGE – GROUP 1 IN THE ENSUITE - BATHROOM	
	- Price to include Cut & Polish for undermount sink (Sinks NOT Included)	
Line 46314	Note:	
18Feb16 / 3Mar16		

ELECTRICAL

Inv.3513	4 - RELOCATE EXISTING CEILING LIGHT IN FORMAL ROOM WITH ADDITONAL CAPPED CEILING LIGHT ROUGH-IN ONLY ON EXISTING SWITCH & RELOCATE KITCHEN LIGHT WITH ADDITONAL CAPPED CEILING LIGHT ROUGH-IN ONLY ON EXISTING SWITCH ABOVE BREAKFATS BAR	
Line 46320	Note:	
18Feb16 / 3Mar16		
Inv.3513	1 - SUPPLY AND INSTALL LIGHT VALANCE ROUGH IN (INCLUDES 1 SWITCH)	
	- PRICE TO INCLUDE SERVERY	
Line 46326	Note:	
18Feb16 / 3Mar16		



CONSTRUCTION SUMMARY

Teefy Developments Limited / 9130 Bathurst

Lot/Unit: 148    Phase/Building: 1    Model/Floor Plan: Riverdale(22-3)

HARDWOOD

Inv.3513	1 - The Vendor agrees to supply and install hardwood flooring in the upper level hallway with choice of stain from Vendors standard samples.	
Line 46300	Note:	
18Feb16 / 3Mar16		

MISCELLANEOUS

Inv.3513	1 - LOWER LEVEL LAYOUT CHANGE - PURCHASER HAS OPT'D TO GO WITH THE LOWER LEVEL BEDROOM - THIS CHANGE WAS APPROVED BY HEAD OFFICE	
Line 46301	Note:	
18Feb16 / 3Mar16		
Inv.3513	1 - FIREPLACE WALL FURR OUT - PRICING INCLUDED T.V CABLE ABOVE & DUPLEX OUTLET FOR WALL HUNG T.V  -FIREPLACE BASE TO BE APPROX 18" FROM THE FLOOR -CABLE AND OUTLET TO BE 5' 5" FROM THE FLOOR OFFSET FOR FUTURE T.V WALL MOUNT	
Line 46323	Note:	
18Feb16 / 3Mar16		

PLUMBING

Inv.3513	2 - MASTER ENSUITE - SUPLLY AND INSTALL CONTRAC 17" CONNOR UNDERMOUNT SINK IN LIEU OF THE STANDARD OVERMOUNT - MODEL 4210CFY	
Line 46315	Note:	
18Feb16 / 3Mar16		
Inv.3513	1 - SUPPLY AND INSTALL WATERLINE ROUGH-IN TO THE FRIDGE LOCATION (NO HOOK UP)	
Line 46318	Note: LOCATION AS PER SKETCH ATTACHED.	
18Feb16 / 3Mar16		

TILE - BACKSPLASH

Inv.3513	1 - BACKSPLASH - KITCHEN BACKSPLASH ABOVE COUNTER AND BEHIND STOVE	
Line 46329	Note:	
18Feb16 / 3Mar16		
Inv.3513	1 - BACKSPLASH - KITCHEN BACKSPLASH INSTALLED TO ACCOMMODATE FOR FUTURE CHIMNEY STYLE HOODFAN - RIGHT TO THE CEILING	
Line 46330	Note:	
18Feb16 / 3Mar16		

TILE - FLOOR

Inv.3513	1 - SUPPLY AND INSTALL FLOOR TILE - UPGRADE 8 - VESTIBULE FLOOR	
Line 46311	Note:	
18Feb16 / 3Mar16		
Inv.3513	1 - SUPPLY AND INSTALL FLOOR TILE - UPGRADE 5 - - POWDER ROOM FLOOR	
Line 46310	Note:	
18Feb16 / 3Mar16		
Inv.3513	1 - SUPPLY AND INSTALL FLOOR TILE - UPGRADE 2 - - MAIN BATH FLOOR	
Line 46312	Note:	
18Feb16 / 3Mar16		



CONSTRUCTION SUMMARY

Teefy Developments Limited / 9130 Bathurst

Lot/Unit: 148    Phase/Building: 1    Model/Floor Plan: Riverdale(22-3)

Inv.3513	1 - SUPPLY AND INSTALL FLOOR TILE - UPGRADE 5 - - ENSUITE BATHROOM FLOOR	
Line 46313	Note:	
18Feb16 / 3Mar16		

EXTRAS AS PER OFFER

Stainless Steel Fridge, Stove and Dishwasher and front loading washer and dryer in white from Vendors standard samples, no cash value, not transferable. (Supplied only not installed) ** to - arrange delivery call: The Brick commercial sales division at Worksheet Note:	
Rogers Free Services Package includes 6 months of: home phone, TV and Internet Service. Worksheet Note:	
The Vendor agrees to supply and install hardwood flooring in the upper level hallway with a choice of stain from Vendors standard samples. Worksheet Note:	

Purchasers: Alex Oleg Nemirovsky & Ruslana Nemirovsky Property: 148 of Plan -  
 Telephone Res. / Bus: (416) 817-1681 / Project: Teefy Developments Limited  
 Decor Advisor: Nicole Soares Model and Elevation: Riverdale(22-3)

Layout Changes: ☒ Yes ☐ No Sketch Attached: ☒ Yes ☐ No Exterior Colour Scheme:

### 1. Cabinetry

	Style and Colour	Counter Top	Hardware
Kitchen / Breakfast	Refere to Comments Below	9141 Ice Snow - Std Edge	9677
Kitchen Island	Refere to Comments Below	9141 Ice Snow - Std Edge	9677
Laundry Room	Lancaster Paint: Cappuccino	N/A	9677
Powder Room	Lancaster Maple: Soapstone	White Carrara 4924-38	9677
Main Bathroom	Lancaster Paint: Winter White	Calcutta Marble 4925K-07	9677
Master Ensuite Bathroom	Lancaster Maple: Cappuccino	*Periato Royale - Std Edge	9677
Second Ensuite Bathroom (If Applicable)			
Lower Level Laundry	Lancaster Paint: Cappuccino	N/A	9677
Lower Level Bath	Lancaster Paint: Winter White	Calcutta Marble 4925K-07	9677

Appliances Custom Size Fridge Valance Lighting Microwave / Range Hood  
☐ Yes ☒ No ☒ Yes ☐ No ☒ Yes ☐ No  
 Cooktop / Rangetop Built in Wall Oven Slide-in Range  
☐ Yes ☒ No ☐ Yes ☒ No ☐ Yes ☒ No

Comment  
 UPPER CABINETS AND FRIDGE ENCLOSURE: LANCASTER PAINT: WINTER WHITE  
 BASE CABINETS AND ISLAND: LANCASTER PAINT: CAPPUCCINO

### 2. Flooring

	Selection
Foyer	Must 12x24 Polished: Ivory - To be installed VERTICALLY to the door
Main Hall	Satin Finish Gen. Home 3 5/8" x 3/4" Eng. Hardwood: Graphite
Back Hall	
Breakfast	
Laundry Room	2nd Floor- Alpes 13x13: Grey
Kitchen	Satin Finish Gen. Home 3 5/8" x 3/4" Eng. Hardwood: Graphite
Powder Room	*Must 18x18 Polished: Brown
Main Bathroom	*Irene Series 13x13: Anthracite Matte
Master Ensuite	*Must 18x18 Polished: Brown / Shower Floor Tile- Ontario 2x2 Matte Mosaic: Tender Grey
Bathroom (If Applicable)	Lower Level- New Reeds 13x13: Grey
Mud Room	Tibet 13x13: Grey
Lower Level Laundry	Tibet 13x13: Grey
Living Room	
Dining Room	Satin Finish Gen. Home 3 5/8" x 3/4" Eng. Hardwood: Graphite
Family / Great Room	Satin Finish Gen. Home 3 5/8" x 3/4" Eng. Hardwood: Graphite
Den / Library / Study	
Basement Landing (If Applies)	
Lower Landing (If Applicable)	
Upper Landing	Satin Finish Gen. Home 3 5/8" x 3/4" Eng. Hardwood: Graphite
Upper Hall	Satin Finish Gen. Home 3 5/8" x 3/4" Eng. Hardwood: Graphite
Master Bedroom	Papillio: 17193 Wallaby Cream
Bedroom #2	Papillio: 17193 Wallaby Cream
Bedroom #3	Papillio: 17193 Wallaby Cream
Bedroom #4	Papillio: 17193 Wallaby Cream
Bedroom #5	
Recreation Room	Papillio: 17193 Wallaby Cream

Flooring Continued on Page 2

Initial: AN RN



Purchasers: Alex Oleg Nemirovsky & Ruslana Nemirovsky Property: 148 of Plan -  
 Telephone Res. / Bus: (416) 817-1681 / Project: Teefy Developments Limited  
 Decor Advisor: Nicole Soares Model and Elevation: Riverdale(22-3)

### 2. Flooring - Continued -

Upgrade Underpad	Type	Area
	Standard	Bedrooms & Recreation Room
Carpet on Stairs	Capped	Runner - *Upgrade
Comment		

### 3. Plumbing Fixtures / Faucets

Kitchen	Standard	Second Ensuite		Powder Room	Standard
Master Ensuite	Standard			Other Room	
Main Bathroom	Standard	Lower Level Bath	Standard		

Comment

### 4. Wall Tile

	Tile Selection	Listello	Insert	Insert Selection
Main Bathroom	Serpentine 8x10: White	<input type="checkbox"/>	<input type="checkbox"/>	
Master Ensuite				
Tub Deck	N/A	<input type="checkbox"/>	<input type="checkbox"/>	
Tub Apron	N/A	<input type="checkbox"/>	<input type="checkbox"/>	
Tub Surround	N/A	<input type="checkbox"/>	<input type="checkbox"/>	
Shower Stall	Brick Glossy 8x12: White - To Be Installed Vertically	<input type="checkbox"/>	<input type="checkbox"/>	
Second Ensuite		<input type="checkbox"/>	<input type="checkbox"/>	
Lower Level Bath	Brick Glossy 6x12: White - To Be Installed Horizontally	<input type="checkbox"/>	<input type="checkbox"/>	
Kitchen Backsplash	Refere to Comments Below	<input type="checkbox"/>	<input type="checkbox"/>	
Complete Backsplash		<input type="checkbox"/>	<input type="checkbox"/>	

Comment

See Revised

### 5. Fireplace

	Living Room			Family Room			Other Room - Specify		
	Purchased	As Per Plan	N/A	Purchased	As Per Plan	N/A	Purchased	As Per Plan	N/A
Fireplace Type	<input type="radio"/>	<input type="radio"/>	<input type="radio"/>	<input type="radio"/>	<input checked="" type="radio"/>	<input type="radio"/>	<input type="radio"/>	<input type="radio"/>	<input type="radio"/>
Mantle Type				Standard Electric - BLF 50					
Over Mantle									
Colour / Stain									
Surround				Standard					
Hearth									

Comment

Initial:

AN RN



## INTERIOR COLOUR SCHEME

Revised

Purchasers: Alex Oleg Nemirovsky &amp; Ruslana Nemirovsky

Property: 148 of Plan -

Telephone Res. / Bus: (416) 817-1681 /

Project: Teefy Developments Limited

Decor Advisor: Nicole Soares

Model and Elevation: Riverdale(22-3)

## 2. Flooring - Continued -

Upgrade Underpad	Type	Area
	Standard	Bedrooms & Recreation Room
Carpet on Stairs	Capped	Runner - *Upgrade
Comment		

## 3. Plumbing Fixtures / Faucets

Kitchen	Standard	Second Ensuite		Powder Room	Standard
Master Ensuite	Standard			Other Room	
Main Bathroom	Standard	Lower Level Bath	Standard		

Comment

## 4. Wall Tile

	Tile Selection	Listello	Insert	Insert Selection
Main Bathroom	Serpentine 8x10: White	<input type="checkbox"/>	<input type="checkbox"/>	
Master Ensuite				
Tub Deck	N/A	<input type="checkbox"/>	<input type="checkbox"/>	
Tub Apron	N/A	<input type="checkbox"/>	<input type="checkbox"/>	
Tub Surround	N/A	<input type="checkbox"/>	<input type="checkbox"/>	
Shower Stall	Brick Glossy 8x12: White - To Be Installed Vertically	<input type="checkbox"/>	<input type="checkbox"/>	
Second Ensuite		<input type="checkbox"/>	<input type="checkbox"/>	
Lower Level Bath	Brick Glossy 8x12: White - To Be Installed Horizontally	<input type="checkbox"/>	<input type="checkbox"/>	
Kitchen Backsplash	Refere to Comments Below	<input type="checkbox"/>	<input type="checkbox"/>	
Complete Backsplash		<input type="checkbox"/>	<input type="checkbox"/>	

Comment

ALUMINUM - METAL MOSAICS: SILVER BLEND.  
(CODE # LW.AL.SIL.0.8x1.8.BD)

## 5. Fireplace

	Living Room			Family Room			Other Room - Specify		
	Purchased	As Per Plan	N/A	Purchased	As Per Plan	N/A	Purchased	As Per Plan	N/A
Fireplace Type	<input type="radio"/>	<input type="radio"/>	<input type="radio"/>	<input type="radio"/>	<input checked="" type="radio"/>	<input type="radio"/>	<input type="radio"/>	<input type="radio"/>	<input type="radio"/>
Mantle Type				Standard Electric - BLF 50					
Over Mantle									
Colour / Stain									
Surround				Standard					
Hearth									
Comment									

Initial:

AN RN



Purchasers: Alex Oleg Nemirovsky & Ruslana Nemirovsky Property: 148 of Plan -  
 Telephone Res. / Bus: (416) 817-1681 / Project: Teeffy Developments Limited  
 Decor Advisor: Nicole Soares Model and Elevation: Riverdale(22-3)

### 6. Trim Carpentry

Door Hardware

Interior Trim

Comment

#### Interior Doors

☐ 2 Panel Arch Top

☒ 2 Panel Square Top

☐ 6 Panel



Initial for Door Style AN

### 7. Railings and Pickets

Railing Package

Railing Colour

Picket Colour

Wood Stairs ☐ No ☒ Oak

Tread Colour

Comment

Stairs to be stained to match "Satin Finish Gen. Home 3 5/8" x 3/4" Eng. Hardwood: Graphite as much as possible \*\*\*  
 Purchaser is aware that stain will not be a 100% true match as stairs are stained on site

### 8. Plaster Mouldings and Medallions

Foyer

Main Hall

Living Room

Dining Room

Family Room

Kitchen/Breakfast

Den/Library

Lower Landing

Comment

### 9. Wall Paint

Senator White

Smooth Ceilings

☐ First Floor

☐ First Floor incl. Second Floor Hall

☐ First and Second Floor

☒ Throughout

☐ Not Applicable

Trim Paint

### 10. Additional Comments

### 11. Disclaimers and Notes

- Colours of all materials are as close as possible to builder's selection, but not necessarily identical due to variances in manufacturing.
- Any extras listed above are null and void unless accompanied by a separate invoice/amendment. Said invoice must be paid in full.
- The Purchaser acknowledges that after Interior Colour Selection form is signed and dated, no further changes will be permitted other than re-selection due to unavailability. AN Purchaser's Initials
- The Purchaser acknowledges reading and accepting the "Senator Homes Décor Centre Disclaimers" form. This document contains other miscellaneous disclaimers.

This Interior Colour Selection is final and approved by:

Purchaser:

Signature: AN Date: MAR 03 2016

Signature: NS Date: MAR 03 2016

Vendor:

A  
Teeffy Developments Limited



9130-148

# RIVERDALE

2454 SQ.FT. / 2288 SQ.FT. WITH OPTIONAL TANDEM GARAGE

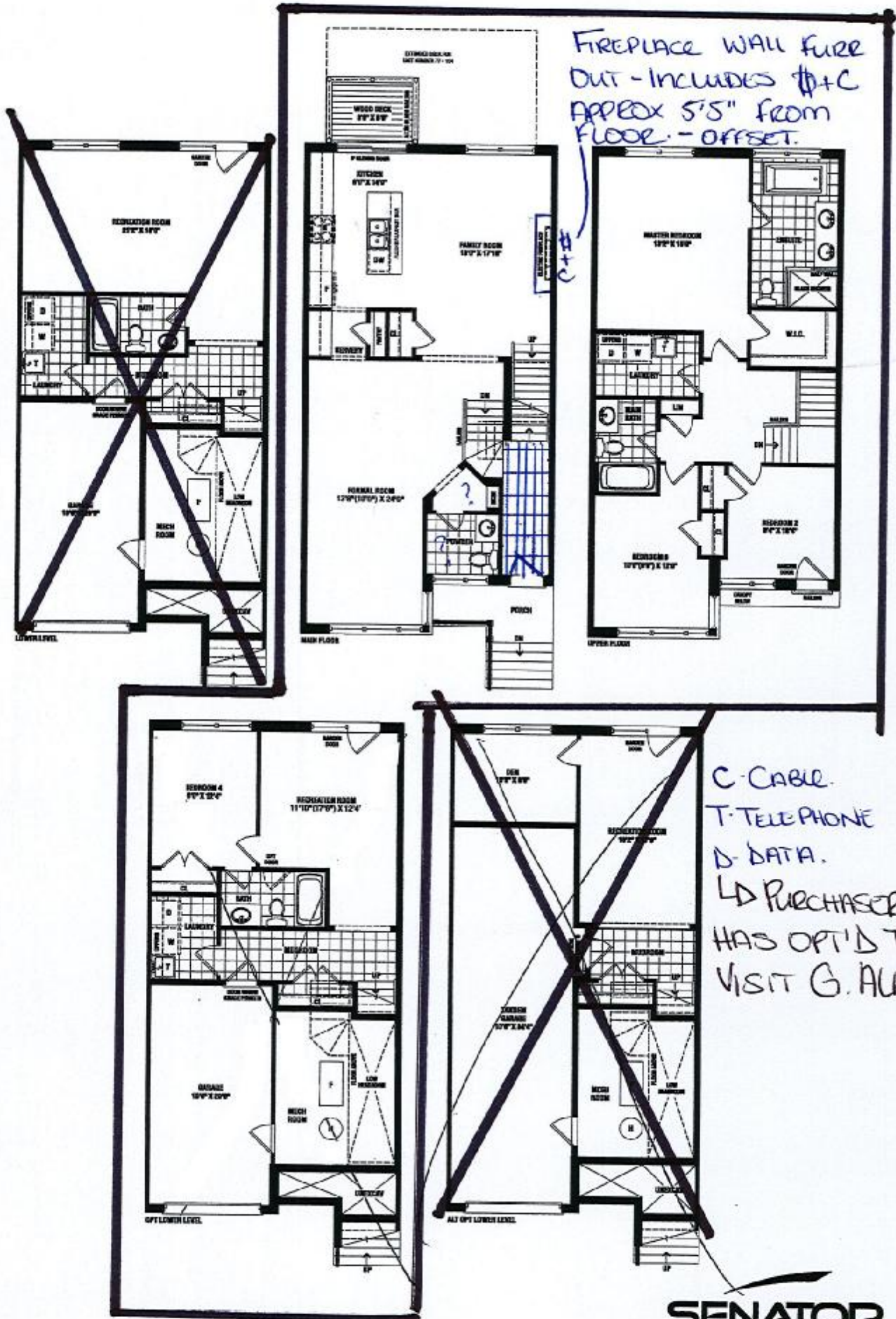

**SENATOR HOMES**

SENATOR HOMES  
DECOR CENTRE

DATE: MAR 03 2016

INITIALS: AN RN

RN AN

Renderings are artist's concept. Some elevations may vary from that shown. Actual useable square footage may vary from that stated herein. Some floorplans and elevations are minor images to that shown. E&O.E. 22-3



# RIVERDALE - TH-22-3

## STD. LAYOUT

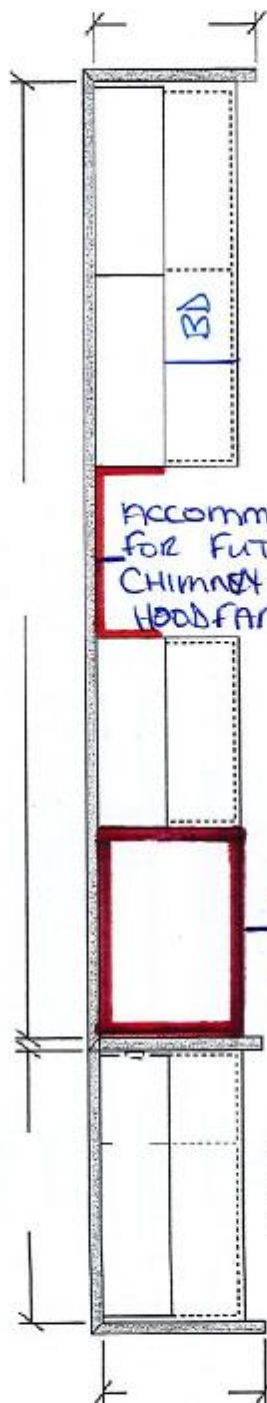

COUNTER DEPTH FRIDGE ENCLOSURE W/ 1 GABLE.

\*WALK IN PANTRY NOT INCLUDED\*

OPT. CROWN (X3)  
OPT. LIGHT VALANCE (X2)

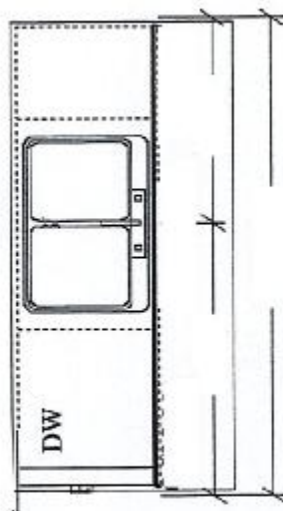

-KITCHEN (MAIN FLOOR) ELEV A  
-ALT 1 ELEV A

## CABINERY (STANDARD ELEVATION)

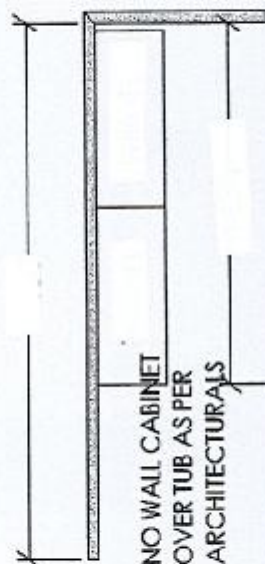

OPT. LAUNDRY UPPIERS (LOWER LEVEL) ELEV A  
(BASE CABINERY NOT REFLECTED ON DWG'S)

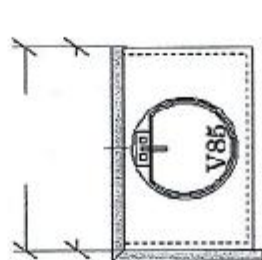

BATH (LOWER LEVEL) ELEV A

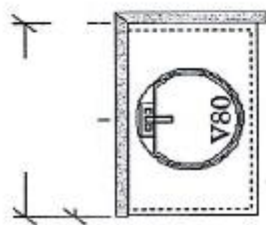

MAIN BATH (UPPER LEVEL) ELEV A

VANITY BANK OF DRAWERS



-ENSUITE (UPPER FLOOR) ELEV A HALF WALL

9130-148

SENATOR HOMES  
DECOR CENTRE

DATE:

MAR 03 2015

INITIALS:

AN  
PN

9130-148

# CONNOR 17" OVAL UNDERMOUNT SINK 9130-148

MASTER BATH x2

## 4210CFY Undermount Sink

### Product Specs:

- Vitreous china
- Front overflow hole
- Template and mounting hardware supplied

### Overall Dimensions (W x D x H):

(OD): 430mm(17") x 355mm(14") x 190mm(7½")

(ID): 380mm(15") x 305mm(12") x 140mm(5½")

### Compliance Certifications:

Meets or exceeds the following:

- IAPMO cUPC
- ASME A112.19.2 / CSA B45.1-2008

### Shipping:

Cube 1.11  
GW 16 lbs

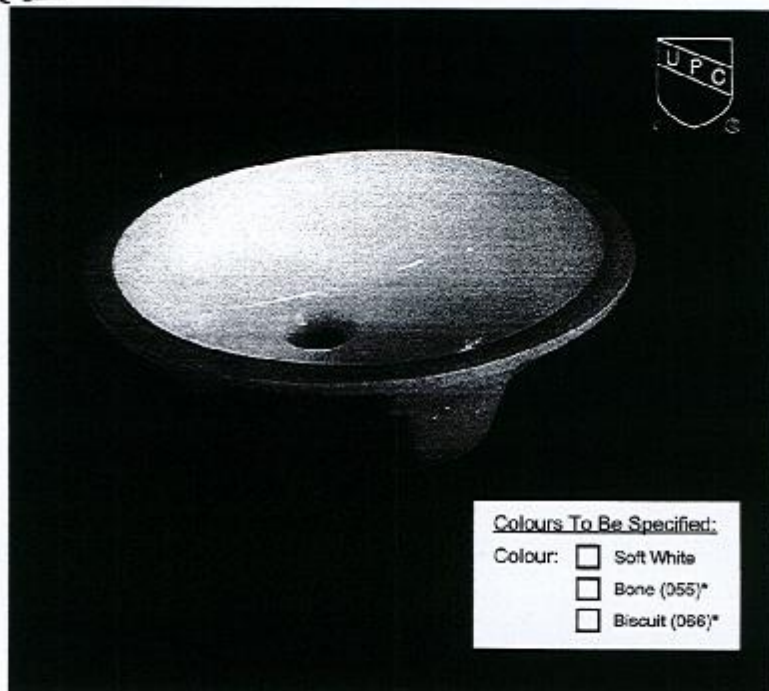

#### Colours To Be Specified:

- Colour: ☐ Soft White  
☐ Bone (955)\*  
☐ Biscuit (086)\*

#### Notes:

Dimensions of fixtures are nominal and may vary within the range of tolerances established by ASME standard A112.19.2. These measurements are subject to change or cancellation. No responsibility is assumed for use of superseded or voided pages.

\*Bone and Biscuit available through Direct Import (CIF) only.

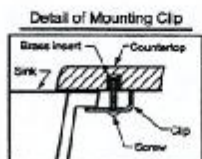

Note:  
▲ Dimensions shown for location of supplies and "P" trap are suggested.

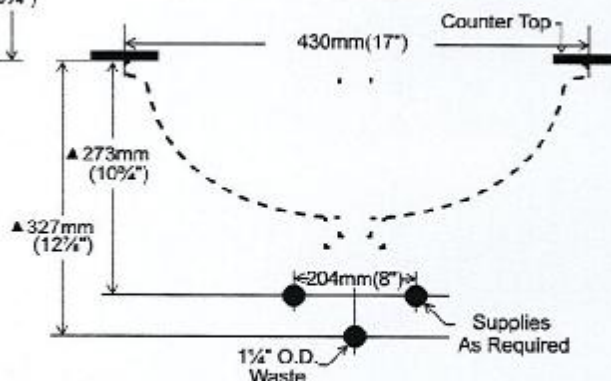
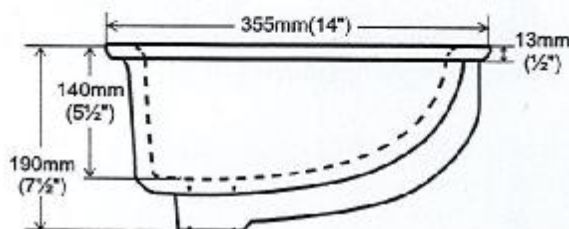
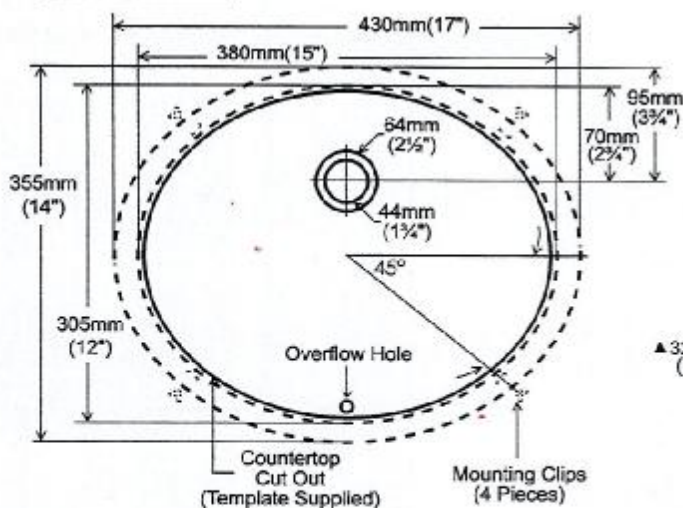

contrac.

5970 Chedworth Way, Unit A, Mississauga, ON, Canada L5R 3V5  
www.contrac.ca

Revised: June 2015

SENATOR HOMES  
DECOR CENTRE

DATE: MAR 03 2016

INITIALS: [Handwritten initials]



# French Door Refrigerator

E23BC78IPS Professional Series

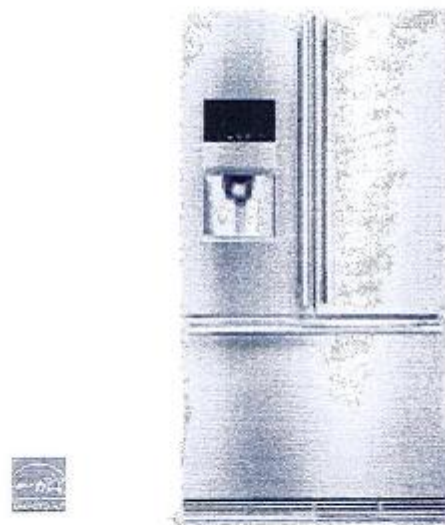

## Custom Temp Drawer™

Enjoy the ultimate in versatility with 9 preset selections including White/Sparkling Wine, Fish/Shellfish, Cheese plus three customizable settings that ensure foods stay at the ideal temperature for serving and maintaining freshness.



## Custom-Design™ Organization System

With our flexible Tri-Level freezer organization system you can keep your freezer well organized. The three Smooth-Glide™ baskets with removable dividers and top removable baskets allow you to configure the space to neatly fit large and small items.



## Theatre Lighting

Transition LED lighting gradually illuminates the interior with soft but ample light as you open the door.



## PureAdvantage® Filtration Systems

Our filtration system keeps clean, filtered air circulated throughout to prevent odor transfer and keeps fresh, clean water and ice at your fingertips.

## 23 CU. FT. COUNTER-DEPTH FRENCH DOOR REFRIGERATOR

CAPACITIES	
Total Capacity	22.8 Cu. Ft.
Fresh Food Volume	15.7 Cu. Ft.
Freezer Volume	8.9 Cu. Ft.
Total Shelf Area	26.45 Sq. Ft.
Fresh Food Shelf Area	18.72 Sq. Ft.
Freezer Shelf Area	7.7 Sq. Ft.
EXTERIOR	
Professional Doors and Handle Design	Yes
Wave-Touch® Electronic Controls	Yes
Door Hinge Covers	Yes
Ice/Water Dispenser	Yes
Custom-Set™ Temperature Control System and Display	Yes
Crushed/Cubes/Water	Yes
Air and Water Filter Indicator/Reset	Yes
Ice Maker On/Off	Yes
Fast Freeze™	Yes
Lock/Dispenser Light Control	Yes/Yes
FRESH FOOD CONVENIENCES	
PureAdvantage® Water & Ice / Air Filtration	Yes
Water Filter Location	Bottom Left
Temp Alarm System / Door Ajar Alarm / Power Failure Alarm	Yes
Custom-Design™ Glass Shelves	3 Half Width 1 Quarter Width
Smooth-Glide® Humidity-Controlled Left Crisper	Yes
Smooth-Glide® Humidity-Controlled Right Crisper	Yes
Custom Temp Drawer™	Yes
Wine Rack	Yes
Clear Gallon Adjustable Door Bins	1
Clear 1/2-Gallon Adjustable Door Bins	1
Clear 2-Liter 1/2-Gallon Removable Door Bins	2
Locking Clear Utility Bin	Yes
Tilt-Out Can Racks	2
Theatre Ramp-Up Multilevel Lighting - LED	Yes
Automatic Ice Maker	Yes
FREEZER CONVENIENCES	
Self-Closing Drawer	Yes
Sliding Full-Width Freezer Baskets	3 Smooth-Glide® (2 with Dividers)
Plastic Basket Tray	1
Tilt-Out Wire Door Racks	1
Theatre Ramp-Up Multilevel Lighting - LED	Yes
ADDITIONAL FEATURES	
ENERGY STAR®	Yes
Sabbath Mode (Star-K® Certified)	Yes
ACCESSORIES	
Collet Kit - PN# ECK230DG*	Optional
Louvered Trim Kit - PN# 241783001*	Optional
Water Filter Replacement Cartridge - PN# EWFD1	Optional
Air Filter Replacement Cartridge - PN# EAFCBF	Optional
SPECIFICATIONS	
Overall Exterior Dimensions -	
Height (with Hinges and 3/8" Rollers)	69-1/2"
Cabinet Width/Cool Width	35-5/8"/36"
Depth (Including Handle)	29-1/2"
(with 30" Doors Open)	42-9/16"
(with Drawer Fully Extended)	44-1/2"
Power Supply Connection Location	Right Bottom Rear
Water Inlet Location	Left Bottom Rear
Voltage Rating	120V/60Hz/15 or 20A
Connected Load (kW Rating) @ 120 Volts†	1.02
Minimum Circuit Required (Amps)	15
Shipping Weight (Approx.)	348 lbs.

\*For detailed Louvered Trim Kit and Collet Kit installation instructions, refer to Product Installation Guides on the web at electroluxicon.ca.

†An electrical supply with grounded three-prong receptacle is required. The power supply circuit must be installed in accordance with current edition of National Electrical Code (NFPA 70) and local codes & ordinances.

NOTE: Always consult local and national electric and plumbing codes. Refer to Product Installation Guide for detailed installation instructions on the web at electroluxicon.ca. Specifications subject to change.

electroluxicon.ca

VENATOR HOMES  
DECOR CENTRE  
DATE: MAR 03 2016  
INITIALS: AN / RN



# French Door Refrigerator

E23BC78PS on 1/2" deep cabinet

9130-148  
Electrolux | icon

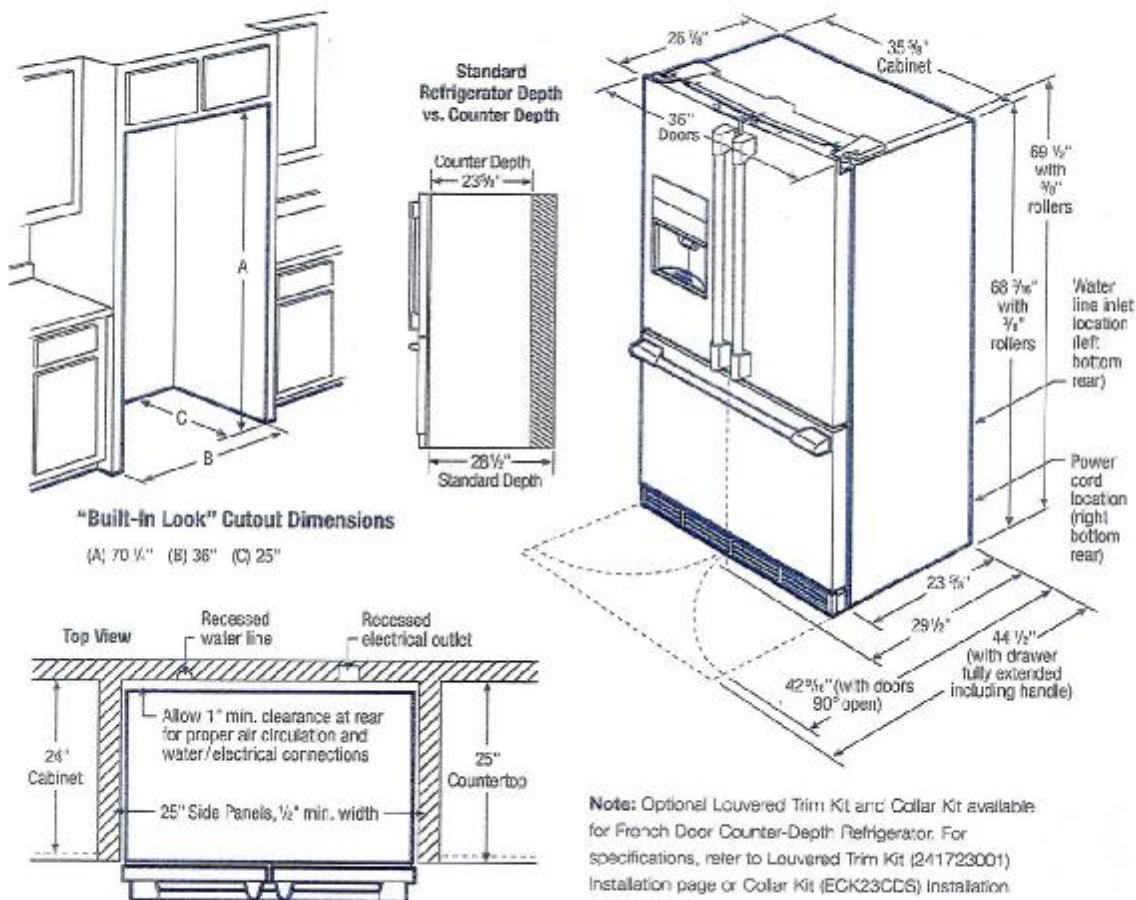

**Note:** Optional Louvered Trim Kit and Collar Kit available for French Door Counter-Depth Refrigerator. For specifications, refer to Louvered Trim Kit (241723001) Installation page or Collar Kit (ECK23CDS) Installation page on web.

## Counter-Depth French Door Refrigerator Specifications

- Product Weight – 330 Lbs.
- An electrical supply with grounded three-prong receptacle is required. The power supply circuit must be installed in accordance with current edition of National Electrical Code (NFPA 70) and local codes & ordinances.
- Voltage Rating – 120V/60Hz/15 or 20 Amps
- Connected Load (kW Rating) @ 120 Volts = 1.02 kW
- Amps @ 120 Volts = 8.5 Amps
- Always consult local and national electric & plumbing codes.
- Floor should be level surface of hard material, capable of supporting fully loaded refrigerator.
- When installing refrigerator adjacent to wall, cabinet or other appliance that extends beyond front edge of unit, 20" minimum clearance recommended to allow for optimum 120° to 180° door swing, providing complete drawer/crisper access and removal. (Absolute 4-1/2" minimum clearance will ONLY allow for 90° door swing which will provide drawer/crisper access with restricted removal.)
- To ensure optimum performance, avoid installing in direct sunlight or close proximity to range, dishwasher or other heat source.
- For proper ventilation, front grille MUST remain unobstructed.
- Recess electrical outlet when possible.
- Water recess on rear wall recommended to prevent water line damage.
- Water Pressure – Cold water line must provide between 30 and 100 pounds per square inch (psi).

- Copper tubing with 1/4" O.D. recommended for water supply line with length equal to distance from rear of unit to household water supply line plus 7 additional feet. Optional Water Supply Installation Kits available.
- Adjustable front rollers to assist with door alignment.
- If optional Collar Kit (PN# ECK23CDS) is to be used, different cutout dimensions are required. (Refer to Collar Kit ECK23CDS Installation Specifications page on web.)
- If optional Louvered Trim Kit (PN# 241723001) is to be used, different cutout dimensions are required. (Refer to Louvered Trim Kit 241723001 Installation Specifications page on web.)

## "Built-In Look" Specifications

- Minimum opening of 70-1/4"H x 36"W x 25"D required to allow for ease of installation, proper air circulation, and plumbing/electrical connections.
- Remove all wall/floor molding prior to installation.

**Note:** For planning purposes only. Refer to Product Installation Guide on the web at [electroluxicon.ca](http://electroluxicon.ca) for detailed instructions.

## Optional Accessories

- Collar Kit – (PN# ECK23CDS)
- Louvered Trim Kit – (PN# 241723001)
- PuraAdvantage® Water Filter Replacement Cartridge – (PN# EWF01)
- PuraAdvantage® Air Filter Replacement Cartridge – (PN# EAF03P)



High standards of quality at Electrolux Major Appliances, N.A. mean we are constantly working to improve our products. We reserve the right to change specifications or discontinue models without notice.

Printed in Canada

## Electrolux Major Appliances, N.A.

CANADA • 5855 Terry Fox Way • Mississauga, ON L5V 3E4 • 1-800-265-6352 • [electroluxicon.ca](http://electroluxicon.ca)

E23BC78PS 01/12

© 2012 Electrolux Major Appliances, N.A.

**SENATOR HOMES**  
**DECOR CENTRE**  
DATE: MAR 03 2016  
INITIALS: AN DW



# ELECTRIC FREESTANDING RANGE

EI30EF4CQS

Featuring IQ-Touch® Electronic Controls



## SIGNATURE FEATURES



**FRONT CONTROL DESIGN**  
Effortlessly upgrade your back-control range to built-in style. This range will easily replace traditional 30" freestanding ranges.



**PERFECT TASTE™ DUAL CONVECTION**  
For consistently delicious taste and texture, our dual-fan convection circulates air more evenly throughout the oven for an even cook. Two variable speeds work in tandem with three heating elements (bake, broil, and convection) to give you delicious results every time.

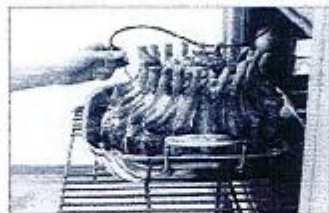

**PERFECT TASTE™ TEMP PROBE**  
The Perfect Taste™ Temp Probe lets you cook each dish to perfection. It does more than measure temperature — it alerts you when food has reached the desired temperature and automatically adjusts to the Keep Warm setting, so you never overcook your food and deliver perfect results every time.



**FLEX-2-FIT® HEATING ELEMENTS**  
Automatically expands up to three sizes, giving you precision and control with a variety of cookware.

## PRODUCT DIMENSIONS

Height	36-1/8" - 36-5/8"
Width	29-7/8"
Depth (including handle)	28-31/32"

## MORE EASY-TO-USE FEATURES

### WARMER DRAWER

Maintain the perfect temperature of your food until serving time.

### EASY-TO-CLEAN COOKTOP SURFACE

Smooth glass cooktop makes cleanup a breeze.

### A LUXURY-GLIDE® OVEN RACK

With a ball bearing system, the oven rack is so smooth it extends effortlessly so you can more easily manage the transfer of all dishes, even heavy ones.

### PLATINUM STAR® LIMITED WARRANTY

Our exclusive limited warranty that includes 3-year coverage on parts and one year on labor.\*

### CONVECTION CONVERSION

Automatically adjusts standard baking temperatures to convection temperatures, for perfect, consistent results.

### 6 COOKING MODES

Bake, Broil, Convection Bake, Convection Roast, Keep Warm and Slow Cook.

### KEEP WARM SETTING

Maintain food at the perfect serving temperature with this setting — it's a great feature when you're entertaining. Additional warming zone on cooktop allows for ultimate flexibility.

### IQ-TOUCH™ CONTROLS

The IQ-Touch™ control panel displays all of your options, at all times.

Available in:



Stainless  
(S)

ELEMENT	WATTS
8 1/2" to 12" Triple Expandable Element	1,200/2,000/3,000
2" Electric Element	2,500
6" Electric Element	1,200
8" Electric Element	1,200
Broiling Zone	100

\*Warranty does not include transportation and Electrolux Home Appliances will not cover any installation. Products must have been purchased on or after July 1, 2012. Coverage includes required parts or 2 years and labor for 1 year.

ELECTROLUXAPPLIANCES.CA

**SENATOR HOMES  
DECOR CENTRE**

DATE: \_\_\_\_\_  
INITIALS: AW RM



# ELECTRIC FREESTANDING RANGE

EI30EF4CQS

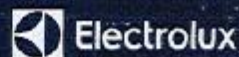

9130-148

## 30" ELECTRIC FREESTANDING RANGE

### CONTROL PANEL FEATURES

Q-Touch™ Electronic Oven Control	Yes
Professional-Grade Element Controls	Yes
Keyed Entry of Time & Temperature	Yes
Electronic Clock & Timer	Yes
Temperature Display	Yes
Automatic Oven (Delay, Cook & Off)	Yes

### COOKTOP FEATURES

Five 3-RP™ Ceramic Glass Smoothtop	1
8 to 9 to 12" Inseparable Element 1,200W/2,000W/3,000W	1
8" Electric Element 1,200W	1
6" Electric Element 1,200W	2
Warming Zone - 100W	Yes

### OVEN FEATURES

Capacity	4.8 Cu.Ft.
Broil Bake Element	Yes
Eight-Pass Bake Element - 2200 Watts	Yes
Eight-Pass Broil Element - 3000 Watts	Yes
Convection Element - 2500 Watts	Yes
Catalytic Blue Interior	Yes
Self-Clean Options with Door Lock	Yes
Periodic Taste™ Connection	Yes
Cooking Modes	6
Bake, Broil, Convection Bake, Convection Roast, Keep Warm, Slow Cook	
Baking Options	3
Temperature Probe, Delay Bake, Convection Convert	
Luxury-Design™ Lighting with Dual 40W Halogen Bulbs	Yes
Luxury-Glide™ Panels	Yes
Conventional Rack	Yes
Convection Rotating Rack	Yes

### ADDITIONAL FEATURES

Luxury-Hold™ Oven Door	Yes
Extra-Large Glass Window	Yes
Warmer Drawer	Yes
Adjustable Leveling Legs	Yes
Scratch-Nada™ (Scratch-N-Not)	Yes

### ACCESSORIES

Wear Probe	Included
Stainless Steel Backguard - P11 46233CG01	Optional

### SPECIFICATIONS

Color	Stainless Steel
Power Supply Connection Location	Right Bottom Rear
Connected Load (kW Rating) (240 / 230 Volts)	13.5 / 15.4
Amps (120V/200 Volts)	57.5 / 60
Minimum Circuit Required (Amps)	40
Shipping Weight (Approx.)	245 Lbs.

2007 Electrolux and its subsidiaries reserve the right to modify specifications without notice. Specifications subject to change.

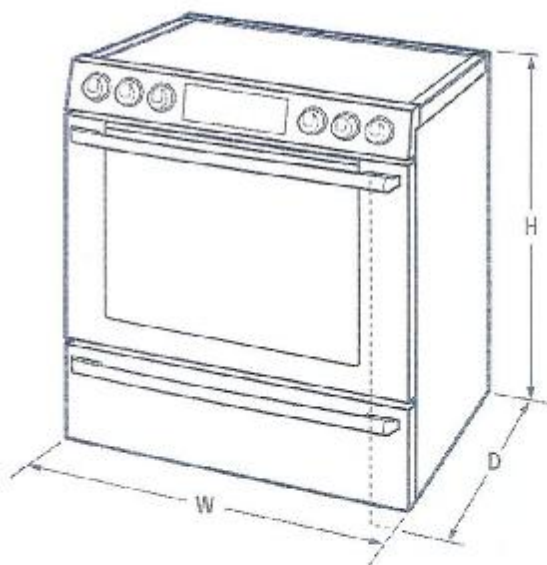

### PRODUCT DIMENSIONS

Height (approximate)	36-1/8" - 36-5/8"
Width	29-7/8"
Depth (including handle, with 90° Door Open)	28-3/8" / 32" / 46"

### OVEN CAVITY DIMENSIONS

Height	17-1/2"
Width	24-1/8"
Depth	18-3/4"

Electrolux Major Appliances, N.A.

CANADA • 5855 Terry Fox Way • Mississauga, ON L5V 3E4 • 1-800-265-8352 • [electroluxappliances.ca](http://electroluxappliances.ca)

EI30EF4CQ 10/15

© 2015 Electrolux Major Appliances, NA



High standards of quality are Electrolux's commitment. We are constantly working to improve our products. We reserve the right to change specifications or discontinue models without notice.

Printed in Canada

**SENATOR HOMES  
DECOR CENTRE**

DATE: MAR 03 2016

INITIALS: AN BN





Electrolux

ICON

9130-148

## Built-In Dishwasher

professional series

E24DB740QPS



## Signature Features

**30-Minute Fast Wash Cycle**

Quick Wash Cycle allows you to thoroughly wash dishes in half the time.

**Largest Usable Capacity**

Largest usable capacity in its class, so even your dinner party dishes fit.

**SatelliteSpray™ Arm**

An innovative rotating wash zone gives you 400% more water coverage, targeting virtually every spot in your dishwasher for a truly professional-level clean.

**Perfect Stemware™ Cycle**

Ensures your stemware comes out spotless and clean.

## PRODUCT DIMENSIONS

Height	33-3/4" - 35-3/4"
Width	23-3/4"
Depth	24-1/4"

## MORE EASY-TO-USE FEATURES

**IQ-Touch™ Controls**

For those who like to have their options always visible on their dishwasher, the IQ-Touch™ control panel displays all of your options, at all times.

**Easy-Lift Adjustable Racks**

Versatile racking system easily adjusts to provide the perfect place for all your dishware — no pinching, pulling, or flogging required.

**Auto Wash Feature**

A Smart Soil Sensor technology that determines how long the wash cycle should run, for a more effective operation.

**AquaLux™ Wash System**

A unique washing system that uses alternating wash arms, for a quieter and more efficient operation.

**Luxury Soft Grip Racks**

Luxury Soft Grip Racks hold plastic and dishware in place, and prevent tipping, for a more thorough clean.

**Perfect Stemware™ Grips**

Six flexible grips gently hold stemware and other delicate items for a secure wash, every time.

**Luxury-Glide® Racks**

With our Luxury-Glide® technology, upper and lower racks are so smooth they extend effortlessly.

**Sure-2-Fit® Racking System**

The most versatile and adjustable racking system — there's a perfect place for over 180 items, from chopsticks to stockpots to stemware. In its lowest position, you can fit 10" dinner plates in the top rack and 12" dinner plates in the bottom.

**More Cycles**

With up to ten cycles — including Heavy, Normal, Fast Wash, Auto, Upper Rack Only, Eco Wash, Stemware, Rinse Only, Delicate, and "My Favourite" — you can choose the perfect wash for any occasion.

**"My Favourite" Settings**

A programmable setting that lets you customize the wash for your unique cleanup needs.

electroluxicon.ca

SENATOR HOMES  
DECOR CENTRE

DATE:

INITIALS:

MAY 03 2016

AN BN



# Built-In Dishwasher

E24ID74QPS, 2015 Series



Electrolux ICON

9130-148

## BUILT-IN DISHWASHER

### FEATURES

Stainless Steel Interior	Yes
LuxuryFold™ Door	Yes
Custom-Set™ Option	Yes
Theatre LED Lighting	Yes
PowerSeed™ Wash Controls	Yes
LED Indicator Lights	Yes
Tall-Tube Design	Yes
ProClean™ Wash System	Yes
Total NoSpray™ Arms	Yes
Luxury-Clean™ Technology	Yes
Luxury-Clean™ Sound Package (Approx. dBA)	Yes/43.0
Wash Levels	5
AquaLock™ Wash System	Yes
Catch-Collection System	Yes
Adjustable Rinse Aid Dispenser with Indicator	Yes
ENERGY STAR®	Yes

### CYCLES

AutoWash	Yes
Delicate	Yes
Even Wash	Yes
Heavy	Yes
Normal	Yes
Perfect Steam™	Yes
30-Min. Fast Wash	Yes
Rinse-Only	Yes
Triple Rinse	Yes

### OPTIONS

Air-Dry	Yes
NSF® Certified Sanitation Option	Yes
Delay Start	30 Min. - 24 Hrs.

### RACK SYSTEM

Surge-2-Rite™ Rack System	Yes
Upper Rack	
Adjustable Height	Yes
Cup Cages	4
Cup Shelf/Silverware Holder	2/Yes
Fold-Down Rins	4 Folds
Rack Handle	Yes
VaraTray™	Yes
Lower Rack	
Fold-Down Trays	6 Folds
Knife Holder	Yes
Utility Tray/Shell	Yes
Silverware/Chargeware Glass Holders	4
Silverware Basket	3-Piece Split
Special Items Cover/Wash Shield/Bamie Bag	Full Set

### SPECIFICATIONS

Water Supply Connection Location	Right Bottom Front
Water Inlet Location	Left Bottom Front
Leakage Test	Yes
Water Usage (Gallons) - Normal Cycle	4.0 - 8.0
Water Pressure (PSI)	15 - 120
Integral Air Gap on Supply	Yes
Voltage Rating	120V/60Hz
Connected Load (kW) Rating @ 120 Volts	1.44
Amp @ 120 Volts	9.0
Shipping Weight (Approx.)	115 Lbs.

Always use proper wiring when connecting to a dedicated branch circuit. Always use proper wiring when connecting to a dedicated branch circuit. Always use proper wiring when connecting to a dedicated branch circuit. Always use proper wiring when connecting to a dedicated branch circuit.

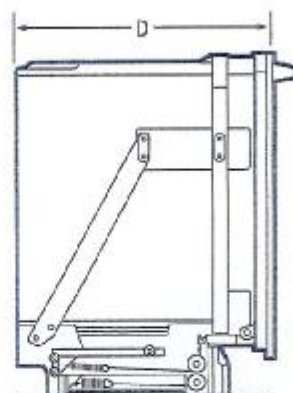
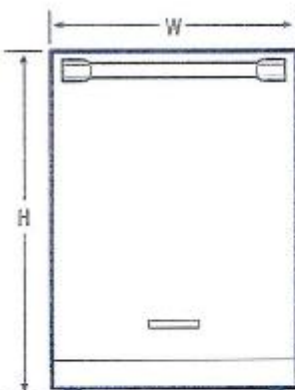

### PRODUCT DIMENSIONS

Height (Adjustable)	33-3/4" - 35-3/4"
Width	23-5/4"
Depth (Including Control Rail) (Closed 90° Open)	24-1/4" / 20-1/4"

## Electrolux Major Appliances, N.A.

CANADA • 5855 Terry Fox Way • Mississauga, ON L5V 3E4 • 1-800-265-6352 • [electroluxicon.ca](http://electroluxicon.ca)

E24ID74QPS 03/15

© 2015 Electrolux Major Appliances, N.A.

Printed in Canada



Electrolux is a leader in quality and innovation. We are committed to providing the highest quality products and services to our customers. We are committed to providing the highest quality products and services to our customers. We are committed to providing the highest quality products and services to our customers.

**SENATOR HOMES  
DECOR CENTRE**

DATE: MAR 03 2016

INITIALS: AW RN



9130-148

**SENATOR HOMES**  
DECOR CENTRE

**Pre-Installation (continued)**

DATE: MAR 14 2016

INITIALS: AA

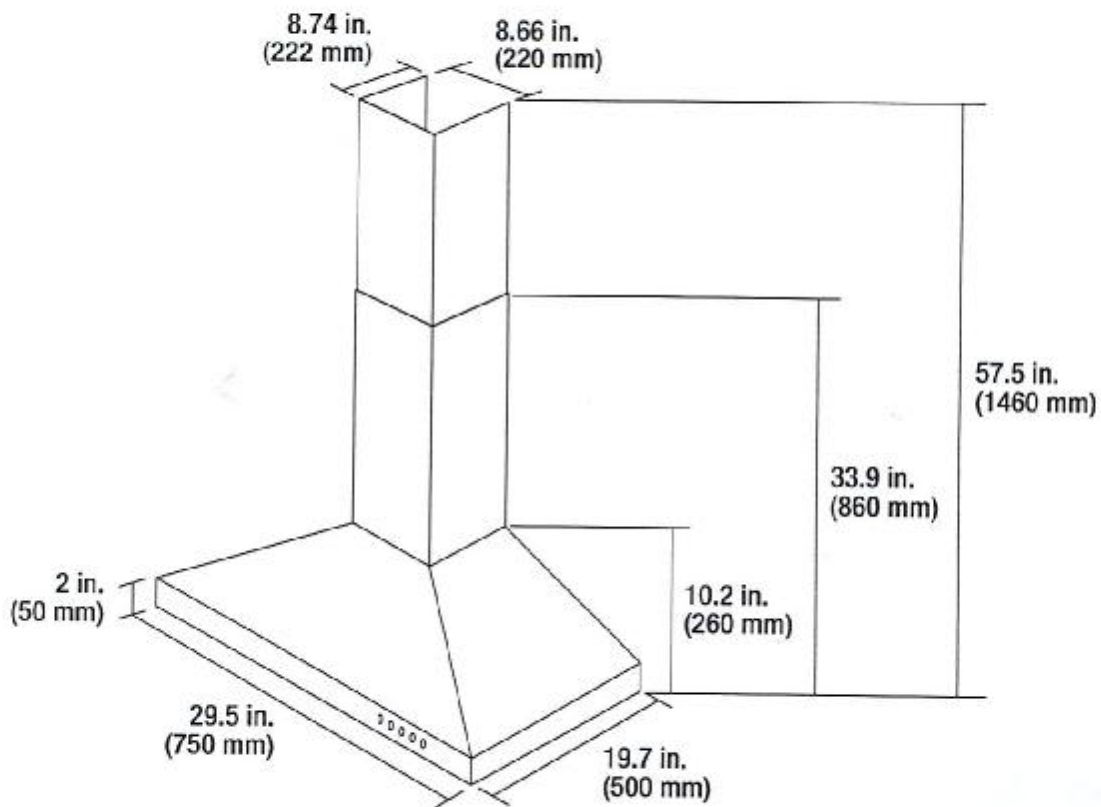

Specifications

SENATOR HOMES  
DECOR CENTRE

DATE: MAR 14/2016  
INITIALS: *AN*

Dimensions

Assembled Depth (in inches)	
24.02	
Assembled Height (in inches)	
13.58	
Assembled Weight (In LBS)	
36.52	
Assembled Width (in inches)	
32.09	
Item Depth	
24.02	
Item Height	
13.58	
Item Weight	
36.52	
Item Width	
32.09	

9130-148

Details

CSA Certified	
Yes	
Country of Origin	
CN-China	

\* add'l elec. - Declined.  
by Purchaser



9130-148

SENATOR HOMES  
DECOR CENTRE

DATE: MAR 14 2016

INITIALS: *AA*

## Pre-Installation (continued)

### PLANNING INSTALLATION

#### NOTE:

Do not remove the plastic covering on the chimney set at this time, as it protects the chimney set from scratches during installation.

#### Number of people required: 2 or more

Carefully check the range hood for damage and for missing parts prior to installation. If there is any damage or if you are missing parts, do not proceed with the installation. Report damage and missing parts immediately. Do not dispose of packaging before you are satisfied with your new range hood.

1. Choose a location for your range hood. The range hood location should be away from strong draft areas, such as windows, doors, and strong heating vents.
2. Measure all distances to ensure the proper position of the range hood (A) and chimney set (B, C).
  - The size of the range hood installation location must have a width (1) of at least 29.5 in. (750 mm) and a depth (2) of at least 19.7 in. (500 mm) deep (2) to accommodate the size of the range hood (A).
  - The minimum distance (3) from the cooking surface to the range hood is 18 in. (458 mm) for electric ranges, and 29.5 in. (750 mm) for gas ranges. If your gas range specifies a different distance, use the greater distance of the two. To get the best performance, this distance should range from 18 in.–29.5 in. (458 mm–750 mm).
3. Toggle bolts are provided to secure the hood to most wall types. However, a qualified technician must verify suitability of the bolts, screws and drywall anchors for your wall type.
4. Due to the size and weight of this range hood, the supports must be firmly attached to the wall. For plaster or sheet rock walls, the support must be attached to the studs. If this is not possible, a support structure must be built behind the plaster or sheet rock.
5. Put a thick, protective covering over your counter, cooktop, or range to protect it from damage and dirt during installation. Remove any hazardous objects around the area.



**WARNING:** Always wear safety goggles and gloves during installation.

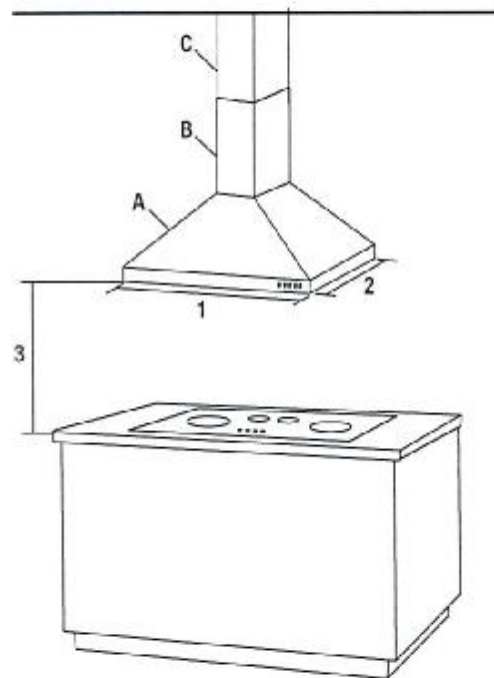

## Pre-Installation (continued)

6. Adjust old duct work or install new duct work, as necessary, by following these guidelines:

- Your venting system must vent to the outdoors either horizontally through the back wall (4) or vertically through the roof (5).
- A straight, short duct run will allow the hood to perform most efficiently. Long duct runs with elbows and transitions will reduce the performance of the range hood. Use as few of them as possible.
- Use round metal duct work with a uniform diameter of 6 in. (152 mm). Larger ducting may be required for best performance with longer duct runs.
- Before making cuts, make sure there is proper clearance within the ceiling or wall for the exhaust vent.
- Fasten all connections between pieces of duct with sheet metal screws and tape all joints with certified duct tape.
- Cap the exterior of the duct with a wall cap (6) or roof cap (7).

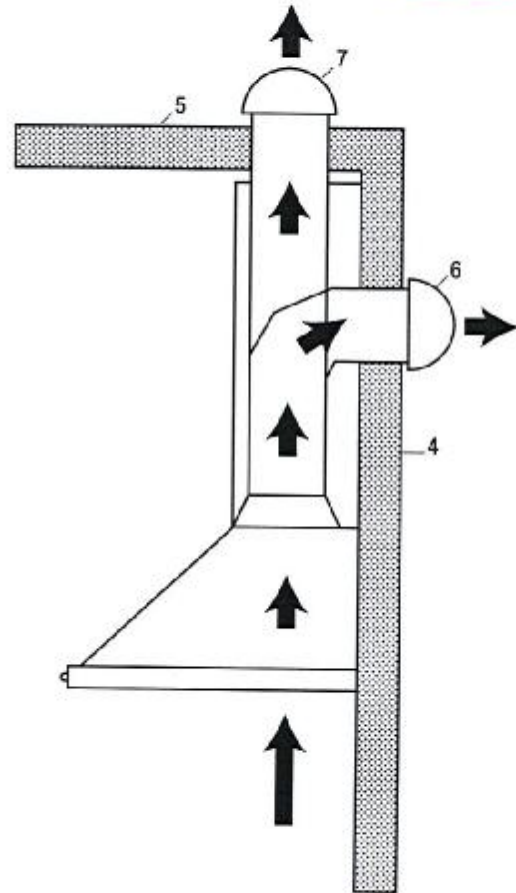

9130-148

SENATOR HOMES  
DECOR CENTRE

DATE: MAR 14 2016

INITIALS: AW



9130-148

SENATOR HOMES  
DECOR CENTRE

## Pre-Installation (continued)

DATE: MAR 14 2015INITIALS: AN

### WIRING CONNECTION REQUIREMENTS

Installation work and electrical wiring must be done by a qualified person(s) in accordance with all applicable codes and standards, including fire-rated construction.

#### OBSERVE ALL GOVERNING CODES AND ORDINANCES WARNINGS

- Electrical grounding is required for this range hood. Check with a qualified electrician if you are not sure whether the range hood is properly grounded.
- Failure to follow electrical requirements may result in a fire.
- A fuse in the neutral or grounding circuit could result in electrical shock.
- If the hot/cold water pipe is interrupted by plastic nonmetallic gaskets or other materials, DO NOT use for grounding.
- DO NOT GROUND TO A GAS PIPE.

**IMPORTANT:** It is the customer's responsibility to contact a qualified electrical installer and assure that the electrical installation is adequate and complies with the National Electrical Code, or CSA standards, as well as all local codes and ordinances.

1. Save installation instructions for electrical inspector's use.
2. If codes permit and a separate ground wire is used, it is recommended that a qualified electrician determine if the ground path is adequate.
3. DO NOT use an extension cord or adapter plug with this appliance.
4. The range hood must be connected with copper wire only.
5. The range hood should be connected directly to the junction (or circuit breaker) box through flexible, armoured or nonmetallic sheathed copper cable. Allow some slack in the cable so the appliance can be moved if servicing is ever necessary.
6. A UL listed or CSA approved conduit connector must be provided at each end of the power supply cable (at the range hood and at the junction box).
7. When making the electrical connection, cut a 3.2 cm (1-1/4 in. hole in the wall. A hole cut through wood must be sanded until smooth. A hole through metal must have a grommet.
8. When cutting or drilling into the wall or ceiling, do not damage electrical wiring and other hidden utilities.
9. Wire size must conform to all local codes and ordinances. The latest edition requirements of the National Electrical Code ANSI/NFPA 70, or the latest edition CSA Standards C22.1-94, Canadian Electrical Code Part 1 and C22.2 No. 0-M91.



**DANGER:** Risk of electrical shock. This range hood must be properly grounded.



**DANGER:** Turn off the power circuit breaker or the power switch on the junction box before installing this unit. Touching circuitry inside the range hood while it is energized will result in death or serious injury.



**DANGER:** All electrical wiring must be properly installed, insulated, and grounded. Improper insulation and grounding will result in deadly electrical shock.

#### NOTE:

Temporarily wire the range hood to test it for proper operation. If the range hood does not operate correctly, do not proceed with the installation.

- Cut a 1 1/4 in. (31.75 cm) diameter hole in an appropriate location in the wall for the electrical connection. A hole cut through wood must be sanded until smooth. A hole through metal must have a grommet.
- Connect the range hood (A) directly to the junction box or circuit breaker box with a flexible, armoured, or nonmetallic sheathed copper cable. Allow some slack in the cable so the appliance can be moved if servicing is ever necessary.
- Connect a UL-listed or CSA-approved conduit connector to each end of the power supply cable (at the range hood and at the junction box).
- Connect the three colored wires (6) from the range hood (A) to the corresponding wires (7) from the electrical source: black to black (live), white to white (neutral), and green to green/yellow (ground). Cap wires with wire connectors.
- Turn the power on, and ensure that all lights and fans are operating correctly.
- Once you have tested the electrical connection, disconnect the power supply cable and wires from the electrical source before proceeding with the rest of the installation.

