



CONSTRUCTION SUMMARY

Teefy Developments Limited / 9130 Bathurst

Lot/Unit: 147 Phase/Building: 1 Model/Floor Plan: Riverdale(22-3)

CABINETRY ACCESSORIES

Inv.3453	3 - KITCHEN - SUPPLY AND INSTALL FACIA PANEL ABOVE KITCHEN UPPERS - PRICE IS PER 8FT PIECE	
Line 45379	Note:	
5Jan16 / 26Feb16		
Inv.3453	3 - KITCHEN - SUPPLY AND INSTALL LIGHT VALANCE - NOT APPLICABLE FOR THERMOVISION - PRICE PER 8 FOOT LENGTH	
Line 45387	Note:	
5Jan16 / 26Feb16		

CABINETRY APPLIANCE - FRIDGE

Inv.3453	1 - KITCHEN - SUPPLY AND INSTALL 59 CM DEEP FRIDGE UPPER CABINETS WITH 1 GABLE	
Line 45383	Note:	
5Jan16 / 26Feb16		

CABINETRY BASE CABINETS

Inv.3453	1 - KITCHEN SERVERY - ACCOMMODATE BASE CABINETS FOR FUTURE WINE FRIDGE PURCHASER HAS SUPPLIED SPECS	
	- 33.46 H x 22.44 D x 14.96 W	
Line 45374	Note:	
5Jan16 / 26Feb16		
Inv.3453	2 - TOP DRAWER PRICE PER DRAWER	
	- X1 IN SERVERY AS INDICATED ON KITCHEN SKETCH	
	- X1 IN KITCHEN AREA AS PER THE ATTACHED SKETCH	
Line 45376	Note:	
5Jan16 / 26Feb16		
Inv.3453	1 - KITCHEN - POTS & PANS DRAWER - MINIMUM 60 CM - MAXIMUM 90 CM - SIZE SUBJECT TO FLOOR PLAN	
Line 45384	Note:	
5Jan16 / 26Feb16		

CABINETRY HARDWARE

Inv.3453	1 - KITCHEN - CABINET HARDWARE - UPGRADE 2 - DISPLAY BOARD	
Line 45394	Note:	
5Jan16 / 26Feb16		

CABINETRY HOOD FANS

Inv.3453	1 - KITCHEN - ACCOMMODATE FOR MICROWAVE HOOD FAN COMBO - PURCHASER MUST SUPPLY SPECS	
Line 45385	Note:	
5Jan16 / 26Feb16		

CABINETRY UPPERS

Inv.3453	1 - KITCHEN - SUPPLY AND INSTALL 120CM EXTENDED KITCHEN UPPERS IN LIEU OF THE STD 100CM	
Line 45378	Note:	
5Jan16 / 26Feb16		



CONSTRUCTION SUMMARY

Teefy Developments Limited / 9130 Bathurst

Lot/Unit: 147 Phase/Building: 1 Model/Floor Plan: Riverdale(22-3)

CABINETRY VANITY

Inv.3453	1 - MASTER ENSUITE - VANITY BANK OF DRAWERS - 55 CM MAXIMUM	
Line 45392	Note:	
5Jan16 / 26Feb16		

CABINETRY WALL AND HUTCH

Inv.3453	1 - GLASS DOOR CLEAR - WHITE CABINET INTERIOR - STANDARD LINE	
Line 45382	Note:	
5Jan16 / 26Feb16		

ELECTRICAL

Inv.3453	1 - MASTER ENSUITE - ELECTRICAL - DOUBLE HEAT LAMP - LOCATION SKETCH ATTACHED	
Line 45373	Note:	
5Jan16 / 26Feb16		
Inv.3453	1 - SUPPLY AND INSTALL ADDITIONAL INTERIOR RECEPTACLE ON SEPARATE CIRCUIT (IE: MICROWAVE, FREEZER) -X 1 IN SERVERY BASE CABINET WINE FRIDGE LOCATION	
Line 45375	Note:	
5Jan16 / 26Feb16		
Inv.3453	4 - RELOCATE STANDARD CEILING LIGHT FIXTURE & SWITCH -X1 KITCHEN FIXTURE RELOCATED CENTERED ABOVE ISLAND -X1 FAMILY ROOM FIXTURE RELOCATED TO CENTER OF SERVERY -X1 FORMAL ROOM FIXTURE TO BE RELOCATED OUTSIDE OF POWDER ROOM	
Line 45380	Note: -X1 GARAGE RELOCATED CENTERED ABOVE REAR HALF OF TANDEM	
5Jan16 / 26Feb16		
Inv.3453	2 - SUPPLY AND INSTALL ADDITIONAL RG6 OUTLET ROUGH-IN ONLY	
Line 45381	Note:	
5Jan16 / 26Feb16		
Inv.3453	1 - SUPPLY AND INSTALL ADDITIONAL INTERIOR RECEPTACLE ON SEPARATE CIRCUIT FOR FUTURE MICROWAVE OVER THE RANGE (OTR)	
Line 45386	Note:	
5Jan16 / 26Feb16		
Inv.3453	1 - KITCHEN - SUPPLY AND INSTALL LIGHT VALANCE ROUGH IN (INCLUDES 1 SWITCH)	
Line 45388	Note: LOCATION AS PER SKETCH ATTACHED.	
5Jan16 / 26Feb16		
Inv.3453	23 - ELECTRICAL - MINI LOW VOLTAGE HALOGEN POT LIGHT - 1ST FLOOR - LOCATION SKETCH ATTACHED - X5 IN KITCHEN FOR POTLIGHTS - X6 IN FAMILY ROOM FOR POTLIGHTS - X12 IN FORMAL ROOM FOR POTLIGHTS	
Line 45390	Note:	
5Jan16 / 26Feb16		
Inv.3453	4 - SUPPLY AND INSTALL ADDITIONAL INTERIOR SINGLE POLE SWITCH - X1 IN KITCHEN FOR POTLIGHTS - X1 IN FAMILY ROOM FOR POTLIGHTS - X2 IN FORMAL ROOM FOR POTLIGHTS	
Line 45391	Note:	
5Jan16 / 26Feb16		



CONSTRUCTION SUMMARY

Teefy Developments Limited / 9130 Bathurst

Lot/Unit: 147 Phase/Building: 1 Model/Floor Plan: Riverdale(22-3)

Inv.3453	1 - FAMILY ROOM - SUPPLY AND INSTALL ADDITIONAL INTERIOR RECEPTACLE (NOT SEPARATE CIRCUIT) - X1 O BE INSTALLED CENTERED ABOVE FIREPLACE NEXT TO T.V AND DATA OUTLET APPX 5' 5" FROM THR FLOOR TO ACCOMMODATE FOR FUTURE WALL HUNG T.V	
Line 45393	Note:	
5Jan16 / 26Feb16		

FIREPLACE

Inv.3453	1 - FAMILY ROOM - FIREPLACE TO BE LOWERED AND BASE TO BE APPROX. 18" FROM THE FLOOR	
Line 45377	Note:	
5Jan16 / 26Feb16		

HARDWOOD

Inv.3453	1 - SUPPLY AND INSTALL HARDWOOD - UPGRADE 1 - SATIN FINISH GEN. - HOME OAK 3 5/8 INCH X 3/4 INCH - STAIN - - MASTER BEDROOM -INCLUDED IN A.P.S	
Line 45367	Note:	
5Jan16 / 26Feb16		
Inv.3453	1 - SUPPLY AND INSTALL HARDWOOD - UPGRADE 1 - SATIN FINISH GEN. - HOME OAK 3 5/8 INCH X 3/4 INCH - STAIN - - BEDROOM 2 -INCLUDED IN A.P.S	
Line 45368	Note:	
5Jan16 / 26Feb16		
Inv.3453	1 - SUPPLY AND INSTALL HARDWOOD - UPGRADE 1 - SATIN FINISH GEN. - HOME OAK 3 5/8 INCH X 3/4 INCH - STAIN - - BEDROOM 3 -INCLUDED IN A.P.S	
Line 45369	Note:	
5Jan16 / 26Feb16		

HEATING AND AIR CONDITIONING

Inv.3453	1 - HVAC - SUPPLY AND INSTALL POWER HUMIDIFIER - LENNOX WB 217	
Line 45370	Note:	
5Jan16 / 26Feb16		
Inv.3453	1 - HVAC - SUPPLY AND INSTALL HEPA FILTER HC 16	
Line 45371	Note:	
5Jan16 / 26Feb16		

MISCELLANEOUS

PLUMBING

Inv.3453	1 - KITCHEN - SUPPLY AND INSTALL WATERLINE ROUGH-IN TO THE FRIDGE LOCATION (NO HOOK UP)	
Line 45389	Note:	
5Jan16 / 26Feb16		



CONSTRUCTION SUMMARY

Teefy Developments Limited / 9130 Bathurst

Lot/Unit: 147 Phase/Building: 1 Model/Floor Plan: Riverdale(22-3)

EXTRAS AS PER OFFER

Stainless Steel Fridge, Stove and Dishwasher and front loading washer and dryer in white from Vendors standard samples, no cash value, not transferable. (Supplied only not installed) ** to - arrange delivery call: The Brick commercial sales division at <i>Worksheet Note:</i>	
Rogers Free Services Package includes 6 months of: home phone, TV and Internet Service. <i>Worksheet Note:</i>	
Vendor agrees to supply and install optional tandem car garage as per standard sketch. \$20,000 has been added to the purchase price for this option. <i>Worksheet Note:</i>	
Vendor agrees to supply and install hardwood flooring in all upper level bedrooms from vendors standard samples. <i>Worksheet Note:</i>	

This Document is Extremely Time Sensitive - Printed 29 Mar 16 at 9:05

Page 4 of 4



INTERIOR COLOUR SCHEME

Purchasers: Janice C Ross & Neil B Applebaum

Property: 147 of Plan -

Telephone Res. / Bus: (416) 931-7582 /

Project: Teefy Developments Limited

Decor Advisor: Nicole Soares

Model and Elevation: Riverdale(22-3)

Layout Changes: ☒ Yes ☐ NoSketch Attached: ☒ Yes ☐ No

Exterior Colour Scheme:

1. Cabinetry

	Style and Colour	Counter Top	Hardware
Kitchen / Breakfast	BOSTON PAINT: MACADEMIA	9141 ICE SNOW - SQ EDGE	*12829
Kitchen Island	BOSTON PAINT: MACADEMIA	9141 ICE SNOW - SQ EDGE	*12829
Laundry Room	WESTBROOK PAINT: WINTER WHITE	N/A	9677
Powder Room	MANCHESTER MAPLE: SHALE GREY	INUKSHUK TAUPE P-345-LM	9677
Main Bathroom	MANCHESTER MAPLE: SHALE GREY	INUKSHUK CARBON P-346-LM	9677
Master Ensuite Bathroom	MANCHESTER MAPLE: OYSTER	BRUNE SLATE 1763-60	9677
Second Ensuite Bathroom (If Applicable)			

Appliances

Custom Size Fridge

☐ Yes ☒ No

Valance Lighting

☒ Yes ☐ No

Microwave / Range Hood

☒ Yes ☐ No

Cooktop / Rangetop

☐ Yes ☒ No

Built in Wall Oven

☐ Yes ☒ No

Slide-in Range

☒ Yes ☐ No

Comment

2. Flooring

	Selection
Foyer	NEW REEDS 13x13: SILVER
Main Hall	
Back Hall	
Breakfast	
Laundry Room	LILY 12x12: WHITE
Kitchen	SATIN FINISH GEN. HOME 3 5/8" x 3/4" ENG. HARDWOOD: COBALT
Powder Room	VENINA 12x12: BLACK
Main Bathroom	NEW REEDS 13x13: BROWN
Master Ensuite Bathroom (If Applicable)	VENUS 13x13: BROWN / SHOWER FLR TILE- *QUEBEC 2x2 UNGLAZED MOSAIC: ARCTIC WHT FS
Mud Room	NEW REEDS 13x13: SILVER
Formal Room	SATIN FINISH GEN. HOME 3 5/8" x 3/4" ENG. HARDWOOD: COBALT
Living Room	
Dining Room	
Family / Great Room	SATIN FINISH GEN. HOME 3 5/8" x 3/4" ENG. HARDWOOD: COBALT
Den / Library / Study	PAPILIO: MAPLE SEASON 79497
Basement Landing (If Applies)	
Lower Landing (If Applicable)	
Upper Landing	SATIN FINISH GEN. HOME 3 5/8" x 3/4" ENG. HARDWOOD: COBALT
Upper Hall	SATIN FINISH GEN. HOME 3 5/8" x 3/4" ENG. HARDWOOD: COBALT
Master Bedroom	*SATIN FINISH GEN. HOME 3 5/8" x 3/4" ENG. HARDWOOD: COBALT
Bedroom #2	*SATIN FINISH GEN. HOME 3 5/8" x 3/4" ENG. HARDWOOD: COBALT
Bedroom #3	*SATIN FINISH GEN. HOME 3 5/8" x 3/4" ENG. HARDWOOD: COBALT
Bedroom #4	
Bedroom #5	
Recreation Room	PAPILIO: MAPLE SEASON 79497

Flooring Continued on Page 2

Initial:

Page 1 of 3



INTERIOR COLOUR SCHEME

Purchasers: Janice C Ross & Neil B Applebaum

Property: 147 of Plan -

Telephone Res. / Bus: (416) 931-7582 /

Project: Teefy Developments Limited

Decor Advisor: Nicole Soares

Model and Elevation: Riverdale(22-3)

2. Flooring - Continued -

Upgrade Underpad	Type	Area
	STANDARD	RECREATION ROOM & DEN
Carpet on Stairs	Capped	Runner - *Upgrade
Comment		

3. Plumbing Fixtures / Faucets

Kitchen	STD	Second Ensuite	STD	Powder Room	STD
Master Ensuite	STD			Other Room	
Main Bathroom	STD				
Comment					

4. Wall Tile

	Tile Selection	Listello	Insert	Insert Selection
Main Bathroom	SPLENDOUR 8x10: WHITE	<input type="checkbox"/>	<input type="checkbox"/>	
Master Ensuite				
Tub Deck		<input type="checkbox"/>	<input type="checkbox"/>	
Tub Apron		<input type="checkbox"/>	<input type="checkbox"/>	
Tub Surround		<input type="checkbox"/>	<input type="checkbox"/>	
Shower Stall		<input type="checkbox"/>	<input type="checkbox"/>	
Second Ensuite	VENUS 8x10: BROWN	<input type="checkbox"/>	<input type="checkbox"/>	
		<input type="checkbox"/>	<input type="checkbox"/>	
		<input type="checkbox"/>	<input type="checkbox"/>	
Kitchen Backsplash		<input type="checkbox"/>	<input type="checkbox"/>	
Complete Backsplash		<input type="checkbox"/>	<input type="checkbox"/>	
Comment				

5. Fireplace

	Living Room			Family Room			Other Room - Specify		
	Purchased	As Per Plan	N/A	Purchased	As Per Plan	N/A	Purchased	As Per Plan	N/A
Fireplace Type	<input type="radio"/>	<input type="radio"/>	<input type="radio"/>	<input type="radio"/>	<input checked="" type="radio"/>	<input type="radio"/>	<input type="radio"/>	<input type="radio"/>	<input type="radio"/>
Mantle Type				STD 50" ELECTRIC LINEAR					
Over Mantle									
Colour / Stain									
Surround				STANDARD					
Hearth									
Comment									

Initial:

Page 2 of 3



INTERIOR COLOUR SCHEME

Purchasers: Janice C Ross & Neil B Applebaum
Telephone Res. / Bus: (416) 931-7582 /
Decor Advisor: Nicole Soares

Property: 147 of Plan -
Project: Teefy Developments Limited
Model and Elevation: Riverdale(22-3)

6. Trim Carpentry

Door Hardware STANDARD

Interior Trim STANDARD BASEBOARD AND CASING

Comment

Interior Doors

☐ 2 Panel Arch Top

☒ 2 Panel Square Top

☐ 6 Panel



Initial for Door Style

[Handwritten signature]

7. Railings and Pickets

Railing Package STANDARD PLAIN PICKETS, SQUARE POST AND HANDRAIL

Railing Colour STAINED

Picket Colour FLAT BLACK METAL

Wood Stairs ☐ No ☒ Oak

Tread Colour STAINED

Comment

STAIRS TO BE STAINED TO MATCH SATIN FINISH GEN. HOME 3 5/8" x 3/4" ENG. HARDWOOD: COBALT AS MUCH AS POSSIBLE *** PURCHASER IS AWARE THAT THE STAIN WILL NOT BE A 100% TRUE MATCH, AS STAIRS ARE STAINED ON SITE

8. Plaster Mouldings and Medallions

Foyer

Main Hall

Living Room

Dining Room

Family Room

Kitchen/Breakfast

Den/Library

Lower Landing

Comment

9. Wall Paint

SENATOR WHITE

Smooth Ceilings ☐ First Floor

☐ First Floor incl. Second Floor Hall

☐ First and Second Floor

☒ Throughout

☐ Not Applicable

Trim Paint STANDARD

10. Additional Comments

11. Disclaimers and Notes

- Colours of all materials are as close as possible to builder's selection, but not necessarily identical due to variances in manufacturing.
- Any extras listed above are null and void unless accompanied by a separate invoice/amendment. Said invoice must be paid in full.
- The Purchaser acknowledges that after Interior Colour Selection form is signed and dated, no further changes will be permitted other than re-selection due to unavailability. *[Handwritten initials]* Purchaser's Initials
- The Purchaser acknowledges reading and accepting the "Senator Homes Décor Centre Disclaimers" form. This document contains other miscellaneous disclaimers.

This Interior Colour Selection is final and approved by:

Purchaser:

Signature:

Date:

FEB 26 2016

FEB 26 2016

Signature:

Date:

Vendor:

Teefy Developments Limited

Lot 147

FRIDGE COLD WATER
LINE (ROUGH-IN) —
Ø OUTLET FOR FUTURE
MISC. OTR.

- CAPPED CEILING
FIXTURE (RELOCATE
STD)
- POTLIGHTS.

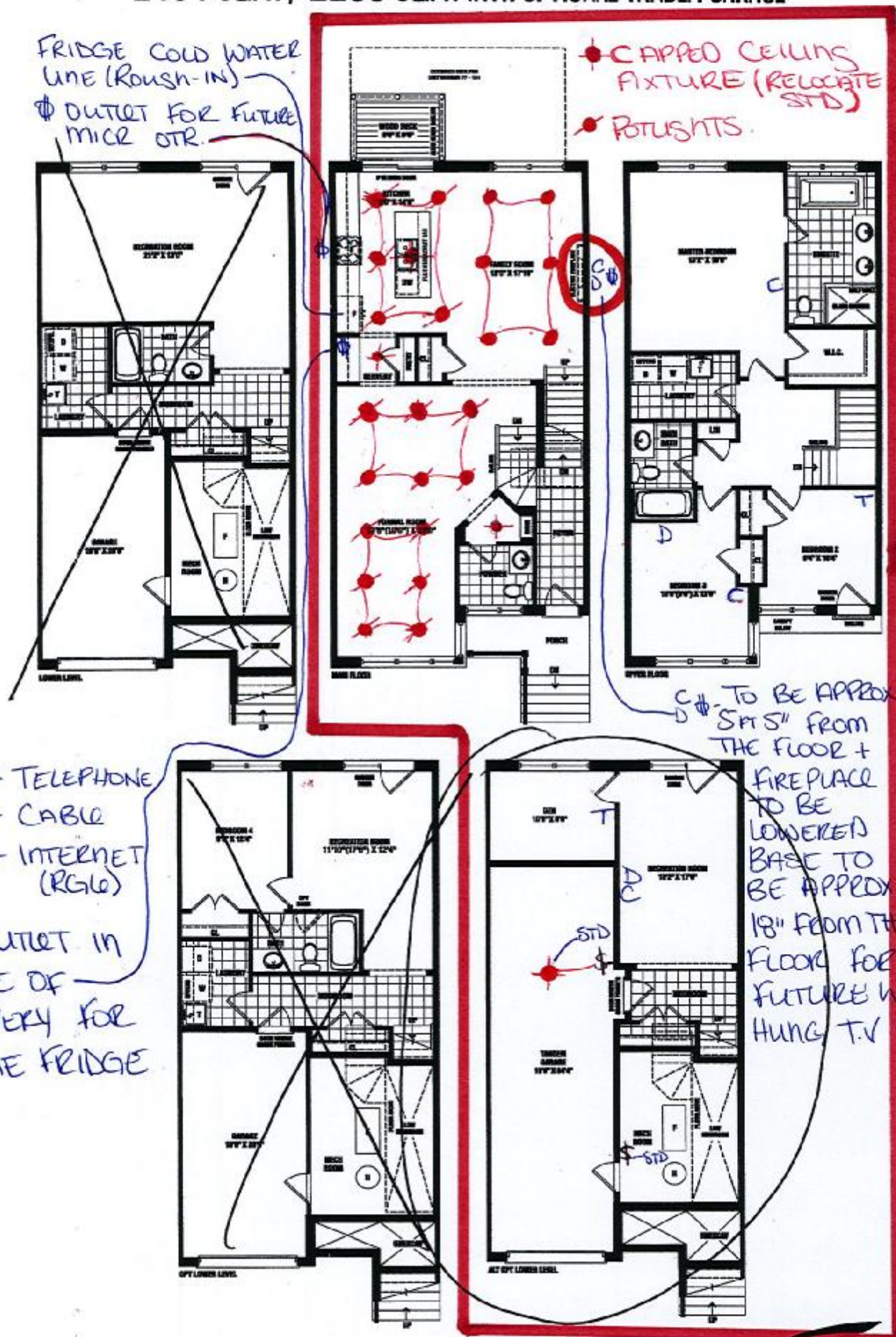

T- TELEPHONE
C- CABLE
D- INTERNET (RG6)
\$ OUTLET IN
BASE OF
SERVERY FOR
WINE FRIDGE

C# - TO BE APPROX
18" FROM
THE FLOOR +
FIREPLACE
TO BE
LOWERED
BASE TO
BE APPROX
18" FROM THE
FLOOR FOR
FUTURE WALL
HUNG T.V

SENATOR HOMES
DECOR CENTRE

DATE: _____

FEB 26 2016

INITIALS:

Rancierings are artist's concept. Some elevations may vary from that shown. Actual useable square footage may vary from that stated herein. Some floorplans and elevations are mirror image to that shown. E&O.E. 22-3

SENATOR

RIVERDALE - TH-22-3

STD. LAYOUT

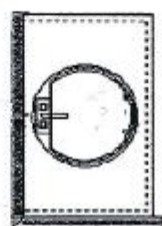

BATH (LOWER LEVEL) ELEV A



MAIN BATH (UPPER LEVEL) ELEV A

Vanity Bank OF DRAWERS

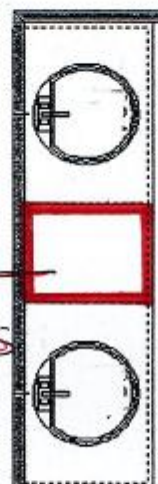

-ENSUITE (UPPER FLOOR) ELEV A HALF WALL

SENATOR HOMES - TEEFY



120 cm UPPERS WITH FACIA PANEL

UPG HARDWARE IN KITCHEN - 12829

POTS AND PANS DRAWERS

ACCOMMODATE FOR MICRO OVER THE RANGE

TOP DRAWER

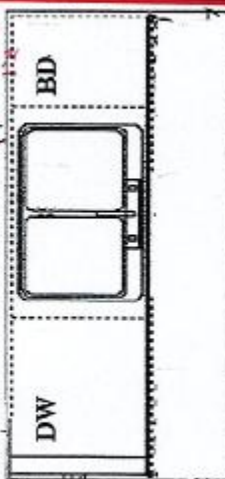

54cm DEEP FRIDGE UPPER CABINETS WITH 1 GABLE

WINE FRIDGE ACCOMMODATIONS

33.46 H
22.44 D
14.96 W

SERVERY

TOP DRAWER

CLEAR GLASS DOOR WITH MATCHING INTERIOR

WALK IN PANTRY NOT INCLUDED

OPT. CROWN (X3)

OPT. LIGHT VALANCE (X2)

-KITCHEN (MAIN FLOOR) ELEV A
-ALT 1 ELEV A

OPTIONAL CABINETRY (STANDARD ELEVATION)



NO WALL CABINET OVER TUB AS PER ARCHITECTURALS

OPT. LAUNDRY UPPERS (LOWER LEVEL) ELEV A
(BASE CABINETRY NOT REFLECTED ON DWGS)

SENATOR HOMES DECOR CENTRE

DATE: FEB 26 2015

INITIALS:

FEB 26 2015

9130-147

French Door Refrigerators

EI23BC35K S, EI23BC35K W, EI23BC35K B

Featuring IQ-Touch™ Electronic Controls

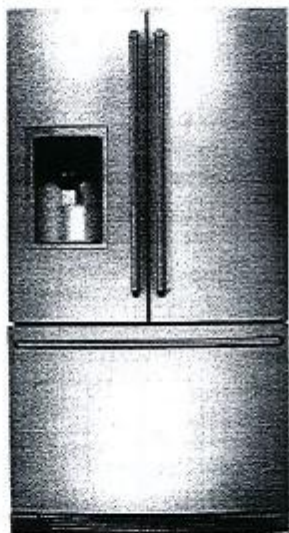

Most Usable Capacity¹

Most usable space inside, same space on the outside, so you'll have space for everything from party platters and beverages to kids' snacks and juice boxes.



IQ-Touch™ Controls

For those who like to have their options always visible, the IQ-Touch™ control panel displays your options at all times.



Luxury-Glide® Cool Zone™ Drawer

This drawer keeps contents chilled, so it's perfect for wine and beer or even snacks and juice boxes.



SpillSafe® Sliding Glass Shelves

SpillSafe® glass shelves slide out for easy access and are designed to keep spills contained, making cleanup a breeze.

23 CU. FT. COUNTER-DEPTH FRENCH DOOR REFRIGERATORS

Capacity	
Total Capacity	22.9 Cu. Ft.
Fresh Food Volume	15.70 Cu. Ft.
Freezer Volume	6.09 Cu. Ft.
Total Shelf Area	23.20 Sq. Ft.
Fresh Food Shelf Area	17.85 Sq. Ft.
Freezer Shelf Area	5.35 Sq. Ft.
Exterior	
Signature Soft-Arc Door and Handle Design	Yes
Electronic Controls	IQ-Touch
Hidden Hinge Door Design	Yes
Ice/Water Dispenser	Yes
Perfect-Set™ Temperature Control System and Display	Yes
Crushed Cubes/Water	Yes/Yes/Yes
Air and Water Filter Indicator/Reset	Yes
Ice Maker On/Off	Yes
Fast Freeze™	Yes
Lock/Dispenser Light Control	Yes
Fresh Food Conveniences	
PureAdvantage® Water & Ice	Yes
PureAdvantage® Air Filtration/Water Filter Location	Yes/Bottom Left
Temp/Alarm System/Door Ajar Alarm	Yes/Yes
Power Failure Alarm	Yes
Glass Shelves	SpillSafe® Sliding 1 (Drawer With SpillSafe®)
Humidity-Controlled Left Crisper	Luxury-Glide®
Humidity-Controlled Right Crisper	Luxury-Glide®
Perfect-Temp® Drawer	Luxury-Glide®
Cool-Zone™ Drawer	Luxury-Glide®
Wine and Beverage Mat	Yes
Dispenser Bin	Yes
Clear Gallon Door Bins (Adjustable)	Yes
Clear 2-Liter Door Bins (Adjustable/Removable)	1/1
Clear 1/2-Gallon Door Bins	Yes
Clear Condiment Bin	Yes
Clear Entry Door	Yes
Tilt-Out Can Racks	Yes
Luxury-Design® LED Ramp-Up Multilevel Lighting	Yes
Automatic Ice Maker	Yes
Freezer Conveniences	
Automatic Ice Maker (Second Ice Maker)	Yes
Self-Closing Drawers	Yes
Sliding Freezer Baskets	2 Luxury-Glide® 11 Deep Plastic w/Dividers
Soft Freeze™ Bin/Pizza Bin	Yes
Tilt-Out Door Baskets/Plastic Baskets Tray	Yes
Luxury-Design® LED Ramp-Up Multilevel Lighting	Yes
Additional Features	
ENERGY STAR®	Yes
Sabbath Mode (Star-K® Certified)	Yes
Specifications	
Color	
Stainless Steel	S
White	W
Black	B
Product Dimensions	
Height (with Hinges and 3/8" Rollers)	69-1/2"
Cabinet Width/Door Width	25-5/8"/36"
Depth (to Center of Arc) (with 5/8" Door Open)	28-3/4"
Depth (to Center of Arc) (with Drawer Fully Extended including Handle)	45-3/8"
Power Supply Connection Location	Right Bottom Rear
Water Inlet Location	Left Bottom Rear
Voltage Rating	120V/60 Hz/15 or 20A
Connected Load (kW Rating @ 120 Volts)	1.02
Minimum Circuit Required (amps)	15
Shipping Weight (Approx.)	350 lbs.

SENATOR HOMES
DECOR CENTRE

DATE: FEB 26 2016

INITIALS:



9130-147

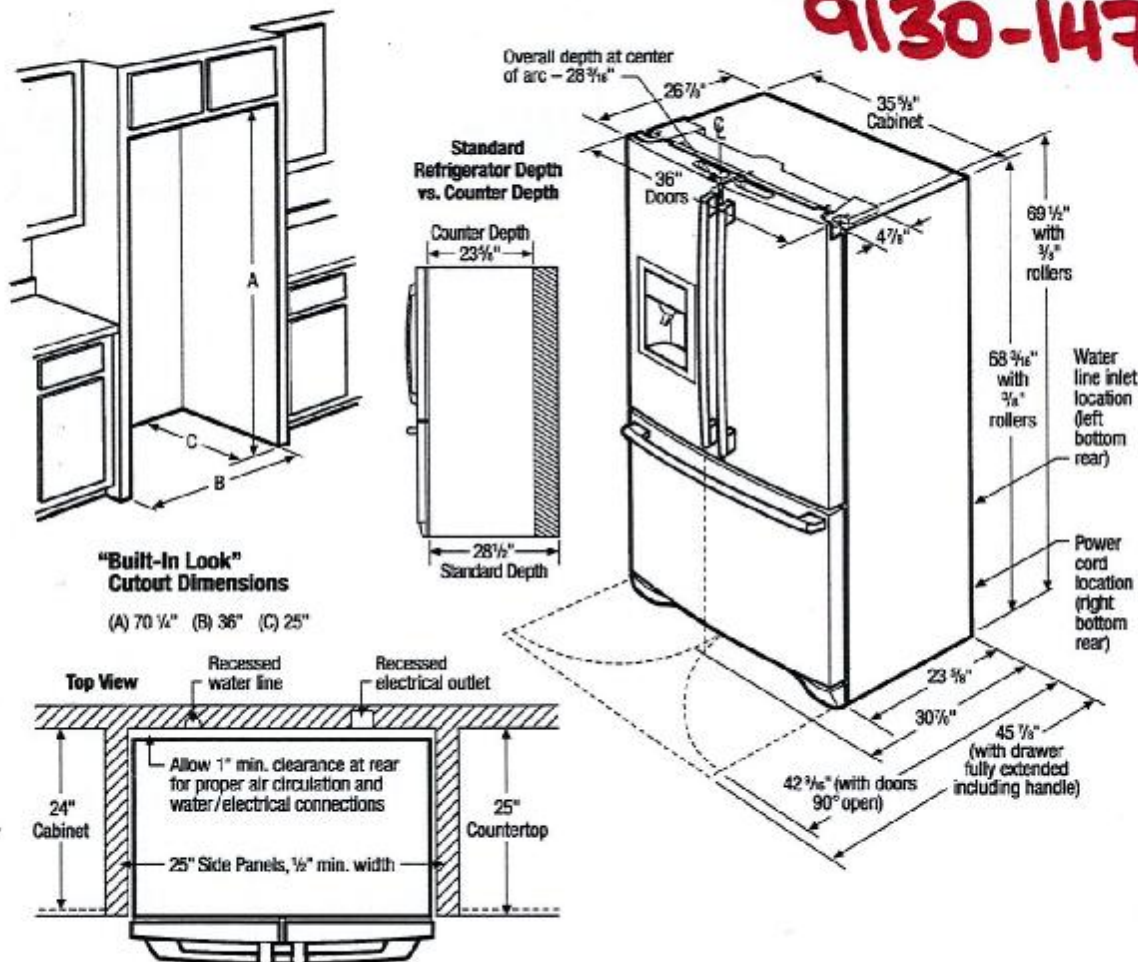

Counter-Depth French Door Refrigerator Specifications

- Product Weight – 345 Lbs.
- An electrical supply with grounded three-prong receptacle is required. The power supply circuit must be installed in accordance with current edition of National Electrical Code (NFPA 70) and local codes & ordinances.
- Voltage Rating – 120V/60 Hz/15 or 20 Amps
- Connected Load (kW Rating) @ 120 Volts = 1.02 kW
- Amps @ 120 Volts = 8.5 Amps
- Always consult local and national electric & plumbing codes.
- Floor should be level surface of hard material, capable of supporting fully loaded refrigerator.
- When installing refrigerator adjacent to wall, cabinet or other appliance that extends beyond front edge of unit, 20" minimum clearance recommended to allow for optimum 120° to 180° door swing, providing complete drawer/crisper access and removal. (Absolute 4-1/2" minimum clearance will ONLY allow for 90° door swing which will provide drawer/crisper access with restricted removal.)
- To ensure optimum performance, avoid installing in direct sunlight or close proximity to range, dishwasher or other heat source.

- For proper ventilation, front grille MUST remain unobstructed.
- Recess electrical outlet when possible.
- Water reuses on rear wall recommended to prevent water line damage.
- Water Pressure – Cold water line must provide between 30 and 100 pounds per square inch (psi).
- Copper tubing with 1/4" O.D. recommended for water supply line with length equal to distance from rear of unit to household water supply line plus 7 additional feet. Optional Water Supply Installation Kits available.
- Adjustable front rollers to assist with door alignment.

"Built-In Look" Specifications

- Minimum opening of 70-1/4" H x 36" W x 25" D required to allow for ease of installation, proper air circulation, and plumbing/electrical connections.
- Remove all wall/floor molding prior to installation.

Note: For planning purposes only. Refer to Product Installation Guide on the web at electroluxappliances.com for detailed instructions.

Electrolux Major Appliances, N.A.

USA • 10200 David Taylor Drive • Charlotte, NC 28262 • 1-877-4electrolux (1-877-435-3287) • electroluxappliances.com



High standards of quality at Electrolux Home Products, Inc. mean

SENATOR HOMES
DECOR CENTRE

DATE: FEB 26 2016

INITIALS:

[Handwritten signature]



Use these dimensions and clearance instructions for planning purposes only. For detailed installation instructions, refer to installation guide, packed with product, or on the web at electroluxappliances.com.

9130-147

Front

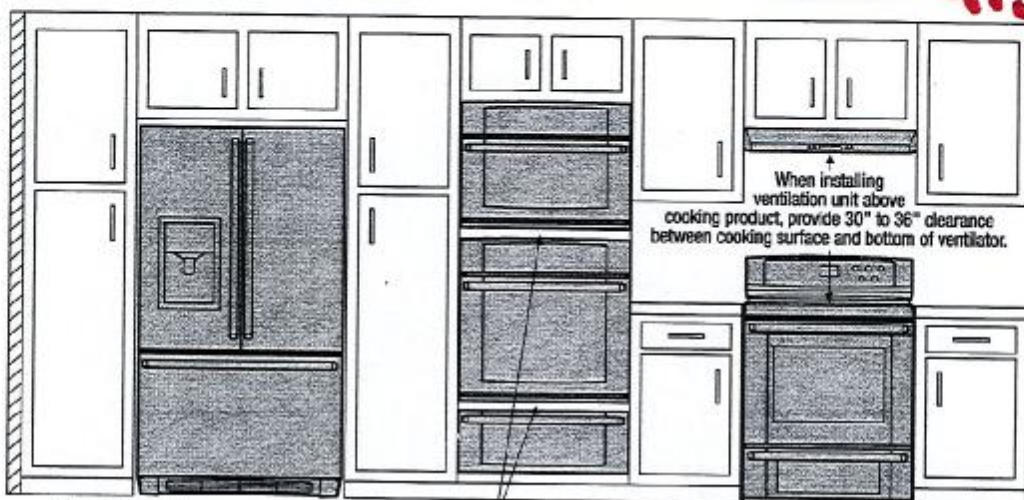

When installing built-in cooking appliances in combination, 2" high minimum visible gap between appliance faceplates required.

Clearance information for cooking appliances, provided in specific product's installation guide.

Top

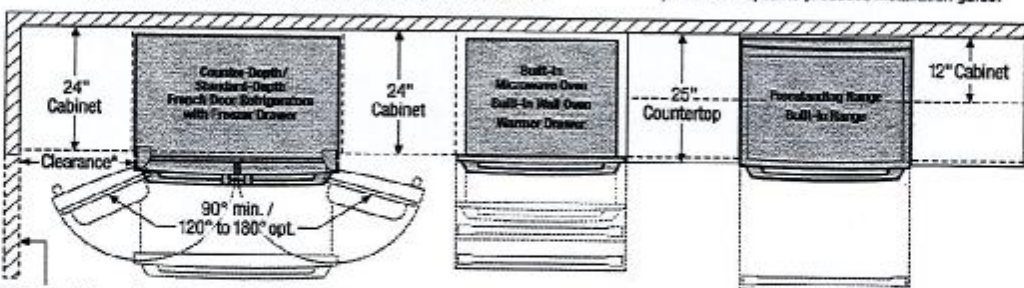

*When installing a French door refrigerator adjacent to wall, cabinet or another appliance that extends beyond front edge of unit, 20" minimum clearance recommended to allow for optimum 120° to 180° door swing, providing complete drawer/crisper access and removal. (Absolute 4-1/2" minimum clearance will ONLY allow for 90° door swing which will provide limited drawer/crisper access with restricted removal.)

When installing appliance with sliding drawer or drop-down door directly across from obstructions, provide sufficient clearance for drawer extension or door swing.

Front

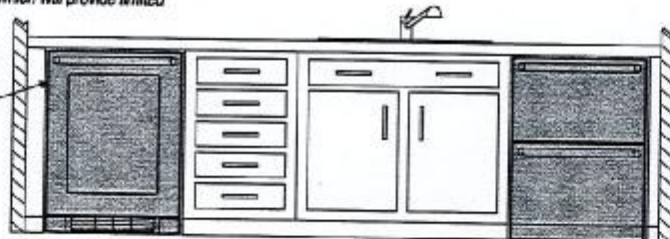

To ensure optimum performance, avoid installing refrigeration appliances in direct sunlight or near heat source.

Top

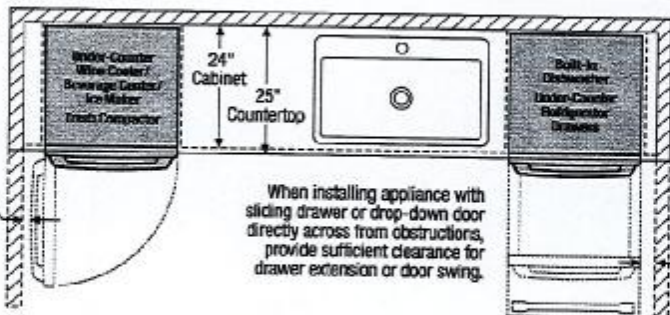

When installing appliance with side-swing door adjacent to wall, cabinet, or other obstruction that extends beyond front edge of appliance, door swing and handle clearance must be sufficient to allow access to appliance interior.

When installing appliance with sliding drawer or drop-down door directly across from obstructions, provide sufficient clearance for drawer extension or door swing.

When installing appliance with sliding drawer or drop-down door adjacent to wall, cabinet, or other obstruction that extends beyond front edge of appliance, allow 2" minimum clearance between drawer or door and obstruction.

Electrolux Major Appliances, N.A.

USA • 10200 David Taylor Drive • Charlotte, NC 28262 • 1-877-4electrolux (1-877-435-3267) • electroluxappliances.com

High standards of quality at Electrolux Home Products, Inc. mean our products are built to last.

SENATOR HOMES
DECOR CENTRE

DATE: FEB 26 2016

INITIALS:

[Handwritten signature]

Over-the-Range Microwave

EI30BM6CPS

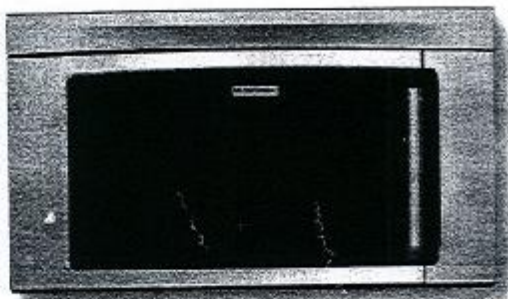

Convection Cooking

Gives you oven results at microwave speed—perfect for roasting, cooking and baking everything from steaks to cupcakes.



Cook-2-Perfection® Technology

Uses a diamond-design rear wall, plus stirring fan and turntable to heat your food evenly every time.



Quartz Grill Element

Provides a true oven bake finish.



Auto-Cook Options

Cook display prompts you through Quick Meal options and Dinner Recipes.

30" OVER-THE-RANGE CONVECTION MICROWAVE

Oven Cavity	1.8 Cu. Ft.
Watts	1000
Oven Interior	Stainless Steel
Interior Light	Yes
14-1/4" Glass Turntable	Yes
Control Panel Features	
Q-Touch® Electronic Controls	Yes
Convection	Yes
Front Display with Blue LED	Yes
Electronic Clock & Timer	Yes
Humidity Sensor	Yes
Power Levels	10
Touch Pad Controls	31
Fast Cook Options	Yes
Cook-2-Perfection® Technology	Yes
Auto-Start	Yes
Auto-Dellect Options	6
Auto-Cook Options—Quick Meal (4), Dinner Recipes (5)	9
Auto-Melt/Softening Options—Ice Cream (1), Cream Cheese (1), Butter (1), Chocolate (1)	4
Auto-Reheat Options—Breakfast (5), Eggs (1)	6
Beverage (1.5-2.0 Cup)	Yes
Sealer Cook Options—Cook (5), Reheat (1), Popcorn (3), Baked Potato (3), Frozen Vegetables (1), Fresh Vegetables (1)	10
Multi-Stage Cooking Options	4
Shutout Options	6
Auto 30 Seconds	Yes
Cooking Help Options	5
Panel Lock	Yes
Desno Mode	Yes
Adjustable Sound Level For Timer/Reminders	Yes
Memo/Lock Function	Yes
Additional Features	
Signature Soft-Arm Oven Door and Handle Design	Yes
Glass Window	Yes
Ventilation System	
Road Fan	Yes
Exhaust Duct	Convertible*
Exhaust Fan (400 CFM)	4-Speed
Charcoal Filters (Recommended Installation)	1
Grease Filters	2
Accessories	
Metal Rack	Included
36" Filter Kit—Stainless Steel—PNEUMATICS	Optional
Specifications	
Color	Stainless Steel
Oven Cavity Dimensions	
Height	9-1/2"
Width	21-1/4"
Depth	14-2/3"
Product Dimensions	
Height (Including Lower Extension)	17-9/16"
Width	29-7/8"
Depth (To Centre of Arc—Including Rear Extension)	7-3/8"
Power Supply Connection Location	Right Top Panel
Voltage Rating	120V/60Hz/15A
Connected Load (kW Rating) @ 120 Volts†	1.7†
Amps @ 120 Volts	14.2
Frequency (MHz)	2450
Microwave—Watts @ 120 Volt Input	1050
Convection—Watts @ 120 Volt Input	1500
40" Electrical Cable	Included
Shipping Weight (Approx.)	85 Lbs.

*Ventilation system is made to accommodate both duct and no ducting. Converting to ductless exhaust is optional.
†For use on adequately sized 120V, dedicated circuit feeding 2-wire w/ground with a separate ground wire. Appliances must be grounded for safe operation.
NOTE: Always consult local codes and regulations for proper installation. Refer to Product Installation Guide for detailed installation instructions on the back of the product literature.
Specifications subject to change.

SENATOR HOMES
DECOR CENTRE

DATE: FEB 26 2010

INITIALS:

[Signature]

9130-147

Locate 120V/60Hz grounded outlet inside upper cabinet

Microwave MUST be mounted to BOTH a top cabinet AND a wall*

Bottom edge of cabinet MUST be 30" min. from cooking surface

Cabinet MUST be capable of supporting a total load of 135 lbs.

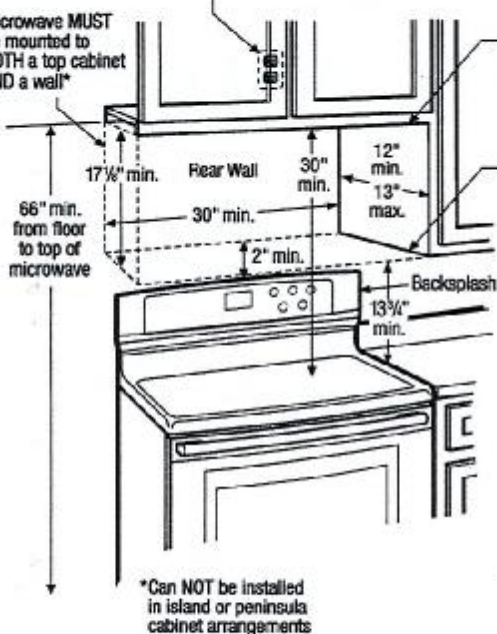

*Can NOT be installed in island or peninsula cabinet arrangements

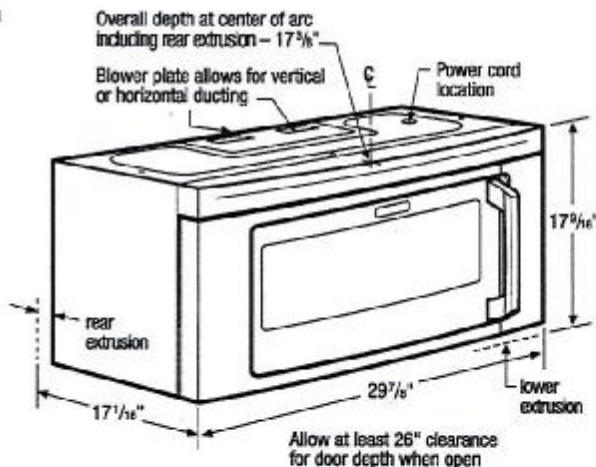
**30" Over-the-Range Microwave Specifications**

- Product Weight – 70 Lbs.
- Voltage Rating – 120V/60 Hz/15 Amps
- Connected Load (kW Rating) @ 120 Volts = 1.71 kW (For use on adequately wired 120V, dedicated circuit having 2-wire service with a separate ground wire. Appliance must be grounded for safe operation.)
- Amps @ 120 Volts = 14.3 Amps
- Always consult local and national electric codes.
- Grounded outlet should be located in cabinet above, with hole in base to route power cord. Carefully follow top template instructions for power cord clearance when installing beneath smooth, flat cabinets.
- Microwave's ventilation system is preset to recirculate air inside with no ducting system required. Exhausting air outside is optional, using either vertical or horizontal ducting system. (Refer to Ducted Option Specifications for outside ventilation.)
- For safe and proper installation, microwave MUST be mounted to BOTH a top cabinet AND a wall, and connected to at least one wall stud. Can NOT be installed in island or peninsula cabinet arrangements.
- Cabinet bottom MUST be level to insure proper installation.
- Cabinet MUST be capable of supporting a total load of 135 lbs.
- Filler blocks recommended for installation when cabinet front hangs below recessed bottom shelf.
- Minimum distance of 30" required from cooking surface to bottom edge of top cabinet.
- Minimum distance of 66" required from floor to top of microwave.
- Opening between cabinets MUST be 30" wide and free of obstructions. For openings up to 36" wide, order optional 36" Filler Kit to fill in gap between unit and cabinets.
- Allow 26" minimum clearance for 90° door swing.

Ducted Option Specifications

- For outside ventilation.
- Exhaust duct adapter will be needed for outside ventilation, to mate with standard 3-1/4" x 10" rectangular duct. If round duct required, rectangular-to-round transition adapter will be needed with no more than 6" diameter.
- For most efficient airflow exhaust, use a straight run or as few elbows as possible with a maximum duct length of 3-1/4" x 10" rectangular or 6" diameter round duct, not to exceed 120 equivalent feet.
- For horizontal installation, be sure to allow enough space between wall studs to accommodate exhaust.
- Refer to installation instructions on web for detailed duct preparation and converting exhaust vent blower system for exterior exhaust ventilation.

Note: For planning purposes only. Refer to Product Installation Guide on the web at electroluxappliances.ca for detailed instructions.

Optional Accessories

- 36" Filler Kit: S – (PN # MW/FILKTSS).

Electrolux Major Appliances, N.A.



High standards of quality at Electrolux Home Products, Inc. mean

SENATOR HOMES
DECOR CENTRE

DATE: FEB 26 2016

INITIALS:

[Signature]

NE58H9970WS

5.8 CU. FT. FLEX DUO™ SLIDE-IN INDUCTION RANGE

9130
147

CHEF COLLECTION

Our premium Chef Collection line is designed by Master Chefs with the sophisticated cook in mind. Every appliance in the collection has been tested and approved by Michelin Star chefs to build the best kitchen possible.

FEATURES

- Premium Slide-in Design
- Flex Duo™ Technology – traditional single cavity range and double oven in one; unique design easily switches from single cavity to two smaller cavities
- Chef Bake – Precise Temperature Control for Optimal Results
- Four Induction Elements – 11", 7", two 6"
- Glass Touch Controls with Guiding Light System
- Dual Convection for Even Cooking
- Gliding Rack for Simplest Access to Food in the Oven
- Temperature Probe Ensures Best Cooking Results
- Large Oven Capacity–5.8 cu. ft.
- Warming Drawer: High, Medium, Low
- SteamQuick™ (20 min. oven cleaning) and Self Clean

CONVENIENCE

- Hot Surface Indicator Lights
- Auto Oven Light
- Proofing
- Sabbath Mode
- Kitchen Timer
- Delay Start
- Auto Shut-Off Option
- Child Safety Lock
- 5 Healthy Cook Presets



Ranked "Highest in Customer Satisfaction with Ranges, Cooktops and Ovens."*

—J.D. Power



Available Color



Stainless Steel



Full Induction Cooktop with Virtual Flame Technology



Guiding Light Controls

SIGNATURE FEATURES

FULL INDUCTION COOKTOP WITH VIRTUAL FLAME TECHNOLOGY

- Induction cooking focuses the most heat directly to the pot so that you can boil and cook faster, plus simmer with more control. Induction cooking uses heat more efficiently as compared to electric and gas.
- LED lights shine onto pots and pans to provide the visual of gas cooking with the precision of induction.

FLEX DUO™ OVEN

- 5.8 cu. ft. oven splits into two ovens (2.6 cu. ft. and 3.1 cu. ft.) with the Smart Divider.
- Two temperature controls cook dishes at different temperatures.
- No noticeable transfer of aroma.

CHEF BAKE

- Chef Bake delivers consistent cooking temperature with minimum fluctuation.
- Typical ovens experience up to 25 degrees of temperature change during cook time while Chef Bake never fluctuates more than 8 degrees Fahrenheit.

PREMIUM DESIGN WITH GUIDING LIGHT CONTROLS

- Intuitive controls offer simple, step-by-step instructions for choosing cooking options.
- Only illuminates cooking options that are able to be selected and goes from left to right eliminating back and forth.
- Control temperature and time settings, select cooking functions and program your favorite recipes.

GLIDING RACK

- Glides heavy items in and out with ease.
- Easily check on food with lightweight sliding action with the ball-bearing gliding rack.

SENATOR HOMES
DECOR CENTRE

DATE: FEB 26 2015

INITIALS:

[Handwritten signature]

NE58H9970WS

5.8 CU. FT. FLEXDUO™ SLIDE-IN INDUCTION RANGE

9130-147

INSTALLING YOUR RANGE

30" minimum clearance between the top of the cooking surface and the bottom of an unprotected wood or metal cabinet; or 24" minimum when the bottom of the wood or metal cabinet is protected by not less than 1/4" flame retardant millboard covered with not less than no.28 MSG sheet steel, 0.015" stainless steel, 0.024" aluminum or 0.020" copper.

** 18" minimum between the countertop and the adjacent cabinet bottom.

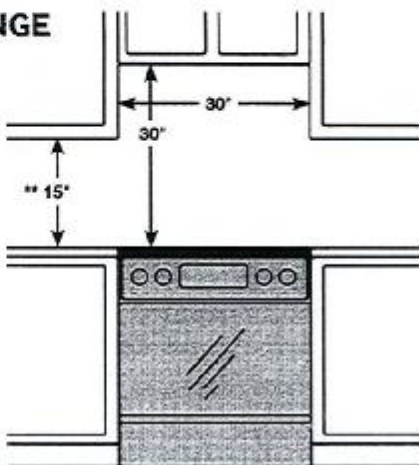

IMPORTANT: To eliminate the risk of burns or fire caused by reaching over heated surface units, cabinet storage space located above the surface units should be avoided. If cabinet storage is to be provided, the risk can be reduced by installing a range hood that projects horizontally a minimum of 5" beyond the bottom of the cabinets.

DIMENSIONS

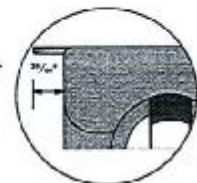
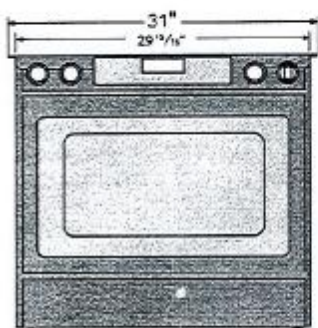

Glass cooktop overlaps and sits on top of your kitchen countertop to give a built-in look. Cut out space for the range is 29 13/16".

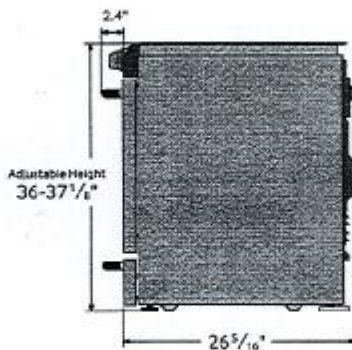

Induction Cooktop

- Right Front: 7", 1.8 KW (Boost 1.8KW)
- Left Front: 11", 2.3 KW (Boost 3.3KW)
- Right Rear: 6", 1.2 KW (Boost 2.0 KW)
- Left Rear: 7", 1.8 KW (Boost 1.8KW)

Dual Oven (with Divider)

- Hidden Bake Element: 3000 W
- Bake: 150°F - 550°F
- Convection Bake: 175°F - 550°F
- Convection Roast: 175°F - 550°F
- Variable Broil (Low - High)
- Convection Element/Heater: 1250 W
- Proofing
- Sabbath Mode

Warming Drawer

- Capacity - 0.7 cu. ft.
- Heating Performance: 600 W (4 pass)
- Temperature Settings: High, Medium, Low

Warranty

- One (1) Year All Parts and Labor
- Five (5) Years Electric Cooktop

Product Dimensions & Weight (WxHxD)

Outside Dimensions:
29 13/16" x 36-37 1/4" (Adjustable) x 26 5/16"

Weight: 231.5 lbs.

Shipping Dimensions & Weight (WxHxD)

Dimensions:
33 1/32" x 41 3/4" x 30 9/32"

Weight: 255.7 lbs.

Color	Model #	UPC Code
Stainless Steel	NE58H9970WS	887276033013

Samsung received the highest numerical score for ranges, cooktops and ovens in the proprietary J.D. Power 2014 Kitchen Appliance Study. Study based on 15,380 total responses measuring 17 ranges, cooktops and oven brands and measures opinions of consumers about their new appliance purchased in the past 24 months. Proprietary study results are based on experiences and perceptions of consumers surveyed in January-March 2014. Your experiences may vary. Visit jdpower.com

SENATOR HOMES
DECOR CENTRE

DATE: FEB 26 2016

INITIALS:

[Handwritten signature]



Electrolux

9130-147

DISHWASHER

EW24ID80QS

Featuring Wave-Touch® Electronic Controls



SIGNATURE FEATURES



PROCLEAN™ SYSTEM

Professional-level clean with ProClean™ System, featuring SatelliteSpray™, 30-minute Fast Wash Cycle, and Target Wash Zones.



SATELLITESPRAY™ ARM

An innovative rotating wash zone gives you 400% more water coverage, targeting virtually every spot in your dishwasher for a truly professional-level clean.



30-MINUTE FAST WASH CYCLE

Thoroughly cleans in just 30 minutes.

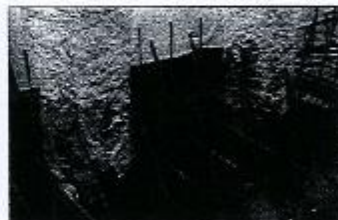

TARGET WASH ZONES

Four flexible spray jets deliver a targeted wash to the most challenging dirty dishes, from sport bottles to heavy-duty pots and pans.

PRODUCT DIMENSIONS

Height (Adjustable)	33-3/4" - 35-3/4"
Width	23-3/4"
Depth	24-1/4"

MORE EASY-TO-USE FEATURES

THIRD-LEVEL RACK

Convenient space for spatulas and unique kitchen tools, or extra room for everyday utensils. Easily lifts out for convenient unloading.

EASY-LIFT ADJUSTABLE RACKS

Versatile racking system easily adjusts to provide the perfect place for all your dishware — no pinching, pulling, or toggling required.

LUXURY SOFT GRIP RACKS

Luxury Soft Grip Racks hold plastics and dishware in place, and prevent flopping, for a more thorough clean.

PERFECT STEMWARE™ GRIPS

Eighteen flexible grips gently hold stemware and other delicate items for a secure wash, every time.

LUXURY-QUIET™ DISHWASHER + SMART CLEAN LIGHT

A sound package so quiet, we engineered Smart Clean Light to let you know how much time is left in the cycle, and when your dishes are clean and ready.

SMARTSOIL™ SENSOR

Responsive technology that delivers a more effective, more efficient clean by continuously monitoring water purity to determine exactly how long a cycle should run.

MORE CYCLES

With up to nine cycles — including Heavy, Normal, Fast Wash, Auto, Upper Rack Only, Eco Wash, Stemware, Rinse Only, and "My Favorite" — you can choose the perfect wash for any occasion.

MORE OPTIONS

An even more amazing wash with unique options like Air-Dry, NSF Certified Sanitize Rinse, Hi-Temp Wash, Max Dry and Delay Start (1-24 hours).

FLEXIBLE UTENSIL BASKET

With a large capacity utensil basket that can be split, reconfigured, and placed anywhere, you have even more loading options.

Available in:



Sensors (S)

SENATOR HOMES
DECOR CENTRE

DATE: FEB 26 2016

INITIALS:

9130-147

24" BUILT-IN DISHWASHER

FEATURES

Stainless Steel Interior	Yes
Signature Soft-Arc Handle Design	
Gravity Hold™ Door	Yes
Wave-Touch™ Electronic Controls	Yes
Fully Integrated Control Panel	Yes
Tall-Tub Design	Yes
ProClean™ Wash System	Yes
Self-Heating™ Arm	Yes
Target Wash Zones	4
Wash Levels	5
AquaLock™ Wash System	Yes
Luxury Care™ Sound Package	Yes
Sound Level	42 dBS
SmartSoft™ Sensor	Yes
Luxury Dry™ System	Yes
Adjustable Rinse Aid Dispenser with Indicator	Yes
ENERGY STAR®	Yes
Reclaimable	

CYCLES

Auto Wash	Yes
Heavy	Yes
Normal	Yes
Fast Wash (30-Min)	Yes
China Crystal	
Perfect Steam™ Cycle	Yes
Favorite	Yes
Ice Maker	Yes
Upper Rack Only	Yes
Rinse Only	Yes

OPTIONS

Hi-Touch™ Wash	Yes
Heat/No-Heat Dry	Yes
Max Dry	Yes
HEP® Certified Sanitize Option	Yes
Delay Start (Hours)	1-24

RACK SPECIFICATIONS

Nylon Rack System	Slide-2-RT™
Luxury Slide™ Upper Rack	
Adjustable Height	Yes
Cup Shelf/Product Separator™ Holders	4/18
Fork-Down Tines	4 Rows
Rack Handle	Yes
Luxury Slide™ Lower Rack	
Fork-Down Tines	6 Rows
Stemware/Champagne/Glass Holders	7
Silverware Basket	2-Handle Split
Rack Handle	Yes
Third-Layer Rack (Single Tray)	Yes

SPECIFICATIONS

Color	Stainless Steel
Power Supply Location	Right Bottom Front
Water Inlet Location	Left Bottom Front
Water Usage (Gallons) - Normal Cycle	4.0 - 8.0
Water Pressure (PSI)	15 - 120
Integral Air Gap or Supply	Yes
Voltage/Phase	120V/60 Hz
Connected Load (kW) Rating (Grids/Volts)	1.44
Amps @ 120 Volts	15
Shipping Weight (Approx)	115 lbs.

*For more information, please visit our website at www.electrolux.com or call 1-877-4ELECTROLUX. All dimensions are approximate and subject to change without notice. Always consult the product literature and specifications for the most current information. Specifications subject to change.

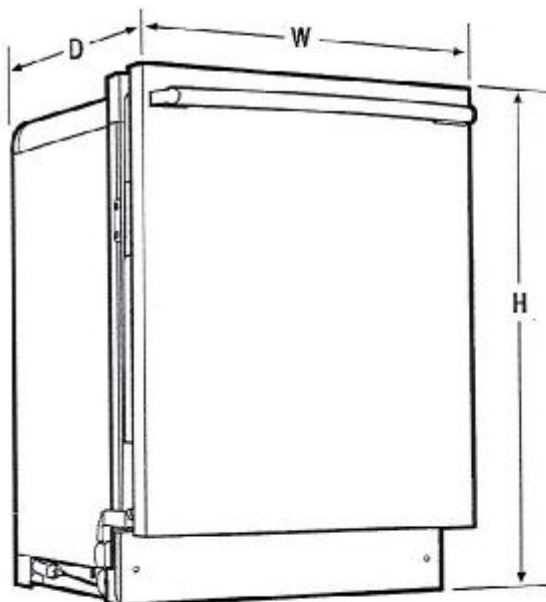

PRODUCT DIMENSIONS

Height (projectable)	33 3/4" - 35 3/4"
Width	23 3/4"
Depth	24 1/4"
Depth with 3rd Rack Open	24 1/4"

*Height adjustable to 33 3/4" with 3rd rack installed. For 35 3/4" height, remove 3rd rack. Call of number for 3rd rack. *See website.

Electrolux Major Appliances, N.A.

USA • 10200 David Taylor Drive • Charlotte, NC 28262 • 1-877-4electrolux (1-877-435-3287) • electroluxappliances.com
CANADA • 5855 Terry Fox Way • Mississauga, ON L5V 3E4 • 1-800-265-8352 • electroluxappliances.ca

Meets requirements of ASSE 1006
UL US
NSF
High standards of quality at Electrolux Home Products, Inc. mean we are constantly working to improve our products.

SENATOR HOMES
DECOR CENTRE

DATE: FEB 26 2016

INITIALS:

[Handwritten signature]

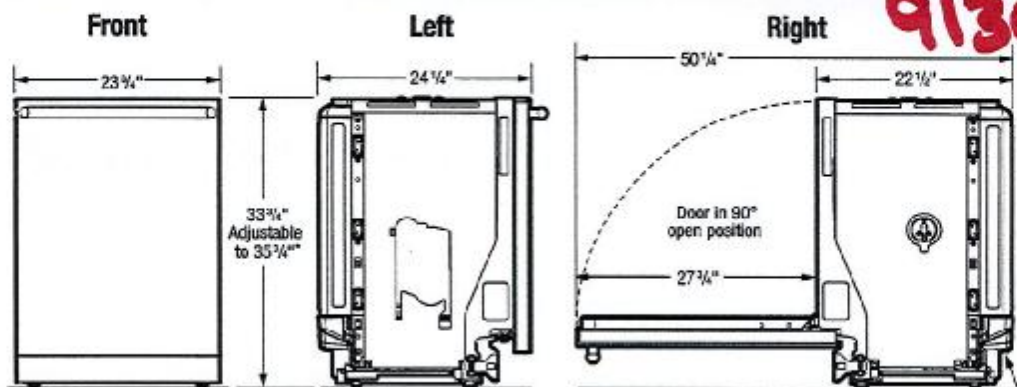

*Height only adjustable to 35 3/4" max. when installed in 35 3/4" max. standard cabinetry cutout. (Dimensions do NOT include insulation - insulation blanket may be compressed during installation.)

Power supply & water inlet location (bottom rear)

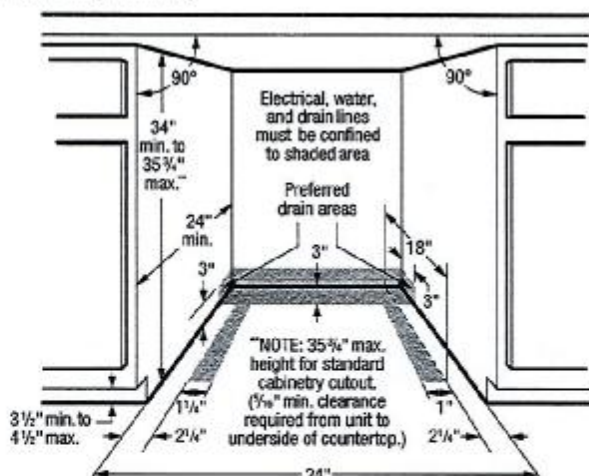

Built-in Dishwasher Specifications

- Product Weight - 98 Lbs.
- Voltage Rating - 120V/60Hz
- Connected Load (kW Rating) @120 Volts = 1.44 kW
(For use on adequately wired 120V, dedicated circuit having 2-wire service with a separate ground wire. Appliance must be grounded for safe operation.)
- Amps @ 120V = 15.0
- Always consult local and national electric & plumbing codes. Meets requirements of ASSE 1006 - integral air gap on supply.
- Water Pressure - Hot water line to dishwasher must provide between 20 and 90 pounds per square inch (psi) with at least 120° F hot water temperature.
- Make sure location has correct drain, water and electrical outlets to make connections.
- Electrical and water supplies should enter cabinet opening on floor, or through back or side walls, as shown in shaded areas.
- Keep back free of drain, water & electrical supply.
- Connections preferably located toward left side of dishwasher. Do not cross drain, water or electrical lines in front of motor, blower or frame.

- If connecting drain hose to sink trap, local code may require installation of Air Gap Kit (not included).
- Leveling legs supplied to adjust height. (Note: Height only adjustable to 35-3/4" max. when installed in 35-3/4" max. standard cabinetry cutout. 5/16" min. clearance required from top of unit to underside of countertop. Dimensions do NOT include insulation - insulation blanket may be compressed during installation.)
- When installing adjacent to wall, cabinet or other obstruction that extends beyond front edge of unit, allow 2" minimum clearance between opened door and obstruction.
- Floor should be flat and free of obstructions.
- When installing at end of cabinet line, sides and back must be fully enclosed.
- Do not install unit under a cooktop, damage will occur.
- Recommended to seal cabinets, enclosing all sides of dishwasher, including underside of countertop, with oil-based paint or moisture-proof polyurethane to prevent possible steam/moisture damage.

Note: For planning purposes only. Refer to Product Installation Guide on the web at electroluxappliances.com for detailed instructions.

Electrolux Major Appliances, N.A.

USA • 10200 David Taylor Drive • Charlotte, NC 28262 • 1-877-4electrolux (1-877-435-3287) • electroluxappliances.com
CANADA • 5855 Terry Fox Way • Mississauga, ON L5V 3E4 • 1-800-265-8352 • electroluxappliances.ca

Meets requirements of ASSE 1006



High standards of quality at Electrolux Home Products, Inc. mean we are constantly working to improve our products.

SENATOR HOMES
DECOR CENTRE

DATE: FEB 26 2019

INITIALS:

[Handwritten signature]