



CONSTRUCTION SUMMARY

Teefy Developments Limited / 9130 Bathurst

Lot/Unit: 115 Phase/Building: 1 Model/Floor Plan: Claremont(19-3)

AUDIO AND SECURITY

Inv.3502	3 - TO LOCATE THREE (3) STANDARD ROUGH IN CABLE OUTLETS INCLUDED IN OFFER: ONE (1) IN GREAT ROOM (ABOVE FIREPLACE) ONE (1) IN MASTER BEDROOM ONE (1) IN RECREATION ROOM	
Line 45958	Note: LOCATION AS PER SKETCH ATTACHED	
6Feb16 / 6Feb16		
Inv.3502	2 - TO LOCATE TWO (2) STANDARD ROUGH IN TELEPHONE OUTLETS INCLUDED IN OFFER: ONE (1) IN RECREATION ROOM ONE (1) IN MASTER BEDROOM	
Line 45959	Note: LOCATION AS PER SKETCH ATTACHED	
6Feb16 / 6Feb16		

CABINETRY

Inv.3502	2 - LOCATION: KITCHEN SUPPLY AND INSTALL HORIZONTAL CABINET WITH BLUM HARDWARE BELOW UPPER CABINETS - APPROXIMATELY 12" - TO BE LOCATED ONE ON EITHER SIDE OF THE STOVE AS PER KITCHEN SKETCH ATTACHED	
Line 45979	Note: DOES NOT INCLUDE GLASS	
6Feb16 / 6Feb16		
Inv.3502	1 - LOCATION: KITCHEN DELETE THE UPPER CABINETS ABOVE STOVE AND FINISH SIDES TO ACCOMODATE INSTALL OF FUTURE CHIMNEY HOOD FAN BEING SUPPLIED AND INSTALLED BY PURCHASER AFTER CLOSING	
Line 45975	Note: LOCATION AS PER KITCHEN SKETCH ATTACHED	
6Feb16 / 6Feb16		
Inv.3502	1 - LOCATION: KITCHEN SUPPLY AND INSTALL DIFFERENT COLOUR TO ISLAND	
Line 45981	Note: ANNEX DHGL TORMENTA GLOSS MWP HANDLE 9677	
6Feb16 / 6Feb16		
Inv.3502	1 - LOCATION: KITCHEN CABINETRY - KITCHEN - UPGRADE - 13 - ELITE PLUS - SUPPLY AND INSTALL	
Line 45992	Note: ANNEX DHGL ARCTICO GLOSS MWP HANDLE 9677	
6Feb16 / 6Feb16		

CABINETRY ACCESSORIES

Inv.3502	2 - LOCATION: KITCHEN LIGHT VALANCE - NOT APPLICABLE FOR THERMOVISION - PRICE PER 8 FOOT LENGTH	
Line 45989	Note:	
6Feb16 / 6Feb16		

CABINETRY APPLIANCE - FRIDGE



CONSTRUCTION SUMMARY

Teefy Developments Limited / 9130 Bathurst

Lot/Unit: 115 Phase/Building: 1 Model/Floor Plan: Claremont(19-3)

Inv.3502	1 - LOCATION: KITHCHEN	
	59 CM FRIDGE CABINET - 2 GABLES & CABINET 59 CM DEEP - DEEP - UPGRADE 1	
Line 45965	Note:	
6Feb16 / 6Feb16		

CABINETRY MICROWAVE OVEN STOVE COOKTOP

Inv.3502	1 - LOCATION: KITCHEN	
	BUILT IN OVEN IN BASE CABINET WITH COOKTOP ABOVE. INCLUDES COUNTERTOP AND COOKTOP CUT OUT - PURCHASER MUST SUPPLY SPECS - UPGRADE 3	
Line 45971	Note: LOCATION AS PER SKETCH ATTACHED	
6Feb16 / 6Feb16		

Inv.3502	1 - LOCATION: KITCHEN	
	MICROWAVE UNDER COUNTER IN BASE CABINET WITH DRAWER BELOW - FINISH INTERIOR - PURCHASER MUST SUPPLY SPECS - UPGRADE 1	
Line 45974	Note: LOCATION AS PER SKETCH ATTACHED	
6Feb16 / 6Feb16		

CABINETRY WALL AND HUTCH

Inv.3502	2 - LOCATION: KITCHEN	
	GLASS DOOR FROSTED - WHITE CABINET INTERIOR -UPGRADE 1 GLASS TO BE FRAMED WITH ALUMINUM COLOUR TRIM	
Line 45980	Note: LOCATION AS PER KITCHEN SKETCH ATTACHED	
6Feb16 / 6Feb16		

COUNTER TOP - ACCESSORIES

Inv.3502	1 - LOCATION: MASTER ENSUITE	
	SUPPLY AND INSTALL GRANITE COUNTER-TOP TO MASTER ENSUITE. SELECTION FROM VENDOR'S STANDARD SAMPLES. DOES NOT INCLUDED UNDERMOUNT SINK, CUT-OUT AND POLISHING. INCLUDED IN SCHEDULE PE ITEM #5	
Line 45957	Note:	
6Feb16 / 6Feb16		

COUNTER TOP - EXTRAS

Inv.3502	2 - LOCATION: MASTER ENSUITE	
	SUPPLY PROVISIONS FOR GRANITE CUTOUT AND POLISHING FOR UNDERMOUNT SINK IN MASTER ENSUITE	
Line 45960	Note:	
6Feb16 / 6Feb16		

ELECTRICAL

Inv.3502	1 - LOCATION: KITCHEN	
	ELECTRICAL - CONNECTION FOR BUILT-IN OVEN BEING INSTALLED BELOW GAS COOK-TOP STOVE	
Line 45970	Note: LOCATION AS PER KITCHEN SKETCH ATTACHED	
6Feb16 / 6Feb16		



CONSTRUCTION SUMMARY

Teefy Developments Limited / 9130 Bathurst

Lot/Unit: 115 Phase/Building: 1 Model/Floor Plan: Claremont(19-3)

Inv.3502	1 - LOCATION: KITCHEN	
	SUPPLY AND INSTALL ADDITIONAL INTERIOR RECEPTACLE ON SEPARATE CIRCUIT REQUIRED TO ACCOMODATE INSTALL OF FUTURE CHIMNEY HOOD FAN BEING SUPPLIED AND INSTALLED AFTER CLOSING	
Line 45976	Note: LOCATION AS PER SKETCH ATTACHED.	
6Feb16 / 6Feb16		
Inv.3502	1 - LOCATION: KITCHEN	
	ELECTRICAL - CONNECTION FOR BUILT IN MICROWAVE BEING INSTALLED IN BASE CABINETS	
Line 45978	Note: LOCATION AS PER KITCHEN SKETCH ATTACHED	
6Feb16 / 6Feb16		
Inv.3502	1 - LOCATION: KITCHEN	
	SUPPLY AND INSTALL LIGHT VALANCE ROUGH IN (INCLUDES 1 SWITCH)	
Line 45990	Note: LOCATION AS PER SKETCH ATTACHED.	
6Feb16 / 6Feb16		

HARDWOOD

Inv.3502	1 - LOCATION: ALL BEDROOMS	
	SUPPLY AND INSTALL ENGINEERED HARDWOOD TO ALL BEDROOMS IN UPPER LEVEL OF HOME. SELECTION FROM VENDOR'S STANDARD SAMPLES. INCLUDED IN SCHEDULE PE ITEM #3	
Line 45956	Note: COLOUR: GRAPHITE	
6Feb16 / 6Feb16		

HEATING AND AIR CONDITIONING

Inv.3502	1 - LOCATION: KITCHEN	
	GAS LINE - ROUGH-IN ONLY - FOR STOVE TO INCLUDE 110V CODE REQUIREMENT	
Line 45969	Note:	
6Feb16 / 6Feb16		

MISCELLANEOUS

Inv.3502	1 - LOCATION: GREAT ROOM	
	SUPPLY AND INSTALL FURRED OUT WALL TO RECESS ELECTRIC FIREPLACE. WALL TO BE APPROXIMATELY 6 FEET +/- WIDE AND APPROXIMATELY 10 INCHES +/- DEEP FROM FLOOR TO CEILING.	
Line 45962	Note: CEILING. PRICE INCLUDES RELOCATION OF STANDARD CABLE TV ROUGH-IN CABLE AND ELECTRICAL OUTLET.	
6Feb16 / 6Feb16		

PLUMBING

Inv.3502	2 - LOCATION: MASTER ENSUITE	
	SUPPLY AND INSTALL UNDERMOUNT SINK - RECTANGULAR - CATENA MODEL 4210 CIY WHITE - IN LIEU OF STANDARD	
Line 45961	Note:	
6Feb16 / 6Feb16		



CONSTRUCTION SUMMARY

Teefy Developments Limited / 9130 Bathurst

Lot/Unit: 115 Phase/Building: 1 Model/Floor Plan: Claremont(19-3)

Inv.3502	1 - LOCATION: KITCHEN	
	SUPPLY AND INSTALL WATERLINE ROUGH-IN TO THE FRIDGE LOCATION (NO HOOK UP)	
Line 45967	Note: LOCATION AS PER SKETCH ATTACHED.	
6Feb16 / 6Feb16		

PLUMBING - KITCHEN FAUCETS:

Inv.3502	1 - LOCATION: KITCHEN	
	SUPPLY AND INSTALL UPGRADE FAUCET - MOEN 90 DEGREE SINGLE HANDLE PULL OUT FAUCET - MODEL # S7597 CHROME	
Line 45993	Note:	
6Feb16 / 6Feb16		

STAIRS AND RAILING

Inv.3502	1 - RAILING - UPGRADE 5	
	WINDSOR OAK, PICKETS -STEEL 1/2 INCH SQUARE, SINGLE COLLAR/DOUBLE COLLAR, WITH SHOES FLAT BLACK, POSTS - 3 1/2 INCH SQUARE, CHAMFERED, WITH CAP OAK - SUPPLY AND INSTALL	
Line 45988	Note:	
6Feb16 / 6Feb16		

TILE - FLOOR

Inv.3502	1 - LOCATION: FOYER	
	SUPPLY AND INSTALL FLOOR TILE - UPGRADE 3 - - VESTIBULE FLOOR	
Line 45983	Note: 13 X 13 MILIEU SERIES - SMOKE(BLU/GRY/CREAM) GE.MU.SMK.1313)	
6Feb16 / 6Feb16		
Inv.3502	1 - LOCATION: POWDER ROOM	
	SUPPLY AND INSTALL FLOOR TILE - UPGRADE 3 - - POWDER ROOM FLOOR	
Line 45985	Note: 13 X 13 MILIEU SERIES - SMOKE(BLU/GRY/CREAM) GE.MU.SMK.1313)	
6Feb16 / 6Feb16		

EXTRAS AS PER OFFER

Stainless Steel Fridge, Stove and Dishwasher and front loading washer and dryer in white from Vendors standard samples, no cash value, not transferable. (Supplied only not installed) ** to - arrange delivery call: The Brick commercial sales division at Worksheet Note:	
Rogers Free Services Package includes 6 months of: home phone, TV and Internet Service. Worksheet Note:	
The Vendor agrees to supply and install hardwood flooring in all bedrooms on upper level of home from Vendors standard samples. Worksheet Note:	
The Vendor agrees to supply and install granite countertop in Master Ensuite, from Vendors standard samples. Worksheet Note:	



INTERIOR COLOUR SCHEME

Purchasers: AZITA ASSADI & BABAK BAYAT

Property: 115 of Plan -

Telephone Res. / Bus: (647) 985-6745 /

Project: Teefy Developments Limited

Decor Advisor: Steffanee Appio

Model and Elevation: Claremont(19-3)

Layout Changes: ☐ Yes ☒ No

Sketch Attached: ☒ Yes ☐ No

Exterior Colour Scheme:

1. Cabinetry

	Style and Colour	Counter Top	Hardware
Kitchen / Breakfast	ANNEX DHGL ARCTICO GLOSS MWP	9141 ICE SNOW STD SQ EDGE	9677 HANDLE
Kitchen Island	ANNEX DHGL TORMENTA GLOSS MWP	9141 ICE SNOW STD SQ EDGE	9677 HANDLE
Laundry Room	N/A	N/A	N/A
Powder Room	CLASS - BOSTON PAINT MACADEMIA	P-346-LM INUKSHUK CARBON	KNOB 196
Main Bathroom	CLASS - BOSTON PAINT MACADEMIA	P-346-LM INUKSHUK CARBON	KNOB 196
Master Ensuite Bathroom	CLASS - BOSTON PAINT MACADEMIA	UBA TUBA STD SQ EDGE	KNOB 196
Second Ensuite Bathroom (If Applicable)	N/A	N/A	N/A

Appliances

Custom Size Fridge

☐ Yes ☒ No

Valance Lighting

☒ Yes ☐ No

Microwave / Range Hood

☐ Yes ☒ No

Cooktop / Rangetop

☒ Yes ☐ No

Built in Wall Oven

☒ Yes ☐ No

Slide-in Range

☐ Yes ☒ No

Comment

NOTE: WALL OVEN BELOW GAS COOK-TOP STOVE

NOTE: MICROWAVE IN BASE CABINET

NOTE: VALANCE AND ROUGH IN ELECTRICAL ONLY FOR VALANCE

NOTE: GRANITE COUNTER-TOP WITH STANDARD SQUARE EDGE IN MASTER ENSUITE

2. Flooring

Selection

FOYER	13 X 13 MILIEU SMOKE (BLU/GRY/CRM) GE.MU.SML.1313 - UPGRADE 3
Main Hall	3/4" X 3-5/8" STANDARD GENERATIONS SATIN FINISH RED OAK - GRAPHITE (AT POWDER ROOM)
Back Hall	N/A
Breakfast	3/4" X 3-5/8" STANDARD GENERATIONS SATIN FINISH RED OAK - GRAPHITE
Laundry Room	N/A
Kitchen	3/4" X 3-5/8" STANDARD GENERATIONS SATIN FINISH RED OAK - GRAPHITE
Powder Room	13 X 13 MILIEU SMOKE (BLU/GRY/CRM) GE.MU.SML.1313 - UPGRADE 3
Main Bathroom	13 X 13 NEW REEDS SILVER (GE.NR.SIL.1313)
Master Ensuite	13 X 13 NEW REEDS SILVER (GE.NR.SIL.1313)
Bathroom (If Applicable)	N/A
Mud Room	13 X 13 REFLEX OLIVE (GE.RF.OLV.1313) GARAGE ENTRY AREA LOWER LEVEL
Living Room	N/A
Dining Room	3/4" X 3-5/8" STANDARD GENERATIONS SATIN FINISH RED OAK - GRAPHITE
Family / Great Room	3/4" X 3-5/8" STANDARD GENERATIONS SATIN FINISH RED OAK - GRAPHITE
Den / Library / Study	STANDARD PAPILO BERBER 64676 OLIVE CREAM (LOWER LEVEL RECREATION ROOM)
Basement Landing (If Applies)	N/A
Lower Landing (If Applicable)	N/A
Upper Landing	3/4" X 3-5/8" STANDARD GENERATIONS SATIN FINISH RED OAK - GRAPHITE
Upper Hall	3/4" X 3-5/8" STANDARD GENERATIONS SATIN FINISH RED OAK - GRAPHITE
Master Bedroom	3/4" X 3-5/8" STANDARD GENERATIONS SATIN FINISH RED OAK - GRAPHITE
Bedroom #2	3/4" X 3-5/8" STANDARD GENERATIONS SATIN FINISH RED OAK - GRAPHITE
Bedroom #3	3/4" X 3-5/8" STANDARD GENERATIONS SATIN FINISH RED OAK - GRAPHITE
Bedroom #4	N/A
Bedroom #5	N/A

Flooring Continued on Page 2

Initial:

BB AA

Page 1 of 3

Purchasers:
AZITAASSADI & BABAK BAYAT

Property: 115 of Plan -

Telephone Res. / Bus: (647) 985-6745 /

Project: Teefy Developments Limited

Decor Advisor: Steffanee Appio

Model and Elevation: Claremont(19-3)

2. Flooring - Continued -

Upgrade Underpad	Type	Area
	STANDARD	RECREATION ROOM
Carpet on Stairs	Capped	Runner - *Upgrade
Comment		
NOTE: HARDWOOD TO ALL BEDROOMS IN UPPER LEVEL		
STANDARD PAPILO BERBER 64676 OLIVE CREAM IN RECREATION ROOM - LOWER LEVEL		

3. Plumbing Fixtures / Faucets

Kitchen	STD UTG	Second Ensuite		Powder Room	STD
Master Ensuite	STD			Other Room	
Main Bathroom	STD				

Comment

4. Wall Tile

	Tile Selection	Listello	Insert	Insert Selection
Main Bathroom	8 X 10 NEW REEDS BROWN (QT.NR.BWN.0810)	<input type="checkbox"/>	<input type="checkbox"/>	
Master Ensuite				
Tub Deck	N/A	<input type="checkbox"/>	<input type="checkbox"/>	
Tub Apron	N/A	<input type="checkbox"/>	<input type="checkbox"/>	
Tub Surround	N/A	<input type="checkbox"/>	<input type="checkbox"/>	
Shower Stall	8 X 10 NEW REEDS BROWN (QT.NR.BWN.0810)	<input type="checkbox"/>	<input type="checkbox"/>	2 X 2 MOSAIC TENDER GREY
Second Ensuite		<input type="checkbox"/>	<input type="checkbox"/>	SHOWER FLOOR TILE
		<input type="checkbox"/>	<input type="checkbox"/>	
		<input type="checkbox"/>	<input type="checkbox"/>	
Kitchen Backsplash	N/A	<input type="checkbox"/>	<input type="checkbox"/>	
Complete Backsplash	N/A	<input type="checkbox"/>	<input type="checkbox"/>	

Comment

5. Fireplace

	Living Room			Family Room			Other Room - Specify		
	Purchased	As Per Plan	N/A	Purchased	As Per Plan	N/A	Purchased	As Per Plan	N/A
	<input type="radio"/>	<input type="radio"/>	<input type="radio"/>	<input type="radio"/>	<input checked="" type="radio"/>	<input type="radio"/>	<input type="radio"/>	<input type="radio"/>	<input type="radio"/>
Fireplace Type				BLF-50 STANDARD					
Mantle Type									
Over Mantle									
Colour / Stain									
Surround									
Hearth									

Comment

NOTE: FURR OUT WALL TO ACCOMODATE RECESSED FIREPLACE



INTERIOR COLOUR SCHEME

Purchasers: AZITA ASSADI & BABAK BAYAT

Property: 115 of Plan -

Telephone Res. / Bus: (647) 985-6745 /

Project: Teefy Developments Limited

Decor Advisor: Steffanee Appio

Model and Elevation: Claremont(19-3)

6. Trim Carpentry

Door Hardware: STANDARD

Interior Trim: STANDARD

Comment:

Interior Doors

☐ 2 Panel Arch Top

☒ 2 Panel Square Top

☐ 6 Panel



Initial for Door Style: AA
BIB

7. Railings and Pickets

Railing Package: UPGRADE 5

Railing Colour: GRAPHITE

Picket Colour: MATTE BLACK METAL

Wood Stairs: ☐ No ☒ Oak

Tread Colour: GRAPHITE

Comment:

STAIN OAK STAIRS TO COMPLIMENT HARDWOOD - GRAPHITE COLOUR

8. Plaster Mouldings and Medallions

Foyer

Main Hall

Living Room

Dining Room

Family Room

Kitchen/Breakfast

Den/Library

Lower Landing

Comment:

9. Wall Paint

STANDARD SENATOR WHITE

Smooth Ceilings

☐ First Floor

☐ First Floor incl. Second Floor Hall

☐ First and Second Floor

☒ Throughout

☐ Not Applicable

Trim Paint:

10. Additional Comments

11. Disclaimers and Notes

- Colours of all materials are as close as possible to builder's selection, but not necessarily identical due to variances in manufacturing.
- Any extras listed above are null and void unless accompanied by a separate invoice/amendment. Said invoice must be paid in full.
- The Purchaser acknowledges that after Interior Colour Selection form is signed and dated, no further changes will be permitted other than re-selection due to unavailability. AA BIB Purchaser's Initials
- The Purchaser acknowledges reading and accepting the "Senator Homes Décor Centre Disclaimers" form. This document contains other miscellaneous disclaimers.

This Interior Colour Selection is final and approved by:

Purchaser:

Signature: [Signature] Date: Feb 6, 2016

Signature: [Signature] Date: Feb 6, 2016 Vendor: [Signature]

Teefy Developments Limited

Feb 11, 16

SENATOR HOMES - TEEFY

new

chimney hood fan

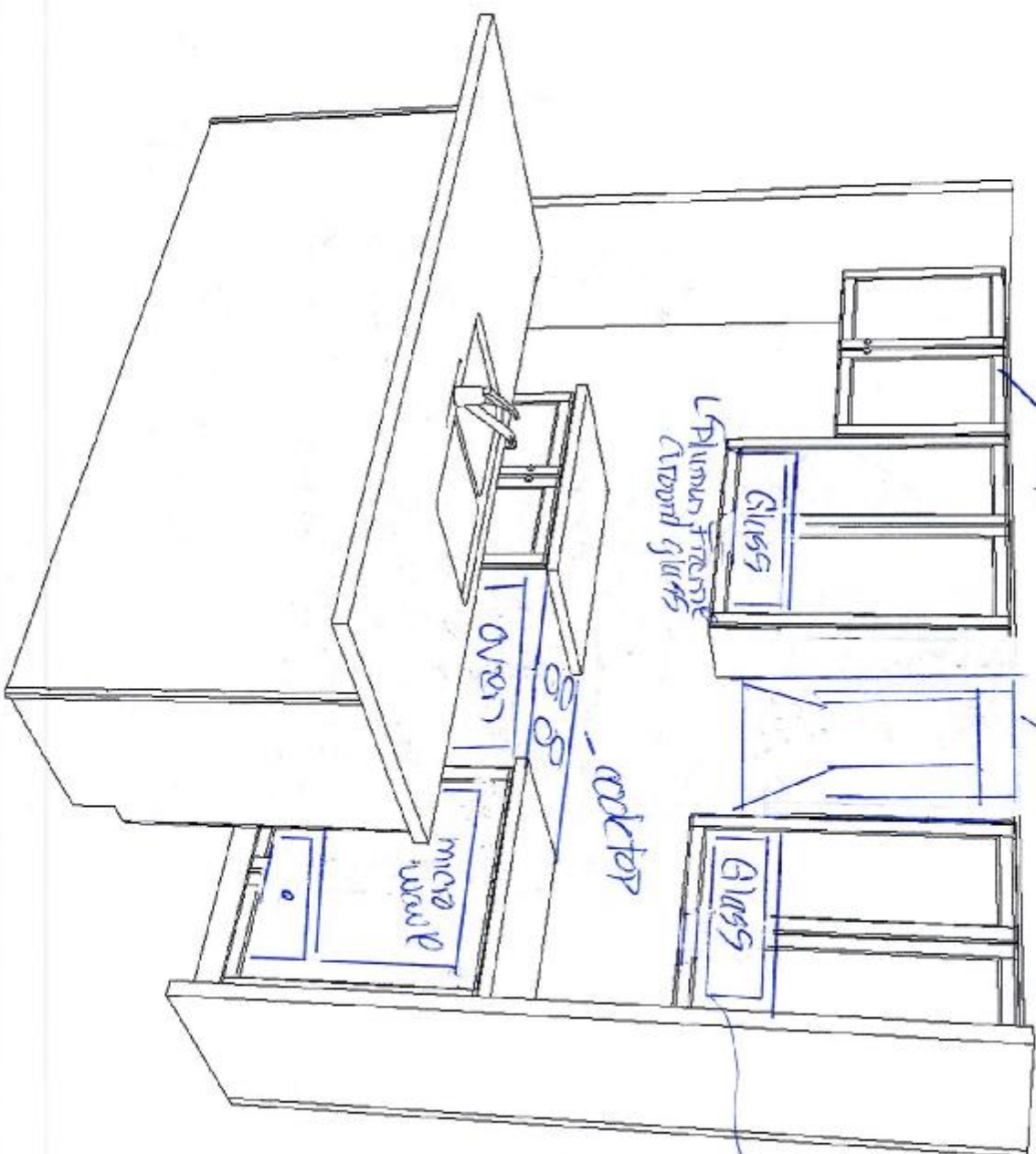

plummet fixture around glass

rock top

glass plummet fixture around glass

STD. LAYOUT

CLAREMONT - TH-19-3

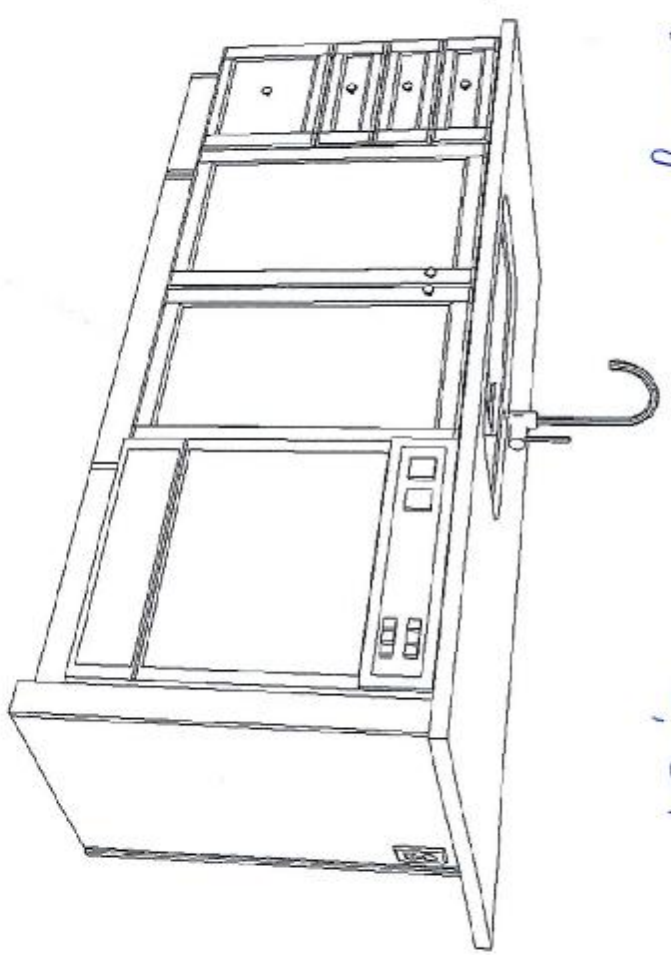

SENATOR HOMES
DECOR CENTRE
DATE: FEB. 06 2016
INITIALS: P.A.

B.P.

**SENATOR HOMES
DECOR CENTRE**

DATE: _____

INITIALS: _____

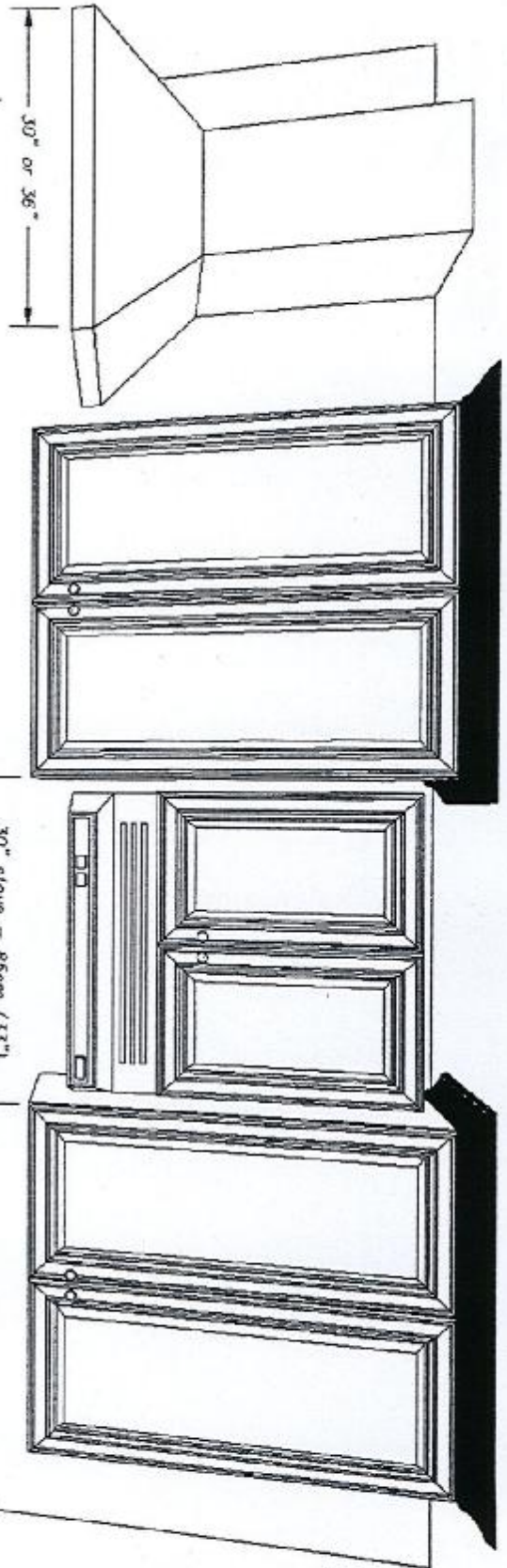

The standard 77cm. wide stove upper will be installed so the standard fan can be installed for occupancy purposes. Cabinet and fan will be removed by purchaser after closing. Builder will not be held responsible for any damage to wall or adjacent cabinetry after removal.

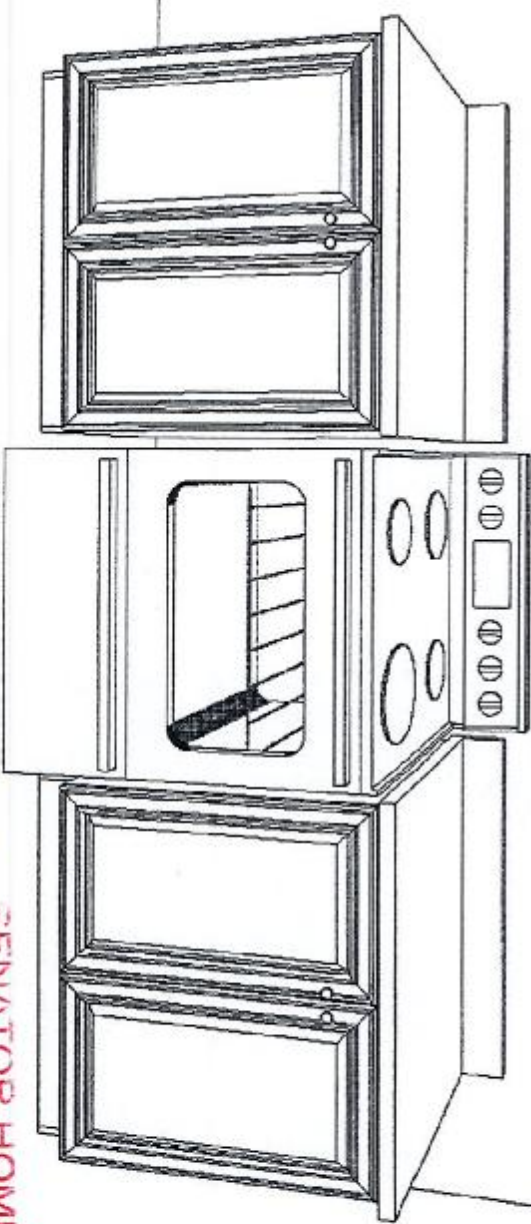

9130-hof115

**SENATOR HOMES
DECOR CENTRE**

DATE: _____

INITIALS: _____

20, AA



contrac

CATENA 20" RECTANGULAR UNDERMOUNT SINK

4210CIY Undermount Sink

Product Specs:

- Vitreous china
- Front overflow hole
- Template and mounting hardware supplied

Overall Dimensions (W x D x H):

(OD): 510mm(20") x 395mm(15½") x 190mm(7½")
(ID): 450mm(17¾") x 335mm(13¾") x 140mm(5½")

Compliance Certifications:

- Meets or exceeds the following:
- IAPMO cUPC
 - ASME A112.19.2 / CSA B45.1-2008

Shipping:

Cube 1.72
GW 27 lbs

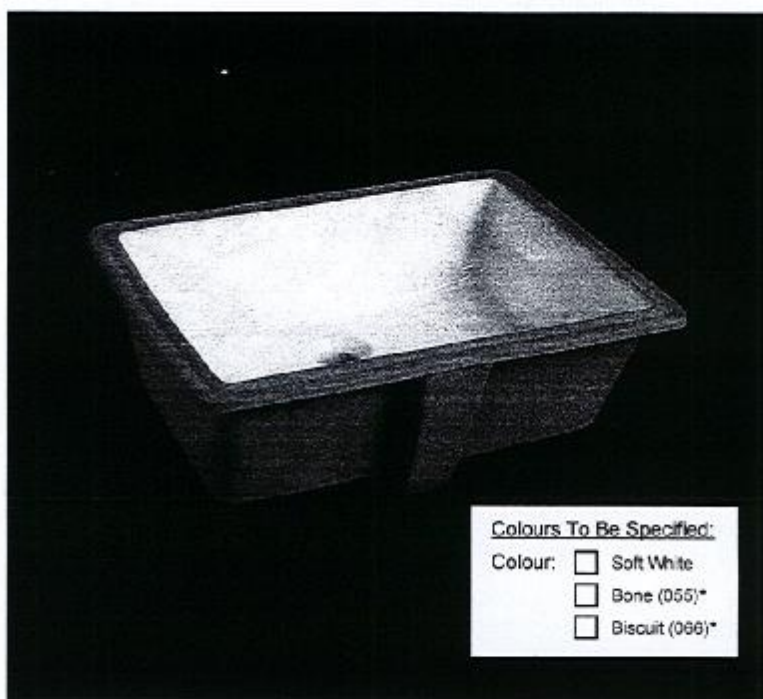

Colours To Be Specified:

- Colour: ☐ Soft White
☐ Bone (055)*
☐ Biscuit (066)*

Notes:

Dimensions of fixtures are nominal and may vary within the range of tolerances established by ASME standard A112.19.2. These measurements are subject to change or cancellation. No responsibility is assumed for use of superseded or voided pages.

*Bone and Biscuit available through Direct Import (DIF) only.

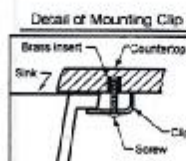

Note:
▲ Dimensions shown for location of supplies and "P" trap are suggested.

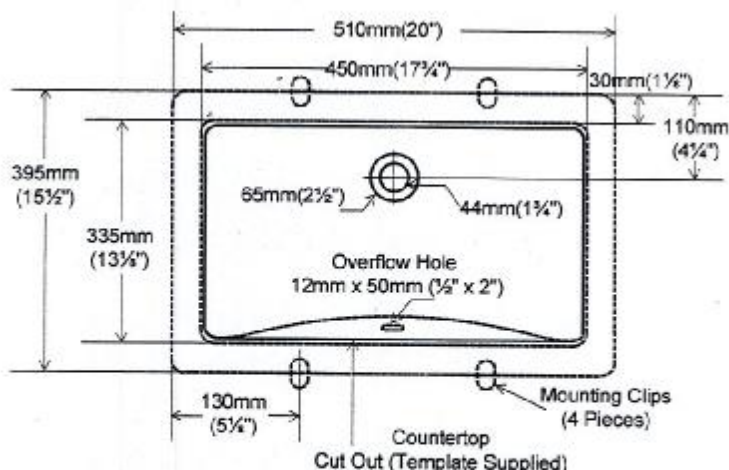
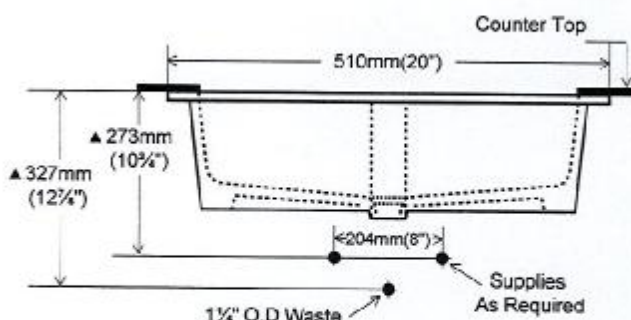
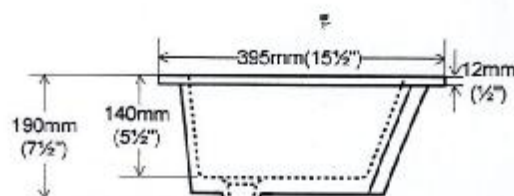

CONTRAC® 5970 Chedworth Way, Unit A, Mississauga, Ontario Canada L5R 3V5 • 1.888.256.7551
www.contrac.ca

Revised: January 2014

9130-Lot#15
SENATOR HOMES
DECOR CENTRE

DATE FEB 06 2015

INITIALS A.A

master ensuite (x2)
B.B.

CLAREMONT END

1755 SQ.FT.

9/30 hot 115

SENATOR HOMES
DECOR CENTRE

DATE: FEB 06 2016

INITIALS: A.A

BB

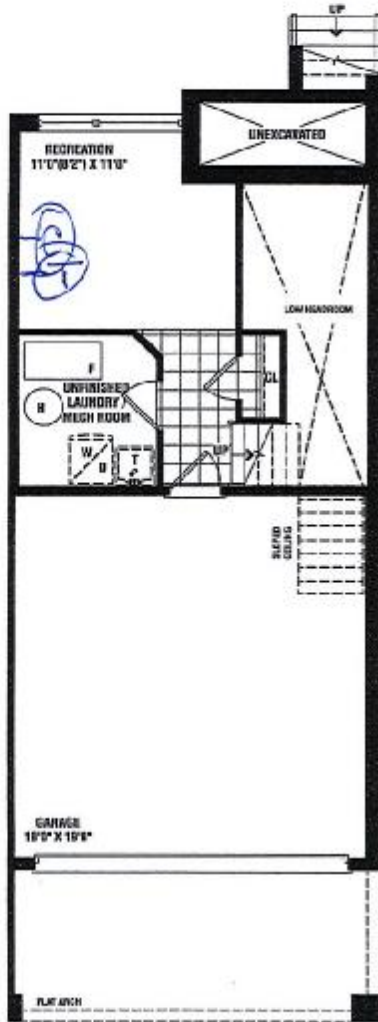

LOWER LEVEL
INTERIOR END CONDITION



MAIN FLOOR
INTERIOR END CONDITION

(C) cable
(I) telephone
(A) electrical plug



UPPER FLOOR
INTERIOR END CONDITION

SENATOR
HOMES

Renderings are artist's concept. Some elevations may vary from that shown. Actual usable square footage may vary from that stated herein. Some floorplans and elevations are mirror image to that shown. E.&O.E. 19-3

BB
A.A

French Door Refrigerator

E23BC78IPS professional series

DATE: FEB 06 2016

INITIALS: BB AA



Custom Temp Drawer™

Enjoy the ultimate in versatility with 9 preset selections including White/Sparkling Wine, Fish/Shellfish, Cheese plus three customizable settings that ensure foods stay at the ideal temperature for serving and maintaining freshness.



Custom-Design™ Organization System

With our flexible Tri-Level freezer organization system you can keep your freezer well organized. The three Smooth-Glide® baskets with removable dividers and top removable baskets allow you to configure the space to neatly fit large and small items.

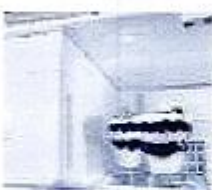

Theatre Lighting

Transition LED lighting gradually illuminates the interior with soft but ample light as you open the door.



PureAdvantage® Filtration Systems

Our filtration system keeps clean, filtered air circulated throughout to prevent odor transfer and keeps fresh, clean water and ice at your fingertips.

23 CU.FT. COUNTER-DEPTH
FRENCH DOOR REFRIGERATOR

CAPACITIES

Total Capacity	22.6 Cu. Ft.
Fresh Food Volume	15.7 Cu. Ft.
Freezer Volume	6.9 Cu. Ft.
Total Shelf Area	26.45 Sq. Ft.
Fresh Food Shelf Area	18.72 Sq. Ft.
Freezer Shelf Area	7.7 Sq. Ft.

EXTERIOR

Professional Doors and Handle Design	Yes
Wave-Touch® Electronic Controls	Yes
Door Hinge Covers	Yes
Ice/Water Dispenser	Yes
Custom-Set™ Temperature Control System and Display	Yes
Crushed/Cubes/Water	Yes
Air and Water Filter Indicator/Reset	Yes
Ice Maker On/Off	Yes
Fast Freeze™	Yes
Lock/Dispenser Light Control	Yes/Yes

FRESH FOOD CONVENIENCES

PureAdvantage® Water & Ice / Air Filtration	Yes
Water Filter Location	Bottom Left
Temp Alarm System / Door Ajar Alarm / Power Failure Alarm	Yes
Custom-Design™ Glass Shelves	3 Half Width 1 Quarter Width
Smooth-Glide® Humidity-Controlled Left Crisper	Yes
Smooth-Glide® Humidity-Controlled Right Crisper	Yes
Custom Temp Drawer™	Yes
Wine Rack	Yes
Clear Gallon Adjustable Door Bins	1
Clear 1/2-Gallon Adjustable Door Bins	1
Clear 2-Liter/1/2-Gallon Removable Door Bins	2
Locking Clear Utility Bin	Yes
Till-Out Can Rack	2
Theatre Ramp-Up Multilevel Lighting – LED	Yes
Automatic Ice Maker	Yes

FREEZER CONVENIENCES

Self-Closing Drawer	Yes
Sliding Full-Width Freezer Baskets	3 Smooth-Glide® (2 with Dividers)
Plastic Basket Tray	1
Till-Out Wire Door Racks	1
Theatre Ramp-Up Multilevel Lighting – LED	Yes

ADDITIONAL FEATURES

ENERGY STAR®	Yes
Sabbath Mode (Shut-Off Certified)	Yes

ACCESSORIES

Coiler Kit – PN# ECK23CDS*	Optional
Louvered Trim Kit – PN# 241723001*	Optional
Water Filter Replacement Cartridge – PN# EWF01	Optional
Air Filter Replacement Cartridge – PN# EAF0BF	Optional

SPECIFICATIONS

Overall Exterior Dimensions –	
Height (with Hinges and 3/8" Rollers)	69-1/2"
Cabinet Width/Door Width	35-5/8"/36"
Depth (including Handle)	29-1/2"
Depth (with 90° Doors Open)	42-3/16"
Depth (with Drawer Fully Extended)	44-1/2"
Power Supply Connection Location	Right Bottom Rear
Water Inlet Location	Left Bottom Rear
Voltage Rating	120V/60Hz/15 or 20A
Connected Load (KW Rating) @ 120 Volts†	1.02
Minimum Circuit Required (Amps)	15
Shipping Weight (Approx.)	348 Lbs.

*For detailed Louvered Trim Kit and Coiler Kit installation instructions, refer to Product Installation Guides on the web at electroluxicon.com

†An electrical supply with grounded three-prong receptacle is required. The power supply circuit must be installed in accordance with current edition of National Electrical Code (NFPA 70) and local codes & ordinances.

NOTE: Always consult local and national electric and plumbing codes. Refer to Product Installation Guide for detailed installation instructions on the web at electroluxicon.ca. Specifications subject to change.

French Door Refrigerator

E23BC781PS professional series

4130-LOT 115
SENATOR HOMES
DECOR CENTRE

DATE FEB 05 2016

INITIALS: B D A A

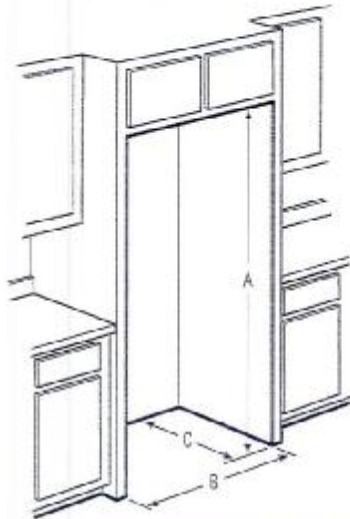

"Built-In Look" Cutout Dimensions

(A) 70 1/4" (B) 36" (C) 25"

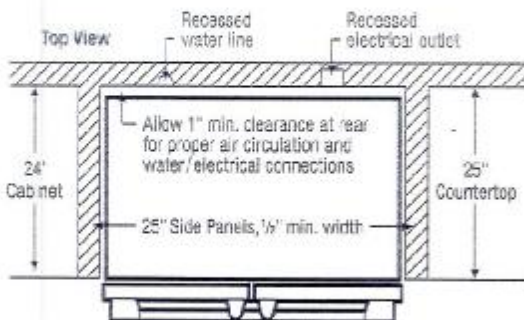

Standard Refrigerator Depth vs. Counter Depth

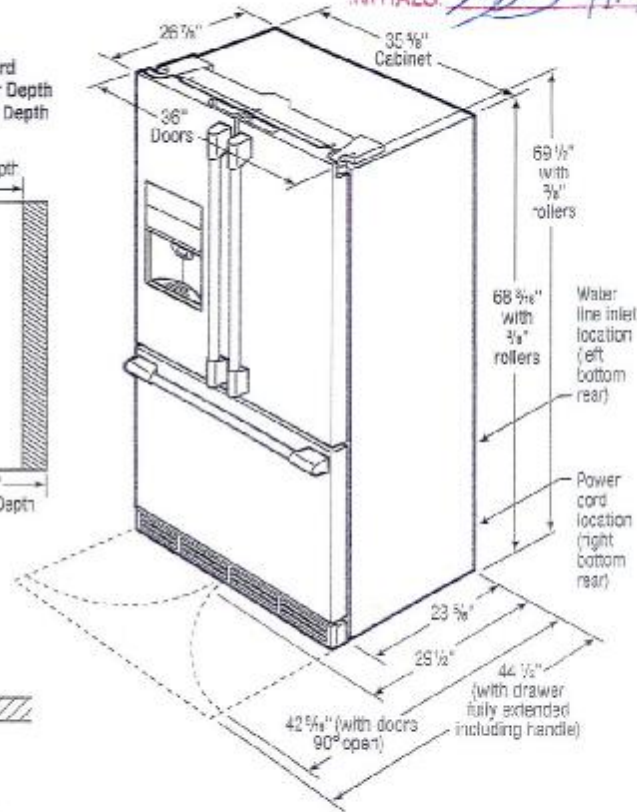

Note: Optional Louvered Trim Kit and Collar Kit available for French Door Counter-Depth Refrigerator. For specifications, refer to Louvered Trim Kit (241723001) Installation page or Collar Kit (ECK23CDS) Installation page on web.

Counter-Depth French Door Refrigerator Specifications

- Product Weight – 338 Lbs.
- An electrical supply with grounded three-prong receptacle is required. The power supply circuit must be installed in accordance with current edition of National Electrical Code (NFPA 70) and local codes & ordinances.
- Voltage Rating – 120V/60Hz/15 or 20 Amps
- Connected Load (kW Rating) @ 120 Volts = 1.02 kW
- Amps @ 120 Volts = 8.5 Amps
- Always consult local and national electric & plumbing codes.
- Floor should be level surface of hard material, capable of supporting fully loaded refrigerator.
- When installing refrigerator adjacent to wall, cabinet or other appliance that extends beyond front edge of unit, 20" minimum clearance recommended to allow for optimum 120° to 180° door swing, providing complete drawer/crisper access and removal. (Absolute 4-1/2" minimum clearance will ONLY allow for 90° door swing which will provide drawer/crisper access with restricted removal.)
- To ensure optimum performance, avoid installing in direct sunlight or close proximity to range, dishwasher or other heat source.
- For proper ventilation, front grille MUST remain unobstructed.
- Recess electrical outlet when possible.
- Water recess on rear wall recommended to prevent water line damage.
- Water Pressure – Cold water line must provide between 30 and 100 pounds per square inch (psi).

- Copper tubing with 1/4" O.D. recommended for water supply line with length equal to distance from rear of unit to household water supply line plus 7 additional feet. Optional Water Supply Installation Kits available.
- Adjustable front rollers to assist with door alignment.
- If optional Collar Kit (PN# ECK23CDS) is to be used, different cutout dimensions are required. (Refer to Collar Kit ECK23CDS Installation Specifications page on web.)
- If optional Louvered Trim Kit (PN# 241723001) is to be used, different cutout dimensions are required. (Refer to Louvered Trim Kit 241723001 Installation Specifications page on web.)

"Built-In Look" Specifications

- Minimum opening of 70-1/4"H x 36"W x 25"D required to allow for ease of installation, proper air circulation, and plumbing/electrical connections.
- Remove all wall/floor molding prior to installation.

Note: For planning purposes only. Refer to Product Installation Guide on the web at electroluxcan.ca for detailed instructions.

Optional Accessories

- Collar Kit – (PN# ECK23CDS).
- Louvered Trim Kit – (PN# 241723001).
- PureAdvantage® Water Filter Replacement Cartridge – (PN# EWF01).
- PureAdvantage® Air Filter Replacement Cartridge – (PN# EAF01).



Electrolux Major Appliances, N.A.

CANADA • 5955 Terry Fox Way • Mississauga, ON L5V 3E4 • 1-800-265-8352 • electroluxcan.ca

High standards of quality at Electrolux Major Appliances, N.A. mean we are constantly working to improve our products. We reserve the right to change specifications or discontinue models without notice.



Electrolux

9130- Lot 115
 SENATOR HOMES
 DECOR CENTRE
 DATE 10 FEB 06 2016

GAS COOKTOP

EW30GC60PS

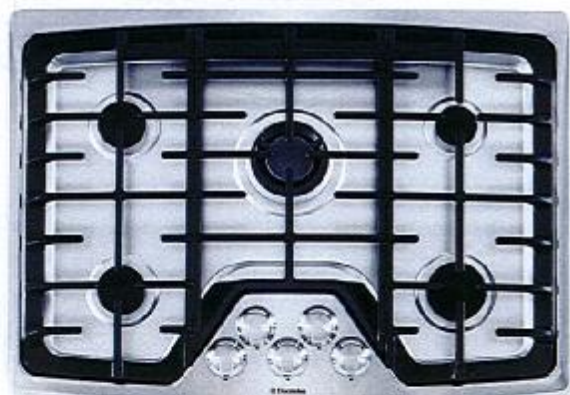

PRODUCT DIMENSIONS

Width	30"
Depth	21 3/4"
Height (Extreme Bottom to Underside of Cooktop)	4-1/4"

MORE EASY-TO-USE FEATURES

SEALED BURNERS

ELECTRIC PILOTLESS IGNITION

PLATINUM STAR® LIMITED WARRANTY

Our exclusive limited warranty that includes a 3-year coverage on parts and one year on labor without charge.*

PERFECT OVER A WALL OVEN

Mounts above a single wall oven for additional installation options.

DISHWASHER-SAFE GRATES

For easy cleanup.

Available in:



Stainless
 (S)

SIGNATURE FEATURES



MIN-2-MAX® GAS BURNER

Designed with a dual-flame sealed burner, this cooktop offers the widest range of BTU performance in the industry for the utmost versatility — from a roaring 20,000-BTU boil to a 1,100-BTU simmer.



PROFESSIONAL-GRADE CONTROL KNOBS

Professional-grade control knobs are designed to provide you with pinpoint precision control.



DEEP-WELL DESIGN

Keeps spills contained for easy cleanup and lowers the cooking surface to countertop-level, which makes moving oversized pots and pans onto and off of the cooking surface much easier.



CONTINUOUS GRATES

Designed for cooking multiple dishes at varying temperatures on a single cooktop. These grates allow easy movement of even the heaviest pots and pans from burner to burner — without lifting.

BURNER

BTU

Min-2-Max Dual-Flame Sealed Burner®	20,000 - 1,100
Sealed Power Burner	12,000
Sealed Precision Burner	9,500
Sealed Precision Burner	7,500
Sealed Precision Burner	5,000 - 750

*Warranty based on product registration with Electrolux North America within 60 days of purchase. Products must have been purchased on or after July 1, 2012. Coverage includes material parts for 3 years and labor for 1 year.

ELECTROLUXAPPLIANCES.CA

GAS COOKTOP
EW30GC60PS



30" GAS COOKTOP

FEATURES

Deep-Well Formed Cooktop	Yes
Professional-Grade Burner Controls	Yes
Continuous Grates	Yes
Min-2-Max-Dial Flame Sealed Burner* - 20,000 - 1,100 BTU	1
Sealed Power Burner - 12,000 BTU	1
Sealed Precision Burner - 9,600 BTU	1
Sealed Precision Burner - 7,600 BTU	1
Sealed Precision Burner - 5,000 - 750 BTU	1
Linear Flow Burner Valves	Yes
Electric Pilotless Ignition	Yes

ACCESSORIES

Granite Countertop Installation Kit - P/N# 903103-8010	Optional
Unit Griddle - P/N# 318251614	Mail-In Card
LP Gas Conversion Kit	Included

SPECIFICATIONS

Colour -	
Stainless Steel	S
Gas/Power Supply Connection Location	Right Bottom Rear
Voltage Rating	120V/60 Hz/15A
Connected Load (kW Rating) @120 Volts	.12
Electrical Cable	Yes
Approved for Single Oven Combination Installation*	Yes
Shipping Weight (Approx.)	56

*N.E.A. always consult local and national electrical and gas codes. Refer to Product Installation Guide for detailed installation instructions on the wall at electroluxappliances.ca.
For gas an adequately sized CNG regulated (certified) having 2 year service with a separate ground wire.
Appliance must be grounded for safe operation.
Specifications subject to change.

*Electrolux Inc. does not accept responsibility for any damage.

SENATOR HOMES
DECOR CENTRE
FEB 06 2016
9130-Lot
115

DATE: _____
INITIALS: A.A BB



PRODUCT DIMENSIONS

Width	30"
Depth	21-3/4"
Height (Excess Bottom to Underside of Cooktop)	4-1/4"

Electrolux Major Appliances, N.A.

CANADA • 6855 Terry Fox Way • Mississauga, ON L5V 3E1 • 1-800-265-8352 • electroluxappliances.ca

EW30GC60PS 05/15

© 2015 Electrolux Major Appliances, NA



High standards of quality at Electrolux Home Products, Inc. mean we are constantly working to improve our products. We reserve the right to change specifications or discontinue models without notice.



Electrolux | ICON

9130- Lot 115
SENATOR HOME'S
DECOR CENTRE

DATE: FEB 06 2016

INITIALS: BB A A

Single Wall Oven

professional series

E30EW75PPS



PRODUCT DIMENSIONS

Height	29"
Width	30"
Depth	24-3/4"

MORE EASY-TO-USE FEATURES

Large Capacity

Coordinate an entire meal — our ovens feature 4.8 cu. ft. of cooking space with three adjustable baking racks.

Flat Oven Door Design

Our unique flat oven door is sleekly designed with fewer bumps and ridges — so it not only looks great but is easier to clean.

Smooth-Glide® Oven Racks

With a ball bearing system, the oven racks are so smooth they extend effortlessly.

Rapid Preheat

Savor sooner, with Rapid Preheat.

Precise Baking Options

Includes Defrost, Dehydrate, Broast Proof, My Favourites, Multi-Stage Cooking, Temperature Probe, Fast Preheat, Delay Bake and Convection Convert.

Platinum Star® Limited Warranty

Our exclusive limited warranty that includes a 3-year coverage on parts and one year on labour without charge¹.

Signature Features



Perfect Taste™ Dual Convection

For consistently delicious taste and texture, home chefs rely on our dual-fan convection heat, which circulates air evenly with two variable speeds that work in tandem with three heating elements.



Perfect Taste™ Temp Probe

The Perfect Taste™ Temp Probe does more than measure temperature — it keeps an active eye on your dishes by alerting you when food is at the peak of perfection and automatically adjusting to the Keep Warm setting.



Multi-Stage Cooking

Create great taste with ease. With Multi-Stage Cooking, an Electrolux ICON® oven is a built-in sous chef, helping you conquer delicious by adjusting between seven professionally inspired cooking modes, including Bake, Broil, Convection Bake, Convection Roast, Convection Broil, Keep Warm and Slow Cook.



Self-Cleaning Porcelain Racks

Bake, roast, broil, savor — the cleaning's on us. Our porcelain racks are safe to stay inside of the oven during the self-clean cycle, eliminating the mess and inconvenience of removing and cleaning racks by hand.

¹Warranty based on product registration with Electrolux North America within 90 days of purchase.

electroluxicon.ca

E30EW75PPS professional series



Electrolux ICON

9/30 Lot 15

SENATOR HOMES
DECOR CENTRE

DATE: FEB 06 2016

INITIALS: B.B.
A.A.

OVEN FEATURES

CONTROL PANEL FEATURES

DOOR STYLE

ADDITIONAL FEATURES

SPECIFICATIONS

[illegible]

Always consult local and national electric codes. Refer to Product Installation Guide for detailed installation instructions on the wall of non-flammable.

Specifications subject to change.

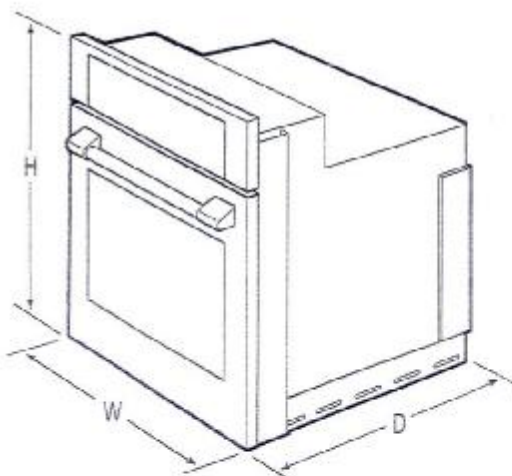

NOTE: Always consult local and national electric codes. Refer to Product Installation Guide for detailed installation instructions on the web at electroflux.com.

Height	29"
Width	30"
Depth (including Door)	24-3/4"
(with Door Open 90°)	45-3/4"

Height	17-1/2"
Width	24-1/8"
Depth	18-1/2"



E3CEW75PPS 08/15

© 2015 Electrolux Major Appliances, N.A.

Printed in Canada

High standards in quality at Electronic Home Products, Inc., mean we are constantly working to improve our products. We reserve the right to change specifications or discontinue models without notice.

9130-107115
SENATOR HOMES
DECOR CENTRE

DATE: FEB 06 2016

INITIALS: B.A.

Login



NN-SD797S

Mid Size Genius® Prestige® Inverter® Microwave

\$419.99

ADD TO CART

[Previous](#)

[Next](#)

PRODUCT INFORMATION

- New Blue LED light dial control system
- Stainless steel fingerprint resistant coating

- 1.6 cu. ft.
- 1200 Watts
- New half mirror door deco
- Menu action screen
- Sensor reheat
- Sensor cook (15 categories)
- Inverter® Turbo defrost
- Popcorn key
- Keep warm
- Function key
- Optional stainless steel trim kit available
- Exterior Dimensions (H x W x D): 304 x 555 x 493 mm
- Compatible with trimkit(s): NNTK714SS, NNTK722S, NNTK732S

9130-LOT115
SENATOR HOMES
DECOR CENTRE
DATE: FEB 08 2016
INITIALS: BB AA

Back to top

Province: ON ▾



9130 Lot 115
SENATOR HOMES
DECOR CENTRE
DATE: FEB 06 2016
INITIALS: BB AA

MWTK-60
24" Stainless Steel Trim Kit

Porter & Charles



MWTK-60

4130 LOT 115
SENATOR HOMES
DECOR CENTRE
FEB 06 2016

24" / 60cm Stainless Steel Trim Kit

1. Unscrew the 4 screws holding the 2 pieces of wood in place, and retain the screws
2. Hold the MWTK-60 in place and position the 2 pieces of wood against the cabinet sides and against the MWTK. Remove the MWTK
3. Screw the 2 pieces of wood onto the base of the cabinet. The wooden strips should touch the inside of the front of the MWTK-60, and be aligned against the side gables.
(wooden stripes 18" = 46cm apart)
4. Being careful not to scratch the microwave door, lift the microwave onto the wooden strips, and move it back about 2 inches.
5. Place the MWTK-60 into position. Use the 4 screws and screw them through the flanges into the side gables.
6. Pull the microwave forward, and align the front of the microwave with the front of the MWTK-60
7. To stop the microwave from sliding backwards whilst opening it, it might be necessary to attach a piece of wood behind the feet of the microwave, on the wooden supports
8. Air must be able to flow from the microwave upwards and into the room, or roof space. Failure to comply will void the manufacturer's warranty on the micro wave oven.

Porter&Charles

MWTK-60

9130-60115
SENATOR HOMES
DECOR CENTRE

DATE: FEB 06 2016

INITIALS:

BOB A.A

24" / 60cm Stainless Steel Trim Kit

- For use with Panasonic microwave NNSD797 or equivalent
- Wooden support provided with MWTK60 kit
- Please keep and reuse wood screws provided with the kit

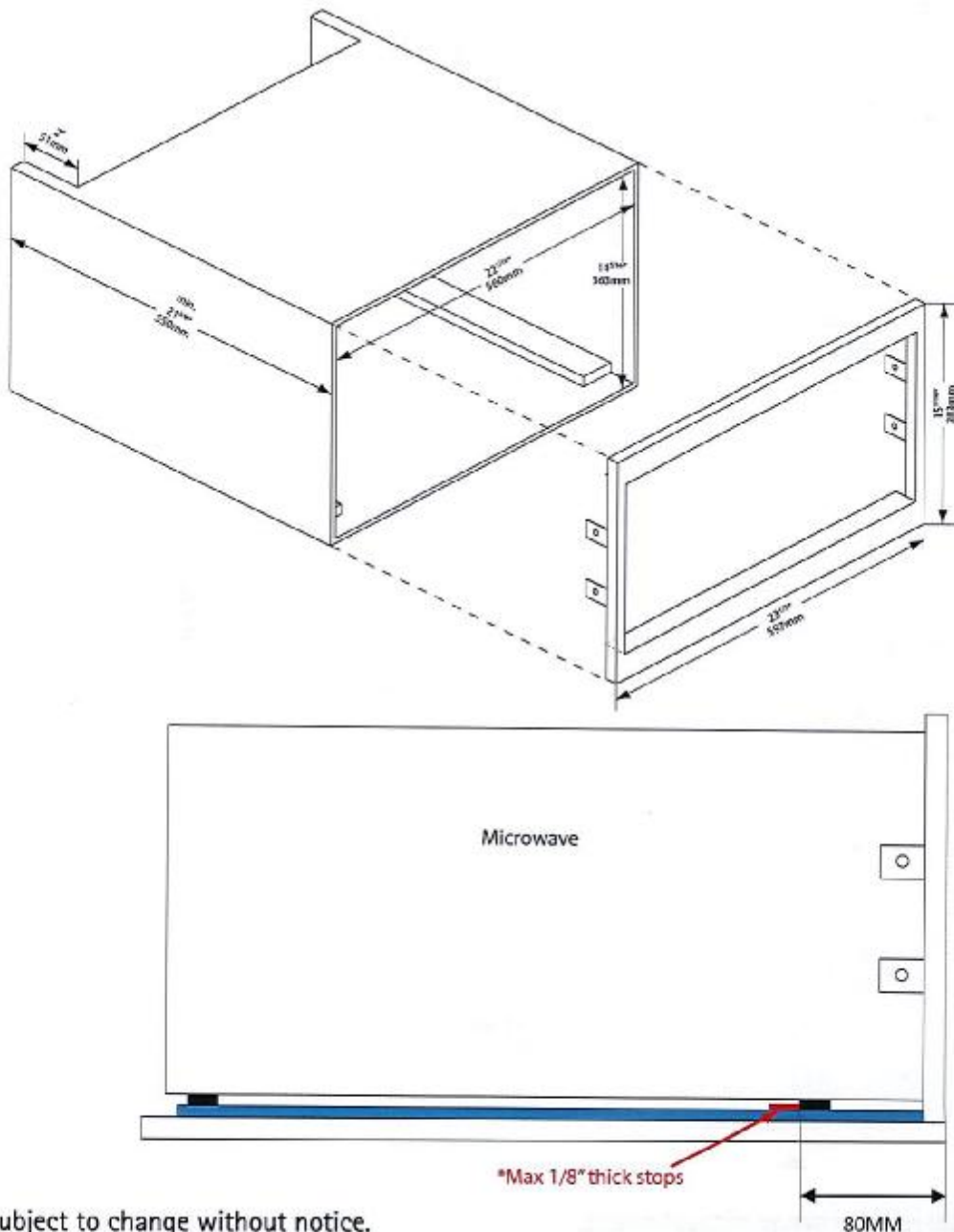

Specifications are subject to change without notice.

Detailed Specification Available at www.porterandcharles.ca

Porter&Charles

MWTK-60

4130-LA-115
SENATOR HOMES
DECOR CENTRE

DATE FEB 06 2016

BB A.A

24" / 60cm Stainless Steel Trim Kit

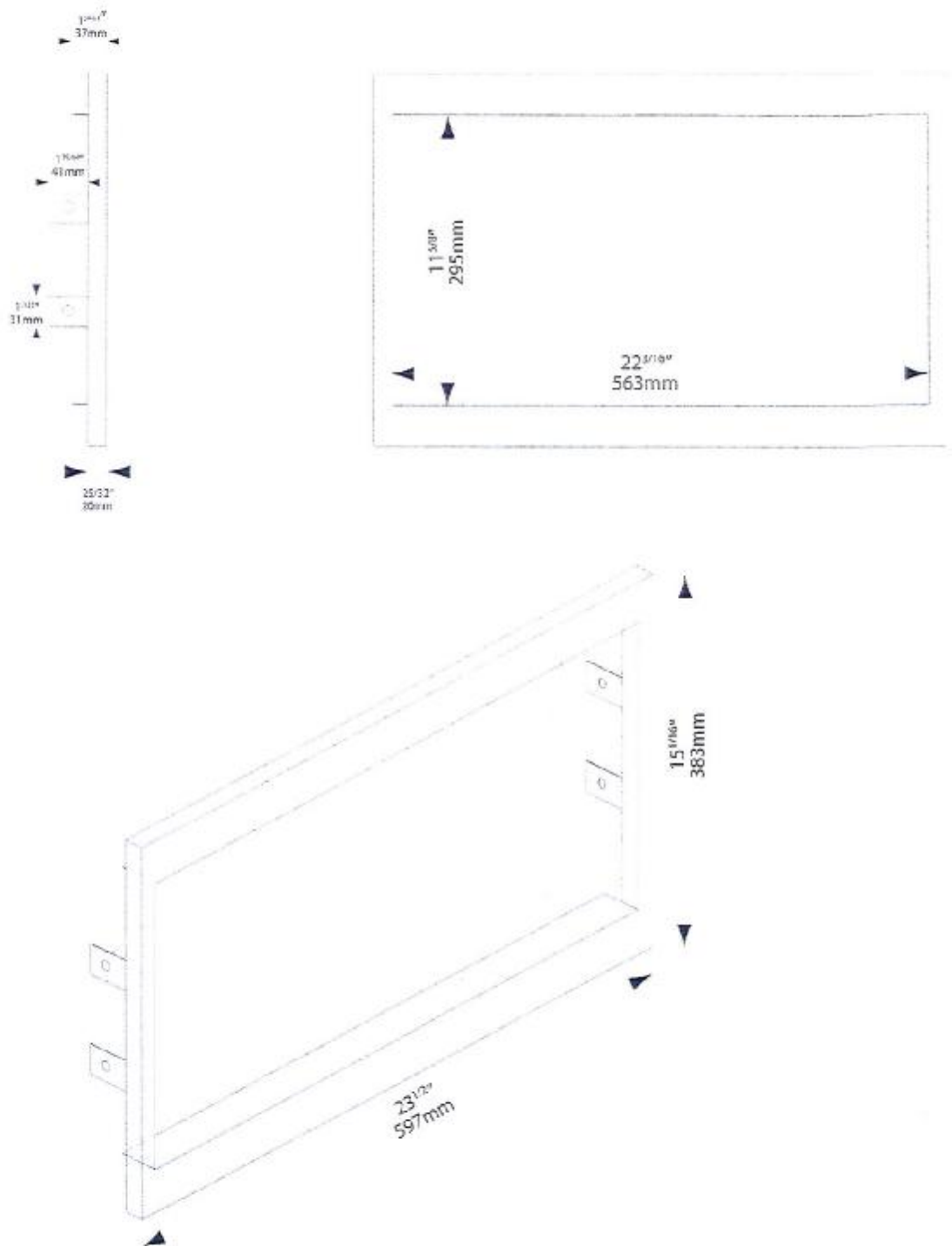

Specifications are subject to change without notice.
Detailed Specification Available at www.porterandcharles.ca

Porter&Charles

Specifications: Alito Collection - Wall Mount

Model: SC514

9130- Lot 115
SENATOR HOMES
DECOR CENTRE
DATE: FEB 06 2016
INITIALS: A.A
BB

