



CONSTRUCTION SUMMARY

Teefy Developments Limited / 9130 Bathurst

Lot/Unit: 66    Phase/Building: 1    Model/Floor Plan: Belmont(22-1)

CABINETRY

Inv.3445	1 - SUPPLY AND INSTALL 120CM EXTENDED CABINETS TO THE KITCHEN IN LEVEL 1	
Line 44561	Note:	
18Dec15 / 19Dec15		

CABINETRY ACCESSORIES

Inv.3445	1 - SUPPLY AND INSTALL DIFFERENT COLOUR ISLAND THAN KITCHEN COLOUR	
Line 44574	Note:	
18Dec15 / 19Dec15		

CABINETRY APPLIANCE - FRIDGE

Inv.3445	1 - SUPPLY AND INSTALL KITCHEN 59 CM FRIDGE CABINET - 1 GABLE & CABINET 59 CM DEEP - DEEP - UPGRADE 1	
Line 44566	Note: LOCATION AS PER SKETCH	
18Dec15 / 19Dec15		

CABINETRY BASE CABINETS

Inv.3445	1 - SUPPLY AND INSTALL TOP DRAWER PRICE PER DRAWER AND DUMMY DRAWER FRONTS - UPGRADE 1 TO THE KITCHEN	
Line 44591	Note: LOCATION AS PER SKETCH ATTACHED	
18Dec15 / 19Dec15		
Inv.3445	3 - SUPPLY AND INSTALL ADDITIONAL THREE FEET OF BASE CABINET TO THE ISLAND - PRICE IS PER FOOT - UPGRADE 1	
Line 44562	Note:	
18Dec15 / 19Dec15		

CABINETRY MICROWAVE OVEN STOVE COOKTOP

Inv.3445	1 - SUPPLY AND INSTALL BUILT IN DOUBLE APPLIANCE CABINET WITH DRAWER BELOW - TRIM KIT REQUIRED - PURCHASER MUST SUPPLY SPECS - UPGRADE 1	
Line 44559	Note: LOCATION AS PER SKETCH ATTACHED	
18Dec15 / 19Dec15		
Inv.3445	1 - SUPPLY AND INSTALL COOKTOP CABINET (FULL HEIGHT) WITH FALSE TOP DRAWER AND DOORS BELOW - PURCHASER MUST SUPPLY SPECS - UPGRADE 1	
Line 44565	Note:	
18Dec15 / 19Dec15		

CABINETRY MISCELLANEOUS

Inv.3445	1 - SUPPLY AND INSTALL KITCHEN FASCIA CEILING PANELS FOR CROWN MOULDING. (PRICE INCLUDES STANDARD CROWN MOULDING)	
Line 44560	Note:	
18Dec15 / 19Dec15		

CABINETRY PANTRY

Inv.3445	2 - SUPPLY AND INSTALL APPROXIMATELY TWO [2] FEET +/- OF KITCHEN PANTRY 59 CM DEEP - PRICE IS PER FOOT - UPGRADE 1	
Line 44597	Note: LOCATION AS PER SKETCH ATTACHED	
18Dec15 / 19Dec15		

CABINETRY VANITY



CONSTRUCTION SUMMARY

Teefy Developments Limited / 9130 Bathurst

Lot/Unit: 66    Phase/Building: 1    Model/Floor Plan: Belmont(22-1)

Inv.3445	1 - SUPPLY AND INSTALL VANITY BANK OF DRAWERS - 55 CM MAXIMUM - UPGRADE 1 TO THE MASTER ENSUITE	
Line 44592	Note: LOCATION AS PER SKETCH	
18Dec15 / 19Dec15		

COUNTER TOP - KITCHEN

Inv.3445	1 - SUPPLY AND INSTALL THREE [3] ADDITIONAL FEET OF 3CM STONE COUNTEROP WITH STANDARD SQUARE EDGE – GROUP 2 IN THE KITCHEN ISLAND AND FLUSH BREAKFAST BAR	
Line 44573	Note: LOCATION AS PER SKETCH	
18Dec15 / 19Dec15		
Inv.3445	3 - SUPPLY AND INSTALL GRANITE CUTOUT AND POLISHED EDGE FOR UNDERMOUNT SINK TO THE: - POWDER ROOM - MASTER ENSUITE [X2]	
Line 44580	Note: UNDERMOUNT SINK PURCHASED SEPARATELY.	
18Dec15 / 19Dec15		

COUNTER TOP - VANITY

Inv.3445	1 - SUPPLY AND INSTALL 2CM STONE COUNTEROP WITH STANDARD SQUARE EDGE – GROUP 2 IN THE POWDER ROOM	
Line 44593	Note:	
18Dec15 / 19Dec15		
Inv.3445	1 - SUPPLY AND INSTALL 2CM STONE COUNTER TOP WITH STANDARD SQUARE EDGE – GROUP 3 IN THE ENSUITE - BATHROOM	
Line 44594	Note:	
18Dec15 / 19Dec15		

ELECTRICAL

Inv.3445	1 - SUPPLY AND INSTALL ADDITIONAL INTERIOR RECEPTACLE (NOT SEPARATE CIRCUIT) OVER THE STANDARD FIREPLACE APPROXIMATELY 66" +/- FROM FLOOR	
Line 44552	Note: LOCATION AS PER SKETCH ATTACHED.	
18Dec15 / 19Dec15		
Inv.3445	1 - SUPPLY AND INSTALL ADDITIONAL INTERIOR GROUND FAULT RECEPTACLE TO THE END OF THE KITCHEN ISLAND.	
Line 44553	Note: LOCATION AS PER SKETCH ATTACHED.	
18Dec15 / 19Dec15		
Inv.3445	1 - SUPPLY AND INSTALL CAPPED CEILING LIGHT ROUGH-IN ONLY ON EXISTING SWITCH. TERMINATE CONNECTION TO SWITCHED OUTLET (OUTLET TO REMAIN) AND USE EXISTING SWITCH TO THE FORMAL ROOM.	
Line 44554	Note: LOCATION AS PER SKETCH ATTACHED.	
18Dec15 / 19Dec15		
Inv.3445	2 - SUPPLY AND INSTALL CAPPED CEILING LIGHT ROUGH-IN ONLY ON SEPARATE SINGLE SWITCH TO THE: - FAMILY ROOM - BREAKFAST BAR	
Line 44555	Note: LOCATION AS PER SKETCH ATTACHED.	
18Dec15 / 19Dec15		



CONSTRUCTION SUMMARY

Teefy Developments Limited / 9130 Bathurst

Lot/Unit: 66    Phase/Building: 1    Model/Floor Plan: Belmont(22-1)

Inv.3445	1 - SUPPLY AND INSTALL KITCHEN LIGHT VALANCE ROUGH IN (INCLUDES 1 SWITCH)	
Line 44557	Note: LOCATION AS PER SKETCH ATTACHED.	
18Dec15 / 19Dec15		
Inv.3445	1 - SUPPLY AND INSTALL ADDITIONAL INTERIOR RECEPTACLE ON SEPARATE CIRCUIT FOR FUTURE BUILT-IN WALL OVEN	
Line 44563	Note: LOCATION AS PER SKETCH ATTACHED.	
18Dec15 / 19Dec15		

FIREPLACE

Inv.3445	1 - SUPPLY AND INSTALL STANDARD FIREPLACE APPROXIMATELY 17" +/- FROM THE FLOOR IN THE FAMILY ROOM	
Line 44556	Note:	
18Dec15 / 19Dec15		

HARDWOOD

Inv.3445	1 - SUPPLY AND INSTALL HARDWOOD - UPGRADE 1 - SATIN FINISH GEN. - HOME OAK 3 5/8 INCH X 3/4 INCH - STAIN - - BEDROOM 2	
Line 44581	Note:	
18Dec15 / 19Dec15		
Inv.3445	1 - SUPPLY AND INSTALL HARDWOOD - UPGRADE 1 - SATIN FINISH GEN. - HOME OAK 3 5/8 INCH X 3/4 INCH - STAIN - - BEDROOM 3	
Line 44582	Note:	
18Dec15 / 19Dec15		
Inv.3445	1 - SUPPLY AND INSTALL HARDWOOD - UPGRADE 1 - SATIN FINISH GEN. - HOME OAK 3 5/8 INCH X 3/4 INCH - STAIN - - MASTER BEDROOM	
Line 44583	Note:	
18Dec15 / 19Dec15		

HEATING AND AIR CONDITIONING

Inv.3445	1 - SUPPLY AND INSTALL GAS LINE - ROUGH-IN ONLY - FIRST CONNECTION- FOR BBQ	
Line 44571	Note: LOCATION AS PER SKETCH ATTACHED	
18Dec15 / 19Dec15		

MISCELLANEOUS

Inv.3445	1 - DELETE DO NOT INSTALL AND DO NOT SUPPLY CLOSET SHELVES OR RODS THROUGHOUT	
Line 44572	Note:	
18Dec15 / 19Dec15		

PLUMBING

Inv.3445	1 - SUPPLY AND INSTALL WATERLINE ROUGH-IN TO THE FRIDGE LOCATION (NO HOOK UP)	
Line 44595	Note: LOCATION AS PER SKETCH ATTACHED.	
18Dec15 / 19Dec15		



CONSTRUCTION SUMMARY

Teefy Developments Limited / 9130 Bathurst

Lot/Unit: 66    Phase/Building: 1    Model/Floor Plan: Belmont(22-1)

Inv.3445	3 - SUPPLY AND INSTALL CONTRAC CATENA 20" RECTANGULAR UNDERMOUNT SINK MODEL 4210CIY TO THE: - POWDER ROOM - MASTER ENSUITE [X2]	
Line 44579	Note:	
18Dec15 / 19Dec15		

TILE - FLOOR

Inv.3445	1 - SUPPLY AND INSTALL FLOOR TILE - UPGRADE 4 - - ENSUITE BATHROOM FLOOR	
Line 44587	Note:	
18Dec15 / 19Dec15		
Inv.3445	1 - SUPPLY AND INSTALL FLOOR TILE - UPGRADE 8 - - VESTIBULE FLOOR	
Line 44589	Note:	
18Dec15 / 19Dec15		
Inv.3445	1 - SUPPLY AND INSTALL FLOOR TILE - UPGRADE 8 - - POWDER ROOM FLOOR	
Line 44590	Note:	
18Dec15 / 19Dec15		

TILE - WALL

Inv.3445	1 - SUPPLY AND INSTALL WALL TILE - UPGRADE 8 - - ENSUITE BATH SHOWER WITH CEILING	
Line 44588	Note: VERTICAL STACKED INSTALLATION	
18Dec15 / 19Dec15		

EXTRAS AS PER OFFER

Stainless Steel Fridge, Stove and Dishwasher and front loading washer and dryer in white from Vendors standard samples, no cash value, not transferable. (Supplied only not installed) ** to - arrange delivery call: The Brick commercial sales division at Worksheet Note:		
Rogers Free Services Package includes 6 months of: home phone, TV and Internet Service. Worksheet Note:		

Purchaser: Catherine Tsai  
 Telephone Res./ Bus: (647) 892-4858 /  
 Decor Advisor: Diana Rojas

Property: 66 of Plan -  
 Project: Teefy Developments Limited  
 Model and Elevation: Belmont(22-1)

Layout Changes: ☐ Yes ☒ No Sketch Attached: ☒ Yes ☐ No Exterior Colour Scheme:

## 1. Cabinetry

	Style and Colour	Counter Top	Hardware
Kitchen / Breakfast	BOSTON PAINT - WINTER WHITE	QUARTZ - 9141 ICE SNOW	9677 HANDLE
Kitchen Island	BOSTON MAPLE - SHALE GREY CL	QUARTZ - 9141 ICE SNOW	9677 HANDLE
Laundry Room	MANCHESTE PAINT - WINTER WHITE	N/A	9677 HANDLE
Powder Room	MANCHESTE PAINT - WINTER WHITE	QUARTZ 6141 OCEAN FOAM (2)	9677 HANDLE
Main Bathroom	MANCHESTE PAINT - WINTER WHITE	WHITE CARRARA 4924-38	9677 HANDLE
Master Ensuite Bathroom	MANCHESTE PAINT - WINTER WHITE	QUARTZ - 3142 (3)	9677 HANDLE
Second Ensuite Bathroom (If Applicable)			
LOWER BATH	MANCHESTE PAINT - WINTER WHITE	WHITE CARRARA 4924-38	9677 HANDLE

## Appliances

### Custom Size Fridge

☐ Yes ☒ No

### Cooktop / Rangetop

☒ Yes ☐ No

### Valance Lighting

☒ Yes ☐ No

### Built in Wall Oven

☒ Yes ☐ No

### Microwave / Range Hood

☐ Yes ☒ No

### Slide-in Range

☐ Yes ☒ No

## Comment

SEE SPECS ATTACHED

## 2. Flooring

### Selection

FOYER	12X24 PORTLAND - TABOURI (CHARCOAL) (8)
Main Hall	
Back Hall	
Breakfast	3-5/8"X3/4" SATIN FINISH GEN R.O. N.F. ENG HRDWD - GRAPHITE
Laundry Room	& MUD ROOM = 13X13 NEW REEDS - BROWN
Kitchen	3-5/8"X3/4" SATIN FINISH GEN R.O. N.F. ENG HRDWD - GRAPHITE
Powder Room	12X24 PORTLAND - TABOURI (CHARCOAL) (8)
Main Bathroom	13X13 NEW REEDS - BROWN
Master Ensuite	NIAGARA FALLS - WHITE (4)
Bathroom (If Applicable)	
Mud Room	
LOWER BATH	13X13 NEW REEDS - BROWN
Living Room	FORMAL ROOM = 3-5/8"X3/4" SATIN FINISH GEN R.O. N.F. ENG HRDWD - GRAPHITE
Dining Room	
Family / Great Room	3-5/8"X3/4" SATIN FINISH GEN R.O. N.F. ENG HRDWD - GRAPHITE
Den / Library / Study	LOWER REC ROOM = SOFT CAMEO 17185
Basement Landing (If Applies)	
Lower Landing (If Applicable)	3-5/8"X3/4" SATIN FINISH GEN R.O. N.F. ENG HRDWD - GRAPHITE
Upper Landing	3-5/8"X3/4" SATIN FINISH GEN R.O. N.F. ENG HRDWD - GRAPHITE
Upper Hall	3-5/8"X3/4" SATIN FINISH GEN R.O. N.F. ENG HRDWD - GRAPHITE
Master Bedroom	3-5/8"X3/4" SATIN FINISH GEN R.O. N.F. ENG HRDWD - GRAPHITE
Bedroom #2	3-5/8"X3/4" SATIN FINISH GEN R.O. N.F. ENG HRDWD - GRAPHITE
Bedroom #3	3-5/8"X3/4" SATIN FINISH GEN R.O. N.F. ENG HRDWD - GRAPHITE
Bedroom #4	
Bedroom #5	

Flooring Continued on Page 2

Initial:

GT

Page 1 of 3





# INTERIOR COLOUR SCHEME

T-666

Purchaser: Catherine Tsai  
Telephone Res. / Bus: (647) 892-4858 /  
Decor Advisor: Diana Rojas

Property: 66 of Plan -  
Project: Teefy Developments Limited  
Model and Elevation: Belmont(22-1)

## 2. Flooring - Continued -

Upgrade Underpad	Type	Area
	STND	LOWER REC ROOM
Carpet on Stairs	Capped	Runner - *Upgrade
Comment		

## 3. Plumbing Fixtures / Faucets

Kitchen	STND	Second Ensuite		Powder Room	UPG
Master Ensuite	UPG			Other Room	
Main Bathroom	STND	LOWER LEVEL	STND		

Comment  
SEE UPG EXTRAS

## 4. Wall Tile

	Tile Selection	Listello	Insert	Insert Selection
Main Bathroom	8X12 BRICK GLOSSY - WHITE	<input type="checkbox"/>	<input type="checkbox"/>	
Master Ensuite		<input type="checkbox"/>	<input type="checkbox"/>	
Tub Deck		<input type="checkbox"/>	<input type="checkbox"/>	
Tub Apron		<input type="checkbox"/>	<input type="checkbox"/>	
Tub Surround		<input type="checkbox"/>	<input type="checkbox"/>	
Shower Stall	1.9X11.7 CRISTALLO GLASS GLOSSY - WARM GREY*	<input type="checkbox"/>	<input type="checkbox"/>	
Second Ensuite		<input type="checkbox"/>	<input type="checkbox"/>	
LOWER LEVEL	8X12 BRICK GLOSSY - WHITE	<input type="checkbox"/>	<input type="checkbox"/>	
Kitchen Backsplash		<input type="checkbox"/>	<input type="checkbox"/>	
Complete Backsplash		<input type="checkbox"/>	<input type="checkbox"/>	

Comment  
VERTICAL STACK INSTALLATION FOR ALL WALL TILES

## 5. Fireplace

	Living Room			Family Room			Other Room - Specify		
	Purchased	As Per Plan	N/A	Purchased	As Per Plan	N/A	Purchased	As Per Plan	N/A
Fireplace Type	<input type="radio"/>	<input type="radio"/>	<input type="radio"/>	<input type="radio"/>	<input checked="" type="radio"/>	<input type="radio"/>	<input type="radio"/>	<input type="radio"/>	<input type="radio"/>
Mantle Type				STND					
Over Mantle									
Colour / Stain									
Surround									
Hearth									

Comment  
F.P. APPROXIMATELY 17" +/- FROM THE FLOOR TO THE BASE OF THE F.P.

Initial:   CF



## INTERIOR COLOUR SCHEME

T-640

Purchaser: Catherine Tsai  
Telephone Res. / Bus: (647) 892-4858 /  
Decor Advisor: Diana Rojas

Property: 66 of Plan -  
Project: Teefy Developments Limited  
Model and Elevation: Belmont(22-1)

## 6. Trim Carpentry

Door Hardware Interior Trim 

Comment

## Interior Doors

☐ 2 Panel Arch Top☒ 2 Panel Square Top☐ 6 PanelInitial for Door Style CT

## 7. Railings and Pickets

Railing Package Railing Colour Picket Colour Wood Stairs ☐ No ☒ OakTread Colour 

Comment

## 8. Plaster Mouldings and Medallions

Foyer

Main Hall

Living Room

Dining Room

Family Room

Kitchen/Breakfast

Den/Library

Lower Landing

Comment

## 9. Wall Paint

Smooth Ceilings ☐ First Floor  
☐ First Floor incl. Second Floor Hall  
☐ First and Second Floor  
☒ Throughout  
☐ Not Applicable

Trim Paint 

## 10. Additional Comments

## 11. Disclaimers and Notes

- 1) Colours of all materials are as close as possible to builder's selection, but not necessarily identical due to variances in manufacturing.
- 2) Any extras listed above are null and void unless accompanied by a separate invoice/amendment. Said invoice must be paid in full.
- 3) The Purchaser acknowledges that after Interior Colour Selection form is signed and dated, no further changes will be permitted other than re-selection due to unavailability. CT Purchaser's Initials
- 4) The Purchaser acknowledges reading and accepting the "Senator Homes Décor Centre Disclaimers" form. This document contains other miscellaneous disclaimers.

This Interior Colour Selection is final and approved by:

Purchaser:

Signature: [Signature] Date: Dec 19, 2015

Vendor:

Teefy Developments Limited

Feb 11, 16



INITIALS: CG

**2190 SQ.FT. / 2021 SQ.FT. WITH OPTIONAL TANDEM GARAGE** INITIALS: \_\_\_\_\_

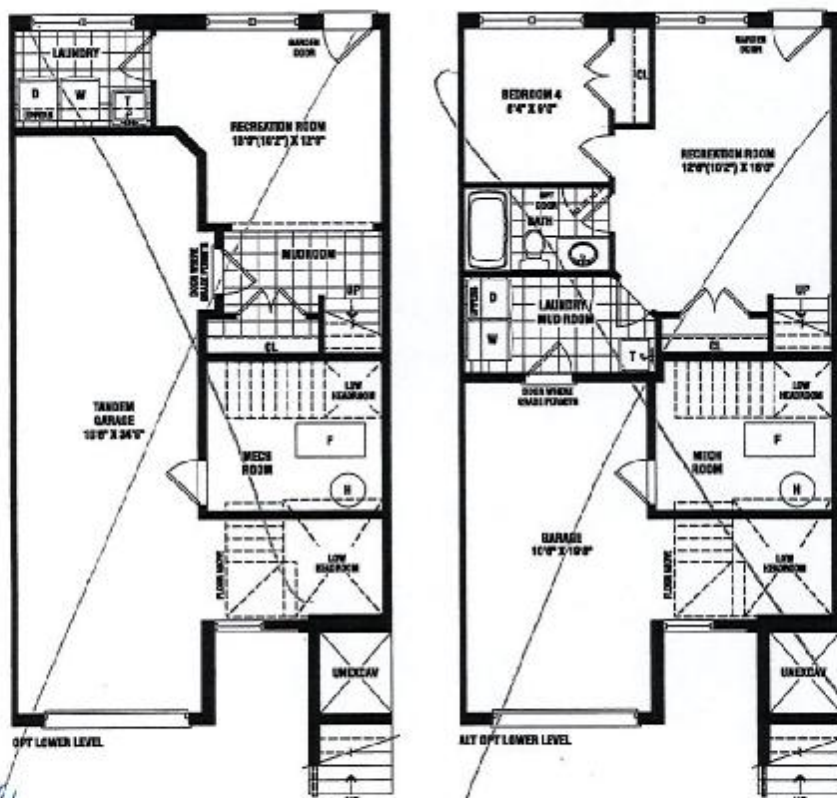
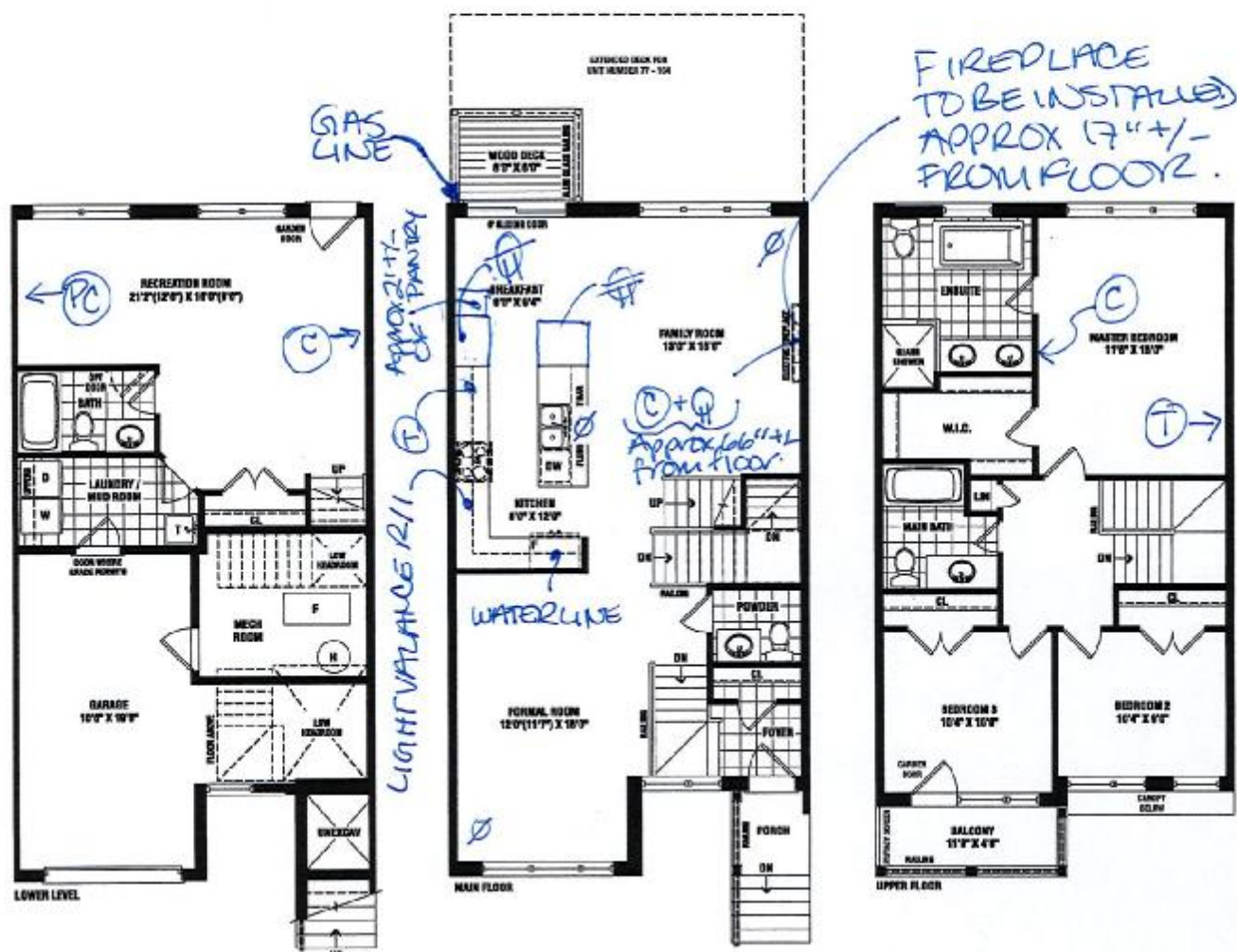

(C) = cable tv R/I  
 (+) = telephone R/I  
 (PC) = computer outlet.  
 (H) = ELECTRICAL RECEPTACLE  
~~(H)~~ = GROUND FAULT RECEPTACLE.  
 (O) = CAPPED CEILING OUTLET

$\textcircled{4}$  = DEDICATED RECEPTACLE

# SENATOR

## HOMES

Renderings are artist's concept. Some elevations may vary from that shown. Actual useable square footage may vary from that stated herein. Some floorplans and elevations are mirror image to that shown. E&O/E. 22-1

Lot 66



\* FASCIA PANEL WITH CROWN  
\* EXTENDED UPpers

# BELMONT - TH-22-1

## STD. LAYOUT

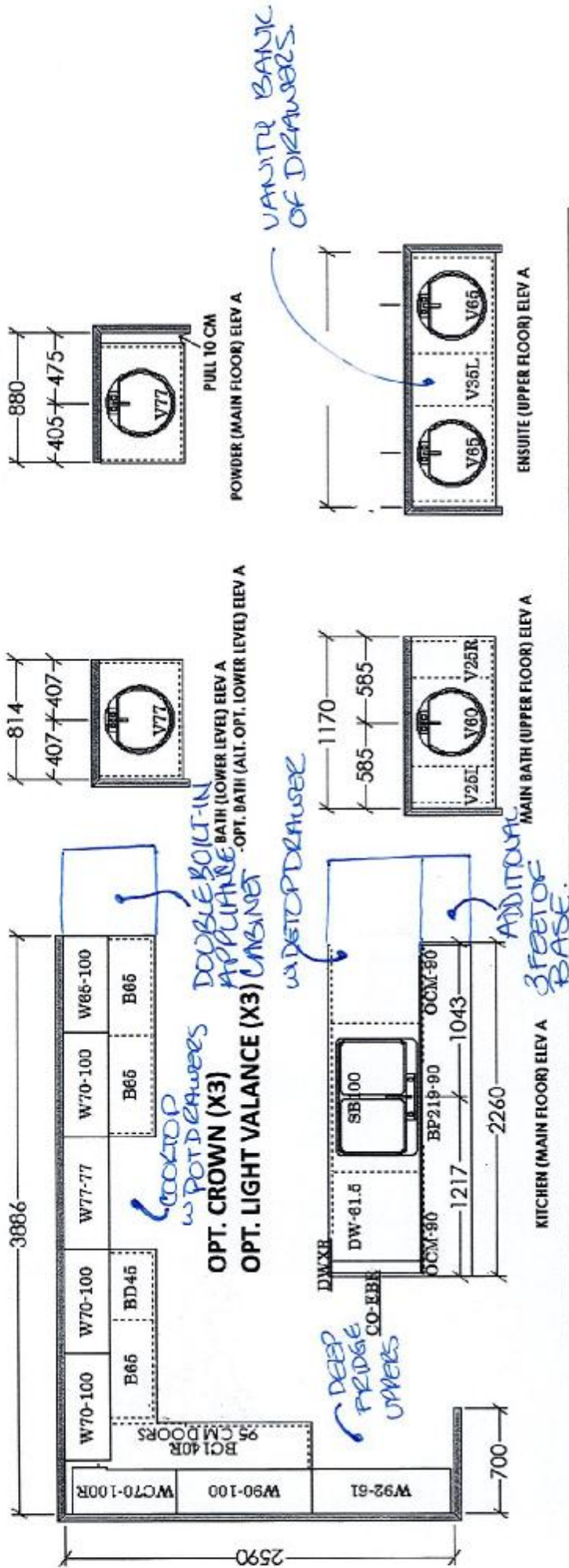

## OPTIONAL CABINETRY (STANDARD ELEVATION)

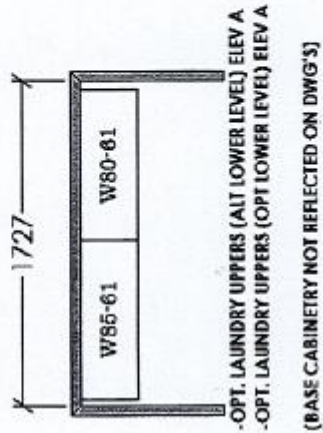

## OPTIONAL CABINETRY (ALTERNATE & OPTIONAL ELEVATION)

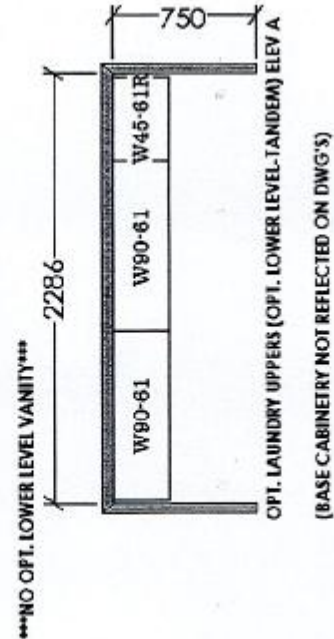

DATE: DEC 19 2015  
INITIALS: *CH*

SENATOR HOMES  
DECOR CENTRE

T-666



# 20" RECTANGULAR UNDERMOUNT SINK

TEEPY-66

## 4210C1Y Undermount Sink

### Product Specs:

- Vitreous china
- Front overflow hole
- Template and mounting hardware supplied

### Overall Dimensions (W x D x H):

(OD): 510mm(20") x 395mm(15½") x 190mm(7½")  
(ID): 450mm(17¾") x 335mm(13⅜") x 140mm(5½")

### Compliance Certifications:

- Meets or exceeds the following :
- IAPMO cUPC
  - ASME A112.19.2 / CSA B45.1-2008

### Shipping:

Cube 1.72  
GW 27 lbs

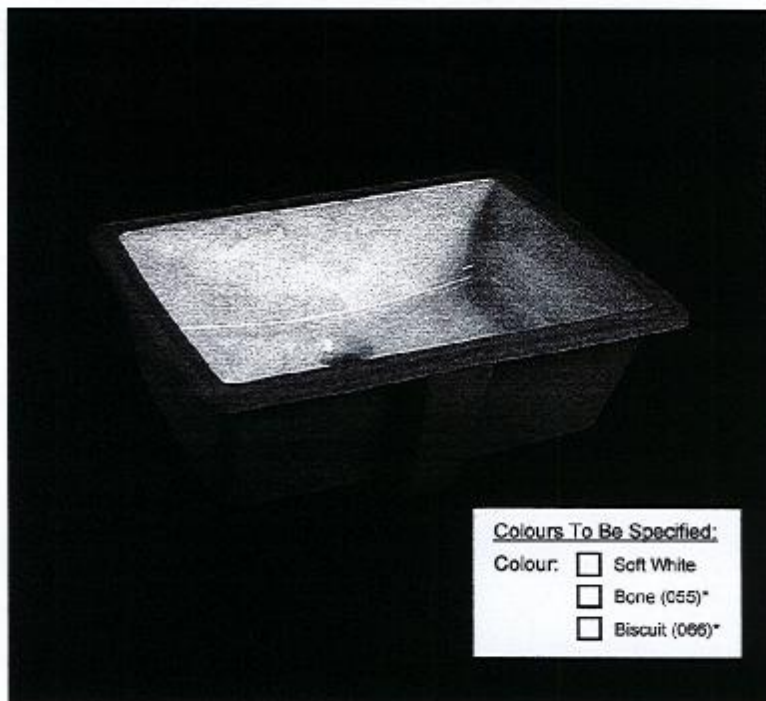

#### Colours To Be Specified:

- Colour: ☐ Soft White  
☐ Bone (055)\*  
☐ Biscuit (066)\*

#### Notes:

Dimensions of fixtures are nominal and may vary within the range of tolerances established by ASME standard A112.19.2. These measurements are subject to change or cancellation. No responsibility is assumed for use of superseded or voided pages.

\*Bone and Biscuit available through Direct Import (CIF) only

Detail of Mounting Clip

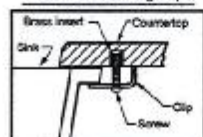

Note:  
▲ Dimensions shown for location of supplies and "P" trap are suggested.

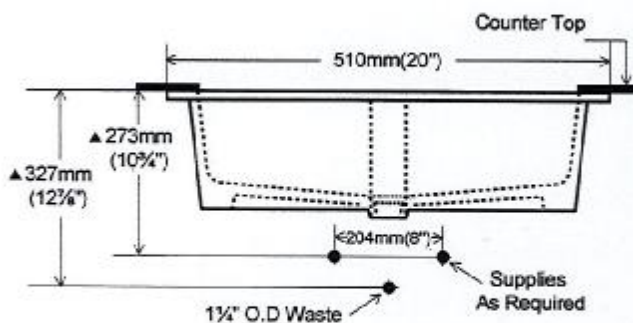
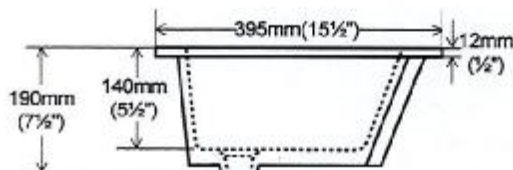
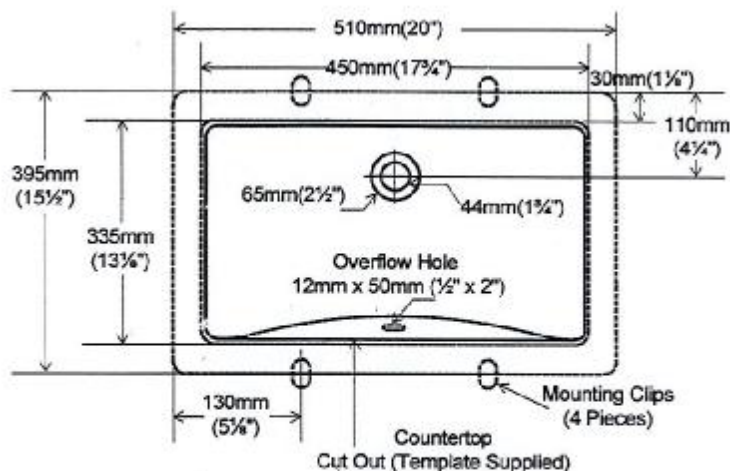

CONTRAC® 5970 Chedworth Way, Unit A, Mississauga, Ontario Canada L5R 3V5 • 1.888.256.7551  
www.contrac.ca

Revised: January 2014

SENATOR HOMES  
DECOR CENTRE  
DATE: DEC 19 2015  
INITIALS: *57*



T-66

SENATOR HOMES  
DECOR CENTRE

DATE: DEC 19 2015

INITIALS:   67  

# 36" French Door Bottom-Freezer

800 Series – Stainless Steel B26FT70SNS

**BOSCH**  
Invented for life**B26FT70SNS**  
Stainless Steel

The standard-depth French Door refrigerator offers large storage capacity and keeps your produce fresh longer.

## Features & Benefits

VitaFresh® controls humidity and temperature to keep food fresh.

Bright ALL LED Lighting shines throughout the entire interior.

Dispenses fresh-tasting water, crushed ice and cubed ice.

Stainless Steel Touch Control offers an easy-to-use luxury detail.

## General Properties

Water filter	Yes
Lighting	LED
Defrost process refrigerator section	Frost-free
Number of shelves - refrigerator	5
Adjustable shelves - refrigerator	4 half-width
Shelf material - refrigerator	Tempered glass
Type of shelves - refrigerator	Spill-proof glass
Gallon storage bins	2
Humidity control drawer	2
Defrost process freezer section	Automatic
Number of drawers - freezer	2
Ice maker	Yes
Quick ice	Yes

## Capacity

Total unit gross capacity (cu. ft.) - AHAM	25.9 cu. ft.
Refrigerator gross capacity (cu. ft.)	16.9 cu. ft.
Freezer gross capacity (cu. ft.)	9 cu. ft.

## Technical Details

Current (A)	15 A
Volts (V)	120 V
Frequency (Hz)	60 Hz
Power cord length (in.)	62"
Plug type	120V-3 prong

## Dimensions & Weight

Appliance dimensions (H x W x D) (in.)	69 3/4" x 35 5/8" x 33 13/32"
Required cutout size (H x W x D) (in.)	69" x 36" x 30 1/8"
Net weight (lbs)	248 lbs

## Efficiency

ENERGY STAR® qualified	No
Energy consumption (kWh/yr)	710 kWh

## Accessories-Included

Included	Egg box with lid
----------	------------------

## Accessories-Optional

**BORPLFTR10**  
Replacement water filter  
(P/N 00740570)



For help and assistance with Bosch accessories please visit: [www.bosch-eshop.com/eshop/bosch/us](http://www.bosch-eshop.com/eshop/bosch/us) or call 1-800-944-2904 Mon-Fri 5am to 6pm PST Sat 6am to 3pm PST

Notes: All height, width and depth dimensions are shown in inches. BSH reserves the absolute and unrestricted right to change product materials and specifications, at any time, without notice. Consult the product's installation instructions for final dimensional data and other details prior to making cutout. Applicable product warranty can be found in accompanying product literature or you may contact your account manager for further details.

Warranties: Bosch warrants that the Product is free from defects in materials and workmanship for a period of three hundred and sixty-five (365) days from the date of purchase. The foregoing timeline begins to run upon the date of purchase, and shall not be stalled, tolled, extended, or suspended, for any reason whatsoever. This Product is also warranted to be free from cosmetic defects in material and workmanship (such as scratches of stainless steel, paint/porcelain blemishes, chip, dents, or other damage) to the finish of the Product, for a period of thirty (30) days from the date of purchase or closing date for new construction. This cosmetic warranty excludes slight color variations due to inherent differences in painted and porcelain parts, as well as differences caused by kitchen lighting, product location, or other similar factors. This cosmetic warranty specifically excludes any display, floor, "As is", or "B" stock appliances.

For more information on our entire line of products, go to [www.bosch-home.com/us](http://www.bosch-home.com/us) or call 1-800-944-2904

© BSH Home Appliances Corporation. All rights reserved. Bosch is a registered trademark of Robert Bosch GmbH.

11/15



DATE: DEC 19 2015  
INITIALS: CS

## 36" French Door Bottom-Freezer

800 Series – Stainless Steel B26FT70SNS



**BOSCH**  
Invented for life

## Installation Details

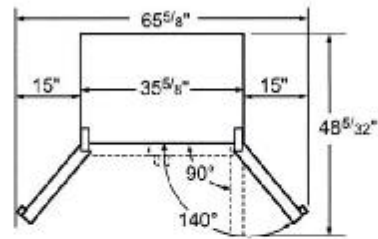
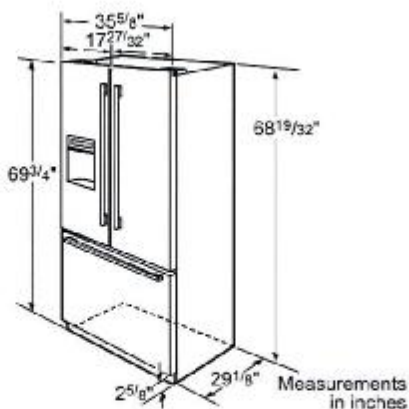

Drawers can be pulled out with door open 90°. Drawers can be taken out with door completely opened.

Dimensions in inches

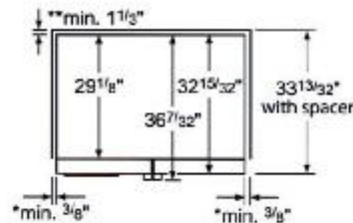

\* If the appliance is placed next to a cooker, the distance at the sides must be at least 1".

\*\* The clearance in the back must include the space of the water connection.

Measurements in inches

For help and assistance with Bosch accessories please visit: [www.bosch-eshop.com/eshop/bosch/us](http://www.bosch-eshop.com/eshop/bosch/us) or call 1-800-944-2904 Mon-Fri 9am to 6pm PST Sat 9am to 3pm PST

Notes: All height, width and depth dimensions are shown in inches. BSH reserves the absolute and unrestricted right to change product materials and specifications at any time, without notice. Consult the product's installation instructions for final dimensional data and other details prior to making cutout. Applicable product warranty can be found in accompanying product literature or you may contact your account manager for further details.

**Warranties:** Bosch warrants that the Product is free from defects in materials and workmanship for a period of three hundred and sixty-five (365) days from the date of purchase. The foregoing timeline begins to run upon the date of purchase, and shall not be stalled, tolled, extended, or suspended, for any reason whatsoever. This Product is also warranted to be free from cosmetic defects in material and workmanship (such as scratches of stainless steel, paint/porcelain blemishes, chips, dents, or other damage) to the finish of the Product, for a period of thirty (30) days from the date of purchase or closing date for new construction. This cosmetic warranty excludes slight color variations due to inherent differences in painted and porcelain parts, as well as differences caused by kitchen lighting, product location, or other similar factors. This cosmetic warranty specifically excludes any display, floor, "As Is", or "B" stock appliances.

For more information on our entire line of products, go to [www.bosch-home.com/us](http://www.bosch-home.com/us) or call 1-800-944-2904

© BSH Home Appliances Corporation. All rights reserved. Bosch is a registered trademark of Robert Bosch GmbH.

# 30" Electric Cooktop

Benchmark™ Series – Black with Stainless Steel Frame NETP066SUC



**BOSCH**  
Invented for life



**NETP066SUC**  
Black with Stainless  
Steel Frame

The Benchmark™ Series 30" electric cooktop is sleek in design, and features five burners with a touch control panel.

## Features & Benefits

Only 30" five-burner cooktop in the market with a touch control panel.

AutoChef® maintains exact cooking temperatures for consistent results.

Each zone's timer automatically shuts off when cooking is done.

PreciseSelect® offers 17 different direct cooking level settings.

Bosch-recommended AutoChef® pan included via mail-in redemption card.

## Element Performance

Power of Front Left heating element	2,000 / 800 W
Power of Back Left heating element	1,200 W
Power of Centre heating element	3,100 / 1,300 W
Power of Back Right heating element	1,200 W
Power of Front Right heating element	1,500 W

## Element Size

Dimension of Front Left heating element	7", 5"
Dimension of Back Left heating element	6"
Dimension of Centre heating element	9", 6"
Dimension of Back Right heating element	6"
Dimension of Front Right heating element	7"

## Technical Details

Watts	9,000 W
Circuit breaker	40 A
Volts	208-240 V
Frequency	60 Hz
Plug type	No plug
Energy source	Electric



## Dimensions & Weight

Overall appliance dimensions (HxWxD)	1/4" +4" x 31" x 21 1/4"
Required cutout size (HxWxD)	4" x 28 7/8" x 20"
Minimum distance from counter front	2 1/4"
Minimum distance from rear wall	2"
Net weight	27 lbs

## Accessories—Optional



**HEZ390210**  
8" AutoChef® pan



**HEZ390220**  
9" AutoChef® pan



**HEZ390230**  
10" AutoChef® pan



For help and assistance with Bosch accessories please call 1-800-944-2904 Mon-Fri 8am to 6pm EST

Notes: All height, width and depth dimensions are shown in inches. Please refer to installation instructions prior to making cutout. BSH reserves the absolute and unrestricted right to change product materials and specifications, at any time, without notice. Consult the product's installation instructions for final dimensional data and other details. Applicable product warranty can be found in accompanying product literature or you may contact your account manager for further details.

Warranties: Bosch warrants that the Product is free from defects in materials and workmanship for a period of three hundred and sixty-five (365) days from the date of purchase. The foregoing timeline begins to run upon the date of purchase, and shall not be stalled, tolled, extended, or suspended, for any reason whatsoever. This Product is also warranted to be free from cosmetic defects in material and workmanship (such as scratches of stainless steel, paint/porcelain blemishes, chip, dents, or other damage to the finish of the Product) for a period of thirty (30) days from the date of purchase or closing date for new construction. This cosmetic warranty excludes slight colour variations due to inherent differences in painted and porcelain parts, as well as differences caused by kitchen lighting, product location, or other similar factors. This cosmetic warranty specifically excludes any display, floor, "As Is", or "B" stock appliances.

For more information on our entire line of products, go to [www.bosch-home.ca](http://www.bosch-home.ca) or call 1-800-944-2904

© 2014 BSH Home Appliances Canada. All rights reserved. Bosch is a registered trademark of Robert Bosch GmbH.



# 30" Electric Cooktop

Benchmark™ Series – Black with Stainless Steel Frame NETP066SUC



## Installation Details

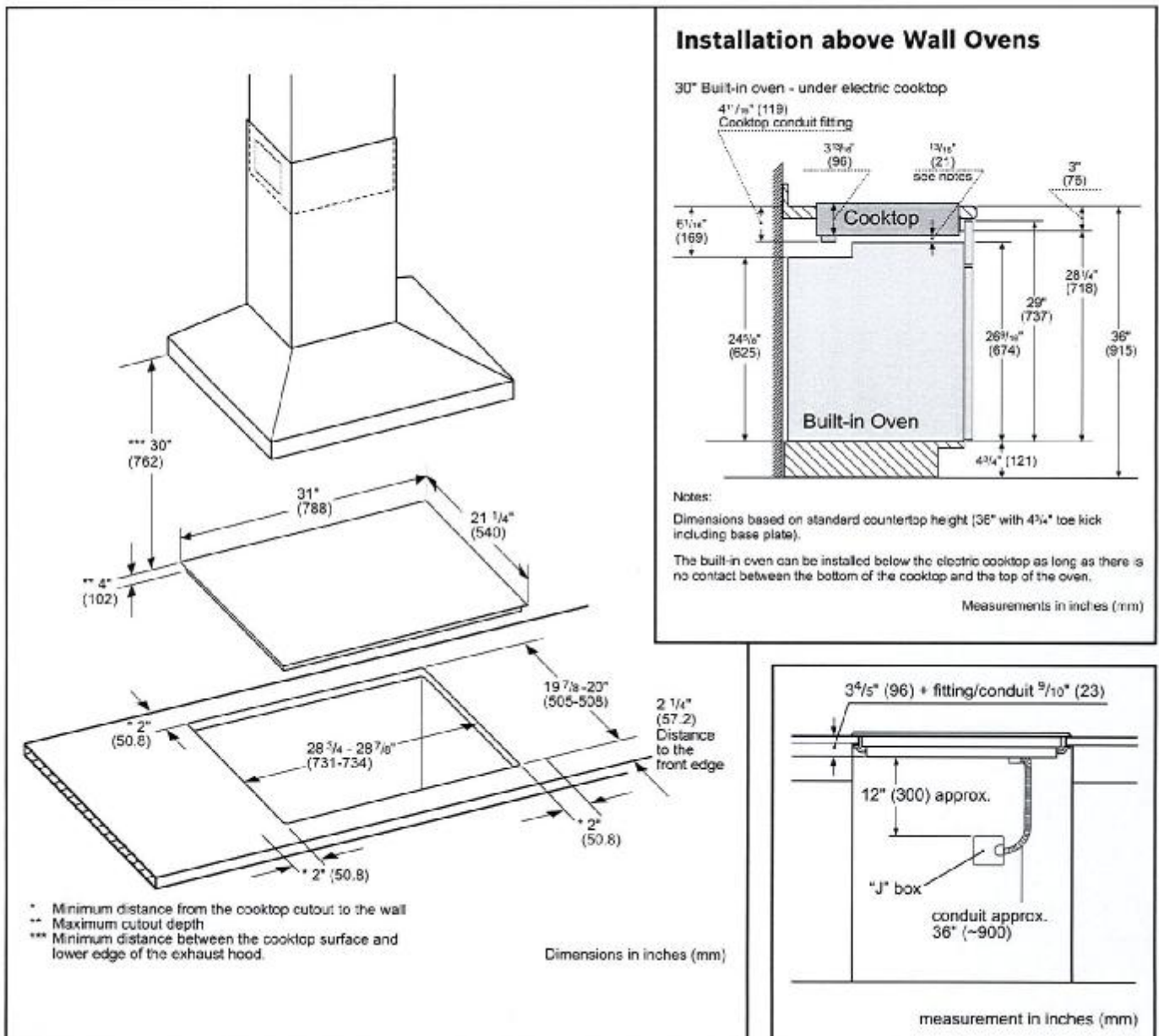

For help and assistance with Bosch accessories please call 1-800-944-2904 Mon-Fri 8am to 6pm EST

Notes: All height, width and depth dimensions are shown in inches. Please refer to installation instructions prior to making cutout. BSH reserves the absolute and unrestricted right to change product materials and specifications, at any time, without notice. Consult the product's installation instructions for final dimensional data and other details. Applicable product warranty can be found in accompanying product literature or you may contact your account manager for further details.

Warranties: Bosch warrants that the Product is free from defects in materials and workmanship for a period of three hundred and sixty-five (365) days from the date of purchase. The foregoing timeline begins to run upon the date of purchase, and shall not be stalled, tolled, extended, or suspended, for any reason whatsoever. This Product is also warranted to be free from cosmetic defects in material and workmanship (such as scratches of stainless steel, paint/porcelain blemishes, chip, dents, or other damage to the finish of the Product) for a period of thirty (30) days from the date of purchase or closing date for new construction. This cosmetic warranty excludes slight colour variations due to inherent differences in painted and porcelain parts, as well as differences caused by kitchen lighting, product location, or other similar factors. This cosmetic warranty specifically excludes any display, floor, "As Is", or "B" stock appliances.

For more information on our entire line of products, go to [www.bosch-home.ca](http://www.bosch-home.ca) or call 1-800-944-2904

© 2014 BSH Home Appliances Canada. All rights reserved. Bosch is a registered trademark of Robert Bosch GmbH.



# 30" Single Wall Oven

800 Series – Stainless Steel HBL8451UC



**HBL8451UC**  
Stainless Steel

Also available in:  
Black HBL8461UC

**The Bosch wall oven  
installs flush and features  
a SmoothClose door.**

## Features & Benefits

Dampened hinges softly and quietly guide the SmoothClose door shut.

A full-extension telescopic rack offers safe access to the oven cavity.

Touch control with SteelTouch™ buttons makes operating the oven easier.

The wall oven is designed to be installed flush with cabinetry.

Bosch wall ovens are compatible with most competitors' cutouts.

Genuine European Convection for even baking results on multiple racks.

## General Properties

Cooking Modes	Bake, Variable Broil (hi & low), Roast, Warm, Sabbath, Proof Dough, Convection Bake, Convection Broil, Convection Roast, Pizza, Multi Rack Genuine European Convection, Convection Conversion, Temperature Probe, Fast Preheat
---------------	--

Cleaning Type	Self Clean
Telescopic Rack	1
Illumination Type	Incandescent
Interior Lights	2

## Oven Performance

Bake Element Wattages	2,400 W
Broil Element Wattages	3,800 W
Convection Element Wattages	2,000 W

## Technical Details

Watts (W)	6,325 W
Circuit Breaker (A)	30 A
Volts (V)	240/208 V
Frequency (Hz)	60 Hz
Power Cord Length (in)	50"
Plug Type	Fixed Connection, No Plug
Energy Source	Electric

## Dimensions & Weight

Overall Appliance Dimensions (HxWxD)(in)	29" x 29 3/4" x 23 1/2"
Required Cutout Size (HxWxD) (in)	27" - 28 5/8" x 28 1/2" x 23 1/2"
Net Weight (lbs)	149 lbs

## Accessories-Included

Included	3 x Oven Racks, Temperature Probe
----------	-----------------------------------

## Accessories-Optional



**HEZTR301**  
30" Telescopic Rack



For help and assistance with Bosch accessories please call 1-800-944-2904 Mon-Fri 8am to 6pm EST

Notes: All height, width and depth dimensions are shown in inches. Please refer to installation instructions prior to making cutout. BSH reserves the absolute and unrestricted right to change product materials and specifications, at any time, without notice. Consult the product's installation instructions for final dimensional data and other details. Applicable product warranty can be found in accompanying product literature or you may contact your account manager for further details.

Warranties: Bosch warrants that the Product is free from defects in materials and workmanship for a period of three hundred and sixty-five (365) days from the date of purchase. The foregoing timeline begins to run upon the date of purchase, and shall not be stalled, tolled, extended, or suspended, for any reason whatsoever. This Product is also warranted to be free from cosmetic defects in material and workmanship (such as scratches of stainless steel, paint/porcelain blemishes, chip, dents, or other damage to the finish of the Product) for a period of thirty (30) days from the date of purchase or closing date for new construction. This cosmetic warranty excludes slight colour variations due to inherent differences in painted and porcelain parts, as well as differences caused by kitchen lighting, product location, or other similar factors. This cosmetic warranty specifically excludes any display, floor, "As Is", or "B" stock appliances.

For more information on our entire line of products, go to [www.bosch-home.ca](http://www.bosch-home.ca) or call 1-800-944-2904

© 2014 BSH Home Appliances Canada. All rights reserved. Bosch is a registered trademark of Robert Bosch GmbH.

# 30" Single Wall Oven

800 Series – Stainless Steel HBL8451UC



## Installation Details

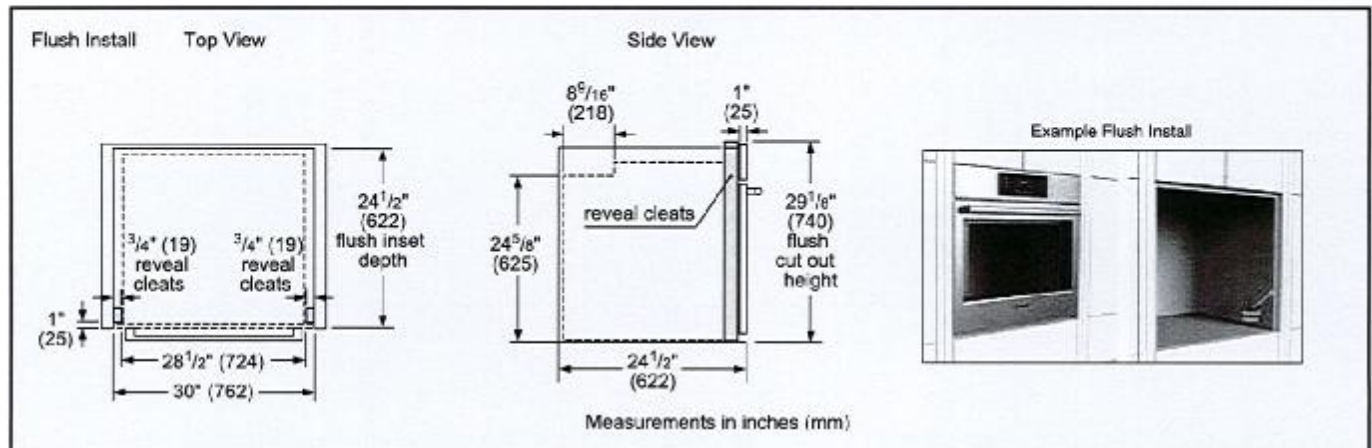
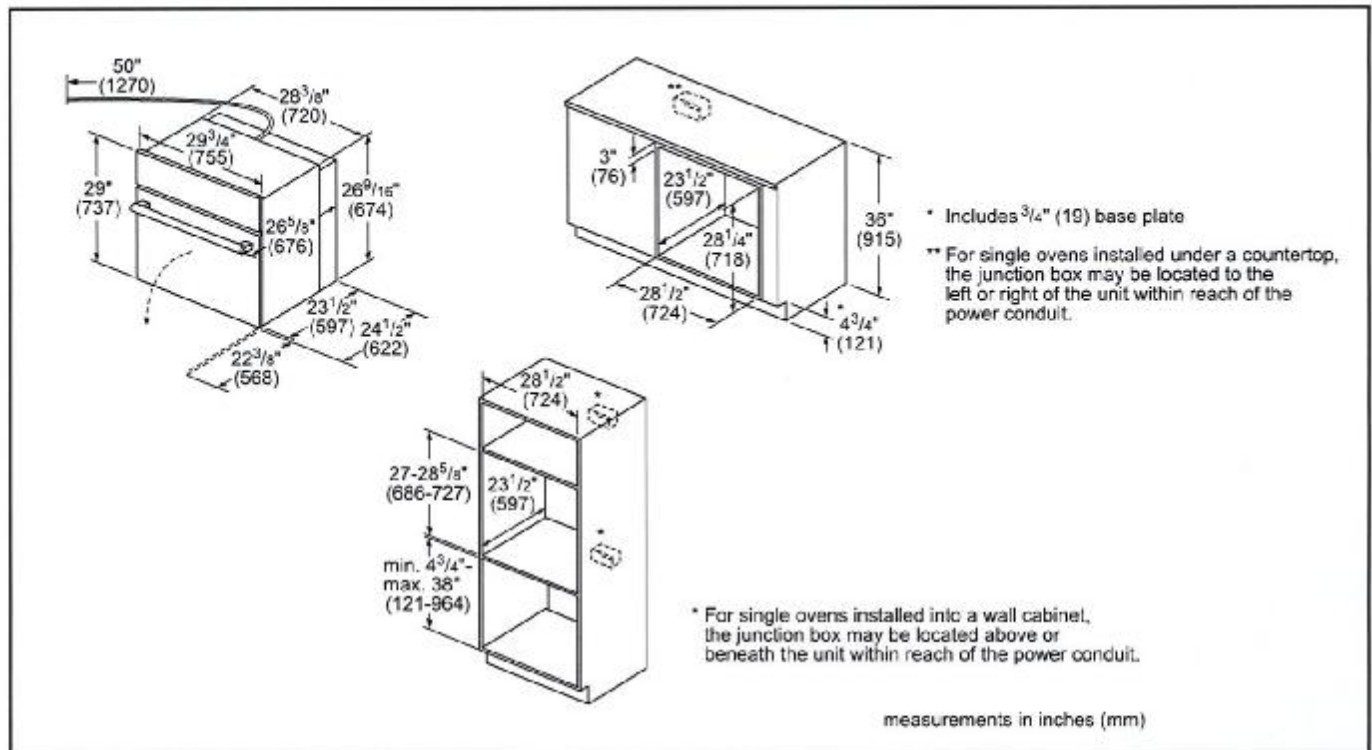

For help and assistance with Bosch accessories please call 1-800-944-2904 Mon-Fri 8am to 6pm EST

Notes: All height, width and depth dimensions are shown in inches. Please refer to installation instructions prior to making cutout. BSH reserves the absolute and unrestricted right to change product materials and specifications, at any time, without notice. Consult the product's installation instructions for final dimensional data and other details. Applicable product warranty can be found in accompanying product literature or you may contact your account manager for further details.

Warranties: Bosch warrants that the Product is free from defects in materials and workmanship for a period of three hundred and sixty-five (365) days from the date of purchase. The foregoing timeline begins to run upon the date of purchase, and shall not be stalled, tolled, extended, or suspended, for any reason whatsoever. This Product is also warranted to be free from cosmetic defects in material and workmanship (such as scratches of stainless steel, paint/porcelain blemishes, chip, dents, or other damage to the finish of the Product) for a period of thirty (30) days from the date of purchase or closing date for new construction. This cosmetic warranty excludes slight colour variations due to inherent differences in painted and porcelain parts, as well as differences caused by kitchen lighting, product location, or other similar factors. This cosmetic warranty specifically excludes any display, floor, "As Is", or "B" stock appliances.

For more information on our entire line of products, go to [www.bosch-home.ca](http://www.bosch-home.ca) or call 1-800-944-2904

© 2014 BSH Home Appliances Canada. All rights reserved. Bosch is a registered trademark of Robert Bosch GmbH.



# 30" Single Wall Oven

800 Series – Stainless Steel HBL8451UC



## Installation Details

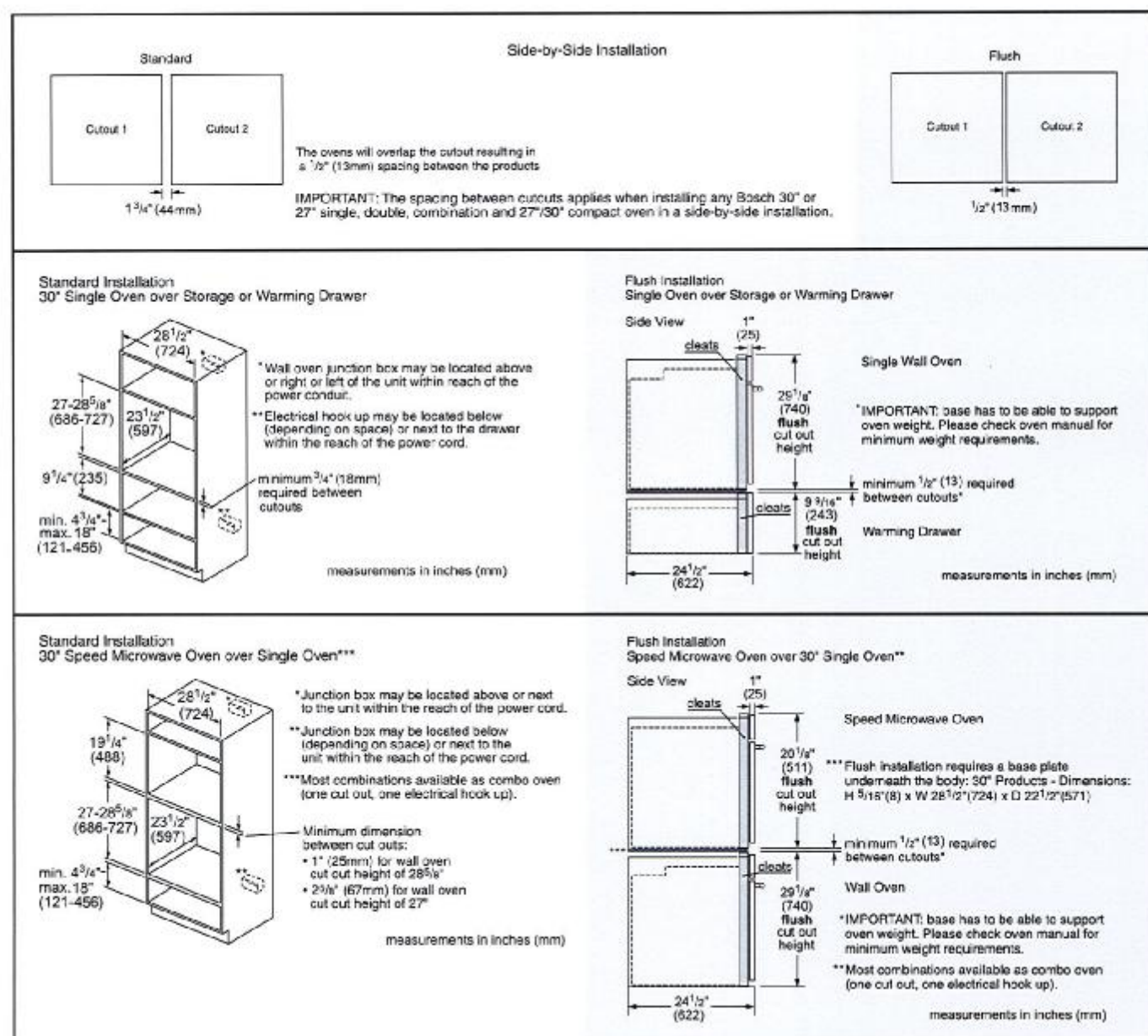

For help and assistance with Bosch accessories please call 1-800-944-2904 Mon-Fri 8am to 6pm EST

Notes: All height, width and depth dimensions are shown in inches. Please refer to installation instructions prior to making cutout. BSH reserves the absolute and unrestricted right to change product materials and specifications, at any time, without notice. Consult the product's installation instructions for final dimensional data and other details. Applicable product warranty can be found in accompanying product literature or you may contact your account manager for further details.

Warranties: Bosch warrants that the Product is free from defects in materials and workmanship for a period of three hundred and sixty-five (365) days from the date of purchase. The foregoing timeline begins to run upon the date of purchase, and shall not be stalled, tolled, extended, or suspended, for any reason whatsoever. This Product is also warranted to be free from cosmetic defects in material and workmanship (such as scratches of stainless steel, paint/porcelain blemishes, chip, dents, or other damage to the finish of the Product) for a period of thirty (30) days from the date of purchase or closing date for new construction. This cosmetic warranty excludes slight colour variations due to inherent differences in painted and porcelain parts, as well as differences caused by kitchen lighting, product location, or other similar factors. This cosmetic warranty specifically excludes any display, floor, "As Is", or "B" stock appliances.

For more information on our entire line of products, go to [www.bosch-home.ca](http://www.bosch-home.ca) or call 1-800-944-2904

© 2014 BSH Home Appliances Canada. All rights reserved. Bosch is a registered trademark of Robert Bosch GmbH.



# 24" Bar Handle Dishwasher

300 Series DLX – Stainless Steel SHX53TL5UC



**SHX53TL5UC**  
 Stainless Steel

Bosch dishwashers are so quiet, you may forget they're on. InfoLight® projects a red light onto the floor to let you know it's on.

## Features & Benefits

46 dBA: Quietest dishwasher brand.

InfoLight® shines on the floor so you know the dishwasher's running.

RackMatic® offers 3 height levels, for 9 possible rack positions.

Detergent tray optimizes detergent dissolving.

AquaStop® leak protection works 24/7 to prevent water damage.

## General Properties

Number of wash cycles	4
Number of options	5
dBA	46
Third rack	
Rack adjustability	RackMatic®
Tub material	Stainless steel
Control type	Buttons
Concealed heating element	Yes
Leak protection system	24/7 AquaStop®
Water softener	No
Five-level wash	Yes
ChildLock	No
Special features	InfoLight®, Duo-Flex Silverware Basket, SpeedPerfect™

## Efficiency

Water usage per cycle	2.9
Energy efficiency class	Tier 1
ENERGY STAR® qualified	Yes
Total annual energy consumption (kWh)	259
Total annual water consumption (g)	624

## Capacity

Number of place settings	15
--------------------------	----



## Technical Details

Watts (W)	1300 W
Current (A)	12 Amps
Volts (V)	120 V
Frequency (Hz)	60 Hz
Power cord length	56 5/16"
Minimum water pressure (lb/sin)	14
Length inlet hose (in)	60"
Length outlet hose (in)	79"

## Dimensions & Weight

Overall appliance dimensions (HxWxD) (in)	33 7/8" x 23 9/16" x 23 3/4"
Required cutout size (HxWxD) (in)	33 7/8" x 23 5/8" x 24"
Adjustable feet	Yes
Net weight (lbs)	84 lbs

## Accessories—Optional

Dishwasher Supply and Drainage Hose Extension 76 3/4"	SGZ1010UC
Dishwasher 3-Prong Power Cord 66 7/8"	SMZPC002UC
Dishwasher Accessory Kit	SMZ5000
Anti-tarnish Silverware Cassette	SMZ5002UC



For help and assistance with Bosch accessories please visit: [www.bosch-eshop.com/eshop/bosch/us](http://www.bosch-eshop.com/eshop/bosch/us) or call 1-800-944-2904 Mon-Fri 5am to 6pm PST Sat 6am to 3pm PST

Notes: All height, width and depth dimensions are shown in inches. Please refer to installation instructions prior to making cutout. BSH reserves the absolute and unrestricted right to change product materials and specifications, at any time, without notice. Consult the product's installation instructions for final dimensional data and other details. Applicable product warranty can be found in accompanying product literature or you may contact your account manager for further details.

Warranties: Bosch warrants that the Product is free from defects in materials and workmanship for a period of three hundred and sixty-five (365) days from the date of purchase. The foregoing timeline begins to run upon the date of purchase, and shall not be stalled, tolled, extended, or suspended, for any reason whatsoever. This Product is also warranted to be free from cosmetic defects in material and workmanship (such as scratches of stainless steel, paint/porcelain blemishes, chip, dents, or other damage to the finish of the Product, for a period of thirty (30) days from the date of purchase or closing date for new construction. This cosmetic warranty excludes slight color variations due to inherent differences in painted and porcelain parts, as well as differences caused by kitchen lighting, product location, or other similar factors. This cosmetic warranty specifically excludes any display, "floor," "As Is," or "B" stock appliances.

For more information on our entire line of products, go to [www.bosch-home.com/us](http://www.bosch-home.com/us) or call 1-800-944-2904

© BSH Home Appliances Corporation. All rights reserved. Bosch is a registered trademark of Robert Bosch GmbH.



# 24" Bar Handle Dishwasher

300 Series DLX – Stainless Steel SHX53TL5UC



## Installation Details

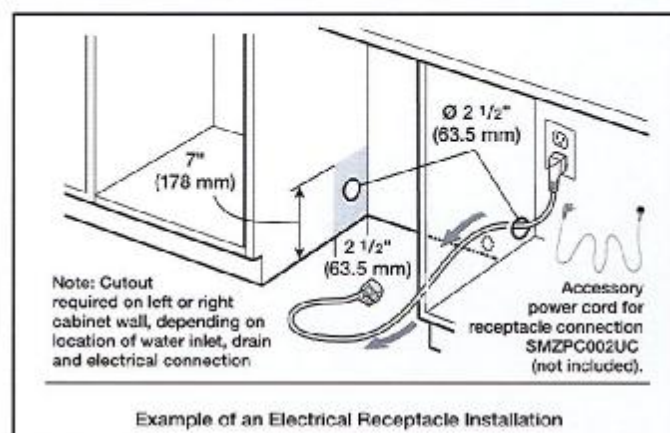
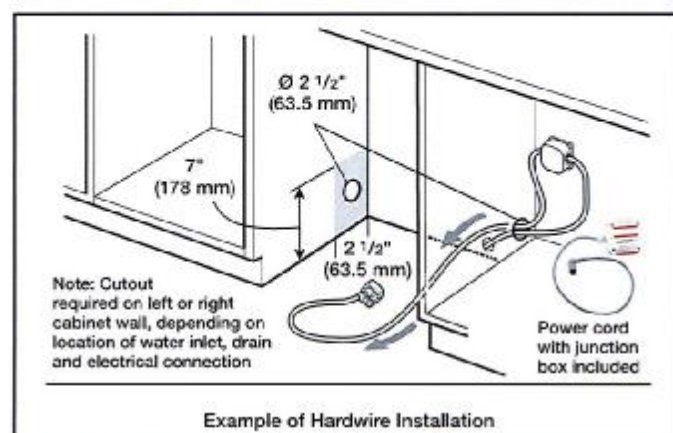
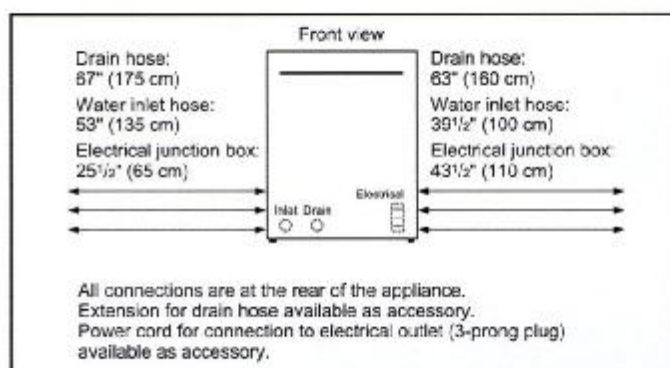
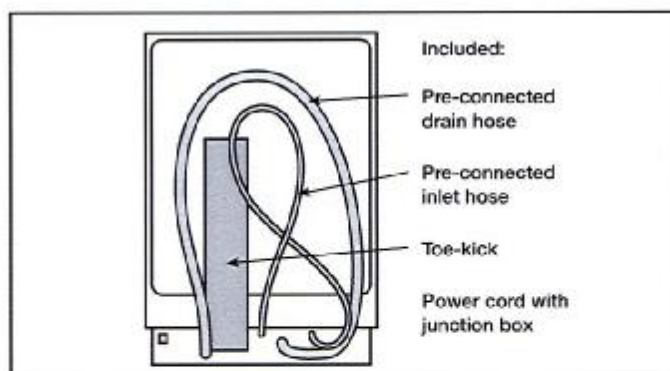
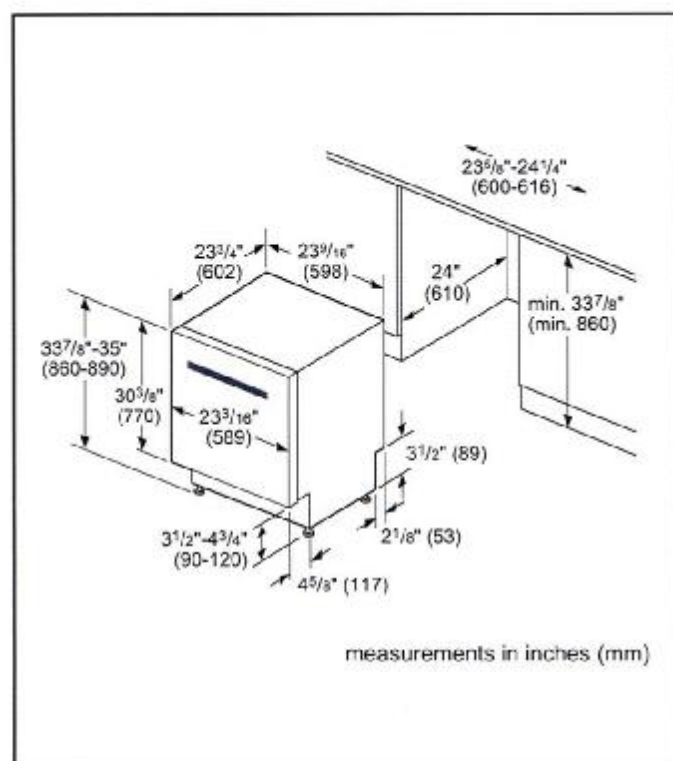

For help and assistance with Bosch accessories please visit: [www.bosch-eshop.com/eshop/bosch/us](http://www.bosch-eshop.com/eshop/bosch/us) or call 1-800-944-2904 Mon-Fri 5am to 6pm PST Sat 6am to 3pm PST

Notes: All height, width and depth dimensions are shown in inches. Please refer to installation instructions prior to making cutout. BSH reserves the absolute and unrestricted right to change product materials and specifications, at any time, without notice. Consult the product's installation instructions for final dimensional data and other details. Applicable product warranty can be found in accompanying product literature or you may contact your account manager for further details.

Warranties: Bosch warrants that the Product is free from defects in materials and workmanship for a period of three hundred and sixty five (365) days from the date of purchase. The foregoing timeline begins to run upon the date of purchase, and shall not be stalled, tolled, extended, or suspended, for any reason whatsoever. This Product is also warranted to be free from cosmetic defects in material and workmanship (such as scratches of stainless steel, paint/porcelain blemishes, chip, dents, or other damage to the finish of the Product), for a period of thirty (30) days from the date of purchase or closing date for new construction. This cosmetic warranty excludes slight color variations due to inherent differences in painted and porcelain parts, as well as differences caused by kitchen lighting, product location, or other similar factors. This cosmetic warranty specifically excludes any display, floor, "As is", or "R" stock appliances.

For more information on our entire line of products, go to [www.bosch-home.com/us](http://www.bosch-home.com/us) or call 1-800-944-2904

© BSH Home Appliances Corporation. All rights reserved. Bosch is a registered trademark of Robert Bosch GmbH.

# 24" Bar Handle Dishwasher

300 Series DLX - Stainless Steel SHX53TL5UC



## Installation Details

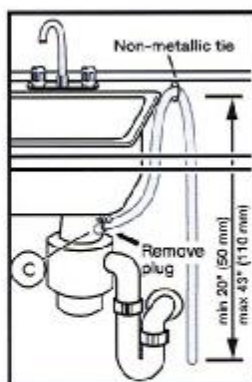
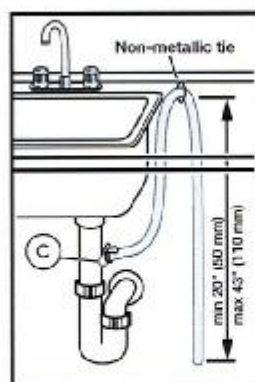

Note: Plumbing installations will vary - refer to local codes. Drain hose included is 79 (201 cm) and can be extended to a maximum of 155 3/4" (396 cm).

Always use the approved drain hose extension kit (SGZ1010UC).

Ensure a portion of the drain hose is raised between min. 20" (50 cm) and max. 43" (110 cm) above the cabinet floor.

For help and assistance with Bosch accessories please visit: [www.bosch-eshop.com/eshop/bosch/us](http://www.bosch-eshop.com/eshop/bosch/us) or call 1-800-944-2904 Mon-Fri 5am to 6pm PST Sat 6am to 3pm PST

Notes: All height, width and depth dimensions are shown in inches. Please refer to installation instructions prior to making cutout. BSH reserves the absolute and unrestricted right to change product materials and specifications, at any time, without notice. Consult the product's installation instructions for final dimensional data and other details. Applicable product warranty can be found in accompanying product literature or you may contact your account manager for further details.

Warranties: Bosch warrants that the Product is free from defects in materials and workmanship for a period of three hundred and sixty-five (365) days from the date of purchase. The foregoing timeline begins to run upon the date of purchase, and shall not be stalled, tolled, extended, or suspended, for any reason whatsoever. This Product is also warranted to be free from cosmetic defects in material and workmanship (such as scratches of stainless steel, paint/porcelain blemishes, chip, dents, or other damage to the finish of the Product, for a period of thirty (30) days from the date of purchase or closing date for new construction. This cosmetic warranty excludes slight color variations due to inherent differences in painted and porcelain parts, as well as differences caused by kitchen lighting, product location, or other similar factors. This cosmetic warranty specifically excludes any display, floor, "As is", or "B" stock appliances.

For more information on our entire line of products, go to [www.bosch-home.com/us](http://www.bosch-home.com/us) or call 1-800-944-2904

© BSH Home Appliances Corporation. All rights reserved. Bosch is a registered trademark of Robert Bosch GmbH.



T-66

**Diana Rojas**

**SENATOR HOMES**  
**DÉCOR CENTRE**  
DATE: JAN 15 2016  
INITIALS: **CONFIRMED BY EMAIL**

**From:** Chia Ying <chiaying@ctsai.org>  
**Sent:** Wednesday, January 13, 2016 9:52 PM  
**To:** Diana Rojas  
**Cc:** catherine@ctsai.org  
**Subject:** Re: 9130 Bathurst - Lot 66

**Follow Up Flag:** Flag for follow up  
**Flag Status:** Flagged

Hi Diana,

Sorry for the delay, please link below for microwave / convection combo

<https://products.bsh-partner.com/picenterext/specsheet/CA/en-CA/HMC80151UC.pdf?errorUrl=http://www.bosch-home.com/global/bosch-error.aspx>

Thanks,  
Catherine

On Jan 13, 2016, at 5:55 PM, Diana Rojas <[drojas@senatorhomes.com](mailto:drojas@senatorhomes.com)> wrote:

Hello Catherine,

Our construction department is requesting your file. Kindly forward me your specs so I can submit your paperwork asap.

Thank you,  
Diana Rojas  
Décor Consultant  
Senator Homes Décor Centre  
250 Lesmill Road  
Toronto ON M3B 2T5  
PH: 416-446-5238  
FAX: 416-445-1069

---

**From:** Diana Rojas  
**Sent:** Wednesday, January 06, 2016 11:15 PM  
**To:** 'catherine@ctsai.org' <catherine@ctsai.org>  
**Subject:** 9130 Bathurst - Lot 66  
**Importance:** High

Hello Catherine,

Happy new year and I hope you had a great holiday season!  
I'm just following up as we need to finalize your file this week.  
Kindly, forward me the appliance specs to attach to the documents for processing at your earliest convenience.

Thank you and best regards,  
Diana Rojas  
Décor Consultant  
Senator Homes Décor Centre  
250 Lesmill Road  
Toronto ON M3B 2T5  
PH: 416-446-5238  
FAX: 416-445-1069



## Microwaves

### HMC80151UC 30" Speed Microwave Oven 800 Series - Stainless Steel

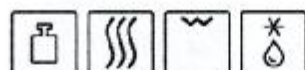

### The Speed Microwave Oven Pairs the Cooking Qualities of a Conventional Oven with the Speed of Microwave Technology

- AutoChef Cooking Cycles Offer Faster Cooking Times for your Convenience
- Flush Install Matches Bosch Wall Oven, Steam Oven, or Warming Drawer
- 2-in-1 Microwave and Convection Oven for a Variety of Cooking Options
- 30" Width Can be Installed in Horizontal and Vertical Configuration
- Electrical Connection - 120 Volt NEMA 5-20 Three Prong Plug

#### Technical Data

Max. Microwave power (W) :	1000
Number of Power Levels :	10
Turntable :	Yes
Turntable diameter (in) :	14 1/8"
Turntable diameter (mm) :	360
Heating type :	Combi microwave constant, Half width variable grill, Hot Air, Microwave, warming
Cavity material :	Stainless steel
Door opening :	Handle
Clock / Timer :	Yes
Included accessories :	1 x grid
UPC code :	825225908562
Product color :	Stainless steel
Watts (W) :	1920
Current (A) :	20
Volts (V) :	120
Frequency (Hz) :	60
Approval certificates :	CUL, UL
Power cord length (in) :	43"
Power cord length (cm) :	109
Plug type :	120V-3 prong
Required cutout size (HxWxD) (in) :	19 1/4" x 28 1/2" x 23 1/2"
Required cutout size (HxWxD) (mm) :	488 x 724 x 560
Overall appliance dimensions (HxWxD) (in) :	19 5/8" x 29 3/4" x 21 3/8"
Overall appliance dimensions (HxWxD) (mm) :	498 x 755 x 543
Product packaging dimensions (HxWxD) (in) :	23.62 x 26.29 x 33.85
Net weight (lbs) :	86
Net weight (kg) :	39.0
Gross weight (lbs) :	96
Gross weight (kg) :	44.0

#### Included accessories

1 x grid



T-606  
**SENATOR HOMES**  
DECOR CENTRE

DATE: JAN 15 2016

INITIALS: CONFIRMED BY EMAIL



**BOSCH**

## Microwaves

### HMC80151UC

**30" Speed Microwave Oven  
800 Series - Stainless Steel**

**The Speed Microwave Oven Pairs the  
Cooking Qualities of a Conventional Oven  
with the Speed of Microwave Technology**

#### Performance

- Nine AutoChef Cycles Offer Faster Cooking Times For Your Convenience
- 1750 Watt Broil Element
- 1000 Watts Microwave Power
- 1700 Watt Convection Element
- Convection Cooking

#### Design

- Installs Perfectly Flush With a Bosch Wall Oven or Steam Oven & Warming Drawer
- Wall or Undercounter Installation
- White Colored LCD

#### Convenience

- 2-in-1 Microwave and Oven for a Variety of Cooking Options
- 10 Levels of Microwavable Power
- Kitchen Timer and Childlock Setting

#### Quality

- Metal and Ceramic Turntable
- Stainless Steel Cooking Interior

T-600  
**SENATOR HOMES**  
 DECOR CENTRE  
 DATE: JAN 15 2016  
 INITIALS: CONFIRMED BY EMAIL



## Microwaves

**HMC80151UC**

**30" Speed Microwave Oven**  
**800 Series - Stainless Steel**

