



CONSTRUCTION SUMMARY

Teefy Developments Limited / 9130 Bathurst

Lot/Unit: 101 Phase/Building: 1 Model/Floor Plan: Riverdale(22-3)

CABINETRY

Inv.3467	1 - SUPPLY AND INSTALL CABINETRY - KITCHEN - UPGRADE 2 - ANNEX SERIES	
Line 44967	Note:	
9Jan16 / 11Jan16		
Inv.3467	1 - SUPPLY AND INSTALL CABINETRY - ENSUITE - UPGRADE 2 - ANNEX SERIES	
Line 44986	Note:	
9Jan16 / 11Jan16		
Inv.3467	1 - SUPPLY AND INSTALL CABINETRY - POWDER ROOM - UPGRADE 2 - ANNEX SERIES	
Line 44999	Note:	
9Jan16 / 11Jan16		

CABINETRY ACCESSORIES

Inv.3467	2 - SUPPLY AND INSTALL KITCHEN LIGHT VALANCE - NOT APPLICABLE FOR THERMOVISION - PRICE PER 8 FOOT LENGTH - TWO PIECES REQUIRED	
Line 44973	Note:	
9Jan16 / 11Jan16		

CABINETRY APPLIANCE - FRIDGE

Inv.3467	1 - SUPPLY AND INSTALL KITCHEN 59 CM FRIDGE CABINET - 1 GABLE & CABINET 59 CM DEEP - DEEP - UPGRADE 2	
Line 44968	Note: LOCATION AS PER SKETCH	
9Jan16 / 11Jan16		
Inv.3467	1 - SUPPLY AND INSTALL KITCHEN BASE CABINET TO ACCOMMODATE BUILT-IN BAR FRIDGE TO THE SERVERY	
Line 44972	Note: AS PER SKETCH ATTACHED	
9Jan16 / 11Jan16		

CABINETRY HARDWARE

Inv.3467	1 - SUPPLY AND INSTALL KITCHEN BASE WASTE / RECYCLE CENTER PULL OUT DOOR - ONLY AVAILABLE IN 45 CM CABINET (2) 35L BINS - PRICE IS PER UNIT	
Line 44971	Note: LOCATION AS PER SKETCH	
9Jan16 / 11Jan16		
Inv.3467	1 - SUPPLY AND INSTALL KITCHEN - CABINET HARDWARE - UPGRADE 2 - DISPLAY BOARD	
Line 44981	Note: TO BE INSTALLED HORIZONTALLY	
9Jan16 / 11Jan16		

CABINETRY MICROWAVE OVEN STOVE COOKTOP

Inv.3467	1 - SUPPLY AND INSTALL KITCHEN BUILT IN DOUBLE APPLIANCE CABINET WITH DRAWER BELOW - TRIM KIT REQUIRED - PURCHASER MUST SUPPLY SPECS - UPGRADE 2	
Line 44970	Note: LOCATION AS PER SKETCH	
9Jan16 / 11Jan16		
Inv.3467	1 - SUPPLY AND INSTALL KITCHEN COOKTOP CABINET (FULL HEIGHT) WITH FALSE TOP DRAWER AND POT & PANS DRAWERS BELOW - PURCHASER MUST SUPPLY SPECS - UPGRADE 2	
Line 44969	Note: LOCATION AS PER SKETCH	
9Jan16 / 11Jan16		



CONSTRUCTION SUMMARY

Teefy Developments Limited / 9130 Bathurst

Lot/Unit: 101 Phase/Building: 1 Model/Floor Plan: Riverdale(22-3)

CABINETRY MISCELLANEOUS

Inv.3467	1 - SUPPLY KITCHEN DISHWASHER PANEL - ANNEX SERIES	
Line 44990	Note: PURCHASER ACKNOWLEDGES AND ACCEPTS THAT THEY ARE RESPONSIBLE FOR INSTALLATION AFTER CLOSING	
9Jan16 / 11Jan16		

CABINETRY VANITY

Inv.3467	1 - SUPPLY AND INSTALL MASTER ENSUITE VANITY BANK OF DRAWERS - 55 CM MAXIMUM - UPGRADE 2 - ANNEX SERIES	
Line 45001	Note: AS PER SKETCH ATTACHED	
9Jan16 / 11Jan16		

COUNTER TOP - KITCHEN

Inv.3467	4 - SUPPLY AND INSTALL GRANITE CUTOUT AND POLISHED EDGE FOR UNDERMOUNT SINK TO THE: - LOWER BATH [X1] - MAIN BATH [X1] - MASTER ENSUITE [X2]	
Line 44980	Note: UNDERMOUNT SINK PURCHASED SEPARATELY.	
9Jan16 / 11Jan16		

ELECTRICAL

Inv.3467	1 - SUPPLY AND INSTALL LIGHT VALANCE ROUGH IN (INCLUDES 1 SWITCH)	
Line 44992	Note: LOCATION AS PER SKETCH ATTACHED.	
9Jan16 / 11Jan16		
Inv.3467	1 - SUPPLY AND INSTALL CAPPED CEILING LIGHT ROUGH-IN ONLY ON EXISTING SWITCH. TERMINATE CONNECTION TO SWITCHED OUTLET AND USE EXISITNG SWITCH IN THE FORMAL ROOM.	
Line 44993	Note: LOCATION AS PER SKETCH ATTACHED.	
9Jan16 / 11Jan16		
Inv.3467	2 - SUPPLY AND INSTALL CAPPED CEILING LIGHT ROUGH-IN ONLY ON SEPARATE SINGLE SWITCH TO THE: - FAMILY ROOM - OVER THE BREAKFAST BAR	
Line 44994	Note: LOCATION AS PER SKETCH ATTACHED.	
9Jan16 / 11Jan16		
Inv.3467	2 - SUPPLY AND INSTALL ADDITIONAL INTERIOR RECEPTACLE ON SEPARATE CIRCUIT TO THE: - KITCHEN FOR FUTURE BUILT-IN APPLIANCES - SERVERY FOR FUTURE BUILT-IN BAR FRIDGE	
Line 44995	Note: LOCATION AS PER SKETCH ATTACHED.	
9Jan16 / 11Jan16		

HEATING AND AIR CONDITIONING

Inv.3467	1 - SUPPLY AND INSTALL GAS LINE - ROUGH-IN ONLY - FIRST CONNECTION- FOR BBQ	
Line 44984	Note: AS PER SKETCH ATTACHED	
9Jan16 / 11Jan16		
Inv.3467	1 - SUPPLY AND INSTALL GAS LINE - ROUGH-IN ONLY - FOR STOVE TO INCLUDE 110V CODE REQUIREMENT	
Line 44983	Note: LOCATION AS PER SKETCH	
9Jan16 / 11Jan16		



CONSTRUCTION SUMMARY

Teefy Developments Limited / 9130 Bathurst

Lot/Unit: 101 Phase/Building: 1 Model/Floor Plan: Riverdale(22-3)

MISCELLANEOUS

PLUMBING

Inv.3467	1 - SUPPLY AND INSTALL MOEN SOAP/LOTION DISPENSER MODEL 3942 IN CHROME TO THE KITCHEN	
Line 45002	Note: AS PER SKETCH ATTACHED	
9Jan16 / 11Jan16		
Inv.3467	4 - SUPPLY AND INSTALL CONTRAC CATENA 20" RECTANGULAR UNDERMOUNT SINK MODEL 4210CIY TO THE: - LOWER BATH [X1] - MAIN BATH [X1] - MASTER ENSUITE [X2]	
Line 44982	Note: CUT OUT PURCHASED SEPARATELY	
9Jan16 / 11Jan16		
Inv.3467	1 - SUPPLY AND INSTALL WATERLINE ROUGH-IN TO THE FRIDGE LOCATION (NO HOOK UP)	
Line 44985	Note: LOCATION AS PER SKETCH ATTACHED.	
9Jan16 / 11Jan16		
Inv.3467	1 - SUPPLY AND INSTALL HOT WATERLINE ROUGH-IN TO THE MASTER ENSUITE TOILET LOCATION FOR FUTURE BIDET HOSE ATTACHEMENT.	
Line 45000	Note: LOCATION AS PER SKETCH ATTACHED	
9Jan16 / 11Jan16		
Inv.3467	1 - SUPPLY AND INSTALL AMERICAN STANDARD XEN 0990.000 17"X17"X5" TEMPERED GLASS VESSEL BASIN WITH CHROME DRAIN INCLUDED TO THE POWDER ROOM	
Line 44988	Note: VESSEL FAUCET PURCHASED SEPARATELY	
9Jan16 / 11Jan16		
Inv.3467	1 - SUPPLY AND INSTALL MOEN SINGLE HANDLE VESSEL LAVATORY FAUCET WITH DRAIN MODEL 6810/A2020 IN CHROME TO THE POWDER ROOM	
Line 44989	Note: VESSEL SINK PURCHASED SEPARATELY	
9Jan16 / 11Jan16		
Inv.3467	1 - SUPPLY AND INSTALL PLUMBING ROUGH-IN TO THE STOVE LOCATION FOR FUTURE POT FILLER	
Line 44996	Note: LOCATION AS PER SKETCH ATTACHED.	
9Jan16 / 11Jan16		
Inv.3467	1 - SUPPLY AND INSTALL INSINKERATOR INSTANT HOT WATER DISPENSER MODEL HOT1 ONE-PIECE IN THE KITCHEN	
Line 44997	Note: LOCATION AS PER SKETCH	
9Jan16 / 11Jan16		

TILE - FLOOR

Inv.3467	1 - SUPPLY AND INSTALL FLOOR TILE - UPGRADE 9 - - KITCHEN AND BREAKFAST FLOOR WITH SERVERY	
Line 44960	Note:	
9Jan16 / 11Jan16		
Inv.3467	1 - SUPPLY AND INSTALL FLOOR TILE - UPGRADE 9 - - FORMAL ROOM	
Line 44962	Note:	
9Jan16 / 11Jan16		



CONSTRUCTION SUMMARY

Teefy Developments Limited / 9130 Bathurst

Lot/Unit: 101 Phase/Building: 1 Model/Floor Plan: Riverdale(22-3)

Inv.3467 Line 44964 9Jan16 / 11Jan16	1 - SUPPLY AND INSTALL FLOOR TILE - UPGRADE 9 - - VESTIBULE FLOOR Note: 	
Inv.3467 Line 44966 9Jan16 / 11Jan16	1 - SUPPLY AND INSTALL FLOOR TILE - UPGRADE 4 - - POWDER ROOM FLOOR Note: 	
Inv.3467 Line 44961 9Jan16 / 11Jan16	1 - SUPPLY AND INSTALL FLOOR TILE - UPGRADE 9 - - FAMILY ROOM Note: 	
Inv.3467 Line 44987 9Jan16 / 11Jan16	1 - SUPPLY AND INSTALL FLOOR TILE - UPGRADE 5 - - ENSUITE BATHROOM FLOOR Note: 	
Inv.3467 Line 44998 9Jan16 / 11Jan16	1 - SUPPLY AND INSTALL FLOOR TILE - UPGRADE 9 - - MAIN HALL Note: 	

EXTRAS AS PER OFFER

Stainless Steel Fridge, Stove and Dishwasher and front loading washer and dryer in white from Vendors standard samples, no cash value, not transferable. (Supplied only not installed) ** to - arrange delivery call: The Brick commercial sales division at Worksheet Note:	
Rogers Free Services Package includes 6 months of: home phone, TV and Internet Service. Worksheet Note:	
The Vendor agrees to supply and install hardwood flooring in all bedrooms, with a choice of stain, from Vendors standard samples. Worksheet Note:	
The Vendor agrees to supply and install engineered hardwood flooring in recreation room, with a choice of stain, from Vendors standard samples. Worksheet Note:	
The Vendor agrees to supply and install granite countertops in all bathrooms, including powder room, from Vendors standard samples. Worksheet Note:	
The Vendor agrees to supply and install optional lower level bedroom, from Vendors standard samples, at no charge. Worksheet Note:	

Purchasers: Negah Haghparsad & Touraj Hemati

Property: 101 of Plan -

Telephone Res. / Bus: (905) 731-2000 /

Project: Teffy Developments Limited

Decor Advisor: Diana Rojas

Model and Elevation: Riverdale(22-3)

Layout Changes: ☐ Yes ☒ No Sketch Attached: ☒ Yes ☐ No Exterior Colour Scheme:

1. Cabinetry	Style and Colour	Counter Top	Hardware
Kitchen / Breakfast	ANNEX DHGL TEXTIL PLATA GLOSS CTR*	QUARTZ 9241 ALMOND ROCCA	12817 HANDLE
Kitchen Island	ANNEX DHGL TEXTIL PLATA GLOSS CTR*	QUARTZ 9241 ALMOND ROCCA	12817 HANDLE
Laundry Room	SLAB MAPLE - OYSTER CL	N/A	9677 HANDLE
Powder Room	ANNEX DHGL EUROLINE 03 GLOSS CTR*	QUARTZ 9141 ICE SNOW	9677 HANDLE
Main Bathroom	SLAB MAPLE - OYSTER CL	MARBLE - BOTICCINO	9677 HANDLE
Master Ensuite Bathroom	ANNEX DHGL - RUEDA GLOSS MWP*	MARBLE - PERLATO ROYALE	9677 HANDLE
Second Ensuite Bathroom (If Applicable)			
LOWER BATH	SLAB MAPLE - OYSTER CL	MARBLE - BOTICCINO	9677 HANDLE

Appliances Custom Size Fridge Valance Lighting Microwave / Range Hood
☒ Yes ☐ No ☐ Yes ☒ No ☐ Yes ☒ No
 Cooktop / Rangetop Built in Wall Oven Slide-in Range
☒ Yes ☐ No ☒ Yes ☐ No ☐ Yes ☒ No

Comment

*** ALL HARDWARE TO BE INSTALLED ON A HORIZONTAL
 *** BOTH LAUNDRIES TO BE THE SAME CABINETS AND HARDWARE
 *** SEE APPLIANCE SPECS ATTACHED

2. Flooring

	Selection
FOYER	24X24 MARMI EVOLUZIONE POLISHED - TAFU*
Main Hall	24X24 MARMI EVOLUZIONE POLISHED - TAFU*
Back Hall	
Breakfast	24X24 MARMI EVOLUZIONE POLISHED - TAFU*
Laundry Room	LOWER & UPPER = 13X13 COSTA MATTE - IVORY
Kitchen	24X24 MARMI EVOLUZIONE POLISHED - TAFU*
Powder Room	12X12 REGAL - SHELL WHITE POLISHED*
Main Bathroom	13X13 COSTA MATTE - IVORY
Master Ensuite	17.7X17.7 MUST POLISHED IVORY*
Bathroom (If Applicable)	
Mud Room	13X13 COSTA MATTE - IVORY
LOWER BATH	13X13 COSTA MATTE - IVORY
Living Room	FORMAL ROOM = 24X24 MARMI EVOLUZIONE POLISHED - TAFU*
Dining Room	
Family / Great Room	24X24 MARMI EVOLUZIONE POLISHED - TAFU*
Den / Library / Study	LOWER REC ROOM = 3-5/8X3/4 SATIN FINISH GEN RO ENG HRDWD NF - COBALT
Basement Landing (If Applies)	
Lower Landing (If Applicable)	
Upper Landing	3-5/8X3/4 SATIN FINISH GEN RO ENG HRDWD NF - COBALT
Upper Hall	3-5/8X3/4 SATIN FINISH GEN RO ENG HRDWD NF - COBALT
Master Bedroom	3-5/8X3/4 SATIN FINISH GEN RO ENG HRDWD NF - COBALT
Bedroom #2	3-5/8X3/4 SATIN FINISH GEN RO ENG HRDWD NF - COBALT
Bedroom #3	3-5/8X3/4 SATIN FINISH GEN RO ENG HRDWD NF - COBALT
Bedroom #4	3-5/8X3/4 SATIN FINISH GEN RO ENG HRDWD NF - COBALT
Bedroom #5	

Flooring Continued on Page 2

Initial:

Handwritten initials: T.H.

Page 1 of 3



INTERIOR COLOUR SCHEME

Purchasers: Negah Haghparastrad & Touraj Hemati

Property: 101 of Plan -

Telephone Res. / Bus: (905) 731-2000 /

Project: Teefy Developments Limited

Decor Advisor: Diana Rojas

Model and Elevation: Riverdale(22-3)

2. Flooring - Continued -

Upgrade Underpad	Type	Area
	<input type="text"/>	<input type="text"/>
Carpet on Stairs	Capped	Runner - *Upgrade
Comment	<input type="text"/>	<input type="text"/>

3. Plumbing Fixtures / Faucets

Kitchen	<input type="text" value="STND"/>	Second Ensuite	<input type="text"/>	Powder Room	<input type="text" value="UPG"/>
Master Ensuite	<input type="text" value="STND"/>			Other Room	<input type="text"/>
Main Bathroom	<input type="text" value="STND"/>	LOWER BATH	<input type="text" value="STND"/>		

Comment

*** SEE UPG EXTRAS

4. Wall Tile

	Tile Selection	Listello	Insert	Insert Selection
Main Bathroom	8X10 VENUS - BEIGE	<input type="checkbox"/>	<input type="checkbox"/>	
Master Ensuite				
Tub Deck		<input type="checkbox"/>	<input type="checkbox"/>	
Tub Apron		<input type="checkbox"/>	<input type="checkbox"/>	
Tub Surround		<input type="checkbox"/>	<input type="checkbox"/>	
Shower Stall	8X10 SERPENTINE - KREM	<input type="checkbox"/>	<input type="checkbox"/>	
Second Ensuite		<input type="checkbox"/>	<input type="checkbox"/>	
LOWER BATH	8X10 VENUS - BEIGE	<input type="checkbox"/>	<input type="checkbox"/>	
		<input type="checkbox"/>	<input type="checkbox"/>	
Kitchen Backsplash		<input type="checkbox"/>	<input type="checkbox"/>	
Complete Backsplash		<input type="checkbox"/>	<input type="checkbox"/>	

Comment

5. Fireplace

	Living Room			Family Room			Other Room - Specify		
	Purchased	As Per Plan	N/A	Purchased	As Per Plan	N/A	Purchased	As Per Plan	N/A
Fireplace Type	<input type="radio"/>	<input type="radio"/>	<input type="radio"/>	<input type="radio"/>	<input checked="" type="radio"/>	<input type="radio"/>	<input type="radio"/>	<input type="radio"/>	<input type="radio"/>
Mantle Type	<input type="text"/>			STND***			<input type="text"/>		
Over Mantle	<input type="text"/>			<input type="text"/>			<input type="text"/>		
Colour / Stain	<input type="text"/>			<input type="text"/>			<input type="text"/>		
Surround	<input type="text"/>			<input type="text"/>			<input type="text"/>		
Hearth	<input type="text"/>			<input type="text"/>			<input type="text"/>		

Comment

*** FURRED OUT WALL SEE UPG EXTRAS

21

Initial:

sh-T-H

Page 2 of 3



INTERIOR COLOUR SCHEME

T-1A

Purchasers: Negah Haghparastrad & Touraj Hemati

Property: 101 of Plan -

Telephone Res. / Bus: (905) 731-2000 /

Project: Teefy Developments Limited

Decor Advisor: Diana Rojas

Model and Elevation: Riverdale(22-3)

6. Trim Carpentry

Door Hardware Interior Trim

Comment

Interior Doors

☐ 2 Panel Arch Top☒ 2 Panel Square Top☐ 6 Panel

Initial for Door Style

ch. T.H.

7. Railings and Pickets

Railing Package Railing Colour Wood Stairs ☐ No ☒ OakPicket Colour Tread Colour

Comment

8. Plaster Mouldings and Medallions

Foyer

Kitchen/Breakfast

Main Hall

Den/Library

Living Room

Lower Landing

Dining Room

Family Room

Comment

9. Wall Paint

Smooth Ceilings

☐ First Floor☐ First Floor incl. Second Floor Hall☐ First and Second Floor☒ Throughout☐ Not ApplicableTrim Paint

10. Additional Comments

11. Disclaimers and Notes

- 1) Colours of all materials are as close as possible to builder's selection, but not necessarily identical due to variances in manufacturing.
- 2) Any extras listed above are null and void unless accompanied by a separate invoice/amendment. Said invoice must be paid in full.
- 3) The Purchaser acknowledges that after Interior Colour Selection form is signed and dated, no further changes will be permitted other than re-selection due to unavailability. *ch. T.H.* Purchaser's Initials
- 4) The Purchaser acknowledges reading and accepting the "Senator Homes Décor Centre Disclaimers" form. This document contains other miscellaneous disclaimers.

This Interior Colour Selection is final and approved by:

Purchaser:

Signature: *T. Haghparastrad*Date: *Jan 11/16*Signature: *T. Haghparastrad*Date: *Jan 11/16*

Vendor:

Teefy Developments Limited

Jan 13/16

RIVERDALE

T-101
SENATOR HOMES
DECOR CENTRE

DATE: JAN 09 2016

INITIALS: *dt. T.H.*

2454 SQ.FT. / 2288 SQ.FT. WITH OPTIONAL TANDEM GARAGE

SOAP/LOTION DISPENSOR
INSTANT HOT WATER

GASLINE FOR BBQ.

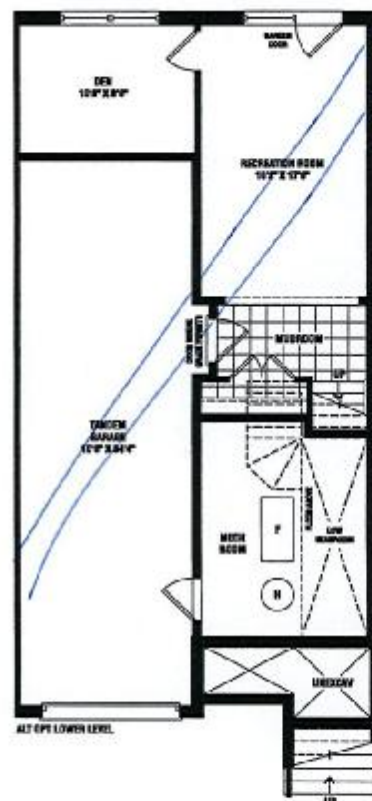
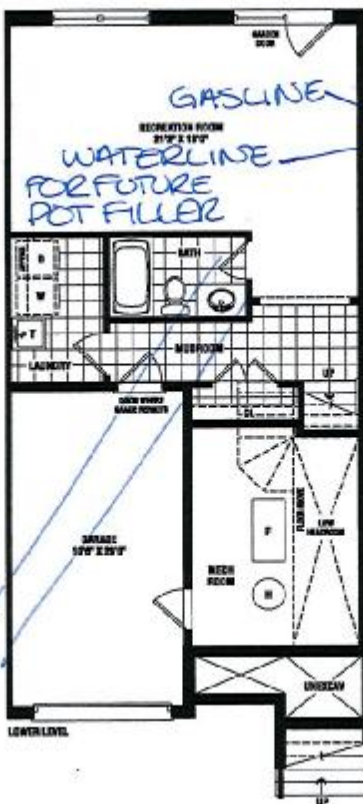

- Ⓢ = cable tv r/i
- Ⓣ = telephone r/i
- ⌀ = copped ceiling r/i
- Ⓢ = dedicated electrical outlet.
- ⓈC = computer outlet.

SENATOR
HOMES

Renderings are artist's concept. Some elevations may vary from that shown. Actual useable square footage may vary from that stated herein. Some floorplans and elevations are mirror image to that shown. E&O.E. 22-3

RIVERDALE - TH-22-3

SENATOR HOMES - TEEFY

STD. LAYOUT

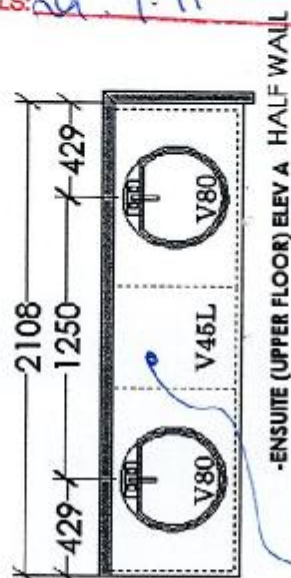
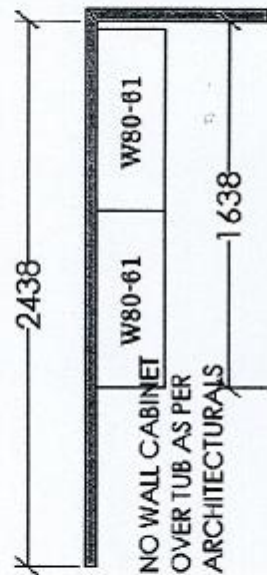
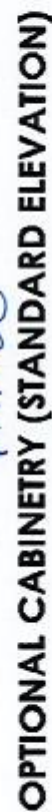
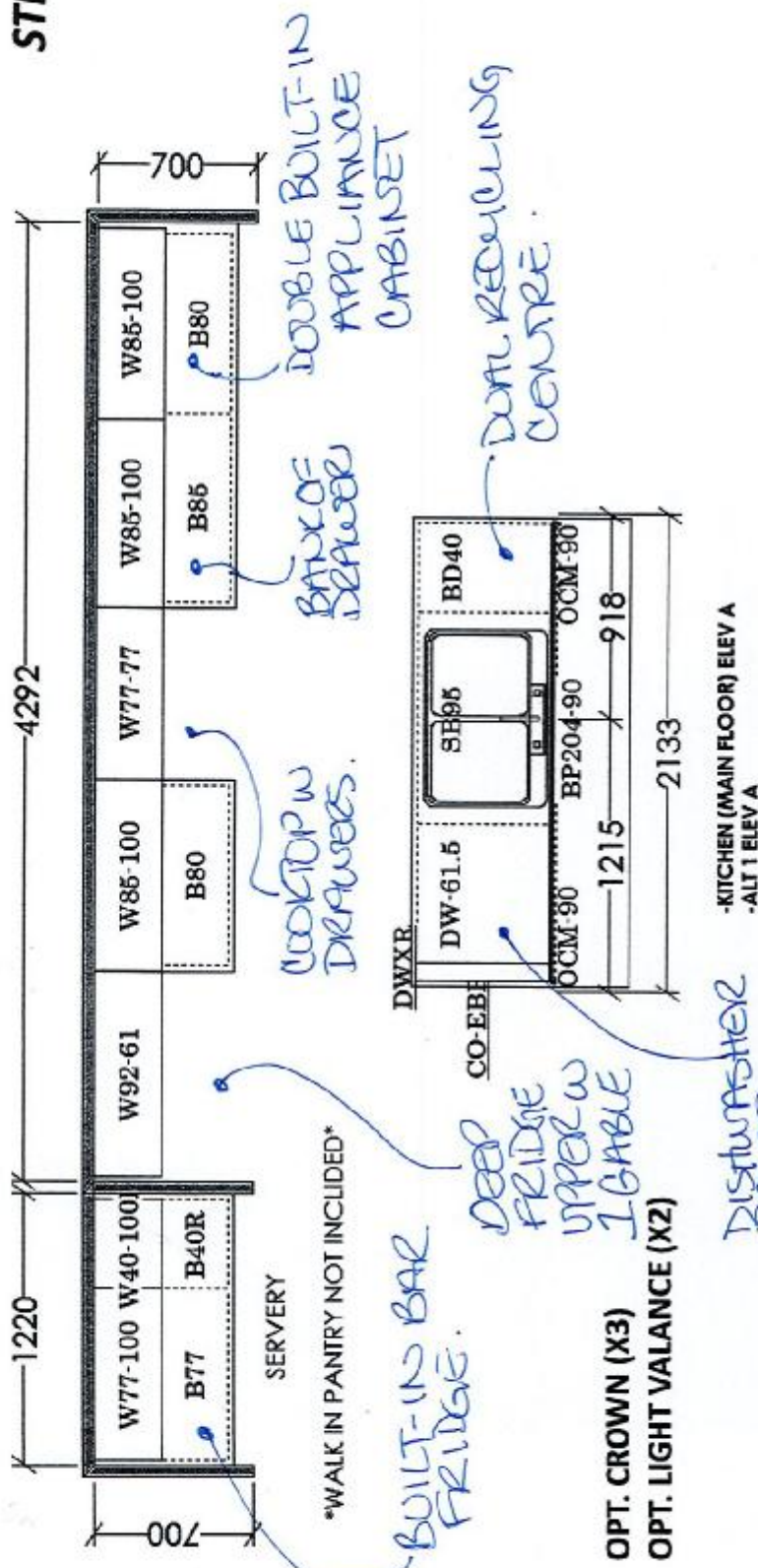

SENATOR HOMES
DECOR CENTRE

DATE: JAN 09 2016

INITIALS: Q. T. H.

T-101

T-101

SENATOR HOMES
DECOR CENTRE

DATE: JAN 09 2016

INITIALS: *ch. t. h.*

- LOWER BATH (x1)
 - MAIN BATH (x1)
 - MASTER ENSUITE (x2)
 (x4 TOTAL)



contrac

CATENA 20" RECTANGULAR UNDERMOUNT SINK

4210CIY Undermount Sink

Product Specs:

- Vitreous china
- Front overflow hole
- Template and mounting hardware supplied

Overall Dimensions (W x D x H):

(OD): 510mm(20") x 395mm(15½") x 190mm(7½")
 (ID): 450mm(17¾") x 335mm(13⅜") x 140mm(5½")

Compliance Certifications:

Meets or exceeds the following :

- IAPMO cUPC
- ASME A112.19.2 / CSA B45.1-2008

Shipping:

Cube 1.72
 GW 27 lbs

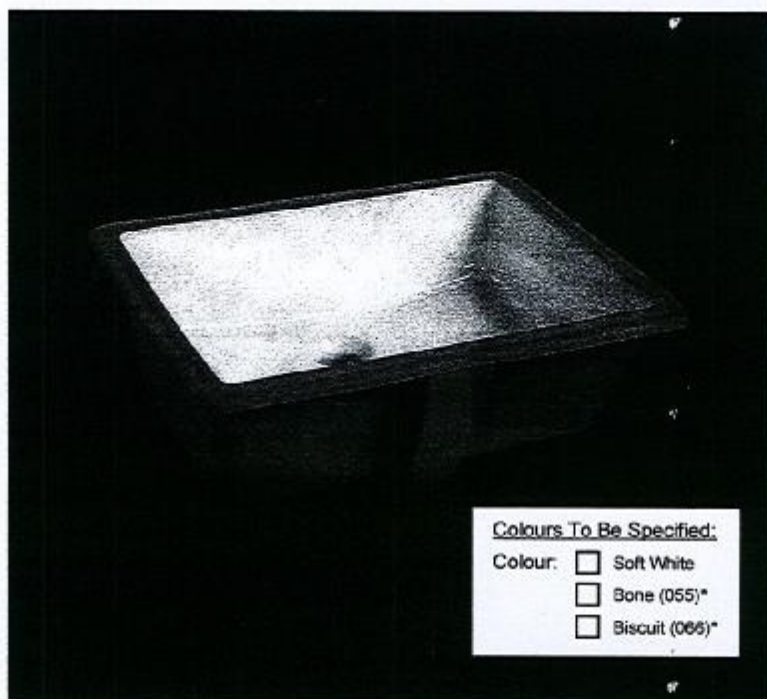

Colours To Be Specified:

- Colour: ☐ Soft White
☐ Bone (055)*
☐ Biscuit (066)*

Notes:

Dimensions of fixtures are nominal and may vary within the range of tolerances established by ASME standard A112.19.2. These measurements are subject to change or cancellation. No responsibility is assumed for use of superseded or voided pages.

*Bone and Biscuit available through Direct import (CIF) only.

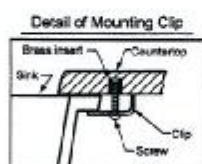

Note:
 ▲ Dimensions shown for location of supplies and "P" trap are suggested

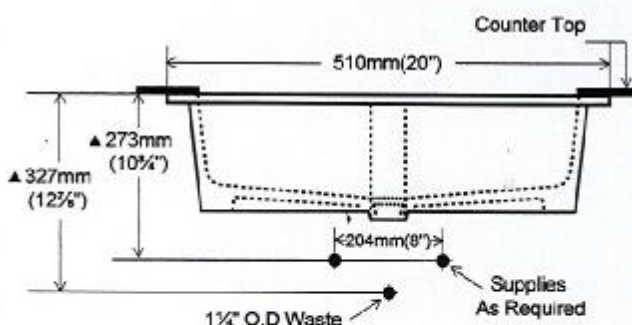
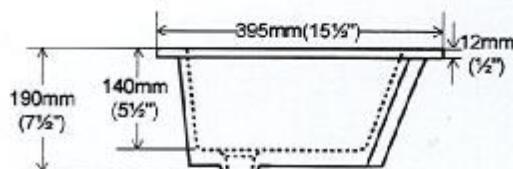
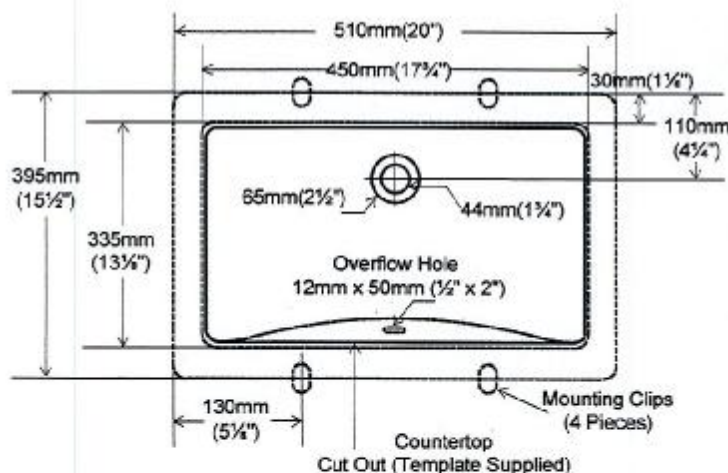

T-101

SENATOR HOMES
DECOR CENTRE

DATE: JAN 09, 2016

INITIALS: Li.T.H

Option 2

XEN



American Standard XEN
0990.000 17" x 17" x 5"
Tempered Glass
Chrome Grid Drain Included

POWDER ROOM
(x1)

Method

Modern



Single Handle Vessel
Lavatory with Drain
Model 6810T / A2020 +

CHROME



Single Handle Lavatory
with Pop-Up Drain
Model 6810T



Widespread Lavatory with
Pop-Up Drain
Model 69000 / T6820T

T-101

SENATOR HOMES
DECOR CENTRE

DATE: JAN 09 2016

INITIALS: ali. J.H.

POWDER ROOM

Soap or Lotion Dispensers

Traditional | Transitional | Modern



To order, combine the model number with one of these finish letters

Chrome
(Use dispenser
number only)



~~SS~~



T-101

SENATOR HOMES
DECOR CENTRE

DATE: JAN 09 2016

INITIALS: *gh T-H*

KITCHEN

(XI)

T-101

SENATOR HOMES
DECOR CENTRE

DATE: 910Z 6 0 NYR JAN 09 2016

INITIALS: ph. T. H

KITCHEN

in sink erator[®]

The Next Necessity[™]

Instant Hot Water Dispensers

Model Hot1

One-piece construction for easy installation



Dimensions

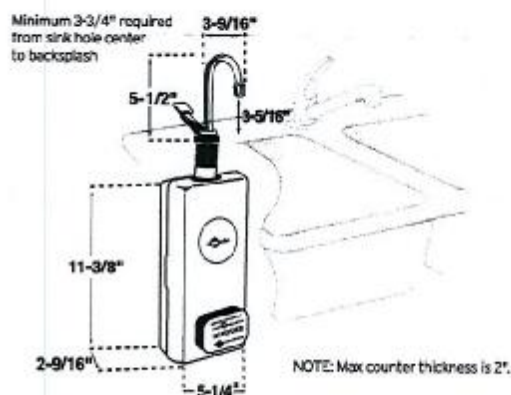

Submittal Sheet

- **Hot Only** - 1/3-gallon tank delivers 40 cups of near-boiling 190°F water per hour
- 1-Year *We Come To You[®]* In-Home Service Warranty*
- 115 volts, 500 watts, 4.3 amps
- Available in polished stainless steel with black handle

Sample Specification

Instant hot water dispenser(s) shall be InSinkErator Model Hot1 with adjustable temperature from 160°F to 200°F and instant, self-closing hot valve.

Warranty:
1-year parts and in-home service.

* The complete InSinkErator warranty is included in the Care & Use booklet packed with each unit.

Specifications

Capacity	1/3-gallon copper tank dispenses 40 cups of 190°F water per hour
Electrical	115 volts A.C., 500 watts, 4.3 amp heating element with grounded three (3) prong plug
Thermostat	Snap-action, adjustable from 160°F to 200°F (factory preset at 190°F)
Valve	Instant, self-closing
Recommended Supply Pressure	30-125 psi
Shipping Weight	Approximately 4 lbs.
Required Hole Diameter	1-1/4" - 1-1/2" standard sink hole

Job Specifications

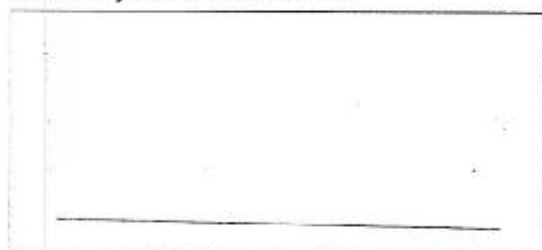

Complies with California Lead Plumbing Law

1-800-558-5700
www.insinkerator.com

Printed in USA



EMERSON
Appliance Solutions

The Emerson logo is a trademark and service mark of Emerson Electric Co.

InSinkErator may make improvements and/or changes in the specifications at any time, in its sole discretion, without notice or obligation and further reserves the right of change or discontinuous models.

© 2011 InSinkErator, a division of Emerson Electric Co. All Rights Reserved.

HWD386-11A-45-10

T-101

SENATOR HOMES
DECOR CENTRE

JAN 09 2016

DATE:

INITIALS:



Electrolux

French Door Refrigerators

EI23BC35K S, EI23BC35K W, EI23BC35K B

Featuring IQ-Touch™ Electronic Controls



Most Usable Capacity¹

Most usable space inside, same space on the outside, so you'll have space for everything from party platters and beverages to kids' snacks and juice boxes.



IQ-Touch™ Controls

For those who like to have their options always visible, the IQ-Touch™ control panel displays your options at all times.

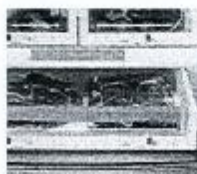

Luxury-Glide® Cool Zone™ Drawer

This drawer keeps contents chilled, so it's perfect for wine and beer or even snacks and juice boxes.



SpillSafe® Sliding Glass Shelves

SpillSafe® glass shelves slide out for easy access and are designed to keep spills contained, making cleanup a breeze.

23 CU. FT. COUNTER-DEPTH FRENCH DOOR REFRIGERATORS

Capacities

Total Capacity	22.6 Cu. Ft.
Fresh Food Volume	15.70 Cu. Ft.
Freezer Volume	5.90 Cu. Ft.
Total Shelf Area	23.20 Sq. Ft.
Fresh Food Shelf Area	17.85 Sq. Ft.
Freezer Shelf Area	5.35 Sq. Ft.

Exterior

Signature Soft-Arc Door and Handle Design	Yes
Electronic Controls	IQ-Touch™
Hidden Hinge Door Design	Yes
Ice/Water Dispenser	Yes
Perfect Set™ Temperature Control System and Display	Yes
Cubed/Cubes/Water	Yes/Yes/Yes
Air and Water Filter Indicator/Reset	Yes
Ice Maker On/Off	Yes
Fast Freeze™	Yes
Lock/Dispenser Light Control	Yes

Fresh Food Conveniences

PureAdvantage® Water & Ice	Yes
PureAdvantage® Air Filtration/Water Filter Location	Yes/Bottom Left
Temp Alarm System/Door Ajar Alarm	Yes/Yes
Power Failure Alarm	Yes
Glass Shelves	SpillSafe® Sliding, 1 Quarter Width, 3 Half Width
Humidity-Controlled Left Crisper	Luxury-Glide®
Humidity-Controlled Right Crisper	Luxury-Glide®
Perfect Temp® Drawer	
Cool Zone™ Drawer	Luxury-Glide®
Wine and Beverage Mat	
Dispenser Bin	Yes
Clear Gallon Door Bins (Adjustable)	1
Clear 2-Liter Door Bins (Adjustable/Removable)	1/1
Clear 1/2 Gallon Door Bins	
Clear Condiment Bin	1
Clear Dairy Door	
Tilt-Out Can Racks	2
Luxury-Design® LED Ramp-Up Multilevel Lighting	Yes
Automatic Ice Maker	Yes

Freezer Conveniences

Automatic Ice Maker (Second Ice Maker)	Yes
Self-Closing Drawer	Yes
Slicing Freezer Baskets	2 Luxury-Glide® (1 Deep Plastic w/ Divider)
Soft Freeze™ Bin/Pizza Bin	
Tilt-Out Door Racks/Plastic Basket Tray	
Luxury-Design® LED Ramp-Up Multilevel Lighting	Yes

Additional Features

ENERGY STAR®	Yes
Setpoint Mode (Star-K® Certified)	Yes

Specifications

Color—	
Stainless Steel	S
White	W
Black	B
Product Dimensions—	
Height (with Hinges and 3/8" Rollers)	69-1/2"
Cabinet Width/Door Width	35-5/8"/35"
Depth (to Center of Arc, with 50" Door Open)	28-3/16"
(with Drawer Fully Extended Including Handle)	43-9/16"
(with 7-1/2" Door)	45-7/8"
Power Supply Connection Location	Right Bottom Rear
Water Inlet Location	Left Bottom Rear
Voltage Rating	120V/60 Hz/15 or 20A
Connected Load (kW Rating) @ 120 Volts*	1.02
Minimum Circuit Required (Amps)	15
Shipping Weight (Approx.)	350 Lbs.

*An electrical supply with grounded three-wire receptacle is required. The power supply circuit must be installed in accordance with current edition of National Electrical Code (NEC) and local codes & ordinances.

NOTE: Always consult local and national electric & plumbing codes. Refer to Product Installation Guide for detailed installation instructions on the web at electroluxappliances.com.

Specifications subject to change.

¹As compared to other French Door Counter-Depth models.

electroluxappliances.com

French Door Refrigerators

EI23BC35K S, EI23BC35K W, EI23BC35K B



Electrolux

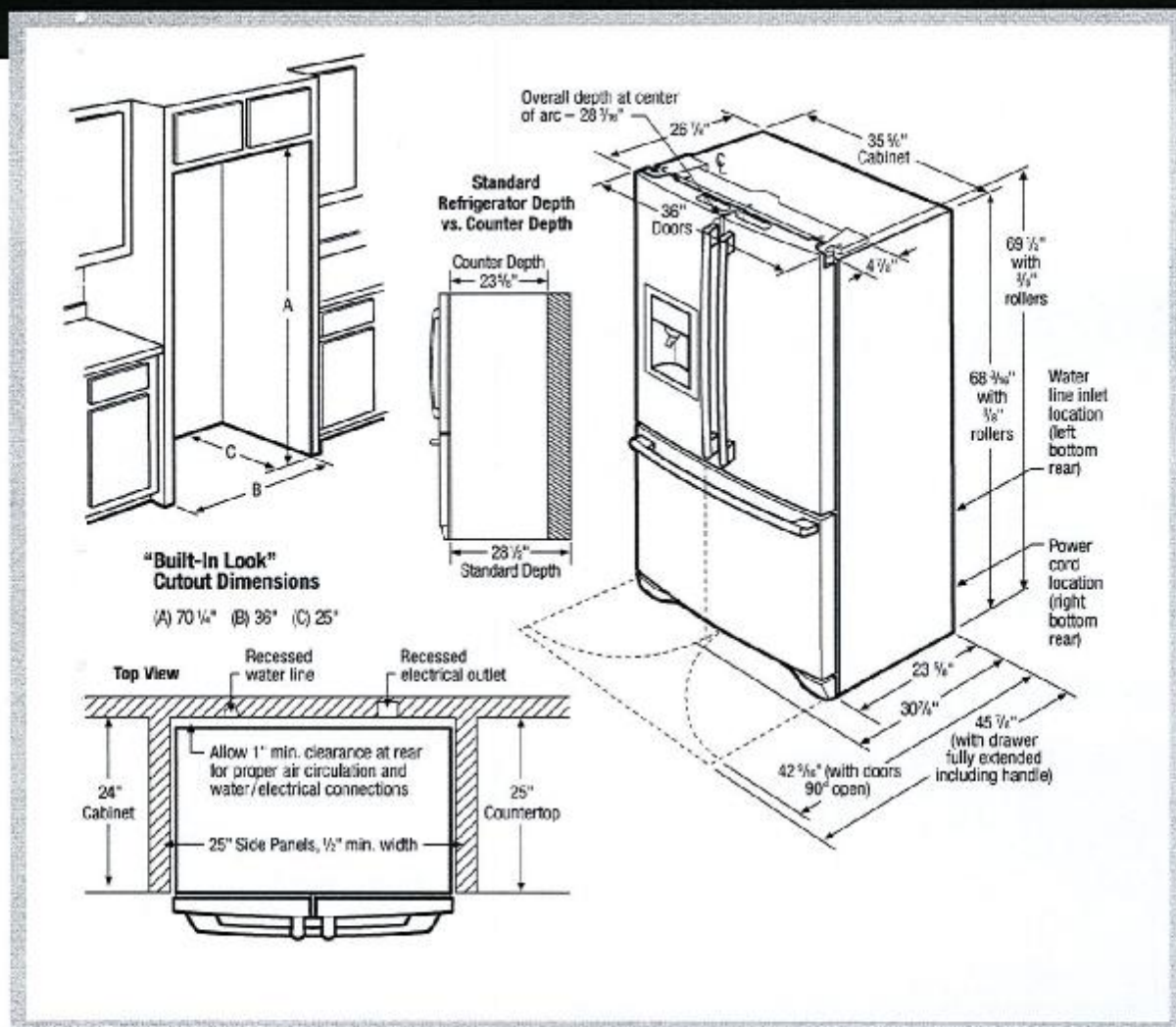

Counter-Depth French Door Refrigerator Specifications

- Product Weight – 345 Lbs.
- An electrical supply with grounded three-prong receptacle is required. The power supply circuit must be installed in accordance with current edition of National Electrical Code (NFPA 70) and local codes & ordinances.
- Voltage Rating – 120V/60 Hz/15 or 20 Amps
- Connected Load (kW Rating) @ 120 Volts = 1.02 kW
- Amps @ 120 Volts = 8.5 Amps
- Always consult local and national electric & plumbing codes.
- Floor should be level surface of hard material, capable of supporting fully loaded refrigerator.
- When installing refrigerator adjacent to wall, cabinet or other appliance that extends beyond front edge of unit, 20" minimum clearance recommended to allow for optimum 120° to 180° door swing, providing complete drawer/crisper access and removal. (Absolute 4-1/2" minimum clearance will ONLY allow for 90° door swing which will provide drawer/crisper access with restricted removal.)
- To ensure optimum performance, avoid installing in direct sunlight or close proximity to range, dishwasher or other heat source.

- For proper ventilation, front grille MUST remain unobstructed.
- Pecess electrical outlet when possible.
- Water recess on rear wall recommended to prevent water line damage.
- Water Pressure – Cold water line must provide between 30 and 100 pounds per square inch (psi).
- Copper tubing with 1/4" O.D. recommended for water supply line with length equal to distance from rear of unit to household water supply line plus 7 additional feet. Optional Water Supply Installation Kits available.
- Adjustable front rollers to assist with door alignment.

"Built-In Look" Specifications

- Minimum opening of 70-1/4" H x 36" W x 25" D required to allow for ease of installation, proper air circulation, and plumbing/electrical connections.
- Remove all wall/floor molding prior to installation.

Note: For planning purposes only. Refer to Product Installation Guide on the web at electroluxappliances.com for detailed instructions.

Electrolux Major Appliances, N.A.

USA • 10200 David Taylor Drive • Charlotte, NC 28262 • 1-877-4electrolux (1-877-435-3267) • electroluxappliances.com
 CANADA • 5855 Terry Fox Way • Mississauga, ON L5V 3E4 • 1-800-265-3352 • electroluxappliances.ca

EI23BC35K 06/13

© 2013 Electrolux Home Products, Inc.



High standards of quality at Electrolux Home Products, Inc. mean we are constantly working to improve our products. We reserve the right to change specifications or discontinue models without notice.

General Installation Guidelines

For Installation with French Door Refrigerator



Electrolux

Use these dimensions and clearance instructions for planning purposes only. For detailed installation instructions, refer to installation guide, packed with product, or on the web at electroluxappliances.com.

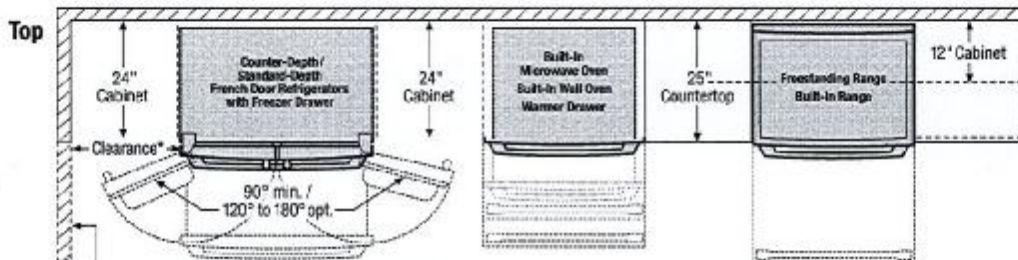
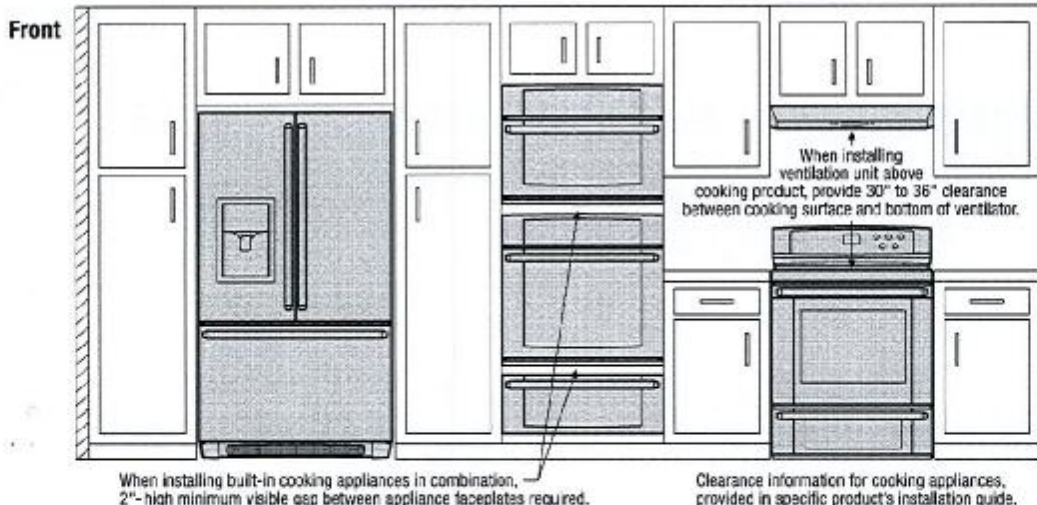

*When installing a French door refrigerator adjacent to wall, cabinet or another appliance that extends beyond front edge of unit, 20" minimum clearance recommended to allow for optimum 120° to 180° door swing, providing complete drawer / crisper access and removal. (Absolute 4-1/2" minimum clearance will ONLY allow for 90° door swing which will provide limited drawer / crisper access with restricted removal.)

When installing appliance with sliding drawer or drop-down door directly across from obstructions, provide sufficient clearance for drawer extension or door swing.

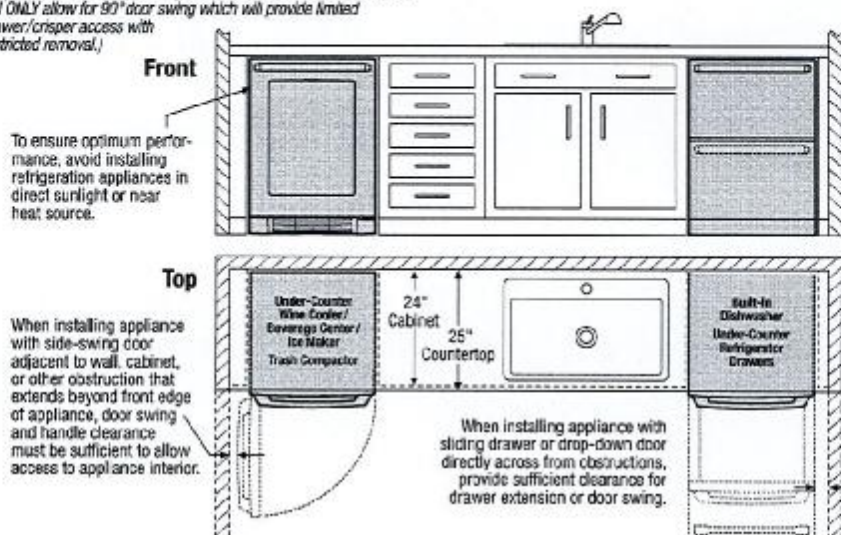

Electrolux Major Appliances, N.A.

USA • 10200 David Taylor Drive • Charlotte, NC 28262 • 1-877-4electrolux (1-877-435-3287) • electroluxappliances.com
 CANADA • 5855 Terry Fox Way • Mississauga, ON L5V 3E4 • 1-800-265-8352 • electroluxappliances.ca

INSTGDLN3_FDR EL 02/12

© 2012 Electrolux Home Products, Inc.

High standards of quality at Electrolux Home Products, Inc. mean we are constantly working to improve our products. We reserve the right to change specifications or discontinue models without notice.

T-101
 SENATOR HOMES
 DECOR CENTRE
 DATE: JAN 09 2016
 INITIALS: [Signature]



SPECIFICATION SHEET IU600ES SERIES

SPECIFICATIONS

MODEL	IU600ES SERIES
VOLTS	120 VAC
Hz	60
AMPS	1.8
INTERNAL BLOWER	600 CFM
CFM (LOW SPEED HORIZ. DISCHARGE)	160
CFM (HIGH SPEED HORIZ. DISCHARGE)	500*
CFM (LOW SPEED VERT. DISCHARGE)	160
CFM (HIGH SPEED VERT. DISCHARGE)	440*
SONE (LOW SPEED HORIZ. & VERT. DISCH.)	1.0
SONES (HIGH SPEED HORIZ. DISCHARGE)	9.5
SONES (HIGH SPEED VERT. DISCHARGE)	9.5
DUCTING SIZE	3 1/4" x 10"
2 LED MODULES	120 V, 5.5 W
WARRANTY	5 YEARS (EXCEPT LED MODULES, 3 YEARS)

* IF NEEDED, ASK A RECOMMENDED INSTALLER TO LIMIT DISCHARGE TO 300 CFM.

DIMENSIONS

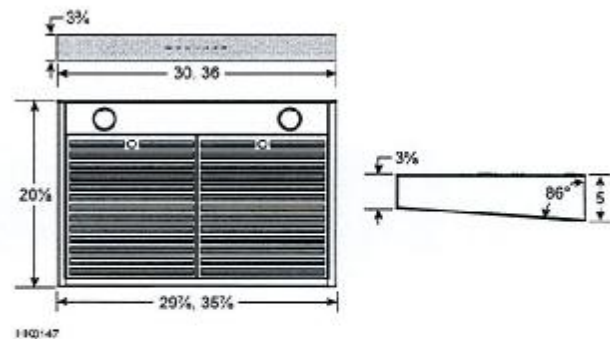

NOTE: DIMENSIONS SHOWN ARE IN INCHES.



AIR FLOW PERFORMANCE

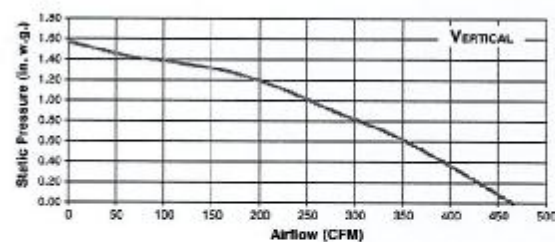
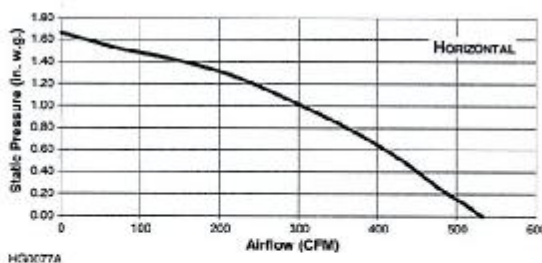

HVI-2100 CERTIFIED RATINGS comply with new testing technologies and procedures prescribed by the Home Ventilating Institute, for off-the-shelf products, as they are available to consumers. Product performance is rated at 0.1 in. (2.54 mm) static pressure, based on tests conducted in a state-of-the-art test laboratory. Sones are a measure of humanly-perceived loudness, based on laboratory measurements.



www.venmar.ca

Venmar Ventilation inc., 550 Lemire Blvd., Drummondville, Québec, Canada J2C 7W9 - Tel: 1-800-567-3855 Fax: 1-800-567-1715

PROJECT	REMARKS
LOCATION	
MODEL No.	
QTY.	
SUBMITTED BY	
DATE	

PRODUCT SPECIFICATIONS SUBJECT TO CHANGE WITHOUT NOTICE.

IU600ESd140612

TABLE OF CONTENTS

1.	INSTALL DUCTWORK	3-4
2.	PREPARE INSTALLATION	4-5
3.	PREPARE THE HOOD	5-6
4.	INSTALL GLASS PANEL (WG MODELS ONLY)	6
5.	INSTALL THE ADAPTER/DAMPER	7-8
6.	INSTALL THE HOOD	8
7.	CONNECT WIRING	9
8.	REINSTALL BLOWER WHEEL AND BOTTOM PANEL	9
9.	REINSTALL HYBRID FILTERS	10
10.	LED LIGHTING	10
11.	CARE	10-11
12.	OPERATION	11-12
13.	WIRING DIAGRAM	13
14.	SERVICE PARTS	14-15
15.	WARRANTY	16

1. INSTALL DUCTWORK

Plan where and how the ductwork will be installed.

The ducting from this fan to the outside of the building has a strong effect on the air flow, noise and energy use of the fan. Use the shortest, straightest duct routing possible for best performance, and avoid installing the fan with smaller ducts than recommended. Insulation around the ducts can reduce energy loss and inhibit mold growth. Fans installed with existing ducts may not achieve their rated airflow. Refer to the table next page to help you plan the most efficient installation.

Install wall or roof cap; once done, ensure there is no leak in house insulation. Connect metal ductwork to cap and work back towards the hood location. If 6" round ducts are installed, use a 3 1/4" x 10" to 6" transition positioned, if possible, 18" away from the adapter/damper. Use 2" metal foil duct tape to seal the joints.

We recommend to install the hood at a minimum distance of 24" from an electric range and of 30" from a gas range.

Distances over 30" are at the installer and users discretion.

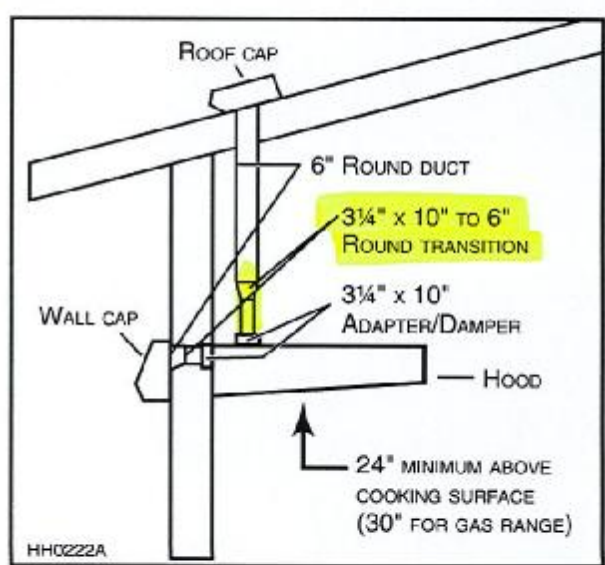
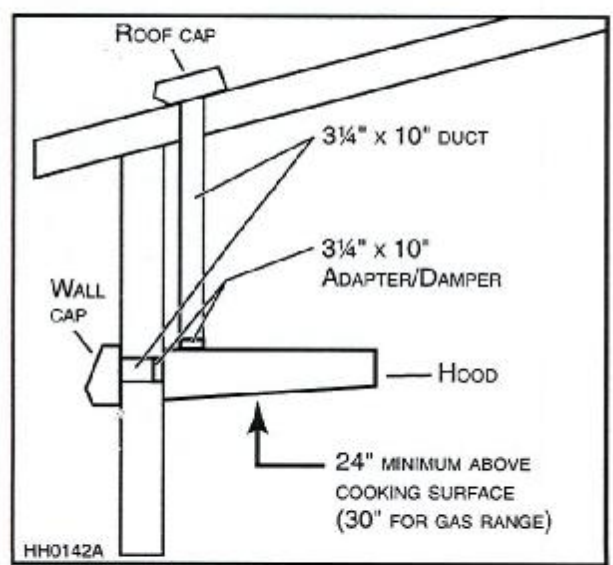

1. INSTALL DUCTWORK (CONT'D)

MAXIMUM DUCT LENGTHS RECOMMENDED TO ACHIEVE 80% EXHAUST EFFICIENCY

3 1/4" x 10" MAXIMUM DUCT LENGTH	6" ROUND MAXIMUM DUCT LENGTH	ROOF OR WALL CAP WITH DAMPER	ELBOW(S)* (90° AND/OR 45°)
60 FT.	-	1	0
50 FT.	-	1	1
40 FT.	-	1	2
-	50 FT.	1	0
-	40 FT.	1	1
-	30 FT.	1	2

*STANDARD ELBOWS WITH 1" INTERNAL RADIUS.

2. PREPARE INSTALLATION

⚠ WARNING

When performing installation, servicing or cleaning the unit, it is recommended to wear safety glasses and gloves.

NOTE: Before proceeding to the installation, check the contents of the box. If items are missing or damaged, contact the manufacturer.

Make sure that the following items are included:

- Hood
- Installation manual
- Accessories:
 - 2 hybrid filters
 - 3 1/4" x 10" adapter/damper (located in one styrofoam end cap)
 - Parts bag (located in one styrofoam end cap) including:
 - 1 wire clamp, 9 no. 8 x 1/2" screws, 2 wire connectors and 3 no. 6 x 1/2" standard screws

Parts sold separately:

- Ducts, elbows, wall or roof caps
- Transition 3 1/4" x 10" to 6" round (optional, for 6" round ducts installation only)
- Glass panel for IU600ES30WG and IU600ES36WG models (see service parts list on pages 14 and 15)

NOTES: 1. During installation, protect countertop and/or cooktop.

2. If the bottom of the cabinet is recessed, attach four 1" wide wood strips (not included), as shown at right, in order to properly attach the hood to the cabinet. The wood strips must be as thick as recess.

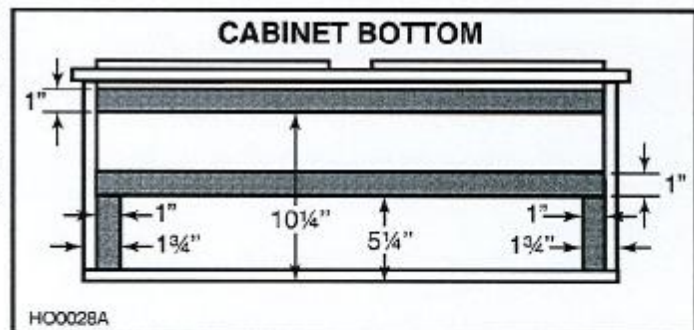

2. PREPARE INSTALLATION (CONT'D)

Cut-out the openings for duct (A) and power cable (B), in cabinet or wall, according to the direction of discharge chosen. See figures below.

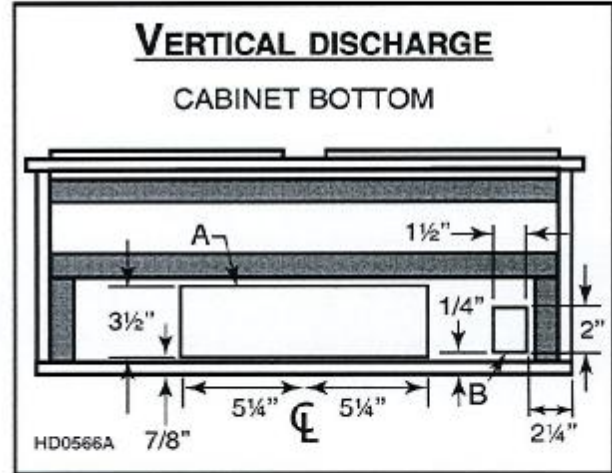
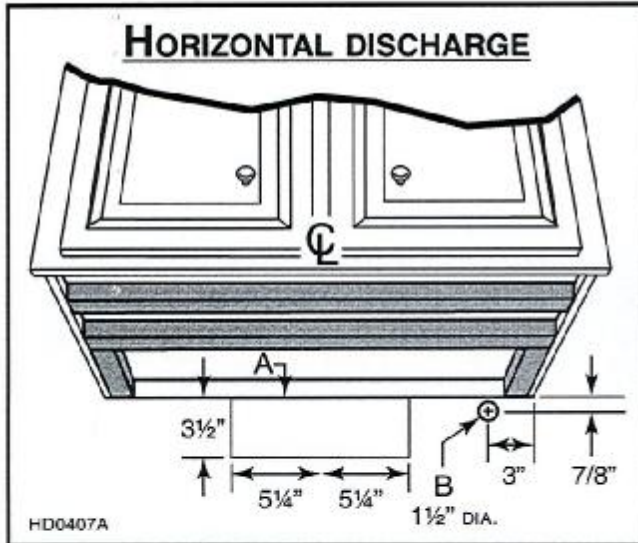

3. PREPARE THE HOOD

- 3.1 Lay the hood filters up on a table. Use a piece of cardboard to avoid damaging the table or the hood. Remove tape on filters. Lift filters by pushing them towards the back and flip them up, then set the filters aside.

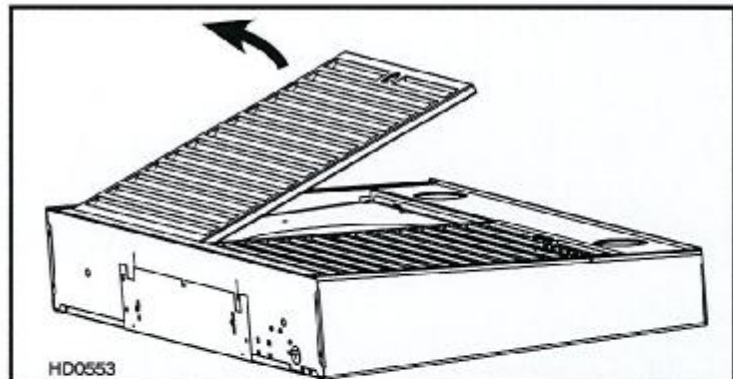

- 3.2 **FOR 30" WIDE HOODS:**
Remove the 7 screws (A only) retaining the bottom panel, and set aside.

FOR 36" WIDE HOODS:
Remove the 8 screws (A and B) retaining the bottom panel and set aside.

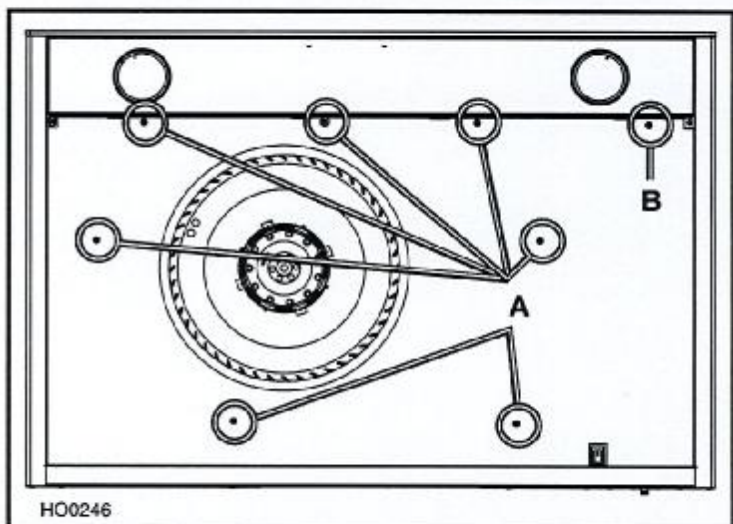

T-101
SENATOR HOMES
 DECOR CENTRE
 DATE: 1 JAN 09 2016
 INITIALS: NT



GAS COOKTOP

EW30GC60PS

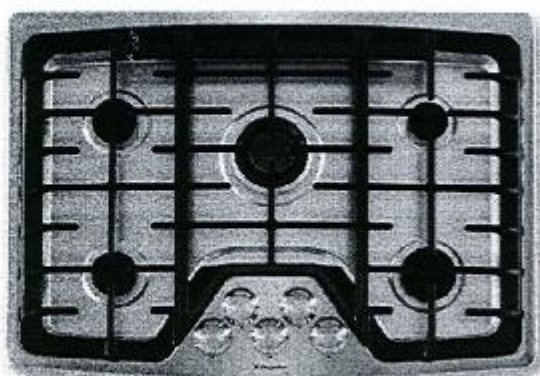

PRODUCT DIMENSIONS

Width	30"
Depth	21-3/4"
Height (Extreme Bottom to Underside of Cooktop)	4-1/4"

MORE EASY-TO-USE FEATURES

SEALED BURNERS

ELECTRIC PILOTLESS IGNITION

PLATINUM STAR® LIMITED WARRANTY

Our exclusive limited warranty that includes a 3-year coverage on parts and one year on labor without charge.*

PERFECT OVER A WALL OVEN

Mounts above a single wall oven for additional installation options.

DISHWASHER-SAFE GRATES

For easy cleanup.

A.D.A. COMPLIANT

When properly installed, this model is A.D.A.-qualified based on the United States Access Board's A.D.A./A.B.A. Accessibility Guidelines and the Department of Justice's 2010 A.D.A. Standards for Accessible Design.

SIGNATURE FEATURES



MIN-2-MAX® GAS BURNER

Designed with a dual-flame sealed burner, this cooktop offers the widest range of BTU performance in the industry for the utmost versatility — from a roaring 20,000-BTU boil to a 1,100-BTU simmer.



PROFESSIONAL-GRADE CONTROL KNOBS

Professional-grade control knobs are designed to provide you with pinpoint precision control.

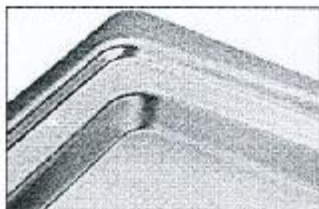

DEEP-Well DESIGN

Keeps spills contained for easy cleanup and lowers the cooking surface to countertop-level, which makes moving oversized pots and pans onto and off of the cooking surface much easier.



CONTINUOUS GRATES

Designed for cooking multiple dishes at varying temperatures on a single cooktop. These grates allow easy movement of even the heaviest pots and pans from burner to burner — without lifting.

Available in:



Stainless
 (S)

BURNER	BTU
Min-2-Max® Dual-Flame Sealed Burner	20,000 - 1,100
Sealed Power Burner	12,000
Sealed Precision Burner	9,500
Sealed Precision Burner	7,500
Sealed Precision Burner	5,000 - 700

*Eligibility based on product registration with Electrolux North America within 60 days of purchase. Product must have been purchased prior to July 1, 2013. Coverage requires national guard for 3 years and labor for 1 year.

ELECTROLUXAPPLIANCES.COM

T-101
SENATOR HOMES
DECOR CENTRE
 DATE: JAN 09 2016
 INITIALS: TH

GAS COOKTOP
 EW30GC60PS

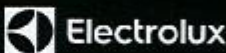

30" GAS COOKTOP	
FEATURES	
Deep-Well Formed Cooktop	Yes
Professional-Grade Burner Controls	Yes
Continuous Grates	Yes
Min-2-Max™ Dual Flame Sealed Burner – 20,000 – 1,100 BTU	1
Sealed Power Burner – 12,000 BTU	1
Sealed Precision Burner – 9,500 BTU	1
Sealed Precision Burner – 7,500 BTU	1
Sealed Precision Burner – 5,000 – 754 BTU	1
Linear Flow Burner Valves	Yes
Electric Pilotless Ignition	Yes
A.D.A. Compliant*	Yes
ACCESSORIES	
Griddle Countertop Installation Kit – P/Nr 903103-9010	Optional
Grill/Griddle – P/Nr 310251014	Not-In-Card
LP Gas Conversion Kit	Included
SPECIFICATIONS	
Color –	
Stainless Steel	IS
Gas/Power Supply Connection Location	Right Bottom Rear
Voltage Rating	120V/60 Hz/15A
Connected Load (kW Rating) @120 Volts†	1.2
Electrical Cable	Yes
Approved For Single Oven Combination Installation**	Yes
Shipping Weight (Approx.)	55
<small>*When properly installed, this model is A.D.A. compliant based on the United States Access Board's A.D.A./A.A.A. Accessibility Guidelines and the Department of Justice's 2010 A.D.A. Standards for Accessible Design. †For use on independently wired 120V electrical circuit having 15amp capacity with a separate ground wire. Appliances must be grounded to utility location. **NFS Always consult local and national codes, rules and regulations. Refer to Product Installation Manual for detailed installation instructions on the web at electrolux.com/us. Specifications subject to change.</small>	

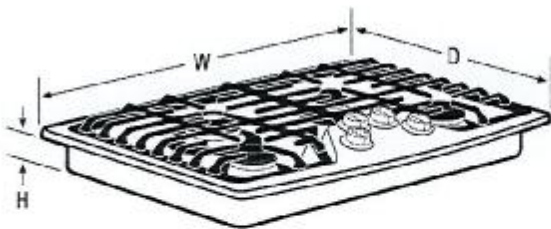

PRODUCT DIMENSIONS	
Width	30"
Depth	21-3/4"
Height (Bottom to Underside of Cooktop)	4-1/4"

**Approved for use with every Electrolux Single-Bowl Oven

Electrolux Major Appliances, N.A.

USA • 10200 David Taylor Drive • Charlotte, NC 28262 • 1-877-4electrolux (1-877-435-3267) • electroluxappliances.com
CANADA • 5855 Terry Fox Way • Mississauga, ON L5V 3E4 • 1-800-265-8352 • electroluxappliances.ca

EW30GC60P 09/15

© 2015 Electrolux Home Products, Inc.



High standards of quality at Electrolux Home Products, Inc. mean we are constantly working to improve our products. We reserve the right to change specifications or discontinue models without notice.

INITIALS: W. T. H.

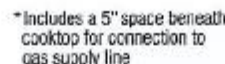

- Granite Countertop Installation Kit – PN# 903103-9010

© 2015 Electrolux Home Products, Inc.

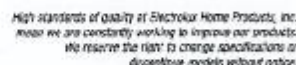

T-101

SENATOR HOMES
DECOR CENTRE

DATE: JAN 09 2016

INITIALS: sh TH

SINGLE WALL OVEN

EI30EW35PS

Featuring IQ-Touch™ Electronic Controls



PRODUCT DIMENSIONS

Height (including 1" Bottom Trim)	29"
Width	30"
Depth (to Front Door Corner)	24-3/4"
(with 90° Door Open)	45-3/4"

MORE EASY-TO-USE FEATURES

FLAT OVEN DOOR DESIGN

Our unique flat oven door is sleekly designed with fewer bumps and ridges — so it not only looks great but is easier to clean.

LUXURY-GLIDE™ OVEN RACK

With a ball bearing system, the oven rack is so smooth it extends effortlessly.

PERFECT FIT PROMISE

Find the perfect Electrolux wall oven for your space using a convenient online tool.

FAST PREHEAT

Savor sooner, with Fast Preheat.

MULTIPLE BAKING OPTIONS

Includes Dehydrate, Bread Proof, My Favorite, Temperature Probe, Fast Preheat, Delay Bake and Convection Convert.

IQ-TOUCH™ CONTROLS

For those who like to have their options always visible on their wall oven, the IQ-Touch™ control panel displays all of your options, at all times.

PLATINUM STAR® LIMITED WARRANTY

Our exclusive limited warranty that includes a 3-year coverage on parts and one year on labor without charge.*

LUXURY-DESIGN® LIGHTING

Our ramp-up designer halogen lighting provides full visibility to see in the back of the oven.

"MY FAVORITE" SETTING

A setting you can customize to meet your needs, so the option you want is available at the touch of a button.

A.D.A. COMPLIANT

When properly installed, this model is A.D.A.-qualified based on the United States Access Board's A.D.A./A.B.A. Accessibility Guidelines and the Department of Justice's 2010 A.D.A. Standards for Accessible Design.

Available in:

Stainless
(S)
*Warranty based on product registration with Electrolux North America within 30 days of purchase.

ELECTROLUXAPPLIANCES.COM

SIGNATURE FEATURES



PERFECT TASTE™ CONVECTION

For consistently delicious taste and texture, home chefs rely on our convection heat, which circulates air evenly with two variable speeds that work in tandem with three heating elements.



PERFECT TASTE™ TEMP PROBE

The Perfect Taste™ Temp Probe does more than measure temperature — it keeps an active eye on your dishes by alerting you when food is at the peak of perfection and automatically adjusting to the Keep Warm setting.



FRESH CLEAN™ TECHNOLOGY

Exclusive Fresh Clean™ self-cleaning technology virtually eliminates odors and smoke to keep the room smelling fresh.



LARGE CAPACITY

Coordinate an entire meal — our ovens feature 4.8 cu. ft. of cooking space with three adjustable baking racks.

DATE: JAN 09 2016
INITIALS: als TH

High standards of quality at Electroware Home Products, Inc. mean we are constantly working to improve our products. We reserve the right to change specifications or discontinue models without notice.

SINGLE WALL OVEN

EI30EW35PS

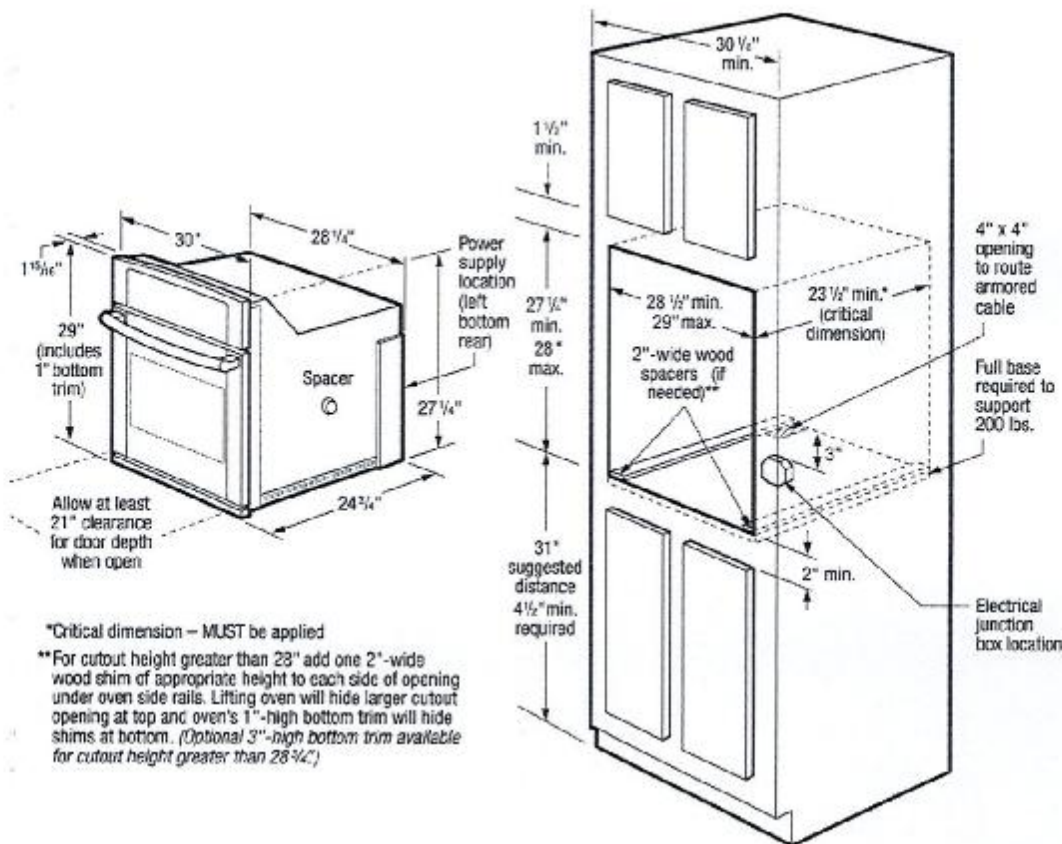
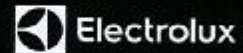

30" Electric Single Wall Oven Specifications

- Product Weight – 144 Lbs.
- Single phase 3- or 4-wire cable, 120/240 or 120/208 Volt, 60 Hertz AC only electrical supply with ground required on separate circuit fused on both sides of line.
- Connected Load (kW Rating) @ 240/208 Volts = 4.6/3.5 kW
- Amps @ 240/208 Volts = 19.2/16.8 Amps
- Recommended Circuit Breaker – 20 Amps
- Always consult local and national electric codes.
- Minimum 21" clearance for oven door depth when open.
- Suggested distance from floor is 31". Minimum required distance is 4-1/2".
- Minimum 23-1/2" deep cutout dimension is critical for proper installation, to ensure that oven's faceplate will fit flush against cabinet front.
- For cutout height greater than 28" add one 2"-wide wood shim of appropriate height to each side of opening under oven side rails. Lifting oven will hide larger cutout opening at top and oven's 1"-high bottom trim will hide shims at bottom. (Standard 1"-High Bottom Trim included, Optional 3"-High Bottom Trim available for cutout height greater than 28-3/4")
- Full oven base of solid plywood or similar material required, capable of supporting 200 Lbs.
- Base must be level and cabinet front must be square.

- Single Wall Ovens are NOT approved to be used in stackable or side-by-side installation.
- Single Wall Ovens are approved to be used alone in under-counter installation or beneath Electrolux gas cooktop models EW30GC60L, EW30GC55G, EW36GC55G, EW30GC55P and EW30GC60P; and electric cooktop models EI30EC45K, EI36EC45K, EW30IC60L, EW36IC60L, EW30CC55G and EW36CC55G. (Refer to Gas or Electric Cooktop Installation Over 30"/27" Electric Single Wall Oven Specifications pages on web.)
- Single Wall Ovens are approved to be used in combination with any Electrolux Warmer Drawer. (Refer to model-specific Warmer Drawer product page for Combination Installation Specifications.)
- Single Wall Ovens are approved to be used in combination with any Electrolux Built-In Microwave Oven. (Refer to model-specific Combination Installation Specifications pages on web.)

Note: For planning purposes only. Refer to Product Installation Guide on the web at electroluxappliances.com for detailed instructions.

Optional Accessories

- 3"-High Bottom Trim: S – (PN# 903114-9110).
- 10'-Long Armored Power Cable – (PN# 903056-9010).

Electrolux Major Appliances, N.A.

USA • 10200 David Taylor Drive • Charlotte, NC 28262 • 1-877-4electrolux (1-877-435-3287) • electroluxappliances.com

CANADA • 5855 Terry Fox Way • Mississauga, ON L5V 3E4 • 1-800-265-6352 • electroluxappliances.ca

EI30EW35P 12/15

© 2015 Electrolux Home Products, Inc.



High standards of quality at Electrolux Home Products, Inc. mean we are constantly working to improve our products. We reserve the right to change specifications or discontinue models without notice.

T-101

SENATOR HOMES
DECOR CENTRE

DATE: JAN 09 2016

INITIALS: *sh 7.1*



Built-In Microwave

EI24MO45I B



Microwave includes choice of 30" or 27" Trim Kit available in 3 colors (shown with 30" Stainless Steel Trim Kit).



Microwave EI24MO45I B with 30" Stainless Steel Trim Kit E30MO45T S



Microwave EI24MO45I D with 30" White Trim Kit E30MO45T W



Microwave EI24MO45I B with 30" Black Trim Kit E30MO45T B



Microwave EI24MO45I B with 27" Stainless Steel Trim Kit E27MO45T S



Microwave EI24MO45I B with 27" White Trim Kit E27MO45T W



Microwave EI24MO45I B with 27" Black Trim Kit E27MO45T B



Cook-2-Perfection® Technology
Evenly distributes microwave cooking energy throughout the oven's interior for even cooking. A 13" x 9" pan – with handles – can be evenly heated.



Sure-2-Fit® Capacity
Our 2.0 cu. ft. extra-large microwaves will hold nearly any dish.



High-Performance Power
With 11 power levels and 1,100 watts, our microwaves are capable of handling even the biggest cooking jobs.

BUILT-IN SIDE-SWING DOOR MICROWAVE

30" or 27" Trim Kit	Order Separately
Oven Cavity	2.0 Cu. Ft.
Watts	1,100
Oven Interior	White
Interior Kryptonite Light	Yes
16" Glass Turntable	Yes
Control Panel Features	
IQ-Touch® Electronic Controls	Yes
Front Display with Blue LED	Yes
Electronic Clock & Timer	Yes
Microwave Sensor	Yes
Power Levels	11
Touch Pad Controls	33
Auto-Start	Yes
Auto-Defrost Options	6
Auto-Cook Options –	
Pizza (1), Snacks (3), Kid's Meals (3), Soften/Melt (4)	11
Auto-Reheat Options –	
Breads/Muffins (2), Pasta/Casserole (1)	3
Evening (10.5-2.0 Cycles)	Yes
Sensor-Cook Options –	
Cook (5), Reheat, Popcorn, Baked Potato, Frozen Vegetables, Fresh Vegetables	10
Multi-Stage Cooking Options	4
Shut-off Options	6
Add 30 Seconds	Yes
Keep Warm	Yes
Custom Help Options	Yes
Panel Lock	Yes
Demo Mode	Yes
Adjustable Sound Level For Timers/Reminders	Yes
More/Less Function	Yes
Power Failure Indicator	Yes

Additional Features

Signature Soft-Air Oven Door	Yes
Glass Window	Yes

Required Trim Kit Options*

30" Trim Kit –	
Stainless Steel	PN# E30MO45T S
White	PN# E30MO45T W
Black	PN# E30MO45T B
27" Trim Kit –	
Stainless Steel	PN# E27MO45T S
White	PN# E27MO45T W
Black	PN# E27MO45T B

Specifications

Color –	
Black	8
Oven Cavity Dimensions –	
Height	10-1/2"
Width	17-3/8"
Depth	18-5/8"
Product Dimensions –	
Height	18-1/16"
Width (including Trim Kit – 30" / 27")	30" / 27"
Depth (to Center of Arc)	20-1/16"
Approved for Under-Counter Installation	Yes
Approved for Electric Single Oven Combination Installation**	Yes
Power Supply Connection Location	Right Top Rear
Voltage Rating	120V/60Hz/15 or 20A
Connected Load (kW Rating) @ 120 Volts*	1.5
Amps @ 120 Volts	13
60" Electrical Cable	Included
Shipping Weight (Approx.) – Microwave	50 Lbs.
Shipping Weight (Approx.) – 30" Trim Kit*	12 Lbs.
Shipping Weight (Approx.) – 27" Trim Kit*	12 Lbs.

*After use on adequately wired 120V dedicated circuit having 2-wire service into a separate ground wire. Appliance must be grounded for safe operation.

**Installation requires use of 30" or 27" Trim Kit (ordered by individual part number and shipped separately). Includes Bottom Duct Assembly.

*Approved to be used in combination with any Electrolux Electric Single Wall Oven and/or Range. (Not approved to be used above any gas wall oven.)

NOTE: Always consult local and national electrical codes. Refer to product installation guide for detailed installation instructions on the web at electroluxappliances.com. Specifications subject to change.

30" Combination Installation – Built-In Microwave/Single Wall Oven

Electrolux

For detailed product dimensions and installation specifications, refer to model-specific product page and installation guide on web

30" Built-In Microwave Cutout

For model:
E24M04GI (with 30" Trim Kit)

30" Electric Single Wall Oven Cutout

For models:
EW30EW55G
E130EW35L
E130EW35K

* Minimum 27/8" clearance required from bottom of Built-In Microwave cutout to top edge of Wall Oven's faceplate, leaving a 2" visible gap between both product faceplates.

** Critical dimension – MUST be applied

† For cutout height between 27 1/4" and 28 1/4" add one 2"-wide wood shim of appropriate height to each side of opening under oven side rails. Lifting oven will hide larger cutout opening at top and oven's 1"-high bottom trim will hide shims at bottom. (Optional 3"-high bottom trim available for cutout height between 28 1/4" and 30")

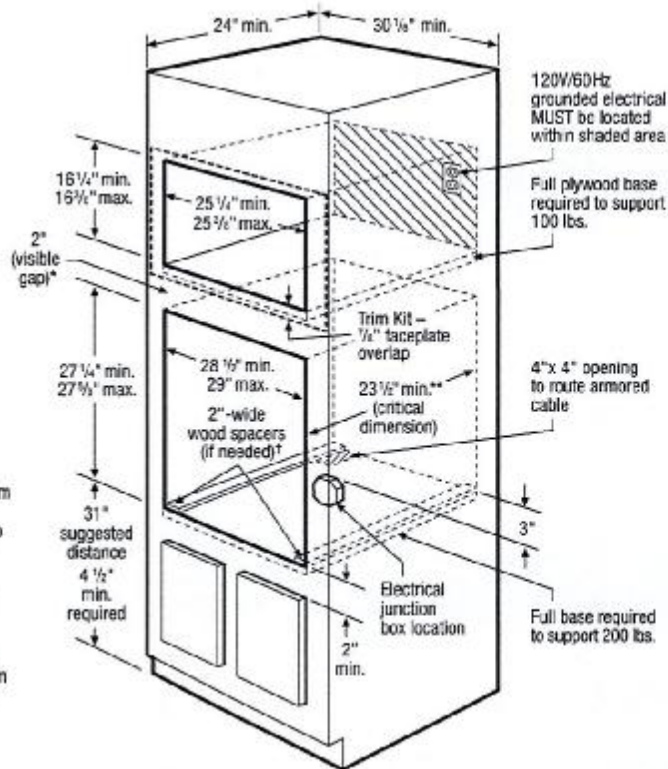

30" Combination Installation Specifications

- Always consult local and national electric codes. (Refer to product-specific electrical specifications on this page.)
- Minimum 23-1/2" deep cutout dimension is critical for proper combination installation, to ensure that each built-in product's faceplate will fit flush against cabinet front.
- Bases must be level and cabinet front must be square.
- Minimum 4-1/2" required distance from bottom of Wall Oven cutout to floor, 31" suggested.
- Respect critical dimensions as noted for proper installation of built-in products.
- Minimum 21" clearance needed for Wall Oven door depth when open.

30" Built-In Microwave Specifications

- Product Weight – 48 Lbs.
- Voltage Rating – 120V/60Hz/15 or 20 Amps
- Connected Load (kW Rating) @ 120 Volts = 1.5 kW (For use on adequately wired 120V, dedicated circuit having 2-wire service with a separate ground wire. Appliance must be grounded for safe operation.)
- Amps @ 120 Volts = 13 Amps
- Full oven base of solid plywood or similar material required, capable of supporting 100 Lbs.
- Minimum 2-7/8" clearance required from bottom of Built-In Microwave cutout to top edge of Wall Oven's faceplate, leaving a 2" visible gap between both product faceplates.

30" Electric Single Wall Oven Specifications

- Product Weight – 200 Lbs.
- Single phase 3- or 4-wire cable, 120/240 or 120/208 Volt, 60 Hertz AC only electrical supply with ground required on separate circuit fused on both sides of line.
- Connected Load (kW Rating) @ 240/208 Volts = 4.0/3.0 kW
- Amps @ 240/208 Volts = 17.0/14.5 Amps
- Full oven base of solid plywood or similar material required, capable of supporting 200 Lbs.
- To adapt oven to fit cutout height between 27-5/8" and 28-1/4", add one 2"-wide wood shim of appropriate height to each side of opening under oven side rails. Lifting oven will hide larger cutout opening at top and oven's 1"-high bottom trim will hide shims at bottom. (Standard 1"-High Bottom Trim included.)
- To adapt oven to fit cutout height between 28-1/4" and 30", optional 3"-High Bottom Trim available.

Note: For planning purposes only. Refer to Product Installation Guide on the web at electroluxappliances.com for detailed instructions.

Electrolux Major Appliances, N.A.

USA • 10200 David Taylor Drive • Charlotte, NC 28262 • 1-877-4electrolux (1-877-435-3287) • electroluxappliances.com
 CANADA • 5855 Terry Fox Way • Mississauga, ON L5V 3E4 • 1-800-265-8352 • electroluxappliances.ca

MOSS_EW 30INST EL 07/11

© 2011 Electrolux Major Appliances, NA

High standards of quality at Electrolux Home Products, Inc. mean we are constantly working to improve our products. We reserve the right to change specifications or discontinue models without notice.

Printed in the U.S.A.



KitchenAid 24" Left-Swing Door Beverage Cellar - Stainless Steel

\$2,599.97

Item Code: KUBL204S

Dimensions: Width: 23.75" Height: 35.12" Depth: 26.75"

Always be prepared for drop-in guests and family dinners with this KitchenAid 24" beverage cellar. With two temperature-controlled zones and an easy-to-use touch control panel, you can chill pop, juice and wine without a problem. The UV-protected thermal glass door keeps the sunlight out and the cold inside to ensure your drinks are perfectly cooled. Plus, the professionally-inspired design features a stainless steel exterior, with wood-fronted wine racks and glass shelves inside.

KitchenAid

Key Features:

- Two Temperature-Controlled Zones
- 4.8 cu. ft. Capacity
- UV-Protected Thermal Glass Door
- Touch Controls
- Door Ajar/Door Open Alarm
- SatinGlide® Wood-Front Racks
- Over-Temperature Alarm
- Professionally-Inspired Design

Two Temperature-Controlled Zones

With two temperature-controlled zones in this beverage cellar, you can customize how cool you want your beverages to be for your guests.

4.8 cu. ft. Capacity

You'll have plenty of room for your drinks with this large, 4.8 cu. ft. cooler. Use either the 14 spots for wine bottles, or the 3 cu. ft available in the upper zone for smaller refreshments.

UV-Protected Thermal Glass Door

Protect your beverages from the sun's effects. Thanks to the UV-protected thermal glass door, you can see everything you can offer friends and family without risk of spoiling their drink of choice.

Touch Controls

Easily control your cellar's temperatures with the accessible touch control panel.

Door Ajar/Door Open Alarm

If you have a habit of leaving the fridge door open accidentally, this door ajar/door open alarm will make sure you don't risk spoiling your beverages. After five minutes, the alarm will sound to let you know the door is open so you can save what's inside.

SatinGlide Wood-Front Racks

Re-arrange your wine racks easily with the SatinGlide racks, which are designed to slide in and out without jarring your favourite drinks. Plus, the wood fronts on the metal racks provide a rustic touch to your beverage cellar.

Be sure your drinks are sitting at the right temperature with this over-temperature alarm. If the sensors detect your cooler isn't cold enough to properly store your beverages, the alarm will go off so you have time to save what's inside.

Professionally-Inspired Design

Bring the sommelier experience home with this beautiful and well-designed beverage cellar. From the satin-textured handle to the wood-front wine racks, every inch of this cooler was created to make your home feel like a five-star hotel.

Detailed Specifications:

General Overview:

- Bottle Capacity: 14
- Total Capacity: 4.8 cu. ft.
- Number of Shelves: Two
- Shelf Material: Glass
- Installation Options: Free-Standing, Built-In
- Temperature Range: 33°F to 64°F
- Cabinet Material: Painted Steel
- Cabinet Interior Colour: Black
- Cabinet Finish: Textured
- Cabinet Levelling: Four Adjustable Legs
- Door Colour: Stainless Steel
- Door Handle Material: Aluminum
- Door Style: Overlay
- Door Swing: Left
- Control Type: Electronic
- Cooling On/Off
- Door Ajar/Door Open Alarm
- Shelf Description: One Fixed 3/4 Depth, One Fixed Full-Width, Two Metal Wine Racks
- Temperature Divider LED Colour: White

SENATOR HOMES
DECOR CENTRE

DATE: JAN 09 2016
INITIALS: [Signature]

Zone 1 Features

- Zone 1 Capacity: 3 cu. ft.
- Zone 1 Temperature Range: 33°F to 40°F

Zone 2 Features

- Zone 2 Capacity: 14 Bottles
- Zone 2 Description: White/Red Wine Storage
- Zone 2 Temperature Range: 42°F to 64°F

Dimensions

Beverage Cellar:

- Width: 23.75"
- Height: 35.12"
- Depth: 26.75"

Shipping:

- Width: 30.43"
- Height: 36.63"
- Depth: 26"
- Weight: 203 lb.