



CONSTRUCTION SUMMARY

Teefy Developments Limited / 9130 Bathurst

Lot/Unit: 19 Phase/Building: 1 Model/Floor Plan: Madison(23-2)

CABINETRY ACCESSORIES

Inv.3199	2 - SUPPLY AND INSTALL THERMOVISION LIGHT VALANCE (N/A WOOD, N/A SOLID TV COLOURS) - PRICE PER 8 FOOT LENGTH	
Line 39817	Note:	
12Sep15 / 12Sep15		
Inv.3199	2 - SUPPLY AND INSTALL CROWN MOULDING - NOT APPLICABLE FOR THERMOVISION - PRICE IS PER 8 FOOT LENGTH	
Line 39819	Note:	
12Sep15 / 12Sep15		

CABINETRY APPLIANCE - FRIDGE

Inv.3199	1 - SUPPLY AND INSTALL 59 CM FRIDGE CABINET - 1 GABLE & CABINET 59 CM DEEP - DEEP - UPGRADE 1	
Line 39820	Note:	
12Sep15 / 12Sep15		

CABINETRY BASE CABINETS

Inv.3199	1 - SUPPLY AND INSTALL INTERIOR PULL OUT DRAWER FOR DOUBLE DOOR CABINET - MAXIMUM 2 PER CABINET - PRICE IS PER DRAWER - UPGRADE 1 TO THE BASE OF THE KITCHEN SINK	
Line 39821	Note:	
12Sep15 / 12Sep15		
Inv.3199	2 - SUPPLY AND INSTALL TOP DRAWER PRICE PER DRAWER AND DUMMY DRAWER FRONTS - STANDARD LINE TO THE MAIN BATH	
Line 39858	Note:	
12Sep15 / 12Sep15		

CABINETRY VANITY

Inv.3199	1 - SUPPLY AND INSTALL VANITY CABINET HEIGHT TO KITCHEN HEIGHT (90 CM) - DEPTH TO REMAIN THE SAME IN THE MASTER ENSUITE	
Line 39815	Note:	
12Sep15 / 12Sep15		
Inv.3199	1 - SUPPLY AND INSTALL VANITY BANK OF DRAWERS - 55 CM MAXIMUM - UPGRADE 1	
Line 39823	Note:	
12Sep15 / 12Sep15		
Inv.3199	2 - SUPPLY AND INSTALL VANITY TOP DRAWER PRICE PER DRAWER - INCLUDE FALSE DRAWERS - STANDARD LINE TO THE MAIN BATH AS PER SKETCH	
Line 39859	Note:	
12Sep15 / 12Sep15		

COUNTER TOP

Inv.3199	1 - SUPPLY AND INSTALL COUNTER TOP - POWDER BATHROOM - 2CM WITH STANDARD EDGE FE20 - GROUP 1	
Line 39794	Note:	
12Sep15 / 12Sep15		
Inv.3199	1 - SUPPLY AND INSTALL COUNTER TOP - ENSUITE BATHROOM - 2CM WITH STANDARD EDGE FE20 - GROUP 2	
Line 39797	Note:	
12Sep15 / 12Sep15		



CONSTRUCTION SUMMARY

Teefy Developments Limited / 9130 Bathurst

Lot/Unit: 19 Phase/Building: 1 Model/Floor Plan: Madison(23-2)

Inv.3199	3 - SUPPLY AND INSTALL GRANITE CUTOUT AND POLISHED EDGE FOR UNDERMOUNT SINK TO THE: - MAIN BATH [X1] - MASTER ENSUITE [X2]	
Line 39798	Note: SINGLE HOLE FAUCET AND UNDERMOUNT SINK PURCHASED SEPARATELY.	
12Sep15 / 12Sep15		

Inv.3199	1 - SUPPLY AND INSTALL COUNTER TOP - MAIN BATHROOM - 2CM WITH STANDARD EDGE FE20 - GROUP 2	
Line 39800	Note:	
12Sep15 / 12Sep15		

ELECTRICAL

Inv.3199	1 - SUPPLY AND INSTALL ADDITIONAL INTERIOR RECEPTACLE ON SEPARATE CIRCUIT (IE: MICROWAVE, FREEZER) IN THE PANTRY	
Line 39801	Note: LOCATION AS PER SKETCH ATTACHED.	
12Sep15 / 12Sep15		

Inv.3199	1 - SUPPLY AND INSTALL CAPPED CEILING LIGHT ROUGH-IN ONLY ON SEPARATE SINGLE SWITCH OVER THE ROMAN TUB IN THE MASTER ENSUITE	
Line 39813	Note: LOCATION AS PER SKETCH ATTACHED.	
12Sep15 / 12Sep15		

Inv.3199	1 - SUPPLY AND INSTALL LIGHT VALANCE ROUGH IN (INCLUDES 1 SWITCH)	
Line 39816	Note: LOCATION AS PER SKETCH ATTACHED.	
12Sep15 / 12Sep15		

Inv.3199	2 - SUPPLY AND INSTALL ELECTRICAL - MINI LOW VOLTAGE HALOGEN POT LIGHT ON EXISTING SWITCH - 1ST FLOOR - LIVINGROOM . LOCATION AS PER SKETCH ATTACHED	
Line 39818	Note: TERMINATE CONNECTION TO SWITCHED OUTLET (SWITCH TO REMAIN) USE EXISTING SWITCH	
12Sep15 / 12Sep15		

Inv.3199	1 - SUPPLY AND INSTALL ADDITIONAL INTERIOR RECEPTACLE (NOT SEPARATE CIRCUIT) TO THE MASTER BEDROOM APPROXIMATELY 66" +/- FROM FLOOR NEXT TO THE STANDARD CABEL TV R/I	
Line 39824	Note: LOCATION AS PER SKETCH ATTACHED.	
12Sep15 / 12Sep15		

Inv.3199	1 - SUPPLY AND INSTALL ELECTRICAL - SHOWER POT LIGHT - TO THE MAIN BATH SKETCH ATTACHED	
Line 39855	Note:	
12Sep15 / 12Sep15		

FIREPLACE

Inv.3199	1 - STANDARD FIREPLACE TO BE INSTALLED APPROXIMATELY 21" +/- FROM THE FLOOR TO THE BOTTOM OF THE FIREPLACE IN THE LIVINGROOM	
Line 39856	Note:	
12Sep15 / 12Sep15		

HARDWOOD

Inv.3199	1 - SUPPLY AND INSTALL HARDWOOD - UPGRADE 1 - SATIN FINISH GEN. - HOME OAK 3 5/8 INCH X 3/4 INCH - STAINS - INSTALLED IN OP - - LOWER LEVEL FOYER	
Line 39790	Note:	
12Sep15 / 12Sep15		



CONSTRUCTION SUMMARY

Teefy Developments Limited / 9130 Bathurst

Lot/Unit: 19 Phase/Building: 1 Model/Floor Plan: Madison(23-2)

Inv.3199	1 - SUPPLY AND INSTALL HARDWOOD - UPGRADE 1 - SATIN FINISH GEN. - HOME OAK 3 5/8 INCH X 3/4 INCH - STAINS - INSTALLED IN OP - - LOWER LEVEL RECREATION ROOM	
Line 39791	Note:	
12Sep15 / 12Sep15		

Inv.3199	1 - SUPPLY AND INSTALL HARDWOOD - UPGRADE 1 - SATIN FINISH GEN. - HOME OAK 3 5/8 INCH X 3/4 INCH - STAINS - INSTALLED IN OP - - POWDER HALL / PANTRY	
Line 39792	Note:	
12Sep15 / 12Sep15		

HEATING AND AIR CONDITIONING

Inv.3199	1 - SUPPLY AND INSTALL GAS LINE - ROUGH-IN ONLY - FIRST CONNECTION- FOR BBQ	
Line 39812	Note: LOCATION AS PER SKETCH	
12Sep15 / 12Sep15		

MISCELLANEOUS

Inv.3199	1 - DELETE DO NOT INSTALL AND DO NOT SUPPLY BATHROOM MIRRORS THROUGHOUT	
Line 39783	Note: PURCHASER ACKNOWLEDGES THAT THERE WILL BE NO CREDIT FOR THIS DELETION	
12Sep15 / 12Sep15		

Inv.3199	1 - DELETE DO NOT INSTALL AND DO NOT SUPPLY BATHROOM LIGHT FIXTURES OVER THE MIRRORS THROUGHOUT. PLEASE INTALL A JUNCTION BOX AND CAP.	
Line 39785	Note: PURCHASER ACKNOWLEDGES THAT THERE WILL BE NO CREDIT FOR THIS DELETION NO JUNCTION. Please INSTALL A BOX AND CAP.	
12Sep15 / 12Sep15		

Inv.3389	1 - DELETE DO NOT INSTALL AND DO NOT SUPPLY BATHROOM ACCESSORIES THROUGHOUT. PURCHASER ACKNOWLEDGES AND ACCEPTS THAT THERE WILL NOT BE A CREDIT GIVEN FOR THIS DELETION.	
Line 43455	Note:	
23Nov15 / 23Nov15		

PLUMBING

Inv.3199	3 - SUPPLY AND INSTALL CONTRAC CATENA RECTANGULAR VANITY UNDERMOUNT SINK MODEL 4210CIY IN THE: - MAIN BATH [X1] - MASTER ENSUITE [X2]	
Line 39799	Note:	
12Sep15 / 12Sep15		

Inv.3199	1 - SUPPLY AND INSTALL WATERLINE ROUGH-IN TO THE FRIDGE LOCATION (NO HOOK UP)	
Line 39814	Note: LOCATION AS PER SKETCH ATTACHED.	
12Sep15 / 12Sep15		

Inv.3199	1 - SUPPLY AND INSTALL EL MUSTEE 10K DROP-IN LAUNDRY COUNTER MOUNT SINK IN THE LAUNDRY	
Line 39852	Note:	
12Sep15 / 12Sep15		

Tile



CONSTRUCTION SUMMARY

Teefy Developments Limited / 9130 Bathurst

Lot/Unit: 19 Phase/Building: 1 Model/Floor Plan: Madison(23-2)

Inv.3199 Line 39786 12Sep15 / 12Sep15	1 - SUPPLY AND INSTALL FLOOR TILE - UPGRADE 3 - - POWDER ROOM FLOOR Note: 	
Inv.3199 Line 39793 12Sep15 / 12Sep15	1 - SUPPLY AND INSTALL FLOOR TILE - UPGRADE 3 - - MUD ROOM IN BASEMENT (ON CONCRETE) Note: 	
Inv.3199 Line 39804 12Sep15 / 12Sep15	1 - SUPPLY AND INSTALL FLOOR TILE - UPGRADE 3 - - MAIN BATH FLOOR Note: 	
Inv.3199 Line 39811 12Sep15 / 12Sep15	1 - SUPPLY AND INSTALL FLOOR TILE - UPGRADE 3 - - ENUSITE BATH FLOOR Note: 	
Inv.3199 Line 39853 12Sep15 / 12Sep15	1 - SUPPLY AND INSTALL FLOOR TILE - UPGRADE 3 - - LAUNDRY ROOM Note: 	

EXTRAS AS PER OFFER

Stainless Steel Fridge, Stove and Dishwasher and front loading washer and dryer in white from Vendors standard samples, no cash value, not transferable. (Supplied only not installed) ** to - arrange delivery call: The Brick commercial sales division at Worksheet Note:	
Rogers Free Services Package includes 6 months of: home phone, TV and Internet Service. Worksheet Note:	
Vendor agrees to supply and install hardwood flooring throughout main and upper floors, including all bedrooms, with a choice of stain from Vendors standard samples. Worksheet Note:	

Purchasers: David W Simone & N'Gina Lindile Simone

Property: 19 of Plan -

Telephone Res. / Bus: (905) 727-1273 /

Project: Teefy Developments Limited

Decor Advisor: Diana Rojas

Model and Elevation: Madison(23-2)

Layout Changes: ☐ Yes ☒ No

Sketch Attached: ☒ Yes ☐ No

Exterior Colour Scheme:

1. Cabinetry

	Style and Colour	Counter Top	Hardware
Kitchen / Breakfast	BOSTON PAINT - WINTER WHITE	QUARTZ - 9141	9677 HANDLE
Kitchen Island	BOSTON PAINT - WINTER WHITE	QUARTZ - 9141	9677 HANDLE
Laundry Room	MANCHESTER PAINT - MACADEMIA	KALAHARI TOPAZ 4588K-07	151 KNOB
Powder Room	MANCHESTER PAINT - MACADEMIA	MARBLE - PERLATO ROYALE	151 KNOB
Main Bathroom	MANCHESTER PAINT - MACADEMIA	QUARTZ - 2260	151 KNOB
Master Ensuite Bathroom	MANCHESTER PAINT - WINTER WHITE	QUARTZ - 9601	151 KNOB
Second Ensuite Bathroom (If Applicable)			

Appliances

Custom Size Fridge

☐ Yes ☒ No

Valance Lighting

☒ Yes ☐ No

Microwave / Range Hood

☐ Yes ☒ No

Cooktop / Rangetop

☐ Yes ☒ No

Built in Wall Oven

☐ Yes ☒ No

Slide-in Range

☒ Yes ☐ No

Comment

STANDARD APPLIANCES

2. Flooring

Selection

FOYER & HALL	3-5/8" SATIN FINISH RED OAK - ENGLISH TOFFEE 30
Main Hall	& PANTRY = 3-5/8" SATIN FINISH RED OAK - ENGLISH TOFFEE 30
Back Hall	
Breakfast	3-5/8" SATIN FINISH RED OAK - ENGLISH TOFFEE 30
Laundry Room	12X24 NEW BYZANTINE - PENTILIC GREY
Kitchen	3-5/8" SATIN FINISH RED OAK - ENGLISH TOFFEE 30
Powder Room	12X24 NEW BYZANTINE - PENTILIC GREY
Main Bathroom	12X24 PALAIS - WHITE
Master Ensuite	12X24 PALAIS - WHITE
Bathroom (If Applicable)	
Mud Room	12X24 NEW BYZANTINE - PENTILIC GREY
Living Room	3-5/8" SATIN FINISH RED OAK - ENGLISH TOFFEE 30
Dining Room	
Family / Great Room	
Den / Library / Study	REC ROOM = 3-5/8" SATIN FINISH RED OAK - ENGLISH TOFFEE 30
Basement Landing (If Applies)	3-5/8" SATIN FINISH RED OAK - ENGLISH TOFFEE 30
Lower Landing (If Applicable)	
Upper Landing	
Upper Hall	3-5/8" SATIN FINISH RED OAK - ENGLISH TOFFEE 30
Master Bedroom	3-5/8" SATIN FINISH RED OAK - ENGLISH TOFFEE 30
Bedroom #2	3-5/8" SATIN FINISH RED OAK - ENGLISH TOFFEE 30
Bedroom #3	3-5/8" SATIN FINISH RED OAK - ENGLISH TOFFEE 30
Bedroom #4	
Bedroom #5	

Flooring Continued on Page 2

Initial:



Page 1 of 3

Purchasers: David W Simone & N'Gina Lindile Simone

Property: 19 of Plan -

Telephone Res. / Bus: (905) 727-1273 /

Project: Teefy Developments Limited

Decor Advisor: Diana Rojas

Model and Elevation: Madison(23-2)

2. Flooring - Continued -

Upgrade Underpad	Type	Area
Carpet on Stairs	Capped	Runner - *Upgrade
Comment		

3. Plumbing Fixtures / Faucets

Kitchen	STND	Second Ensuite		Powder Room	UPG
Master Ensuite	UPG			Other Room	
Main Bathroom	UPG	LAUNDRY	UPG		

Comment

*** SEE UPG EXTRAS

4. Wall Tile

	Tile Selection	Listello	Insert	Insert Selection
Main Bathroom	3X6 COLOUR & DIMENSIONS - BONE BRIGHT	<input type="checkbox"/>	<input type="checkbox"/>	
Master Ensuite				
Tub Deck		<input type="checkbox"/>	<input type="checkbox"/>	
Tub Apron		<input type="checkbox"/>	<input type="checkbox"/>	
Tub Surround		<input type="checkbox"/>	<input type="checkbox"/>	
Shower Stall	3X6 COLOUR & DIMENSIONS - BISCUIT	<input type="checkbox"/>	<input type="checkbox"/>	
Second Ensuite		<input type="checkbox"/>	<input type="checkbox"/>	
		<input type="checkbox"/>	<input type="checkbox"/>	
Kitchen Backsplash		<input type="checkbox"/>	<input type="checkbox"/>	
Complete Backsplash		<input type="checkbox"/>	<input type="checkbox"/>	

Comment

5. Fireplace

	Living Room			Family Room			Other Room - Specify		
	Purchased	As Per Plan	N/A	Purchased	As Per Plan	N/A	Purchased	As Per Plan	N/A
Fireplace Type	<input type="radio"/>	<input checked="" type="radio"/>	<input type="radio"/>	<input type="radio"/>	<input type="radio"/>	<input type="radio"/>	<input type="radio"/>	<input type="radio"/>	<input type="radio"/>
Mantle Type	STND - BLF50								
Over Mantle									
Colour / Stain									
Surround									
Hearth									

Comment

***STND FIREPLACE TO BE INSTALLED APPROXIMATELY 21" +/- FROM THE FLOOR TO THE BOTTOM OF THE FIREPLACE.

Initial:

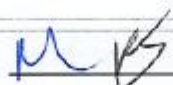

Page 2 of 3



INTERIOR COLOUR SCHEME

Treeby19

Purchasers: David W Simone & N'Gina Lindile Simone

Property: 19 of Plan -

Telephone Res. / Bus: (905) 727-1273 /

Project: Teefy Developments Limited

Decor Advisor: Diana Rojas

Model and Elevation: Madison(23-2)

6. Trim Carpentry

Door Hardware Interior Trim

Comment

Interior Doors

☐ 2 Panel Arch Top☒ 2 Panel Square Top☐ 6 Panel

Initial for Door Style

M

7. Railings and Pickets

Railing Package Railing Colour Picket Colour Wood Stairs ☐ No ☒ OakTread Colour

Comment

8. Plaster Mouldings and Medallions

Foyer

Kitchen/Breakfast

Main Hall

Den/Library

Living Room

Lower Landing

Dining Room

Family Room

Comment

9. Wall Paint

Smooth Ceilings

☐ First Floor☐ First Floor incl. Second Floor Hall☐ First and Second Floor☒ Throughout☐ Not ApplicableTrim Paint

10. Additional Comments

11. Disclaimers and Notes

- Colours of all materials are as close as possible to builder's selection, but not necessarily identical due to variances in manufacturing.
- Any extras listed above are null and void unless accompanied by a separate invoice/amendment. Said invoice must be paid in full.
- The Purchaser acknowledges that after Interior Colour Selection form is signed and dated, no further changes will be permitted other than re-selection due to unavailability. *M* *JS* Purchaser's Initials
- The Purchaser acknowledges reading and accepting the "Senator Homes Décor Centre Disclaimers" form. This document contains other miscellaneous disclaimers.

This Interior Colour Selection is final and approved by:

Purchaser:

Signature: *David W Simone* Date: *Sept 12/15*Signature: *N'Gina Simone*Date: *SEP 12/15*Vendor: *Teefy Developments Limited*

Jan 12/16



FRENDEL
KITCHENS LIMITED

1350 Showdon Drive, Mississauga, ON L4W 1C5

Tel: (905) 470-7886
Fax: (905) 670-1866
www.frendel.com

STANDARD & ALTERNATE 1 ELEVATION

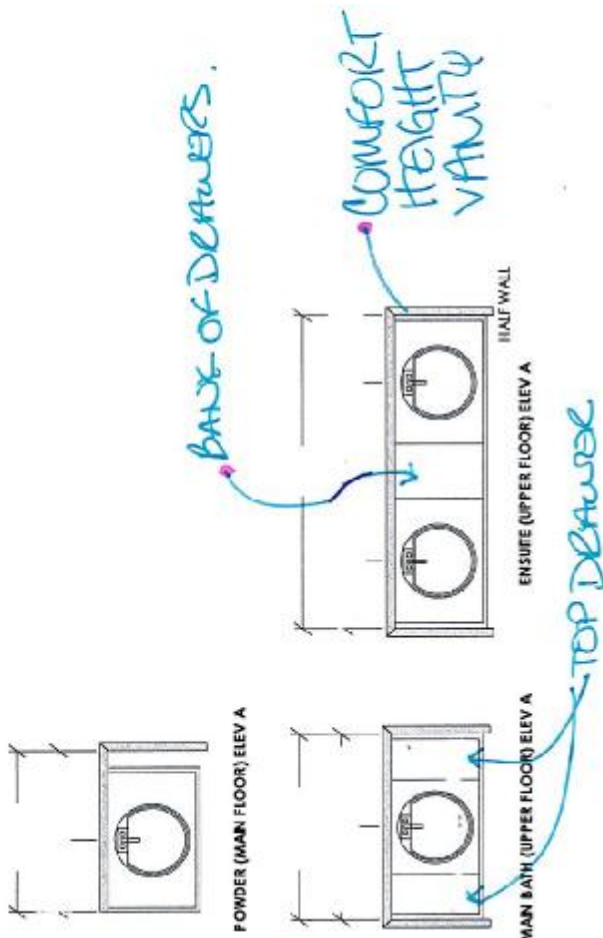
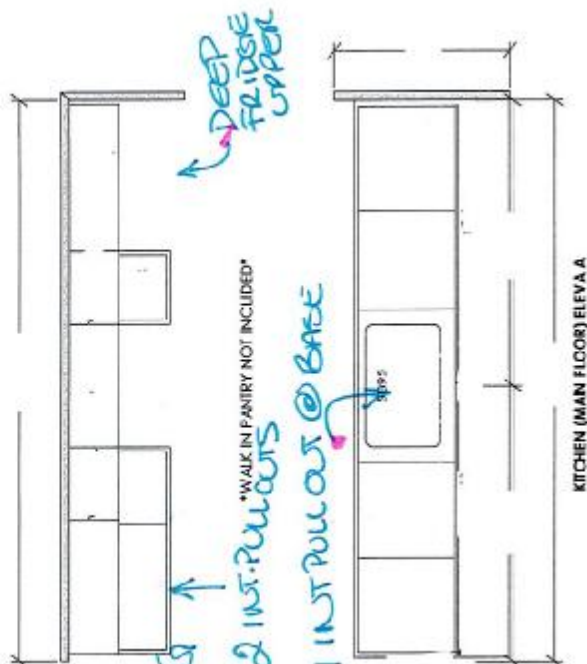

OPTIONAL CABINETRY

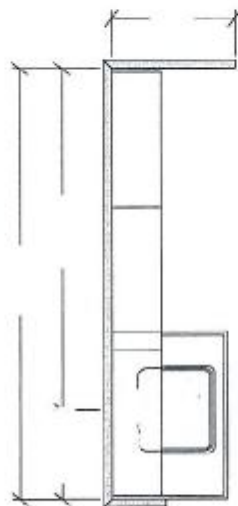

OPT. LAUNDRY UPPERS
OPT. LAUNDRY BASE
(MAIN LEVEL) ELEV A

SENATOR HOMES
TEEFY DEVELOPMENTS LIMITED - 9130 BATHURST
MODEL: MADISON - TH-23-2
TOTAL UNITS: 9

TEEFY-19
SENATOR HOMES
DECOR CENTRE
DATE: SEPT 12/15
INITIALS: M KS

Note: This drawing is an artistic interpretation of the general appearance of the design. It is not meant to be an exact rendition.	2020	Designed: 8/4/2014 Printed: 2/11/2015
	TH-23-2	Drawing 3 Drawing #: 1



CATENA 20" RECTANGULAR UNDERMOUNT SINK

TEEPY 19

4210CIY Undermount Sink

Product Specs:

- Vitreous china
- Front overflow hole
- Template and mounting hardware supplied

Overall Dimensions (W x D x H):

(OD): 510mm(20") x 395mm(15½") x 190mm(7½")
(ID): 450mm(17¾") x 335mm(13¼") x 140mm(5½")

Compliance Certifications:

- Meets or exceeds the following :
- IAPMO dUPC
 - ASME A112.19.2 / CSA B45.1-2008

Shipping:

Cube 1.72
GW 27 lbs

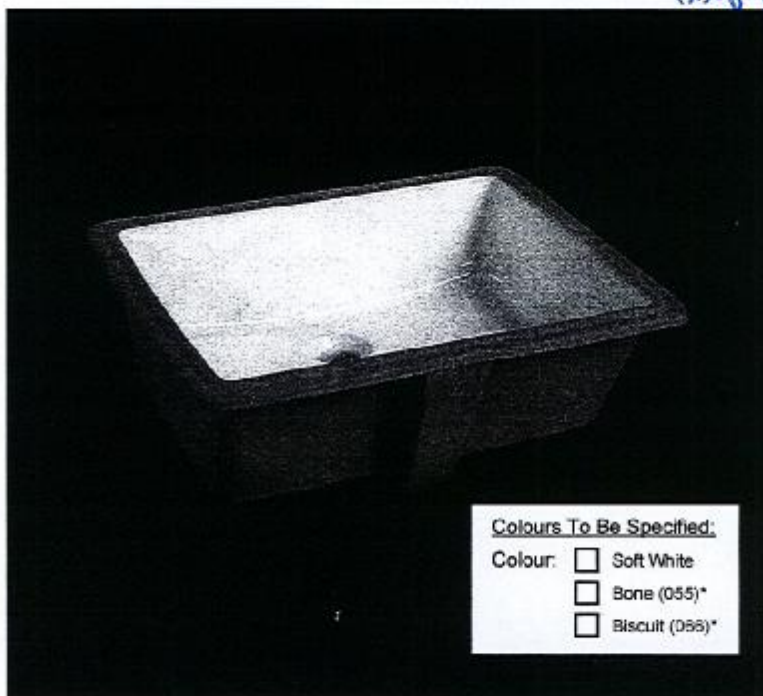

Colours To Be Specified:

- Colour: ☐ Soft White
☐ Bone (055)*
☐ Biscuit (056)*

Notes:

Dimensions of fixtures are nominal and may vary within the range of tolerances established by ASME standard A112.19.2. These measurements are subject to change or cancellation. No responsibility is assumed for use of superseded or voided pages.

*Bone and Biscuit available through Direct import (DI) only.

Detail of Mounting Clip

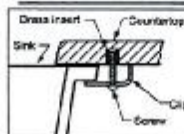

Note:
▲ Dimensions shown for location of supplies and "P" trap are suggested.

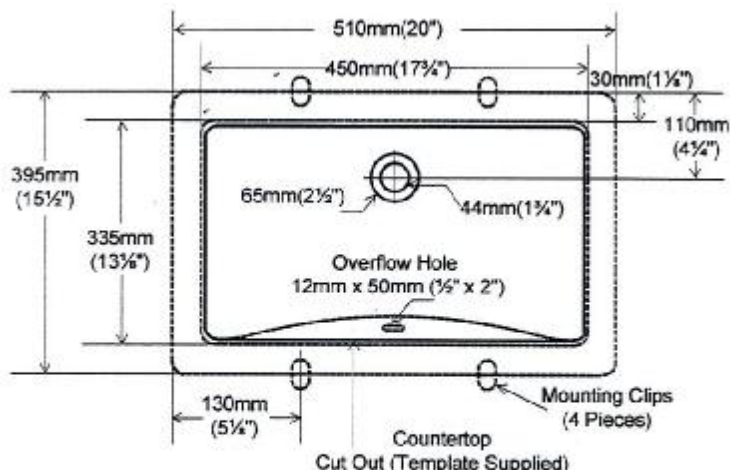
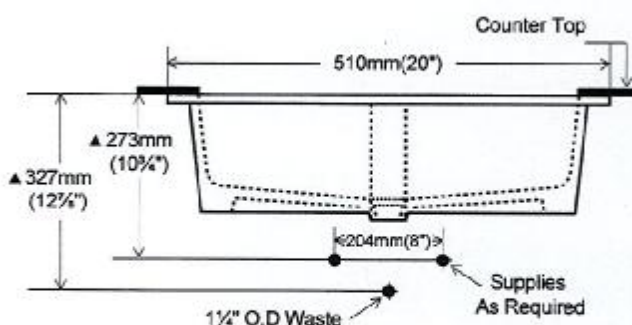
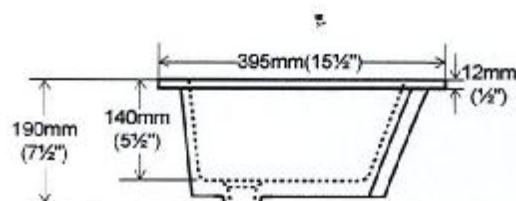

CONTRAC® 5970 Chedworth Way, Unit A, Mississauga, Ontario Canada L5R 3V5 • 1.888.256.7551
www.contrac.ca

Revised: January 2014

MAIN BATH x1
MASTER ENS. x2

X3 TOTAL

TEEPY-19
SENATOR HOMES
DECOR CENTRE
DATE: SEPT 12/15
INITIALS: M B

*LAUNDRY.

SENATOR
HOMES

UPGRADE

Laundry Up-Grade Opt 1

Feb 3/2015

Mustee 10 K

Drop-In Counter Mount

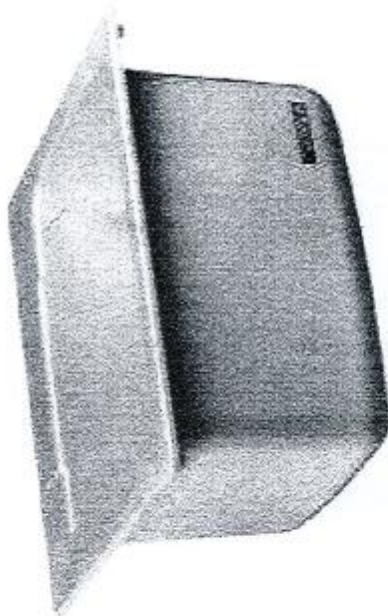

EL Mustee 10K Laundry Tub

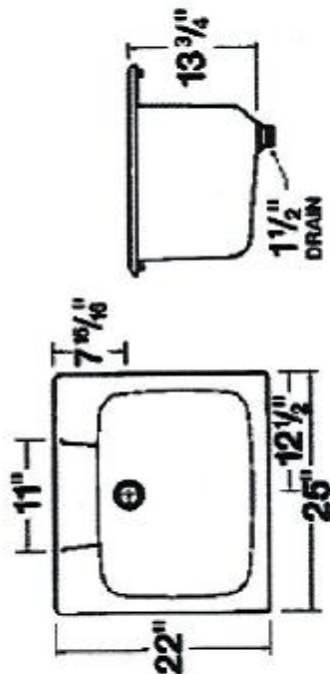

- Molded using matched metal molds with premium fiberglass blended with special resins for extra strength and durability
- 17 gallon capacity, extra deep bowl — self-rimming
- Includes 1-1/2" drain assembly with stopper
- Connects to standard 1-1/2" P or S trap
- Accommodate single or dual-handle faucet with 4" or 8" center
- Available in white and bone
- Stain resistant, semi-gloss, colorfast finish
- Easy to clean

Teeby 19

Teeby-19
SENATOR HOMES
DECOR CENTRE
DATE: SEPT 12 15
INITIALS: ML