



CONSTRUCTION SUMMARY

Teefy Developments Limited / 9130 Bathurst

Lot/Unit: 95    Phase/Building: 1    Model/Floor Plan: Riverdale(22-3)

AUDIO AND SECURITY

Inv.3431	1 - LOCATE THREE (3) STANDARD ROUGH IN CABLE OUTLETS INCLUDED IN OFFER:  ONE (1) IN MASTER BEDROOM ONE (1) IN FORMAL ROOM ONE (1) IN FAMILY ROOM (ABOVE FIREPLACE)  Line 44234      Note: LOCATION AS PER SKETCH ATTACHED	
8Dec15 / 17Jan16		
Inv.3431	1 - LOCATE TWO (2) STANDARD TELEPHONE ROUGH IN OUTLETS INCLUDED IN OFFER  ONE (1) IN MASTER BEDROOM ONE (1) IN RECREATION ROOM  Line 44235      Note: LOCATION AS PER SKETCH ATTACHED	
8Dec15 / 17Jan16		

CABINETRY

Inv.3431	1 - LOCATION: KITCHEN  CABINETRY - KITCHEN - UPGRADE - 11 - ELITE I - SUPPLY AND INSTALL  Line 44107      Note: ANNEX DHGL ARTICO GLOSS MWP	
8Dec15 / 17Jan16		
Inv.3431	1 - LOCATION: KITCHEN  SUPPLY AND INSTALL CABINETS ABOVE STOVE TO ACCOMMODATE AN UNDERMOUNT CANOPY HOOD AS PER SPECS ATTACHED  Line 44125      Note: PURCHASER TO SUPPLY AND INSTALL THEIR OWN UNDERMOUNT CANOPY HOOD AFTER CLOSING	
8Dec15 / 17Jan16		
Inv.3431	1 - LOCATION: KITCHEN  PROVIDE 36" STOVE AND HOOD FAN OPENING IN LIEU OF STANDARD 30"  Line 44126      Note:	
8Dec15 / 17Jan16		

CABINETRY ACCESSORIES

Inv.3431	3 - LOCATION: KITCHEN  LIGHT VALANCE - NOT APPLICABLE FOR THERMOVISION - PRICE PER 8 FOOT LENGTH  Line 44132      Note:	
8Dec15 / 17Jan16		

CABINETRY APPLIANCE - FRIDGE

Inv.3431	1 - LOCATION: KITCHEN  ACCOMMODATE SUB - ZERO TYPE FRIDGE ENCLOSURE - PURCHASER MUST SUPPLY SPECS - UPGRADE 3  Line 44115      Note: FIABA FRIDGE	
8Dec15 / 17Jan16		

CABINETRY BASE CABINETS



CONSTRUCTION SUMMARY

Teefy Developments Limited / 9130 Bathurst

Lot/Unit: 95    Phase/Building: 1    Model/Floor Plan: Riverdale(22-3)

Inv.3431	1 - LOCATION: KITCHEN SERVERY  DELETE EXISTING BASE CABINETS IN SERVERY AS REQUIRED TO AND SUPPLY AND INSTALL ACCOMMODATIONS FOR A 24" BAR FRIDGE  Line 44116 Note: LOCATION AS PER SKETCH ATTACHED  8Dec15 / 17Jan16	
Inv.3431	4 - LOCATION: KITCHEN  INTERIOR PULL OUT DRAWER FOR DOUBLE DOOR CABINET - MAXIMUM 2 PER CABINET - PRICE IS PER DRAWER - UPGRADE 3  Line 44117 Note: LOCATION AS PER SKETCH ATTACHED  8Dec15 / 17Jan16	
Inv.3431	1 - LOCATION: KITCHEN  POTS & PANS DRAWER - MINIMUM 60 CM - MAXIMUM 90 CM - SIZE SUBJECT TO FLOOR PLAN - UPGRADE 3  Line 44118 Note: LOCATION AS PER SKETCH ATTACHED  8Dec15 / 17Jan16	

CABINETRY HARDWARE

Inv.3431	4 - LOCATION: POWDER ROOM, MASTER ENSUITE, MAIN BATHROOM AND LAUNDRY ROOM  VANITY - CABINET HARDWARE - UPGRADE 1 - DISPLAY BOARD  Line 45406 Note: KNOB 145 FOR LAUNDRY ROOM AND MAIN KNOB 9645 FOR MASTER ENSUITE AND POWDER ROOM  8Dec15 / 17Jan16	
Inv.3431	1 - LOCATION: KITCHEN  KITCHEN - CABINET HARDWARE - UPGRADE 2 - DISPLAY BOARD  Line 45407 Note: HANDLE 12899  8Dec15 / 17Jan16	

CABINETRY LAUNDRY

Inv.3431	2 - LOCATION: 2ND FLOOR LAUNDRY  LAUNDRY BASE - - PRICE IS PER FOOT - STANDARD LINE  Line 44157 Note: CLASSIC LINE - BOSTON PAINT MACADEMIA WITH UPGRADE 1 KNOB (145)  8Dec15 / 17Jan16	
----------	--	--

CABINETRY PANTRY

Inv.3431	4 - LOCATION: SERVERY  PANTRY 30 CM DEEP - PRICE IS PER FOOT - UPGRADE 2  DELETE THE STANDARD CLOSET PANTRY AND SUPPLY AND INSTALL PANTRY WITH MATCHING KITCHEN CABINETS - 12" DEEP  Line 44629 Note: LOCATION AS PER SKETCH ATTACHED  8Dec15 / 17Jan16	
----------	--	--

CABINETRY VANITY



CONSTRUCTION SUMMARY

Teefy Developments Limited / 9130 Bathurst

Lot/Unit: 95    Phase/Building: 1    Model/Floor Plan: Riverdale(22-3)

Inv.3431	4 - LOCATION: POWDER ROOM, MAIN BATH AND MASTER ENSUITE	
	KITCHEN - INCREASE VANITY HEIGHT TO KITCHEN HEIGHT (90 CM) - DEPTH TO REMAIN THE SAME - PRICE IS PER CABINET BOX	
Line 44120	Note:	
8Dec15 / 17Jan16		
Inv.3431	1 - LOCATION: LAUNDRY ROOM	
	KITCHEN - INCREASE VANITY HEIGHT TO KITCHEN HEIGHT (90 CM) - DEPTH TO REMAIN THE SAME - PRICE IS PER CABINET BOX	
Line 44121	Note: BASE CABINETS PURCHASED FOR LAUNDRY ROOM	
8Dec15 / 17Jan16		

COUNTER TOP - EXTRAS

Inv.3431	1 - LOCATION: KITCHEN ISLAND	
	SUPPLY AND INSTALL CONTINUOUS WATERFALL SIDES TO KITCHEN ISLAND USING CAESARSTONE	
Line 44112	Note: CAESARSTONE 9141 ICE SNOW - STQ SQ EDGE	
8Dec15 / 17Jan16		
Inv.3431	4 - LOCATION: POWDER ROOM, MAIN AND MASTER ENSUTIE	
	SUPPLY AND INSTALL GRANITE CUTOUT PROVISION AND POLISHING OF EDGES FOR UNDERMOUNT SINKS	
Line 44141	Note: UNDERMOUNT SINKS HAVE BEEN PURCHASED SEPARATELY	
8Dec15 / 17Jan16		

COUNTER TOP - VANITY

Inv.3431	1 - LOCATION: MAIN BATHROOM	
	SUPPLY AND INSTALL 2CM STONE COUNTER TOP WITH STANDARD SQUARE EDGE – GROUP 3 IN THE MAIN BATHROOM	
Line 45415	Note: CAESARSTONE 4350 LAGOS BLUE	
8Dec15 / 17Jan16		
Inv.3431	1 - LOCATION: POWDER ROOM	
	SUPPLY AND INSTALL 3CM STONE COUNTER TOP WITH STANDARD SQUARE EDGE – GROUP 3 IN THE POWDER ROOM	
Line 44140	Note: CAESARSTONE 4350 - LAGOS BLUE	
8Dec15 / 17Jan16		
Inv.3431	1 - LOCATION: MASTER ENSUITE	
	SUPPLY AND INSTALL 2CM STONE COUNTER TOP WITH STANDARD SQUARE EDGE – GROUP 4 IN THE ENSUITE - BATHROOM	
Line 45417	Note: CAEASARSTONE 1141 PURE WHITE	
8Dec15 / 17Jan16		

ELECTRICAL



CONSTRUCTION SUMMARY

Teefy Developments Limited / 9130 Bathurst

Lot/Unit: 95    Phase/Building: 1    Model/Floor Plan: Riverdale(22-3)

Inv.3431	1 - LOCATION: KITCHEN	
	SUPPLY AND INSTALL ADDITIONAL INTERIOR RECEPTACLE ON SEPARATE CIRCUIT TO ACCOMODATE FUTURE CANOPY HOOD	
Line 44122	Note: PURCHASER TO SUPPLY AND INSTALL THEIR OWN UNDERMOUNT CANOPY HOOD AFTER CLOSING	
8Dec15 / 17Jan16		
Inv.3431	1 - LOCATION: KITCHEN SERVERY	
	SUPPLY AND INSTALL ADDITIONAL INTERIOR RECEPTACLE ON SEPARATE CIRCUIT TO ACCOMODATE FUTURE BAR FRIDGE IN SERVERY	
Line 44124	Note: LOCATION AS PER SKETCH ATTACHED.	
8Dec15 / 17Jan16		
Inv.3431	3 - LOCATION: KITCHEN ISLAND	
	SUPPLY AND INSTALL CAPPED CEILING LIGHT ROUGH-IN ONLY ON SEPARATE SINGLE SWITCH. ONE SWITCH FOR ALL THREE (3) CAPS	
	TO BE EQUALLY SPACED AND CENTRED ABOVE ISLAND IN KITCHEN	
Line 44129	Note: DO NOT DELETE STANDARD CEILING FIXTURES IN KITCHEN	
8Dec15 / 17Jan16		
Inv.3431	1 - LOCATION: KITCHEN	
	SUPPLY AND INSTALL LIGHT VALANCE ROUGH IN (INCLUDES 1 SWITCH)	
Line 44131	Note: LOCATION TO BE DETERMINED BY VENDOR	
8Dec15 / 17Jan16		
Inv.3431	1 - LOCATION: RECREATION ROOM	
	SUPPLY AND INSTALL ADDITIONAL CABLE OUTLET ROUGH-IN ONLY	
Line 45413	Note: LOCATION AS PER SKETCH ATTACHED.	
8Dec15 / 17Jan16		
Inv.3431	2 - LOCATION: MAIN AND MASTER ENSUITE SHOWER STALLS	
	ELECTRICAL - SHOWER POT LIGHT (FLUSH) - ONE (1) IN MAIN SHOWER STALL AND ONE (1) IN MASTER ENSUITE SHOWER STALL	
Line 45401	Note:	
8Dec15 / 17Jan16		

HEATING AND AIR CONDITIONING

Inv.3431	1 - LOCATION: KITCHEN	
	GAS LINE - ROUGH-IN ONLY - FOR STOVE TO INCLUDE 110V CODE REQUIREMENT	
Line 44123	Note:	
8Dec15 / 17Jan16		
Inv.3431	1 - LOCATION: HVAC	
	SUPPLY AND INSTALL HEPA FILTER	
Line 45409	Note:	
8Dec15 / 17Jan16		

MISCELLANEOUS



CONSTRUCTION SUMMARY

Teefy Developments Limited / 9130 Bathurst

Lot/Unit: 95    Phase/Building: 1    Model/Floor Plan: Riverdale(22-3)

Inv.3431	1 - LOCATION: ALL BEDROOMS  SUPPLY AND INSTALL HARDWOOD FROM VENDOR'S STANDARD SAMPLES TO ALL BEDROOMS. AS PER SCHEDULE PE ITEM #4  Line 44101      Note: 3/4" X 3-5/8" GENERATIONS SATIN FINISH RED OAK - COBALT  8Dec15 / 17Jan16	
Inv.3431	1 - LOCATION: RECREATION ROOM  SUPPLY AND INSTALL HARDWOOD FROM VENDOR'S STANDARD SAMPLES TO THE RECREATION ROOM AS PER SCHEDULE PE ITEM #5  DOES NOT INCLUDE DEN IN LOWER LEVEL Line 44102      Note: 3/4" X 3-5/8" GENERATIONS SATIN FINISH RED OAK - COBALT  8Dec15 / 17Jan16	
Inv.3431	1 - LOCATION: ALL BATHROOMS  SUPPLY AND INSTALL GRANITE COUNTER-TOPS TO ALL BATHROOMS AS PER SCHEDULE PE #6.  DOES NOT INCLUDE OVERMOUNT SINKS AND/OR POLISHED EDGES Line 44103      Note:  8Dec15 / 17Jan16	
Inv.3431	1 - LOCATION: MAIN BATHROOM  SUPPLY AND INSTALL FULLY TILED SHOWER STALL IN LIEU OF TUB IN MAIN BATHROOM AS PER SCHEDULE PE ITEM #7  Line 44104      Note: DOES NOT INCLUDE GLASS  8Dec15 / 17Jan16	
Inv.3431	1 - LOCATION: KITCHEN  SUPPLY AND INSTALL DIFFERENT COLOUR TO ISLAND IN KITCHEN Line 44108      Note: ANNEX DHGL EUROLINE 03 GLOSS CTR  8Dec15 / 17Jan16	
Inv.3431	1 - LOCATION: 2ND FLOOR LAUNDRY  SUPPLY AND INSTALL 2CM STONE COUNTERT TOP WITH STANDARD SQUARE EDGE – GROUP 1 IN THE LAUNDRY ROOM Line 44158      Note: CAESARSTONE 9141 ICE SNOW WITH STD SQUARE EDGE  8Dec15 / 17Jan16	
Inv.3431	1 - LOCATION: FORMAL ROOM  SUPPLY AND INSTALL COFFERED CEILING TO FORMAL ROOM PRICING AS PER LIST ATTACHED Line 44133      Note: SEE SKETCH ATTACHED  8Dec15 / 17Jan16	
Inv.3431	1 - LOCATION: BEDROOM 2 AND 3  DELETE IN ITS ENTIRETY THE CLOSET IN BEDROOM 2 AND BEDROOM 3 FINISH SMOOTH WALL - STRAIGHT ACROSS Line 44135      Note:  8Dec15 / 17Jan16	



CONSTRUCTION SUMMARY

Teefy Developments Limited / 9130 Bathurst

Lot/Unit: 95    Phase/Building: 1    Model/Floor Plan: Riverdale(22-3)

Inv.3431	1 - LOCATION: FLOOR TILE IN FOYER, POWDER ROOM, MASTER ENSUITE & MAIN & LAUNDRY ROOM  SUPPLY AND INSTALL UPGRADE GROUT: BONE 612 TO FLOOR TILE IN SPECIFIED AREAS ABOVE  Line 44144 Note: 12 X 24 CLASSIC DESIGN ZEBRINO BIANCO GREY (OE.CL.ZEB.1224.PL) WITH UPGRADE GROUT COLOUR: BONE 612  8Dec15 / 17Jan16	
Inv.3431	1 - LOCATION: MAIN & MASTER SHOWER STALLS  SUPPLY AND INSTALL UPGRADE GROUT COLOUR TO SHOWER FLOOR TILE IN MAIN AND MASTER SHOWER STALLS  COLOUR: BONE 612  Line 44153 Note: MARBLE MOSAICS POLISHED VERONA BLEN HERRINGBONE 0.6"X 2" (GM.VERONA.BL.HER.BON)  8Dec15 / 17Jan16	
Inv.3431	1 - LOCATION: ALL BATHROOMS  DO NOT SUPPLY OR INSTALL MIRRORS, TOILET PAPER HOLDERS, SOAP HOLDERS OR TOWEL BARS IN ALL BATHROOMS.  Line 44188 Note:  8Dec15 / 17Jan16	
Inv.3431	1 - LOCATION: FAMILY ROOM  SUPPLY AND INSTALL FURRED OUT WALL TO RECESS ELECTRIC FIREPLACE. WALL TO BE APPROXIMATELY 6 FEET +/- WIDE AND APPROXIMATELY 10 INCHES +/- DEEP FROM FLOOR TO CEILING.  Line 44630 Note: PRICE INCLUDES RELOCATION OF STANDARD CABLE TV ROUGH-IN CABLE AND ELECTRICAL OUTLET.  8Dec15 / 17Jan16	

PLUMBING

Inv.3431	1 - LOCATION: KITCHEN  SUPPLY AND INSTALL WATERLINE ROUGH-IN TO THE FRIDGE LOCATION (NO HOOK UP)  Line 45400 Note: LOCATION AS PER SKETCH ATTACHED.  8Dec15 / 17Jan16	
Inv.3431	1 - LOCATION: KITCHEN  SUPPLY AND INSTALL SOAP DISPENSER TO KITCHEN ISLAND MOEN MODEL #S3947 CHROME  Line 44114 Note: TO BE LOCATED TO THE LEFT SIDE OF FAUCET (WHEN FACING SINK)  8Dec15 / 17Jan16	
Inv.3431	4 - LOCATION: POWDER ROOM, MAIN BATHROOM AND MASTER ENSUITE  SUPPLY AND INSTALL UNDERMOUNT SINKS TO ALL BATHROOMS MODEL # 4210CIY CATENA RECTANGULAR SINK 20"  Line 44142 Note: GRANITE AND SINGLE HOLE FAUCET IS INCLUDED IN SCHEDULE PE  8Dec15 / 17Jan16	



CONSTRUCTION SUMMARY

Teefy Developments Limited / 9130 Bathurst

Lot/Unit: 95    Phase/Building: 1    Model/Floor Plan: Riverdale(22-3)

Inv.3431	1 - LOCATION: MASTER ENSUITE  SUPPLY AND INSTALL UPGRADE FAUCET TO FREE STANDING TUB MOEN 90 DEGREE MODEL #9796/TS904 CHROME ROMAN TUB WITH HANDHELD SHOWER	
Line 44160	Note:	
8Dec15 / 17Jan16		
Inv.3431	1 - LOCATION: MASTER ENSUITE  SUPPLY AND INSTALL SHOWER SPA PACKAGE OPTION 6 - MOEN 90 DEGREE - CHROME	
Line 44161	Note: SEE SPECS ATTACHED FOR COMPONENT DETAILS	
8Dec15 / 17Jan16		
Inv.3431	1 - LOCATION: MASTER ENSUITE  SUPPLY AND INSTALL RAIN HEAD TO OPTION 6 SHOWER SPA PACKAGE CHROME -(MOEN S112) IN ADDITION TO STANDARD SHOWER HEAD  DO NOT DELETE THE SHOWER HEAD	
Line 44162	Note: SEE SPEC SHEET ATTACHED FOR COMPONENT DETAILS THIS PRICE INCLUDES DIVERTER REQUIRED FOR RAIN HEAD	
8Dec15 / 17Jan16		
Inv.3431	1 - LOCATION: MASTER ENSUITE  FRAMELESS GLASS SHOWER ENCLOSURE WITH CHROME TOP FRAME ONLY	
Line 44163	Note:	
8Dec15 / 17Jan16		
Inv.3431	3 - LOCATION: ALL BATHROOMS  SUPPLY AND INSTALL UPGRADE TOILETS IN LIEU OF STANDARD THROUGHOUT. CONTRACT CARLI ONE PIECE MODEL #4710BOVU WHITE	
Line 44631	Note:	
8Dec15 / 17Jan16		
Inv.3431	2 - LOCATION: MASTER ENSUITE AND MAIN BATH SHOWER STALLS  SUPPLY AND INSTALL INFINITY DRAIN IN LIEU OF STANDARD DRAIN TO SHOWER STALL IN MASTER AND MAINBATHROOMS	
Line 45408	Note: SEE SPEC ATTACHED	
8Dec15 / 17Jan16		

PLUMBING - LAVATORY FAUCETS

Inv.3431	1 - LOCATION: KITCHEN  SUPPLY AND INSTALL UPGRADE FAUCET - MOEN MODEL S7597 CHROME 90 DEGREE SINGLE HANDLE PULL OUT	
Line 44113	Note:	
8Dec15 / 17Jan16		
Inv.3431	2 - LOCATION: MASTER ENSUITE  SUPPLY AND INSTALL UPGRADE FAUCETS TO MASTER ENSUITE SINKS MOEN 90 DEGREE MODEL #S6705 CHROME - SINGLE HANDLE OPEN TROUGH	
Line 44159	Note:	
8Dec15 / 17Jan16		



CONSTRUCTION SUMMARY

Teefy Developments Limited / 9130 Bathurst

Lot/Unit: 95    Phase/Building: 1    Model/Floor Plan: Riverdale(22-3)

TILE - FLOOR

Inv.3431	1 - LOCATION: MUD ROOM LOWER LEVEL	
	SUPPLY AND INSTALL FLOOR TILE - UPGRADE 2 - - MUD ROOM IN BASEMENT (ON CONCRETE)	
Line 44137	Note: 13 X 13 VENUS ANTHRACITE (GE.VN.ATR.1313.MT)	
8Dec15 / 17Jan16		
Inv.3431	1 - LOCATION: POWDER ROOM	
	SUPPLY AND INSTALL FLOOR TILE - UPGRADE 8 - - POWDER ROOM FLOOR - STANDARD STACKED INSTALL	
Line 44139	Note: 12 X 24 CLASSIC DESIGN ZEBRINO BIANCO GREY (OE.CL.ZEB.1224.PL) WITH UPGRADE GROUT COLOUR: BONE 612	
8Dec15 / 17Jan16		
Inv.3431	1 - LOCATION: FOYER	
	SUPPLY AND INSTALL FLOOR TILE - UPGRADE 8 - - VESTIBULE FLOOR STANDARD STACKED INSTALL	
Line 44143	Note: 12 X 24 CLASSIC DESIGN ZEBRINO BIANCO GREY (OE.CL.ZEB.1224.PL) WITH UPGRADE GROUT COLOUR: BONE 612	
8Dec15 / 17Jan16		
Inv.3431	1 - LOCATION: MASTER ENSUITE	
	SUPPLY AND INSTALL FLOOR TILE - UPGRADE 8 - - ENSUITE BATHROOM FLOOR STANDARD STACKED INSTALL	
Line 44146	Note: 12 X 24 CLASSIC DESIGN ZEBRINO BIANCO GREY (OE.CL.ZEB.1224.PL) WITH UPGRADE GROUT COLOUR: BONE 612	
8Dec15 / 17Jan16		
Inv.3431	1 - LOCATION: LAUNDRY ROOM	
	SUPPLY AND INSTALL FLOOR TILE - UPGRADE 8 - - LAUNDRY ROOM ON 2ND FLOOR - STANDARD STACKED INSTALL	
Line 45403	Note: 12 X 24 CLASSIC DESIGN ZEBRINO BIANCO GREY (OE.CL.ZEB.1224.PL) WITH UPGRADE GROUT COLOUR: BONE 612	
8Dec15 / 17Jan16		
Inv.3431	1 - LOCATION: MAIN BATHROOM SHOWER STALL	
	SUPPLY AND INSTALL FLOOR TILE - UPGRADE 8 - - MAIN BATHROOM SHOWER FLOOR	
Line 44151	Note: MARBLE MOSAICS POLISHED - VERONA BLEND HERRINGBONE 0.6" X 2" (GM.VERONA.BL.HER.BON) UPGRADE GROUT: BONE 612	
8Dec15 / 17Jan16		
Inv.3431	1 - LOCATION: MASTER ENSUITE SHOWER STALL	
	SUPPLY AND INSTALL FLOOR TILE - UPGRADE 8 - - ENSUITE BATH SHOWER FLOOR	
Line 44152	Note: MARBLE MOSAICS POLISHED - VERONA BLEND HERRINGBONE 0.6" X 2" (GM.VERONA.BL.HER.BON) UPGRADE GROUT: BONE 612	
8Dec15 / 17Jan16		
Inv.3431	1 - LOCATION: MAIN BATHROOM	
	SUPPLY AND INSTALL FLOOR TILE - UPGRADE 8 - - MAIN BATH FLOOR STANDARD STACKED INSTALL	
Line 45404	Note: 12 X 24 CLASSIC DESIGN ZEBRINO BIANCO GREY (OE.CL.ZEB.1224.PL) WITH UPGRADE GROUT COLOUR: BONE 612	
8Dec15 / 17Jan16		

TILE - WALL





CONSTRUCTION SUMMARY

Teefy Developments Limited / 9130 Bathurst

Lot/Unit: 95    Phase/Building: 1    Model/Floor Plan: Riverdale(22-3)

Inv.3431	1 - LOCATION: MAIN BATH SHOWER STALL  SUPPLY AND INSTALL WALL TILE - UPGRADE 2 - - MAIN BATH SHOWER WITH CEILING  INSTALL HORIZONTAL IN LIEU OF VERTICAL  Line 45411 Note: 8 X 12 BRICK GLOSSY WHITE (TH.BR.WHT.0812) STANDARD WHITE GROUT  8Dec15 / 17Jan16	
Inv.3431	1 - LOCATION: MASTER ENSUITE  SUPPLY AND INSTALL WALL TILE - UPGRADE 2 - - ENSUITE BATH SHOWER WITH CEILING  INSTALL HORIZONTAL IN LIEU OF VERTICAL  Line 44149 Note: 8 X 12 BRICK GLOSSY WHITE (TH.BR.WHT.0812.GL) GROUT: STANDARD WHITE  8Dec15 / 17Jan16	

EXTRAS AS PER OFFER

Stainless Steel Fridge, Stove and Dishwasher and front loading washer and dryer in white from Vendors standard samples, no cash value, not transferable. (Supplied only not installed) ** to - arrange delivery call: The Brick commercial sales division at Worksheet Note:	
Rogers Free Services Package includes 6 months of: home phone, TV and Internet Service. Worksheet Note:	
The Vendor agrees to supply and install hardwood flooring in all bedrooms, with a choice of colour, from Vendors standard samples. Worksheet Note:	
The Vendor agrees to supply and install engineered hardwood in lower level recreation room from Vendors standard samples. Worksheet Note:	
The Vendor agrees to supply and install granite countertops in all bathrooms including powder room from Vendors standard samples Worksheet Note:	
The Vendor agrees to supply and install a fully tiled shower in the main bathroom in lieu of standard tub (does not include glass) from Vendors standard samples, as per plan. Worksheet Note:	



## INTERIOR COLOUR SCHEME

Purchasers: GRAZIELLA CIARROCCI & MICHEL LAVAL Property: 95 of Plan -  
Telephone Res. / Bus: (416) 939-2888 / Project: Teffy Developments Limited  
Decor Advisor: Steffanee Appio Model and Elevation: Riverdale(22-3)

Layout Changes: ☒ Yes ☐ No Sketch Attached: ☒ Yes ☐ No Exterior Colour Scheme:

## 1. Cabinetry

	Style and Colour	Counter Top	Hardware
Kitchen / Breakfast	ANNEX DHGL ARTICO GLOSS MWP	8141 ICE SNOW STD SQ EDGE	12899 HANDLE
Kitchen Island	ANNEX DHGL EUROLINE C3 GLOSS CTR	8141 ICE SNOW STD SQ EDGE	12899 HANDLE
Laundry Room	CLASS - BOSTON PAINT MACADEMIA	8141 ICE SNOW STD SQ EDGE	145 KNOB
Powder Room	CLASS - BOSTON PAINT MACADEMIA	4350 LAGOS BLUE STD SQ ED	9645 HANDLE
Main Bathroom	CLASS - BOSTON PAINT MACADEMIA	4350 LAGOS BLUE STD SQ ED	145 KNOB
Master Ensuite Bathroom	CLASS - BOSTON PAINT MACADEMIA	1141 PURE WHITE STD SQ ED	9645 HANDLE
Second Ensuite Bathroom (If Applicable)	N/A	N/A	N/A

## Appliances

## Custom Size Fridge

☒ Yes ☐ No

## Valance Lighting

☒ Yes ☐ No

## Microwave / Range Hood

☐ Yes ☒ No

## Cooktop / Rangesetop

☐ Yes ☒ No

## Built in Wall Oven

☐ Yes ☒ No

## Slide-in Range

☒ Yes ☐ No

## Comment

UPGRADE CABINETS IN KITCHEN - DIFFERENT COLOUR TO ISLAND IN KITCHEN- CAEASARSTONE WATERFALL SIDES TO KITCHEN ISLAND - UPGRADE CAESARSTONE TO LAUNDRY ROOM, POWDER ROOM, MAIN & MASTER BATHROOM  
UPGRADE HANDLES & KNOBS TO KITCHEN, BATHROOMS, LAUNDRY ROOM

## 2. Flooring

	Selection
FOYER	12 X 24 CLASSIC DESIGN ZEBRINO (BIANCO/GREY) (OE.CL.ZEB.1224.PL) GROUT BONE 812
Main Hall	N/A
Back Hall	N/A
Breakfast	3/4" X 3-5/8" GENERATIONS SATIN FINISH RED OAK - COBALT
Laundry Room	12 X 24 CLASSIC DESIGN ZEBRINO (BIANCO/GREY) (OE.CL.ZEB.1224.PL) GROUT BONE 812
Kitchen	3/4" X 3-5/8" GENERATIONS SATIN FINISH RED OAK - COBALT
Powder Room	12 X 24 CLASSIC DESIGN ZEBRINO (BIANCO/GREY) (OE.CL.ZEB.1224.PL) GROUT BONE 812
Main Bathroom	12 X 24 CLASSIC DESIGN ZEBRINO (BIANCO/GREY) (OE.CL.ZEB.1224.PL) GROUT BONE 812
Master Ensuite	12 X 24 CLASSIC DESIGN ZEBRINO (BIANCO/GREY) (OE.CL.ZEB.1224.PL) GROUT BONE 812
Bathroom (If Applicable)	N/A
Mud Room	13 X 13 VENUS ANTHRACITE (OE.VN.ATR.1313.MT) (UPGRADE 2)
Living Room	N/A
Dining Room	3/4" X 3-5/8" GENERATIONS SATIN FINISH RED OAK - COBALT (FORMAL ROOM)
Family / Great Room	3/4" X 3-5/8" GENERATIONS SATIN FINISH RED OAK - COBALT
Den / Library / Study	STANDARD PAPILIO BERBER - 18674 NEWFOUNDLAND SAND (LOWER LEVEL)
Basement Landing (If Applies)	N/A
Lower Landing (If Applicable)	3/4" X 3-5/8" GENERATIONS SATIN FINISH RED OAK - COBALT (AT POWDER ROOM)
Upper Landing	3/4" X 3-5/8" GENERATIONS SATIN FINISH RED OAK - COBALT
Upper Hall	3/4" X 3-5/8" GENERATIONS SATIN FINISH RED OAK - COBALT
Master Bedroom	3/4" X 3-5/8" GENERATIONS SATIN FINISH RED OAK - COBALT
Bedroom #2	3/4" X 3-5/8" GENERATIONS SATIN FINISH RED OAK - COBALT
Bedroom #3	3/4" X 3-5/8" GENERATIONS SATIN FINISH RED OAK - COBALT
Bedroom #4	N/A
Bedroom #5	N/A
RECREATION ROOM	3/4" X 3-5/8" GENERATIONS SATIN FINISH RED OAK - COBALT (LOWER LEVEL)

Flooring Continued on Page 2

Initial: 

Page 1 of 3



## INTERIOR COLOUR SCHEME

Purchasers: GRAZIELLA CIARROCCI & MICHEL LAVAL Property: 95 of Plan -  
Telephone Res. / Bus: (416) 939-2888 / Project: Tesfy Developments Limited  
Decor Advisor: Steffanee Appio Model and Elevation: Riverdale(22-3)

### 2. Flooring - Continued -

Upgrade Underpad	Type	Area
	STD	DEN IN LOWER LEVEL
Carpet on Stairs	Capped	Runner - *Upgrade
Comment	STD	STD

STANDARD PAPILO WITH STANDARD UNDERPAD - 18674 NEWFOUNDLAND SAND

### 3. Plumbing Fixtures / Faucets

Kitchen	UPGRADE	Second Ensuite		Powder Room	STD
Master Ensuite	UPGRADE			Other Room	
Main Bathroom	STD				

#### Comment

UPGRADE FAUCET IN KITCHEN  
UPGRADE FAUCETS IN MASTER ENSUITE (SINKS, TUB, SHOWER STALL)

### 4. Wall Tile

	Tile Selection	Listello	Insert	Insert Selection
Main Bathroom	6 X 12 BRICK GLOSSY WHITE (TH.BR.WHT.0812) UP 2	<input type="checkbox"/>	<input type="checkbox"/>	MARBLE MOSAIC 0.6" X 2"
Master Ensuite				
Tub Deck	N/A	<input type="checkbox"/>	<input type="checkbox"/>	
Tub Apron	N/A	<input type="checkbox"/>	<input type="checkbox"/>	
Tub Surround	N/A	<input type="checkbox"/>	<input type="checkbox"/>	
Shower Stall	6 X 12 BRICK GLOSSY WHITE (TH.BR.WHT.0812) UP 2	<input type="checkbox"/>	<input type="checkbox"/>	MARBLE MOSAIC 0.6" X 2"
Second Ensuite	HORIZONTAL INSTALL TO WALL TILE	<input type="checkbox"/>	<input type="checkbox"/>	VERONA BLEND HERRINGB
		<input type="checkbox"/>	<input type="checkbox"/>	SHOWER FLOORS
		<input type="checkbox"/>	<input type="checkbox"/>	GROUT 612 BONE
Kitchen Backsplash	N/A	<input type="checkbox"/>	<input type="checkbox"/>	
Complete Backsplash	N/A	<input type="checkbox"/>	<input type="checkbox"/>	

#### Comment

MAIN BATH & MASTER SHOWER STALL FLOOR - MARBLE MOSAIC POLISHED VERONA BLEND HERRINGBONE  
(GM.VERONA.BL.HER.BON) UPGRADE GROUT BONE 612 TO SHOWER FLOOR TILE AND FLOOR TILE ONLY  
(STANDARD WHITE GROUT TO SHOWER WALL TILES)  
HORIZONTAL WALL TILE INSTALL TO SHOWER STALLS - MAIN AND MASTER SHOWERS

### 5. Fireplace

	Living Room			Family Room			Other Room - Specify		
	Purchased	As Per Plan	N/A	Purchased	As Per Plan	N/A	Purchased	As Per Plan	N/A
Fireplace Type	<input type="radio"/>	<input type="radio"/>	<input type="radio"/>	<input type="radio"/>	<input checked="" type="radio"/>	<input type="radio"/>	<input type="radio"/>	<input type="radio"/>	<input type="radio"/>
Mantle Type				BLF-50 STANDARD					
Over Mantle									
Colour / Stain									
Surround									
Hearth									

#### Comment

\*\*\*\*\*UPGRADE - FURR OUT WALL TO ACCOMMODATE RECESSED FIREPLACE\*\*\*\*\*

Initial:

*[Handwritten signatures]*

Page 2 of 3





## INTERIOR COLOUR SCHEME

Purchasers: GRAZIELLA CIARROCCI & MICHEL LAVAL Property: 95 of Plan -  
Telephone Res. / Bus: (416) 939-2988 / Project: Teefy Developments Limited  
Decor Advisor: Steffanee Appio Model and Elevation: Riverdale(22-3)

### 6. Trim Carpentry

Door Hardware STD

Interior Trim STD

Comment

#### Interior Doors

☐ 2 Panel Arch Top

☒ 2 Panel Square Top

☐ 6 Panel

Initial for Door Style

### 7. Railings and Pickets

Railing Package STD

Railing Colour COBALT

Picket Colour MATTE BLACK METAL

Wood Stairs ☐ No ☒ Oak

Tread Colour COBALT

Comment

STAIN OAK STAIRS TO COMPLIMENT HARDWOOD STAIN - COBALT COLOUR

### 8. Plaster Mouldings and Medallions

Foyer

Main Hall

Living Room

Dining Room

Family Room

Kitchen/Breakfast

Den/Library

Lower Landing

Comment

COFFERED CEILING IN FORMAL ROOM

### 9. Wall Paint

STANDARD SENATOR WHITE

Smooth Ceilings

☐ First Floor

☐ First Floor incl. Second Floor Hall

☐ First and Second Floor

☒ Throughout

☐ Not Applicable

Trim Paint

### 10. Additional Comments

### 11. Disclaimers and Notes

- Colours of all materials are as close as possible to builder's selection, but not necessarily identical due to variances in manufacturing.
- Any extras listed above are null and void unless accompanied by a separate invoice/amendment. Said invoice must be paid in full.
- The Purchaser acknowledges that after Interior Colour Selection form is signed and dated, no further changes will be permitted other than re-selection due to unavailability. Purchaser's Initials
- The Purchaser acknowledges reading and accepting the "Senator Homes Décor Centre Disclaimers" form. This document contains other miscellaneous disclaimers.

This Interior Colour Selection is final and approved by:

Purchaser:

Signature: [Signature]

Date: Jun. 19 / 2016

Signature: [Signature]

Date: Jun. 19 / 2016

Vendor: [Signature]

Teefy Developments Limited

# RIVERDALE

2454 SQ.FT. / 2288 SQ.FT. WITH OPTIONAL TANDEM GARAGE

9130-h04# 95

SENATOR HOMES  
DECOR CENTRE

DATE: 1/28/85  
INITIALS: JAC

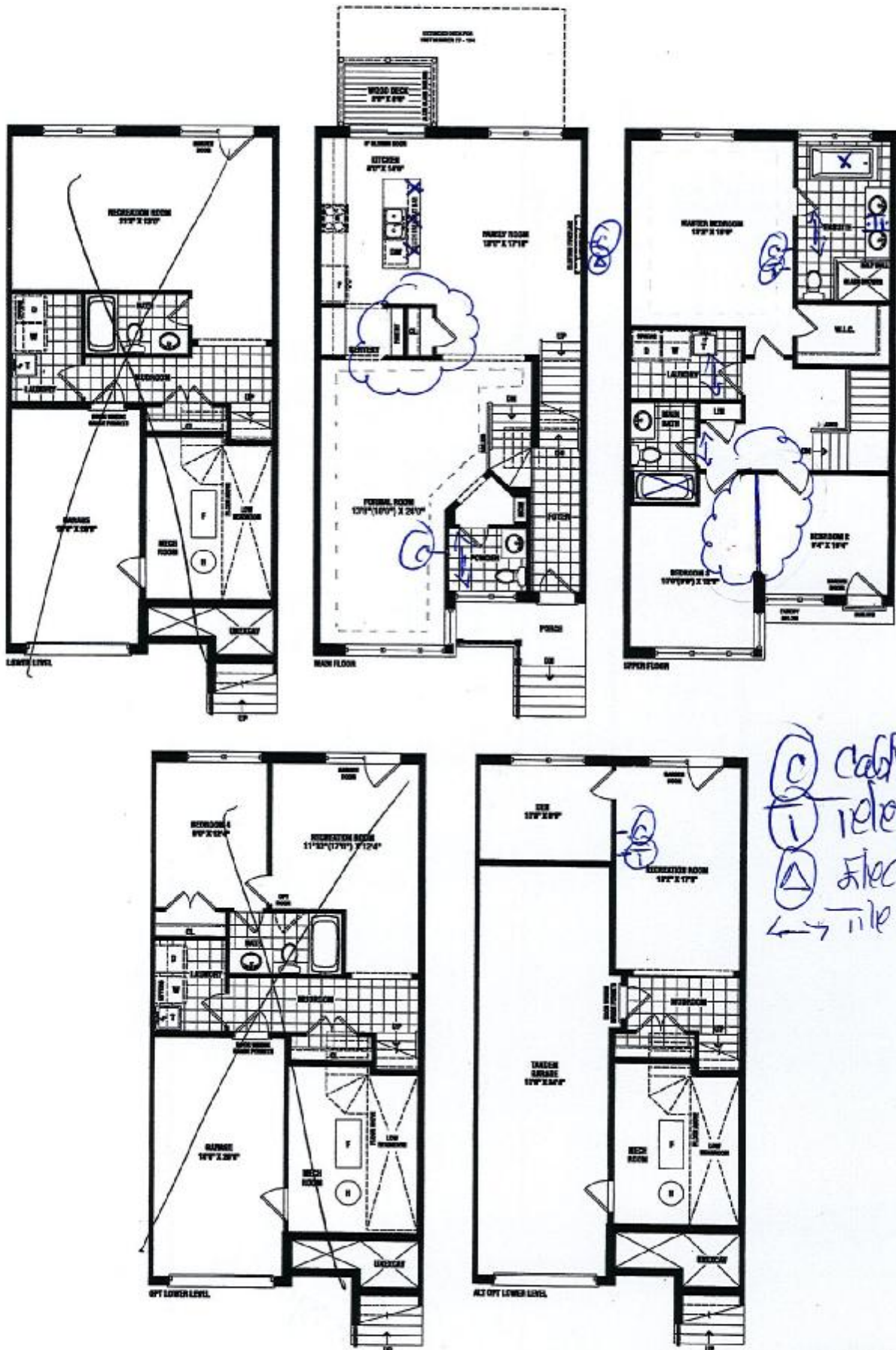

③ cable  
① telephone  
⊕ Electrical  
↔ tile direction

**SENATOR**  
HOMES

Renderings are artist's concept. Some elevations may vary from that shown. Actual useable square footage may vary from that stated herein. Some floorplans and elevations are minor in size to that shown. E&O.E. 22-3

JAC



# SENATOR HOMES - TEEFY

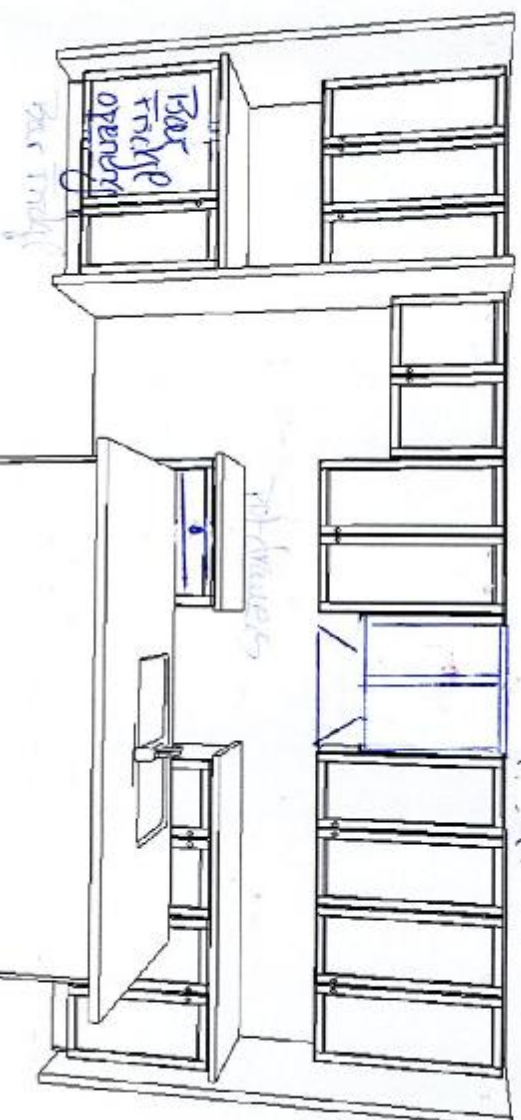

# RIVERDALE - TH-22-3

## STD. LAYOUT

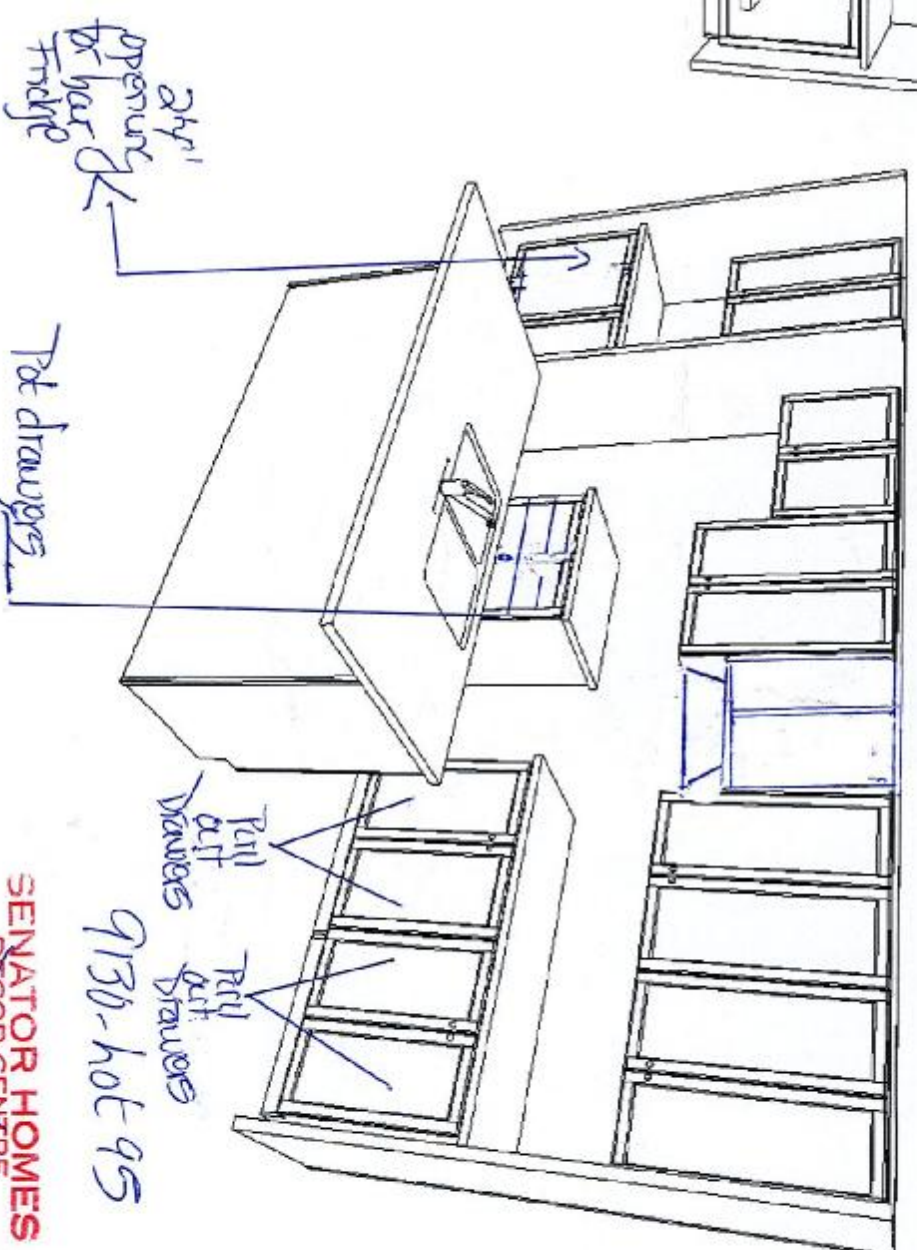

Note: see PD for  
pantry in servery

SENATOR HOMES  
DECOR CENTRE

DATE:

INITIALS:

9130-hot 95

9130- hot 95

SENATOR HOMES  
DECOR CENTRE

DATE: Dec 8/15  
INITIALS: [Signature]

90°

Traditional | Transitional | Modern

master ensuite  
x2



**Single Handle Open Trough  
Lavatory with Pop-Up Drain**  
Model S6705†

Chrome:	\$ 552.79
Other:	<del>\$ 875.28</del>



**Single Handle Lavatory  
with Pop-Up Drain**  
Model S6700†

Chrome:	\$ 480.76
Other:	\$ 761.04



**Single Handle Vessel Lavatory  
with Push Button Drain**  
Model 140780 †/ S6711†

Chrome:	\$ 750.47
Other:	\$ 1,111.46



**Widespread Lavatory  
with Pop-Up Drain**  
Model 69000 / TS6720†

Chrome:	\$ 616.56
Other:	\$ 904.47

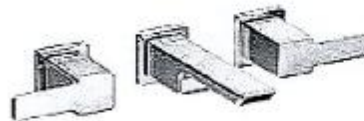

**Two Handle Wall Mount Lavatory  
Faucet Lever Handles**  
Model 9700 / TS6730† / 140780†

Chrome:	\$ 837.76
Other:	\$ 1,270.71

\*\* Please see Vertical Spa Guide for Installation #700106

Matching tub drain assembly available. Please see *Bath Hardware and Home Care* Section.

† To order, combine the model number with one of these finish letters:



Chrome  
(use faucet  
number only)



BN

**MOEN**  
Buy it for looks. Buy it for life.\*



90°

Traditional | Transitional | Modern

9130- Lot 95  
**SENATOR HOMES**  
 DECOR CENTRE  
 DATE: SEP 8/15  
 INITIALS: [Signature]



**Roman Tub**  
 Model 4796 / TS903†

Chrome:	\$ 642.46
Other:	\$ 935.41

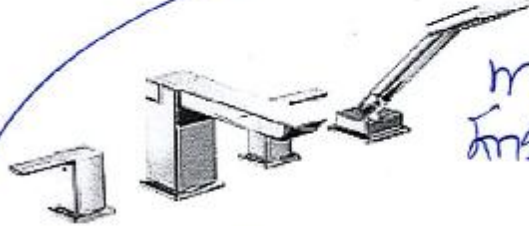

**Roman Tub with Handheld Shower**  
 Model 9796 / TS904†

Chrome:	\$ 1,583.85
Other:	<del>\$ 2,115.78</del>

*master  
 Insuite*

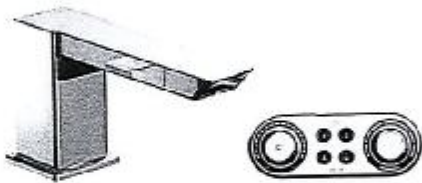

**IO Digital™ 90° Roman Tub**  
 Model 54994 / 4998 / TS9031† / TS3495†

Chrome:	\$ 2,605.05
Other:	\$ 3,091.90



**IO Digital™ 90° Roman Tub with Handheld Shower**  
 Model 54994 / 4898 / TS9041† / TS3495†

Chrome:	\$ 3,311.80
Other:	\$ 4,037.56



**IO Digital™ Remote Control for Roman Tub**

Model SA349 (for Chrome) or  
 SA349BL (for Black)

\$ 337.89
-----------

\*\* Please see Vertical Spa Guide for Installation #700106  
 Matching tub drain assembly available. Please see *Bath Hardware and Home Care* Section.  
 † To order, combine the model number with one of these finish letters:



Chrome  
 (use faucet  
 number only)

BN

**MOEN**  
 Buy it for Looks. Buy it for Life.®





9130-607 95

Master Insuite

DATE: 12/28/15

INITIALS: [Signature]

90°

As Seen in Showroom

Shower Spa Packages  
Option 6

In Lieu of Standard Shower

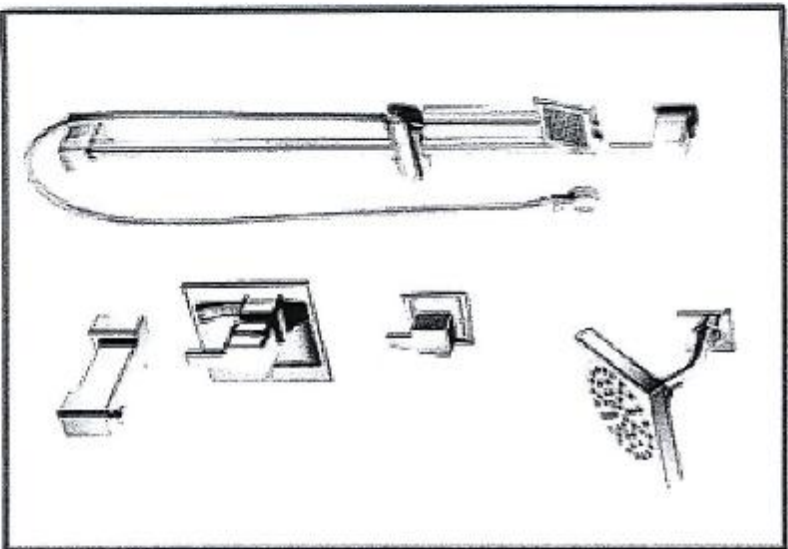

Moen Shower Package In lieu of Standard  
OPTION 6

- Moen TS3111 Valve Trim
- Moen TS4172 Transfer Trim
- Moen S3879EP Hand Shower Bar
- Moen A720 Wall Elbow
- Moen Transfer Valve RJ 3373
- Moen Valve RJ 2510

Price - Chrome \$1900.00 + HST  
Brush Nickel ~~\$2700.00 + HST~~

+



Plus Rainhead

The Rain Head Head is substituted  
For either the Hand Shower or Standard  
Shower Head. The Posturecise Valve will  
not accommodate all 3 functions.

- Optional Rain Head In lieu of standard:
- Moen S11210 Rain Head
  - Moen 116651 Ceiling Arm
  - Moen AT2119 Ceiling Arm Flange

ADDD Price - Chrome \$570.00 + HST  
Brush Nickel ~~\$790.00 + HST~~



\$210

# 20" RECTANGULAR UNDERMOUNT SINK

DATE: Dec 8/15 9130-LW-95  
INITIALS: [Signature]

## ✓ 4210CIY Undermount Sink

### Product Specs:

- Vitreous china
- Front overflow hole
- Template and mounting hardware supplied

### Overall Dimensions (W x D x H):

(OD): 510mm(20") x 395mm(15½") x 190mm(7½")  
(ID): 450mm(17¾") x 335mm(13¾") x 140mm(5½")

### Compliance Certifications:

- Meets or exceeds the following :
- IAPMO cUPC
  - ASME A112.19.2 / CSA B45.1-2008

### Shipping:

Cube 1.72  
GW 27 lbs

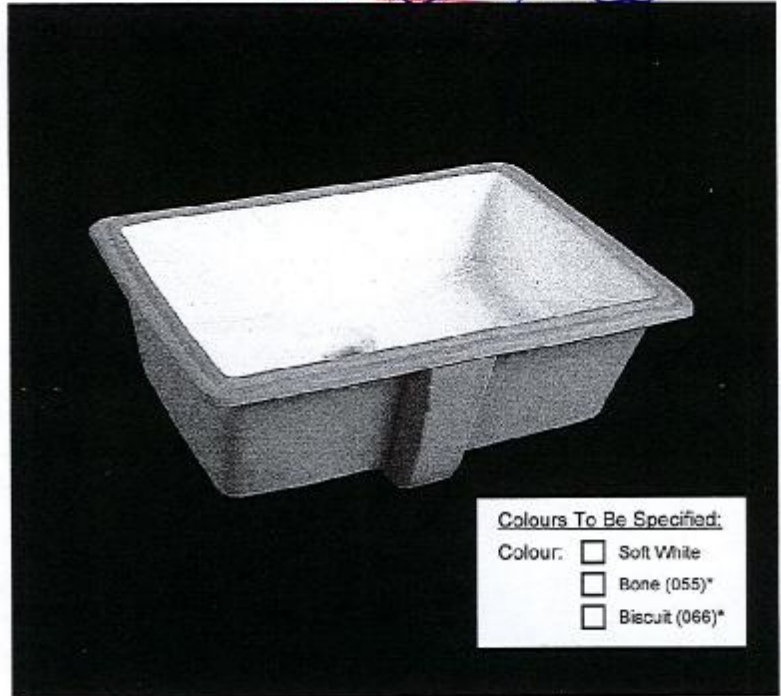

#### Colours To Be Specified:

- Colour: ☐ Soft White  
☐ Bone (055)\*  
☐ Biscuit (066)\*

#### Notes:

Dimensions of fixtures are nominal and may vary within the range of tolerances established by ASME standard A112.19.2. These measurements are subject to change or cancellation. No responsibility is assumed for use of superseded or voided pages.

\*Bone and Biscuit available through Direct Import (CIF) only

Detail of Mounting Clip

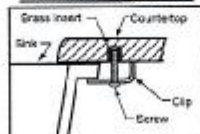

Note:  
▲ Dimensions shown for location of supplies and "P" trap are suggested.

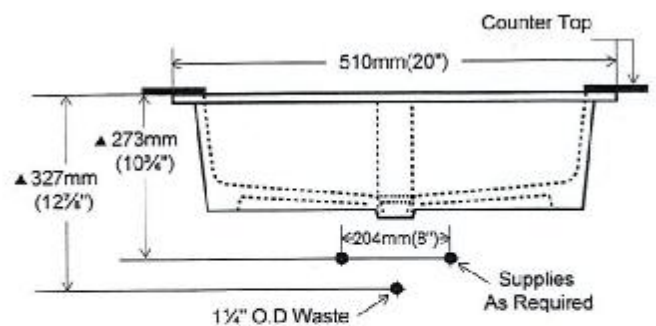
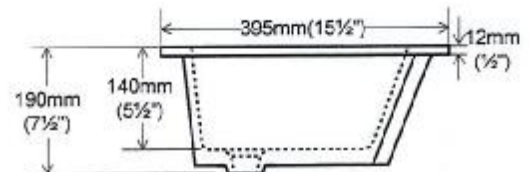
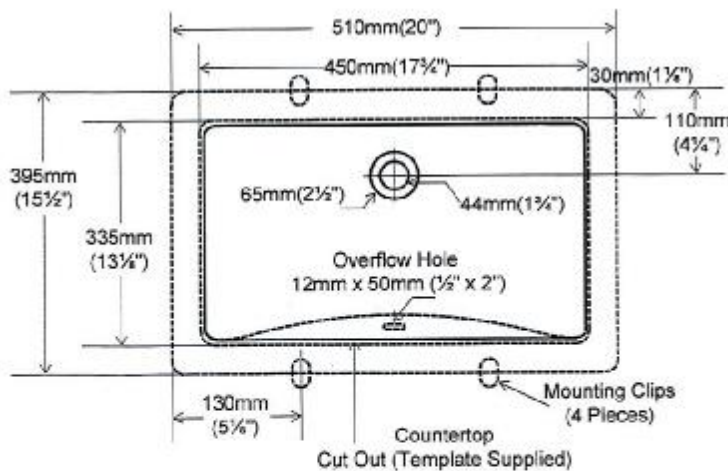



# 90 Degree

Traditional | Transitional | Modern

9130-Lot 95

SENATOR HOMES  
DECOR CENTRE

DATE: Dec 8/15  
INITIALS: [Signature]

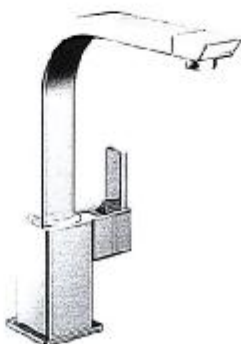

**Single Handle Kitchen Faucet±**

Model S7170†  
(Use model number only for Chrome finish)

Chrome: \$ 576.87  
Other: \$ 741.37

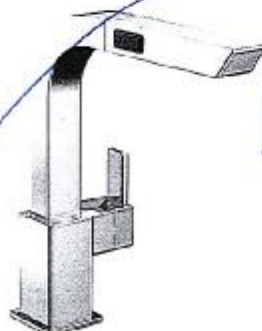

**Single Handle Pullout Kitchen Faucet±**

Model S7597†

Chrome: \$ 885.85  
Other: ~~\$ 1,111.95~~



**Single Handle Bar/Prep Faucet±**

Model S5170†  
(Use model number only for Chrome finish)

Chrome: \$ 518.84  
Other: \$ 666.33

† To order, combine the model number with one of these finish letters:



C



SRS

\* Single or Three Hole Installation  
± Single Hole Installation Only

**MOEN**

Buy it for looks. Buy it for life.®

# Soap or Lotion Dispensers

Traditional | Transitional | Modern



**Traditional Styled Soap/Lotion Dispenser±**

Model S3945†



C SRS ORB

Chrome:	\$ 187.39
Other:	\$ 234.22



**Modern Styled Soap/Lotion Dispenser±**

Model S3947†



C SRS

Chrome:	\$ 187.39
Other:	\$ 234.22



**Transitional Styled Soap/Lotion Dispenser±**

Model S3948†



C SRS ORB

Chrome:	\$ 187.39
Other:	\$ 234.22



**Transitional Styled Soap/Lotion Dispenser±**

Model S3946†



C SRS ORB BL

Chrome:	\$ 187.39
Other:	\$ 234.22
BL:	\$ 206.15

\* Single or Three Hole Installation  
± Single Hole Installation Only

**MOEN**  
Buy it for looks. Buy it for life.\*

9130-hol-95  
SENATOR HOMES  
DECOR CENTRE  
DATE: 12/28/95  
INITIALS: [Signature]  
kitchen



**BreDa  
Baypoint**

Plumbing & Mechanical Inc

45 Rodinea Road, Unit 6 | Maple | ON L6A 1R3

O: 905.553.5711 F: 905.553.6168

**UPPERMOR**

**Infinity Drain**

9130-6045

SENTRY FOR HOMES

JAN 16 2016

*[Handwritten signature]*

Flag



*master shower  
main shower.*



**ACO Residential Trough Drain**

Available in Flag Grate Style Stainless Steel Shown

**36" Drain in lieu of standard Drain \$180.00 + GST**

**QUARTZ**  
DESIGNS



# SENATOR HOMES

## UPGRADE

### Up-Grade Toilets



9130-6045  
 SENATOR HOMES  
 DECOR CENTRE  
 JAN 18 2016  
 DATE: 1/18/2016  
 INITIALS: [Signature]

*Full bathrooms*

#### Option 1

Contrac Cali

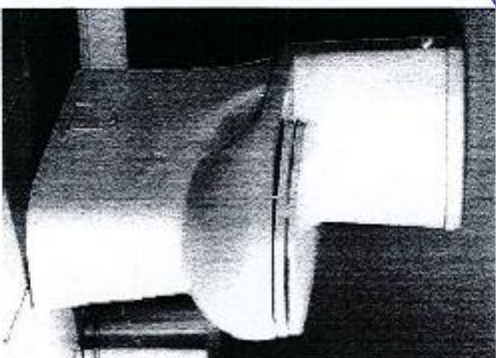

MaP  
1000g

- Cali 1PC Toilet  
 (As Seen standard in Powder Room Main)  
 IN LIEU OF STANDARD 2pc TOILET  
 - Model 4710B0VU (In lieu of standard)  
 • Elongated Bowl Comfort Height  
 • Concealed Trapway  
 • Soft Close Bennis Seat

**\$840.00 + HST**

IN LIEU OF STANDARD

#### Option 2

Contrac Cayla

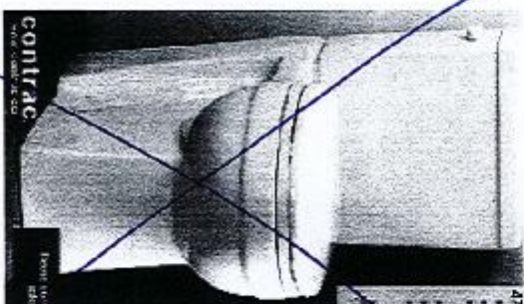

MaP  
1000g

- Cayla 2PC Toilet  
 IN LIEU OF STANDARD 2pc TOILET  
 - Model 478B0VU/4761B0VU  
 • Elongated Bowl Comfort Height  
 • Concealed Trapway  
 • Soft Close Seat

**\$730.00 + HST**

IN LIEU OF STANDARD



9130 - LOT # 95

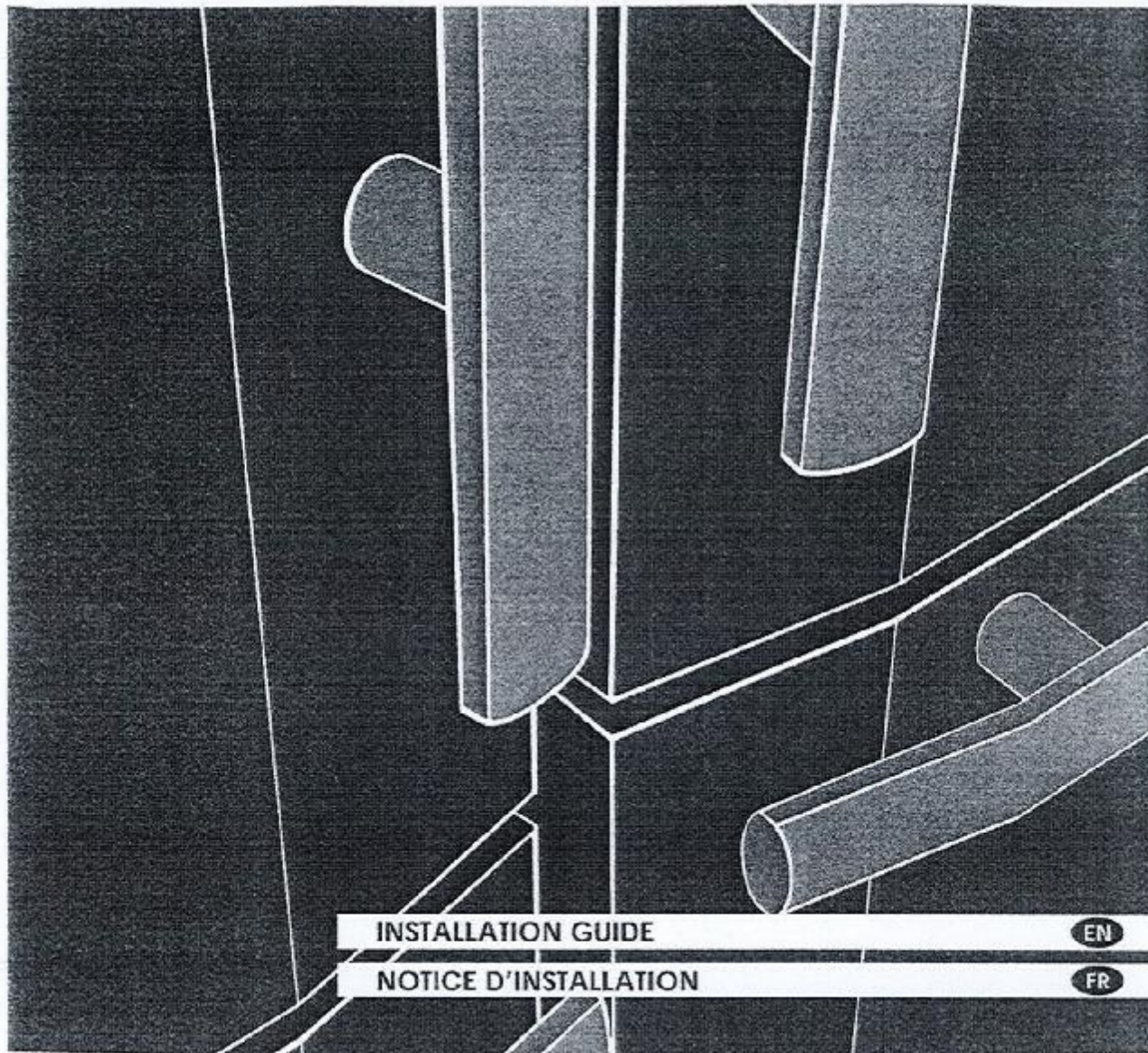

INSTALLATION GUIDE

EN

NOTICE D'INSTALLATION

FR

SENATOR HOMES  
DECOR CENTRE

DATE: JAN 16 2016

INITIALS: [Signature]

**Fhiaba**

9130-LOT#95

SENATOR HOMES  
DECOR CENTRE

DATE: JAN 16 2016  
INITIALS: [Signature]

Installation niche features: X-Pro Series

A area to be left clear for the anti-tipping brackets

Niche Height

2134 mm (84")

Niche Width

FP36: 900 mm (35 1/2")

~~FP30: 750 mm (29 5/8")~~

~~FP24: 600 mm (23 3/4")~~

Door Swing Clearance

FP36: 1470 mm (57 7/8")

~~FP30: 1320 mm (52")~~

~~FP24: 1170 mm (46")~~

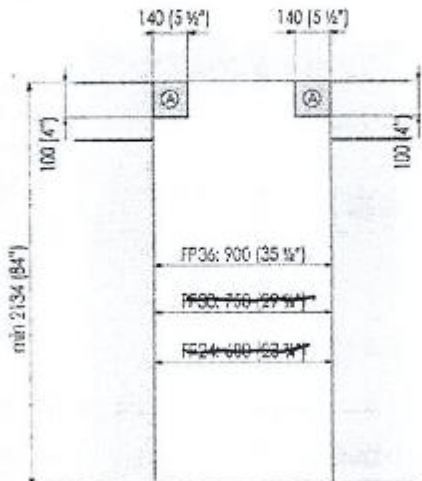

Door Opening Angle

105°

Width

FP36: 899 mm (35 3/8")

~~FP30: 745 mm (29 3/8")~~

~~FP24: 590 mm (23 1/8")~~

Height

2120 mm (83 1/2") + 25 mm (1")

Depth with door

635 mm (25")

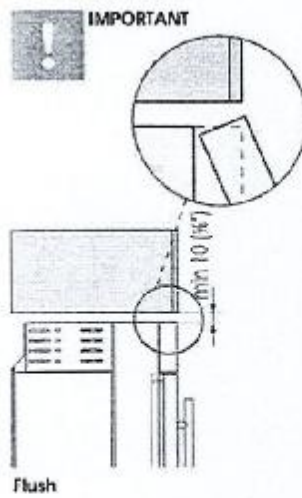
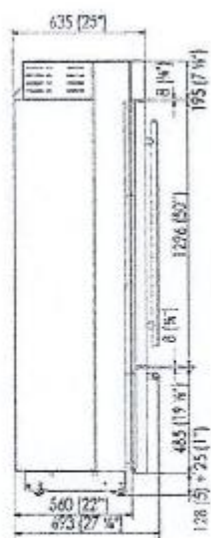
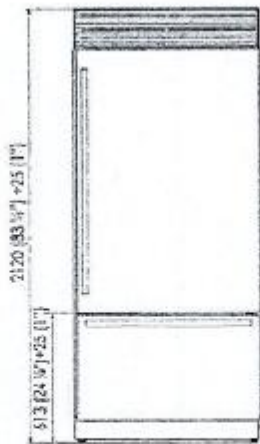
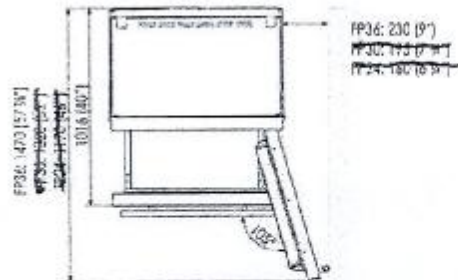



9130 - LOT # 95

Installation Guide

**SENATOR HOMES**  
DECOR CENTRE

DATE:

INITIALS:

JAN 16 2016

Installation niche features: StandPlus Series

**A** area to be left clear for the anti-tipping brackets

**Niche Height**

2134 mm (84")

**Niche Width**

FM36: 900 mm (35 1/2")

FM24: 600 mm (23 3/4")

**Door Swing Clearance**

FM36: 1470 mm (57 7/8")

FM24: 1170 mm (46")

**Door Opening Angle**

105°

**Width**

FM36: 899 mm (35 3/8")

FM24: 599 mm (23 5/8")

**Height**

2120 mm (83 1/2") + 25 mm (1")

**Depth with door**

629 mm (24 3/4")

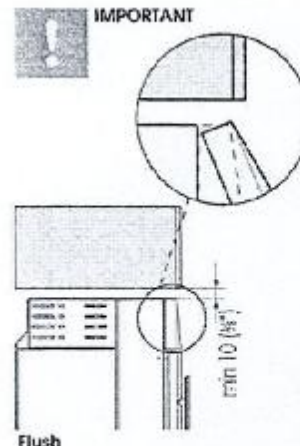
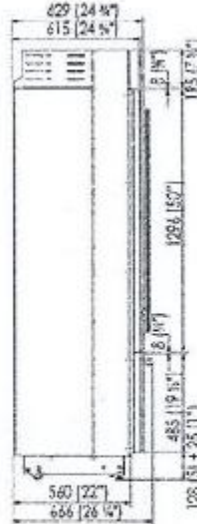
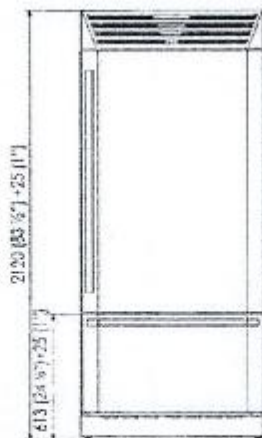
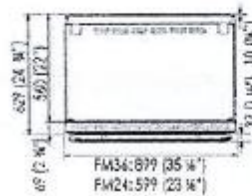
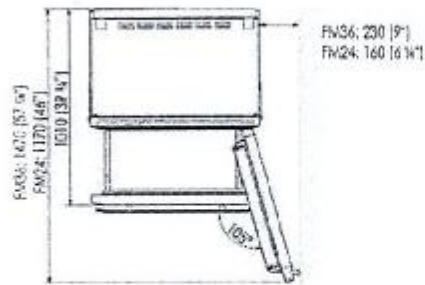
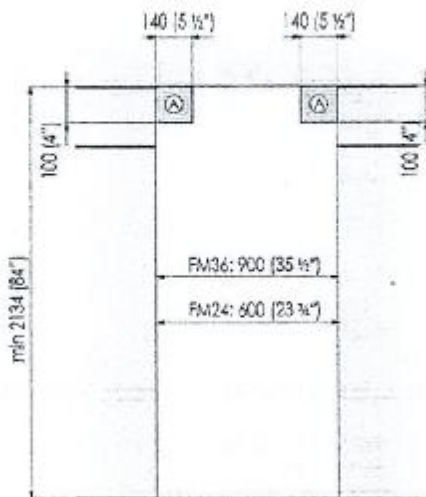

Flush

www.helco.com www.thewillgroup.com

English

9130 - LOT# 95

## BERTAZZONI PROFESSIONAL SERIES

36" UNDERMOUNT CANOPY HOOD KU36 PRO 1 XV

SENATOR HOMES  
DECOR CENTRE

JAN 16 2016

DATE:

INITIALS:

### FEATURES

Hood finishing	stainless steel
Motor	1
Speed	3
Hood control	slider
Halogen lights	2
Filters	aluminum mesh
Max extraction power	400 cfm

### TECHNICAL SPECIFICATIONS

Voltage, frequency	120 V 60 Hz
Max Amp usage, power rating	3.3 A - 400 W
Certification	UL
Warranty	2 years parts and labor

### ACCESSORIES

Narrow duct cover	code 901262
Medium duct cover	code 901263 *
Full-width duct cover	code 901265
Narrow duct cover for ceiling height 8-10 ft	code 901281

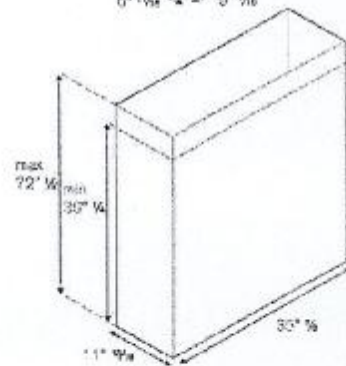
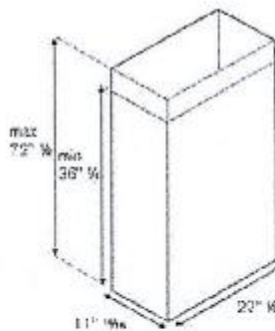
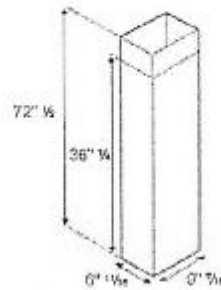
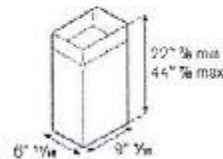
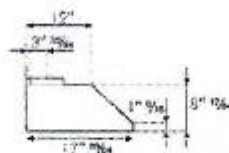
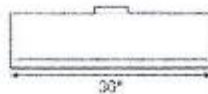
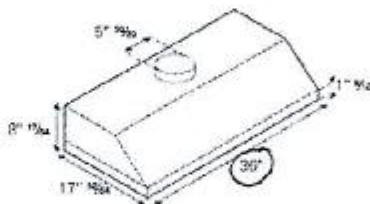

### INSTALLATION INSTRUCTIONS

Bertazzoni recommends to operate the appliance after it has been properly installed. Please refer to the installation manual for further details.

Disclaimer: while every effort has been made to insure the accuracy of the information contained in this brochure, Fratelli Bertazzoni reserves the right to change any part of the information at any time without notice.

Fratelli Bertazzoni, Bertazzoni and the winged wheel brand icon are registered trademarks of Bertazzoni S.p.A.

[bertazzoni.com](http://bertazzoni.com)

9130-LOT#95

## BERTAZZONI PROFESSIONAL SERIES

36" UNDERMOUNT CANOPY HOOD KU36 PRO 1 XV

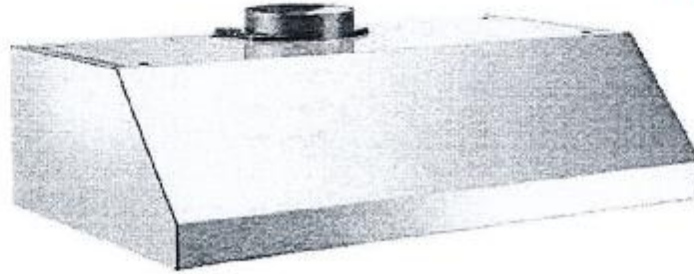

SENATOR HOMES  
DECOR CENTRE  
JAN 16 2016  
DATE: \_\_\_\_\_  
INITIALS: *gl* *ll*

The single-motor canopy hoods deliver extraction power up to 400 CFM with three different power settings. They come equipped with aluminum mesh filters, all easily removable and dishwasher safe. They can be installed under a cabinet or on the wall with an optional narrow or wide duct cover. The design matches Bertazzoni Professional Series ranges and cooktops while also complementing other Bertazzoni Series.

### ~~SINGLE MOTOR CANOPY~~

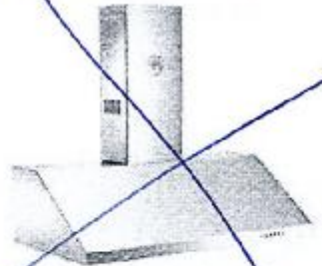

~~Single motor canopy hood shown with optional narrow duct cover. Full-width duct cover is also available.~~



TO COOK BEAUTIFULLY



9130-LOT#95

## BERTAZZONI PROFESSIONAL SERIES

36" 6-BURNER, GAS OVEN PRO36 6 GAS X



SENATOR HOMES  
DECOR CENTRE  
DATE: JAN 16 2016  
INITIALS: [Signature]

Bertazzoni Professional Series ranges bring the authentic experience of Italian cooking to the heart of your home. They are available in stainless steel and six beautiful colors inspired by the wonderful produce of Emilia, the heartland of Bertazzoni. The Professional 36-inch gas range has an oven with balanced air-flow convection fan to provide even heat distribution for single and multi-level roasting and baking with no flavor crossover. The oven includes telescopic glide shelves, soft-motion door hinges for easy one-hand operation, and triple-glass windows to minimize heat loss. The beautiful worktop is precision-molded off of one sheet of stainless steel. It is configured with six versatile gas burners in brass, including Bertazzoni's signature dual-ring power burner with independently controlled flames for high power to delicate simmer. The worktop is designed for high-efficiency in heat delivery without energy waste. Each burner is equipped with the thermocouple gas shut-off safety system for maximum safety. Complete your Bertazzoni range with any of the available ventilation and backsplash solutions, as well as low profile trim, toekick and other beautiful accessories.

### BRASS BURNER

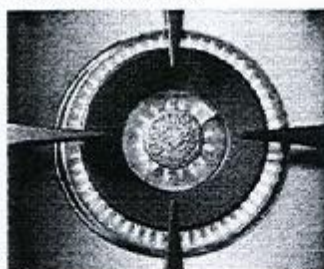

Bertazzoni's exclusive power burners in brass have independently operated flame rings giving maximum flexibility of operation from delicate low simmer to full power.

### SOFT MOTION DOOR

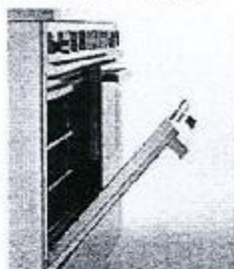

The soft-motion oven door is specially designed and carefully balanced for easy opening and smooth closing with one hand.

### TELESCOPIC GLIDE SHELVES



The telescopic oven rack provides more convenient oven access and easier handling of hot and heavy dishes.



TO COOK BEAUTIFULLY

9130 - LOT #95

## BERTAZZONI PROFESSIONAL SERIES

36" 6-BURNER, GAS OVEN PRO36 6 GAS X

SENATOR HOMES  
DECOR CENTRE

DATE: JAN 16 2016

INITIALS:

### COLORS OF ITALY

Color is an essential expression of Italian exuberance and artistic elegance. Bertazzoni celebrates these special qualities with seven color choices inspired by the wonderful produce of Emilia-Romagna, heartland of Italian food since Roman times.



STAINLESS (X)  
PRO36 6 GAS X



BLACK (NE)  
PRO36 6 GAS NE



WHITE (BI)  
PRO36 6 GAS BI



YELLOW (GI)  
PRO36 6 GAS GI



ORANGE (AR)  
PRO36 6 GAS AR



RED (RO)  
PRO36 6 GAS RO



BURGUNDY (VI)  
PRO36 6 GAS VI

### FEATURES

Gas burners	6
Burner type	brass
Maintop	one piece stainless steel sheet
Burner controls	knobs
Knobs	metal finish
Grates	cast iron
Backguard	standard 4 inches
Gas safety device	thermocouple technology
One hand ignition	standard
Standard accessories	wok ring & simmer plate
Dual Power burner	750 - 18,000 Btu/h
Rapid burner	11,000 Btu/h
Semi-rapid burner	6500 Btu/h
Auxiliary burner	3400 Btu/h
Simmer rate	750 Btu/h
Main oven	gas convection with gas infrared broiler
Main oven functions	traditional bake, gas convection, broil, defrost/dehydrate, sabbath mode
Main oven volume	4.4 ft <sup>3</sup>
Inner oven door	full - width triple glass
Oven equipment	1 telescopic glide shelf, 1 baking tray, 2 heavy gauge wire shelves, 1 grill, trivet for tray
Legs	flap storage compartment, height adjustable stainless steel wrapped legs

### ACCESSORIES

Toe kick plate (TKS 36 X), flat island trim (IR- 36 X), side trim (ST 36 X)

Available LPG version PRO36 6 GAS X LP

A LP conversion kit for all burners is included

### MATCHING VENTILATION SOLUTIONS

Bertazzoni offers a variety of matching ventilation solutions for this range. Please check our website under the ventilation tab for a complete overview of all choices.

### TECHNICAL SPECIFICATIONS

Voltage, frequency	120 V, 60Hz
Max Amp Usage, power rating	1.5 A - 150 W
Certification	CSA
Warranty	2 years parts and labor

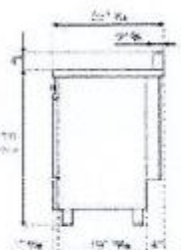
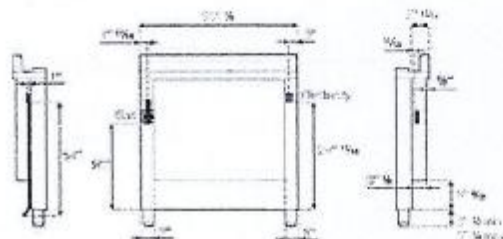
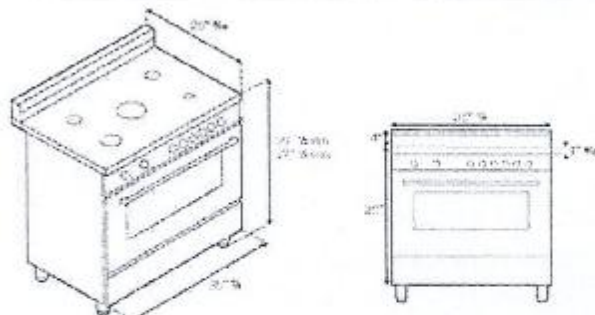

### INSTALLATION INSTRUCTIONS

Bertazzoni recommends to operate the appliance after it has been installed in a cabinet. The kitchen cabinets shall be made of materials capable of withstanding temperatures at least 117°F (65°C) above room temperature in order to avoid possible damage to the cabinets during oven usage. For further installation instructions refer to the installation manual.

Disclaimer: while every effort has been made to ensure the accuracy of the information contained in this brochure, Bertazzoni reserves the right to change any part of this information at any time without notice.

Models Bertazzoni, Bertazzoni and the logo shall stand out as registered trademarks of Bertazzoni S.p.A.

[bertazzoni.com](http://bertazzoni.com)



9130. Lot # 95

## 24" Marvel Beverage Center with Two 60/40 Split Convertible Shelves™

Model # ML24BCG1\*\*



Certified to meet  
ENERGY STAR® requirements

- Dynamic Cooling Technology™ delivers rapid cooldown and the industry's best temperature stability
- 60/40 Split Convertible Shelf™ — cantilevered glass shelving, wine rack with a Vibration Neutralization System™ or both configurations all in one
- Rollout wine storage
- Solid, black-stained maple shelf fronts (natural maple shelf accessories available)
- MARVEL Intuit™ Integrated Controls ensure precise temperature management from 34°F to 42°F
- Thermal-efficient cabinet ensures optimum food preservation and energy efficiency while maximizing capacity
- Tinted, UV-resistant dual pane glass door protects wine from damaging ultra-violet light
- Two-stage, soft white theatre-style LED lighting and midnight black interior
- Cantilevered, fully adjustable shelving system
- Close Door Assist System™ gently and automatically closes door
- Audible and visual alarms signal when door is left ajar to protect food integrity and energy use
- Vacation/Sabbath mode conserves energy during times when the unit is not in use and complies with Star-K requirements
- Height adjustment up to 1" with leveling legs
- 4" black adjustable toe kick
- 1-year warranty



SENATOR HOMES  
DECOR CENTRE  
JAN 18 2016  
DATE: \_\_\_\_\_  
INITIALS: \_\_\_\_\_

Ordering Details	
Stainless Frame Glass Door, Right Hinge	ML24BCG1RS
Stainless Frame Glass Door, Left Hinge	ML24BCG1LS
Panel Overlay Frame Glass Door Integrated Right Hinge	ML24BCF2RP
Panel Overlay Frame Glass Door Integrated Left Hinge	ML24BCF2LP
Panel Overlay Frame Glass Door Integrated Right Hinge	ML24BCP2RP
Panel Overlay Frame Glass Door Integrated Left Hinge	ML24BCP2LP

### Storage Capacity

Up to (162) 12-oz cans or (18) wine bottles

### Storage Configuration

- (2) cantilevered, full-width 60/40 Split Convertible Shelf™ black steel-framed glass shelf
- (1) roller-gl dr 4-bottle wine rack

### Product Dimensions

23 3/4" W x 33 3/4" minimum H x 25 1/2" D (including handle)

### Finish/Door Options

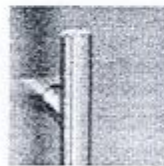

Stainless Steel



Wood Overlay  
(Panel Ready)

9130-LOT# 95

# SENATOR HOMES DECOR CENTRE

DATE: 16/1/2016  
INITIALS: CSO

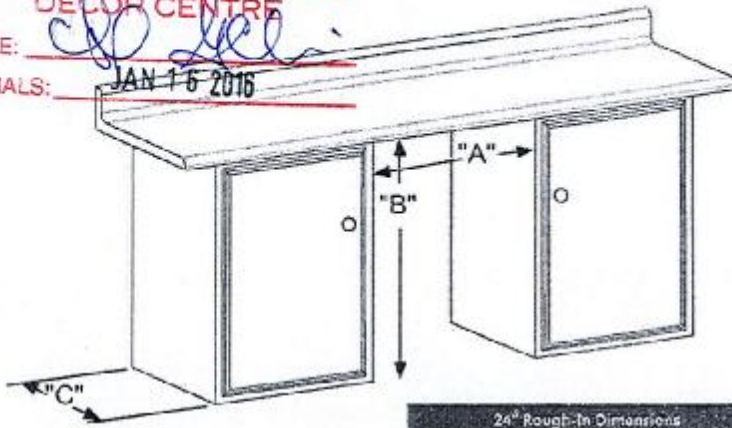

24" Rough-In Dimensions		
"A"	"B"	"C"
24" (610 mm)	34 1/2" to 35 1/2" (880 mm to 902 mm)	24" (610 mm)

Cabinet Dimensions		
"A"	"B"	"C"
24 3/4" (627 mm)	35 1/4" to 36 1/4" (897 mm to 927 mm)	24 3/4" (627 mm)
"D"	"E"	"F"
25 1/2" (649 mm)	47 1/4" to 48 1/4" (1203 mm to 1230 mm)	25 1/2" (649 mm)

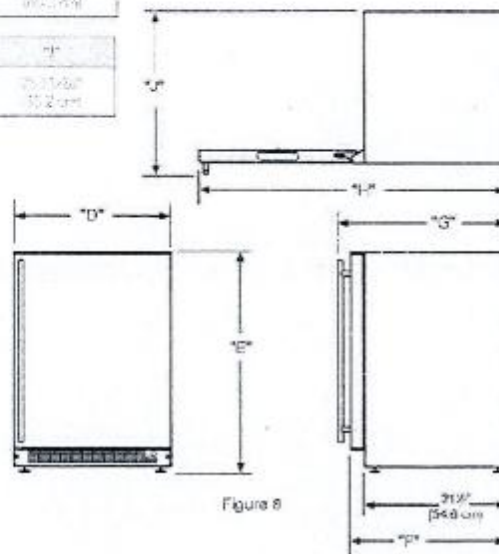
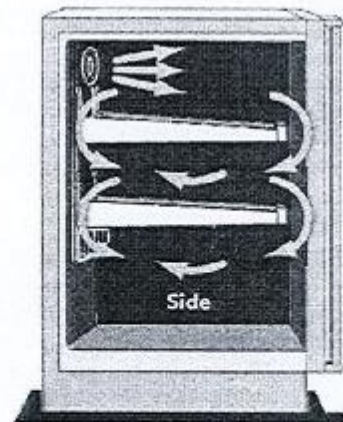
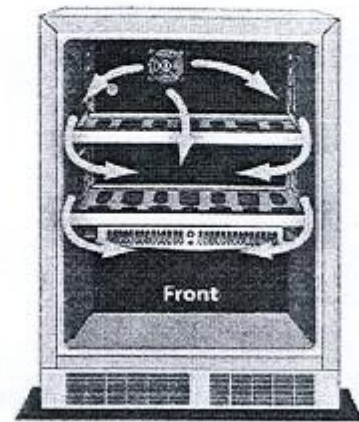

Figure 8

Width	24 3/4"
Interior Finish	Black
Capacity	Up to 12 wine bottles or up to 352 1/2 oz cans
Shelving System	Carbons
Shelf Frosts	Black painted maple
Other Storage	NA
Interior Lighting	4 White LED Frosts
Tox Grill Finish	Black
Hinge	Classic Hinge
Handle	Deakylor

Control Type	Intuit™
Temperature Range	34° - 41°F
Lock	NA
Electrical Requirements	120V / 60 Hz / 15A
Length of Power Cord	5'
Product Dimensions	24 3/4" W x 35 1/4" H x 24 3/4" D
Depth to Front of Door	23 7/8"
Depth to Handle	25 7/8"
Depth with door at 90°	46 7/8"
Shipping Weight	160 lbs



## Dynamic Cooling Technology™ delivers rapid cool down and the industry's best temperature stability

The distinctive Marvel design features a thermal-efficient cabinet and door combined with Dynamic Cooling Technology™ for superior temperature stability, faster cooling times and speedy temperature recovery even with high frequency.

Finish	SS, C
Vacation / Sabbath Mode	Yes
Agency Approvals	CSA
Energy Star Certified	

### Finishes Key

SS = Stainless Steel  
C = Overlay