



CONSTRUCTION SUMMARY

Teefy Developments Limited / 9130 Bathurst

Lot/Unit: 54    Phase/Building: 1    Model/Floor Plan: Riverdale(22-3)

CABINETRY

Inv.3209	1 - KITCHEN - ADDITIONAL BASE & UPPER CABINETS	
Line 44167	Note:	
17Sep15 / 10Dec15		

CABINETRY ACCESSORIES

Inv.3209	1 - KITCHEN - CROWN MOULDING	
Line 40002	Note:	
17Sep15 / 10Dec15		

Inv.3209	1 - KITCHEN - LIGHT VALANCE	
Line 40004	Note:	
17Sep15 / 10Dec15		

CABINETRY APPLIANCE - FRIDGE

Inv.3209	1 - KITCHEN - 60.5 CM FRIDGE CABINET - 2 GABLES    ADJACENT TO PANTRY	
Line 44168	Note:	
17Sep15 / 10Dec15		

CABINETRY BASE CABINETS

Inv.3209	1 - KITCHEN - BANK OF DRAWERS CABINET	
Line 44240	Note:	
17Sep15 / 10Dec15		

Inv.3209	1 - KITCHEN - POTS & PANS DRAWER	
Line 44241	Note:	
17Sep15 / 10Dec15		

CABINETRY HARDWARE

Inv.3209	1 - KITCHEN - CABINET HARDWARE - UPGRADE 2 - DISPLAY BOARD	
Line 40001	Note:	
17Sep15 / 10Dec15		

Inv.3209	4 - VANITY - CABINET HARDWARE - UPGRADE 1 - DISPLAY BOARD	
Line 40000	Note:    THROUGHOUT BATHROOMS	
17Sep15 / 10Dec15		

CABINETRY HOOD FANS

Inv.3209	1 - KITCHEN - ACCOMMODATE FOR CHIMNEY STYLE HOOD FAN	
Line 40017	Note:	
17Sep15 / 10Dec15		

CABINETRY VANITY

Inv.3209	1 - VANITY BANK OF DRAWERS -x1 IN MASTER ENSUITE	
Line 40009	Note:	
17Sep15 / 10Dec15		

CABINETRY WALL AND HUTCH



CONSTRUCTION SUMMARY

Teefy Developments Limited / 9130 Bathurst

Lot/Unit: 54    Phase/Building: 1    Model/Floor Plan: Riverdale(22-3)

Inv.3209	1 - KITCHEN - WIDE UPPER ANGLE CORNER	
Line 44166	Note:	
17Sep15 / 10Dec15		
Inv.3209	1 - KITCHEN CABINETRY UPGRADE - UPPER ANGLE CORNER CABINET	
	-GLASS DOOR CLEAR	
	-MATCHING INTERIOR	
Line 44239	Note:	
17Sep15 / 10Dec15		

CARPET

Inv.3209	1 - CARPET - RECREATION ROOM @ LOWER LEVEL - SUPREME WHITE	
Line 39998	Note:	
17Sep15 / 10Dec15		

DOORS AND WINDOWS

Inv.3209	1 - DOOR INTERIOR - IN LIEU OF STANDARD - INTERIOR FRENCH DOOR 1PC.	
	BEVELLED GLASS - 80 INCHES	
Line 39999	Note: IN LIEU OF THE STD BEDROOM 3 DOOR	
17Sep15 / 10Dec15		

ELECTRICAL

Inv.3209	1 - KITCHEN - SUPPLY AND INSTALL LIGHT VALANCE ROUGH IN (INCLUDES 1 SWITCH)	
Line 40003	Note:	
17Sep15 / 10Dec15		
Inv.3209	1 - SUPPLY AND INSTALL CAPPED CEILING LIGHT ROUGH-IN ONLY ON SEPARATE SINGLE SWITCH	
Line 40011	Note: CENTERED ABOVE ISLAND AS MUCH AS POSSIBLE ADDITIONAL CAPS PURCHASED	
17Sep15 / 10Dec15		
Inv.3209	2 - SUPPLY AND INSTALL CAPPED CEILING LIGHT ROUGH-IN ONLY ON EXISTING SWITCH	
Line 40012	Note: IN KITCHEN ABOVE THE ISLAND	
17Sep15 / 10Dec15		
Inv.3209	1 - KITCHEN - SUPPLY AND INSTALL ADDITIONAL INTERIOR RECEPTACLE (NOT SEPARATE CIRCUIT)	
	-FOR BUILT-IN MICROWAVE	
Line 40014	Note: IN KITCHEN FOR BUILT-IN MICRO	
17Sep15 / 10Dec15		
Inv.3209	1 - SUPPLY AND INSTALL ADDITIONAL INTERIOR RECEPTACLE (NOT SEPARATE CIRCUIT)	
	-APPROX 5.5FT FROM THE FLOOR CLOSER TO THE END OF THE FIREPLACE FOR FUTURE WALL MOUNT T.V STAND	
Line 40022	Note:	
17Sep15 / 10Dec15		

HEATING AND AIR CONDITIONING

Inv.3209	1 - GAS LINE - ROUGH-IN ONLY - FIRST CONNECTION- FOR BBQ	
Line 40020	Note: LOCATION AS INDICATED ON SKETCH	
17Sep15 / 10Dec15		



CONSTRUCTION SUMMARY

Teefy Developments Limited / 9130 Bathurst

Lot/Unit: 54    Phase/Building: 1    Model/Floor Plan: Riverdale(22-3)

MISCELLANEOUS

PAINT AND DRYWALL

Inv.3209	1 - NEWLY ADDED - FIREPLACE WALL FURR OUT - AT APPROX 6FT WIDE x 10" DEEP, FLOOR TO CEILING *** WALL TO BE REINFORCED FOR FUTURE TV WALL MOUNT -BASE OF FIREPLACE TO BE APPROX. 18" FROM THE FLOOR	
Line 40005	Note:	
17Sep15 / 10Dec15		

PLUMBING

Inv.3209	1 - KITCHEN - SUPPLY AND INSTALL WATERLINE ROUGH-IN TO THE FRIDGE LOCATION (NO HOOK UP)	
Line 40007	Note:	
17Sep15 / 10Dec15		
Inv.3209	2 - TOILET - MAIN BATH & POWDER ROOM - GERBER MAXWELL 2PC TOILET MODEL 21928/28990	
Line 40015	Note:	
17Sep15 / 10Dec15		
Inv.3209	1 - MASTER ENSUITE - SHOWER TRENCH DRAIN	
Line 40019	Note:	
17Sep15 / 10Dec15		
Inv.3209	1 - TOILET - MASTER ENSUITE - CONTRAC CAYLA 2PC TOILET MODEL 4782BOV/4781BOVU	
Line 40016	Note:	
17Sep15 / 10Dec15		

TILE - FLOOR

Inv.3209	1 - SUPPLY AND INSTALL FLOOR TILE - UPGRADE 3 - - VESTIBULE FLOOR	
Line 40025	Note:	
17Sep15 / 10Dec15		
Inv.3209	1 - SUPPLY AND INSTALL FLOOR TILE - UPGRADE 3 - - MUD ROOM IN BASEMENT (ON CONCRETE)	
Line 40024	Note:	
17Sep15 / 10Dec15		
Inv.3209	1 - SUPPLY AND INSTALL FLOOR TILE - UPGRADE 3 - - ENSUITE BATHROOM FLOOR	
Line 43507	Note:	
17Sep15 / 10Dec15		



CONSTRUCTION SUMMARY

Teefy Developments Limited / 9130 Bathurst

Lot/Unit: 54    Phase/Building: 1    Model/Floor Plan: Riverdale(22-3)

EXTRAS AS PER OFFER

The Vendor to Supply & INSTALL - Stainless Steel Fridge, Stove and Dishwasher and front loading washer and dryer in white from Vendors standard samples, no cash value, not transferable. ** To arrange delivery call: The Brick commercial sales division <i>Worksheet</i> Note:	
Rogers Free Services Package includes 6 months of: home phone, TV and Internet Service. <i>Worksheet</i> Note:	
The Vendor agrees to supply and install hardwood flooring in all bedrooms, with a choice of stain, from Vendors standard samples. <i>Worksheet</i> Note:	
Vendor to supply and install Optional Elevator, as per plan, from Vendors standard samples. \$40,000 has been added to the purchase price for this option . <i>Worksheet</i> Note:	
The Vendor agrees to supply and install 3 additional cable and telephone outlets in room to be determined by the purchaser at their decor appointment. From vendors standard samples. This amount has no cash value and is non-negotiable. <i>Worksheet</i> Note:	



## INTERIOR COLOUR SCHEME

NOTE: This is not an approved document. Document must be locked \*\*\*

Purchaser: Ian C Glass  
Telephone Res. / Bus: (547) 638-4282 /  
Decor Advisor: Nicole Soares

Property: 54 of Plan -  
Project: Teely Developments Limited  
Model and Elevation: Riverdale(22-3)

Layout Changes: ☒ Yes ☐ NoSketch Attached: ☒ Yes ☐ No

Exterior Colour Scheme:

## 1. Cabinetry

	Style and Colour	Counter Top	Hardware
Kitchen / Breakfast	HUMBER: WHITE SUGAR	GRIGIO SARDO - SQ EDGE	12829
Kitchen Island	HUMBER: WHITE SUGAR	GRIGIO SARDO - SQ EDGE	12829
Laundry Room	MUSKOKA: ONTARIO WHITE	N/A	9677
Powder Room	HUMBER: COFFEE BEAN	BLACKSTAR GRANITE4551K-52	96650
Main Bathroom	HUMBER: COFFEE BEAN	BLACKSTAR GRANITE4551K-52	96650
Master Ensuite Bathroom	HUMBER: COFFEE BEAN	MADURA PEARL 4922K-52	96650
Second Ensuite Bathroom (If Applicable)			
Lower Level	HUMBER: COFFEE BEAN	BLACKSTAR GRANITE4551K-52	96650

## Appliances

Custom Size Fridge

☐ Yes ☒ No

Valance Lighting

☒ Yes ☐ No

Microwave / Range Hood

☒ Yes ☐ No

Cooktop / Rangenop

☐ Yes ☒ No

Built in Wall Oven

☐ Yes ☒ No

Slide-in Range

☒ Yes ☐ No

Comment

## -2. Flooring

	Selection
Foyer	PALAIS 12x24: WHITE
Main Hall	SATIN FINISH GEN HOME 3 5/8" x 3/4": GRAPHITE
Back Hall	
Breakfast	
Laundry Room	NEW REEDS 13x13: SILVER
Kitchen	SATIN FINISH GEN HOME 3 5/8" x 3/4": GRAPHITE
Powder Room	NEW REEDS 13x13: SILVER
Main Bathroom	NEW REEDS 13x13: SILVER
Master Ensuite	PALAIS 12x24: WHITE
Bathroom (If Applicable)	LOWER LEVEL- NEW REEDS 13x13: SILVER
Mud Room	PALAIS 12x24: WHITE
Formal Room	SATIN FINISH GEN HOME 3 5/8" x 3/4": GRAPHITE
Living Room	
Dining Room	
Family / Great Room	SATIN FINISH GEN HOME 3 5/8" x 3/4": GRAPHITE
Den / Library / Study	
Basement Landing (If Applies)	
Lower Landing (If Applicable)	
Upper Landing	SATIN FINISH GEN HOME 3 5/8" x 3/4": GRAPHITE
Upper Hall	SATIN FINISH GEN HOME 3 5/8" x 3/4": GRAPHITE
Master Bedroom	SATIN FINISH GEN HOME 3 5/8" x 3/4": GRAPHITE
Bedroom #2	SATIN FINISH GEN HOME 3 5/8" x 3/4": GRAPHITE
Bedroom #3	SATIN FINISH GEN HOME 3 5/8" x 3/4": GRAPHITE
Bedroom #4	SATIN FINISH GEN HOME 3 5/8" x 3/4": GRAPHITE
Bedroom #5	
Recreation Room	PAPILIO: NEWFOUNDLANDSAND 18674

Flooring Continued on Page 2

Printed 11/25/2015 11:22:52

Initial:

Page 1 of 3





# INTERIOR COLOUR SCHEME

Purchaser: Ian C Glass  
Telephone Res. / Bus: (647) 638-4282 /  
Decor Advisor: Nicole Soares

Property: 54 of Plan -  
Project: Teefy Developments Limited  
Model and Elevation: Riverdale(22-3)

## 2. Flooring - Continued -

Upgrade Underpad	Type SUPREME WHITE	Area RECREATION ROOM
Carpet on Stairs	Capped	Runner - *Upgrade
Comment		

## 3. Plumbing Fixtures / Faucets

Kitchen	STD	Second Ensuite		Powder Room	STD
Master Ensuite	STD			Other Room	
Main Bathroom	STD	Lower Level Bath	STD		
Comment					

## 4. Wall Tile

	Tile Selection	Listello	Insert	Insert Selection
Main Bathroom	NEW REEDS 8x10: SILVER ✓	<input type="checkbox"/>	<input type="checkbox"/>	
Master Ensuite		<input type="checkbox"/>	<input type="checkbox"/>	
Tub Deck		<input type="checkbox"/>	<input type="checkbox"/>	
Tub Apron		<input type="checkbox"/>	<input type="checkbox"/>	
Tub Surround		<input type="checkbox"/>	<input type="checkbox"/>	
Shower Stall	REFLECTIONS 8x10: ESPRESSO	<input type="checkbox"/>	<input type="checkbox"/>	
Second Ensuite		<input type="checkbox"/>	<input type="checkbox"/>	
Ensuite Shower Floor	ONTARIO 2x2 MOSAICS: TENDER GREY ✓	<input type="checkbox"/>	<input type="checkbox"/>	
Lower Level	NEW REEDS 8x10: SILVER ✓	<input type="checkbox"/>	<input type="checkbox"/>	
Kitchen Backsplash		<input type="checkbox"/>	<input type="checkbox"/>	
Complete Backsplash		<input type="checkbox"/>	<input type="checkbox"/>	
Comment				

## 5. Fireplace

	Living Room			Family Room			Other Room - Specify		
	Purchased	As Per Plan	N/A	Purchased	As Per Plan	N/A	Purchased	As Per Plan	N/A
Fireplace Type	<input type="radio"/>	<input type="radio"/>	<input type="radio"/>	<input type="radio"/>	<input checked="" type="radio"/>	<input type="radio"/>	<input type="radio"/>	<input type="radio"/>	<input type="radio"/>
Mantle Type				50" ELECTRIC LINEAR					
Over Mantle									
Colour / Stain									
Surround									
Hearth									
Comment	FIREPLACE WALL TO BE FURRED OUT								



## INTERIOR COLOUR SCHEME

Purchaser: Ian C Glass  
Telephone Res. / Bus: (647) 638-4282 /  
Decor Advisor: Nicole Soares

Property: 54 of Plan -  
Project: Teety Developments Limited  
Model and Elevation: Riverdale(22-3)

6. Trim Carpentry

Door Hardware: STD LEVER

Interior Trim: STANDARD BASEBOARD & CASING

Comment: BEDROOM 3 - DOOR INTERIOR - IN LIEU OF STANDARD - INTERIOR FRENCH DOOR 1PC. BEVELLED GLASS - 80 INCHES

Interior Doors:

☐ 2 Panel Arch Top

☒ 2 Panel Square Top

☐ 6 Panel

Initial for Door Style: \_\_\_\_\_

7. Railings and Pickets

Railing Package: \_\_\_\_\_

Railing Colour: STAINED TO MATCH

Wood Stairs: ☐ No ☒ Oak

Picket Colour: BLACK METAL PICKETS

Tread Colour: STAINED TO MATCH

Comment: STAIRS TO BE STAINED TO MATCH SATIN FINISH GEN HOME 3 5/8" x 3/4" GRAPHITE AS MUCH AS POSSIBLE PURCHASER IS AWARE THAT THE STAIN WILL NOT BE A 100% TRUE MATCH

8. Plaster Mouldings and Medallions

Foyer			Kitchen/Breakfast		
Main Hall			Den/Library		
Living Room			Lower Landing		
Dining Room					
Family Room					

Comment: \_\_\_\_\_

9. Wall Paint

SENATOR HOMES

Smooth Ceilings: ☐ First Floor

☐ First Floor incl. Second Floor Hall

☐ First and Second Floor

☒ Throughout

☐ Not Applicable

Trim Paint: SENATOR HOMES

10. Additional Comments

\_\_\_\_\_

11. Disclaimers and Notes

1) Colours of all materials are as close as possible to builder's selection, but not necessarily identical due to variances in manufacturing.

2) Any extras listed above are null and void unless accompanied by a separate invoice/amendment. Said invoice must be paid in full.

3) The Purchaser acknowledges that after Interior Colour Selection form is signed and dated, no further changes will be permitted other than re-selection due to unavailability. \_\_\_\_\_ Purchaser's Initials

4) The Purchaser acknowledges reading and accepting the "Senator Homes Decor Centre Disclaimers" form. This document contains other miscellaneous disclaimers.

This Interior Colour Selection is final and approved by:

Purchaser Signature: \_\_\_\_\_ Date: Jan 14/16

Vendor: \_\_\_\_\_ Teety Developments Limited

Jan 21, 16



9130-54

# RIVERDALE

OPTIONAL ELEVATOR PLAN

2454 SQ.FT.

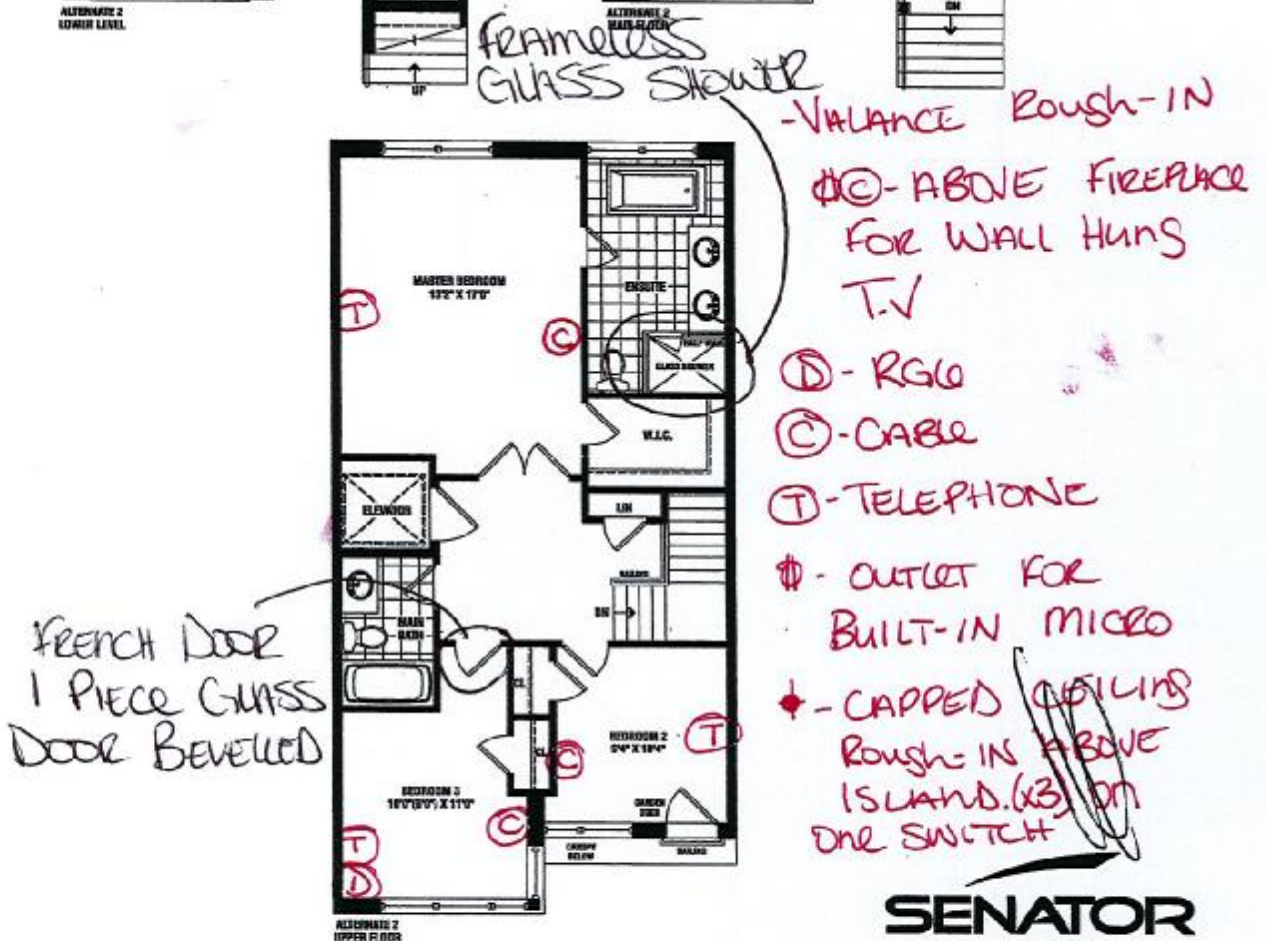
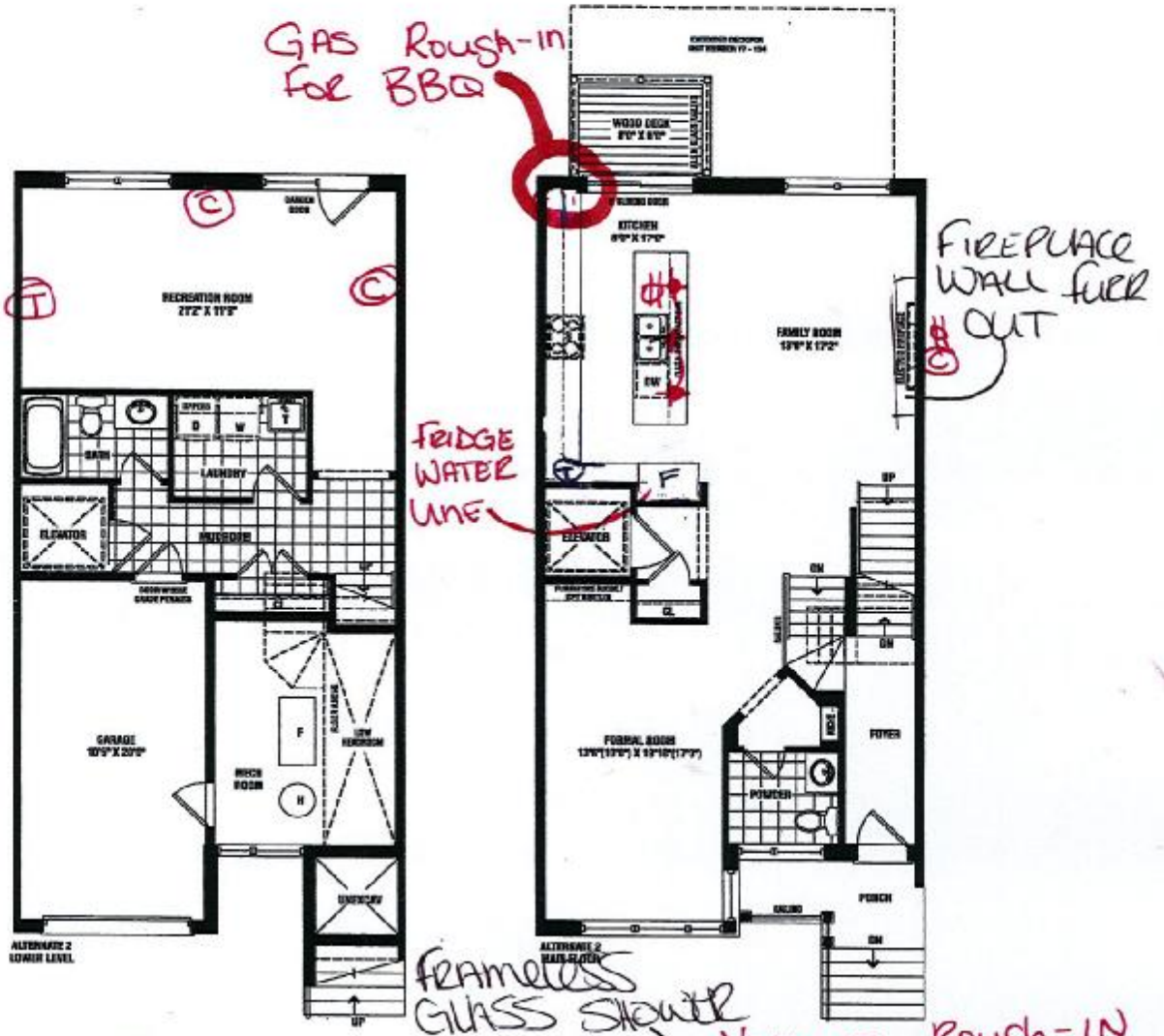

**SENATOR**  
HOMES

Drawings are artist's concept. Some elevations may vary from that shown. Actual useable square footage may vary from that stated herein. Some floorplans and elevations are mirror image to that shown. E&O.E. 22-3

**SENATOR HOMES**  
DECOR CENTRE

DATE: DEC 10 2015  
INITIALS:



9130-54

DECEMBER 7, 2015



Tel: (905) 670-7818  
Fax: (905) 670-1986  
www.frendel.com

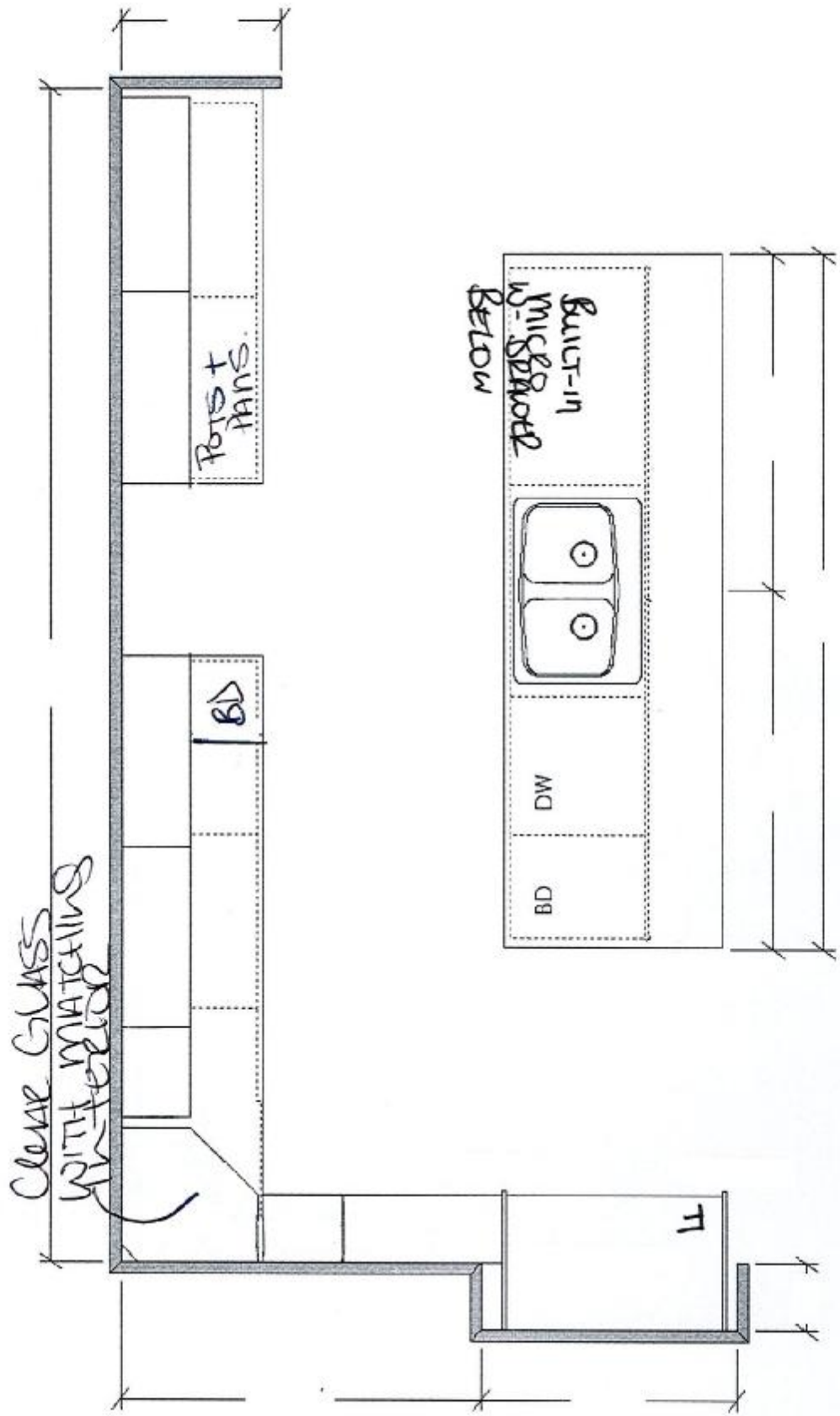

SENATOR HOMES  
DECOR CENTRE  
DATE: DEC 10 2015  
INITIALS: [Signature]

SENATOR HOMES  
TEEFY DEV  
LOT 54 (RIVERDALE OPT. ELEVATOR PLAN – TH-22-3)



**FRENDEL**  
KITCHENS LIMITED  
1350 Shawson Drive, Mississauga, ON L4W 1C5

Tel: (905) 670-7858  
Fax: (905) 670-1986  
www.frendel.com

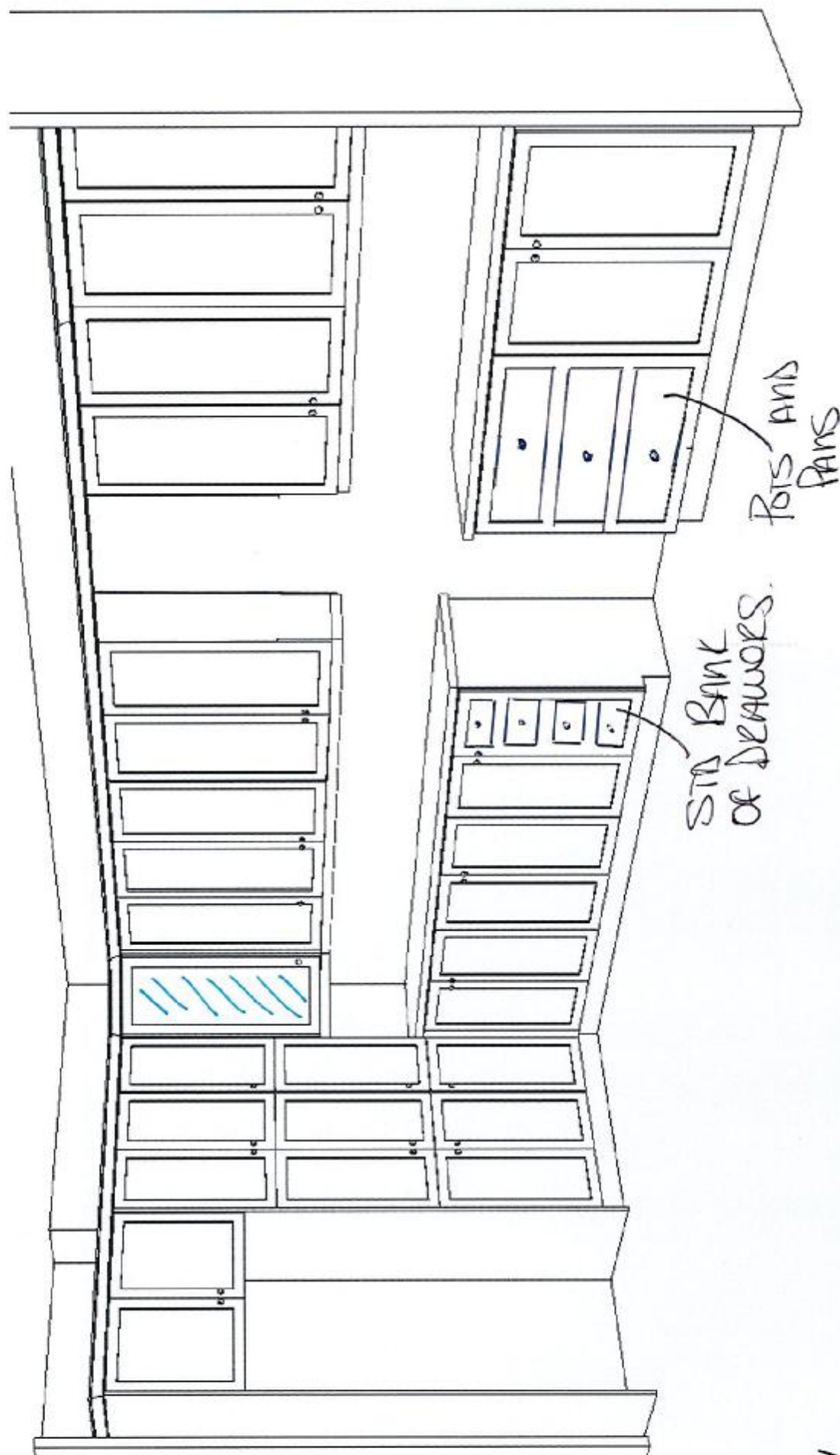

**SENATOR HOMES  
DECOR CENTRE**

DATE: DEC 10 2015  
INITIALS: *[Signature]*

SENATOR  
TEEFY DEV  
LOT 54 (RIVERDALE OPT. ELEVATOR PLAN - TH-22-3)

9130-54

DECEMBER 7, 2015



FRENDEL

KITCHENS LIMITED

1350 Shawan Drive, Mississauga, ON L4W 1C5

Tel: (905) 670-1893  
Fax: (905) 670-1986  
www.frendel.com

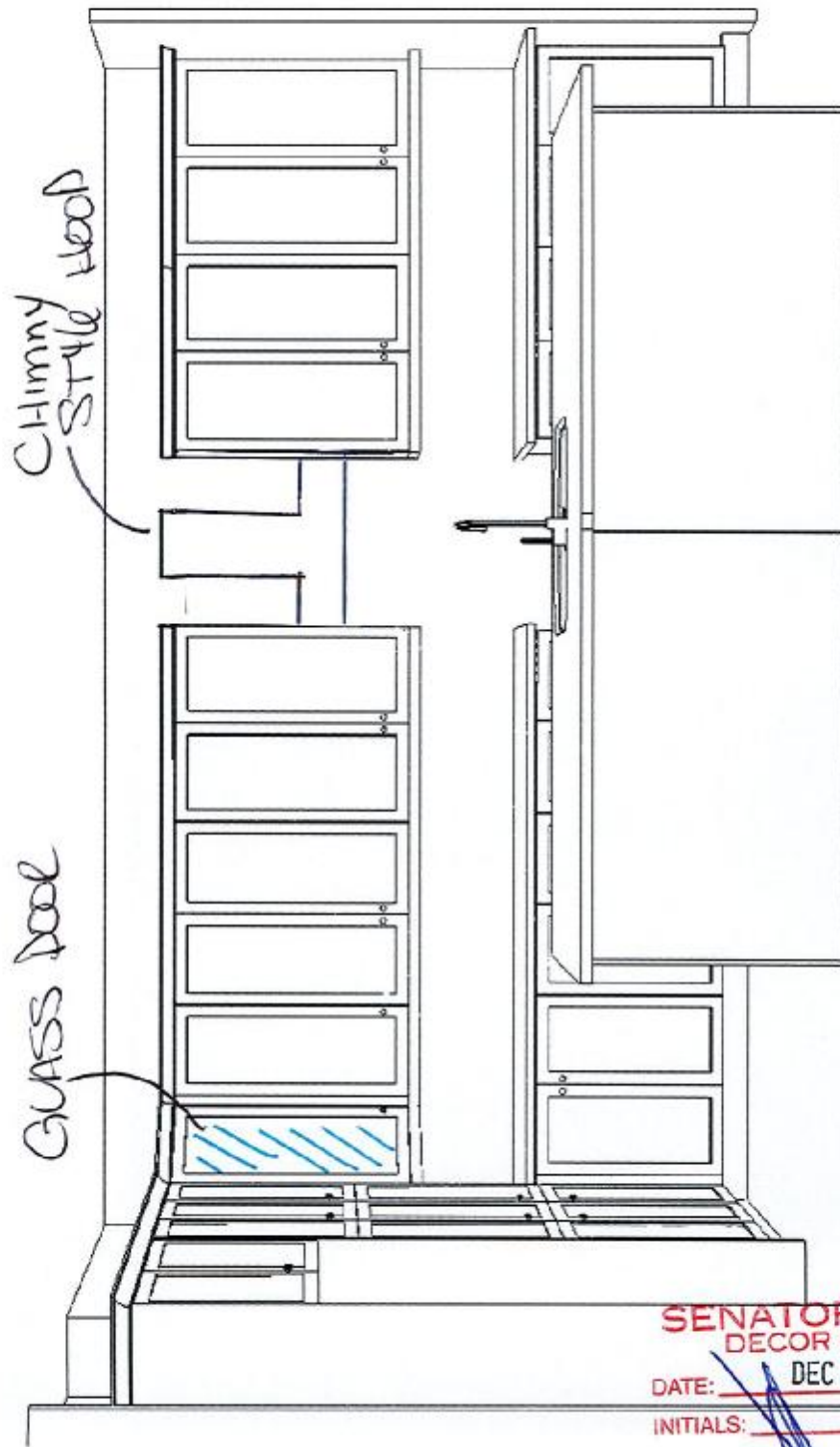

CHIMNEY  
STYLE HOOD

GLASS DOOR

9130-54



BUILT-IN  
MICRO

SENATOR HOME  
DECOR CENTRE

DATE: DEC 10 2015

INITIALS:

SENATOR HOMES

TEEFY DEV

LOT 54 (RIVERDALE OPT. ELEVATOR PLAN -- TH-22-3)

DECEMBER 7, 2015



9130 BATHURST LOT # 54

# 36" Counter-Depth French Door Refrigerator

800 Series - Stainless Steel B22CT80SNS

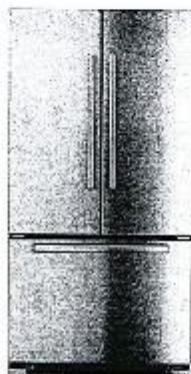

**B22CT80SNS**  
Stainless Steel

This 72" counter-depth French Door refrigerator installs nearly flush and features LED lighting for easier viewing.

## Features & Benefits

The internal water dispenser delivers filtered and chilled water.

72" height fills refrigerator cutout precisely, with no unsightly gap.

Clean exterior design for a perfect built-in look.

The LED lighting shines exceptionally bright and saves energy.

Spill-proof glass shelves prevent liquids from running off shelves.

## General Properties

Water filter	Yes
Lighting	LED
Defrost process refrigerator section	Frost-free
Number of shelves - refrigerator	5
Adjustable shelves - refrigerator	4 half-width
Shelf material - refrigerator	Tempered glass
Type of shelves - refrigerator	Spill-proof glass
Gallon storage bins	2
Humidity control drawer	2
Defrost process freezer section	Automatic
Number of drawers - freezer	3
Ice maker	Yes
Quick ice	No

## Capacity

Total unit gross capacity (cu. ft.) - AHAM	21.8 cu. ft.
Refrigerator gross capacity (cu. ft.)	15.27 cu. ft.
Freezer gross capacity (cu. ft.)	5.52 cu. ft.



## Technical Details

Current (A)	15 A
Volts (V)	120 V
Frequency (Hz)	60 Hz
Power cord length (in.)	62
Plug type	120V-3 prong

## Dimensions & Weight

Appliance dimensions (H x W x D) (in.)	71 7/8" x 35 5/8" x 30 1/8"
Required cutout size (H x W x D) (in.)	72" x 36" x 25 5/8"
Net weight (lbs)	345 lbs

## Efficiency

ENERGY STAR® qualified	No
Energy consumption (kWh/yr)	633 kWh

## Accessories-Included

Included	Ice scoop
----------	-----------

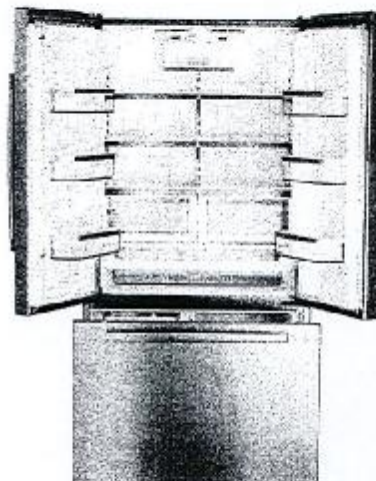

For help and assistance with Bosch accessories please visit: [www.bosch-eshop.com/eshop/Bosch/us](http://www.bosch-eshop.com/eshop/Bosch/us) or call 1-800-944-2504 Mon-Fri 9am to 6pm PST Sat 9am to 3pm PST

Notes: All height, width and depth dimensions are shown in inches. Please refer to installation instructions prior to making cutout. BSH reserves the absolute and unrestricted right to change product materials and specifications, at any time, without notice. Consult the product's installation instructions for final dimensions, data and other details. Applicable product warranty can be found in accompanying product literature or you may contact your account manager for further details.

Warranties: Bosch warrants that the Product is free from defects in materials and workmanship for a period of three hundred and sixty-five (365) days from the date of purchase. The foregoing timeline begins to run upon the date of purchase, and shall not be stalled, tolled, extended, or suspended, for any reason whatsoever. This Product is also warranted to be free from cosmetic defects in material and workmanship (such as scratches of stainless steel, paint/porcelain blemishes, chip, dents, or other damage to the finish of the Product, for a period of thirty (30) days from the date of purchase or closing date for new construction. This cosmetic warranty excludes slight color variations due to inherent differences in painted and porcelain parts, as well as differences caused by kitchen lighting, product location, or other similar factors. This cosmetic warranty specifically excludes any display, floor, "As Is", or "B" stock appliances.

For more information on our entire line of products, go to [www.bosch-home.com/us](http://www.bosch-home.com/us) or call 1-800-944-2504

© BSH Home Appliances Corporation. All rights reserved. Bosch is a registered trademark of Robert Bosch GmbH.

**SENATOR HOMES  
DECOR CENTRE**

DATE: Dec 10 2015  
INITIALS: [Signature]

9130-54

# 36" Counter-Depth French Door Refrigerator

800 Series - Stainless Steel B22CT80SNS



## Installation Details

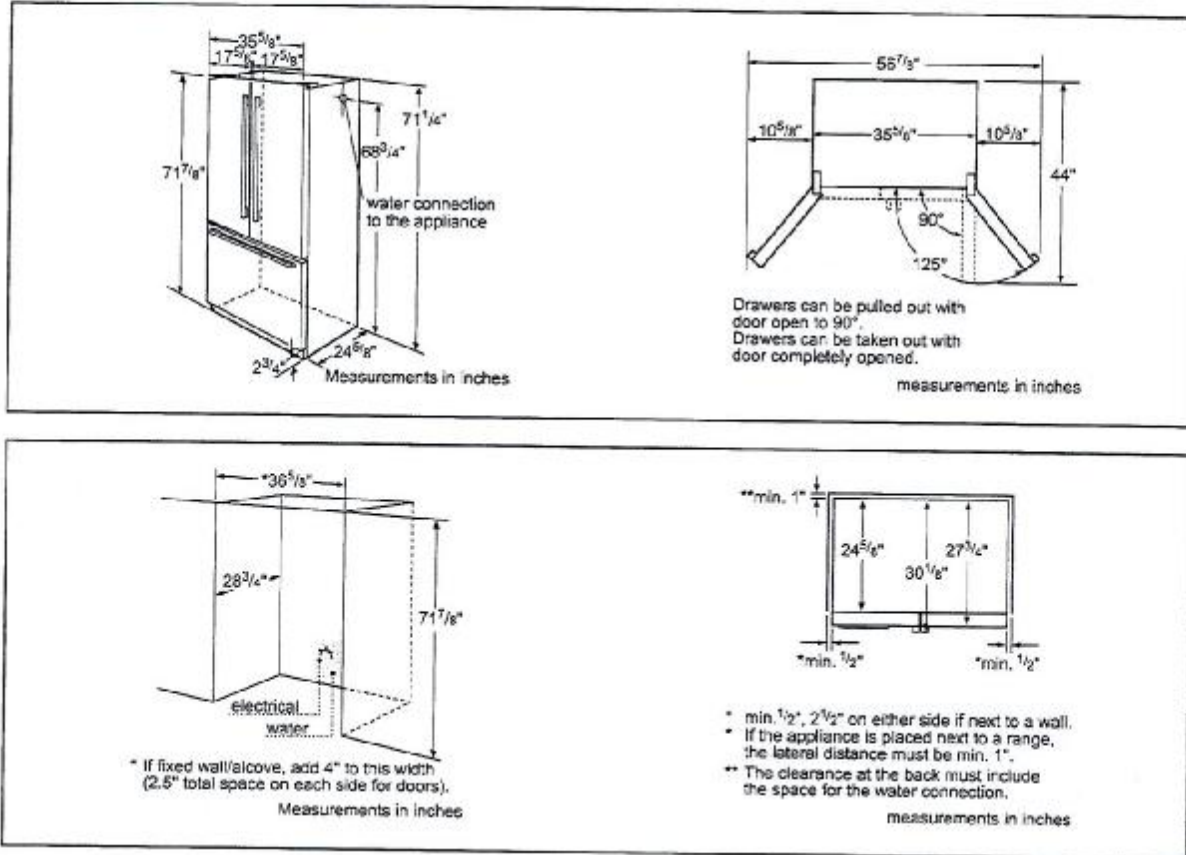

For help and assistance with Bosch accessories please visit: [www.bosch-es-shop.com/cshop/bosch/us](http://www.bosch-es-shop.com/cshop/bosch/us) or call 1-800-944-2964 Mon-Fri 9am to 6pm PST Sat 9am to 3pm PST

Notes: All height, width and depth dimensions are shown in inches. Please refer to installation instructions prior to making cutout. BSH reserves the absolute and unrestricted right to change product materials and specifications, at any time, without notice. Consult the product's installation instructions for final dimensional data and other details. Applicable product warranty can be found in accompanying product literature or you may contact your account manager for further details.

Warranty: Bosch warrants that the Product is free from defects in materials and workmanship for a period of three hundred and sixty-five (365) days from the date of purchase. The foregoing timeline begins to run upon the date of purchase, and shall not be altered, tolled, extended, or suspended, for any reason whatsoever. This Product is also warranted to be free from cosmetic defects in material and workmanship (such as scratches of stainless steel, paint/porcelain blemishes, chip, dents, or other damage to the finish of the Product, for a period of thirty (30) days from the date of purchase or closing date for new construction. This cosmetic warranty excludes slight color variations due to inherent differences in painted and porcelain parts, as well as differences caused by kitchen lighting, product location, or other similar factors. This cosmetic warranty specifically excludes any display, floor, "As Is", or "B" stock appliances.

For more information on our entire line of products, go to [www.bosch-home.com/us](http://www.bosch-home.com/us) or call 1-800-944-2964

© BSH Home Appliances Corporation. All rights reserved. Bosch is a registered trademark of Robert Bosch GmbH.

SENATOR HOMES  
DECOR CENTRE

DATE: DEC 10 2015  
INITIALS: [Signature]



9130-54

# 30" Electric Slide-in Range

800 Series - Stainless Steel HE18054C



**HE18054U**  
Stainless Steel

The newly designed full-depth electric slide-in range fits into any freestanding range cutout, and offers a flush built-in look.

## Features & Benefits

The new Bosch slide-in range fits in any freestanding range cutout.

Cook with a 6" or a 9" element.

At 4.6 cu. ft., a large oven capacity accommodates most pots and pans.

Genuine European convection for even baking results on multiple levels.

The warming drawer keeps everything you cook warm and ready to serve.

## General Properties

Cooking modes	Variable Broil (hi & low), Roast, Warm, Proof, Convection Bake, Convection Broil, Convection Roast, Pizza, True Convection/Convection Multi-Rack, Fast Preheat, Sabbath
Cleaning type	Self clean
Knob material	Full metal
Drawer type	Warming drawer

## Oven Performance

Bake element watts (W)	2,400 W
Broil element watts (W)	3,800 W
Convection element watts (W)	2,000 W

## Element Performance

Total number of cooktop elements	5
Power of front left element watts (W)	1,400 / 3,000 W
Power of back left element watts (W)	1,200 W
Power of centre element watts (W)	100 W
Power of back right element watts (W)	1,200 W
Power of front right element watts (W)	1,100 / 3,200 W



## Element Size

Dimension of front left heating element	6" / 9"
Dimension of back left heating element	6"
Dimension of centre heating element	6"
Dimension of back right heating element	6"
Dimension of front right heating element	9.5"

## Technical Details

Watts (W)	13,800 W
Circuit breaker (A)	40 A
Volts (V)	240 V
Frequency (Hz)	60 Hz
Plug type	N/A
Cord length	N/A
Energy source	Electric

## Dimensions & Weight

Overall appliance dimensions (HxWxD) (in.)	36 1/2" x 31 1/2" x 28 7/8"
Required cutout size (HxWxD) (in.)	35 1/2" x 30" x 25"
Adjustable range height (in.)	1 1/2"
Net weight (lbs)	248 lbs

## Accessories-Included

Use and care manual, installation guide, mounting hardware, island trim, standard racks

## Accessories-Optional



**HEZTR301**  
30" Telescopic rack



**HEZBS301**  
Low backguard

For help and assistance with Bosch accessories please call 1-800-944-2994 Mon-Fri 8am to 6pm EST

Notes: All height, width and depth dimensions are shown in inches. Please refer to installation instructions prior to making cutout. BSH reserves the absolute and unrestricted right to change product materials and specifications, at any time, without notice. Consult the product's installation instructions for final dimensional data and other details. Applicable product warranty can be found in accompanying product literature or you may contact your account manager for further details.

Warranties: Bosch warrants that the Product is free from defects in materials and workmanship for a period of three hundred and sixty-five (365) days from the date of purchase. The foregoing timeline begins to run upon the date of purchase, and shall not be stalled, extended, or suspended, for any reason whatsoever. This Product is also warranted to be free from cosmetic defects in material and workmanship (such as scratches of stainless steel, paint/porcelain blemishes, chip, dents, or other damage to the finish of the Product) for a period of thirty (30) days from the date of purchase or closing date for new construction. This cosmetic warranty excludes slight colour variations due to inherent differences in painted and porcelain parts, as well as differences caused by kitchen lighting, product location, or other similar factors. This cosmetic warranty specifically excludes any display, floor, "As Is", or "B" stock appliances.

For more information on our entire line of products, go to [www.bosch-home.ca](http://www.bosch-home.ca) or call 1-800-944-2994

© 2014 BSH Home Appliances Canada. All rights reserved. Bosch is a registered trademark of Robert Bosch GmbH.

**SENATOR HOMES**  
**DECOR CENTRE**

DATE: DEC 10 2015  
INITIALS: [Signature]



# 30" Electric Slide-in Range

800 Series - Stainless Steel HE18054C

9130-54



## Installation Details

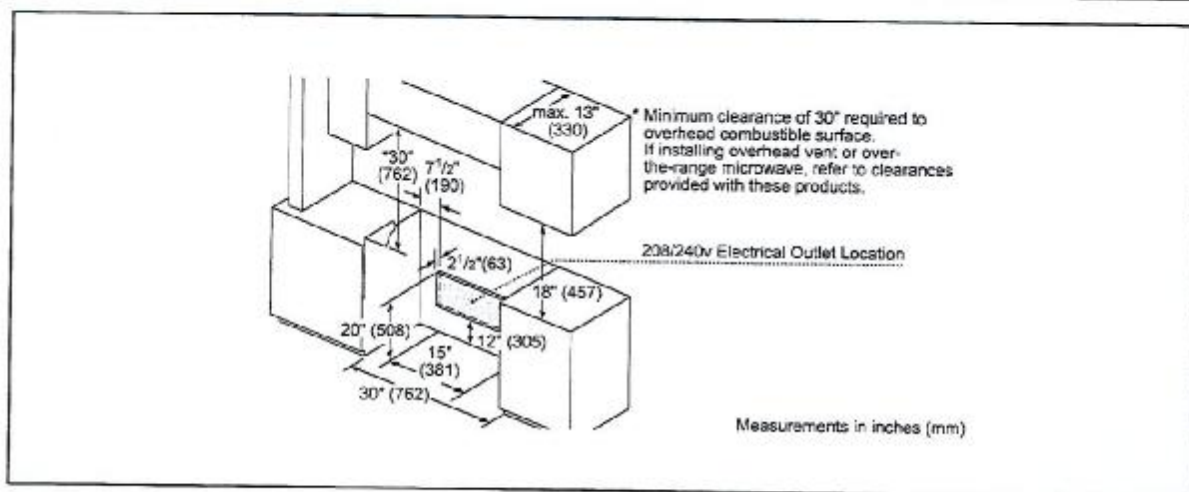
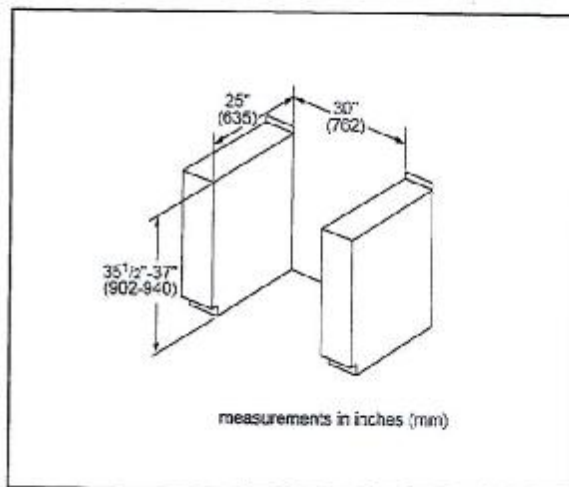
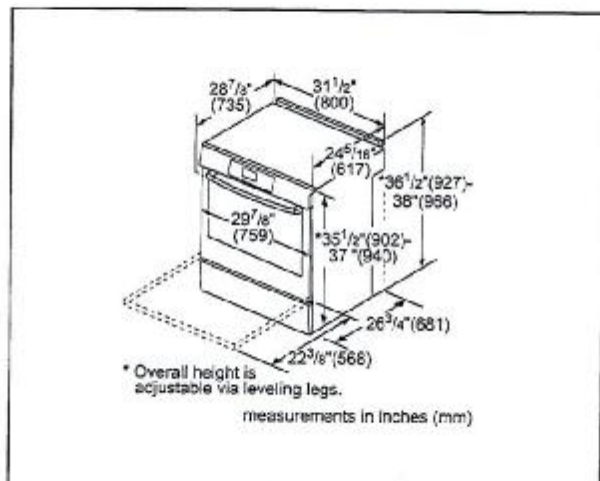

For help and assistance with Bosch accessories please call 1-800-944-2904 Mon-Fri 8am to 6pm EST

Notes: All height, width and depth dimensions are shown in inches. Please refer to installation instructions prior to making cutout. BSH reserves the absolute and unrestricted right to change product materials and specifications, at any time, without notice. Consult the product's installation instructions for final dimensional data and other details. Applicable product warranty can be found in accompanying product literature or you may contact your account manager for further details.

Warranty: Bosch warrants that the Product is free from defects in materials and workmanship for a period of three hundred and sixty-five (365) days from the date of purchase. The foregoing timeline begins to run upon the date of purchase, and shall not be abated, tolled, extended, or suspended, for any reason whatsoever. This Product is also warranted to be free from cosmetic defects in material and workmanship (such as scratches of stainless steel, paint/porcelain blemishes, chip, dents, or other damage to the finish of the Product) for a period of thirty (30) days from the date of purchase or closing date for new construction. This cosmetic warranty excludes slight colour variations due to inherent differences in painted and porcelain parts, as well as differences caused by kitchen lighting, product location, or other similar factors. This cosmetic warranty specifically excludes any display, floor, "As Is", or "D" stock appliances.

For more information on our entire line of products, go to [www.bosch-home.ca](http://www.bosch-home.ca) or call 1-800-944-2904

© 2014 BSH Home Appliances Canada. All rights reserved. Bosch is a registered trademark of Robert Bosch GmbH.

SENATOR HOMES  
DECOR CENTRE

DATE:

DEC 10 2015

INITIALS:

# 24" Bar Handle Dishwasher

300 Series DLX - Stainless Steel SHX53T5UC

9130-54



**SHX53T5UC**  
Stainless Steel

Bosch dishwashers are so quiet, you may forget they're on. InfoLight® projects a red light onto the floor to let you know it's on.

## Features & Benefits

46 dBA: Quietest dishwasher brand.

InfoLight® shines on the floor so you know the dishwasher's running.

RackMatic® offers 3 height levels, for 9 possible rack positions.

Detergent tray optimizes detergent dissolving.

AcquaStop® leak protection works 24/7 to prevent water damage.

## General Properties

Number of wash cycles	4
Number of options	5
dBA	46
Third rack	
Rack adjustability	RackMatic®
Tub material	Stainless steel
Control type	Buttons
Concealed heating element	Yes
Leak protection system	24/7 AcquaStop®
Water softener	No
Five-level wash	Yes
ChildLock	No
Special features	InfoLight®, Duo-Flex Silverware Basket, SpeedPerfect™

## Efficiency

Water usage per cycle	2.9
Energy efficiency class	Tier 1
ENERGY STAR® qualified	Yes
Total annual energy consumption (kWh)	259
Total annual water consumption (g)	624

## Capacity

Number of place settings	15
--------------------------	----



## Technical Details

Watts (W)	1300 W
Current (A)	12 Amps
Volts (V)	120 V
Frequency (Hz)	60 Hz
Power cord length	56 5/16"
Minimum water pressure (lb/sin)	14
Length inlet hose (in)	60"
Length outlet hose (in)	79"

## Dimensions & Weight

Overall appliance dimensions (HxWxD) (in)	33 7/8" x 23 9/16" x 23 3/4"
Required cutout size (HxWxD) (in)	33 7/8" x 23 5/8" x 24"
Adjustable feet	Yes
Net weight (lbs)	84 lbs

## Accessories—Optional

Dishwasher Supply and Drainage Hose Extension 75 3/4"	SGZ1010UC
Dishwasher 3-Prong Power Cord 66 7/8"	SMZPC002UC
Dishwasher Accessory Kit	SMZ5000
Anti-tarnish Silverware Cassette	SMZ5002UC



For help and assistance with Bosch accessories please visit [www.bosch-eshop.com/eshop/bosch/us](http://www.bosch-eshop.com/eshop/bosch/us) or call 1-800-944-2904 Mon-Fri 9am to 6pm PST Sat 9am to 3pm PST

Notes: All height, width and depth dimensions are shown in inches. Please refer to installation instructions prior to making cutout. BSH reserves the absolute and unrestricted right to change product materials and specifications, at any time, without notice. Consult the product's installation instructions for final dimensional data and other details. Applicable product warranty can be found in accompanying product literature or you may contact your account manager for further details.

Warranties: Bosch warrants that the Product is free from defects in materials and workmanship for a period of three hundred and sixty-five (365) days from the date of purchase. The foregoing timeline begins to run upon the date of purchase, and shall not be stalled, tolled, extended, or suspended, for any reason whatsoever. This Product is also warranted to be free from cosmetic defects in material and workmanship (such as scratches of stainless steel, paint/porcelain blemishes, chip, dents, or other damage to the finish of the Product, for a period of thirty (30) days from the date of purchase or closing date for new construction. This cosmetic warranty excludes slight color variations due to inherent differences in painted and porcelain parts, as well as differences caused by kitchen lighting, product location, or other similar factors. This cosmetic warranty specifically excludes any display, floor, "As Is", or "B" stock appliances.

For more information on our entire line of products, go to [www.bosch-home.com/us](http://www.bosch-home.com/us) or call 1-800-944-2904

© BSH Home Appliances Corporation. All rights reserved. Bosch is a registered trademark of Robert Bosch GmbH.

**SENATOR HOMES**  
**DECOR CENTRE**

DATE: DEC 10 2015

INITIALS: [Signature]



# 24" Bar Handle Dishwasher

300 Series DLX - Stainless Steel SHX53TLSUC

9130-54



**BOSCH**  
Invented for life

## Installation Details

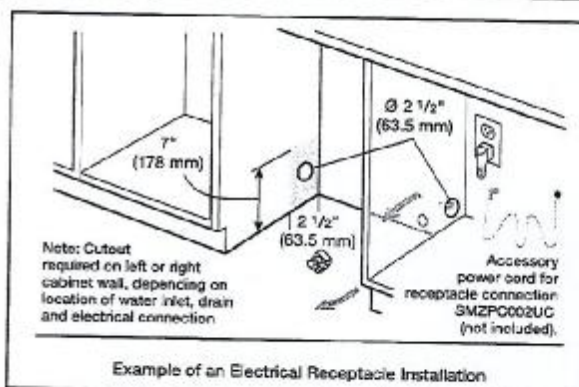
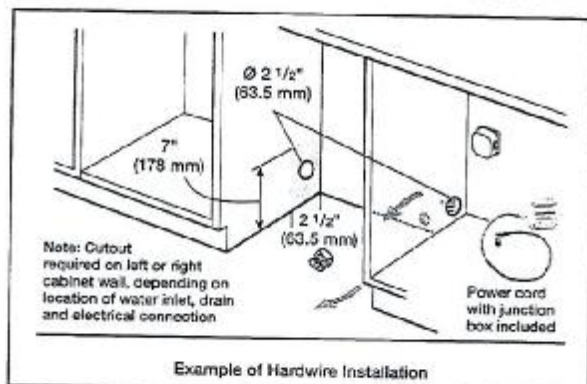
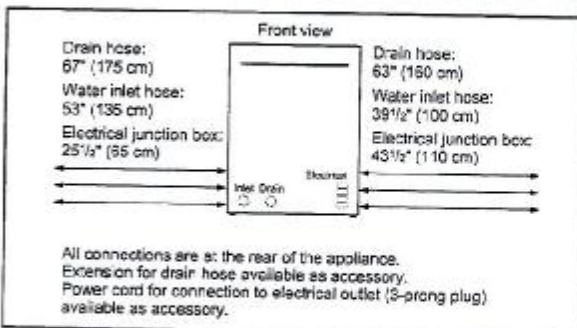
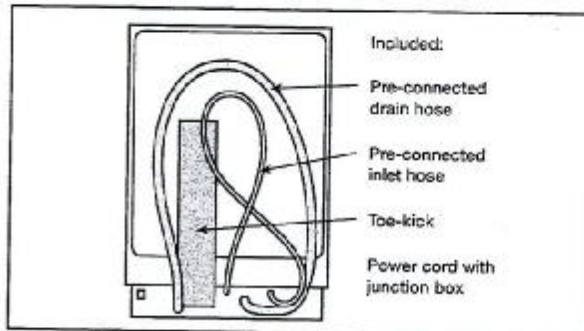
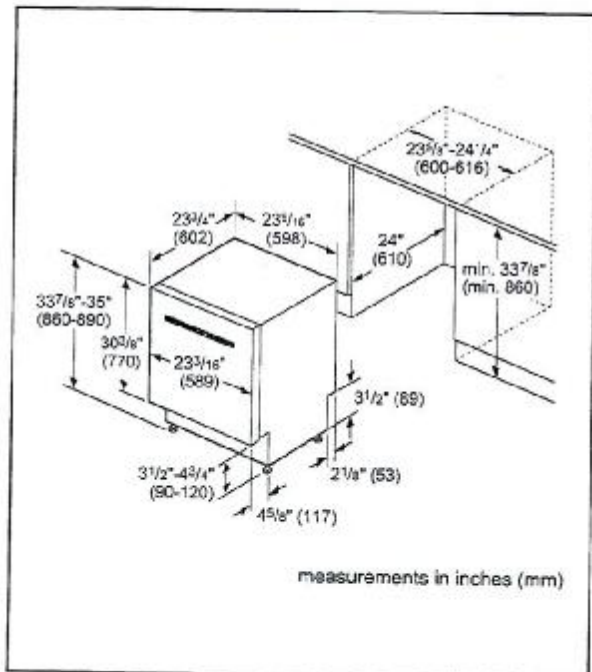

For help and assistance with Bosch accessories please visit: [www.bosch-eshop.com/eshop/bosch/us](http://www.bosch-eshop.com/eshop/bosch/us) or call 1-800-944-2994 Mon-Fri 9am to 6pm PST Sat 9am to 3pm PST

Notes: All height, width and depth dimensions are shown in inches. Please refer to installation instructions prior to making cutout. BSH reserves the absolute and unrestricted right to change product materials and specifications, at any time, without notice. Consult the product's installation instructions for final dimensional data and other details. Applicable product warranty can be found in accompanying product literature or you may contact your account manager for further details.

Warranty: Bosch warrants that the Product is free from defects in materials and workmanship for a period of three hundred and sixty-five (365) days from the date of purchase. The foregoing timeline begins to run upon the date of purchase, and shall not be stalled, tolled, extended, or suspended, for any reason whatsoever. This Product is also warranted to be free from cosmetic defects in material and workmanship (such as scratches of stainless steel, paint/porcelain blemishes, chip, dents, or other damage to the finish of the Product, for a period of thirty (30) days from the date of purchase or closing date for new construction. This cosmetic warranty excludes slight color variations due to inherent differences in painted and porcelain parts, as well as differences caused by kitchen lighting, product location, or other similar factors. This cosmetic warranty specifically excludes any display, floor, "as is", or "E" stock appliances.

For more information on our entire line of products, go to [www.bosch-home.com/us](http://www.bosch-home.com/us) or call 1-800-944-2994

© BSH Home Appliances Corporation. All rights reserved. Bosch is a registered trademark of Robert Bosch GmbH.

**SENATOR HOMES  
DECOR CENTRE**

DATE: DEC 10 2015  
INITIALS: [Signature]



9130-54

# 24" Bar Handle Dishwasher

300 Series DLX - Stainless Steel SHX53TL5UC



## Installation Details

Note: Plumbing installations will vary - refer to local codes. Drain hose included is 79 (201 cm) and can be extended to a maximum of 155 3/4" (395 cm).

Always use the approved drain hose extension kit (SGZ1010UC).

Ensure a portion of the drain hose is raised between min. 20" (50 cm) and max. 43" (110 cm) above the cabinet floor.

For help and assistance with Bosch accessories please visit: [www.bosch-eschop.com/eschop/bosch/us](http://www.bosch-eschop.com/eschop/bosch/us) or call 1-800-944-2304 Mon-Fri 5am to 6pm PST Sat 6am to 3pm PST

Notes: All height, width and depth dimensions are shown in inches. Please refer to installation instructions prior to making cutout. BSH reserves the absolute and unrestricted right to change product materials and specifications, at any time, without notice. Consult the product's installation instructions for final dimensional data and other details. Applicable product warranty can be found in accompanying product literature or you may contact your account manager for further details.

Warranties: Bosch warrants that the Product is free from defects in materials and workmanship for a period of three hundred and sixty-five (365) days from the date of purchase. The foregoing timeline begins to run upon the date of purchase, and shall not be stalled, tolled, extended, or suspended, for any reason whatsoever. This Product is also warranted to be free from cosmetic defects in material and workmanship (such as scratches of stainless steel, paint/porcelain blemishes, chip, dents, or other damage to the finish of the Product, for a period of thirty (30) days from the date of purchase or closing date for new construction. This cosmetic warranty excludes slight color variations due to inherent differences in painted and porcelain parts, as well as differences caused by kitchen lighting, product location, or other similar factors. This cosmetic warranty specifically excludes any display, floor, "As Is", or "B" stock appliances.

For more information on our entire line of products, go to [www.bosch-home.com/us](http://www.bosch-home.com/us) or call 1-800-944-2304

© BSH Home Appliances Corporation. All rights reserved. Bosch is a registered trademark of Robert Bosch GmbH.

SENATOR HOMES  
DECOR CENTRE

DATE: DEC 10 2015  
INITIALS: [Signature]

9130-54

## Pyramid 30

30" Stainless Steel Range Hood

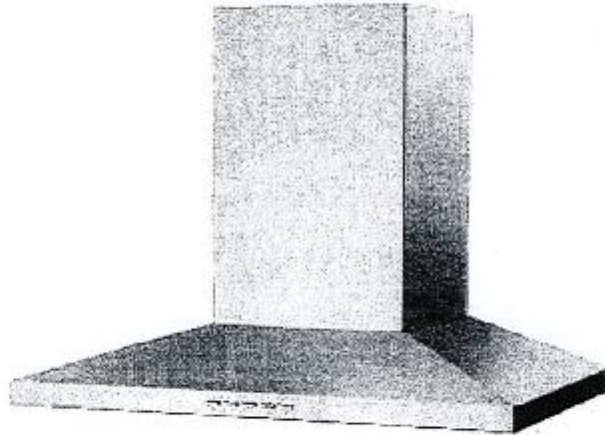

- 30" (76cm) stainless steel pyramid shaped wall-mount range hood
- LED lighting
- 3 speed adjustment
- 2 x dishwasher safe baffle filters
- Electronic back-lit push buttons
- Quiet (8 sones/ 58dB) 500 CFM motor

Porter&Charles

SENATOR HOMES  
DECOR CENTRE

DATE: DEC 10 2015

INITIALS:  

9130-54

# Pyramid 30

30" Stainless Steel Range Hood

## Dimensions:

L: 18<sup>3/8"</sup> x H: 18<sup>3/8"</sup> x W: 30"

L: 46.67 cm x H: 46.67 cm x W: 76.2 cm

Duct Size: 6"

## Electrical Requirements

• 115 Volt, 60Hz, 15AMP

\* AEG Range Hoods are supplied with a Canadian plug

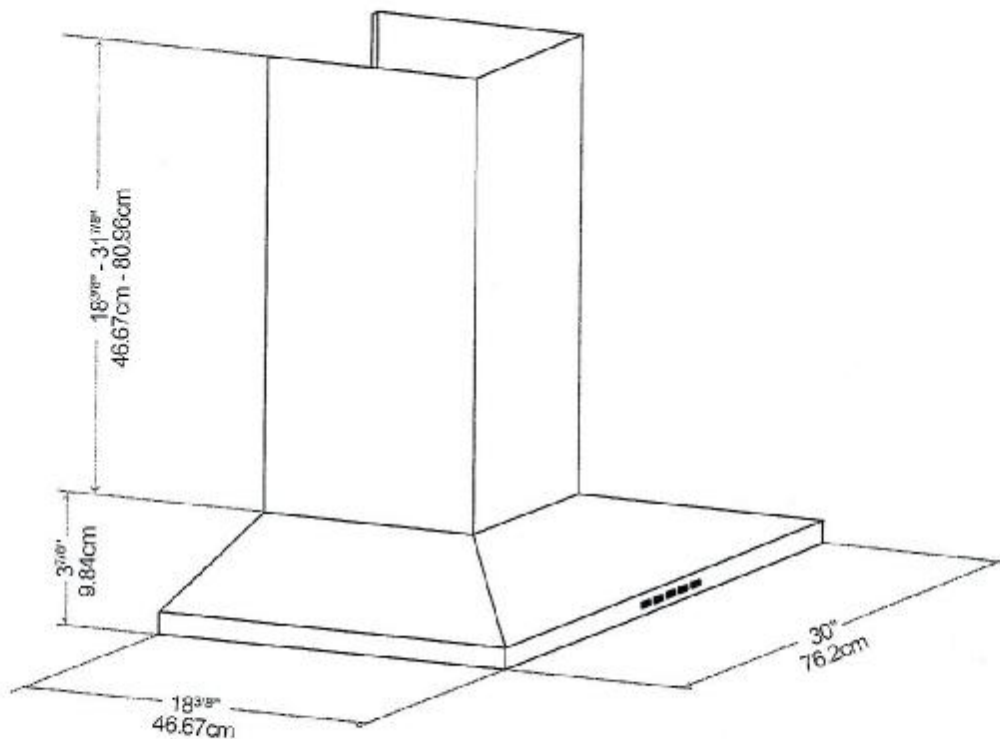

# Porter & Charles

SENATOR HOMES  
DECOR CENTRE

DATE: DEC 10 2015

INITIALS:



9130-54

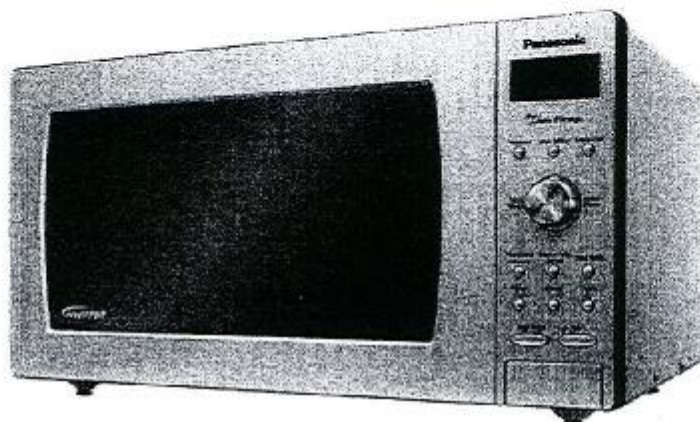

\$369.99

ADD TO CART

Previous

#### PRODUCT INFORMATION

- New Blue LED light dial control system
- Stainless steel fingerprint resistant coating
- 1.6 cu. ft.
- 1200 Watts
- New half mirror door deco
- Menu action screen
- Sensor reheat
- Sensor cook (15 categories)
- Inverter® Turbo defrost
- Popcorn key
- Keep warm
- Function key
- Optional stainless steel trim kit available
- Exterior Dimensions (H x W x D): 304 x 555 x 493 mm
- Compatible with trim kit(s): NNTK714SS, NNTK722S, NNTK729SSA, NNTK732S, NNTK739SS,

SENATOR HOMES  
DECOR CENTRE

DATE: DEC 10 2015

INITIALS: [Signature]

9130-54

# Specifications (Column Installation)

## 30" Stainless Steel Microwave Trim Kit

### INSTALLATION

1. Unscrew the 4 screws holding the 2 pieces of wood in place, and retain the screws.
2. Screw the 2 pieces of wood onto the base of the cabinet. The wooden strips should touch the inside of the front of the MWTK-76, and be positioned with the centre of the wooden strips ( $18\frac{17}{64}" = 46.4\text{cm}$ ) apart.
3. Being careful not to scratch the microwave door, lift the microwave onto the wooden strips, and move it back about 2 inches.
4. Place the MWTK-76 into position. Use the 4 screws and screw them through the flanges into the side gables.
5. Pull the microwave forward, and align the front of the microwave with the front of the MWTK-76.
6. To stop the microwave from sliding backwards whilst opening it, it might be necessary to attach a piece of wood behind the feet of the microwave, on the wooden supports.
7. Air must be able to flow from the microwave upwards and into the room, or roof space. Failure to comply will void the manufacturer's warranty on the microwave oven.

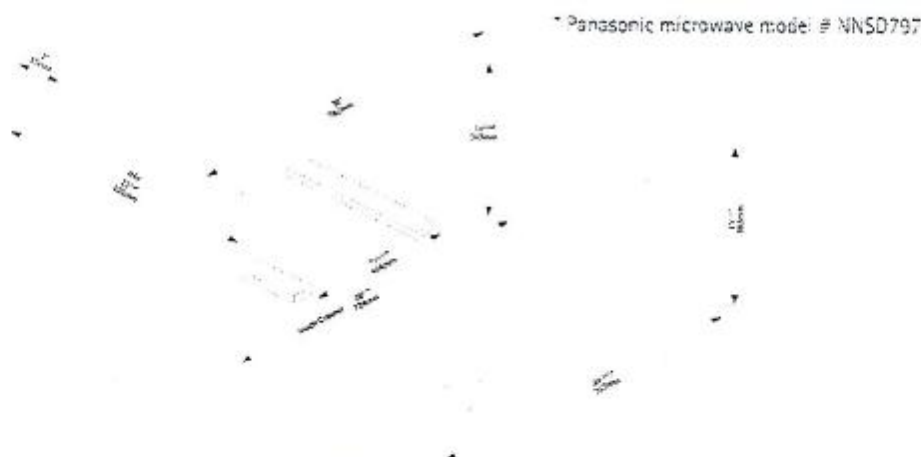

Oven Specifications are subject to change without notice  
Detailed Specification Available at [www.aeg-appliances.ca](http://www.aeg-appliances.ca)

**AEG**

SENATOR HOMES  
DECOR CENTRE

DATE: DEC 10 2015

INITIALS:

FRIGIDAIRE



# Front Load Washer

FFFW5000QW

7 Wash Cycles  
4.5 Cu. Ft. I.E.C.

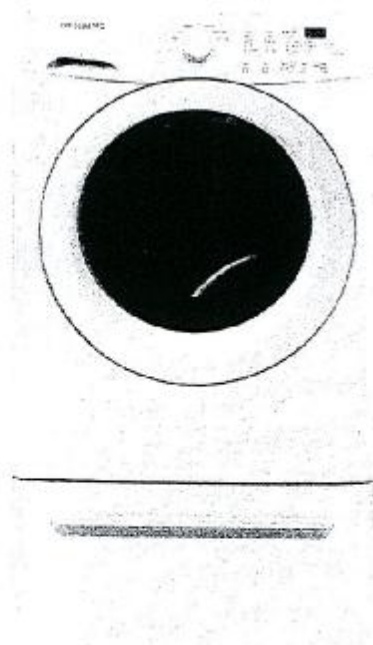

Optional SpaceWise® Pedestal Drawer Shown

## Product Dimensions

Height	36"
Width	27"
Depth	30-9/16"

## More Easy To Use Features

### ENERGY STAR®-Qualified

### Stain Clean Option

### Delay Start

Begin your washing cycle at the time that works best with your schedule.

### End-Of-Cycle Signal

### Ready-Select® Controls

It's easy to get laundry started with just the touch of a button.

### TimeWise® Technology

Wash time equals dry time — so you don't wait for clothes to dry.

### SilentDesign™

Designed for quiet operation.

### Stay-Fresh™ Antimicrobial Seal

### Auto Options

### Automatic Water Level Control

### Optional Pedestal Drawer

### Vibration Control System

Advanced vibration control keeps even oversized loads balanced for smooth, quiet operation. Ideal for second floor installation.

### Add-a-Garment

With just the touch of a button, easily add an extra piece to the washer once a cycle has started.

ENERGY STAR®



Available in:

Classic  
White  
(CW)

frigidaire.ca

## Signature Features

### Advance Rinse Technology

Final rinse uses fresh water to ensure whiter whites and reduce allergens.

### Stainless Steel Drum

Smooth, durable interior is rust-proof and won't snag clothes.

### Large Capacity

Finish more in less time with our 4.5 cu.ft. I.E.C. capacity — the washer can fit two baskets of laundry in a single load.

### Tumble Action Cleaning System

By removing the agitator, you can count on the tumble action to wash gently and rinse completely, ensuring your clothes feel fresher and last longer.

SENATOR HOMES  
DECOR CENTRE

DATE: DEC 10 2015

INITIALS: [Signature]



FRIGIDAIRE

9130-54  
Front Load Washer  
FFFW5000QW 4.5 Cu.Ft. I.E.C.

Features	
Total Capacity I.E.C. (Cu.Ft.)	4.5
Controls	Ready-Select™
Washer Drum Interior	Stainless Steel
Lifetime Warranty Tub	Yes
Interior Light/Door Trim	No/White
Vibration Control System	Yes
Advanced Rinse Technology	Yes
TimeWise™ Technology	Yes
Ready Clean™/Ready Steam™	
Fresh Water Rinse Option	Yes
Stay-Fresh™ Door Seal	Yes
Automatic Temperature Control	Yes
Automatic Water Level Adjustments	Yes
Auto Prewash Detergent Dispenser	
Auto Bleach Dispenser	Yes
Auto Detergent Dispenser	Yes
Auto Fabric Softener Dispenser	Yes
Time Remaining Indicator	Yes
Cycle Status Lights	Yes
Cycle Signal/Cycle Signal "On/Off"	Chime/Yes
Cycle Signal Volume Control	
Door Lock Indicator Light	Yes
Control Lock/Stay Put Door	Yes/Yes
Start/Pause/Cancel Buttons	Yes
Energy Saver Option	Yes
Delay Start	Up to 10 Hours
Integral Water Heater	
Tumble Speed (RPM)	Variable
Spin Speed (Maximum RPM)	1,200
Sound Package	Silent Design™
Adjustable Leveling Legs	Yes
Cycles	
Wash Cycles/Specialty Cycles	7/0
Options	
Water Temperature Selections	5
Water Levels	Automatic/Max Fill
Spin Speed/Soil Level Selections	5/5
Allergen	
Optional Accessories	
Dryer Stacking Kit	PN# STACKIT4X
15" Frigidaire® Pedestal Drawers	
Classic White (W)	PN# CFWWD15W
Mobile Home Installation Kit	PN# 137067200
Drain Hose Extension Kit	PN# 137098000
Certifications	
ENERGY STAR®	Yes
NSF® Certified Sanitize/Allergen	
Specifications	
Power Supply Connection Location	Right Top Rear
Water Inlet Connection Location	Left Top Rear
Voltage Rating	120V/60Hz/15A
Connected Load (kW Rating) @ 120 Volts	1
Watts @ 120 Volts/Amps @ 120 Volts	1,000/10
Minimum Circuit Required (Amps)	15
Shipping Weight (Approx.)	222 Lbs.

For use on adequately wired 120V dedicated circuit having 2-wire service with a separate ground wire. Appliance must be grounded for safe operation.

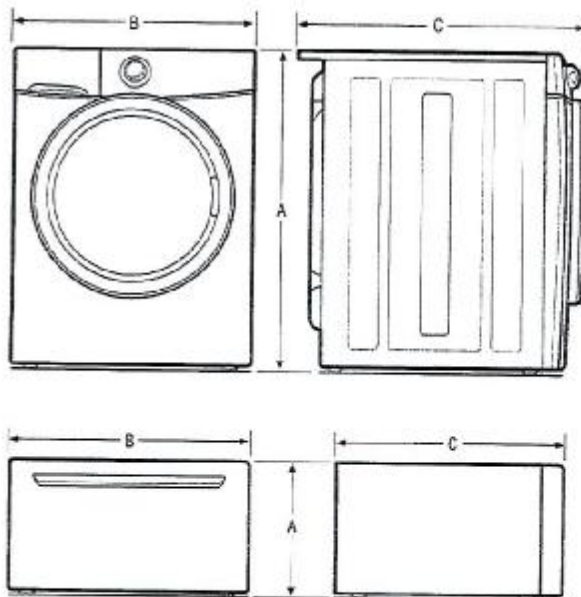

NOTE: For planning purposes only. Always consult local and national electric and plumbing codes. Refer to Product Installation Guide for detailed installation instructions on the web at [frigidaire.ca](http://frigidaire.ca)



Product Dimensions	
A-Height (Single)	36"
Height (Stacked)	71-1/2"
B-Width	27"
C-Depth	30-9/16"
Depth with Door Open 90°	50-13/16"
Pedestal Dimensions	
A-Height	15-1/8"
B-Width	27"
C-Depth	26-1/2"
Depth with Drawer Fully Extended	42-1/2"

Accessories information available on the web at [frigidaire.ca](http://frigidaire.ca)

FRIGIDAIRE

CANADA • 5855 Terry Fox Way • Mississauga, ON L5V 5E4 • 1-800-265-8352 • [frigidaire.ca](http://frigidaire.ca)  
FFFW5000Q 02/14

© 2014 Electrolux Major Appliances, Inc.

Specifications subject to change  
Printed in Canada

SENATOR HOMES  
DECOR CENTRE

DATE: DEC 10 2015

INITIALS:

FRIGIDAIRE



## Front Load Dryer

CFQE5000QW

6 Dry Cycles  
7.0 Cu.Ft. I.E.C. Electric

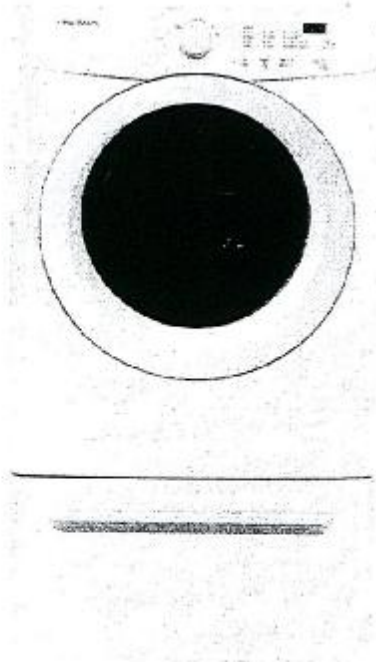

Optional SpaceWise® Pedestal Dryer Shown

### Product Dimensions

Height	36"
Width	27"
Depth	30-9/16"

### More Easy To Use Features

**Precision Dry™ Moisture Sensor**  
Dries even extra-large loads quickly and efficiently.

### Timed Dry Cycles

### Multiple Dryness Levels

**Ready-Select® Controls**  
Easily select options with the touch of a button.

### Auto Dry Cycles

### Control Lock

**Dryness Selections**  
Allow for better control over fabric care and the drying process. More Dry, Normal, Less Dry or Damp can be selected. More Dry is ideal for towels while Damp is perfect for items that will be ironed.

Available in:

Classic  
White  
(W)

## Signature Features

### Quick Dry

Dries even extra-large loads quickly and efficiently.

### One-Touch™ Wrinkle Release

Prevents wrinkles, so your clothes look great every time. The Wrinkle Release System finishes by tumbling without heat.

### Large Dryer Capacity

Finish more laundry in less time with our 7.0 cu.ft. I.E.C. dryer capacity.

### Reversible Door

Dries clothes more evenly for better results.

frigidaire.ca

SENATOR HOMES  
DECOR CENTRE

DATE: DEC 10 2015

INITIALS:

*[Handwritten signature]*



FRIGIDAIRE

9130-54

# Front Load Dryer

CFQE5000QW 7.0 Cu. Ft. I.E.C. Electric

Features	
Total Capacity U.S.C. (Cu. Ft.)	7.0
Controls	Ready Select™
Dryer Drum Interior	Painted Steel
Interior Light	Yes
Door Trim	White
Ready Steam™	
DrySense™ Technology	Yes
Wrinkle Release Technology	Yes
TimeWise™ Technology	Yes
Precision Moisture Sensor	Yes
Time Remaining Indicator	Yes
Cycle Status Lights	Yes
Cycle Signal	Chime
Cycle Signal "On/Off"	Yes
Cycle Signal Volume Control	
Control Lock	Yes
Start/Pause/Cancel Buttons	Yes
Energy Saver Option	
Delay Start	
Tumble Speed (RPM)	50
Reversible Door	Yes
Lint Screen	Yes
Sound Package	SilentDesign™
Adjustable Leveling Legs	Yes
Cycles	
Dry Cycles	6
Specialty Cycles	0
Options	
Temperature Selections	5
Dryness Level Selections	4
Timed Dry	30, 60, 90
Optional Accessories	
Dryer Stacking Kit	PN# STACKIT4X
15" Frigidaire® Pedestal Drawers	
Classic White (CW)	PN# CFPWD1SW
Mobile Home Installation Kit	PN# 137067200
Drying Rack	PN# 137067300
Certifications	
NSF® Certified Sanitize	
Specifications	
Maximum Exhaust Duct Length* (Ft.)	64
Power Supply Connection Location	Right Bottom Rear
Voltage Rating	240V/60Hz/30A
Connected Load (kW/Rating) @ 240 Volts	5.4
Amps @ 240 Volts	24
Heating Element @ 240 Volts (Watts)	4,700
Shipping Weight (Approx.)	140 Lbs.

\*Rigid metal duct preferred, semi-rigid optional and allow deductions for elbows and vents. Refer to Installation Guide on web for additional information.

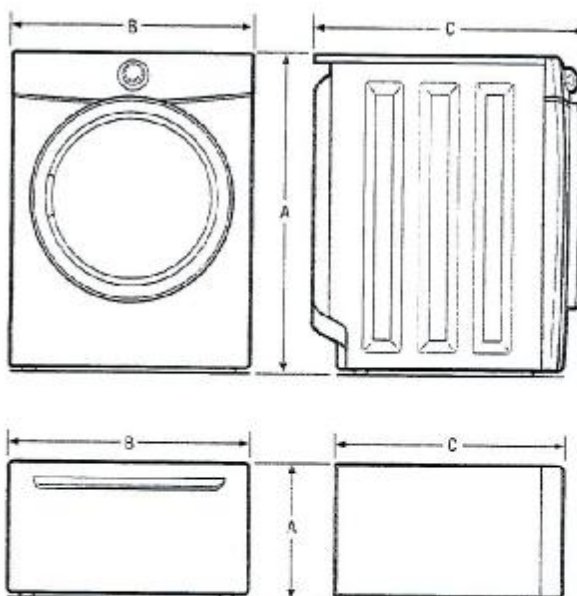

NOTE: For planning purposes only. Always consult local and national electric and plumbing codes. Refer to Product Installation Guide for detailed installation instructions on the web at [frigidaire.ca](http://frigidaire.ca).



Product Dimensions	
A - Height (Single)	36"
Height (Stacked)	71-1/2"
B - Width	27"
C - Depth	30-9/16"
Depth with Door Open 90°	81-3/16"
Pedestal Dimensions	
A - Height	15-1/4"
B - Width	27"
C - Depth	26-1/2"
Depth with Drawer Fully Extended	42-1/2"

Accessories information available on the web at [frigidaire.ca](http://frigidaire.ca)

FRIGIDAIRE

CANADA • 5855 Terry Fox Way • Mississauga, ON L5V 3E4 • 1-800-255-8352 • [frigidaire.ca](http://frigidaire.ca)

CFQE5000QW 05/14

© 2014 Electrolux Major Appliances, Inc.

Specifications  
Subject to change  
Printed in Canada

SENATOR HOMES  
DECOR CENTRE  
DATE: DEC 10 2015  
SALES: [Signature]



BEDROOM 3  
IN LIEU OF  
THE STD

9130-54



SENATOR HOMES  
DECOR CENTRE

DATE: DEC 10 2015  
INITIALS: [Signature]