



CONSTRUCTION SUMMARY

Teefy Developments Limited / 9130 Bathurst

Lot/Unit: 60    Phase/Building: 1    Model/Floor Plan: Riverdale(22-3)

CABINETRY ACCESSORIES

Inv.3197	2 - SUPPLY AND INSTALL KITCHEN LIGHT VALANCE - NOT APPLICABLE FOR THERMOVISION - PRICE PER 8 FOOT LENGTH	
Line 41501	Note:	
11Sep15 / 15Jan16		
Inv.3197	3 - SUPPLY AND INSTALL CROWN MOULDING - NOT APPLICABLE FOR THERMOVISION - PRICE IS PER 8 FOOT LENGTH	
Line 41502	Note:	
11Sep15 / 15Jan16		

CABINETRY APPLIANCE - FRIDGE

Inv.3197	1 - SUPPLY AND INSTALL KITCHEN 59 CM FRIDGE CABINET - 1 GABLE & CABINET 59 CM DEEP - DEEP - UPGRADE 1	
Line 41499	Note:	
11Sep15 / 15Jan16		

CABINETRY BASE CABINETS

Inv.3197	2 - SUPPLY AND INSTALL ADDITIONAL TWO FEET BASE CABINET - PRICE IS PER FOOT - UPGRADE 1 TO THE KITCHEN ISLAND	
Line 45217	Note:	
11Sep15 / 15Jan16		

CABINETRY HARDWARE

Inv.3197	1 - SUPPLY AND INSTALL BASE WASTE / RECYCLE CENTER PULL OUT DOOR - ONLY AVAILABLE IN 45 CM CABINET (2) 35L BINS - PRICE IS PER UNIT	
Line 41504	Note:	
11Sep15 / 15Jan16		

CABINETRY HOOD FANS

Inv.3197	1 - SUPPLY AND INSTALL ACCOMMODATION FOR FUTURE CHIMNEY STYLE HOOD FAN IN THE KITCHEN	
Line 41514	Note:	
11Sep15 / 15Jan16		

COUNTER TOP - KITCHEN

Inv.3197	1 - SUPPLY AND INSTALL ADDITIONAL TWO LINEAR FEET - 3CM STONE COUNTEROP WITH STANDARD SQUARE EDGE – GROUP 1 TO THE KITCHEN ISLAND AND BREAKFAST BAR	
Line 45218	Note:	
11Sep15 / 15Jan16		

COUNTER TOP - VANITY

Inv.3197	1 - SUPPLY AND INSTALL 2CM STONE COUNTEROP WITH STANDARD SQUARE EDGE – GROUP 1 IN THE POWDER ROOM	
Line 41512	Note:	
11Sep15 / 15Jan16		
Inv.3197	1 - SUPPLY AND INSTALL 2CM STONE COUNTEROP WITH STANDARD SQUARE EDGE – GROUP 1 IN THE ENSUITE - BATHROOM	
Line 41513	Note:	
11Sep15 / 15Jan16		



CONSTRUCTION SUMMARY

Teefy Developments Limited / 9130 Bathurst

Lot/Unit: 60    Phase/Building: 1    Model/Floor Plan: Riverdale(22-3)

DOORS AND WINDOWS

Inv.3197	1 - SUPPLY AND INSTALL LOWER BATH OPTIONAL DOOR SWING AS PER SKETCH ATTACHED	
Line 45221	Note:	
11Sep15 / 15Jan16		

ELECTRICAL

Inv.3197	1 - SUPPLY AND INSTALL LIGHT VALANCE ROUGH IN (INCLUDES 1 SWITCH) TO THE KITCHEN	
Line 41476	Note: LOCATION AS PER SKETCH ATTACHED.	
11Sep15 / 15Jan16		
Inv.3197	1 - SUPPLY AND INSTALL ADDITIONAL INTERIOR RECEPTACLE ON SEPARATE CIRCUIT FOR FUTURE CHIMNEY STYLE HOOD FAN IN THE KITCHEN	
Line 45216	Note: LOCATION AS PER SKETCH ATTACHED.	
11Sep15 / 15Jan16		
Inv.3197	1 - SUPPLY AND INSTALL ADDITIONAL INTERIOR RECEPTACLE (NOT SEPARATE CIRCUIT) IN THE FAMILY ROOM APPROXIMATELY 60" +/- FROM THE FLOOR NEXT TO THE STANDARD CABLE TV ROUGH-IN	
Line 41516	Note: LOCATION AS PER SKETCH ATTACHED	
11Sep15 / 15Jan16		

FIREPLACE

Inv.3197	1 - RELOCATE FIREPLACE TO THE FORMAL ROOM LOCATION AS PER SKETCH ATTACHED. TO BE INSTALLED APPROXIMATELY 28" +/- FROM THE FLOOR TO THE BOTTOM OF THE FIREPLACE.	
Line 41517	Note:	
11Sep15 / 15Jan16		

MISCELLANEOUS

Inv.3197	1 - SUPPLY AND INSTALL CHANGES TO UPPER FLOOR AS PER SKETCH	
Line 45222	Note: NO CHARGE AS PER AGREEMENT OF PURCHASE AND SALE SCHEDULE PE DATED JAN 24, 2015	
11Sep15 / 15Jan16		
Inv.3197	1 - SUPPLY AND INSTALL EMPTY CONDUIT TO THE FAMILY ROOM AS PER SKETCH ATTACHED. TERMINATION POINT A TO BE APPROXIMATELY 60" +/- FROM THE FLOOR AND TERMINATION POINT B TO BE BELOW AT APPROXIMATELY 17" +/- FROM THE FLOOR.	
Line 41518	Note:	
11Sep15 / 15Jan16		

PLUMBING

Inv.3197	1 - SUPPLY AND INSTALL WATERLINE ROUGH-IN TO THE FRIDGE LOCATION (NO HOOK UP)	
Line 41477	Note: LOCATION AS PER SKETCH ATTACHED.	
11Sep15 / 15Jan16		
Inv.3197	3 - SUPPLY AND INSTALL AMERICAN STANDARD LOFT COUNTER VESSEL SINK MODEL 0552.001 IN THE: - POWDER ROOM [X1] - MASTER ENSUITE [X2]	
Line 41515	Note:	
11Sep15 / 15Jan16		



CONSTRUCTION SUMMARY

Teefy Developments Limited / 9130 Bathurst

Lot/Unit: 60    Phase/Building: 1    Model/Floor Plan: Riverdale(22-3)

TILE - FLOOR

Inv.3197	1 - SUPPLY AND INSTALL FLOOR TILE - UPGRADE 3 - - VESTIBULE FLOOR	
Line 41507	Note:	
11Sep15 / 15Jan16		
Inv.3197	1 - SUPPLY AND INSTALL FLOOR TILE - UPGRADE 3 - - POWDER ROOM FLOOR	
Line 41509	Note:	
11Sep15 / 15Jan16		
Inv.3197	1 - SUPPLY AND INSTALL FLOOR TILE - UPGRADE 4 - - ENSUITE BATHROOM FLOOR	
Line 41511	Note:	
11Sep15 / 15Jan16		

EXTRAS AS PER OFFER

Stainless Steel Fridge, Stove and Dishwasher and front loading washer and dryer in white from Vendors standard samples, no cash value, not transferable. (Supplied only not installed) ** to - arrange delivery call: The Brick commercial sales division at Worksheet Note:	
Rogers Free Services Package includes 6 months of: home phone, TV and Internet Service. Worksheet Note:	
The Vendor agrees to supply and install hardwood flooring in all bedrooms, with a choice of stain, from Vendors standard samples. Worksheet Note:	
The Vendor agrees to supply and install optional lower level bedroom floorplan (from Vendors standard samples) at no charge. Worksheet Note:	
Vendor agrees to supply and install changes to upper floor as per sketch at no charge. Worksheet Note:	



INTERIOR COLOUR SCHEME

T-60

Purchaser: Shahandeh Ehtemam

Property: 60 of Plan -

Telephone Res. / Bus: (416) 400-3482 /

Project: Teefy Developments Limited

Decor Advisor: Diana Rojas

Model and Elevation: Riverdale(22-3)

Layout Changes: ☒ Yes ☐ No      Sketch Attached: ☒ Yes ☐ No      Exterior Colour Scheme:

1. Cabinetry

	Style and Colour	Counter Top	Hardware
Kitchen / Breakfast	KINGSTON PAINT - MACADEMIA	NEW CALEDONIA	9677 HANDLE
Kitchen Island	KINGSTON PAINT - MACADEMIA	NEW CALEDONIA	9677 HANDLE
Laundry Room	NEWPORT PAINT - MACADAMIA	N/A	12801 HANDLE
Powder Room	KINGSTON PAINT - WINTER WHITE	GRIGIO SARDO (GR1)	9677 HANDLE
Main Bathroom	NEWPORT PAINT - CAPPUCCINO	MADURA PEARL 4922K-52	12801 HANDLE
Master Ensuite Bathroom	KINGSTON PAINT - WINTER WHITE	GRIGIO SARDO (GR1)	9677 HANDLE
Second Ensuite Bathroom (If Applicable)			
LOWER BATH	NEWPORT PAINT - CAPPUCCINO	MADURA PEARL 4922K-52	12801 HANDLE

Appliances

Custom Size Fridge

☒ Yes ☐ No

Valance Lighting

☒ Yes ☐ No

Microwave / Range Hood

☐ Yes ☒ No

Cooktop / Rangetop

☐ Yes ☒ No

Built in Wall Oven

☐ Yes ☒ No

Slide-in Range

☒ Yes ☐ No

Comment

\*\*\*SEE SPECS ATTACHED FOR FRIDGE, SLIDE-IN STOVE, CHIMNEY STYLE HOOD FAN. ALL OTHER APPLIANCES TO BE STANDARD.

2. Flooring

	Selection
FOYER	12X24 COPPER - BEYEZ (3RD UPG)*
Main Hall	3-5/8"X3/4" SATIN FINISH GEN R.O. N.F. ENG HRDWD - GROTTTO
Back Hall	
Breakfast	3-5/8"X3/4" SATIN FINISH GEN R.O. N.F. ENG HRDWD - GROTTTO
Laundry Room	13X13 ALPES - WHITE
Kitchen	3-5/8"X3/4" SATIN FINISH GEN R.O. N.F. ENG HRDWD - GROTTTO
Powder Room	12X24 COPPER - BEYEZ (3RD UPG)*
Main Bathroom	13X13 ALPES - WHITE
Master Ensuite	NIAGARA FALLS - BLACK (4TH UPG)
Bathroom (If Applicable)	
Mud Room	13X13 ALPES - WHITE
LOWER BATH	13X13 ALPES - WHITE
Living Room	FORMAL ROOM = 3-5/8"X3/4" SATIN FINISH GEN R.O. N.F. ENG HRDWD - GROTTTO
Dining Room	
Family / Great Room	3-5/8"X3/4" SATIN FINISH GEN R.O. ENG HRDWD - GROTTTO
Den / Library / Study	LOWER REC ROOM = PAPILIO PALE FACES 19513
Basement Landing (If Applies)	
Lower Landing (If Applicable)	
Upper Landing	3-5/8"X3/4" SATIN FINISH GEN R.O. N.F. ENG HRDWD - GROTTTO
Upper Hall	3-5/8"X3/4" SATIN FINISH GEN R.O. N.F. ENG HRDWD - GROTTTO
Master Bedroom	3-5/8"X3/4" SATIN FINISH GEN R.O. N.F. ENG HRDWD - GROTTTO
Bedroom #2	3-5/8"X3/4" SATIN FINISH GEN R.O. N.F. ENG HRDWD - GROTTTO
Bedroom #3	3-5/8"X3/4" SATIN FINISH GEN R.O. N.F. ENG HRDWD - GROTTTO
Bedroom #4	LOWER BEDROOM 4 = PAPILIO PALE FACES 19513
Bedroom #5	

Flooring Continued on Page 2

Initial:

S.E.

Page 1 of 3



INTERIOR COLOUR SCHEME

T-60

Purchaser: Shahandeh Ehtemam  
Telephone Res. / Bus: (416) 400-3482 /  
Decor Advisor: Diana Rojas

Property: 60 of Plan -  
Project: Teefy Developments Limited  
Model and Elevation: Riverdale(22-3)

2. Flooring - Continued -

Upgrade Underpad	Type	Area
	STND	LOWER LEVEL NON TILED AREAS
Carpet on Stairs	Capped	Runner - *Upgrade
Comment		

3. Plumbing Fixtures / Faucets

Kitchen	STND	Second Ensuite		Powder Room	UPG
Master Ensuite	UPG			Other Room	
Main Bathroom	STND	LOWER BATH	STND		
Comment					

4. Wall Tile

	Tile Selection	Listello	Insert	Insert Selection
Main Bathroom	8X10 WEAVE - TENDER GREY	<input type="checkbox"/>	<input type="checkbox"/>	
Master Ensuite				
Tub Deck		<input type="checkbox"/>	<input type="checkbox"/>	
Tub Apron		<input type="checkbox"/>	<input type="checkbox"/>	
Tub Surround		<input type="checkbox"/>	<input type="checkbox"/>	
Shower Stall	8X10 WEAVE - WHITE	<input type="checkbox"/>	<input type="checkbox"/>	
Second Ensuite		<input type="checkbox"/>	<input type="checkbox"/>	
LOWER BATH	8X10 WEAVE - TENDER GREY	<input type="checkbox"/>	<input type="checkbox"/>	
		<input type="checkbox"/>	<input type="checkbox"/>	
Kitchen Backsplash		<input type="checkbox"/>	<input type="checkbox"/>	
Complete Backsplash		<input type="checkbox"/>	<input type="checkbox"/>	
Comment	STANDARD VERTICAL STACK INSTALL			

5. Fireplace

	Living Room			Family Room			Other Room - Specify FORMAL RM		
	Purchased	As Per Plan	N/A	Purchased	As Per Plan	N/A	Purchased	As Per Plan	N/A
	<input type="radio"/>	<input type="radio"/>	<input checked="" type="radio"/>	<input type="radio"/>	<input type="radio"/>	<input checked="" type="radio"/>	<input type="radio"/>	<input type="radio"/>	<input type="radio"/>
Fireplace Type							STND - BLF50		
Mantle Type									
Over Mantle									
Colour / Stain									
Surround									
Hearth									
Comment	F.P. LOCATED IN THE FORMAL ROOM AS PER SKETCH								

Initial: S-E



## INTERIOR COLOUR SCHEME

T-60

Purchaser: Shahandeh Ehtemam  
Telephone Res. / Bus: (416) 400-3482 /  
Decor Advisor: Diana Rojas

Property: 60 of Plan -  
Project: Teefy Developments Limited  
Model and Elevation: Riverdale(22-3)

## 6. Trim Carpentry

Door Hardware Interior Trim 

Comment

## Interior Doors

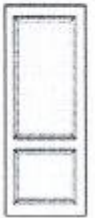
☐ 2 Panel Arch Top☒ 2 Panel Square Top☐ 6 PanelInitial for Door Style S.E.

## 7. Railings and Pickets

Railing Package Railing Colour  Picket Colour Wood Stairs ☐ No ☒ Oak Tread Colour 

Comment

## 8. Plaster Mouldings and Medallions

Foyer   Kitchen/Breakfast  Main Hall   Den/Library  Living Room   Lower Landing  Dining Room  Family Room  

Comment

## 9. Wall Paint

Smooth Ceilings ☐ First Floor  
☐ First Floor incl. Second Floor Hall  
☐ First and Second Floor  
☒ Throughout  
☐ Not Applicable

Trim Paint 

## 10. Additional Comments

## 11. Disclaimers and Notes

- Colours of all materials are as close as possible to builder's selection, but not necessarily identical due to variances in manufacturing.
- Any extras listed above are null and void unless accompanied by a separate invoice/amendment. Said invoice must be paid in full.
- The Purchaser acknowledges that after Interior Colour Selection form is signed and dated, no further changes will be permitted other than re-selection due to unavailability. S.E. Purchaser's Initials
- The Purchaser acknowledges reading and accepting the "Senator Homes Décor Centre Disclaimers" form. This document contains other miscellaneous disclaimers.

This Interior Colour Selection is final and approved by:

Purchaser:  Date: Jun 15, 2016Vendor:  Jun 21, 16  
Teefy Developments Limited



# RIVERDALE

SENATOR HOMES  
DECOR CENTRE

DATE: JAN 15 2016

INITIALS: S.E.

2454 SQ.FT. / 2288 SQ.FT. WITH OPTIONAL TANDEM GARAGE



SENATOR  
HOMES

Renderings are artist's concept. Some elevations may vary from that shown. Actual useable square footage may vary from that stated herein. Some floorplans and elevations are mirror image to that shown. E.&O.E. 22-3

S.E.





# RIVERDALE - TH-22-3

## STD. LAYOUT

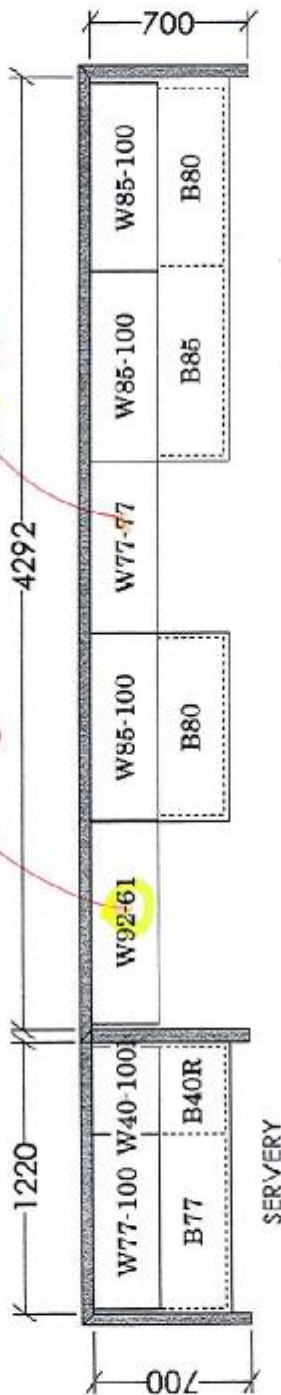

\*WALK IN PANTRY NOT INCLUDED\*

SERVERY

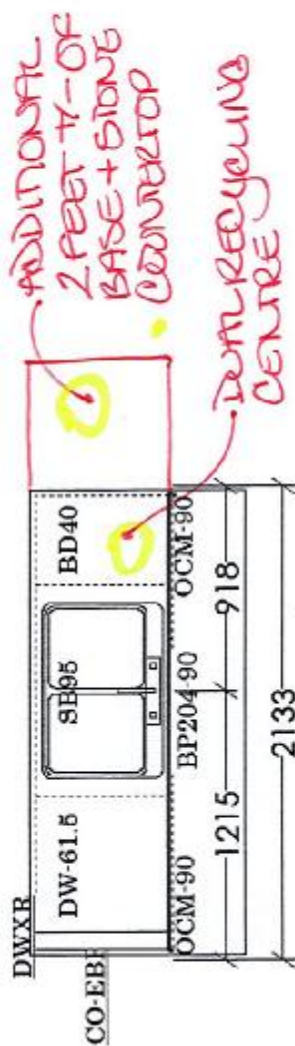

OPT. CROWN (X3)  
OPT. LIGHT VALANCE (X2)

-KITCHEN (MAIN FLOOR) ELEV A  
-ALT 1 ELEV A

## OPTIONAL CABINETRY (STANDARD ELEVATION)

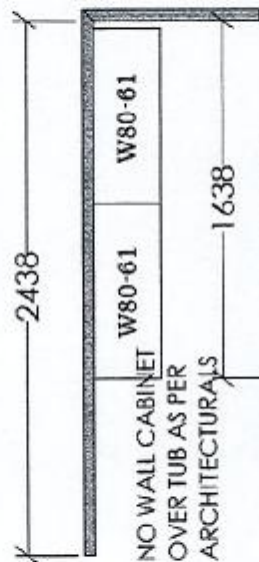

OPT. LAUNDRY UPPIERS (LOWER LEVEL) ELEV A  
(BASE CABINETRY NOT REFLECTED ON DWG'S)

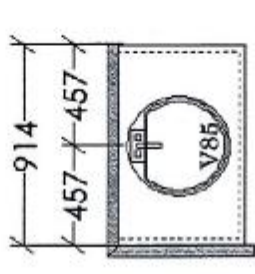

BATH (LOWER LEVEL) ELEV A

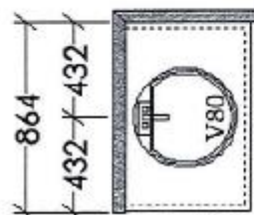

MAIN BATH (UPPER LEVEL) ELEV A

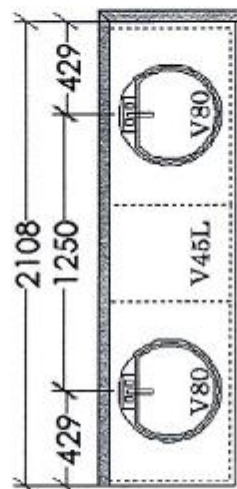

-ENSUITE (UPPER FLOOR) ELEV A HALF WALL

SENATOR HOMES  
DECOR CENTRE

DATE: JAN 15 2016

INITIALS: S.E.

## Option 9

### Loft Counter Vessel

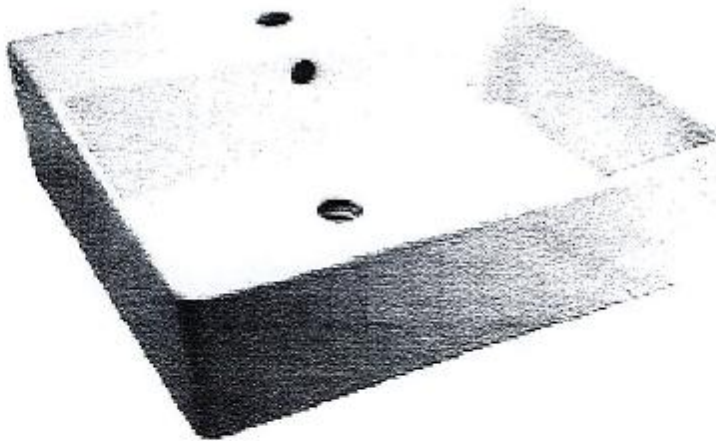

American Standard Loft Counter Vessel  
0552.001 19 5/8" x 17 3/4" x 5 1/2"  
China  
Chrome Grid Drain Included

POWDER ROOM (x1)  
ENSUITE (x2)

(x3 TOTAL).

STND KIT  
FAUCET



**Kitchen Faucet**

**SENATOR**  
HOMES

**Moen Ascent 90**  
**Showhouse**  
Model S71709 CSL

Stainless Steel  
Pull Out Dual Spray Handle  
1-Hole Application

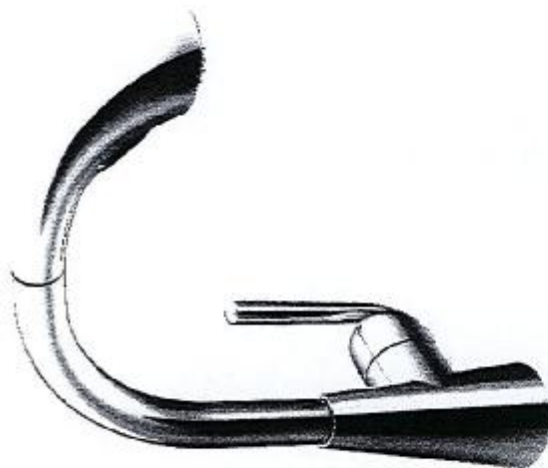

T-60

SENATOR HOMES  
DECOR CENTRE

DATE: JAN 15 2016

INITIALS: S.Z.

STND KIT. SINK



Kitchen Sink

Franke TCX120-29

Undermounted 0Radius Sink  
DBL Equal Bowl  
18guage Stainless

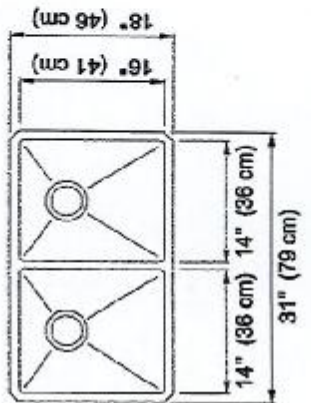
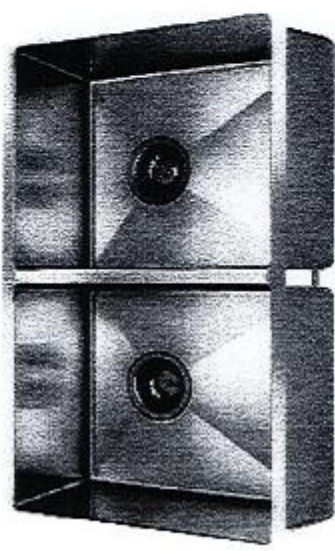



T-60

SENATOR HOMES  
DECOR CENTRE

DATE: JAN 9 5 2018  
INITIALS: S.E.

STND  
PLUMBING  
FIXTURES



### Faucets



### Moen VOSS Series

Model T693/4796

Chrome Finish  
3PC Deck Mount

### Moen VOSS Series

Model T2693/62320

Chrome Finish  
Pressure Balance Positomp  
Diverter Spout

### Moen VOSS Series

Model 6903

Chrome Finish  
Single Hole Application  
Mechanical Pop-up Drain





T-60

SENATOR HOMES  
DECOR CENTRE

DATE: S.E.

INITIALS: JAN 15 2016

STANDARD BATHROOM  
ACCESSORIES



SENATOR  
HOMES

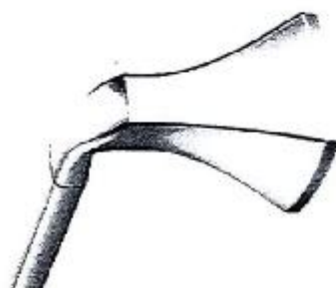

**Moen VOSS Series**  
Model YB5118

18" Towel Bar  
Chrome Finish



**Moen VOSS Series**  
Model YB5108

Toilet Paper Holder  
Chrome Finish

T-60

SENATOR HOMES  
DECOR CENTRE  
DATE: SE.  
INITIALS: JAN 15 2016

STND ENSUITE  
TUB



Free Standing Bath

Jazz - 105359

Dimensions:

66" x 36" x 24"

Free Standing Bath  
2PC Acrylic Construction  
Deck Mounted Tub Faucet

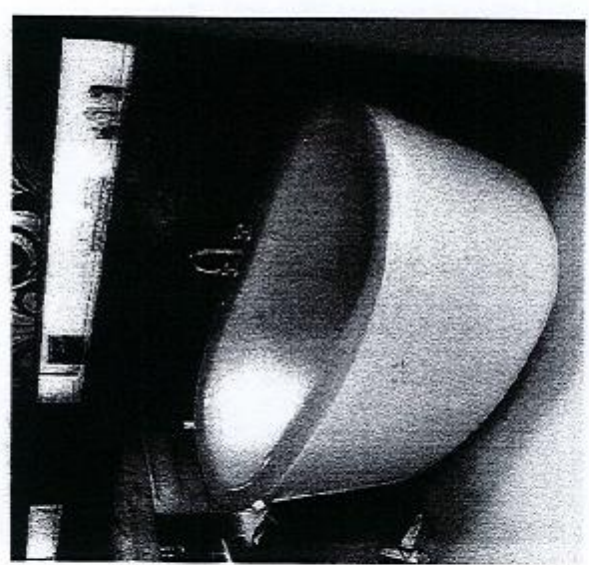

T-60

SENATOR HOMES  
DECOR CENTRE

DATE: SE.

INITIALS: JAN 15 2016

STND BATHROOM  
TUB



5Ft Bath

Kohler Sterling Performa

Dimensions:

60 " x 32 " x 16 "

Minimalist Design

Integral Skirt

Vikrell Contruction

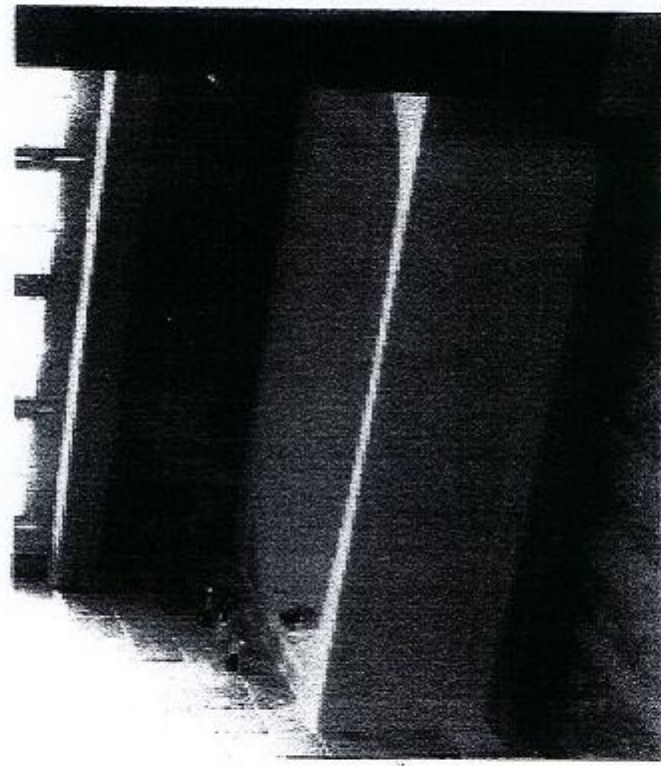

T-60

SENATOR HOMES  
DECOR CENTRE

DATE: S. E.

INITIALS: JAN 15 2016

STUD TOILET



Fixtures

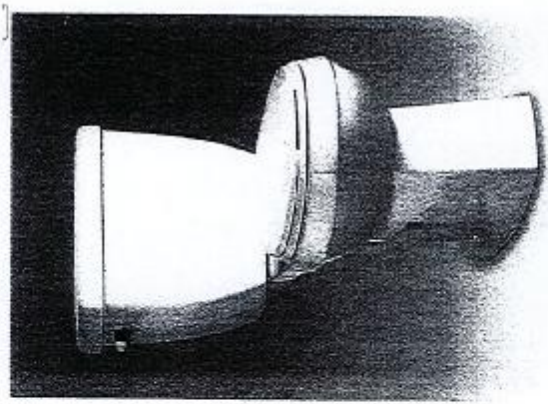

**Contrac Carlin 2PC Toilet**  
Model 4721 BFV/4721BFVU

2PC Construction  
Regular Round Front Bowl  
Standard Seat



FRIGIDAIRE

T-60



# Chimney Hood

FHWC3055LS

30" Wall Mount



## Signature Features

### Stainless Steel Canopy Design

Classic hood design is constructed of durable stainless steel and very attractive.

### Washable Filters

Dishwasher-safe for easy cleaning. The aluminum filter provides strength and durability not found in foam filters.

### Centrifugal Fan

Move air quietly and efficiently — up to 400 cu. ft. of air per minute.

### Halogen Lighting

For bright illumination of the cooktop surface.

Features	
Nominal Width	30"
Installation Type	Wall Mount
Style	Stainless Steel/Chimney
Air Discharge	Vertical
Air Delivery (CFM)	400
Blower Type	Centrifugal
Controls	Electronic Push Button
Fan Speeds	3
Sound Level (dBA)	69.5
Dual Halogen Lights	Yes
Dishwasher-Safe Filters	Yes
Exhaust Duct	Convertible*
Duct Required	6" Round

Optional Accessories	
Duct-Free Kit	PN# FHWRKT55LS
10' Flue Extension Kit	PN# FHW10XS5LS

Specifications	
Product Dimensions -	
Height (With One Cover) (With Flue Extension)	26-25/32" min. 31-11/16" min. 45" max.
Width	29-7/8"
Depth	19-11/16"
Voltage Rating	120V/60Hz/15A
Amps @ 120 Volts	4.0
Connected Load (kW Rating) @ 120 Volts	0.516
Shipping Weight (Approx.)	80 Lbs.
Sones Rating	7.9

\*Ventilation is convertible to be either ducted outside, or recirculated inside requiring no ducting. (Recirculated option requires use of optional Duct-Free Kit.)  
†For use on adequately wired 120V, dedicated circuit having 2-wire service with a separate ground wire. Appliance must be grounded for safe operation.  
NOTE: Always consult local and national electric codes. Check local building codes for installation requirements, as they may vary per locale. Refer to Product Installation Guide for detailed installation instructions on the web at [frigidaire.ca](http://frigidaire.ca).

Specifications subject to change.

Available in:



Stainless  
(S)

[frigidaire.ca](http://frigidaire.ca)

SENATOR HOMES  
DECOR CENTRE  
JAN 15 2016

DATE: \_\_\_\_\_  
INITIALS: S.E.



T-60

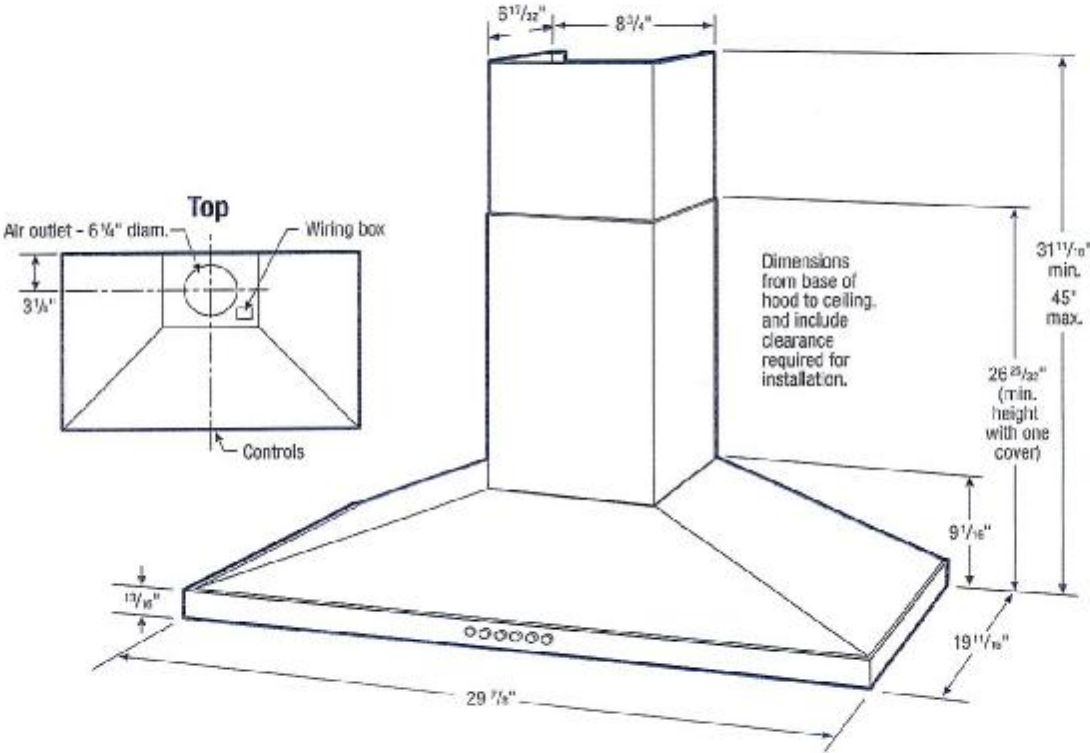

Chimney Wall-Mount Hood Specifications

- Product Shipping Weight (approx.) - 80 Lbs.
- Wall-Mount Installation
- Ventilation system is preset to exhaust air outside. If outside ducting is not possible, optional Duct-Free Recirculation Kit (PN# FHWRT55LS) is available to convert ventilation to allow air to recirculate inside. (Refer to Ducted Option Specifications for outside ventilation.)
- Sones Rating - 7.9
- Voltage Rating - 120V/60 Hz/15 Amps
- Connected Load (kW Rating) @ 120 Volts = 0.516 kW (For use on adequately wired 120V, dedicated circuit having 2-wire service with a separate ground wire. Appliance must be grounded for safe operation.)
- Amps @ 120 Volts = 4 Amps
- Always consult local and national electric codes. Check local building codes for installation requirements, as they may vary per locale.
- Minimum installation height allowed from bottom of hood to standard 36"-high electric or gas cooking surface is 26" - 35", (NOT more than 32" recommended.) For detailed instructions regarding install heights in 8', 9' and 10' ceiling applications, refer to installation guide on web.
- To prepare mounting surface, adequate structural support must be provided, capable of supporting 100 lbs.

Ducted Option Specifications

- For outside ventilation.
- Exhaust Duct Required - 6" round
- For most efficient airflow exhaust, use a straight run or as few elbows as possible.
- Use metallic flex ducting only to connect rigid duct directly to transitions (if allowed by code).
- Thermal breaks such as short section of nonmetallic duct, should be used in areas of extreme cold.
- Cold weather installations should have additional backdraft damper installed.
- Refer to installation instructions on web for detailed exhaust duct preparation and converting vent blower system for recirculating inside.

Note: For planning purposes only. Refer to Product Installation Guide on the web at [frigidaire.ca](http://frigidaire.ca) for detailed instructions.

Optional Accessories

- Duct-Free Recirculation Kit - (PN# FHWRT55LS).
- 10' Flue Extension Kit - (PN# FHW10X55LS).

Accessories information available on the web at [frigidaire.ca](http://frigidaire.ca)



FRIGIDAIRE

CANADA • 5855 Terry Fox Way • Mississauga, ON L5V 3E4 • 1-800-265-8352 • [frigidaire.ca](http://frigidaire.ca)  
FHWC3055LS 05/14

© 2014 Electrolux Major Appliances, NA

Specifications subject to change  
Printed in Canada

SENATOR HOMES  
DECOR CENTRE

DATE: JAN 15 2016  
INITIALS: S.E.

T-60  
SENATOR HOMES  
DECOR CENTRE

DATE: JAN 15 2016

INITIALS: S.E.

# 30" Electric Slide-in Range

800 Series - Stainless Steel HEI8054C



**HEI8054U**  
Stainless Steel

The newly designed full-depth electric slide-in range fits into any freestanding range cutout, and offers a flush built-in look.

## Features & Benefits

The new Bosch slide-in range fits in any freestanding range cutout.

Cook with a 6" or a 9" element.

At 4.6 cu. ft., a large oven capacity accommodates most pots and pans.

Genuine European convection for even baking results on multiple levels.

The warming drawer keeps everything you cook warm and ready to serve.

## General Properties

Cooking modes Variable Broil (hi & low), Roast, Warm, Proof, Convection Bake, Convection Broil, Convection Roast, Pizza, True Convection/Convection Multi-Rack, Fast Preheat, Sabbath

Cleaning type Self clean

Knob material Full metal

Drawer type Warming drawer

## Oven Performance

Bake element watts (W) 2,400 W

Broil element watts (W) 3,800 W

Convection element watts (W) 2,000 W

## Element Performance

Total number of cooktop elements 5

Power of front left element watts (W) 1,400 / 3,000 W

Power of back left element watts (W) 1,200 W

Power of centre element watts (W) 100 W

Power of back right element watts (W) 1,200 W

Power of front right element watts (W) 1,100 / 3,200 W



## Element Size

Dimension of front left heating element 6" / 9"

Dimension of back left heating element 6"

Dimension of centre heating element 6"

Dimension of back right heating element 6"

Dimension of front right heating element 9.5"

## Technical Details

Watts (W) 13,800 W

Circuit breaker (A) 40 A

Volts (V) 240 V

Frequency (Hz) 60 Hz

Plug type N/A

Cord length N/A

Energy source Electric

## Dimensions & Weight

Overall appliance dimensions (HxWxD)(in.) 36 1/2" x 31 1/2" x 28 7/8"

Required cutout size (HxWxD) (in.) 35 1/2" x 30" x 25"

Adjustable range height (in.) 1 1/2"

Net weight (lbs) 248 lbs

## Accessories-Included

Use and care manual, installation guide, mounting hardware, island trim, standard racks

## Accessories-Optional



**HEZTR301**  
30" Telescopic rack

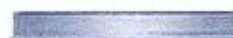

**HEZBS301**  
Low backguard

For help and assistance with Bosch accessories please call 1-800-944-2904 Mon-Fri 8am to 6pm EST

Notes: All height, width and depth dimensions are shown in inches. Please refer to installation instructions prior to making cutout. BSH reserves the absolute and unrestricted right to change product materials and specifications, at any time, without notice. Consult the product's installation instructions for final dimensional data and other details. Applicable product warranty can be found in accompanying product literature or you may contact your account manager for further details.

Warranties: Bosch warrants that the Product is free from defects in materials and workmanship for a period of three hundred and sixty-five (365) days from the date of purchase. The foregoing timeline begins to run upon the date of purchase, and shall not be stalled, tolled, extended, or suspended, for any reason whatsoever. This Product is also warranted to be free from cosmetic defects in material and workmanship (such as scratches of stainless steel, paint/porcelain blemishes, chip, dents, or other damage to the finish of the Product) for a period of thirty (30) days from the date of purchase or closing date for new construction. This cosmetic warranty excludes slight colour variations due to inherent differences in painted and porcelain parts, as well as differences caused by kitchen lighting, product location, or other similar factors. This cosmetic warranty specifically excludes any display, floor, "As is", or "B" stock appliances.

For more information on our entire line of products, go to [www.bosch-home.ca](http://www.bosch-home.ca) or call 1-800-944-2904

© 2014 BSH Home Appliances Canada. All rights reserved. Bosch is a registered trademark of Robert Bosch GmbH.



T-100  
SENATOR HOMES  
DECOR CENTRE

DATE: JAN 15 2016  
INITIALS: S.E.

## 30" Electric Slide-in Range

800 Series - Stainless Steel HEI8054C



### Installation Details

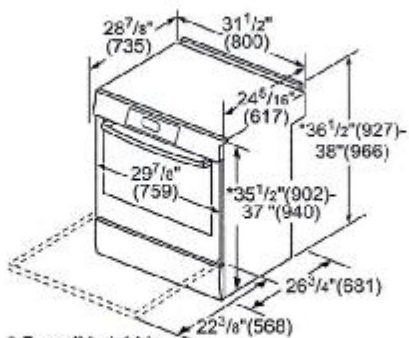

measurements in inches (mm)

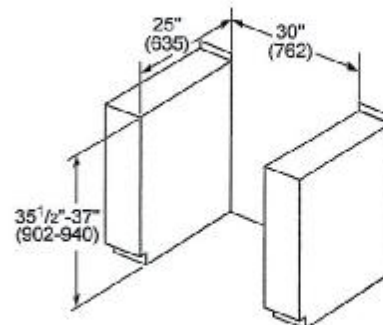

measurements in inches (mm)

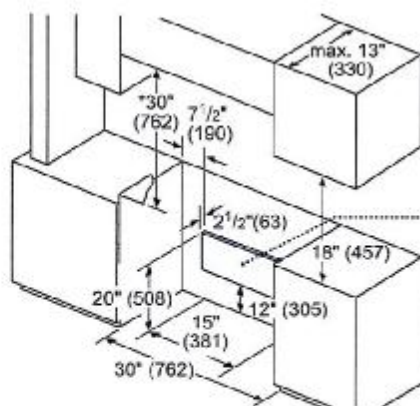

\* Minimum clearance of 30" required to overhead combustible surface. If installing overhead vent or over-the-range microwave, refer to clearances provided with these products.

208/240v Electrical Outlet Location

Measurements in inches (mm)

For help and assistance with Bosch accessories please call 1-800-944-2904 Mon-Fri 8am to 6pm EST

Notes: All height, width and depth dimensions are shown in inches. Please refer to installation instructions prior to making cutout. BSH reserves the absolute and unrestricted right to change product materials and specifications, at any time, without notice. Consult the product's installation instructions for final dimensional data and other details. Applicable product warranty can be found in accompanying product literature or you may contact your account manager for further details.

Warranties: Bosch warrants that the Product is free from defects in materials and workmanship for a period of three hundred and sixty-five (365) days from the date of purchase. The foregoing timeline begins to run upon the date of purchase, and shall not be stalled, tolled, extended, or suspended, for any reason whatsoever. This Product is also warranted to be free from cosmetic defects in material and workmanship (such as scratches of stainless steel, paint/porcelain blemishes, chip, dents, or other damage to the finish of the Product) for a period of thirty (30) days from the date of purchase or closing date for new construction. This cosmetic warranty excludes slight colour variations due to inherent differences in painted and porcelain parts, as well as differences caused by kitchen lighting, product location, or other similar factors. This cosmetic warranty specifically excludes any display, floor, "As Is", or "B" stock appliances.

For more information on our entire line of products, go to [www.bosch-home.ca](http://www.bosch-home.ca) or call 1-800-944-2904

© 2014 BSH Home Appliances Canada. All rights reserved. Bosch is a registered trademark of Robert Bosch GmbH.

SENATOR HOMES  
DECOR CENTRE

DATE: JAN 15 2016

INITIALS: J. E.

# 36" French Door Bottom-Freezer

800 Series - Stainless Steel B26FT70SNS



**BOSCH**  
Invented for life



**B26FT70SNS**  
Stainless Steel

The standard-depth French Door refrigerator offers large storage capacity and keeps your produce fresh longer.

## Features & Benefits

VitaFresh™ controls humidity and temperature to keep food fresh.

Bright ALL LED Lighting shines throughout the entire interior.

Dispenses fresh-tasting water, crushed ice and cubed ice.

Stainless Steel Touch Control offers an easy-to-use luxury detail.

## General Properties

Water filter	Yes
Lighting	LED
Defrost process refrigerator section	Frost-free
Number of shelves - refrigerator	5
Adjustable shelves - refrigerator	4 half-width
Shelf material - refrigerator	Tempered glass
Type of shelves - refrigerator	Spill-proof glass
Gallon storage bins	2
Humidity control drawer	2
Defrost process freezer section	Automatic
Number of drawers - freezer	2
Ice maker	Yes
Quick ice	Yes

## Capacity

Total unit gross capacity (cu. ft.) - AHAM	25.9 cu. ft.
Refrigerator gross capacity (cu. ft.)	16.9 cu. ft.
Freezer gross capacity (cu. ft.)	9 cu. ft.



## Technical Details

Current (A)	15 A
Volts (V)	120 V
Frequency (Hz)	60 Hz
Power cord length (in.)	62"
Plug type	120V-3 prong

## Dimensions & Weight

Appliance dimensions (H x W x D) (in.)	69 3/4" x 35 5/8" x 33 13/32"
Required cutout size (H x W x D) (in.)	69" x 36" x 30 1/8"
Net weight (lbs)	248 lbs

## Efficiency

ENERGY STAR® qualified	No
Energy consumption (kWh/yr)	710 kWh

## Accessories-Included

Included	Egg box with lid
----------	------------------



For help and assistance with Bosch accessories please visit: [www.bosch-eshop.com/eshop/bosch/us](http://www.bosch-eshop.com/eshop/bosch/us) or call 1-800-944-2904 Mon-Fri 9am to 6pm PST Sat 9am to 3pm PST

Notes: All height, width and depth dimensions are shown in inches. Please refer to installation instructions prior to making cutout. BSH reserves the absolute and unrestricted right to change product materials and specifications, at any time, without notice. Consult the product's installation instructions for final dimensional data and other details. Applicable product warranty can be found in accompanying product literature or you may contact your account manager for further details.

Warranties: Bosch warrants that the Product is free from defects in materials and workmanship for a period of three hundred and sixty-five (365) days from the date of purchase. The foregoing timeline begins to run upon the date of purchase, and shall not be stalled, tolled, extended, or suspended, for any reason whatsoever. This Product is also warranted to be free from cosmetic defects in material and workmanship (such as scratches on stainless steel, paint/porcelain blemishes, chip, dent, or other damage to the finish of the Product, for a period of thirty (30) days from the date of purchase or closing date for new construction. This cosmetic warranty excludes slight color variations due to inherent differences in painted and porcelain parts, as well as differences caused by kitchen lighting, product location, or other similar factors. This cosmetic warranty specifically excludes any display, floor, "As Is", or "B" stock appliances.

For more information on our entire line of products, go to [www.bosch-home.com/us](http://www.bosch-home.com/us) or call 1-800-944-2904

© BSH Home Appliances Corporation. All rights reserved. Bosch is a registered trademark of Robert Bosch GmbH.



T-60  
 SENATO DECOR  
 DATE: JAN 15 2016  
 INITIALS: S. E.

# 36" French Door Bottom-Freezer

800 Series – Stainless Steel B26FT70SNS



## Installation Details

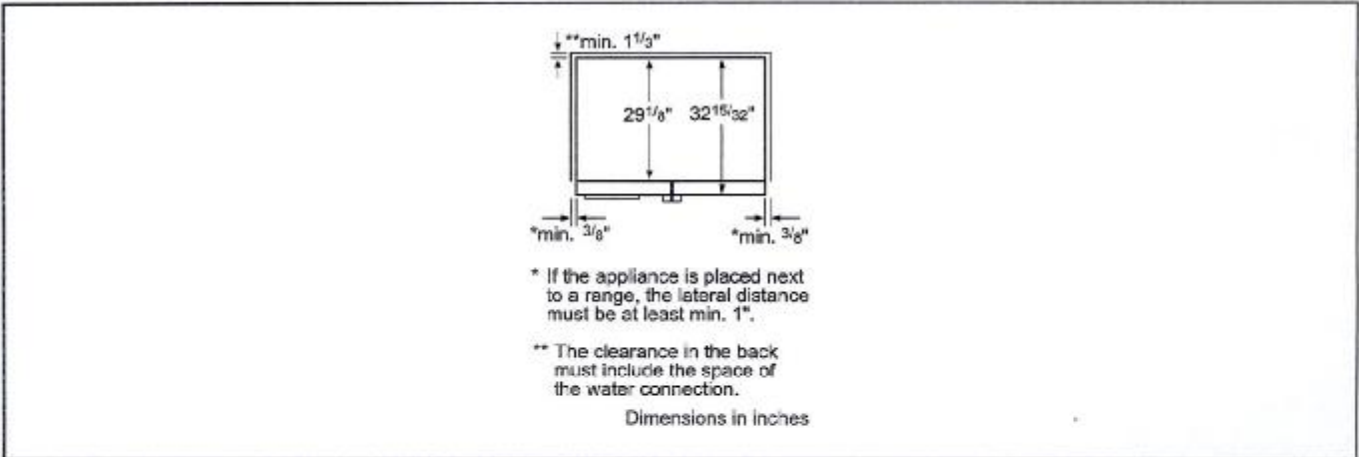
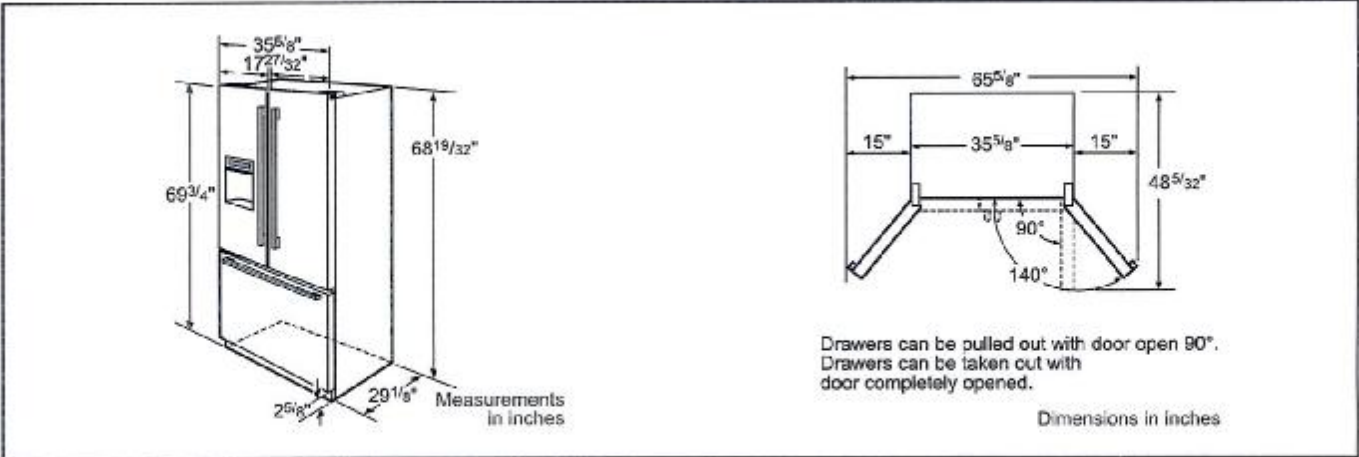

For help and assistance with Bosch accessories please visit: [www.bosch-eshop.com/eshop/bosch/us](http://www.bosch-eshop.com/eshop/bosch/us) or call 1-800-944-2904 Mon-Fri 5am to 6pm PST Sat 6am to 3pm PST

Notes: All height, width and depth dimensions are shown in inches. Please refer to installation instructions prior to making cutout. BSH reserves the absolute and unrestricted right to change product materials and specifications, at any time, without notice. Consult the product's installation instructions for final dimensional data and other details. Applicable product warranty can be found in accompanying product literature or you may contact your account manager for further details.

Warranties: Bosch warrants that the Product is free from defects in materials and workmanship for a period of three hundred and sixty-five (365) days from the date of purchase. The foregoing timeline begins to run upon the date of purchase, and shall not be stalled, tolled, extended, or suspended, for any reason whatsoever. This Product is also warranted to be free from cosmetic defects in material and workmanship (such as scratches of stainless steel, paint/porcelain blemishes, chip, dents, or other damage to the finish of the Product, for a period of thirty (30) days from the date of purchase or closing date for new construction. This cosmetic warranty excludes slight color variations due to inherent differences in painted and porcelain parts, as well as differences caused by kitchen lighting, product location, or other similar factors. This cosmetic warranty specifically excludes any display, floor, "As Is", or "B" stock appliances.

For more information on our entire line of products, go to [www.bosch-home.com/us](http://www.bosch-home.com/us) or call 1-800-944-2904

© BSH Home Appliances Corporation. All rights reserved. Bosch is a registered trademark of Robert Bosch GmbH.



# 24" Bar Handle Dishwasher

500 Series - Stainless Steel SHX65T55UC



**SHX65T55UC**  
 Stainless Steel

The new 3rd rack now offers 30% more loading area. Perfect for ramekins, cooking utensils and extra-long silverware.

## Features & Benefits

44 dBA - Quietest dishwasher brand.

New 3rd rack adds versatility and offers 30% more loading capacity.

Detergent tray optimizes detergent dissolving.

InfoLight® shines on the floor so you know the dishwasher's running.

RackMatic® offers 3 height levels, for 9 possible rack positions.

## General Properties

Number of wash cycles	5
Number of options	5
dBA	44
Third rack	Standard
Rack adjustability	RackMatic®
Tub material	Stainless steel
Control type	Buttons
Concealed heating element	Yes
Leak protection system	24/7 AquaStop®
Water softener	No
Five-level wash	Yes
ChildLock	No
Special features	InfoLight®

## Efficiency

Water usage per cycle	2.9
Energy efficiency class	Tier 1
ENERGY STAR® qualified	Yes
Total annual energy consumption (kWh)	259
Total annual water consumption (g)	624

## Capacity

Number of place settings	15
--------------------------	----



## Technical Details

Watts (W)	1300 W
Current (A)	12 Amps
Volts (V)	120 V
Frequency (Hz)	60 Hz
Power cord length	56 5/16"
Minimum water pressure (lb/sin)	14
Length inlet hose (in)	60"
Length outlet hose (in)	79"

## Dimensions & Weight

Overall appliance dimensions (HxWxD) (in)	33 7/8" x 23 9/16" x 23 3/4"
Required cutout size (HxWxD) (in)	33 7/8" x 23 5/8" x 24"
Adjustable feet	Yes
Net weight (lbs)	91 lbs

## Accessories—Optional

Dishwasher Supply and Drainage Hose Extension 76 3/4"	SGZ1010UC
Dishwasher 3-Prong Power Cord 66 7/8"	SMZPC002UC
Dishwasher Accessory Kit	SMZ5000
Duo-Flex Silverware Basket	SMZ4000UC



For help and assistance with Bosch accessories please visit: [www.bosch-eshop.com/eshop/bosch/us](http://www.bosch-eshop.com/eshop/bosch/us) or call 1-800-944-2904 Mon-Fri 9am to 6pm PST Sat 9am to 3pm PST

Notes: All height, width and depth dimensions are shown in inches. Please refer to installation instructions prior to making cutout. BSH reserves the absolute and unrestricted right to change product materials and specifications, at any time, without notice. Consult the product's installation instructions for final dimensional data and other details. Applicable product warranty can be found in accompanying product literature or you may contact your account manager for further details.

Warranty: Bosch warrants that the Product is free from defects in materials and workmanship for a period of three hundred and sixty-five (365) days from the date of purchase. The foregoing timeline begins to run upon the date of purchase, and shall not be stalled, tolled, extended, or suspended, for any reason whatsoever. This Product is also warranted to be free from cosmetic defects in material and workmanship (such as scratches of stainless steel, paint/porcelain blemishes, chip, dents, or other damage to the finish of the Product, for a period of thirty (30) days from the date of purchase or closing date for new construction. This cosmetic warranty excludes slight color variations due to inherent differences in painted and porcelain parts, as well as differences caused by kitchen lighting, product location, or other similar factors. This cosmetic warranty specifically excludes any display, floor, "As Is", or "B" stock appliances.

For more information on our entire line of products, go to [www.bosch-home.com/us](http://www.bosch-home.com/us) or call 1-800-944-2904

© BSH Home Appliances Corporation. All rights reserved. Bosch is a registered trademark of Robert Bosch GmbH.



INITIALS: S.E.

© BSH Home Appliances Corporation. All rights reserved. Bosch is a registered trademark of Robert Bosch GmbH.

# 24" Bar Handle Dishwasher

500 Series – Stainless Steel SHX65T55UC



## Installation Details

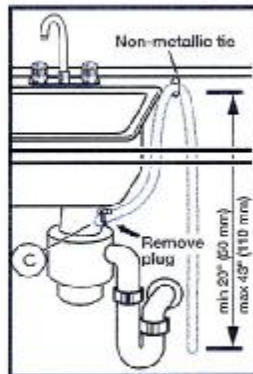
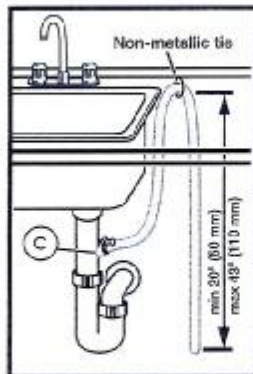

Note: Plumbing installations will vary - refer to local codes. Drain hose included is 79 (201 cm) and can be extended to a maximum of 155 3/4" (396 cm).

Always use the approved drain hose extension kit (SGZ1010UC).

Ensure a portion of the drain hose is raised between min. 20" (50 cm) and max. 43" (110 cm) above the cabinet floor.

For help and assistance with Bosch accessories please visit: [www.bosch-eshop.com/eshop/bosch/us](http://www.bosch-eshop.com/eshop/bosch/us) or call 1-800-944-2904 Mon-Fri 5am to 6pm PST Sat 6am to 3pm PST

Notes: All height, width and depth dimensions are shown in inches. Please refer to installation instructions prior to making cutout. BSH reserves the absolute and unrestricted right to change product materials and specifications, at any time, without notice. Consult the product's installation instructions for final dimensional data and other details. Applicable product warranty can be found in accompanying product literature or you may contact your account manager for further details.

Warranties: Bosch warrants that the Product is free from defects in materials and workmanship for a period of three hundred and sixty-five (365) days from the date of purchase. The foregoing timeline begins to run upon the date of purchase, and shall not be stalled, tolled, extended, or suspended, for any reason whatsoever. This Product is also warranted to be free from cosmetic defects in material and workmanship (such as scratches of stainless steel, paint/porcelain blemishes, chip, dents, or other damage to the finish of the Product, for a period of thirty (30) days from the date of purchase or closing date for new construction. This cosmetic warranty excludes slight color variations due to inherent differences in painted and porcelain parts, as well as differences caused by kitchen lighting, product location, or other similar factors. This cosmetic warranty specifically excludes any display, floor, "As Is", or "E" stock appliances.

For more information on our entire line of products, go to [www.bosch-home.com/us](http://www.bosch-home.com/us) or call 1-800-944-2904

© BSH Home Appliances Corporation. All rights reserved. Bosch is a registered trademark of Robert Bosch GmbH.