



PURCHASER'S EXTRAS
North 88 - North 88 Developments Inc.

PURCHASER: HANXIANG LIU

LOT NUMBER	PHASE	HOUSE TYPE
54 Block 8	1	Carnation-Elev A

EXTRAS/UPGRADES INCLUDED IN PURCHASE PRICE

- 1). **5 FREE APPLIANCES** - FRIDGE, STOVE, WASHER, DRYER, AND DISHWASHER (**SUPPLIED ONLY NOT INSTALLED**, FROM BUILDERS STANDARD LINE) *** TO ARRANGE DELIVERY - CALL THE BRICK COMMERCIAL SALES DIVISION **1-877-843-2742**
- 2). **Bell Fibe Line:** 6 Months Free TV, Phone and Internet Services. As per Bell offer. See certificate for details.

This is your direction to install the above extras in accordance with the following terms and conditions:

1. In the event the work on the house has progressed beyond the point where the items covered by this extra cannot be installed without entailing any unusual expense, then this order is to be cancelled and any deposit paid in connection with the same is to be refunded to the purchaser.
2. The Vendor will undertake to incorporate the work covered by the sales extra in the construction of the house but will not be liable to the purchaser in any way, if for any reason the work covered by the extra is not carried out. In that event, any monies paid in connection with the same shall be returned to the purchaser.
3. It is understood and agreed that if for any reason whatsoever the transaction of Purchase and Sale is not completed, the total cost of extras ordered are not refundable to the Purchaser(s).
4. Extras or changes will not be processed unless signed by the Vendor.
5. These extras may not be amended without the written consent of North 88 Developments Inc.
6. The purchaser(s) and the builder acknowledge and agree that this "Purchaser's Extra" form shall not be deemed to be part of the agreement of purchase and sale entered into between them, nor an addendum thereto.

CONSTRUCTION SCHEDULING APPROVAL

PER: _____

DATE: _____



CONSTRUCTION SUMMARY

North 88 Developments Inc. / North 88

Lot/Unit: 54 Block 8 Phase/Building: 1 Model/Floor Plan: Carnation-Elev A

CABINETRY APPLIANCE - FRIDGE

Inv.3202	1 - SUPPLY AND INSTALL 59 CM FRIDGE CABINET - 1 GABLE & CABINET 59 CM DEEP - DEEP - STANDARD LINE	
Line 39952	Note:	
14Sep15 / 14Sep15		

CABINETRY BASE CABINETS

Inv.3202	3 - SUPPLY AND INSTALL APPROX THREE [3] FEET OF STANDARD LINE BASE CABINETS TO THE ISLAND AS PER SKETCH	
Line 39968	Note:	
14Sep15 / 14Sep15		

CABINETRY HARDWARE

Inv.3202	1 - SUPPLY AND INSTALL VANITY - CABINET HARDWARE - UPGRADE 2 - DISPLAY BOARD TO THE MASTER ENSUITE VANITY	
Line 39942	Note:	
14Sep15 / 14Sep15		

CABINETRY MICROWAVE OVEN STOVE COOKTOP

Inv.3202	1 - SUPPLY AND INSTALL ACCOMMODATION FOR FUTURE OVER THE RANGE MICROWAVE.	
Line 39961	Note:	
14Sep15 / 14Sep15		

CABINETRY VANITY

Inv.3202	1 - SUPPLY AND INSTALL VANITY BANK OF DRAWERS - 55 CM MAXIMUM - STANDARD LINE TO THE MASTER ENSUITE	
Line 39932	Note:	
14Sep15 / 14Sep15		

COUNTER TOP

Inv.3202	1 - SUPPLY AND INSTALL COUNTER TOP - 2CM WITH STANDARD EDGE FE20 - GROUP 5 - ENSUITE 3RD FLOOR	
Line 39931	Note:	
14Sep15 / 14Sep15		
Inv.3202	2 - SUPPLY AND INSTALL GRANITE CUTOUT AND POLISHED EDGE FOR UNDERMOUNT SINK IN THE MASTER ENSUITE	
Line 39951	Note: SINGLE HOLE FAUCET AND UNDERMOUNT SINK PURCHASED SEPARATELY.	
14Sep15 / 14Sep15		
Inv.3202	1 - SUPPLY AND INSTALL COUNTER TOP - 2CM WITH STANDARD EDGE FE20 - GROUP 2 - KITCHEN	
Line 39971	Note:	
14Sep15 / 14Sep15		

ELECTRICAL

Inv.3202	1 - SUPPLY AND INSTALL SIX [6] MINI LOW VOLTAGE HALOGEN POT LIGHT - 1ST FLOOR - IN THE LIVING ROOM ON EXISTING SWITCH. TERMINATE CONNECTION TO SWITCHED OUTLET (OUTLET TO REMAIN) AND USE EXISTING SWITCH.	
Line 39956	Note: LOCATION SKETCH ATTACHED	
14Sep15 / 14Sep15		



CONSTRUCTION SUMMARY

North 88 Developments Inc. / North 88

Lot/Unit: 54 Block 8 Phase/Building: 1 Model/Floor Plan: Carnation-Elev A

Inv.3202	1 - SUPPLY AND INSTALL FOUR [4] MINI LOW VOLTAGE HALOGEN POT LIGHT - 1ST FLOOR - IN THE DINING ROOM ON A SEPARATE SWITCH (SWITCH PURCHASED SEPARATELY.	
Line 39957	Note: LOCATION SKETCH ATTACHED	
14Sep15 / 14Sep15		
Inv.3202	1 - SUPPLY AND INSTALL ADDITIONAL INTERIOR SINGLE POLE SWITCH FOR THE DINING ROOM POTLIGHTS	
Line 39958	Note: LOCATION AS PER SKETCH ATTACHED.	
14Sep15 / 14Sep15		
Inv.3202	1 - SUPPLY AND INSTALL CAPPED CEILING LIGHT ROUGH-IN ONLY ON SEPARATE SINGLE SWITCH OVER THE BREAKFAST ISLAND AS PER SKETCH. TO BE SWITCHED WITH ADDITIONAL PURCHASED CAPPED OUTLET.	
Line 39959	Note: LOCATION AS PER SKETCH ATTACHED.	
14Sep15 / 14Sep15		
Inv.3202	1 - SUPPLY AND INSTALL CAPPED CEILING LIGHT ROUGH-IN ONLY ON EXISTING SWITCH OVER THE BREAKFAST ISLAND. TO BE SWITCHED WITH ADDITIONAL PURCHASED CAPPED OUTLET.	
Line 39960	Note: LOCATION AS PER SKETCH ATTACHED.	
14Sep15 / 14Sep15		
Inv.3202	1 - SUPPLY AND INSTALL ADDITIONAL INTERIOR RECEPTACLE ON SEPARATE CIRCUIT (IE: MICROWAVE, FREEZER) FOR FUTURE OVER THE RANGE MICROWAVE.	
Line 39962	Note: LOCATION AS PER SKETCH ATTACHED.	
14Sep15 / 14Sep15		
Inv.3202	1 - SUPPLY AND INSTALL CAPPED CEILING LIGHT ROUGH-IN ONLY ON SEPARATE SINGLE SWITCH OVER THE MASTER ENSUITE TUB AS PER SKETCH	
Line 39963	Note: LOCATION AS PER SKETCH ATTACHED.	
14Sep15 / 14Sep15		
Inv.3202	1 - SUPPLY AND INSTALL ADDITIONAL INTERIOR RECEPTACLE (NOT SEPARATE CIRCUIT) OVER THE FIREPLACE IN THE LIVING ROOM APPROX 60 " +/- FROM THE FLOOR	
Line 39964	Note: LOCATION AS PER SKETCH ATTACHED.	
14Sep15 / 14Sep15		
Inv.3202	1 - SUPPLY AND INSTALL ADDITIONAL 3 WAY SWITCH 1 LIGHT OPERATES BY 2 SWITCHES IN THE MASTER BEDROOM.	
Line 39966	Note: LOCATION AS PER SKETCH ATTACHED.	
14Sep15 / 14Sep15		

FIREPLACE

Inv.3202	1 - SUPPLY AND INSTALL STANDARD BLF50 FIREPLACE AT APPROXIMATELY 21" +/- FROM THE FLOOR TO THE BOTTOM OF THE FIREPLACE IN THE LIVING ROOM	
Line 39965	Note:	
14Sep15 / 14Sep15		

HARDWOOD

Inv.3202	1 - SUPPLY AND INSTALL HARDWOOD - UPGRADE 3 - VINTAGE - SOLID SAWN - WHITE OAK 5 INCH X 3/4 INCH - HAND SCRAPPED - INSTALLED - - HALL - 2ND FLOOR HALL	
Line 39926	Note:	
14Sep15 / 14Sep15		



CONSTRUCTION SUMMARY

North 88 Developments Inc. / North 88

Lot/Unit: 54 Block 8 Phase/Building: 1 Model/Floor Plan: Carnation-Elev A

Inv.3202	1 - SUPPLY AND INSTALL HARDWOOD - UPGRADE 3 - VINTAGE - SOLID SAWN - WHITE OAK 5 INCH X 3/4 INCH - HAND SCRAPED - INSTALLED - - MASTER BEDROOM - 3RD FLOOR	
Line 39927	Note:	
14Sep15 / 14Sep15		
Inv.3202	1 - SUPPLY AND INSTALL HARDWOOD - UPGRADE 3 - VINTAGE - SOLID SAWN - WHITE OAK 5 INCH X 3/4 INCH - HAND SCRAPED - UPGRADE F - - DINING ROOM	
Line 39928	Note:	
14Sep15 / 14Sep15		
Inv.3202	1 - SUPPLY AND INSTALL HARDWOOD - UPGRADE 3 - VINTAGE - SOLID SAWN - WHITE OAK 5 INCH X 3/4 INCH - HAND SCRAPED - UPGRADE F - - KITCHEN	
Line 39929	Note: TO BE INSTALLED ON THE BREAKFAST SIDE OF THE KITCHEN ONLY AS THE KITCHEN WILL RECEIVE TILE. PURCHASER CHARGED FOR 1/4 OF THE SPACE.	
14Sep15 / 14Sep15		
Inv.3202	1 - SUPPLY AND INSTALL HARDWOOD - UPGRADE 3 - VINTAGE - SOLID SAWN - WHITE OAK 5 INCH X 3/4 INCH - HAND SCRAPED - UPGRADE F - - LIVING ROOM	
Line 39930	Note:	
14Sep15 / 14Sep15		

MISCELLANEOUS

PLUMBING

Inv.3202	2 - SUPPLY AND INSTALL CONTRAC CATENA RECTANGULAR UNDERMOUNT SINK MODEL 4210CIY IN THE MASTER ENSUITE	
Line 39950	Note:	
14Sep15 / 14Sep15		
Inv.3202	1 - SUPPLY AND INSTALL WATERLINE ROUGH-IN TO THE FRIDGE LOCATION (NO HOOK UP)	
Line 39967	Note: LOCATION AS PER SKETCH ATTACHED.	
14Sep15 / 14Sep15		

PLUMBING - KITCHEN FAUCETS:

Inv.3202	1 - SUPPLY AND INSTALL 90 DEGREE SERIES SINGLE HANDLE PULLOUT KITCHEN FAUCET MODEL S7597 IN CHROME	
Line 39949	Note:	
14Sep15 / 14Sep15		

PLUMBING - LAVATORY FAUCETS

Inv.3202	1 - SUPPLY AND INSTALL 90 DEGREE SERIES POSI-TEMP WITH 3 FUNCTION DIVERTER VALVE, SLIDE BAR WITH HANDHELD AND SHOWERHEAD MODEL 62320/3372/TS4172/TS2712EP/S3879EP/A721 IN CHROME IN THE MASTER ENSUITE SHOWER	
Line 39948	Note:	
14Sep15 / 14Sep15		

TILE

Inv.3202	1 - SUPPLY AND INSTALL FLOOR TILE - UPGRADE 5 - - ENSUITE BATHROOM - FLOOR	
Line 39946	Note:	
14Sep15 / 14Sep15		



CONSTRUCTION SUMMARY

North 88 Developments Inc. / North 88

Lot/Unit: 54 Block 8 Phase/Building: 1 Model/Floor Plan: Carnation-Elev A

Inv.3202	1 - SUPPLY AND INSTALL STANDARD LEVEL FLOOR TILE TO THE KITCHEN SPACE ONLY AS PER SKETCH ATTACHED.	
Line 39947	Note: PURCHASER HAS BEEN CHARGED FOR 3/4 OF THE SPACE FOR TILE.	
14Sep15 / 14Sep15		

EXTRAS AS PER OFFER

Note:	
-------	--

Purchaser: HANXIANG LIU

Telephone Res. / Bus:

Property: 54 Block 8 of Plan -

Project: North 88 Developments Inc.

Decor Advisor: Diana Rojas

Model and Elevation: Carnation-Elev A

Layout Changes: ☐ Yes ☒ No

Sketch Attached: ☒ Yes ☐ No

Exterior Colour Scheme:

1. Cabinetry

	Style and Colour	Counter Top	Hardware
Kitchen / Breakfast	TORONTO MAPLE - SHALE GREY CL	GRANITE - SERENTA (GR2)	9677 HANDLE
Kitchen Island	TORONTO MAPLE - SHALE GREY CL	GRANITE - SERENTA (GR2)	9677 HANDLE
Laundry Room			
Powder Room	TORONTO MAPLE - SHALE GREY CL	MADURA PEARL 4922K-52	196 KNOB
Main Bathroom	TORONTO MAPLE - SHALE GREY CL	MADURA PEARL 4922K-52	196 KNOB
Master Ensuite Bathroom	HUDSON - ONTARIO WHITE	QUARTZ - 5141 (GR5)	12818 HANDLE
Second Ensuite Bathroom (If Applicable)			

Appliances

Custom Size Fridge

☐ Yes ☒ No

Valance Lighting

☐ Yes ☒ No

Microwave / Range Hood

☒ Yes ☐ No

Cooktop / Rangetop

☐ Yes ☒ No

Built in Wall Oven

☐ Yes ☒ No

Slide-in Range

☒ Yes ☐ No

Comment

STANDARD APPLIANCES. SEE SPECS FOR OTR M/W

2. Flooring

	Selection
FOYER	12X12 VENINA WHITE
Main Hall	
Back Hall	
Breakfast	5" VINTAGE HANDSCRAPPED WHITE OAK - GOTHAM PEARL
Laundry Room	12X12 VENINA WHITE
Kitchen	12X12 VENINA WHITE
Powder Room	12X12 VENINA WHITE
Main Bathroom	12X12 VENINA WHITE
Master Ensuite	12X24 CALACATTA VINTAGE HONED - WHITE
Bathroom (If Applicable)	
Mud Room	
Living Room	5" VINTAGE HANDSCRAPPED WHITE OAK - GOTHAM PEARL
Dining Room	5" VINTAGE HANDSCRAPPED WHITE OAK - GOTHAM PEARL
Family / Great Room	PAPILIO - 19513 PALE FACES
Den / Library / Study	
Basement Landing (If Applies)	
Lower Landing (If Applicable)	
Upper Landing	
Upper Hall	5" VINTAGE HANDSCRAPPED WHITE OAK - GOTHAM PEARL
Master Bedroom	5" VINTAGE HANDSCRAPPED WHITE OAK - GOTHAM PEARL
Bedroom #2	PAPILIO - 19513 PALE FACES
Bedroom #3	PAPILIO - 19513 PALE FACES
Bedroom #4	
Bedroom #5	

Flooring Continued on Page 2

Initial:

LL

Page 1 of 3



INTERIOR COLOUR SCHEME

N88 7107 54

Purchaser: HANXIANG LIU

Property: 54 Block 8 of Plan -

Telephone Res. / Bus:

Project: North 88 Developments Inc.

Decor Advisor: Diana Rojas

Model and Elevation: Carnation-Elev A

2. Flooring - Continued -

Upgrade Underpad	Type	Area
	STND	BDRM 2 & 3, FAM ROOM
Carpet on Stairs	Capped	Runner - *Upgrade
Comment		

3. Plumbing Fixtures / Faucets

Kitchen	UPG	Second Ensuite		Powder Room	UPG
Master Ensuite	UPG			Other Room	
Main Bathroom	STND				

Comment

4. Wall Tile

	Tile Selection	Listello	Insert	Insert Selection
Main Bathroom	8X10 REFLECTION - WHITE	<input type="checkbox"/>	<input type="checkbox"/>	
Master Ensuite				
Tub Deck		<input type="checkbox"/>	<input type="checkbox"/>	
Tub Apron		<input type="checkbox"/>	<input type="checkbox"/>	
Tub Surround		<input type="checkbox"/>	<input type="checkbox"/>	
Shower Stall	8X10 WEAVE - WHITE	<input type="checkbox"/>	<input type="checkbox"/>	
Second Ensuite		<input type="checkbox"/>	<input type="checkbox"/>	
		<input type="checkbox"/>	<input type="checkbox"/>	
		<input type="checkbox"/>	<input type="checkbox"/>	
Kitchen Backsplash		<input type="checkbox"/>	<input type="checkbox"/>	
Complete Backsplash		<input type="checkbox"/>	<input type="checkbox"/>	

Comment

5. Fireplace

	Living Room			Family Room			Other Room - Specify		
	Purchased	As Per Plan	N/A	Purchased	As Per Plan	N/A	Purchased	As Per Plan	N/A
	<input type="radio"/>	<input checked="" type="radio"/>	<input type="radio"/>	<input type="radio"/>	<input type="radio"/>	<input type="radio"/>	<input type="radio"/>	<input type="radio"/>	<input type="radio"/>

Fireplace Type	STND BLF50		
Mantle Type			
Over Mantle			
Colour / Stain			
Surround			
Hearth			

Comment

*** TO BE INSTALLED APPROX 21" +/- FROM FLOOR TO BOTTOM OF FIREPLACE

Initial:

Page 2 of 3

Purchaser: HANXIANG LIU
Telephone Res. / Bus:
Decor Advisor: Diana Rojas

Property: 54 Block 8 of Plan -
Project: North 88 Developments Inc.
Model and Elevation: Carnation-Elev A

6. Trim Carpentry

Door Hardware

Interior Trim

Comment

Interior Doors

☐ 2 Panel Arch Top

☒ 2 Panel Square Top

☐ 6 Panel



Initial for Door Style LHx

7. Railings and Pickets

Railing Package

Railing Colour

Wood Stairs ☐ No ☒ Oak

Picket Colour

Tread Colour

Comment

8. Plaster Mouldings and Medallions

Foyer	<input type="text"/>	<input type="text"/>
Main Hall	<input type="text"/>	<input type="text"/>
Living Room	<input type="text"/>	<input type="text"/>
Dining Room	<input type="text"/>	<input type="text"/>
Family Room	<input type="text"/>	<input type="text"/>

Kitchen/Breakfast	<input type="text"/>	<input type="text"/>
Den/Library	<input type="text"/>	<input type="text"/>
Lower Landing	<input type="text"/>	<input type="text"/>

Comment

9. Wall Paint

Smooth Ceilings ☐ First Floor
☐ First Floor incl. Second Floor Hall
☐ First and Second Floor
☐ Throughout
☐ Not Applicable

Trim Paint

10. Additional Comments

SMOOTH CEILINGS ON MAIN FLOOR

11. Disclaimers and Notes

- Colours of all materials are as close as possible to builder's selection, but not necessarily identical due to variances in manufacturing.
- Any extras listed above are null and void unless accompanied by a separate invoice/amendment. Said invoice must be paid in full.
- The Purchaser acknowledges that after Interior Colour Selection form is signed and dated, no further changes will be permitted other than re-selection due to unavailability. LHx Purchaser's Initials
- The Purchaser acknowledges reading and accepting the "Senator Homes Décor Centre Disclaimers" form. This document contains other miscellaneous disclaimers.

This Interior Colour Selection is final and approved by:

Purchaser:

Signature: LHx Date: 4/10/2015

Vendor:

DR
North 88 Developments Inc.

N 88 → lot 54

CARNATION TH1501

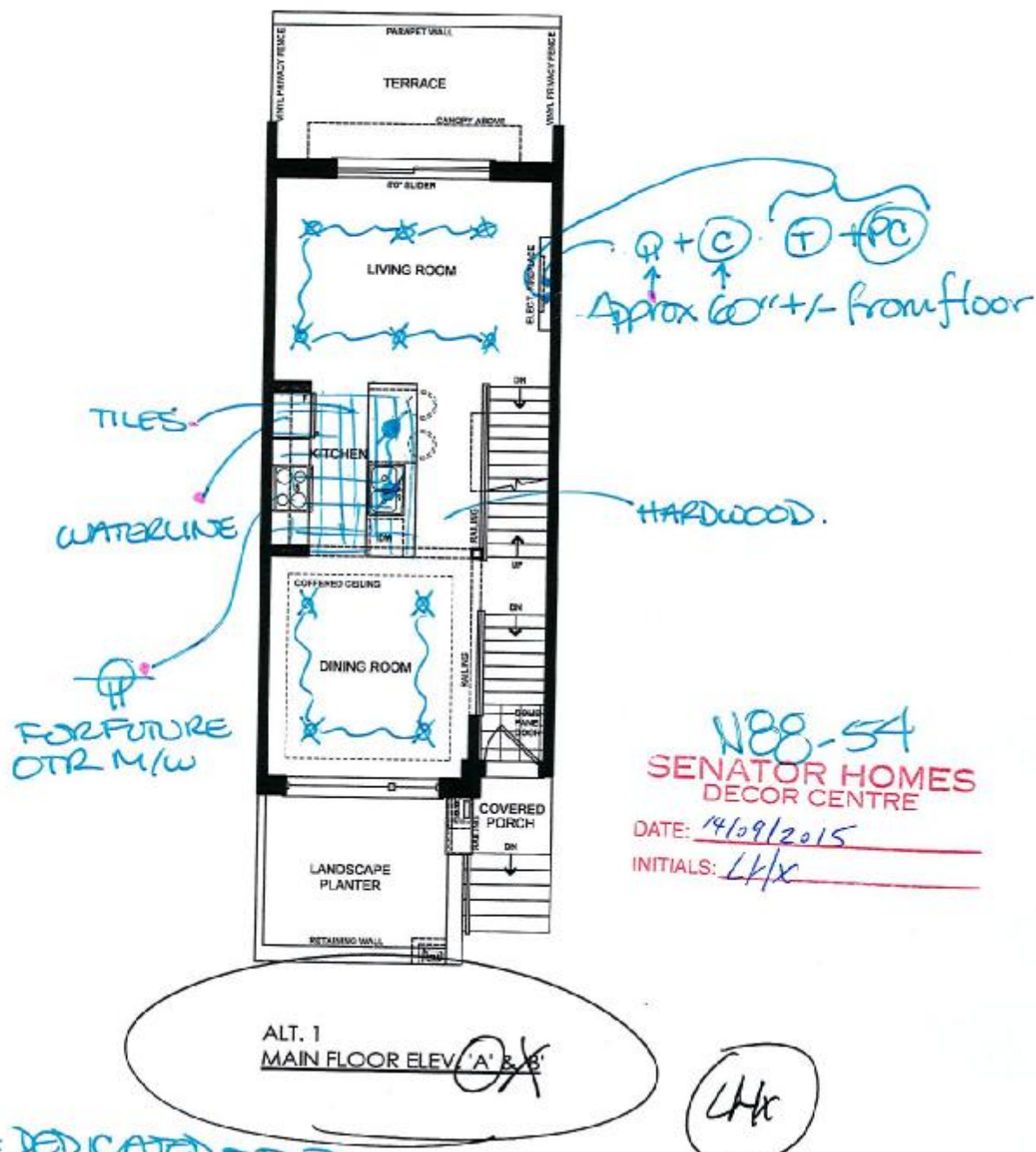

N88-54
SENATOR HOMES
DECOR CENTRE

DATE: 14/09/2015

INITIALS: LK/x

ALT. 1
MAIN FLOOR ELEV. 'A' & 'B'

- ⊕ = DEDICATED OUTLET
- ⊗ = POT LIGHTS
- ⬮ = CAPPED CEILING ROUGH-IN.
- Ⓢ = CABLE TV R/I
- Ⓣ = TELEPHONE R/I
- ⓈⓈ = COMPUTER OUTLET
- Ⓢ = ADDITIONAL RECEPTACLE

Lot 54
Carnation A

This plan is not to scale and subject to architectural review and revision, including without limitation, the Unit being constructed with a layout that is the reverse of that set out above. All drawings, floorplans, materials, specifications, details and dimensions, if any, are approximate and subject to change without notice. Bulkheads are not shown on this plan and may be located in areas of the Unit. Terraces, balconies and patios, if any, are exclusive use common elements, shown for display purposes only and location and size are subject to change without notice. Number of steps, window location, size and type may vary without notice. - March 13, 2014.

N88-71054

CARNATION TH1501

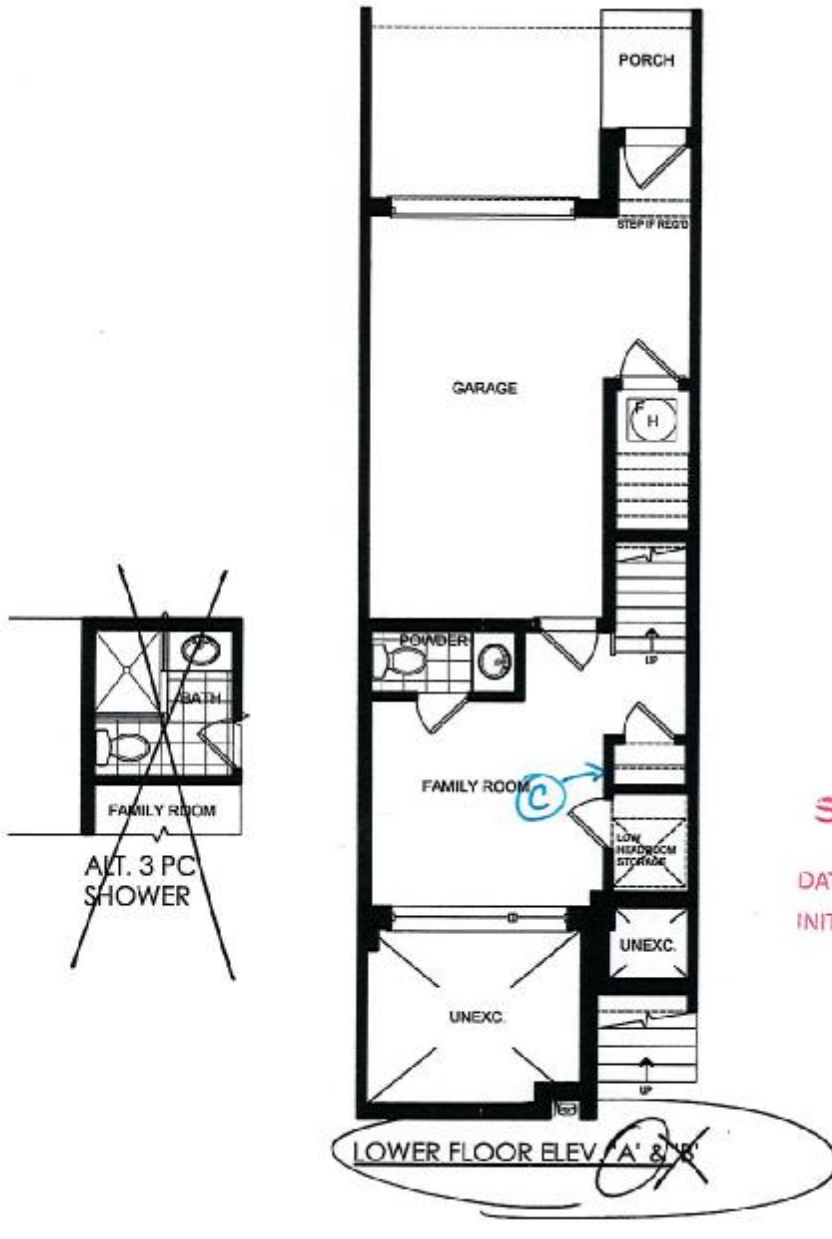

N88-54
SENATOR HOMES
DECOR CENTRE
DATE: 14/09/2015
INITIALS: LHX

Lot 54
Carnation A

N88-54

CARNATION
TH1501



N88-54
SENATOR HOMES
DECOR CENTRE
DATE: 14/09/2015
INITIALS: LHX

LHX

Lot 54
Carnation A

North 88 7/10 54

CARNATION TH1501

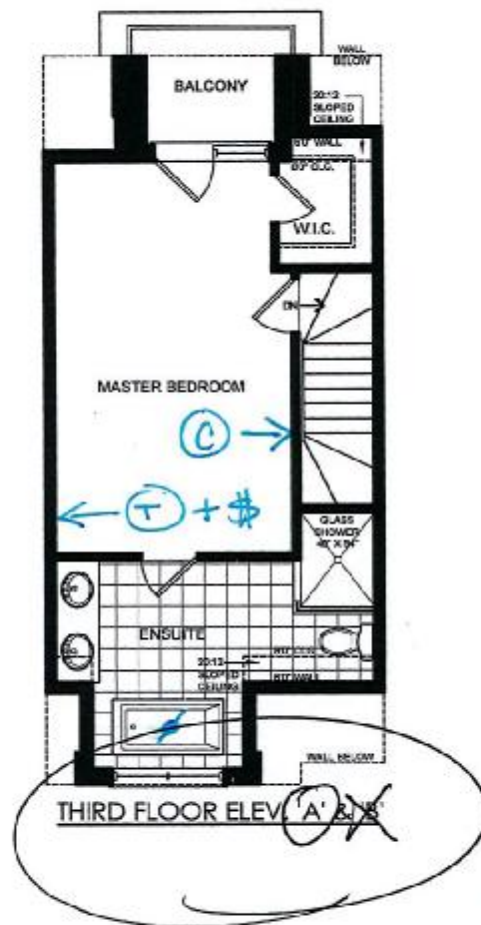

N88-54
SENATOR HOMES
DECOR CENTRE
DATE: 14/09/2015
INITIALS: LHx

- ⚡ = CRAPPED CEILING OUTLET
- © = CABLE TV R/I
- Ⓣ = TELEPHONE R/I
- \$ = SWITCH (3WAY SWITCH).

Lot 54
Carnation A

N887/01 54

CARNATION – TH1501

ALT. 1 & 2 LAYOUT

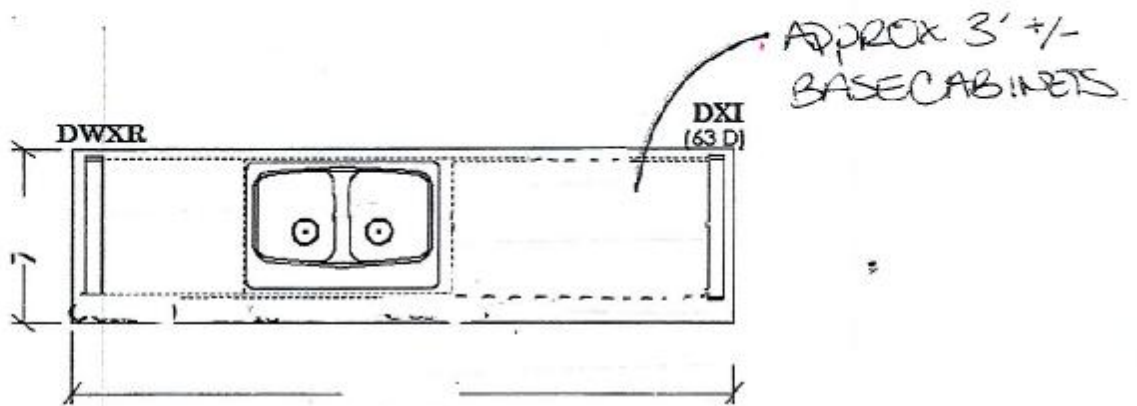
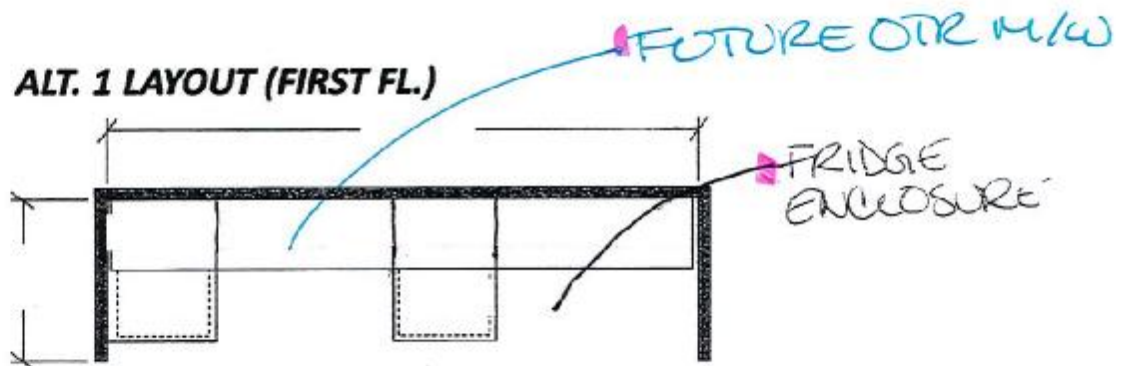

ALT 1. KITCHEN (FIRST FL) - ELEV A & B

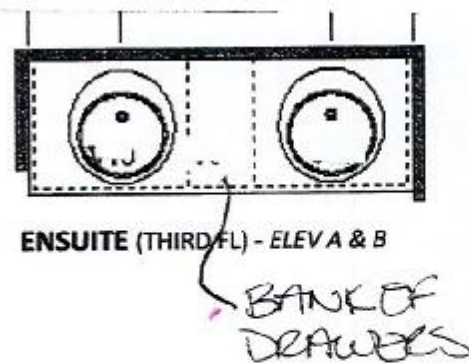

N8854
SENATOR HOMES
DECOR CENTRE

DATE: 14/09/2015

INITIALS: LHX



contrac

CATENA 20" RECTANGULAR UNDERMOUNT SINK

N88-54

□ 4210CIY Undermount Sink

Product Specs:

- Vitreous china
- Front overflow hole
- Template and mounting hardware supplied

Overall Dimensions (W x D x H):

(OD): 510mm(20") x 395mm(15½") x 190mm(7½")
(ID): 450mm(17¾") x 335mm(13½") x 140mm(5½")

Compliance Certifications:

- Meets or exceeds the following :
- IAPMO cUPC
 - ASME A112.19.2 / CSA B45.1-2008

Shipping:

Cube 1.72
GW 27 lbs



Colours To Be Specified:

- Colour: ☐ Soft White
☐ Bone (055)*
☐ Biscuit (066)*

Notes:

Dimensions of fixtures are nominal and may vary within the range of tolerances established by ASME standard A112.19.2. These measurements are subject to change or cancellation. No responsibility is assumed for use of superseded or voided pages.

*Bone and Biscuit available through Direct Import (CIF) only.

Detail of Mounting Clip

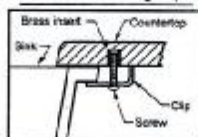

Note:
▲ Dimensions shown for location of supplies and "P" trap are suggested.

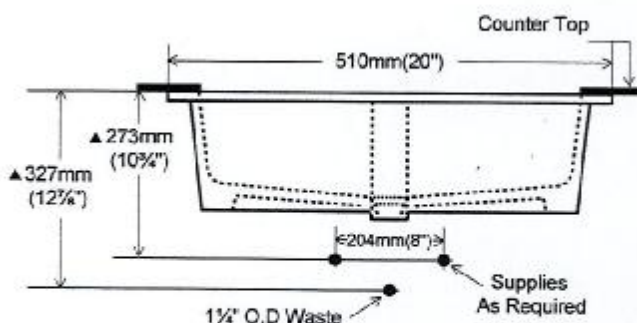
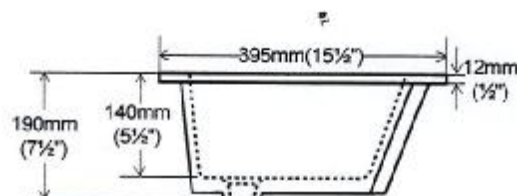
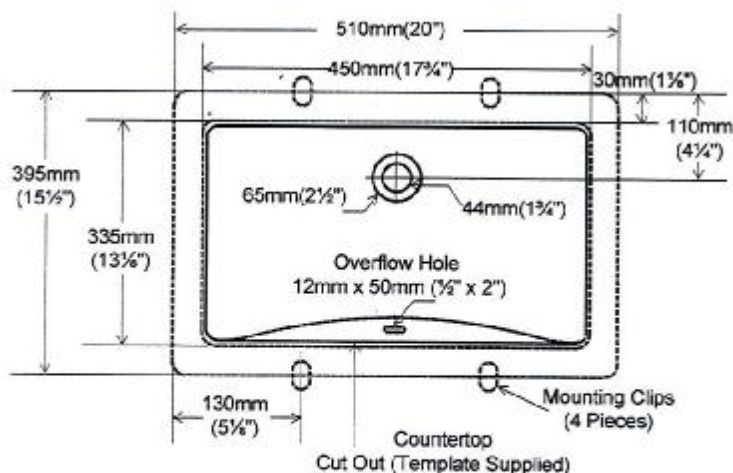

CONTRAC® 5970 Chedworth Way, Unit A, Mississauga, Ontario Canada L5R 3V5 • 1.888.256.7551
www.contrac.ca

Revised: January 2014

MASTER BEDROOM

N88 - 54
SENATOR HOMES
DECOR CENTRE

DATE: 14/09/2015
INITIALS: LHX

N88-7 lot 54

10

Modern

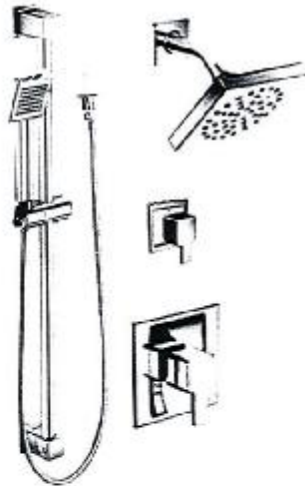

90TH Posi-Temp® with 3 Function Diverter Valve, Slide Bar with Handheld and Showerhead**

Model 62320 / 3372 / TS4172+ / TS2712EP+ / S3879EP+ / A721+

MASTER
ENSUITE SHOWER

N88-54

SENATOR HOMES
DECOR CENTRE

DATE: 14/09/2015

INITIALS: LHX

N88 → lot 54

gree

Modern



Single Handle Pullout Kitchen Faucet[®]

Model S7597+

KITCHEN

N8854

SENATOR HOMES
DECOR CENTRE

DATE: 14/09/2015

INITIALS: LHX



FRIGIDAIRE PROFESSIONAL 1.8 CU. FT. 2-IN1 OVER-THE-RANGE CONVECTION MICROWAVE

29-7/8" W x 16-1/16" D x 17-1/16" H
CPBM3077RF

Stainless Steel

SPECIFICATIONS

GENERAL SPECIFICATIONS

Professional Collection: Yes
Power Type: Electric
Size: 1.8 Cu. Ft.
Installation Type: Over-the-Range
Collection: Frigidaire Professional

EXTERIOR

Finish: Smudge-Proof™
Stainless Steel

USER MODES

User Preferences: Yes
Child Lock: Yes
Clock: Yes
Auto Start: Yes
Language (En/Fr/Sp): Yes
User Selectable Weight (lb/kg): Yes
Demo Mode: Yes

CUT-OUT DIMENSIONS

Cut-Out Width: 30"
Cut-Out Depth (Min): 12"
Cut-Out Depth (Max): 17"
Cut-Out Height (Min): 66"
Cut-Out Height (Max): 18"

CAPACITIES

Capacity (Cu. Ft.): 1.8

CONTROLS

Controls: Glass-Touch
Display Type: Blue LED
Display Colour: Blue
Touch Pad Buttons: 31
Electronic Clock: Yes
Timer Function: Yes
Stop / Cancel Button: Yes
Start Button: Yes
Add 30 Seconds: Yes
Turntable On / Off: Yes
Numeric Touch Pad: 31
Power Levels: 9

VENT & LIGHT SYSTEM

Exhaust Fan Speeds: 4 speeds
- 100 170 300 400 CFM
Vent Style: Hidden
Ducted / Ductless Vent
Installation: Convertible - outside or recirculated inside
Grease Filter (Dishwasher Safe): 1 - Yes
Charcoal Filter: Yes
Cooktop Light: Yes
Cooktop Light Wattage: 1.5
Lights: Yes
Heat Deflector: Yes
Auto-start Heat Sensor: Yes

CERTIFICATIONS & APPROVALS

CDRH Approval: No

MICROWAVE OVEN SPECIFICATIONS

Watts: 900
Microwave Turntable Diameter: 14-3/16"
Interior Light Wattage: 40
Frequency (Mhz): 2450

SENSOR FEATURES

Cooking - Multiple Stages: Yes
Sensor Cooking Options: Yes
Popcorn Button: Yes
Snack Button: Yes
Chicken Nuggets Button: No
Vegetable Cook Sensor: Yes
30-Minute Warm Hold: Yes

ACCESSORIES

Removable Metal Rack: Yes

ELECTRICAL SPECIFICATIONS

Power Supply Connection
Location: Right Rear Top
Voltage Rating: 120V / 60Hz / 15A
Connected Load (kW Rating) @ 120V: 1.65
Amps @ 120 Volts: 14.3

[download](#)

INTERNAL SPECIFICATIONS

Oven Interior: Stainless
Interior Light: LED
Microwave Interior Width: 21-1/4"
Microwave Interior Depth: 14-23/32"
Microwave Interior Height: 17-9/16"

AUTO FEATURES

Auto Cook Options: 9 Options - Frozen Breakfast Scrambled Eggs Hot Cereal Sou
Auto Defrost Options: Yes
Auto Melt / Soften Options: Yes
Snack Menu Options: No
Auto Reheat Options: Yes
Auto Defrost (Keep Warm): Yes

EXTERIOR DIMENSIONS

Width: 29-7/8"
Depth: 16-1/16"
Height: 17-1/16"

N88-54
SENATOR HOMES
DECOR CENTRE

DATE: 14/09/2015

INITIALS: LHX