



PURCHASER'S EXTRAS
North 88 - North 88 Developments Inc.

PURCHASER: Ling Feng Gu

LOT NUMBER	PHASE	HOUSE TYPE
26 Block 3	1	Lotus-Elev A

EXTRAS/UPGRADES INCLUDED IN PURCHASE PRICE

- 1). **5 FREE APPLIANCES** - FRIDGE, STOVE, WASHER, DRYER, AND DISHWASHER (**SUPPLIED ONLY NOT INSTALLED**, FROM BUILDERS STANDARD LINE) *** TO ARRANGE DELIVERY - CALL THE BRICK COMMERCIAL SALES DIVISION **1-877-843-2742**
- 2). **Bell Fibe Line:** 6 Months Free TV, Phone and Internet Services. As per Bell offer. See certificate for details.

This is your direction to install the above extras in accordance with the following terms and conditions:

1. In the event the work on the house has progressed beyond the point where the items covered by this extra cannot be installed without entailing any unusual expense, then this order is to be cancelled and any deposit paid in connection with the same is to be refunded to the purchaser.
2. The Vendor will undertake to incorporate the work covered by the sales extra in the construction of the house but will not be liable to the purchaser in any way, if for any reason the work covered by the extra is not carried out. In that event, any monies paid in connection with the same shall be returned to the purchaser.
3. It is understood and agreed that if for any reason whatsoever the transaction of Purchase and Sale is not completed, the total cost of extras ordered are not refundable to the Purchaser(s).
4. Extras or changes will not be processed unless signed by the Vendor.
5. These extras may not be amended without the written consent of North 88 Developments Inc.
6. The purchaser(s) and the builder acknowledge and agree that this "Purchaser's Extra" form shall not be deemed to be part of the agreement of purchase and sale entered into between them, nor an addendum thereto.

CONSTRUCTION SCHEDULING APPROVAL	
PER:	_____
DATE:	_____



CONSTRUCTION SUMMARY

North 88 Developments Inc. / North 88

Lot/Unit: 26 Block 3 Phase/Building: 1 Model/Floor Plan: Lotus-Elev A

AUDIO AND SECURITY

Inv.3239	1 - SUPPLY AND INSTALL EMPTY CONDUIT TO THE FAMILY ROOM. TERMINATION POINT "A" TO BE APPROX 5'5" +/- FROM THE FLOOR ABOVE THE FIREPLACE LOCATION AND TERMINATION POINT "B" TO BE BELOW TERIMATION POINT "A" APPROXY 36" +/- FROM FLOOR	
Line 40848	Note: TO BE LOCATED NEXT TO THE CABLE TV ROUGH IN - LOCATION AS PER VENDOR DISCRETION	
2Oct15 / 13Oct15		

CABINETRY ACCESSORIES

Inv.3239	1 - LOCATION: KITCHEN DIFFERENT COLOUR ISLAND THAN KITCHEN COLOUR LANCASTER MAPLE - NOCE NERO	
Line 40791	Note:	
2Oct15 / 13Oct15		
Inv.3239	1 - SUPPLY AND INSTALL PAN/FASCIA WITH CROWN MOULDING TO UPPER CABINETS IN KITCHEN.	
Line 40801	Note:	
2Oct15 / 13Oct15		

CABINETRY APPLIANCE - FRIDGE

Inv.3239	1 - 59 CM FRIDGE CABINET - 2 GABLES & CABINET 59 CM DEEP - DEEP - UPGRADE 1	
Line 40788	Note:	
2Oct15 / 13Oct15		

CABINETRY HARDWARE

Inv.3239	1 - KITCHEN - CABINET HARDWARE - UPGRADE 2 - 12818 HANDLE	
Line 40799	Note:	
2Oct15 / 13Oct15		

CABINETRY MICROWAVE OVEN STOVE COOKTOP

Inv.3239	1 - BUILT IN SINGLE APPLIANCE CABINET WITH POTS & PANS DRAWERS BELOW - TRIM KIT REQUIRED - PURCHASER MUST SUPPLY SPECS - UPGRADE 1	
Line 40786	Note:	
2Oct15 / 13Oct15		
Inv.3239	1 - COOKTOP CABINET (FULL HEIGHT) WITH FALSE TOP DRAWER AND POT & PANS DRAWERS BELOW - PURCHASER MUST SUPPLY SPECS - UPGRADE 1	
Line 40787	Note:	
2Oct15 / 13Oct15		

COUNTER TOP

Inv.3239	1 - LOCATION: KITCHEN COUNTER TOP - 2CM WITH STANDARD EDGE FE20 - GROUP 4 - KITCHEN WITH ISLAND AND FLUSH BREAKFAST BAR	
	BIANCO ANTICO - STANDARD SQUARE EDGE	
Line 40790	Note:	
2Oct15 / 13Oct15		



CONSTRUCTION SUMMARY

North 88 Developments Inc. / North 88

Lot/Unit: 26 Block 3 Phase/Building: 1 Model/Floor Plan: Lotus-Elev A

Inv.3239	1 - LOCATION: MASTER ENSUITE COUNTER TOP - 2CM WITH STANDARD EDGE FE20 - GROUP 3 - CAESARSTONE 6600 COLOUR NOUGAT	
Line 40820	Note:	
2Oct15 / 13Oct15		

ELECTRICAL

Inv.3239	4 - LOCATION: FAMILY ROOM TO LOCATE FOUR (4) POTLIGHTS INCLUDED IN OFFER SEPARATE SWITCH HAS BEEN PURCHASED FOR POTLIGHTS DO NOT DELETE THE STANDARD CEILING FIXTURE AND/OR SWITCHED OUTLET.	
Line 41349	Note: SEE SKETCH ATTACHED FOR LOCATION	
2Oct15 / 13Oct15		

Inv.3239	2 - LOCATION: LIVING/DINING ELECTRICAL - MINI LOW VOLTAGE HALOGEN POT LIGHT - 1ST FLOOR - TWO (2) ADDITIONAL POTLIGHTS IN LIVING ROOM (NOTE: 2 ARE INCLUDED IN OFFER) - DO NOT DELETE THE STD CEILING FIXTURE IN DINING ROOM OR CAPPED OUTLET IN LIVING ROOM	
Line 40805	Note: SEE SKETCH ATTACHED FOR LOCATION	
2Oct15 / 13Oct15		

Inv.3239	4 - LOCATION: MASTER BEDROOM ELECTRICAL - MINI LOW VOLTAGE HALOGEN POT LIGHT - 2ND FLOOR - LOCATION SKETCH ATTACHED - MASTER BEDROOM DO NOT DELETE THE STANDARD CEILING FIXTURE	
Line 40806	Note:	
2Oct15 / 13Oct15		

Inv.3239	1 - LOCATION: LIVING/DINING ROOM SUPPLY AND INSTALL ADDITIONAL INTERIOR SINGLE POLE SWITCH ONE SWITCH FOR FOUR (4) POTLIGHTS IN DINING/LIVING ROOM DO NOT DELETE THE STANDARD CEILING FIXTURE AND/OR SWITCHED OUTLET	
Line 40807	Note: LOCATION AS PER SKETCH ATTACHED.	
2Oct15 / 13Oct15		

Inv.3239	1 - LOCATION: FAMILY ROOM SUPPLY AND INSTALL ADDITIONAL INTERIOR SINGLE POLE SWITCH ONE SWITCH FOR FOUR (4) POTLIGHTS IN FAMILY ROOM DO NOT DELETE THE STANDARD CEILING FIXTURE AND/OR SWITCHED OUTLET	
Line 40808	Note: LOCATION AS PER SKETCH ATTACHED.	
2Oct15 / 13Oct15		

Inv.3239	1 - LOCATION: KITCHEN ISLAND SUPPLY AND INSTALL ADDITIONAL INTERIOR SINGLE POLE SWITCH ONE SWITCH FOR FOUR (4) POTLIGHTS CENTRED TO BREAKFAST ISLAND DO NOT DELETE THE STANDARD CEILING FIXTURES	
Line 40809	Note: LOCATION AS PER SKETCH ATTACHED.	
2Oct15 / 13Oct15		



CONSTRUCTION SUMMARY

North 88 Developments Inc. / North 88

Lot/Unit: 26 Block 3 Phase/Building: 1 Model/Floor Plan: Lotus-Elev A

Inv.3239	1 - LOCATION: MASTER BEDROOM	
	SUPPLY AND INSTALL ADDITIONAL INTERIOR SINGLE POLE SWITCH ONE SWITCH FOR FOUR (4) POTLIGHTS IN MASTER BEDROOM DO NOT DELETE THE STANDARD CEILING FIXTURE	
Line 40810	Note: LOCATION AS PER SKETCH ATTACHED.	
2Oct15 / 13Oct15		

Inv.3239	4 - LOCATION: LIVING/DINING ROOM	
	TO LOCATE FOUR (4) POTLIGHTS INCLUDED IN OFFER	
	SEPARATE SWITCH HAS BEEN PURCHASED FOR POTLIGHTS DO NOT DELETE STD CEILING FIXTURE IN DINING ROOM DO NOT DELETE STD SWITCHED OUTLET IN LIVING ROOM	
Line 41348	Note: SEE SKETCH FOR LOCATION	
2Oct15 / 13Oct15		

FIREPLACE

Inv.3239	2 - LOCATION: KITCHEN ISLAND	
	TO LOCATE TWO (2) POTLIGHTS INCLUDED IN OFFER	
	SEPARATE SWITCH HAS BEEN PURCHASED FOR POTLIGHTS	
	DO NOT DELETE STD CEILING FIXTURES IN KITCHEN/BREAKFAST AREA	
Line 41350	Note: SEE SKETCH ATTACHED FOR LOCATIOIN	
2Oct15 / 13Oct15		

HARDWOOD

Inv.3239	1 - LOCATION: BREAKFAST AREA	
	SUPPLY AND INSTALL HARDWOOD - UPGRADE 6 - MIRAGE - LINEN OLD RED OAK - W.O. RIFT AND 1/4 ROUND - 6 1/2 INCH - - (25897)	
Line 40792	Note:	
2Oct15 / 13Oct15		

Inv.3239	1 - LOCATION: KITCHEN AREA	
	SUPPLY AND INSTALL HARDWOOD - UPGRADE 6 - MIRAGE - LINEN OLD RED OAK - W.O. RIFT AND 1/4 ROUND - 6 1/2 INCH - - (25897)	
Line 40794	Note:	
2Oct15 / 13Oct15		

Inv.3239	1 - LOCATION: FAMILY ROOM	
	SUPPLY AND INSTALL HARDWOOD - UPGRADE 6 - MIRAGE - LINEN OLD RED OAK - W.O. RIFT AND 1/4 ROUND - 6 1/2 INCH - - (25897)	
Line 40793	Note:	
2Oct15 / 13Oct15		

Inv.3239	1 - LOCATION: MAIN HALL (MAIN FLOOR)	
	SUPPLY AND INSTALL HARDWOOD - UPGRADE 6 - MIRAGE - LINEN OLD RED OAK - W.O. RIFT AND 1/4 ROUND - 6 1/2 INCH - - (25897)	
Line 40795	Note:	
2Oct15 / 13Oct15		

Inv.3239	1 - LOCATION: LIVING/DINING ROOM	
	SUPPLY AND INSTALL HARDWOOD - UPGRADE 6 - MIRAGE - LINEN OLD RED OAK - W.O. RIFT AND 1/4 ROUND - 6 1/2 INCH - - (25897)	
Line 40796	Note:	
2Oct15 / 13Oct15		



CONSTRUCTION SUMMARY

North 88 Developments Inc. / North 88

Lot/Unit: 26 Block 3 Phase/Building: 1 Model/Floor Plan: Lotus-Elev A

Inv.3239	1 - LOCATION: LANDING LOWER FLOOR TO 1ST FLOOR SUPPLY AND INSTALL HARDWOOD - UPGRADE 6 - MIRAGE - LINEN OLD RED OAK - 25897	
Line 41346	Note:	
2Oct15 / 13Oct15		

HEATING AND AIR CONDITIONING

Inv.3239	1 - GAS LINE - ROUGH-IN ONLY - FOR STOVE TO INCLUDE 110V CODE REQUIREMENT	
Line 40783	Note:	
2Oct15 / 13Oct15		

Inv.3239	1 - UPGRADE GAS LINE FROM 3/4 INCH TO 1 INCH	
Line 40784	Note:	
2Oct15 / 13Oct15		

MISCELLANEOUS

Inv.3239	1 - SUPPLY AND INSTALL FURRING OUT OF WALL IN THE FAMILY ROOM TO RECESS THE STANDARD BLF-50 FIREPLACE. APPROXIMATELY 6' +/- WIDE BY APPROXIMATELY 10" +/- DEEP FROM FLOOR TO CEILING.	
Line 40789	Note: PRICE INCLUDES RELOCATION OF STANDARD ELECTRICAL RECEPTACLE AND CABLE TV ROUGH-IN APPROXIMATELY 66" +/- FROM THE FLOOR. FIREPLACE TO BE LOCATED APPROXIMATELY 22" +/- FROM THE FLOOR TO THE BASE OF THE FIREPLACE.	
2Oct15 / 13Oct15		

PAINT AND DRYWALL

Inv.3239	1 - SUPPLY SMOOTH CEILINGS THROUGHOUT	
Line 40804	Note:	
2Oct15 / 13Oct15		

PLUMBING

Inv.3239	2 - LOCATION: MASTER ENSUITE PLUMBING EXTRAS - UNDERMOUNT VANITY SINK (GRANITE PRICED SEPARATELY)	
Line 41347	Note:	
2Oct15 / 13Oct15		

Inv.3239	1 - MASTER ENSUITE - SUPPLY AND INSTALL UPGRADE MOEN 90 DEGREE SHOWER SPA PACKAGE OPTION 6 IN CHROME.	
	SEE SPECS SHEET ATTACHED	
Line 40802	Note:	
2Oct15 / 13Oct15		

Inv.3239	1 - MASTER ENSUITE - SUPPLY AND INSTALL UPGRADE MOEN 90 DEGREE ROMAN TUB FAUCET WITH HANDHELD SHOWER IN CHROME.	
	MODEL 9796/TS904.	
Line 40803	Note:	
2Oct15 / 13Oct15		

Inv.3239	1 - KITCHEN - SUPPLY AND INSTALL MOEN SOAP DISPENSER OPTION 5 MODEL S3947 CHROME	
	TO BE INSTALLED TO THE LEFT SIDE OF FAUCET (WHEN FACING SINK)	
Line 40822	Note:	
2Oct15 / 13Oct15		



CONSTRUCTION SUMMARY

North 88 Developments Inc. / North 88

Lot/Unit: 26 Block 3 Phase/Building: 1 Model/Floor Plan: Lotus-Elev A

Inv.3239	2 - MASTER ENSUITE - SUPPLY AND INSTALL TWO (2) UNDERMOUNT SINKS IN LIEU OF STANDARD. CATENA SQUARE UNDERMOUNT MODEL #4210CHY	
Line 40823	Note:	
2Oct15 / 13Oct15		
Inv.3239	1 - FRAMELESS GLASS SHOWER ENCLOSURE WITH CHROME TOP FRAME ONLY	
Line 41344	Note:	
2Oct15 / 13Oct15		

PLUMBING - KITCHEN FAUCETS:

Inv.3239	1 - KITCHEN - SUPPLY AND INSTALL UPGRADE FAUCET IN LIEU OF STANDARD MOEN 90 DEGREE COLLECTION - SINGLE HANDLE PULLOUT KITCHEN FAUCET MODEL S7597 CHROME	
Line 40825	Note:	
2Oct15 / 13Oct15		

PLUMBING - LAVATORY FAUCETS

Inv.3239	2 - MASTER ENSUITE - SUPPLY AND INSTALL UPGRADE FAUCETS MOEN 90 DEGREE COLLECTION - SINGLE HANDLE OPEN TROUGH LAVATORY WITH POP-UP DRAIN - MODEL S6705 CHROME	
Line 40824	Note:	
2Oct15 / 13Oct15		

STAIRS AND RAILING

Inv.3239	1 - RAILING UPGRADE - UPGRADE 5 - HANDRAIL - WINDSOR OAK, PICKETS - STEEL 1/2 INCH SQUARE, SINGLE COLLAR/DOUBLE COLLAR, WITH SHOES FLAT BLACK, POSTS - 3 1/2 INCH SQUARE, CHAMFERED, WITH CAP OAK	
Line 40778	Note:	
2Oct15 / 13Oct15		

TILE - BACKSPLASH

Inv.3239	1 - BACKSPLASH - 8TH UPGRADE KITCHEN BACKSPLASH - ABOVE COUNTER AND BEHIND STOVE AND BEHIND CHIMNEY HOOD FAN TO TOP OF UPPER CABINETS.	
	3X12 CALACATTA VINTAGE - HONED MARBLE - VN.CV.WHT.0312.HN	
Line 40800	Note:	
2Oct15 / 13Oct15		

TILE - FLOOR

Inv.3239	1 - LOCATION: MASTER ENSUITE SUPPLY AND INSTALL FLOOR TILE - UPGRADE 5 - - 12 X 24 CALACATTA VINTAGE HONED (VN.CV.WHT.1224)	
Line 40817	Note:	
2Oct15 / 13Oct15		
Inv.3239	1 - LOCATION: POWDER ROOM SUPPLY AND INSTALL FLOOR TILE - UPGRADE 5 - - 12 X 24 CALACATTA VINTAGE HONED (VN.CV.WHT.1224)	
Line 40818	Note:	
2Oct15 / 13Oct15		



CONSTRUCTION SUMMARY

North 88 Developments Inc. / North 88

Lot/Unit: 26 Block 3 Phase/Building: 1 Model/Floor Plan: Lotus-Elev A

Inv.3239	1 - SUPPLY AND INSTALL FLOOR TILE - UPGRADE 5 - - VESTIBULE FLOOR - ON CONC. 12 X 24 CALACATTA VINTAGE WHITED HONED (VN.CV.WHT.1224.HN)	
Line 40829	Note:	
2Oct15 / 13Oct15		

TILE - WALL

Inv.3239	1 - LOCATION: MASTER ENSUITE SHOWER STALL WITH CEILING SUPPLY AND INSTALL WALL TILE - UPGRADE 1 - - 8 X 10 WEAVE WHITE (QT.WV.WHT.0810)	
Line 40819	Note:	
2Oct15 / 13Oct15		

EXTRAS AS PER OFFER

Note:	
-------	--

Purchaser: Ling Feng Gu
 Telephone Res. / Bus: (647) 801-9999
 Decor Advisor: Steffanee Appio

Property: 26 Block 3 of Plan -
 Project: North 88 Developments Inc.
 Model and Elevation: Lotus-Elev A

Layout Changes: ☒ Yes ☐ No Sketch Attached: ☒ Yes ☐ No Exterior Colour Scheme:

1. Cabinetry

	Style and Colour	Counter Top	Hardware
Kitchen / Breakfast	CLASS - LANCASTER CANNOLI	BIANCO ANTICO - STD SQ EDG	HANDLE 12818
Kitchen Island	CLASS - LANCASTER MAPLE NOCE NERO	BIANCO ANTICO - STD SQ EDG	HANDLE 12818
Laundry Room	N/A		
Powder Room	CLASS - LANCASTER CANNOLI	CALCUTTA MARBLE 4925K-07	KNOB 171
Main Bathroom	CLASS - LANCASTER CANNOLI	CALCUTTA MARBLE 4925K-07	KNOB 171
Master Ensuite Bathroom	CLASS - LANCASTER CANNOLI	QUARTZ 6600 NOUGAT STD SQ	KNOB 171
Second Ensuite Bathroom (If Applicable)	CLASS - LANCASTER CANNOLI	CALCUTTA MARBLE 4925K-07	KNOB 171
	LOWER LEVEL BATHROOM		

Appliances

Custom Size Fridge

☒ Yes ☐ No

Valance Lighting

☐ Yes ☒ No

Microwave / Range Hood

☒ Yes ☐ No

Cooktop / Rangetop

☒ Yes ☐ No

Built in Wall Oven

☒ Yes ☐ No

Slide-in Range

☐ Yes ☒ No

Comment

*****EXTRAS***** BIANCO ANTICO GRANITE - STD SQUARE EDGE TO KITCHEN - UPGRADE 4
 CAEASARSTONE QUARTZ - 6600 NOUGAT - STD SQUARE EDGE TO MASTER ENSUITE - UPG 3
 HANDLE 12818 TO KITCHEN - UPGRADE 2

2. Flooring

Selection

FOYER	UPG 5 - 12 X 24 CALACATTA VINTAGE HONED (VN.CV.WHT.1224.HN)
Main Hall	UPG 6 - MIRAGE LINEN 25897 - 6.1/2" - OLD RED OAK
Back Hall	N/A
Breakfast	UPG 6 - MIRAGE LINEN 25897 - 6.1/2" - OLD RED OAK
Laundry Room	13 X 13 REFLEX BONE (GE.RF.BON.1313)
Kitchen	UPG 6 - MIRAGE LINEN 25897 - 6.1/2" - OLD RED OAK
Powder Room	UPG 5 - 12 X 24 CALACATTA VINTAGE HONED (VN.CV.WHT.1224.HN)
Main Bathroom	13 X 13 REFLEX BONE (GE.RF.BON.1313)
Master Ensuite	UPG 5 - 12 X 24 CALACATTA VINTAGE HONED (VN.CV.WHT.1224.HN)
Bathroom (If Applicable)	13 X 13 REFLEX BONE (GE.RF.BON.1313) LOWER LEVEL BATHROOM
Mud Room	N/A
	N/A
Living Room	UPG 6 - MIRAGE LINEN 25897 - 6.1/2" - OLD RED OAK
Dining Room	UPG 6 - MIRAGE LINEN 25897 - 6.1/2" - OLD RED OAK
Family / Great Room	UPG 6 - MIRAGE LINEN 25897 - 6.1/2" - OLD RED OAK
Den / Library / Study	N/A
Basement Landing (If Applies)	UPG 6 - MIRAGE LINEN 25897 - 6.1/2" - OLD RED OAK
Lower Landing (If Applicable)	UPG 6 - MIRAGE LINEN 25897 - 6.1/2" - OLD RED OAK
Upper Landing	N/A
Upper Hall	STD PAPILO - MAPLE SEASON 79497
Master Bedroom	STD PAPILO - MAPLE SEASON 79497
Bedroom #2	STD PAPILO - MAPLE SEASON 79497
Bedroom #3	STD PAPILO - MAPLE SEASON 79497
Bedroom #4	N/A
Bedroom #5	N/A

Flooring Continued on Page 2

Initial:

Carrie

Page 1 of 3

Lot 26
N 88

Purchaser: Ling Feng Gu
Telephone Res. / Bus: (647) 801-9999
Decor Advisor: Steffanee Appio

Property: 26 Block 3 of Plan -
Project: North 88 Developments Inc.
Model and Elevation: Lotus-Elev A

2. Flooring - Continued -

Upgrade Underpad	Type	Area
	STANDARD	REC ROOM, BEDROOMS & UPPER HALL
Carpet on Stairs	Capped	Runner - *Upgrade
Comment	N/A	N/A

3. Plumbing Fixtures / Faucets

Kitchen	UPG	Second Ensuite		Powder Room	STD
Master Ensuite	UPG			Other Room	STD
Main Bathroom	STD				

Comment

*****SEE UPGRADES/EXTRAS

4. Wall Tile

	Tile Selection	Listello	Insert	Insert Selection
Main Bathroom	8 X 10 REFLECTION BONE (QT.RF.BON.0810)	<input type="checkbox"/>	<input type="checkbox"/>	
Master Ensuite				
Tub Deck	N/A	<input type="checkbox"/>	<input type="checkbox"/>	
Tub Apron	N/A	<input type="checkbox"/>	<input type="checkbox"/>	
Tub Surround	N/A	<input type="checkbox"/>	<input type="checkbox"/>	
Shower Stall	1ST UPG - 8 X 10 WEAVE WHITE (QT.WV.WHT.0810)	<input type="checkbox"/>	<input type="checkbox"/>	FLOOR-2X2 MOSAIC WHITE
Second Ensuite	8 X 10 REFLECTION BONE (QT.RF.BON.0810)	<input type="checkbox"/>	<input type="checkbox"/>	
	LOWER LEVEL SHOWER STALL	<input type="checkbox"/>	<input type="checkbox"/>	FLOOR-2X12 MOSAIC WHITE
		<input type="checkbox"/>	<input type="checkbox"/>	
Kitchen Backsplash	8TH UPG - CALACATTA VINTAGE HN WHT 3 X 12	<input type="checkbox"/>	<input type="checkbox"/>	
Complete Backsplash		<input type="checkbox"/>	<input type="checkbox"/>	

Comment

BACKSPASH: CALACATTA VINTAGE HN WHITE 3 X 12 (VN.CV.WHT.0312.HN)

5. Fireplace

	Living Room			Family Room			Other Room - Specify		
	Purchased	As Per Plan	N/A	Purchased	As Per Plan	N/A	Purchased	As Per Plan	N/A
Fireplace Type	<input type="radio"/>	<input type="radio"/>	<input type="radio"/>	<input type="radio"/>	<input checked="" type="radio"/>	<input type="radio"/>	<input type="radio"/>	<input type="radio"/>	<input type="radio"/>
Mantle Type				BLF-50 STANDARD					
Over Mantle									
Colour / Stain									
Surround									
Hearth									

Comment

NOTE: FURR OUT WALL TO RECESS FIREPLACE*****

Initial:

Carver

Page 2 of 3

Purchaser: Ling Feng Gu
Telephone Res. / Bus: (647) 801-9999
Decor Advisor: Steffanee Appio

Property: 26 Block 3 of Plan -
Project: North 88 Developments Inc.
Model and Elevation: Lotus-Elev A

6. Trim Carpentry

Door Hardware

Interior Trim

Comment

Interior Doors

☐ 2 Panel Arch Top

☒ 2 Panel Square Top

☐ 6 Panel



Initial for Door Style

LF

7. Railings and Pickets

Railing Package

Railing Colour

Picket Colour

Wood Stairs ☐ No ☒ Oak

Tread Colour

Comment

*****SEE UPGRADE/EXTRAS*****

STAIN ON STAIRS TO COMPLIMENT HARDWOOD (MIRAGE CASHMERE)

8. Plaster Mouldings and Medallions

Foyer

Main Hall

Living Room

Dining Room

Family Room

Kitchen/Breakfast

Den/Library

Lower Landing

Comment

9. Wall Paint

Smooth Ceilings

☐ First Floor

☐ First Floor incl. Second Floor Hall

☐ First and Second Floor

☒ Throughout

☐ Not Applicable

Trim Paint

10. Additional Comments

11. Disclaimers and Notes

- Colours of all materials are as close as possible to builder's selection, but not necessarily identical due to variances in manufacturing.
- Any extras listed above are null and void unless accompanied by a separate invoice/amendment. Said invoice must be paid in full.
- The Purchaser acknowledges that after Interior Colour Selection form is signed and dated, no further changes will be permitted other than re-selection due to unavailability. *LF* Purchaser's Initials
- The Purchaser acknowledges reading and accepting the "Senator Homes Décor Centre Disclaimers" form. This document contains other miscellaneous disclaimers.

This Interior Colour Selection is final and approved by:

Purchaser:

Signature: *LF*

Date:

10-13, 2015

Vendor:

[Signature]
North 88 Developments Inc.



INTERIOR COLOUR SCHEME

Purchaser: Ling Feng Gu
Telephone Res. / Bus: (647) 801-9999
Decor Advisor: Steffanee Appio

Property: 26 Block 3 of Plan -
Project: North 88 Developments Inc.
Model and Elevation: Lotus-Elev A

A handwritten signature in blue ink, appearing to read "C. Appio".

N88
Lot 26

LOTUS
TH2007

SENATOR HOMES
DECOR CENTRE
DATE: 07/2/15
INITIALS: Carol

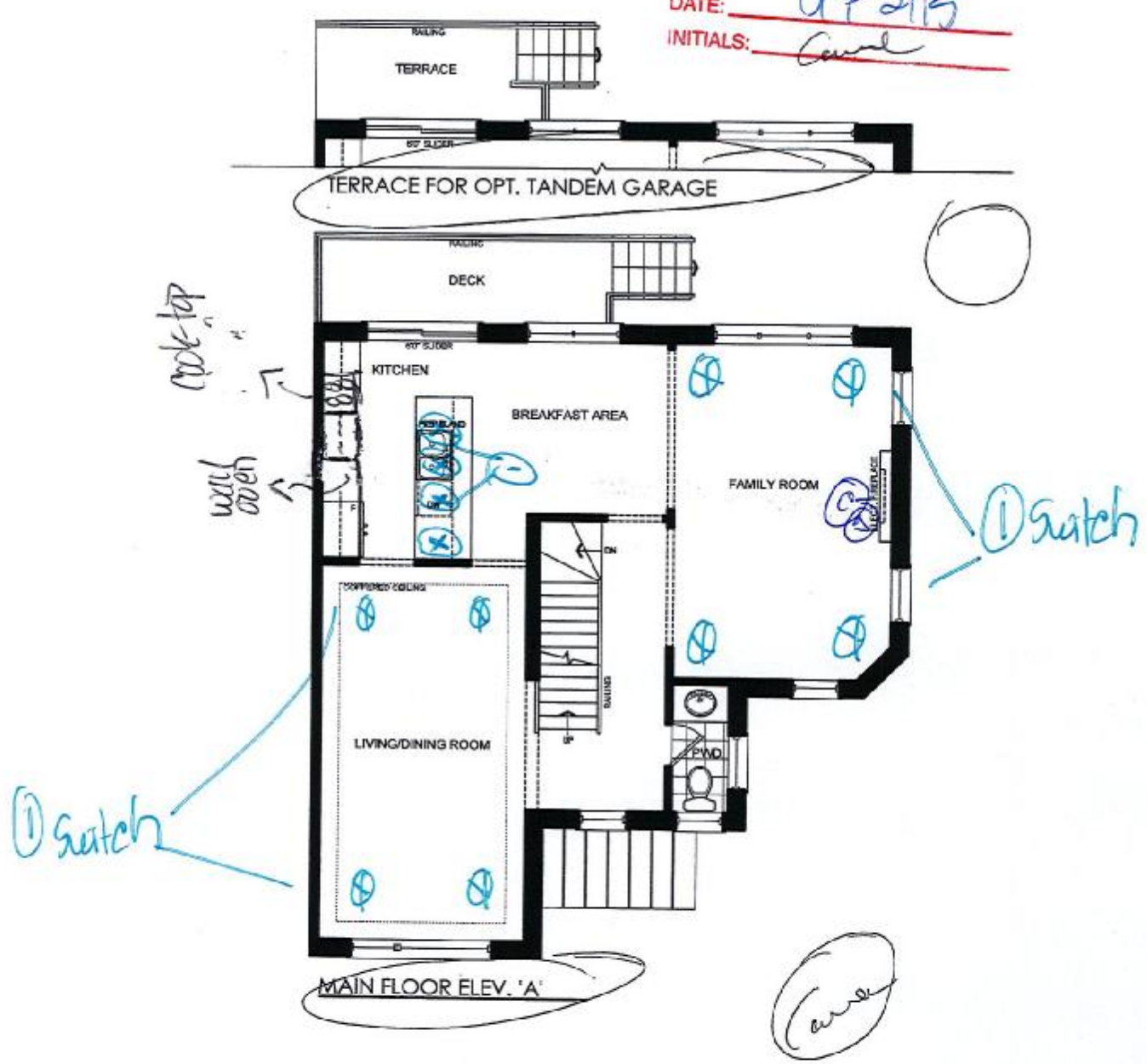

Feb 24/2015
Lot 26

This plan is not to scale and subject to architectural review and revision, including without limitation, the Unit being constructed with a layout that is the reverse of that set out above. All drawings, floorplans, materials, specifications, details and dimensions, if any, are approximate and subject to change without notice. Bulkheads are not shown on this plan and may be located in areas of the Unit. Terraces, balconies and patios, if any, are exclusive use common elements, shown for display purposes only and location and size are subject to change without notice. Number of steps, window location, size and type may vary without notice. - March 13, 2014.

N88
Lot 26

LOTUS
TH2007

SENATOR HOMES
DECOR CENTRE

DATE: 17/2/15

INITIALS: Curre

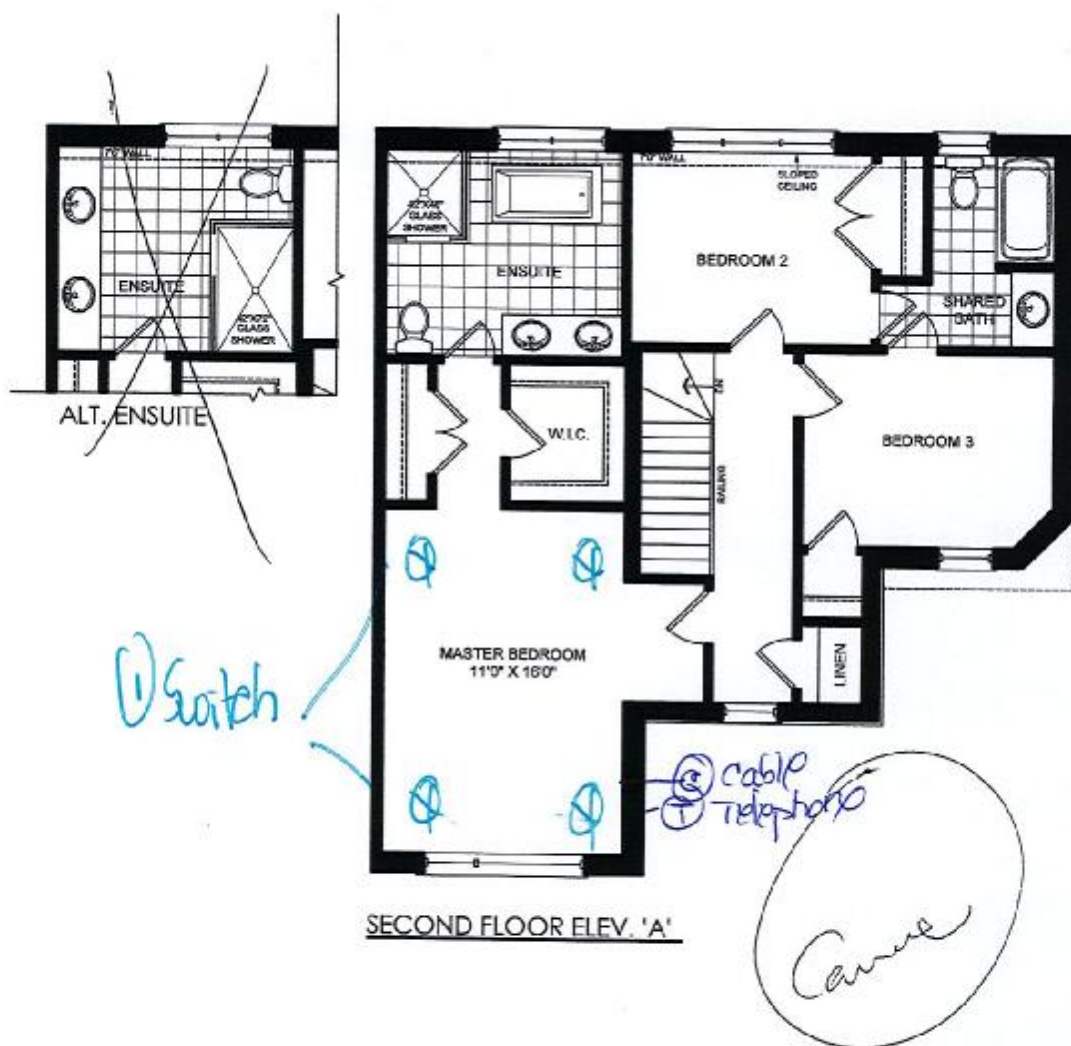

Feb 24/2015

Lot 26

This plan is not to scale and subject to architectural review and revision, including without limitation, the Unit being constructed with a layout that is the reverse of that set out above. All drawings, floorplans, materials, specifications, details and dimensions, if any, are approximate and subject to change without notice. Bulkheads are not shown on this plan and may be located in areas of the Unit. Terraces, balconies and patios, if any, are exclusive use common elements, shown for display purposes only and location and size are subject to change without notice. Number of steps, window location, size and type may vary without notice. - March 13, 2014.

N88
Lot 26

LOTUS
TH2007

SENATOR HOMES
DECOR CENTRE

DATE: 07/2/15
INITIALS: Care

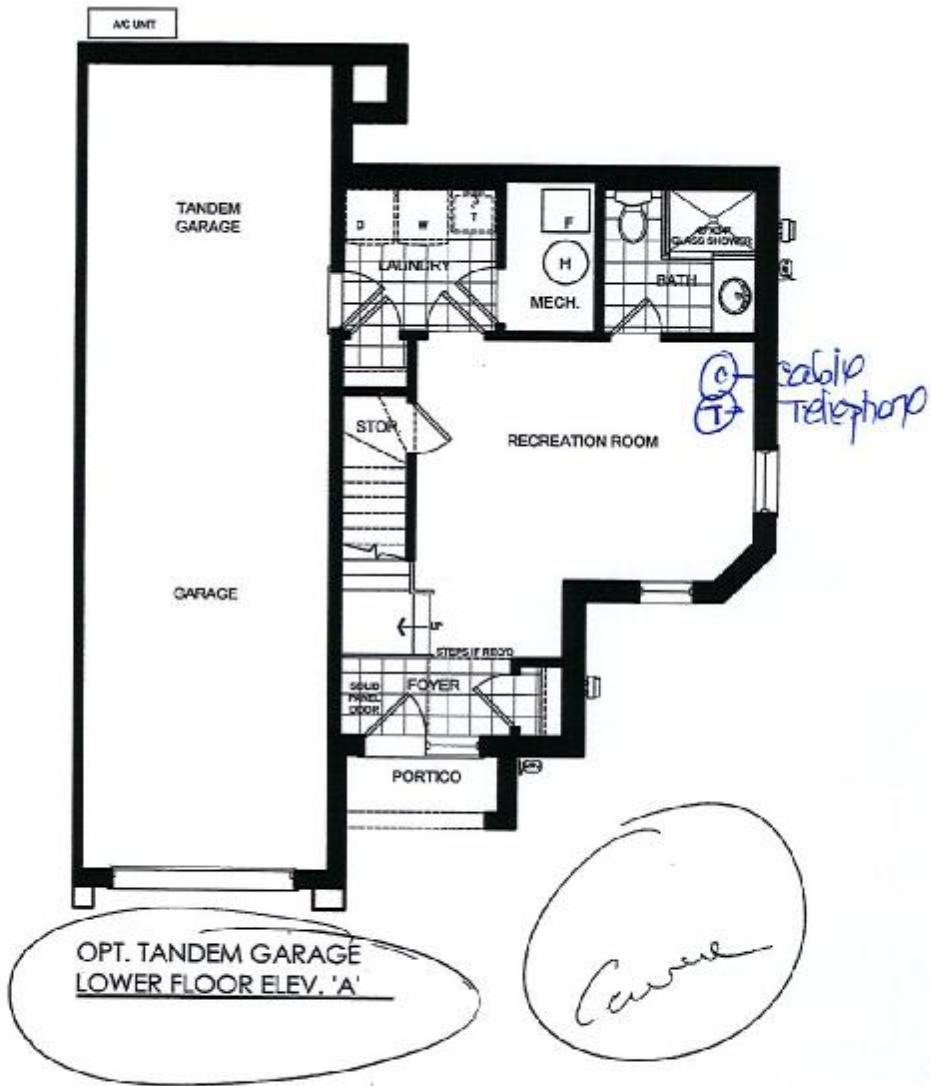

Feb 24, 2015
Lot 26

This plan is not to scale and subject to architectural review and revision, including without limitation, the Unit being constructed with a layout that is the reverse of that set out above. All drawings, floorplans, materials, specifications, details and dimensions, if any, are approximate and subject to change without notice. Bulkheads are not shown on this plan and may be located in areas of the Unit. Terraces, balconies and patios, if any, are exclusive use common elements, shown for display purposes only and location and size are subject to change without notice. Number of steps, window location, size and type may vary without notice. - March 13, 2014.

Lot 88
Lot 26

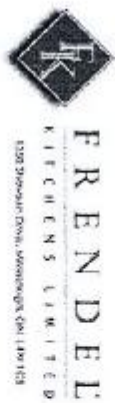

Call 1-800-430-7888
Fax: 1-905-470-1585
www.frendel.com

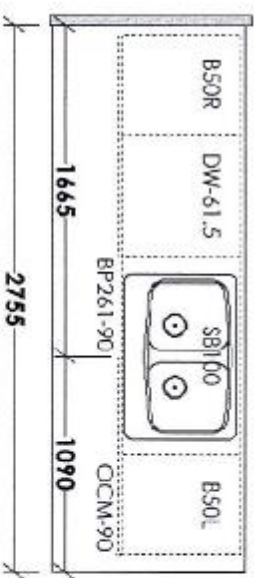
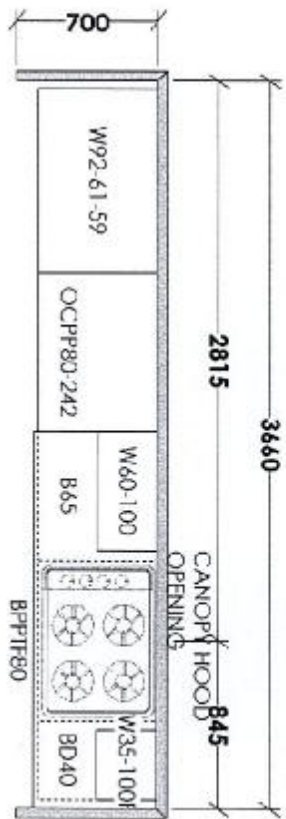

SENATOR HOMES
DECOR CENTRE
DATE: 08/13/2015
INITIALS: *Carrie*

lot #26
North 88

SENATOR HOMES
NORTH 88
LOT 26 (LOTUS - TH2007)

lot 26
N88



FRENDEL
KITCHENS LIMITED
1310 DAVENPORT RD, MARKHAM, ON L3R 9V5

1st Floor, Unit 108
Tel: (905) 479-7888
Fax: (905) 479-7885
www.frendel.com

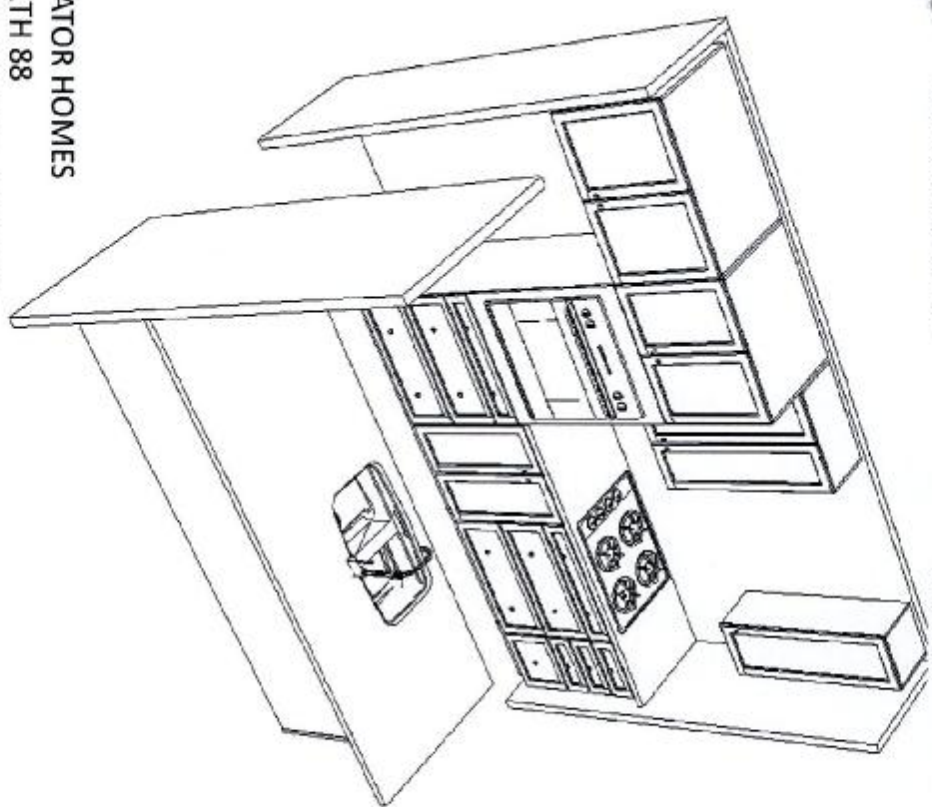

SENATOR HOMES
NORTH 88
LOT 26 (LOTUS - TH2007)

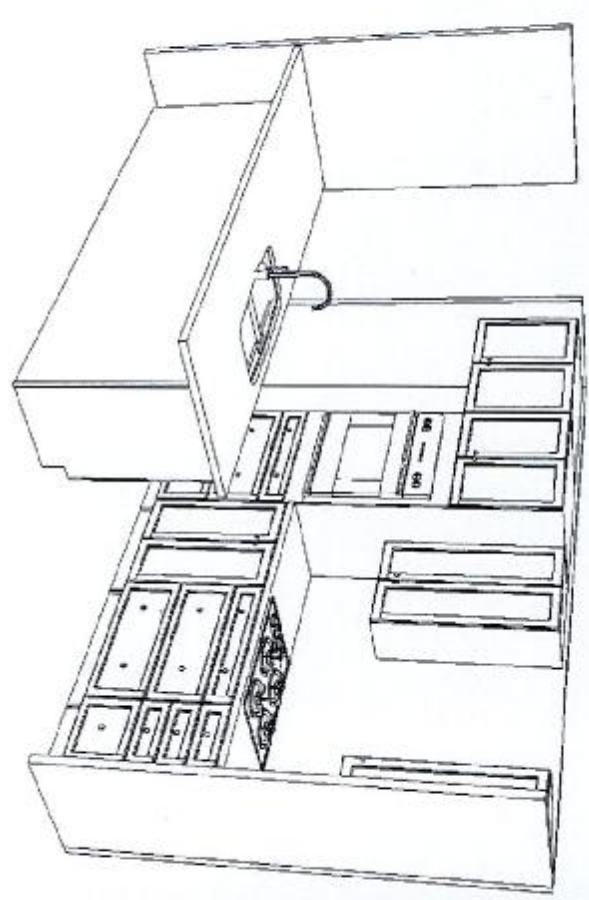

lot 26
north 88

SENATOR HOMES
DECOR CENTRE
DATE: 07/13/15
INITIALS: Cover

OCT, 7, 2015

Lot 26
N 88

SENATOR HOMES

UPGRADE



Contrac Jan 1/2019

Contrac Fixtures

lot 26

Option 10

Contrac Camden Square Undermount

SENATOR HOMES
DECOR CENTRE

DATE: 07/2/15

INITIALS: Carene

magher
suite x 2



Camden Square Undermount - Model 4210CHY
(in lieu of standard)
• China Undermount Inner Dim 14" x 14"
• Overflow Front opening

\$220.00 + HST

IN LIEU OF STANDARD

Option 11

Contrac Catena Rectangular Undermount



Catena Rectangular Undermount - Model 4210CHY
(in lieu of standard)
• China Undermount Inner Dim 17" x 14"
• Overflow Front opening

\$240.00 + HST

IN LIEU OF STANDARD

90 Degree

Traditional | Transitional | Modern

SENATOR HOMES
DECOR CENTRE

DATE: 01/13/15

INITIALS: Car

hot tap
north 88



Single Handle Kitchen Faucet†

Model S7170†

(Use model number only for Chrome finish)

Chrome: \$ 576.87
Other: \$ 741.37



Single Handle Pullout Kitchen Faucet†

Model S7597†

Chrome: \$ 885.85
Other: ~~\$ 1,111.95~~



Single Handle Bar/Prep Faucet†

Model S5170†

(Use model number only for Chrome finish)

Chrome: \$ 518.84
Other: \$ 666.33

† To order, combine the model number with one of these finish letters:



C



SRS

* Single or Three Hole Installation
± Single Hole Installation Only

MOEN

Buy it for looks. Buy it for life.*

hot 26 north 88 **SENATOR HOMES** DECOR CENTRE

DATE: 07/2/15

INITIALS: Lawrence

90°

master
ensuite

Modern



**Single Handle Open Trough
Lavatory with Pop-Up Drain**
Model S6705†

Chrome: \$ 552.79 ✓
Other: \$ ~~875.28~~



**Single Handle Lavatory
with Pop-Up Drain**
Model S6700†

Chrome: \$ 480.76
Other: \$ 761.04



**Single Handle Vessel Lavatory
with Push Button Drain**
Model 140780 +/ S6711†

Chrome: \$ 750.47
Other: \$ 1,111.46



**Widespread Lavatory
with Pop-Up Drain**
Model 69000 / TS6720†

Chrome: \$ 616.56
Other: \$ 904.47



**Two Handle Wall Mount Lavatory
Faucet Lever Handles**
Model 9700 / TS6730† / 140780†

Chrome: \$ 837.76
Other: \$ 1,270.71

** Please see Vertical Spa Guide for Installation #700106
Matching tub drain assembly available. Please see *Bath Hardware and Home Care* Section.
† To order, combine the model number with one of these finish letters:



Chrome
(use faucet
number only)



BN

MOEN
Buy it for looks. Buy it for life.®

90°

SENATOR HOMES
DECOR CENTRE

DATE: 07/2/15

INITIALS: [Signature]

hot 2p N88

master
bounty

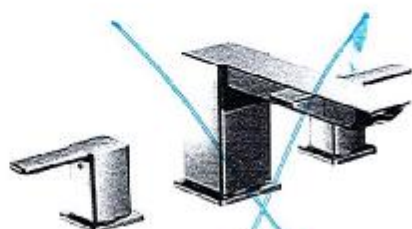

Roman Tub
Model 4796 / TS903+

Chrome: \$ 642.46
Other: \$ ~~935.41~~

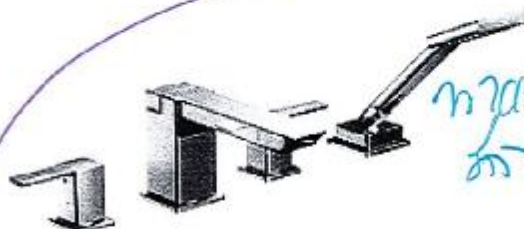

Roman Tub with Handheld Shower
Model 9796 / TS904+

Chrome: \$ 1,583.85 ✓
Other: \$ ~~2,115.78~~



IO Digital™ 90° Roman Tub
Model S4994 / 4998 / TS9031+ / TS3495+

Chrome: \$ 2,605.05
Other: \$ 3,091.90



IO Digital™ 90° Roman Tub with Handheld Shower
Model S4994 / 4898 / TS9041+ / TS3495+

Chrome: \$ 3,311.80
Other: \$ 4,037.56



IO Digital™ Remote Control for Roman Tub

Model SA349 (for Chrome) or
SA349BL (for Black)

\$ 337.89

** Please see Vertical Spa Guide for Installation #700106
Matching tub drain assembly available. Please see *Bath Hardware and Home Care* Section.

† To order, combine the model number with one of these finish letters:



Chrome
(use faucet
number only)



BN

MOEN
Buy it for looks. Buy it for life.®

Lot 26
N 88

Wagner
Knoth
Shower
Stall

SENATOR
HOMES

MOEN

90°

As Seen in Showroom

**Shower Spa Packages
Option 6**

In Lieu of Standard Shower

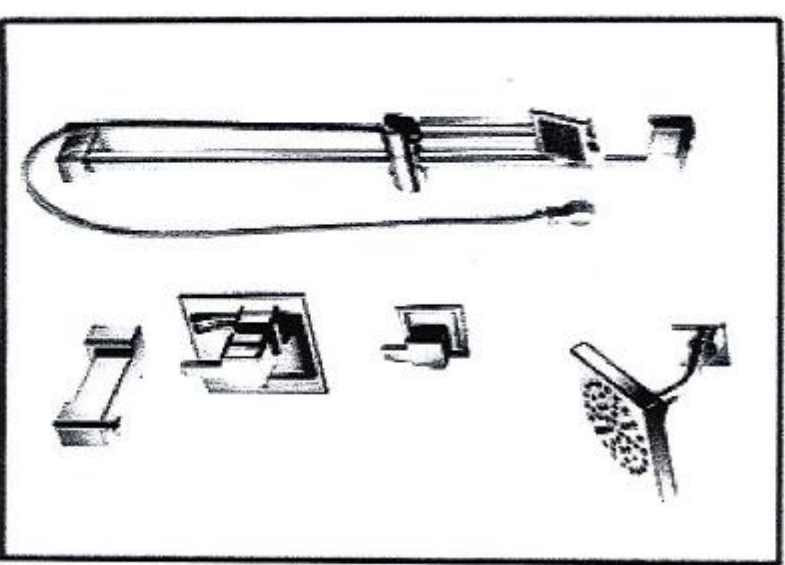

Moen Shower Package in lieu of Standard
OPTION 6

- Moen TS3111 Valve Trim
- Moen TS4172 Transfer Trim
- Moen S3879EP Hand Shower Bar
- Moen A720 Wall Elbow
- Moen Transfer Valve RI 3373
- Moen Valve RI 2510

Price - Chrome \$1900.00 + HST
Brush Nickel \$2700.00 + HST

SENATOR HOMES
DECOR CENTRE
DATE: 09/21/15
INITIALS: [Signature]

Lot 26



The Rain Head must be substituted
For either the Hand Shower or Standard
Shower Head. The Porting Valve will
not accommodate all 3 functions

~~Optional Rain Head in lieu of standard~~
~~- Moen S31210 Rain Head~~
~~- Moen 716651 Ceiling Arm~~
~~- Moen AT2119 Ceiling Arm Flange~~

~~ADD Price - Chrome \$570.00 + HST
Brush Nickel \$790.00 + HST~~



Print Page



30" 4-Burner KM 3465 G Gas Cooktop

Miele Pricing
\$2,199.00

[Find a Retailer](#)

Miele Advantage
\$2,409.00

Miele Advantage Plus
\$2,709.00

[What is this?](#)

Promotions:



Save up to 10% with the Miele Complete Cooking Program and receive a Free 5 Year Warranty on all Miele cooking appliances

[Learn More](#)

Product Details		Downloads	Recommended Products	ForeverCare
Width				
Width	30" (76 cm)			
Cooktop Type				
Type	Gas Cooktop			
Design				
Grate design	Linear			
Cast iron grates	•			
Continuous grate design (permits pots to be moved effortlessly from burner without lifting)	•			
Number of Heating Elements				
Number of heating elements	4			

SENATOR HOMES
DECOR CENTRE

DATE: 1-2-15

INITIALS: [Signature]

10726

1188 - lot
26

Controls

Knob controls

•

Features

Completely sealed burners (allow for easy cleaning and maintenance)

•

Simmer function

•

Wok burner (including wok ring)

•

Electronic ignition

•

Automatic re-ignition

•

Technical Specifications

BTU range

620-15,300 BTU/h

Back to Top

SENATOR HOMES
DECOR CENTRE

DATE: 07/01/15

INITIALS: [Signature]

Lot 26

Miele

N88-10726

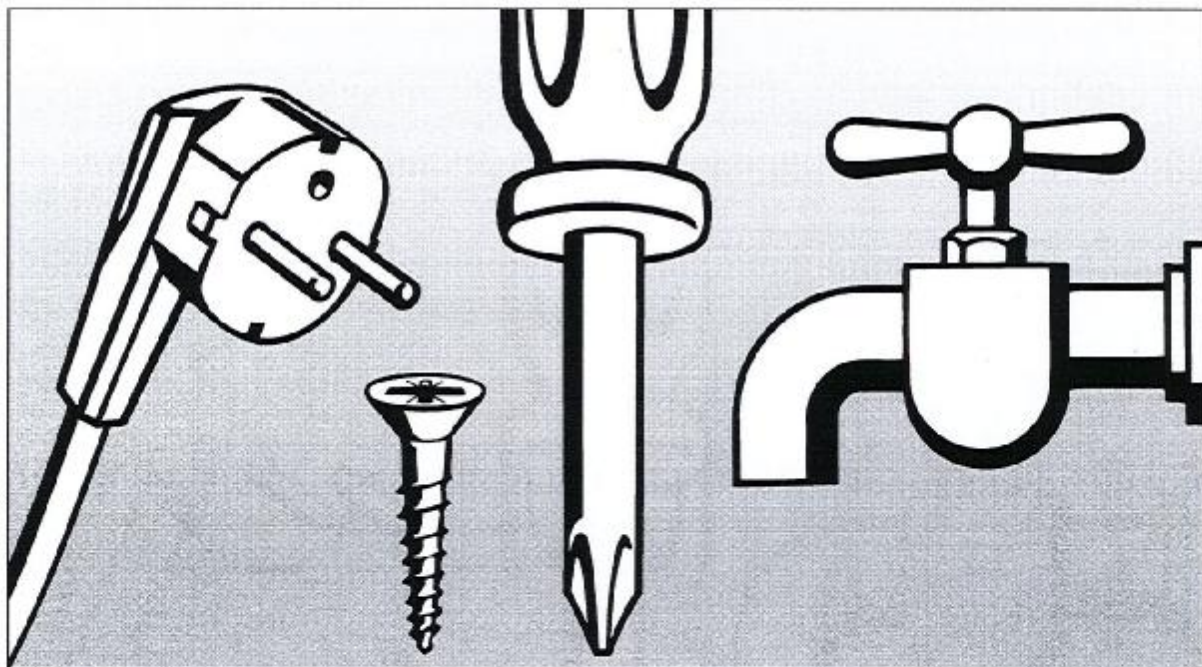

Installation Instructions

KM 3464, KM 3465

en - CA

KM 3474, KM 3475

KM 3484, KM 3485

Installation, repair and maintenance work should be performed by a Miele authorized service technician in accordance with national and local safety regulations and the provided installation instructions.

IMPORTANT SAFETY INSTRUCTIONS

N88-10726

Installation

The minimum distances given in these Installation instructions are to combustible surfaces, and must be observed to ensure safe operation. Failure to do so increases the risk of fire.

The cabinetry and venting hood should be installed first to prevent damage to the cooktop.

- ▶ Gas appliances should only be installed in a well ventilated area.
- ▶ The countertop must be bonded with heat resistant (212 °F/100 °C) adhesive to prevent distortion or dissolving.
- ▶ The cooktop should only be installed as shown in the illustrations while maintaining the required safety distances shown. Do not install the cooktop between two tall cabinets, this is a fire hazard.

① = indicates cooktop cut-out
② = minimum distance between cut-out and a tall cabinet:
12" (305 mm)

- ▶ This appliance has not been designed for maritime use or for use in mobile installations such as recreational vehicles or aircraft. However, under certain conditions it may be possible for installation in these applications. Please contact the Miele Technical Service Department with specific requirements.

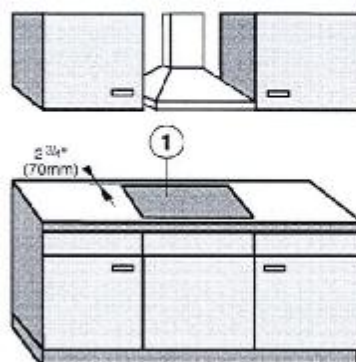

recommended

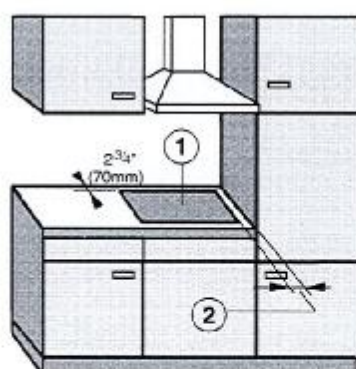

not recommended

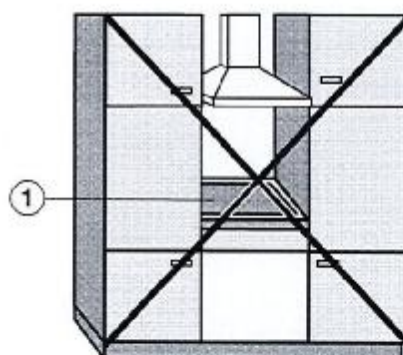

not allowed

IMPORTANT SAFETY INSTRUCTIONS

► The cooktop must not be installed over a dishwasher, washer, dryer, refrigerator or freezer. Heat radiated by the cooktop may damage the appliances.

► Deep fat fryers must not be installed next to gas cooktops. Gas flames can ignite splattering oil. A distance of at least 12" (305 mm) should be maintained between these two appliances. The minimum distance between two cooktops must be 4" (100 mm).

► Install the appliance so that the power cord or gas piping does not come into contact with any portion of the cooktop which may become hot during use.

This appliance must be installed with its own shut off valve and the included gas pressure regulator. Both the valve and the regulator must be easily accessible to the consumer after the appliance is installed.

This appliance must be disconnected from the gas supply during any pressure testing of the system performed in excess of $\frac{1}{2}$ psi (3.5 kPa). This appliance must be isolated at test pressures equal to or less than $\frac{1}{2}$ psi (3.5 kPa).

Any pipe connections must be made using a thread sealant approved for gas connections. Failure to correctly install these items could lead to a gas leak and subsequent explosion.

Safety distances above the appliance

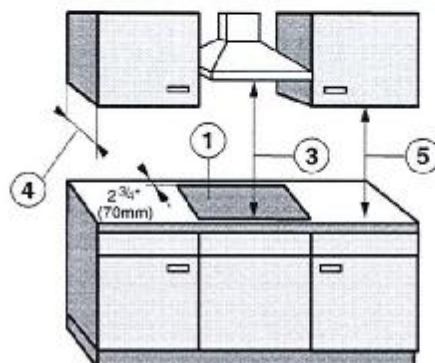

There must be a safety distance of at least 30" (760 mm), ③ between the appliance and any objects above it. The overhead cabinet depth, ④, if unprotected, must not exceed 13" (330 mm). The minimum distance of combustible surfaces located above and to the sides of the cooktop, ⑤, is 18" (457 mm).

If the cabinet manufacturer recommends a greater distance, follow that manufacturer's recommendation.

When installing the cooktop under a venting hood, always observe the minimum distance recommended by the hood manufacturer.

Keep this instruction book in a safe place for reference and pass it on to any future user.

Appliance dimensions

KM 3474 / KM 3475

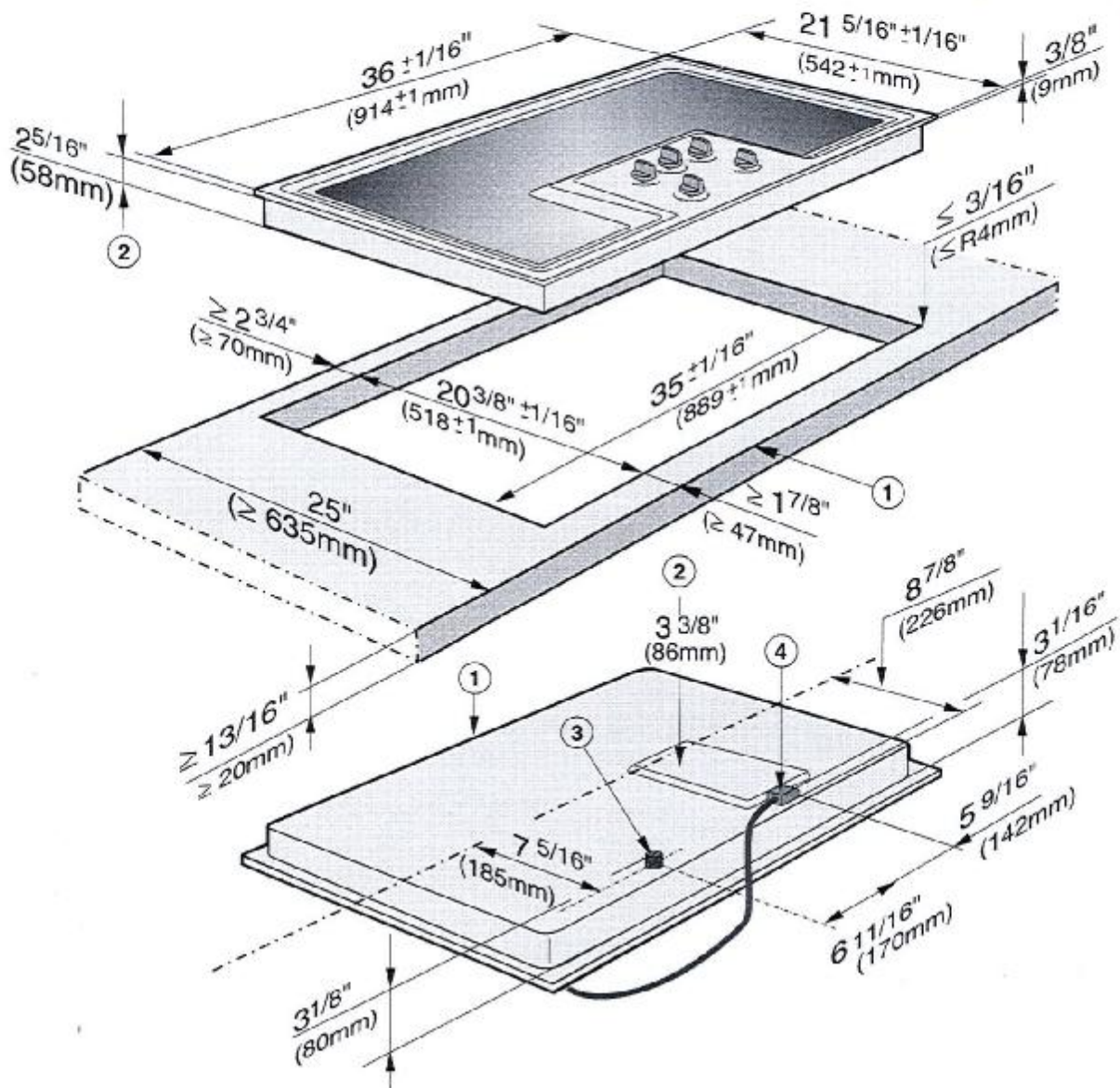

- ① Front
- ② Built-in depth
- ③ Gas connection R $\frac{1}{2}"$ NPT
- ④ Mains connection box

Appliance dimensions

lot 26. North 88

KM 3484 / KM 3485

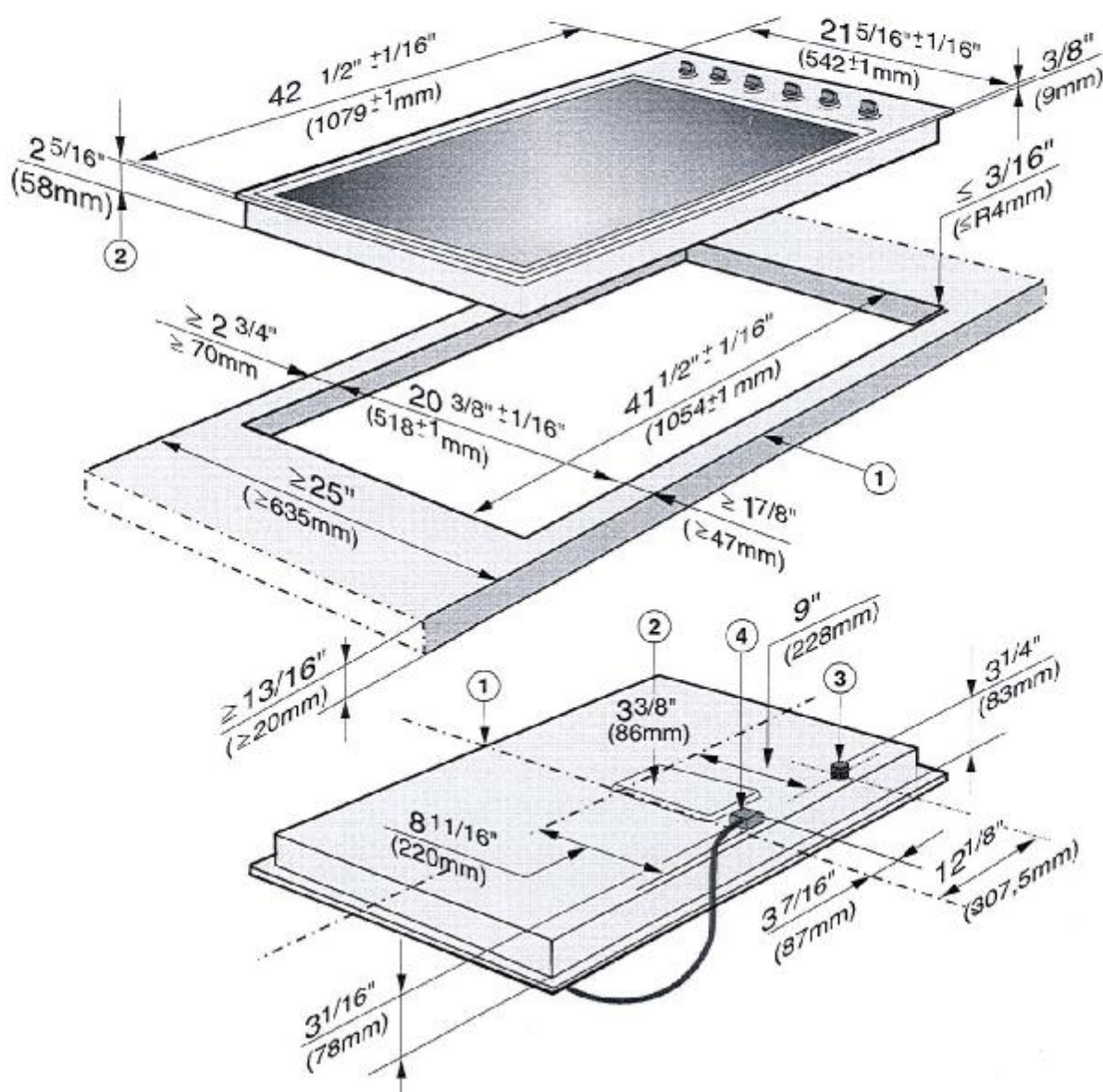

- ① Front
- ② Built-in depth
- ③ Gas connection R $\frac{1}{2}''$ NPT
- ④ Mains connection box

- Prepare the work top cut-out as shown in the diagram.
Remember to maintain the minimum safety distances to combustible surfaces:
 - 2 $\frac{3}{4}$ " (70 mm) between the cut-out and the back wall and
 - 12" (305 mm) between the cut-out and a side wall or tall unit to the right or left of the cut-out.(See "Important Safety instructions").
- Seal the cut surfaces with a suitable heat-resistant sealant to avoid swelling caused by moisture.

If during installation, the corners of the frame are not flush with the work top surface, the corner radius (max. $\frac{3}{16}$ " [4 mm]) can be carefully filed to fit.

lot
26
N88

Installation

N88 - 10726

Setting the cooktop into place

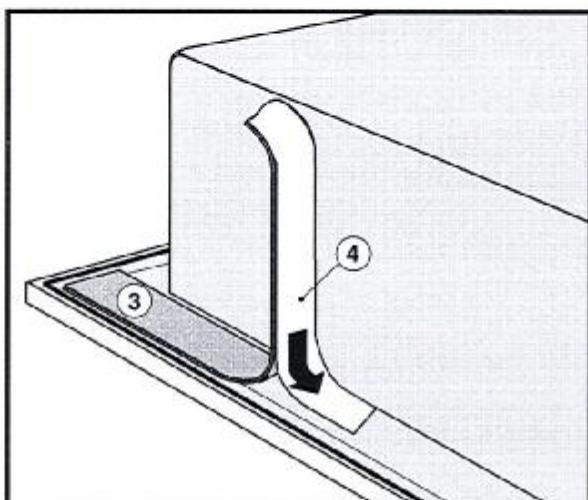

- After removing the protective backing, ④, stick the supplied seal, ③, under the edge of the cooktop.
- Screw the gas regulator onto the nipple underneath the cooktop. (See "Gas Connection - Gas pressure regulator".)
- Feed the power cord through the cut-out to the power outlet.
- Set the cooktop in the cut-out and center it.

Install the appliance so that the power cord and gas piping does not come in contact with any portion of the cooktop which may become hot during use.

Securing the cooktop

- Secure the cooktop with the included fixing bracket.

Countertop $1\frac{3}{16}$ " (20 mm)

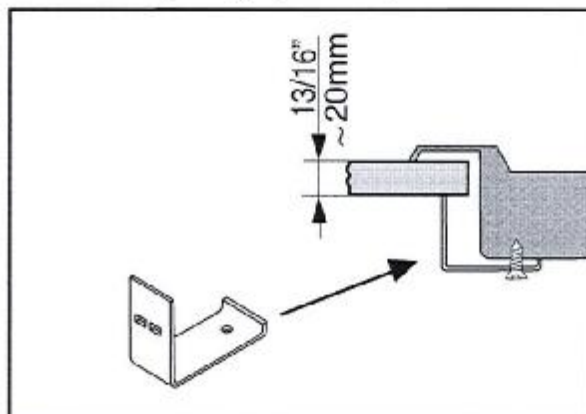

Countertop $1\frac{9}{16}$ " (40 mm)

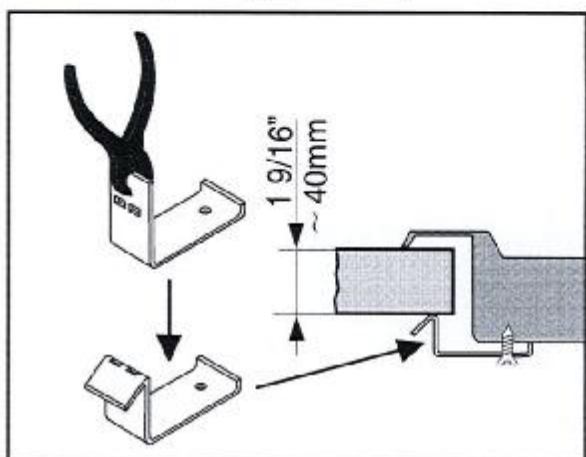

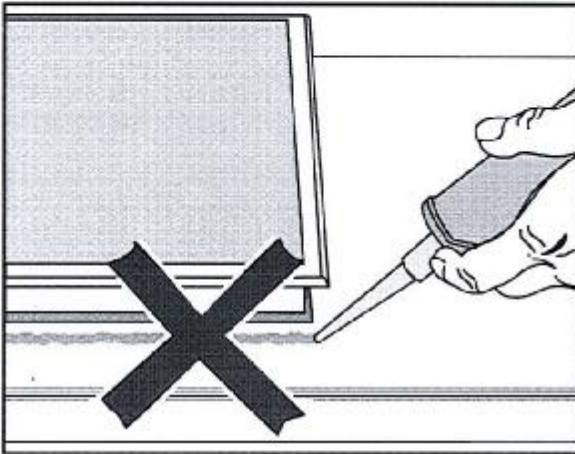

N88
Lot 26

The sealing strip under the edge of the top part of the cooktop provides a sufficient seal for the worktop.

Do not let sealant get in between the cooktop frame and the worktop. This could cause difficulties if the cooktop ever needs to be taken out for servicing and possibly result in damage to the cooktop frame or the worktop.

Electrical connection

488 - 10726

This appliance must be grounded according to local or national codes.

All electrical work should be performed by a qualified electrician in accordance with local codes and with the:

- National Electrical Code ANSI / NFPA No. 70 for the USA
- or
- Canadian Electrical Code Part I for Canada (CSA Standard C 22.1).



WARNING

Disconnect the appliance from the main power supply before installation or service. To reduce the risk of electric shock, make sure that the appliance is properly grounded after installation.

Power supply

The automatic ignition requires that the cooktop be connected to a 120 VAC, 60 Hz power supply. The supply line should be protected by a 15 A fuse.

Actual power consumption (during ignition only) is 25 W.

This appliance is equipped with a 4 ft. (1.2 m) long power cord that is ready for connection to the appropriate outlet.

Place the power outlet so that it is accessible after the appliance has been installed in the countertop.

This appliance is equipped with a three-prong grounding plug to prevent shock hazards. It should be plugged directly into a properly grounded outlet. Do not cut or remove the grounding prong from the plug. If the plug does not fit the outlet, have the proper outlet installed by a licensed electrician.

To guarantee the electrical safety of this appliance, continuity must exist between the appliance and an effective grounding system. It is imperative that this basic safety requirement be met. If there is any doubt, have the electrical system of the house checked by a qualified electrician.

Note to the installer

Please leave these instructions with the consumer or the appliance.

Electrical connection

Wiring diagram

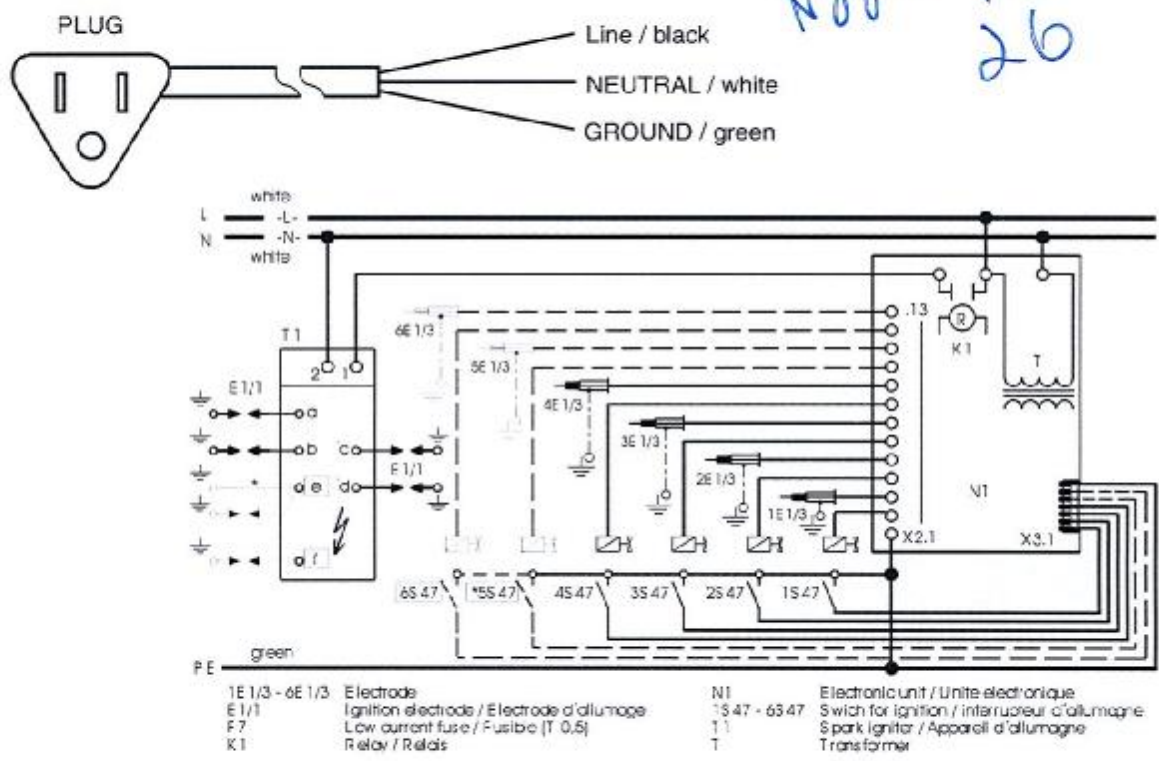

⚠ Caution: Label all wires prior to disconnection when servicing controls. Wiring errors can cause improper and dangerous operation. Verify proper operation after servicing.

Gas connection

lot 26
N 88

Installation and service must be performed by a qualified installer, service agency or gas supplier.

In Massachusetts a licensed plumber / gas fitter is required.

This appliance must be installed with its own shut off valve and the included gas pressure regulator. Both the valve and the regulator must be easily accessible to the consumer to turn on or shut off the gas supply after the appliance is installed.

This appliance and its individual shut off valve must be disconnected from the gas supply during any pressure testing of that system performed in excess of $\frac{1}{2}$ psi (3.5 kPa). The appliance must be isolated from the gas supply line by closing its individual manual shut off valve at test pressures equal to or less than $\frac{1}{2}$ psi (3.5 kPa).

Any pipe connections must be made using a thread sealant approved for gas connections. Failure to correctly install these items could lead to a gas leak and subsequent explosion.

The gas connection must be made in accordance with local codes or, in the absence of local codes, with

- the National Fuel Gas Code, ANSI Z 21.1 / NFPA 54 for the USA
- or
- the current Can / CGA B 149.1 and .2 Installation Codes for gas burning appliances for Canada.

Make sure that the maximum gas supply pressure before the gas pressure regulator is never more than $\frac{1}{2}$ psi for both natural gas or LP gas.

The minimum required gas pressure to get the required gas input is
4" w.c. for natural gas
10" w.c. for LP gas.

Gas pressure regulator

A pressure regulator that is convertible from natural to LP gas (Propane) or vice versa is included with the appliance. The included regulator corresponds with the gas type of the cooktop. Verify before installing.

The adjusted pressure is:

natural gas - 4" w.c.

LP gas - 10" w.c.

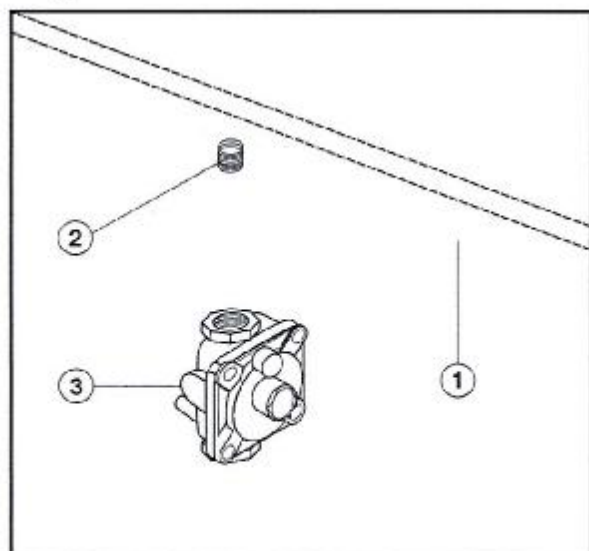

① Cooktop

② ½" NPT

③ Regulator

As shown in the above diagram, the included regulator **must** be used when connecting the Miele cooktop to your gas supply. This item has been customized by Miele to meet all applicable safety requirements. Make sure the regulator is easily accessible for adjustment after the appliance has been installed.

For convenience, an AGA or CGA approved flexible stainless steel gas hose (accordion type) may be used between the gas connection and the regulator. This will allow the appliance to be lifted out of the countertop for cleaning or servicing. Make sure that any drawers, cabinet doors, etc., do not rub on this gas hose.

Do not use any regulator unless it has been supplied by Miele. Doing so may cause a gas leak.

If there is any doubt concerning installation contact the Miele Technical Service Department:

USA 1-800-999-1360
techserv@mieleusa.com

CDN 1-800-565-6435
service@miele.ca

After connecting the appliance check all fittings for gas leaks e.g. with soapy water.

When installed properly, the flame will be steady and quiet. It will also have a sharp, blue inner core that will vary in length proportional to the burner size. Flame adjustment will not be necessary.

Gas connection

Nominal Rating Table

lot 26 North 88

	KM 3464 / KM 3465		KM 3474 / KM 3475		KM 3484 / KM 3485	
	NG / LP-Gas		NG / LP-Gas		NG / LP-Gas	
Normal burner	BTU/hr	kW	BTU/hr	kW	BTU/hr	kW
Max. output	9,000	2.6	9,000	2.6	9,000	2.6
Min. output	1,700	0.50	1,700	0.50	1,700	0.5
Fast burner						
Max. output	12,000	3.5	12,000	3.5	12,000	3.5
Min. output	2,500	0.73	2,500	0.73	2,500	0.73
Wok burner left						
Max. output	15,300	4.5	15,300	4.5	15,300	4.5
Min. output	620	0.18	620	0.18	620	0.18
Wok burner right						
Max. output	-	-	15,300	4.5	16,500	4.8
Min. output	-	-	620	0.18	620	0.18
All burners						
Max. output	45,300	13.2	60,600	17.7	73,800	21.6

Converting to another type of gas

The cooktop should have been ordered for connection to either natural or LP gas.

If the cooktop is not configured for the proper type of gas connection please contact your Miele Dealer.

lot 26
North 88

Help protect our environment

Disposal of packing materials

The cardboard box and packing materials are biodegradable and recyclable. Please recycle.

Disposal of an old appliance

Old appliances contain materials that can be recycled. Please contact your local recycling center about the possibility of recycling these materials.

Before discarding an old appliance, disconnect it from the gas and electrical supply and cut off the power cord to prevent it from becoming a hazard.

lot 26
North 88

Please have the model and serial number
of your appliance available before
contacting Technical Service.

Miele

1st 2b
N 88

**U.S.A.
Miele, Inc.**

National Headquarters

9 Independence Way
Princeton, NJ 08540
Phone: 800-843-7231
609-419-9898
Fax: 609-419-4298
www.miele.com

**Technical Service & Support
Nationwide**

Phone: 800-999-1360
Fax: 888-586-8056

TechnicalService@mieleusa.com

**Canada
Miele Limited**

Headquarters and Showroom

161 Four Valley Drive
Vaughan, ON L4K 4V8
Phone: 800-643-5381
905-660-9936
Fax: 905-532-2290
www.miele.ca
info@miele.ca (general enquiries)
professional@miele.ca (commercial enquiries)

MieleCare National Service

Phone: 800-565-6435
905-532-2272

Alterations rights reserved / 4212

M.-Nr. 06 818 490 / 06



INFORMATION IS SUBJECT TO CHANGE. PLEASE REFER TO OUR WEBSITE TO OBTAIN THE MOST
CURRENT PRODUCT SPECIFICATIONS, TECHNICAL & WARRANTY INFORMATION.



Print Page



30" H 6580 BP ContourLine SensorTronic Convection Oven

- SensorTronic Display (5-Line text TFT)
- MasterChef automatic programs
- Ergonomic swivel handle
- Roast probe
- Self-Clean function and Pyro Fit self-clean safe racks

lot
26
N88

Miele Pricing

\$5,999.00

[Find a Retailer](#)

Miele Advantage

\$6,309.00

Miele Advantage Plus

\$6,769.00

[What is this?](#)

Promotions:



Save up to 10% with the Miele Complete Cooking Program and receive a Free 5 Year Warranty on all Miele cooking appliances

[Learn More](#)

Product Details	Downloads	Accessories	ForeverCare
Series			
Product design line	ContourLine		
Width			
Size in inches	30"		
Oven Type			
Oven	•		
Single oven	•		
Design			

SENATOR HOMES
DECOR CENTRE

DATE: 07/21/15

INITIALS:

lot # 26

Cave

Ergonomic Swivel handle •

CleanTouch Steel with ContourLine handle •

Controls

SensorTronic •

Oven Interior & Lighting

Interior oven usable volume

131.24 L

Identification of shelf levels •

Number of convection fans

2

PyroFit Self-Clean Safe Racks and Side-Runners •

Halogen lighting •

Programs

Favourites •

Sabbath Program •

Pizza •

Low Temperature Cooking •

MasterChef Programs •

Auto Roast •

Gentle Bake •

Maxi Broil •

Broil •

Convection Bake •

Intensive •

Surround •

Bake •

Browning •

Convection Broil •

Defrost •

Dehydrate •

Reheat •

Proof •

Warm-up Cookware •

Safety and Convenience

lot 26
N 88SENATOR HOMES
DECOR CENTRE

DATE:

INITIALS:

07/3/15

Cana

lot 26

Appliance cooling system	•	107 26 N 88
Cool touch fronts	•	
System Lock	•	
Safety switch-off	•	
Appliance Care		
Self Clean - enamelled interior	•	
CleanGlass door	•	
Features		
Digital display	•	
Multilingual display	•	
Timer	•	
Date display	•	
Temperature display (F/C)	F/C	
Metric/Imperial conversion	•	
Recommended temperature per operating mode	•	
Accessories Included		
Roast probe	1	
Anti-splash tray	1	
Universal Tray with PerfectClean Coating	1	
PyroFit wire rack (Stainless steel)	3	

Back to Top

SENATOR HOMES
DECOR CENTRE
DATE: 17/5/15
INITIALS: Cam
hot 26

Miele

lot 26
N 88

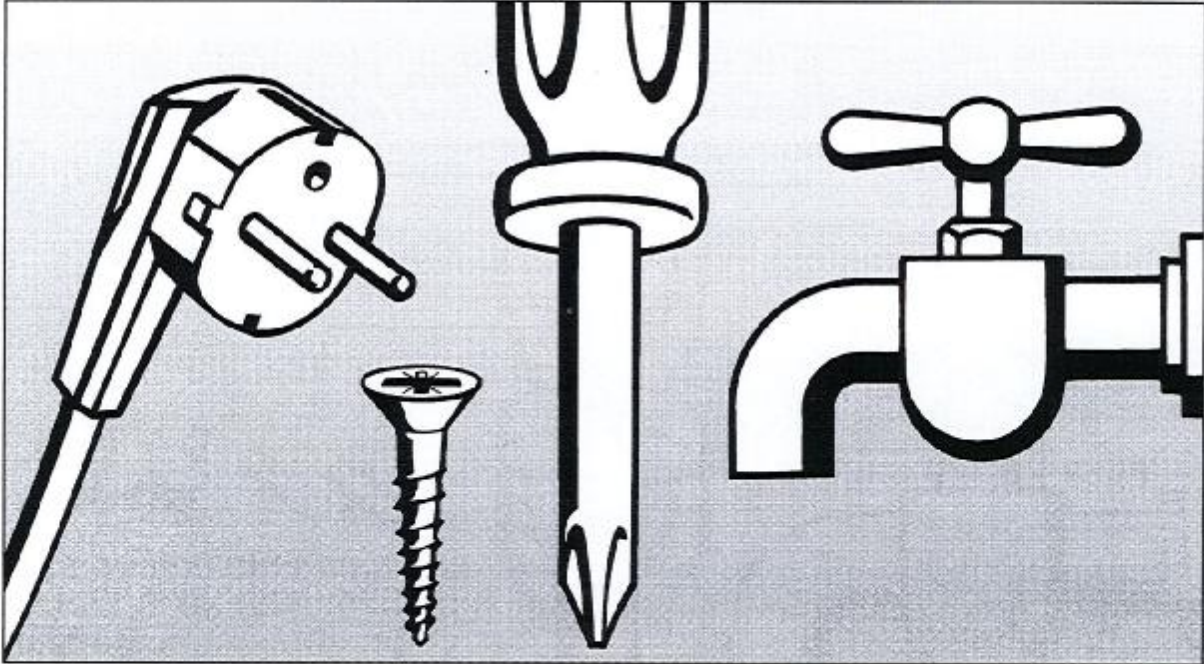

Installation Instructions

H 6580 BP

en - CA

H 6680 BP

Installation, repair and maintenance work should be performed by a Miele authorized service technician in accordance with national and local safety regulations and the provided installation instructions.

Electrical connection

CAUTION:

Before servicing, disconnect the power supply by either removing the fuse, shutting off the power main or manually "tripping" the circuit breaker.

Installation, repair and maintenance work must be performed by a Miele authorized service technician. Work by unqualified persons could be dangerous and may void the warranty.

Before connecting the appliance to the power supply, make sure that the voltage and frequency listed on the data plate correspond with the household electrical supply. This data must correspond to prevent machine damage. Consult an electrician if in doubt.

Only operate the appliance after it has been installed into cabinetry.

The plug must be plugged into an appropriate outlet that is installed and grounded in accordance with all local codes and ordinances.

WARNING: THIS APPLIANCE MUST BE GROUNDED

Installer: Please leave these instructions with the consumer.

Electrical connection

The oven is equipped with a power cord approx. 7' 2" (2.2 m) in length with a NEMA 14-30 P plug ready for connection to the power supply:

– 120/208 V, 30 A, 60 Hz

or

– 120/240 V, 30 A, 60 Hz

The voltage can be adjusted (see "Settings - Electrical Version").

SAVE THESE INSTRUCTIONS FOR THE ELECTRICAL INSPECTOR'S USE.

(NEMA 14-30P, L1, L2, N, G, 30 amp 208/240 VAC)

Installation diagrams

Appliance and cut-out dimensions

Miele ovens can be installed flush or proud. Discuss your installation requirements with your architect, designer and installer.

10+26
N88

Undercounter installation

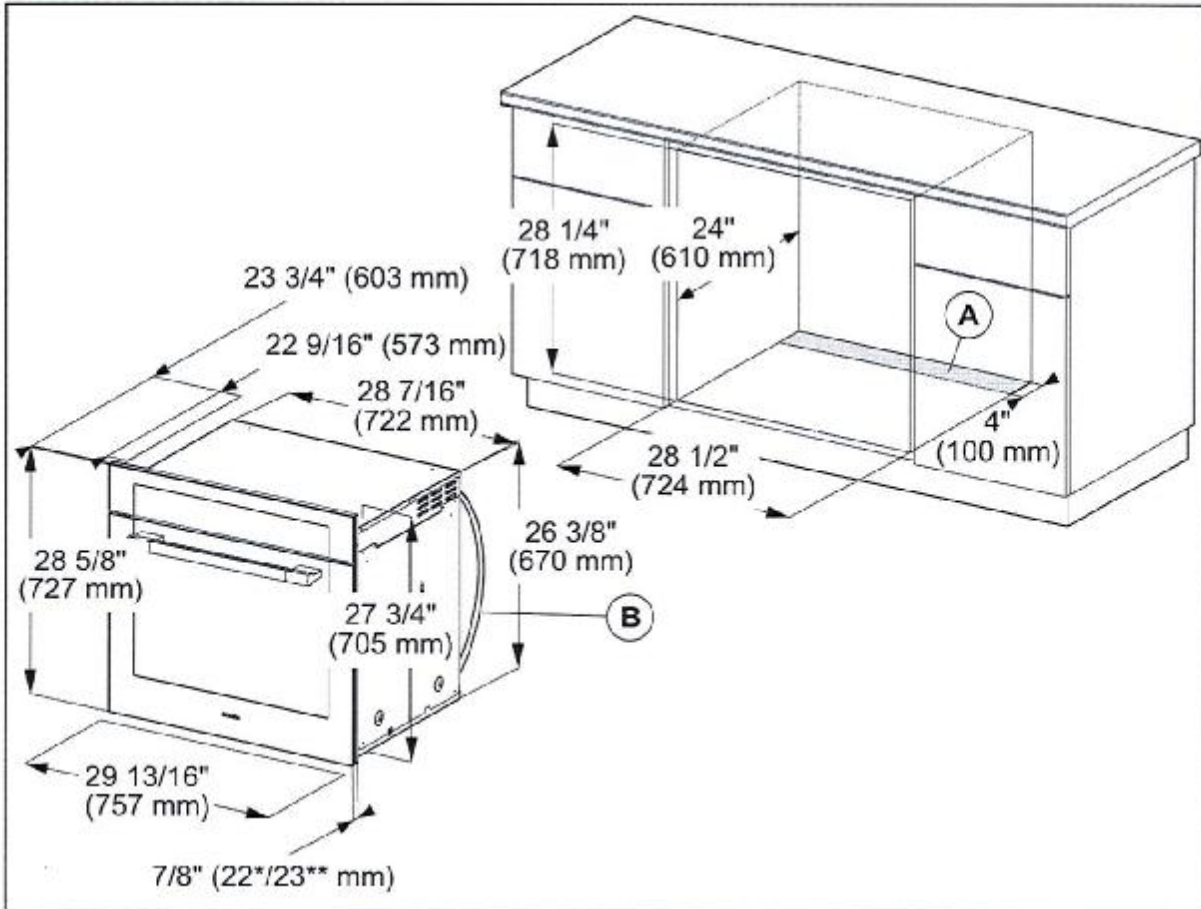

Ⓐ Cut-out (4" x 28" / 100 mm x 720 mm) in the bottom of the cabinet for power cord and ventilation

Ⓑ Power cord with plug

* Oven with glass front

** Oven with metal front

Front design may vary depending on model. For the more current specifications please visit the Miele website.

Installation diagrams

Installation into a tall cabinet

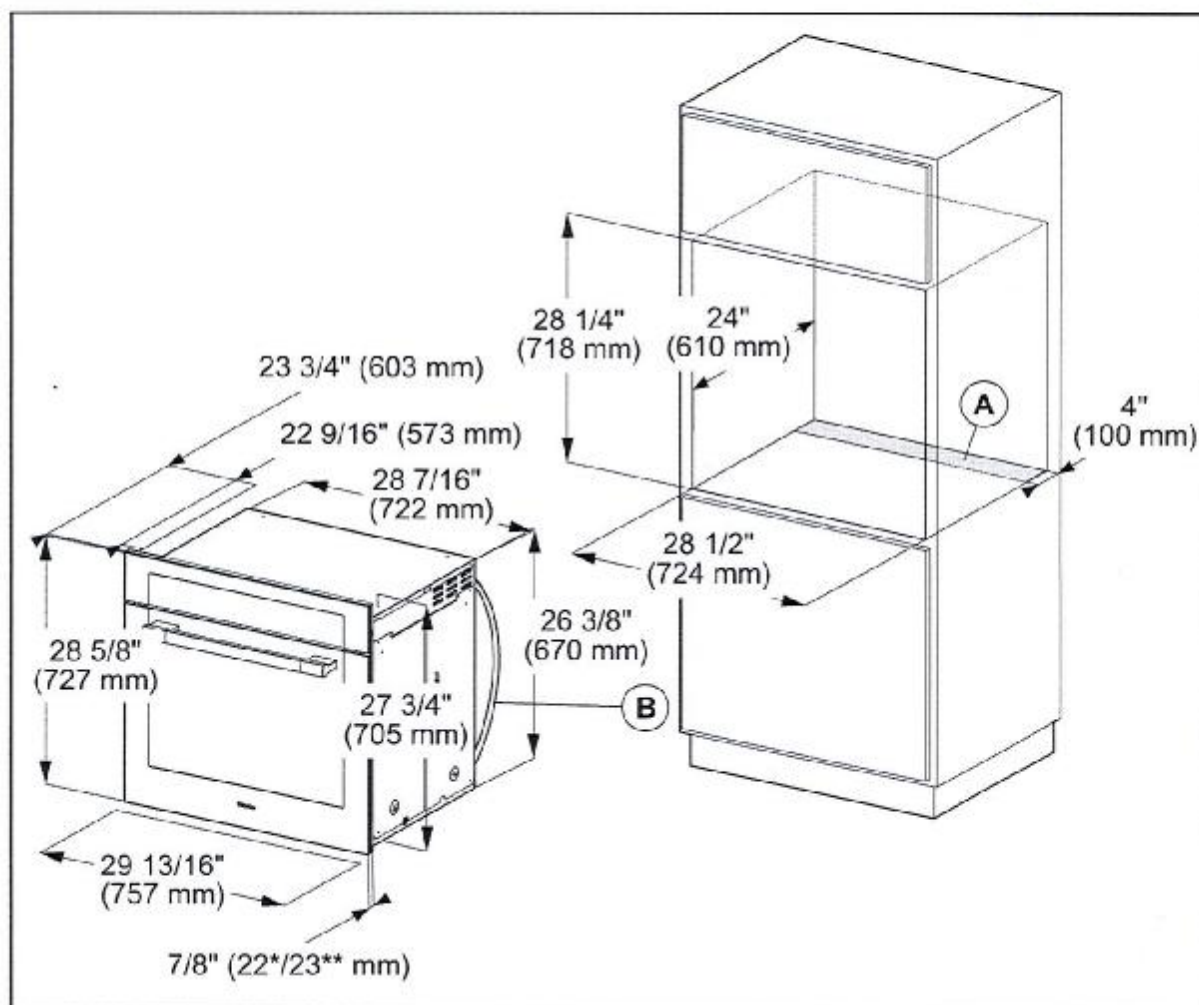

- Ⓐ Cut-out (4 " x 28 " / 100 mm x 720 mm) in the bottom of the cabinet for power cord and ventilation
- Ⓑ Power cord with plug
- * Oven with glass front
- ** Oven with metal front

Front design may vary depending on model. For the more current specifications please visit the Miele website.

CFM	
CFM	625
Lighting	
Halogen lighting	•
Circulation	
Vented application	•
Recirculated application	•
Hood Integration	
Wall hood	•
Operation	
Clean Cover	•
Programmable automatic intensive level switch off	•
Dishwasher-safe metal filters	•
Double-sided blower	•
Accessories and custom options	
Sound-Reducing Kit	DASD 150 silencer
Wall Vent	•
Reducing collar for 300 CFM operation	•
Recirculation kit	DUW20
Extension kits	DATK1-760, DATK2-1000
Custom height solutions	•
Active charcoal filters	DKF12-1

lot 26
N88

Back to Top

SENATOR HOMES
DECOR CENTRE
DATE: 01/2/15
INITIALS: Canner
lot 26

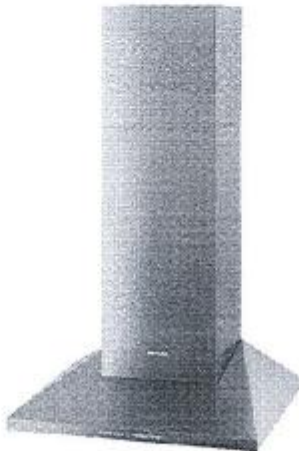
lot 26
CD N88**Miele**
IMMER BESSER[Print Page](#)

30" DA398-6 Wall Hood, Diamond Shape

- Double sided blower moves up to 625 CFM
- Integrated halogen lighting
- Dishwasher safe metal filters
- Programmable intensive level switch off
- Vented or recirculating

Miele Pricing

\$2,099.00

[Find a Retailer](#)

Miele Advantage

\$2,279.00

Miele Advantage Plus

\$2,539.00

[What is this?](#)

Promotions:



Save up to 10% with the Miele Complete Cooking Program and receive a Free 5 Year Warranty on all Miele cooking appliances

[Learn More](#)

Product Details	Downloads	Recommended Products	ForeverCare
Width			
Width		30" (76 cm)	
Design			
Diamond shaped		•	
Stainless steel		•	
Controls			
Front mounted controls for lights/4 fan speed		•	

SENATOR HOMES
DECOR CENTREDATE: Oct 2/15INITIALS: Carrie

lot 26

Miele

lot 26
N 88

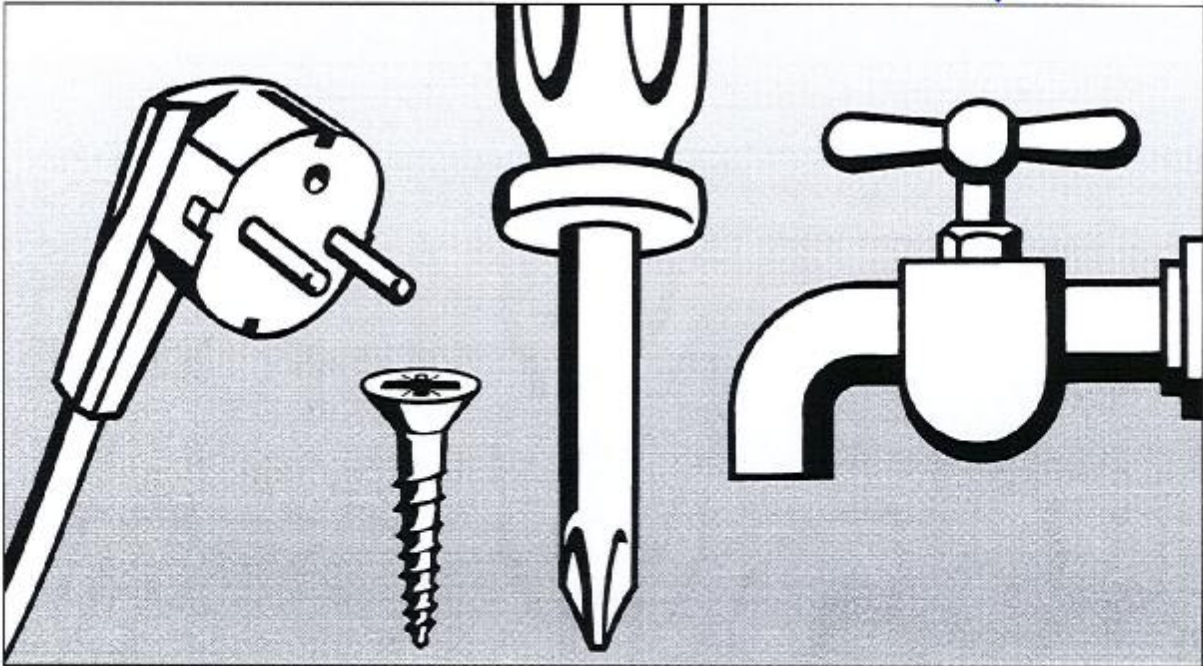

Installation Instructions DA398-6, DA399-6

en - CA

Installation, repair and maintenance work should be performed by a Miele authorized service technician in accordance with national and local safety regulations and the provided installation instructions.

10726

Installation

Before installation

⚠ Before installing the appliance, read all of the information contained in this chapter and also in the "IMPORTANT SAFETY INSTRUCTIONS" section.

Removing the protective film

The housing components are covered by a protective film to prevent them from becoming damaged during transport.

- Please remove this film before installing the housing components. It can be peeled off easily without any additional tools.

Installation Instructions

Please refer to the accompanying installation sheet for instructions on how to install the appliance.

Disassembly

If the device ever needs to be disassembled, follow the installation sheet instructions in reverse order. A lever is provided to assist with the removal of the chimney.

- Unscrew the two mounting screws on the chimney.

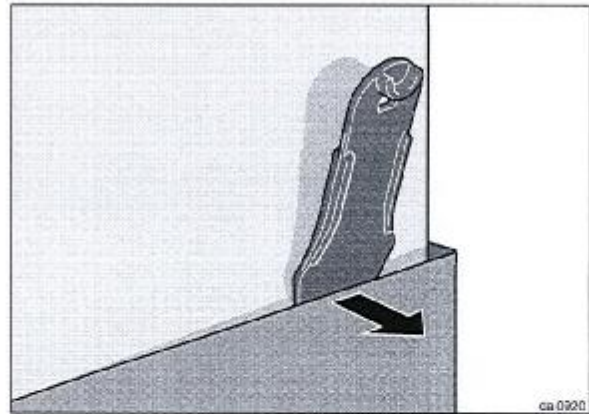

- Slide the supplied lever between the chimney and the extension piece.
- Pry the chimney out of its attachment.

Installation

10+26-7 N88

Installation parts

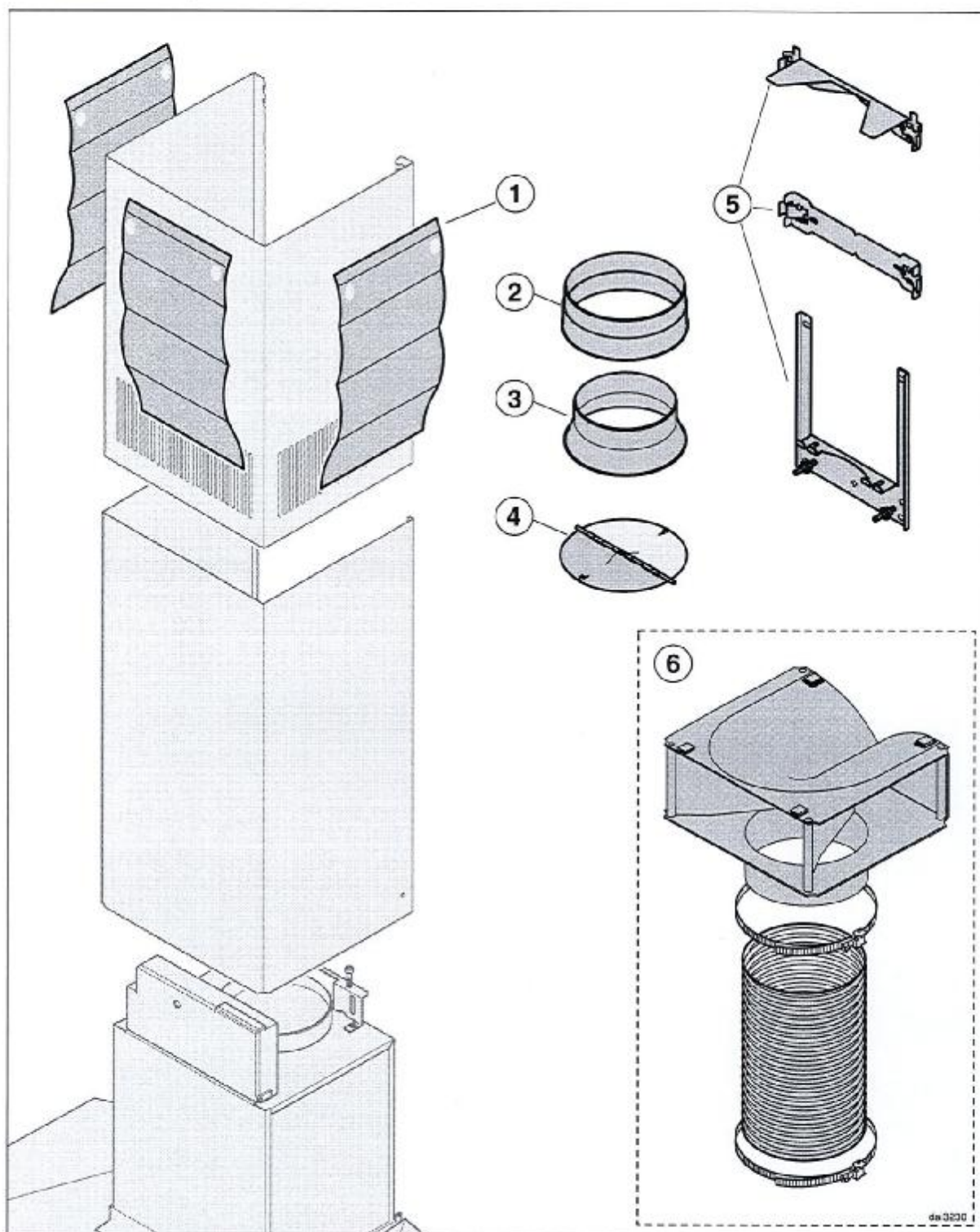

Installation

- ① **3 protective installation sheets**
for use when installing the chimney
- ② **1 exhaust connector**
for an exhaust duct \varnothing 6" (150 mm).
- ③ **1 reducer**
for an exhaust duct \varnothing 5" (125 mm).
- ④ **1 non-return flap**
for installation in the outlet duct collar of the motor unit (not for recirculation mode). Depending on the device version, the non-return flap is already mounted.
- ⑤ **Wall bracket**
for securing the hood on the wall.
- ⑥ **Recirculation kit for recirculation mode**
contains diverter, aluminum hose and hose clamps (not contained in scope of delivery, available as optional accessory – see "Technical Data").



5.68346-01.002.05

8 screws, $\frac{3}{16}$ " x $2\frac{3}{8}$ " (5 x 60 mm)

8 plugs, $\frac{5}{16}$ " x 2" (8 x 50 mm)
for attaching to the wall (not for use in USA / CDN).

The screws and plugs are designed for use in solid walls only.
Use different fasteners for other wall construction types.
Make sure that the wall can support the load.



00031622

2 x M 6 locknuts
for securing the canopy.



00254613

2 screws $\frac{1}{8}$ " x $\frac{5}{16}$ " (3.9 x 7.5 mm)
for attaching the chimney.



000337-6

1 lever
for disassembling the chimney.



000337-6

Installation sheet

Installation

Appliance dimensions

lot 26
N 88

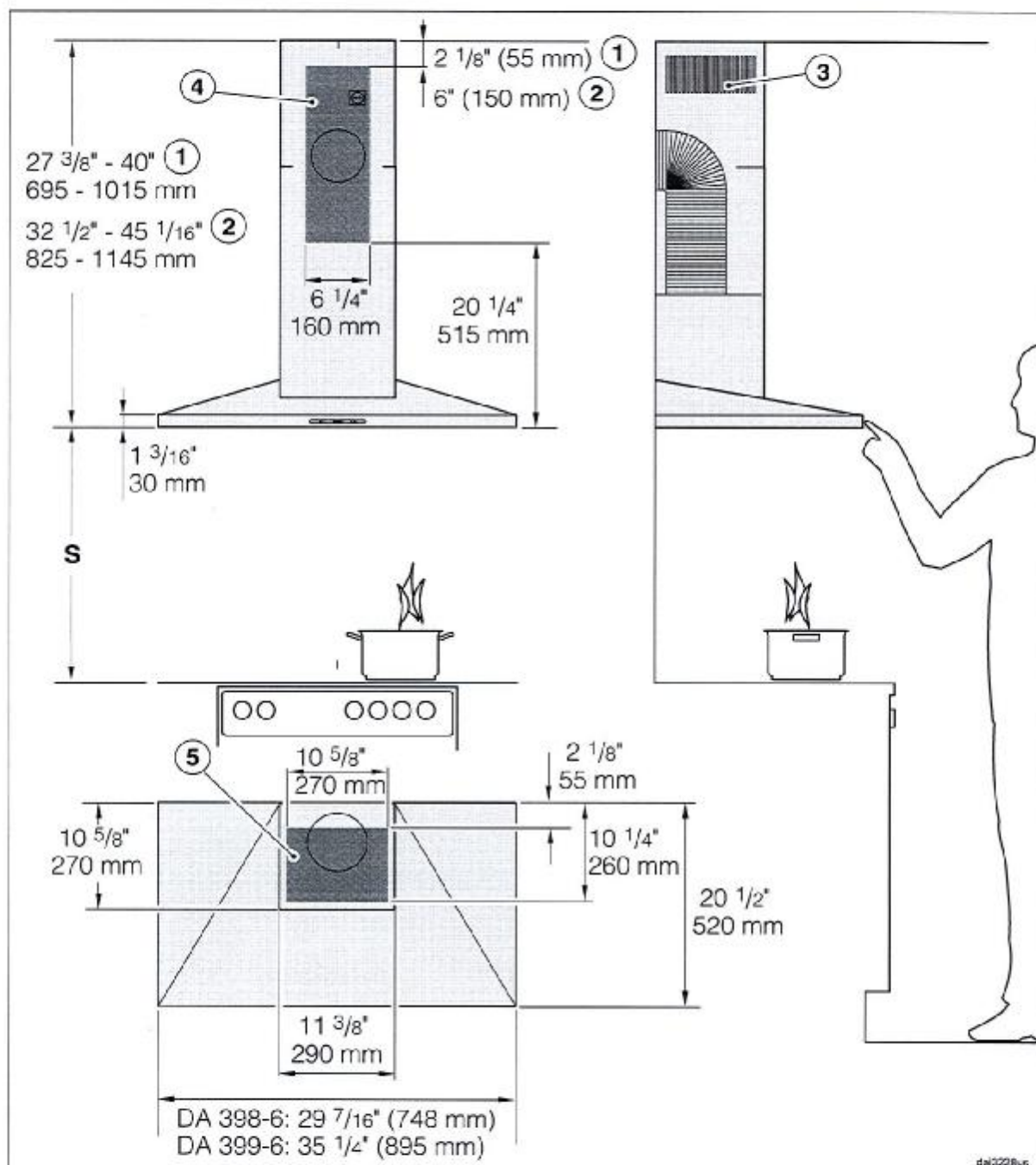

① Extraction

② Recirculation

③ Air vent positioned at top for recirculation

10726
N88

Installation

- ④⑤ Mounting area (only ④ is required for recirculation hoods). Wall and ceiling area for exhaust duct opening and for wall socket installation. Only the wall socket installation is required for recirculation hoods.

Vent collar Ø 6" (150 mm), with adapter Ø 5" (125 mm).

Distance between cooktop and ventilation hood (S)

Provided a larger distance is not given by the manufacturer of the cooktop, follow the minimum safety distances between a cooktop and the bottom of the hood.

Please also observe the information contained in the "IMPORTANT SAFETY INSTRUCTIONS" section.

Cooking appliance	Minimum distance S	
	Miele appliance	Non-Miele appliance
Electric/Induction cooktop	24" (610 mm)	
Electric grill, deep fat fryer (electric)	26" (660 mm)	
Multi-burner gas cooktop ≤ 43,000 BTU/hr (12.6 W), no burner > 15,000 BTU/hr (4.5 kW).	26" (660 mm)	30" (760 mm)
Multi-burner gas cooktop ≤ 73,800 BTU/hr (21.6 W), no burner > 16,500 BTU/hr (4.8 kW)	30" (760 mm)	
Multi-burner gas cooktop > 73,800 BTU/hr (21.6 W), or one of the burners > 16,500 BTU/hr (4.8 kW)	Not possible	
Single-burner gas cooktop ≤ 20,500 BTU/hr (6 kW)	26" (660 mm)	30" (760 mm)
Single-burner gas cooktop > 20,500 BTU/hr (6 kW) ≤ 27,600 BTU/hr (8.1 kW)	30" (760 mm)	
Single-burner gas cooktop > 27,600 BTU/hr (8.1 kW)	Not possible	

Installation

Installation recommendations

- We also recommend a distance of at least $25\frac{1}{2}"$ (650 mm) above electric cooktops to provide more workspace and easier cooking under the hood.
- When selecting an installation height, always take the user height into consideration. Users should have ample space to work comfortably on the cooktop and reach the ventilation hood controls with ease.
- Please note that the greater the distance from the cooktop, the less effective the hood is at drawing in the cooking vapors.
- To achieve optimal vapor extraction, make sure that the hood covers the cooktop. The hood should be positioned centrally over the cooktop, not to the side or rear.
- The cooktop should be no wider than the hood. Preferably, it should be narrower.
- The mounting area must be easily accessible. The ventilation hood should be easy to reach and disassemble in case a service call is necessary. This should be taken into consideration when planning the position of cupboards, shelves, ceilings or decorative elements in the vicinity of the ventilation hood.

Drilling diagram for wall mounting

- When drilling, please follow the directions contained on the accompanying installation sheet.

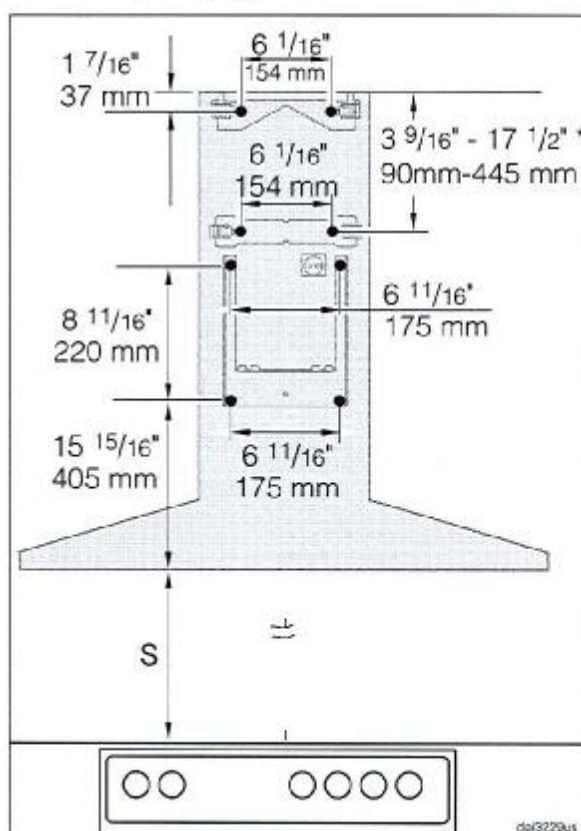

- When installing a custom back wall with pre-drilled holes, please refer to the drilling distances in the drawing above (screws $\varnothing\frac{3}{16}"$ (5 mm)).

* The dimension for the middle wall bracket is variable. It will depend on the position of the wall vent and the socket. It should be set as low as possible.

Door hinges (left/right)	left
--------------------------	------

Back to Top

lot 26
N 88

SENATOR HOMES
DECOR CENTRE
DATE: 07/2/15
INITIALS: Cam
Lot 26

Miele
IMMER BESSER

NBS 7/10/26

Print Page

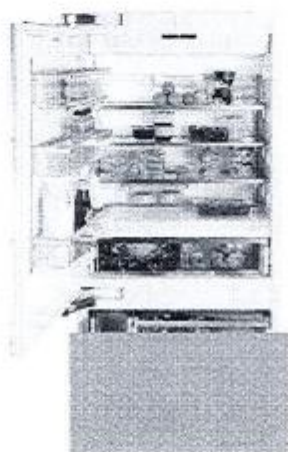

36" KF 1913 Vi MasterCool Bottom Mount Fridge/Freezer

A brighter way to see FRESH.

- Built-in
- Panel-ready
- Left-hinged
- MasterFresh food preservation ion system
- BrilliantLight

Miele Pricing

\$9,999.00

[Find a Retailer](#)

Miele Advantage

\$10,459.00

Miele Advantage Plus

\$11,029.00

[What is this?](#)

Promotions:



Save up to 10% with the Miele Complete Cooking Program and receive a Free 5 Year Warranty on all Miele cooking appliances

[Learn More](#)

Product Details	Downloads	Accessories	Recommended Products	ForeverCare
Series				
Type	MasterCool			
Width				
Refrigerator capacity	13.51 cu. ft. / 382.6 L			
Freezer capacity	4.77 cu. ft. / 135 L			
Width	36" (90 cm)			
Refrigeration Category				

* no water hose *

SENATOR HOMES
DECOR CENTRE

DATE:

INITIALS:

07/2/15

Care

Lot-26

Bottom mount fridge freezer	•	10/26 N88
Design		
Automatic ice cube maker	•	
Water filter	•	
Holds custom door panels (not included)	•	
Built-in	•	
Shelving		
Floating deli drawer	•	
Full access storage drawers	•	
Drop-and-lock door bins	•	
Metal freezer baskets with adjustable compartments	•	
Spill proof shelves	•	
Lighting		
Halogen-based interior lighting system	•	
Features		
MasterFresh food preservation system	•	
Bypass cartridge	•	
Dual compressor system	•	
SuperFreeze function	•	
SuperCool function	•	
Dynamic cooling	•	
Remote vision module	•	
Door & temperature alarm	•	
Temperature & humidity touch controls (MasterCool™ controls)	•	
Independent cooling zones	•	
Technical Specifications		
Merging kit	KSK1002	
Energy Star qualified	•	
Door hinges		
MaxLoad door	•	

SENATOR HOMES
DECOR CENTRE
DATE: 07/2/15
INITIALS: Anne

10/26