



CONSTRUCTION SUMMARY

Teefy Developments Limited / 9130 Bathurst

Lot/Unit: 144 Phase/Building: 1 Model/Floor Plan: Bedford(22-2)

AUDIO AND SECURITY

Inv.3435	1 - TO LOCATE TWO (2) STANDARD ROUGH IN TELEPHONE OUTLETS INCLUDED IN OFFER	
	PURCHASER TO MEET DIRECTLY WITH GRAND ALARMS TO LOCATE	
Line 44344	Note:	
11Dec15 / 12Dec15		
Inv.3435	1 - TO LOCATE THREE (3) STANDARD ROUGH IN CABLE OUTLETS INCLUDED IN OFFER	
	PURCHASER TO MEET DIRECTLY WITH GRAND ALARMS TO LOCATE	
Line 44343	Note:	
11Dec15 / 12Dec15		

CABINETRY

Inv.3435	1 - LOCATION: KITCHEN	
	SUPPLY AND INSTALL TWO (2) POT DRAWERS IN KITCHEN AS PER SCHEDULE PE ITEM #8	
	NOTE: ONE (1) SET OF POT DRAWERS HAS BEEN DEFINED	
Line 44342	Note: LOCATION AS PER SKETCH ATTACHED	
11Dec15 / 12Dec15		
Inv.3435	1 - LOCATION: KITCHEN	
	CABINETRY - KITCHEN - UPGRADE - 12 - ELITE II - SUPPLY AND INSTALL	
Line 44361	Note: ANNEX DHGL ARCTICO MWP	
11Dec15 / 12Dec15		
Inv.3435	1 - LOCATION: KITCHEN	
	RELOCATE THE STANDARD BANK OF DRAWERS TO THE ISLAND	
Line 44372	Note: LOCATION AS PER SKETCH ATTACHED	
11Dec15 / 12Dec15		
Inv.3435	1 - LOCATION: KITCHEN	
	SUPPLY 36" STOVE AND HOOD FAN OPENING IN LIEU OF STANDARD 30"	
Line 44375	Note:	
11Dec15 / 12Dec15		
Inv.3435	1 - LOCATION: KITCHEN	
	DELETE THE UPPER CABINETS ABOVE STOVE AND SUPPLY FINISHED SIDES TO ACCOMMODATE FUTURE INSTALL OF CHIMNEY HOOD FAN	
Line 44376	Note: PURCHASER TO SUPPLY AND INSTALL OWN HOOD FAN AFTER CLOSING	
11Dec15 / 12Dec15		
Inv.3435	1 - LOCATION: KITCHEN - WAIVER	
	PURCHASER ACKNOWLEDGES AND ACCEPTS THAT SIZE OF BREAKFAST AREA WILL BE REDUCED TO ACCOMMODATE PANTRY AND ISLAND EXTENSION	
Line 44386	Note:	
11Dec15 / 12Dec15		

CABINETRY ACCESSORIES



CONSTRUCTION SUMMARY

Teefy Developments Limited / 9130 Bathurst

Lot/Unit: 144 Phase/Building: 1 Model/Floor Plan: Bedford(22-2)

Inv.3435	8 - LOCATION: KITCHEN	
	CROWN MOULDING - NOT APPLICABLE FOR THERMOVISION - PRICE IS PER 8 FOOT LENGTH	
Line 44394	Note:	
11Dec15 / 12Dec15		
Inv.3435	6 - LOCATION: KITCHEN	
	LIGHT VALANCE - NOT APPLICABLE FOR THERMOVISION - PRICE PER 8 FOOT LENGTH	
Line 44396	Note:	
11Dec15 / 12Dec15		

CABINETRY APPLIANCE - FRIDGE

Inv.3435	1 - LOCATION: KITCHEN	
	59 CM FRIDGE CABINET - 2 GABLES & CABINET 59 CM DEEP - DEEP - UPGRADE 1	
Line 44362	Note:	
11Dec15 / 12Dec15		

CABINETRY BASE CABINETS

Inv.3435	1 - LOCATION: KITCHEN	
	BASE PIE CUT CORNER - UPGRADE 1	
Line 44364	Note: LOCATION AS PER SKETCH ATTACHED	
11Dec15 / 12Dec15		
Inv.3435	4 - LOCATION: KITCHEN	
	BASE ISLAND WITH PANEL - PRICE IS PER FOOT - INCLUDES 27 INCH DEEP COUNTER FROM VENDORS STANDARD LINE - UPGRADE 1	
	REQUIRED TO EXTEND ISLAND WHICH WILL INCLUDE BANK OF DRAWERS AND RECYCLE BINS	
Line 44381	Note:	
11Dec15 / 12Dec15		
Inv.3435	9 - LOCATION: KITCHEN	
	BASE CABINET 30 CM (12 INCH) DEEP - PRICE IS PER FOOT - UPGRADE 1 TO BE LOCATED BENEATH FLUSH BREAKFAST BAR THEREFORE BREAKFAST BAR IS NOT USEABLE	
	OPERATING DOORS HAVE BEEN PURCHASED SEPARATELY	
Line 44384	Note:	
11Dec15 / 12Dec15		

CABINETRY HARDWARE

Inv.3435	1 - LOCATION: KITCHEN	
	BASE WASTE / RECYCLE CENTER PULL OUT DOOR - ONLY AVAILABLE IN 45 CM CABINET (2) 35L BINS - PRICE IS PER UNIT	
	TO BE LOCATED IN ISLAND	
Line 44385	Note: LOCATION AS PER SKETCH ATTACHED	
11Dec15 / 12Dec15		



CONSTRUCTION SUMMARY

Teefy Developments Limited / 9130 Bathurst

Lot/Unit: 144 Phase/Building: 1 Model/Floor Plan: Bedford(22-2)

CABINETRY LAUNDRY

Inv.3435	2 - LAUNDRY ROOM	
	LAUNDRY BASE - INCLUDES LAMINATE COUNTER TOP - PRICE IS PER FOOT - UPGRADE 1	
Line 44413	Note: CLASSIC - LANCASTER PAINT CANNOLI - HANDLE 9677 COUNTER-TOP: P-277-LM BEDROCK	
11Dec15 / 12Dec15		

CABINETRY MICROWAVE OVEN STOVE COOKTOP

Inv.3435	1 - LOCATION: KITCHEN	
	MICROWAVE CABINET WITH SHELF - OPENING APPROXIMATELY 27-30 INCHES WIDE X 13 3/4 INCHES HIGH - PURCHASER MUST SUPPLY SPECS - UPGRADE 1	
	NOTE: SPECS AND TRIM KIT ATTACHED	
Line 44373	Note: TO BE LOCATED IN UPPER CABINETS NEXT TO FRIDGE - SEE SKETCH	
11Dec15 / 12Dec15		

CABINETRY PANTRY

Inv.3435	4 - LOCATION: KITCHEN	
	PANTRY 30 CM DEEP - PRICE IS PER FOOT - UPGRADE 1 TO CONTINUE WITH BASE AND UPPER CABINETS TOWARD BREAKFAST AREA	
Line 44380	Note: LOCATION AS PER SKETCH ATTACHED	
11Dec15 / 12Dec15		

CABINETRY VANITY

Inv.3435	1 - LOCATION: MAIN BATHROOM	
	VANITY BANK OF DRAWERS - 55 CM MAXIMUM - UPGRADE 1 TO BE LOCATED ON SIDE CLOSEST TO TOILET	
Line 44416	Note: LOCATION AS PER SKETCH ATTACHED	
11Dec15 / 12Dec15		
Inv.3435	1 - LOCATION: MASTER ENSUITE	
	VANITY BANK OF DRAWERS (60 CM TO 90 CM) - SEE NOTE L - UPGRADE 1 TO BE CENTRED BETWEEN VANITY SINKS IN MASTER ENSUITE	
Line 44418	Note: LOCATION AS PER SKETCH ATTACHED	
11Dec15 / 12Dec15		

CABINETRY WALL AND HUTCH

Inv.3435	1 - LOCATION: KITCHEN	
	UPPER ANGLE CORNER - PRICE IS PER UNIT - UPGRADE 1	
Line 44370	Note: LOCATION AS PER SKETCH ATTACHED	
11Dec15 / 12Dec15		
Inv.3435	1 - LOCATION: KITCHEN	
	GLASS DOOR FROSTED - WHITE CABINET INTERIOR - UPGRADE 1 TO BE LOCATED IN UPPER ANGLE CORNER CABINET	
Line 44368	Note: LOCATION AS PER SKETCH ATTACHED	
11Dec15 / 12Dec15		



CONSTRUCTION SUMMARY

Teefy Developments Limited / 9130 Bathurst

Lot/Unit: 144 Phase/Building: 1 Model/Floor Plan: Bedford(22-2)

COUNTER TOP - EXTRAS

Inv.3435	1 - LOCATION: KITCHEN	
	SUPPLY AND INSTALL STANDARD LINE CAESARSTONE TO EXTENSION OF ISLAND APPROXIMATELY 4' FEET - WITH STANDARD SQUARE EDGE	
Line 44391	Note: 9141 ICE SNOW	
11Dec15 / 12Dec15		

ELECTRICAL

Inv.3435	1 - LOCATION: KITCHEN	
	SUPPLY AND INSTALL ADDITIONAL INTERIOR RECEPTACLE ON SEPARATE CIRCUIT (IE: MICROWAVE, FREEZER) TO ACCOMMODATE BUILT IN MICROWAVE NEXT TO FRIDGE	
Line 44374	Note: LOCATION AS PER SKETCH ATTACHED.	
11Dec15 / 12Dec15		

Inv.3435	1 - LOCATION: KITCHEN	
	SUPPLY AND INSTALL ADDITIONAL INTERIOR RECEPTACLE ON SEPARATE CIRCUIT (IE: MICROWAVE, FREEZER) TO ACCOMMODATE FUTURE CHIMNEY HOOD FAN	
Line 44377	Note: PURCHASER TO SUPPLY AND INSTALL OWN CHIMNEY HOOD FAN AFTER CLOSING	
11Dec15 / 12Dec15		

Inv.3435	1 - LOCATION: KITCHEN	
	SUPPLY AND INSTALL LIGHT VALANCE ROUGH IN (INCLUDES 1 SWITCH)	
Line 44392	Note: LOCATION TO BE DETERMINED BY VENDOR	
11Dec15 / 12Dec15		

Inv.3435	1 - LOCATION: KITCHEN	
	ELECTRICAL - 220V REQUIRED TO ACCOMMODATE DUAL FUEL STOVE	
Line 44393	Note:	
11Dec15 / 12Dec15		

HEATING AND AIR CONDITIONING

Inv.3435	1 - LOCATION: KITCHEN	
	GAS LINE - ROUGH-IN ONLY - FOR STOVE TO INCLUDE 110V CODE REQUIREMENT	
Line 44387	Note:	
11Dec15 / 12Dec15		

Inv.3435	1 - LOCATION: REAR EXTERIOR	
	GAS LINE - ROUGH-IN ONLY - FIRST CONNECTION- FOR BBQ TO BE LOCATED ON MAIN FLOOR - OUTSIDE SLIDING DOOR FROM KITCHEN	
Line 44410	Note: LOCATION AS PER SKETCH ATTACHED	
11Dec15 / 12Dec15		

Inv.3435	1 - LOCATION: MECHANICAL ROOM	
	SUPPLY AND INSTALL HUMIDIFIER (MIST TYPE FROM VENDOR'S STANDARD SELECTIONS)	
Line 44411	Note:	
11Dec15 / 12Dec15		



CONSTRUCTION SUMMARY

Teefy Developments Limited / 9130 Bathurst

Lot/Unit: 144 Phase/Building: 1 Model/Floor Plan: Bedford(22-2)

MISCELLANEOUS

Inv.3435	1 - LOCATION: RECREATION ROOM SUPPLY AND INSTALL HARDWOOD FROM VENDOR'S STANDARD SAMPLES TO RECREATION ROOM IN LOWER LEVEL AS PER SCHEDULE PE ITEM #5 Line 44340 Note: 3/4" X 3-5/8" GENERATIONS SATIN FINISH RED OAK - GRAPHITE	
11Dec15 / 12Dec15		
Inv.3435	1 - LOCATION: ALL BEDROOMS INCLUDING BEDROOM 4 IN LOWER LEVEL SUPPLY AND INSTALL HARDWOOD FROM VENDOR'S STANDARD SAMPLES TO ALL BEDROOMS AS PER SCHEDULE PE ITEM #4 Line 44339 Note: 3/4" X 3-5/8" GENERATIONS SATIN FINISH RED OAK - GRAPHITE	
11Dec15 / 12Dec15		
Inv.3435	1 - LOCATION: ALL BATHROOMS SUPPLY AND INSTALL GRANITE COUNTER-TOPS TO FROM VENDOR'S STANDARD SAMPLES TO ALL BATHROOMS AS PER SCHEDULE PE ITEM #6 Line 44341 Note: DOES NOT INCLUDE UNDERMOUNT SINKS OR POLISHED EDGES TO GRANITE	
11Dec15 / 12Dec15		
Inv.3435	1 - LOCATION: KITCHEN SUPPLY AND INSTALL CAESARSTONE STANDARD LINE KITCHEN BACKSPLASH BEHIND STOVE AND INCLUDING BEHIND CHIMNEY HOOD FAN UP TO LINE TO UPPER CABINETS Line 44397 Note: 9141 ICE SNOW	
11Dec15 / 12Dec15		
Inv.3435	1 - LOCATION: FAMILY ROOM SUPPLY AND INSTALL FURRED OUT WALL TO RECESS ELECTRIC FIREPLACE. WALL TO BE APPROXIMATELY 6 FEET +/- WIDE AND APPROXIMATELY 10 INCHES +/- DEEP FROM FLOOR TO CEILING. Line 44398 Note: DO NOT LOWER THE FIREPLACE - LEAVE AT STANDARD HEIGHT	
11Dec15 / 12Dec15		
Inv.3435	5 - LOCATION: ALL BATHROOMS CUT OUT FOR UNDERMOUNT SINKS AND POLISHING TO EDGES TO ACCOMMODATE UNDERMOUNT SINKS Line 44403 Note:	
11Dec15 / 12Dec15		

PLUMBING

Inv.3435	1 - LOCATION: KITCHEN SUPPLY AND INSTALL WATERLINE ROUGH-IN TO THE FRIDGE LOCATION (NO HOOK UP) Line 44388 Note: LOCATION AS PER SKETCH ATTACHED.	
11Dec15 / 12Dec15		



CONSTRUCTION SUMMARY

Teefy Developments Limited / 9130 Bathurst

Lot/Unit: 144 Phase/Building: 1 Model/Floor Plan: Bedford(22-2)

Inv.3435	5 - LOCATION: ALL BATHROOMS	
	SUPPLY AND INSTALL UNDERMOUNT SINKS IN LIEU OF STANDARD SINKS TO ALL BATHROOMS - 20" RECTANGULAR MODEL CATENA #4210 CIY WHITE	
Line 44402	Note:	
11Dec15 / 12Dec15		
Inv.3435	1 - LOCATION: MASTER ENSUITE	
	FRAMELESS GLASS SHOWER ENCLOSURE WITH CHROME TOP FRAME ONLY	
Line 44412	Note:	
11Dec15 / 12Dec15		

PLUMBING - KITCHEN FAUCETS:

Inv.3435	1 - LOCATION: KITCHEN	
	SUPPLY AND INSTALL UPGRADE FAUCET TO KITCHEN - MOEN 90 DEGREE MODEL #S7597 CHROME - SINGLE HANDLE PULL OUT FAUCET	
Line 44389	Note:	
11Dec15 / 12Dec15		

TILE - FLOOR

Inv.3435	1 - LOCATION: POWDER ROOM	
	SUPPLY AND INSTALL FLOOR TILE - UPGRADE 8 - - POWDER ROOM FLOOR	
	STANDARD STACKED INSTALL	
Line 44400	Note: 12 X 24 MUST POLISHED (BROWN OV.MU.BWN.1224.PL)	
11Dec15 / 12Dec15		
Inv.3435	1 - LOCATION: FOYER	
	SUPPLY AND INSTALL FLOOR TILE - UPGRADE 8 - - VESTIBULE FLOOR	
	STANDARD STACKED INSTALL	
Line 44401	Note: 12 X 24 MUST POLISHED (BROWN OV.MU.BWN.1224.PL)	
11Dec15 / 12Dec15		
Inv.3435	1 - LOCATION: MASTER ENSUITE	
	SUPPLY AND INSTALL FLOOR TILE - UPGRADE 2 - - ENSUITE BATHROOM FLOOR	
Line 44405	Note: 13 X 13 VENUS ANTHRACITE (GE.VN.ATR.1313.MT)	
11Dec15 / 12Dec15		
Inv.3435	1 - LOCATION: MUD ROOM	
	SUPPLY AND INSTALL FLOOR TILE - UPGRADE 2 - - MUD ROOM IN BASEMENT (ON CONCRETE)	
Line 44406	Note: 13 X 13 VENUS BROWN (GE.VN.BWN.1313.MT)	
11Dec15 / 12Dec15		
Inv.3435	1 - LOCATION: MAIN BATH	
	SUPPLY AND INSTALL FLOOR TILE - UPGRADE 2 - - MAIN BATH FLOOR	
Line 44407	Note: 13 X 13 VENUS BROWN (GE.VN.BWN.1313.MT)	
11Dec15 / 12Dec15		



CONSTRUCTION SUMMARY

Teefy Developments Limited / 9130 Bathurst

Lot/Unit: 144 Phase/Building: 1 Model/Floor Plan: Bedford(22-2)

Inv.3435	1 - LOCATION: LAUNDRY ROOM	
	SUPPLY AND INSTALL FLOOR TILE - UPGRADE 2 - - LAUNDRY ROOM IN BASEMENT (ON CONCRETE)	
Line 44422	Note: 13 X 13 VENUS BROWN (GE.VN.BWN.1313.MT)	
11Dec15 / 12Dec15		

TILE - WALL

Inv.3435	1 - LOCATION: MASTER ENSUITE SHOWER STALL	
	SUPPLY AND INSTALL WALL TILE - UPGRADE 3 - - ENSUITE BATH SHOWER WITH CEILING	
Line 44409	Note: 10 X 16 VENUS ANTHRACITE (GE.VN.ATR.1016.) INSTALL HORIZONTAL (STACKED) IN LIEU OF VERTICAL	
11Dec15 / 12Dec15		

EXTRAS AS PER OFFER

Stainless Steel Fridge, Stove and Dishwasher and front loading washer and dryer in white from Vendors standard samples, no cash value, not transferable. (Supplied only not installed) ** to - arrange delivery call: The Brick commercial sales division at Worksheet Note:		
Rogers Free Services Package includes 6 months of: home phone, TV and Internet Service. Worksheet Note:		
The Vendor agrees to supply and install hardwood flooring in all bedrooms, with a choice of stain, from Vendors standard samples. Worksheet Note:		
The Vendor agrees to supply and install engineered hardwood flooring in recreation room from Vendors standard samples. Worksheet Note:		
The Vendor agrees to supply and install granite countertops in all bathrooms, including powder room, from Vendors standard samples. Worksheet Note:		
The Vendor agrees to supply and install optional fourth bedroom on lower level from Vendors standard plan and Vendors standard samples. The cost of \$5,000 is included in the purchase price. Worksheet Note:		
The Vendor agrees to supply and install two pot drawers in kitchen from Vendors standard samples. Location to be determined at decor appointment. Worksheet Note:		

Purchasers:
Julio Hernan Triana & Monica Kang

Property: 144 of Plan -

Telephone Res. / Bus: (416) 433-8386 /

Project: Teefy Developments Limited

Decor Advisor: Steffannee Appio

Model and Elevation: Bedford(22-2)

Layout Changes:
☒ Yes
☐ No

Sketch Attached:
☒ Yes
☐ No

Exterior Colour Scheme:

1. Cabinetry	Style and Colour	Counter Top	Hardware
Kitchen / Breakfast	ANNEX DHGLARCTICO GLOSS MWP	9141 ICE SNOW STD SQ EDGE	9677 HANDLE
Kitchen Island	ANNEX DHGLARCTICO GLOSS MWP	9141 ICE SNOW STD SQ EDGE	9677 HANDLE
Laundry Room	CLASS - LANCASTER PAINT CANNOLI	P-277-LM BEDROCK	9677 HANDLE
Powder Room	CLASS - LANCASTER PAINT CANNOLI	TAN BROWN STD SQ EDGE	KNOB 151
Main Bathroom	CLASS - LANCASTER PAINT CANNOLI	GRIGIO SARDO STD SQ EDGE	KNOB 151
Master Ensuite Bathroom	CLASS NEWPORT MAPLE SHALE GREY	NEW CALEDONIA ST SQ EDGE	KNOB 151
Second Ensuite Bathroom (If Applicable)	CAMDEN PAINT WINTER WHITE	UBA TUBA GRANITE STD SQ ED	KNOB 196
	LOWER LEVEL BATHROOM	LOWER LEVEL BATHROOM	LOWER LEV

Appliances

Custom Size Fridge
☒ Yes
☐ No

Valance Lighting
☒ Yes
☐ No

Microwave / Range Hood
☒ Yes
☐ No

Cooktop / Rangetop
☐ Yes
☒ No

Built in Wall Oven
☐ Yes
☒ No

Slide-in Range
☒ Yes
☐ No

Comment

BASE CABINET AND COUNTER-TOP TO LAUNDRY ROOM - UPGRADE

2. Flooring	Selection
FOYER	12 X 24 MUST POLISHED BROWN (0V.MU.BWN.1224.PL) STACKED INSTALL (UPGRADE 8)
Main Hall	3/4" X 3-5/8" GENERATIONS SATIN FINISH RED OAK - GRAPHITE
Back Hall	N/A
Breakfast	3/4" X 3-5/8" GENERATIONS SATIN FINISH RED OAK - GRAPHITE
Laundry Room	13 X 13 VENUS BROWN (GE.VN.BWN.1313.MT)
Kitchen	3/4" X 3-5/8" GENERATIONS SATIN FINISH RED OAK - GRAPHITE
Powder Room	12 X 24 MUST POLISHED BROWN (0V.MU.BWN.1224.PL) STACKED INSTALL (UPGRADE 8)
Main Bathroom	13 X 13 VENUS BROWN (GE.VN.BWN.1313.MT) UPGRADE 2
Master Ensuite	13 X 13 VENUS ANTHRACITE (GE.VN.ATR.1313.MT) UPGRADE 2
Bathroom (If Applicable)	13 X 13 COSTA MATTE GREY (GE.CA.GRY.1313.MT) N LOWER LEVEL BATHROOM
Mud Room	13 X 13 VENUS BROWN (GE.VN.BWN.1313.MT) LOWER LEVEL IN FRONT OF LAUNDRY ROOM
	UPGRADE FROM CARPET IN THIS AREA
Living Room	N/A
Dining Room	3/4" X 3-5/8" GENERATIONS SATIN FINISH RED OAK - GRAPHITE
Family / Great Room	3/4" X 3-5/8" GENERATIONS SATIN FINISH RED OAK - GRAPHITE
Den / Library / Study	3/4" X 3-5/8" GENERATIONS SATIN FINISH RED OAK - GRAPHITE (RECREATION ROOM LOWER LEV
Basement Landing (If Applies)	N/A
Lower Landing (If Applicable)	N/A
Upper Landing	3/4" X 3-5/8" GENERATIONS SATIN FINISH RED OAK - GRAPHITE
Upper Hall	3/4" X 3-5/8" GENERATIONS SATIN FINISH RED OAK - GRAPHITE
Master Bedroom	3/4" X 3-5/8" GENERATIONS SATIN FINISH RED OAK - GRAPHITE
Bedroom #2	3/4" X 3-5/8" GENERATIONS SATIN FINISH RED OAK - GRAPHITE
Bedroom #3	3/4" X 3-5/8" GENERATIONS SATIN FINISH RED OAK - GRAPHITE
Bedroom #4	3/4" X 3-5/8" GENERATIONS SATIN FINISH RED OAK - GRAPHITE (LOWER LEVEL)
Bedroom #5	N/A

Flooring Continued on Page 2

Initial:



Page 1 of 3

Printed 12/12/2015 15:01:48



INTERIOR COLOUR SCHEME

Purchasers: Julio Hernan Triana & Monica Kang

Property: 144 of Plan -

Telephone Res. / Bus: (416) 433-8386 /

Project: Teefy Developments Limited

Decor Advisor: Steffanee Appio

Model and Elevation: Bedford(22-2)

2. Flooring - Continued -

Upgrade Underpad	Type	Area
	N/A	N/A
Carpet on Stairs	Capped	Runner - *Upgrade
Comment	N/A	N/A

SCHEDULE PE ITEM #1 - HARDWOOD IN ALL BEDROOMS, UPPER HALLWAY, RECREATION ROOM AND BEDROOM 4

3. Plumbing Fixtures / Faucets

Kitchen	UPGRADE	Second Ensuite		Powder Room	STD
Master Ensuite	STD			Other Room	STD
Main Bathroom	STD				

Comment

4. Wall Tile

	Tile Selection	Listello	Insert	Insert Selection
Main Bathroom	8 X 10 VENUS BROWN (GE.VN.BWN.0810)	<input type="checkbox"/>	<input type="checkbox"/>	
Master Ensuite				
Tub Deck	N/A	<input type="checkbox"/>	<input type="checkbox"/>	
Tub Apron	N/A	<input type="checkbox"/>	<input type="checkbox"/>	
Tub Surround	N/A	<input type="checkbox"/>	<input type="checkbox"/>	
Shower Stall	10 X 16 VENUS ANTHRACITE (GE.VN.ATR.1016)	<input type="checkbox"/>	<input type="checkbox"/>	2 X 2 MOSAIC TENDER GREY
Second Ensuite	8 X 10 VENUS GREY (GE.VN.GRY.0810)	<input type="checkbox"/>	<input type="checkbox"/>	SHOWER FLOOR
		<input type="checkbox"/>	<input type="checkbox"/>	
		<input type="checkbox"/>	<input type="checkbox"/>	
Kitchen Backsplash		<input type="checkbox"/>	<input type="checkbox"/>	
Complete Backsplash	9141 ICE SNOW CAESARSTONE (LEVEL 1)	<input type="checkbox"/>	<input type="checkbox"/>	

Comment

BACKSPLASH TO CONTINUE BEHIND CHIMNEY HOOD FAN - TO LINE OF UPPER CABINETS*****
UPGRADE 3 WALL TILE TO MASTER SHOWER STALL - INSTALL HORIZONTAL

5. Fireplace

	Living Room			Family Room			Other Room - Specify		
	Purchased	As Per Plan	N/A	Purchased	As Per Plan	N/A	Purchased	As Per Plan	N/A
Fireplace Type	<input type="radio"/>	<input type="radio"/>	<input type="radio"/>	<input type="radio"/>	<input checked="" type="radio"/>	<input type="radio"/>	<input type="radio"/>	<input type="radio"/>	<input type="radio"/>
Mantle Type				BLF-50 STANDARD					
Over Mantle									
Colour / Stain									
Surround									
Hearth									

Comment

FURR OUT WALL TO ACCOMMODATE RECESSED FIREPLACE IN FAMILY ROOM **
LEAVE THE FIREPLACE AT STANDARD HEIGHT - DO NOT LOWER

Initial:

YMK JTP

Page 2 of 3

Purchasers: Julio Hernan Triana & Monica Kang

Property: 144 of Plan -

Telephone Res. / Bus: (416) 433-8386 /

Project: Teefy Developments Limited

Decor Advisor: Steffannee Appio

Model and Elevation: Bedford(22-2)

6. Trim Carpentry

Door Hardware

Interior Trim

Comment

Interior Doors

☐ 2 Panel Arch Top

☒ 2 Panel Square Top

☐ 6 Panel

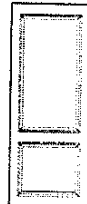

Initial for Door Style

mk JCP

7. Railings and Pickets

Railing Package

Railing Colour

Picket Colour

Wood Stairs ☐ No ☒ Oak

Tread Colour

Comment

STAIN OAK STAIRS TO COMPLIMENT HARDWOOD - GRAPHITE

8. Plaster Mouldings and Medallions

Foyer

Main Hall

Living Room

Dining Room

Family Room

Kitchen/Breakfast

Den/Library

Lower Landing

Comment

9. Wall Paint

STANDARD SENATOR WHITE

Smooth Ceilings

☐ First Floor

☐ First Floor incl. Second Floor Hall

☒ First and Second Floor

☐ Throughout

☐ Not Applicable

Trim Paint

10. Additional Comments

11. Disclaimers and Notes

- Colours of all materials are as close as possible to builder's selection, but not necessarily identical due to variances in manufacturing.
- Any extras listed above are null and void unless accompanied by a separate invoice/amendment. Said invoice must be paid in full.
- The Purchaser acknowledges that after Interior Colour Selection form is signed and dated, no further changes will be permitted other than re-selection due to unavailability. mk JCP Purchaser's Initials
- The Purchaser acknowledges reading and accepting the "Senator Homes Décor Centre Disclaimers" form. This document contains other miscellaneous disclaimers.

This Interior Colour Selection is final and approved by:

Purchaser:

Signature: [Signature]

Date: Dec 12/15

Signature: [Signature]

Date: Dec 12/15

Vendor:

[Signature]
Teefy Developments Limited

Dec 18/15

BEDFORD SIDE

2448 SQ.FT. / 2278 SQ.FT. WITH OPTIONAL TANDEM GARAGE

9130-hot-144
 SENATOR HOMES
 DECOR CENTRE
 DATE: DEC 12/15
 INITIALS: ITP MK

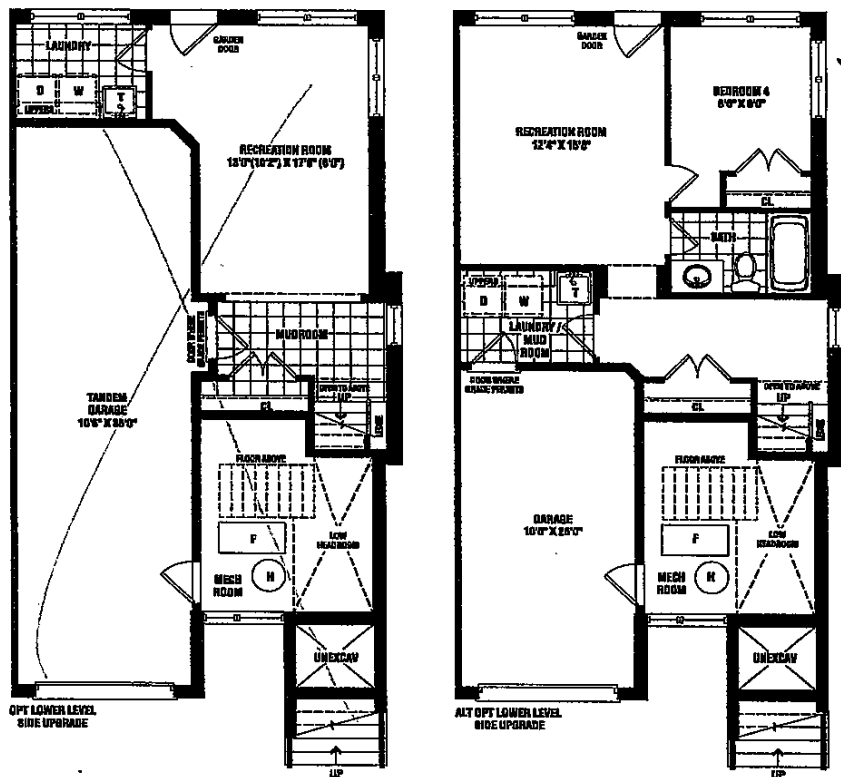
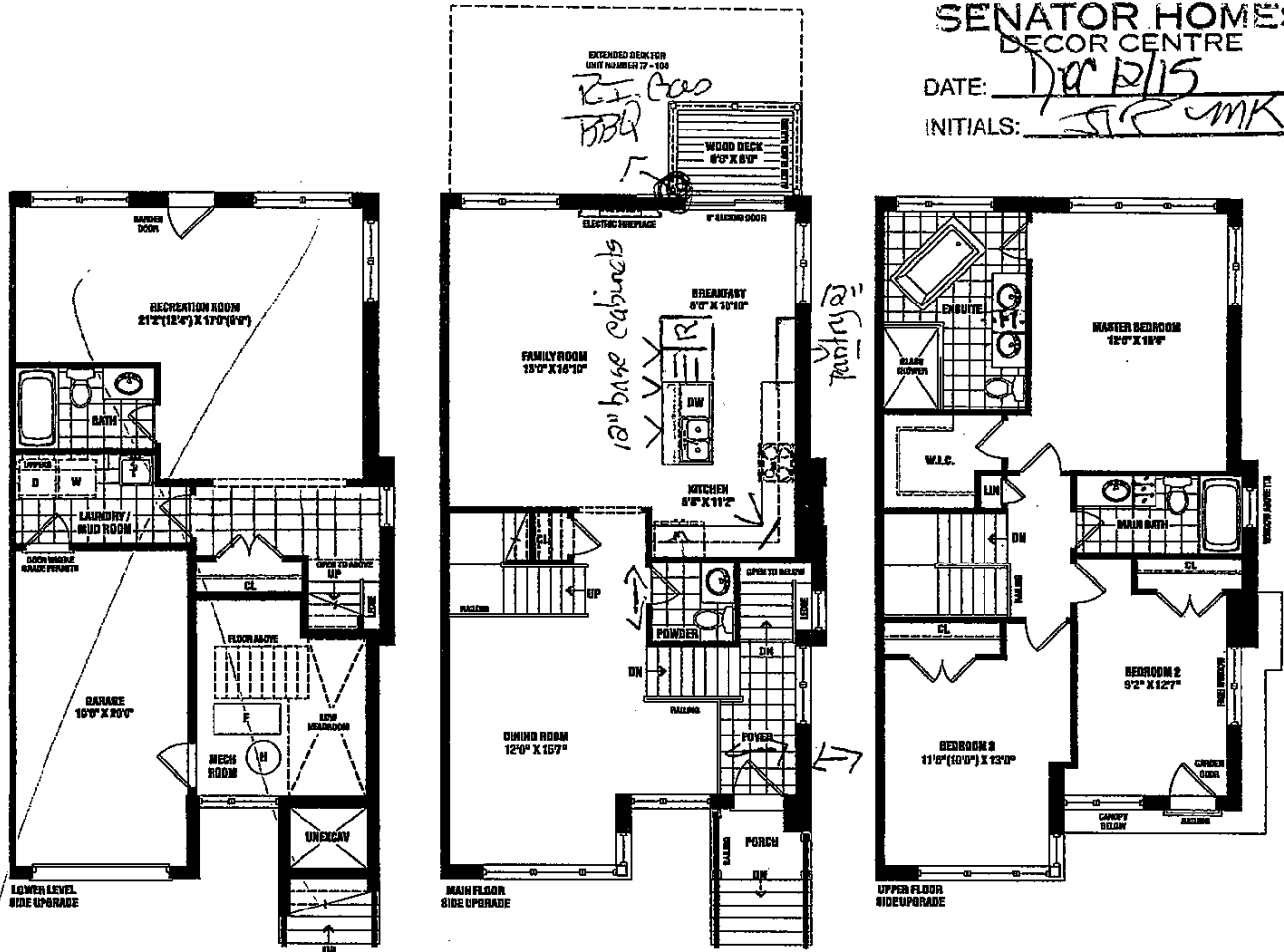

SENATOR
 HOMES

Renderings are artist's concept. Some elevations may vary from that shown. Actual useable square footage may vary from that stated herein. Some floorplans and elevations are mirror image to that shown. E.&O.E. 22-2

ITP MK
 17

SENATOR HOMES - TEEFY

- 1) Crown molding
- 2) high valances
- 3)

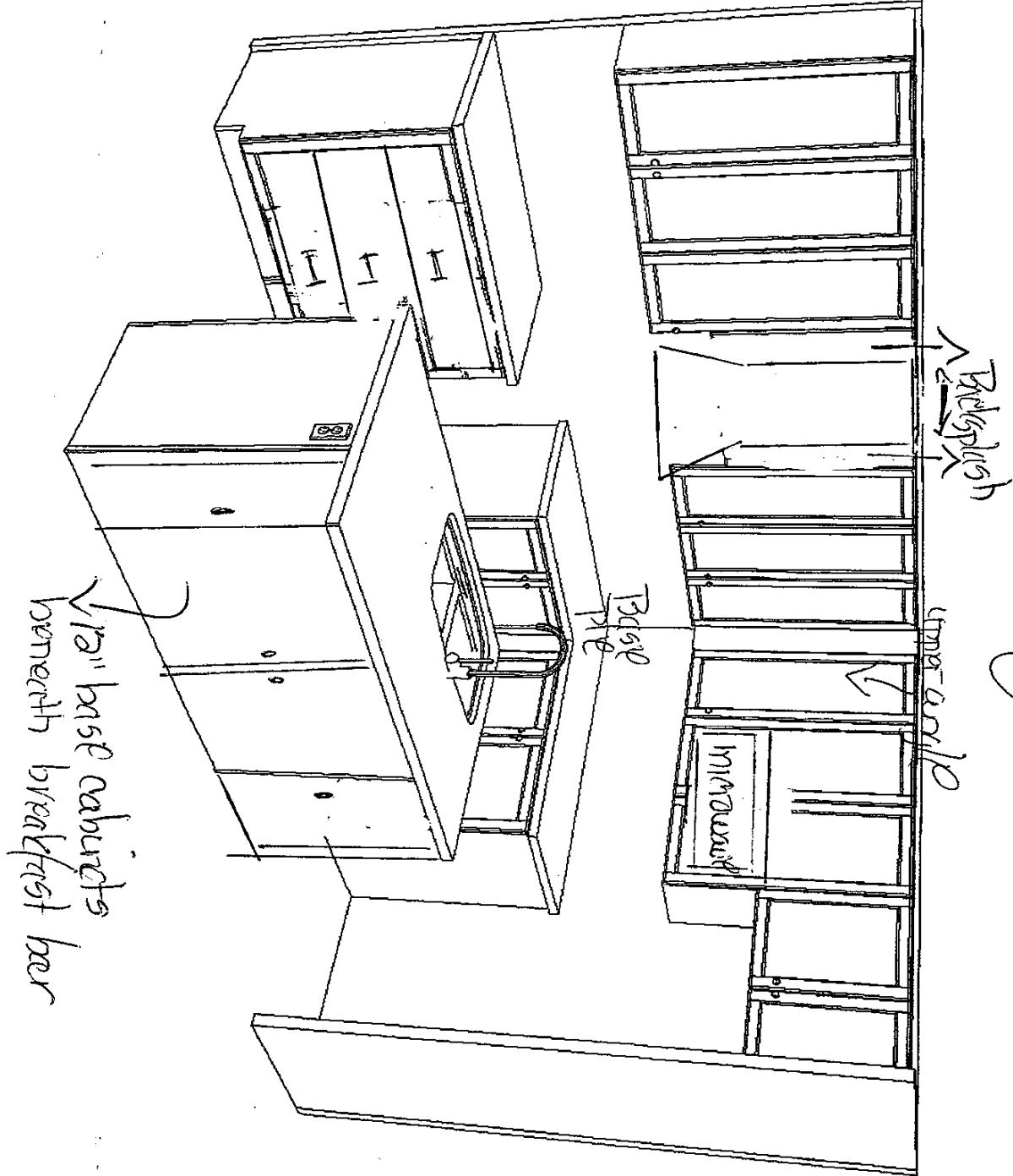

BEDFORD - TH-22-2

STD. LAYOUT

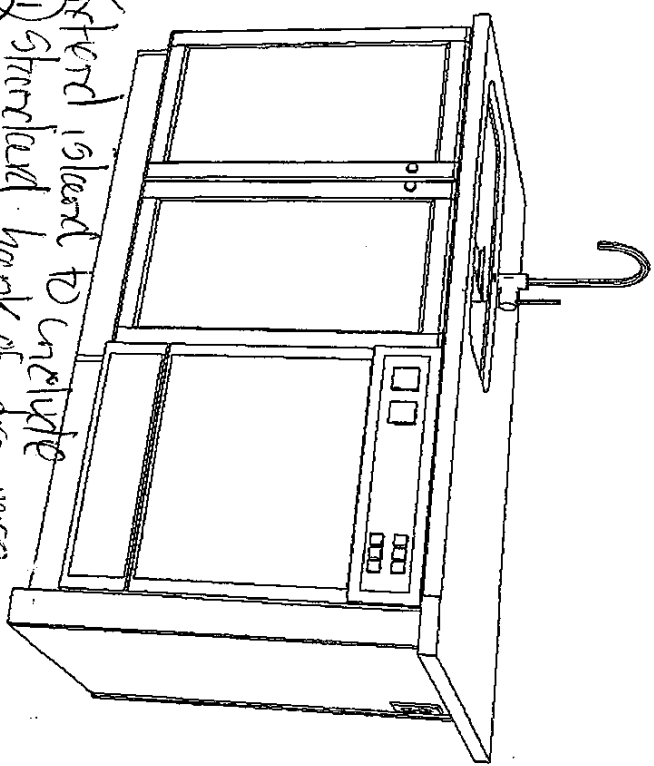

- Extend island to include
- 1) Standard bank of drawers
- 2) Recycle bin drawer

SENATOR HOMES
DECOR CENTRE
DATE:
INITIALS: MM STP

36" (91.4 cm) models

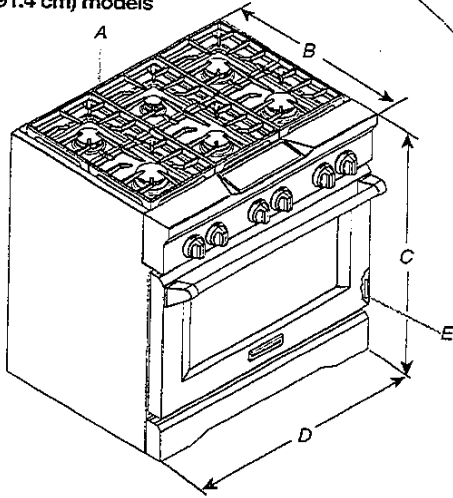

- A. Optional backguard may be installed.
- B. 27 $\frac{1}{4}$ " (70.5 cm) depth with control panel, see NOTE*.
- C. 35 $\frac{1}{4}$ " (90.8 cm) cooktop height when setting on the wheels
- D. 36" (91.4 cm) width
- E. Model/serial rating plate location

48" (121.9 cm) models

NOTE: The following illustration is for dimension planning purposes only, and the locations and appearances of the features shown may not match those of your model.

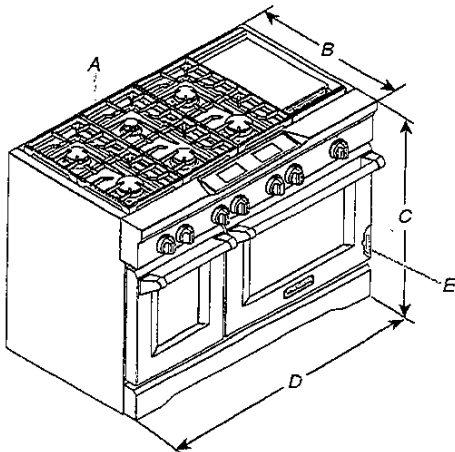

- A. Optional backguard may be installed.
- B. 27 $\frac{1}{4}$ " (70.5 cm) depth with control panel, see NOTE*.
- C. 35 $\frac{1}{4}$ " (90.8 cm) cooktop height when setting on the wheels
- D. 48" (121.9 cm) width
- E. Model/serial rating plate location

***NOTE:** When installed in a 24" (61.0 cm) base cabinet with 25" (63.5 cm) countertop, front of oven door protrudes 1 $\frac{7}{8}$ " (4.8 cm) beyond 24" (61.0 cm) base cabinet.

CABINET DIMENSIONS

DATE: 12/15

Cabinet opening dimensions shown are for 25" (64 cm) countertop depth, 24" (61 cm) base cabinet depth and 36" (91.4 cm) countertop height. Dimensions must be met in order to ensure a flush fit to back wall.

IMPORTANT: If installing a range hood or a hood liner above the range, follow the range hood or hood liner installation instructions for dimensional clearances above the cooktop surface.

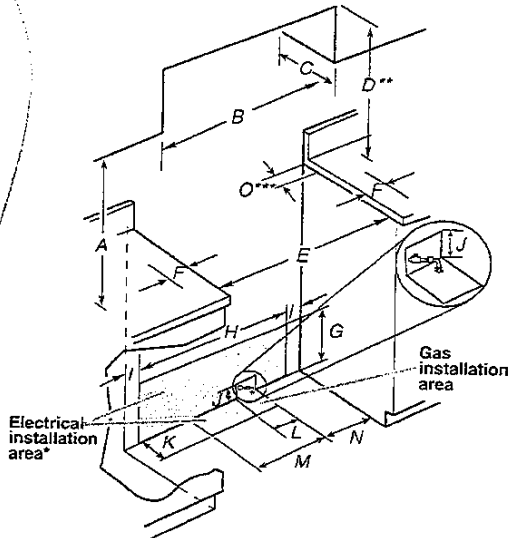

- A. 18" (45.7 cm) upper cabinet to countertop
- B. 30" (76.2 cm) model: 30" (76.2 cm) min. upper cabinet width
36" (91.4 cm) model: 36" (91.4 cm) min. upper cabinet width
48" (121.9 cm) model: 48" (121.9 cm) min. upper cabinet width
- C. 13" (33 cm) max. upper cabinet depth
- D. For minimum clearance to top of range, see NOTE**.
- E. 30 $\frac{1}{4}$ " (76.8 cm) on 30" (76.2 cm) models
36 $\frac{1}{4}$ " (92.1 cm) on 36" (91.4 cm) models
48 $\frac{1}{4}$ " (122.6 cm) on 48" (121.9 cm) models
- F. 6" (15.2 cm) min. clearance from both sides of range to side wall or other combustible material
- G. 15" (38.1 cm)
- H. 22" (55.9 cm) on 30" (76.2 cm) models
28" (71.1 cm) on 36" (91.4 cm) models
40" (101.6 cm) on 48" (121.9 cm) models
- I. 1 $\frac{1}{2}$ " (3.8 cm)
- J. 3" (7.6 cm)
- K. 5" (12.7 cm)
- L. 6" (15.2 cm) on 30" (76.2 cm) models
14" (35.5 cm) on 36" (91.4 cm) models
24" (61.0 cm) on 48" (121.9 cm) models
- M. 10 $\frac{1}{2}$ " (26.7 cm)
- N. 6" (15.2 cm)
- O. 6" (15.2 cm), see NOTE***

***NOTE:** Receptacle must be rotated 90° for Canadian installation.

**NOTE: Minimum Clearances

30" (76.2 cm) models: 30" (76.2 cm) minimum clearance between the top of the cooking platform and the bottom of an uncovered wood or metal cabinet.

36" (91.4 cm) models: 42" (106.7 cm) minimum clearance between the top of the cooking platform and the bottom of an uncovered wood or metal cabinet.

48" (121.9 cm) models: 42" (106.7 cm) minimum clearance between the top of the cooking platform and the bottom of an uncovered wood or metal cabinet.

*****NOTE:** If backwall is constructed of a combustible material and a backguard is not installed, a 6" (15.2 cm) minimum clearance is required for all models.

36"

9/30-2014 #144

SEINATOR HOMES
DECOR CENTRE**KitchenAid® 30", 36" and 48" (76.2, 91.4 and 121.9 cm) Commercial-Style Dual Fuel Convection Ranges****PRODUCT MODEL NUMBERS**

KDRS407V	KDRS467V	KDRU763V
KDRS462V	KDRS483V	KDRU767V
KDRS463V	KDRU707V	KDRU783V

Gas Supply Requirements:**Type of Gas****Natural gas:**

This range is design-certified by CSA International for use with Natural gas or, after proper conversion, for use with LP gas.

- This range is factory set for use with Natural gas. See "Gas Conversions" section. The model/serial rating plate located on the oven frame behind the left side of the broiler door has information on the types of gas that can be used. If the types of gas listed do not include the type of gas available, check with the local gas supplier.

LP gas conversion:

Conversion must be done by a qualified service technician.

No attempt shall be made to convert the appliance from the gas specified on the model/serial rating plate for use with a different gas without consulting the serving gas supplier. See "Gas Conversions" section.

Gas Supply Line

- Provide a gas supply line of 3/4" (1.9 cm) rigid pipe to the range location. A smaller size pipe on longer runs may result in insufficient gas supply. With LP gas, piping or tubing size can be 1/2" (1.3 cm) minimum. Usually, LP gas suppliers determine the size and materials used in the system.

NOTE: Pipe-joint compounds that resist the action of LP gas must be used. Do not use TEFLON® tape.

Flexible metal appliance connector:

- If local codes permit, a new CSA design-certified, 4 to 5 ft (122 to 152.4 cm) long, 3/8" (1.6 cm) or 1/2" (1.9 cm) I.D., flexible metal appliance connector may be used for connecting range to the gas supply line.



- A 1/2" (1.3 cm) male pipe thread is needed for connection to the female pipe threads of the inlet to the appliance pressure regulator.
- Do not kink or damage the flexible metal tubing when moving the range.

Rigid pipe connection:

The rigid pipe connection requires a combination of pipe fittings to obtain an in-line connection to the range. The rigid pipe must be level with the range connection. All strains must be removed from the supply and fuel lines so range will be level and in line.

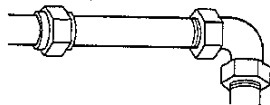

- Must include a shutoff valve:

The supply line must be equipped with a manual shutoff valve. This valve should be located in the same room but external to the range opening, such as an adjacent cabinet. It should be in a location that allows ease of opening and closing. Do not block access to shutoff valve. The valve is for turning on or shutting off gas to the range.

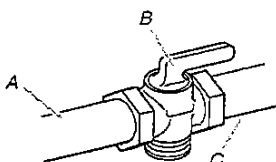

A. Gas supply line
B. Shutoff valve "open" position
C. To range

†®TEFLON is a registered trademark of E.I. Du Pont Nemours and Company.

Electrical Connection

- Range must be connected to the proper electrical voltage and frequency as specified on the model/serial number rating plate. The model/serial number rating plate is located on the right vertical surface of the oven door frame. Refer to the illustrations in the "Product Dimensions" section of the "Location Requirements" section.
- This range may be manufactured with a 4-wire power supply cord, or it may not include a power supply cord. If your range does not include a power supply cord, use a 4-wire power supply cord rated at 250 volts, 40 or 50 amps and investigated for use with ranges.

Range Rating***Specified Rating of Power Supply Cord Kit and Circuit Protection**

120/240 Volts	120/208 Volts	Amps	Range Size
8.8 - 16.5 KW	7.8 - 12.5 KW	40 or 50**	30" (76.2 cm)
			36" (91.4 cm)
16.6 - 22.5 KW	12.6 - 18.5 KW	50	48" (121.9 cm)

*The NEC calculated load is less than the total connected load listed on the model/serial rating plate.

**If connecting to a 50-amp circuit, use a 50-amp rated cord with kit. For 50-amp rated cord kits, use kits that specify use with a nominal 1 3/8" (34.9 mm) diameter connection opening.

- A circuit breaker is recommended.

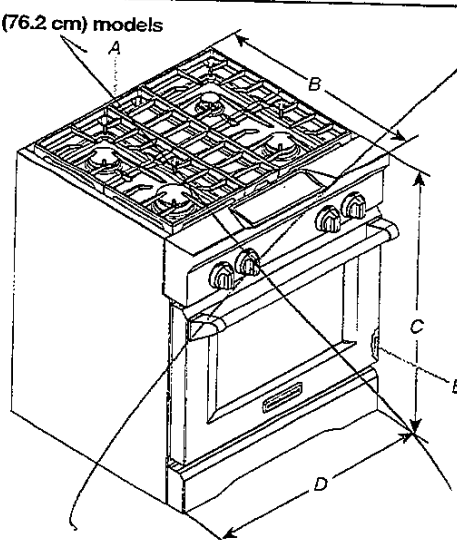
PRODUCT DIMENSIONS**30" (76.2 cm) models**

- A. Optional backguard may be installed.
B. 27 3/4" (70.5 cm) depth with control panel, see NOTE.
C. 35 3/4" (90.8 cm) cooktop height when setting on the wheels
D. 30" (76.2 cm) width
E. Model/serial rating plate location

2. Installation Diagram
2. Schéma d'installation
2. Diagrama de instalación

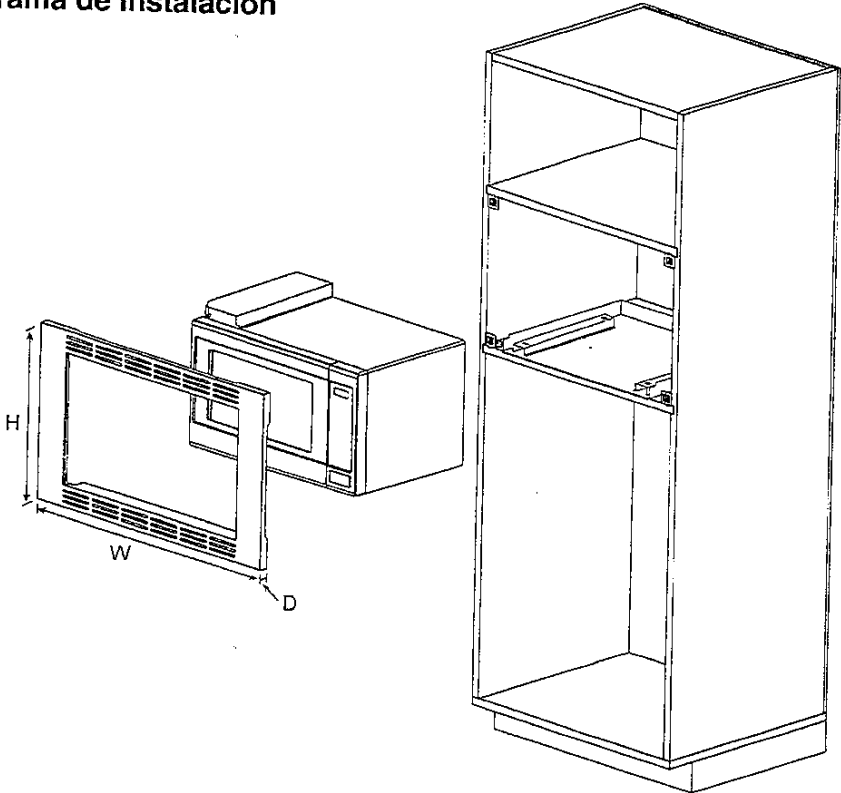

Trim Kit Dimensions			
	TK932S	TK922S	TK732S
Width	30" (760 mm)	27" (684 mm)	30" (760 mm)
Height	18 3/8" (472 mm)	18 3/8" (472 mm)	16 1/2" (419 mm)
Depth (Thickness)	3/4" (20 mm)	3/4" (20 mm)	3/4" (20 mm)

Dimensions du nécessaire d'encastrement				
	TK932S	TK922S	TK732S	TK722S
Largeur	760 mm (30 po)	684 mm (27 po)	760 mm (30 po)	684 mm (27 po)
Hauteur	472 mm (18 3/8 po)	472 mm (18 3/8 po)	419 mm (16 1/2 po)	419 mm (16 1/2 po)
Profondeur (épaisseur)	20 mm (3/4 po)	20 mm (3/4 po)	20 mm (3/4 po)	20 mm (3/4 po)

Dimensiones del juego de acabados				
	TK932S	TK922S	TK732S	TK722S
Ancho	30" (760 mm)	27" (684 mm)	30" (760 mm)	27" (684 mm)
Altura	18 3/8" (472 mm)	18 3/8" (472 mm)	16 1/2" (419 mm)	16 1/2" (419 mm)
Profundidad (grosor)	3/4" (20 mm)	3/4" (20 mm)	3/4" (20 mm)	3/4" (20 mm)

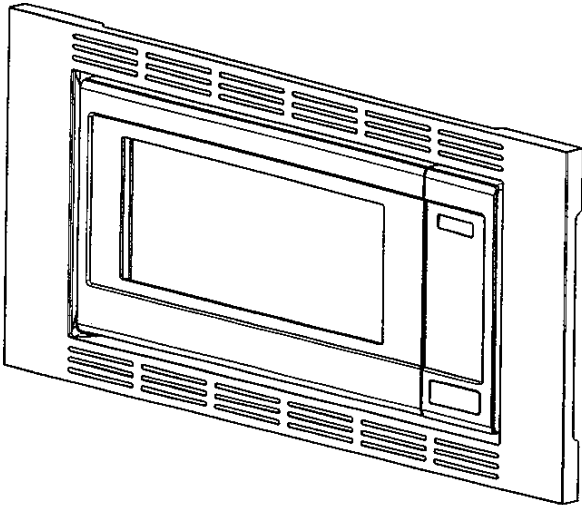

30" trim kit
=

Installation Instructions

Notice d'installation

Instrucciones para la instalación

Cabinet Armoire Gabinete	Trim kit Nécessaire d'encastrement Juego de acabados
30" (762 mm) 30 po (762 mm) 30" (762 mm)	NN-TK932S NN-TK732S
27" (686 mm) 27 po (686 mm) 27" (686 mm)	NN-TK922S NN-TK722S

Read carefully and keep these installation instructions.
Lisez attentivement et conservez cette notice d'installation.
Lea cuidadosamente y guarde este instructivo de
instalación para su referencia.

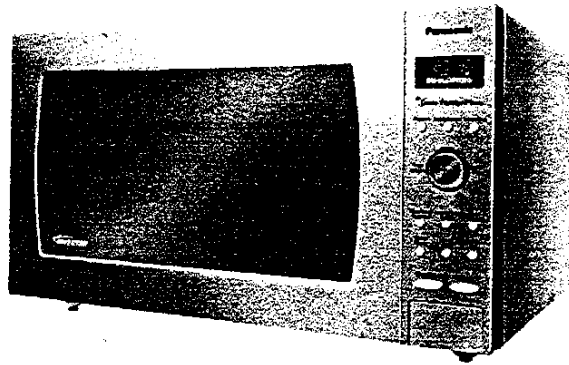

9130-Lo144
SENATOR HOMES
DEVELOPMENT CENTRE
DATE: 12/15
INITIALS: MK JTP

\$419.99

ADD TO CART

Previous

Next

PRODUCT INFORMATION

- Blue LED light
- Electrostatic touch dial
- 2.2 cu. ft.
- 1200 Watts
- Menu Action Screen
- Genius® Sensor Reheat
- Genius® Sensor Cook
- Inverter® Turbo Defrost
- Popcorn Key
- Keep Warm (up to 30 minutes)
- Function Key
- Child Safety Lock
- Optional Trim Kit Available
- Exterior Dimensions (H x W x D): 356 x 606 x 497 mm
- Compatible with trimkit(s): NNTK922S, NNTK929SSA, NNTK932S, NNTK939SSA



MICROWAVE TRIMKIT FINDER

9130- hot 144

SENATOR HOMES
DECOR CENTRE

DATE 12/08/15
INITIALS MR JTP

9130 BATHURST

LOT #144

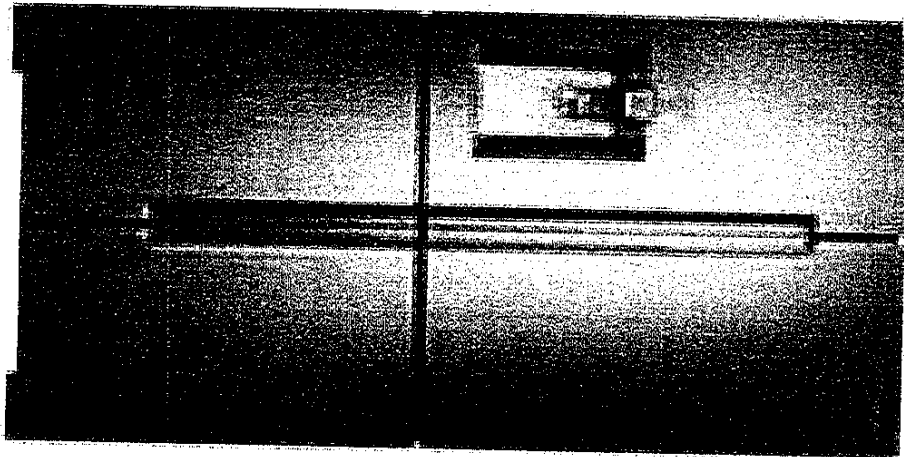

35 3/4" (D)

35 3/4" (D)

72 7/8" (H)



\$210

CATENA 20" RECTANGULAR UNDERMOUNT SINK

contrac

4210CLY Undermount Sink

Product Specs:

- Vitreous china
- Front overflow hole
- Template and mounting hardware supplied

Overall Dimensions (W x D x H):

(OD): 510mm(20") x 395mm(15½") x 190mm(7½")
(ID): 450mm(17¾") x 335mm(13½") x 140mm(5½")

Compliance Certifications:

Meets or exceeds the following :

- IAPMC cUPC
- ASME A112.19.2 / CSA B45.1-2008

Shipping:

Cube 1.72
GW 27 lbs

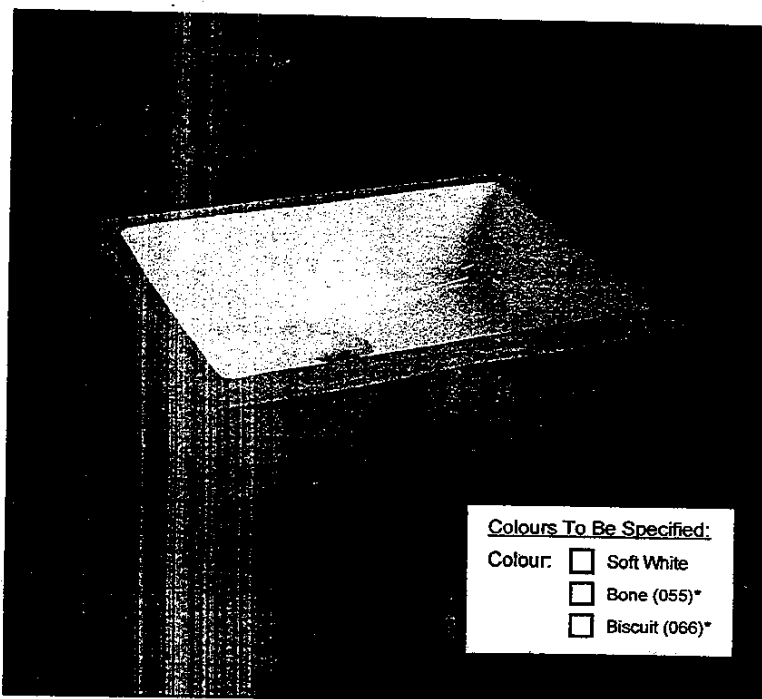

Colours To Be Specified:

- Colour: ☐ Soft White
☐ Bone (055)*
☐ Biscuit (066)*

Notes:

Dimensions of fixtures are nominal and may vary within the range of tolerances established by ASME standard A112.19.2. These measurements are subject to change or cancellation. No responsibility is assumed for use of superseded or voided pages.

*Bone and Biscuit available through Direct import (CIF) only.

Detail of Mounting Clip

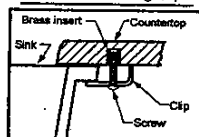

Note:
▲ Dimensions shown for location of supplies and "P" trap are suggested.

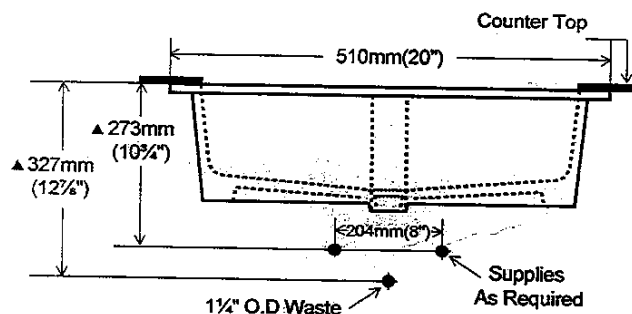
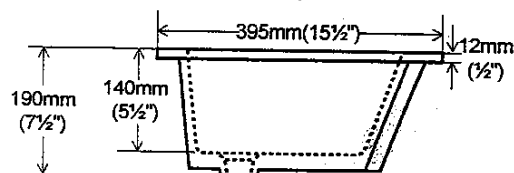
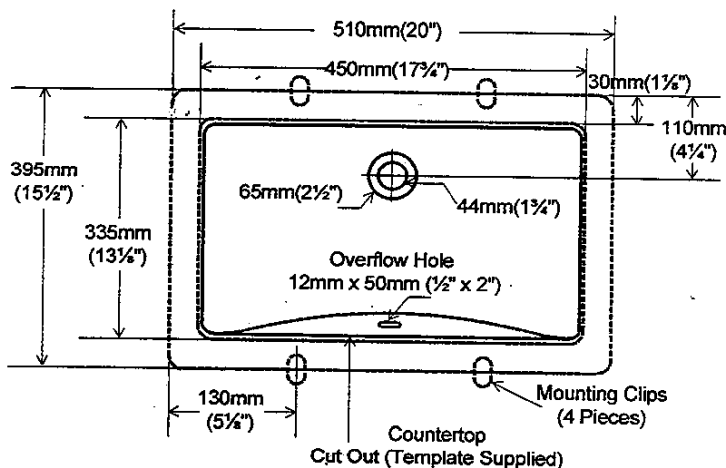

CONTRAC® 5970 Chedworth Way, Unit A, Mississauga, Ontario Canada L5R 3V5 • 1.888.256.7551
www.contrac.ca

Revised: January 2014

9130-LOT 144
SENATOR HOMES
DECOR CENTRE
DATE: DEC 12/13
INITIALS: [Signature]

Tealby 144

Dama Wall Hood

A value alternative in wall mounted range hoods

FABER
ON AIR. SINCE 1955

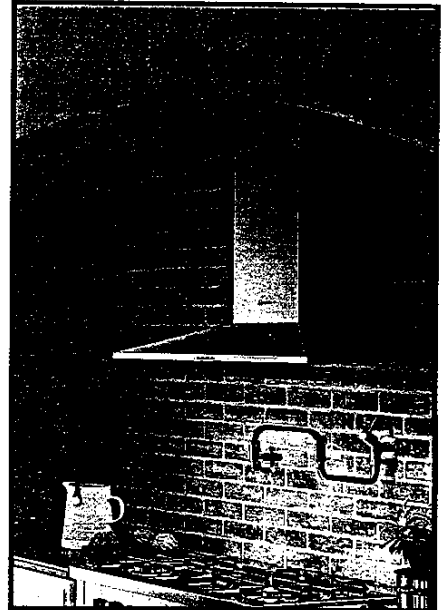
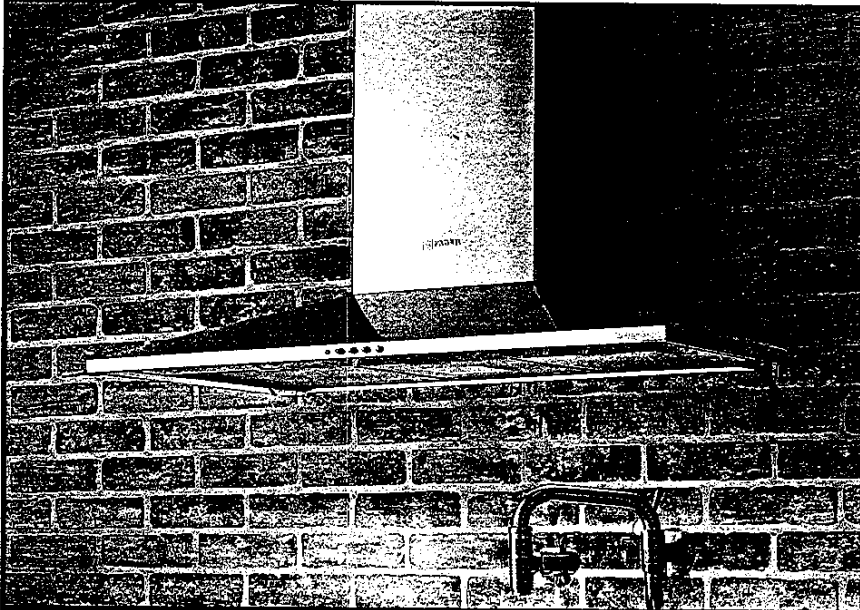

Designed to offer a high-end decorative look while taking into consideration great value. Traditional styling, great features, and solid performance make the Dama wall hood a great choice in canopy range hoods.

Model #	Size Color	Performance Range	Sound Levels
DAMA30SS	30 Stainless	160 - 600 CFM	3.5 - 6.5 sones
DAMA36SS	36 Stainless	160 - 600 CFM	3.5 - 6.5 sones
DAMA30SS300	30 Stainless	80 - 300 CFM	2.0 - 4.0 sones
DAMA36SS300	36 Stainless	80 - 300 CFM	2.0 - 4.0 sones



Feature Chart

Min. / Max. Ceiling Height	7' 7 1/8" - 9' 1/8"
Canopy Depth / Height	19 9/32" D / 4 3/4" H
High Ceiling Kit	Yes - up to 11'
Convertible to Ductless / Recirculating	Yes - ductless kit needed
Controls	3 Speed Push
Lighting	2 X 20 (W) Halogen
Ducting Top	6" Round
Grease Filters	dishwasher safe mesh
Easy Cube Mounting	Yes
Pro Motor with Metal Impellers	Yes
AC Input	120 V - 60 hz
AC Power 600 / 300 cfm	Max 490 W at 4.1 A / 320 W at 2.7 A
Annual Electricity Costs (600 / 300 cfm)	\$5.29 / \$3.62 / Year *

* Note -- ran 30 minutes a day on low speed with the lights on, 365 days, using the North American average of 12.2 cents per kWh.
p.o. box 435 • Wayland, MA 01778 • tel: (508) 358-5353 • fax: (508) 358-5730 • e-mail: info@faberonline.com • www.faberonline.com

Tee by 144

Dimensional Diagrams
(see installation instructions for more information)

Ducted

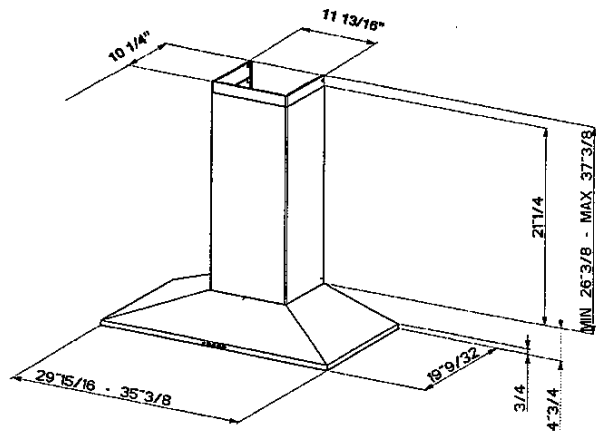

Ductless

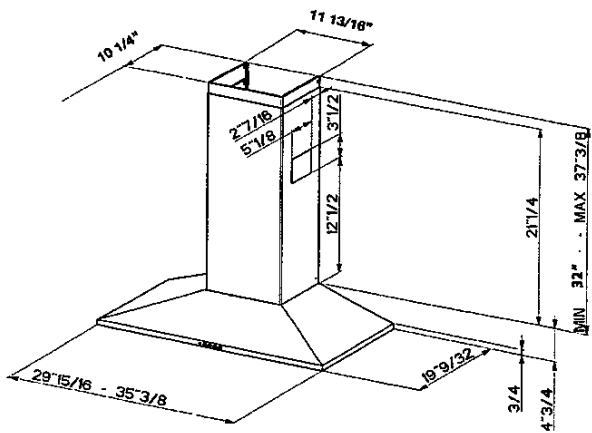

min & max ceiling height examples			
x = range hood height above cook top			
ductless		ducted	
x = 24"	x = 30"	x = 24"	x = 30"
min	min	min	min
8' 3/4"	8' 6 3/4"	7' 7 1/8"	8' 1 1/8"
max	max	max	max
8' 6 1/8"	9' 1/8"	8' 6 1/8"	9' 1/8"

For shorter ceilings, have the chimney cover(s) cut at a sheet metal shop. For higher ceiling installations, the High Ceiling Chimney Kit includes a new 39" upper chimney which would replace the 16 1/8" upper chimney that came with the hood.

ACCESSORIES

High Ceiling Chimney Kit # HIGH1 One 39" upper chimney to replace 16 1/8" upper chimney that came with hood		Replacement Charcoal Filter # FILTER2 For ductless installations, high quality, heavy duty filters ensure the removal of smoke and odors from the kitchen.	
Ductless Conversion Kit # DUCT1 Includes: • Lower Chimney with holes for ducting • Ductless Diverter Assembly • Vent Grates • Charcoal Filter			



WARNING! Product specifications are subject to change without notification. Consult the installation instructions before you begin installing this rangehood.