



CONSTRUCTION SUMMARY

Teefy Developments Limited / 9130 Bathurst

Lot/Unit: 91 Phase/Building: 1 Model/Floor Plan: Bedford(22-2)

CABINETRY ACCESSORIES

Inv.3154	1 - KITCHEN - LIGHT VALANCE	
Line 43559	Note:	
19Aug15 / 25Nov15		
Inv.3154	1 - KITCHEN - SUPPLY AND INSTALL FACIA PNAEL MOUNDLING WITH TALL(LARGE) CROWN MOUNDLING - NO GAP ABOVE UPPER CABINETS	
Line 43566	Note:	
19Aug15 / 25Nov15		

CABINETRY APPLIANCE - FRIDGE

Inv.3154	1 - KITCHEN - 59CM FRIDGE CABINET - ADJACENT TO PANTRY - AS INDICATED ON SKETCH	
Line 38957	Note:	
19Aug15 / 25Nov15		

CABINETRY BASE CABINETS

Inv.3154	4 - BASE CABINET EXTENTION AS INDICATED ON KITCHEN LAYOUT	
Line 38947	Note:	
19Aug15 / 25Nov15		
Inv.3154	1 - BASE PIE CUT CORNER	
Line 38964	Note:	
19Aug15 / 25Nov15		

CABINETRY HOOD FANS

Inv.3154	1 - KITCHEN - ACCOMMODATE FOR FUTURE CHIMINEY STYLE HOOD FAN	
Line 38968	Note:	
19Aug15 / 25Nov15		

CABINETRY MICROWAVE OVEN STOVE COOKTOP

Inv.3154	1 - BUILT IN DOUBLE APPLIANCE CABINET WITH DRAWER BELOW - TRIM KIT REQUIRED - PURCHASER MUST SUPPLY SPECS	
Line 38959	Note:	
19Aug15 / 25Nov15		
Inv.3154	1 - COOKTOP CABINET (FULL HEIGHT) WITH FALSE TOP DRAWER AND POT & PANS DRAWERS BELOW - PURCHASER MUST SUPPLY SPECS - UPGRADE 1	
Line 38967	Note:	
19Aug15 / 25Nov15		

CABINETRY PANTRY

Inv.3154	8 - KITCHEN - INTERIOR PULL OUT DRAWER (STANDARD METABOX DRAWERS NOT SOFT CLOSING)	
Line 43552	Note:	
19Aug15 / 25Nov15		
Inv.3154	3 - KITCHEN - PANTRY 59 CM DEEP - PRICED PER FOOT	
Line 43577	Note:	
19Aug15 / 25Nov15		

CABINETRY WALL AND HUTCH



CONSTRUCTION SUMMARY

Teefy Developments Limited / 9130 Bathurst

Lot/Unit: 91 Phase/Building: 1 Model/Floor Plan: Bedford(22-2)

Inv.3154	1 - UPPER ANGLE CORNER	
Line 38963	Note:	
19Aug15 / 25Nov15		
Inv.3154	1 - GLASS DOOR CLEAR - WITH MATCHING INTERIOR - IN UPPER ANGLE CORNER CABINET	
Line 43565	Note:	
19Aug15 / 25Nov15		

COUNTER TOP

Inv.3154	1 - COOKTOP PROVISION	
Line 38949	Note:	
19Aug15 / 25Nov15		
Inv.3154	1 - COUNTERTOP EXTENTION FOR ISLAND WITH THE 12" OVER HANG	
Line 38951	Note:	
19Aug15 / 25Nov15		
Inv.3154	1 - COUNTER TOP - ENSUITE BATHROOM - 2CM WITH STANDARD EDGE FE20 - GROUP 2	
Line 38970	Note:	
19Aug15 / 25Nov15		

COUNTER TOP - VANITY

Inv.3154	5 - BATHROOM VANITY - SINK CUT OUT - DOES NOT INCLUDE SINK	
Line 43580	Note:	
19Aug15 / 25Nov15		

ELECTRICAL

Inv.3154	1 - ELECTRICAL - CONNECTION FOR DOUBLE OVEN	
Line 38960	Note:	
19Aug15 / 25Nov15		
Inv.3154	1 - SUPPLY AND INSTALL LIGHT VALANCE ROUGH IN (INCLUDES 1 SWITCH)	
Line 43562	Note: LOCATION AS PER SKETCH ATTACHED.	
19Aug15 / 25Nov15		
Inv.3154	1 - KITCHEN - SUPPLY AND INSTALL ADDITIONAL INTERIOR RECEPTACLE - FOR CHIMNEY STYLE HOODFAN	
Line 43564	Note:	
19Aug15 / 25Nov15		
Inv.3154	10 - ELECTRICAL - MINI LOW VOLTAGE HALOGEN POT LIGHT - 1ST FLOOR - LOCATION SKETCH ATTACHED -X3 IN REC ROOM ON 1 SWITCH -X3 IN DINING ROOM ON 1 SWITCH -X2 IN KITCHEN ON 1 SWITCH -X2 IN FAMILY ROOM ON 1 SWITCH	
Line 43571	Note:	
19Aug15 / 25Nov15		
Inv.3154	2 - ELECTRICAL - MINI LOW VOLTAGE HALOGEN POT LIGHT - 2ND FLOOR - LOCATION SKETCH ATTACHED -X2 IN MASTER ENSUITE AS INDICATED ON SKETCH	
Line 43572	Note:	
19Aug15 / 25Nov15		



CONSTRUCTION SUMMARY

Teefy Developments Limited / 9130 Bathurst

Lot/Unit: 91 Phase/Building: 1 Model/Floor Plan: Bedford(22-2)

Inv.3154	6 - SUPPLY AND INSTALL ADDITIONAL INTERIOR SINGLE POLE SWITCH -x1 REC ROOM FOR POTS -X1FAMILY ROOM FOR POTS -X1 KITCHEN FOR POTS -X1 IN DINING FOR POTS -X2 IN MASTER ENSUITE FOR CAP & POTS	
Line 43573	Note:	
19Aug15 / 25Nov15		
Inv.3154	1 - KITCHEN - RELOCATE STANDARD OVEN ELECTRICAL IN BUILT-IN LOCATION	
Line 43575	Note:	
19Aug15 / 25Nov15		
Inv.3154	2 - SUPPLY AND INSTALL CAPPED CEILING LIGHT ROUGH-IN ONLY ON SEPARATE SINGLE SWITCH -CENTERED ABOVE MASTER ENSUITE BATHTUB AS MUCH AS POSSIBLE -ABOVE THE ISLAND AS INIDCATED ON SKETCH	
Line 43582	Note:	
19Aug15 / 25Nov15		
Inv.3154	1 - SUPPLY AND INSTALL CAPPED CEILING LIGHT ROUGH-IN ONLY ON EXISTING SWITCH -ABOEE ISLAND ON EXISTING SWITCH ADDITONAL SWITCH WITH CAPPED ROUGH IN	
Line 43590	Note:	
19Aug15 / 25Nov15		
Inv.3154	2 - SUPPLY AND INSTALL ADDITIONAL CABLE OUTLET ROUGH-IN ONLY	
Line 43592	Note:	
19Aug15 / 25Nov15		

HARDWOOD

Inv.3154	1 - HARDWOOD - UPGRADE 1 - SATIN FINISH GEN. - HOME OAK 3 5/8 INCH X 3/4 INCH - STAINS - INSTALLED IN OP - - MASTER BEDROOM	
Line 38937	Note: PURCHASER IS ENTITLED TO RECIEVE HARDWOOD FLOORING THROUGHOUT MAIN AND UPPER FLOORS WITH CHOICE OF COLOUR FROM VENDORS STANDARD SAMPLES	
19Aug15 / 25Nov15		
Inv.3154	1 - HARDWOOD - UPGRADE 1 - SATIN FINISH GEN. - HOME OAK 3 5/8 INCH X 3/4 INCH - STAINS - INSTALLED IN OP - - BEDROOM 2	
Line 38938	Note: PURCHASER IS ENTITLED TO RECIEVE HARDWOOD FLOORING THROUGHOUT MAIN AND UPPER FLOORS WITH CHOICE OF COLOUR FROM VENDORS STANDARD SAMPLES	
19Aug15 / 25Nov15		
Inv.3154	1 - HARDWOOD - UPGRADE 1 - SATIN FINISH GEN. - HOME OAK 3 5/8 INCH X 3/4 INCH - STAINS - INSTALLED IN OP - - BEDROOM 3	
Line 38939	Note: PURCHASER IS ENTITLED TO RECIEVE HARDWOOD FLOORING THROUGHOUT MAIN AND UPPER FLOORS WITH CHOICE OF COLOUR FROM VENDORS STANDARD SAMPLES	
19Aug15 / 25Nov15		

HEATING AND AIR CONDITIONING

Inv.3154	1 - GAS LINE - ROUGH-IN ONLY - FOR STOVE TO INCLUDE 110V CODE REQUIREMENT *** FOR GAS COOK-TOP	
Line 38936	Note: VENDOR HAS AGREED TO SUPPLY AND INSTALL A GAS LINE IN KITCHEN AND STOVE LOCATION	
19Aug15 / 25Nov15		

MISCELLANEOUS

Inv.3154	1 - GROUND FLOOR LAUNDRY ROOM & BATHROOM RELOCATION**** TO BE INSTALLED AS CLOSE AS POSSIBLE TO THE RIVERDALE LAYOUT (PRICE TO INCLUDE EXTRA TILES AND TRIM)	
----------	--------------------------------------------------------------------------------------------------------------------------------------------------------------	--



CONSTRUCTION SUMMARY

Teefy Developments Limited / 9130 Bathurst

Lot/Unit: 91 Phase/Building: 1 Model/Floor Plan: Bedford(22-2)

Inv.3154	1 - GROUND FLOOR LAUNDRY ROOM & BATHROOM RELOCATION**** TO BE INSTALLED AS CLOSE AS POSSIBLE TO THE RIVERDALE LAYOUT (PRICE TO INCLUDE EXTRA TILES AND TRIM)	
Line 38945	Note: AS PER THE ATTACHED SKETCH	
19Aug15 / 25Nov15		

PLUMBING

Inv.3154	1 - SUPPLY AND INSTALL WATERLINE ROUGH-IN TO THE FRIDGE LOCATION (NO HOOK UP)	
Line 38941	Note: LOCATION AS PER SKETCH ATTACHED.	
19Aug15 / 25Nov15		

Inv.3154	5 - BATHROOM VANITY - SUPPLY AND INSTALL CONTRAC CONNOR 17" OVAL UNDERMOUNT SINK - MODEL 4210CFY - SINGLE HOLE FAUCET STANDARD	
Line 43581	Note:	
19Aug15 / 25Nov15		

Tile

Inv.3154	1 - FLOOR TILE - UPGRADE 2 - - POWDER ROOM FLOOR	
Line 38955	Note:	
19Aug15 / 25Nov15		

Inv.3154	1 - FLOOR TILE - UPGRADE 4 - - ENSUITE BATH SHOWER FLOOR	
Line 38971	Note:	
19Aug15 / 25Nov15		

Inv.3154	1 - WALL TILE - UPGRADE 3 - - ENSUITE BATH SHOWER WITH CEILING	
Line 38977	Note:	
19Aug15 / 25Nov15		

EXTRAS AS PER OFFER

Stainless Steel Fridge, Stove and Dishwasher and front loading washer and dryer in white from Vendors standard samples, no cash value, not transferable. (Supplied only not installed) ** to - arrange delivery call: The Brick commercial sales division at Worksheet Note:	
Rogers Free Services Package includes 6 months of: home phone, TV and Internet Service. Worksheet Note:	
Vendor has agreed to supply and install a gas line in kitchen at stove location. Worksheet Note:	
Purchaser is entitled to receive granite countertops in kitchen, bathrooms and powder room from Vendors standard samples. Worksheet Note:	
Purchaser is entitled to receive hardwood flooring throughout main and upper floors with choice of colour from Vendors standard samples. Worksheet Note:	

Purchaser: Yuehua Jiang
Telephone Res. / Bus: /
Decor Advisor: Nicole Soares

Property: 91 of Plan -
Project: Teefy Developments Limited
Model and Elevation: Bedford(22-2)

Layout Changes: ☒ Yes ☐ No Sketch Attached: ☒ Yes ☐ No Exterior Colour Scheme:

1. Cabinetry

	Style and Colour	Counter Top	Hardware
Kitchen / Breakfast	OTTAWA PAINT: CANNOLI	9141 - SQ EDGE	12891
Kitchen Island	OTTAWA PAINT: CANNOLI	9141 - SQ EDGE	12891
Laundry Room	NEW PORT PAINT: CANNOLI	N/A	196
Powder Room	NEW PORT PAINT: CANNOLI	GRIGIO SARDO - SQ EDGE	196
Main Bathroom	KINGSTON MAPLE: ESPRESSO	9141 - SQ EDGE	196
Master Ensuite Bathroom	KINGSTON MAPLE: ESPRESSO	9141 - SQ EDGE	196
Second Ensuite Bathroom (If Applicable)			
Ground Floor Bath	NEW PORT PAINT: CANNOLI	GRIGIO SARDO - SQ EDGE	196

Appliances

Custom Size Fridge

☒ Yes ☐ No

Valance Lighting

☒ Yes ☐ No

Microwave / Range Hood

☒ Yes ☐ No

Cooktop / Rangetop

☒ Yes ☐ No

Built in Wall Oven

☒ Yes ☐ No

Slide-in Range

☐ Yes ☒ No

Comment

2. Flooring

	Selection
Foyer	MUST 18X18 POLISHED: IVORY
Main Hall	SATIN FINISH GEN. - HOME OAK 3 5/8 INCH X 3/4 INCH: WALNUT
Back Hall	
Breakfast	SATIN FINISH GEN. - HOME OAK 3 5/8 INCH X 3/4 INCH: WALNUT
Laundry Room	RELEX 13X13: OLIVE
Kitchen	SATIN FINISH GEN. - HOME OAK 3 5/8 INCH X 3/4 INCH: WALNUT
Powder Room	SERPENTINE 13x13: KREM (CREAM)
Main Bathroom	NEW REEDS 13x13: SILVER
Master Ensuite	REGAL POLISHED 12x24: TAUPE
Bathroom (If Applicable)	
Mud Room	RELEX 13X13: OLIVE
Ground Floor Bath	RELEX 13X13: OLIVE
Living Room	
Dining Room	SATIN FINISH GEN. - HOME OAK 3 5/8 INCH X 3/4 INCH: WALNUT
Family / Great Room	SATIN FINISH GEN. - HOME OAK 3 5/8 INCH X 3/4 INCH: WALNUT
Den / Library / Study	
Basement Landing (If Applies)	
Lower Landing (If Applicable)	
Upper Landing	
Upper Hall	SATIN FINISH GEN. - HOME OAK 3 5/8 INCH X 3/4 INCH: WALNUT
Master Bedroom	SATIN FINISH GEN. - HOME OAK 3 5/8 INCH X 3/4 INCH: WALNUT
Bedroom #2	SATIN FINISH GEN. - HOME OAK 3 5/8 INCH X 3/4 INCH: WALNUT
Bedroom #3	SATIN FINISH GEN. - HOME OAK 3 5/8 INCH X 3/4 INCH: WALNUT
Bedroom #4	
Bedroom #5	
Recreation Room	PAPILIO: SOFT CAMEO 17185

Flooring Continued on Page 2

Initial: JYH



INTERIOR COLOUR SCHEME

Purchaser: Yuehua Jiang

Property: 91 of Plan -

Telephone Res. / Bus: /

Project: Teefy Developments Limited

Decor Advisor: Nicole Soares

Model and Elevation: Bedford(22-2)

2. Flooring - Continued -

Upgrade Underpad	Type	Area
	<input type="text"/>	<input type="text"/>
Carpet on Stairs	Capped	Runner - *Upgrade
Comment	<input type="text"/>	<input type="text"/>

3. Plumbing Fixtures / Faucets

Kitchen	STD	Second Ensuite	<input type="text"/>	Powder Room	STD
Master Ensuite	STD			Other Room	<input type="text"/>
Main Bathroom	STD	Ground Floor Bath	STD		

Comment

4. Wall Tile

	Tile Selection	Listello	Insert	Insert Selection
Main Bathroom	WEAVE 8x10: IVORY	<input type="checkbox"/>	<input type="checkbox"/>	<input type="text"/>
Master Ensuite				
Tub Deck	<input type="text"/>	<input type="checkbox"/>	<input type="checkbox"/>	<input type="text"/>
Tub Apron	<input type="text"/>	<input type="checkbox"/>	<input type="checkbox"/>	<input type="text"/>
Tub Surround	<input type="text"/>	<input type="checkbox"/>	<input type="checkbox"/>	<input type="text"/>
Shower Stall	NEW BELLA 10X20: WHITE/GREY VEINING	<input type="checkbox"/>	<input type="checkbox"/>	<input type="text"/>
Second Ensuite	<input type="text"/>	<input type="checkbox"/>	<input type="checkbox"/>	<input type="text"/>
Ensuite Shower Floor	ONTARIO 2x2 MOSAIC: TENDER GREY	<input type="checkbox"/>	<input type="checkbox"/>	<input type="text"/>
Ground Floor Bath	WEAVE 8x10: IVORY	<input type="checkbox"/>	<input type="checkbox"/>	<input type="text"/>
Kitchen Backsplash	<input type="text"/>	<input type="checkbox"/>	<input type="checkbox"/>	<input type="text"/>
Complete Backsplash	<input type="text"/>	<input type="checkbox"/>	<input type="checkbox"/>	<input type="text"/>

Comment

5. Fireplace

	Living Room			Family Room			Other Room - Specify		
	Purchased	As Per Plan	N/A	Purchased	As Per Plan	N/A	Purchased	As Per Plan	N/A
Fireplace Type	<input type="radio"/>	<input type="radio"/>	<input type="radio"/>	<input type="radio"/>	<input checked="" type="radio"/>	<input type="radio"/>	<input type="radio"/>	<input type="radio"/>	<input type="radio"/>
Mantle Type	<input type="text"/>			STD ELECTRIC 50" LINEAR			<input type="text"/>		
Over Mantle	<input type="text"/>			<input type="text"/>			<input type="text"/>		
Colour / Stain	<input type="text"/>			<input type="text"/>			<input type="text"/>		
Surround	<input type="text"/>			STANDARD			<input type="text"/>		
Hearth	<input type="text"/>			<input type="text"/>			<input type="text"/>		

Comment

Initial:

JK

Page 2 of 3



INTERIOR COLOUR SCHEME

Purchaser: Yuehua Jiang
Telephone Res. / Bus: /
Decor Advisor: Nicole Soares

Property: 91 of Plan -
Project: Teefy Developments Limited
Model and Elevation: Bedford(22-2)

6. Trim Carpentry

Door Hardware STANDARD

Interior Trim STANDARD BASEBOARD & CASING

Comment

Interior Doors

☐ 2 Panel Arch Top☒ 2 Panel Square Top☐ 6 Panel

Initial for Door Style

JYH

7. Railings and Pickets

Railing Package STANDARD PLAIN BLACK METAL PICKETS WITH SQUARE POST

Railing Colour STAINED TO MATCH

Picket Colour BLACK METAL PICKETS

Wood Stairs ☐ No ☒ Oak

Tread Colour STAINED TO MATCH

Comment

STAIRS TO BE STAINED TO MATCH SATIN FINISH GEN. - HOME OAK 3 5/8 INCH X 3/4 INCH: WALNUT AS MUCH AS POSSIBLE **** PURCHASER IS AWARE THAT STAIN WILL NOT BE A 100% TRUE MATCH

8. Plaster Mouldings and Medallions

Foyer

Main Hall

Living Room

Dining Room

Family Room

Kitchen/Breakfast

Den/Library

Lower Landing

Comment

9. Wall Paint

SENATOR WHITE

Smooth Ceilings

☐ First Floor☐ First Floor incl. Second Floor Hall☐ First and Second Floor☒ Throughout☐ Not Applicable

Trim Paint SENATOR WHITE

10. Additional Comments

CEILINGS TO BE DONE SMOOTH AS PER SCHEDULE

11. Disclaimers and Notes

- Colours of all materials are as close as possible to builder's selection, but not necessarily identical due to variances in manufacturing.
- Any extras listed above are null and void unless accompanied by a separate invoice/amendment. Said invoice must be paid in full.
- The Purchaser acknowledges that after Interior Colour Selection form is signed and dated, no further changes will be permitted other than re-selection due to unavailability. JYH Purchaser's Initials
- The Purchaser acknowledges reading and accepting the "Senator Homes Décor Centre Disclaimers" form. This document contains other miscellaneous disclaimers.

This Interior Colour Selection is final and approved by:

Purchaser:

Signature:

Date: NOV 25 2015

Vendor:

Teefy Developments Limited

BEDFORD^{END}

9130-91

2420 SQ.FT. / 2251 SQ.FT. WITH OPTIONAL TANDEM GARAGE

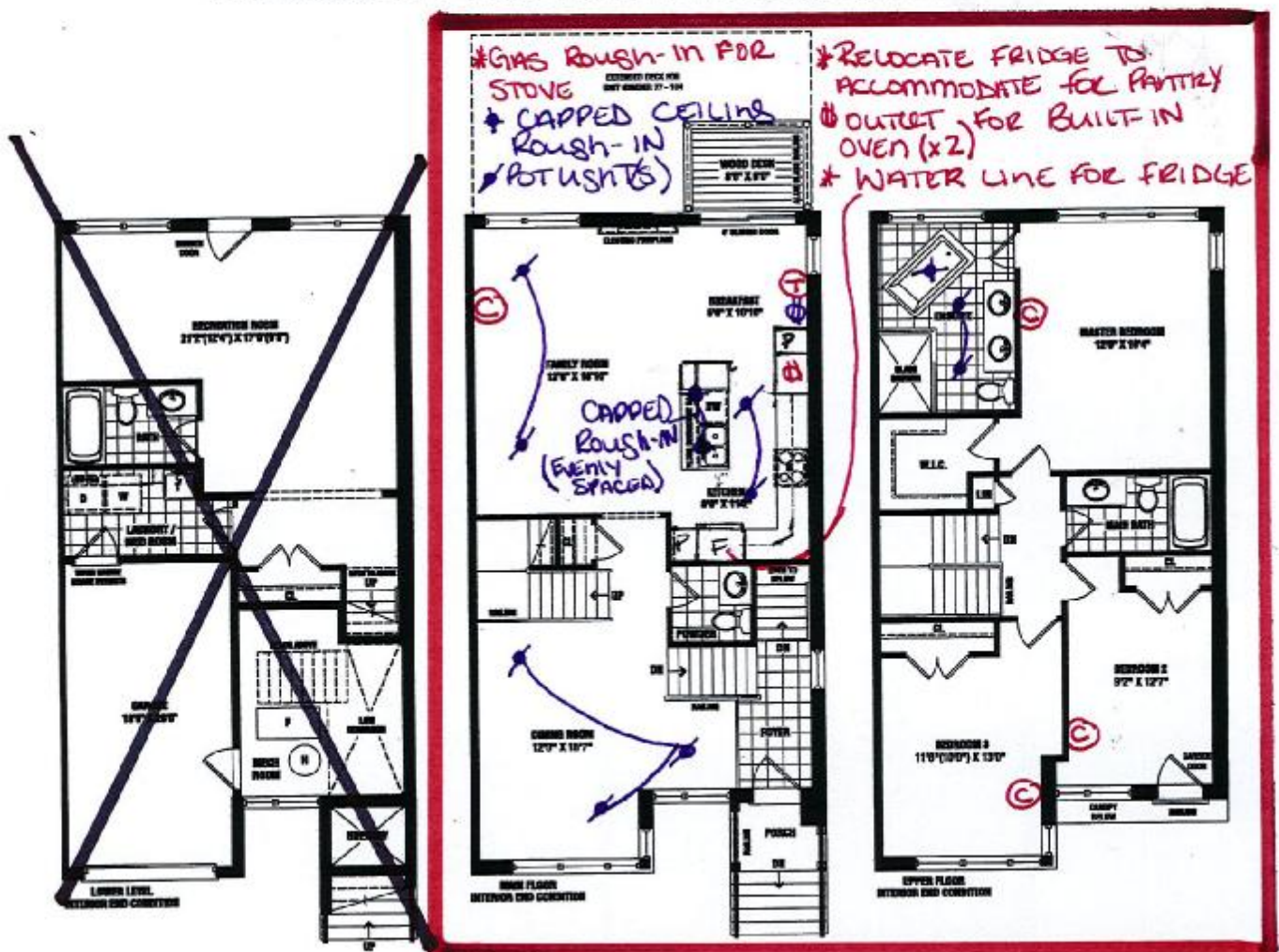

© CABLE
 ① TELEPHONE
 # OUTLET (NOT ON SEP. CIE.)

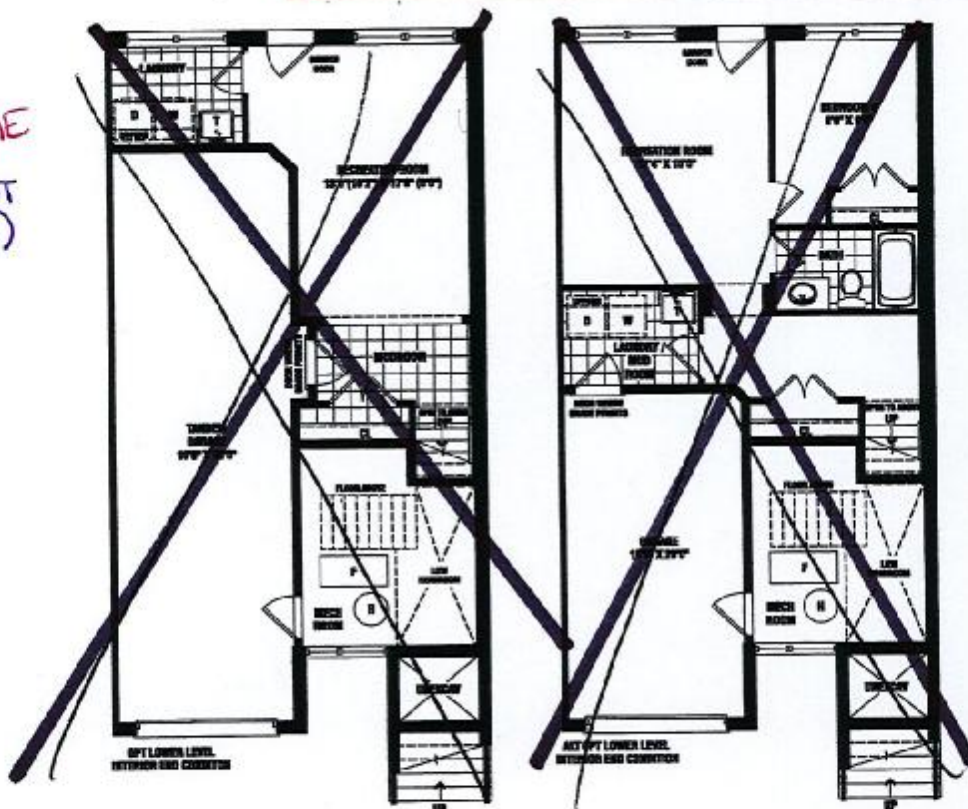

SENATOR HOMES

SENATOR HOMES DECOR CENTRE

DATE: NOV 25 2015
 INITIALS: JVB

Renderings are artist's concept. Some elevations may vary from that shown. Actual useable square footage may vary from that stated herein. Some floorplans and elevations are mirror image to that shown. E.A.O.E. 22-2

R

UPGRADE REQUEST

Lot 91 - BEDFORD - TH 22-2

SENATOR HOMES - TEEFY

KITCHEN - OTTOWA CANNOLI
*CROWN VALANCE (LARGE)

*LIGHT VALANCE

*FACIA Panel

-APPLIANCE SPECS REQUIRED

-SENATOR MUST CONFIRM KITCHEN WALL EXTENSION LENGTH

-SENATOR MUST CONFIRM ISLAND BASE EXTENSION LENGTH

SENATOR HOMES
DECOR CENTRE

DATE: NOV 25 2015

INITIALS:

TRIX

STANDARD ELEVATION

-KITCHEN (MAIN FLOOR) ELEV A

-1/2 PG. INT END, SIDE ELEV A

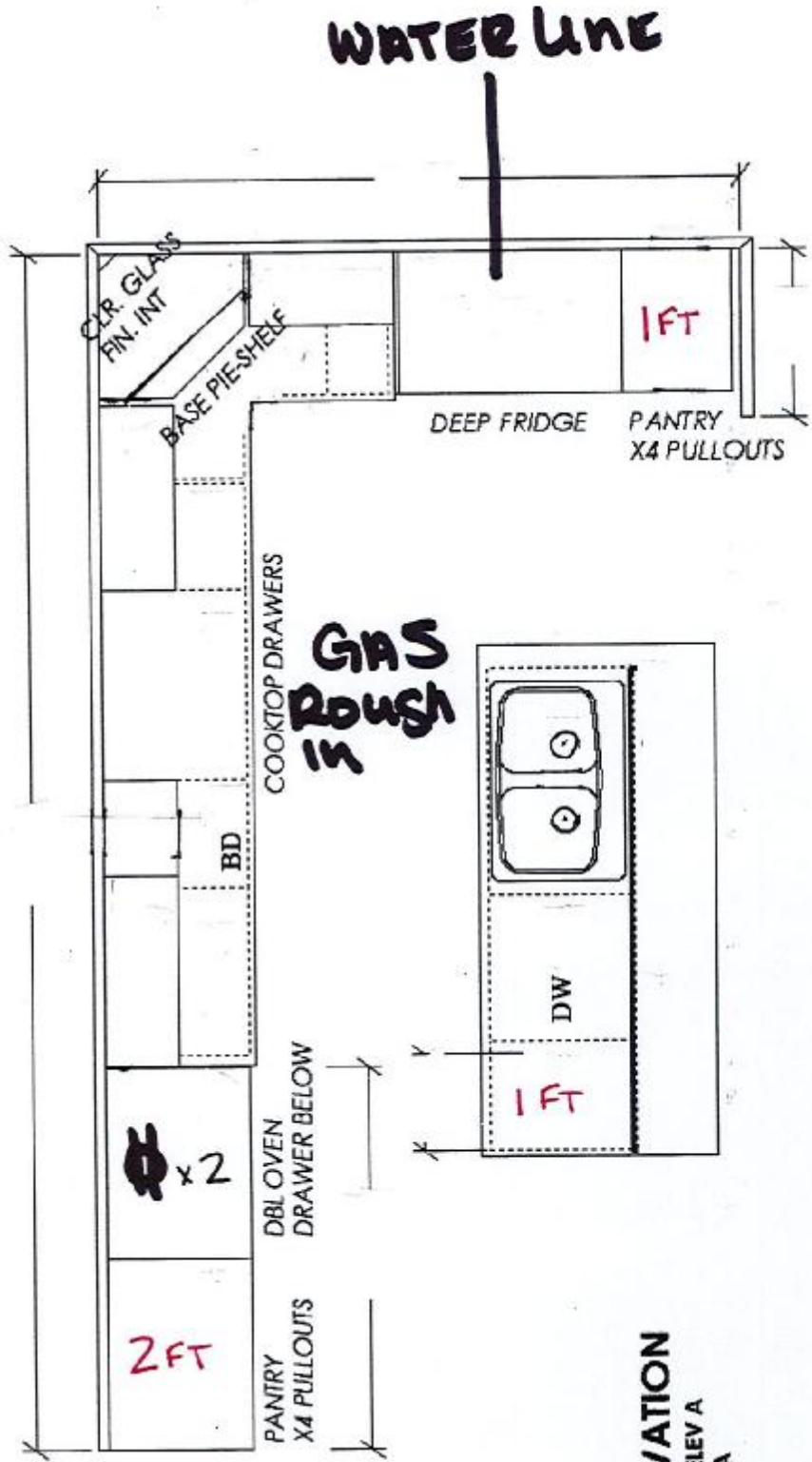

9130-91

36" Counter-Depth French Door Refrigerator

800 Series – Stainless Steel B22CT80SNS



BOSCH
Invented for life



B22CT80SNS
Stainless Steel

This 72" counter-depth French Door refrigerator installs nearly flush and features LED lighting for easier viewing.

Features & Benefits

- The internal water dispenser delivers filtered and chilled water.
- 72" height fills refrigerator cutout precisely, with no unsightly gap.
- Clean exterior design for a perfect built-in look.
- The LED lighting shines exceptionally bright and saves energy.
- Spill-proof glass shelves prevent liquids from running off shelves.

General Properties	
Water filter	Yes
Lighting	LED
Defrost process refrigerator section	Frost-free
Number of shelves - refrigerator	5
Adjustable shelves - refrigerator	4 half-width
Shelf material - refrigerator	Tempered glass
Type of shelves - refrigerator	Spill-proof glass
Gallon storage bins	2
Humidity control drawer	2
Defrost process freezer section	Automatic
Number of drawers - freezer	3
Ice maker	Yes
Quick ice	No

Capacity	
Total unit gross capacity (cu. ft.) - AHAM	21.8 cu. ft.
Refrigerator gross capacity (cu. ft.)	16.27 cu. ft.
Freezer gross capacity (cu. ft.)	5.52 cu. ft.



Technical Details	
Current (A)	15 A
Volts (V)	120 V
Frequency (Hz)	60 Hz
Power cord length (in.)	62
Plug type	120V-3 prong
Dimensions & Weight	
Appliance dimensions (H x W x D) (in.)	71 7/8" x 35 5/8" x 30 1/8"
Required cutout size (H x W x D) (in.)	72" x 36" x 25 5/8"
Net weight (lbs)	345 lbs
Efficiency	
ENERGY STAR® qualified	No
Energy consumption (kWh/yr)	633 kWh
Accessories-Included	
Included	Ice scoop



For help and assistance with Bosch accessories please visit: www.bosch-eshop.com/eshop/bosch/us or call 1-800-944-2904 Mon-Fri 9am to 6pm PST Sat 9am to 3pm PST

Notes: All height, width and depth dimensions are shown in inches. Please refer to installation instructions prior to making cutout. BSH reserves the absolute and unrestricted right to change product materials and specifications, at any time, without notice. Consult the product's installation instructions for final dimensional data and other details. Applicable product warranty can be found in accompanying product literature or you may contact your account manager for further details.

Warranties: Bosch warrants that the Product is free from defects in materials and workmanship for a period of three hundred and sixty-five (365) days from the date of purchase. The foregoing timeline begins to run upon the date of purchase, and shall not be stalled, tolled, extended, or suspended, for any reason whatsoever. This Product is also warranted to be free from cosmetic defects in material and workmanship (such as scratches of stainless steel, paint/porcelain blemishes, chip, dents, or other damage to the finish of the Product, for a period of thirty (30) days from the date of purchase or closing date for new construction. This cosmetic warranty excludes slight color variations due to inherent differences in painted and porcelain parts, as well as differences caused by kitchen lighting, product location, or other similar factors. This cosmetic warranty specifically excludes any display, floor, "As Is", or "B" stock appliances.

For more information on our entire line of products, go to www.bosch-home.com/us or call 1-800-944-2904

© BSH Home Appliances Corporation. All rights reserved. Bosch is a registered trademark of Robert Bosch GmbH.

SENATOR HOMES
DECOR CENTRE
DATE: NOV 25 2015
INITIALS: JY18

36" Counter-Depth French Door Refrigerator

800 Series – Stainless Steel B22CT80SNS



BOSCH
Invented for life

Installation Details

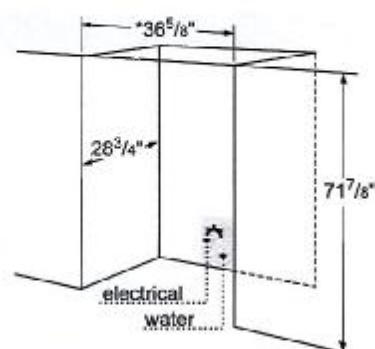
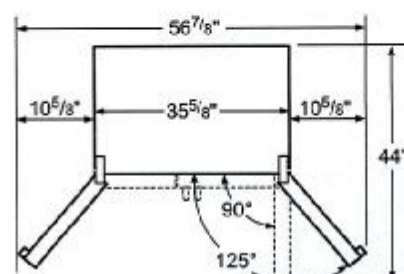
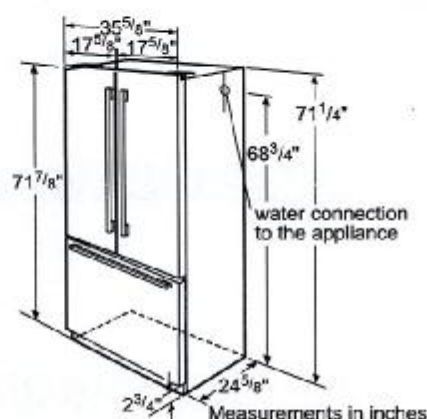

* If fixed wall/alcove, add 4" to this width (2.5" total space on each side for doors).

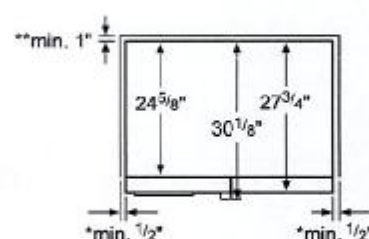

- * min. 1/2", 2 1/2" on either side if next to a wall.
- * If the appliance is placed next to a range, the lateral distance must be min. 1".
- ** The clearance at the back must include the space for the water connection.

**SENATOR HOMES
DECOR CENTRE**

DATE: NOV 25 2015

INITIALS: JYJ

For help and assistance with Bosch accessories please visit: www.bosch-eshop.com/eshop/bosch/us or call 1-800-944-2904 Mon-Fri 5am to 6pm PST Sat 6am to 3pm PST

Notes: All height, width and depth dimensions are shown in inches. Please refer to installation instructions prior to making cutout. BSH reserves the absolute and unrestricted right to change product materials and specifications, at any time, without notice. Consult the product's installation instructions for final dimensional data and other details. Applicable product warranty can be found in accompanying product literature or you may contact your account manager for further details.

Warranties: Bosch warrants that the Product is free from defects in materials and workmanship for a period of three hundred and sixty-five (365) days from the date of purchase. The foregoing timeline begins to run upon the date of purchase, and shall not be stalled, tolled, extended, or suspended, for any reason whatsoever. This Product is also warranted to be free from cosmetic defects in material and workmanship (such as scratches of stainless steel, paint/porcelain blemishes, chip, dents, or other damage to the finish of the Product, for a period of thirty (30) days from the date of purchase or closing date for new construction. This cosmetic warranty excludes slight color variations due to inherent differences in painted and porcelain parts, as well as differences caused by kitchen lighting, product location, or other similar factors. This cosmetic warranty specifically excludes any display, floor, "As is", or "B" stock appliances.

For more information on our entire line of products, go to www.bosch-home.com/us or call 1-800-944-2904

© BSH Home Appliances Corporation. All rights reserved. Bosch is a registered trademark of Robert Bosch GmbH.

30" Gas Cooktop

Benchmark™ Series - Stainless Steel NGMP055UC



BOSCH
Invented for life

9130-91



NGMP055UC

The Benchmark™ Series gas cooktop features a 20,000 BTU dual-stacked burner, allowing flexibility to cook on high heat or simmer.

Features & Benefits

- Five burners in a 30" cooktop to cook more dishes at once.
- Powerful centre burner designed for faster boil time and a low simmer.
- Heavy-duty metal knobs for a premium look and feel.
- Distinctive red LED light indicates burners are on.

General Properties	
Knob material	Metal
Sealed burners	Yes
Grate material	Cast iron
Element Performance	
Total BTU load (NG / LP)	51,000 / 43,200
Power of front left burner (NG / LP)	10,000 / 9,100
Power of back left burner (NG / LP)	5,500 / 5,000
Power of centre burner (NG / LP)	20,000 / 15,000
Power of back right burner (NG / LP)	10,000 / 9,100
Power of front right burner (NG / LP)	5,500 / 5,000
Technical Details	
Watts	360 W
Circuit breaker	15 A
Volts	120 V
Frequency	60 Hz
Plug type	3 prong
Power cord length	60"
Energy source	Gas
Convertible to LP (kit required)	Yes

Dimensions & Weight	
Overall appliance dimensions (HxWxD)	3 13/16" x 31" x 21 1/4"
Required cutout size (HxWxD)	3 13/16" x 28 15/16" x 19 1/8"
Minimum distance from counter front	1 7/8"
Minimum distance from rear wall	3"
Net weight	38 lbs
Accessories-Included	
Included	LP conversion kit



For help and assistance with Bosch accessories please call 1-800-944-2904 Mon-Fri 8am to 6pm EST

Notes: All height, width and depth dimensions are shown in inches. Please refer to installation instructions prior to making cutout. BSH reserves the absolute and unrestricted right to change product materials and specifications, at any time, without notice. Consult the product's installation instructions for final dimensional data and other details. Applicable product warranty can be found in accompanying product literature or you may contact your account manager for further details.

Warranties: Bosch warrants that the Product is free from defects in materials and workmanship for a period of three hundred and sixty-five (365) days from the date of purchase. The foregoing timeline begins to run upon the date of purchase, and shall not be stalled, tolled, extended, or suspended, for any reason whatsoever. This Product is also warranted to be free from cosmetic defects in material and workmanship (such as scratches of stainless steel, paint/porcelain blemishes, chip, dents, or other damage to the finish of the Product) for a period of thirty (30) days from the date of purchase or closing date for new construction. This cosmetic warranty excludes slight colour variations due to inherent differences in painted and porcelain parts, as well as differences caused by kitchen lighting, product location, or other similar factors. This cosmetic warranty specifically excludes any display, floor, "As Is", or "B" stock appliances.

For more information on our entire line of products, go to www.bosch-home.ca or call 1-800-944-2904

© 2014 BSH Home Appliances Canada. All rights reserved. Bosch is a registered trademark of Robert Bosch GmbH.

SENATOR HOMES
DECOR CENTRE
DATE: NOV 25 2015
INITIALS: SYL

9130-91

30" Gas Cooktop

Benchmark™ Series - Stainless Steel NGMP055UC



BOSCH
Invented for life

Installation Details

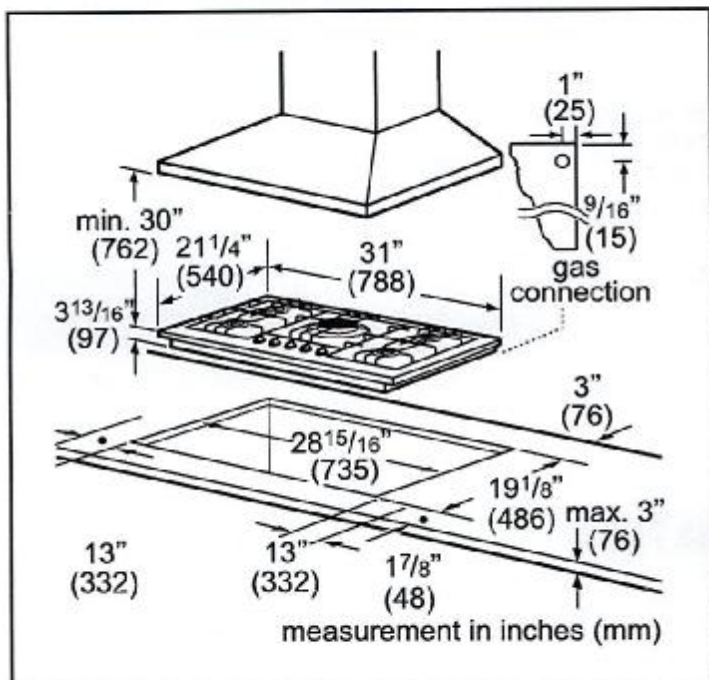

Installation above Wall Ovens

30" Built-in oven - under gas cooktop

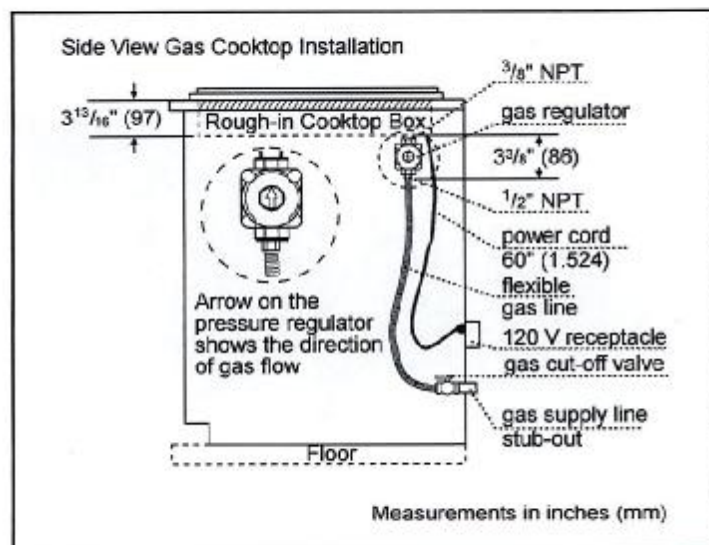
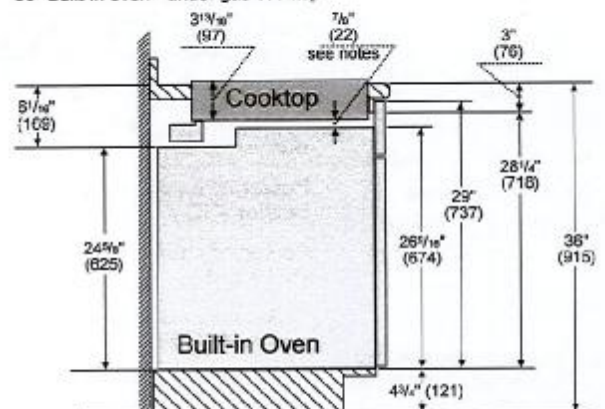

**SENATOR HOMES
DECOR CENTRE**

DATE: NOV 25 2015
INITIALS: JYH

For help and assistance with Bosch accessories please call 1-800-944-2904 Mon-Fri 8am to 6pm EST

Notes: All height, width and depth dimensions are shown in inches. Please refer to installation instructions prior to making cutout. BSH reserves the absolute and unrestricted right to change product materials and specifications, at any time, without notice. Consult the product's installation instructions for final dimensional data and other details. Applicable product warranty can be found in accompanying product literature or you may contact your account manager for further details.

Warranties: Bosch warrants that the Product is free from defects in materials and workmanship for a period of three hundred and sixty-five (365) days from the date of purchase. The foregoing timeline begins to run upon the date of purchase, and shall not be stalled, tolled, extended, or suspended, for any reason whatsoever. This Product is also warranted to be free from cosmetic defects in material and workmanship (such as scratches of stainless steel, paint/porcelain blemishes, chip, dents, or other damage to the finish of the Product) for a period of thirty (30) days from the date of purchase or closing date for new construction. This cosmetic warranty excludes slight colour variations due to inherent differences in painted and porcelain parts, as well as differences caused by kitchen lighting, product location, or other similar factors. This cosmetic warranty specifically excludes any display, floor, "As Is", or "B" stock appliances.

For more information on our entire line of products, go to www.bosch-home.ca or call 1-800-944-2904

© 2014 BSH Home Appliances Canada. All rights reserved. Bosch is a registered trademark of Robert Bosch GmbH.



Chimney Hood
CTS9004



9130-91

Specification

Type	: Ducted
Noise level (dB)	: ≤56
Illumination power (W)	: 1.5 × 2
Unrestrained air flow (m³/h)	: 1450
Motor power (W)	: 200
Filter	: Clean & clear filter

Features

- 90cm wide stainless steel surface
- Elegant black panel design
- Ultra powerful extraction
- 2 x 1.5W LED lights, energy-saving
- 3 speed fan control
- Delay-off function
- Seamless canopy, easy cleaning

Print Send to friend Share this page

Schematic Diagram

Back to Product

Where to buy
Locate Fotile products at your nearest stores.
Find out more >

Service & Care
Need help? We will advise you.
Find out more >

E-Warranty **Register Now!**
You can now register your Fotile warranty.
Find out more >

Innovation
Fotile keeps on developing advanced technology.
Find out more >

Press Room
Fotile is actively involves in events.
Find out more >

Download Centre
You can now download Fotile brochure.
Find out more >

View Fotile EL brochure online

View Fotile ST brochure online

SENATOR HOMES
DECOR CENTRE

DATE: NOV 25 2015
INITIALS: [Signature]

9130-91

Hood

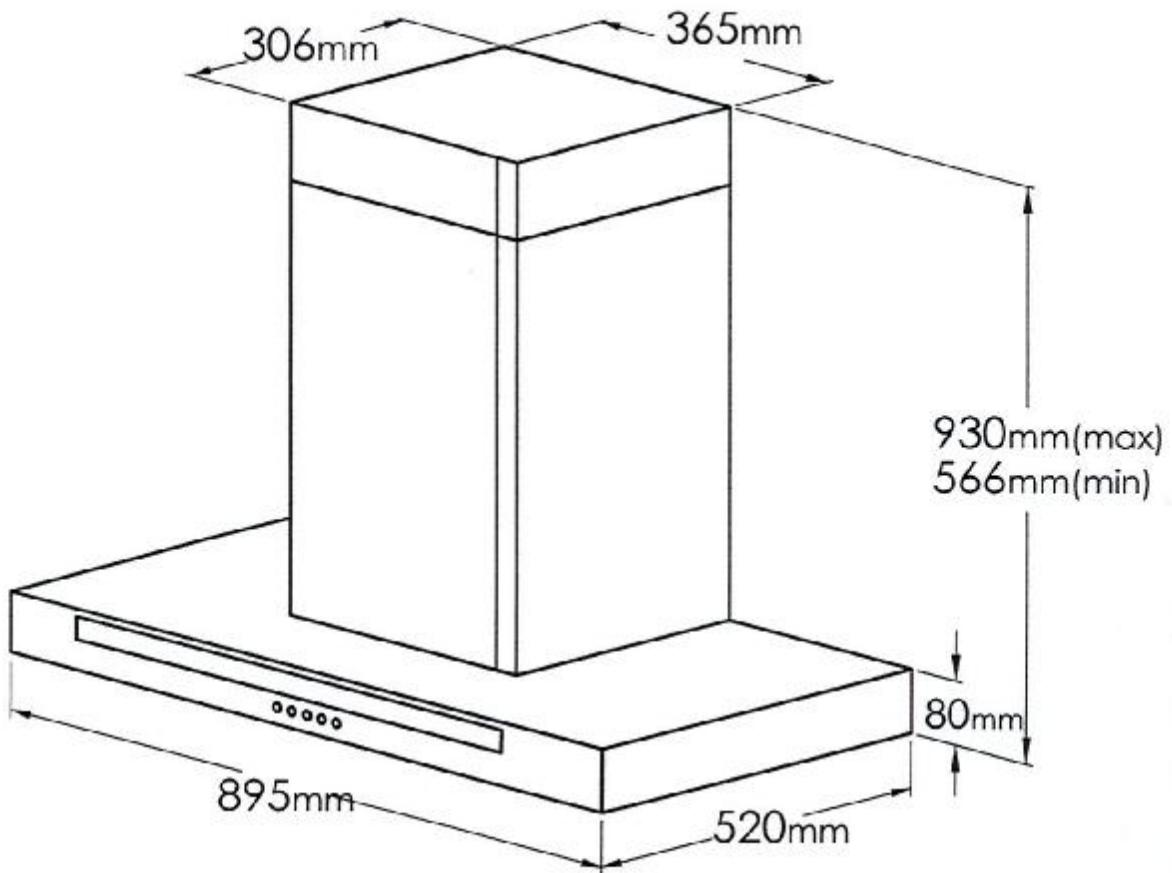

CTS9004

SENATOR HOMES
DECOR CENTRE
DATE: NOV 25 2015
INITIALS: TYL

Built-In Microwave Oven

500 Series - Stainless Steel HMB5051



Access Specification Sheet for Download

9130-71



BOSCH
Invented for life



HMB5051
Stainless Steel

Also available in:
Black HMB5061

Built-In microwave design matched for use in combination with Bosch wall oven.

Features & Benefits

- Large Cooking Interior Gives You More Flexibility in What Types of Dishes You Can Cook
- Built For Speed and Convenience With 1200 Watts of Microwave Cooking Power
- Built-In Microwave With Trim Kit Profile is Flush to Cabinet Doors
- Convenient Automatic Sensor Programs Simplify Cooking for Great Results Every Time

General Properties

Cavity colour	White
Max. microwave power (W)	1,200 W

Capacity

Cavity capacity (cu. ft.)	2.1 cu. ft.
Turntable diameter (in.)	16 1/2"

Technical Details

Watts (W)	1,460 W
Circuit breaker (A)	20 A
Volts (V)	120 V
Frequency (Hz)	60 Hz
Power cord length (in)	41 5/16"
Plug type	120V-3 prong



Dimensions & Weight

Overall appliance dimensions (HxWxD) (in)	14" x 23 7/8" x 19 7/16"
Required cutout size (HxWxD) (in)	19 7/8" X 25 7/16" - 28 7/16" X 21"
Net weight (lbs)	34 lbs

Accessories-Included

Included	Glass turntable
----------	-----------------

Accessories-Optional



HMT5751
27" Stainless steel trim kit



HMT5051
30" Stainless steel trim kit

For help and assistance with Bosch accessories please call 1-800-944-2904 Mon-Fri 8am to 6pm EST

Notes: All height, width and depth dimensions are shown in inches. Please refer to installation instructions prior to making cutout. BSH reserves the absolute and unrestricted right to change product materials and specifications, at any time, without notice. Consult the product's installation instructions for final dimensional data and other details. Applicable product warranty can be found in accompanying product literature or you may contact your account manager for further details.

Warranties: Bosch warrants that the Product is free from defects in materials and workmanship for a period of three hundred and sixty-five (365) days from the date of purchase. The foregoing timeline begins to run upon the date of purchase, and shall not be stalled, tolled, extended, or suspended, for any reason whatsoever. This Product is also warranted to be free from cosmetic defects in material and workmanship (such as scratches of stainless steel, paint/porcelain blemishes, chip, dents, or other damage to the finish of the Product) for a period of thirty (30) days from the date of purchase or closing date for new construction. This cosmetic warranty excludes slight colour variations due to inherent differences in painted and porcelain parts, as well as differences caused by kitchen lighting, product location, or other similar factors. This cosmetic warranty specifically excludes any display, floor, "As Is", or "B" stock appliances.

For more information on our entire line of products, go to www.bosch-home.ca or call 1-800-944-2904

© 2014 BSH Home Appliances Canada. All rights reserved. Bosch is a registered trademark of Robert Bosch GmbH.

SENATOR HOMES
DECOR CENTRE
DATE: NOV 25 2015
INITIALS: TYU

9130-91

Built-In Microwave Oven

500 Series - Stainless Steel HMB5051



BOSCH
Invented for life

Installation Details

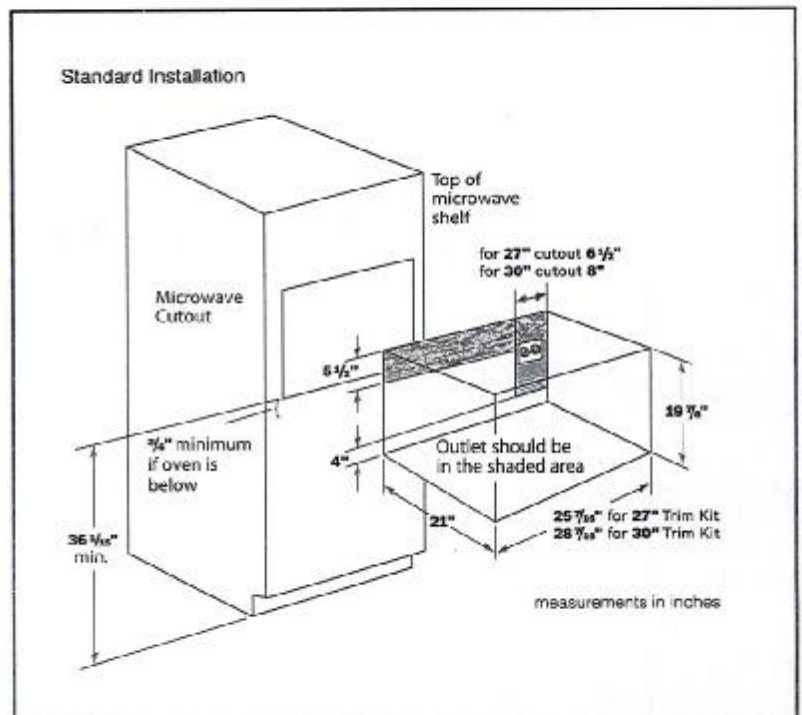
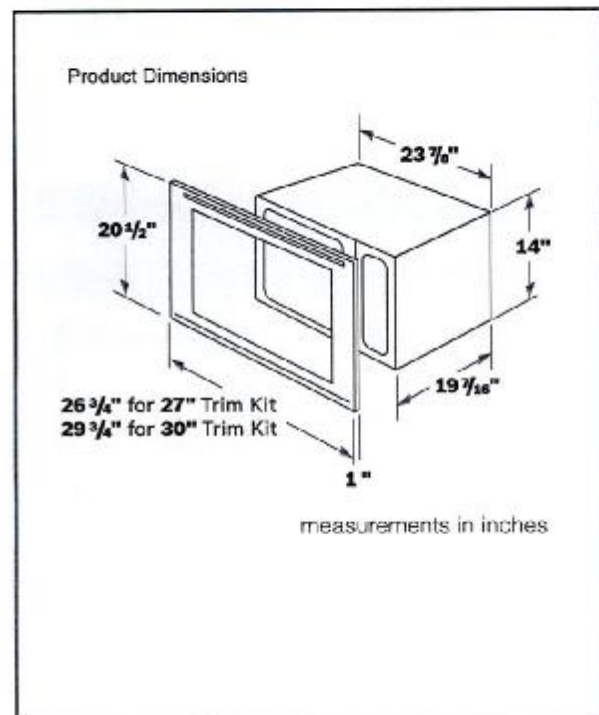

SENATOR HOMES
DECOR CENTRE

DATE: NOV 25 2015
INITIALS: TYL

For help and assistance with Bosch accessories please call 1-800-944-2904 Mon-Fri 8am to 6pm EST

Notes: All height, width and depth dimensions are shown in inches. Please refer to installation instructions prior to making cutout. BSH reserves the absolute and unrestricted right to change product materials and specifications, at any time, without notice. Consult the product's installation instructions for final dimensional data and other details. Applicable product warranty can be found in accompanying product literature or you may contact your account manager for further details.

Warranties: Bosch warrants that the Product is free from defects in materials and workmanship for a period of three hundred and sixty-five (365) days from the date of purchase. The foregoing timeline begins to run upon the date of purchase, and shall not be stalled, tolled, extended, or suspended, for any reason whatsoever. This Product is also warranted to be free from cosmetic defects in material and workmanship (such as scratches of stainless steel, paint/porcelain blemishes, chip, dents, or other damage to the finish of the Product) for a period of thirty (30) days from the date of purchase or closing date for new construction. This cosmetic warranty excludes slight colour variations due to inherent differences in painted and porcelain parts, as well as differences caused by kitchen lighting, product location, or other similar factors. This cosmetic warranty specifically excludes any display, floor, "As Is", or "B" stock appliances.

For more information on our entire line of products, go to www.bosch-home.ca or call 1-800-944-2904

© 2014 BSH Home Appliances Canada. All rights reserved. Bosch is a registered trademark of Robert Bosch GmbH.

WF42H5700AG

Samsung Front-Load Washer

9130-91

4.8 cu. ft. Capacity IEC

Features

- PowerFoam™
- Steam Washing
- SuperSpeed
- Smart Care™
- Self Clean+
- VRT®
- Eco Cold Wash
- Diamond Drum® Design
- Direct Drive Motor
- 1300 rpm Maximum Spin Speed
- Internal Water Heater
- 13 Preset Wash Cycles
- 12 Options
- Garment+

Convenience

- Child Lock
- Door Lock
- Dispenser Trays: Prewash, Main Wash, Softener, Bleach



ENERGY STAR® rated:
CEE Tier 3
MEF=3.42
WCF=2.70
90 kWh/yr



4.8 cu. ft. Capacity

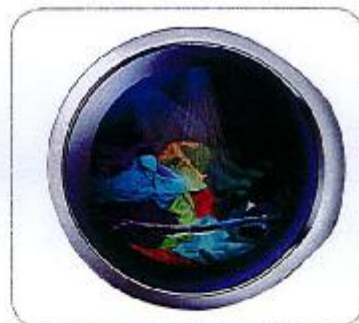

SuperSpeed

Available Colour:



Onyx
(shown)

Signature Features

POWERFOAM

- Powerful washing performance.
- Creates a powerful yet gentle foam that easily penetrates through fabrics.
- Confidently wash even your largest loads.

STEAM WASHING

- Powerful steam removes stains.
- No pre-treatment needed.

SUPERSPEED

- 40% faster wash cycle.*
- Wash a full load in only 36 minutes.**
- Save over 3 hours of laundry time every week.**
- Laundry gets done quicker without loss of performance.

*Normal full load wash can now be completed in as little as 36 minutes as compared to Samsung WF42H5700AG without SuperSpeed. Based on 2014 standards average of 1.2 hours per wash.

**Based on average of 210 lbs. load per year with average normal wash cycle of 55 minutes, resulting in time savings of over 3 hours per year.



Ranked "Highest in Customer Satisfaction with Clothes Washers" in 2013 & 2014 by J.D. Power and Associates.



Achieved the U.S. Environmental Protection Agency's 2014 ENERGY STAR® "Most Efficient" designation.

SAMSUNG

SENATOR HOMES
DECOR CENTRE

DATE:

NOV 25 2015

INITIALS:

JYLY

9130-91

WF45H5700AG

Samsung Front-Load Washer

Installing Options



Stacked

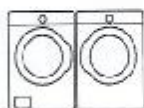

Side by Side



On Pedestals



Stacked Depth

4.5 cu. ft. Capacity IEC

13 Preset Wash Cycles:

Eco Cold Wash, Normal, Heavy Duty, Permanent Press, Sanitize, Allergen, Bedding, Deep Steam, Active Wear, Delicates, Wool, Quick Wash, Rinse and Spin

12 Options:

SuperSpeed, Steam, Self Clean+, Delay End, My Cycle, Prewash, Extra Rinse, Extra Spin, Spin Only, Sound, Child Lock, Smart Care

5 Temperature Settings:

Extra Hot, Hot, Warm, Eco Warm, Cold

5 Spin Settings:

Extra High, High, Medium, Low, No Spin

5 Soil Settings:

Heavy, Heavy Medium, Normal, Low Medium, Light

Dispenser Trays:

Prewash, Main Wash, Softener, Bleach

Warranty

One (1) Year Parts and Labour
Two (2) Years Control Board
Three (3) Years Stainless Steel Drum
Ten (10) Years Direct Drive Motor

Product Dimensions & Weight (WxHxD)

Dimensions: 27" x 38 11/16" x 34"
Weight: 194 lbs

Shipping Dimensions & Weight (WxHxD)

Dimensions: 29 1/4" x 41 11/16" x 34 5/8"
Weight: 203 lbs

Colour

Onyx

Model

WF42H5700AG

UPC Code

887276963006

Matching Dryer (Electric)

Onyx

DV42H5600EG

887276963327

Installing Your Washer

1. Alcove or closet installation

Minimum clearances for closet and alcove installations:

Sides - 1"
Rear - 5 1/8"
Top - 17"
Closet Front - 2"

If the washer and dryer are installed together, the closet front must have at least a 72" unobstructed air opening. Your washer alone does not require a specific air opening.



Dimensions

2. With optional pedestal base or stacking kit

Required Dimensions for Installation with Pedestal

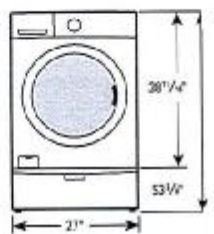
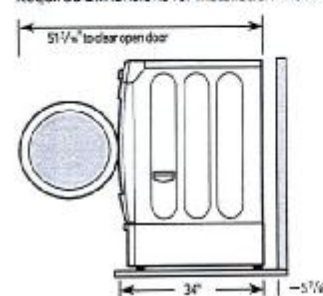

Required Dimensions for Installation with Stacking Kit

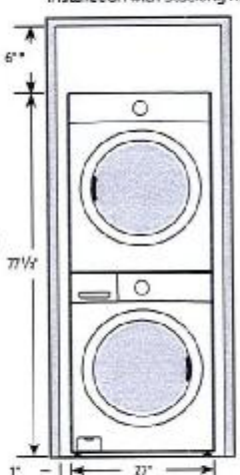

*Required spacing.
**External exhaust elbow requires additional space.

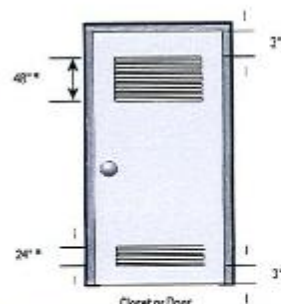

Closet or Door

SAMSUNG

Actual colour may vary. Design, specifications, and colour availability are subject to change without notice. Non-metric weights and measurements are approximate. Minimum clearances are recommendations only. Samsung received the highest numerical score for clothes washers in the proprietary J.D. Power 2009-2013 Laundry Appliance Studies®. 2013 study based on 7,850 total responses measuring 17 clothes washer brands and measures opinions of consumers about their new washer purchased in the past 24 months. Proprietary study results are based on experiences and perceptions of consumers surveyed in January-February, 2013. Your experiences may vary. Visit jdpower.com for more information. The ENERGY STAR Most Efficient 2014 designation recognizes the most efficient products among those that qualify for the ENERGY STAR program. These exceptional clothes washers represent the leading edge in energy efficient products.

© 2014 Samsung Electronics Canada Inc. All rights reserved. Samsung is a registered trademark of Samsung Electronics Co., Ltd. used with permission.

**SENATOR HOMES
DECOR CENTRE**

DATE: NOV 25 2015
INITIALS: JYI



CONNOR 17" OVAL UNDERMOUNT SINK

9130-91

4210CFY Undermount Sink ALL BATHROOMS

Product Specs:

- Vitreous china
- Front overflow hole
- Template and mounting hardware supplied

Overall Dimensions (W x D x H):

(OD): 430mm(17") x 355mm(14") x 190mm(7½")
(ID): 380mm(15") x 305mm(12") x 140mm(5½")

Compliance Certifications:

Meets or exceeds the following:

- IAPMO cUPC
- ASME A112.19.2 / CSA B45.1-2008

Shipping:

Cube 1.11
GW 16 lbs

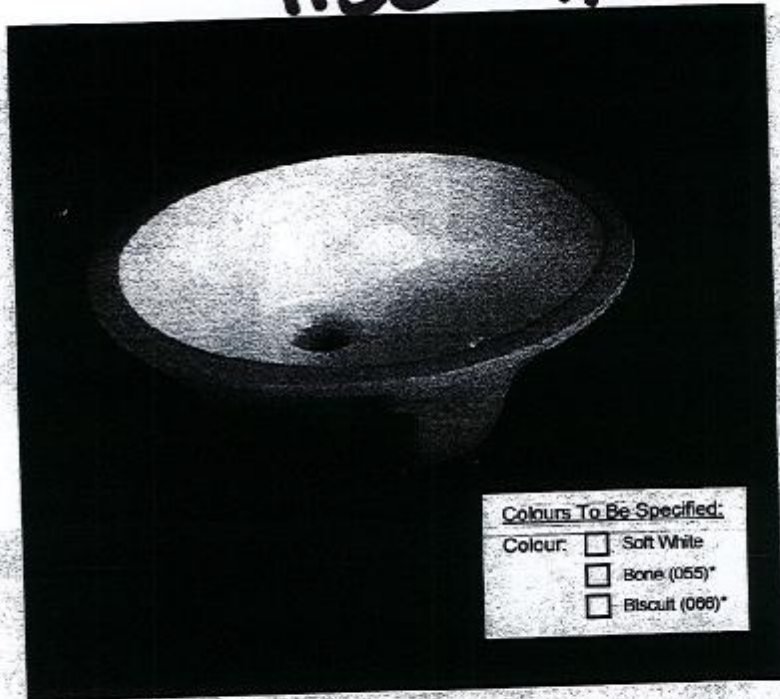

Colours To Be Specified:

- Colour: ☐ Soft White
☐ Bone (055)*
☐ Biscuit (066)*

Notes:

Dimensions of fixtures are nominal and may vary within the range of tolerances established by ASME standard A112.19.2. These measurements are subject to change or cancellation. No responsibility is assumed for use of superseded or voided pages.

*Bone and Biscuit available through Direct Import (DI) only.

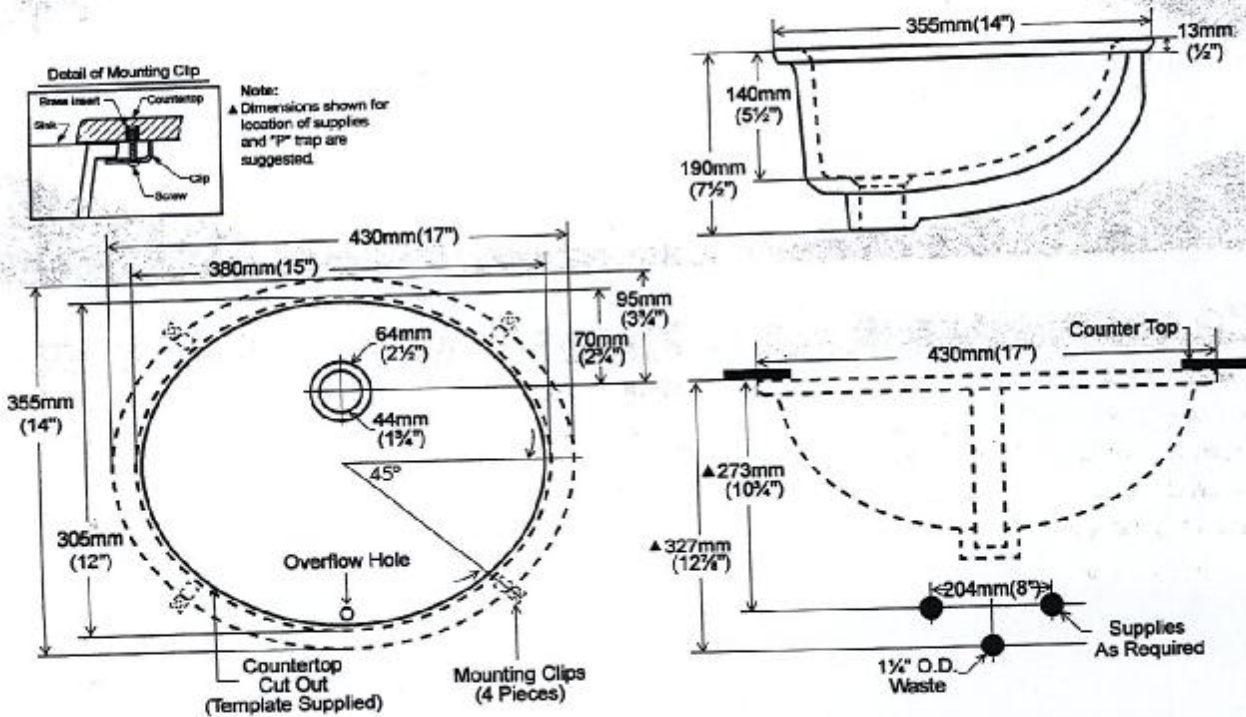

CONTRAC® 5970 Chedworth Way, Unit A, Mississauga, Ontario Canada L5R 3V5 • 1.888.256.7551
www.contrac.ca

Revised: January 2015

SENATOR HOMES
DECOR CENTRE

DATE: NOV 25 2015
INITIALS: [Signature]

9130-91

30" Single Wall Oven

800 Series - Stainless Steel HBL8451UC



Microwave oven Over Single Wall Oven



HBL8451UC
Stainless Steel

Also available in:
Black HBL8461UC

The Bosch wall oven
installs flush and features
a SmoothClose door.

Features & Benefits

Dampened hinges softly
and quietly guide the
SmoothClose door shut.

A full-extension telescopic
rack offers safe access to
the oven cavity.

Touch control with
SteelTouch™ buttons
makes operating the oven
easier.

The wall oven is designed
to be installed flush with
cabinetry.

Bosch wall ovens are
compatible with most
competitors' cutouts.

Genuine European
Convection even baking
results on multiple racks.

General Properties

Cooking Modes	Bake, Variable Broil (hi & low), Roast, Warm, Sabbath, Proof Dough, Convection Bake, Convection Broil, Convection Roast, Pizza, Multi Rack Genuine European Convection, Convection Conversion, Temperature Probe, Fast Preheat
---------------	--------------------------------------------------------------------------------------------------------------------------------------------------------------------------------------------------------------------------------------------------------------------------

Cleaning Type	Self Clean
Telescopic Rack	1
Illumination Type	Incandescent
Interior Lights	2

Oven Performance

Bake Element Wattages	2,400 W
Broil Element Wattages	3,800 W
Convection Element Wattages	2,000 W

Technical Details

Watts (W)	6,325 W
Circuit Breaker (A)	30 A
Volts (V)	240/208 V
Frequency (Hz)	60 Hz
Power Cord Length (in)	50"
Plug Type	Fixed Connection, No Plug
Energy Source	Electric

Dimensions & Weight

Overall Appliance Dimensions (HxWxD) (in)	29" x 29 3/4" x 23 1/2"
Required Cutout Size (HxWxD) (in)	27" - 28 5/8" x 28 1/2" x 23 1/2"
Net Weight (lbs)	149 lbs

Accessories-Included

Included	3 x Oven Racks, Temperature Probe
----------	--------------------------------------

Accessories-Optional



HEZTR301
30" Telescopic Rack

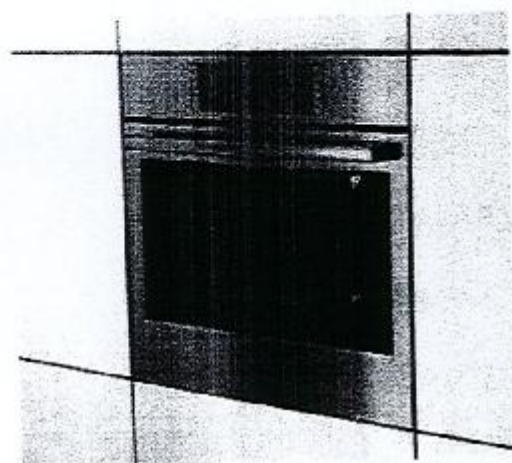

**SENATOR HOMES
DECOR CENTRE**

DATE: NOV 30 2015

INITIALS: JYH

For help and assistance with Bosch accessories please call 1-800-944-2904 Mon-Fri 8am to 6pm EST

Notes: All height, width and depth dimensions are shown in inches. Please refer to installation instructions prior to making cutout. BSH reserves the absolute and unrestricted right to change product materials and specifications, at any time, without notice. Consult the product's installation instructions for final dimensional data and other details. Applicable product warranty can be found in accompanying product literature or you may contact your account manager for further details.

Warranties: Bosch warrants that the Product is free from defects in materials and workmanship for a period of three hundred and sixty-five (365) days from the date of purchase. The foregoing timeline begins to run upon the date of purchase, and shall not be stalled, tolled, extended, or suspended, for any reason whatsoever. This Product is also warranted to be free from cosmetic defects in material and workmanship (such as scratches of stainless steel, paint/porcelain blemishes, chip, dents, or other damage to the finish of the Product) for a period of thirty (30) days from the date of purchase or closing date for new construction. This cosmetic warranty excludes slight colour variations due to inherent differences in painted and porcelain parts, as well as differences caused by kitchen lighting, product location, or other similar factors. This cosmetic warranty specifically excludes any display, floor, "As Is", or "B" stock appliances.

For more information on our entire line of products, go to www.bosch-home.ca or call 1-800-944-2904

© 2014 BSH Home Appliances Canada. All rights reserved. Bosch is a registered trademark of Robert Bosch GmbH.

9130-91

30" Single Wall Oven

800 Series - Stainless Steel HBL8451UC



Installation Details

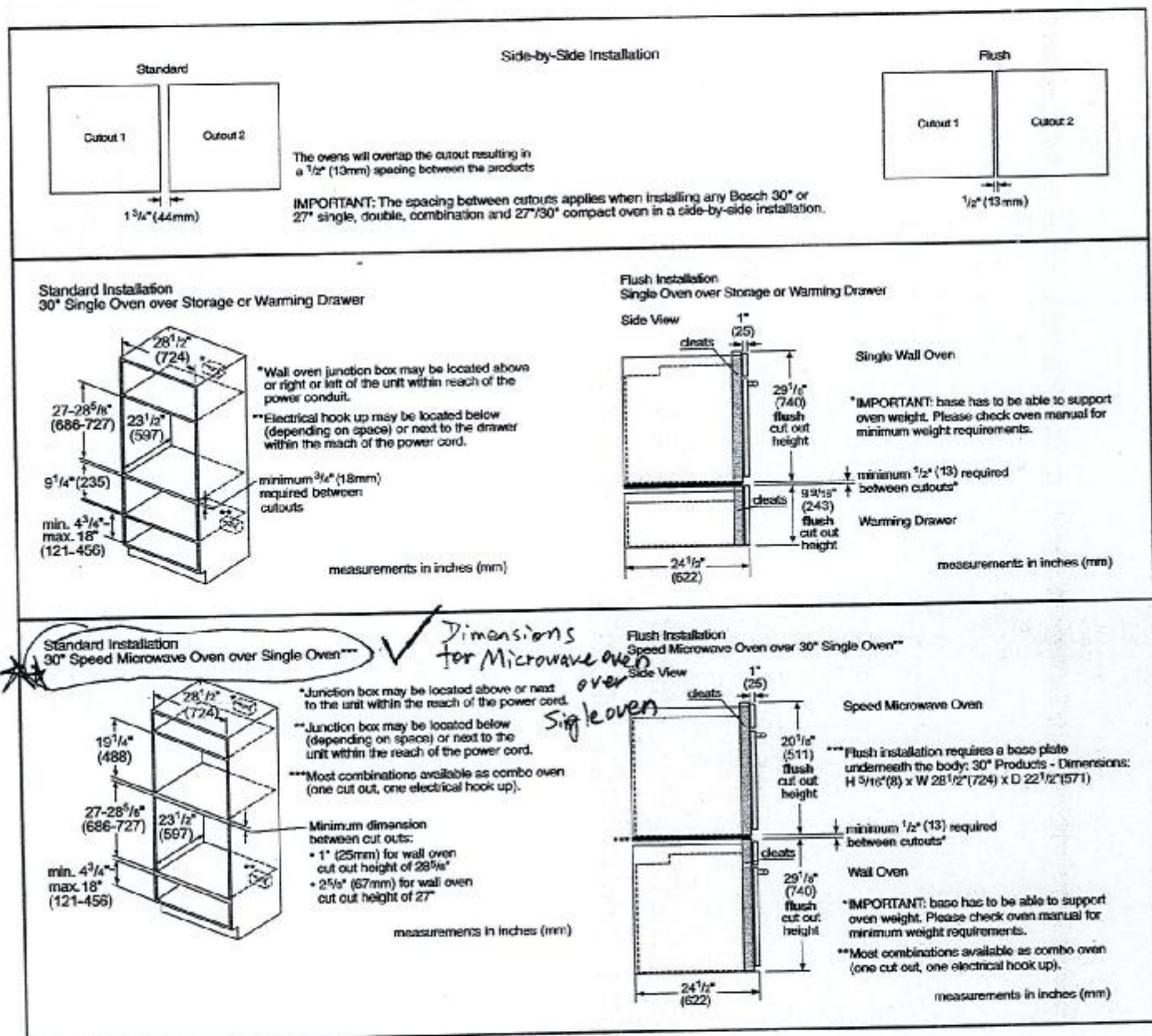

For help and assistance with Bosch accessories please call 1-800-944-2904 Mon-Fri 8am to 6pm EST

Notes: All height, width and depth dimensions are shown in inches. Please refer to installation instructions prior to making cutout. BSH reserves the absolute and unrestricted right to change product materials and specifications, at any time, without notice. Consult the product's installation instructions for final dimensional data and other details. Applicable product warranty can be found in accompanying product literature or you may contact your account manager for further details.

Warranties: Bosch warrants that the Product is free from defects in materials and workmanship for a period of three hundred and sixty-five (365) days from the date of purchase. The foregoing timeline begins to run upon the date of purchase, and shall not be stalled, tolled, extended, or suspended, for any reason whatsoever. This Product is also warranted to be free from cosmetic defects in material and workmanship (such as scratches of stainless steel, paint/porcelain blemishes, chip, dents, or other damage to the finish of the Product) for a period of thirty (30) days from the date of purchase or closing date for new construction. This cosmetic warranty excludes slight colour variations due to inherent differences in painted and porcelain parts, as well as differences caused by kitchen lighting, product location, or other similar factors. This cosmetic warranty specifically excludes any display, floor, or wall mounted appliances.

For more information on our entire line of products, go to www.bosch-home.ca or call 1-800-944-2904

© 2014 BSH Home Appliances Canada. All rights reserved. Bosch is a registered trademark of Robert Bosch GmbH.

DATE: NOV 30 2015
INITIALS: JYL

9130-91

30" Single Wall Oven

800 Series - Stainless Steel HBL8451UC



Installation Details

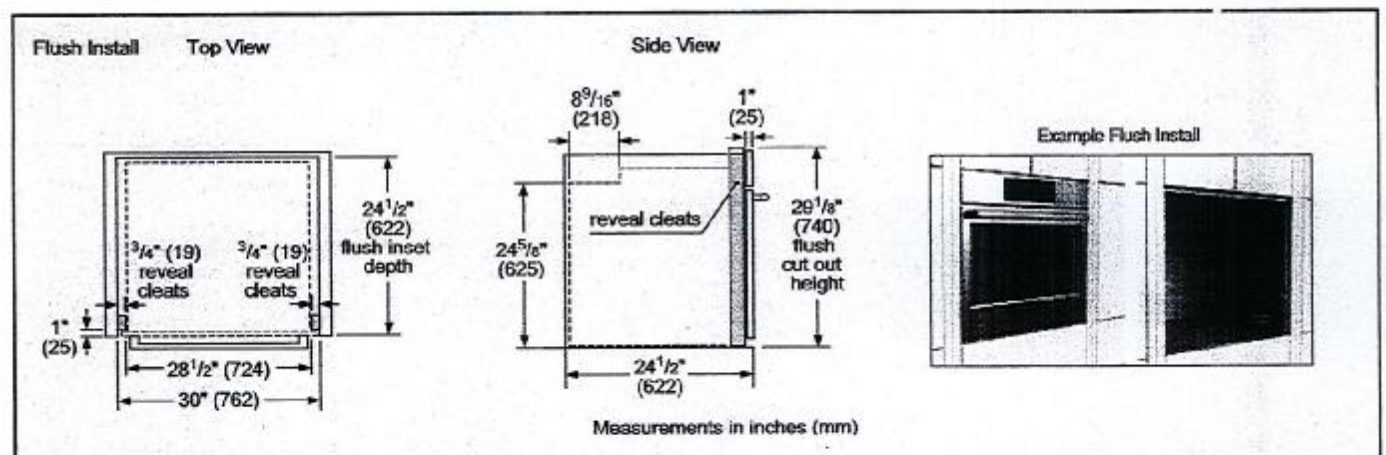
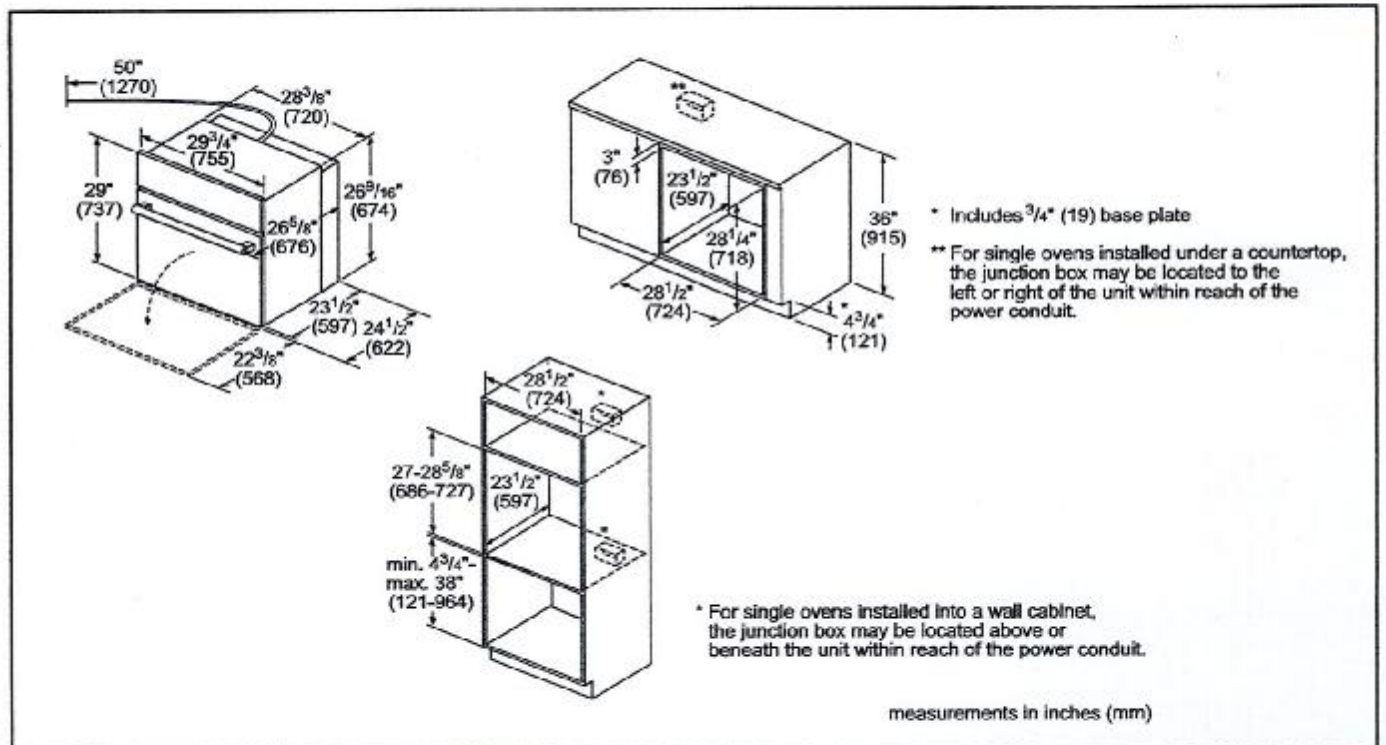

For help and assistance with Bosch accessories please call 1-800-944-2904 Mon-Fri 8am to 6pm EST

Notes: All height, width and depth dimensions are shown in inches. Please refer to installation instructions prior to making cutout. BSH reserves the absolute and unrestricted right to change product materials and specifications, at any time, without notice. Consult the product's installation instructions for final dimensional data and other details. Applicable product warranty can be found in accompanying product literature or you may contact your account manager for further details.

Warranties: Bosch warrants that the Product is free from defects in materials and workmanship for a period of three hundred and sixty-five (365) days from the date of purchase. The foregoing timeline begins to run upon the date of purchase, and shall not be stalled, tolled, extended, or suspended, for any reason whatsoever. This Product is also warranted to be free from cosmetic defects in material and workmanship (such as scratches of stainless steel, paint/porcelain blemishes, chip, dents, or other changes to the finish of the Product) for a period of thirty (30) days from the date of purchase or closing date for new construction. This cosmetic warranty excludes slight colour variations due to inherent differences in painting and porcelain parts, as well as differences caused by kitchen lighting, product location, or other similar factors. This cosmetic warranty specifically excludes any display floor, "As Is", or "B" stock appliances.

For more information on our entire line of products, go to www.bosch-home.ca or call 1-800-944-2904

© 2014 BSH Home Appliances Canada. All rights reserved. Bosch is a registered trademark of Robert Bosch GmbH.

DATE: NOV 30 2015
INITIALS: JYH