



CONSTRUCTION SUMMARY

Teefy Developments Limited / 9130 Bathurst

Lot/Unit: 38 Phase/Building: 1 Model/Floor Plan: Melrose(19-1)

CABINETRY ACCESSORIES

Inv.3198	1 - CABINETRY - KITCHEN - LIGHT VALANCE - NOT APPLICABLE FOR THERMOVISION	
Line 39827	Note:	
12Sep15 / 14Oct15		
Inv.3198	1 - CABINETRY - KITCHEN - CROWN MOULDING - MODEL TYPE: CRM4T	
Line 41164	Note:	
12Sep15 / 14Oct15		

CABINETRY APPLIANCE - FRIDGE

Inv.3198	1 - CABINETRY - FRIDGE - FRIDGE OPENING TO ACCOMMODATE UPGRADED FRIDGE AND TRIM KIT - PURCHASER HAS SUPPLIED SPECS	
Line 41400	Note:	
12Sep15 / 14Oct15		
Inv.3198	1 - CABINETRY - KITCHEN - 59 CM FRIDGE CABINET - 1 GABLE & CABINET 59 CM DEEP	
Line 41165	Note:	
12Sep15 / 14Oct15		

CABINETRY BASE CABINETS

Inv.3198	1 - CABINETRY - KITCHEN - RELOCATE THE STD BANK OF DRAWERS NEXT TO DISHWASHER	
Line 39831	Note:	
12Sep15 / 14Oct15		

CABINETRY HOOD FANS

Inv.3198	1 - ACCOMMODATE FOR CHIMNEY STYLE HOOD FAN - PURCHASER HAS SUPPLIED SPECS	
Line 41343	Note:	
12Sep15 / 14Oct15		

CABINETRY LAUNDRY

Inv.3198	1 - CABINETRY - LAUNDRY - STANDARD HEIGHT LAUNDRY UPPER - 61 CM HIGH - INSTALLED IN UNFINISHED LAUNDRY/MECHANICAL ROOM - ONE WALL TO BE DRY WALL AND BRACED FOR WALL HUNG CABINETS	
Line 39781	Note: The Vendor agrees to supply and install optiona upper cabinets in lower laundry at no charge from Vendors standard samples	
12Sep15 / 14Oct15		

CABINETRY VANITY

Inv.3198	1 - CABINETRY - MASTER ENSUITE - VANITY BANK OF DRAWERS - AS INDICATED ON SKETCH	
Line 39836	Note:	
12Sep15 / 14Oct15		

CARPET

Inv.3198	1 - CARPET UNDERPAD - RECREATION ROOM @ LOWER LEVEL - GREY GOOSE UNDERPAD	
Line 39795	Note:	
12Sep15 / 14Oct15		



CONSTRUCTION SUMMARY

Teefy Developments Limited / 9130 Bathurst

Lot/Unit: 38 Phase/Building: 1 Model/Floor Plan: Melrose(19-1)

COUNTER TOP

Inv.3198	1 - OUARTZ COUNTER TOP - KITCHEN WITH FLUSH BREAKFAST BAR - 3CM WITH STANDARD EDGE - GROUP 3	
Line 39807	Note:	
12Sep15 / 14Oct15		

ELECTRICAL

Inv.3198	1 - ELECTRICAL - KITCHEN - SUPPLY AND INSTALL LIGHT VALANCE ROUGH IN (INCLUDES 1 SWITCH)	
Line 39828	Note: LOCATION AS PER SKETCH ATTACHED.	
12Sep15 / 14Oct15		
Inv.3198	2 - ELECTRICAL - SUPPLY AND INSTALL ADDITIONAL CABLE OUTLET ROUGH-IN ONLY	
Line 39839	Note: IN BEDROOM 2 & BEDROOM 3	
12Sep15 / 14Oct15		
Inv.3198	1 - ELECTRICAL - SUPPLY AND INSTALL CAPPED CEILING LIGHT ROUGH-IN ONLY ON SEPARATE SINGLE SWITCH	
Line 39842	Note: AS INDICATED ABOVE THE BREAKFAST B.BAR ADDITONAL LIGHT PURCHASED	
12Sep15 / 14Oct15		
Inv.3198	1 - ELECTRICAL - SUPPLY AND INSTALL CAPPED CEILING LIGHT ROUGH-IN ONLY ON EXISTING SWITCH	
Line 39843	Note: ABOVE THE B.BAR ON EXISTING ADDITONAL LIGHT & SWITCHED PURCHASED	
12Sep15 / 14Oct15		

HARDWOOD

Inv.3198	1 - HARDWOOD - UPGRADE 1 - SATIN FINISH GEN. - HOME OAK 3 5/8 INCH X 3/4 INCH - STAINS - NF FINISH- BEDROOM 2	
Line 39808	Note: The Vendor agrees to supply and install hardwood flooring in all bedrooms, with a choice of stain, from Vendors standard samples	
12Sep15 / 14Oct15		
Inv.3198	1 - HARDWOOD - UPGRADE 1 - SATIN FINISH GEN. - HOME OAK 3 5/8 INCH X 3/4 INCH - STAINS - NF FINISH- BEDROOM 3	
Line 39809	Note: The Vendor agrees to supply and install hardwood flooring in all bedrooms, with a choice of stain, from Vendors standard samples	
12Sep15 / 14Oct15		
Inv.3198	1 - HARDWOOD - UPGRADE 1 - SATIN FINISH GEN. - HOME OAK 3 5/8 INCH X 3/4 INCH - STAINS - NF FINISH- MASTER BEDROOM	
Line 39810	Note: The Vendor agrees to supply and install hardwood flooring in all bedrooms, with a choice of stain, from Vendors standard samples	
12Sep15 / 14Oct15		

HEATING AND AIR CONDITIONING

Inv.3198	1 - EXTERIOR GAS LINE - ROUGH-IN ONLY - FIRST CONNECTION- BBQ	
Line 39780	Note: The Vendor agrees to supply and install gas line at deck locatio for future BBQ hookup at no charge	
12Sep15 / 14Oct15		
Inv.3198	1 - INTERIOR GAS LINE - ROUGH-IN ONLY - FOR STOVE TO INCLUDE 110V CODE REQUIREMENT	
Line 39779	Note: The Vendor agrees to supply and install gas line to stove in kitchen at no charge	
12Sep15 / 14Oct15		

MISCELLANEOUS



CONSTRUCTION SUMMARY

Teefy Developments Limited / 9130 Bathurst

Lot/Unit: 38 Phase/Building: 1 Model/Floor Plan: Melrose(19-1)

Inv.3198	1 - DO NOT INSTALL MIRRORS ***** PURCHASER IS AWARE THAT NONE WILL BE SUPPLIED AND NO CREDIT TO BE GIVEN	
Line 39835	Note:	
12Sep15 / 14Oct15		

PLUMBING

Inv.3198	1 - PLUMBING - KITCHEN - MOEN SOAP/LOTION DISPENSERS MODEL 3942SRS	
Line 39838	Note:	
12Sep15 / 14Oct15		

Inv.3198	1 - PLUMBING - SUPPLY AND INSTALL WATERLINE ROUGH-IN TO THE FRIDGE LOCATION (NO HOOK UP)	
Line 41163	Note:	
12Sep15 / 14Oct15		

TILE

Inv.3198	1 - WALL TILE - MASTER ENSUITE - UPGRADE 5	
Line 39826	Note:	
12Sep15 / 14Oct15		

Inv.3198	1 - FLOOR TILE - POWDER ROOM - UPGRADE 8	
Line 39784	Note:	
12Sep15 / 14Oct15		

Inv.3198	1 - FLOOR TILE - LOWER LEVEL MUD ROOM - UPGRADE 3	
Line 39802	Note:	
12Sep15 / 14Oct15		

Inv.3198	1 - FLOOR TILE - MAIN BATHROOM - UPGRADE 3	
Line 39803	Note:	
12Sep15 / 14Oct15		

Inv.3198	1 - FLOOR TILE - MASTER ENSUITE - UPGRADE 5	
Line 39806	Note:	
12Sep15 / 14Oct15		

TILE - WALL

Inv.3198	1 - FLOOR TILE - ENSUITE SHOWER FLOOR - UPGRADE 2	
Line 41334	Note:	
12Sep15 / 14Oct15		



CONSTRUCTION SUMMARY

Teefy Developments Limited / 9130 Bathurst

Lot/Unit: 38 Phase/Building: 1 Model/Floor Plan: Melrose(19-1)

EXTRAS AS PER OFFER

Stainless Steel Fridge, Stove and Dishwasher and front loading washer and dryer in white from Vendors standard samples, no cash value, not transferable. (Supplied only not installed) ** to - arrange delivery call: The Brick commercial sales division at <i>Worksheet</i> Note:	
Rogers Free Services Package includes 6 months of: home phone, TV and Internet Service. <i>Worksheet</i> Note:	
The Vendor agrees to supply and install hardwood flooring in all bedrooms, with a choice of stain, from Vendors standard samples. <i>Worksheet</i> Note:	
The Vendor agrees to supply and install a gas line to stove in kitchen at no charge. <i>Worksheet</i> Note:	
The Vendor agrees to supply and install a gas line at deck location for future BBQ hookup at no charge. <i>Worksheet</i> Note:	
The Vendor agrees to supply and install optional upper cabinets in lower level laundry at no charge from Vendors standard samples. <i>Worksheet</i> Note:	



INTERIOR COLOUR SCHEME

Purchasers: Barry I Altro & Carol L Altro

Property: 38 of Plan -

Telephone Res. / Bus: (647) 274-5441 /

Project: Teefy Developments Limited

Decor Advisor: Nicole Soares

Model and Elevation: Melrose(19-1)

Layout Changes: ☒ Yes ☐ NoSketch Attached: ☒ Yes ☐ NoExterior Colour Scheme:

1. Cabinetry

	Style and Colour	Counter Top	Hardware
Kitchen / Breakfast	BOSTON PAINT: WINTER WHITE	4600 ORGANIC WHT- SQ EDGE	12801
Kitchen Island	BOSTON PAINT: WINTER WHITE	4600 ORGANIC WHT- SQ EDGE	12801
Laundry Room	SIMCOE: ONTARIO WHITE	N/A	9677
Powder Room	MANCHESTER MAPLE: OYSTER	WHITE CARRARA 4924-38	9671
Main Bathroom	OTTAWA MAPLE: SOAPSTONE	CALCUTTA MARBLE 4925K-07	9671
Master Ensuite Bathroom	LANCASTER MAPLE: ESPRESSO	WHITE CARRARA 4924-38	9671
Second Ensuite Bathroom (If Applicable)			

Appliances

Custom Size Fridge

☒ Yes ☐ No

Valance Lighting

☒ Yes ☐ No

Microwave / Range Hood

☐ Yes ☒ No

Cooktop / Rangetop

☐ Yes ☒ No

Built in Wall Oven

☐ Yes ☒ No

Slide-in Range

☐ Yes ☒ No

Comment

2. Flooring

Selection

Foyer	VEINS POLISHED 12x24: CALACATTA *** INSTALLED IN A STACKED PATTERN
Main Hall	SATIN FINISH GEN. HOME RED OAK 3 5/8" x 3/4" NF: COBALT
Back Hall	
Breakfast	SATIN FINISH GEN. HOME RED OAK 3 5/8" x 3/4" NF: COBALT
Laundry Room	
Kitchen	SATIN FINISH GEN. HOME RED OAK 3 5/8" x 3/4" NF: COBALT
Powder Room	CLASSIC DESIGN 12 x 24: ZEBRINO (BIANCO/GREY) *** INSTALLED IN A STACKED PATTERN
Main Bathroom	PALMA 12 x 24: WHITE
Master Ensuite	CALACATTA VINTAGE - HONED 12 x 24: WHITE
Bathroom (If Applicable)	
Mud Room	LOWER LEVEL: PALMA 12 x 24: NEW MOCHA
Living Room	FORMAL ROOM- SATIN FINISH GEN. HOME RED OAK 3 5/8" x 3/4" NF: COBALT
Dining Room	
Family / Great Room	SATIN FINISH GEN. HOME RED OAK 3 5/8" x 3/4" NF: COBALT
Den / Library / Study	
Basement Landing (If Applies)	
Lower Landing (If Applicable)	
Upper Landing	
Upper Hall	SATIN FINISH GEN. HOME RED OAK 3 5/8" x 3/4" NF: COBALT
Master Bedroom	SATIN FINISH GEN. HOME RED OAK 3 5/8" x 3/4" NF: COBALT
Bedroom #2	SATIN FINISH GEN. HOME RED OAK 3 5/8" x 3/4" NF: COBALT
Bedroom #3	SATIN FINISH GEN. HOME RED OAK 3 5/8" x 3/4" NF: COBALT
Bedroom #4	
Bedroom #5	
Recreation Room	PAPILIO: SOFT CAMEO 17185

Flooring Continued on Page 2

Initial: 

Page 1 of 3



INTERIOR COLOUR SCHEME

Purchasers: Barry I Altro & Carol L Altro

Property: 38 of Plan -

Telephone Res. / Bus: (647) 274-5441 /

Project: Teefty Developments Limited

Decor Advisor: Nicole Soares

Model and Elevation: Melrose(19-1)

2. Flooring - Continued -

Upgrade Underpad	Type	Area
	GREY GOOSE	RECREATION ROOM
Carpet on Stairs	Capped	Runner - *Upgrade
Comment		

3. Plumbing Fixtures / Faucets

Kitchen	STD	Second Ensuite		Powder Room	STD
Master Ensuite	STD			Other Room	
Main Bathroom	STD				
Comment					

4. Wall Tile

	Tile Selection	Listello	Insert	Insert Selection
Main Bathroom	WEAVE 8x10: TENDER GREY	<input type="checkbox"/>	<input type="checkbox"/>	
Master Ensuite				
Tub Deck		<input type="checkbox"/>	<input type="checkbox"/>	
Tub Apron		<input type="checkbox"/>	<input type="checkbox"/>	
Tub Surround		<input type="checkbox"/>	<input type="checkbox"/>	
Shower Stall	CALACATTA VINTAGE - HONED 12 x 24: WHITE	<input type="checkbox"/>	<input type="checkbox"/>	
Second Ensuite		<input type="checkbox"/>	<input type="checkbox"/>	
Ensuite Shower Floor	ONTARIO 2 x 2 MOSAIC: SNOW WHITE	<input type="checkbox"/>	<input type="checkbox"/>	
		<input type="checkbox"/>	<input type="checkbox"/>	
Kitchen Backsplash		<input type="checkbox"/>	<input type="checkbox"/>	
Complete Backsplash		<input type="checkbox"/>	<input type="checkbox"/>	
Comment				

5. Fireplace

	Living Room			Family Room			Other Room - Specify Great Room		
	Purchased	As Per Plan	N/A	Purchased	As Per Plan	N/A	Purchased	As Per Plan	N/A
Fireplace Type	<input type="radio"/>	<input type="radio"/>	<input type="radio"/>	<input type="radio"/>	<input type="radio"/>	<input type="radio"/>	<input type="radio"/>	<input checked="" type="radio"/>	<input type="radio"/>
Mantle Type							STD ELECTRIC 50" LINEAR		
Over Mantle									
Colour / Stain									
Surround							STANDARD		
Hearth									
Comment									

Initial:



INTERIOR COLOUR SCHEME

Purchasers: Barry I Altro & Carol L Altro

Property: 38 of Plan -

Telephone Res. / Bus: (647) 274-5441 /

Project: Teefy Developments Limited

Decor Advisor: Nicole Soares

Model and Elevation: Melrose(19-1)

6. Trim Carpentry

Door Hardware: STANDARD LEVER

Interior Trim: STANDARD BASEBOARD & CASINGS

Comment

Interior Doors

☐ 2 Panel Arch Top

☒ 2 Panel Square Top

☐ 6 Panel

Initial for Door Style



7. Railings and Pickets

Railing Package: STANDARD PLAIN BLACK METAL PICKETS SQUARE POST & HANDRAIL

Railing Colour: STAINED TO MATCH

Picket Colour: BLACK METAL PICKETS

Wood Stairs: ☐ No ☒ Oak

Tread Colour: STAINED TO MATCH

Comment

STAINED TO MATCH SATIN FINISH GEN. HOME RED OAK 3 5/8" x 3/4" NF: COBALT AS MUCH AS POSSIBLE *** PURCHASER IS AWARE

8. Plaster Mouldings and Medallions

Foyer

Main Hall

Living Room

Dining Room

Family Room

Kitchen/Breakfast

Den/Library

Lower Landing

Comment

9. Wall Paint

SENATOR WHITE

Smooth Ceilings ☐ First Floor
☐ First Floor incl. Second Floor Hall
☐ First and Second Floor
☒ Throughout
☐ Not Applicable

Trim Paint: SENATOR WHITE

10. Additional Comments

11. Disclaimers and Notes

- 1) Colours of all materials are as close as possible to builder's selection, but not necessarily identical due to variances in manufacturing.
- 2) Any extras listed above are null and void unless accompanied by a separate invoice/amendment. Said invoice must be paid in full.
- 3) The Purchaser acknowledges that after Interior Colour Selection form is signed and dated, no further changes will be permitted other than re-selection due to unavailability. *ok* Purchaser's Initials
- 4) The Purchaser acknowledges reading and accepting the "Senator Homes Décor Centre Disclaimers" form. This document contains other miscellaneous disclaimers.

This Interior Colour Selection is final and approved by:

Purchaser:

Signature: *Barry I Altro*

Date: *Oct 14 / 15*

Signature: *Carol L Altro*

Date: *Oct 14 / 15*

Vendor:

[Signature]
Teefy Developments Limited

Nov 27 / 15

1765 SQ.FT.

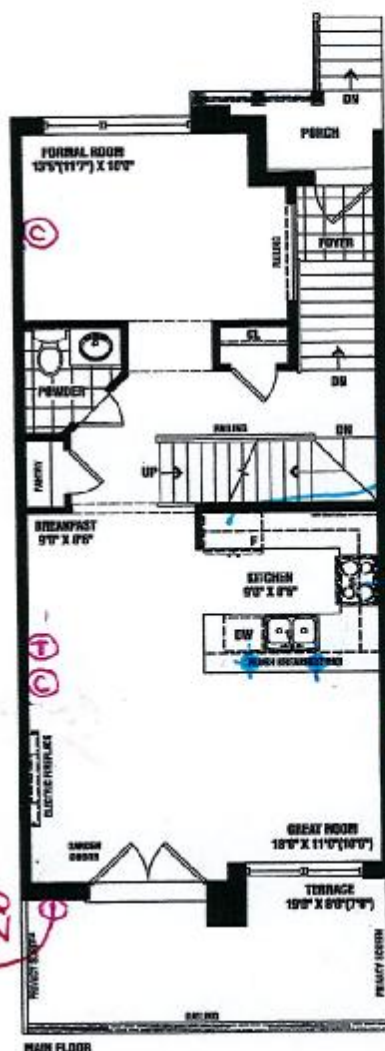

• CAPPED
CEILING ROUGH-IN
(x2) ON 1 SWITCH

GAS BBQ
Rough-IN



☐ T - TELEPHONE
☐ C - CABLE
☐ D - RADIO

SENATOR HOMES
DECOR CENTRE

DATE: OCT 14 2015

INITIALS: Q E

SENATOR
HOMES

Flenderings are artist's concept. Some elevations may vary from that shown. Actual useable square footage may vary from that stated herein. Some floorplans and elevations are mirror image to that shown. E.&O.E. 19-1

per Ct.

9130-38

MELROSE - TH-19-1

STD. LAYOUT

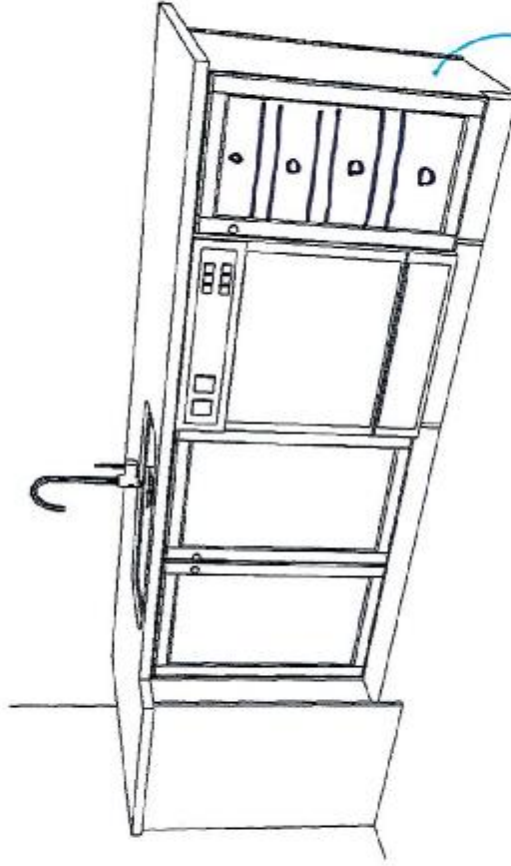

RELOCATE STD.
BANK OF DRAWERS
NEXT TO DISHWASHER

*Crown mouldings.
*Light valance

DELETE CABINETS
ABOVE THE STOVE
TO ACCOMMODATE FOR
CHIMNEY
STYLE
HOOD/FAN

SENATOR HOMES - TEEFY

DEEP FRIDGE
UPPERS WITH
ONE CABINET.

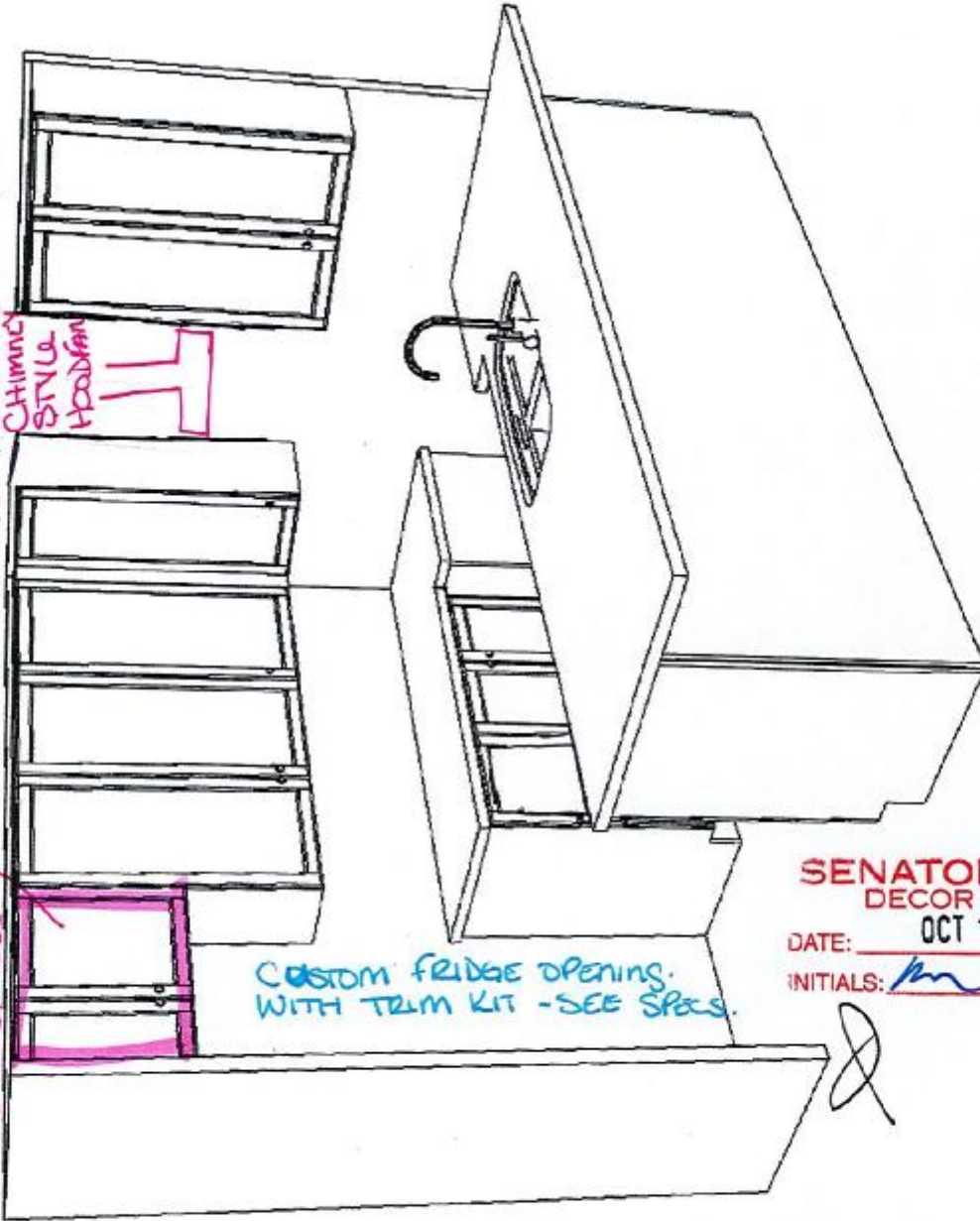

CUSTOM FRIDGE OPENING.
WITH TRIM KIT - SEE SPECS.

SENATOR HOMES
DECOR CENTRE

DATE: OCT 14 2015

INITIALS: *km* *EX*

MELROSE - TH-19-1

STD. LAYOUT

SENATOR HOMES - TEEFY

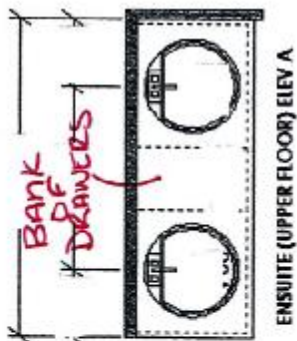
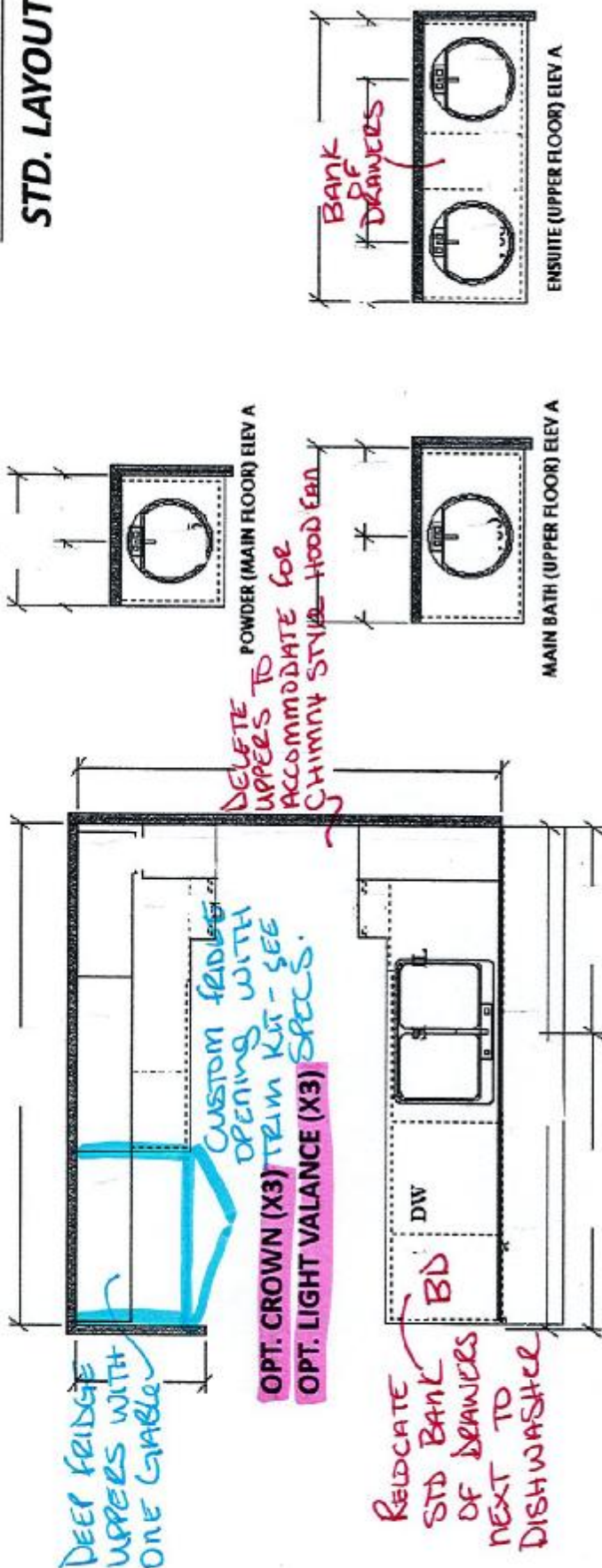

OPTIONAL CABINETS

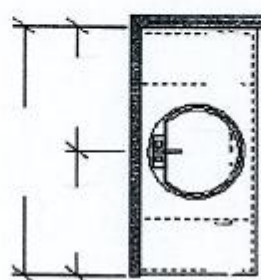

OPT. LAUNDRY UPPEERS (LOWER FLOOR) ELEV A
(BASE CABINETS NOT REFLECTED ON DWG'S)

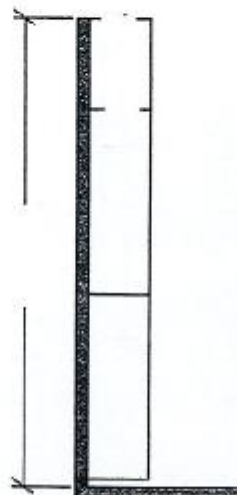

SENATOR HOMES
DECOR CENTRE

DATE:

OCT 14 2015

INITIALS:

Handwritten initials and signature.

9130-38

TEEFY VANITIES

TYPICAL VANITY LAYOUTS

SENATOR HOMES - TEEFY

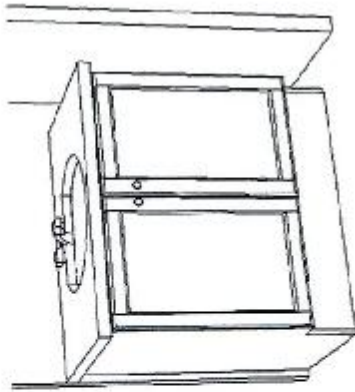

TYPICAL VANITY - 100 CM & UNDER

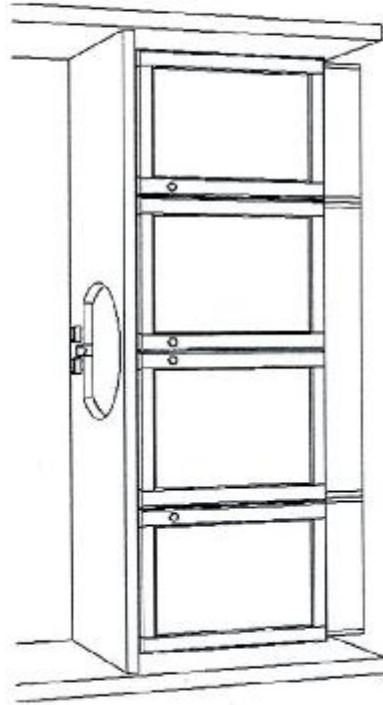

TYPICAL VANITY - 110 CM & OVER

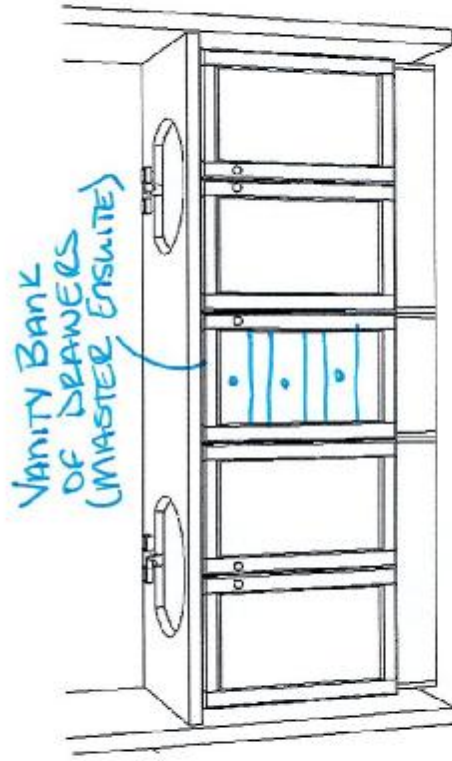

TYPICAL DOUBLE SINK VANITY - 145 CM & OVER

SENATOR HOMES
DECOR CENTRE

DATE: OCT 14 2015
INITIALS: [Signature]

French Door Refrigerator

PROFESSIONAL SERIES - MODEL NUMBER : E23BC68JPS - (35-5/8" W X 29-1/2" D X 69-1/2" H)



Features

CUSTOM TEMP DRAWER™

Enjoy the ultimate in versatility with 9 preset selections including White/Sparkling Wine, Fish/Shellfish, Cheese plus three customizable settings that ensure foods stay at the ideal temperature for serving and maintaining freshness.

THEATRE LIGHTING

Transition LED lighting gradually illuminates the interior with soft but ample light as you open the door.

PUREADVANTAGE® FILTRATION SYSTEMS

Our filtration system keeps clean, filtered air circulated throughout to prevent odour transfer and keeps fresh, clean water and ice at your fingertips.

SMOOTH-GLIDE® CRISPER DRAWERS

Crisper Drawers smoothly glide out and keep even the most delicate fruits and vegetables fresh with adjustable humidity control and minimal temperature variation.

Specifications & Guides

Product Code	E23BC68JPS
Base Model	E23BC68JP
Product Type	French Door
Power Type	Electric
Size	23 Cu. Ft.
Installation Type	Free-Standing
UPC Code	0-12505-69615-6
Colour	Stainless Steel
Colour Code	S

CAPACITIES

Freezer Capacity (Cu. Ft.)	6.90
Freezer Shelf Area (Sq. Ft.)	6.90
Fresh-food Capacity (Cu. Ft.)	15.70
Fresh Food Shelf Area (Sq. Ft.)	20.3
Capacity (Cu. Ft.)	22.6
Total Shelf Area (Sq. Ft.)	27.2

CERTIFICATIONS & APPROVALS

CSA Certified	Yes
ENERGY STAR® Certified	Yes
Sabbath Mode (Star-K® Certified)	Yes

FRESH FOOD

Air Filter Location	Left Fresh Food Door
Air Filter	PureAdvantage®
Door Ajar Alert	Yes
Temperature Alert	Yes
Power Failure Alarm	Yes
Crispers	2, Smooth-Glide®

SENATOR HOMES
DECOR CENTRE

DATE:

OCT 14 2015

INITIALS:

[Handwritten signature]

9130-38

Dairy Compartment	1, Clear (Right Door)
1-Gallon Removable Door Bins	2 Adjustable Clear Gallon Bins (1 per door)
Half-Gallon Door Bins	3, Clear (1 Right Door, 2 Left Door)
Tilt-Out Door Bins	2, Clear (1 per door)
Meat / Deli Drawer	Custom Temp Drawer™
Drawer Trims	Yes
Drawer Trim Colour	White & Silver
Energy Saver Plus	Yes
Humidity Controls	2
Lighting Levels	Dual-Level
Luxury-Design® Ramp-Up Multilevel Lighting	Theatre Ramp-Up LED
Cantilever Shelves	Yes
Custom-Design™ Shelves	4, Fixed
Water Filter Location	Bottom/Left Fresh Food Section
Water Filter	PureAdvantage®
CONTROLS	
Console Control Location	Left Door Edge
Controls	Custom-Set™ Electronic
GENERAL SPECIFICATIONS	
Condenser Type	Dynamic
Water Inlet Location	Left Bottom Rear
Sound Package	Luxury-Quiet™
Shipping Weight (lbs)	348
FREEZER SPECIFICATIONS	
Lower Adjustable Basket Dividers	Yes
Middle Adjustable Basket Dividers	Yes
Upper Adjustable Basket Dividers	Yes
Lower Basket Construction	Wire, grey powder-coated
Middle Basket Construction	Wire, grey powder-coated
Upper Basket Construction	Wire, grey powder-coated
Lower Basket Design	Smooth-Glide®, Full-Width
Middle Basket Design	Smooth-Glide®, Full-Width

SENATOR HOME
DECOR CENTRE

DATE: OCT 14 2015

INITIALS: 

9130-38

Upper Basket Design

Smooth-Glide®, 1/2-Width

ICE MAKER

Ice Maker Bucket	Yes
Ice Maker Location	Freezer
Ice Maker	Yes
Ice Maker On/Off	Yes
Ice Maker Type	Side-Mounted

DISPENSER

Air Filter Indicator/Reset	Yes
Supplemental Freeze	Fast Freeze™
Supplemental Ice	Fast Ice™
System On/Off Control	Yes
Water Filter Indicator / Reset	Yes

EXTERIOR DIMENSIONS

Cabinet Depth	23-5/8"
Depth (with 90° Door Open)	44-1/2"
Cabinet Depth (including Door)	26-7/8"
Cabinet Depth (including Handle)	35-5/8"
Height	69-1/2"
Cabinet Height	68-3/16"
Cabinet Height (including Hinge Covers)	69-1/2"
Width	35-5/8"
Cabinet Width	35-5/8"

EXTERIOR SPECIFICATIONS

Cabinet Colour	Stainless-Look
Cabinet Finish	Smooth
Door Closers	Yes
Door Design	Tall
Door Finish	Stainless Steel
Door Gasket	White
Door and Handle Design	Professional Stainless Steel
Door Hinge Covers	Hidden

SENATOR HOMES
DECOR CENTRE

DATE: OCT 14 2015

INITIALS: [Signature]

9130-38

Louvered Trim Kit
(4480)

Planning Information

For new-build installation when installed with Counter-Depth Side-by-Side Refrigerator models E23CS78HPS and E23CS78HSS

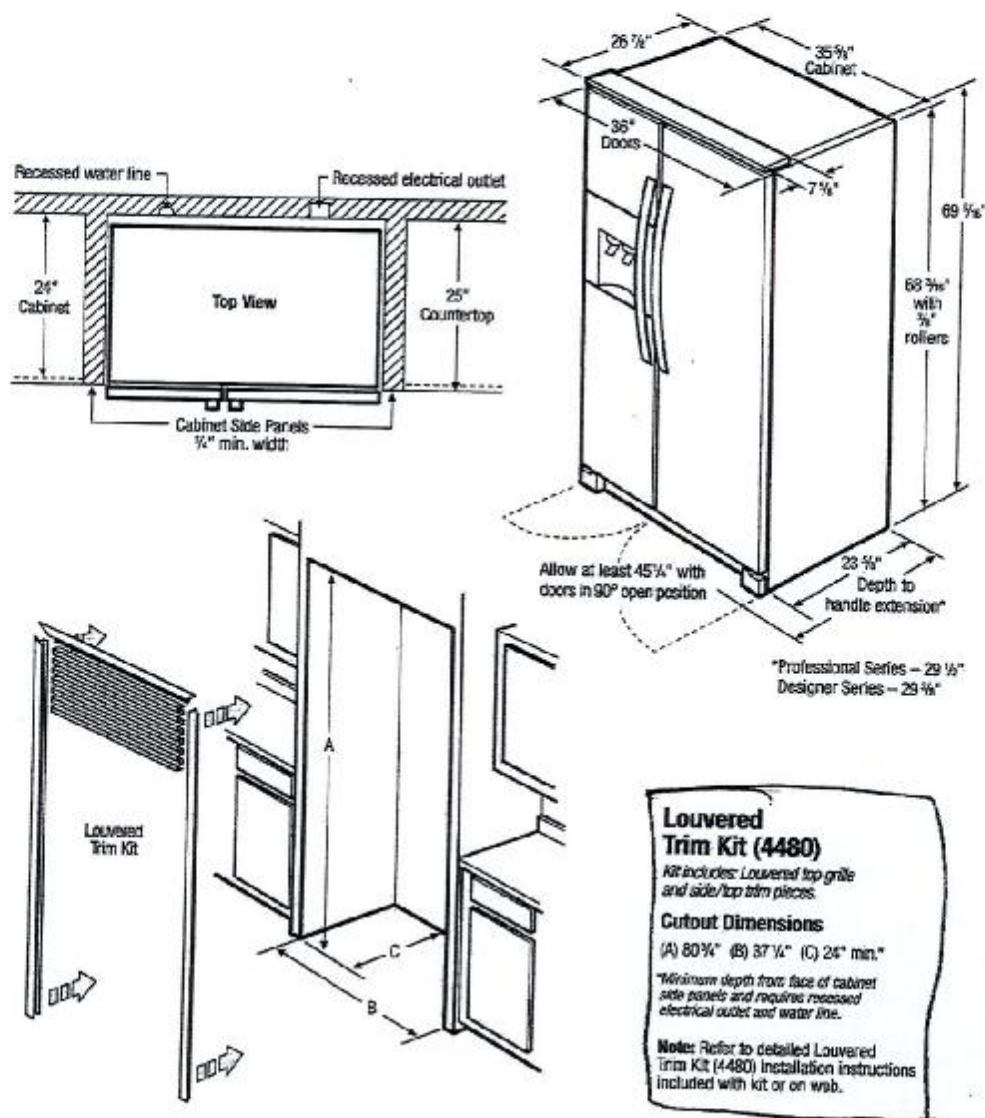

Installation Specifications

- **New-Build Installation** - Louvered Trim Kit (PN # 4480) is designed for built-in installation with Counter-Depth Side-by-Side Refrigerator models E23CS78HPS and E23CS78HSS.
- To use Louvered Trim Kit (PN # 4480), an enclosure is required around Counter-Depth Side-by-Side Refrigerator having an opening of 80-3/4" H x 37-1/4" W with minimum cabinet side panels of 24" D x 3/4" W.
- Minimum 24" depth requires recessed electrical outlet and water line.
- Cabinet or soffit above unit must extend out to same depth as side panels.
- Minimum 7" x 7" clear floor space required for Trim Kit assembly.

- For detailed Trim Kit installation, refer to instructions packed with kit or on web.
- For detailed Counter-Depth Side-by-Side Refrigerator installation, refer to model-specific product page and installation guide on web.

* Louvered Trim Kit (PN # 4480) can also be used with Counter-Depth Side-by-Side Refrigerator models E23CS75DSS, E23CS78EPS, E23CS78E3G, E23CS78GPG and E23CS78GSS.

Note: For planning purposes only. Refer to product information on the web at electrolux.com for detailed installation instructions. Specifications subject to change.

SENATOR HOMES
DECOR CENTRE

DATE: OCT 14 2015

INITIALS:

9130-38

Synthesis Wall Range Hood

A value alternative in canopy wall hoods

FABER

ON AIR SINCE 1955

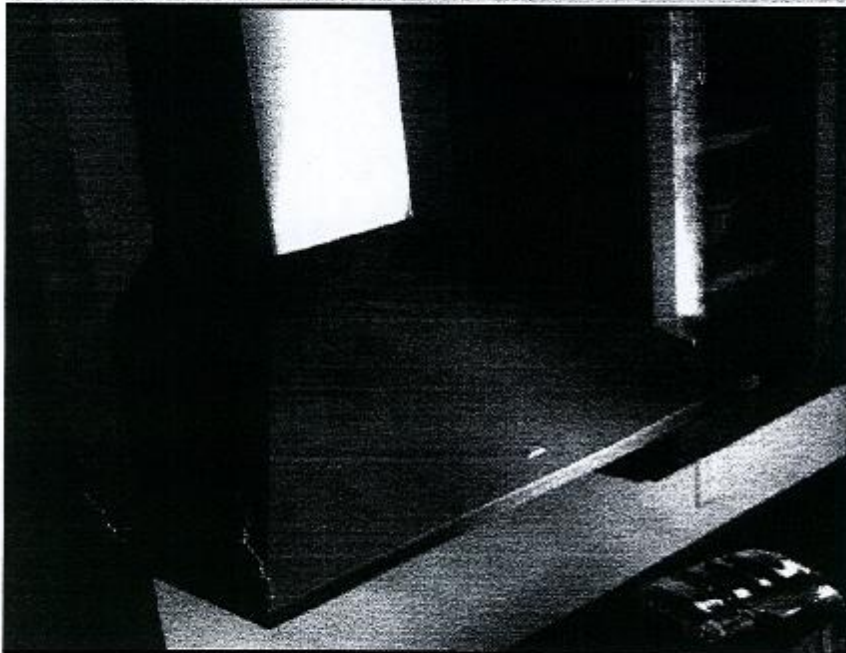

Backlit electronic controls with a blue LED light to indicate the current speed and lighting on/off

Designed to offer a high-end look without the high-end price tag, the Synthesis offers a chimney style range hood for the price conscious customer. Traditional styling, designer features, and solid performance make the Synthesis a great value in canopy range hoods.

Model #	Size Color	Performance Range	Sound Levels
SYNT30SS	30 Stainless	160 - 600 CFM	3.5 - 6.5 sones
SYNT36SS	36 Stainless	160 - 600 CFM	3.5 - 6.5 sones
SYNT30SS300	30 Stainless	80 - 300 CFM	2.0 - 5.0 sones
SYNT36SS300	36 Stainless	80 - 300 CFM	2.0 - 5.0 sones

**Feature Chart**

Min. / Max. Ceiling Height	7' 8 1/2" - 9' 5 7/8"
Canopy Depth / Height	19 1/4" D / 9 1/2" H
High Ceiling Kit	Yes - up to 11' 4 1/2"
Convertible to Ductless / Recirculating	Yes - kit needed
Controls	3 Speed Push w/ Blue LED
Lighting	2 X 20 (W) Halogen
Ducting Top	6" Round
Grease Filters	dishwasher safe mesh
10 Minute Intensive Speed	Yes
AC Input / AC Power (600/300 cfm)	(120 V - 60 hz) / (Max 370 / 190 W at 3.1 / 1.6 A)
Annual Electricity Costs (600/300 cfm)	\$6.17 / \$3.29 Year *

* Note -- ran 30 minutes a day on low speed, 365 days, using the North American average of 12.2 cents per kWh.

p.o. box 435 • Wayland, MA 01778 • tel: (508) 358-5353 • fax: (508) 358-5730 • e-mail: info@faberonline.com • www.faberonline.com

SENATOR HOMES
DECOR CENTRE

DATE:

OCT 14 2015

INITIALS:

[Handwritten signature]

9130-38

Dimensional Diagrams

(see installation instructions for more information)

Ducted

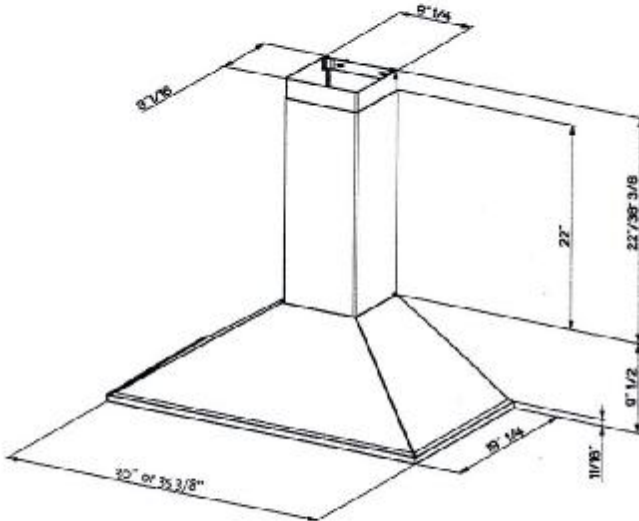

Ductless

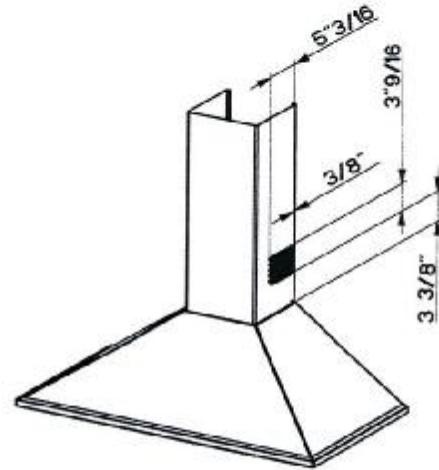

min & max ceiling height examples
x = range hood height above cook top

x = 24"	x = 30"
<u>min</u>	<u>min</u>
7' 8 1/2"	8' 2 1/2"
<u>max</u>	<u>max</u>
8' 11 7/8"	9' 5 7/8"

For shorter ceilings, have the chimney cover(s) cut at a sheet metal shop. For higher ceiling installations, the High Ceiling Chimney Kit includes a new 39" upper chimney which would replace the 16 3/8" upper chimney that came with the hood.

ACCESSORIES

High Ceiling Chimney Kit # HIGHSYNT

One 39" upper chimney to replace 16 3/8" upper chimney that came with the hood.



Replacement Charcoal Filter # FILTER1

For ductless installations, high quality, heavy duty filters ensure the removal of smoke and odors from the kitchen.



Ductless Conversion Kit # DUCTSYNT

Includes: • Lower Chimney with holes for ducting • Ductless Diverter • Vent Grates • Two Charcoal Filters

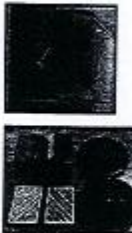

WARNING! Product specifications are subject to change without notification. Consult the installation instructions before you begin installing this rangehood.

Rev. 11/12

SENATOR HOMES
DECOR CENTRE

OCT 14 2015

DATE:

INITIALS:

[Handwritten signature]

9130-38



Professional Series
30" Dual-Fuel Standard-depth Range
PRD304GHC - Porcelain Rangetop



PRD304GHC Stainless steel

Design

- Bold Professional design
- Truly Flush Mounted™, 24" standard cabinet depth
- Patented Pedestal Star® Burner with QuickClean Base®
- Restaurant style metal knobs
- Professional style, continuous cast iron grates
- Continuous porcelain, easy to clean cooking surface

Performance

- Exclusive, patented Star® Burner – most even heating, unsurpassed flame coverage
- Every burner 18,000 BTU (NG)
- Precision simmering capabilities as low as 100°F (375 BTU) with 2 ExtraLow® Simmer burners
- Widest range of simmer options from 375 BTU to 3,000 BTU
- Powerful, 8-pass bake and broil elements
- Third Element Convection offers precise airflow for cooking on multiple levels without flavor transfer
- Superfast 2-hour self-clean mode – fastest in the industry

Capacity

- Massive oven capacity of 4.4 cu.ft.
- Six rack levels for multiple item cooking

Convenience

- Star® design delivers superior heat spread for any size pan
- Simmer without stirring/scorching with exclusive ExtraLow®
- QuickClean Base® designed for easy surface cleaning
- Electronic oven control ensures precise heating
- Signature blue indicator lighting
- Large oven door window for maximum viewing
- Powerful halogen lighting illuminates the oven cavity
- Sabbath mode
- 30" units ship standard with island trim included
- One Full Access® telescopic rack and two standard racks, all with integrated easy-grip handle

Optional accessories

PA12CHPBLK 12" Professional Chopping Block Acc
PAGRIDDLE Professional Griddle Accessory

825225881209

SENATOR HOMES
DECOR CENTRE

OCT 14 2015

DATE:

INITIALS:

[Handwritten signature]

INITIALS:

9130-38

Thermador ★
REAL INNOVATIONS FOR REAL COOKS®



DWHD640JFP Stainless steel

- Professional Handle and Fully Flush Stainless Steel Panel
- Topaz 24"
- 6 Programs and 4 options
- DWHD640JFP

Quality

- Blue PowerBeam® operating indicator lets you know when the unit is running
- Dosage Assist optimizes break down of detergent tablets

Performance

- Crystal Protection™ System ensures perfect results for fine crystal
- PowerBoost® option increases temperature and pressure in the lower rack for the ultimate in heavy-duty cleaning
- Sens-A-Wash® ensures superior washing and drying guaranteed
- Extra Dry option ensures perfectly dry dishes
- Hand Wash allows you to delicately wash fine items and wine glasses
- Powerfully Quiet® - 44 dBA for peaceful kitchen experience
- ENERGY STAR® Qualified - uses only 279kWh/Yr
- Extra-Tall-Item™ Sprinkler allows large items (22" high) to be washed

Design

- Professional Handle
- Stainless Steel Control Panel
- Chef's Tool Drawer® delivers added loading capacity for a range of small and large utensils
- Sleek charcoal-grey racks with height-adjustment ability for added flexibility
- Blue LED Display
- 18/10 high-grade stainless steel interior offers long-lasting reliability, never rusts and resists nicks and chips
- Silver Painted Toe Kick
- Accommodates 15 plate settings for your dinner parties

Optional accessories

- SGZ1010UC Drain hose extension kit
- SGZ9091UC finish salt for dishwashers
- SMZ5000 Dishwashing aid set

825225900238

SENATOR HOMES
DECOR CENTRE

DATE: _____

INITIALS: _____

OCT 14 2015

[Handwritten initials]

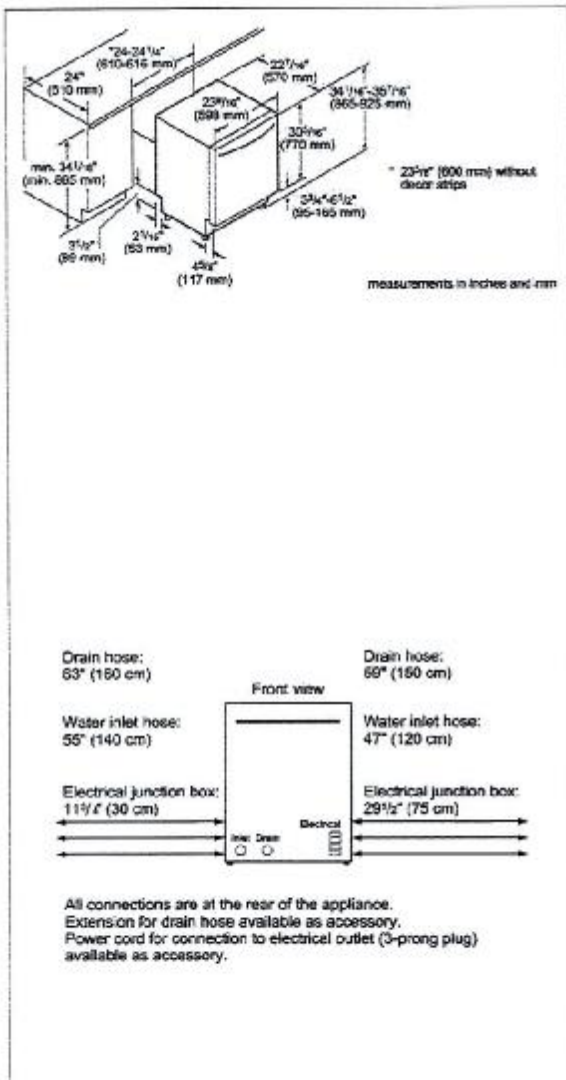

Product Features

Upper Rack: mid
Adjustable upper rack: Rackmatic 3-stage
Upper rack cup shelf: 2
Lower Rack: mid
3rd Rack: 3rd Rack 1.0
Silverware Basket: Standard
Accessories Parts: baking-sheet spray head grey
Optional accessories: SGZ1010UC, SGZ9091UC, SMZ5000

Consumption and connection features

UPC code: 825225900238
 Variant color: Stainless steel
 Panel ready: No
 Alternative colors available:
 Silence level (dBA): 44
 Watts (W): 1300
 Current (A): 12
 Volts (V): 120
 Frequency (Hz): 60
 Energy Consumption (kWh/yr): 279
 Energy Star® qualified: Yes
 Plug type: 120V-3 prong
 Required cutout size (HxWxD) (in): 34 1/8" x 24" x 24"
 Required cutout size (HxWxD) (mm): 865-925 x 610 x 610
 Overall appliance dimensions (HxWxD) (in): 34 1/16" x 23 9/16" x 22 7/16"
 Power cord length (in): 47 1/4"
 Power cord length (cm): 175
 Length outlet hose (in): 55 1/8"
 Length outlet hose (cm): 190.0
 Length inlet hose (in): 55 1/8"
 Length inlet hose (cm): 165
 Product packaging dimensions (HxWxD) (in): 36 13/16" x 26" x 28"
 Tub material: Stainless steel
 Tub type: TallTub
 ADA Compliant: No
 Number of place settings: 14

2015-06-24

SENATOR HOMES
DECOR CENTRE
OCT 14 2015
DATE: _____
INITIALS: A. M.

Front Load Washers

EIFLS60L SS, EIFLS60L T, EIFLS60J IW

IQ-Touch™ Electronic Controls Featuring Perfect Steam™



Most Efficient
2014
ENERGY STAR

Silver Sands
EIFLS60L SS



Silver Sands



Titanium



Island White

Optional Luxury-Glide™
Touch-2-Open™
Pedestal Shown in
Available Colours.



ExpertCare™ Wash System

State-of-the-art wash technology includes varied wash motions and bottom-vent steam options to deliver the best front-load cleaning performance.



Perfect Steam™ Washer

Add steam to select wash cycles to gently deep clean clothes for better stain removal.



Fastest Wash Time¹

Fifteen minutes to wash.



Sure-2-Fit® Capacity Washer

Wash more in one load with our large capacity washer.



¹Fastest time based on analysis: LoadFast Wash and Fast Dry cycles selected for various load compositions.
²Recognized as the Most Efficient of ENERGY STAR® in 2014.

27" ELECTRIC FRONT LOAD WASHERS

Capacity (cu ft)	5.0 Cu Ft
Features	
Door Design	Signature Soft-Air
Electronic Controls	IQ-Touch™ with LCD Display
Perfect Steam™ Wash System	Yes
Balance System	Perfect Balance®
Sound System	Trimmy-Clon™
Lighting	Luxury-Glide™
Touch-2-Open™/Clack Door	Yes
Touch-2-Open™/Clack Dispenser Drawer	Luxury-Glide™
Wash Cycle	ExpertCare™
Integral Water Heater	Yes
Wash Drum	Stainless Steel
Automatic Temperature Control	Yes
Automatic Water Level Adjustment	Yes
Auto Prewash Dispenser (Liquid/Powder)	Yes
Auto Bleach Dispenser (Liquid Only)	Yes
Auto Detergent Dispenser (Liquid/Powder)	Yes
Auto Fabric Softener Dispenser (Liquid Only)	Yes
Variable Speed (RPM)	Variable
Spin Speed (RPM)	1,300
Reversible Door	Yes
Adjustable Leveling Legs	Yes
ENERGY STAR®	Most Efficient
NSF Certified	Sanitize/Allergen

Cycles	
LoadWash™ My Favorite (1), Deep Clean™, Signature™, Heavy Duty™, White™, White™, Colour™, Normal™, Sanitize™, Prewash™, Allergen™, Rinse & Spin™ (Can be used with Add Clean™ option)	1
Specialty Cycles:	
Stains, Fast Sanitize, Stained Linens, Pot Beds, Color Wash™, Active Wear, Fast Steam	7
Options	
Wash/Fine Temperature Combinations	5
Temperature Collection	5
Auto Steam	7
Spin Speed Selections	5
Soft Level Selections	5
Delay Start (Hours)	22
End-of-Cycle Chime	Adjustable

Installation Options	
Freestanding, Under Counter, Stacked (Belt Drive), Pedestal, Pedestal (in Closet), Second Floor	Yes
Accessories	
Luxury-Glide™ Touch-2-Open™/Clack Pedestal	
Silver Sands™ - PNF EPWD1533	Optional
Titanium™ - PNF EPWD1534	
Island White™ - PNF EPWD1535	
Dryer Stacking Kit - PNF STACK1540	Optional
Drain Hose Extension Kit - PNF 13706000	Optional
Multi-Hose Installation Kit - PNF 137067200	Optional

Specifications	
Color	
Silver Sands	SS
Titanium	T
Island White	IW
Product Dimensions:	
Height Without 15" Pedestal	36"
(With 15" Pedestal)	52"
Width	27"
Depth to Centre of Arm (Not including Hose)	31 1/2"
(with 30" Door Open)	30 5/8"
Power Supply/	Top Right (See
Water Inlet Location	on Left Side)
Voltage Rating	120V/60Hz/15A
Connected Load (kW) Rating @ 120 Volts	1.2
Wattage (Wattage)	200
Amperage (20 Volts)	1.2
Shipping Weight (Approx.)	247 lbs.

¹Fastest time based on analysis: LoadFast Wash and Fast Dry cycles selected for various load compositions.
²Recognized as the Most Efficient of ENERGY STAR® in 2014.
³Note: When installing, please refer to the product installation guide for details. For more information, please visit electroluxappliances.ca.

electroluxappliances.ca

**SENATOR HOMES
DECOR CENTRE**

DATE: OCT 14 2015
INITIALS: *[Signature]*

Front Load Washers

EIFLS60L SS, EIFLS60L T, EIFLS60J IW



Electrolux

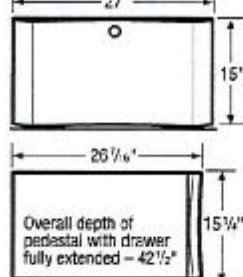
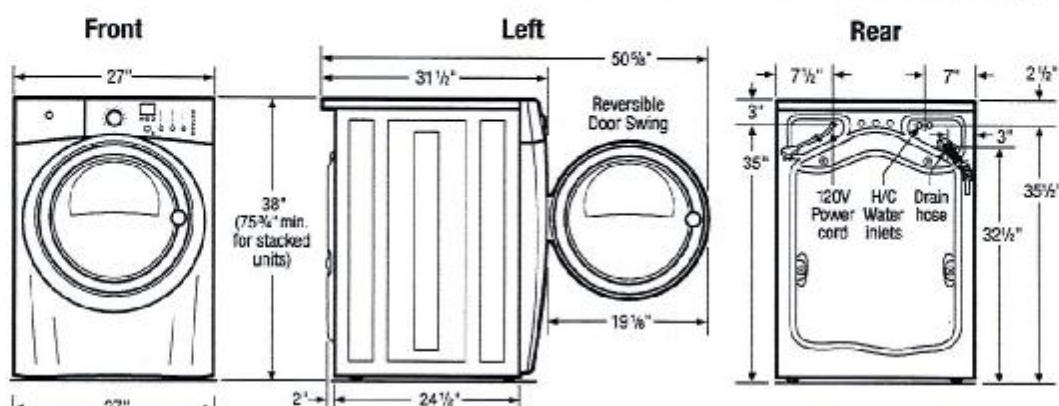

15" Pedestal Drawer Installation

Elevates washer height to 53". For detailed pedestal installation, refer to instructions included with pedestal or on web. **Note:** Pedestal installation requires modified utility hookup locations. For details, refer to Product Installation Guide on web.

Built-In Installations

For built-in installations, NO minimum clearance required around sides and backs of units. (Steam dryers only will require 3/4" steam hose clearance at back of unit.) For closet installation, allow 1" clearance between fronts of units and door. Location of plumbing, exhaust and utility hookups MUST be considered in built-in installations. For additional installation details, refer to Product Installation Guides on web.

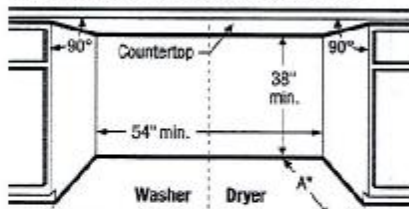

Side-by-Side Units in Under-Counter Installation
Requires custom-built countertop and/or cabinetry.

A - 31 1/2" (with non-steam dryer) / 32 1/4" (with steam dryer)

* To achieve minimal depth dimensions or clearances, dryer MUST be vented straight back or with quick-turn 90° elbow.

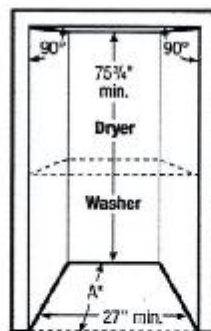

Stacked Units in Recessed or Closet Installation

For detailed stacked installation, refer to instructions included with Stacking Kit or on web. **Note:** Stacked installation requires modified utility hookup locations for dryer. For details, refer to Product Installation Guide on web.

Front Load Washer Specifications

- Product Weight - 237 Lbs.
- An electrical supply with grounded three-prong receptacle is required. The power supply circuit must be installed in accordance with national and local codes & ordinances. (Do not use same circuit as dryer.)
- Voltage Rating - 120V/60 Hz/15 Amps
- Amps @120 Volts = 12 Amps
- Connected Load (kW Rating) @120 Volts = 1.2 kW
- Equipped with 120V 3-wire power supply cord, approx. 60" long.
- Always consult local and national electric & plumbing codes.
- To maximize detergent effectiveness, ambient temperature should never be below 60° F.
- Can be installed alone, with or without optional 15" pedestal drawer, or stacked beneath matching Electrolux Dryer, which requires installation of optional dryer stacking kit. (For installation details, refer to instructions included with optional pedestal or stacking kit or on web.)
- Can be built in with matching Electrolux Dryer in under-counter, recessed or closet installation. Installations requiring countertop and/or cabinetry will require custom building. (Refer to Built-in Installations on this page for cutout dimensions. For additional installation details, refer to Product Installation Guide on web.)
- Closet installation requires vented door with 2 unobstructed louvered openings, minimum 60 sq.in. each, located 3" from top and bottom of door. Full-length 120 sq.in. opening also acceptable. Allow 1" clearance between door and fronts of units.

- Do NOT install in area exposed to dripping water or outdoor weather conditions, or where gasoline or other flammables, including automobiles, are kept or stored.
- Floor MUST be solid with 1" maximum slope. To ensure vibration or movement does not occur, reinforcement of floor may be necessary. Do NOT install on carpeted surface.
- Leveling legs supplied to level washer properly and reduce excessive noise and vibration.
- H/C water faucets MUST be installed within 42" of washer's water inlet and MUST be 3/4" garden hose type, to connect to 48-1/2" inlet hoses.
- Water pressure MUST be between 30 and 120 psi with NOT more than 1.0 psi pressure difference between hot and cold.
- Drain required with standpipe diameter of 1-1/4" min. and height of 24" min./96" max. above floor, capable of eliminating 17 gallons per minute. Attached 59" drain hose can reach 79"-high standpipe.

Note: For planning purposes only. Refer to Product Installation Guide on the web at electroluxappliances.ca for detailed instructions.

Optional Accessories

- Pedestal Drawers - Silver Sands (PN# EPWD15SS), Titanium (PN# EPWD15T), Island White (PN# EPWD15IW).
- Dryer Stacking Kit - (PN# STACKIT4X).
- Drain Hose Extension Kit - (PN# 137098000).
- Mobile Home Installation Kit - (PN# 137067200).

Electrolux Major Appliances, N.A.

CANADA • 5855 Terry Fox Way • Mississauga, ON L5V 3E4 • 1-800-265-8352 • electroluxappliances.ca

EIFLS60L 06/14

© 2014 Electrolux Major Appliances, NA



High standards of quality at Electrolux Home Products, Inc. mean we are constantly working to improve our products. We reserve the right to change specifications or discontinue models without notice.

Printed in Canada

SENATOR HOMES
DECOR CENTRE

DATE: OCT 14 2015

INITIALS:

[Handwritten initials and signature]

Electric Front Load Dryers

EIMED6CL SS, EIMED6CL T, EIMED6CJ IW

IQ-Touch™ Electronic Controls Featuring Perfect Steam™



Silver Sand
EIMED6CL SS



Silver Sand



Titanium



Island White

Optional Luxury-Glide™
Touch-2-Open™
Pedestal Shown in
Available Colours.



Gentlest Dry¹

Our gentlest dryer offers exclusive technology that gently tumbles clothes with exceptional temperature control to help protect fabric.



Fastest Dry Time²

Fastest dryer with just 14 minutes to dry.



Largest Capacity Dryer³

Dry the most in one load with 8.0 cu. ft. capacity.



Perfect Steam™ Dryer

The latest technology removes wrinkles and freshens clothes. "Add Steam" option can be used with select cycles.



27" ELECTRIC FRONT LOAD DRYERS

Capacity (CU. FT.)	8.0 CU. FT.
Features	
Door Design	Signature Soft-Arc
Electronic Controls	IQ-Touch™ with LCD Display
Perfect Steam™ Dry System	Yes
Dry System	Gasless Tumble™
Sound System	Luxury-Quiet™
Lighting System	Luxury-Design™
Touch-2-Open™ (Close) Door	Yes
Moisture Sensor	Exact Dry™
Dryer Drum	Stainless Steel
Humid-Sense™ (RH%)	50
Reversible Door	Yes
Adjustable Leveling Legs	Yes
NSF® Certified	Sanitary
Cycles	
Fast Dry, My Favourite (F), Heavy Duty, Mixed Load, Towels, Normal, Casual, Delicate, Allergic, Taped Dry, Perfect Steam™ (Fast-Dry used with Add Steam option)	11
Specialty Cycles: Warm-Warm-Up, Stuffed Animals, Pet Beds, Active Wear, Socking, Air-Clean	7
Options	
Temperature Selections	5
Add Steam	5
Electronic Auto-Dry System	Yes
Manual Timed Dry Selections	4
Delay-Start (Hours)	20
End-of-Cycle Chime	Adjustable
Extended Tumble	Yes
Anti-Ratchet	Yes
Less Dry	Yes
Strike Guard	Yes
Delayed Lock	4
Installation Options	
Freestanding, Under Counter, Stacked (Above Washing Pedestal, Model to Close), Second Floor, 4-Way Dryer Venting	Yes
Accessories	
Luxury-Glide™ Touch-2-Open™ (Close) Pedestal (Silver Sand - EIMED6MD1000, Titanium - EIMED6MD1010, Island White - EIMED6MD1010)	Optional
Dryer Bypass Kit - EIMED6BCK11X	Optional
Mobile Home Installation Kit - EIMED6MHI200	Optional
Drying Rack - EIMED6DRK1000	Optional
Specifications	
Colour	
Silver Sand	SS
Titanium	T
Island White	IW
Product Dimensions:	
Height (Without Pedestal)	38"
Height (With Pedestal)	53"
Width	27"
Depth (to Centre of Arc, Not including Hood with 30" Door Open)	31-1/2"
Maximum Exhaust Duct Length (F.T.)	125'
Power Supply Connection Location	Bottom Right Rear
Voltage Rating	240V/60 Hz/30A
Connected Load (kW Rating @ 240 volts)	6.0
Amps @ 240 volts	25
Heating Element @ 240 Volts (Watts)	5,400
Shipping Weight (Approx.)	140 lbs.
NSF: For use only on NSF certified equipment, custom built counter-top pedestal required. Always read manual and follow instructions for safe use. Refer to Installation Guide on web for additional information. Specifications subject to change.	

¹Based on cloth temperature, January 2012.

²Fastest time based on smallest load/ Fast Dry cycle selected for various load compositions.

³Based on manufacturer specifications.

⁴Right metal duct required, venting options and allow deductions for elbows and vents. Refer to Installation Guide on web for additional information.

electroluxappliances.ca

SENATOR HOMES
DECOR CENTRE

DATE: OCT 14 2015

INITIALS:

[Handwritten signature]

Electric Front Load Dryers

EIMED6CL SS, EIMED6CL T, EIMED8CJ IW



Electrolux

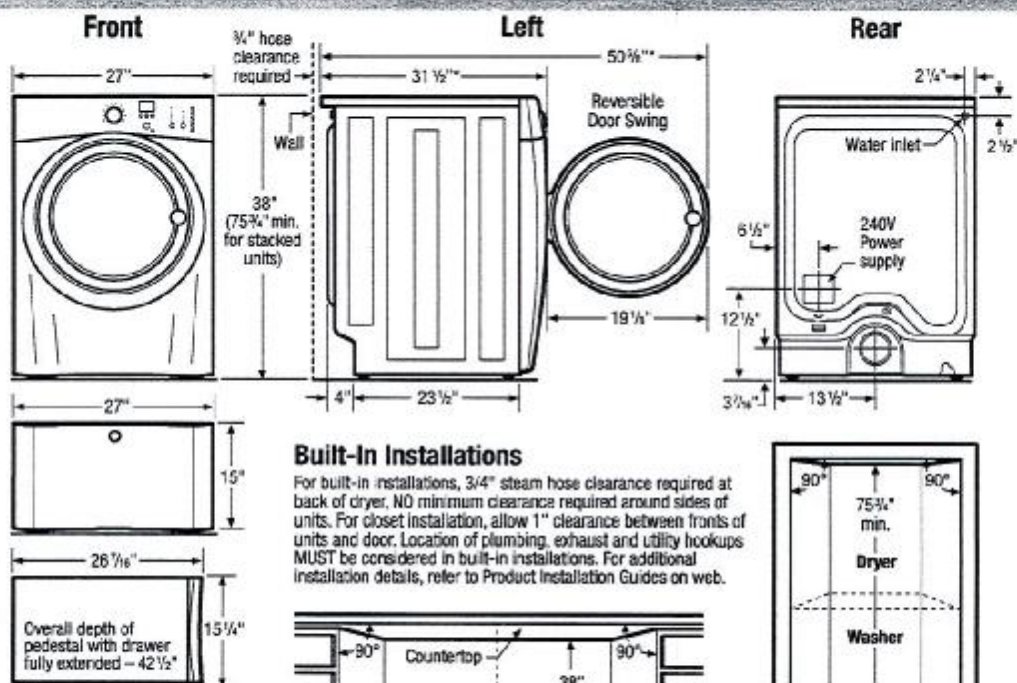

15" Pedestal Drawer Installation

Elevates dryer height to 53". For detailed pedestal installation, refer to instructions included with pedestal or on web. **Note:** Pedestal installation requires modified utility hookup locations. For details, refer to Product Installation Guide on web.

Built-In Installations

For built-in installations, 3/4" steam hose clearance required at back of dryer. NO minimum clearance required around sides of units. For closet installation, allow 1" clearance between fronts of units and door. Location of plumbing, exhaust and utility hookups **MUST** be considered in built-in installations. For additional installation details, refer to Product Installation Guides on web.

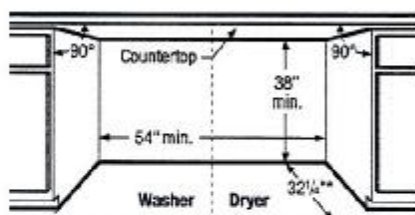

Side-by-Side Units in Under-Counter Installation

Requires custom-built countertop and/or cabinetry. ***To achieve minimal depth dimensions or clearances, dryer MUST be vented straight back or with quick-turn 90° elbow.**

Stacked Units in Recessed or Closet Installation

For detailed stacked installation, refer to instructions included with Stacking Kit or on web. **Note:** Stacked installation requires modified utility hookup locations for dryer. For details, refer to Product Installation Guide on web.

Electric Dryer Specifications

- Product Weight – 130 Lbs.
- Voltage Rating – 240V/60 Hz/30 Amps
- Single phase 3- or 4-wire cable, 240 Volt, 60 Hertz AC only electrical supply with ground required on separate circuit fused on both sides of line. (Do not use same circuit as washer.)
- Connected Load (kW Rating) @ 240 Volts = 6.0 kW
- Amps @ 240 Volts = 25 Amps
- Dryer **MUST** employ a 3-conductor NEMA 10-30 type SRDT or 4-conductor NEMA 14-30 type SRDT or ST (as required), rated at 240 volt AC minimum, 30 amp power supply cord marked for use with clothes dryers (not supplied).
- Grounding through neutral link prohibited in specific applications and certain locales, requiring use of 4-wire system. (For detailed electrical requirements, refer to Product Installation Guide on web.)
- Always consult local and national electric & plumbing codes.
- Can be installed alone, with or without optional 15" pedestal drawer, or stacked above matching Electrolux Washer, which requires installation of optional dryer stacking kit. (For installation details, refer to instructions included with optional pedestal or stacking kit or on web.)
- Can be built in with matching Electrolux Washer in under-counter, recessed or closet installation. Installations requiring countertop and/or cabinetry will require custom building. (Refer to Built-In Installations on this page for cutout dimensions. For additional installation details, refer to Product Installation Guide on web.)
- Closet installation requires vented door with 2 unobstructed louvered openings, minimum 60 sq. in. each, located 3" from top and bottom of door. Full-length 120 sq. in. opening also acceptable. Allow 1" clearance between door and fronts of units.

- Do NOT install in area exposed to dripping water or outdoor weather conditions, or where gasoline or other flammables, including automobiles, are kept or stored.
- Floor **MUST** be solid with 1" maximum slope. To ensure vibration or movement does not occur, reinforcement of floor may be necessary. Do NOT install on carpeted surface.
- Dryer **MUST** exhaust to outside of building, NOT into any concealed space.
- Dryer equipped for 4-way venting and approved for up to 125-foot-equivalent of duct length, determined by length of run and number of elbows needed.
- Exhaust installation requires minimum 4" diameter rigid or semi-rigid metal duct with approved, unobstructed vent hood having swing-out damper(s). If installing rigid metal duct (preferred), do not exceed MAXIMUM venting run length of 125 ft., allow deductions for elbows and vents. If installing semi-rigid metal duct, do not exceed MAXIMUM venting run length of 8 ft., always allow deductions for elbows and vents (Refer to Product Installation Guide on web for additional information). Do NOT use flexible plastic or metal foil duct and use shortest run possible.
- Leveling legs supplied to level dryer properly and reduce excessive noise and vibration.
- Water inlet hose for steam setting connects to cold water supply with "Y" connector and requires 3/4" clearance between back of unit and wall.

Note: For planning purposes only. Refer to Product Installation Guide on the web at electroluxappliances.ca for detailed instructions.

Optional Accessories

- Pedestal Drawers – Silver Sands (PN# EPWD15SS), Titanium (PN# EPWD15T), Island White (PN# EPWD15IW).
- Dryer Stacking Kit – (PN# STACKT4X).
- Mobile Home Installation Kit – (PN# 137067200).
- Drying Rack – (PN# 137453000).



High standards of quality at Electrolux Home Products, Inc. mean we are constantly working to improve our products. We reserve the right to change specifications or discontinue models without notice.

Electrolux Major Appliances, N.A.

CANADA • 5855 Terry Fox Way • Mississauga, ON L5V 3E4 • 1-800-265-8352 • electroluxappliances.ca

EIMED6CL 10/13

© 2013 Electrolux Major Appliances, NA

Printed in Canada

SENATOR HOMES
DECOR CENTRE

DATE: OCT 14 2015

INITIALS:

[Signature]