



CONSTRUCTION SUMMARY

Teefy Developments Limited / 9130 Bathurst

Lot/Unit: 42    Phase/Building: 1    Model/Floor Plan: Belmont(22-1)

CABINETRY HOOD FANS

|                  |  |  |
|------------------|--|--|
| Inv.3187         | 1 - ACCOMMODATE FOR MICROWAVE HOOD FAN COMBO - PURCHASER MUST SUPPLY SPECS |  |
| Line 39577       | Note:  |  |
| 9Sep15 / 25Nov15 |  |  |

COUNTER TOP

|                  |   |  |
|------------------|---|--|
| Inv.3187         | 4 - SUPPLY AND INSTALL ENSUITE GRANITE CUTOUT AND POLISHED EDGE FOR UNDERMOUNT SINK IN POWDER ROOM, MAIN AND MASTER ENSUITE |  |
| Line 39552       | Note: UNDERMOUNT SINK PURCHASED SEPARATELY.   |  |
| 9Sep15 / 25Nov15 |   |  |
| Inv.3187         | 1 - COUNTER TOP - ENSUITE BATHROOM - 2CM WITH STANDARD EDGE FE20 - GROUP 3  |  |
| Line 39558       | Note:   |  |
| 9Sep15 / 25Nov15 |   |  |
| Inv.3187         | 1 - COUNTER TOP - POWDER ROOM - 2CM WITH STANDARD EDGE - GROUP 5  |  |
| Line 40230       | Note:   |  |
| 9Sep15 / 25Nov15 |   |  |
| Inv.3187         | 1 - COUNTER TOP - MAIN BATHROOM - 2CM WITH STANDARD EDGE FE20 - GROUP 3   |  |
| Line 40254       | Note:   |  |
| 9Sep15 / 25Nov15 |   |  |

ELECTRICAL

|                  |  |  |
|------------------|--|--|
| Inv.3187         | 1 - SUPPLY AND INSTALL ADDITIONAL INTERIOR RECEPTACLE ON SEPARATE CIRCUIT FOR FUTURE OTR |  |
| Line 39578       | Note:  |  |
| 9Sep15 / 25Nov15 |  |  |

HARDWOOD

|                  |  |  |
|------------------|--|--|
| Inv.3187         | 1 - SUPPLY AND INSTALL HARDWOOD - UPGRADE 1 - SATIN FINISH GEN. - HOME OAK 3 5/8 INCH X 3/4 INCH - STAIN - - LOWER LEVEL RECREATION ROOM |  |
| Line 40232       | Note:  |  |
| 9Sep15 / 25Nov15 |  |  |

MISCELLANEOUS

PLUMBING

|                   |  |  |
|-------------------|--|--|
| Inv.3187          | 4 - PLUMBING EXTRAS - UNDERMOUNT VANITY SINK (GRANITE PRICED SEPARATELY) 2 IN POWDER ROOM, MASTER ENSUITE 1 IN MAIN BATH CONTRAC RECTANGULAR MODEL 4210CIY |  |
| Line 39553        | Note:  |  |
| 9Sep15 / 25Nov15  |  |  |
| Inv.3225          | 1 - SUPPLY AND INSTALL WATERLINE ROUGH-IN TO THE FRIDGE LOCATION (NO HOOK UP)  |  |
| Line 40528        | Note: LOCATION AS PER SKETCH ATTACHED.   |  |
| 26Sep15 / 26Sep15 |  |  |

TILE - FLOOR



CONSTRUCTION SUMMARY

Teefy Developments Limited / 9130 Bathurst

Lot/Unit: 42    Phase/Building: 1    Model/Floor Plan: Belmont(22-1)

|                  |  |  |
|------------------|--|--|
| Inv.3187         | 1 - SUPPLY AND INSTALL FLOOR TILE - UPGRADE 2 - - POWDER ROOM FLOOR  |  |
| Line 40228       | Note:  |  |
| 9Sep15 / 25Nov15 |  |  |
| Inv.3187         | 1 - SUPPLY AND INSTALL FLOOR TILE - UPGRADE 2 - - ENUSITE BATH FLOOR |  |
| Line 40227       | Note:  |  |
| 9Sep15 / 25Nov15 |  |  |

EXTRAS AS PER OFFER

|  |  |
|--|--|
| Stainless Steel Fridge, Stove and Dishwasher and front loading washer and dryer in white from Vendors standard samples, no cash value, not transferable.<br>(Supplied only not installed) ** to - arrange delivery call: The Brick commercial sales division at<br>Worksheet Note: |  |
| Rogers Free Services Package includes 6 months of: home phone, TV and Internet Service.<br>Worksheet Note:   |  |

Teefy 42

Purchasers: Jacqueline Uy Tan & Sonny Tan

Property: 42 of Plan -

Telephone Res. / Bus: /

Project: Teefy Developments Limited

Decor Advisor: Nicole Soares

Model and Elevation: Belmont(22-1)

Layout Changes: ☐ Yes ☒ No Sketch Attached: ☒ Yes ☐ No Exterior Colour Scheme:

### 1. Cabinetry

|   | Style and Colour               | Counter Top                | Hardware |
|---|--------------------------------|----------------------------|----------|
| Kitchen / Breakfast                     | WESTBROOK PAINT: WINTER WHITE  | UBA TUBA - STD SQUARE EDGE | 9671     |
| Kitchen Island                          | WESTBROOK PAINT: WINTER WHITE  | UBA TUBA - STD SQUARE EDGE | 9671     |
| Laundry Room                            | CAMDEN PAINT: WINTER WHITE     | N/A                        | 12801    |
| Powder Room                             | MAITLAND: ONTARIO WHITE        | 5110 - STD SQUARE EDGE     | 149      |
| Main Bathroom                           | MANCHESTER PAINT: WINTER WHITE | 4330 - STD SQUARE EDGE     | 181      |
| Master Ensuite Bathroom                 | RIDEAU: ONTARIO WHITE          | 2141 - STD SQUARE EDGE     | 149      |
| Second Ensuite Bathroom (If Applicable) |                                |                            |          |
| Lower Level Bath                        | MANCHESTER PAINT: WINTER WHITE | WHITE CARRARA 4924-38      | 181      |

### Appliances

#### Custom Size Fridge

☐ Yes ☒ No

#### Valance Lighting

☒ Yes ☐ No

#### Microwave / Range Hood

☒ Yes ☐ No

#### Cooktop / Rangetop

☐ Yes ☒ No

#### Built in Wall Oven

☐ Yes ☒ No

#### Slide-in Range

☒ Yes ☐ No

### Comment

### 2. Flooring

|                               | Selection   |
|-------------------------------|---|
| Foyer                         | NEW REEDS 13x13: BROWN                                      |
| Main Hall                     |   |
| Back Hall                     |   |
| Breakfast                     | SATIN FINISH GEN. HOME 3 5/8" x 3/4": GROTTTO               |
| Laundry Room                  | NEW REEDS 13x13: SILVER                                     |
| Kitchen                       | SATIN FINISH GEN. HOME 3 5/8" x 3/4": GROTTTO               |
| Powder Room                   | UPG 2 - NEW BYZANTINE 13x13: PENTELLIC GREY                 |
| Main Bathroom                 | TIBET 13x13: GREY   |
| Master Ensuite                | UPG 2 - SAUBLE 13x13: ANTHRACITE (BLACK)                    |
| Bathroom (If Applicable)      |   |
| Mud Room                      |   |
| Lower Level Bathroom          | BANFF 12x12: GREY   |
| Living Room                   |   |
| Dining Room                   | FORMAL ROOM - SATIN FINISH GEN. HOME 3 5/8" x 3/4": GROTTTO |
| Family / Great Room           | SATIN FINISH GEN. HOME 3 5/8" x 3/4": GROTTTO               |
| Den / Library / Study         |   |
| Basement Landing (If Applies) |   |
| Lower Landing (If Applicable) |   |
| Upper Landing                 | SATIN FINISH GEN. HOME 3 5/8" x 3/4": GROTTTO               |
| Upper Hall                    | SATIN FINISH GEN. HOME 3 5/8" x 3/4": GROTTTO               |
| Master Bedroom                | PAPILIO: 18674 NEWFOUNDLAND SAND                            |
| Bedroom #2                    | PAPILIO: 18674 NEWFOUNDLAND SAND                            |
| Bedroom #3                    | PAPILIO: 18674 NEWFOUNDLAND SAND                            |
| Bedroom #4                    |   |
| Bedroom #5                    |   |
| Recreation Room               | PAPILIO: 18674 NEWFOUNDLAND SAND                            |

Flooring Continued on Page 2

Initial:

Page 1 of 3

Teefy 42

Purchasers: Jacqueline Uy Tan & Sonny Tan

Property: 42 of Plan -

Telephone Res. / Bus: /

Project: Teefy Developments Limited

Decor Advisor: Nicole Soares

Model and Elevation: Belmont(22-1)

### 2. Flooring - Continued -

|                  |                           |                   |
|------------------|---------------------------|-------------------|
| Upgrade Underpad | Type<br>STANDARD UNDERPAD | Area              |
| Carpet on Stairs | Capped                    | Runner - *Upgrade |
| Comment          |                           |                   |

### 3. Plumbing Fixtures / Faucets

|                |     |                  |     |             |     |
|----------------|-----|------------------|-----|-------------|-----|
| Kitchen        | STD | Second Ensuite   |     | Powder Room | STD |
| Master Ensuite | STD |                  |     | Other Room  |     |
| Main Bathroom  | STD | Lower Level Bath | STD |             |     |
| Comment        |     |                  |     |             |     |

### 4. Wall Tile

|                       | Tile Selection                  | Listello                 | Insert                   | Insert Selection |
|-----------------------|---------------------------------|--------------------------|--------------------------|------------------|
| Main Bathroom         | SERPENTINE 8x10: KREM (CREAM)   | <input type="checkbox"/> | <input type="checkbox"/> |                  |
| Master Ensuite        |                                 |                          |                          |                  |
| Tub Deck              |                                 | <input type="checkbox"/> | <input type="checkbox"/> |                  |
| Tub Apron             |                                 | <input type="checkbox"/> | <input type="checkbox"/> |                  |
| Tub Surround          |                                 | <input type="checkbox"/> | <input type="checkbox"/> |                  |
| Shower Stall          | VENUS 8x10: GREY                | <input type="checkbox"/> | <input type="checkbox"/> |                  |
| Second Ensuite        |                                 | <input type="checkbox"/> | <input type="checkbox"/> |                  |
| M. Ensuite Shower Flr | ONTARIO 2x2 MOSAIC: TENDER GREY | <input type="checkbox"/> | <input type="checkbox"/> |                  |
| Lower Level Bath      | ALPES 8x10: GREY                | <input type="checkbox"/> | <input type="checkbox"/> |                  |
| Kitchen Backsplash    |                                 | <input type="checkbox"/> | <input type="checkbox"/> |                  |
| Complete Backsplash   |                                 | <input type="checkbox"/> | <input type="checkbox"/> |                  |
| Comment               |                                 |                          |                          |                  |

### 5. Fireplace

|                | Living Room           |                       |                       | Family Room           |                                  |                       | Other Room - Specify  |                       |                       |
|----------------|-----------------------|-----------------------|-----------------------|-----------------------|----------------------------------|-----------------------|-----------------------|-----------------------|-----------------------|
|                | Purchased             | As Per Plan           | N/A                   | Purchased             | As Per Plan                      | N/A                   | Purchased             | As Per Plan           | N/A                   |
| Fireplace Type | <input type="radio"/> | <input type="radio"/> | <input type="radio"/> | <input type="radio"/> | <input checked="" type="radio"/> | <input type="radio"/> | <input type="radio"/> | <input type="radio"/> | <input type="radio"/> |
| Mantle Type    |                       |                       |                       | STANDARD 50" ELECTRIC |                                  |                       |                       |                       |                       |
| Over Mantle    |                       |                       |                       |                       |                                  |                       |                       |                       |                       |
| Colour / Stain |                       |                       |                       |                       |                                  |                       |                       |                       |                       |
| Surround       |                       |                       |                       | STANDARD              |                                  |                       |                       |                       |                       |
| Hearth         |                       |                       |                       |                       |                                  |                       |                       |                       |                       |
| Comment        |                       |                       |                       |                       |                                  |                       |                       |                       |                       |

Initial: 

Page 2 of 3



## INTERIOR COLOUR SCHEME

Teefy 42

Purchasers: Jacqueline Uy Tan &amp; Sonny Tan

Property: 42 of Plan -

Telephone Res. / Bus: /

Project: Teefy Developments Limited

Decor Advisor: Nicole Soares

Model and Elevation: Belmont(22-1)

## 6. Trim Carpentry

Door Hardware STANDARD LEVER

Interior Trim STANDARD BASEBOARD &amp; CASING

Comment

## Interior Doors

☐ 2 Panel Arch Top☒ 2 Panel Square Top☐ 6 Panel

Initial for Door Style

## 7. Railings and Pickets

Railing Package STANDARD PACKAGE

Railing Colour STAINED TO MATCH

Picket Colour FLAT BLACK METAL

Wood Stairs ☐ No ☒ Oak

Tread Colour STAINED TO MATCH

Comment

STAIRS TO BE STAINED TO MATCH- SATIN FINISH GEN. HOME 3 5/8" x 3/4": \*\*\* AS MUCH AS POSSIBLE\*\*\*\*PURCHASER IS AWARE THAT THE STAIN IS NOT GOING TO BE A 100% TRUE MATCH

## 8. Plaster Mouldings and Medallions

Foyer

Main Hall

Living Room

Dining Room

Family Room

Kitchen/Breakfast

Den/Library

Lower Landing

Comment

## 9. Wall Paint

SENATOR WHITE

## Smooth Ceilings

☐ First Floor☐ First Floor incl. Second Floor Hall☐ First and Second Floor☒ Throughout☐ Not Applicable

Trim Paint SENATOR WHITE

## 10. Additional Comments

## 11. Disclaimers and Notes

- 1) Colours of all materials are as close as possible to builder's selection, but not necessarily identical due to variances in manufacturing.
- 2) Any extras listed above are null and void unless accompanied by a separate invoice/amendment. Said invoice must be paid in full.
- 3) The Purchaser acknowledges that after Interior Colour Selection form is signed and dated, no further changes will be permitted other than re-selection due to unavailability. \_\_\_\_\_ Purchaser's Initials
- 4) The Purchaser acknowledges reading and accepting the "Senator Homes Décor Centre Disclaimers" form. This document contains other miscellaneous disclaimers.

This Interior Colour Selection is final and approved by:

Purchaser:

Signature: \_\_\_\_\_ Date: 9/24/2015

Signature: \_\_\_\_\_ Date: \_\_\_\_\_

Vendor:

Teefy Developments Limited

Teefy 42

# BELMONT

2190 SQ.FT. / 2021 SQ.FT. WITH OPTIONAL TANDEM GARAGE

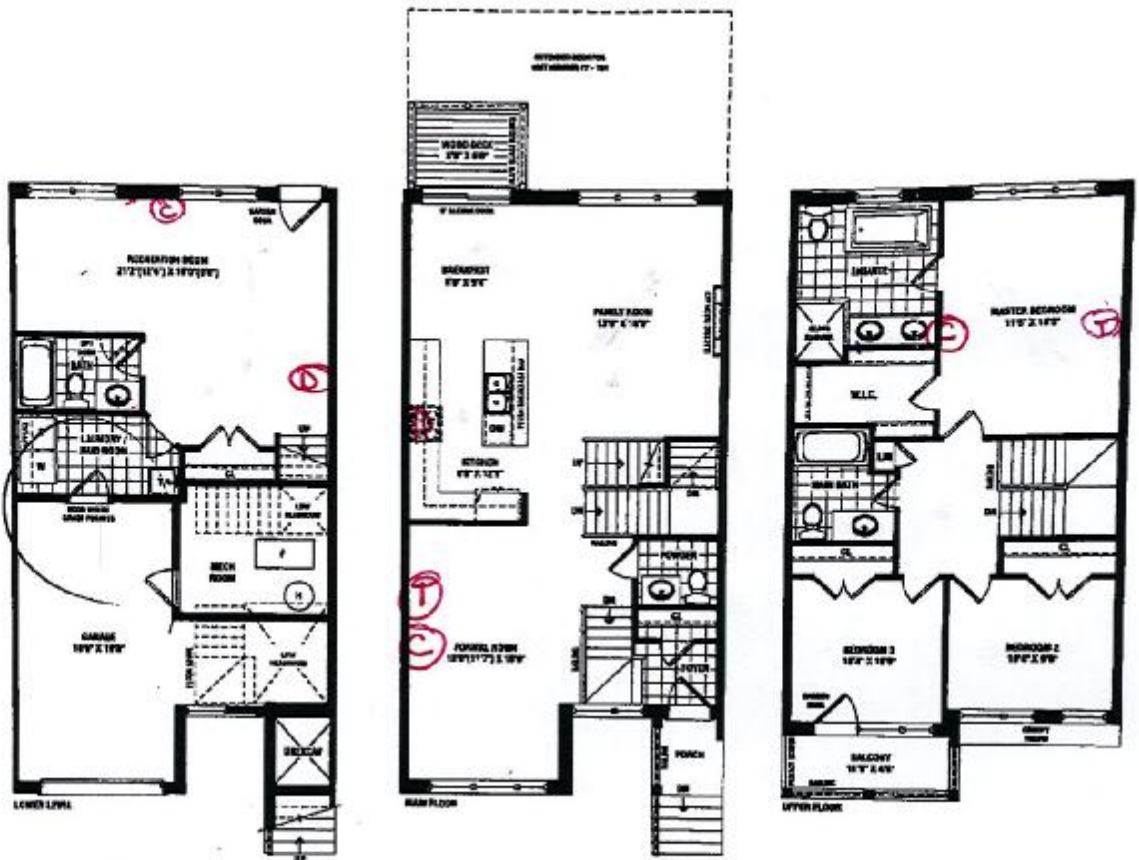

- Ⓚ OUTLET FOR MICRO OTR
- Ⓢ CABLE
- Ⓣ TELEPHONE
- Ⓡ RG10

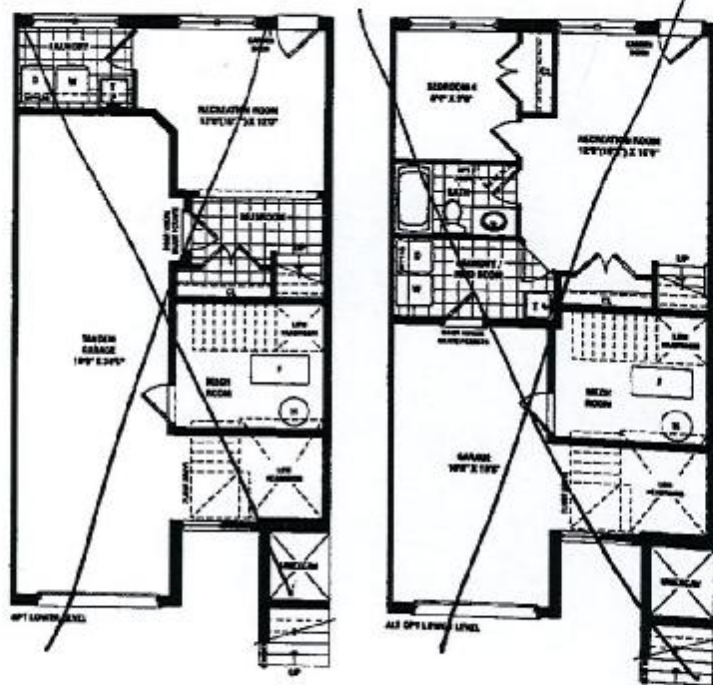

SENATOR

SENATOR HOMES  
DECOR CENTRE

DATE: 9/21/2015  
INITIALS: [Signature]

# BELMONT - TH-22-1

STD. LAYOUT

ACCOMMODATE  
for MICRO DTR

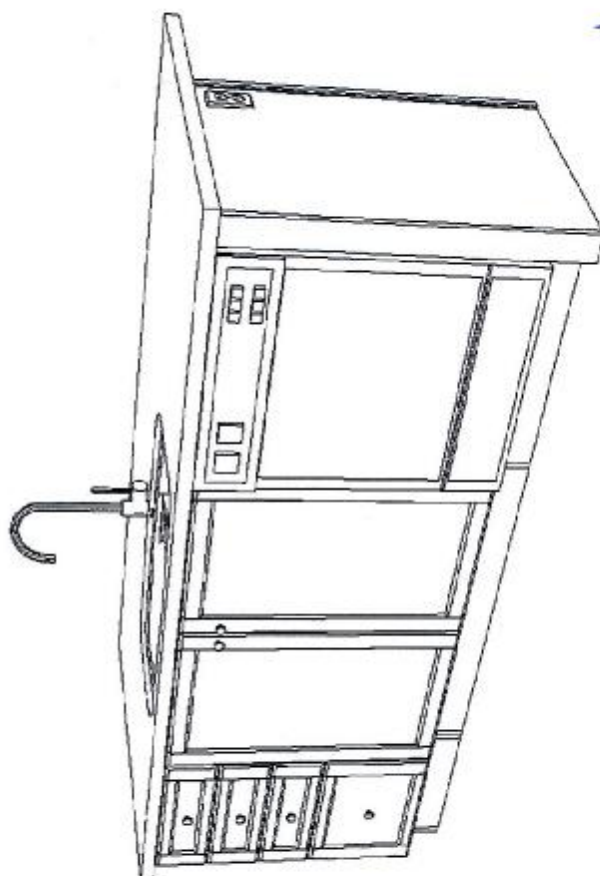
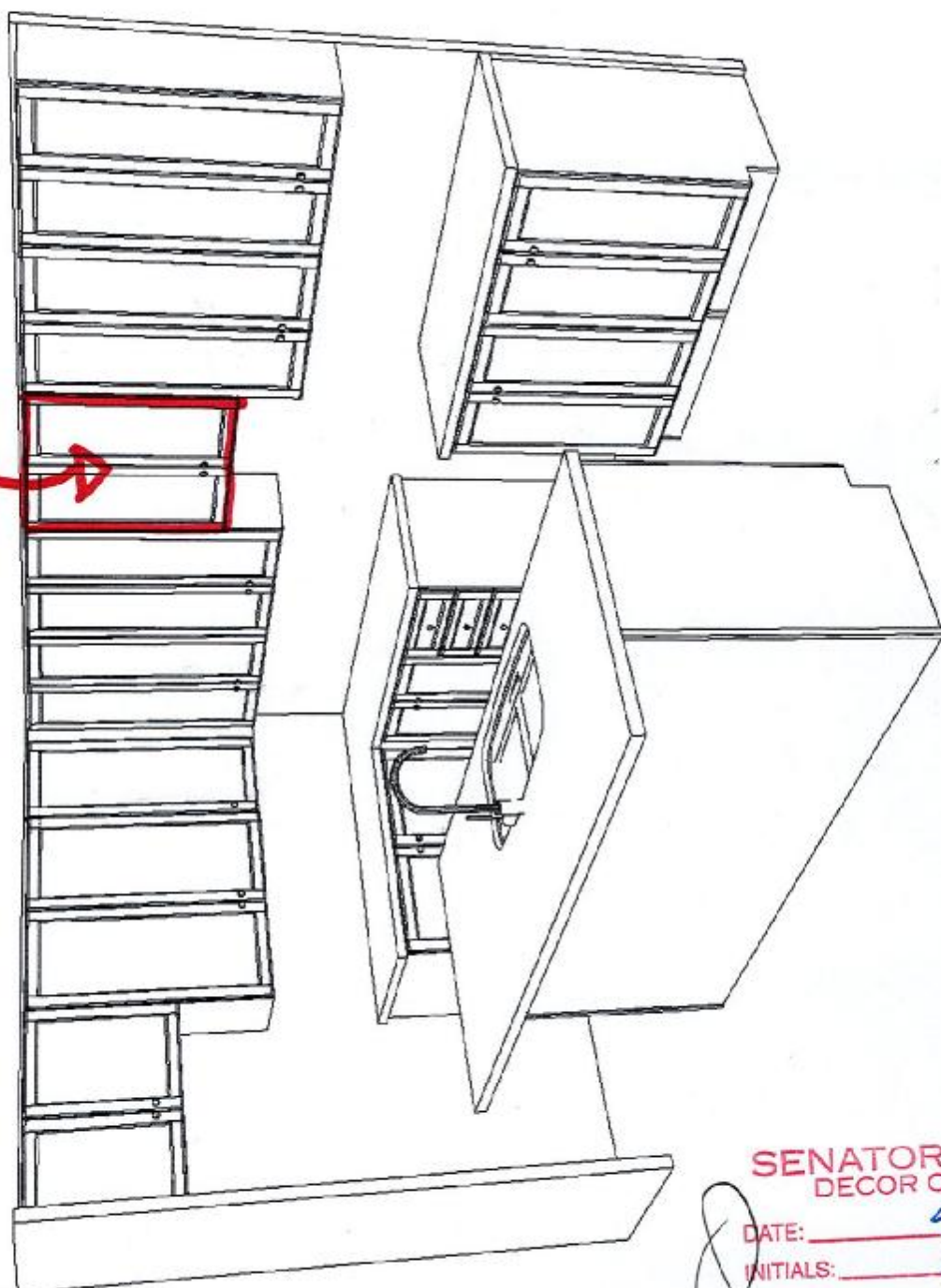

Teefy 42

SENATOR HOMES - TEEFY

SENATOR HOMES  
DECOR CENTRE

DATE:

INITIALS:

9/21/2005

*[Signature]*



**FRENDEL**  
KITCHENS LIMITED

1950 Shawston Drive, Mississauga, ON L4W 1C5

**ACCOMMODATE  
for MICRO DTR**

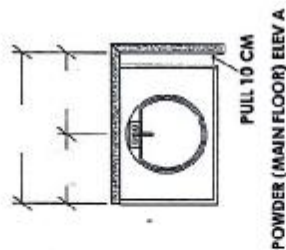

PULL 10 CM  
POWDER (MAIN FLOOR) ELEV A

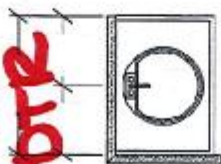

BATH (LOWER LEVEL) ELEV A  
OPT. BATH (ALT. OPT. LOWER LEVEL) ELEV A

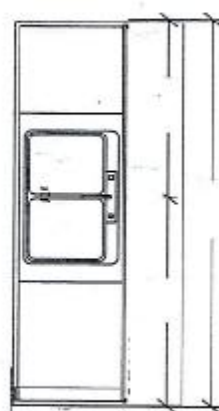

KITCHEN (MAIN FLOOR) ELEV A

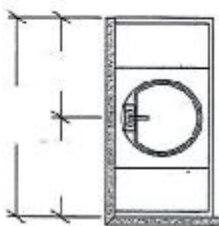

MAIN BATH (UPPER FLOOR) ELEV A

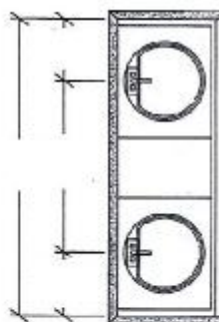

ENSUITE (UPPER FLOOR) ELEV A

**SENATOR HOMES  
DECOR CENTRE**

DATE: 9/24/15

INITIALS: [Signature]

### OPTIONAL CABINERY (STANDARD ELEVATION)

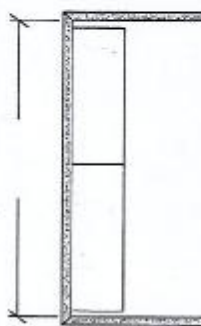

-OPT. LAUNDRY UPPERS (ALT LOWER LEVEL) ELEV A  
-OPT. LAUNDRY UPPERS (OPT LOWER LEVEL) ELEV A

(BASE CABINERY NOT REFLECTED ON DWG'S)

### OPTIONAL CABINERY (ALTERNATE & OPTIONAL ELEVATION)

\*\*\*NO OPT. LOWER LEVEL VANITY\*\*\*

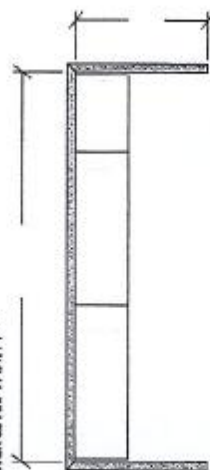

OPT. LAUNDRY UPPERS (OPT. LOWER LEVEL-TANDEM) ELEV A

(BASE CABINERY NOT REFLECTED ON DWG'S)

**SENATOR HOMES  
TEEFY DEVELOPMENTS LIMITED - 9130 BATHURST  
MODEL: BELMONT - TH-22-1  
TOTAL UNITS:**

**2020**  
Renovations

Note: This drawing is an artistic  
interpretation of the general  
appearance of the design. It is  
not meant to be an exact rendition.

Designed: 7/31/2014  
Printed: 2/10/2015

TH-22-1

Drawing 1 Drawing #: 1

*Teefy 42*



# RECTANGULAR UNDERMOUNT SINK

4210CIY

Undermount Sink

## Product Specs:

- Vitreous china
- Front overflow hole
- Template and mounting hardware supplied

## Overall Dimensions (W x D x H):

(OD): 510mm(20") x 395mm(15½") x 190mm(7½")  
(ID): 450mm(17¾") x 335mm(13¼") x 140mm(5½")

## Compliance Certifications:

- Meets or exceeds the following :
- IAPMO cUPC
  - ASME A112.19.2 / CSA B45.1-2008

## Shipping:

Cube 1.72  
GW 27 lbs

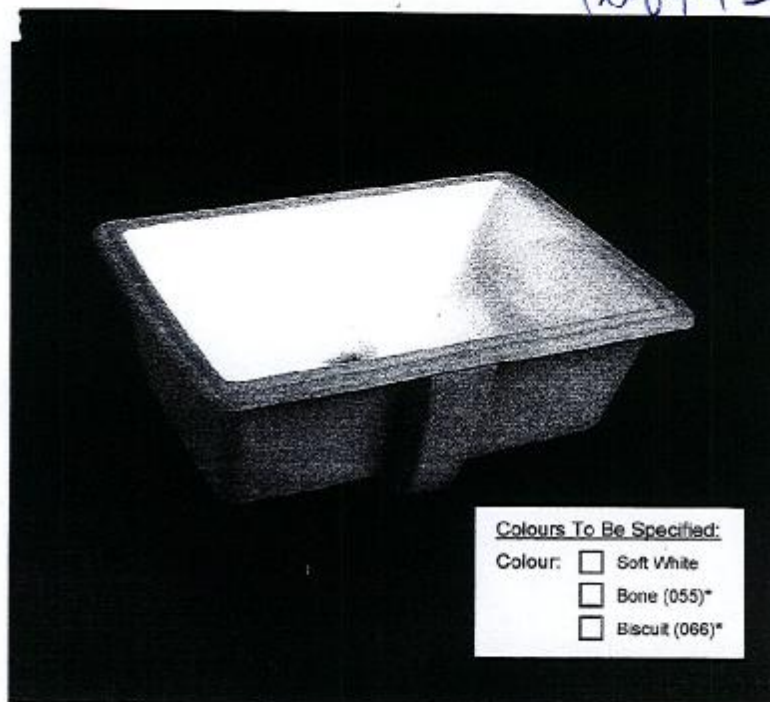

## Notes:

Dimensions of fixtures are nominal and may vary within the range of tolerances established by ASME standard A112.19.2. These measurements are subject to change or cancellation. No responsibility is assumed for use of superseded or voided pages.

\*Bone and Biscuit available through Direct Import (CIF) only.

Detail of Mounting Clip

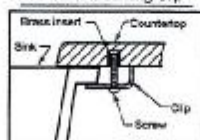

Note:  
▲ Dimensions shown for location of supplies and "P" trap are suggested.

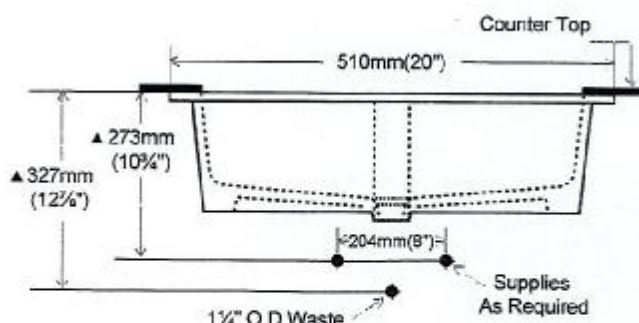
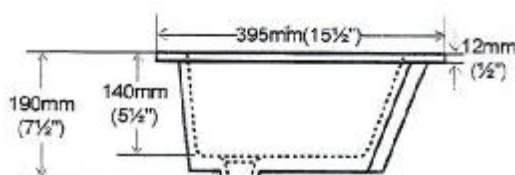
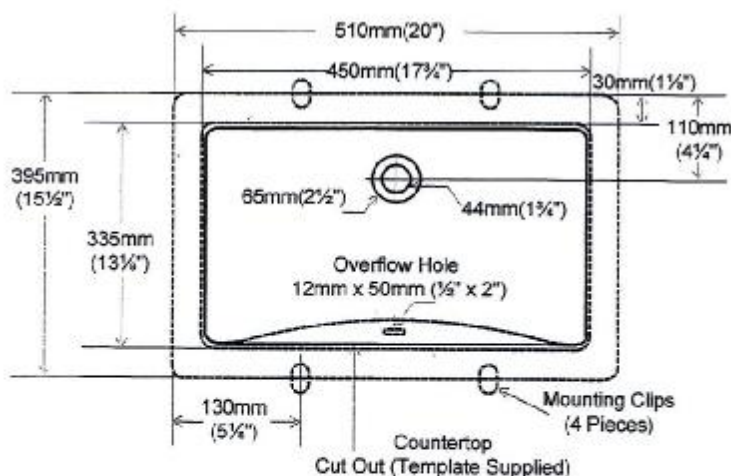

CONTRAC® 5970 Chedworth Way, Unit A, Mississauga, Ontario Canada L5R 3V5 • 1.888.256.7551  
www.conrac.ca

Revised: January 201

POWDER ROOM(1), MAIN BATH(1)  
MASTER ENSUITE(2)

SENATOR HOMES  
DECOR CENTRE

DATE: SEPT 21<sup>ST</sup>, 2015  
INITIALS: [Signature]