



CONSTRUCTION SUMMARY

Teefy Developments Limited / 9130 Bathurst

Lot/Unit: 73 Phase/Building: 1 Model/Floor Plan: Riverdale(22-3)

PLUMBING

Inv.2977	1 - SUPPLY AND INSTALL FRIDGE COLD WATER LINE	
Line 35480	Note:	
21May15 / 29May15		

EXTRAS AS PER OFFER

Stainless Steel Fridge, Stove and Dishwasher and front loading washer and dryer in white from Vendors standard samples, no cash value, not transferable. (Supplied only not installed) ** to - arrange delivery call: The Brick commercial sales division at Worksheet Note:	
Rogers Free Services Package includes 6 months of: home phone, TV and Internet Service. Worksheet Note:	

This Document is Extremely Time Sensitive - Printed 24 Nov 15 at 17:01

Page 1 of 1

RIVERDALE

Treeby 1st 73

2454 SQ.FT. / 2288 SQ.FT. WITH OPTIONAL TANDEM GARAGE



Ⓣ - TELEPHONE
Ⓢ - CABLE

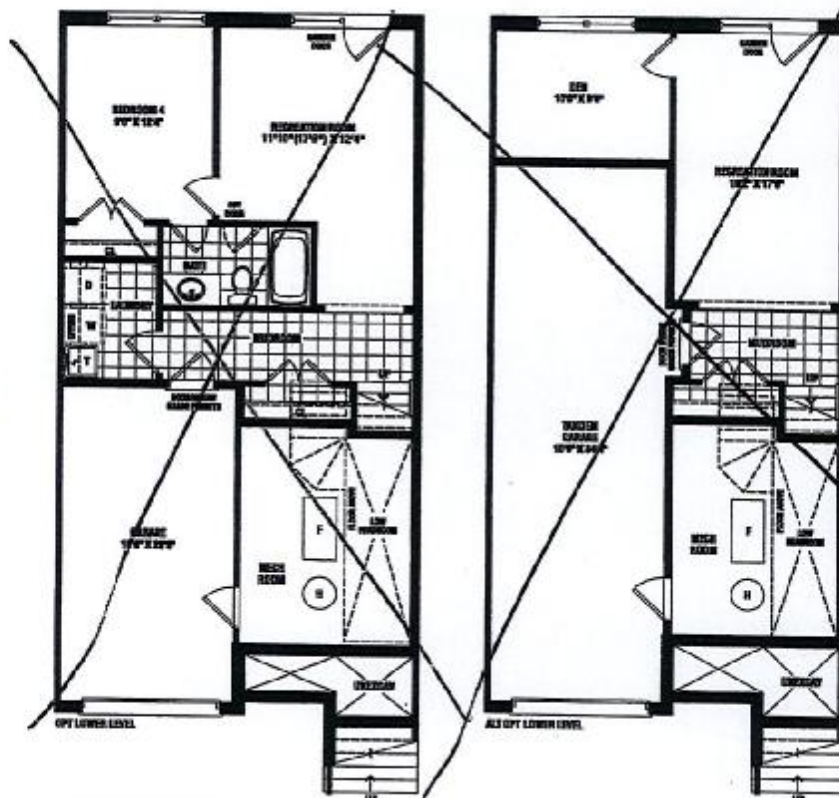

SENATOR HOMES
DECOR CENTRE

DATE: 2015-5-29

INITIALS: *[Handwritten initials]*

SENATOR
HOMES

Renderings are artist's concept. Some elevations may vary from that shown. Actual useable square footage may vary from that stated herein. Some floorplans and elevations are minor image to that shown. E&O.E. 22-3

[Handwritten initials]

Teefy lot 73

Purchasers: In A Lee & Montgomery V Kersell

Property: 73 of Plan -

Telephone Res. / Bus: (647) 287-8991 /

Project: Teefy Developments Limited

Decor Advisor: Nicole Soares

Model and Elevation: Riverdale(22-3)

Layout Changes: ☐ Yes ☒ No Sketch Attached: ☒ Yes ☐ No Exterior Colour Scheme:

1. Cabinetry	Style and Colour	Counter Top	Hardware
Kitchen / Breakfast	CLASSIC- MANCHESTER PAINT: CANNOLI	GRIGIO SARDO	9677
Kitchen Island	CLASSIC- MANCHESTER PAINT: CANNOLI	GRIGIO SARDO	9677
Laundry Room	BOTH****MANCHESTER PAINT: CANNOLI		BOTH****9677
Powder Room	CLASSIC- MANCHESTER PAINT: CANNOLI	MILANO QUARTZ 4726K-52	151
Main Bathroom	CLASSIC- MANCHESTER PAINT: CANNOLI	MILANO QUARTZ 4726K-52	151
Master Ensuite Bathroom	CLASSIC- MANCHESTER PAINT: CANNOLI	MILANO QUARTZ 4726K-52	151
Second Ensuite Bathroom (If Applicable)	CLASSIC- MANCHESTER PAINT: CANNOLI	MILANO QUARTZ 4726K-52	151

Appliances

Custom Size Fridge ☐ Yes ☒ No

Valance Lighting ☐ Yes ☒ No

Microwave / Range Hood ☐ Yes ☒ No

Cooktop / Rangetop ☐ Yes ☒ No

Built in Wall Oven ☐ Yes ☒ No

Slide-in Range ☐ Yes ☒ No

Comment

2. Flooring

	Selection
Main Hall	MAIN FLOOR FOYER- 13X13 SAUBLE: BROWN
Back Hall	SATIN FINISH RED OAK 3 5/8: CHARCOAL
Breakfast	
Laundry Room	BOTH****13X13 SAUBLE: BROWN
Kitchen	SATIN FINISH RED OAK 3 5/8: CHARCOAL
Powder Room	13X13 SAUBLE: BROWN
Main Bathroom	13X13 SAUBLE: BROWN
Master Ensuite	13X13 SAUBLE: BROWN
Bathroom (If Applicable)	GROUND FLOOR****13X13 SAUBLE: BROWN
Mud Room	13X13 SAUBLE: BROWN
Living Room	SERVERY- SATIN FINISH RED OAK 3 5/8: CHARCOAL
Dining Room	FORMAL ROOM****SATIN FINISH RED OAK 3 5/8: CHARCOAL
Family / Great Room	SATIN FINISH RED OAK 3 5/8: CHARCOAL
Den / Library / Study	
Basement Landing (If Applies)	
Lower Landing (If Applicable)	
Upper Landing	
Upper Hall	CORONET PAPILO: 79497 MAPLE SEASON
Master Bedroom	CORONET PAPILO: 79497 MAPLE SEASON
Bedroom #2	CORONET PAPILO: 79497 MAPLE SEASON
Bedroom #3	CORONET PAPILO: 79497 MAPLE SEASON
Bedroom #4	
Bedroom #5	
	RECREATION ROOM- CORONET PAPILO: 79497 MAPLE SEASON

Flooring Continued on Page 2

Initial: 

Page 1 of 3



INTERIOR COLOUR SCHEME

Teefy lot 73

Purchasers: In A Lee & Montgomery V Kersell

Property: 73 of Plan -

Telephone Res. / Bus: (647) 287-8991 /

Project: Teefy Developments Limited

Decor Advisor: Nicole Soares

Model and Elevation: Riverdale(22-3)

2. Flooring - Continued -

Upgrade Underpad	Type	Area
	STD	
Carpet on Stairs	Capped	Runner - *Upgrade
Comment		

3. Plumbing Fixtures / Faucets

Kitchen	STD	Second Ensuite	STD	Powder Room	STD
Master Ensuite	STD			Other Room	STD
Main Bathroom	STD		STD		
Comment					

4. Wall Tile

	Tile Selection	Listello	Insert	Insert Selection
Main Bathroom	8X10 CLASSICO TRA: NOCE (BROWN)	<input type="checkbox"/>	<input type="checkbox"/>	
Master Ensuite		<input type="checkbox"/>	<input type="checkbox"/>	
Tub Deck		<input type="checkbox"/>	<input type="checkbox"/>	
Tub Apron		<input type="checkbox"/>	<input type="checkbox"/>	
Tub Surround		<input type="checkbox"/>	<input type="checkbox"/>	
Shower Stall	8X10 CLASSICO TRA: NOCE (BROWN)	<input type="checkbox"/>	<input type="checkbox"/>	
Second Ensuite	8X10 CLASSICO TRA: NOCE (BROWN)	<input type="checkbox"/>	<input type="checkbox"/>	
		<input type="checkbox"/>	<input type="checkbox"/>	
	GRND FLR BTH 8X10 CLASSICO TRA: NOCE (BROWN)	<input type="checkbox"/>	<input type="checkbox"/>	
Kitchen Backsplash		<input type="checkbox"/>	<input type="checkbox"/>	
Complete Backsplash		<input type="checkbox"/>	<input type="checkbox"/>	

Comment

5. Fireplace

	Living Room			Family Room			Other Room - Specify		
	Purchased	As Per Plan	N/A	Purchased	As Per Plan	N/A	Purchased	As Per Plan	N/A
Fireplace Type	<input type="radio"/>	<input type="radio"/>	<input checked="" type="radio"/>	<input type="radio"/>	<input checked="" type="radio"/>	<input type="radio"/>	<input type="radio"/>	<input type="radio"/>	<input checked="" type="radio"/>
Mantle Type				STANDARD ELECTRICAL					
Over Mantle									
Colour / Stain									
Surround									
Hearth									
Comment									

Initial:

Page 2 of 3

Teefy lot 73

Purchasers: In A Lee & Montgomery V Kersell

Property: 73 of Plan -

Telephone Res. / Bus: (647) 287-8991 /

Project: Teefy Developments Limited

Decor Advisor: Nicole Soares

Model and Elevation: Riverdale(22-3)

6. Trim Carpentry

Door Hardware

Interior Trim

Comment

INTERIOR DOORS TO BE 2 PANEL SQUARE

Interior Doors

☒ 2 Panel SQUARE

☐ 6 Panel

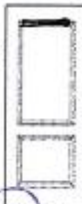

Initial for Door Style *MD (B)*

7. Railings and Pickets

Railing Package

Railing Colour

Picket Colour

Wood Stairs ☐ No ☒ Oak

Tread Colour

Comment

PURCHASER REQUESTS STAIRS TO BE STAINED AS CLOSE AS POSSIBLE TO THE HARDWOOD SATIN FINISH RED OAK 3 5/8: CHARCOAL****PURCHASER IS AWARE THE STAIN WILL NOT BE A 100% MATCH TO THE HARDWOOD

8. Plaster Mouldings and Medallions

Foyer

Main Hall

Living Room

Dining Room

Family Room

Kitchen/Breakfast

Den/Library

Lower Landing

Comment

9. Wall Paint

Smooth Ceilings ☐ First Floor

☐ First Floor incl. Second Floor Hall

☒ First and Second Floor

☐ Not Applicable

Trim Paint

10. Additional Comments

CEILINGS ON GROUND FLOOR TO BE SMOOTH AS PER A.P.S SCHEDULE "A"

11. Disclaimers and Notes

- Colours of all materials are as close as possible to builder's selection, but not necessarily identical due to variances in manufacturing.
- Any extras listed above are null and void unless accompanied by a separate invoice/amendment. Said invoice must be paid in full.
- The Purchaser acknowledges that after Interior Colour Selection form is signed and dated, no further changes will be permitted other than re-selection due to unavailability. *MD (B)* Purchaser's Initials
- The Purchaser acknowledges reading and accepting the "Senator Homes Décor Centre Disclaimers" form. This document contains other miscellaneous disclaimers.

This Interior Colour Selection is final and approved by:

Purchaser:

Signature: *Monty Kersell* Date: *2015-5-29*

Signature: *MD (B)* Date: *2015-5-29*

Vendor:

Teefy Developments Limited