



CONSTRUCTION SUMMARY

Teefy Developments Limited / 9130 Bathurst

Lot/Unit: 51 Phase/Building: 1 Model/Floor Plan: Bedford(22-2)

CABINETRY APPLIANCE - FRIDGE

Inv.3195	1 - 59 CM FRIDGE CABINET - 1 GABLE & CABINET 59 CM DEEP - DEEP	
Line 39743	Note:	
10Sep15 / 11Sep15		

CABINETRY BASE CABINETS

Inv.3195	1 - BASE PIE CUT CORNER	
Line 39742	Note:	
10Sep15 / 11Sep15		

CABINETRY HARDWARE

Inv.3195	1 - KITCHEN - CABINET HARDWARE - UPGRADE 2 - DISPLAY BOARD	
Line 39749	Note:	
10Sep15 / 11Sep15		

CABINETRY HOOD FANS

Inv.3195	1 - ACCOMMODATE FOR CHIMNEY STYLE HOOD FAN - PURCHASER MUST SUPPLY SPECS	
Line 39744	Note:	
10Sep15 / 11Sep15		

CABINETRY VANITY

Inv.3195	1 - VANITY BANK OF DRAWERS - 55 CM MAXIMUM - IN MASTER ENSUITE	
Line 39753	Note:	
10Sep15 / 11Sep15		

CABINETRY WALL AND HUTCH

Inv.3195	1 - UPPER ANGLE CORNER	
Line 39741	Note:	
10Sep15 / 11Sep15		
Inv.3195	3 - GLASS DOOR CLEAR - WHITE CABINET INTERIOR	
Line 39740	Note:	
10Sep15 / 11Sep15		

DOORS AND WINDOWS

Inv.3195	1 - DOOR INTERIOR - SUPPLY AND INSTALL ADDITIONAL 5 PANEL LAM IN LIEU OF THE STANDARD MASTER BEDROOM DOOR	
Line 39745	Note:	
10Sep15 / 11Sep15		

ELECTRICAL

Inv.3195	1 - SUPPLY AND INSTALL CAPPED CEILING LIGHT ROUGH-IN ONLY ON SEPARATE SINGLE SWITCH	
Line 39739	Note: CENTERED TO THE ISLAND AS MUCH AS POSSIBLE	
10Sep15 / 11Sep15		



CONSTRUCTION SUMMARY

Teefy Developments Limited / 9130 Bathurst

Lot/Unit: 51 Phase/Building: 1 Model/Floor Plan: Bedford(22-2)

Inv.3195	1 - FIREPLACE WALL FURR OUT *** TO BE APROX. 10" DEEP X 6' WIDE FROM FLOOR TO CEILING *** TO INCLUDE CABLE AND ELECTRICAL OUTLET FOR FUTURE TV WALL MOUNT (WALL TO REINFORCED FOR TV)	
Line 39748	Note:	
10Sep15 / 11Sep15		

HARDWOOD

Inv.3195	1 - HARDWOOD - UPGRADE 1 - SATIN FINISH GEN. - HOME OAK 4 5/8 INCH X 3/4 INCH - STAINS - BREAKFAST	
Line 39764	Note:	
10Sep15 / 11Sep15		

Inv.3195	1 - HARDWOOD - UPGRADE 1 - SATIN FINISH GEN. - HOME OAK 4 5/8 INCH X 3/4 INCH - STAINS - FAMILY ROOM	
Line 39772	Note:	
10Sep15 / 11Sep15		

Inv.3195	1 - HARDWOOD - UPGRADE 1 - SATIN FINISH GEN. - HOME OAK 4 5/8 INCH X 3/4 INCH - STAINS - DINING ROOM	
Line 39773	Note:	
10Sep15 / 11Sep15		

Inv.3195	1 - HARDWOOD - UPGRADE 1 - SATIN FINISH GEN. - HOME OAK 4 5/8 INCH X 3/4 INCH - STAINS - LANDING 1ST TO 2ND	
Line 39774	Note:	
10Sep15 / 11Sep15		

Inv.3195	1 - HARDWOOD - UPGRADE 1 - SATIN FINISH GEN. - HOME OAK 4 5/8 INCH X 3/4 INCH - UPPER HALL	
Line 39775	Note:	
10Sep15 / 11Sep15		

Inv.3195	1 - HARDWOOD - UPGRADE 1 - SATIN FINISH GEN. - HOME OAK 4 5/8 INCH X 3/4 INCH - STAINS - KITCHEN	
Line 39776	Note:	
10Sep15 / 11Sep15		

HEATING AND AIR CONDITIONING

Inv.3195	1 - GAS LINE - ROUGH-IN ONLY - FOR STOVE TO INCLUDE 110V CODE REQUIREMENT	
Line 39737	Note:	
10Sep15 / 11Sep15		

MISCELLANEOUS

PLUMBING

Inv.3195	1 - SUPPLY AND INSTALL WATERLINE ROUGH-IN TO THE FRIDGE LOCATION (NO HOOK UP)	
Line 39738	Note: LOCATION AS PER SKETCH ATTACHED.	
10Sep15 / 11Sep15		

Tile

Inv.3195	1 - FLOOR TILE - UPGRADE 8 - ENSUITE BATH FLOOR	
Line 39719	Note:	
10Sep15 / 11Sep15		



CONSTRUCTION SUMMARY

Teefy Developments Limited / 9130 Bathurst

Lot/Unit: 51 Phase/Building: 1 Model/Floor Plan: Bedford(22-2)

Inv.3195	1 - FLOOR TILE - UPGRADE 8 - POWDER ROOM FLOOR	
Line 39720	Note:	
10Sep15 / 11Sep15		
Inv.3195	1 - FLOOR TILE - UPGRADE 8 - FOYER FLOOR	
Line 39721	Note:	
10Sep15 / 11Sep15		
Inv.3195	1 - FLOOR TILE - UPGRADE 8 - MAIN BATH	
Line 39722	Note:	
10Sep15 / 11Sep15		
Inv.3195	1 - FLOOR TILE - UPGRADE 5 - MUD / LAUNDRY ROOM IN BASEMENT (ON CONCRETE)	
Line 39723	Note:	
10Sep15 / 11Sep15		
Inv.3195	1 - FLOOR TILE - UPGRADE 5 - BASEMENT BATH FLOOR	
Line 39724	Note:	
10Sep15 / 11Sep15		
Inv.3195	1 - WALL TILE - UPGRADE 8 - ENSUITE BATH SHOWER WITH CEILING	
Line 39725	Note:	
10Sep15 / 11Sep15		
Inv.3195	1 - WALL TILE - UPGRADE 8 - MAIN BATH WITH CEILING	
Line 39762	Note:	
10Sep15 / 11Sep15		

EXTRAS AS PER OFFER

Stainless Steel Fridge, Stove and Dishwasher and front loading washer and dryer in white from Vendors standard samples, no cash value, not transferable. (Supplied only not installed) ** to - arrange delivery call: The Brick commercial sales division at Worksheet Note:	
Rogers Free Services Package includes 6 months of: Highspeed home phone, TV service, and highspeed internet Worksheet Note:	

BEDFORD SIDE

Treeby 51

2448 SQ.FT. / 2278 SQ.FT. WITH OPTIONAL TANDEM GARAGE



\$ OUTLET FOR TV.
 @ CABLE
 T TELEPHONE
 D B&O
 CAPPED
 Ceiling
 Rough-IN

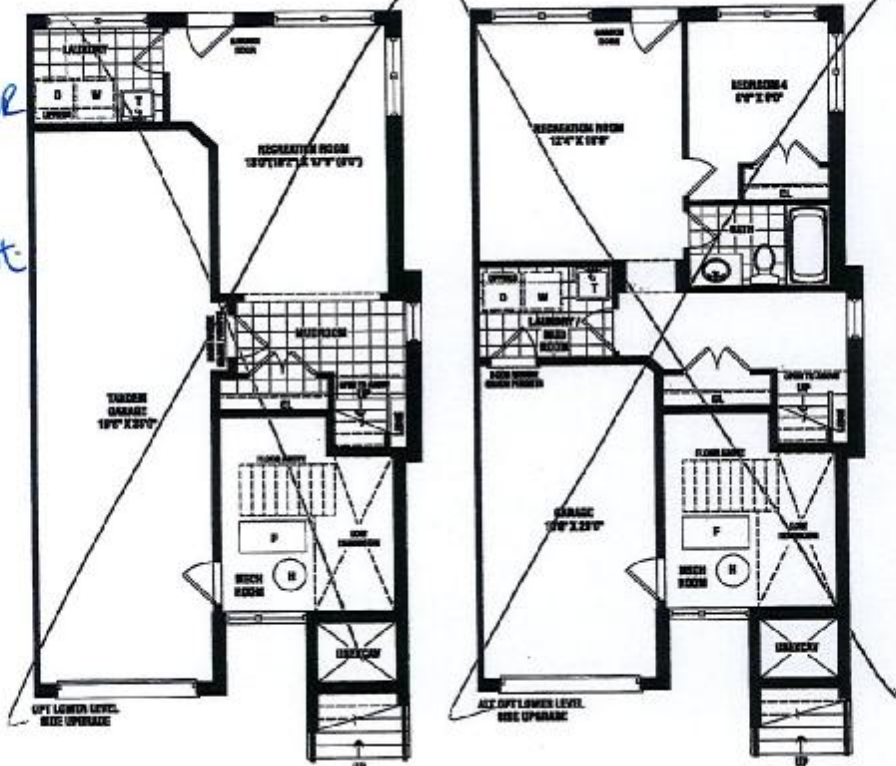

SENATOR
HOMES

SENATOR HOMES
DECOR CENTRE

DATE: SEPT 10TH, 2015

INITIALS: BB

BB

Lot 51

Purchasers: Bahram Mehrfar & Banoo Bozorgchami

Property: 51 of Plan -

Telephone Res. / Bus: /

Project: Teefy Developments Limited

Decor Advisor: Nicole Soares

Model and Elevation: Bedford(22-2)

Layout Changes: ☒ Yes ☐ No

Sketch Attached: ☒ Yes ☐ No

Exterior Colour Scheme:

1. Cabinetry

	Style and Colour	Counter Top	Hardware
Kitchen / Breakfast	BOSTON PAINT: WINTER WHITE	9141 - SQ EDGE	12899
Kitchen Island	BONSTON MAPLE: SHAYLE GREY	9141 - SQ EDGE	12899
Laundry Room	HUMBER: WHITE SUGAR	N/A	9677
Powder Room	BOSTON MAPLE: WINTER WHITE	INUKSHUK GREY P-344-LM	181
Main Bathroom	WESTBROOK PAINT: CANOLLI	BRUNE SLATE 1763-60	9671
Master Ensuite Bathroom	BOSTON MAPLE: WINTER WHITE	INUKSHUK GREY P-344-LM	9671
Second Ensuite Bathroom (If Applicable)			
Lower Level Bathroom	HUMBER: WHITE SUGAR	INUKSHUK GREY P-344-LM	9671

Appliances

Custom Size Fridge

☐ Yes ☒ No

Valance Lighting

☐ Yes ☒ No

Microwave / Range Hood

☒ Yes ☐ No

Cooktop / Rangetop

☐ Yes ☒ No

Built in Wall Oven

☐ Yes ☒ No

Slide-in Range

☒ Yes ☐ No

Comment

2. Flooring

Selection

Foyer	CLASSIC DESIGN 12X24:ZEBRINO (BIANCO/GREY)
Main Hall	SATIN FINISH GEN. HOME 4 5/8" x 3/4": GROTTO
Back Hall	
Breakfast	SATIN FINISH GEN. HOME 4 5/8" x 3/4": GROTTO
Laundry Room	MUST POLISHED 18X18: BROWN
Kitchen	SATIN FINISH GEN. HOME 4 5/8" x 3/4": GROTTO
Powder Room	CLASSIC DESIGN 12X24:ZEBRINO (BIANCO/GREY)
Main Bathroom	GLASSIC DESIGN 12X24: STRIATO ELEGANTE (TAUPE)
Master Ensuite	CLASSIC DESIGN 12X24:ZEBRINO (BIANCO/GREY)
Bathroom (If Applicable)	LOWER LEVEL- MUST POLISHED 18X18: BROWN
Mud Room	MUST POLISHED 18X18: BROWN
Lower Level Hallway	ENDURING QUALITIES: 507 MINERAL GREY
Living Room	
Dining Room	SATIN FINISH GEN. HOME 4 5/8" x 3/4": GROTTO
Family / Great Room	SATIN FINISH GEN. HOME 4 5/8" x 3/4": GROTTO
Den / Library / Study	
Basement Landing (If Applies)	
Lower Landing (If Applicable)	
Upper Landing	SATIN FINISH GEN. HOME 4 5/8" x 3/4": GROTTO
Upper Hall	SATIN FINISH GEN. HOME 4 5/8" x 3/4": GROTTO
Master Bedroom	PAPILIO: SOFT CAMEO 17185
Bedroom #2	PAPILIO: SOFT CAMEO 17185
Bedroom #3	PAPILIO: SOFT CAMEO 17185
Bedroom #4	
Bedroom #5	
Recreation Room	PAPILIO: SOFT CAMEO 17185

Flooring Continued on Page 2

Initial: BB

Page 1 of 3

Purchasers: Bahram Mehrfar & Banoo Bozorgchami

Property: 51 of Plan -

Telephone Res. / Bus: /

Project: Teefy Developments Limited

Decor Advisor: Nicole Soares

Model and Elevation: Bedford(22-2)

2. Flooring - Continued -

Upgrade Underpad	Type	Area
	STANDARD	BEDROOMS & REC ROOM
Carpet on Stairs	Capped	Runner - *Upgrade
Comment		

3. Plumbing Fixtures / Faucets

Kitchen	STD	Second Ensuite		Powder Room	STD
Master Ensuite	STD			Other Room	
Main Bathroom	STD	Lower Level Bathroom	STD		

Comment

4. Wall Tile

	Tile Selection	Listello	Insert	Insert Selection
Main Bathroom	CLASSIC DESIGN 12X24: STRIATO ELEGANTE (TAUPE)	<input type="checkbox"/>	<input type="checkbox"/>	
Master Ensuite				
Tub Deck		<input type="checkbox"/>	<input type="checkbox"/>	
Tub Apron		<input type="checkbox"/>	<input type="checkbox"/>	
Tub Surround		<input type="checkbox"/>	<input type="checkbox"/>	
Shower Stall		<input type="checkbox"/>	<input type="checkbox"/>	
Second Ensuite	CLASSIC DESIGN 12X24: ZEBRINO (BIANCO/GREY)	<input type="checkbox"/>	<input type="checkbox"/>	
Lower Level Bathroom	WEAVE 8X10: TENDER GREY	<input type="checkbox"/>	<input type="checkbox"/>	
		<input type="checkbox"/>	<input type="checkbox"/>	
Kitchen Backsplash		<input type="checkbox"/>	<input type="checkbox"/>	
Complete Backsplash		<input type="checkbox"/>	<input type="checkbox"/>	

Comment

5. Fireplace

	Living Room			Family Room			Other Room - Specify		
	Purchased	As Per Plan	N/A	Purchased	As Per Plan	N/A	Purchased	As Per Plan	N/A
Fireplace Type	<input type="radio"/>	<input type="radio"/>	<input type="radio"/>	<input type="radio"/>	<input checked="" type="radio"/>	<input type="radio"/>	<input type="radio"/>	<input type="radio"/>	<input type="radio"/>
Mantle Type				STANDARD 50" ELECTRIC					
Over Mantle									
Colour / Stain									
Surround									
Hearth									

Comment

FIREPLACE TO BE FURRED OUT AS PER INVOICE

Initial:

BB

Page 2 of 3

Purchasers: Bahram Mehrfar & Banoo Bozorgchami
 Telephone Res. / Bus: /
 Decor Advisor: Nicole Soares

Property: 51 of Plan -
 Project: Teefy Developments Limited
 Model and Elevation: Bedford(22-2)

6. Trim Carpentry

Door Hardware STANDARD LEVER

Interior Trim STANDARD BASEBOARD & CASING

Comment

MASTER BEDROOM: 5 PANEL EQUAL GLASS DOOR LAMI

Interior Doors

☐ 2 Panel Arch Top

☒ 2 Panel Square Top

☐ 6 Panel



Initial for Door Style BB

7. Railings and Pickets

Railing Package STANDARD PLAIN BLACK METAL PICKET

Railing Colour STAINED TO MATCH

Picket Colour STAINED TO MATCH

Wood Stairs ☐ No ☒ Oak

Tread Colour STAINED TO MATCH

Comment

STAIRS TO BE STAINED TO MATCH SATIN FINISH GEN. HOME 4 5/8" x 3/4": GROTTO AS MUCH AS POSSIBLE ***
 PURCHASER IS AWARE THAT THE STAIN WILL NOT BE A 100% TRUE MATCH

8. Plaster Mouldings and Medallions

Foyer

Kitchen/Breakfast

Main Hall

Den/Library

Living Room

Lower Landing

Dining Room

Family Room

Comment

9. Wall Paint

SENATOR WHITE

Smooth Ceilings

☐ First Floor

☐ First Floor incl. Second Floor Hall

☐ First and Second Floor

☒ Throughout

☐ Not Applicable

Trim Paint SENATOR WHITE

10. Additional Comments

11. Disclaimers and Notes

- Colours of all materials are as close as possible to builder's selection, but not necessarily identical due to variances in manufacturing.
- Any extras listed above are null and void unless accompanied by a separate invoice/amendment. Said invoice must be paid in full.
- The Purchaser acknowledges that after Interior Colour Selection form is signed and dated, no further changes will be permitted other than re-selection due to unavailability. BB Purchaser's Initials
- The Purchaser acknowledges reading and accepting the "Senator Homes Decor Centre Disclaimers" form. This document contains other miscellaneous disclaimers.

This Interior Colour Selection is final and approved by:

Purchaser:

Signature: [Signature] Date: sep 10, 15

Signature: _____ Date: _____

Vendor:

[Signature]
 Teefy Developments Limited

BEDFORD - TH-22-2

STD. LAYOUT

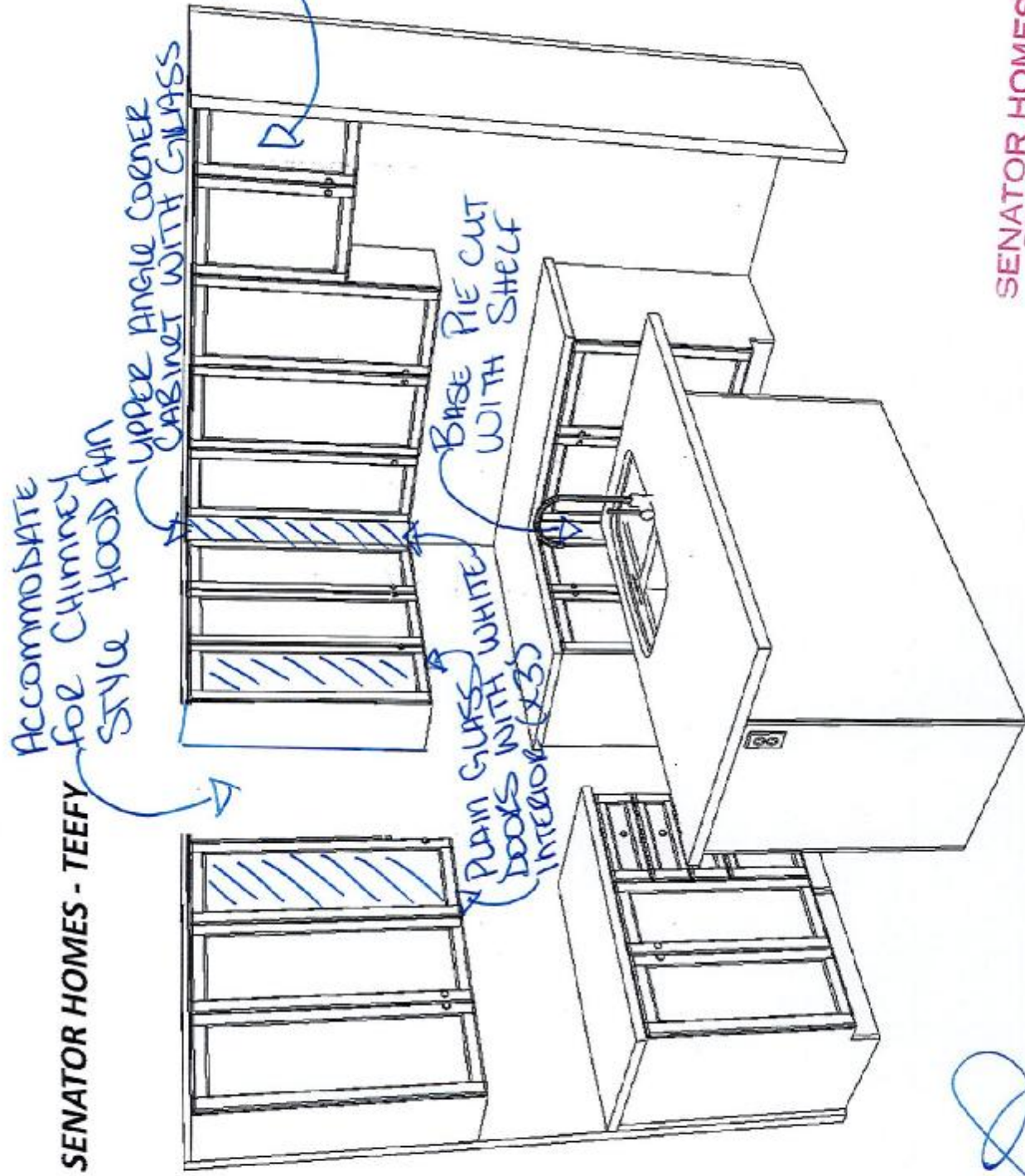

SENATOR HOMES
DECOR CENTRE

DATE: SEPT 10TH 2015

INITIALS: BB

TEEFY VANITIES

TYPICAL VANITY LAYOUTS

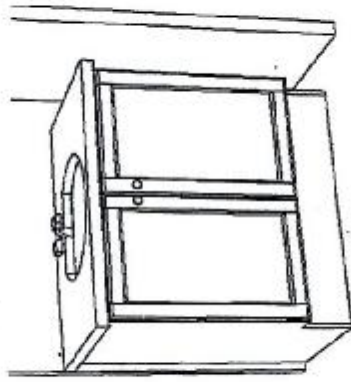

TYPICAL VANITY – 100 CM & UNDER

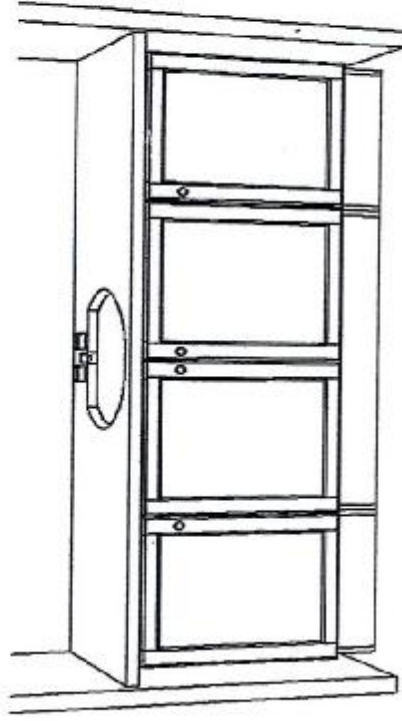

TYPICAL VANITY – 110 CM & OVER

VANITY BANK
OF DRAWERS

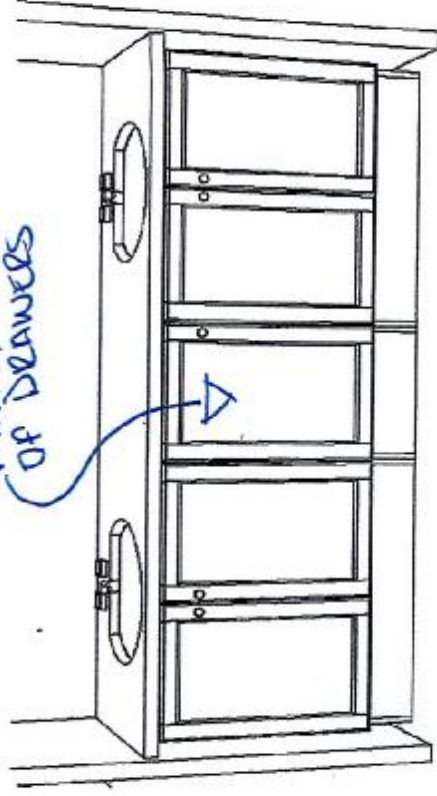

TYPICAL DOUBLE SINK VANITY – 145 CM & OVER

Teefy 51

SENATOR HOMES
DECOR CENTRE

DATE: SEPT 10TH 2015

INITIALS: R.R.

2

36" French Door Bottom-Freezer

800 Series - Stainless Steel B26FT70SN5

Teeby 51



B26FT70SN5
Stainless Steel

The standard-depth French Door refrigerator offers large storage capacity and keeps your produce fresh longer.

Features & Benefits

- VitaFresh™ controls humidity and temperature to keep food fresh.
- Bright ALL LED Lighting shines throughout the entire interior.
- Dispenses fresh-tasting water, crushed ice and cubed ice.
- Stainless Steel Touch Control offers an easy-to-use luxury detail.

General Properties	
Water filter	Yes
Lighting	LED
Defrost process refrigerator section	Frost free
Number of shelves - refrigerator	5
Adjustable shelves - refrigerator	4 half-width
Shelf material - refrigerator	Tempered glass
Type of shelves - refrigerator	Spill-proof glass
Gallon storage bins	2
Humidity control drawer	2
Defrost process freezer section	Automatic
Number of drawers - freezer	2
Ice maker	Yes
Quick ice	Yes
Capacity	
Total unit gross capacity (cu. ft.) - AHAM	25.9 cu. ft.
Refrigerator gross capacity (cu. ft.)	16.9 cu. ft.
Freezer gross capacity (cu. ft.)	9 cu. ft.



Technical Details	
Current (A)	15A
Volts (V)	120V
Frequency (Hz)	60 Hz
Power cord length (in.)	62"
Plug type	120V/3 prong
Dimensions & Weight	
Appliance dimensions (H x W x D) (in.)	69 3/4" x 35 5/8" x 33 13/32"
Required cutout size (H x W x D) (in.)	69" x 36" x 30 1/8"
Net weight (lbs)	245 lbs
Efficiency	
ENERGY STAR® qualified	No
Energy consumption (kWh/yr)	710 kWh
Accessories-Included	
Included	Egg box with lid



For help and assistance with Bosch accessories please visit: www.bosch-home.com/eshop/bosch/us or call 1-800-944-2964 Mon-Fri 9am to 6pm PST Sat 9am to 3pm PST

Notes: All height, width and depth dimensions are shown in inches. Please refer to installation instructions prior to making cutout. BSH reserves the absolute and unrestricted right to change product materials and specifications, at any time, without notice. Consult the product's installation instructions for final dimensional data and other details. ADH/DA/DA Product warranty can be found in accompanying product literature or you may contact your account manager for further details.

Warranty: Bosch warrants that the Product is free from defects in materials and workmanship for a period of three hundred and sixty (360) days from the date of purchase. The foregoing (warranty) begins to run upon the date of purchase, and shall not be started, tolled, extended, or suspended, for any reason whatsoever. This Product is also warranted to be free from cosmetic defects in material and workmanship (such as scratches of stainless steel, paint/porcelain blemishes, chips, dents, or other damage to the finish of the Product, for a period of thirty (30) days from the date of purchase or closing date for new construction. This cosmetic warranty excludes slight color variations due to inherent differences in painted and porcelain parts, as well as differences caused by kitchen lighting, product location, or other a minor factors. This cosmetic warranty specifically excludes any display, floor, "as is", or "if" stock appliances.

For more information on our entire line of products, go to www.bosch-home.com/us or call 1-800-944-2964

© BSH Home Appliances Corporation. All rights reserved. Bosch is a registered trademark of Robert Bosch GmbH.

SENATOR HOMES
DECOR CENTRE
DATE: SEPT 10TH, 2015
INITIALS: BB

LOT 51

36" French Door Bottom-Freezer

800 Series - Stainless Steel B26FT70SWS



Treeby 51

Installation Details

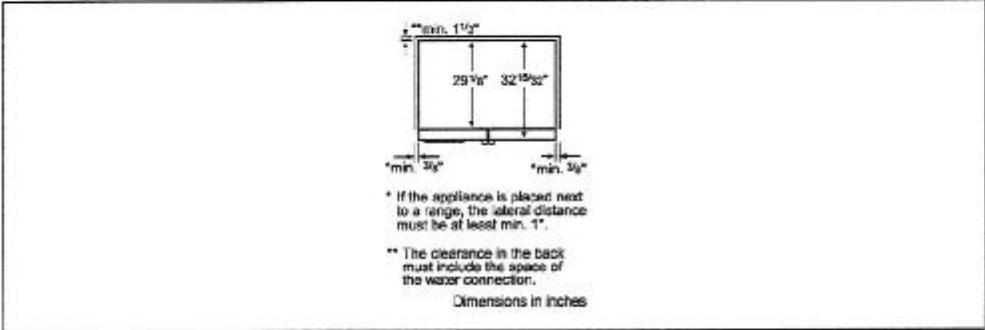
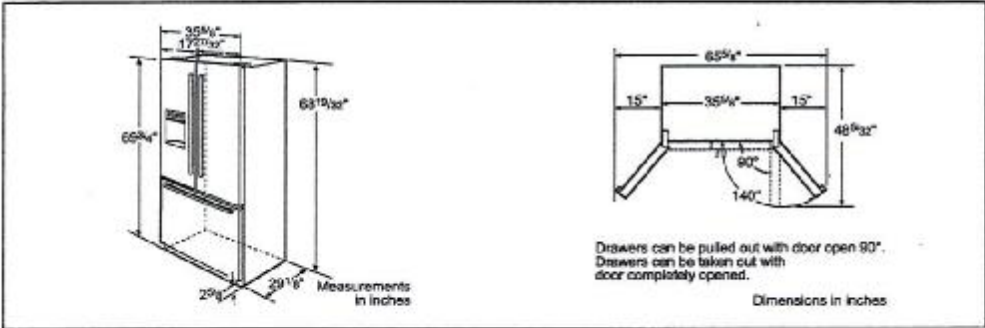

For help and assistance with Bosch accessories please visit: www.bosch-ehome.com/esksp/bosch/us or call 1-800-944-2904 Mon-Fri 9am to 6pm PST Sat 9am to 3pm PST

Notes: All height, width and depth dimensions are shown in inches. Please refer to installation instructions prior to making cutout. BSH reserves the absolute and unrestricted right to change product materials and specifications, at any time, without notice. Consult the product's installation instructions for final dimensional data and other details. Applicable product warranty can be found in accompanying product literature or you may contact your account manager for further details.

Warranty: Bosch warrants that the Product is free from defects in materials and workmanship for a period of three hundred and sixty-five (365) days from the date of purchase. The foregoing timeline begins to run upon the date of purchase, and shall not be stalled, tolled, extended, or suspended, for any reason whatsoever. This Product is also warranted to be free from cosmetic defects in material and workmanship (such as scratches of stainless steel, paint/porcelain blemishes, chips, dents, or other damage to the finish of the Product, for a period of thirty (30) days from the date of purchase or closing date for new construction. This cosmetic warranty excludes slight color variations due to inherent differences in painted and porcelain parts, as well as differences caused by kitchen lighting, product location, or other similar factors. This cosmetic warranty specifically excludes any display, floor, "as is", or "as found" stock appliances.

For more information on our entire line of products, go to www.bosch-home.com/us or call 1-800-944-2904

© BSH Home Appliances Corporation. All rights reserved. Bosch is a registered trademark of Robert Bosch GmbH.

SENATOR HOMES
DECOR CENTRE

DATE: SEPT 10TH, 2015

INITIALS: BB

LOT 51

Q

30" Gas Slide-in Range

800 Series - Stainless Steel HG18054UC

Teeby 51



HG18054UC
Stainless Steel

The full-depth gas slide-in range fits into any freestanding range cutout, and features five burners to cook more dishes at once.

Features & Benefits

The new Bosch slide-in range fits in any freestanding range cutout.

Powerful 18,000 BTU centre burner speeds cooking time.

At 4.8 cu. ft., a large oven capacity accommodates most pots and pans.

Heavy-duty metal knobs for a premium look and feel.

The warming drawer keeps everything you cook warm and ready to serve.

General Properties	
Cooking modes	Variable Broil (three low), Roast, Warm, Proof, Convection, Bake, Convection Roast, Pizza, Sabbath
Cleaning type	Self-clean
Type of grate	Cast iron
Knob material	Fall metal
Drawer type	Warming drawer
Sealed burners	Yes
Oven Performance	
Bake burner power	18,000 BTU
Broil burner power	12,500 BTU
Convection element	N/A
Burner Performance	
Total number of cooktop burners	5
Total connection rating (NG / LP) BTU	53,000 / 44,000
Power of front left burner (NG / LP) BTU	10,000 / 8,000
Power of back left burner (NG / LP) BTU	5,000 / 5,000
Power of centre burner (NG / LP) BTU	18,000 / 17,500
Power of back right burner (NG / LP) BTU	5,000 / 5,000
Power of front right burner (NG / LP) BTU	15,000 / 13,500



Technical Details	
Circuit breaker (A)	15-A
Volts (V)	120 V
Frequency (Hz)	60 Hz
Plug type	US 3 prong
Cord length	78"
Energy source	Gas
Gas type	Natural gas 15 mbar (USA)
Alternative gas type	LP 27.5 mbar (USA)
Dimensions & Weight	
Overall appliance dimensions (HxWxD) (in.)	36 1/2" x 31 1/2" x 24 7/8"
Required cutout size (HxWxD) (in.)	35 1/2" x 30" x 25"
Adjustable range height (in.)	1 1/2"
Net weight (lbs)	243 lbs
Accessories-Included	
Use and care manual, installation guide, mounting hardware, island trim, LP conversion kit, standard racks	
Accessories-Optional	



HEZTR301
30" Telescopic rack



HGZB5301
Low backguard



HEZGR301
Griddle



HEZ298102
Wok ring

For help and assistance with Bosch accessories please call 1-800-944-2964. Month/Day/Year to 6pm EST.

Notes: All height, width and depth dimensions are shown in inches. Please refer to installation instructions prior to making cutout. BSH reserves the absolute and unrestricted right to change product materials and specifications, at any time, without notice. Consult the product's installation instructions for final dimensional data and other details. Applicable product warranty can be found in accompanying product literature or you may contact your account manager for further details.

Warranty: Bosch warrants that the Product is free from defects in materials and workmanship for a period of three hundred and sixty-five (365) days from the date of purchase. The foregoing obligation begins to run upon the date of purchase, and shall not be delayed, tolled, extended, or suspended, for any reason whatsoever. This Product is also warranted to be free from cosmetic defects in material and workmanship (such as scratches of stainless steel, paint/porcelain blemishes, chips, dents, or other damage to the finish of the Product) for a period of thirty (30) days from the date of purchase or closing date for new construction. This cosmetic warranty excludes slight colour variations due to inherent differences in painted and porcelain parts, as well as differences caused by kitchen lighting, product location, or other similar factors. This cosmetic warranty specifically excludes any display, floor, "As Is", or "B" stock appliances.

For more information on our entire line of products, go to www.bosch-home.ca or call 1-800-944-2964.

© 2014 BSH Home Appliances Canada. All rights reserved. Bosch is a registered trademark of Robert Bosch GmbH.

SENATOR HOMES
DECOR CENTRE
DATE: SEPT 10TH, 2015
INITIALS: BP
LOT 51

30" Gas Slide-in Range

800 Series, - Stainless Steel HG8054LC



Teeby 51

Installation Details

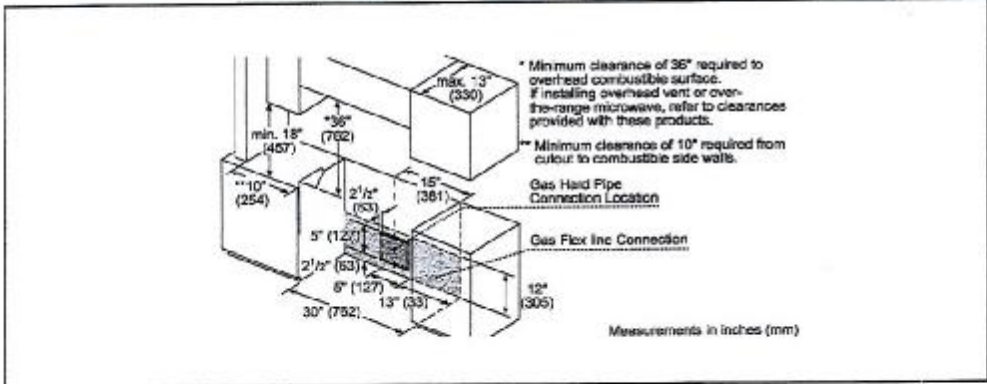
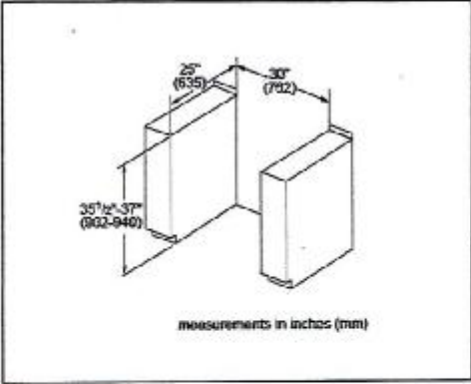
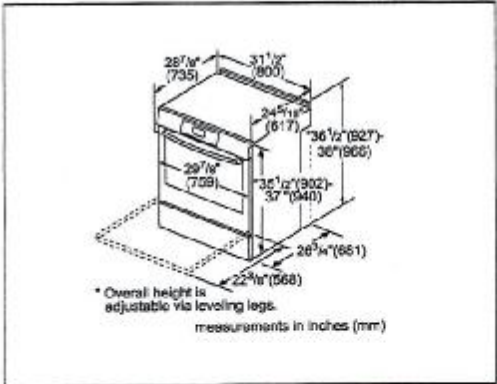

For help and assistance with Bosch accessories please call 1-800-944-2964 Mon-Fri 9am to 6pm EDT
Notes: All heights, widths and depth dimensions are shown in inches. Please refer to installation instructions prior to making cutout. BSH reserves the absolute and unrestricted right to change product materials and specifications, at any time, without notice. Consult the product's installation instructions for final dimensional data and other details. Applicable product warranty can be found in accompanying product literature or you may contact your account manager for further details.
Warranty: Bosch warrants that the Product is free from defects in materials and workmanship for a period of three hundred and sixty-five (365) days from the date of purchase. The foregoing timeline begins to run upon the date of purchase, and shall not be delayed, tolled, extended, or suspended, for any reason whatsoever. This Product is also warranted to be free from cosmetic defects in material and workmanship (such as scratches of stainless steel, dents/punctures in finishes, ch p. dents, or other damage to the finish of the Product) for a period of thirty (30) days from the date of purchase or closing date for new construction. This cosmetic warranty excludes slight colour variations due to inherent differences in painted and porcelain parts, as well as differences caused by kitchen lighting, product location, or other similar factors. This cosmetic warranty specifically excludes any display, floor, "As Is", or "S" stock appliances.
For more information on our entire line of products, go to www.bosch-home.us or call 1-800-944-2964
© 2014 BSH Home Appliances Canada. All rights reserved. Bosch is a registered trademark of Robert Bosch GmbH.

SENATOR HOMES
DECOR CENTRE
DATE: SEPT 10TH, 2015
INITIALS: BB
LOT 51 Q

24" Bar Handle Dishwasher

500 Series - Stainless Steel SHX65T55UC



Teefy 51



SHX65T55UC
Stainless Steel

The new 3rd rack now offers 30% more loading area. Perfect for ramekins, cooking utensils and extra-long silverware.

Features & Benefits

44 dBA - Quietest dishwasher brand.

New 3rd rack adds versatility and offers 30% more loading capacity.

Detergent tray optimizes detergent dissolving.

Infolight® shines on the floor so you know the dishwasher's running.

RackMatic® offers 3 height levels, for 9 possible rack positions.

General Properties	
Number of wash cycles	5
Number of options	5
dBA	44
Third rack	Standard
Rack adjustability	RackMatic®
Tub material	Stainless steel
Control type	Buttons
Concealed heating element	Yes
Leak protection system	24/7 AquaStop®
Water softener	No
Five-level wash	Yes
ChildLock	No
Special features	Infolight®
Efficiency	
Water usage per cycle	2.9
Energy efficiency class	Tier 1
ENERGY STAR® qualified	Yes
Total annual energy consumption (kWh)	259
Total annual water consumption (g)	624
Capacity	
Number of place settings	16

Technical Details	
Watts (W)	1300 W
Current (A)	12 Amps
Volts (V)	120 V
Frequency (Hz)	60 Hz
Power cord length	56.5/16"
Minimum water pressure (lb/sin)	14
Length inlet hose (in)	60"
Length outlet hose (in)	79"
Dimensions & Weight	
Overall appliance dimensions (HxWxD) (in)	33 7/8" x 23 3/16" x 23 3/4"
Required cutout size (HxWxD) (in)	32 7/8" x 23 5/8" x 24"
Adjustable feet	Yes
Net weight (lbs)	91 lbs
Accessories-Optional	
Dishwasher Supply and Drainage Hose Extension 76 3/4"	SGZ1010UC
Dishwasher 3-Prong Power Cord 65 7/8"	SMZPC002UC
Dishwasher Accessory Kit	SMZ5000
Duo-Flex Silverware Basket	SMZ4000UC



For help and assistance with Bosch accessories please visit: www.bosch-eshop.com/eshop/bosch/us or call 1-800-944-2994 Mon-Fri 9am to 6pm PST Sat 9am to 3pm PST

Notes: All height, width and depth dimensions are shown in inches. Please refer to installation instructions prior to making cutouts. BSH reserves the absolute and unrestricted right to change product materials and specifications, at any time, without notice. Consult the product's installation instructions for final dimensional data and other details. Applicable product warranty can be found in accompanying product literature or you may contact your account manager for further details.

Warranty: Bosch warrants that the Product is free from defects in materials and workmanship for a period of three hundred and sixty-five (365) days from the date of purchase. The foregoing provision begins to run upon the date of purchase, and shall not be stalled, tolled, extended, or suspended, for any reason whatsoever. This Product is also warranted to be free from cosmetic defects in material and workmanship (such as scratches of stainless steel, paint/porcelain blemishes, chip, dents, or other damage to the finish of the Product, for a period of thirty (30) days from the date of purchase or closing date for new construction. This cosmetic warranty excludes slight color variations due to inherent differences in painted and porcelain parts, as well as differences caused by kitchen lighting, product location, or other similar factors. This cosmetic warranty specifically excludes any display, floor, "as is", or "B" stock appliances.

For more information on our entire line of products, go to www.bosch-home.com/us or call 1-800-944-2994

© BSH Home Appliances Corporation. All rights reserved. Bosch is a registered trademark of Robert Bosch GmbH.

SENATOR HOMES
DECOR CENTRE

DATE: SEPT 10TH, 2015

INITIALS: BR

LOT 51

24" Bar Handle Dishwasher

500 Series - Stainless Steel SIX65T55UC



Teefy 51

Installation Details

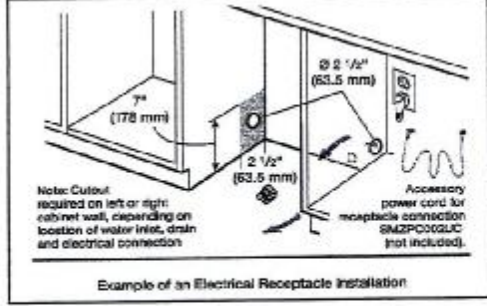
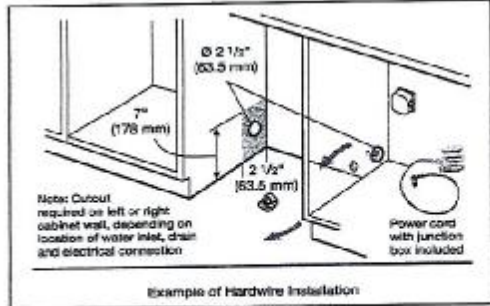
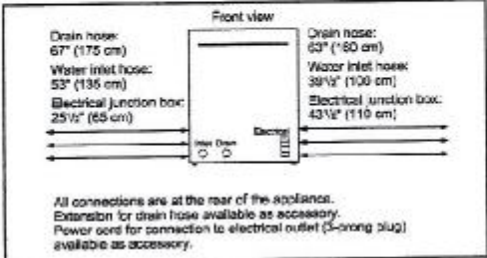
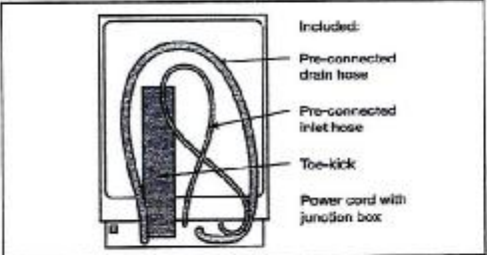
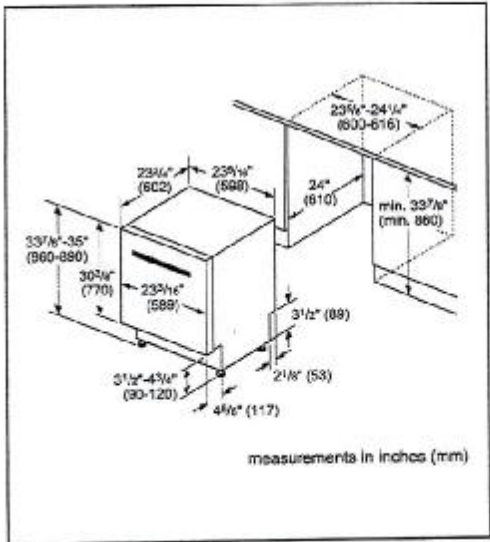

For help and assistance with Bosch accessories please visit: www.bosch-eshop.com/eshop/bosch/us or call 1-800-944-2504 Mon-Fri 9am to 5pm PST Sat 9am to 3pm PST
Notes: All height, width and depth dimensions are shown in inches. Please refer to installation instructions prior to making cutout. BSH reserves the absolute and unrestricted right to change product materials and specifications, at any time, without notice. Consult the product's installation instructions for final dimensional data and other details. Applicable product warranty can be found in accompanying product literature or you may contact your account manager for further details.
Warranty: Bosch warrants that the Product is free from defects in materials and workmanship for a period of three hundred and sixty-five (365) days from the date of purchase. The foregoing warranty begins to run upon the date of purchase, and shall not be stalled, tolled, extended, or suspended, for any reason whatsoever. This Product is also warranted to be free from cosmetic defects in material and workmanship (such as scratches on stainless steel, paint/burrs on themselves, chips, dents, or other damage to the finish of the Product, for a period of thirty (30) days from the date of purchase or closing date for new construction. This cosmetic warranty excludes slight color variations due to inherent differences in painted and porcelain parts, as well as differences caused by kitchen lighting, product location, or other similar factors. This cosmetic warranty specifically excludes any display, floor, "as is", or "B" stock appliances.
For more information on our entire line of products, go to www.boschhome.com/us or call 1-800-944-2504
© 2014 Home Appliances Corporation. All rights reserved. Bosch is a registered trademark of Robert Bosch GmbH.

SENATOR HOMES
DECOR CENTRE

DATE: SEPT 10TH, 2015

INITIALS: BB

LOT 51

24" Bar Handle Dishwasher

500 Series™ Stainless Steel SHX65T55UC



Teelby 51

Installation Details

Note: Plumbing installations will vary - refer to local codes. Drain hose included is 79\"/>

Always use the approved drain hose extension kit (SGZ1010UC).

Ensure a portion of the drain hose is raised between min. 20\"/>

For help and assistance with Bosch accessories please visit www.bosch-shop.com/enhelp/bosch/us or call 1-800-944-2964. Max-Fill Sam to Open PST Set Cam to 30cm PST

Notes: All height, width and depth dimensions are shown in inches. Please refer to installation instructions prior to making cutout. BSH reserves the absolute and unrestricted right to change product materials and specifications, at any time, without notice. Consult the product's installation instructions for final dimensional data and other details. Applicable product warranty can be found in accompanying product literature or you may contact your account manager for further details.

Warranties: Bosch warrants that the Product is free from defects in materials and workmanship for a period of three hundred and sixty-five (365) days from the date of purchase. The foregoing timeframe begins to run upon the date of purchase, and shall not be stalled, tolled, extended, or suspended, for any reason whatsoever. This Product is also warranted to be free from cosmetic defects in material and workmanship (such as scratches of stainless steel, paint/porcelain blemishes, chip, dents, or other damage to the finish of the Product, for a period of thirty (30) days from the date of purchase or closing date for new construction. This cosmetic warranty excludes slight color variations due to inherent differences in painted and porcelain parts, as well as differences caused by kitchen lighting, product location, or other similar factors. This cosmetic warranty specifically excludes any display, floor, "As Is", or "S" stock appliances.

For more information on our entire line of products, go to www.bosch-home.com/us or call 1-800-944-2964.

© BSH Home Appliances Corporation. All rights reserved. Bosch is a registered trademark of Robert Bosch GmbH.

SENATOR HOMES
DECOR CENTRE
DATE: SEPT 10TH, 2015
INITIALS: BR
LOT 51