

HIGHCASTLE HOMES - COLOUR SCHEDULE

Purchaser: JONATHAN SEBASTIAN GILBERT

Telephone Res. / Bus: /

Decor Advisor: Caroline Rajcsanyi

Property: 16 Block CPhase: 1 of Plan -

Project: 2174372 ONTARIO LTD.

Model and Elevation: The Banner (T-2)

KITCHEN AND VANITIES

	Cabinet	Counter	Hardware
Kitchen	Lv1 - Hudson- Ontario White	Lv1 - GR-Bianco Sardo (Grigio)	12881
Main Bathroom	Lv1 - Manchester Oak - Shale Grey CL	Calcutta Marble 4925K-07	12881
Ensuite Bathroom	Lv1 - Manchester Oak - Shale Grey CL	Calcutta Marble 4925K-07	12881
Opt. Breakfast Bar	Counter Height/Flush	Kitchen Hood Fan	Accommodate for over-range microwave
		Kitchen Upper Height	77 cm - Standard

Stove opening – if not specified will be set to builders standard opening of approximately 30 in width  
Fridge Opening – if not specified will be set to builders minimum opening of approximately 33 x71 height (townhouses)  
- if not specified will be set to builders minimum opening of approximately 36 x 71 height (singles)

Counter top Edge

Kitchen

Single Edge (3/4") Top Bevelled

Opt. Kitchen Extras

PARQUET / HARDWOOD OR BROADLOOM

Kitchen / Breakfast	N/A	Master Bedroom	Lv1 -TXP135 Lv1 - T15
Great Room	N/A	Bedroom 2	Lv1 -TXP135 Lv1 - T15
Living / Formal Room	Lvl 2 - Concerto, 1/2x5x48in, Tenor Oak, #54360205	Bedroom 3	Lv1 -TXP135 Lv1 - T15
Dining Room	Lvl 2 - Concerto, 1/2x5x48in, Tenor Oak, #54360205	Bedroom 4	N/A
Family Room	N/A		
Main Hall	Lvl 2 - Concerto, 1/2x5x48in, Tenor Oak, #54360205	Grd Fl Landing	Lv1 -TXP135 Lv1 - T15
Main Stairs	Lv1 -TXP135 Lv1 - T15	Grnd Fl Stairs	Lv1 -TXP135 Lv1 - T15
Upper Hall	Lv1 -TXP135 Lv1 - T15	Grd Fl Hall	Lvl 2 - Concerto, 1/2x5x48in, Tenor Oak, #54360205
Com. Centre/Home Office	N/A	Basement	N/A
Main Stair Landing	Lv1 -TXP135 Lv1 - T15	Basement Landing	N/A
Library/Den/Study	N/A	Basement Stairs	NA
In Law Suite	N/A		

Carpet Runner ☐ Yes ☒ No

Underpad Main Floor	Underpad 2nd Floor	Underpad Main Stairs
NA	Lv1 Underpad-standard	Lv1 Underpad-standard

Opt. Flooring Extras

FLOOR AND WALL TILES

	Floor Tile	Wall Tile		
Front Foyer	1-13x13, Serpentine White			
Main Hall	N/A			
Kitchen/Breakfast	1-13x13, Serpentine White	Kitchen Backsplash	N/A	<input type="checkbox"/> <input type="checkbox"/>
Powder Room	1-13x13, Serpentine White	Pwdr Wall if Applicable	N/A	<input type="checkbox"/> <input type="checkbox"/>
Laundry				

	Floor	Tub Wall	Shower Wall	Deck Skirt	Deck Splash	Decor	Listello
Main Bathroom	1-13 X 13 Malena Ice	1-8x10,Malena Ice	N/A	N/A	NA	<input type="checkbox"/>	<input type="checkbox"/>
Master Ens	1-13 X 13 Malena Ice	1-8x10, Weave, Tender Grey	N/A	N/A	NA	<input type="checkbox"/>	<input type="checkbox"/>
						<input type="checkbox"/>	<input type="checkbox"/>
						<input type="checkbox"/>	<input type="checkbox"/>
						<input type="checkbox"/>	<input type="checkbox"/>
						<input type="checkbox"/>	<input type="checkbox"/>

Shower - Upgrade Floor

Opt. Tile Extras

HIGHCASTLE HOMES - COLOUR SCHEDULE

Purchaser:  
Telephone Res. / Bus:  
Decor Advisor:

JONATHAN SEBASTIAN GILBERT  
/  
Caroline Rajcsanyi

Property: 16 Block CPhase: 1 of Plan -  
Project: 2174372 ONTARIO LTD.  
Model and Elevation: The Banner (T-2)

PLUMBING / FAUCETS

Powder Room  
Main Bath  
Master Ensuite  
2nd Ensuite  
R.I. Bath

Standard  
Standard  
Standard  
N/A  
2 PC ROUGH IN - GROUND FLOOR

Laundry

Standard

Kitchen Sink  
Kitchen Faucet

Undermount  
Upgrade

Drain for 2nd floor Laundry  
Waterline for fridge

☐ Yes  
☒ No

☒ Yes  
☐ No

Supply and install all toilet paper holders, towel bars and soap dishes

☒ Yes  
☐ No

Whirlpool

Opt. Plumbing Extras

PAINTING

Wall Colour  
22 Warm Grey

Trim Colour  
Standard

Railing Colour  
Natural

Pickets Colour  
Natural

Stair Colour  
Carpet On Stair

Opt. Paint Extras

MISCELLANEOUS

Railing Style  
Opt. Garage Door  
Interior Doors

RAILING - STANDARD - 1 5/16in oak picket, 2 1/2in oak handrail and 2 3/4in oak post.  
Yes-Grade Permitting  
Standard - Classique

Opt. Side Door  
Int. Door Hardware  
Trim Style

No  
Straight Pewter Lever  
1 - 2 3/4in Case & 4in Baseboard

Stair Type  
Ext. Door Hardware  
Pewter Exterior package

Standard  
Cold Cellar

Smooth Ceiling 1st Floor  
Smooth Ceiling 2nd Floor  
Supply and Install Standard Mirrors

☐ Yes  
☒ No

☐ Yes  
☒ No

☒ Yes  
☐ No

Basement Windows Upgrade

☐ Yes  
☒ No

Misc.

HEATING

Fireplace

Type

Mantle

Surround

Hearth

Air Conditioning  
Hood Fan Duct  
Gas Provisions for Dryer  
Gas Provisions for Stove

☒ Yes  
☐ No

☒ 6 inch  
☐ 8 inch  
☐ 10 inch

☐ Yes  
☒ No

☐ Yes  
☒ No

Gas Provisions for BBQ  
Humidifier

☐ Yes  
☒ No

☐ Yes  
☒ No

Exterior Colour Scheme:

Pre-selected By Vendor

NOTE: The Purchaser(s) agree(s) that:

a) Colours of materials are as close as possible to Vendor's selections, but not necessarily identical due to variances in manufacturing or manufacturers.

b) Purchaser(s) has checked and acknowledges accuracy of the above selections. Where omissions occur on the original colour selection sheet Purchaser(s) acknowledge that the Builder's selection will be final.

c) Upgrades or extras listed on this schedule will not be deemed part of the Agreement of Purchase and Sale. Any such upgrades or extras shall be null and void unless accompanied by a separate invoice and amendment. Said invoice must be paid in f

d) The Purchaser(s) further agrees that in the event that the Vendor has preselected colours prior to the purchase of the house, the prescribed colours are final not withstanding that the Purchaser may have completed a colour selection schedule

e) The Purchaser(s) Acknowledges that once this colour schedule is signed and dated, no changes, additions or deletions will be permitted other than re-selection due to unavailability.

A \$350 (Per item) administration fee will apply to the above exceptions (if the change is possible).

This Interior Colour Selection is final and approved by:

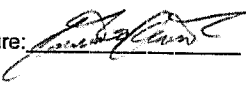
Signature: 

Date: 03/02/2021

Printed 3/2/2021 11:36:21

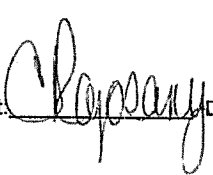
Builder's Agent:  Date: Mar 2, 2021



## Highcastle Homes Décor Centre Disclaimers

Lot#: 16 Block C Model: The Banner (T-2) in Orchards Enclave - 2174372 ONTARIO LTD.

PURCHASER: JONATHAN SEBASTIAN GILBERT

TEL:

*Through years of doing business, we at Highcastle Homes have encountered issues beyond our control. The following disclaimers apply to all instances of Purchaser's Extras forms and all Interior Colour Scheme forms.*

### Fireplaces

Fireplace Marble: Due to the many variables that can affect the pattern and/or design, frequently the marble installed on the fireplace will not be identical to the samples. We will make every attempt to come as close to the samples as possible, but cannot be responsible for results which differ from the samples.

### Ceramic Floor Tile

Many variables including variegation can affect tile colour, pattern and/or design which mean installed tiles may not be identical to the samples. We will make every attempt to come as close as possible, but cannot be responsible for results which differ from the samples.

### Hardwood Flooring

The purchaser is advised that cupping and shrinkage are characteristics of hardwood flooring normal appearing some time after installation, and no warranty is provided by the flooring supplier with respect to such cupping and shrinkage. The vendor agrees to install any hardwood flooring ordered by the purchaser in good and workmanlike manner, but shall not be responsible for, and is hereby released by the purchaser from responsibility and liability for cupping and shrinkage of hardwood flooring.

Shrinking and expanding/cupping of the hardwood floors may occur if the humidity levels in the home are not kept at industry recommendations. If the hardwood floors shrink or expand due to the homeowner not complying with these levels, the hardwood floor will no longer be under warranty and it will be the homeowner's responsibility to repair the flooring.

### Stain Colours

Due to many variables that can affect the outcome of a stain colour on wood, staircases, railings, and fireplaces, will not be identical to samples. Factors such as density, age humidity, air temperature, and the uniqueness of each piece of wood can result in wide variations in darkness or lightness. We will make every attempt to come as close to the sample as possible, but cannot be responsible for results which differ from the samples.

Stain on pre-finished hardwood floors will not be an exact match to the stain colours available on stairs, pickets and rails. The purchaser is responsible for choosing the stain on these areas to their satisfaction.

### Appliances

All fridge openings are set to builder's standard width. Please advise Décor Centre at time of colour appointment if custom sizing of cabinets is required for any built - in appliances. The purchaser is responsible for costs and fees associated with changes to pre-manufactured kitchens made subsequent to colour appointments.

### Kitchen Cabinets

The kitchen you order/purchase will undoubtedly contain slight colour variations. The degree of these variations is virtually impossible to determine before the kitchen is installed in its intended location. The amount of and type of lighting will also affect various highlights in the finish. Note: No two pieces of wood are identical. Variations in colour tone and grain patterns make a perfect colour match virtually impossible. It is generally agreed that these variations add to the natural beauty of a wood kitchen.

Shrinking and expanding of the kitchen cabinets may occur if the humidity levels in the home are not kept at industry recommendations. If the cabinets shrink or expand due to the homeowner not complying with these levels, the cabinets will no longer be under warranty and it will be the homeowner's responsibility to repair the cabinets.

### Plaster Mouldings and Medallions

Plaster mouldings will not be installed in open to above areas or areas with 2 storey elements.

### Metal Spindles

Due to the characteristics of wrought iron railing production, it is possible for the wrought iron to develop a scale effect. This scale may or may not be totally covered during the painting process. In effect, once the wrought iron picket is painted, the paint may in effect amplify the iron scale depending on the colour chosen. This is a natural effect of wrought iron and should not be construed as a defect or damage.

I hereby acknowledge reading and understanding the above copy and will not hold Highcastle Homes responsible for any issues in relation to above.

Purchasers Signature(s):

Date:

03/02/2021

Lot 16.  
Bik C

# STONE EDGE PROFILES

Approx 2CM or  $\frac{3}{4}$ " Standard Edge

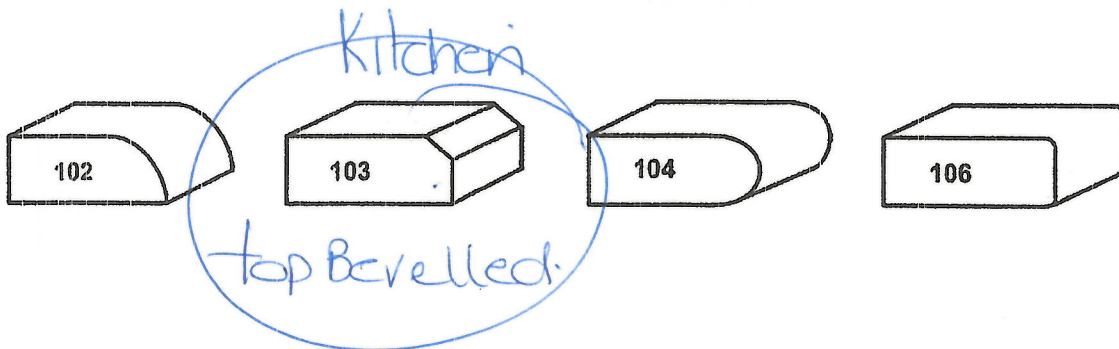

1<sup>st</sup> UPGRADE

Approx 4CM or 1.5" - SEAMS WILL BE VISIBLE

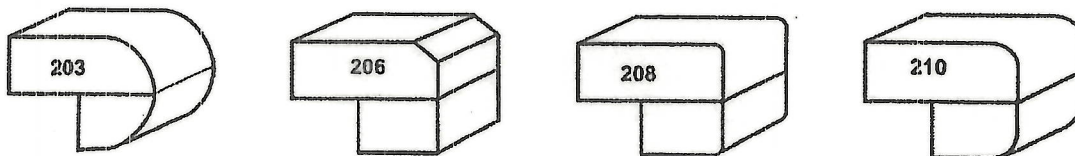

2<sup>nd</sup> UPGRADE

Approx 4CM or 1.5" - SEAMS WILL BE VISIBLE

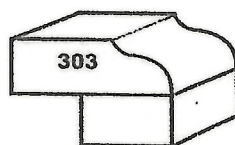

Sign

*[Handwritten signature]*

Date

March 2<sup>nd</sup> 2021



Endge

Specifications

Dimensions

Assembled Depth (in inches)	33.5	Assembled Height (in inches)	70
Assembled Weight (in lbs)	311	Assembled Width (in inches)	35.75
Packaged Depth (in inches)	36.125	Packaged Height (in inches)	76.625
Packaged Weight (in lbs)	323	Packaged Width (in inches)	38

L0716, BKC

Dishwasher

Specifications

Dimensions

Assembled Depth (in inches)	24.63	Assembled Height (in inches)	33.875
Assembled Weight (in lbs)	97	Assembled Width (in inches)	23.875
Packaged Depth (in inches)	29.5	Packaged Height (in inches)	35
Packaged Weight (in lbs)	112.4	Packaged Width (in inches)	26

Lori, Bike

Range.

Specifications

Dimensions

Assembled Depth (in inches)	28.4375	Assembled Height (in inches)	46.5
Assembled Weight (in lbs)	162.2	Assembled Width (in inches)	29.9
Packaged Depth (in inches)	30.063	Packaged Height (in inches)	50.625
Packaged Weight (in lbs)	190.479	Packaged Width (in inches)	33.063

Microwave

Specifications

Dimensions

Packaged Depth (in inches)	19.375	Packaged Height (in inches)	20.813
Packaged Weight (in lbs)	67.24	Packaged Width (in inches)	33.375



Lot 16.  
BKC.

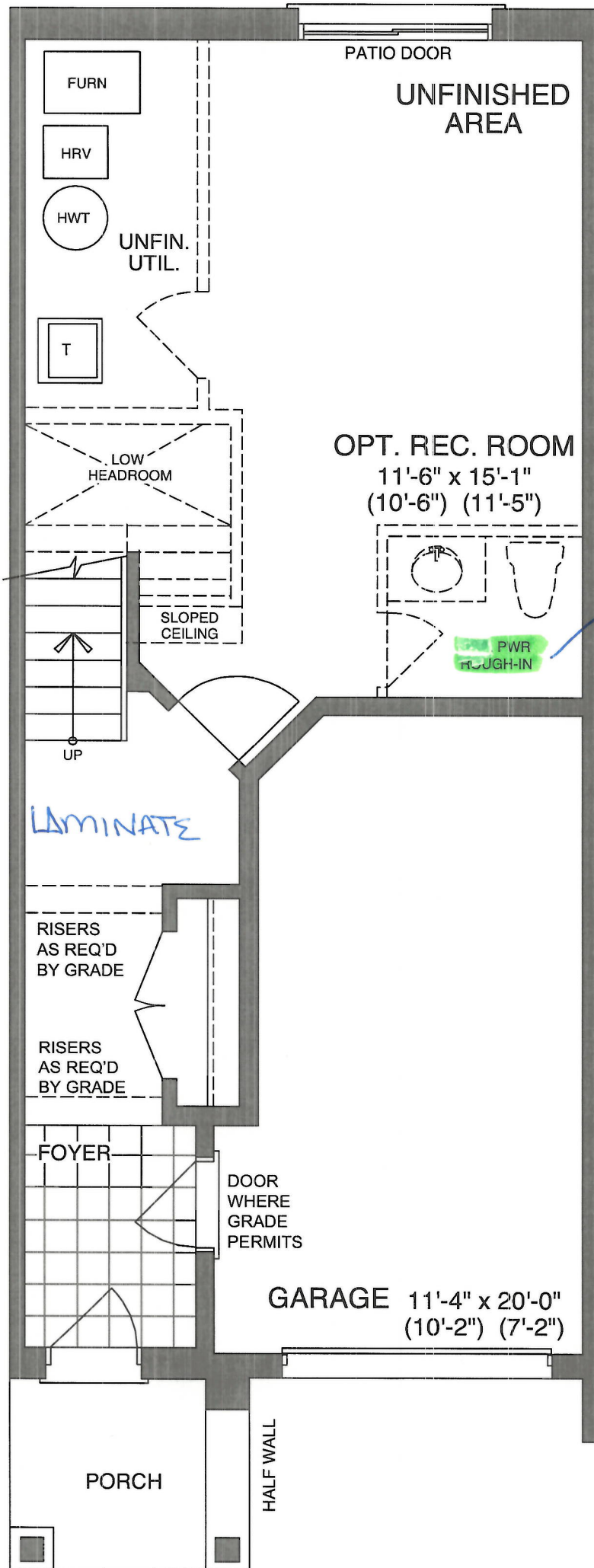

GROUND FLOOR - ELEV B

Sign  
[Signature]

Date  
March 2nd 2021

Lot 16  
BIK C.

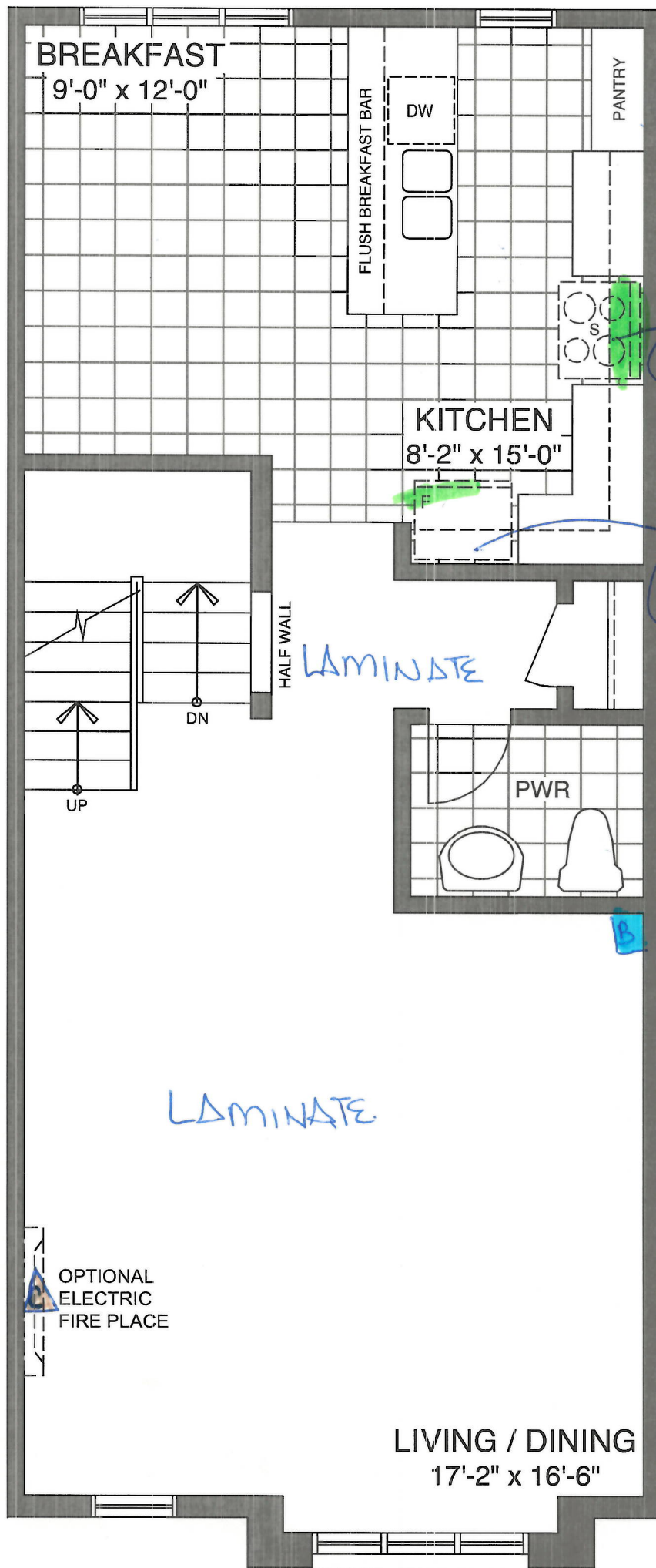

B Bell  
C Cable

over the  
range micro

waterline  
for fridge

LAMINATE

LAMINATE

MAIN FLOOR - ELEV B1



Sign  
[Signature]

Date

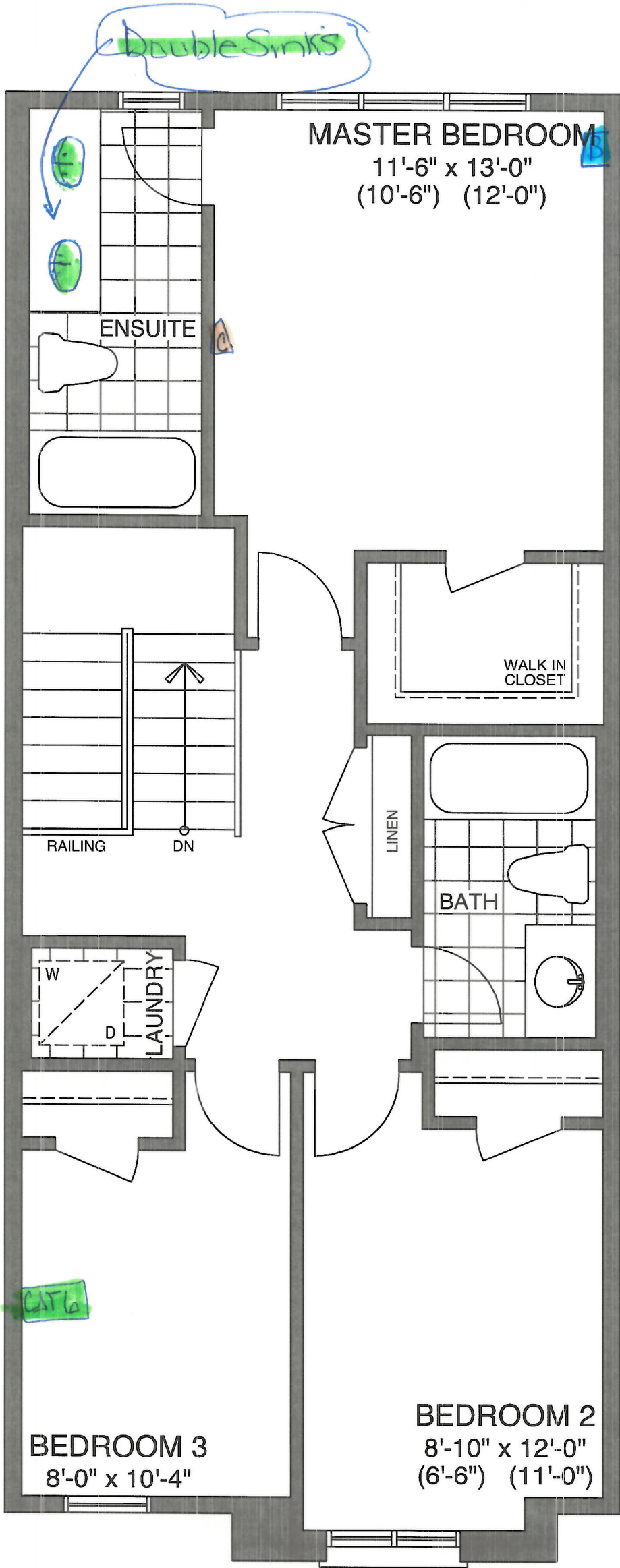
March 8<sup>th</sup> 2021



Lot 16.  
BIKC.

 Bell  
 Cable

C176

**THIRD FLOOR - ELEV B1**

Sigi  

Dabe  
March 2nd 2021





CONSTRUCTION SUMMARY				
Orchards Enclave - 2174372 ONTARIO LTD.				
PURCHASER: JONATHAN SEBASTIAN GILBERT				TEL:
LOT / PHASE	REG. PLAN #	HOUSE TYPE		CLOSING DATE
16 Block C / 1		The Banner (T-2)		07-Dec-21

Agreement of Purchase and Sale

Central air conditioner (builders standard line) <i>Worksheet</i> Note:	
Laminate Flooring in leiu of carpet on main floor, as per plan, from builders standard samples. <i>Worksheet</i> Note:	
Granite kitchen countertops, (as per plan-from builders standard samples). <i>Worksheet</i> Note:	

4) PLUMBING

1 - SINK - KITCHEN - UNDERMOUNTED (RECTANGULAR SQUARE - DOUBLE EQUAL BOWL) <i>02Mar21</i> Note: 11,555/37072	
1 - KITCHEN - ALIGN 7565 CHROME, 1 HOLE APPLICATION <i>02Mar21</i> Note: 11,555/37070	
1 - WATER LINE - FRIDGE - ROUGH IN ONLY <i>02Mar21</i> Note: 11,555/37069	
1 - SINK - WASHROOM VANITY - ADDITIONAL (INCLUDES STANDARD FAUCET) <i>02Mar21</i> Note: 11,555/37068	
1 - 2 PIECE ROUGH IN BASEMENT <i>02Mar21</i> Note: 11,555/37066	

5) ELECTRICAL

1 - NETWORK JACK - ADDITIONAL - CAT6E ROUGH-IN - BEDROOM #3 <i>02Mar21</i> Note: 11,555/37062	
---	--

6) FLOORING & WALL TILE

1 - LAMINATE FLOORING - LEVEL 2 - UPGRADE FROM LEVEL 1 LAMINATE - MAIN HALL (UPGRADE FROM HARDWOOD) - <i>02Mar21</i> Note: 11,555/37065	
1 - LAMINATE FLOORING - LEVEL 2 - UPGRADE FROM LEVEL 1 LAMINATE - LIVING/DINING ROOM (UPGRADE FROM HARDWOOD) - <i>02Mar21</i> Note: 11,555/37064	

9) CABINETRY

1 - APPLIANCE CABINETS - HOOD FAN - ACCOMMODATE FOR MICROWAVE/HOOD FAN COMBO (SUPPLY SPECS) INCLUDES ELECTRICAL DEDICATED LINE <i>02Mar21</i> Note: 11,555/37063	
--	--

TRIM DOORS AND HARDWARE - INTERIOR

1 - DOOR HANDLE - UPGRADE TO PEWTER STRAIGHT LEVERS <i>02Mar21</i> Note: 11,555/37071	
---	--