

HIGHCASTLE HOMES - COLOUR SCHEDULE

Purchasers:
Telephone Res. / Bus:
Decor Advisor:

SATISH KUMAR POLUMATI & SOWMYA MOKA
/
Caroline Rajcsanyi

Property: 3Phase: Orchards of Plan - 40M-2627
Project: 2174372 Ontario Ltd.
Model and Elevation: Spencer (40-4) Elev B

KITCHEN AND VANITIES

	Cabinet	Counter	Hardware
Kitchen	Lv2 - Silk Touch Slab - Twilight Grey	Lv1 - GR-Bianco Sardo (Grigio)	12881 Handle
Main Bathroom	NA	N/A	N/A
Ensuite Bathroom	Lv1 - Slab LPL - Stainless	Calcutta Marble 4925K-07	12881 Handle
Shared Ensuite	Lv1 - Slab LPL - Stainless	Calcutta Marble 4925K-07	12881 Handle
Ensuite 2	Lv1 - Slab LPL - Stainless	Calcutta Marble 4925K-07	12881 Handle
Opt. Breakfast Bar	Counter Height/Flush	Kitchen Hood Fan	Purchaser to supply after closing/standard electrical i
		Kitchen Upper Height	100 cm

Stove opening – if not specified will be set to builders standard opening of approximately 30 in width
 Fridge Opening – if not specified will be set to builders minimum opening of approximately 33 x71 height (townhouses)
 - if not specified will be set to builders minimum opening of approximately 36 x 71 height (singles)

Counter top Edge
Kitchen

Double Edge (1 1/2") Top Bevelled

Opt. Kitchen Extras

PARQUET / HARDWOOD OR BROADLOOM

Kitchen / Breakfast	Oak Strip Lauzon Essential Solid 2 1/4" x 3/4"-Natural	Master Bedroom	Lv1 -TXP135 Lv1 - T04
Great Room	Oak Strip Lauzon Essential Solid 2 1/4" x 3/4"-Natural	Bedroom 2	Lv1 -TXP135 Lv1 - T04
Living / Formal Room	N/A	Bedroom 3	Lv1 -TXP135 Lv1 - T04
Dining Room	Oak Strip Lauzon Essential Solid 2 1/4" x 3/4"-Natural	Bedroom 4	Lv1 -TXP135 Lv1 - T04
Family Room	N/A		
Main Hall	N/A		
Main Stairs	Oak		
Upper Hall	Oak Strip Lauzon Essential Solid 2 1/4" x 3/4"-Natural		
Com. Centre/Home Office	N/A	Basement	N/A
Main Stair Landing	N/A	Basement Landing	N/A
Library/Den/Study	Oak Strip Lauzon Essential Solid 2 1/4" x 3/4"-Natural	Basement Stairs	Paint Grade (Grey)
In Law Suite	N/A		

Carpet Runner
 ☐ Yes
 ☒ No

Underpad Main Floor	Underpad 2nd Floor	Underpad Main Stairs
NA	Lv1 Underpad-standard	NA

Opt. Flooring Extras

FOYER AND MAIN HALL - HARDWOOD - Oak Strip Lauzon Essential Solid 2 1/4" x 3/4"-Natural

FLOOR AND WALL TILES

	Floor Tile	Wall Tile	Decor	Listello
Front Foyer	N/A			
Main Hall	N/A			
Kitchen/Breakfast	N/A	Kitchen Backsplash	N/A	<input type="checkbox"/> <input type="checkbox"/>
Powder Room	1-13x13, Serpentine White	Pwdr Wall if Applicable	N/A	<input type="checkbox"/> <input type="checkbox"/>
Laundry	1-13x13, Serpentine White			

	Floor	Tub Wall	Shower Wall	Deck Skirt	Deck Splash	Decor	Listello
Main Bathroom	N/A	N/A	N/A	N/A	NA	<input type="checkbox"/> <input type="checkbox"/>	
Master Ens	1-13x13, Serpentine White	N/A	1-8x10, Serpentine White	1-13x13, Serpentine White	1-8x10, Serpentine White	<input type="checkbox"/> <input type="checkbox"/>	
Shared Ens	1-13x13, Serpentine White	1-8x10, Serpentine White	N/A	N/A	NA	<input type="checkbox"/> <input type="checkbox"/>	
Ensuite 2	1-13x13, Serpentine White	1-8x10, Serpentine White	N/A	N/A	NA	<input type="checkbox"/> <input type="checkbox"/>	
						<input type="checkbox"/> <input type="checkbox"/>	
						<input type="checkbox"/> <input type="checkbox"/>	

Shower - Upgrade Floor

Opt. Tile Extras

HIGHCASTLE HOMES - COLOUR SCHEDULE

Purchasers: SATISH KUMAR POLUMATI & SOWMYA MOKA Property: 3Phase: Orchards of Plan - 40M-2627
Telephone Res. / Bus: / Project: 2174372 Ontario Ltd.
Decor Advisor: Caroline Rajcsanyi Model and Elevation: Spencer (40-4) Elev B

PLUMBING / FAUCETS

Powder Room Standard
Main Bath N/A
Master Ensuite Standard
2nd Ensuite N/A
R.I. Bath *3 Piece
Kitchen Sink *Undermount
Kitchen Faucet Upgrade
Laundry Standard
Shared Ensuite Standard
Drain for 2nd floor Laundry ☐ Yes ☒ No
Waterline for fridge ☒ Yes ☐ No
Supply and install all toilet paper holders, towel bars and soap dishes ☒ Yes ☐ No
Whirlpool

Opt. Plumbing Extras

PAINTING

Wall Colour 22 Warm Grey Trim Colour Standard Railing Colour Natural Pickets Colour *Wrought Iron Stair Colour Natural
Opt. Paint Extras

MISCELLANEOUS

Railing Style RAILING - UPGRADE 1 - 1/2in Wrought iron square picket with square collar on alternating picket, 3in oak handrail and 3 1/2in oak std. post.
Opt. Garage Door *Yes-Grade Permitting Opt. Side Door *Yes-Grade Permitting Stair Type Oak
Interior Doors Standard - Classique Int. Door Hardware *Pewter Knob Ext. Door Hardware *Pewter Exterior package
Trim Style *1 - 2 3/4in Case & 4in Baseboard Cold Cellar ☐
Smooth Ceiling 1st Floor ☒ Yes ☐ No Basement Windows Upgrade ☒ Yes ☐ No
Smooth Ceiling 2nd Floor ☒ Yes ☐ No
Supply and Install Standard Mirrors ☒ Yes ☐ No
Misc.

HEATING

Fireplace Type 36" Mantle Standard - Paint Grade Surround NA Hearth N/A
Great Room
Air Conditioning ☒ *Yes ☐ No Gas Provisions for BBQ ☐ Yes ☒ No
Hood Fan Duct ☒ 6 inch ☐ 8 inch ☐ 10 inch Humidifier ☐ Yes ☒ No
Gas Provisions for Dryer ☐ Yes ☒ No
Gas Provisions for Stove ☒ Yes ☐ No

Exterior Colour Scheme: Pre-selected By Vendor

NOTE: The Purchaser(s) agree(s) that:
a) Colours of materials are as close as possible to Vendor's selections, but not necessarily identical due to variances in manufacturing or manufacturers.
b) Purchaser(s) has checked and acknowledges accuracy of the above selections. Where omissions occur on the original colour selection sheet Purchaser(s) acknowledge that the Builder's selection will be final.
c) Upgrades or extras listed on this schedule will not be deemed part of the Agreement of Purchase and Sale. Any such upgrades or extras shall be null and void unless accompanied by a separate invoice and amendment. Said invoice must be paid in f
d) The Purchaser(s) further agrees that in the event that the Vendor has preselected colours prior to the purchase of the house, the prescribed colours are final not withstanding that the Purchaser may have completed a colour selection schedule
e) The Purchaser(s) Acknowledges that once this colour schedule is signed and dated, no changes, additions or deletions will be permitted other than re-selection due to unavailability.
A \$350 (Per Item) administration fee will apply to the above exceptions (if the change is possible).

This Interior Colour Selection is final and approved by:
Signature: * P. Sat. Kumar Date: 29-March-2021
Printed 3/29/2021 18:12:19
Builder's Agent: C. Rajcsanyi Date: March 29, 2021



Highcastle Homes Décor Centre Disclaimers

Lot#: 3 Model: Spencer (40-4) Elev B in Northglen (H) - 2174372 Ontario Ltd.

PURCHASERS: SATISH KUMAR POLUMATI and SOWMYA MOKA

TEL:

Through years of doing business, we at Highcastle Homes have encountered issues beyond our control. The following disclaimers apply to all instances of Purchaser's Extras forms and all Interior Colour Scheme forms.

Fireplaces

Fireplace Marble: Due to the many variables that can affect the pattern and/or design, frequently the marble installed on the fireplace will not be identical to the samples. We will make every attempt to come as close to the samples as possible, but cannot be responsible for results which differ from the samples.

Ceramic Floor Tile

Many variables including variegation can affect tile colour, pattern and/or design which mean installed tiles may not be identical to the samples. We will make every attempt to come as close as possible, but cannot be responsible for results which differ from the samples.

Hardwood Flooring

The purchaser is advised that cupping and shrinkage are characteristics of hardwood flooring normal appearing some time after installation, and no warranty is provided by the flooring supplier with respect to such cupping and shrinkage. The vendor agrees to install any hardwood flooring ordered by the purchaser in good and workmanlike manner, but shall not be responsible for, and is hereby released by the purchaser from responsibility and liability for cupping and shrinkage of hardwood flooring.

Shrinking and expanding/cupping of the hardwood floors may occur if the humidity levels in the home are not kept at industry recommendations. If the hardwood floors shrink or expand due to the homeowner not complying with these levels, the hardwood floor will no longer be under warranty and it will be the homeowner's responsibility to repair the flooring.

Stain Colours

Due to many variables that can affect the outcome of a stain colour on wood, staircases, railings, and fireplaces, will not be identical to samples. Factors such as density, age humidity, air temperature, and the uniqueness of each piece of wood can result in wide variations in darkness or lightness. We will make every attempt to come as close to the sample as possible, but cannot be responsible for results which differ from the samples.

Stain on pre-finished hardwood floors will not be an exact match to the stain colours available on stairs, pickets and rails. The purchaser is responsible for choosing the stain on these areas to their satisfaction.

Appliances

All fridge openings are set to builder's standard width. Please advise Décor Centre at time of colour appointment if custom sizing of cabinets is required for any built - in appliances. The purchaser is responsible for costs and fees associated with changes to pre-manufactured kitchens made subsequent to colour appointments.

Kitchen Cabinets

The kitchen you order/purchase will undoubtedly contain slight colour variations. The degree of these variations is virtually impossible to determine before the kitchen is installed in its intended location. The amount of and type of lighting will also affect various highlights in the finish. Note: No two pieces of wood are identical. Variations in colour tone and grain patterns make a perfect colour match virtually impossible. It is generally agreed that these variations add to the natural beauty of a wood kitchen.

Shrinking and expanding of the kitchen cabinets may occur if the humidity levels in the home are not kept at industry recommendations. If the cabinets shrink or expand due to the homeowner not complying with these levels, the cabinets will no longer be under warranty and it will be the homeowner's responsibility to repair the cabinets.

Plaster Mouldings and Medallions

Plaster mouldings will not be installed in open to above areas or areas with 2 storey elements.

Metal Spindles

Due to the characteristics of wrought iron railing production, it is possible for the wrought iron to develop a scale effect. This scale may or may not be totally covered during the painting process. In effect, once the wrought iron picket is painted, the paint may in effect amplify the iron scale depending on the colour chosen. This is a natural effect of wrought iron and should not be construed as a defect or damage.

I hereby acknowledge reading and understanding the above copy and will not hold Highcastle Homes responsible for any issues in relation to above.

Purchasers Signature(s): X P. Sat kumar X At Date: X 29-March-2021

Lot 3
Orchards

STONE EDGE PROFILES

Approx 2CM or $\frac{3}{4}$ " Standard Edge



1st UPGRADE

Approx 4CM or 1.5" - SEAMS WILL BE VISIBLE

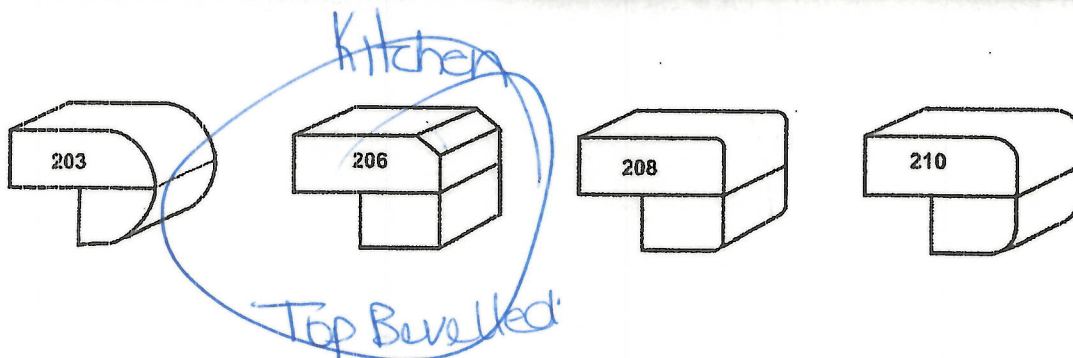

2nd UPGRADE

Approx 4CM or 1.5" - SEAMS WILL BE VISIBLE

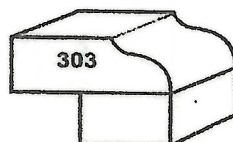

Sign
Sign

Date
Date

Lot 3
Orchards

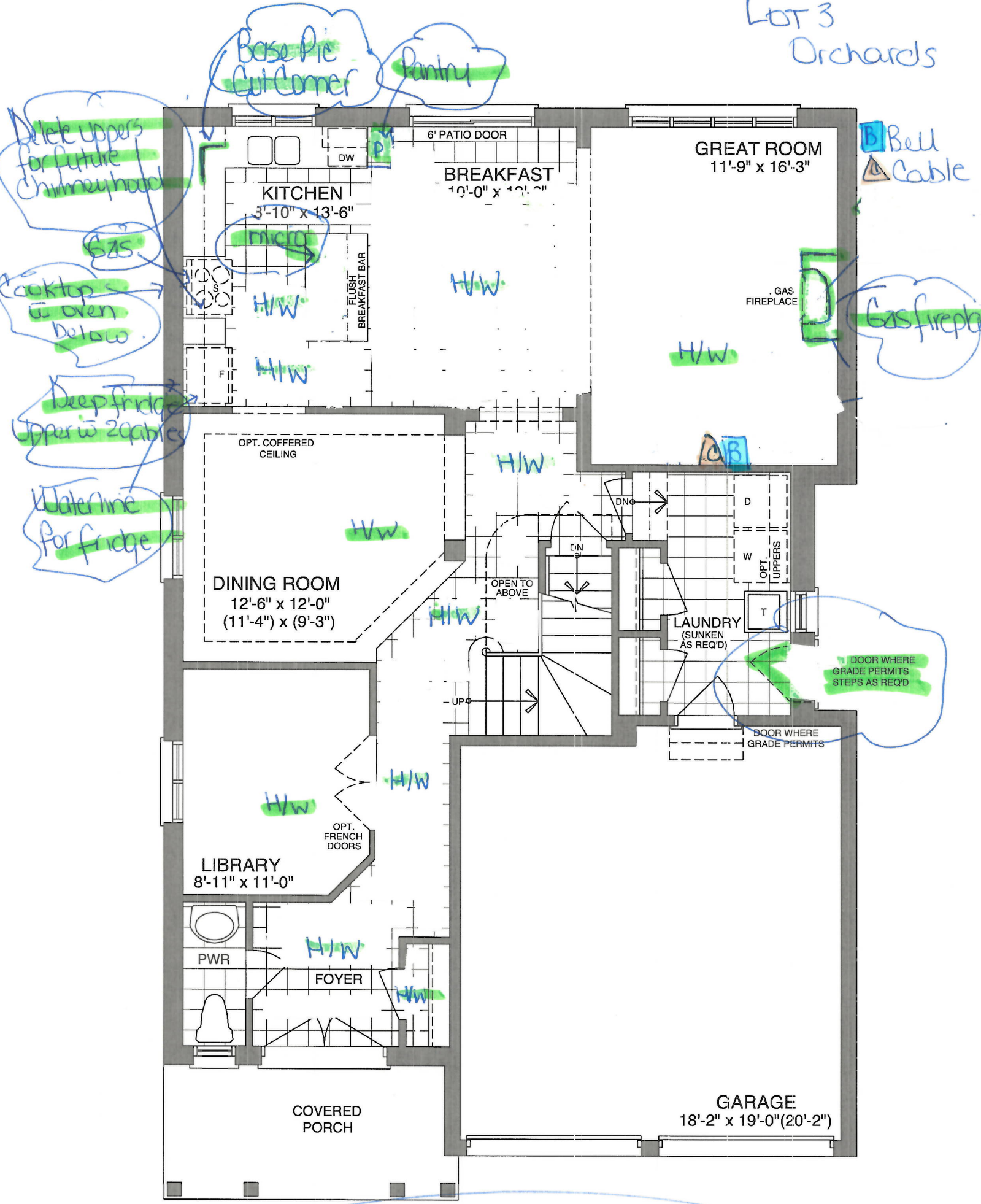

MAIN FLOOR - ELEV A

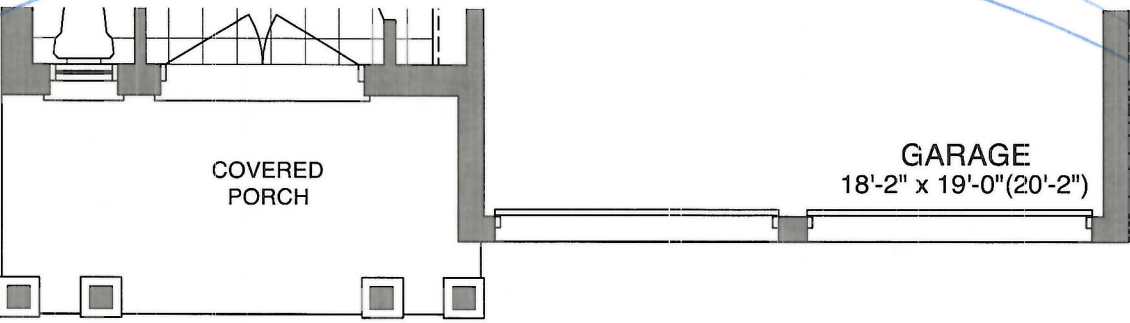

MAIN FLOOR - ELEV B

Sign
Sign

Date
Date

Lot 3 Orchards

B Bell
A Cable.

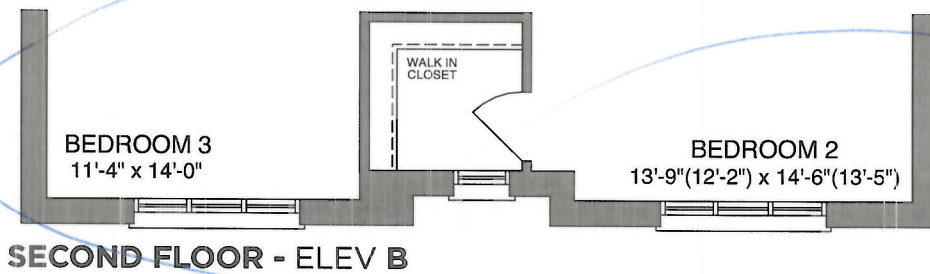
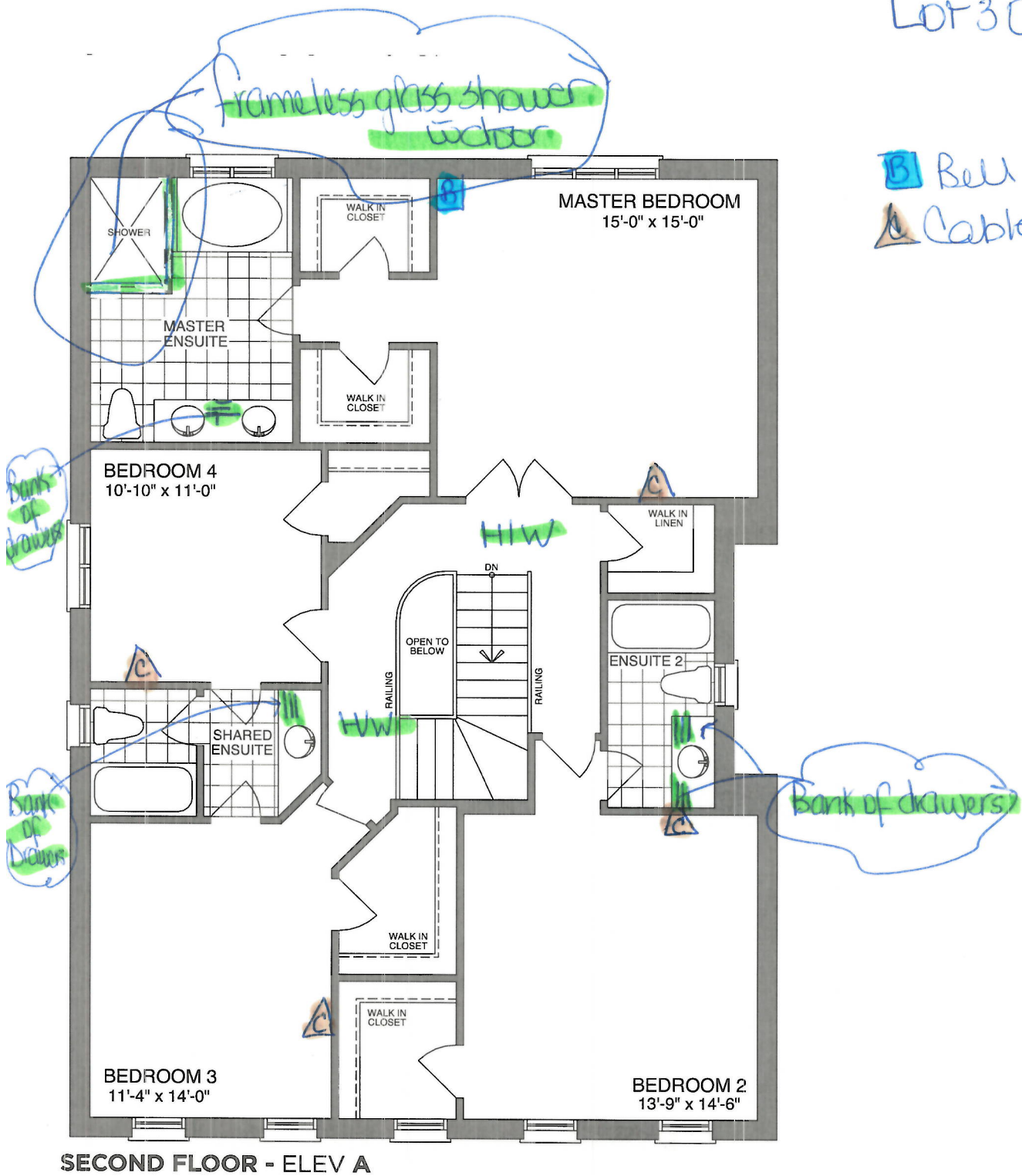

Sign
Sign

Dave
Dave

Lot 3
Orchards

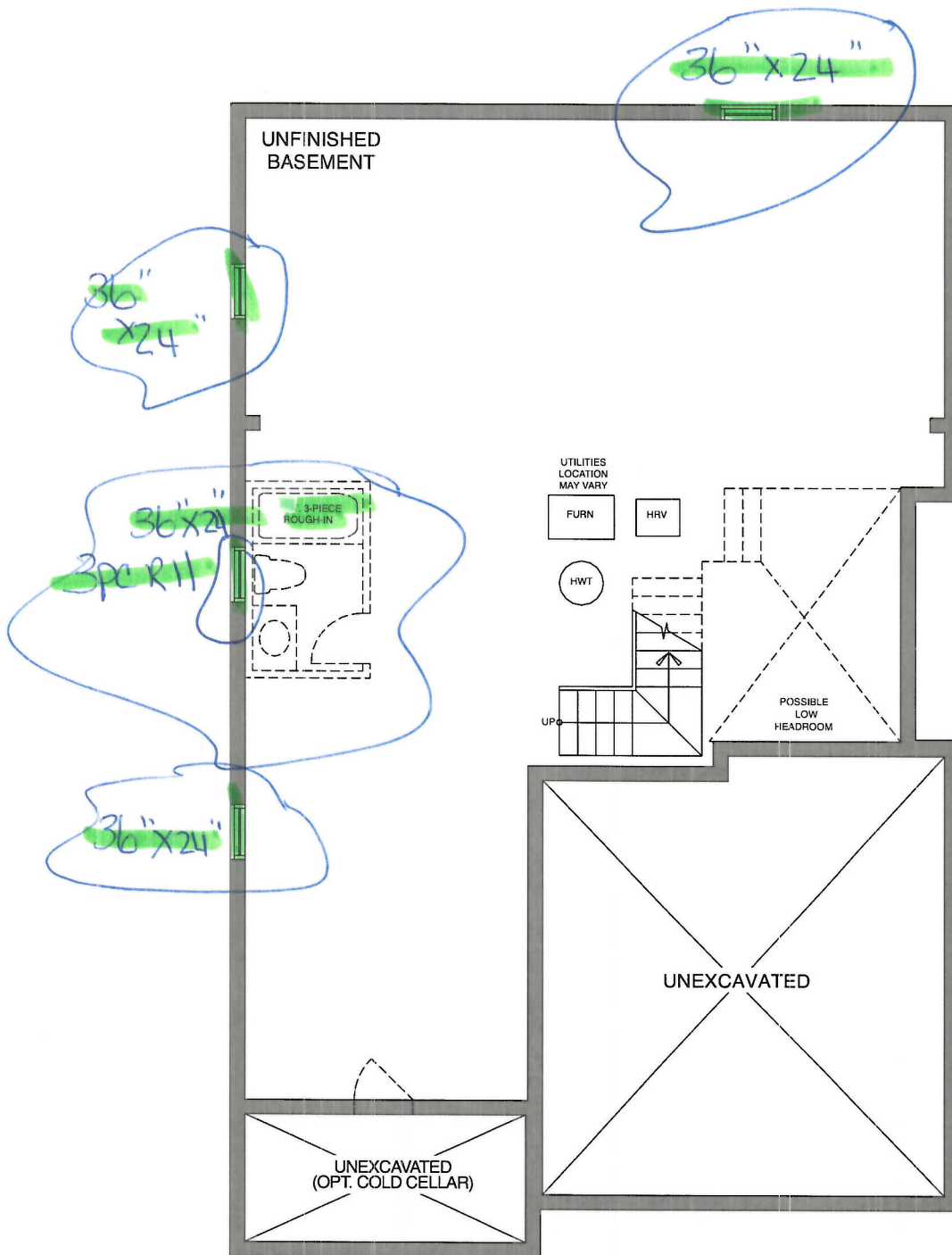

BASEMENT - ELEV A

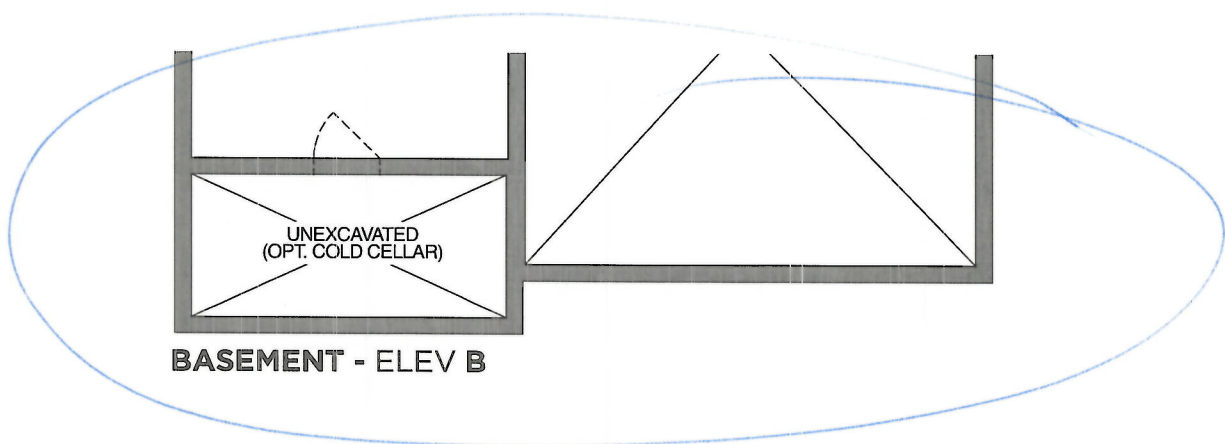

BASEMENT - ELEV B

Sur
Syn

Date
Date

RF24R7201SR

23 cu. ft. Counter Depth, 4-Door
French Door Refrigerator

115V/60Hz/5.0A

SAMSUNG
Lot 3 Orchards



Signature Features

FlexZone™ Drawer

A flexible storage drawer with four different temperature settings and an adjustable Smart Divider to stay organized.

Fingerprint Resistant

A special finish to reduce smudges and minimize cleaning.

Wi-Fi and Bixby Enabled

Use your smartphone to control the temperature and monitor your refrigerator remotely.

Available Colors

-  Fingerprint Resistant Stainless Steel (shown)
-  Fingerprint Resistant Black Stainless Steel
-  Fingerprint Resistant Tuscan Stainless Steel



French Door Design



FlexZone™ Drawer

Convenience

- FlexZone™ Drawer with 4 Temperature Settings and Smart Divider
- Adjustable Shelves for Tall Oversized Items
- Auto Pull-Out Upper Freezer Drawer
- Water Filter Indicator

Design

- Counter Depth
- Modern External Filtered Water and Ice Dispenser
- High Efficiency LED Lighting
- Accessibility (ADA Compliant)
- EZ-Open Handle™ on Freezer Door and FlexZone™ Drawer
- Tempered Glass Spill-Proof Shelves
- Gallon Door Bins
- Dispenser Light

Performance

- Twin Cooling Plus®
- Ice Max - Stores up to 2.7 lbs of ice
- Energy Star® Compliant
- Power Freeze and Power Cool Options
- Two Humidity-Controlled Crispers
- CoolTight Door
- Door Alarm

Rating



ENERGY STAR® rated:
690 kWh/yr

Installation Specifications

1. Measure the height, width and depth of the opening, making sure to include baseboards, molding tile, countertop overhang, etc. Check to be sure there is enough room to open the door (consider walls, islands or other obstacles when measuring).

2. Refer to illustration below to determine dimensions.

3. Allow 2.5" of clearance on hinge side of refrigerator when installing next to a wall where handle may make contact.

4. Allow 1" minimum clearance at rear for proper air circulation and water/electrical connections. Allow a 3/8" minimum clearance at sides and top for ease of installation.

5. Ensure each door and entryway in the home is wide enough for the refrigerator to be moved through easily.

For optimal usage and to be able to open refrigerator doors completely, do not install next to a wall.

Please note: The following dimension and cutout information is for planning purposes only. For complete installation details, consult manual packed with product, or download manual online at [samsung.com](https://www.samsung.com).

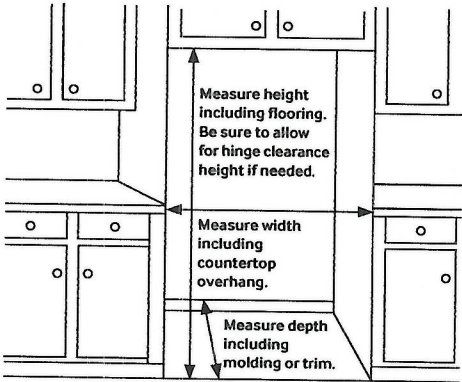

Dimensions

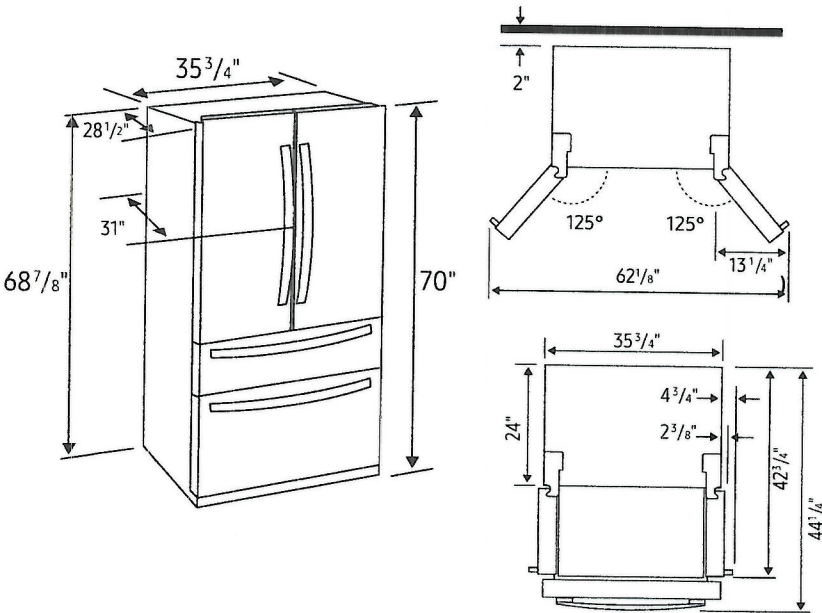

Total Capacity: 22.6 cu. ft.

Refrigerator: 13.0 cu. ft.

- Modern External Filtered Water and Ice Dispenser - Crushed or Cubed Ice

• Ice Max

• High Efficiency LED Lighting

• 2 Humidity-Controlled Crispers

• 5 Tempered Glass Spill-Proof Shelves
 - 1 Slide-In/Flip-Up, 1 Flip-Up, 1 Full Width, 2 Fixed

• 6 Clear Door Bins
 - Right Door: 3 Gallon Bins
 - Left Door: 3 Regular Bins

FlexZone™ Drawer: 3.1 cu. ft.

- EZ-Open Handle™

• 4 Temperature Zones with Smart Divider:
 - Meat/Fish (29°F)
 - Cold Drinks (33°F)
 - Deli/Snacks (37°F)
 - Wine/Party Dishes (42°F)

Freezer: 6.5 cu. ft.

- 1 Large Guard Freezer Bin

• Auto-Out Upper Drawer

• High Efficiency LED Lighting

• EZ-Open Handle™

Warranty

One (1) Year Parts and Labor on Refrigerator
Five (5) Years Parts and Labor on Sealed Refrigeration System Only*
Ten (10) Years Parts and Five (5) Years Labor on Digital Inverter Compressor

*Compressor, evaporator, condenser, drier and connecting tubing.

Product Dimensions & Weight

Dimensions (WxHxD with hinges, handles and doors):
35 3/4" x 70" x 31"

Dimensions (WxHxD without hinges and door):
35 3/4" x 68 7/8" x 24 1/2"

Dimensions (WxHxD with hinges and door, no handle):
35 3/4" x 70" x 28 1/2"

Weight: 315 lbs

Shipping Dimensions & Weight (WxHxD)

Dimensions: 38 1/4" x 75 3/4" x 30 5/8"

Weight: 337 lbs

Color	Model #	UPC Code
Fingerprint Resistant Stainless Steel	RF24R7201SR	887276304892
Fingerprint Resistant Black Stainless Steel	RF24R7201SG	887276304885
Fingerprint Resistant Tuscan Stainless Steel	RF24R7201DT	887276304878

Lot 3 Orchards

KitchenAid Countertop Microwave Use and Care Guide

PRODUCT MODEL NUMBERS

KMCC5015G

LOCATION REQUIREMENTS

IMPORTANT: The control side of the microwave oven is the heavy side. Handle the microwave oven gently. The weight of the microwave oven is over 35 lbs (15.9 kg).

- Place the microwave oven on a cart, counter, table, or shelf that is strong enough to hold the microwave oven and the food and utensils you place inside it.
- The microwave oven should be at a temperature above 50°F (10°C) for proper operation.

NOTE: Some models can be built into a wall or cabinet by using one of the trim kits listed in the “Assistance or Service” section.

- Do not block the exhaust vents or air intake openings. Allow a few inches of space at the back and side of the microwave oven where the exhaust vents are located. Blocking the exhaust vents could cause damage to the microwave oven as well as poor cooking results.
- Make sure the microwave oven legs are in place to ensure proper airflow. If vents are blocked, a sensitive thermal device may automatically turn the microwave oven off. The microwave oven should work properly once it has cooled.

ELECTRICAL REQUIREMENTS

Observe all governing codes and ordinances.

Required:

- A 120-volt, 60 Hz, AC-only, 15- or 20-amp electrical supply with a fuse or circuit breaker.

Recommended:

- A time-delay fuse or time-delay circuit breaker
- A separate circuit serving only this microwave oven

OVERALL DIMENSIONS

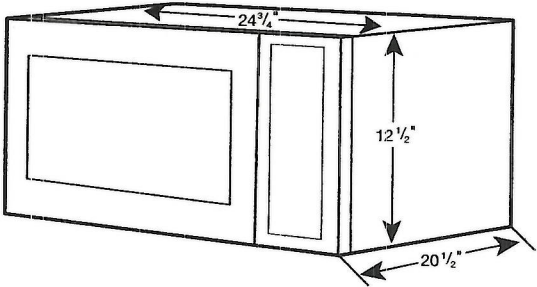

NA30N7755TS

30" Gas Cooktop

SAMSUNG

Lot 3 Orchard

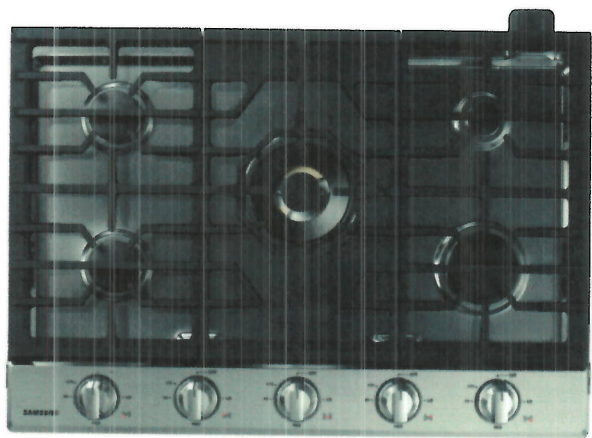

Signature Features

22K True Dual-Power Burner

- Two independent heating burners offer intense heat and precise control to quickly boil water or temper chocolate.

Analog Controls with Digital Wi-Fi and Bluetooth® Technology

- The ultimate combination of analog comfort and digital technology delivers exceptional cooking performance.

Cast Iron Griddle

- Cook breakfast, grill sandwiches, or sauté vegetables on the removable griddle.

Available Colors



Stainless Steel (shown)



Fingerprint Resistant
Black Stainless Steel

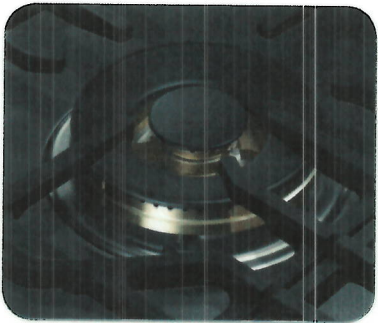

22K True Dual-Power Burner



Cast Iron Griddle

Features

- Bluetooth® Connected to Hood
- Blue LED Lights
- Wi-Fi Connectivity
- Powerful Cooktop
 - Right Front: 13K BTU
 - Left Front: 9.5K BTU
 - Right Rear: 5K BTU
 - Left Rear: 9.5K BTU
 - Center: True Dual, 22K BTU (Brass)

- Cast Iron 3-Piece Grates
- Sealed Burners
- Burner On/Off Monitoring
- ADA Compliant

Convenience

- Wok Grate
- LP Conversion Kit



ADA Compliant

NA30N7755TS

30" Gas Cooktop

SAMSUNG

Lot 3 Orclards

Installation Requirements

Countertop cut-out and minimum clearance dimensions:

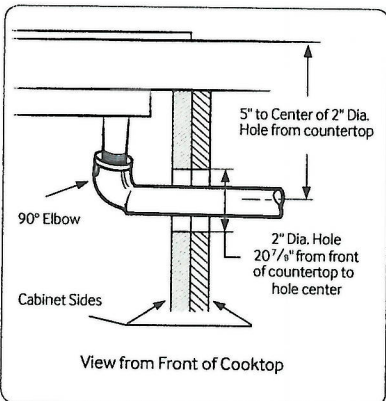
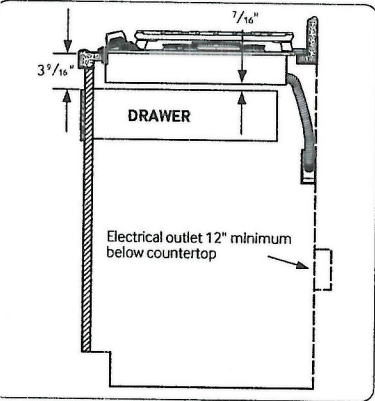
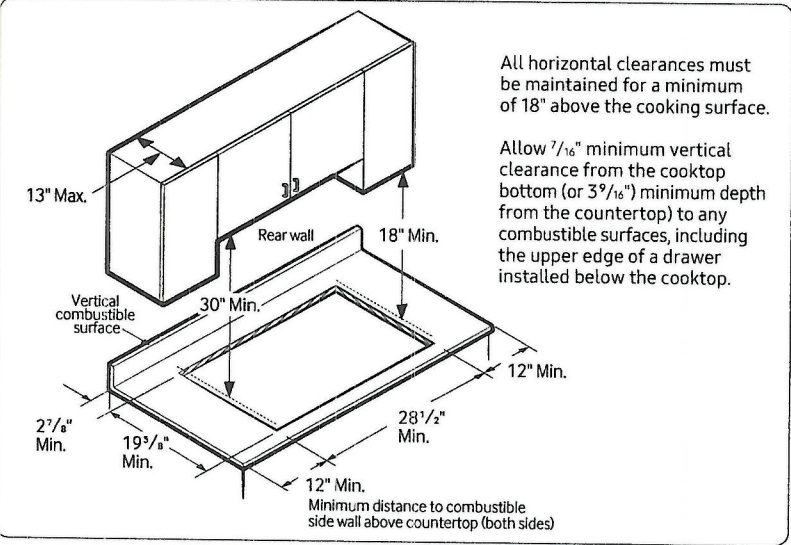

Total Power (BTU)

59K

Power Source

120V / 60 Hz / 1A

Gas Cooktop (BTU)

- Right Front: 13K
- Left Front: 9.5K
- Right Rear: 5K Simmer
- Left Rear: 9.5K
- Center: 22K (True Dual)

Warranty

One (1) Year All Parts and Labor

Product Dimensions & Weight (WxHxD)

Outside (Max) Cooktop Dimensions:

30" x 5 41/72" x 22 1/3"

Cooktop Cut-Out Dimensions:

28 1/2" x 3 1/8" x 19 5/8"

Weight: 75.8 lbs. (76.3 lbs. Fingerprint Resistant Black Stainless Steel)

Shipping Dimensions & Weight (WxHxD)

Dimensions: 34 11/16" x 10 5/8" x 25 5/8"

Weight: 84.0 lbs. (84.9 lbs. Fingerprint Resistant Black Stainless Steel)

Color

Stainless Steel

Model

NA30N7755TS

UPC Code

887276281704

Fingerprint Resistant

Black Stainless Steel

NA30N7755TG

887276281698

Installing Over a Single Oven

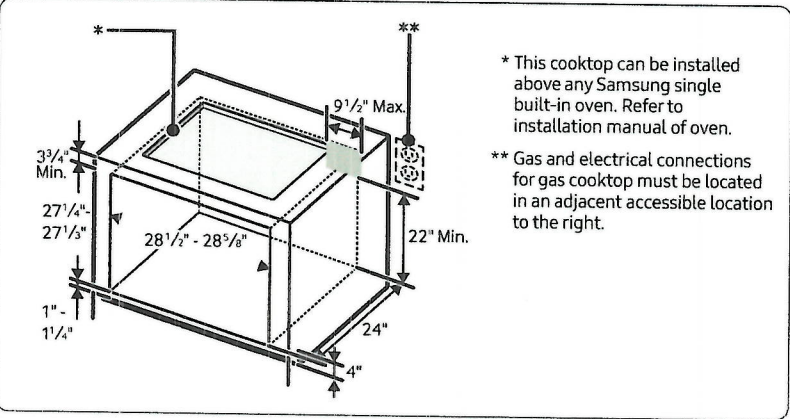

Cooktop Dimensions

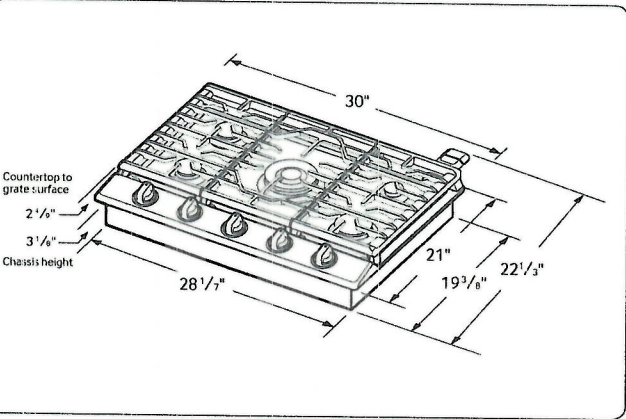

NV51K7770SS

5.1 cu. ft. Single Wall Oven

seperate power source for
oven/cooktop
Electric.

- Lot 3
Orchards.

Features

- 6 Oven Modes including Steam Bake and Steam Roast
- 5.1 cu. ft. Capacity
- Gourmet Cook
- Dual Convection
- WiFi Connectivity
- WiFi-Enabled Temperature Probe
- Signature LED Lights
- Soft-Close Door
- 3 Heavy-Duty Racks including a Gliding Rack
- Blue LED Illuminated Knobs
- Broil Element
- Smart Control Key
- 6 Rack Positions
- Drop-Down Door Design
- LED Display

Convenience

- Hidden Heating Element
- Rapid Preheat
- Sabbath Mode
- Hybrid and Self Clean
- Delay Start
- Proofing
- Warming Mode
- Kitchen Timer
- Child Safety Lock
- Convection Conversion

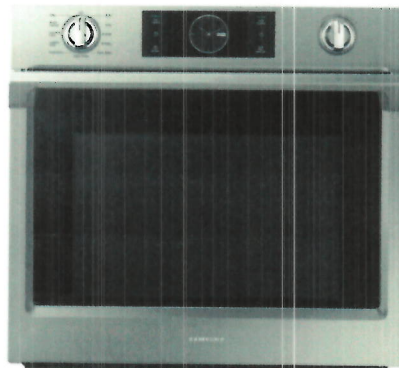

Steam Cook



Flex Duo™

Available Colors



Stainless Steel (shown)



Black Stainless Steel

Signature Features

STEAM COOK

- Delivers moisture at precise times for a crisp, browned outside and tender inside.

DIGITAL-ANALOG CONTROLS

- The ultimate interface, a combination of analog-knobs and a digital touch screen.

FLEX DUO™

- Cook two dishes at different temperatures simultaneously with the Smart Divider.

SAMSUNG

NV51K7770SS

5.1 cu. ft. Single Wall Oven

Lot 3 Orchards

Cabinet Dimensions

Single Oven Installed in Cabinet

*Junction Box

**Allow a minimum of 22" for clearance to adjacent corners, drawers, walls, etc. when door is open.

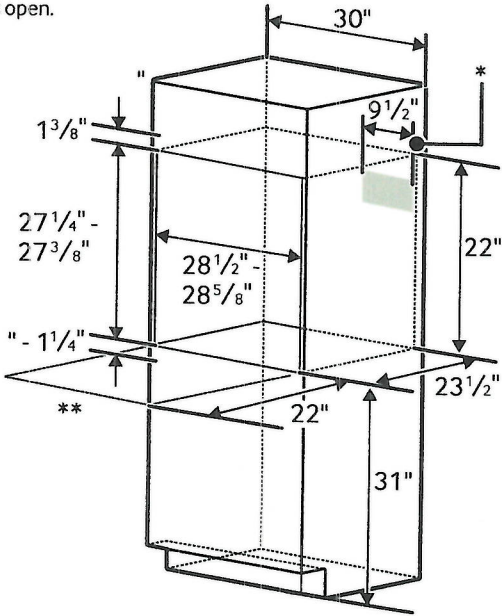

Convection Wall Oven

- Hidden Bake Element
- Bake: 175°F–550°F
- Convection Bake: 175°F–550°F
- Convection Roast: 175°F–550°F
- Broil: Low-High
- Steam Bake: 230°F–550°F
- Steam Roast: 230°F–550°F
- Proofing
- Sabbath Mode

Warranty

One (1) Year All Parts and Labor

Product Dimensions & Weight (WxHxD)

Outside (Max) Wall Oven Dimensions:

28 3/4" x 27 5/8" x 24 7/16"

Wall Oven Cut-Out Dimensions:

28 1/2" x 27 1/4" x 23 1/2"

Weight: 149.9 lbs.

Shipping Dimensions & Weight (WxHxD)

Dimensions:

33 1/2" x 33 3/4" x 29 13/16"

Weight: 176.4 lbs.

Color

Stainless Steel

Black Stainless Steel

Model

NV51K7770SS

NV51K7770SG

UPC Code

887276181691

887276181752

Product Dimensions

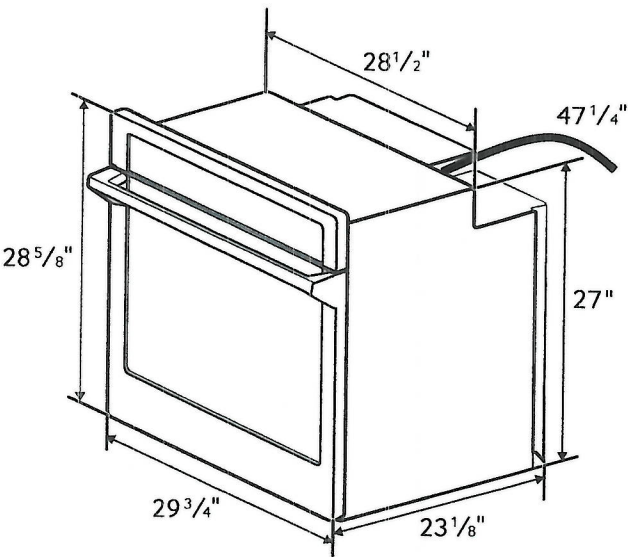

KW RATING	
240V	6.2
208V	4.7
BREAKER SIZE	
240V	30 Amps
208V	30 Amps

SAMSUNG

Actual color may vary. Design, specifications, and color availability are subject to change without notice.
Non-metric weights and measurements are approximate.

©2016 Samsung Electronics America, Inc. 85 Challenger Road, Ridgefield Park, NJ 07660. Tel: 800-SAMSUNG. samsung.com.
Samsung is a registered trademark of Samsung Electronics Co., Ltd.

NK30K7000WS

30" Range Hood

Lot 3 Orchards

Features

- Wi-Fi Monitoring
- ADA Compliant
- 3 Fan Speeds including Booster
- Wall-Mounted Chimney Style
- Digital Touch Control
- Exterior Venting
- 74 dBA Noise Level

Convenience

- LED Lighting

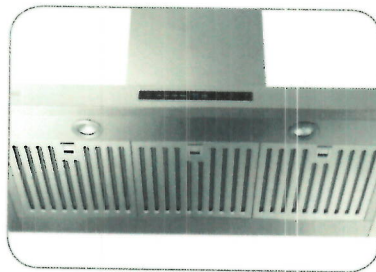
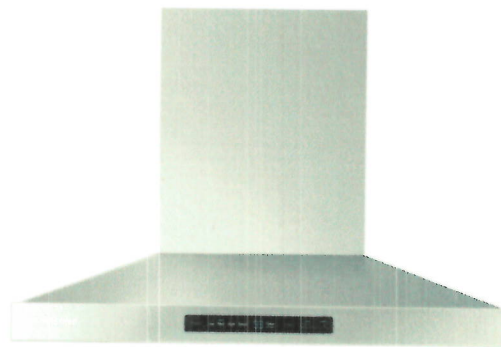

Baffle Filter



Wi-Fi Monitoring

Available Colors



Stainless Steel (shown)



Black Stainless Steel

Signature Features

BLUETOOTH CONNECTED HOOD

- Automatically sync the fans and the lights with the cooktop through Bluetooth.¹

¹Only on select Samsung cooktops.

BAFFLE FILTER

- Dishwasher-safe metal filters help keep the air clean by drawing grease and odor through the hood.

POWERFUL 600 CFM VENTILATION

- Circulates air to remove odors quickly.

SAMSUNG

NK30K7000WS

30" Range Hood

Lot 3 Orchards

Venting Methods

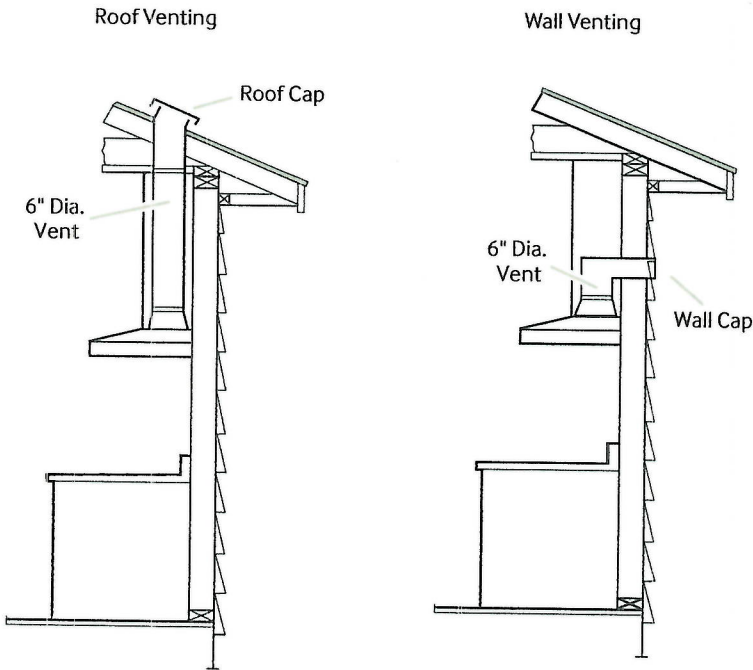

Total Power
220W

Power Source
120V / 60 Hz / 15A

- Range Hood
- 30" Stainless Steel Chimney Hood
 - Vent Fan: 600 CFM
 - Front-Centered, Touch Control
 - 4 Fan Speeds: 3 Step, 1 Booster
 - 74 dBA Noise Level
 - Hood Connectivity Control
 - Bluetooth On/Off Control
 - Mobile Monitoring: Fan Speed, Lighting On/Off, Power Control
 - Removable Baffle Filter
 - LED Lighting

Warranty
One (1) Year All Parts and Labor

Product Dimensions & Weight (WxHxD)
Outside (Max) Hood Dimensions:
30" x 25²⁵/₆₄" x 19¹¹/₁₆"
Weight: 44.1 lbs.

Shipping Dimensions & Weight (WxHxD)
Dimensions:
34¹/₄" x 26¹/₂" x 18¹/₁₆"
Weight: 56.7 lbs.

Color	Model #	UPC Code
Stainless Steel	NK30K7000WS	887276182964
Black Stainless Steel	NK30K7000WG	887276182957

Dimensions and Clearance

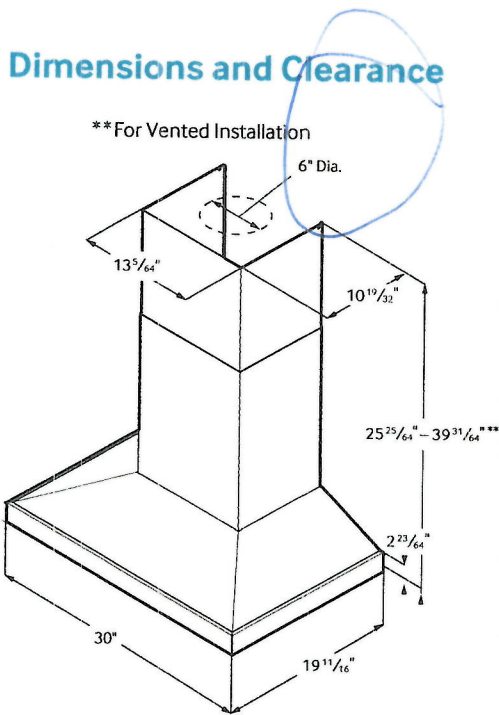

SAMSUNG

Actual color may vary. Design, specifications, and color availability are subject to change without notice.
Non-metric weights and measurements are approximate.
©2017 Samsung Electronics America, Inc. 85 Challenger Road, Ridgefield Park, NJ 07660. Tel: 800-SAMSUNG. samsung.com.
Samsung is a registered trademark of Samsung Electronics Co., Ltd.

DW80R9950

Samsung Linear Wash 39 dBA Dishwasher

SAMSUNG

Lot 3 Orkards

120/60/15

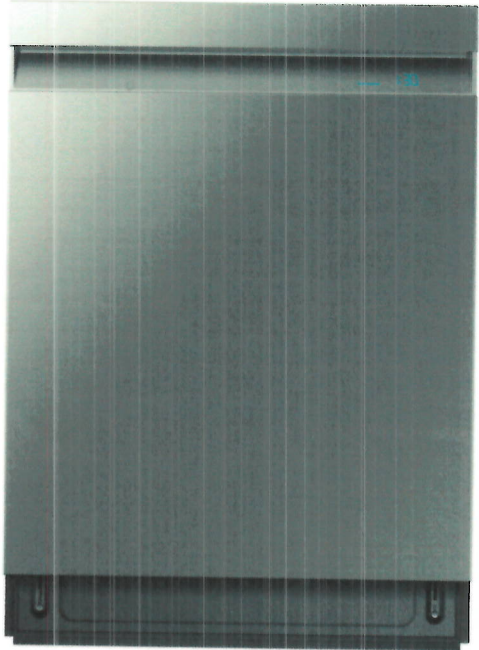

Signature Features

Linear Wash System

- AquaBlast™ jets provide corner to corner coverage for superior cleaning.

Whisper Quiet Cleaning

- Less noise and less disturbance with virtually silent wash cycles at 39 dBA.

AutoRelease™ Door

- At the end of a cycle, the door automatically opens to circulate air and improve drying performance.

Available Colors



Fingerprint Resistant
Stainless Steel (shown)



Fingerprint Resistant
Black Stainless Steel



Fingerprint Resistant
Tuscan Stainless Steel

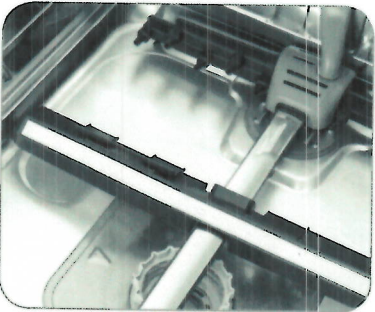

Linear Wash System

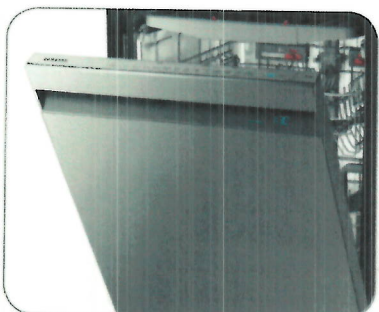

AutoRelease™ Door

Features

- Flexible 3rd Rack
- Fingerprint Resistant Stainless Finish
- Zone Booster™
- Touch Control
- Quiet Operation: 39 dBA
- Wi-Fi Connectivity
- 7 Wash Cycles
- 8 Options
- Half-Load Cycle
- Express Cycle: 60 Minutes
- One-Touch Adjustable Racking System
- Full Stainless Steel Interior
- 15 Place Settings
- 3 Spray Wash Arms
(Upper, Middle, Lower)

Convenience

- LED Time Display
- Control Lock
- Delay Start
- Digital Leak Sensor

Rating

ENERGY STAR®-rated:
239 kWh/yr

DW80R9950

Samsung Linear Wash 39 dBA Dishwasher

SAMSUNG
Lot 3 Orchards

Installation Specifications

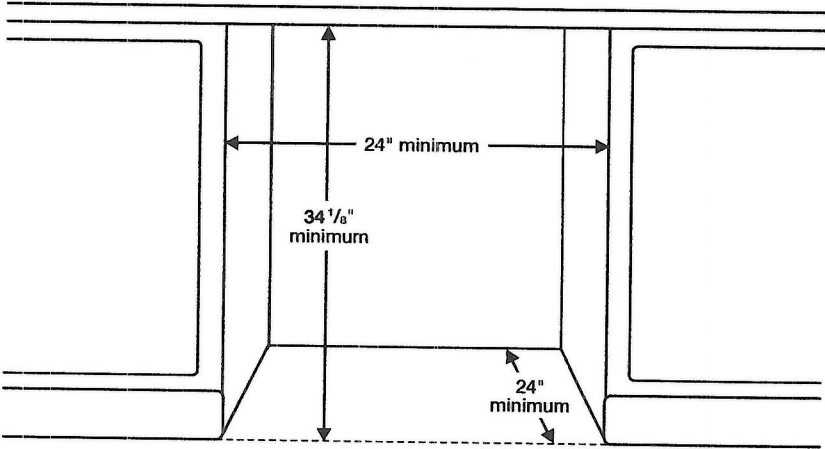

Features

- 7 Wash Cycles: Auto, Normal, Heavy, Delicate, Express 60, Rinse Only, Self Clean
- 8 Options: Half-Load Wash (Lower Rack), Zone Booster™ (Left), Speed Booster, Hi-Temp Wash, Sanitize (Anti-bacterial – NSF), Delay Start, Control Lock, Smart Control (Wi-Fi App)
- AutoRelease™ Door
- Hidden Heat Element
- Stainless Steel Interior Tub

Convenience

- Control Lock
- Digital Water Leakage Sensor
- Flexible Third Rack
- One-Touch Adjustable Racking System
- Silverware Basket
- Upper Rack: Foldable Cup Shelves, 2 Adjustable Tines
- Lower Rack: Fold-Down Tines

Warranty

One (1) Year All Parts and Labor
Five (5) Year Limited on Printed Circuit Board and Interior Nylon Racks

Product Dimensions & Weight (WxHxD)

Dimensions (height is adjustable):
23⁷/₈" x 33⁷/₈" – 35" x 25"

Weight: 95 lbs

Shipping Dimensions & Weight (WxHxD)

Dimensions:
26" x 34³/₄" x 29³/₄"

Weight: 101 lbs

Color	Model #	UPC Code
Fingerprint Resistant Stainless Steel	DW80R9950US	887276296647
Fingerprint Resistant Black Stainless Steel	DW80R9950UG	887276296623
Fingerprint Resistant Tuscan Stainless Steel	DW80R9950UT	887276320137

Dimensions

Side View

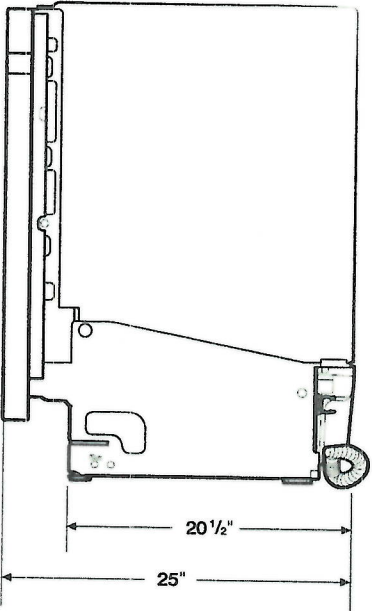

Rear View

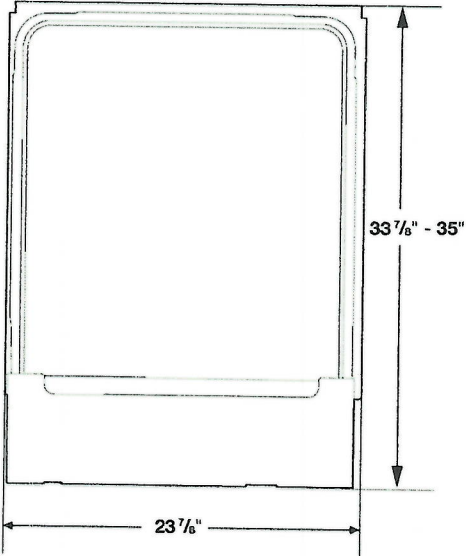

Actual color may vary. Design, specifications, and color availability are subject to change without notice. Non-metric weights and measurements are approximate.
©2019 Samsung Electronics America, Inc., 85 Challenger Road, Ridgefield Park, NJ 07660. Tel: 800-SAMSUNG. samsung.com. Samsung is a registered trademark of Samsung Electronics Co., Ltd.

DLEX3700_ /DLGX3701_

7.4 cu. ft. Front Load Dryer

QUICK INSTALL & CLEARANCES

For full installation directions/clearances please refer to the corresponding User Manual and Installation Guide.

DIMENSIONS

A Width	27"
B Height	38 11/16"
C Depth	30"
D Depth with Door Open	51"
Carton (WxHxD)	29 19/32" x 43 3/8" x 31 3/8"
ENERGY / POWER SOURCE	
ENERGY STAR® Qualified	Yes
Ratings	CSA Listed
Electrical Requirements	240V 30 Amps (Electric)
Type	Electric (DLEX3700_)
BTU Rating	10,000 Feet

CONNECTING THE GAS SUPPLY

- Installation and service must be performed by a qualified installer, service agency, or the gas supplier.
- Use only a new stainless steel flexible connector and a new AGA-certified connector.
- A gas shutoff valve must be installed within 6 ft. (1.8 m) of the dryer.
- The dryer is configured for natural gas when shipped from the factory. Make sure that the dryer is equipped with the correct burner nozzle for the type of gas being used (natural gas or propane gas).
- If necessary, the correct nozzle (for the LP nozzle kit, order part number 383EEL3002D) should be installed by a qualified technician and the change should be noted on the dryer.
- All connections must be in accordance with local codes and regulations. Gas dryers MUST exhaust to the outdoors.

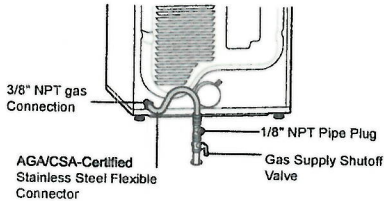

CONNECTING ELECTRIC DRYERS

- A 4-wire connection is required for all mobile and manufactured home installations, as well as all new construction after January 1, 1996.
- A 3-wire connection is NOT permitted on new construction after January 1, 1996.
- A UL-listed strain relief is required.
- Use a 30-amp, 240-volt, 4-wire, UL-listed power cord with #10 AWG-minimum copper conductor and closed loop or forked terminals with upturned ends.

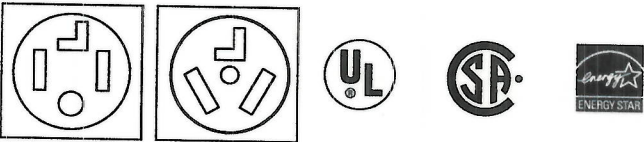

Electric Dryer



DIMENSIONS AND CLEARANCES

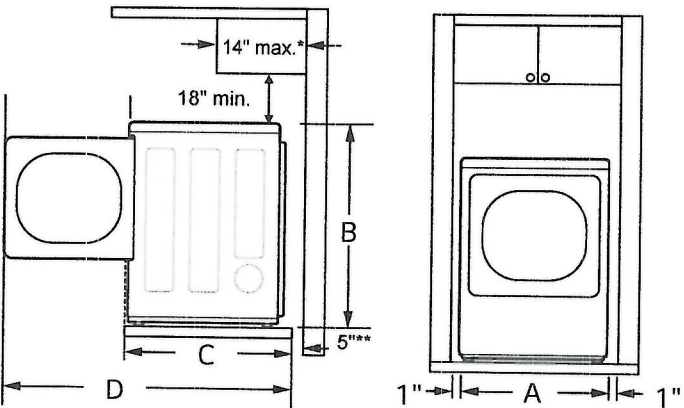

* Required spacing
** For side or bottom venting, 2-inch (5.1 cm) of spacing is allowed.



VENTING NETWORK

NOTE: Follow the guidelines below to maximize drying performance and reduce lint buildup and condensation in the ductwork. Ductwork and fittings are NOT included and must be purchased separately

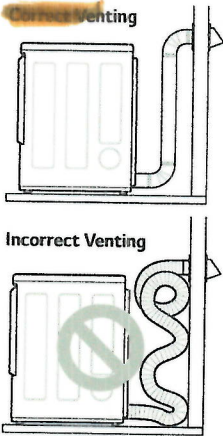
- Use 4-inch (10.2 cm) diameter rigid, semi-rigid or flexible metal ductwork.
- The exhaust duct run should be as short as possible.
- Use as few elbow joints as possible.
- The male end of each section of exhaust duct must point away from the dryer.
- Use duct tape on all duct joints.
- Insulate ductwork that runs through unheated areas in order to reduce condensation and lint buildup on duct surfaces.
- Incorrect or inadequate exhaust systems are not covered by the dryer warranty. Dryer failures or service required because of such exhaust systems will not be covered by the dryer warranty.



- Ductwork is not provided with the dryer. You should obtain the necessary ductwork locally. The vent hood should have hinged dampers to prevent backdraft when the dryer is not in use.
- The total length of flexible metal duct must not exceed 8 ft. (2.4 m).
- Deduct 6 ft. (1.8 m) for each additional elbow. Do not use more than four 90° elbows.

Wall Cap Type	Number of 90° Elbows	Maximum length of 4-inch diameter rigid metal duct
Recommended 	0	65 ft.(19.8 m)
	1	55 ft.(16.8 m)
	2	47 ft.(14.3 m)
	3	36 ft.(11.0 m)
a: 4" (10.2 cm) 	4	28 ft.(8.5 m)
	0	55 ft.(16.8 m)
	1	47 ft.(14.3 m)
	2	41 ft.(12.5 m)
Use only for short run installations 	3	30 ft.(9.1 m)
	4	22 ft.(6.7 m)
b: 2.5" (6.35 cm)		

LG LAUNDRY

DLEX3700_/DLGX3701_

7.4 cu. ft. Front Load Dryer

7.4 cu. ft. Capacity

12 Dryer Programs

TurboSteam™

SmartThinQ® Technology

Wi-Fi Connectivity

SmartDiagnosis™

ENERGY STAR® Qualified



SmartThinQ®

Enjoy new ways to control your home with LG smart appliances

- Start the laundry while you're out shopping
- Get alerts when the cycle is finished
- Works with the LG SmartThinQ® app

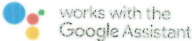

SUMMARY

Capacity	7.4 cu. ft.
Matching Washer	WM3700H_A
Sensor Dry	Yes
Steam	Yes
Colors	White (W), Graphite Steel (V)

APPEARANCE

Intelligent Electronic Controls with LED Display	Yes
Dial-A-Cycle™	Yes
Touch Buttons	Yes

DRYER PROGRAMS

No. of Programs	12
	Normal, Heavy Duty, Bedding, Anti Bacterial, SteamSanitary™, SteamFresh™, Perm. Press, Delicates, Towels, Speed Dry (Manual Dry), Air Dry (Manual Dry), Downloaded

DRYER OPTIONS

No. of Options	12
	More Time, Less Time, Damp Dry Signal, Wrinkle Care, Control Lock, Custom Program, PGM Save, Wi-Fi Connect, Energy Saver, TurboSteam™, Reduce Static, Remote Start
Temperature Settings	High, Medium High, Medium, Low, Ultra Low
Drying Levels	Very Dry, More Dry, Normal Dry, Less Dry, Damp Dry
Manual Dry Times	60 min., 50 min., 40 min., 30 min., 20 min., More Time/Less Time

FABRIC CARE FEATURES

Sensor Dry	Yes
Precise Temperature Control with Variable Heater	Yes
Steam	TurboSteam™

CONVENIENCE FEATURES

3 Minute Installation Check	Yes
LoDecibel™ Quiet Operation	Yes
End of Cycle Signal	Yes
Drum Light	Yes
Reversible Door	Yes
FlowSense™ Duct Clogging Indicator	Yes
Wrinkle Care Option	Yes
Child Lock	Yes
Venting Option	Gas: 3 Way Venting Electric: 4 Way Venting
4 Adjustable Legs	Yes
Remaining Time Display/Status Indicator(s)	Yes

SMARTTHINQ® TECHNOLOGY

SmartDiagnosis™	Yes
Wi-Fi	Yes
Remote Control	Yes
Cycle Monitoring and Notification	Yes
Energy Monitoring	Yes (Wi-Fi)

ENERGY

ENERGY STAR® Qualified	Yes
MATERIALS AND FINISHES	
Aluminized Alloy Steel Drum	Yes
Tub Rear	Painted
Cabinet	Painted Steel
Door	Round w/ Chrome trim
All Available Colors	White (W), Graphite Steel (V)

POWER SOURCE

Ratings	CSA Listed
Electrical Requirements	240V 30 Amps (Electric)
Type	Electric (DLEX3700_)
BTU Rating	10,000 Feet

OPTIONS

LP Conversion Kit	LPK1
Side Venting Kit	383EEL9001B
Pedestal	WDP4W
Pedestal (WxHxD)	27 x 14 1/8 x 30 3/4 (50 1/2 D with door open)

DIMENSIONS

Product (WxHxD)	27" x 38 11/16" x 30"
Depth with Door Open	51"
Carton (WxHxD)	29 19/32" x 43 3/8" x 31 3/8"
Weight (Product)	Gas: 125.7 Electric: 123
Weight Carton	Gas: 138.9 Electric: 136.2

WARRANTY

Parts and Labor	1 Year
-----------------	--------

UPC CODES

DLEX3700W (Electric Dryer White)	048231024969
DLGX3701W (Gas Dryer White)	048231024976
WM3700HWA (Washer White)	048231024624
WDP4W (Pedestal White)	048231011211
DLEX3700V (Electric Dryer Graphite Steel)	048231024921
DLGX3701V (Gas Dryer Graphite Steel)	048231024938
WM3700HVA (Washer Graphite Steel)	048231024600
WDP4V (Pedestal Graphite Steel)	048231011198

LG LAUNDRY

WM3700H_A

4.5 cu. ft. Front Load Washer

- 12 Wash Programs
- 6 Motion™ Technology
- Inverter Direct Drive Motor with 10-Year Warranty
- Steam Technology
- TWINWash™ Compatibility
- SmartThinQ® (Wi-Fi Enabled)
- SmartDiagnosis™
- ColdWash™ Option
- ENERGY STAR® Most Efficient 2019
- NeverRust™ Stainless Steel Drum



SmartThinQ®

Enjoy new ways to control your home with LG smart appliances

- Start the laundry while you're out shopping
- Get alerts when the cycle is finished
- Works with the LG SmartThinQ® app

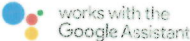

SUMMARY

Capacity (cu.ft.)	4.5 cu. ft.
Matching Electric Dryer	DLEX3700_
Matching Gas Dryer	DLGX3701_
Color	White (W), Graphite Steel (V)

APPEARANCE

Hard Buttons	Yes
Touch Buttons	Yes
Dial-A-Cycle™	Yes

ENERGY

ENERGY STAR® Most Efficient 2019	Yes
ENERGY STAR® Qualified	Yes
CEE Tier	2
IMEF	2.92
IWF	2.9

WASH PROGRAMS

No. of Programs	12
	Normal, Heavy Duty, Bedding, Sanitary, Allergiene™, Tub Clean, Bright White, Perm. Press, Delicates, Towels, Speed Wash, Downloaded

WASH OPTIONS

No. of Options	11
	Steam, Fresh Care, Prewash, Re-mote Start, Delay Wash, Wi-Fi, Add Garments, ColdWash, Extra Rinse, Rinse+Spin, Child Lock

WASH DETAILS

No. of Wash/Rinse Temps	5
Wash/Rinse Temps	Extra Hot, Hot, Warm, Cold, Tap Cold
No. of Spin Speeds	5
Spin Speeds	Extra High, High, Medium, Low, No Spin
Max RPM	1300
Water Levels	Load Sensing
No. of Soil Levels	5

FABRIC CARE FEATURES

Steam Technology	Yes
Allergiene™ Cycle	Yes
Sanitary Cycle	Yes
ColdWash™ Option	Yes
SenseClean™ System	Yes

CONVENIENCE FEATURES

TrueBalance™ Anti-Vibration System	Yes
4 Tray Dispenser	Prewash, Main Wash (with liquid detergent cup), Bleach, Fabric Softener
LoDecibel™ Quiet Operation	Yes
End of Cycle Signal	Yes
LoadSense	Yes
Child Lock*	Yes
Auto Suds Removal	Yes
Leveling Legs	4 Adjustable Legs
Easy Loading TilTub™	Yes
SMARTTHINQ® TECHNOLOGY	
SmartDiagnosis™ (v3.0)	Yes
Wi-Fi	Yes
Energy Monitoring	Yes
Cycle Monitoring and Notification	Yes

MOTOR

Motor Type	Inverter Direct Drive Motor
Axis	Horizontal

MATERIALS AND FINISHES

NeverRust™ Stainless Steel Drum	Yes
Cabinet	PCM
Control Panel	Plastic
Top Plate	Painted
Door / Rim	Glass/Chrome
Door Cover	Clear Round Cover
All Available Colors	White (W), Graphite Steel (V), Cherry Red (R)

CERTIFICATION

AFFA	Yes
------	-----

POWER SOURCE

Ratings	UL Listed
Electrical Requirements	120V, 10 Amps
Type	Electric

OPTIONS/ACCESSORIES

Pedestal	WDP4_
Pedestal (WxHxD)	27 x 14 1/8 x 30 3/4 (50 9/16 D with door open)
LG SideKick™ Pedestal Washer	WD100C_
LG SideKick™ Pedestal Washer (WxHxD)	27 x 14 1/8 x 30 3/4 (50 9/16 D with door open)
Stacking Kit	KSTK1

DIMENSIONS

Product (WxHxD)	27" x 39" x 30 1/4"
Depth with Door Open	(55" D with door open)
Carton (WxHxD)	29 23/32" x 41 27/32" x 31 17/32"
Weight (Product/Carton)	202.8 / 224.8 lbs.

LIMITED WARRANTY

Parts and Labor	3 Years
Direct Drive Motor	10 Years
Drum	Limited Lifetime

UPC CODES

WM3700HVA (Washer Graphite Steel)	048231024600
DLEX3700V (Electric Dryer Graphite Steel)	048231024921
DLGX3701V (Gas Dryer Graphite Steel)	048231024938
WDP4V (Pedestal Graphite Steel)	048231011198
WD100CV (LG SideKick™ Graphite Steel)	048231015165
WM3700HWA (Washer White)	048231024624
DLEX3700W (Electric Dryer White)	048231024969
DLGX3701W (Gas Dryer White)	048231024976
WDP4W (Pedestal White)	048231011211
WD100CW (LG SideKick™ White)	048231015172

LG LAUNDRY

WM3700H_A

4.5 cu. ft. Front Load Washer

QUICK INSTALL & CLEARANCES

For full installation directions/clearances please refer to the corresponding User Manual and Installation Guide.

DIMENSIONS	
A Width	27"
B Height	39"
C Depth	30 1/4"
D Depth with Door Open	55"
Carton (WxHxD)	29 23/32" x 41 27/32" x 31 17/32"
POWER SOURCE	
Ratings	UL Listed
Electrical Requirements	120V, 10 Amps
Type	Electric

DIMENSIONS AND CLEARANCES

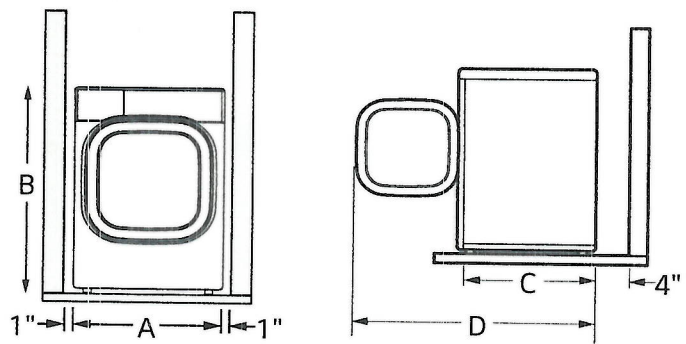

- Install the washing machine on a solid floor that is strong and rigid enough to support the weight of the washing machine, even when fully loaded, without flexing or bouncing. If the floor has too much flex, you may need to reinforce it to make it more rigid. If the floor is not solid, it may cause severe vibration and noise.

CONNECTING THE WATER LINES

- LG recommends the use of LG hoses. Any leaking, property damage, or damage to the washing machine caused by an improper installation or by the use of non-LG hoses is not covered under the terms of the LG warranty and is the sole responsibility of the customer and/or an installer.
- Water supply pressure must be between 20 psi and 120 psi (138-827 kPa). If the water supply pressure is more than 120 psi, a pressure reducing valve must be installed.
- Inspect the threaded fitting on each hose and make sure there is a rubber seal in place in both ends of each hose.
- Connect the water supply hoses to the HOT and COLD water faucets tightly by hand and then tighten another 2/3 turn with pliers.
- Always run a gallon or two of water through each inlet hose to flush dirt, scale and other debris out of the water lines. Doing so will help prevent future problems with clogged filter screens, and will also allow you to verify which water line is hot and which is cold.
- Attach the hot water line to the hot water inlet on the back of the washer. Attach the cold water line to the cold water inlet on the back of the washer. Tighten the fittings securely. Turn ON both faucets all the way and check for leaks at both ends of the hoses.

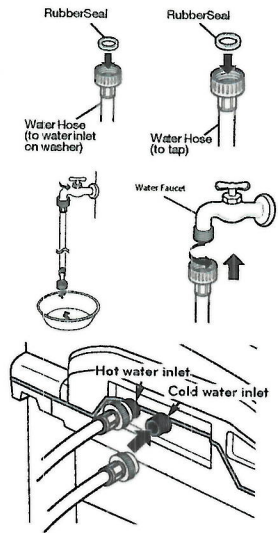

ELECTRICAL REQUIREMENTS

- The washer should be plugged into a 120-VAC, 60-Hz grounded 3-prong outlet. Plug in the washer. Improper connection of the equipment-grounding conductor can result in risk of electric shock. Check with a qualified electrician or service technician if you are in doubt as to whether the appliance is properly grounded. Do not modify the plug provided with the appliance. If it does not fit the outlet, have a proper outlet installed by a qualified electrician. Failure to follow these warnings can cause serious injury, fire, electrical shock, or death.
- The power outlet must be within 60 inches (1.5 m) of either side of the washer.
- The appliance and outlet must be positioned so that the plug is easily accessible.
- Do not overload the outlet with more than one appliance.
- The outlet must be grounded in accordance with current wiring codes and regulations.
- Time-delay fuse or circuit breaker is recommended.
- It is the personal responsibility and obligation of the product owner to have a proper outlet installed by a qualified electrician.



CONNECTING THE DRAIN HOSE

- The drain hose should always be properly secured. Failure to properly secure the drain hose can result in flooding and property damage.
- The drain must be installed in accordance with any applicable local codes and regulations.
- Make sure that the drain hose is not stretched, pinched, crushed, or kinked.
- Normal height of the end of the hose should be approximately 35"-47" (0.9-1.2 m) from the floor.
- Do not install the end of the drain hose lower than 29 in. (73.7 cm) or higher than 96 in. (243.8 cm) above the bottom of the washer or more than 60 in. (152.4 cm) away from the washer.
- Never create an airtight seal between the hose and the drain with tape or other means. If no air gap is present, water can be siphoned out of the tub resulting in poor wash/rinse performance or clothing damage.

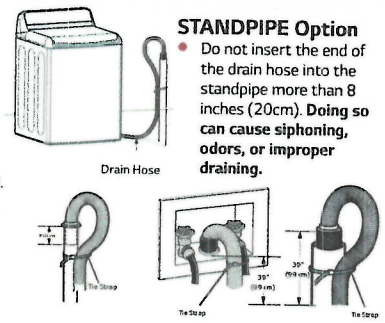

LAUNDRY TUB Option

- Do not use this drain hose with a floor drain. The end of the drain hose must be at least 29 inches above the floor for proper draining to occur.



CONSTRUCTION SUMMARY

Orchards - 2174372 Ontario Ltd.

PURCHASERS: SATISH KUMAR POLUMATI and SOWMYA MOKA TEL:

LOT / PHASE	REG. PLAN #	HOUSE TYPE		CLOSING DATE
3 / Orchards	40M-2627	Spencer (40-4) Elev B		21-Oct-21

Agreement of Purchase and Sale

BONUS: CENTRAL AIR CONDITIONER (FROM BUILDERS STANDARD SAMPLES) <i>Worksheet</i> <i>Note:</i>	
BONUS: GRANITE KITCHEN COUNTER TOP - AS PER PLAN (FROM BUILDERS STANDARD SAMPLES) <i>Worksheet</i> <i>Note:</i>	
BONUS: 2 1/4 INCH NATURAL HARDWOOD FLOORING ON MAIN FLOOR (EXCLUDING TILE AREAS) - AS PER PLAN (FROM BUILDERS STANDARD SAMPLES). <i>Worksheet</i> <i>Note:</i>	
BONUS: 1ST UPGRADE COLONIAL TRIM - AS PER PLAN (FROM BUILDERS STANDARD SAMPLES) <i>Worksheet</i> <i>Note:</i>	
BONUS: \$22,500.00 IN UPGRADES - TO BE USED AT BUILDERS DECORE CENTRE AT TIME OF COLOUR SELECTIONS (INCLUSIVE OF HST) <i>Worksheet</i> <i>Note:</i>	
BONUS: EXTENDED UPPER KITCHEN CABINETS - AS PER PLAN (FROM BUILDERS STANDARD SAMPLES) <i>Worksheet</i> <i>Note:</i>	
BONUS: 1ST UPGRADE KITCHEN CABINETS - AS PER PLAN (FROM BUILDERS STANDARD SAMPLES) <i>Worksheet</i> <i>Note:</i>	
BONUS: 1ST UPGRADE OAK PICKETS AND RAILING - AS PER PLAN (FROM BUILDERS STANDARD SAMPLES) <i>Worksheet</i> <i>Note:</i>	



CONSTRUCTION SUMMARY

Orchards - 2174372 Ontario Ltd.

PURCHASERS: SATISH KUMAR POLUMATI and SOWMYA MOKA				TEL:
LOT / PHASE 3 / Orchards	REG. PLAN # 40M-2627	HOUSE TYPE Spencer (40-4) Elev B		CLOSING DATE 21-Oct-21

1) CONSTRUCTION

1 - CEILING - SMOOTH FINISH - 1ST AND 2ND FLOOR (40 FOOT MODELS) 29Mar21 Note: 11,518/36675	
--	--

10) COUNTERTOPS

1 - UPGRADE STONE COUNTERTOP - UPGRADE 3/4" EDGE TO 1 1/2" STANDARD EDGE - - KITCHEN 29Mar21 Note: 11,518/36977	
--	--

3) HEATING / AIR CONDITIONING

1 - GAS LINE - ROUGH-IN FOR STOVE INCLUDING ELECTRICAL OUTLET 29Mar21 Note: 11,518/36969	
1 - FIREPLACE - GAS - 36 INCH SINGLE SIDED STANDARD - WITH STANDARD PAINT GRADE MANTLE - (NO MARBLE) 29Mar21 Note: 11,518/36671	

4) PLUMBING

1 - KITCHEN - ALIGN 7565 CHROME, 1 HOLE APPLICATION 29Mar21 Note: 11,518/36980	
1 - SINK - KITCHEN - UNDERMOUNTED (RECTANGULAR SQUARE - SINGLE LARGE BOWL) 29Mar21 Note: 11,518/36978	
1 - WATER LINE - FRIDGE - ROUGH IN ONLY 29Mar21 Note: 11,518/36971	
1 - 3 PIECE ROUGH IN BASEMENT 29Mar21 Note: 11,518/36666	

5) ELECTRICAL

3 - NETWORK JACK - ADDITIONAL - CAT5E ROUGH-IN (BEDROOM 2, 3 AND 4) SEE PLAN 29Mar21 Note: 11,518/36672	
--	--

6) FLOORING & WALL TILE

1 - OAK - 3/4 " X 2 1/4 " NATURAL - UPGRADE FROM CARPET - - UPPER HALL (UPGRADE FROM CARPET) - 29Mar21 Note: 11,518/36983	
1 - OAK - 3/4 " X 2 1/4 " NATURAL - UPGRADE FROM CERAMIC TILE - - KITCHEN AND BREAKFAST (UPGRADE FROM CERAMIC) - 29Mar21 Note: 11,518/36982	
1 - OAK - 3/4 " X 2 1/4 " NATURAL - UPGRADE FROM CERAMIC TILE - - FOYER AND MAIN HALL (UPGRADE FROM CERAMIC) - 29Mar21 Note: 11,518/36981	

8) FINISHING

1 - RAILING - 1/2 INCH WROUGHT IRON SQUARE PICKET WITH SINGLE SQUARE COLLAR ON ALTERNATING PICKET, 3 INCH OAK HANDRAIL AND 3 1/2 INCH OAK STANDARD POST. 29Mar21 Note: 11,518/36979	
--	--

9) CABINETRY



CONSTRUCTION SUMMARY

Orchards - 2174372 Ontario Ltd.

PURCHASERS: SATISH KUMAR POLUMATI and SOWMYA MOKA TEL:

LOT / PHASE	REG. PLAN #	HOUSE TYPE		CLOSING DATE
3 / Orchards	40M-2627	Spencer (40-4) Elev B		21-Oct-21

9) CABINETRY

1 - BASE CABINETS - CORNER SYSTEMS - BASE PIE-CUT CORNER - GROUP 1 - 4 29Mar21 Note: 11,518/37380	
1 - APPLIANCE CABINETS - OVEN - BUILT-IN FLUSH MOUNT OVEN IN BASE CABINET WITH COOKTOP ABOVE (INCLUDES COOKTOP CUT-OUT) (SUPPLY ALL SPECS AND INSTALLATION GUIDES) (COOKTOP AND OVEN MUST BE SAME WIDTH) - GROUPS 1 - 4 29Mar21 Note: 11,518/36976	
1 - PANTRY CABINETS - PANTRY 66CM DEEP PER FOOT (COUNTER DEPTH) - GROUP 1 - 4 (BESIDE DISHWASHER END) SEE PLAN 29Mar21 Note: 11,518/36972	
1 - APPLIANCE CABINETS - MICROWAVE - BASE CABINET FOR UNDER-COUNTER MICROWAVE WITH DRAWER BELOW (FINISHED INTERIOR) (SUPPLY SPECS) - GROUP 1 - 4 IN ISLAND, SEE PLAN, CLOSEST IN BASE TO SINK 29Mar21 Note: 11,518/36968	
1 - UPPER CABINETS - DELETE CABINET ABOVE STOVE FOR PURCHASERS FUTURE CHIMNEY HOOD FAN (SUPPLY SPECS) 29Mar21 Note: 11,518/36542	
1 - APPLIANCE CABINETS - FRIDGE - 66CM DEEP FRIDGE ENCLOSURE (COUNTER DEPTH) WITH NO WALLS ([2] 66CM DEEP GABLES AND [1] 66CM DEEP CABINET) (THIS IS NOT A ZERO CLEARANCE ENCLOSURE. STANDARD HEIGHTS AND WIDTHS WILL BE USED.) 29Mar21 Note: 11,518/36536	

CABINETRY - VANITY

4 - VANITY CABINETS - DRAWERS - VANITY BANK OF DRAWERS (MAX. WIDTH 55CM) - GROUP 1 - 4 **MASTER X 1, MAIN X 2, SHARED X 1** SEE PLAN 29Mar21 Note: 11,518/37275	
---	--

SHOWERS

1 - SHOWER - CHANGE FRAMED SHOWER TO FRAMELESS GLASS ENCLOSURE (INCLUDES GLASS DOOR) - (MASTER ENSUITE) 29Mar21 Note: 11,518/36680	
--	--

WINDOWS AND DOORS - EXTERIOR

1 - DOOR - EXTERIOR - SIDE ENTRANCE - INCLUDES EXTERIOR LIGHT 29Mar21 Note: 11,518/36673	
4 - WINDOW - BASEMENT -ENLARGE STANDARD TO 36 INCH (W) X 24 INCH (H) - EACH ADDITIONAL 29Mar21 Note: 11,518/36667	

This Document is Extremely Time Sensitive - Printed 29 Mar 21 at 18:13