

HIGHCASTLE HOMES - COLOUR SCHEDULE

Purchasers:

ALEXANDER GHANDHI & MARIE-PASCALE B GHANDHI

Property: 2Phase: Orchards of Plan - 40M-2627

Telephone Res. / Bus:

/

Project: 2174372 Ontario Ltd.

Decor Advisor:

Caroline Rajcsanyi

Model and Elevation: Spencer (40-4) Elev A

KITCHEN AND VANITIES

	Cabinet	Counter	Hardware
Kitchen	Lv2 - Manchester Maple - Shale Grey CL	Lv1 - GR-Serenata	*2- 12805 BN Nickel Handle
Main Bathroom	NA	N/A	N/A
Ensuite Bathroom	Lv2 - Manchester Maple - Shale Grey CL	Italian White Di Pesco 4954K-22	196 Knob
Ensuite 2	Lv2 - Manchester Maple - Shale Grey CL	Italian White Di Pesco 4954K-22	196 Knob
Shared Ensuite	Lv2 - Manchester Maple - Shale Grey CL	Italian White Di Pesco 4954K-22	196 Knob
Opt. Breakfast Bar	Counter Height/Flush	Kitchen Hood Fan	Accommodate for over-range microwave
		Kitchen Upper Height	100 cm

Stove opening – if not specified will be set to builders standard opening of approximately 30 in width

Fridge Opening – if not specified will be set to builders minimum opening of approximately 33 x71 height (townhouses)

- if not specified will be set to builders minimum opening of approximately 36 x 71 height (singles)

Counter top Edge

Kitchen

Double Edge (1 1/2") Top Bevelled

Opt. Kitchen Extras

PARQUET / HARDWOOD OR BROADLOOM

Kitchen / Breakfast	N/A	Master Bedroom	Oak Strip Lauzon Essential Solid 2 1/4" x 3/4"-Natural
Great Room	Oak Strip Lauzon Essential Solid 2 1/4" x 3/4"-Natural	Bedroom 2	Oak Strip Lauzon Essential Solid 2 1/4" x 3/4"-Natural
Living / Formal Room	N/A	Bedroom 3	Oak Strip Lauzon Essential Solid 2 1/4" x 3/4"-Natural
Dining Room	Oak Strip Lauzon Essential Solid 2 1/4" x 3/4"-Natural	Bedroom 4	Oak Strip Lauzon Essential Solid 2 1/4" x 3/4"-Natural
Family Room	N/A		
Main Hall	N/A		
Main Stairs	Oak		
Upper Hall	Oak Strip Lauzon Essential Solid 2 1/4" x 3/4"-Natural		
Com. Centre/Home Office	N/A	Basement	N/A
Main Stair Landing	N/A	Basement Landing	N/A
Library/Den/Study	Oak Strip Lauzon Essential Solid 2 1/4" x 3/4"-Natural	Basement Stairs	Paint Grade (Grey)
In Law Suite	N/A		

Carpet Runner ☐ Yes ☒ No

Underpad Main Floor	Underpad 2nd Floor	Underpad Main Stairs
NA	NA	NA

Opt. Flooring Extras

FLOOR AND WALL TILES

	Floor Tile	Decor	Listello
Front Foyer	1-13x13, Alpes, White		
Main Hall	1-13x13, Alpes, White		
Kitchen/Breakfast	1-13x13, Alpes, White		
Powder Room	1-13x13, Alpes, White		
Laundry	1-13x13, Alpes, White		

Kitchen Backsplash

Pwdr Wall if Applicable

N/A

N/A

☐

☐

☐

☐

	Floor	Tub Wall	Shower Wall	Deck Skirt	Deck Splash	Decor	Listello
Main Bathroom	N/A	N/A	N/A	N/A	NA	<input type="checkbox"/>	<input type="checkbox"/>
Master Ens	1-13x13, Serpentine White	N/A	1-8x10, Serpentine White	1-13x13, Serpentine White	1-8x10, Serpentine White	<input type="checkbox"/>	<input type="checkbox"/>
Ensuite 2	1-13x13, Serpentine White	1-8x10, Serpentine White	N/A	N/A	NA	<input type="checkbox"/>	<input type="checkbox"/>
Shared Ens.	1-13x13, Serpentine White	1-8x10, Serpentine White	N/A	N/A	NA	<input type="checkbox"/>	<input type="checkbox"/>
						<input type="checkbox"/>	<input type="checkbox"/>
						<input type="checkbox"/>	<input type="checkbox"/>
						<input type="checkbox"/>	<input type="checkbox"/>

Shower - Upgrade Floor

Opt. Tile Extras

HIGHCASTLE HOMES - COLOUR SCHEDULE

Purchasers: ALEXANDER GHANDHI & MARIE-PASCALE B GHANDHI Property: 2Phase: Orchards of Plan - 40M-2627
Telephone Res. / Bus: / Project: 2174372 Ontario Ltd.
Decor Advisor: Caroline Rajcsanyi Model and Elevation: Spencer (40-4) Elev A

PLUMBING / FAUCETS

Powder Room	Standard	Laundry	Standard
Main Bath	N/A	Shared Ensuite	Standard
Master Ensuite	Standard		
2nd Ensuite	Standard		
B.I. Bath	*2 Piece RELOCATED***		
Kitchen Sink	*Undermount		
Kitchen Faucet	Standard		
Drain for 2nd floor Laundry	<input type="radio"/> Yes <input checked="" type="radio"/> No		
Waterline for fridge	<input type="radio"/> Yes <input checked="" type="radio"/> No		
Supply and install all toilet paper holders, towel bars and soap dishes	<input type="radio"/> Yes <input checked="" type="radio"/> No		
Whirlpool			

Opt. Plumbing Extras

PAINTING

Wall Colour	Trim Colour	Railing Colour	Pickets Colour	Stair Colour
22 Warm Grey	Standard	Natural	Natural	Natural
Opt. Paint Extras				

MISCELLANEOUS

Railing Style	RAILING - STANDARD - 1 3/4in oak picket, 3in oak handrail and 3 1/2in oak post.				
Opt. Garage Door	*Yes-Grade Permitting	Opt. Side Door	No	Stair Type	Oak
Interior Doors	Standard - Classique	Int. Door Hardware	*Pewter Knob	Ext. Door Hardware	*Pewter Exterior package
		Trim Style	*1 - 3in Case W/Backband & 5in Base, Colonial		Cold Cellar <input type="checkbox"/>
Smooth Ceiling 1st Floor	<input checked="" type="radio"/> Yes <input type="radio"/> No		Basement Windows Upgrade	<input type="radio"/> Yes <input checked="" type="radio"/> No	
Smooth Ceiling 2nd Floor	<input checked="" type="radio"/> Yes <input type="radio"/> No				
Supply and Install Standard Mirrors	<input checked="" type="radio"/> Yes <input type="radio"/> No				
Misc.					
200 AMP SERVICE					

HEATING

Fireplace	Type	Mantle	Surround	Hearth
Air Conditioning	<input checked="" type="radio"/> *Yes <input type="radio"/> No		Gas Provisions for BBQ	<input type="radio"/> Yes <input checked="" type="radio"/> No
Hood Fan Duct	<input checked="" type="radio"/> 6 inch <input type="radio"/> 8 inch <input type="radio"/> 10 inch		Humidifier	<input type="radio"/> Yes <input checked="" type="radio"/> No
Gas Provisions for Dryer	<input type="radio"/> Yes <input checked="" type="radio"/> No			
Gas Provisions for Stove	<input type="radio"/> Yes <input checked="" type="radio"/> No			

Exterior Colour Scheme:

Pre-selected By Vendor

NOTE: The Purchaser(s) agree(s) that:

- a) Colours of materials are as close as possible to Vendor's selections, but not necessarily identical due to variances in manufacturing or manufacturers.
- b) Purchaser(s) has checked and acknowledges accuracy of the above selections. Where omissions occur on the original colour selection sheet Purchaser(s) acknowledge that the Builder's selection will be final.
- c) Upgrades or extras listed on this schedule will not be deemed part of the Agreement of Purchase and Sale. Any such upgrades or extras shall be null and void unless accompanied by a separate invoice and amendment. Said invoice must be paid in full.
- d) The Purchaser(s) further agrees that in the event that the Vendor has preselected colours prior to the purchase of the house, the prescribed colours are final not withstanding that the Purchaser may have completed a colour selection schedule
- d) The Purchaser(s) Acknowledges that once this colour schedule is signed and dated, no changes, additions or deletions will be permitted other than re-selection due to unavailability.

A \$350.00 (Per Occurance) change/administration fee will apply to above exceptions.

This Interior Colour Selection is final and approved by:

Signature: [Signature] Date: 8/25/2020

Printed 8/25/2020 12:14:24

Signature: [Signature] Date: 8/25/2020

Builder's Agent: [Signature] Date: Aug 25 2020



Highcastle Homes Décor Centre Disclaimers

Lot#: 2 Model:Spencer (40-4) Elev A in Northglen (H) - 2174372 Ontario Ltd.

PURCHASERS: ALEXANDER GHANDHI and MARIE-PASCALE B GHANDHI

TEL:

Through years of doing business, we at Highcastle Homes have encountered issues beyond our control. The following disclaimers apply to all instances of Purchaser's Extras forms and all Interior Colour Scheme forms.

Fireplaces

Fireplace Marble: Due to the many variables that can affect the pattern and/or design, frequently the marble installed on the fireplace will not be identical to the samples. We will make every attempt to come as close to the samples as possible, but cannot be responsible for results which differ from the samples.

Ceramic Floor Tile

Many variables including variegation can affect tile colour, pattern and/or design which mean installed tiles may not be identical to the samples. We will make every attempt to come as close as possible, but cannot be responsible for results which differ from the samples.

Hardwood Flooring

The purchaser is advised that cupping and shrinkage are characteristics of hardwood flooring normal appearing some time after installation, and no warranty is provided by the flooring supplier with respect to such cupping and shrinkage. The vendor agrees to install any hardwood flooring ordered by the purchaser in good and workmanlike manner, but shall not be responsible for, and is hereby released by the purchaser from responsibility and liability for cupping and shrinkage of hardwood flooring.

Shrinking and expanding/cupping of the hardwood floors may occur if the humidity levels in the home are not kept at industry recommendations. If the hardwood floors shrink or expand due to the homeowner not complying with these levels, the hardwood floor will no longer be under warranty and it will be the homeowner's responsibility to repair the flooring.

Stain Colours

Due to many variables that can affect the outcome of a stain colour on wood, staircases, railings, and fireplaces, will not be identical to samples. Factors such as density, age humidity, air temperature, and the uniqueness of each piece of wood can result in wide variations in darkness or lightness. We will make every attempt to come as close to the sample as possible, but cannot be responsible for results which differ from the samples.

Stain on pre-finished hardwood floors will not be an exact match to the stain colours available on stairs, pickets and rails. The purchaser is responsible for choosing the stain on these areas to their satisfaction.

Appliances

All fridge openings are set to builder's standard width. Please advise Décor Centre at time of colour appointment if custom sizing of cabinets is required for any built - in appliances. The purchaser is responsible for costs and fees associated with changes to pre-manufactured kitchens made subsequent to colour appointments.

Kitchen Cabinets

The kitchen you order/purchase will undoubtedly contain slight colour variations. The degree of these variations is virtually impossible to determine before the kitchen is installed in its intended location. The amount of and type of lighting will also affect various highlights in the finish. Note: No two pieces of wood are identical. Variations in colour tone and grain patterns make a perfect colour match virtually impossible. It is generally agreed that these variations add to the natural beauty of a wood kitchen.

Shrinking and expanding of the kitchen cabinets may occur if the humidity levels in the home are not kept at industry recommendations. If the cabinets shrink or expand due to the homeowner not complying with these levels, the cabinets will no longer be under warranty and it will be the homeowner's responsibility to repair the cabinets.

Plaster Mouldings and Medallions



Plaster mouldings will not be installed in open to above areas or areas with 2 storey elements.

Metal Spindles

Due to the characteristics of wrought iron railing production, it is possible for the wrought iron to develop a scale effect. This scale may or may not be totally covered during the painting process. In effect, once the wrought iron picket is painted, the paint may in effect amplify the iron scale depending on the colour chosen. This is a natural effect of wrought iron and should not be constued as a defect or damage.

I hereby acknowledge reading and understanding the above copy and will not hold Highcastle Homes responsible for any issues in relation to above.

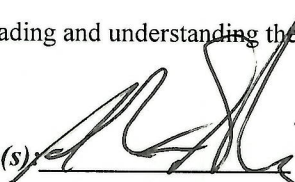
Purchasers Signature(s)

  Date: 8/25/2020

Lor 2.
Orchards

STONE EDGE PROFILES

Approx 2CM or 3/4" Standard Edge

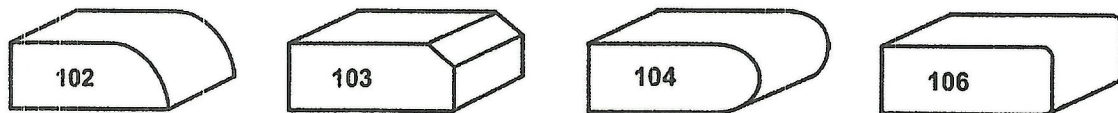

1st UPGRADE

Approx 4CM or 1.5" - SEAMS WILL BE VISIBLE

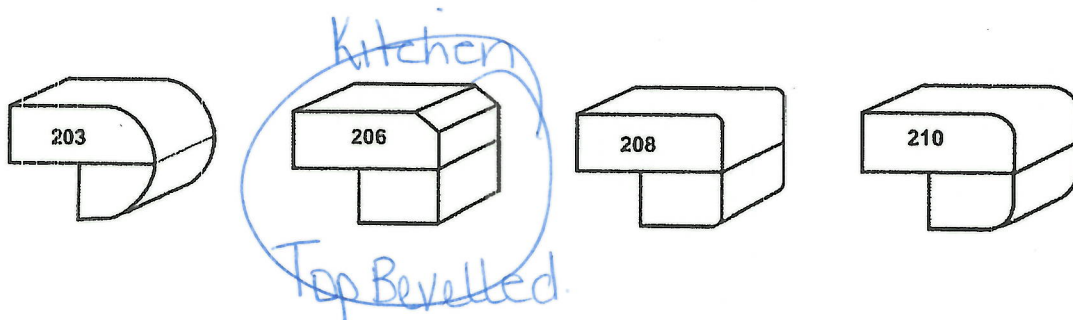

2nd UPGRADE

Approx 4CM or 1.5" - SEAMS WILL BE VISIBLE

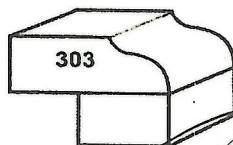

Sign
Sign

MP Ghandhi

Date 8/25/2020
Date 8/25/2020

PRODUCT MODEL NUMBERS

KRMF606E

KRME706F

Electrical: A 115 volt, 60 Hz, AC only, 15- or 20-amp fused, grounded electrical supply is required. It is recommended that a separate circuit serving only your refrigerator be provided. Use an outlet that cannot be turned off by a switch. Do not use an extension cord.

Water: A cold water supply with water pressure between 35 and 120 psi (241 and 827 kPa) is required to operate the water dispenser and ice maker. If you have questions about your water pressure, call a licensed, qualified plumber.

NOTE: If the water pressure is less than what is required, the flow of water from the water dispenser could decrease or ice cubes could be hollow or irregular shaped.

Reverse Osmosis Water Supply:

IMPORTANT: The pressure of the water supply coming out of a reverse osmosis system going to the water inlet valve of the refrigerator needs to be between 35 and 120 psi (241 and 827 kPa).

If a reverse osmosis water filtration system is connected to your cold water supply, the water pressure to the reverse osmosis system needs to be a minimum of 40 to 60 psi (276 to 414 kPa).

Bottom Mount Refrigerator

PRODUCT DIMENSIONS

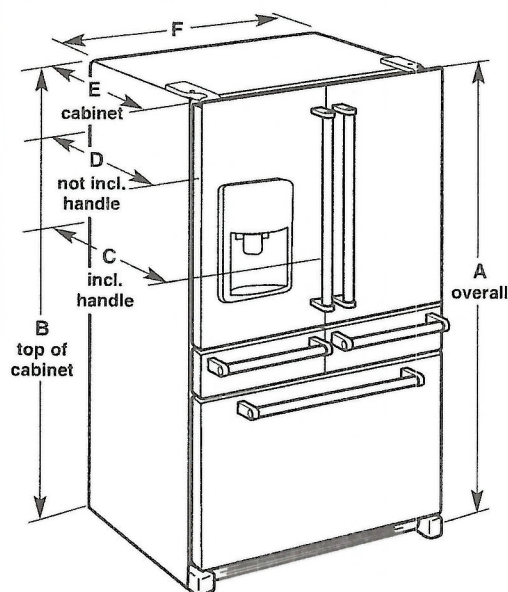

Model Size	Height - Overall "A"	Height - Top of Cabinet "B"	Depth - With Handles "C"	Depth - Without Handles "D"	Depth - Cabinet Only "E"	Width - Cabinet "F"
25.8	70 1/8" (178.1 cm)	68 3/4" (173.7 cm)	36 1/4" (92.1 cm)	34 1/2" (87.7 cm)	29" (73.7 cm)	36" (91.4 cm)

LOCATION REQUIREMENTS

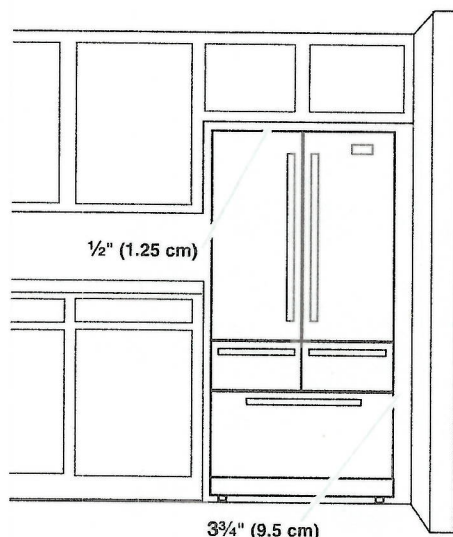

IMPORTANT: This refrigerator is designed for indoor, household use only.

To ensure proper ventilation for your refrigerator, allow for a ½" (1.25 cm) of space on each side and at the top. Allow for a 1" (2.54 cm) space behind the refrigerator. If your refrigerator has an ice maker, allow extra space at the back for the water line connections. When installing your refrigerator next to a fixed wall, leave a 3¾" (9.5 cm) minimum space between the refrigerator and wall to allow the door to swing open.

NOTE: This refrigerator is intended for use in a location where the temperature ranges from a minimum of 55°F (13°C) to a maximum of 110°F (43°C). The preferred room temperature range for optimum performance, which reduces electricity usage and provides superior cooling, is between 60°F (15°C) and 90°F (32°C). It is recommended that you do not install the refrigerator near a heat source, such as an oven or radiator.

LOT 2.
Orchards

80

MPG

Café™ 30" Slide-In Front Control Induction and Convection Double Oven Range

CHS950P4MW2 / CHS950P3MD1 / CHS950P2MS1

C A F E

DISTINCT BY DESIGN™

Lot 2
Orchards

[Handwritten signature]

POWER / RATINGS

Amp Rating at 208V	40
Amp Rating at 240V	40
Convection Wattage	2500W
Bake Wattage	2650W Upper / 2650W Lower
Broiler Wattage	3000W Upper / 3600W Lower
KW Rating at 208V	12.6
KW Rating at 240V	15.2

WARRANTY

Parts warranty	Limited 1-year entire appliance
Labor warranty	Limited 1-year entire appliance

DIMENSIONS

Receptacle Locations: Locally approved flexible service cord or conduit must be used because terminals are not accessible after range installation. See shaded area in drawing for location of electrical outlet box. Recommended outlet locations allow range to be installed directly against rear wall.

Note: This appliance has been approved for 0" spacing to adjacent surfaces above the cooktop. However, a 6" minimum spacing to surfaces less than 15" above the cooktop and adjacent cabinet is recommended to reduce exposure to steam, grease splatter and heat.

Installation Information: Before installing, consult installation instructions for current dimensional data and additional requirements.

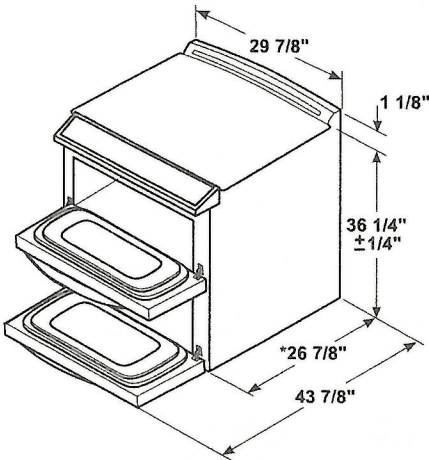

*Depth including door handle is approximately 29-1/2".

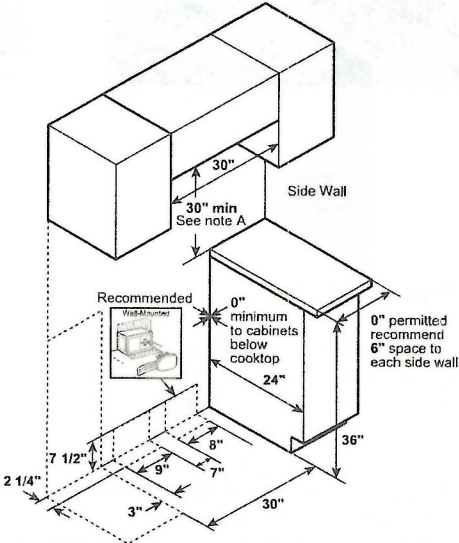

Note A: 30" Minimum to bare cabinet, see installation instructions heights less than 30"

ADDITIONAL ACCESSORIES

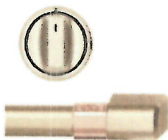

CXFCHHKPMBZ
Brushed Bronze
2 handles; 6 knobs
(standard on Matte White)

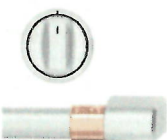

CXFCHHKPMSS
Brushed Stainless
2 handles; 6 knobs
(standard on Matte Black)



CXFCHHKPMBT
Brushed Black
2 handles; 6 knobs

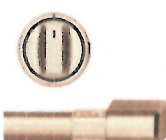

CXFCHHKPMCU
Brushed Copper
2 handles; 6 knobs



JXPROBE1
Probe Accessory

COVID-19: The health and safety of our customers and team members is a top priority. [LEARN MORE](#)

By closing this message, you consent to our cookies on this device in accordance with our [Privacy Notice](#) unless you have disabled them.

close

Lot 2.
Orchards.

KitchenAid®



< Microwave Hood Combinations

MPG ←

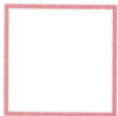

1000-Watt Low Profile Microwave Hood Combination

YKMLS311HSS

★★★★★ 4.5 (430) [Write a review](#)

MSRP: \$999.99

Colour: Stainless Steel



WHERE TO BUY

♡ [WishList](#)

□ [Compare](#)

Lot 2.
Orchards

Electrical Requirements

MPG

~~8~~

Installation Dimensions

NOTE: The grounded 3 prong outlet must be inside the upper cabinet. See the "Electrical Requirements" section.

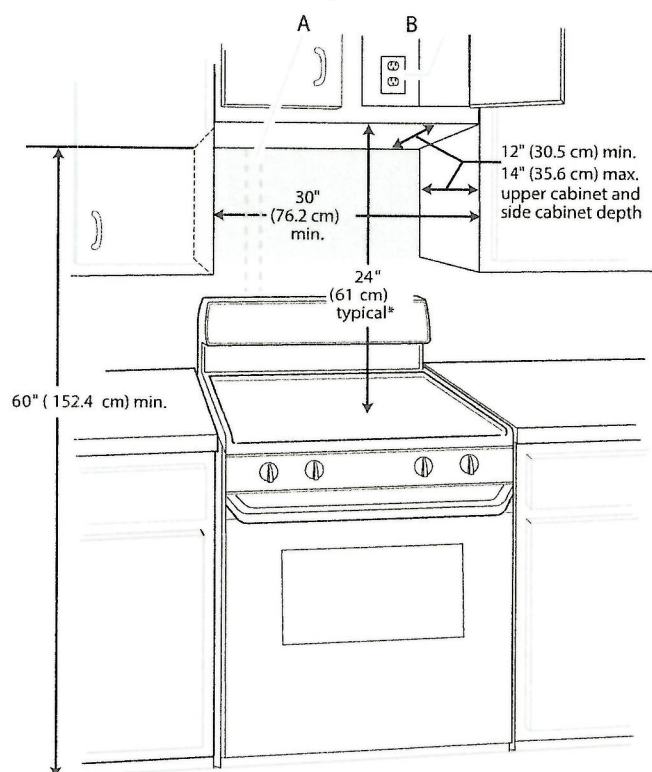

A. 2" x 4" wall stud
B. Grounded 3 prong outlet

*24" (61 cm) is typical for 60" (152.4 cm) installation height. Exact dimensions may vary depending on type of range/cooktop below.

NOTE: To ensure good performance, do not obstruct top vent airflow. If cabinets are deeper than 14" (35.6 cm) but no more than 15" (38.1 cm), use the bump out mounting kit replacing the mounting plate from the wall. The bump out mounting kit (part # W11185746) is not provided but can be purchased from Whirlpool.

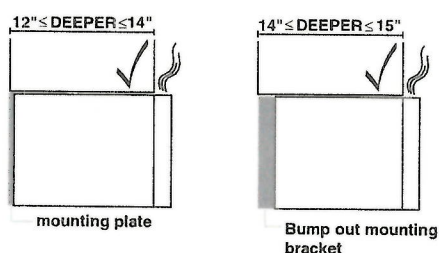

mounting plate

Bump out mounting bracket

Product Dimensions

*Overall depth of product will vary slightly depending on door design.

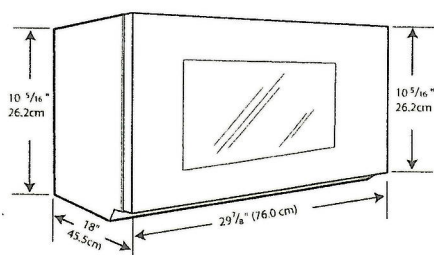

WARNING



Electrical Shock Hazard

Plug into a grounded 3 prong outlet.

Do not remove ground prong.

Do not use an adapter.

Do not use an extension cord.

Failure to follow these instructions can result in death, fire, or electrical shock.

Observe all governing codes and ordinances.

Required:

- A 120 V, 60 Hz, AC only, 15 or 20 A electrical supply with a fuse or circuit breaker

Recommended:

- A time-delay fuse or time-delay circuit breaker
- A separate circuit serving only this microwave oven

GROUNDING INSTRUCTIONS

■ For all cord connected appliances:

The microwave oven must be grounded. In the event of an electrical short circuit, grounding reduces the risk of electric shock by providing an escape wire for the electric current. The microwave oven is equipped with a cord having a grounding wire with a grounding plug. The plug must be plugged into an outlet that is properly installed and grounded.

WARNING: Improper use of the grounding plug can result in a risk of electric shock. Consult a qualified electrician or serviceman if the grounding instructions are not completely understood, or if doubt exists as to whether the microwave oven is properly grounded.

Do not use an extension cord. If the power supply cord is too short, have a qualified electrician or serviceman install an outlet near the microwave oven.

SAVE THESE INSTRUCTIONS

Lot 2.
Orchards

[Signature]
MPG

KitchenAid®

24" Dishwasher

DETAILED PLANNING DIMENSIONS GUIDE

Applies to all model numbers starting with;

KDFE104K, KDFE204K, KDTE204K, KDTE204LPA, KDFM404K,
KDTM404K, KDPM604K, KDTM604K, KDPM704K, KDTM704K,
KDTM704LPA, KDPM804K, KDTM804K

PRODUCT DIMENSIONS

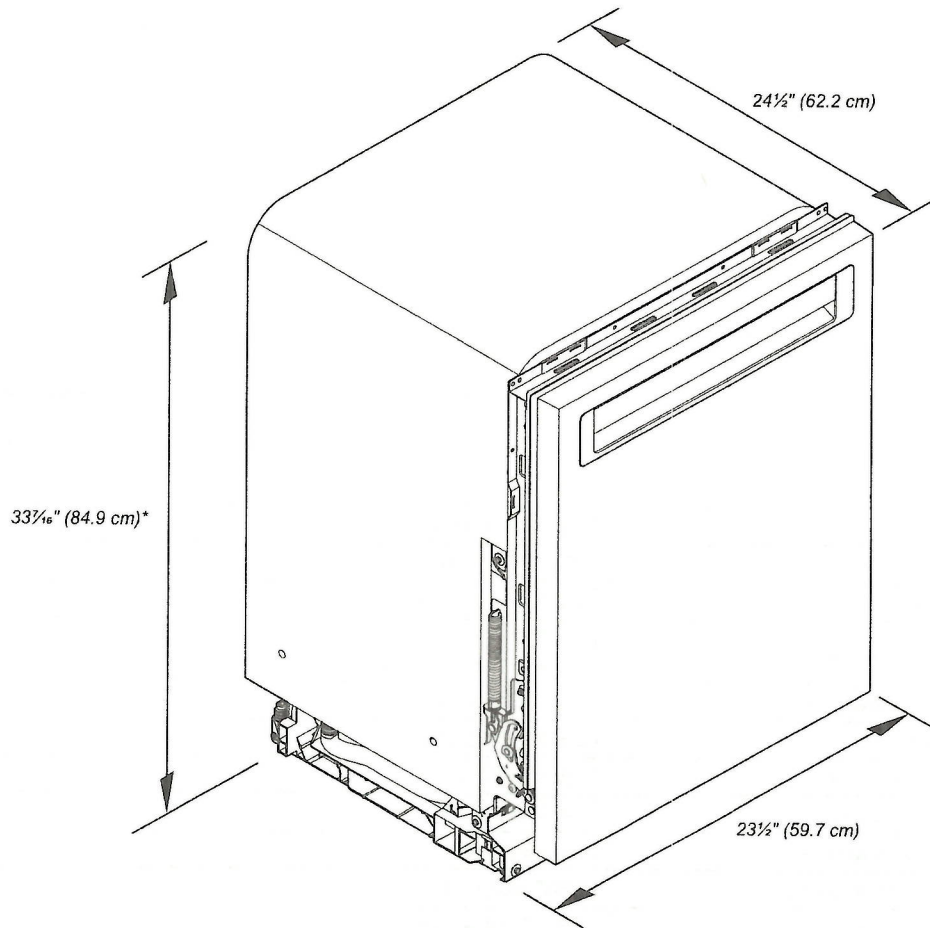

*Dishwasher can be raised 1 7/16" (3.7 cm) with feet fully extended.

Because Whirlpool Corporation policy includes a continuous commitment to improve our products, we reserve the right to change materials and specifications without notice.

Dimensions are for planning purposes only. For complete details, see Installation Instructions packed with product. Specifications subject to change without notice.

Custom under-counter installation:

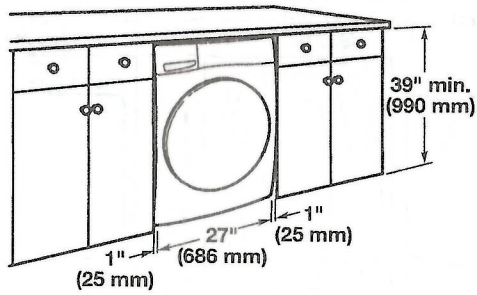

Recessed area or closet installation:

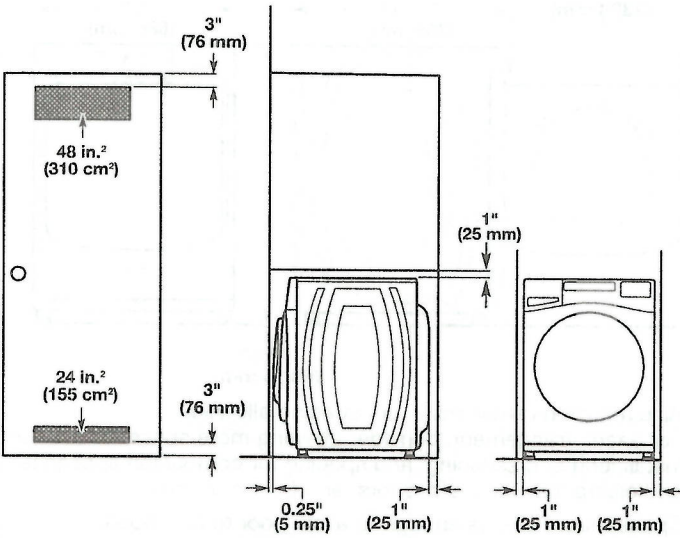

Custom cabinet installation:

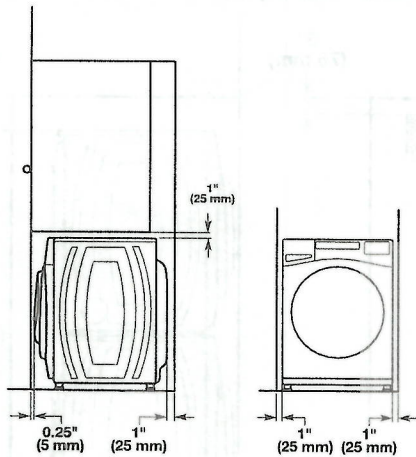

DRAIN SYSTEM

The drain system can be installed using a floor drain, wall standpipe, floor standpipe, or laundry tub. Select the method you need.

IMPORTANT: To avoid siphoning, only 4.5" (114 mm) of drain hose should be inside standpipe. Always secure drain hose with cable tie.

Floor standpipe drain system

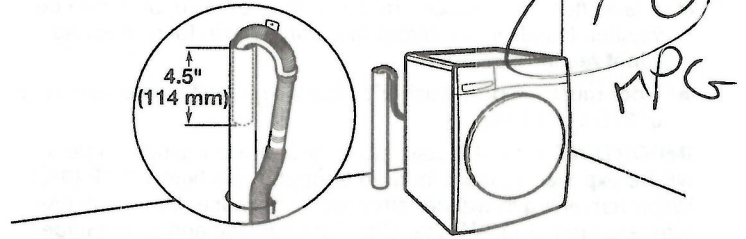

Minimum diameter for a standpipe drain: 2" (51 mm). Minimum carry-away capacity: 17 gal. (64 L) per minute. A 1/4" (6 mm) diameter to 1" (25 mm) diameter Standpipe Adapter Kit is available (Part Number 3363920). Top of standpipe must be at least 30" (762 mm) high; install no higher than 96" (2.44 m) from bottom of washer. If you have an overhead sewer and need to pump higher than 96" (2.44 m), a sump pump and associated hardware are needed. See "Alternate parts."

Wall standpipe drain system

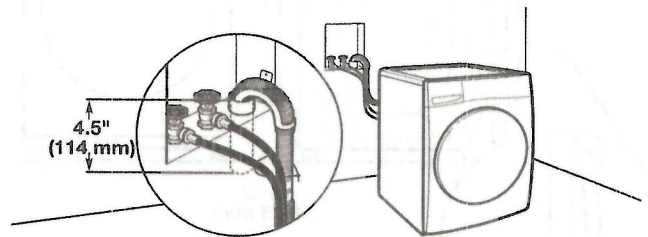

See requirements for floor standpipe drain system.

Laundry tub drain system

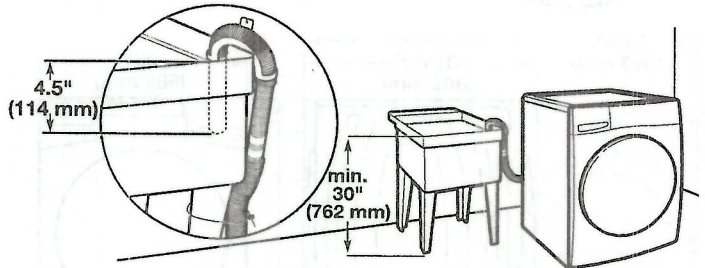

Minimum capacity: 20 gal. (76 L). Top of laundry tub must be at least 30" (762 mm) above floor; install no higher than 96" (2.44 m) from bottom of washer.

Lot 2.
Orchards.
11/6

Back view:

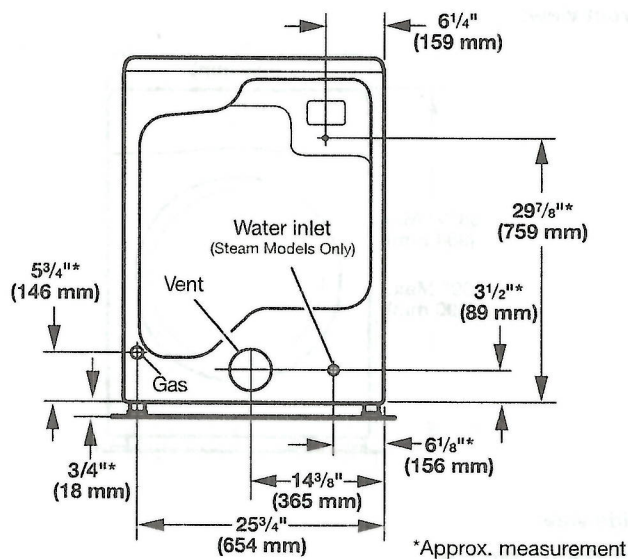

NOTE: Most installations require a minimum of 5" (127 mm) clearance behind dryer for exhaust vent with elbow. See "Venting Requirements."

Installation Clearances

For each arrangement, consider allowing more space for ease of installation and servicing, spacing for companion appliances, and clearances for walls, doors, and floor moldings. Space must be large enough to allow door to fully open. Add spacing on all sides of dryer to reduce noise transfer. If a closet door or louvered door is installed, top and bottom air openings in door are required.

Check code requirements. Some codes limit, or do not permit, installation of the dryer in garages, closets, mobile homes, or sleeping quarters. Contact your local building inspector.

NOTE: No other fuel-burning appliance can be installed in the same closet as a dryer.

Installation spacing for recessed area or closet installation

All dimensions show recommended and minimum spacing allowed.

- Additional spacing should be considered for ease of installation and servicing.
- Additional clearances might be required for wall, door, floor moldings, dryer venting, and gas line.
- Additional spacing should be considered on all sides of the dryer to reduce noise transfer.
- For closet installation with a door, minimum ventilation openings in the top and bottom of the door are required. Louvered doors with equivalent ventilation openings are acceptable.
- Companion appliance spacing should also be considered.

Recommended installation clearances (dryer only):

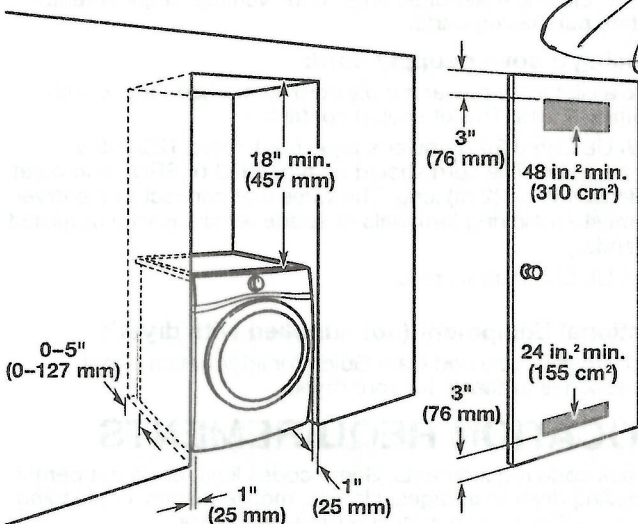

0" (0 mm) rear spacing is allowed for straight back venting only. For steam models only, inlet hose must not be kinked.

Custom under-counter installation:

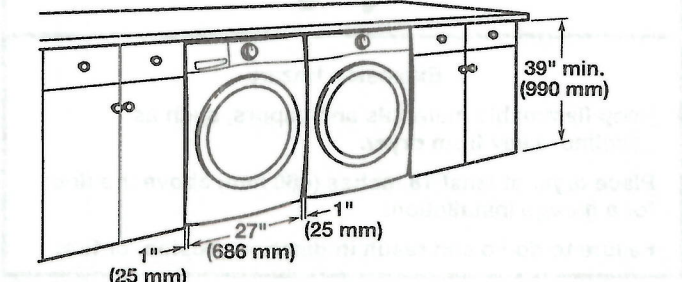

Mobile home – Additional installation requirements:

This dryer is suitable for mobile home installations. The installation must conform to the Manufactured Home Construction and Safety Standard, Title 24 CFR, Part 3280 (formerly the Federal Standard for Mobile home construction and Safety, Title 24, HUD Part 280) or Standard CAN/CSA-Z240 MH.

Mobile home installations require:

- Metal exhaust system hardware, available for purchase from your dealer. For further information, see "Assistance or Service" in your Use and Care Guide.
- Special provisions must be made in mobile homes to introduce outside air into dryer. Openings (such as a nearby window) should be at least twice as large as dryer exhaust opening.

For mobile home installation of gas dryers:

- Mobile Home Installation Hold-down Kit Part Number 346764 is available to order. For further information, see "Assistance or Service" in your Use and Care Guide.

Lot 2.
archards.

Over the
range
micro

Waste
Center

Pots
& pans.
X2

Deep
fridge
Upper w/
2 gables.

B Bell
C Cable
P potlight
R Receptacle
CAT5

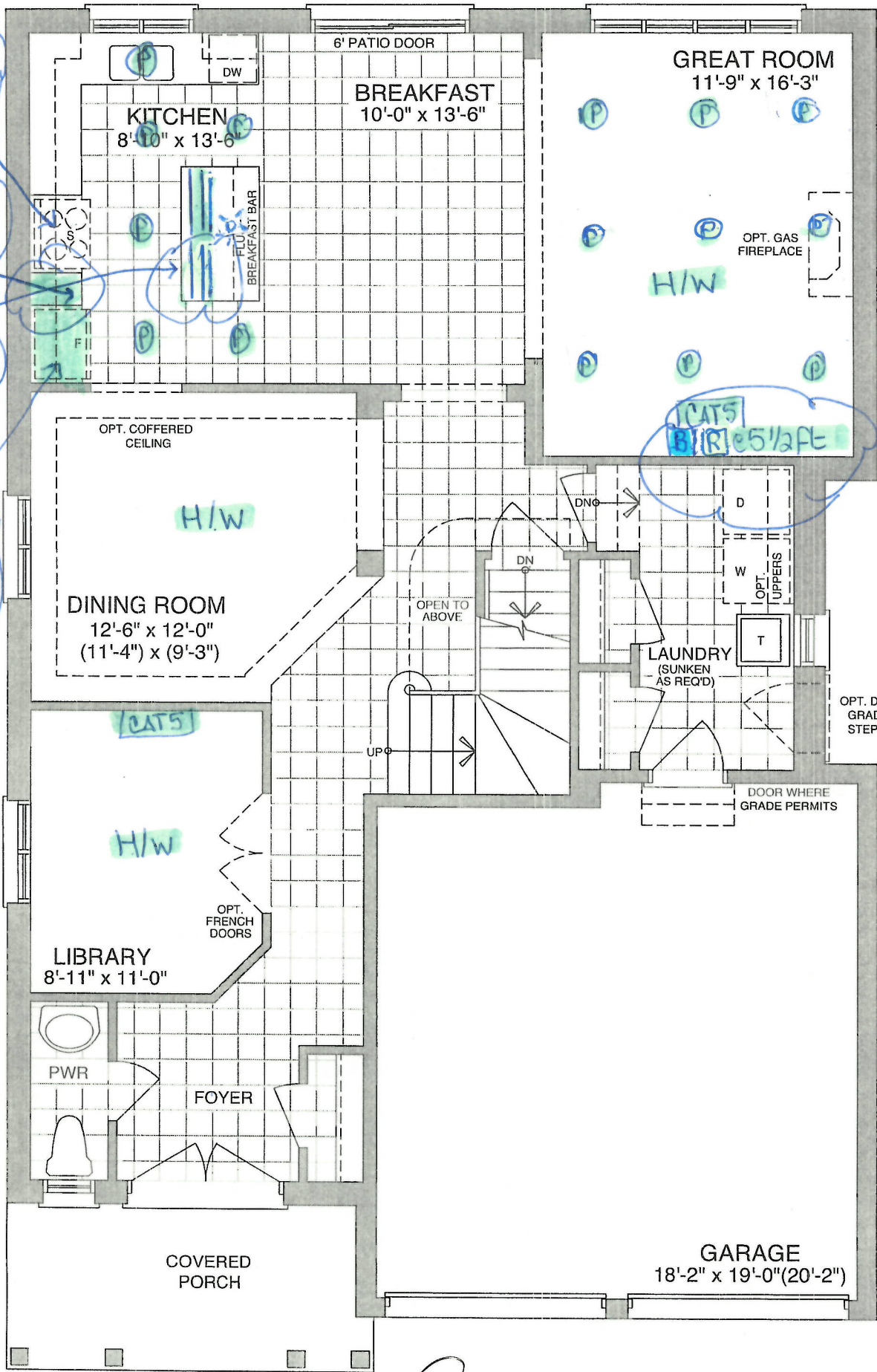

MAIN FLOOR - ELEV A

Sign 
Sign M. P. Grenelli

Date 8/25/2020
Date 8/25/2020

Lot 2
Drchards.

Bell
Cable

CAF 5

Frameless glass shower
w frameless glass door

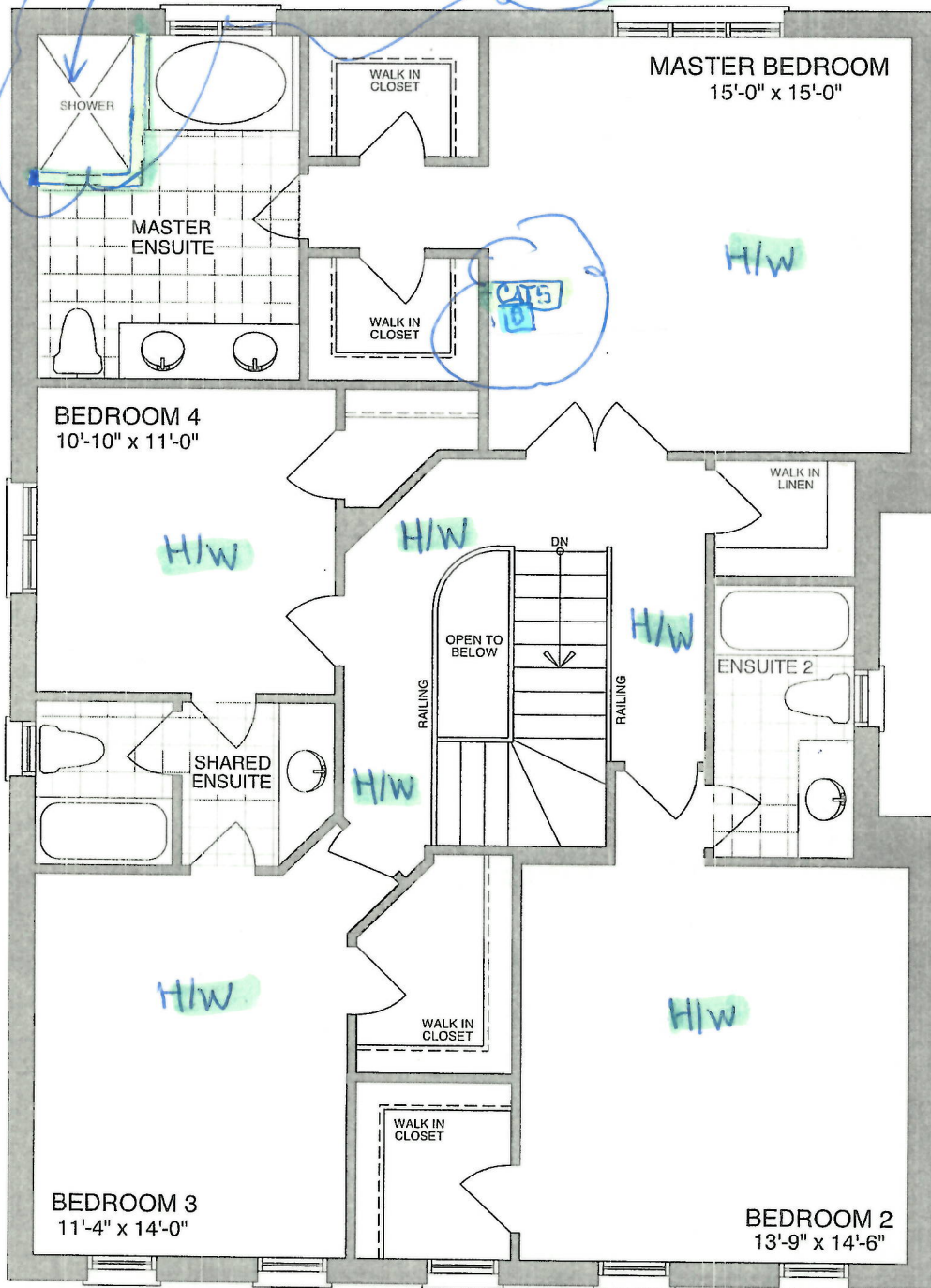

SECOND FLOOR - ELEV A

Sign
Sign

[Signature]

MP Ghendha

Date 8/25/2020
Date 8/25/2020

Lot 2.
Orchards.

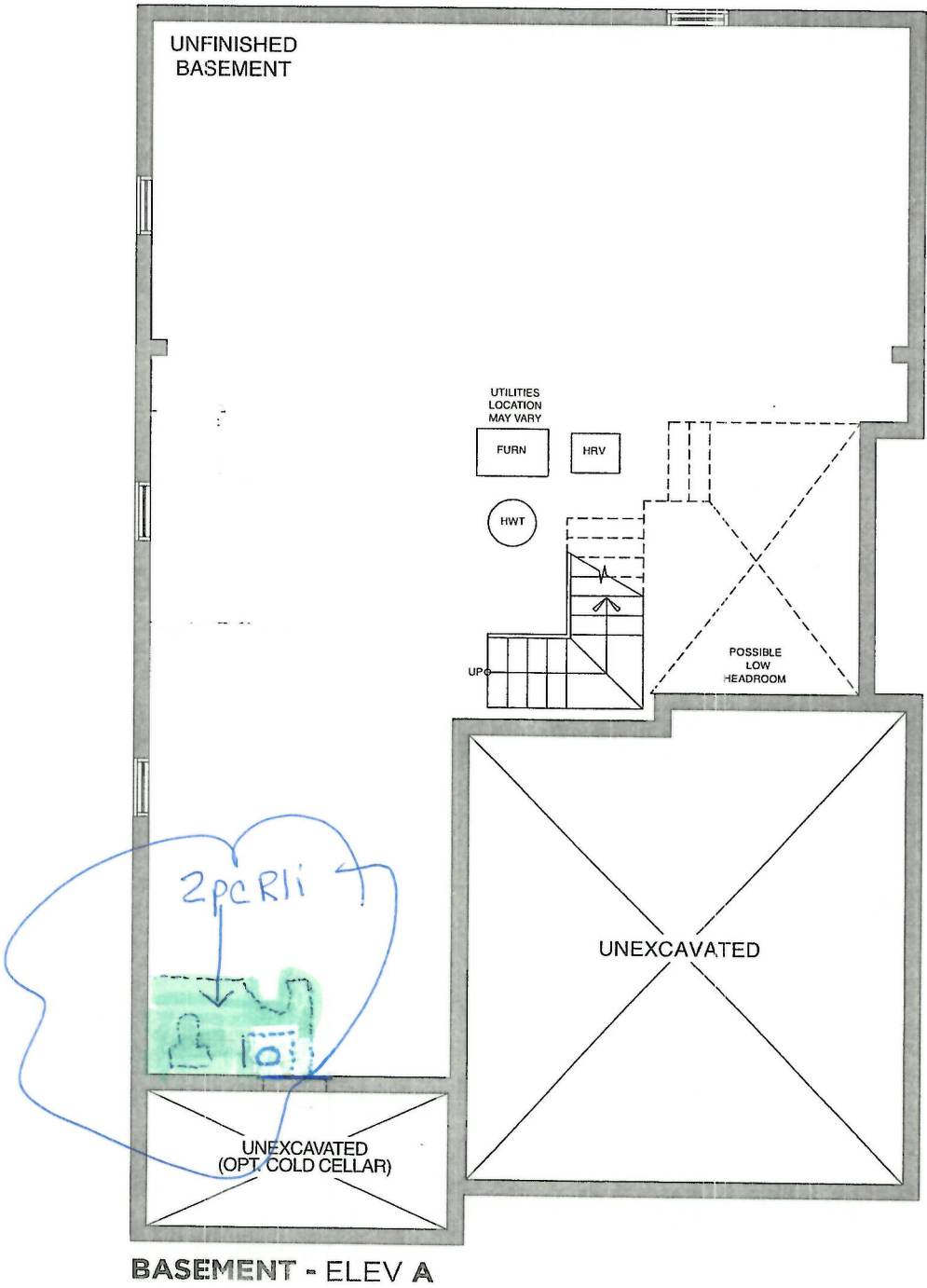

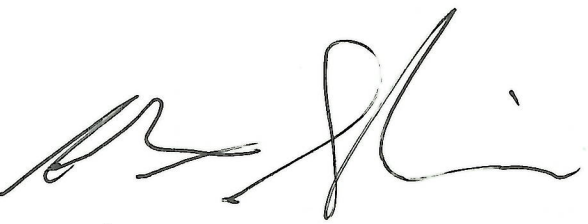
Sign  Date 8/25/2020
Sign MP Chaudhri Date 8/25/2020



CONSTRUCTION SUMMARY				
Orchards - 2174372 Ontario Ltd.				
PURCHASERS: ALEXANDER GHANDHI and MARIE-PASCALE B GHANDHI				TEL:
LOT / PHASE 2 / Orchards	REG. PLAN # 40M-2627	HOUSE TYPE Spencer (40-4) Elev A		CLOSING DATE 01-Apr-21

Agreement of Purchase and Sale

BONUS: CENTRAL AIR CONDITIONER (FROM BUILDERS STANDARD SAMPLES) <i>Worksheet</i> Note:	
BONUS: GRANITE KITCHEN COUNTER TOP - AS PER PLAN (FROM BUILDERS STANDARD SAMPLES) <i>Worksheet</i> Note:	
BONUS: 2 1/4 INCH NATURAL HARDWOOD FLOORING ON MAIN FLOOR (EXCLUDING TILE AREAS) - AS PER PLAN (FROM BUILDERS STANDARD SAMPLES). <i>Worksheet</i> Note:	
BONUS: 1ST UPGRADE COLONIAL TRIM - AS PER PLAN (FROM BUILDERS STANDARD SAMPLES) <i>Worksheet</i> Note:	
BONUS: \$7,500.00 IN UPGRADES - TO BE USED AT BUILDERS DECORE CENTRE AT TIME OF COLOUR SELECTIONS (INCLUSIVE OF HST) <i>Worksheet</i> Note:	
BONUS: EXTENDED UPPER KITCHEN CABINETS - AS PER PLAN (FROM BUILDERS STANDARD SAMPLES) <i>Worksheet</i> Note:	
BONUS: 1ST UPGRADE KITCHEN CABINETS - AS PER PLAN (FROM BUILDERS STANDARD SAMPLES) <i>Worksheet</i> Note:	
BONUS: 1ST UPGRADE OAK PICKETS AND RAILING - AS PER PLAN (FROM BUILDERS STANDARD SAMPLES) <i>Worksheet</i> Note:	



CONSTRUCTION SUMMARY				
Orchards - 2174372 Ontario Ltd.				
PURCHASERS: ALEXANDER GHANDHI and MARIE-PASCALE B GHANDHI				TEL:
LOT / PHASE 2 / Orchards	REG. PLAN # 40M-2627	HOUSE TYPE Spencer (40-4) Elev A		CLOSING DATE 01-Apr-21

1) CONSTRUCTION

1 - DO NOT SUPPLY OR INSTALL CENTRAL VAC OUTLETS 25Aug20 Note: 11,484/36124	
1 - CEILING - SMOOTH FINISH - 1ST AND 2ND FLOOR (40 FOOT MODELS) 25Aug20 Note: 11,484/35933	

10) COUNTERTOPS

1 - UPGRADE STONE COUNTERTOP - UPGRADE 3/4" EDGE TO 1 1/2" STANDARD EDGE - - KITCHEN 25Aug20 Note: 11,484/35946	
--	--

4) PLUMBING

1 - 2 PIECE ROUGH IN BASEMENT - RELOCATION (SEE PLAN FOR LOCATION) 25Aug20 Note: 11,484/36109	
1 - 2 PIECE ROUGH IN BASEMENT 25Aug20 Note: 11,484/36108	
1 - SINK - KITCHEN - UNDERMOUNTED (RECTANGULAR SQUARE - DOUBLE EQUAL BOWL) 25Aug20 Note: 11,484/35950	

5) ELECTRICAL

1 - NETWORK JACK - ADDITIONAL - CAT5E ROUGH-IN IN LIBRARY (SEE PLAN) 25Aug20 Note: 11,484/36120	
1 - NETWORK JACK - ADDITIONAL - CAT5E ROUGH-IN - GREAT ROOM - BESIDE BELL AND RECEPTACLE AT 5 1/2 FT FOR FUTURE WALL MOUNT TV 25Aug20 Note: 11,484/36119	
1 - PLUG - INTERIOR RECEPTICAL (NOT DEDICATED) IN GREAT ROOM BESIDE BELL ON WALL AT 5 1/2 FT FOR FUTURE WALL MOUNT TV 25Aug20 Note: 11,484/36118	
1 - PURCHASER HAS REQUESTED NO CABLE TO BE SUPPLIED OR INSTALLED 25Aug20 Note: 11,484/36115	
1 - NETWORK JACK - ADDITIONAL - CAT5E ROUGH-IN BESIDE BELL AT BASE IN MASTER BEDROOM 25Aug20 Note: 11,484/36114	
15 - POT LIGHT - 4 INCH POTLIGHT WITH LED ENERGY STAR BULB (10 MINIMUM - PRICE IS EACH) 6 X KITCHEN (5 IN KITCHEN AREA AND 1 OVER SINK) ****RELOCATE STANDARD KITCHEN LIGHT TO OVER ISLAND**** (SEE PLAN), 9 X GREAT ROOM (DELETE STANDARD CEILING LIGHT) 25Aug20 Note: 11,484/36111	
1 - ELECTRICAL SERVICE - UPGRADE 100 AMP TO 200 AMP (UP TO 8 FEET) 25Aug20 Note: 11,484/35936	

6) FLOORING & WALL TILE

1 - TOWEL BAR/TOILET PAPER HOLDERS/SOAP DISHES - DO NOT SUPPLY AND INSTALL ALL TOILET PAPER HOLDERS AND TOWEL BARS AND SOAP DISHES THROUGHOUT 25Aug20 Note: 11,484/36117	
1 - OAK - 3/4" X 2 1/4" - NATURAL - UPGRADE FROM CARPET - - BEDROOM 4 (UPGRADE FROM CARPET) 25Aug20 Note: 11,484/35923	



CONSTRUCTION SUMMARY				
Orchards - 2174372 Ontario Ltd.				
PURCHASERS: ALEXANDER GHANDHI and MARIE-PASCALE B GHANDHI				TEL:
LOT / PHASE 2 / Orchards	REG. PLAN # 40M-2627	HOUSE TYPE Spencer (40-4) Elev A		CLOSING DATE 01-Apr-21

6) FLOORING & WALL TILE

1 - OAK - 3/4" X 2 1/4" - NATURAL - UPGRADE FROM CARPET - - BEDROOM 3 (UPGRADE FROM CARPET) 25Aug20 Note: 11,484/35922	
1 - OAK - 3/4" X 2 1/4" - NATURAL - UPGRADE FROM CARPET - - BEDROOM 2 (UPGRADE FROM CARPET) 25Aug20 Note: 11,484/35921	
1 - OAK - 3/4" X 2 1/4" - NATURAL - UPGRADE FROM CARPET - - MASTER BEDROOM (UPGRADE FROM CARPET) 25Aug20 Note: 11,484/35920	
1 - OAK - 3/4" X 2 1/4" - NATURAL - UPGRADE FROM CARPET - - UPPER HALL (UPGRADE FROM CARPET) 25Aug20 Note: 11,484/35919	

9) CABINETRY

2 - BASE CABINETS - DRAWERS - POTS AND PANS DRAWERS (WIDTH MIN. 60CM/MAX. 90 CM) (SIZE SUBJECT TO FLOOR PLAN) - GROUP 1 - 4 (IN ISLAND (2 SETS OF POTS AND PANS) SEE PLAN 25Aug20 Note: 11,484/36121	
1 - BASE CABINETS - DRAWERS - 45CM WIDE PULL-OUT DOOR BASE CABINET WASTE/RECYCLE CENTRE WITH SOFT-CLOSE ([2] 35L BINS) (AVAILABLE ONLY WITH 45CM WIDE CABINET) **IN BETWEEN FRIDGE AND STOVE (SEE PLAN) 25Aug20 Note: 11,484/36112	
1 - ACCESSORIES - UPPER - LIGHT VALANCE WITHOUT ELECTRICAL/LIGHTING 25Aug20 Note: 11,484/36110	
1 - APPLIANCE CABINETS - HOOD FAN - ACCOMMODATE FOR MICROWAVE/HOOD FAN COMBO (SUPPLY SPECS) INCLUDES ELECTRICAL DEDICATED LINE 25Aug20 Note: 11,484/35942	
1 - APPLIANCE CABINETS - FRIDGE - 66CM DEEP FRIDGE ENCLOSURE (COUNTER DEPTH) WITH NO WALLS ([2] 66CM DEEP GABLES AND [1] 66CM DEEP CABINET) (THIS IS NOT A ZERO CLEARANCE ENCLOSURE. STANDARD HEIGHTS AND WIDTHS WILL BE USED.) 25Aug20 Note: 11,484/35941	
1 - CABINETS - SHARED ENSUITE - LEVEL 2 25Aug20 Note: 11,484/35939	
1 - CABINETS - MASTER ENSUITE - LEVEL 2 25Aug20 Note: 11,484/35938	
1 - CABINETS - ENSUITE 2 - LEVEL 2 25Aug20 Note: 11,484/35937	

CABINETRY - HARDWARE

10 - CABINET HARDWARE - INTEGRATED BLUMOTION (SOFT-CLOSE) TRACKS FOR DRAWERS EACH (6 X POTS AND PANS) AND (4 X BANK OF DRAWERS) 25Aug20 Note: 11,484/36123	
1 - CABINET HARDWARE - CABINET HARDWARE UPGRADE 2 DISPLAY BOARD - KITCHEN 25Aug20 Note: 11,484/36122	

SHOWERS

1 - SHOWER - CHANGE FRAMED SHOWER TO FRAMELESS GLASS ENCLOSURE (INCLUDES GLASS DOOR) - MASTER ENSUITE 25Aug20 Note: 11,484/35951	
---	--

TRIM DOORS AND HARDWARE - INTERIOR



CONSTRUCTION SUMMARY				
Orchards - 2174372 Ontario Ltd.				
PURCHASERS: ALEXANDER GHANDHI and MARIE-PASCALE B GHANDHI				TEL:
LOT / PHASE	REG. PLAN #	HOUSE TYPE		CLOSING DATE
2 / Orchards	40M-2627	Spencer (40-4) Elev A		01-Apr-21

TRIM DOORS AND HARDWARE - INTERIOR

1 - TRIM - UPGRADE 1 - 3 INCH CASING WITH BACKBAND & 5 1/4 INCH BASEBOARD - COLONIAL (40 FOOT MODELS)	
25Aug20 Note:	
11,484/36113	

This Document is Extremely Time Sensitive - Printed 25 Aug 20 at 12:21