

HIGHCASTLE HOMES - COLOUR SCHEDULE

Purchasers:

Telephone Res. / Bus:

Decor Advisor:

MARTIN, WILLIAM DONATO & SAMANTHA MEAGHAN L  
/  
Caroline Rajcsanyi

Property: 37Phase: 4 of Plan - 40M-2633  
Project: 2174372 Ontario Ltd.  
Model and Elevation: Aurora (33-2) Elev A Opt Master Ens and Laundry

KITCHEN AND VANITIES

	Cabinet	Counter	Hardware
Kitchen	Lv1 - Camden Oak - Poppyseed	Lv3 - Caesarstone-Misty Carrera	12881 Handle
Main Bathroom	Lv1 - Manchester Oak - Shale Grey CL	Calcutta Marble 4925K-07	12881 Handle
Ensuite Bathroom	Lv1 - Manchester Oak - Shale Grey CL	Calcutta Marble 4925K-07	12881 Handle
Opt. Breakfast Bar	Counter Height/Flush	Kitchen Hood Fan	Accommodate for over-range microwave
		Kitchen Upper Height	100 cm

Stove opening – if not specified will be set to builders standard opening of approximately 30 in width  
Fridge Opening – if not specified will be set to builders minimum opening of approximately 33 x71 height (townhouses)  
- if not specified will be set to builders minimum opening of approximately 36 x 71 height (singles)

Counter top Edge

Kitchen	Double Edge (1 1/2") Top Bevelled	

Opt. Kitchen Extras	**2 FT PANTRY ADDED TO END OF CABINETS (STOVE SIDE)**

PARQUET / HARDWOOD OR BROADLOOM

Kitchen / Breakfast	N/A	Master Bedroom	Lv1 -TXP135 Lv1 - T15
Great Room	*Oak Strip Lauzon Essential Expert 3 1/8" x 3/4"-Graphite	Bedroom 2	Lv1 -TXP135 Lv1 - T15
Living / Formal Room	N/A	Bedroom 3	Lv1 -TXP135 Lv1 - T15
Dining Room	N/A	Bedroom 4	N/A
Family Room	N/A		
Main Hall	N/A		
Main Stairs	Oak		
Upper Hall	*Oak Strip Lauzon Essential Expert 3 1/8" x 3/4"-Graphite		
Com. Centre/Home Office	N/A	Basement	N/A
Main Stair Landing	N/A	Basement Landing	N/A
Library/Den/Study	N/A	Basement Stairs	Paint Grade (Grey)
In Law Suite	N/A		

Carpet Runner ☐ Yes ☒ No

Underpad Main Floor	Underpad 2nd Floor	Underpad Main Stairs
NA	Lv1 Underpad-standard	NA

Opt. Flooring Extras

FLOOR AND WALL TILES

	Floor Tile	Decor	Listello	Wall Tile	Decor	Listello
Front Foyer	3-12 X 24, Biel Series, Bianco White					
Main Hall	3-12 X 24, Biel Series, Bianco White					
Kitchen/Breakfast	3-12 X 24, Biel Series, Bianco White			Kitchen Backsplash	N/A	<input type="checkbox"/>
Powder Room	3-12 X 24, Biel Series, Bianco White			Pwdr Wall if Applicable	N/A	<input type="checkbox"/>
Laundry	1-13x13, Serpentine White					

	Floor	Tub Wall	Shower Wall	Deck Skirt	Deck Splash	Decor	Listello
Main Bathroom	1-13x13, Serpentine White	1-8x10, Serpentine White	N/A	N/A	NA	<input type="checkbox"/>	<input type="checkbox"/>
Master Ens	1-13x13, Serpentine White	N/A	1-8x10, Serpentine White	1-13x13, Serpentine White	1-8x10, Serpentine White	<input type="checkbox"/>	<input type="checkbox"/>
						<input type="checkbox"/>	<input type="checkbox"/>
						<input type="checkbox"/>	<input type="checkbox"/>
						<input type="checkbox"/>	<input type="checkbox"/>
						<input type="checkbox"/>	<input type="checkbox"/>

Shower - Upgrade Floor

Opt. Tile Extras

\*\*12 X 24 TILES LAID HORIZONTAL WHEN ENTERING FROM THE FRONT DOOR\*\*\*\*

# HIGHCASTLE HOMES - COLOUR SCHEDULE

Purchasers: MARTIN, WILLIAM DONATO & SAMANTHA MEAGHAN L Property: 37Phase: 4 of Plan - 40M-2633  
Telephone Res. / Bus: / Project: 2174372 Ontario Ltd.  
Decor Advisor: Caroline Rajcsanyi Model and Elevation: Aurora (33-2) Elev A Opt Master Ens and Laundry

## PLUMBING / FAUCETS

Powder Room  Standard  Laundry  Standard   
Main Bath  Standard   
Master Ensuite  Standard   
Bed Ensuite  N/A   
B.L. Bath  \*2 Piece

Kitchen Sink  \*Undermount   
Kitchen Faucet  Standard

Drain for 2nd floor Laundry ☐ Yes ☒ No

Waterline for fridge ☐ Yes ☒ No

Supply and install all toilet paper holders, towel bars and soap dishes ☒ Yes ☐ No

Whirlpool

Opt. Plumbing Extras

## PAINTING

Wall Colour  22 Warm Grey  Trim Colour  Standard  Railing Colour  \*Stained as Floor  Pickets Colour  \*Stained as Floor  Stair Colour  \*Stained as Floor

Opt. Paint Extras

## MISCELLANEOUS

Railing Style  RAILING - STANDARD - 1 5/16in oak picket, 2 1/2in oak handrail and 2 3/4in oak post.  
Opt. Garage Door  \*Yes-Grade Permilting  Opt. Side Door  No  Stair Type  \*Oak   
Interior Doors  \*1 - Carrara 2 panel  Int. Door Hardware  \*Straight Pewter Lever  Ext. Door Hardware  \*Pewter Exterior package   
Trim Style  \*1 - 2 3/4in Case & 4in Baseboard  Cold Cellar ☐  
Smooth Ceiling 1st Floor ☒ Yes ☐ No  Basement Windows Upgrade ☐ Yes ☒ No   
Smooth Ceiling 2nd Floor ☒ Yes ☐ No   
Supply and install Standard Mirrors ☒ Yes ☐ No   
Misc.

## HEATING

Fireplace  Type  Mantle  Surround  Hearth   
Air Conditioning ☒ Yes ☐ No   
Hood Fan Duct ☒ 6 inch ☐ 8 inch ☐ 10 inch   
Gas Provisions for Dryer ☐ Yes ☒ No   
Gas Provisions for Stove ☐ Yes ☒ No   
Gas Provisions for BBQ ☐ Yes ☒ No   
Humidifier ☐ Yes ☒ No

Exterior Colour Scheme:

Pre-selected By Vendor

NOTE: The Purchaser(s) agree(s) that:

- Colours of materials are as close as possible to Vendor's selections, but not necessarily identical due to variances in manufacturing or manufacturers.
- Purchaser(s) has checked and acknowledges accuracy of the above selections. Where omissions occur on the original colour selection sheet Purchaser(s) acknowledge that the Builder's selection will be final.
- Upgrades or extras listed on this schedule will not be deemed part of the Agreement of Purchase and Sale. Any such upgrades or extras shall be null and void unless accompanied by a separate invoice and amendment. Said invoice must be paid in full.
- The Purchaser(s) further agrees that in the event that the Vendor has preselected colours prior to the purchase of the house, the prescribed colours are final notwithstanding that the Purchaser may have completed a colour selection schedule.
- The Purchaser(s) acknowledges that once this colour schedule is signed and dated, no changes, additions or deletions will be permitted other than re-selection due to unavailability.

A \$350.00 (Per Occurrence) change/administration fee will apply to above exceptions.

This Interior Colour Selection is final and approved by:

Signature: M. Donato Date: 06/08/20

Printed 6/8/2020 14:16:46

Signature: S. Donato Date: 06/08/20

Builder's Agent: C. Rajcsanyi Date: June 8, 2020



## Highcastle Homes Décor Centre Disclaimers

Lot#: 37 Model:Aurora (33-2) Elev A Opt Master Ens and Laundry in Northglen (H) - 2174372 Ontario Ltd.

PURCHASERS: MARTIN, WILLIAM DONATO and SAMANTHA MEAGHAN LEE DONATO

TEL:

*Through years of doing business, we at Highcastle Homes have encountered issues beyond our control. The following disclaimers apply to all instances of Purchaser's Extras forms and all Interior Colour Scheme forms.*

### Fireplaces

Fireplace Marble: Due to the many variables that can affect the pattern and/or design, frequently the marble installed on the fireplace will not be identical to the samples. We will make every attempt to come as close to the samples as possible, but cannot be responsible for results which differ from the samples.

### Ceramic Floor Tile

Many variables including variegation can affect tile colour, pattern and/or design which mean installed tiles may not be identical to the samples. We will make every attempt to come as close as possible, but cannot be responsible for results which differ from the samples.

### Hardwood Flooring

The purchaser is advised that cupping and shrinkage are characteristics of hardwood flooring normal appearing some time after installation, and no warranty is provided by the flooring supplier with respect to such cupping and shrinkage. The vendor agrees to install any hardwood flooring ordered by the purchaser in good and workmanlike manner, but shall not be responsible for, and is hereby released by the purchaser from responsibility and liability for cupping and shrinkage of hardwood flooring.

Shrinking and expanding/cupping of the hardwood floors may occur if the humidity levels in the home are not kept at industry recommendations. If the hardwood floors shrink or expand due to the homeowner not complying with these levels, the hardwood floor will no longer be under warranty and it will be the homeowner's responsibility to repair the flooring.

### Stain Colours

Due to many variables that can affect the outcome of a stain colour on wood, staircases, railings, and fireplaces, will not be identical to samples. Factors such as density, age humidity, air temperature, and the uniqueness of each piece of wood can result in wide variations in darkness or lightness. We will make every attempt to come as close to the sample as possible, but cannot be responsible for results which differ from the samples.

Stain on pre-finished hardwood floors will not be an exact match to the stain colours available on stairs, pickets and rails. The purchaser is responsible for choosing the stain on these areas to their satisfaction.

### Appliances

All fridge openings are set to builder's standard width. Please advise Décor Centre at time of colour appointment if custom sizing of cabinets is required for any built - in appliances. The purchaser is responsible for costs and fees associated with changes to pre-manufactured kitchens made subsequent to colour appointments.

### Kitchen Cabinets

The kitchen you order/purchase will undoubtedly contain slight colour variations. The degree of these variations is virtually impossible to determine before the kitchen is installed in its intended location. The amount of and type of lighting will also affect various highlights in the finish. Note: No two pieces of wood are identical. Variations in colour tone and grain patterns make a perfect colour match virtually impossible. It is generally agreed that these variations add to the natural beauty of a wood kitchen.

Shrinking and expanding of the kitchen cabinets may occur if the humidity levels in the home are not kept at industry recommendations. If the cabinets shrink or expand due to the homeowner not complying with these levels, the cabinets will no longer be under warranty and it will be the homeowner's responsibility to repair the cabinets.

### Plaster Mouldings and Medallions

Plaster mouldings will not be installed in open to above areas or areas with 2 storey elements.

### Metal Spindles

Due to the characteristics of wrought iron railing production, it is possible for the wrought iron to develop a scale effect. This scale may or may not be totally covered during the painting process. In effect, once the wrought iron picket is painted, the paint may in effect amplify the iron scale depending on the colour chosen. This is a natural effect of wrought iron and should not be construed as a defect or damage.

I hereby acknowledge reading and understanding the above copy and will not hold Highcastle Homes responsible for any issues in relation to above.

Purchasers Signature(s): Martin A S. Donato Date: 06/08/20



# COAST APPLIANCES

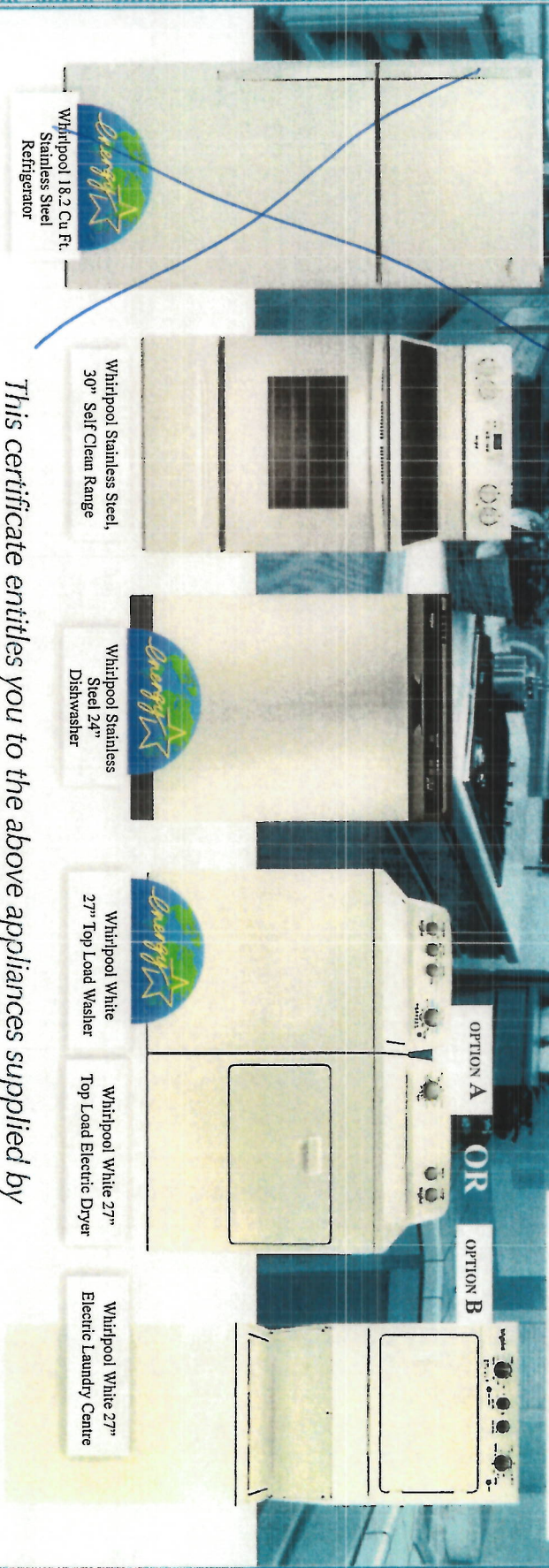

*This certificate entitles you to the above appliances supplied by Coast Appliances courtesy of Highcastle Homes.*

*Martin Donato Samantha Donato June 8, 2000*

ISSUED TO

DATE OF ISSUE



THIS OFFER BY APPOINTMENT ONLY, PLEASE CONTACT



**FRANK DEROSE**

[fderoose@coastappliances.com](mailto:fderoose@coastappliances.com)

**Tel: (905) 303-6909 Fax: (905) 856-9908 1-888-745-0622**

*Voucher expires 60 days after closing. This offer applies to all Highcastle Homes purchasers that receive an Appliance Package in their offer to purchase. Appliance pictures are for representation only. Models may change without notice. See reverse for terms and conditions*

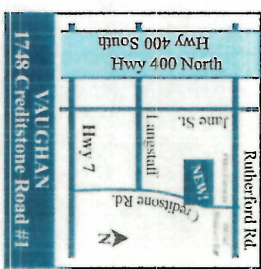





COAST  
APPLIANCES

1748 Creditstone Road, Unit 1, Vaughan, ON L4K 5V8



APPLIANCE  
VOUCHER

1. Book an appointment with Frank DeRose at 905-303-6909
2. This certificate is voided if homeowner agreement is voided or if the agreement is amended or revised to delete any or all of the appliances.
3. It is the customer's responsibility to arrange appliance installation. All appliance packages include free delivery of products and removal of packaging materials. In the event that the customer wishes to upgrade appliances, a credit based on the wholesale value will be applied to the price of the upgraded product.
4. Appliance models are subject to change without notice. Door swings must be stated at time of purchase.
5. Once the standard package is delivered, exchanges or returns will not be permitted.
6. Purchasers may upgrade appliances directly with Coast Appliances. Any upgrades are to be paid directly to Coast Appliances and purchasers are to inform Highcastle Homes of any changes to the dimensions of the appliances. Highcastle Homes will not be responsible for not fitting appliances due to late upgrades. Cabinetry, gas lines and rough-ins are not included and must be arranged through Highcastle Homes. Highcastle Homes is not responsible for any upgrades purchased through Coast Appliances.
7. Certificate has no cash value, and is non-transferable.
8. Standard appliances are to be arranged for delivery 30 days before closing.
9. Premium packages are to be arranged 2 months before closing.
10. Purchaser(s) are to order appliances and arrange for delivery after closing.
11. Installation is not included.

FRANK DEROSE Tel: (905) 303-6909

fderose@coastappliances.com



HOMEOWNER ACKNOWLEDGES THAT THEY HAVE READ AND ACCEPT THE ABOVE TERMS AND CONDITIONS.

APPLIANCE PACKAGE INCLUDES REFRIGERATOR, RANGE,  
DISHWASHER, WASHER AND DRYER OR LAUNDRY CENTRE

SITE: Northglen 4

HOMEOWNERS: Martin Bonetto  
Samantha Bonetto

BLOCK # 37

LOT # 37

CLOSING DATE: Nov 3, 2020

HOME #

CELL # 905-467-1991

EMAIL: mdonato0819@gmail.com  
mecaplan.kc222@gmail.com

BUS #

AUTHORIZATION:

DATE

PER

EXTENDED WARRANTIES AVAILABLE - \*ASK FOR COMPLETE DETAILS



Lot 37  
PH4.

# STONE EDGE PROFILES

Approx 2CM or 3/4" Standard Edge

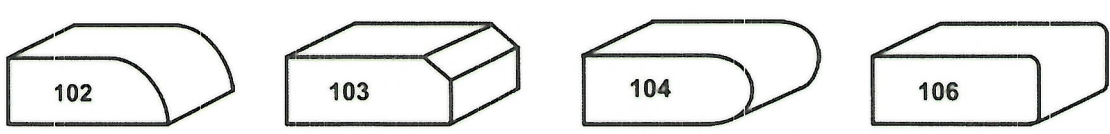

## 1<sup>st</sup> UPGRADE

Approx 4CM or 1.5" - SEAMS WILL BE VISIBLE

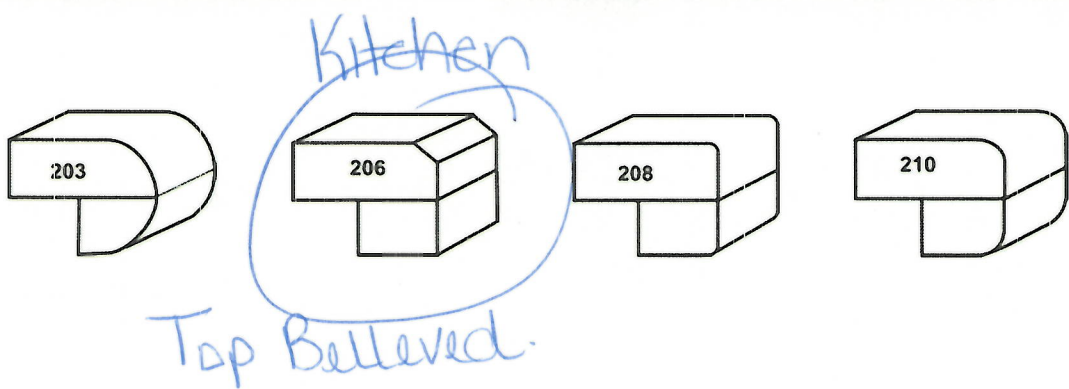

## 2<sup>nd</sup> UPGRADE

Approx 4CM or 1.5" - SEAMS WILL BE VISIBLE

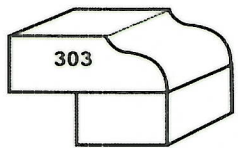

Sign M. Durr  
Sign S. Durr

Date 06/08/20  
Date 06/08/20

Lot 37  
PH4

Prepared by  
FRANK DE ROSE  
fderose@coastappliances.com

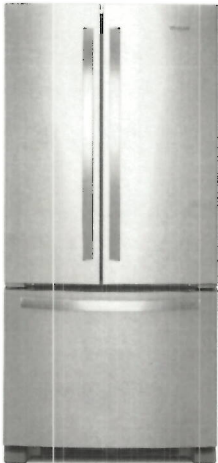

33-inch Wide French Door Refrigerator - 22 cu. ft.

WRF532SNHZ

Available Finishes/Colours

- ☒ WRF532SNHV  
Black Stainless
- ☐ WRF532SNHW  
White
- ☒ WRF532SNHZ  
FingerPrint Resistant Stainless Steel

Dimensions	
Depth	34 1/2
Height	70 1/8
Width	32 5/8

Configuration and Overview	
Advance Foam Insulation	99.9% lower Global Warming Potential and Better Energy Performance
Counter Depth	No
Number of Doors	3

Details	
Advance Foam Insulation	99.9% lower Global Warming Potential and Better Energy Performance
Cooling Type	Single Evaporator
Counter Depth	No

Controls	
Control Type	Electronic

Controls	
Air Filter Indicator/Reset	No
Automatic Defrost	Yes
Verrouillage des commandes	No
Door Ajar/Open Alarm	No
LCD Touch Screen	No
Control Location	Interior Up Front
Water Filter Indicator/Reset	No
Max Cool/Fast Cool	No

Misc.	
Accessory Relationships	Yes
Home Delivery	Yes
Will Call	Yes

Exterior	
Base Grille Color	Grey

This ENERGY STAR® certified refrigerator with glass shelves lets you store more items on each shelf. It also has a crisper drawer to store fruits and veggies at the ideal temperature while LED lighting keeps food looking as great as it tastes.

- Top Features
- Humidity-Controlled Crispers
- Adaptive Defrost adjusts to your usage to save more energy
- Frameless Glass Shelves

- Manuals & Literature:
- [Dimension Guide](#)
- [Energy Guide](#)
- [Use and Care Guide](#)
- [Warranty Information](#)



Because Whirlpool Corporation policy includes a continuous commitment to improve our products, we reserve the right to change materials and specifications without notice. Dimensions are for planning purposes only. For complete details, see Installation Instructions packed with product. Specifications subject to change without notice.

Whirlpool®

## PRODUCT MODEL NUMBERS

WRF532SNH

[illegible]

## PRODUCT DIMENSIONS

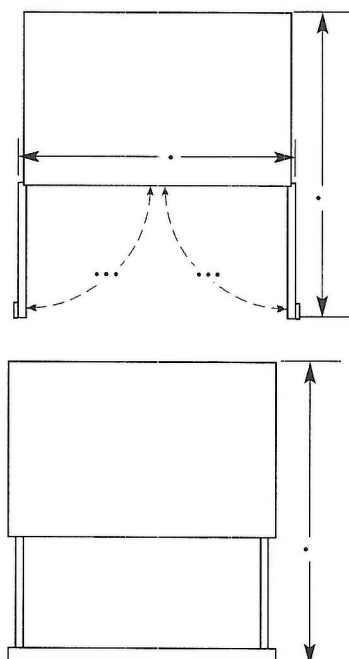
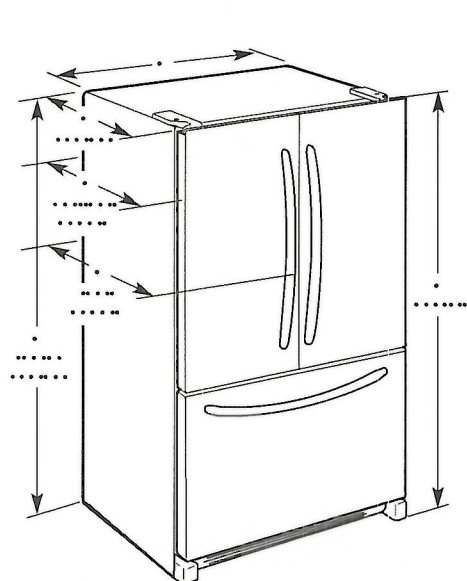
[illegible]

## LOCATION REQUIREMENTS

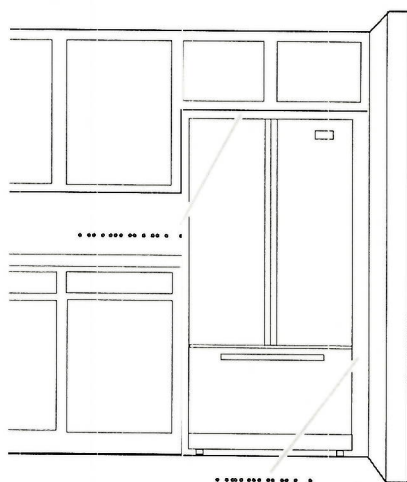
[illegible][illegible]



Lot 37 PH 4.

B Bell  
Coble  
Pendant R/I

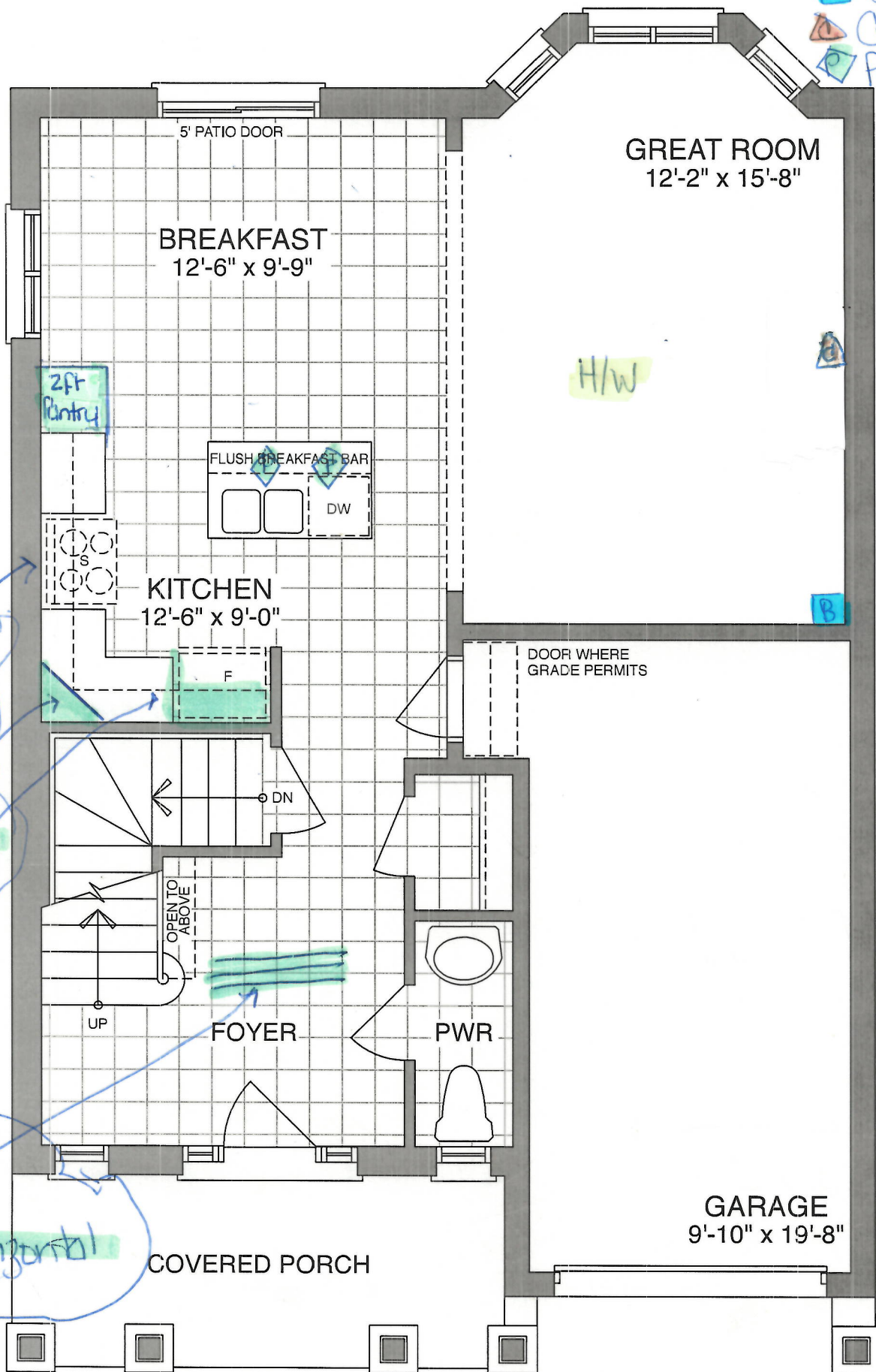

MAIN FLOOR - ELEV A

Sign M. P. P. P.  
Sign S. Donato

Date 06/08/20  
Date 06/08/20

Lot 37  
- PH4

Bell  
Cable

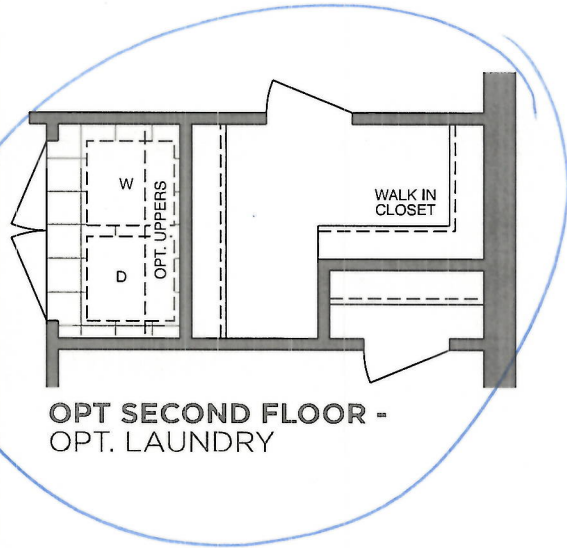
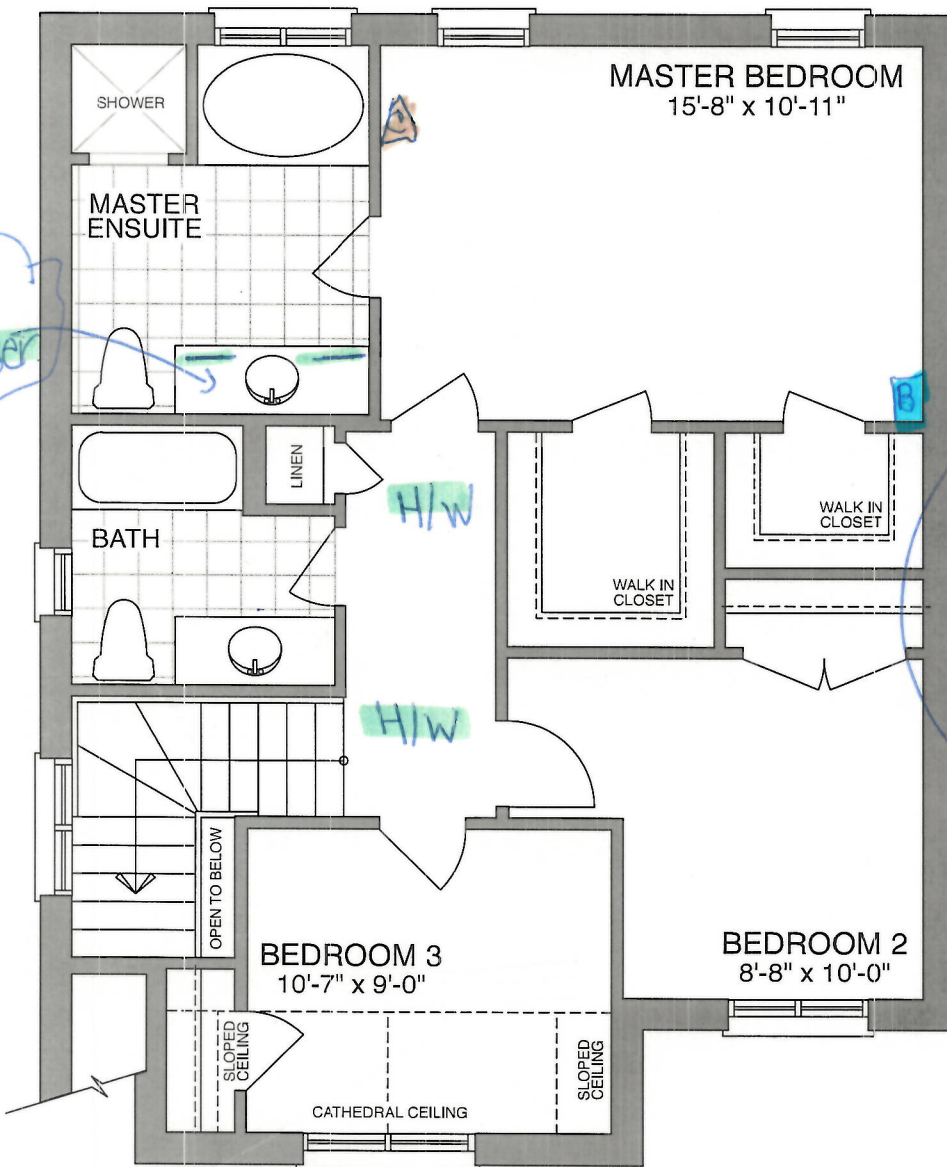

OPT SECOND FLOOR - ELEV A

Sign M. D. D.   
Sign S. D. D.

Date 06/08/20  
Date 06/08/20



Lot 37.  
Northglenn PH 4

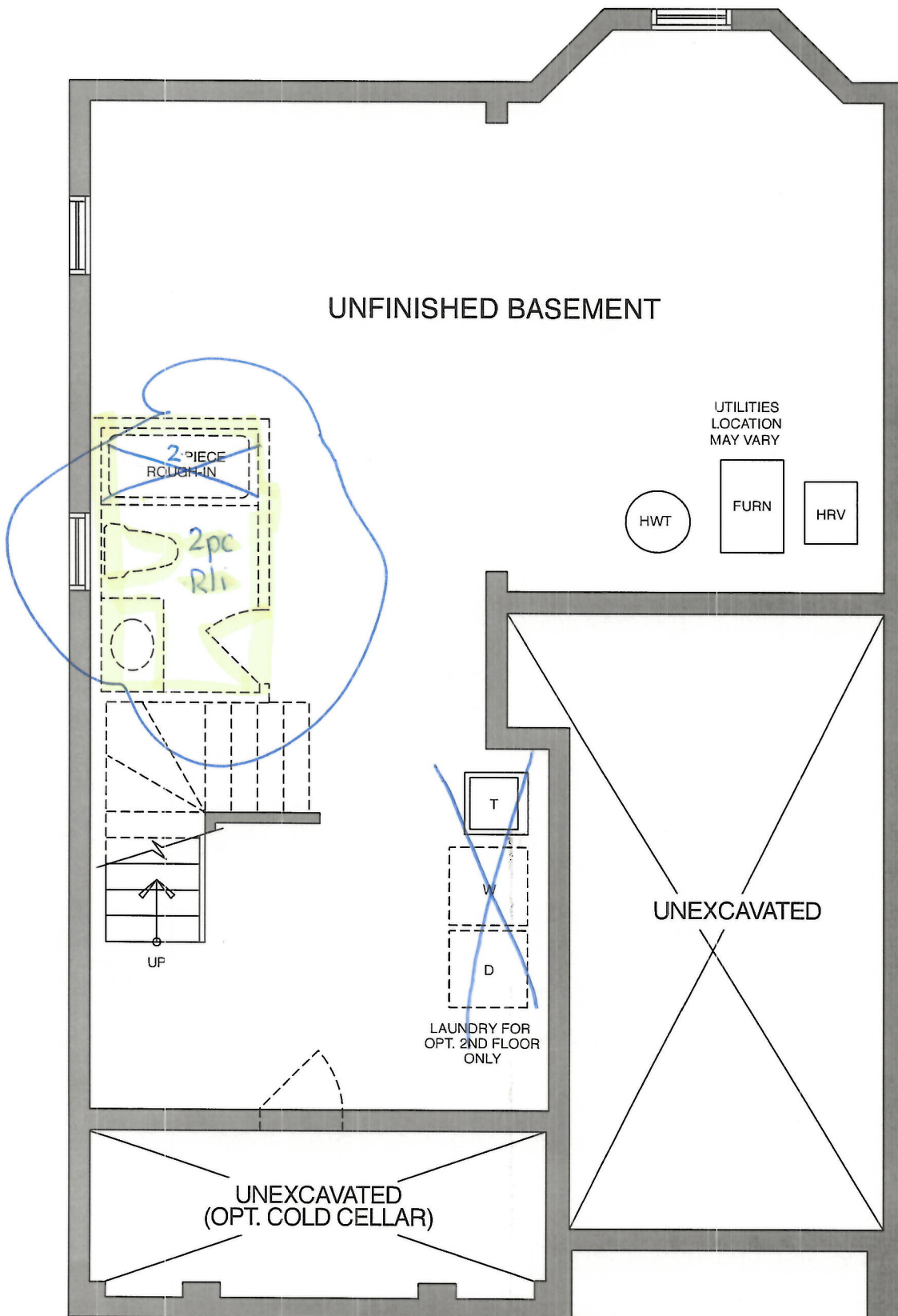

BASEMENT - ELEV A

Sign M. D. Hunt  
Sign S. Donato

Date 06/08/20  
Date 06/08/20



<div>CONSTRUCTION SUMMARY</div> <div>Northglen (H) - 2174372 Ontario Ltd.</div>				
PURCHASERS: MARTIN, WILLIAM DONATO and SAMANTHA MEAGHAN LEE DONATO				TEL:
LOT / PHASE	REG. PLAN #	HOUSE TYPE		CLOSING DATE
37 / 4	40M-2633	Aurora (33-2) Elev A Opt Master Ens and Laundry		03-Nov-20

Agreement of Purchase and Sale

BONUS: 5 APPLIANCE PACKAGE - INCLUDES STAINLESS STEEL: FRIDGE, STOVE, BUILT-IN DISHWASHER: WHITE: WASHER/DRYER-BUILDERS STANDARD PACKAGE <i>Worksheet</i> Note:	
BONUS: GRANITE KITCHEN COUNTER TOP - AS PER PLAN (FROM BUILDERS STANDARD SAMPLES) <i>Worksheet</i> Note:	
BONUS: 2 1/4 INCH NATURAL HARDWOOD FLOORING ON MAIN FLOOR (EXCLUDING TILE AREAS) - AS PER PLAN (FROM BUILDERS STANDARD SAMPLES). <i>Worksheet</i> Note:	
BONUS: 1ST UPGRADE COLONIAL TRIM - AS PER PLAN (FROM BUILDERS STANDARD SAMPLES) <i>Worksheet</i> Note:	
BONUS: \$5,000.00 IN UPGRADES - TO BE USED AT BUILDERS DECORE CENTRE AT TIME OF COLOUR SELECTIONS (INCLUSIVE OF HST) <i>Worksheet</i> Note:	
INCLUDE OPTIONAL LAUNDRY FOR OPTIONAL SECOND FLOOR <i>Worksheet</i> Note:	





CONSTRUCTION SUMMARY

Northglen (H) - 2174372 Ontario Ltd.

PURCHASERS: MARTIN, WILLIAM DONATO and SAMANTHA MEAGHAN LEE DONATO

TEL:

LOT / PHASE	REG. PLAN #	HOUSE TYPE		CLOSING DATE
37 / 4	40M-2633	Aurora (33-2) Elev A Opt Master Ens and Laundry		03-Nov-20

1) CONSTRUCTION

1 - CEILING - SMOOTH FINISH - 1ST AND 2ND FLOOR (33 FOOT MODELS) 08Jun20    Note: 11,458/35482	
--	--

10) COUNTERTOPS

1 - UPGRADE GRANITE COUNTERTOP - FROM LEVEL 1 TO LEVEL 3 CAESARSTONE- - KITCHEN 08Jun20    Note: 11,458/35494	
1 - UPGRADE STONE COUNTERTOP - UPGRADE 3/4" EDGE TO 1 1/2" STANDARD EDGE - - KITCHEN 08Jun20    Note: 11,458/35486	

4) PLUMBING

1 - SINK - KITCHEN - UNDERMOUNTED (RECTANGULAR SQUARE - DOUBLE EQUAL BOWL) 08Jun20    Note: 11,458/35491	
1 - 2 PIECE ROUGH IN BASEMENT 03Apr20    Note: 11,422/35091	

5) ELECTRICAL

2 - LIGHT - ROUGH-IN ONLY - ON SEPARATE SINGLE SWITCH (PENDANT LIGHT ROUGH IN OVER ISLAND (SEE PLAN) 08Jun20    Note: 11,458/35487	
--	--

6) FLOORING & WALL TILE

1 - OAK - 3/4" X 3 1/8" ENGINEERED - STAINED - UPGRADE FROM CARPET - - UPPER HALL (UPGRADE FROM CARPET) 08Jun20    Note: 11,458/35489	
1 - OAK - 3/4" X 3 1/8" ENGINEERED - STAINED - UPGRADE FROM 3/4X 2 1/4 NATURAL OAK - - GREAT ROOM (UPGRADE FROM HARDWOOD) 08Jun20    Note: 11,458/35488	
1 - UPGRADE FLOOR TILE TO LEVEL 3 - - POWDER ROOM (HORIZONTAL WHEN ENTERING FROM THE FRONT DOOR (SEE PLAN) 08Jun20    Note: 11,458/35485	
1 - UPGRADE FLOOR TILE TO LEVEL 3 - - KITCHEN & BREAKFAST (HORIZONTAL WHEN ENTERING FROM THE FRONT DOOR (SEE PLAN) 08Jun20    Note: 11,458/35484	
1 - UPGRADE FLOOR TILE TO LEVEL 3 - - FOYER AND MAIN HALL (HORIZONTAL WHEN ENTERING FROM THE FRONT DOOR (SEE PLAN) 08Jun20    Note: 11,458/35483	

9) CABINETRY

1 - UPPER CABINETS - EXTENDED UPPER CABINET (90 CM AND 100CM TALL) - GROUP 1 - 4 08Jun20    Note: 11,458/35479	
1 - UPPER CABINETS - CORNER SYSTEMS - UPPER ANGLE CORNER PER UNIT - GROUP 1 - 4 08Jun20    Note: 11,458/35478	
2 - PANTRY CABINETS - PANTRY 66CM DEEP PER FOOT (COUNTER DEPTH) - GROUP 1 - 4 (IN KITCHEN, ON STOVE WALL AT THE END (SEE PLAN) 08Jun20    Note: 11,458/35477	



CONSTRUCTION SUMMARY				
Northglen (H) - 2174372 Ontario Ltd.				
PURCHASERS: MARTIN, WILLIAM DONATO and SAMANTHA MEAGHAN LEE DONATO				TEL:
LOT / PHASE	REG. PLAN #	HOUSE TYPE		CLOSING DATE
37 / 4	40M-2633	Aurora (33-2) Elev A Opt Master Ens and Laundry		03-Nov-20

9) CABINETRY

1 - APPLIANCE CABINETS - FRIDGE - 66CM DEEP FRIDGE ENCLOSURE (COUNTER DEPTH) WITH (1) WALL ([1] 66CM DEEP GABLE AND [1] 66CM DEEP CABINET) (THIS IS NOT A ZERO CLEARANCE ENCLOSURE. STANDARD HEIGHTS AND WIDTHS WILL BE CLEARANCE ENCLOSURE. STANDARD HEIGHTS AND	
08Jun20 Note:	
11,458/35476	
1 - APPLIANCE CABINETS - HOOD FAN - ACCOMMODATE FOR MICROWAVE/HOOD FAN COMBO (SUPPLY SPECS) INCLUDES ELECTRICAL DEDICATED LINE	
08Jun20 Note:	
11,458/35474	

CABINETRY - VANITY

2 - VANITY CABINETS - VANITY CABINET PER FOOT (LAMINATE COUNTERTOP INCLUDED) - GROUP 1 - 4 - MASTER ENSUITE	
08Jun20 Note:	
11,458/35481	

STAIR AND RAILING

1 - STAIN STAIR AND RAILING PER FLOOR	
08Jun20 Note:	
11,458/35490	

TRIM DOORS AND HARDWARE - INTERIOR

1 - 2 PANEL SMOOTH DOORS THROUGHOUT (STD. HOLLOW CORE)	
08Jun20 Note:	
11,458/35493	
1 - DOOR HANDLE - UPGRADE TO PEWTER STRAIGHT LEVERS	
08Jun20 Note:	
11,458/35492	

This Document is Extremely Time Sensitive - Printed 8 Jun 20 at 14:15