

HIGHCASTLE HOMES - COLOUR SCHEDULE

Purchaser: KUSHWAHA, ARCHANA SINGH
Telephone Res. / Bus: (905) 880-7426 /
Decor Advisor: Caroline Rajcsanyi

Property: 10Phase: 2 of Plan - Draft Plan 21T-9005B

Project: 2073737 Ontario Inc.

Model and Elevation: Hillcrest Elev B

KITCHEN AND VANITIES

	Cabinet	Counter	Hardware
Kitchen	Lv2 - Hudson 3DL - Coconut	Lv2 - Caesarstone-White Ash	*2- 12877 Handle
Main Bathroom	N/A	N/A	N/A
Ensuite Bathroom	Lv2 - Manchester Maple - Espresso CL	Lv1 - GR-Grigio Sardo	9677 Handle
Ensuite 2	Lv2 - Simcoe 3DL - Ontario White	Lv1 - GR-Grigio Sardo	9677 Handle
Ensuite 3	Lv2 - Manchester Maple - Dark Rye CL	Lv1 - GR-Tan Brown	9677 Handle
Ensuite 4	Lv2 - Simcoe 3DL - Ontario White	Lv1 - GR-San Gabriel	9677 Handle
Ensuite 5	Lv2 - Manchester Maple - Soapstone CL	Lv1 - GR-Grigio Sardo	9677 Handle
Powder Room	Lv2 - Manchester Maple - Espresso CL	Lv3 - Caesarstone-Quartz Reflections	151 Knob
Laundry	Lv2 - Manchester Maple - Shale Grey CL	4987K-07 Leche Vesta	9677 Handle
Opt. Breakfast Bar	Counter Height/Flush	Kitchen Hood Fan	Purchaser to supply after closing/standard electrical
		Kitchen Upper Height	100 cm

Stove opening – If not specified will be set to builders standard opening of approximately 30 in width

Fridge Opening – If not specified will be set to builders minimum opening of approximately 33 x71 height (townhouses)

- If not specified will be set to builders minimum opening of approximately 36 x 71 height (singles)

Counter top Edge

Kitchen	Double Edge (1 1/2") Double Bevelled	Ensuite 4	Single Edge (3/4") Top Bevelled
Master Ens	Single Edge (3/4") Top Bevelled	Ensuite 5	Single Edge (3/4") Top Bevelled
Ensuite 2	Single Edge (3/4") Top Bevelled		
Ensuite 3	Single Edge (3/4") Top Bevelled		

Opt. Kltchen
Extras

PARQUET / HARDWOOD OR BROADLOOM

Kitchen / Breakfast	N/A	Master Bedroom	*Oak Strip Lauzon Essential Expert 4 1/8" x 3/4"-Graphite
Great Room	N/A	Bedroom 2	Lv2 - Sweet Dreams1 Lv2 - 738 Amish Linen
Living / Formal Room	*Oak Strip Lauzon Essential Expert 4 1/8" x 3/4"-Graphite	Bedroom 3	Lv2 - Sweet Dreams1 Lv2 - 738 Amish Linen
Dining Room	*Oak Strip Lauzon Essential Expert 4 1/8" x 3/4"-Graphite	Bedroom 4	Lv2 - Sweet Dreams1 Lv2 - 738 Amish Linen
Family Room	*Oak Strip Lauzon Essential Expert 4 1/8" x 3/4"-Graphite	Bedroom 5	Lv2 - Sweet Dreams1 Lv2 - 738 Amish Linen
Main Hall	N/A	Utility Stairs	Lv2 - Sweet Dreams1 Lv2 - 738 Amish Linen
Main Stairs	Oak	Fin Bsmt Area	*1-Laminate-8mm SF Trend 4 7/8" x 5/16" - Midnight
Upper Hall	*Oak Strip Lauzon Essential Expert 4 1/8" x 3/4"-Graphite		
Com. Centre/Home Office	N/A	Basement	N/A
Main Stair Landing	*Oak Strip Lauzon Essential Expert 4 1/8" x 3/4"-Graphite	Basement Landing	*Oak Strip Lauzon Essential Expert 4 1/8" x 3/4"-Graphite
Library/Den/Study	*Oak Strip Lauzon Essential Expert 4 1/8" x 3/4"-Graphite	Basement Stairs	Oak
In Law Suite	N/A		

Carpet Runner ☐ Yes ☒ No

Underpad Main Floor	Underpad 2nd Floor	Underpad Main Stairs
NA	Lv1 Underpad-standard	NA

Opt. Flooring Extras

FLOOR AND WALL TILES

FLOOR AND WALL TILES		Floor Tile	Wall Tile	Decor	Listello
Front Foyer	*5 - 24 x 24 Carrara X White				
Main Hall	*5 - 24 x 24 Carrara X White				
Kitchen/Breakfast	*5 - 24 x 24 Carrara X White		Kitchen Backsplash	N/A	<input type="checkbox"/> <input type="checkbox"/>
Powder Room	*5 - 24 x 24 Carrara X White		Powdr Wall if Applicable	N/A	<input type="checkbox"/> <input type="checkbox"/>
Laundry	1-13x13, Serpentine White				

	Floor	Tub Wall	Shower Wall	Deck Skirt	Deck Splash	Decor	Listello
Main Bathroom	N/A	N/A	N/A	N/A	NA	<input type="checkbox"/>	<input type="checkbox"/>
Master Ens	2-13x13, Alabastrino, Grey V	N/A	3-10x13, Alabastrino, Grey/V	2-13x13, Alabastrino, Grey V	3-10x13, Alabastrino, Grey/V	<input checked="" type="checkbox"/>	<input type="checkbox"/>
Ensuite 2	2-13x13, Kelly, Grey	3-10x13, Kelly, Grey	N/A	N/A	NA	<input type="checkbox"/>	<input type="checkbox"/>
Ensuite 3	2-13x13, Alabastrino, Beige	3-10x13, Alabastrino, Beige	N/A	N/A	NA	<input type="checkbox"/>	<input type="checkbox"/>
Ensuite 4	2-13x13, Alabastrino, Grey V	N/A	3-10x13, Alabastrino, Grey/V	N/A	NA	<input checked="" type="checkbox"/>	<input type="checkbox"/>
Ensuite 5	2-13x13, Alabastrino, Grey V	N/A	3-10x13, Alabastrino, Grey/V	N/A	NA	<input checked="" type="checkbox"/>	<input type="checkbox"/>

Shower - Upgrade Floor

Opt. Tile Extras

MUD ROOM 1ST FLOOR (17.7 X 17.7 NEW BYZANTINE, PENTELIC GREY) *** LAUNDRY IS 2ND FLOOR WITH 13 X 13 TILES***

HIGHCASTLE HOMES - COLOUR SCHEDULE

Purchaser: KUSHWAHA, ARCHANA SINGH
Telephone Res. / Bus: (905) 880-7426 /
Decor Advisor: Caroline Rajcsanyi

Property: 10Phase: 2 of Plan - Draft Plan 21T-9005B
Project: 2073737 Ontario Inc.
Model and Elevation: Hillcrest Elev B

PLUMBING / FAUCETS

Powder Room	Standard	Laundry	Standard
Main Bath	N/A	Ensuite 3	Standard
Master Ensuite	Standard	Ensuite 4	Standard
2nd Ensuite	Standard	Ensuite 5	Standard
R.I. Bath	*3 Piece		
Kitchen Sink	*Undermount		
Kitchen Faucet	Standard		
Drain for 2nd floor Laundry	<input type="radio"/> Yes <input checked="" type="radio"/> No		
Waterline for fridge	<input checked="" type="radio"/> Yes <input type="radio"/> No		
Supply and install all toilet paper holders, towel bars and soap dishes	<input type="radio"/> Yes <input checked="" type="radio"/> No		
Whirlpool			

Opt. Plumbing Extras

PAINTING

Wall Colour	Trim Colour	Railing Colour	Pickets Colour	Stair Colour
25 Oyster	Standard	*Stained as Floor	*Wrought Iron	*Stained as Floor
Opt. Paint Extras				

MISCELLANEOUS

Railing Style	RAILING - UPGRADE 1 - 1/2in Wrought iron BLACK square picket with square collar on alternating picket, 3in oak handrail and 3 1/2in oak std. post.				
Opt. Garage Door	*Yes-Grade Permitting	Opt. Side Door	NA	Stair Type	Oak
Interior Doors	Carrera	Int. Door Hardware	*1 - Elite Pewter Lever	Ext. Door Hardware	*Pewter Exterior package
		Trim Style	Step-7 1/4 1st fir, 5 1/4 2nd fir base w 3 1/2 Casing	Cold Cellar	<input checked="" type="checkbox"/>
Smooth Ceiling 1st Floor	<input checked="" type="radio"/> Yes <input type="radio"/> No	Basement Windows Upgrade	<input checked="" type="radio"/> Yes <input type="radio"/> No		
Smooth Ceiling 2nd Floor	<input checked="" type="radio"/> Yes <input type="radio"/> No				
Supply and Install Standard Mirrors	<input checked="" type="radio"/> Yes <input type="radio"/> No				
Misc.					

HEATING

Fireplace	Type	Mantle	Surround	Hearth
Family Room	36" Standard	*Stonecast	N/A	N/A
Master Bedroom	36" Standard	Standard - Paint Grade	N/A	N/A
Air Conditioning	<input type="radio"/> *Yes <input checked="" type="radio"/> No		Gas Provisions for BBQ	<input checked="" type="radio"/> Yes <input type="radio"/> No
Hood Fan Duct	<input type="radio"/> 6 inch <input checked="" type="radio"/> 8 inch <input type="radio"/> 10 inch		Humidifier	<input checked="" type="radio"/> Yes <input type="radio"/> No
Gas Provisions for Dryer	<input type="radio"/> Yes <input checked="" type="radio"/> No			
Gas Provisions for Stove	<input checked="" type="radio"/> Yes <input type="radio"/> No			

Exterior Colour Scheme: Pre-selected By Vendor

- NOTE: The Purchaser(s) agree(s) that:
- a) Colours of materials are as close as possible to Vendor's selections, but not necessarily identical due to variances in manufacturing or manufacturers.
 - b) Purchaser(s) has checked and acknowledges accuracy of the above selections. Where omissions occur on the original colour selection sheet Purchaser(s) acknowledge that the Builder's selection will be final.
 - c) Upgrades or extras listed on this schedule will not be deemed part of the Agreement of Purchase and Sale. Any such upgrades or extras shall be null and void unless accompanied by a separate invoice and amendment. Said invoice must be paid in full.
 - d) The Purchaser(s) further agrees that in the event that the Vendor has preselected colours prior to the purchase of the house, the prescribed colours are final not withstanding that the Purchaser may have completed a colour selection schedule
 - d) The Purchaser(s) Acknowledges that once this colour schedule is signed and dated, no changes, additions or deletions will be permitted other than re-selection due to unavailability.
- A \$350.00 (Per Occurance) change/administration fee will apply to above exceptions.

This Interior Colour Selection is final and approved by:

Signature: Archana Singh Date: Aug 24 2016

Printed 8/24/2016 14:46:54

Builder's Agent: Caroline Rajcsanyi Date: Aug 24 16



Highcastle Homes Décor Centre Disclaimers

Lot#: 10 Model:Hillcrest Elev B in Riverwalk II - 2073737 Ontario Inc.

PURCHASER: KUSHWAHA, ARCHANA SINGH

TEL: RES.: 905-880-7426

Through years of doing business, we at Highcastle Homes have encountered issues beyond our control. The following disclaimers apply to all instances of Purchaser's Extras forms and all Interior Colour Scheme forms.

Fireplaces

Fireplace Marble: Due to the many variables that can affect the pattern and/or design, frequently the marble installed on the fireplace will not be identical to the samples. We will make every attempt to come as close to the samples as possible, but cannot be responsible for results which differ from the samples.

Ceramic Floor Tile

Many variables including variegation can affect tile colour, pattern and/or design which mean installed tiles may not be identical to the samples. We will make every attempt to come as close as possible, but cannot be responsible for results which differ from the samples.

Hardwood Flooring

The purchaser is advised that cupping and shrinkage are characteristics of hardwood flooring normal appearing some time after installation, and no warranty is provided by the flooring supplier with respect to such cupping and shrinkage. The vendor agrees to install any hardwood flooring ordered by the purchaser in good and workmanlike manner, but shall not be responsible for, and is hereby released by the purchaser from responsibility and liability for cupping and shrinkage of hardwood flooring.

Shrinking and expanding/cupping of the hardwood floors may occur if the humidity levels in the home are not kept at industry recommendations. If the hardwood floors shrink or expand due to the homeowner not complying with these levels, the hardwood floor will no longer be under warranty and it will be the homeowner's responsibility to repair the flooring.

Stain Colours

Due to many variables that can affect the outcome of a stain colour on wood, staircases, railings, and fireplaces, will not be identical to samples. Factors such as density, age humidity, air temperature, and the uniqueness of each piece of wood can result in wide variations in darkness or lightness. We will make every attempt to come as close to the sample as possible, but cannot be responsible for results which differ from the samples.

Stain on pre-finished hardwood floors will not be an exact match to the stain colours available on stairs, pickets and rails. The purchaser is responsible for choosing the stain on these areas to their satisfaction.

Appliances

All fridge openings are set to builder's standard width. Please advise Décor Centre at time of colour appointment if custom sizing of cabinets is required for any built - in appliances. The purchaser is responsible for costs and fees associated with changes to pre-manufactured kitchens made subsequent to colour appointments.

Kitchen Cabinets

The kitchen you order/purchase will undoubtedly contain slight colour variations. The degree of these variations is virtually impossible to determine before the kitchen is installed in its intended location. The amount of and type of lighting will also affect various highlights in the finish. Note: No two pieces of wood are identical. Variations in colour tone and grain patterns make a perfect colour match virtually impossible. It is generally agreed that these variations add to the natural beauty of a wood kitchen.

Shrinking and expanding of the kitchen cabinets may occur if the humidity levels in the home are not kept at industry recommendations. If the cabinets shrink or expand due to the homeowner not complying with these levels, the cabinets will no longer be under warranty and it will be the homeowner's responsibility to repair the cabinets.

Plaster Mouldings and Medallions

Plaster mouldings will not be installed in open to above areas or areas with 2 storey elements.

Metal Spindles

Due to the characteristics of wrought iron railing production, it is possible for the wrought iron to develop a scale effect. This scale may or may not be totally covered during the painting process. In effect, once the wrought iron picket is painted, the paint may in effect amplify the iron scale depending on the colour chosen. This is a natural effect of wrought iron and should not be construed as a defect or damage.

I hereby acknowledge reading and understanding the above copy and will not hold Highcastle Homes responsible for any issues in relation to above.

Purchasers Signature(s): Archana Singh Date: Dec 24th 2016

Lot 10
Riverwalk II

MOSCONE
MARBLE

STANDARD EDGE

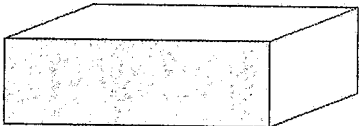

Single Straight polished 3/4"

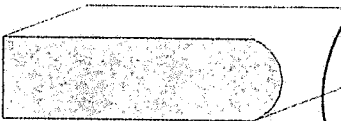

Single Bullnose 3/4"

EOS #2,3,4 + 5.

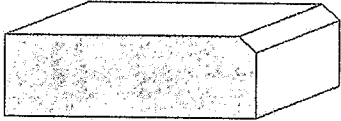

Single Bevel 1/4" top bevel 3/4" thick

UPGRADE #1 EDGES

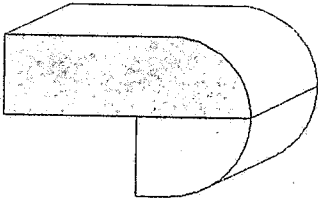

Double Bullnose 1.5" thick

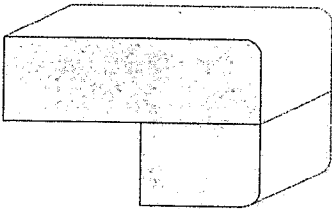

Double Pencil 1.5" thick

KITCHEN

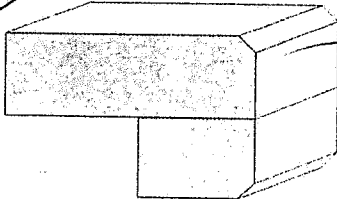

Double Bevel 1/4" top&bottom 1.5" thick

UPGRADE #2 EDGES

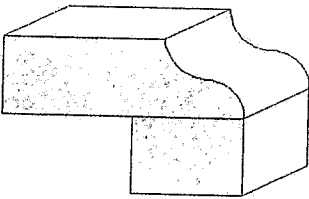

Double Ogee 1.5" thick

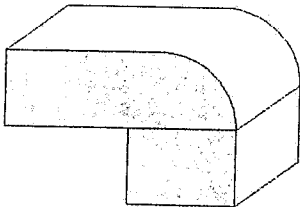

Double Quarter Moon 1.5" thick

Signature Archana LPL

Date 22 Aug 2016



F R E N D E L
K I T C H E N S L I M I T E D

1350 Shawson Drive, Mississauga, ON L4W 1C5

Tel: (905) 670-7898
Fax: (905) 670-1986
www.frendel.com

PLAN

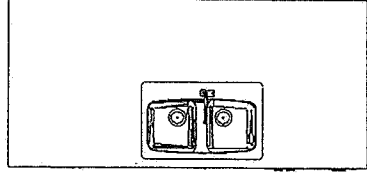
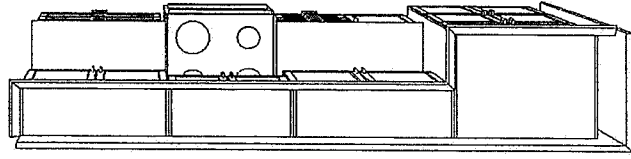
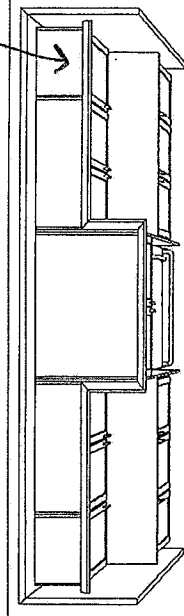

Glass door w matching interior

white tops

BUILT INS
OVEN/MICRO

Lot 10
Riverwalk

different colour
blaze

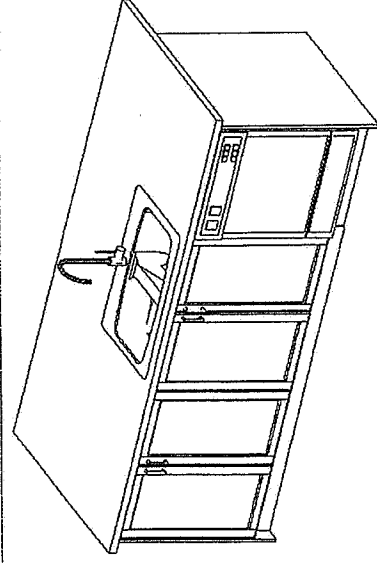

22 Aug 2016

Date

Sigrid Anderson *efl*

HIGHCASTLE HOMES
RIVERWALK 2
MODEL: 87-1 HILLCREST

MAIN FLOOR

LOT 10.
Riverwalk II



CAT5

Light R/I

Change tub
to frameless glass.
Front w shower.
light tiled ceiling

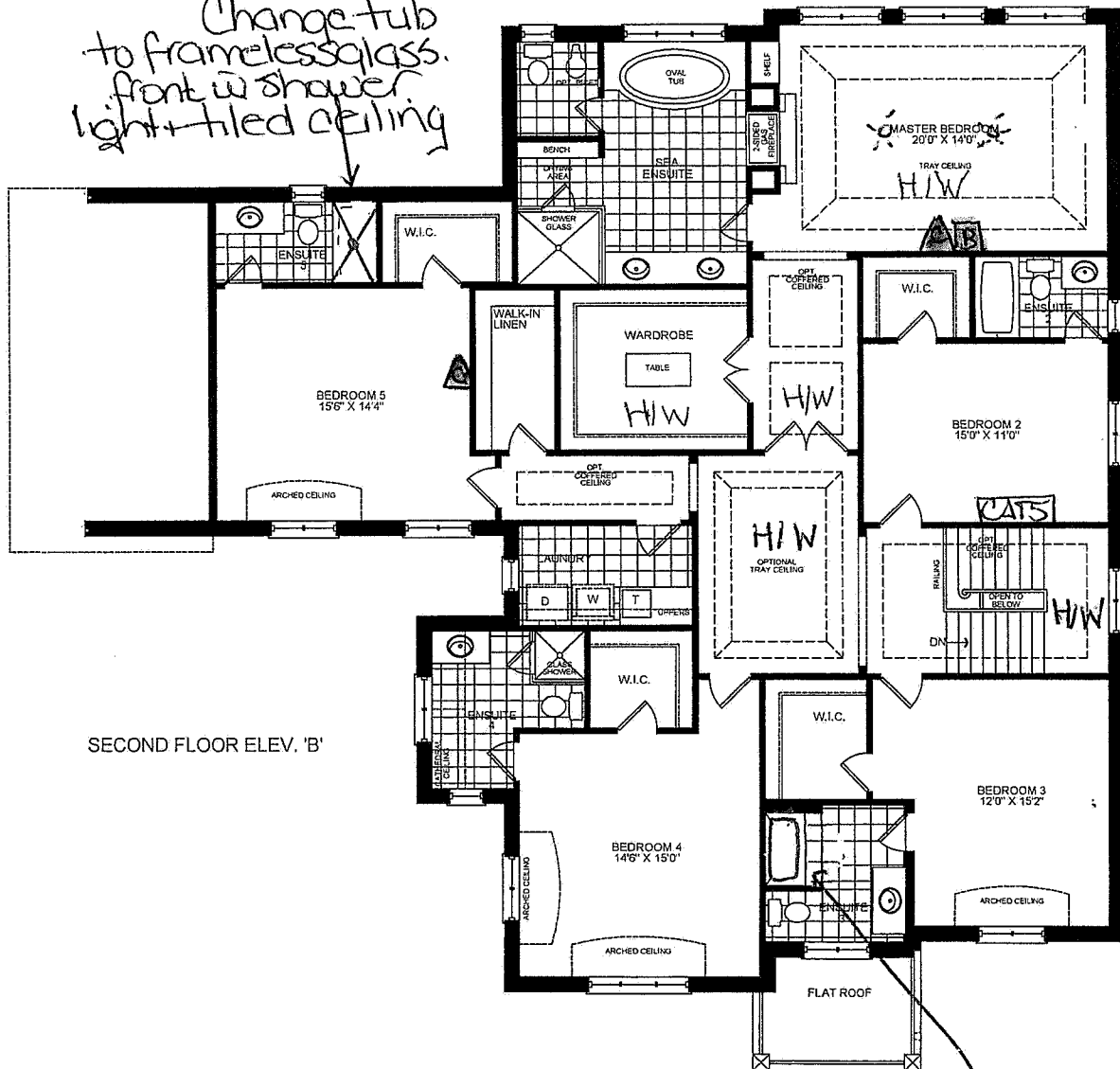

SECOND FLOOR ELEV. 'B'

Standard
tub.

Sig Archana by Aug 24 2016

Archana by

Date

May 6th 2016

BUILDER NAME:	HIGHCASTLE HOMES
PROJECT NAME:	RIVERWALK PHASE 2
LOCATION:	LOT #10
DATE:	MAY 4, 2016
MODEL:	HILLCREST (87-1 B)

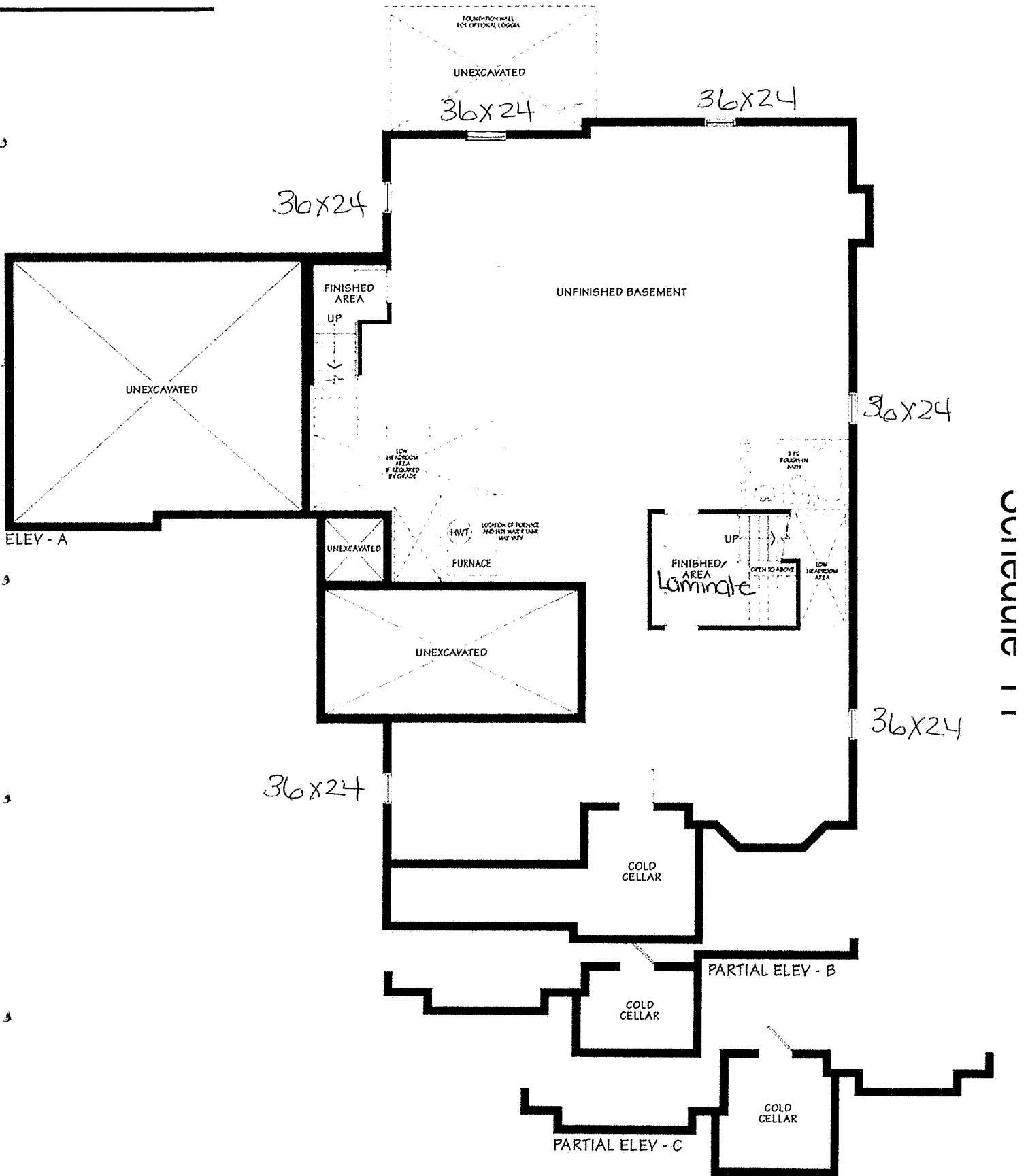

Archaeo by Aug 24th 2016

Archaeo by

BASEMENT

May 6th 2016

Sign

Date

42" BUILT-IN FRENCH DOOR REFRIGERATOR/FREEZER

Lot 10
SUB-ZERO
P. 11

BI-42UFD/S



FEATURES

- LED Lighting for brighter interior
- Maximum capacity in a 42" French door model
- Dual refrigeration keeps food fresher longer
- Air purification system fights spoilage, odors
- Crispers and deli drawers in low-temp, high-humidity zones for optimum freshness
- Microprocessor control assures peak performance
- Two-column shelving for customized storage
- Soft-close deli drawer for meats, cheeses and more
- Water-filtration system reduces contaminants, chlorine taste and odor
- Freshness cards for maximum food preservation
- Rigorously tested in our U.S. manufacturing facilities to ensure at least 20 years of heavy use
- Exceptional 24/7 support from our Customer Care team based in Madison, Wisconsin and just footsteps from our factory
- Over-and-under refrigerator/freezer storage
- Magnetic door seal system locks in cold air
- Automatic ice maker with "max ice" feature
- Adjustable shelves for maximum convenience

ACCESSORIES

- Stainless steel kickplate
- Grilles for 83" or 88" finished height (84" is standard)
- Side panel mounting kit

Accessories are available through an authorized Sub-Zero dealer. For local dealer information, visit subzero-wolf.com/locator.

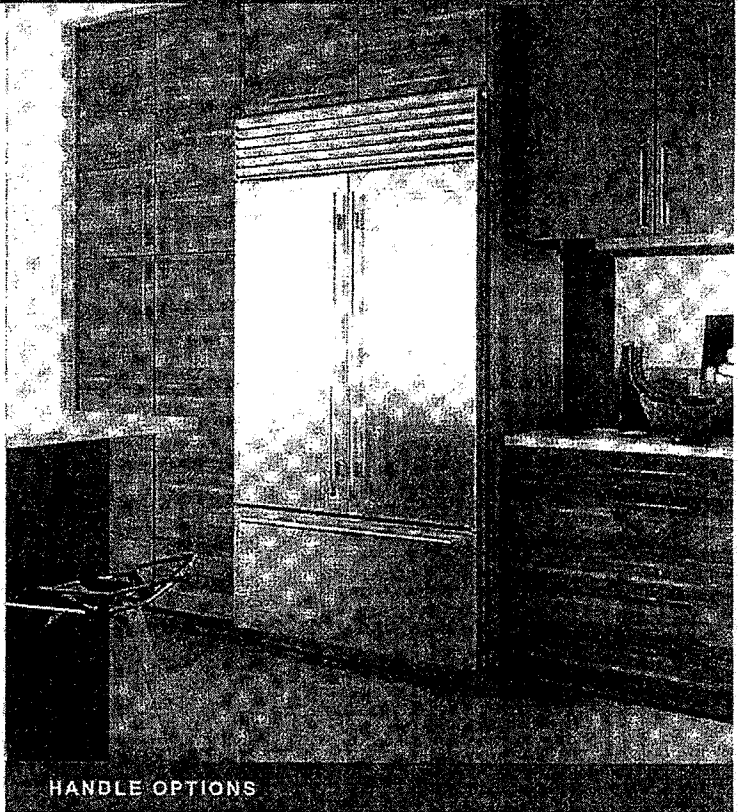

HANDLE OPTIONS

PRO

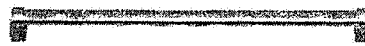

TUBULAR



PRO
Handles

PRODUCT DETAILS

REFRIGERATOR

- 6 Adjustable glass shelves
- 1 Stationary glass shelf
- 1 Deli drawer with dividers
- 2 Crisper drawers
- 4 Adjustable door shelves
- 2 Stationary door shelves
- 2 Adjustable dairy compartments

FREEZER

- Full-extension roll-out freezer drawer
- Two-tier wire storage baskets
- Automatic ice maker

42" BUILT-IN FRENCH DOOR REFRIGERATOR/FREEZER

LOT10
SUB-ZERO
②

PRODUCT SPECIFICATIONS

Model	BI-42UFD/S
Dimensions	42"W x 84"H x 24"D
Door Clearance	22 1/4"
Drawer Clearance	23 5/8"
Weight	582 lb
Refrigerator Capacity	18.3 cu ft
Freezer Capacity	6.4 cu ft
Electrical Supply	115 VAC, 60 Hz
Electrical Service	15 amp dedicated circuit
Plumbing Supply	1/4" OD copper, braided stainless steel or PEX tubing
Plumbing Pressure	35-120 psi
Receptacle	3-prong grounding-type

ELECTRICAL

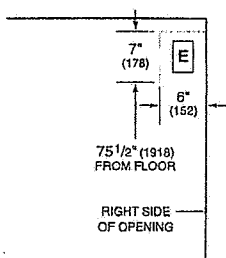

PLUMBING

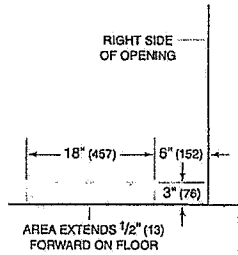

INTERIOR VIEW

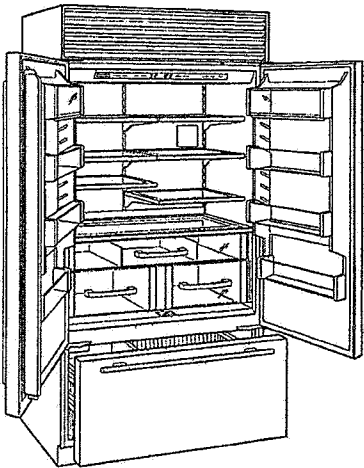

This illustration is intended for interior reference only and may not represent the exterior of the model being specified.

DIMENSIONS

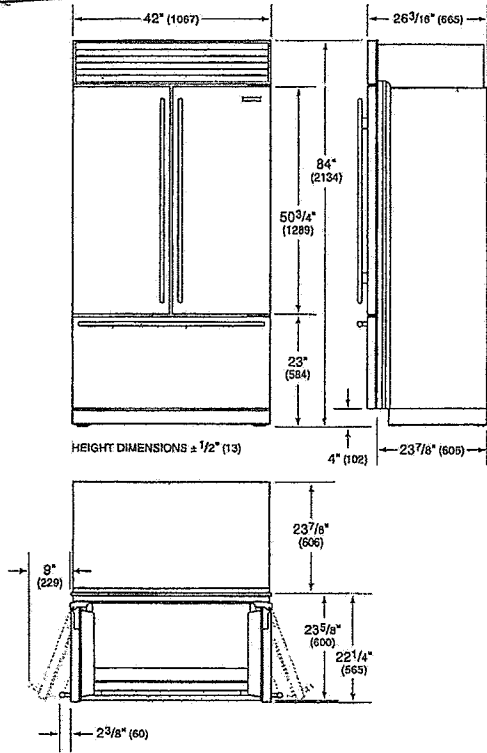

STANDARD INSTALLATION

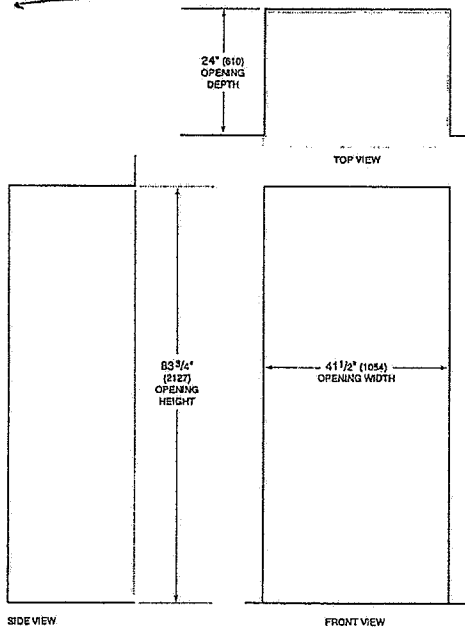

NOTE: Shaded line represents profile of unit.

36" SEALED BURNER RANGETOP - 6 BURNERS

SRT366



FEATURES

- 6 dual-stacked, seamless burners
- Dual-stacked burners go from 20,000 Btu down to a mere breath of flame
- Continuous cast-iron grates for easy movement of pots and pans
- Heavy-gauge stainless steel
- Rigorously tested in our U.S. manufacturing facilities for decades of use
- Exceptional 24/7 support from our Customer Care team in Madison
- Signature red infinite control knobs
- Individual spark ignition system

ACCESSORIES

- Stainless steel, brass or chrome bezels
- High altitude conversion kit
- Cast iron S-grates and wok grate
- Signature red, black or stainless steel control knobs
- 5" and 10" stainless steel risers, and 20" riser with shelf

Accessories available through an authorized Sub-Zero dealer.
For local dealer information, visit subzero-wolf.com/locator.



KNOB OPTIONS



Red Knobs

TOP CONFIGURATION

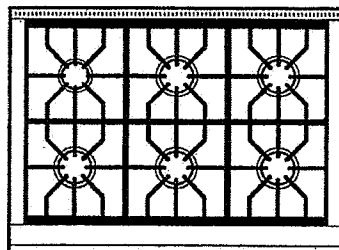

RANGETOP SPECIFICATIONS

- 1 - 9,200 Btu Burner
- 2 - 15,000 Btu Burners
- 2 - 18,000 Btu Burners
- 1 - 20,000 Btu Burner

36" SEALED BURNER RANGETOP - 6 BURNERS

WOLF

PRODUCT SPECIFICATIONS

Model	SRT366
Dimensions	35 7/8"W x 8 1/2"H x 28 1/2"D
Weight	220 lb
Electrical Supply	110/120 VAC, 60 Hz
Electrical Service	15 amp dedicated circuit
Gas Supply	3/4" rigid pipe
Gas Inlet	1/2" NPT female
Receptacle	3-prong grounding-type

ELECTRICAL AND GAS

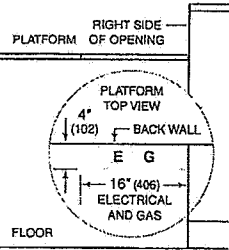

DIMENSIONS

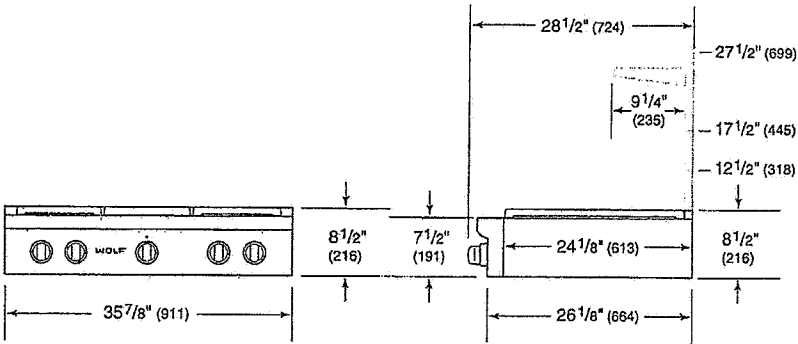

STANDARD INSTALLATION

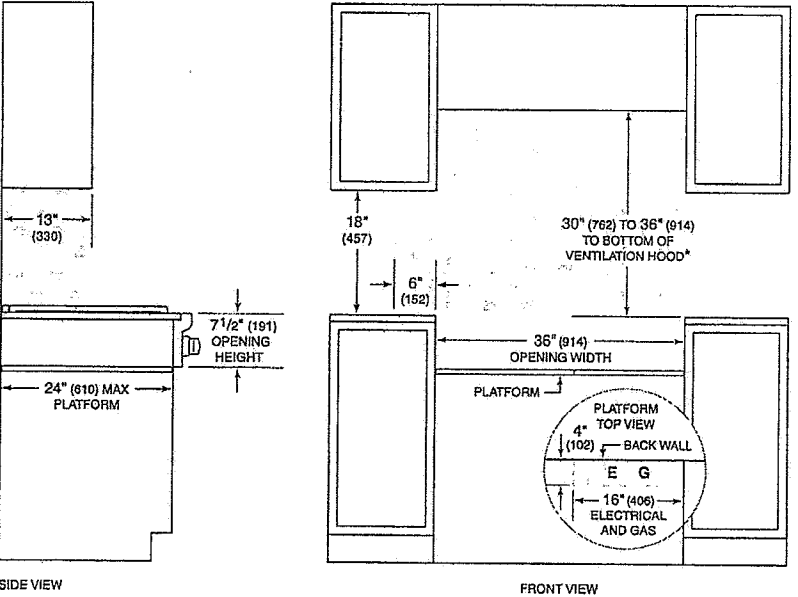

*Without ventilation hood, 36" (914) minimum clearance countertop to combustible materials, 44" (118) for charbroiler.
NOTE: Shaded area above countertop indicates minimum clearance to combustible surfaces, combustible materials cannot be located within this area.
Electrical and gas supply located through bottom of platform.
For island installation, 12" (305) minimum clearance back of range to combustible rear wall above countertop.

Rogers & Co.

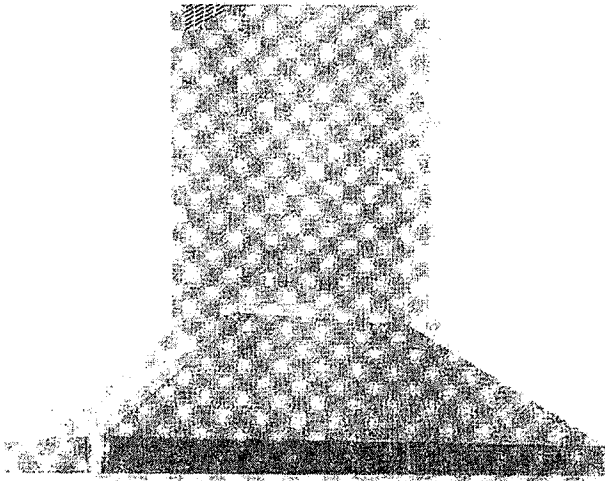

SU54

SU54

- SU54 36" 48" Motor: 2 x EBM 1100 cfm (Duct Size 8")
- SU54 30" 1 x EBM 600 cfm (Duct Size 6")
- Pressure: 800 Pa
- Noise level: 66 dBA/5.1 sones

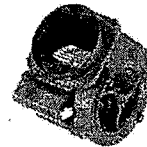

- Lighting:
2x20W Halogen lamps in 30" version
2x20W Halogen lamps in 36" version
4x20W Halogen lamps in 48" version



- Control panel: 4 speed push-button + timer + light switch



- grease filter: commercial style baffle filters
- Stainless steel: AISI 430

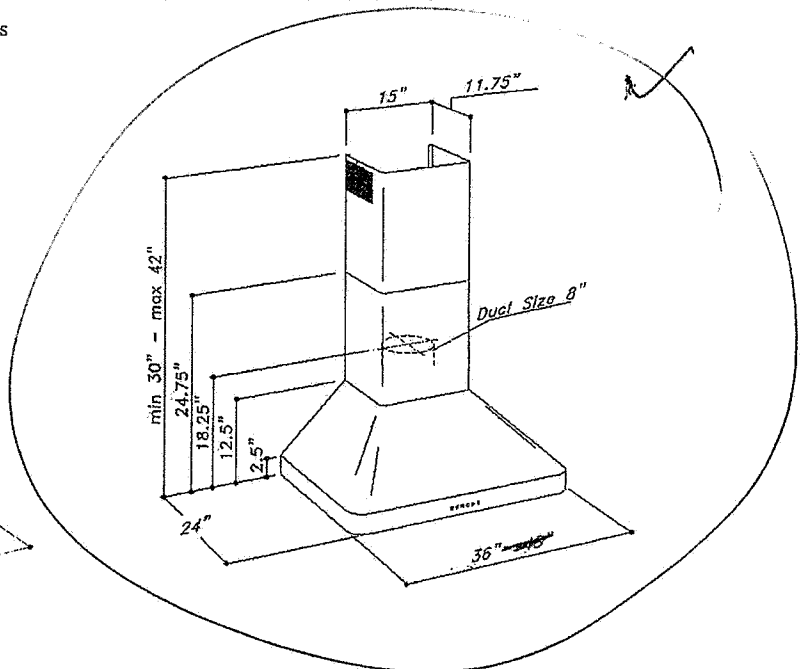
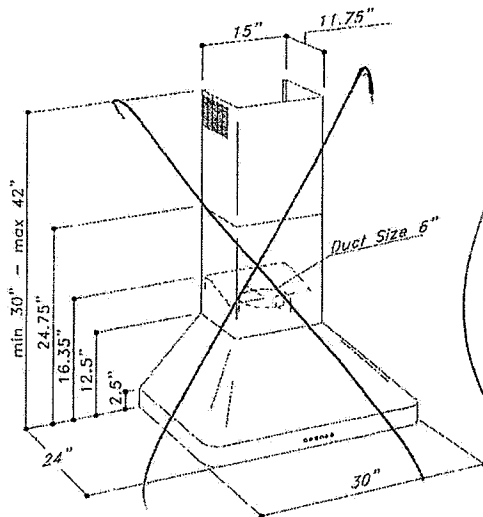

Sirius

ADDITIONAL INSTALLATION REQUIREMENTS

MDD30PM/S/PH - 30" M SERIES PROFESSIONAL DROP-DOWN DOOR
MICROWAVE OVEN

OVERALL DIMENSIONS

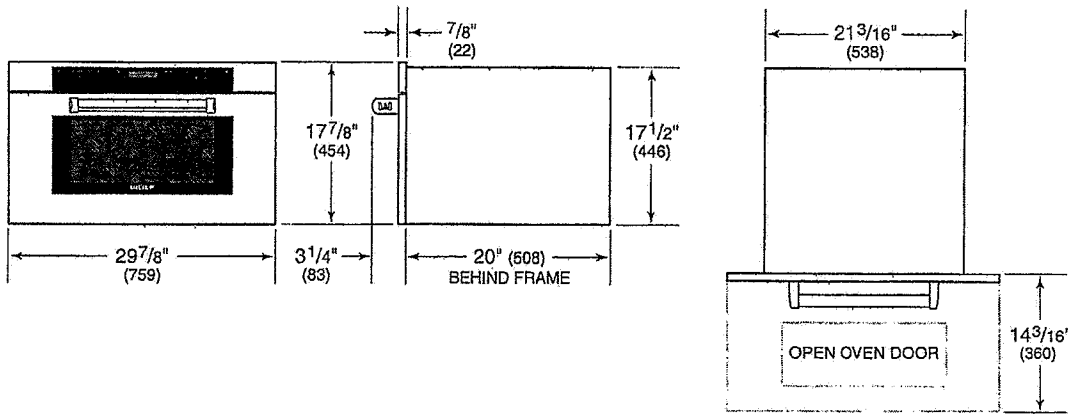

ELECTRICAL

Electrical Supply	grounded, 120 VAC, 60 Hz
Electrical Service	15 amp dedicated circuit
Power Cord Length	4'
Receptacle	3-prong grounding-type

**WARNING**

Installation must comply with all applicable electrical codes.

E

ELECTRICAL
SUPPLY WITHIN OPENING
OR IN ADJACENT CABINET
WITHIN REACH OF
POWER CORD

E

ADDITIONAL INSTALLATION REQUIREMENTS

SO30PM/S/PH - 30" M SERIES PROFESSIONAL BUILT-IN SINGLE OVEN

OVERALL DIMENSIONS

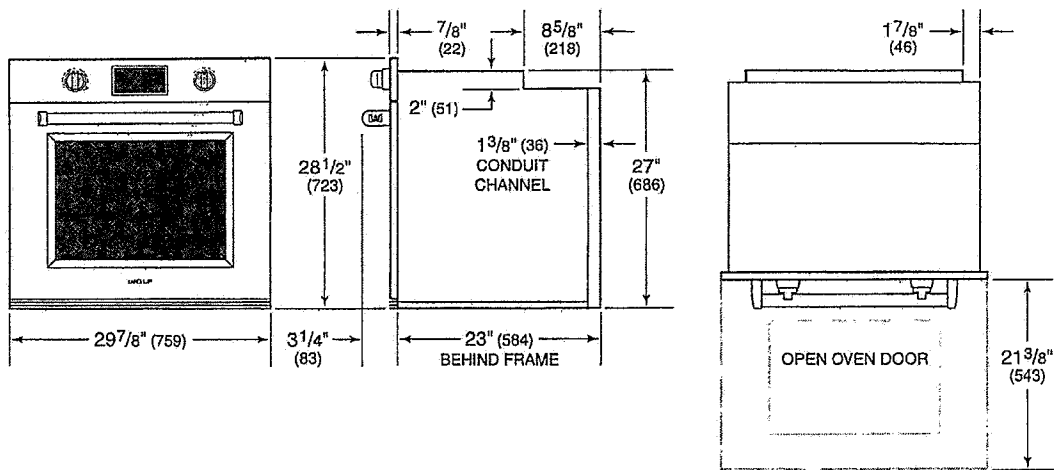

ELECTRICAL

Electrical Supply	grounded, 240/208 VAC, 60 Hz
Electrical Service	30 amp dedicated circuit
Conduit Length	4'

**WARNING**

Installation must comply with all applicable electrical codes.

Performance may be compromised if the electrical supply is less than 240 volts.

The oven is supplied with a conduit consisting of two insulated hot lead conductors and a bare ground conductor. The wiring diagram covering the control circuit is provided with the oven.

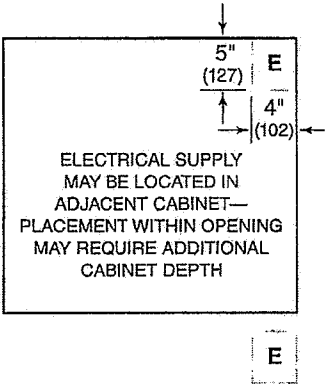

FRONT VIEW

SECTION A

Lot 10
Built In.
Micro/oven.

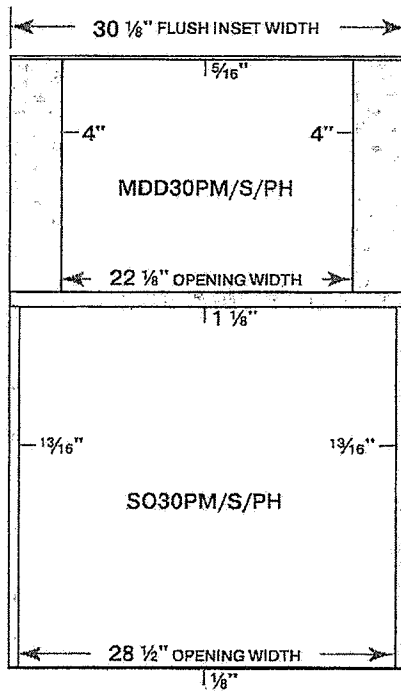

ELECTRICAL LOCATIONS

Please see the electrical page in this document for detailed electrical locations.

PLANNING NOTES

Reveals will be visible and should be finished to match the cabinetry.

If two products with different reveals are specified, the larger reveal must be used.

Dimensions provided assume minimum allowable reveals.

Microwaves

MDD30PM/S/PH: A minimum 1/8" (3) reveal is required on all sides.

1 Series Built-In Ovens

If a cooktop is being installed above an oven, a minimum of 1/4" (6) is required between units.

A minimum 1/8" (3) reveal is required on all sides.

SIDE VIEW

SECTION A

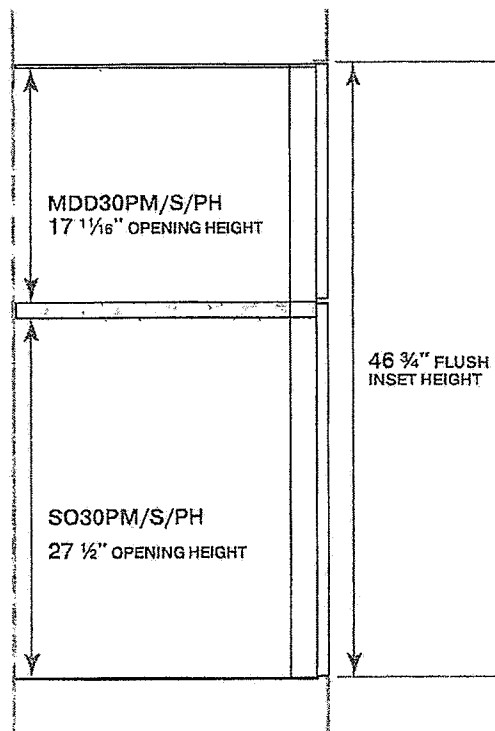

24" XXL Built-In Dishwasher—Pro Handle

MODEL D5636XXLHS/PH

askona.com

FEATURES

- Pro handle and hidden controls.
- TouchProof™ stainless steel.
- Turbo Drying™ system.
- 16 place-setting capacity.
- Quiet operation—46 dB(A).
- 9Spray™ wash system; separate spray nozzles clean pot & pans and continuously spray cutlery basket.
- 10 wash programs.
- Delayed start—up to 24 hours.
- Heavy-duty stainless steel construction with nylon-coated steel racks.
- LED display.
- Remaining time and program end indicator.

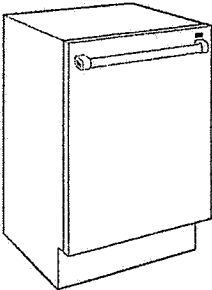
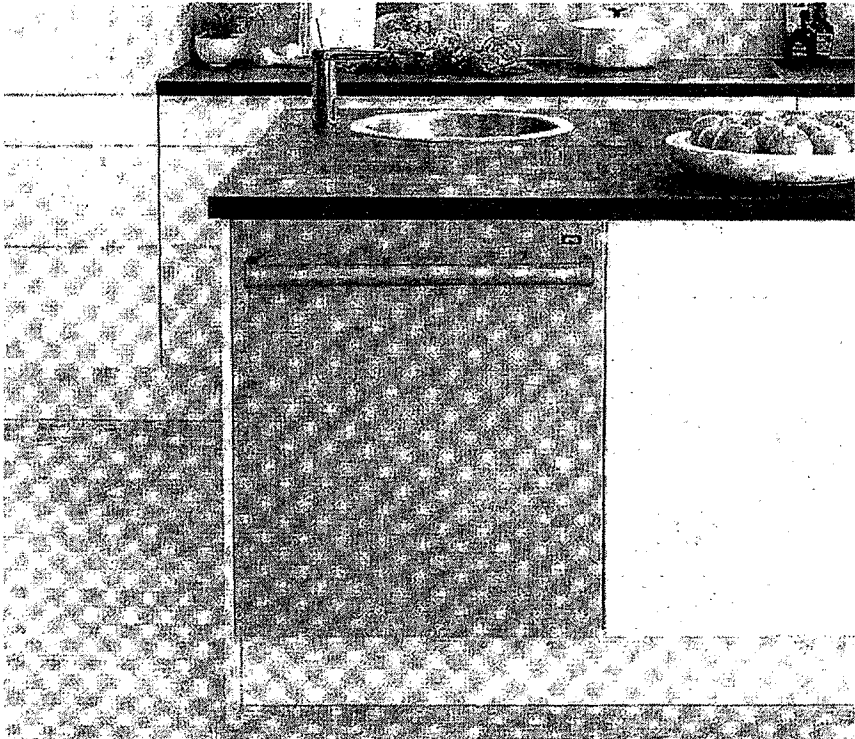

Model D5636XXLHS/PH



MODEL

Pro Handle D5636XXLHS/PH

INTERIOR FEATURES

Top tray with Instant Lift™

Premium upper rack

Premium lower rack

PROGRAMS

Sanitation Wash

Normal Wash

Heavy Wash

Quick Wash

Hygiene

Delicate Wash

Eco Wash

Upper Half

Lower Half

Rinse and Hold

24" XXL Built-In Dishwasher—Pro Handle

MODEL D5636XXLHS/PH

SPECIFICATIONS

PRODUCT

Width	237⁄8"
Height	34"–35¾"
Depth	227⁄8"
Door Clearance	24⁵⁄₈"
Weight	115 lb

MAX LOADING HEIGHT

Upper Rack	9"
Lower Rack	137⁄₈"

ELECTRICAL

Supply	115 VAC, 60 Hz
Service	15 amp circuit

PLUMBING

Supply	1⁄₄" OD copper, braided stainless steel or PEX tubing
Pressure	4.2–140 psi

Electrical supply, plumbing supply and drain should be located in an adjacent cabinet. If not, they must be located within the shaded area shown in the illustrations.

Specifications are subject to change without notice. Visit askona.com/specs for the most up-to-date information.

Dimensions may vary ±1⁄₈" (3). Dimensions in parentheses are millimeters unless otherwise specified.

DIMENSIONS

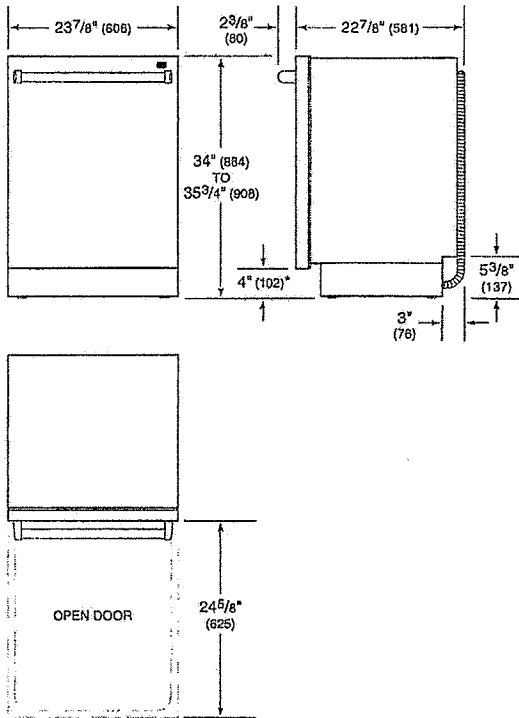

ELECTRICAL

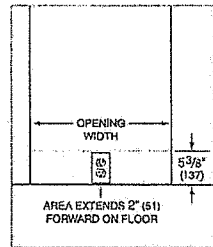

PLUMBING

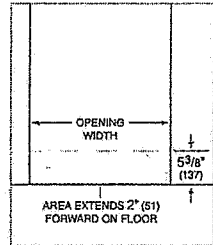

INSTALLATION

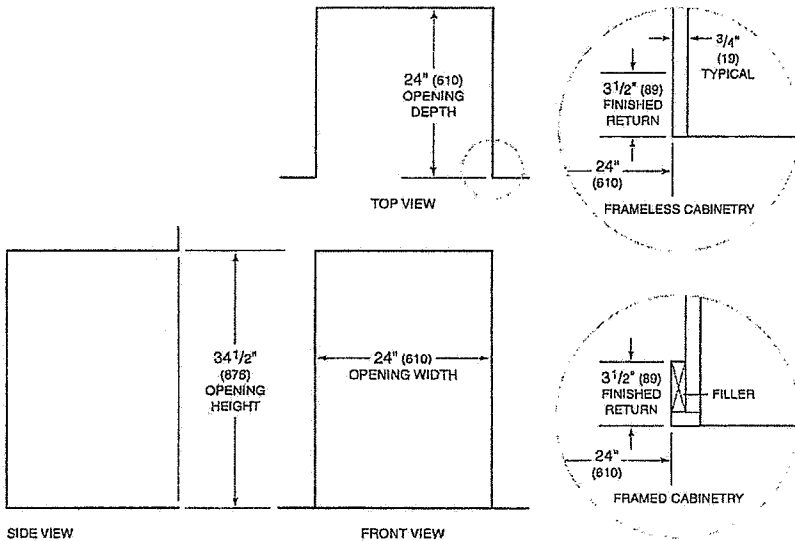

NOTE: 3 1⁄2" (89) finished returns will be visible and should be finished to match cabinetry.



CONSTRUCTION SUMMARY

Riverwalk II - 2073737 Ontario Inc.

PURCHASER: KUSHWAHA, ARCHANA SINGH

TEL: RES.: 905-880-7426

LOT / PHASE	REG. PLAN #	HOUSE TYPE	CLOSING DATE
10 / 2	Draft Plan 21T-9005B	Hillcrest Elev B	30-Mar-17

1) CONSTRUCTION

2 - ENSUITE #3 - CHANGE STANDARD TUB TO A SHOWER WITH FRAMELESS GLASS FRONT WITH SHOWER LIGHT AND TILED CEILING - ENSUITE #4 - CHANGE STANDARD TUB TO A FRAMELESS GLASS SHOWER SURROUND WITH SHOWER LIGHT AND TILED CEILING 06May16 Note: 11,176/30962	CHANGE SHWR FROM ENS 3 TO ENS #5 (SEE PLAN) AND LEAVE ENSUITE 4 AS FRAMELESS GLASS SHOWER
1 - WAFFLE CEILING (12 SQUARES) WOOD FRAMED, DRYWALLED WITH PLASTER MOULDINGS - FAMILY ROOM 06May16 Note: 11,176/30961	
1 - CEILING - SMOOTH FINISH - 2ND FLOOR (65 & 87 MODELS) 06May16 Note: 11,176/30960	

3) HEATING / AIR CONDITIONING

1 - R/I BBQ LINE AS PER AGREEMENT (OUTSIDE OF BREAKFAST AREA) 24Aug16 Note: 11,204/32184	
1 - KITCHEN - CENTRE DUCT (IF POSSIBLE) FOR PURCHASERS FUTURE CHIMNEY HOOD FAN 24Aug16 Note: 11,204/32181	
1 - UPGRADE STOVE EXHAUST DUCT TO 8" EXHAUST 24Aug16 Note: 11,204/31543	
1 - GAS LINE - ROUGH-IN FOR STOVE INCLUDING ELECTRICAL OUTLET 24Aug16 Note: 11,204/31540	

4) PLUMBING

1 - WATER LINE - FRIDGE - ROUGH IN ONLY 24Aug16 Note: 11,204/31547	
1 - SINK - KITCHEN - UNDERMOUNTED (RECTANGULAR SQUARE - DOUBLE EQUAL BOWL) 24Aug16 Note: 11,204/31546	
1 - MASTER ENSUITE - ADD 10" RAIN HEAD IN SHOWER (CHROME) S112 24Aug16 Note: 11,204/31523	
7 - SINK - VANITY - UNDERMOUNTED - RECTANGULAR PORCELAIN (1 X POWDER ROOM, 2 X MASTER, 1 X ENS #2, 1 X ENS #3, 1 X ENS #4, 1 X ENS #5) 24Aug16 Note: 11,204/31522	

5) ELECTRICAL

1 - STANDARD CEILING LIGHTS IN DEN AND FAMILY ROOM WAFFLE (SEE PLAN FOR LOCATION) 24Aug16 Note: 11,204/32175	
1 - CONDUIT - RUN CONDUIT FROM MAIN FLOOR TV (AT FIREPLACE IN FAMILY ROOM) LOCATION DROP TO BASEMENT 24Aug16 Note: 11,204/32174	
18 - POT LIGHT - 4 INCH POTLIGHT WITH LED ENERGY STAR BULB (10 MINIMUM - PRICE IS EACH) - 4 X DEN, 6 X FAMILY ROOM AND 8 X KITCHEN (DELETE STANDARD CEILING LIGHT IN KITCHEN AREA) 24Aug16 Note: 11,204/31530	
1 - PLUG - INTERIOR RECEPTICAL BESIDE CABLE AND CONDUIT OVER FIREPLACE IN FAMILY ROOM FOR FUTURE WALL MOUNT TV 24Aug16 Note: 11,204/31529	
4 - LIGHT - ROUGH-IN ONLY - ON SEPARATE SINGLE SWITCH (1 X LIVING ROOM CEILING, 2 X R/I PENDANT OVER ISLAND AND (1 X MASTER, RELOCATE STANDARD AND ADD R/I, SEE PLAN) 24Aug16 Note: 11,204/31527	



CONSTRUCTION SUMMARY

Riverwalk II - 2073737 Ontario Inc.

PURCHASER: KUSHWAHA, ARCHANA SINGH

TEL: RES.: 905-880-7426

LOT / PHASE 10 / 2	REG. PLAN # Draft Plan 21T-9005B	HOUSE TYPE Hillcrest Elev B	CLOSING DATE 30-Mar-17
-----------------------	-------------------------------------	--------------------------------	---------------------------

6) FLOORING & WALL TILE

1 - TOWEL BAR/TOILET PAPER HOLDERS/SOAP DISHES- DO NOT SUPPLY AND INSTALL ALL TOILET PAPER HOLDERS, SOAP DISHES AND TOWEL BARS THROUGHOUT 24Aug16 Note: 11,204/32185	
1 - KITCHEN - DO NOT SUPPLY OR INSTALL BACKSPLASH 24Aug16 Note: 11,204/32182	
1 - CERAMIC - UPGRADE FROM LEVEL 3 TO LEVEL 5 - - POWDER ROOM 24Aug16 Note: 11,204/31562	
1 - CERAMIC - UPGRADE FROM LEVEL 3 TO LEVEL 5 - - MAIN STAIR HALL 24Aug16 Note: 11,204/31560	
1 - CERAMIC - UPGRADE FROM LEVEL 3 TO LEVEL 5 - - KITCHEN & BREAKFAST 24Aug16 Note: 11,204/31559	
1 - CERAMIC - UPGRADE FROM LEVEL 3 TO LEVEL 5 - - FOYER 24Aug16 Note: 11,204/31558	
1 - IF POSSIBLE (MINIMAL GROUT LINE ON MAIN FLOOR TILES) 24Aug16 Note: 11,204/31550	

8) FINISHING

2 - STAIN STAIR & RAILING PER FLOOR 24Aug16 Note: 11,204/31548	
--	--

9) CABINETRY

1 - RANGETOP CABINET (MODIFIED HEIGHT) WITH DRAWERS BELOW (ELECTRICAL INCLUDED) - LEVEL 1 OR LEVEL 2 24Aug16 Note: 11,204/32183	
1 - KITCHEN - DELETE UPPER CABINETS OVER STOVE FOR PURCHASERS FUTURE CHIMNEY HOOD FAN 24Aug16 Note: 11,204/32180	
1 - BUILT IN DOUBLE APPLIANCE CABINET AT 66 CM DEEP WITH DRAWER BELOW (TRIMKIT REQUIRED)(ELECTRICAL ROUGH IN ONLY) - LEVEL 1 OR LEVEL 2 24Aug16 Note: 11,204/32178	
1 - UPPER CABINETS-GLASS DOOR CLEAR (WHITE CABINET INTERIOR) (LAST CABINET OF FRIDGE WALL, SEE PLAN FOR LOCATION) 24Aug16 Note: 11,204/32176	
1 - UPPER CABINETS-MATCHING INTERIOR PER CABINET FOR GLASS DOOR CABINETS (BESIDE FRIDGE (SEE PLAN) 24Aug16 Note: 11,204/31549	
10 - ACCESSORIES - CONVERT KITCHEN/VANITY FROM METABOX TO TANDEMBOX DRAWERS WITH BLUMOTION (SOFT CLOSE) PER DRAWER 24Aug16 Note: 11,204/31512	
1 - ACCESSORIES - UPGRADE 2 HARDWARE IN KITCHEN 24Aug16 Note: 11,204/31508	
1 - ACCESSORIES - DIFFERENT COLOUR ISLAND THAN KITCHEN COLOUR 24Aug16 Note: 11,204/31506	
1 - ACCESSORIES - ACCOMMODATE BUILT IN DESIGNED REFRIDGERATOR 24Aug16 Note: 11,204/31505	



CONSTRUCTION SUMMARY

Riverwalk II - 2073737 Ontario Inc.

PURCHASER: KUSHWAHA, ARCHANA SINGH

TEL: RES.: 905-880-7426

LOT / PHASE	REG. PLAN #	HOUSE TYPE		CLOSING DATE
10 / 2	Draft Plan 21T-9005B	Hillcrest Elev B		30-Mar-17

Countertop

1 - UPGRADE LAMINATE COUNTERTOP - LEVEL 3 CAESARSTONE COUNTERTOP - - POWDER ROOM 24Aug16 Note: 11,204/32201	
1 - UPGRADE LAMINATE COUNTERTOP - LEVEL 1 GRANITE - - Ensuite - Bedroom 5 24Aug16 Note: 11,204/31521	
1 - UPGRADE LAMINATE COUNTERTOP - LEVEL 1 GRANITE - - Ensuite - Bedroom 4 24Aug16 Note: 11,204/31520	
1 - UPGRADE LAMINATE COUNTERTOP - LEVEL 1 GRANITE - - Ensuite - Bedroom 3 24Aug16 Note: 11,204/31519	
1 - UPGRADE LAMINATE COUNTERTOP - LEVEL 1 GRANITE - - Ensuite - Bedroom 2 24Aug16 Note: 11,204/31518	
1 - UPGRADE LAMINATE COUNTERTOP - LEVEL 1 GRANITE - - MASTER ENSUITE 24Aug16 Note: 11,204/31516	
1 - UPGRADE GRANITE COUNTERTOP - FROM LEVEL 1 TO CAESARSTONE LEVEL 2 - - KITCHEN 24Aug16 Note: 11,204/31515	

Hardwood

1 - OAK - 3/4" X 4 1/8" ENGINEERED - UPGRADE FROM 3/4" X 3 1/8" OAK NATURAL - - UPPER HALL (UPGRADE FROM 3/4"x3 1/4" NATURAL HARDWOOD)) 24Aug16 Note: 11,204/31539	
1 - OAK - 3/4" X 4 1/8" ENGINEERED - UPGRADE FROM 3/4" X 3 1/8" OAK NATURAL - - MASTER (UPGRADE FROM 3/4"x3 1/4" NATURAL HARDWOOD)) 24Aug16 Note: 11,204/31538	
1 - OAK - 3/4" X 4 1/8" ENGINEERED - UPGRADE FROM 3/4" X 3 1/8" OAK NATURAL - - LIVING ROOM (UPGRADE FROM 3/4"x3 1/4" NATURAL HARDWOOD)) 24Aug16 Note: 11,204/31537	
1 - OAK - 3/4" X 4 1/8" ENGINEERED - UPGRADE FROM 3/4" X 3 1/8" OAK NATURAL - - FAMILY ROOM (UPGRADE FROM 3/4"x3 1/4" NATURAL HARDWOOD)) 24Aug16 Note: 11,204/31536	
1 - OAK - 3/4" X 4 1/8" ENGINEERED - UPGRADE FROM 3/4" X 3 1/8" OAK NATURAL - - DINING ROOM (UPGRADE FROM 3/4"x3 1/4" NATURAL HARDWOOD)) 24Aug16 Note: 11,204/31535	
1 - OAK - 3/4" X 4 1/8" ENGINEERED - UPGRADE FROM 3/4" X 3 1/8" OAK NATURAL - - DEN / OFFICE (UPGRADE FROM 3/4"x3 1/4" NATURAL HARDWOOD)) 24Aug16 Note: 11,204/31534	

TRIM DOORS AND HARDWARE - INTERIOR

1 - DEN - ADD FRENCH DOOR TO DEN 24Aug16 Note: 11,204/32177	
---	--

WINDOWS AND DOORS - EXTERIOR

5 - WINDOW - BASEMENT -ENLARGE STANDARD TO 36 INCH (W) X 24 INCH (H) - EACH ADDITIONAL 06May16 Note: 11,176/30964	
1 - WINDOW - BASEMENT - 36 INCH (W) X 24 INCH (H) - EACH ADDITIONAL (AT REAR, SEE PLAN FOR LOCATION) 06May16 Note: 11,176/30963	



CONSTRUCTION SUMMARY

Riverwalk II - 2073737 Ontario Inc.

TEL: RES.: 905-880-7426

PURCHASER: KUSHWAHA, ARCHANA SINGH

LOT / PHASE	REG. PLAN #	HOUSE TYPE	CLOSING DATE
10 / 2	Draft Plan 21T-9005B	Hillcrest Elev B	30-Mar-17

This Document is Extremely Time Sensitive - Printed 24 Aug 16 at 14:47