

HIGHCASTLE HOMES - COLOUR SCHEDULE

Purchasers: ANTONIO STALTERI & CECILIA SILVANA ALVAREZ STAL **Property:** Block 37Phase: 2 of Plan - Draft Plan.21T-9005B
Telephone Res. / Bus: (416) 729-5293 / **Project:** 2073737 Ontario Inc.
Decor Advisor: Caroline Rajcsanyi **Model and Elevation:** Milgrove Elev C

KITCHEN AND VANITIES

[illegible]

Fridge Opening - if not specified will be set to builders minimum opening of approximately 33 x 71 height (townhouses)
- if not specified will be set to builders minimum opening of approximately 36 x 71 height (singles)

Counter top Edge

Opt. Kitchen Extras

***DIFFERENT COLOUR CABINETS ON ISLAND ***Lv4 - BOSTON - SOAPSTONE

PARQUET / HARDWOOD OR BROADLOOM

Kitchen / Breakfast	N/A	Master Bedroom	N/A
Great Room	N/A	Bedroom 2	N/A
Living / Formal Room	N/A	Bedroom 3	N/A
Dining Room	N/A	Bedroom 4	N/A
Family Room	N/A		
Main Hall	N/A		
Main Stairs	Oak		
Upper Hall	N/A		
Com. Centre/Home Office	N/A	Basement	N/A
Main Stair Landing	N/A	Basement Landing	N/A
Library/Den/Study	N/A	Basement Stairs	Paint Grade (Grey)
In Law Suite	N/A		

Carpet-Runner ☐ Yes ☒ No

Underpad Main Floor	Underpad 2nd Floor	Underpad Main Stairs
NA	NA	NA

Opt. Flooring Extras

FLOOR AND WALL TILES

FLOOR AND WALL TILES		Floor Tile	Wall Tile	Decor	Listello
Front Foyer	*6-24x24, Calacatta Vintage (HON), White				
Main Hall	MUDROOM - *4 - 12 x 24 Regal Dark Grey Matte				
Kitchen/Breakfast	*6-24x24, Calacatta Vintage (HON), White		Kitchen Backsplash	N/A	<input type="checkbox"/> <input type="checkbox"/>
Powder Room	5-12x24, Unicouir, Polished, Dark Grey		Powdr Wall if Applicable	N/A	<input type="checkbox"/> <input type="checkbox"/>
Laundry	4-12x24, Niagara Falls, White				

	Floor	Tub Wall	Shower Wall	Deck Skirt	Deck Splash		
Main Bathroom	N/A	N/A	N/A	N/A	NA		
Master Ens	12x24CarraraXWhtPol	N/A	12x24CarraraXWhtPol	N/A	NA		
Ensuite 2	12x24Unidr,PolDkGR	1-8x10, Weave, White	N/A	N/A	NA		
Ensuite 3/4	12x24Unidr,PolDkGR	1-8x10, Weave, White	N/A	N/A	NA		

Shower - Upgrade Floor

Master Ens	2 x 2 Quebec (FOL-Shower Floor with Feldspar-Black)	
------------	---	--

Opt. Tile Extras

POWDER ROOM, MUDROOM, 2ND FLR LAUNDRY TILES TO BE LAID VERTICAL WHEN ENTERING MUDROOM TILES 1ST FLOOR - 12x24, REGAL DARK GREY MATT
NOTE: MASTER ENSUITE FLOOR AND SHWR WALL - (HORIZONTAL WHEN ENTERING + SHWR, ENS2&3/4 FLOOR: 12X24 UNICOLOUR POL DARK GREY

HIGHCASTLE HOMES - COLOUR SCHEDULE

Purchasers: ANTONIO STALTERI & CECILIA SILVANA ALVAREZ STAL Property: Block 37Phase: 2 of Plan - Draft Plan 21T-9005B
Telephone Res. / Bus: (416) 729-5293 / Project: 2073737 Ontario Inc.
Decor Advisor: Caroline Rajcsanyi Model and Elevation: Milgrove Elev C

PLUMBING / FAUCETS

Powder Room	Standard	Laundry	Standard
Main Bath	N/A	Ensuite 3/4	Standard
Master Ensuite	Standard		
2nd Ensuite	Standard		
R.I. Bath	*3 Piece		
Kitchen Sink	*Undermount		
Kitchen Faucet	Standard (1 hole with plate)		
Drain for 2nd floor Laundry	<input checked="" type="radio"/> Yes <input type="radio"/> No		
Waterline for fridge	<input checked="" type="radio"/> Yes <input type="radio"/> No		
Supply and install all toilet paper holders, towel bars and soap dishes	<input type="radio"/> Yes <input checked="" type="radio"/> No		
Whirlpool			

Opt. Plumbing Extras

KITCHEN SINK IS SQUARE DOUBLE BOWL***, ISLAND - SQUARE UNDERMOUNT SINK ***

PAINTING

Wall Colour	Trim Colour	Railing Colour	Pickets Colour	Stair Colour
22 Warm Grey	Standard	*Stained as Floor	*Wrought Iron	*Stained as Floor
Opt. Paint Extras				

***PURCHASER TO SUPPLY HARDWOOD SAMPLE, FOR MATCH (AS CLOSE AS POSSIBLE)

MISCELLANEOUS

Railing Style	RAILING - UPGRADE 1 - 1/2in Wrought iron BLACK square picket with square collar on alternating picket, 3in oak handrail and 3 1/2in oak std. post.				
Opt. Garage Door	*Yes-Grade Permitting	Opt. Side Door	No	Stair Type	Oak
Interior Doors	4 Panel Shaker	Int. Door Hardware	*Straight Pewter Lever	Ext. Door Hardware	*Pewter Exterior package
		Trim Style	STEP-7 1/4" Base w/ 3 1/2" casing 1st and 2nd floor		Cold Cellar <input checked="" type="checkbox"/>
Smooth Ceiling 1st Floor	<input checked="" type="radio"/> Yes <input type="radio"/> No		Basement Windows Upgrade	<input type="radio"/> Yes <input checked="" type="radio"/> No	
Smooth Ceiling 2nd Floor	<input checked="" type="radio"/> Yes <input type="radio"/> No				
Supply and Install Standard Mirrors	<input checked="" type="radio"/> Yes <input type="radio"/> No				

Misc.

****NOTE - PURCHASER TO SUPPLY AND INSTALL AFTER CLOSING - HW 1/2" X 5" ENGINEERED HARDWOOD ****
****MAIN FLR INTERIOR DOORS 8FT (4 PANEL SHAKER) AND 2ND FLR 7FT (4 PANEL SHAKER)

HEATING

Fireplace	Type	Mantle	Surround	Hearth
Family Room	36" Standard	Standard - Paint Grade	N/A	N/A
Air Conditioning	<input type="radio"/> *Yes <input checked="" type="radio"/> No			
Hood Fan Duct	<input type="radio"/> 6 inch <input type="radio"/> 8 inch <input checked="" type="radio"/> 10 inch			
Gas Provisions for Dryer	<input type="radio"/> Yes <input checked="" type="radio"/> No		Gas Provisions for BBQ	<input checked="" type="radio"/> Yes <input type="radio"/> No
Gas Provisions for Stove	<input checked="" type="radio"/> Yes <input type="radio"/> No		Humidifier	<input type="radio"/> Yes <input checked="" type="radio"/> No

Exterior Colour Scheme:

Pre-selected By Vendor

NOTE: The Purchaser(s) agree(s) that:

- Colours of materials are as close as possible to Vendor's selections, but not necessarily identical due to variances in manufacturing or manufacturers.
- Purchaser(s) has checked and acknowledges accuracy of the above selections. Where omissions occur on the original colour selection sheet Purchaser(s) acknowledge that the Builder's selection will be final.
- Upgrades or extras listed on this schedule will not be deemed part of the Agreement of Purchase and Sale. Any such upgrades or extras shall be null and void unless accompanied by a separate invoice and amendment. Said invoice must be paid in full.
- The Purchaser(s) further agrees that in the event that the Vendor has preselected colours prior to the purchase of the house, the prescribed colours are final not withstanding that the Purchaser may have completed a colour selection schedule
- The Purchaser(s) Acknowledges that once this colour schedule is signed and dated, no changes, additions or deletions will be permitted other than re-selection due to unavailability.

A \$350.00 (Per Occurance) change/administration fee will apply to above exceptions.

This Interior Colour Selection is final and approved by:

Signature:  Date: Oct 5/16

Printed 10/4/2016 09:36:37

Signature:  Date: Oct 5/16

Builder's Agent:  Date: Oct 3/16



Highcastle Homes Décor Centre Disclaimers

Lot#: Block 37 Model:Milgrove Elev C in Riverwalk II - 2073737 Ontario Inc.

PURCHASERS: ANTONIO STALTERI and CECILIA SILVANA ALVAREZ STALTERI

TEL: RES.: 416-729-5293

Through years of doing business, we at Highcastle Homes have encountered issues beyond our control. The following disclaimers apply to all instances of Purchaser's Extras forms and all Interior Colour Scheme forms.

Fireplaces

Fireplace Marble: Due to the many variables that can affect the pattern and/or design, frequently the marble installed on the fireplace will not be identical to the samples. We will make every attempt to come as close to the samples as possible, but cannot be responsible for results which differ from the samples.

Ceramic Floor Tile

Many variables including variegation can affect tile colour, pattern and/or design which mean installed tiles may not be identical to the samples. We will make every attempt to come as close as possible, but cannot be responsible for results which differ from the samples.

Hardwood Flooring

The purchaser is advised that cupping and shrinkage are characteristics of hardwood flooring normal appearing some time after installation, and no warranty is provided by the flooring supplier with respect to such cupping and shrinkage. The vendor agrees to install any hardwood flooring ordered by the purchaser in good and workmanlike manner, but shall not be responsible for, and is hereby released by the purchaser from responsibility and liability for cupping and shrinkage of hardwood flooring.

Shrinking and expanding/cupping of the hardwood floors may occur if the humidity levels in the home are not kept at industry recommendations. If the hardwood floors shrink or expand due to the homeowner not complying with these levels, the hardwood floor will no longer be under warranty and it will be the homeowner's responsibility to repair the flooring.

Stain Colours

Due to many variables that can affect the outcome of a stain colour on wood, staircases, railings, and fireplaces, will not be identical to samples. Factors such as density, age humidity, air temperature, and the uniqueness of each piece of wood can result in wide variations in darkness or lightness. We will make every attempt to come as close to the sample as possible, but cannot be responsible for results which differ from the samples.

Stain on pre-finished hardwood floors will not be an exact match to the stain colours available on stairs, pickets and rails. The purchaser is responsible for choosing the stain on these areas to their satisfaction.

Appliances

All fridge openings are set to builder's standard width. Please advise Décor Centre at time of colour appointment if custom sizing of cabinets is required for any built - in appliances. The purchaser is responsible for costs and fees associated with changes to pre-manufactured kitchens made subsequent to colour appointments.

Kitchen Cabinets

The kitchen you order/purchase will undoubtedly contain slight colour variations. The degree of these variations is virtually impossible to determine before the kitchen is installed in its intended location. The amount of and type of lighting will also affect various highlights in the finish. Note: No two pieces of wood are identical. Variations in colour tone and grain patterns make a perfect colour match virtually impossible. It is generally agreed that these variations add to the natural beauty of a wood kitchen.

Shrinking and expanding of the kitchen cabinets may occur if the humidity levels in the home are not kept at industry recommendations. If the cabinets shrink or expand due to the homeowner not complying with these levels, the cabinets will no longer be under warranty and it will be the homeowner's responsibility to repair the cabinets.

Plaster Mouldings and Medallions

Plaster mouldings will not be installed in open to above areas or areas with 2 storey elements.

Metal Spindles

Due to the characteristics of wrought iron railing production, it is possible for the wrought iron to develop a scale effect. This scale may or may not be totally covered during the painting process. In effect, once the wrought iron picket is painted, the paint may in effect amplify the iron scale depending on the colour chosen. This is a natural effect of wrought iron and should not be construed as a defect or damage.

I hereby acknowledge reading and understanding the above copy and will not hold Highcastle Homes responsible for any issues in relation to above.

Purchasers Signature(s):

Date:

Oct 6/16

BLK 37
Riverwalk II

MOSCONE
MARBLE

STANDARD EDGE

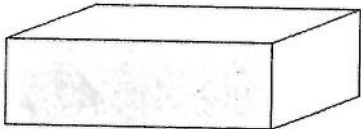

Single Straight polished 3/4"



Single Bullnose 3/4"

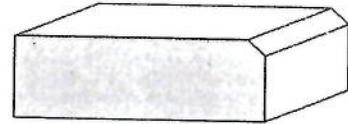

Single Bevel 1/4" top bevel 3/4" thick

UPGRADE #1 EDGES

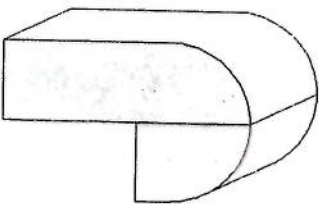

Double Bullnose 1.5" thick

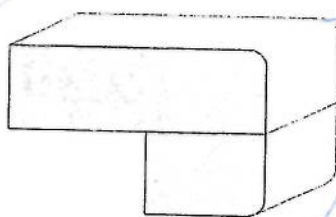

Double Pencil 1.5" thick

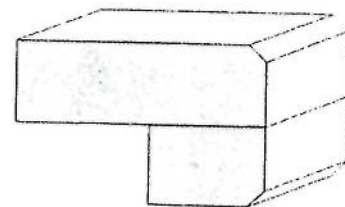

Double Bevel 1/4" top&bottom 1.5" thick

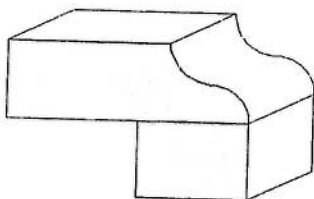

UPGRADE #2 EDGES

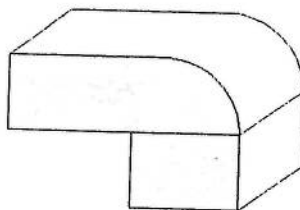

Double Ogee 1.5" thick



Double Quarter Moon 1.5" thick

Sign 
Sign 

Date Aug 3 / 2016
Date Aug 3 / 2016



FRENDEL
KITCHENS LIMITED
1560 Sherman Drive, Mississauga, ON L4W 1C5

For info, call 905.278.7878
Fax: 905.603.1986
www.frendel.com

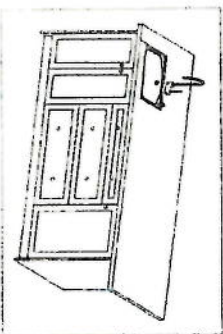
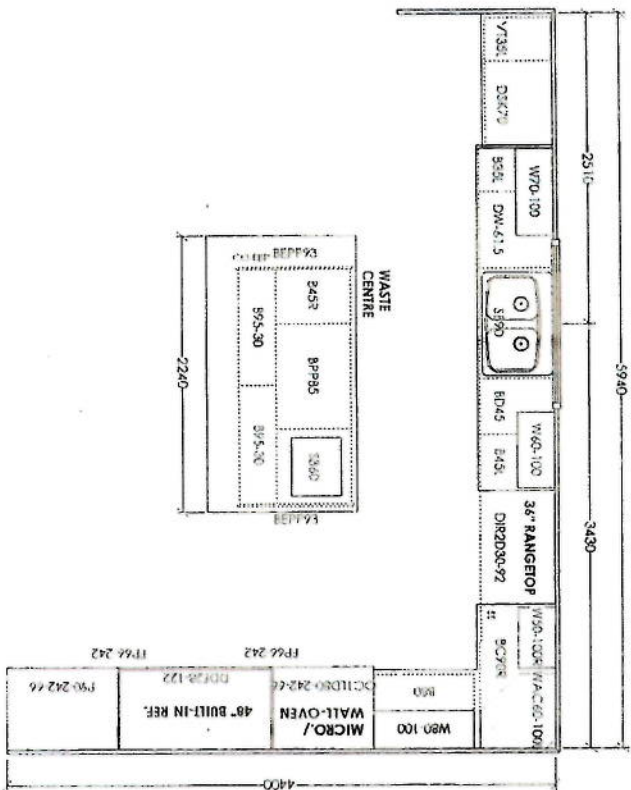

11/4/2016

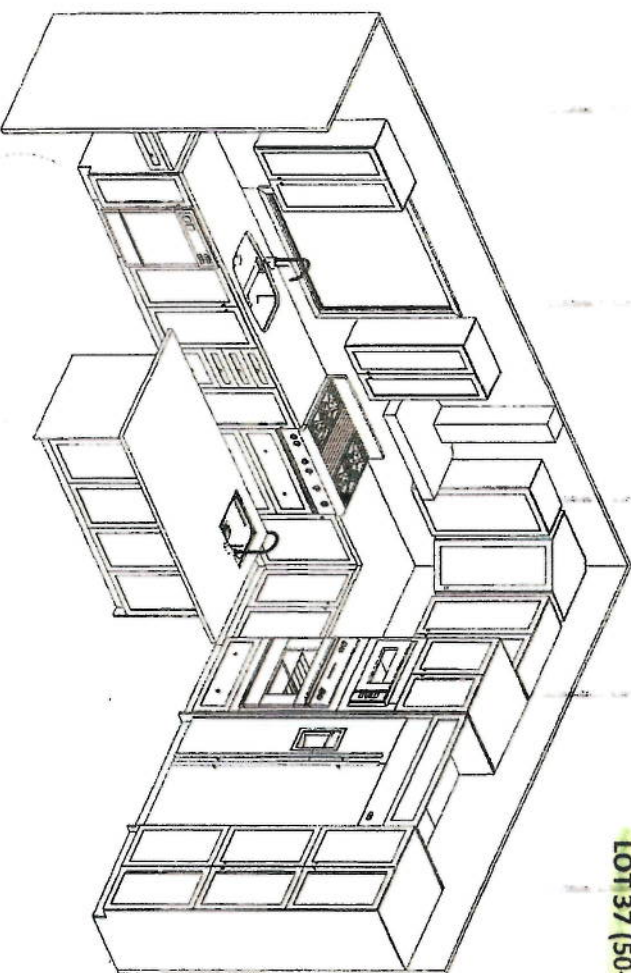

HIGHCASTLE HOMES
RIVERWALK II
LOT 37 (50-2)

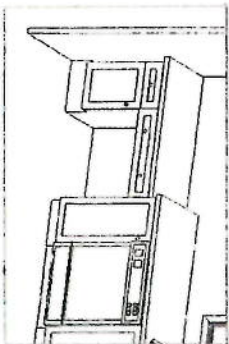

VALANCE ON UPPER
LAMINATE TOP. GRANITE TOPS

THIS DRAWING IS FOR DESIGN PURPOSES ONLY.
IT IS NOT AN EXACT REPRESENTATION.

NOV 7/16
NOV. 7/16

Bk 37

- Riverwalk II
- Beil
- Cable
- Footlight
- Pendants
- CAT5

△ + R + CAT5 over flp for future wall mount tv.

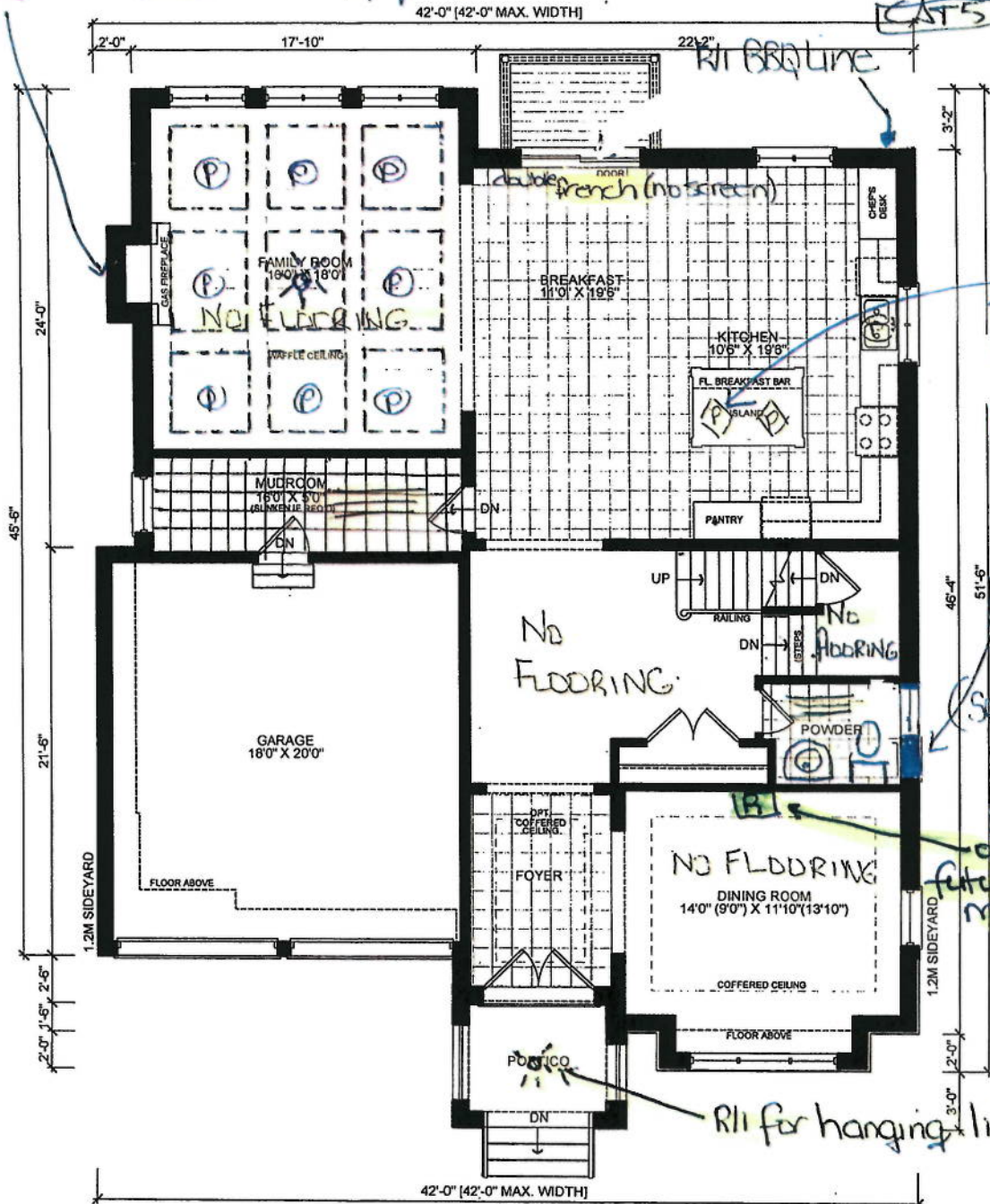

* NOTE *
ISLAND
TURNED.
(See Kitchen
layout)

Powder Room
Changed.
(See attached
plan)

R on wall for
future wall
mount tv

R for hanging light

GROUND FLOOR ELEV. 'C'	
FLOOR AREA:	1509 S.F.
DEDUCT O.T.B.:	0 S.F.
TOTAL:	1509 S.F.
COVERAGE:	1956 S.F.

Sign [Signature]
Sign [Signature]

Date OCT. 5/16
Date OCT 5/16

Revisions	Initials	Date
1. ISSUED FOR REVIEW	PM: [Signature]	

client	Highcastle Homes
project	Riverwalk Phase 2
model	Brompton
project #	50-2
scale	1/8" = 1'0"
page	B2

PN design
Imagine • Inspire • Create

 CATS
 - Light R/I
 - Patlight

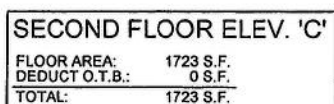

Sign
Sign

Date OCT 5/16

PN design
Imagine • Inspire • Create

Highcastle Homes

Riverwalk Phase 2

50-2

scale
1/8" = 1'0"

page

B3

Lot 37
PH - 2.

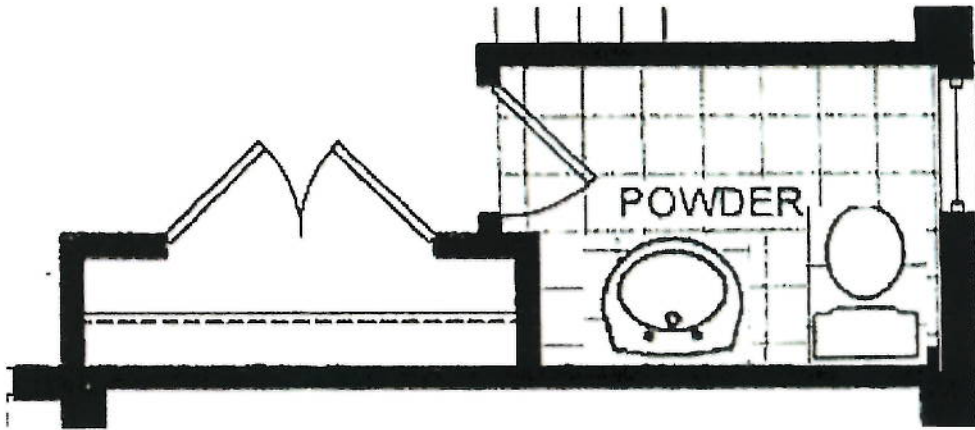

[Handwritten signature]

AUGUST 3, 2016



14021

pend

 $1/8" = 1'-0"$

HIGHCASTLE
HOMES

RIVERWALK
PHASE 2
BRAMPTON

15.3M X 27.5M

50-2
MILGROV

C=3230 S.F.

1 OF 3



BASEMENT FLOOR ELEV. 'C'

Sign
"Sign"



Date OCT 5/16

Date OCT 5/16



PLS DELETE.
PREV CONDS SUMMARY
Nov 11 16

CONSTRUCTION SUMMARY

Riverwalk II - 2073737 Ontario Inc.

PURCHASERS: ANTONIO STALTERI and CECILIA SILVANA ALVAREZ STALTERI

TEL: RES.: 416-729-5293

LOT / PHASE	REG. PLAN #	HOUSE TYPE	CLOSING DATE
Block 37 / 2	Draft Plan 21T-9005B	Milgrove Elev C	24-Nov-16

Agreement of Purchase and Sale

INCLUDES LOOKOUT DECK CONDITION <i>Worksheet</i> <i>Note:</i>	
Upgrade existing floor tiles on main floor Foyer, Powder room, Kitchen & Breakfast area to Level 4 (as per plan). <i>Worksheet</i> <i>Note:</i>	
Do not install tiles (or any other flooring) on main floor hallway (as shown on schedule FP). <i>Worksheet</i> <i>Note:</i>	
Upgrade existing floor tiles on all second floor bathrooms & laundry room to Level 2 (as per plan). <i>Worksheet</i> <i>Note:</i>	
Upgrade trim on main and second floors to 7 1/4 inch Baseboards & 3 inch Casings. <i>Worksheet</i> <i>Note:</i>	
Kitchen undermount sink (square double bowl). <i>Worksheet</i> <i>Note:</i>	
Kitchen under upper cabinet valance with lighting. <i>Worksheet</i> <i>Note:</i>	
Kitchen, upgrade cabinetry to Level 4. <i>Worksheet</i> <i>Note:</i>	
Kitchen, Rough-In waterline for fridge. <i>Worksheet</i> <i>Note:</i>	
Kitchen, flush Breakfast bar (3ft wide on centre island between kitchen & breakfast area) as shown on Schedule FP. <i>Worksheet</i> <i>Note:</i>	
Kitchen, 1 led 4 inch pot light kitchen over sink with separate switch (builders standard line). <i>Worksheet</i> <i>Note:</i>	
Kitchen, 2 capped rough-in light fixtures over kitchen island on separate switch. <i>Worksheet</i> <i>Note:</i>	
Kitchen, Rough-in gas line to stove including receptacle. <i>Worksheet</i> <i>Note:</i>	
Do not install hardwood or any other flooring on main floor Living/Dining room, Family room & den. <i>Worksheet</i> <i>Note:</i>	
Builder to stain existing oak stairs (buyer to supply colour sample and Builder to match as close as possible). <i>Worksheet</i> <i>Note:</i>	
Flat ceilings on main and second floor. <i>Worksheet</i> <i>Note:</i>	
Family Room, Waffle ceiling (as per plan). <i>Worksheet</i> <i>Note:</i>	
Family Room, 8 led 4 inch pot lights (builders standard line). <i>Worksheet</i> <i>Note:</i>	
Family Room, 1 capped rough-in light fixture in centre square on separate switch. <i>Worksheet</i> <i>Note:</i>	
Family Room, Receptacle & rough in for cable & internet above fireplace. <i>Worksheet</i> <i>Note:</i>	
Upgrade all existing doors on main & second floors to 4 panel shaker doors 7 foot high including den. <i>Worksheet</i> <i>Note:</i>	



CONSTRUCTION SUMMARY

Riverwalk II - 2073737 Ontario Inc.

PURCHASERS: ANTONIO STALTERI and CECILIA SILVANA ALVAREZ STALTERI

TEL: RES.: 416-729-5293

LOT / PHASE	REG. PLAN #	HOUSE TYPE	CLOSING DATE
Block 37 / 2	Draft Plan 21T-9005B	Milgrove Elev C	24-Nov-16

Main floor front entrance closet doors opening to be reversed. Worksheet Note:	
Master bedroom ensuite, freestanding tub in lieu of standard tub (builders standard samples). Worksheet Note:	
Master bedroom ensuite, framless glass shower enclosure (excluding enclosed toilet wall) as per plan. Worksheet Note:	
Optional side door entrance (where grade permits) as per plan. Worksheet Note:	
Laundry room to have floor drain - does not include sloped floor or liner. Worksheet Note:	
Do not install ceramic accessories in all bathrooms. Worksheet Note:	
BUILDER TO INCLUDE all the above mentioned items at a group discounted price. Worksheet Note:	
Do not install any flooring on the second floor excluding all tiled areas. Worksheet Note:	
Builder to modify floor plan (basement, main & second) & elevations as attached hereto. 3 pages Worksheet Note:	
Builder to upgrade all existing main floor interior doors (4 panel shaker) to 8 foot hieght. Worksheet Note:	
Upgrade all existing main floor interior doors (4 panel shaker) to 8 ft height with 8 ft arches & (4 panel shaker)7ft on 2nd flr	
Do not install tiles (or any other flooring) on main floor hallway (as shown on schedule FP). Worksheet Note:	
Upgrade existing floor tiles on main floor Foyer, Powder room, Kitchen & Breakfast area to Level 4 (as per plan). Worksheet Note:	
Do not install tiles (or any other flooring) on main floor hallway (as shown on schedule FP). Worksheet Note:	
Upgrade existing floor tiles on all second floor bathrooms & laundry room to Level 2 (as per plan). Worksheet Note:	
Upgrade trim on main and second floors to 7 1/4 inch Baseboards & 3 inch Casings. Worksheet Note:	
Kitchen undermount sink (square double bowl). Worksheet Note:	
Kitchen under upper cabinet valance with lighting. Worksheet Note:	
Kitchen, upgrade cabinetry to Level 4. Worksheet Note:	
Kitchen, Rough-In waterline for fridge. Worksheet Note:	
Kitchen, flush Breakfast bar (3ft wide on centre island between kitchen & breakfast area) as shown on Schedule FP. Worksheet Note:	
Kitchen, 1 led 4 inch pot light kitchen over sink with separate switch (builders standard line). Worksheet Note:	



CONSTRUCTION SUMMARY

Riverwalk II - 2073737 Ontario Inc.

PURCHASERS: ANTONIO STALTERI and CECILIA SILVANA ALVAREZ STALTERI

TEL: RES.: 416-729-5293

LOT / PHASE	REG. PLAN #	HOUSE TYPE	CLOSING DATE
Block 37 / 2	Draft Plan 21T-9005B	Milgrove Elev C	24-Nov-16

Kitchen, 2 capped rough-in light fixtures over kitchen island on separate switch. <i>Worksheet</i> Note:	
Kitchen, Rough-in gas line to stove including receptacle. <i>Worksheet</i> Note:	
Do not install hardwood or any other flooring on main floor Living/Dining room, Family room & den. <i>Worksheet</i> Note:	
Builder to stain existing oak stairs (buyer to supply colour sample and Builder to match as close as possible). <i>Worksheet</i> Note:	
Flat ceilings on main and second floor. <i>Worksheet</i> Note:	
Family Room, Waffle ceiling (as per plan). <i>Worksheet</i> Note:	
Family Room, 8 led 4 inch pot lights (builders standard line). <i>Worksheet</i> Note:	
Family Room, 1 capped rough-in light fixture in centre square on separate switch. <i>Worksheet</i> Note:	
Family Room, Receptacle & rough in for cable & internet above fireplace. <i>Worksheet</i> Note:	
Upgrade all existing doors on main & second floors to 4 panel shaker doors 7 foot high including den. <i>Worksheet</i> Note:	
Main floor front entrance closet doors opening to be reversed. <i>Worksheet</i> Note:	
Master bedroom ensuite, freestanding tub in lieu of standard tub (builders standard samples). <i>Worksheet</i> Note:	
Master bedroom ensuite, framless glass shower enclosure (excluding enclosed toilet wall) as per plan. <i>Worksheet</i> Note:	
Optional side door entrance (where grade permits) as per plan. <i>Worksheet</i> Note:	
Laundry room to have floor drain - does not include sloped floor or liner. <i>Worksheet</i> Note:	
Upgrade existing floor tiles on main floor Foyer, Powder room, Kitchen & Breakfast area to Level 4 (as per plan). <i>Worksheet</i> Note:	
Upgrade existing floor tiles on all second floor bathrooms & laundry room to Level 2 (as per plan). <i>Worksheet</i> Note:	
Upgrade trim on main and second floors to 7 1/4 inch Baseboards & 3 inch Casings. <i>Worksheet</i> Note:	
Kitchen undermount sink (square double bowl). <i>Worksheet</i> Note:	
Kitchen under upper cabinet valance with lighting. <i>Worksheet</i> Note:	
Kitchen, upgrade cabinetry to Level 4. <i>Worksheet</i> Note:	
Kitchen, Rough-In waterline for fridge. <i>Worksheet</i> Note:	



CONSTRUCTION SUMMARY

Riverwalk II - 2073737 Ontario Inc.

PURCHASERS: ANTONIO STALTERI and CECILIA SILVANA ALVAREZ STALTERI

TEL: RES.: 416-729-5293

LOT / PHASE	REG. PLAN #	HOUSE TYPE		CLOSING DATE
Block 37 / 2	Draft Plan 21T-9005B	Milgrove Elev C		24-Nov-16

Kitchen, flush Breakfast bar (3ft wide on centre island between kitchen & breakfast area) as shown on Schedule FP. <i>Worksheet</i> <i>Note:</i>	
Kitchen, 1 led 4 inch pot light kitchen over sink with separate switch (builders standard line). <i>Worksheet</i> <i>Note:</i>	
Kitchen, 2 capped rough-in light fixtures over kitchen island on separate switch. <i>Worksheet</i> <i>Note:</i>	
Kitchen, Rough-in gas line to stove including receptacle. <i>Worksheet</i> <i>Note:</i>	
Do not install hardwood or any other flooring on main floor Living/Dining room, Family room & den. <i>Worksheet</i> <i>Note:</i>	
Builder to stain existing oak stairs (buyer to supply colour sample and Builder to match as close as possible). <i>Worksheet</i> <i>Note:</i>	
Flat ceilings on main and second floor. <i>Worksheet</i> <i>Note:</i>	
Family Room, Waffle ceiling (as per plan). <i>Worksheet</i> <i>Note:</i>	
Family Room, 8 led 4 inch pot lights (builders standard line). <i>Worksheet</i> <i>Note:</i>	
Family Room, 1 capped rough-in light fixture in centre square on separate switch. <i>Worksheet</i> <i>Note:</i>	
Family Room, Receptacle & rough in for cable & internet above fireplace. <i>Worksheet</i> <i>Note:</i>	
Upgrade all existing doors on main & second floors to 4 panel shaker doors 7 foot high including den. <i>Worksheet</i> <i>Note:</i>	
Main floor front entrance closet doors opening to be reversed. <i>Worksheet</i> <i>Note:</i>	
Master bedroom ensuite, freestanding tub in lieu of standard tub (builders standard samples). <i>Worksheet</i> <i>Note:</i>	
Master bedroom ensuite, framless glass shower enclosure (excluding enclosed toilet wall) as per plan. <i>Worksheet</i> <i>Note:</i>	
Optional side door entrance (where grade permits) as per plan. <i>Worksheet</i> <i>Note:</i>	
Laundry room to have floor drain - does not include sloped floor or liner. <i>Worksheet</i> <i>Note:</i>	



CONSTRUCTION SUMMARY

Riverwalk II - 2073737 Ontario Inc.

PURCHASERS: ANTONIO STALTERI and CECILIA SILVANA ALVAREZ STALTERI

TEL: RES.: 416-729-5293

LOT / PHASE	REG. PLAN #	HOUSE TYPE	CLOSING DATE
Block 37 / 2	Draft Plan 21T-9005B	Milgrove Elev C	24-Nov-16

1) CONSTRUCTION

1 - MASTER ENSUITE SHOWER CADDY - 12" X 16" IN MARBLE (SEE PLAN FOR LOCATION, 3/4 WAYS UP THE WALL NEAREST TO THE GLASS FRONT) 04Oct16 Note: 11,138/31874	
1 - KITCHEN - BULKHEAD TO BE BUILT IN KITCHEN (NO CROWN MOULDING) (FLUSH WITH CABINETS) 04Oct16 Note: 11,138/31786	
1 - CHANGE LAYOUT OF TOILET, SINK AND WINDOW IN POWDER ROOM (SEE ATTACHED DRAWING) 04Oct16 Note: 11,138/31783	
1 - UPGRADE 2 X 10 CONVENTIONAL JOISTS TO 9 1/2" ENGINEERED I - JOISTS 17Dec15 Note: 11,131/30253	
1 - CHANGE LOOK OUT CONDITION TO A "WALK OUT" CONDITION 17Dec15 Note: 11,131/30252	

3) HEATING / AIR CONDITIONING

1 - BUILDER DISCOUNT 04Oct16 Note: 11,138/32516	
1 - UPGRADE STOVE EXHAUST DUCT TO 10" EXHAUST 04Oct16 Note: 11,138/32197	
1 - GAS LINE - ROUGH-IN BASEMENT FOR BBQ (SEE PLAN), ALSO R/I BBQ ON AGREEMENT OUTSIDE OF BREAKFAST AREA (SEE PLAN) 04Oct16 Note: 11,138/31673	
1 - KITCHEN - CENTRE DUCT (IF POSSIBLE) FOR PURCHASERS FUTURE CHIMNEY HOOD FAN 04Oct16 Note: 11,138/31655	

4) PLUMBING

1 - ADD UNDERMOUNT SQUARE BAR SINK IN ISLAND WITH STANDARD (*1 HOLE) CAMERIST WITH PLATE 04Oct16 Note: 11,138/32332	
1 - KITCHEN FAUCET TO BE 1 HOLE CAMERIST WITH PLATE (STANDARD FAUCET WITH 1 HOLE WITH PLATE) 04Oct16 Note: 11,138/31793	

5) ELECTRICAL

2 - PLUG - INTERIOR RECEPTICAL (MASTER BEDROOM ON WALL AT 5 1/2FT FOR FUTURE WALL MOUNT TV AND IN DINING ROOM ON WALL AT 5 1/2FT FOR FUTURE WALL MOUNT TV 11Nov16 Note: 11,253/32760	
1 - DELETE FRONT COACH LIGHT AND ADD CEILING R/I FOR FUTURE HANGING LIGHT (CENTERED IN PORTICO, SEE PLAN) 04Oct16 Note: 11,138/32196	
1 - POT LIGHT - WATERPROOF SHOWER POTLIGHT WITH LED ENERGY STAR BULB (MASTER ENSUITE) 04Oct16 Note: 11,138/31671	
1 - LIGHT - ROUGH-IN ONLY - ON SEPARATE SINGLE SWITCH - OVER TUB IN MASTER ENSUITE 04Oct16 Note: 11,138/31670	

* NOTE *

6) FLOORING & WALL TILE

1 - CERAMIC - UPGRADE LEVEL 5 FROM LEVEL 2- - ENSUITE 2 - TILES LAID HORIZONTAL WHEN ENTERING (SEE PLAN) 04Oct16 Note: 11,138/32385	
---	--



CONSTRUCTION SUMMARY

Riverwalk II - 2073737 Ontario Inc.

PURCHASERS: ANTONIO STALTERI and CECILIA SILVANA ALVAREZ STALTERI

TEL: RES.: 416-729-5293

LOT / PHASE	REG. PLAN #	HOUSE TYPE	CLOSING DATE
Block 37 / 2	Draft Plan 21T-9005B	Milgrove Elev C	24-Nov-16

6) FLOORING & WALL TILE

1 - CERAMIC - UPGRADE LEVEL 5 FROM LEVEL 2- - ENSUITE 3/4 - TILES HORIZONTAL TO TUB WALL (SEE PLAN) 04Oct16 Note: 11,138/32384	
1 - COLOURED GROUT - COLOURED GROUT ON MASTER ENSUITE "SHOWER" FLOOR ONLY (GROUT COLOUR: CHARCOAL) (50 MODEL) 04Oct16 Note: 11,138/32382	
1 - CERAMIC - UPGRADE LEVEL 4 FROM LEVEL 2 - LAUNDRY 04Oct16 Note: 11,138/32333	
1 - CERAMIC - UPGRADE LEVEL 4 TO LEVEL 5 FLOOR TILE - - POWDER ROOM 04Oct16 Note: 11,138/32330	
1 - MUDROOM - LEVEL 1 TO LEVEL 4 04Oct16 Note: 11,138/32199	
1 - KITCHEN - DO NOT SUPPLY OR INSTALL BACKSPLASH 04Oct16 Note: 11,138/32198	
1 - LEVEL 5 - WALL TILE FOR SHOWER 04Oct16 Note: 11,138/31880	
1 - CERAMIC - UPGRADE LEVEL 5 FROM LEVEL 2 - MASTER ENSUITE 04Oct16 Note: 11,138/31879	
1 - CERAMIC - UPGRADE LEVEL 6 - - KITCHEN AND BREAKFAST AREA (FROM LEVEL 4) 04Oct16 Note: 11,138/31878	
1 - CERAMIC - UPGRADE LEVEL 6 - - FOYER (FROM LEVEL 4) 04Oct16 Note: 11,138/31877	
1 - SHOWER FLOOR - LEVEL 3 - LEVEL SHOWER FLOOR (MASTER ENSUITE SHOWER FLOOR) 04Oct16 Note: 11,138/31876	
1 - TILES - MINIMAL GROUT LINE (IF POSSIBLE) ON ALL TILES INCLUDING WALL TILES IN BATHROOMS 04Oct16 Note: 11,138/31656	

8) FINISHING

1 - PURCHASER IS SUPPLY AND INSTALLING HARDWOOD AFTER CLOSING. HARDWOOD IS 1/2" X 5" ENGINEERED FLOOR. 04Oct16 Note: 11,138/32383	
---	--

9) CABINetry

1 - KITCHEN CABINETS IN ISLAND HAVE BEEN REVERSED (B 60 ON THE OUTSIDE (2 DOORS) AND (B 25 ON THE INSIDE 1 DOOR) SEE KITCHEN LAYOUT 04Oct16 Note: 11,138/32329	
1 - ROTATE ISLAND AND ENLARGE TO 7FT LENGTH ISLAND (SEE KITCHEN LAYOUT) 04Oct16 Note: 11,138/31785	
1 - ACCESSORIES - UPGRADE 2 HARDWARE IN KITCHEN 04Oct16 Note: 11,138/31657	
1 - ACCESSORIES - BLUMOTION (SOFT CLOSE) FOR DOORS - LEVEL 4- KITCHEN 04Oct16 Note: 11,138/30435	



CONSTRUCTION SUMMARY

Riverwalk II - 2073737 Ontario Inc.

PURCHASERS: ANTONIO STALTERI and CECILIA SILVANA ALVAREZ STALTERI

TEL: RES.: 416-729-5293

LOT / PHASE	REG. PLAN #	HOUSE TYPE	CLOSING DATE
Block 37 / 2	Draft Plan 21T-9005B	Milgrove Elev C	24-Nov-16

9) CABINETRY

12 - ACCESSORIES - CONVERT KITCHEN/VANITY FROM METABOX TO TANDEMBOX DRAWERS WITH BLUMOTION (SOFT CLOSE) PER DRAWER 04Oct16 Note: 11,138/30434	
1 - BASE CABINETS-POTS & PANS DRAWER (MIN. 60CM MAX. 90CM SIZE SUBJECT TO FLOOR PLAN)-LEVEL 4 (IN ISLAND) 04Oct16 Note: 11,138/30433	
1 - UPPER CABINETS-UPPER ANGLE CORNER CABINET PER UNIT-LEVEL 4 04Oct16 Note: 11,138/30432	
1 - ACCESSORIES - DIFFERENT COLOUR ISLAND THAN KITCHEN COLOUR 04Oct16 Note: 11,138/30328	
1 - ACCESSORIES - WASTE CENTER PULL OUT DOOR ONLY AVAILABLE IN 45CM CABINET (2) 35L BINS IN ISLAND (SEE PLAN) 04Oct16 Note: 11,138/30321	
1 - BUILT IN DOUBLE APPLIANCE CABINET *FLUSH INSTALLATION, SEE SPECS* WITH DRAWER BELOW (TRIMKIT REQUIRED)(ELECTRICAL ROUGH IN ONLY) - LEVEL 4 04Oct16 Note: 11,138/30320	
1 - KITCHEN - DELETE UPPER CABINETS OVER STOVE FOR PURCHASERS FUTURE HOOD FAN 04Oct16 Note: 11,138/30319	
1 - RANGETOP CABINET (MODIFIED HEIGHT) WITH DRAWERS BELOW (ELECTRICAL INCLUDED) - LEVEL 4 04Oct16 Note: 11,138/30318	
1 - ACCESSORIES - ACCOMMODATE BUILT IN DESIGNER REFRIDGERATOR 04Oct16 Note: 11,138/30316	

CABINETRY - BATHROOM

1 - VANITY CABINETS-VANITY BANK OF DRAWERS (55CM MAX)-LEVEL 1 OR LEVEL 2 (MASTER ENSUITE) 04Oct16 Note: 11,138/30436	
--	--

Countertop

1 - UPGRADE GRANITE COUNTERTOP - FROM LEVEL 1 TO LEVEL 3 - - KITCHEN INCLUDING BREAKFAST BAR 04Oct16 Note: 11,138/32331	
---	--

WINDOWS AND DOORS

1 - REAR KITCHEN WINDOW TO BE THE SAME HEIGHT AS THE FAMILY ROOM REAR WINDOWS 10Feb16 Note: 11,097/29622	
--	--

WINDOWS AND DOORS - EXTERIOR

1 - IN LIEU OF SIDE DOOR (NOT POSSIBLE TO GRADE), ADD DOUBLE FRENCH DOORS (NO SCREEN) TO BREAKFAST AREA (SEE PLAN) 04Oct16 Note: 11,138/31782	
---	--

This Document is Extremely Time Sensitive - Printed 11 Nov 16 at 12:56

FOR THE WAY IT'S MADE.®

Side By Side Built-In Refrigerator

PRODUCT MODEL NUMBERS

KBSD602E KBSD606E KBSD608E KBSN602E KBSN608E
KBSD612E KBSD618E

Electrical: A 115 volt, 60 Hz., AC only, 15- or 20-amp fused, grounded electrical supply is required. It is recommended that a separate circuit serving only your refrigerator be provided. Use an outlet that cannot be turned off by a switch. Do not use an extension cord.

Water Pressure: A cold water supply with water pressure between 30 and 120 psi (207 and 827 kPa) is required to operate the water dispenser and ice maker. If you have questions about your water pressure, call a licensed, qualified plumber.

Reverse Osmosis Water Supply:

IMPORTANT: The pressure of the water supply coming out of a reverse osmosis system going to the water inlet valve of the refrigerator needs to be between 30 and 120 psi (207 and 827 kPa).

IMPORTANT:

- It is recommended that you do not install the refrigerator near an oven, radiator, or other heat source.
- Do not install in a location where the temperature will fall below 55°F (13°C).
- Floor must support the refrigerator weight, more than 600 lbs (272 kg), door panels and contents of the refrigerator.

PRODUCT DIMENSIONS

- The depth from the front of the top grille to the back of the refrigerator cabinet is 5½" (64.5 cm).
- The power cord is 84" (213 cm) long.
- Height dimensions are shown with leveling legs extended ⅛" (3 mm) below the rollers.

SIDE VIEW

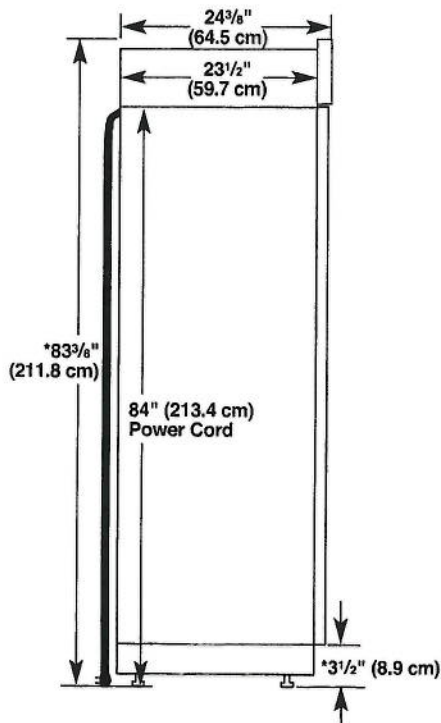

*When leveling legs are fully extended to 1¼" (3.2 cm) below rollers, add 1⅝" (2.9 cm) to the height dimensions.

Because Whirlpool Corporation policy includes a continuous commitment to improve our products, we reserve the right to change materials and specifications without notice.

OPENING DIMENSIONS

To avoid tipping during use, the solid soffit must be within 1" (2.5 cm) maximum above the refrigerator. If the solid soffit is higher than 1" (2.5 cm) or one is not available, then the refrigerator must be braced. If the anti-tip boards are needed, they must be attached to the rear wall studs 80" to 90" (203 cm to 229 cm) above the floor. See "Install Anti-Tip Boards" for more information.

NOTE: A clearance of ½" (1.3 cm) above the top grille must be maintained in order for the top grille to be removed.

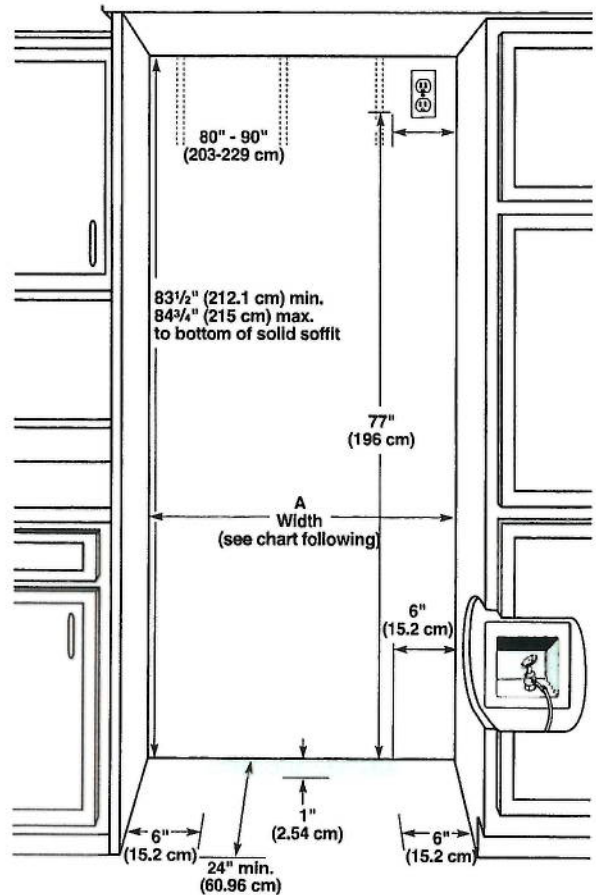

Model	Width A (as shown above)	Dimension B (as shown above)
36	35½" to 35¾" (90.2 cm to 90.8 cm)	4" (10.2 cm)
42	41½" to 41¾" (105.4 cm to 106.1 cm)	7½" (19.1 cm)
48	47½" to 47¾" (120.7 cm to 121.3 cm)	13½" (34.3 cm)

NOTE: Flooring under refrigerator must be at same level as the room. Face of cabinetry must be plumb.

TOP VIEW

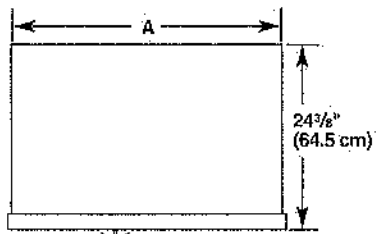

Model	Width A
36	35" (88.9 cm)
42	41" (104.1 cm)
48	47" (119.4 cm)

FRONT VIEW

- Width dimensions were measured from trim edge to trim edge.
- Height dimensions are shown with leveling legs extended 1/8" (3 mm) below the rollers.

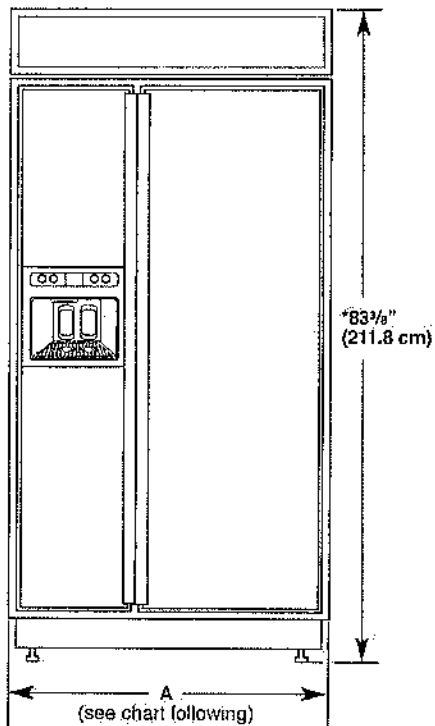

Model	Width A (Trim edge to trim edge)
36	36 1/2" (92.3 cm)
42	42 1/2" (107.5 cm)
48	48 1/2" (122.8 cm)

*When leveling legs are fully extended to 1 1/4" (3.2 cm) below rollers, add 1 1/4" (2.9 cm) to the height dimensions.

DOOR SWING DIMENSIONS

The location must permit both doors to open to a minimum of 90°. Allow 5" (12.7 cm) minimum space between the side of the refrigerator and a corner wall.

NOTE: More clearance may be required if you are using overlay panels, custom handles, or extended handles on a Classic model.

To adjust the door swings, see "Adjust Doors."

36" (91.4 cm) Models

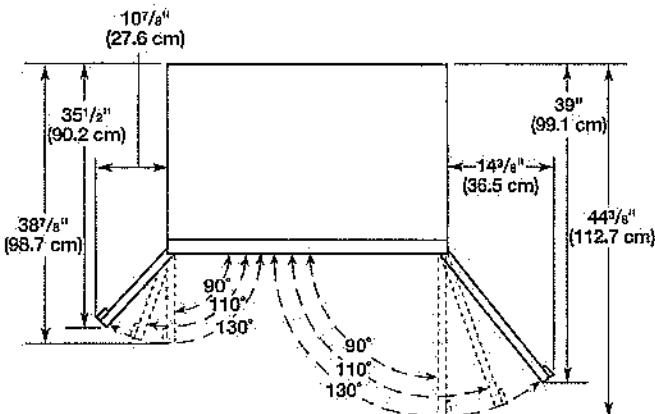

42" (106.7 cm) Models

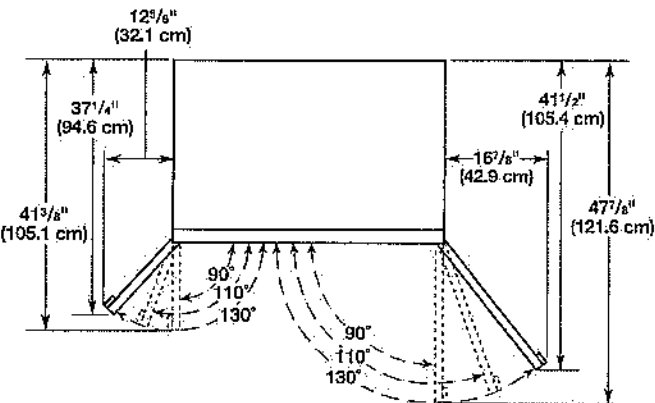

48" (121.9 cm) Models

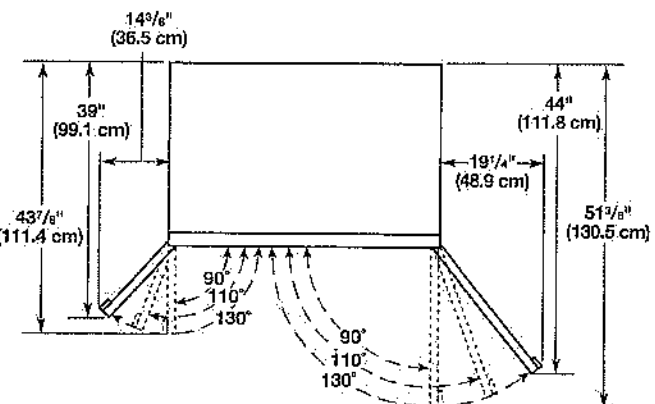

Blk 37.
Riverwalk ii

KitchenAid® Commercial Style Gas Cooktop
FOR THE WAY IT'S MADE.®

PRODUCT MODEL NUMBERS

KGCU407V	KGCU482V
KGCU462V	KGCU483V
KGCU463V	KGCU484V
KGCU467V	

Type of Gas
Natural Gas:

This cooktop is factory-set for use with Natural gas. To convert to LP gas, see the Gas Conversion instructions provided in the package containing literature. The model/serial rating plate located on the left underside of the cooktop burner base has information on the types of gas that can be used. If the types of gas listed do not include the type of gas available, check with the local gas supplier.

LP Gas conversion:
Conversion must be done by a qualified service technician. No attempt shall be made to convert the cooktop from the gas specified on the model/serial rating plate for use with a different gas without consulting the serving gas supplier. To convert to LP gas, use the LP gas conversion kit provided with the cooktop and see the "Gas Conversions" section.

Gas Supply Line

- Provide a gas supply line of 3/4" (1.9 cm) rigid pipe to the cooktop location. A smaller size pipe on longer runs may result in insufficient gas supply. With LP gas, piping or tubing size can be 1/2" (1.3 cm) minimum. Usually, LP gas suppliers determine the size and materials used in the system.

NOTE: Pipe-joint compounds that resist the action of LP gas must be used. Do not use TEFLON® tape.

Flexible metal appliance connector:

- If local codes permit, a new GSA design-certified, 4 - 5 ft (122 - 152.4 cm) long, 5/8" (1.6 cm) or 3/4" (1.9 cm) I.D., flexible metal appliance connector may be used for connecting the cooktop to the gas supply line.



- Must include a shutoff valve:
The supply line must be equipped with a manual shutoff valve. This valve should be located in the same room but external to the cooktop enclosure or cabinet. It should be in a location that allows ease of opening and closing. Do not block access to shutoff valve. The valve is for turning on or shutting off gas to the cooktop.

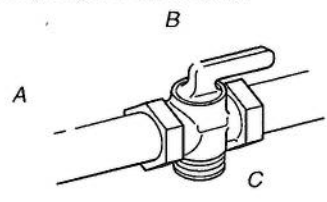

A. Gas supply line
B. Shutoff valve "open" position
C. To cooktop

Electrical:

A 120-volt, 60-Hz, AC-only, 15-amp, fused electrical circuit is required. A time-delay fuse or circuit breaker is also recommended. It is recommended that a separate circuit serving only this cooktop be provided.

†TEFLON is a registered trademark of E.I. Du Pont De Nemours and Company.

LOCATION REQUIREMENTS

IMPORTANT: Observe all governing codes and ordinances. Do not obstruct flow of combustion and ventilation air.
It is the installer's responsibility to comply with installation clearances specified on the model/serial rating plate. The model/serial rating plate is located on the underside of the cooktop burner base.
It is recommended that a 600 CFM or larger vent hood be installed above the cooktop.
It is not recommended that a microwave hood combination be mounted above the cooktop.

The cooktop should be installed in a location away from strong draft areas, such as windows, doors and strong heating vents or fans.
All openings in the wall or floor where cooktop is to be installed must be sealed.
Cabinet opening dimensions that are shown must be used. Given dimensions are minimum clearances.

IMPORTANT: To avoid damage to your cabinets, check with your builder or cabinet supplier to make sure that the materials used will not discolor, delaminate or sustain other damage.

PRODUCT DIMENSIONS

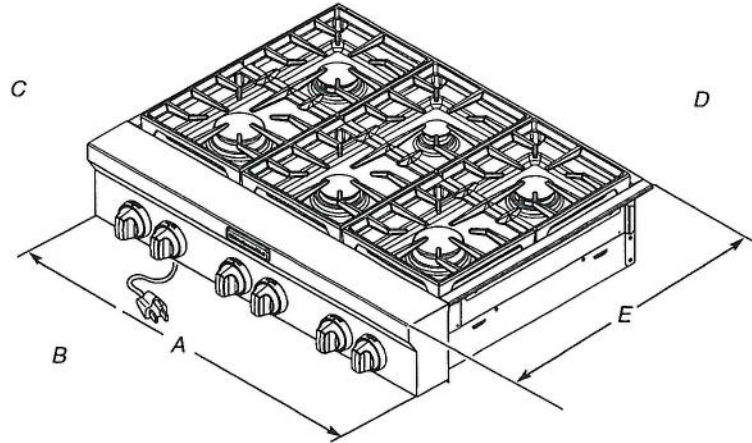

A. 36" (91.4 cm) cooktop: 29 1/8" (75.9 cm)
36" (91.4 cm) cooktop: 35 1/8" (91.1 cm)
48" (121.9 cm) cooktop: 47 1/8" (121.6 cm)
B. 36" (91.4 cm) long 3 prong grounding-type power supply cord
C. Model/serial rating plate (located on the underside of the cooktop burner base)
D. Island trim or optional backguard
E. 27 3/4" (70.5 cm)

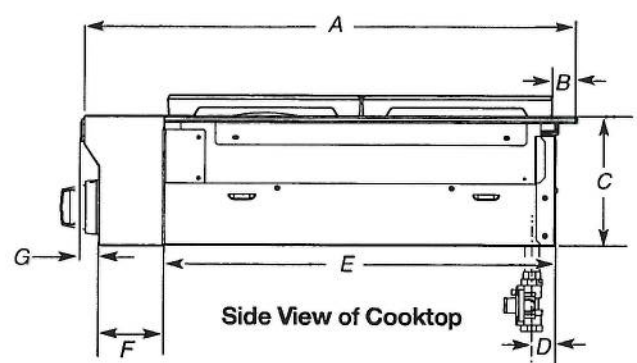

A. 27 3/4" (70.5 cm)
B. 1 1/4" (3.2 cm)
C. 7 1/16" (18.8 cm)
D. Gas inlet is located 1 7/8" (4.8 cm) from the back of the cooktop burner base and 4 7/8" (12.4 cm) in from left-hand side of the cooktop burner base.
E. 22" (55.9 cm)
F. 3 3/8" (9.2 cm)
G. 1" (2.6 cm)

CABINET REQUIREMENTS

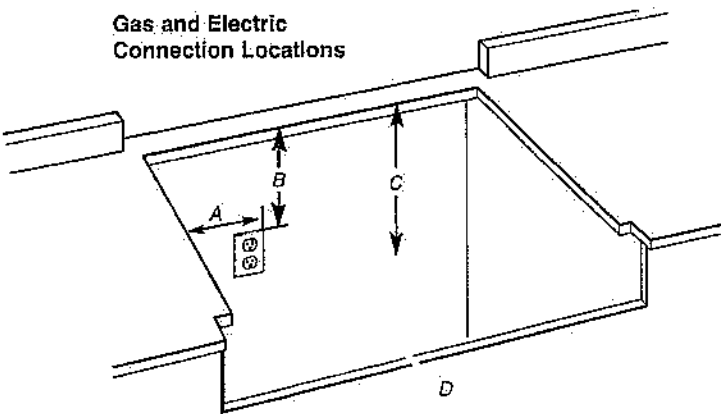

- A. Grounded 3-prong outlet should be located on left-hand side of the cutout 16" (40.6 cm) max. from enclosure sidewall
B. 10" (25.4 cm) min. clearance from countertop to top of the outlet
C. 14" (35.6 cm) countertop to the gas supply line
D. Gas supply line should be located in this area on rear or side walls, or the supply line can come up through the floor.
NOTE: Solid side and bottom of cutout enclosure not shown.

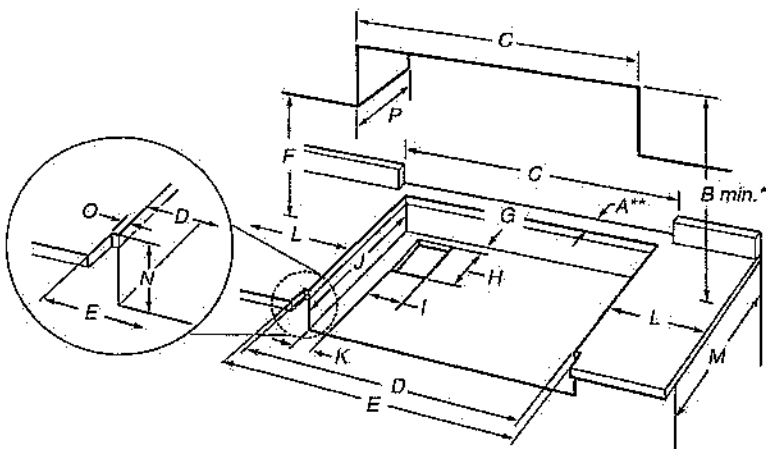

- A. See chart.
B. See chart.
C. See chart.
D. See chart.
E. See chart.
F. 18" (45.7 cm) min. clearance upper cabinet to countertop
G. 3/4" (1.9 cm) back of cabinet cutout to gas opening cutout
H. 6 3/4" (16.1 cm) gas opening cutout depth
I. 12 1/4" (31.7 cm) gas opening cutout width
J. 22 1/4" (56.5 cm) cabinet cutout depth
K. 2" (5.1 cm) cabinet side to gas cutout
L. 6" (15.2 cm) min. distance on both sides of the cooktop to the side wall or other combustible material above cooking surface
M. 24" (61.0 cm) cabinet depth
N. 7 1/4" (18.4 cm) cabinet depth to countertop
O. Notch to be equal on both sides
P. 13" (33.0 cm) upper cabinet depth

Size	Model	A** Cooktop Cutout to Back Wall	B* Cooktop to Cabinet	C Optional Backguard Opening	D Cabinet and Countertop	E Countertop Only
30" (76.2 cm)	KGCU407	1 3/4" (4.4 cm)**	30" (76.2 cm)	30" (76.2 cm)	29 1/4" (74.3 cm)	30" (76.2 cm) or 29 3/4" (75.9 cm) for zero clearance
36" (91.4 cm)	KGCU462 KGCU463 KGCU467	1 1/2" (3.8 cm)** 1 3/4" (4.4 cm) 1 3/4" (4.4 cm)	42" (106.7 cm)	36" (91.4 cm)	35 1/4" (89.5 cm)	36" (91.4 cm) or 35 3/8" (91.1 cm) for zero clearance
48" (121.9 cm)	KGCU482 KGCU483 KGCU484	1 1/2" (3.8 cm)** 1 3/4" (4.4 cm)** 1 1/2" (3.8 cm)**	42" (106.7 cm)	48" (121.9 cm)	47 1/4" (120.0 cm)	48" (121.9 cm) or 47 3/8" (121.6 cm) for zero clearance

*NOTES: Dimension "B" can be reduced by 6" (15.2 cm) when bottom of wood or metal cabinet is covered by not less than 0.25" (6.4 mm) flame retardant millboard covered with not less than No. 28 MSG sheet metal, 0.015" (0.4 mm) stainless steel, 0.024" (0.6 mm) aluminum or 0.020" (0.5 mm) copper.

If installing a range hood above the cooktop, follow the range hood instructions for dimensional clearances above the cooktop surface.

**NOTE: If backwall is constructed of a combustible material and a backguard is not installed, a minimum clearance of dimension A + 6" (15.2 cm) is required for 48" (121.9 cm) cooktops and cooktops with a grill.

BIK 37
Riverwalk ii

KitchenAid® Range Hood - 36" (91.4 cm) and 48" (121.9 cm)

PRODUCT MODEL NUMBERS

KXW9736Y KXW9748Y

Electrical Requirements:

- A 120 volt, 60 Hz., AC only, 15-amp, fused electrical circuit is required.
 - If the house has aluminum wiring, follow the procedure below:
 1. Connect a section of solid copper wire to the pigtail leads.
 2. Connect the aluminum wiring to the added section of copper wire using special connectors and/or tools designed and UL listed for joining copper to aluminum.
- Follow the electrical connector manufacturer's recommended procedure. Aluminum/copper connection must conform with local codes and industry accepted wiring practices.

CABINET OPENING DIMENSIONS

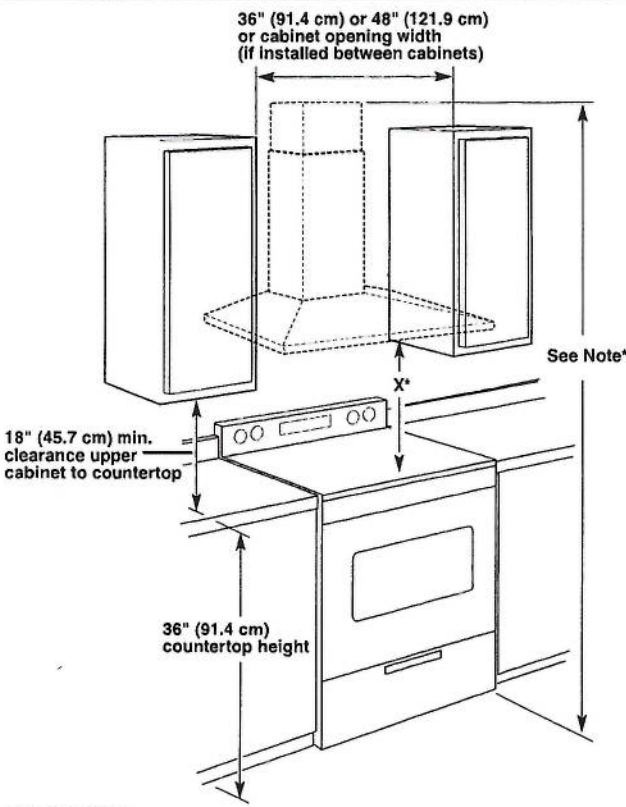

IMPORTANT:

Minimum distance "X": 24" (61 cm) from electric cooking surfaces
Minimum distance "X": 30" (76.2 cm) from gas cooking surfaces
The chimneys can be adjusted for different ceiling heights. See the following chart.

	Vented Installations	
	Min. ceiling height	Max. ceiling height
Electric cooking surface	7' 9" (2.36 m)	10' 2" (3.1 m)
Gas cooking surface	8' 3" (2.51 m)	10' 2" (3.1 m)

***NOTE:** The range hood chimneys are adjustable and designed to meet varying ceiling or soffit heights depending on the distance "X" between the bottom of the range hood and the cooking surface. For higher ceilings, an Extension Kit Part Number W10352733 is available from your dealer or an authorized parts distributor. The chimney extension replaces the upper chimney shipped with the range hood.

PRODUCT DIMENSIONS

Vented Installations

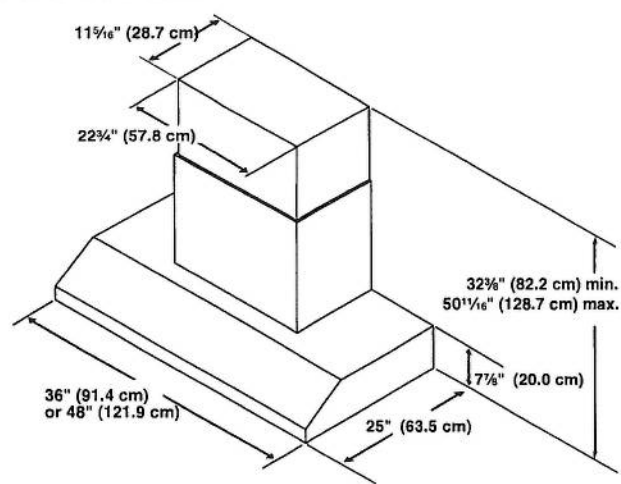

VENTING REQUIREMENTS

- Vent system must terminate to the outdoors.
 - Do not terminate the vent system in an attic or other enclosed area.
 - Do not use 4" (10.2 cm) laundry-type wall caps.
 - Use metal vent only. Rigid metal vent is recommended. Plastic or metal foil vent is not recommended.
 - The length of vent system and number of elbows should be kept to a minimum to provide efficient performance.
- For the most efficient and quiet operation:**
- Use no more than three 90° elbows.
 - Make sure there is a minimum of 24" (61.0 cm) of straight vent between the elbows if more than 1 elbow is used.
 - Do not install 2 elbows together.
 - Use clamps to seal all joints in the vent system.
 - The vent system must have a damper. If the roof or wall cap has a damper, do not use the damper supplied with the range hood.
 - Use caulking to seal exterior wall or roof opening around the cap.
 - The size of the vent should be uniform.

Venting Methods

Typical Internal Blower Motor System Venting Installations

A 10" (25.4 cm) round vent system is needed for installation (not included). The range hood exhaust opening is 10" (25.4 cm) round.

NOTE: Flexible vent is not recommended. Flexible vent creates back pressure and air turbulence that greatly reduce performance.

Vent system can terminate either through the roof or wall. To vent through the wall, a 90° elbow is needed.

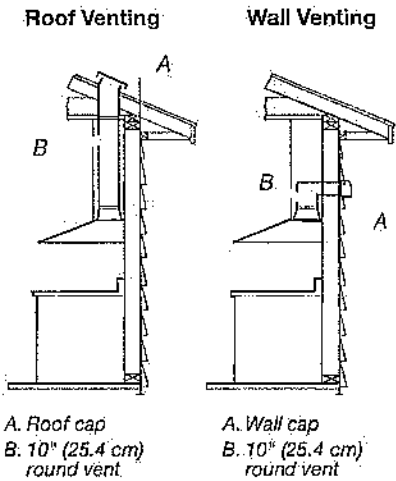

Typical In-line Blower Motor System Venting Installations

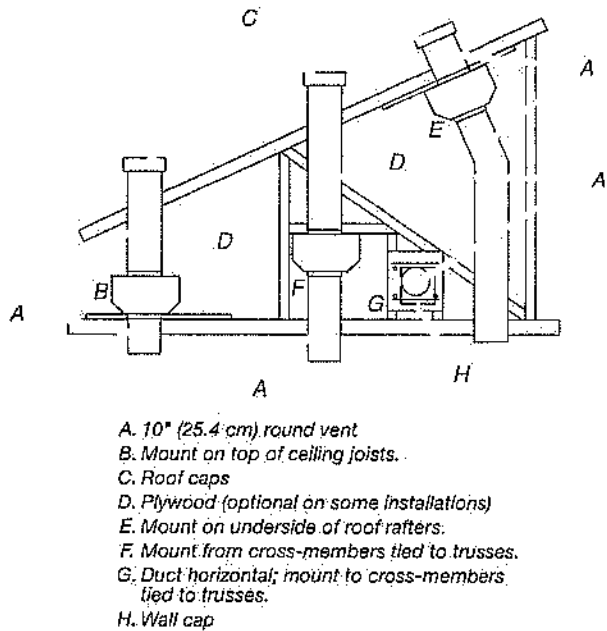

Calculating Vent System Length

To calculate the length of the system you need, add the equivalent feet (meters) for each vent piece used in the system.

Vent Piece	Equivalent Length	
45° elbow	2.5 ft (0.8 m)	
90° elbow	5.0 ft (1.5 m)	

The maximum equivalent vent lengths are:
10" (25.4 cm) round vent - 60 ft (18.3 m)

Example vent system

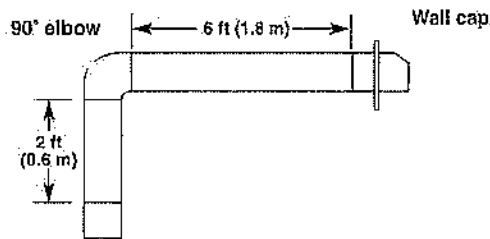

The following example falls within the maximum recommended vent length.

1 - 90° elbow	= 5.0 ft (1.5 m)
1 - wall cap	= 0.0 ft (0.0 m)
8 ft (2.4 m) straight	= 8.0 ft (2.4 m)
Length of system	= 13.0 ft (3.9 m)

JENN-AIR® DETAILED PLANNING DIMENSIONS

1 of 4

30" COMBINATION MICROWAVE/WALL OVENS

JMW3430D, JMW2430D – 30" x 43¾" x 25⅝"

PRODUCT DIMENSIONS

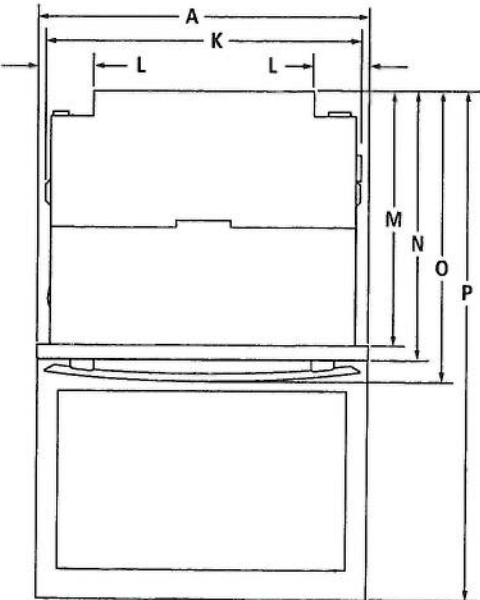
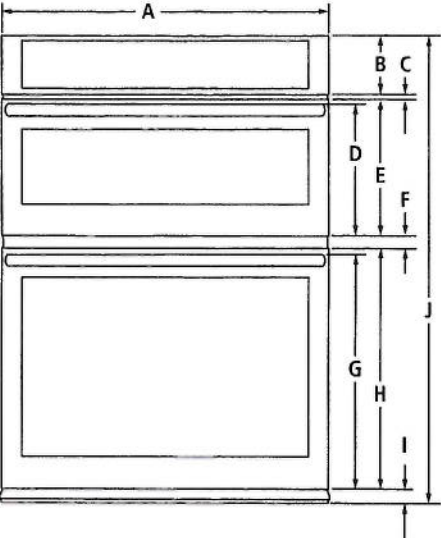

MODEL #	JMW3430D JMW2430D	
	in	cm
Overall width		
A Pro-Style® Stainless or Euro-Style Stainless	30	76.2
Floating Glass	29⅜	76.1
B Height of control panel	5½	14
C Space between control panel and door	½	1.2
Height to top of microwave oven handle		
D Pro-Style® Stainless	12⅜	31.0
Euro-Style (color-coordinating)	12⅜	31.0
E Height of microwave oven door	12⅜	32.3
F Space between doors	1⅝	2.9
Height to top of oven handle		
G Pro-Style® Stainless	21⅞	55.0
Euro-Style (color-coordinating)	21⅞	54.4
H Height of oven door	22⅞	56.2
I Height of trim	1⅞	4.3
J Overall height	43¾	111.1
K Width of recessed oven	28⅞	72.2
L Width of conduit channel	4⅝	12.5
M Depth of recessed oven	23¼	59.0
N Depth with doors	24⅞	61.9
Depth with handles		
O Pro-Style® Stainless	26⅞	67.0
Euro-Style (color-coordinating)	25⅞	64.3
P Depth with door fully open	45⅝	115.3

IMPORTANT: Dimensional specifications are provided for planning purposes only.
Do not make any cutouts based on this information. Refer to the Installation Guide before selecting cabinetry, verifying electrical/gas connections, making cutouts or beginning installation. All Jenn-Air® appliances are appropriately UL, CUL or CSA approved.

JENN-AIR® DETAILED PLANNING DIMENSIONS

30" COMBINATION MICROWAVE/WALL OVENS

JMW3430D, JMW2430D – 30" x 43³/₄" x 25⁵/₁₆"

DIMENSIONS AS INSTALLED

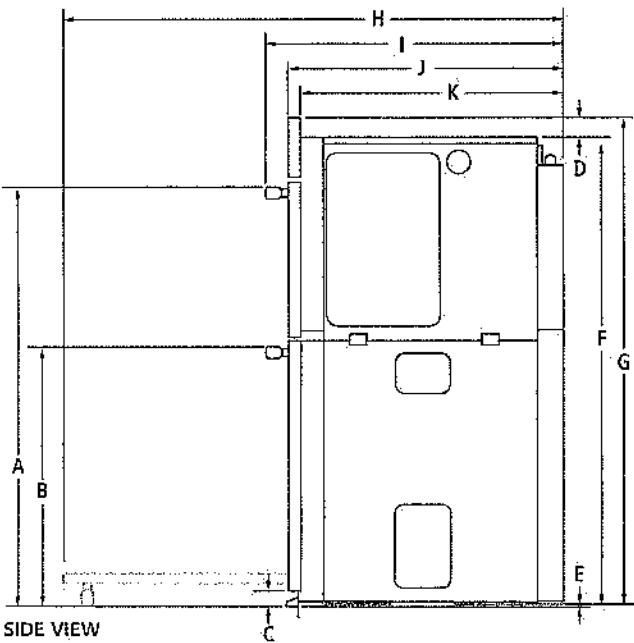

MODEL #	JMW3430D JMW2430D	
	in	cm
A	Height to top of upper handle	
	Pro-Style® Stainless	
	36 ⁵ / ₈	92.7
	Euro-Style (color-coordinating)	
	36 ⁵ / ₈	92.7
B	Height to top of lower handle	
	Pro-Style® Stainless	
	23 ³ / ₄	59.3
	Euro-Style (color-coordinating)	
	23 ³ / ₄	58.7
C	Height of trim extending below cutout	
	1 ¹ / ₄	4.3
D	Height from top of recessed oven to top of control panel	
	JMW3430D	
	2 ¹ / ₄	6.3
	JMW2430D	
	2 ¹⁵ / ₁₆	7.4
E	Height from bottom of recessed oven foot to bottom of oven vent	
	3/ ₁₆	0.5
F	Height of recessed oven	
	41	104.2
G	Height to top of control panel	
	43 ³ / ₄	111.1
H	Depth with door fully open	
	45 ³ / ₈	115.3
I	Depth with handles	
	Pro-Style® Stainless	
	26 ³ / ₈	67.0
	Euro-Style (color-coordinating)	
	25 ³ / ₈	64.3
J	Depth with doors	
	24 ³ / ₄	61.9
K	Depth of recessed oven	
	23 ³ / ₄	59.0

IMPORTANT: Dimensional specifications are provided for planning purposes only. Do not make any cutouts based on this information. Refer to the Installation Guide before selecting cabinetry, verifying electrical/gas connections, making cutouts or beginning installation. All Jenn-Air® appliances are appropriately UL, CUL or CSA approved.



8610AdZw915

JENN-AIR® DETAILED PLANNING DIMENSIONS

4 of 4

30" COMBINATION MICROWAVE/WALL OVENS – FLUSH INSTALLATION



JMW3430D, JMW2430D – 30" x 43³/₄" x 24³/₈" (depth without handles)

OPENING/CLEARANCE DIMENSIONS

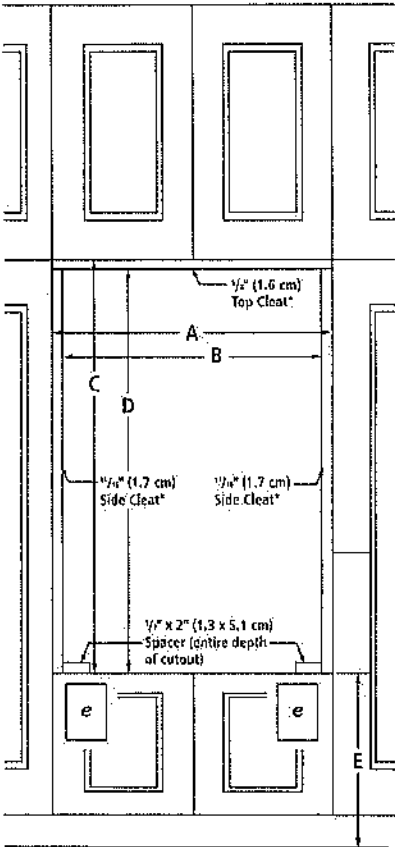

FRONT VIEW

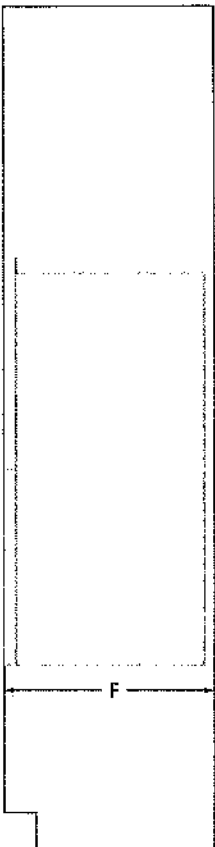

SIDE VIEW

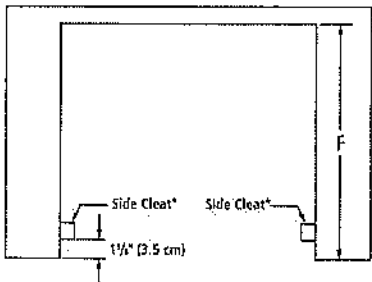

TOP VIEW

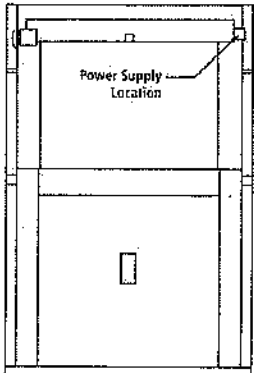

BACK VIEW

* Cleats and spacers must be recessed 1³/₈" (3.5 cm) from the front of the cabinet.

IMPORTANT: Dimensional specifications are provided for planning purposes only. Do not make any cutouts based on this information. Refer to the Installation Guide before selecting cabinetry, verifying electrical/gas connections, making cutouts or beginning installation. All Jenn-Air® appliances are appropriately UL, CUL or CSA approved.

MODEL #	JMW3430D	
	JMW2430D	
	in	cm
A	Width of flush inset cutout (min.)	30 ³ / ₄ 76.8
B	Width of opening (min.)	28 ³ / ₄ 73.3
C	Height of flush inset cutout (min.)	44 ³ / ₈ 112.5
D	Height of opening (min.)	43 ³ / ₄ 110.9
E	Bottom of cutout to floor	4 ³ / ₈ 11.7- 19 ¹ / ₄ 48.9
F	Depth of cutout (min.)	25 63.5
e	Recommended junction box location	

ELECTRICAL REQUIREMENTS

240 volt, 40-amp fused, grounded circuit is required. A dedicated circuit is required.

The length of conduit provided is for serviceability. Do not cut the conduit. The junction box should be located 3" (7.6 cm) maximum below the support surface. Drill a 1" (2.5 cm) minimum diameter hole in the right rear or left rear corner of the support surface for access to the junction box.

FLUSH INSTALLATION REQUIREMENTS

A 25" (63.5 cm) minimum cutout depth is required. These dimensions will result in a 1/4" (0.6 cm) reveal on the top, a 1/4" (0.6 cm) reveal on the sides and a 1/8" (0.3 cm) reveal on the bottom of the wall oven. The front face of the cleats and spacers will be visible and should be treated as a finished surface.

KitchenAid®

FOR THE WAY IT'S MADE.®

Undercounter Dishwasher

PRODUCT MODEL NUMBERS

KDFE204E, KDTE104E, KDTE204E, KDTE254E, KDTM354E, KDTM384E, KDTM404E, KDTM504E, KDTM704E, KDTM804E

Electrical Requirements: 120-volt, 60 Hz, AC-only, 15- or 20-amp, fused electrical supply. Copper wire only. A time delay fuse or circuit breaker and separate circuit is recommended.

If direct wiring dishwasher: Use flexible, armored or nonmetallic, sheathed copper wire with grounding wire that meets the wiring requirements for your home and local codes and ordinances.

Use a UL Listed or CSA Approved conduit connector.

If connecting dishwasher with a power supply cord:

Use power supply cord kit (Part Number 4317824) marked for use with dishwashers. Follow the kit instructions for installing the power supply cord.

Power supply cord must plug into a grounded three-prong outlet located in the cabinet next to the dishwasher opening. Outlet must meet all local codes and ordinances.

Water Supply Requirements: A hot water line with 20 to 120 psi (138 to 862 kPa) water pressure. Water temperature must be 120°F (49°C) water at dishwasher. Use 3/8" O.D. copper tubing with compression fitting or flexible braided water supply line.

Note: 1/2" minimum plastic tubing is not recommended.

Use a 90° elbow with 3/4" hose connection with rubber washer (part number W10273460). Do not solder within 6" (15.2 cm) from water inlet valve.

Drain Requirements: A new drain hose is supplied with your dishwasher. If this is not long enough, use a new drain hose with a maximum length of 12' (3.7 m) (Part No. 3385556) that meets all current AHAM/IAPMO test standards, is resistant to heat and detergent, and fits the 1" (2.5 cm) drain connector of the dishwasher.

Make sure to connect the drain hose to waste tee or disposer inlet above drain trap in house plumbing and 20" (50.8 cm) minimum above the floor. It is recommended

that the drain hose either be looped up and securely fastened to the underside of the counter, or be connected to an air gap.

Make sure to use an air gap if the drain hose is connected to house plumbing lower than 20" (50.8 cm) above subfloor or floor.

Use 1/2" (1.3 cm) minimum I.D. drain line fittings.

If required, the air gap should be installed in accordance with the air gap installation instructions. When connecting the air gap a rubber hose (not provided) will be needed to connect to the waste tee or disposer inlet.

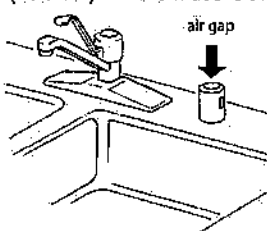

PRODUCT DIMENSIONS

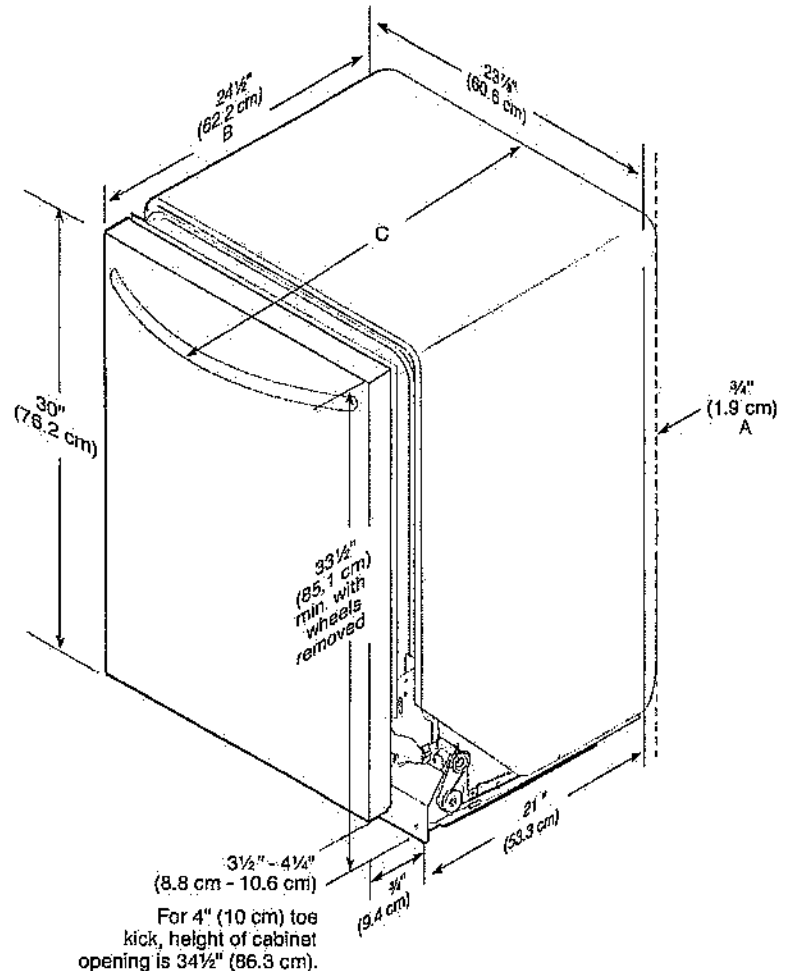

- A. Insulation may be compressed (not used on all models).
- B. For panel-ready models, dishwasher depth is 24" (60 cm) not including the 3/4" (1.9 cm) custom door panel.
- C. Door handles may protrude forward of the face of the dishwasher; varies by model.

CABINET CUTOUT DIMENSIONS

NOTE: Shaded areas of cabinet walls show where utility connections may be installed.

*Measure from the lowest point on the underside of the countertop. May be reduced to 33½" (85.1 cm) by removing the rear leveling legs from dishwasher.

**Minimum, measured from narrowest point of opening.

