

## HIGHCASTLE HOMES - COLOUR SCHEDULE

**Purchasers:** ADAM RAYMOND EMERSON BAINBRIDGE & MELISSA I **Property:** 2Phase: 2 of Plan - S-C-2007-004  
**Telephone Res. / Bus:** (905) 410-2976 / **Project:** 2174372 Ontario Ltd.  
**Decor Advisor:** Caroline Rajcsanyi **Model and Elevation:** The Davenport (33-3) Opt Ensuite Elev B

## KITCHEN AND VANITIES

KITCHEN AND VANITIES		Cabinet	Counter	Hardware
Kitchen		Lv1 - Belwood 3DL - Coconut	Lv1 - GR-Giallo Ornamentale*	9677 Handle
Main Bathroom		Lv1 - Manchester Oak - Shale Grey CL	White Carrara 4924-38	9677 Handle
Ensuite Bathroom		Lv1 - Belwood 3DL - Ontario White	Calcutta Marble 4925K-07	9677 Handle
Opt. Breakfast Bar		Counter Height/Flush	Kitchen Hood Fan	Standard
			Kitchen Upper Height	77 cm - Standard

Fridge Opening – if not specified will be set to builders minimum opening of approximately 33 x 71 height (townhouses)  
- if not specified will be set to builders minimum opening of approximately 36 x 71 height (singles)

Slide in Stove ☐ Yes ☒ No

Counter top Edge

Kitchen	Single Edge (3/4" Top Bevelled	

Opt. Kitchen Extras	
---------------------	--

PARQUET / HARDWOOD OR BROADLOOM

Kitchen / Breakfast	N/A	Master Bedroom	Lv2-National Event Lv2- 00103-Ecru
Great Room	*Oak Strip Lauzon Essential Expert 4 1/8" x 3/4"-Chocolate	Bedroom 2	Lv2-National Event Lv2- 00103-Ecru
Living / Formal Room	N/A	Bedroom 3	Lv2-National Event Lv2- 00103-Ecru
Dining Room	N/A	Bedroom 4	N/A
Family Room	N/A		
Main Hall	N/A		
Main Stairs	Lv2-National Event Lv2- 00103-Ecru		
Upper Hall	Lv2-National Event Lv2- 00103-Ecru		
Com. Centre/Home Office	N/A	Basement	N/A
Main Stair Landing	Lv2-National Event Lv2- 00103-Ecru	Basement Landing	N/A
Library/Den/Study	N/A	Basement Stairs	Paint Grade (Grey)
In Law Suite	N/A		

Carpet Runner ☐ Yes ☒ No

Underpad Main Floor

Underpad 2nd Floor

### Underpad Main Stairs

NA	Lv1 Underpad-standard	Lv1 Underpad-standard
----	-----------------------	-----------------------

### Opt. Flooring Extras

--

## FLOOR AND WALL TILES

<b>FLOOR AND WALL TILES</b>		<b>Floor Tile</b>	<b>Wall Tile</b>	<b>Decor</b>	<b>Listello</b>
Front Foyer	1-13x13, La Riserva, Taupe				
Main Hall	1-13x13, La Riserva, Taupe				
Kitchen/Breakfast	1-13x13, La Riserva, Taupe				
Powder Room	1-13x13, La Riserva, Taupe		Kitchen Backsplash	N/A	<input type="checkbox"/> <input type="checkbox"/>
Laundry	1-13x13, Alpes, White		Pwdr Wall if Applicable	N/A	<input type="checkbox"/> <input type="checkbox"/>

	Floor	Tub Wall	Shower Wall	Deck Skirt	Deck Splash	Decor	Listello
Main Bathroom	1-13x13, Alpes, White	1-8x10 Alpes, White	N/A	N/A	N/A		
Master Ens	1-13x13, New Reeds, Brown	N/A	1-8x10 New Reeds, Brown	1-13x13, New Reeds, Brown	1-8x10 New Reeds, Brown		

### Opt. Tile Extras

--

# HIGHCASTLE HOMES - COLOUR SCHEDULE

Purchasers: ADAM RAYMOND EMERSON BAINBRIDGE & MELISSA I Property: 2Phase: 2 of Plan - S-C-2007-004  
Telephone Res. / Bus: (905) 410-2976 / Project: 2174372 Ontario Ltd.  
Decor Advisor: Caroline Rajcsanyi Model and Elevation: The Davenport (33-3) Opt Ensuite Elev B

## PLUMBING / FAUCETS

Powder Room	Standard	
Main Bath	Standard	
Master Ensuite	Standard	
2nd Ensuite	NA	
R.I. Bath	NA	
Kitchen Sink	*Undermount GT - 100	
Kitchen Faucet	Standard	
Drain for 2nd floor Laundry	<input checked="" type="radio"/> Yes <input type="radio"/> No	
Supply and install all toilet paper holders, towel bars and soap dishes	<input type="radio"/> Yes <input checked="" type="radio"/> No	
Whirlpool		
Shower - Upgrade Floor		
Opt. Plumbing Extras		

## PAINTING

Wall Colour	Trim Colour	Railing Colour	Pickets Colour	Stair Colour
22 Warm Grey	Standard	*Stained as Floor	*Stained as Floor	Carpet On Stair
Opt. Paint Extras				

## MISCELLANEOUS

Railing Style	RAILING - STANDARD - 1 5/16in oak picket, 2 1/2in oak handrail and 2 3/4in oak post.			
Opt. Garage Door	*Yes-Grade Permitting	Opt. Side Door	NA	Stair Type
Interior Doors	*1 - Clermont	Int. Door Hardware	*Pewter Knob	Standard
Smooth Ceiling 1st Floor	<input type="radio"/> Yes <input checked="" type="radio"/> No	Trim Style	Standard - 2 1/4in Case & 3in Baseboard	Ext. Door Hardware
Smooth Ceiling 2nd Floor	<input type="radio"/> Yes <input checked="" type="radio"/> No			*Pewter Exterior package
Supply and Install Standard Mirrors	<input checked="" type="radio"/> Yes <input type="radio"/> No			Cold Cellar
Misc.				

## HEATING

Fireplace	Type	Mantle	Surround	Hearth
Great Room	*Standard	Standard - Paint Grade	N/A	N/A
Air Conditioning	<input checked="" type="radio"/> *Yes <input type="radio"/> No			
Hood Fan Duct	<input checked="" type="radio"/> 6 inch <input type="radio"/> 8 inch <input type="radio"/> 10 inch			
Gas Provisions for Dryer	<input type="radio"/> Yes <input checked="" type="radio"/> No			
Gas Provisions for Stove	<input type="radio"/> Yes <input checked="" type="radio"/> No			
			Gas Provisions for BBQ	<input type="radio"/> Yes <input checked="" type="radio"/> No
			Humidifier	<input type="radio"/> Yes <input checked="" type="radio"/> No

Exterior Colour Scheme:

Pre-selected By Vendor

### NOTE: The Purchaser(s) agree(s) that:



- Colours of materials are as close as possible to Vendor's selections, but not necessarily identical due to variances in manufacturing or manufacturers.
- Purchaser(s) has checked and acknowledges accuracy of the above selections. Where omissions occur on the original colour selection sheet Purchaser(s) acknowledge that the Builder's selection will be final.
- Upgrades or extras listed on this schedule will not be deemed part of the Agreement of Purchase and Sale. Any such upgrades or extras shall be null and void unless accompanied by a separate invoice and amendment. Said invoice must be paid in full.
- The Purchaser(s) further agrees that in the event that the Vendor has preselected colours prior to the purchase of the house, the prescribed colours are final notwithstanding that the Purchaser may have completed a colour selection schedule.
- The Purchaser(s) Acknowledges that once this colour schedule is signed and dated, no changes, additions or deletions will be permitted other than re-selection due to unavailability.

A \$350.00 (Per Occurance) change/administration fee will apply to above exceptions.

This Interior Colour Selection is final and approved by:

Signature:  Date: June 18/15

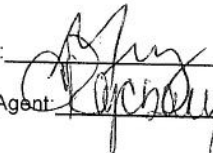
Printed 6/18/2015 13:03:39

Signature:  Date: June 18/15  
Builder's Agent:  Date: June 18/15





## Highcastle Homes Décor Centre Disclaimers

Lot#: 2 Model: The Davenport (33-3) Opt Ensuite Elev B in Northglen (H) - 2174372 Ontario Ltd.

PURCHASERS: ADAM RAYMOND EMERSON BAINBRIDGE and MELISSA KEELI ELLSMERE-YOUNG

TEL: RES.: 905-410-2976

*Through years of doing business, we at Highcastle Homes have encountered issues beyond our control. The following disclaimers apply to all instances of Purchaser's Extras forms and all Interior Colour Scheme forms.*

### Fireplaces

Fireplace Marble: Due to the many variables that can affect the pattern and/or design, frequently the marble installed on the fireplace will not be identical to the samples. We will make every attempt to come as close to the samples as possible, but cannot be responsible for results which differ from the samples.

### Ceramic Floor Tile

Many variables including variegation can affect tile colour, pattern and/or design which mean installed tiles may not be identical to the samples. We will make every attempt to come as close as possible, but cannot be responsible for results which differ from the samples.

### Hardwood Flooring

The purchaser is advised that cupping and shrinkage are characteristics of hardwood flooring normal appearing some time after installation, and no warranty is provided by the flooring supplier with respect to such cupping and shrinkage. The vendor agrees to install any hardwood flooring ordered by the purchaser in good and workmanlike manner, but shall not be responsible for, and is hereby released by the purchaser from responsibility and liability for cupping and shrinkage of hardwood flooring.

Shrinking and expanding/cupping of the hardwood floors may occur if the humidity levels in the home are not kept at industry recommendations. If the hardwood floors shrink or expand due to the homeowner not complying with these levels, the hardwood floor will no longer be under warranty and it will be the homeowner's responsibility to repair the flooring.

### Stain Colours

Due to many variables that can affect the outcome of a stain colour on wood, staircases, railings, and fireplaces, will not be identical to samples. Factors such as density, age humidity, air temperature, and the uniqueness of each piece of wood can result in wide variations in darkness or lightness. We will make every attempt to come as close to the sample as possible, but cannot be responsible for results which differ from the samples.

Stain on pre-finished hardwood floors will not be an exact match to the stain colours available on stairs, pickets and rails. The purchaser is responsible for choosing the stain on these areas to their satisfaction.

### Appliances

All fridge openings are set to builder's standard width. Please advise Décor Centre at time of colour appointment if custom sizing of cabinets is required for any built - in appliances. The purchaser is responsible for costs and fees associated with changes to pre-manufactured kitchens made subsequent to colour appointments.

### Kitchen Cabinets

The kitchen you order/purchase will undoubtedly contain slight colour variations. The degree of these variations is virtually impossible to determine before the kitchen is installed in its intended location. The amount of and type of lighting will also affect various highlights in the finish. Note: No two pieces of wood are identical. Variations in colour tone and grain patterns make a perfect colour match virtually impossible. It is generally agreed that these variations add to the natural beauty of a wood kitchen.

Shrinking and expanding of the kitchen cabinets may occur if the humidity levels in the home are not kept at industry recommendations. If the cabinets shrink or expand due to the homeowner not complying with these levels, the cabinets will no longer be under warranty and it will be the homeowner's responsibility to repair the cabinets.

### Plaster Mouldings and Medallions

Plaster mouldings will not be installed in open to above areas or areas with 2 storey elements.

### Metal Spindles

Due to the characteristics of wrought iron railing production, it is possible for the wrought iron to develop a scale effect. This scale may or may not be totally covered during the painting process. In effect, once the wrought iron picket is painted, the paint may in effect amplify the iron scale depending on the colour chosen. This is a natural effect of wrought iron and should not be construed as a defect or damage.

I hereby acknowledge reading and understanding the above copy and will not hold Highcastle Homes responsible for any issues in relation to above.

Purchasers Signature(s):

Date: June 18/15

Lot 2

# granitec

## Edge Profiles

### Single Edge (3/4")



3/4" Square Edge



3/4" Top Bevel



3/4" Bullnose



3/4" Roman Ogee

### Double Edge Standard (1 1/2")



1 1/2" Square Edge



1 1/2" Top Bevel



1 1/2" Double Bevel

### Double Edge Upgrade (1 1/2")



1 1/2" Bullnose



1 1/2" Ogee Flush



1 1/2" Ogee Step Out

8001 Weston Road #3, Woodbridge, Ontario Tel:905.856.0615 Fax:905.856.9192  
www.granitec.ca sales@granitec.ca

Sign *Ming*  
Sign *Zi*

Date June 18/15  
Date June 18/15



Date June 18, 2015

Ben Cabre

**A+R** over fireplace for future wall mount tv.  
*The Davenport* including Conduit  
Elevation A - 1513 sq.ft. • Elevation B - 1575 sq.ft.

Elevation A - 1513 sq.ft. • Elevation B - ~~1575~~ sq.ft.



**NORTHGLEN**  
EDUCATION

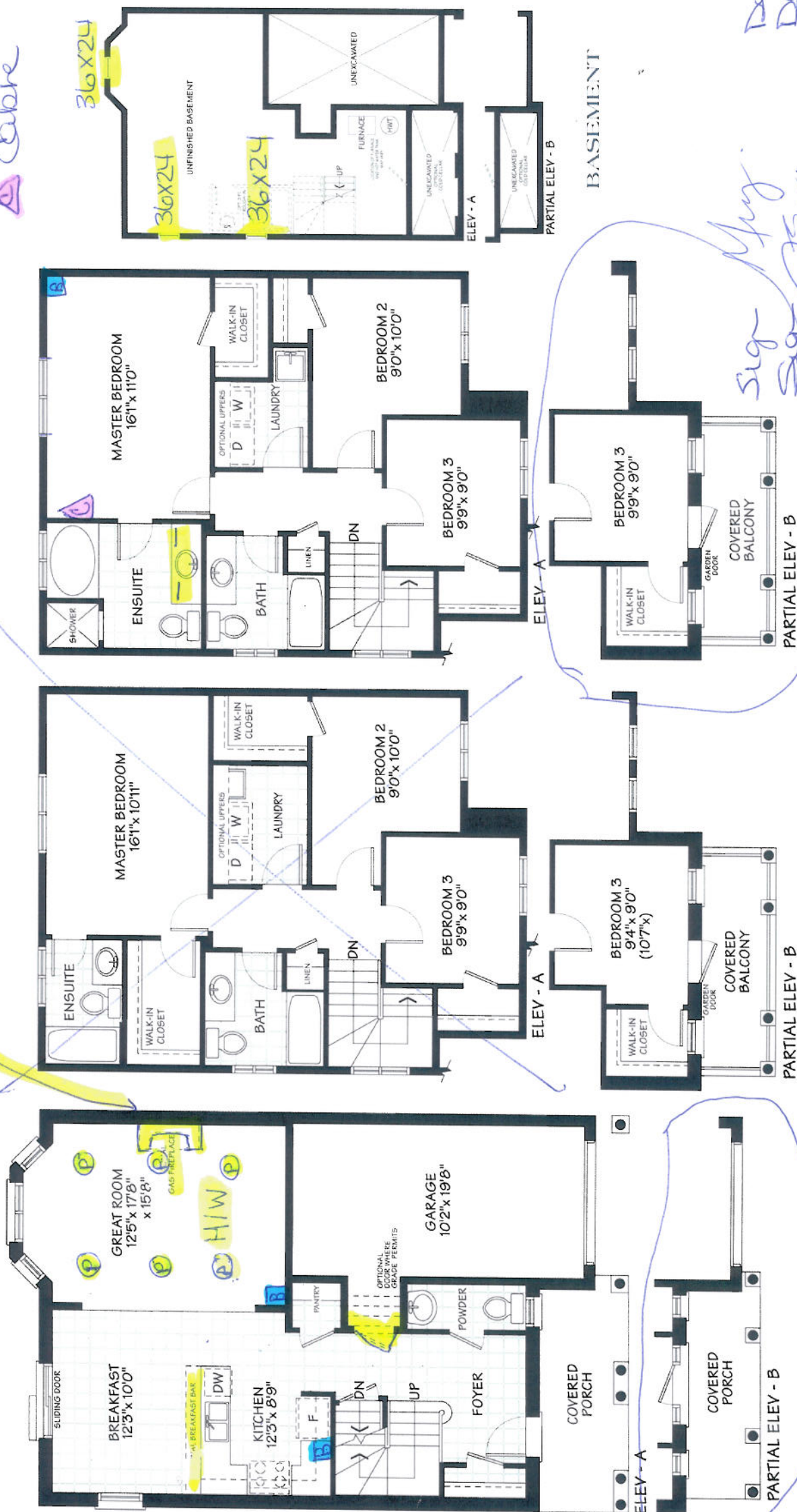

Sg. [Signature]  
 Sg. [Signature]  
 END  
 ft.

## SECOND FLOOR

## MAIN FLOOR

~~OPTIONAL SECOND~~  
Elev. -A 1516 sq.ft.

ALL PLANS, DIMENSIONS AND SPECIFICATIONS ARE SUBJECT TO CHANGE WITHOUT NOTICE. ALL MATERIALS FROM THE STATE FLOOR ARE A MIX OF BURNINGS AND FADING. THERE ARE AN ARTIST CONCEPT FOR



CONSTRUCTION SUMMARY

Northglen (H) - 2174372 Ontario Ltd.

PURCHASERS: ADAM RAYMOND EMERSON BAINBRIDGE and MELISSA KEELI ELLSMERE-YOUNG

TEL: RES.: 905-410-2976

LOT / PHASE	REG. PLAN #	HOUSE TYPE		CLOSING DATE
2 / 2	S-C-2007-004	The Davenport (33-3) Opt Ensuite Elev B		31-May-16

Agreement of Purchase and Sale

CENTRAL AIR CONDITIONER (FROM BUILDERS STANDARD SAMPLES) <i>Worksheet</i> Note:	
GRANITE KITCHEN COUNTER TOP (FROM BUILDERS STANDARD SAMPLES) <i>Worksheet</i> Note:	
2 1/4 INCH x 3/4 INCH NATURAL OAK HARDWOOD FLOORING IN GREAT ROOM - AS PER PLAN (FROM BUILDERS STANDARD SAMPLES) <i>Worksheet</i> Note:	





CONSTRUCTION SUMMARY

Northglen (H) - 2174372 Ontario Ltd.

PURCHASERS: ADAM RAYMOND EMERSON BAINBRIDGE and MELISSA KEELI ELLSMERE-YOUNG

TEL: RES.: 905-410-2976

LOT / PHASE 2 / 2	REG. PLAN # S-C-2007-004	HOUSE TYPE The Davenport (33-3) Opt Ensuite Elev B	CLOSING DATE 31-May-16
----------------------	-----------------------------	---	---------------------------

3) HEATING / AIR CONDITIONING

1 - FIREPLACE - GAS - 33 INCH SINGLE SIDED STANDARD - WITH STANDARD PAINT GRADE MANTLE - (NO MARBLE) - GREAT ROOM 18Jun15 Note: 11,067/29113	
--	--

4) PLUMBING

1 - LAUNDRY FLOOR DRAIN - ADD FLOOR DRAIN (NO SLOPED FLOOR OR LINER) 18Jun15 Note: 11,067/29119	
1 - SINK - KITCHEN - UNDERMOUNTED (2 EQUAL BOWL) GT-100 18Jun15 Note: 11,067/29118	

5) ELECTRICAL

6 - POT LIGHT - GREAT ROOM - 4 INCH POTLIGHT WITH LED ENERGY STAR BULB ( 6 MINIMUM - PRICE IS EACH) *DELETE STANDARD CEILING LIGHT IN GREAT ROOM* 18Jun15 Note: 11,067/29127	
1 - ELECTRICAL CONDUIT - RUN CONDUIT FROM WALL MOUNT TV TO CABLE BOX BELOW AT FLOOR HEIGHT AT FIREPLACE LOCATION 18Jun15 Note: 11,067/29115	
1 - PLUG - INTERIOR RECEPTICAL BESIDE CABLE OVER FIREPLACE FOR A FUTURE WALL MOUNT TV 18Jun15 Note: 11,067/29114	

6) FLOORING & WALL TILE

1 - OAK - 3/4" X 4 1/8" ENGINEERED - UPGRADE FROM 3/4X 2 1/4 NATURAL OAK - - GREAT ROOM (UPGRADE FROM HARDWOOD) 18Jun15 Note: 11,067/29116	
1 - TOWEL BAR/TOILET PAPER HOLDERS/SOAP DISHES - DO NOT SUPPLY AND INSTALL ALL TOILET PAPER HOLDERS, SOAP DISHES AND TOWEL BARS THROUGHOUT 18Jun15 Note: 11,067/29109	
1 - LEVEL 2 - CARPET - NATIONAL EVENT - 2ND FLOOR AND STAIRS 18Jun15 Note: 11,067/29107	

7) TRIM

1 - CLERMONT DOORS THROUGHOUT (STD. HOLLOW CORE) 18Jun15 Note: 11,067/29124	
---	--

8) FINISHING

1 - STAIN HANDRAIL AND PICKETS AND STRINGERS ONLY PER FLOOR 18Jun15 Note: 11,067/29128	
--	--

9) CABINETRY

1 - KITCHEN - GRANITE *GIALLO ORNAMENTALE 18Jun15 Note: 11,067/29111	
1 - OPTIONAL BREAKFAST BAR (GRANITE) 18Jun15 Note: 11,067/29110	

CABINETRY - BATHROOM



CONSTRUCTION SUMMARY

Northglen (H) - 2174372 Ontario Ltd.

PURCHASERS: ADAM RAYMOND EMERSON BAINBRIDGE and MELISSA KEELI ELLSMERE-YOUNG

TEL: RES.: 905-410-2976

LOT / PHASE 2 / 2	REG. PLAN # S-C-2007-004	HOUSE TYPE The Davenport (33-3) Opt Ensuite Elev B	CLOSING DATE 31-May-16
----------------------	-----------------------------	---	---------------------------

CABINETRY - BATHROOM

2 - VANITY CABINETS-VANITY TOP DRAWER PRICE PER DRAWER (INCLUDES FALSE DRAWERS)-LEVEL 1 OR LEVEL 2 (MASTER ENSUITE) 18Jun15 Note: 11,067/29129	
--	--

WINDOWS AND DOORS

3 - WINDOW - BASEMENT -ENLARGE STANDARD TO 36 INCH (W) X 24 INCH (H) - EACH ADDITIONAL 18Jun15 Note: 11,067/29126	
1 - DOOR - GARAGE TO INTERIOR - INCLUDING 3 WAY DOOR CLOSER 18Jun15 Note: 11,067/29125	

This Document is Extremely Time Sensitive - Printed 18 Jun 15 at 13:05