



SITE
APPLIANCE CANADA
FRENDEL KITCHENS
PRACTICAL ELECTRIC

Sales Selection Sheet

Williamsburg Green

REVISED

PURCHASER: INVENTORY HOME_32

TEL:

72 of 76

LOT / UNIT	PHASE	MODEL	
32	1	28-2660 B THE LEMONGRASS	

It is herein understood and agreed between the undersigned parties hereto that the following changes shall be made to the above mentioned Agreement of Purchase and Sale in accordance with the agreement and except for such changes noted below, all other terms and conditions in the Agreement of Purchase and Sale shall remain as stated herein: It is further understood that and agreed that all changes and additions shall be installed as per builder's specifications, location and available selections. The Purchaser hereby agrees to purchase the following extras:

APPLIANCES

1	FINISHED BASEMENT FAMILY (REC) ROOM - V-2 PLAN- SUPPLY AND INSTALL NEW PANASONIC COUNTERTOP STAINLESS MICROWAVE MODEL NN-ST67KS FOR NEW REVISED MICROWAVE SHELF SEE SPEC DELETE- DO NOT SUPPLY OR INSTALL WHIRLPOOL OTR AS PER ORIGINAL COLOUR CHART	Qty: 1.0000
150,667	Note:	

CABINETRY

*2 362,655	FINISHED BASEMENT FAMILY (REC) ROOM - CABINETRY-H34-WALL CABINET WITH SHELF FOR MICROWAVE (FINISHED INTERIOR) (OPENING 24INW X 13 3/4INH X 17IND) (NOT AVAILABLE IN SOME LAMINATES) VIKING	Qty: 1.0000
150,668	Note: V-2 PLAN REMOVE EXISTING OTR CABINET AND SUPPLY NEW MICROWAVE SHELF CABINET (VIKING III SIMCOE MOONLIGHT CABINETS) SKETCH # 8	

ELECTRICAL

3	FINISHED BASEMENT FAMILY (REC) ROOM - V-2 PLAN RELOCATE ELECTRICAL PLUG IF REQUIRED FROM DELETED OTR CABINET FOR NEW MICROWAVE SHELF	Qty: 1.0000
150,671	Note:	

Sub Total
HST
Total

1. This Sales Selection Sheet when properly executed forms part of our Agreement of Purchase and Sale.
2. All extras and upgrades listed above are subject to Construction Progress and Architectural and Municipal requirements.
3. In the event the Vendor is unable to incorporate the work approved above in the construction of the house for any reason whatsoever, the Vendor will not be liable to the Purchaser in any way. The monies paid for any changes or optional extras not proceeded with shall be returned to the Purchaser, without interest. The cost of options or extras is non-refundable in all other circumstances. If for any reason whatsoever the Agreement of Purchase and Sale is not completed, the total cost of work approved above will be retained by the Vendor.
4. The Vendor reserves the right to substitute above materials and equipment with that of equal or better quality.
5. Purchaser acknowledges that items may not be exactly as shown. Variations from the Vendor's samples may occur in finished materials due to normal production processes. Vendor is not responsible for shade difference which may occur from different dye lots or wood grains. Variations from the Vendor's samples will occur with natural materials such as wood, marble, granite, hardwood and brick.
6. The Vendor reserves the right to select Grout & Thresholds that best suits the Tile selected.
7. Selections will not be processed unless signed by Heathwood Homes Head Office.
8. The selections made on this schedule are final and cannot be changed once submitted.
9. The Purchaser has checked and acknowledges the accuracy of this schedule.

Initials:

TAX#:1

PREPARED BY: Marilyn Rosen

PE 1,818-1

SInvoice.rpt 28may19



Sales Selection Sheet
Williamsburg Green

73 of 76

PURCHASER: INVENTORY HOME_32

TEL:

LOT / UNIT 32	PHASE 1	MODEL 28-2660 B THE LEMONGRASS	
------------------	------------	-----------------------------------	--

Payment Summary	
<u>Paid By</u>	<u>Amount</u>
<u>Total Payment:</u>	

PURCHASER:

UNSAID INVENTORY

INVENTORY HOME_32

12-Feb-25

DATE

MARILYN ROSEN - DECOR

Decor Consultant

12-Feb-25

DATE

-02- 12 2025



Date Approved

Heathwood Homes (Williamsburg)

Limited

OPT. FINISHED BASEMENT

Sketch # 8

BATH
BASEMENT

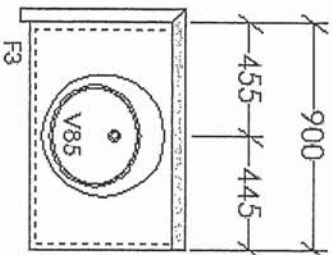

KITCHENETTE
BASEMENT

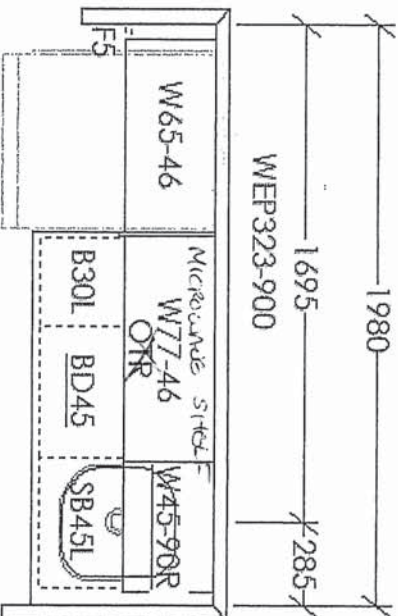

*** MOUNT AT 242 ***

RENOVE
OTR
CABINET
CHANGE TO
NEW MICROWAVE
SHELF
CABINET

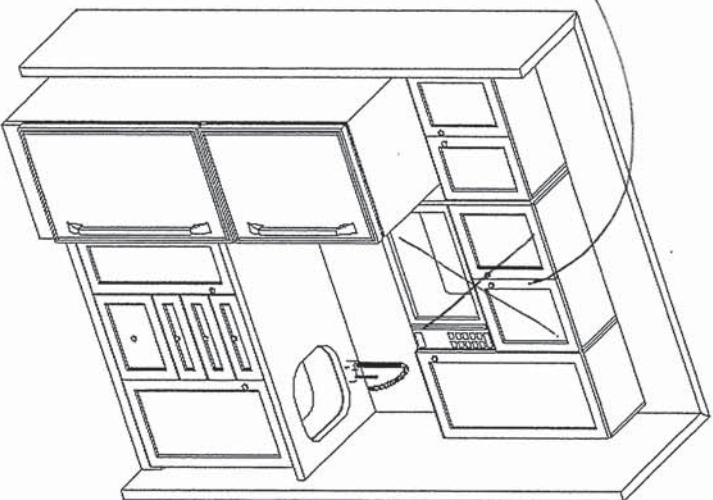

F R E N D E L
K I T C H E N S L I M I T E D
1350 Shawson Drive, Mississauga, ON L4W 1C5

HEATHWOOD HOMES
WILLIAMSBURG
MODEL: LEMONGRASS
28-2660 (3404)

STANDARD CONTRACT INCLUDES:

Appliance Openings

- Hood: 30"W Builder Hood
- Fridge Opening: 37 3/8 "W X 73 3/8"
- Fridge cabinet & gables: 66cm Deep
- Stove Opening: 30" Freestanding
- Dishwasher Opening: 24"

Standard Scope Kitchen, Vanity, Laundry:

- 100cm H wall Cabinets
- Base Pie Cut Corner Cabinets
- Std. Blumotion Hinges-**Soft Close Doors**
- Std. Metabox Drawers-**Not Soft Close**
- Top Drawer In Principal Ensuite (Qty x1)
- Std. Laundry Uppers - 61cm H
- Std. Laundry Base
- Std. Basement Baths
- Backing on All - Except Sink Cabinets
- Countertop by Others for Kitchen & Principal Ensuite

Drawn By: Sepideh B
Date: August 22, 2024
Scale: Not To Scale

This sketch is for DESIGN PURPOSES ONLY – It is not meant to be an exact rendition.

THIS DRAWING IS FOR DESIGN PURPOSES ONLY.
IT IS NOT AN EXACT RENDITION.

2/11/25, 10:54 AM

about:blank

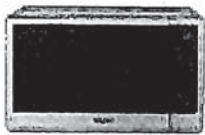

Countertop NN-ST67KS

MODEL & SIZE

Model Number	NN-ST67KS
Type	Mid-size
Oven Capacity	1.2 cu. ft.
Power Source	120 V / 60 Hz
Technology	Inverter®

Power	Microwave	1200W
	Colour	Silver
	Door	Side Open

DESIGN

Door Release	Push Open
Control Panel Design	Touch pad
Display Type	New 4 Digit + Icon
Display Color	White
Sensor	Yes

PROGRAMMABLE FEATURES

Microwave Power Level	11 (P0-P10) P0 keep warm
Cook time	99min 99sec
Kitchen Timer	Yes (99min 99sec)
Standing Time	Yes (99min 99sec)
Delay Start	Yes (99min 99sec)
Clock	12 H
Stage Cooking	3 Stage

SPECIFICATIONS

Outside Dimensions (H x W x D)	310 x 525 x 401 mm
Oven Dimensions (H x W x D)	251 x 355 x 365 mm

2/11/25, 10:54 AM

about:blank

MENU

Net Weight	11.5 kg
Turbo Defrost	Yes (0.1-3.0 kg)
Popcorn	3.2 oz. (91 g) / 2.75 oz. (78 g) / 1.5 oz. (42 g)
Keep Warm	Yes in microwave power (up to 30 min)
Add Time	Yes (Manual)
Quick 30	Yes (up to 5 min)
Serving / Weight	No
More/Less	Yes
Recipe Store / Memory	No
Auto Reheat	Sensor Reheat
Beverage	Coffee/Milk
Auto Cook categories	15
TRIM KIT X	NN-TK621SSAP/TK612GSSAP

© 2025 Panasonic Canada Inc. All rights reserved.